

1 - UPGRADE 3 FLOOR AND WALL TILES IN MAIN BATHROOM 07Jun19 Note:	
1 - UPGRADE 3 FLOOR AND WALL TILES IN MASTER ENSUITE 07Jun19 Note:	

1 - SMOOTH CEILINGS IN BEDROOMS										
07Jun19 Note:										

1 - UPGRADE COUNTERTOP EDGE IN KITCHEN AND BATHROOMS										
07Jun19 Note:										

1 - UPGRADE HARDWOOD THROUGHOUT										
07Jun19 Note:										

<p>1 - UPGRADE BATHROOM ACCESSORIES IN BOTH BATHROOMS- MOEN 90 DEGREE CHROME</p> <p>TOILET PAPER HOLDER #YB8808</p> <p>TOWEL RING #8886</p> <p>24" TOWEL BAR #YB8824</p> <p>07Jun19 Note:</p>	
--	--

1 - LESS CREDIT FROM PURCHASERS EXTRA SHEET IN OFFER	
07Jun19	Note:

<p>The Vendor agrees that notwithstanding any other term or provision in this Agreement included in the Purchase Price and in addition to those items detailed in Schedule D to the Agreement of Purchase and Sale, the Purchaser is entitled to a credit of Ten</p> <p><i>Worksheet</i> Note:</p>	
<p>1 Parking Unit</p> <p><i>Worksheet</i> Note:</p>	

Page 1 of 1

Purchasers: Roberto SALITURO & Bruno IERULLO
Telephone Res. / Bus: (905) 893-2514 / (416) 725-2144
Decor Advisor: Natalie Mancuso
Lock Date: 6/7/2019 11:38:37

Const. No.: Unit 2, Level 27
Municipal: PH02
Suite Type: E746
Project/Phase: Petaluma Building Corp./1

Layout Changes: ☐ Yes ☒ No Sketch Attached: ☒ Yes ☐ No Exterior Colour Scheme:

1. Kitchen and Vanities

	Style and Colour	Counter	Hardware
Kitchen / Breakfast	SEE BELOW	QUARTZ- LYSKAMM #360 EDGE	STD
Main Bath	ARUBA L602XZ4	QUARTZ- LYSKAMM #360 EDGE	STD
Master Ensuite Bathroom	ARUBA L602XZ4	QUARTZ- LYSKAMM #360 EDGE	STD

Appliances: Built In Appliances ☒ Yes ☐ No 41" Upper Cabinets ☒ Yes ☐ No Slide In Stove ☐ Yes ☒ No

Comment

KITCHEN UPPER CABINETS- SENOSAN DARK GREY
KITCHEN BASE CABINETS- ARUBA L602XZ4

2. Flooring

		Grout-If App.	At a 45
Entrance Vestibule	HARDWOOD- MIRAGE 4 5/16 LOCK RED OAK- HOPSCOTCH CHARACTER-BRUSHED		<input type="checkbox"/>
Main Hall	HARDWOOD- MIRAGE 4 5/16 LOCK RED OAK- HOPSCOTCH CHARACTER-BRUSHED		<input type="checkbox"/>
Kitchen / Breakfast	HARDWOOD- MIRAGE 4 5/16 LOCK RED OAK- HOPSCOTCH CHARACTER-BRUSHED		<input type="checkbox"/>
Laundry Room	TILE- MATTE WHITE 8X8	STD	<input type="checkbox"/>
Main Bath	TILE- RMD STATUARIO BRILL 10X30	STD	<input type="checkbox"/>
Master Ensuite Bathroom	TILE- RMD STATUARIO BRILL 10X30	STD	<input type="checkbox"/>
			<input type="checkbox"/>
Living Room	HARDWOOD- MIRAGE 4 5/16 LOCK RED OAK- HOPSCOTCH CHARACTER-BRUSHED		<input type="checkbox"/>
Dining Room	HARDWOOD- MIRAGE 4 5/16 LOCK RED OAK- HOPSCOTCH CHARACTER-BRUSHED		<input type="checkbox"/>
Den / Library / Study			<input type="checkbox"/>
Master Bedroom	HARDWOOD- MIRAGE 4 5/16 LOCK RED OAK- HOPSCOTCH CHARACTER-BRUSHED		<input type="checkbox"/>
Bedroom #2	HARDWOOD- MIRAGE 4 5/16 LOCK RED OAK- HOPSCOTCH CHARACTER-BRUSHED		<input type="checkbox"/>
Bedroom #3			<input type="checkbox"/>
			<input type="checkbox"/>

Comment

3. Wall Tile

	Selection	Grout	Describe
Main Bath			
Tub Deck Wall			
Shower Stall			
Bathtub Enclosure Walls	TILE- RMD STATUARIO BRILL 10X30	STD	
Master Ensuite Bathroom			
Tub Deck Wall			
Shower Stall	TILE- RMD STATUARIO BRILL 10X30	STD	
Bathtub Enclosure Walls			
Kitchen Backsplash	QUARTZ- LYSKAMM		
Backsplash Behind Fridge			

Comment

** Refer to Construction Summary

4. Misc

Water Line for Fridge: NI
Interior Door Handles: STANDARD
Ceramic Bathroom Accessories: UPGRADE MOEN 90 DEGREE CHROME ☒ Yes ☐ No

Comment

Initials:  

Purchasers: Roberto SALITURO & Bruno IERULLO
Telephone Res. / Bus: (905) 893-2514 / (416) 725-2144
Decor Advisor: Natalie Mancuso
Lock Date: 6/7/2019 11:38:37

Const. No.: Unit 2, Level 27
Municipal: PH02
Suite Type: E746
Project/Phase: Petaluma Building Corp./1

5. Plaster Mouldings and Medallions

Entrance Vestibule			Living Room		
Main Hall			Dining Room		
Kitchen/Breakfast			Den / Library /Study		
Laundry Room			Master Bedroom		
Main Bath			BedRoom #2		
Master Ensuite Bathroom			BedRoom #3		

Comment

** Refer to Construction Summary

6. Wall Paint

Entrance Vestibule	BIRCH WHITE	Living Room	BIRCH WHITE
Main Hall	BIRCH WHITE	Dining Room	BIRCH WHITE
Kitchen / Breakfast	BIRCH WHITE	Den/Library	
Laundry Room	BIRCH WHITE	Master Bedroom	BIRCH WHITE
Main Bath	BIRCH WHITE	Bedroom #2	BIRCH WHITE
Master Ensuite	BIRCH WHITE	Bedroom #3	

Comment

7. General Comments

** Refer to Construction Summary

Disclaimers and Notes

- 1) Colours of all materials are as close as possible to builder's selection, but not necessarily identical due to variances in manufacturing.
- 2) Any extras listed above are null and void unless accompanied by a separate invoice/amendment. Said invoice must be paid in full.
- 3) The Purchaser agrees that this colour selection is final and that no changes will be permitted, unless required by the Vendor.
- 4) The Purchaser acknowledges reading and accepting document which contains other miscellaneous disclaimers.

Signature:  Date: June 7/19 Signature:  Date: JUN 6/7/19

Signature: _____ Date: _____

Initials: _____ Page 2 of 2

90°™

Traditional | Transitional | Modern

Geometric forms, squared corners and straight lines create an urban focal point for today's contemporary baths.



Toilet Tank Lever
Model YB8801

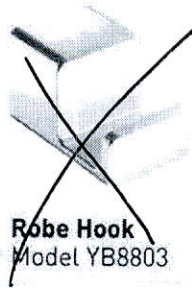

Robe Hook
Model YB8803

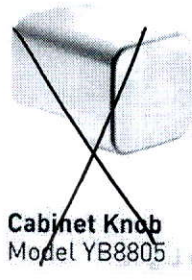

Cabinet Knob
Model YB8805

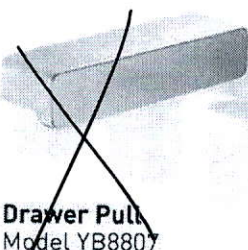

Drawer Pull
Model YB8807

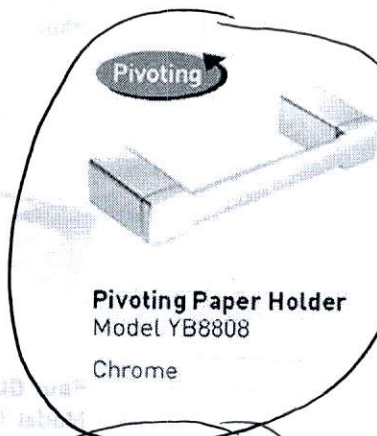

Pivoting Paper Holder
Model YB8808
Chrome



Mini Towel Bar
Model YB8886
Chrome

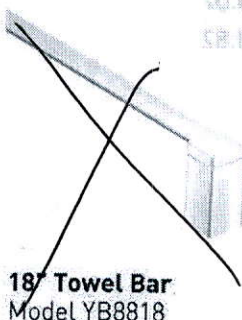

18\" Towel Bar
Model YB8818



24\" Towel Bar
Model YB8824
Chrome

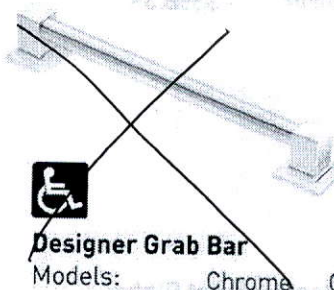

Designer Grab Bar
Models: Chrome Other

FINISH OPTIONS:



CH BN

To order, combine the model number with one of these finish letter(s):
Chrome (CH), LifeShine® Brushed Nickel (BN).

SCHEDULE 'A'

330
RICHMOND

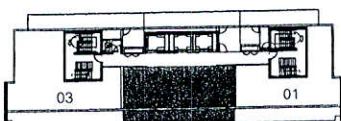
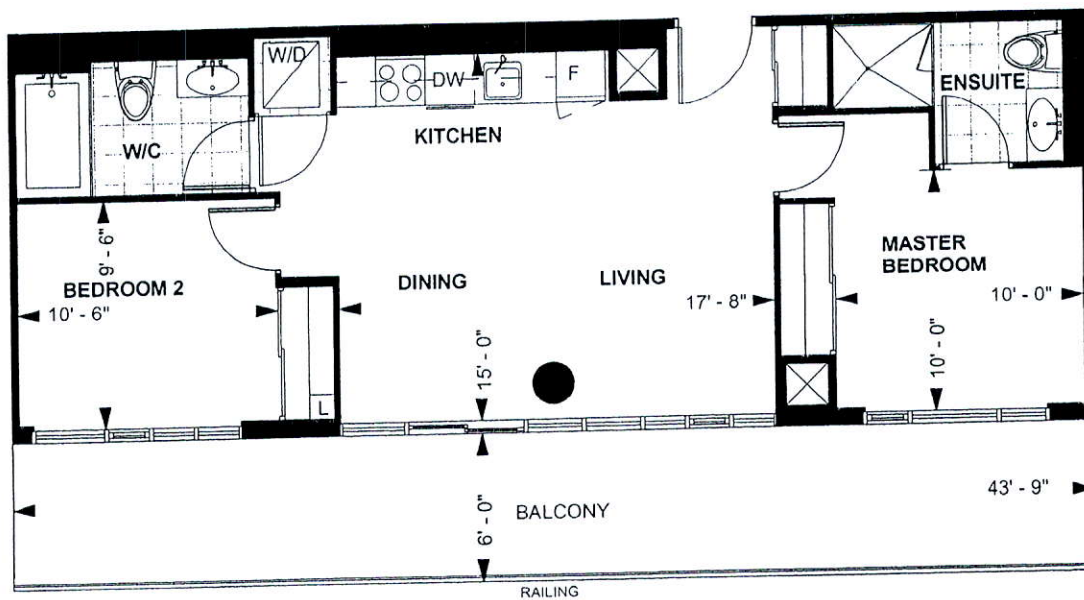

RECEIVED

NOV 01 2019

PENTHOUSE SUITE

E 746

10' CEILING *

746 sq. ft.

2-BEDROOM

Purchaser Initials Purchaser Initials

Date

Unit No. 2 Level No. 27 Suite No. PH02

Dimensions, specification, tile floor pattern and architectural detailing (including window size and location) are approximate and subject to modifications without notice. Orientation of suite may vary from the stated floor area.

*Ceiling height measured from top of floor slab to underside of slab above before finishes, and excluding bulkheads and required drop ceilings. E.&O.E.

*Upgrade Counter top Edge in Kitchen + Baths

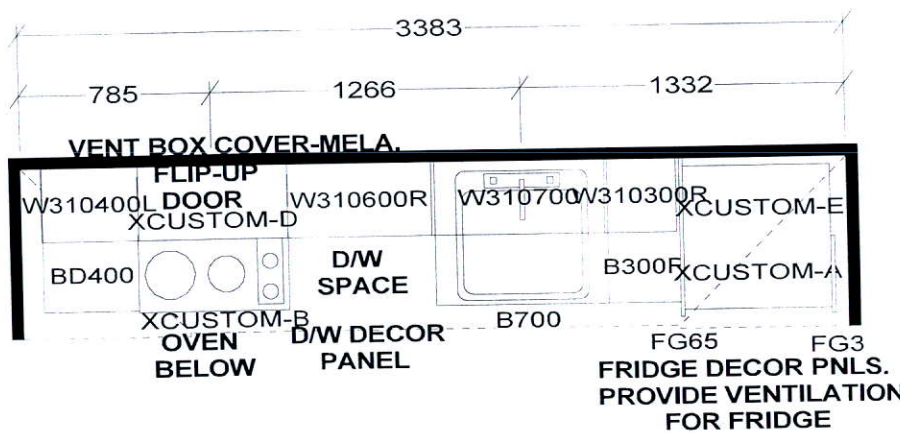

KITCHEN

KITCHEN BASES & VANITIES INSTALLED WITH ADJUSTABLE LEGS

- APPLIANCE PACKAGE:
- 24" INTEGRATED FRIDGE W/ DECOR PNLS
 - 24" INTEGRATED DISHWASHER W/ DECOR PNL
 - 24" BUILT-IN OVEN
 - 24" COOKTOP
 - 24" MICROWAVE HOOD FAN

Selba Industries

W		WDTH		W		HGHT		W		CNT		FL		HGHT		DWY		H		ST		CENT		2X4		VENT BOX COVER	
PENTHOUSE SUITES (10' Ceilings):										<div>This drawing is the intellectual property of SELBA INDUSTRIES INC. and is an original design which must not be released or copied unless applicable fee has been paid or job order placed.</div> <div><div>GA HB FC ED</div><div>JOB NUMBER: BUILDER: GREENPARK SITE NAME: PETALUMA MODEL: PENTHOUSE 2 BDRM - E 746, E 861 LOT #: DESIGNER: KS DATE: JAN 8 18</div></div>																	
1040MM HIGH UPPER CABINETS																											
WHITE STEEL DRAWER BOXES																											
COUNTERTOPS BY OTHERS																											
VENT BOX COVERS																											
CUSTOM VANITIES																											

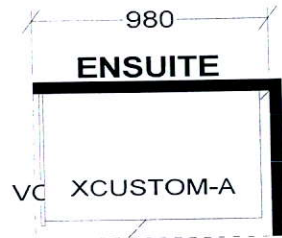

CUSTOM 2 DRAWER VANITY (Drawers modified to clear plumbing) FLOATING TOEKICK

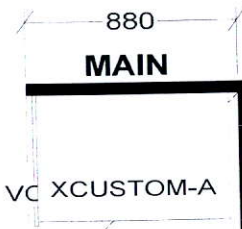

CUSTOM 2 DRAWER VANITY (Drawers modified to clear plumbing) FLOATING TOEKICK