

CONSTRUCTION SUMMARY		DATE: SEP 16 2019
330 Richmond - Petaluma Building Corp.		
PURCHASER: Diana Natalie URSO		TEL: RES.: 905-850-7836
Unit 3, Level 6 (703-1)	Floor Plan E771	

CABINETRY

1 - ***INSERT - KITCHEN - 34" UPPER CABINETRY TO BULKHEAD *** 13Sep19 Note: Insert	RECEIVED SEP 16 2019
1 - ***DELETE - KITCHEN - 41" UPPER CABINETRY *** 13Sep19 Note: DOES NOT FIT DUE TO MECHANICAL BEING INSTALLED ABOVE CABINETRY Delete	
1 - MAIN & MASTER BATHROOMS - UPGRADE 2 - HAMPTON CABINETRY 14Mar19 Note:	
1 - ***DELETE - BATHROOMS - UPGRADED MONACO CABINETRY WITH STAIN*** 14Mar19 Note: Delete	
1 - MAIN AND MASTER BATHROOMS - MONACO CABINETRY WITH STAIN 02Oct18 Note:	
1 - KITCHEN - 41" UPPER CABINETRY 02Oct18 Note:	
1 - KITCHEN - UPPER AND BASE CABINETRY - MISSION - UPGRADE 5 CABINETRY 02Oct18 Note:	

CERAMIC TILE

1 - MASTER ENSUITE BATHROOM - SHOWER STALL - SUL 1001 LATERN WHITE GLOSSY (6.5X5.5) 02Oct18 Note:	
1 - MASTER ENSUITE BATHROOM - FLOOR - UPGRADE 5 TILE - LAID STRAIGHT 02Oct18 Note:	
1 - DELETE STANDARD BATHROOM ACCESSORIES - DO NOT INSTALL SOAP DISH, TOWEL RACK OR TISSUE HOLDER 02Oct18 Note:	
1 - MAIN BATHROOM - TUB ENCLOSURE WALLS - UPGRADE 2 MOSAIC TILE 02Oct18 Note:	
1 - MAIN BATHROOM - FLOOR - UPGRADE 5 TILE - LAID STRAIGHT 02Oct18 Note:	
1 - KITCHEN - UPGRADE 2 MOSAIC BACKSPLASH 02Oct18 Note:	

CONSTRUCTION

2 - BEDROOMS - SMOOTH CEILINGS 02Oct18 Note:	
1 - ENSUITE BATH - 5 FOOT SHOWER WITH SLIDING CHROME FRAMED GLASS DOORS IN LIEU OF TUB 24Apr18 Note: upgraded Doors.	

COUNTER TOP

1 - MASTER ENSUITE BATHROOM - UPGRADED EDGE ON COUNTERTOP 02Oct18 Note:	
1 - MASTER ENSUITE BATHROOM - HIGH-END QUARTZ COUNTERTOP IN LIEU OF STANDARD AS PER OFFER 02Oct18 Note:	
1 - MAIN BATHROOM - UPGRADED EDGE ON COUNTERTOP 02Oct18 Note:	
1 - MAIN BATHRROM - HIGH-END QUARTZ COUNTERTOP IN LIEU OF STANDARD AS PER OFFER 02Oct18 Note:	

CONSTRUCTION SUMMARY
330 Richmond - Petaluma Building Corp.

PURCHASER: Diana Natalie URSO		TEL: RES.: 905-850-7836	
Unit 3, Level 6 (703-1)	Floor Plan E771		
1 - KITCHEN - UPGRADED EDGE ON COUNTERTOP 02Oct18 Note:			
1 - KITCHEN - HIGH-END QUARTZ COUNTERTOP IN LIEU OF STANDARD AS PER OFFER 02Oct18 Note:			

DOORS AND TRIM

1 - THROUGHOUT - 7 1/4" MDF COLONIAL BASEBOARD WITH 3" MDF COLONIAL CASING WITH BACKBEND 02Oct18 Note: WHERE CONSTRUCTION PERMITS	
---	--

ELECTRICAL

1 - LIVING ROOM - ADD LIGHT - IF CONSTRUCTION PERMITS - KEEP STANDARD PLUG TO SWITCH AS WELL 02Oct18 Note:	
--	--

HARDWOOD FLOORING

1 - THROUGHOUT - STANDARD NON-TILED AREAS - UPGRADE MAPLE HARDWOOD FLOORING IN LIEU OF STANDARD AS PER OFFER 02Oct18 Note:	
--	--

MIRRORS AND GLASS

1 - MASTER ENSUITE BATHROOM - SHOWER STALL DOOR AND PANEL - FRAMELESS GLASS SHOWER WITH D-RING AND TOWEL BAR 02Oct18 Note:	
--	--

MISCELLANEOUS

1 - FUTHER DISCOUNT AS PER VENDOR 02Oct18 Note:	
---	--

PLUMBING

1 - MAIN & MASTER ENSUITE BATHROOMS - 90 DEGREE BATHROOM ACCESSORIES - TOILET PAPER HOLDER #YB8808, TOWEL RING #YB8886 & 24" TOWEL BAR #YB8824 02Oct18 Note:	
1 - MASTER BATHROOM - ADD MOEN 90 DEGREE ECO-PERFORMANCE 1 FUNCTION HAND SHOWER WITH SLIDE BAR - CHROME - WITH 3 FUNCTION DIVERTER - #TS4172/3372 S3879EP/A721 02Oct18 Note:	
1 - MAIN BATHROOM - ADD MOEN 90 DEGREE ECO-PERFORMANCE 1 FUNCTION HAND SHOWER WITH SLIDE BAR - CHROME - WITH 3 FUNCTION DIVERTER - #128284/TS4172/3372 S3879EP/A721 02Oct18 Note:	
1 - KITCHEN - BLANCO QUATRUS R15 U 1 MEDIUM UNDERMOUNT SINK #401517 02Oct18 Note:	

PROMOTIONAL

1 - LESS BALANCE OF CREDIT FROM PURCHASERS EXTRA SHEET IN OFFER 14Mar19 Note:	
1 - REDEMPTION OF PROMOTIONAL PACKAGE OF \$1,500. ORIGINAL PROMOTIONAL PACKAGE OF \$1,500 AS PER SCHEDULE PE DATED MARCH 26, 2016. 24Apr18 Note:	



<div>CONSTRUCTION SUMMARY</div> <div>330 Richmond - Petaluma Building Corp.</div>			
PURCHASER: Diana Natalie URSO		TEL: RES.: 905-850-7836	
Unit 3, Level 6 (703-1)	Floor Plan E771		

EXTRAS AS PER OFFER

I Parking Unit <i>Worksheet</i> Note:	
The Vendor agrees that notwithstanding any other term or provision in this Agreement included in the Purchase Price and in addition to those items detailed in Schedule D to the Agreement of Purchase and Sale, the Purchaser is entitled to a credit of One <i>Worksheet</i> Note:	

This Document is Extremely Time Sensitive - Printed 13 Sep 19 at 16:00

Purchaser: Diana Natalie URSO
Telephone Res. / Bus: (905) 850-7836 /
Decor Advisor: Candace Forza
Lock Date: 10/2/2018 14:48:12

Const. No.: Unit 3, Level 6
Municipal: 703
Suite Type: E771
Project/Phase: Petaluma Building Corp./1

Layout Changes: ☐ Yes ☒ No Sketch Attached: ☒ Yes ☐ No Exterior Colour Scheme:

1. Kitchen and Vanities	Style and Colour	Counter	Hardware
Kitchen / Breakfast	MISSION L614XZ4	QUARTZ-VIRGINIA-#360 PENCIL EDGE	STD
Main Bath	Hampton W821X24	QUARTZ-FROSTY CARRARA-#360 PENCIL EDGE	STD
Master Ensuite Bathroom	Hampton W821X24	QUARTZ-FROSTY CARRARA-#360 PENCIL EDGE	STD

Appliances: **RECEIVED** **MAR 22 2019** Built In Appliances ☒ Yes ☐ No ~~41"~~ Upper Cabinets ☒ Yes ☐ No Slide In Stove ☐ Yes ☒ No

Comment **REVISED** **34"** **RECEIVED**

SEP 16 2019
DATE: _____

2. Flooring		Grout-If App.	At a 45
Entrance Vestibule	STRIP-MIRAGE-LOCK-ADMIRATION-MAPLE-CASHMERE-COFFEE-4 5/16"		<input type="checkbox"/>
Main Hall	STRIP-MIRAGE-LOCK-ADMIRATION-MAPLE-CASHMERE-COFFEE-4 5/16"		<input type="checkbox"/>
Kitchen / Breakfast	STRIP-MIRAGE-LOCK-ADMIRATION-MAPLE-CASHMERE-COFFEE-4 5/16"		<input type="checkbox"/>
Laundry Room	TILE-WHITE-8X8	STANDARD	<input type="checkbox"/>
Main Bath	TILE-GOTHA DIAMOND LUX-24X24	TITANIUM 50	<input type="checkbox"/>
Master Ensuite Bathroom	TILE-GOTHA BRONZE LUX-24X24	PORTEBELLO49	<input type="checkbox"/>
	N/A		<input type="checkbox"/>
Living Room	STRIP-MIRAGE-LOCK-ADMIRATION-MAPLE-CASHMERE-COFFEE-4 5/16"		<input type="checkbox"/>
Dining Room	STRIP-MIRAGE-LOCK-ADMIRATION-MAPLE-CASHMERE-COFFEE-4 5/16"		<input type="checkbox"/>
Den / Library / Study	N/A		<input type="checkbox"/>
Master Bedroom	STRIP-MIRAGE-LOCK-ADMIRATION-MAPLE-CASHMERE-COFFEE-4 5/16"		<input type="checkbox"/>
Bedroom #2	STRIP-MIRAGE-LOCK-ADMIRATION-MAPLE-CASHMERE-COFFEE-4 5/16"		<input type="checkbox"/>
Bedroom #3	N/A		<input type="checkbox"/>
			<input type="checkbox"/>

Comment

3. Wall Tile	Selection	Grout	Describe
Main Bath			
Tub Deck Wall	N/A		
Shower Stall	N/A		
Bathtub Enclosure Walls	TILE-ARISTONE WHITE HEX MOSAIC-12X12	TITANIUM 50	(MB067B3-BP)
Master Ensuite Bathroom			
Tub Deck Wall	N/A		
Shower Stall	TILE-SUL1001 LATERN WHITE GLOSSY-	TITANIUM 50	6.5X6.5
Bathtub Enclosure Walls	N/A		
Kitchen Backsplash	TILE-BIANCO HEX. POL. (MB067B1-P)-	STANDARD	12X12
Backsplash Behind Fridge	N/A		

Comment
** Refer to Construction Summary

4. Misc	
Water Line for Fridge	N/A
Interior Door Handles	AS PER CONSTRUCTION SPECS
Ceramic Bathroom Accessories	NO - UPGRADE - MOEN 90 DEGREE <input type="radio"/> Yes <input checked="" type="radio"/> No

Comment

Purchaser: Diana Natalie URSO

Telephone Res. / Bus: (905) 850-7836 /

Decor Advisor: Candace Forza

Lock Date: 10/2/2018 14:48:12

Const. No.: Unit 3, Level 6

Municipal: 703

Suite Type: E771

Project/Phase: Petaluma Building Corp./1

5. Plaster Mouldings and Medallions

Entrance Vestibule	N/A		Living Room	N/A	
Main Hall	N/A		Dining Room	N/A	
Kitchen/Breakfast	N/A		Den / Library /Study	N/A	
Laundry Room	N/A		Master BedRoom	N/A	
Main Bath	N/A		BedRoom #2	N/A	
Master Ensuite Bathroom	N/A		BedRoom #3	N/A	

Comment

** Refer to Construction Summary

6. Wall Paint

Entrance Vestibule	43-BIRCH WHITE	Living Room	43-BIRCH WHITE
Main Hall	43-BIRCH WHITE	Dining Room	43-BIRCH WHITE
Kitchen / Breakfast	43-BIRCH WHITE	Den/Library	N/A
Laundry Room	43-BIRCH WHITE	Master Bedroom	43-BIRCH WHITE
Main Bath	43-BIRCH WHITE	Bedroom #2	43-BIRCH WHITE
Master Ensuite	43-BIRCH WHITE	Bedroom #3	N/A
	N/A		

Comment

7. General Comments

** Refer to Construction Summary

Disclaimers and Notes

- 1) Colours of all materials are as close as possible to builder's selection, but not necessarily identical due to variances in manufacturing.
- 2) Any extras listed above are null and void unless accompanied by a separate invoice/amendment. Said invoice must be paid in full.
- 3) The Purchaser agrees that this colour selection is final and that no changes will be permitted, unless required by the Vendor.
- 4) The Purchaser acknowledges reading and accepting document which contains other miscellaneous disclaimers.

Signature: 

Date: _____

Signature: _____

Date: _____

90°™

Traditional | Transitional | Modern

Geometric forms, squared corners and straight lines create an urban focal point for today's contemporary baths.



Toilet Tank Lever
Model YB8801

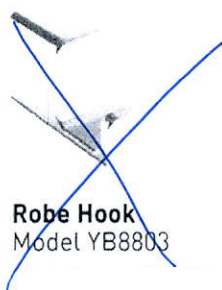

Robe Hook
Model YB8803



Cabinet Knob
Model YB8805

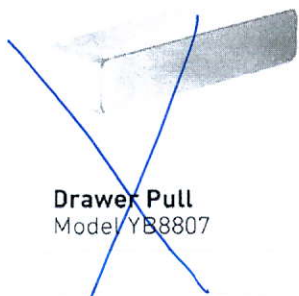

Drawer Pull
Model YB8807



Pivoting Paper Holder
Model YB8808
Chrome

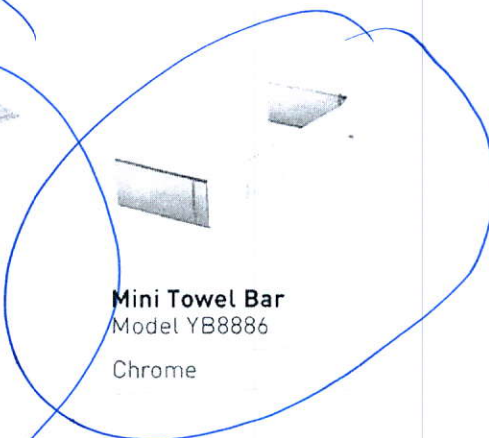

Mini Towel Bar
Model YB8886
Chrome



18" Towel Bar
Model YB8818

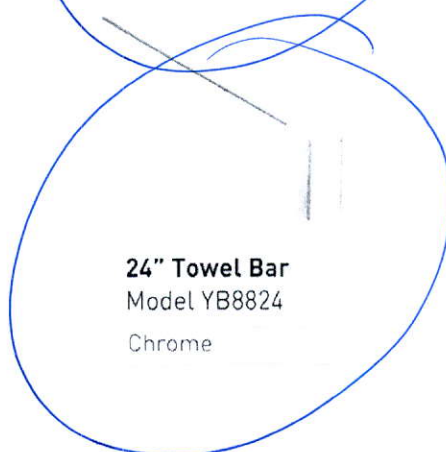

24" Towel Bar
Model YB8824
Chrome



Designer Grab Bar

Models: Chrome Other

12" - YG8812

18" - YG8818

24" - YG8824

36" - YG8836

FINISH OPTIONS:



CH

BN

To order, combine the model number with one of these finish letter(s):
Chrome (CH), LifeShine® Brushed Nickel (BN).

90°™

Traditional | Transitional | Modern

Geometric forms, squared corners and straight lines create an urban focal point for today's contemporary baths.

Main Bathroom

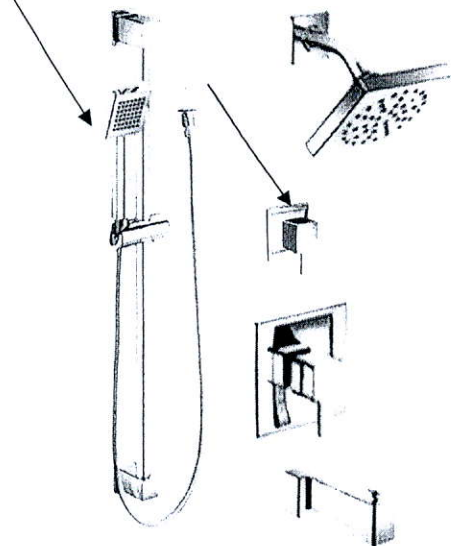

Posi-Temp® Tub/Shower Faucet
Function Transfer Valve/Trim
Bar with Hand Shower *

Model TS2713EP / 62380 –Standard /

Upgrade 128284 / TS4172 / 3372
(Three Function transfer valve and trim)

S3879EP / A721 -> Slide bar and Drop ell

Master Ensuite Bathroom

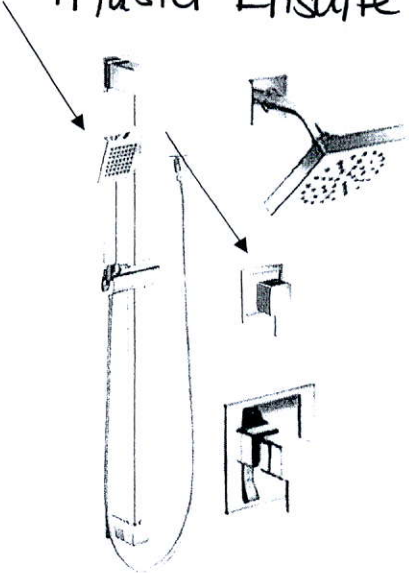

Posi-Temp® Shower Only
with 3 Function Transfer Valve/Trim
Slide Bar with Hand Shower * and

Model TS2712EP / 62380 –Standard /

Upgrade TS4172 / 3372
(Three Function transfer valve and trim)

S3879EP / A721 -> Slide bar and Drop ell

FINISH OPTIONS:

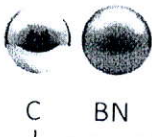

To order, combine the model number with one of these finish letter(s):
LifeShine® Brushed Nickel (BN).
To order Chrome (C) model, use model number only.
* Please see vertical spa guide for installation #700106

Posi-Temp[®]

with Transfer Valve

Geometric forms, squared corners and straight lines create an urban focal point for today's contemporary baths.

One-Wall Posi-Temp Used with 2- or 3-Function Transfer Valve

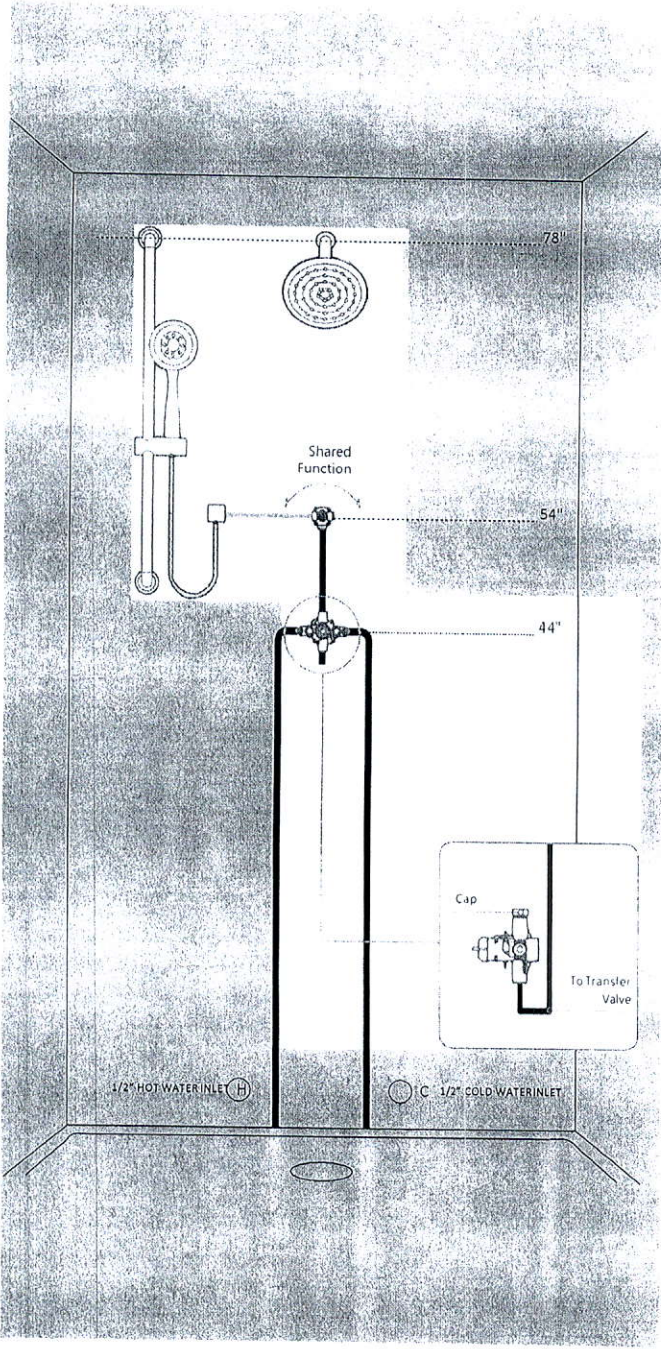

- * Use tub port to supply shower and plug shower port.
- * Primary showerhead.
- * Moen handshowers come with an integrated double check valve to prevent back-siphon.

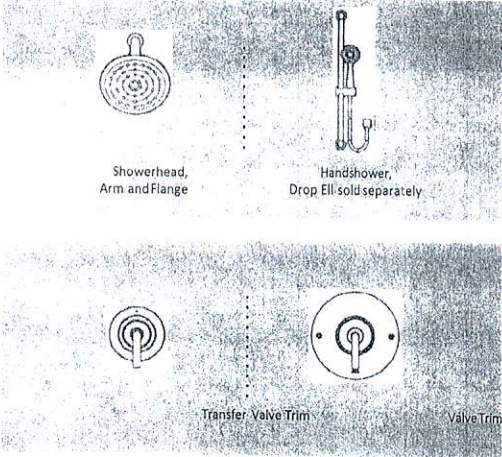

Shower spa trim is compatible with the M-PACT[®] Common Valve System.

All vertical dimensions measured from the floor. Dimensions listed are suggested. Refer to specification sheet for critical dimensions for installation.

Posi-Temp®

with Transfer Valve

Geometric forms, squared corners and straight lines create an urban focal point for today's contemporary baths.

Configuration 02

One-Wall Posi-Temp Used with 2- or 3-Function Transfer Valve and Tub Spout

- * Plug the shower port and use a twin ell to supply water from the tub spout to transfer valve.
 - * Primary showerhead.
 - * Moen handshowers come with an integrated double check valve to prevent back-siphon.

TUBSPOUT

 - * When using a diverter tub spout, plumb the flow valve outlet to the twin ell front vertical inlet.
 - * Plumb the twin ell rear vertical outlet to the two- or three-function transfer valve inlet.
 - * Plumb the twin ell front horizontal outlet to the diverter tub spout.

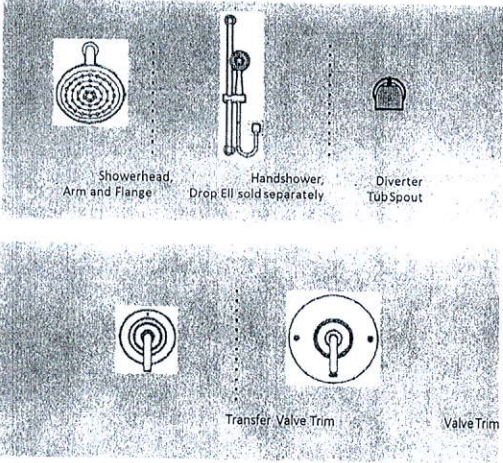

Shower spa trim is compatible with the M•PACT® Common Valve System.

NOTE: This configuration is intended for use with the diverter tub spout.

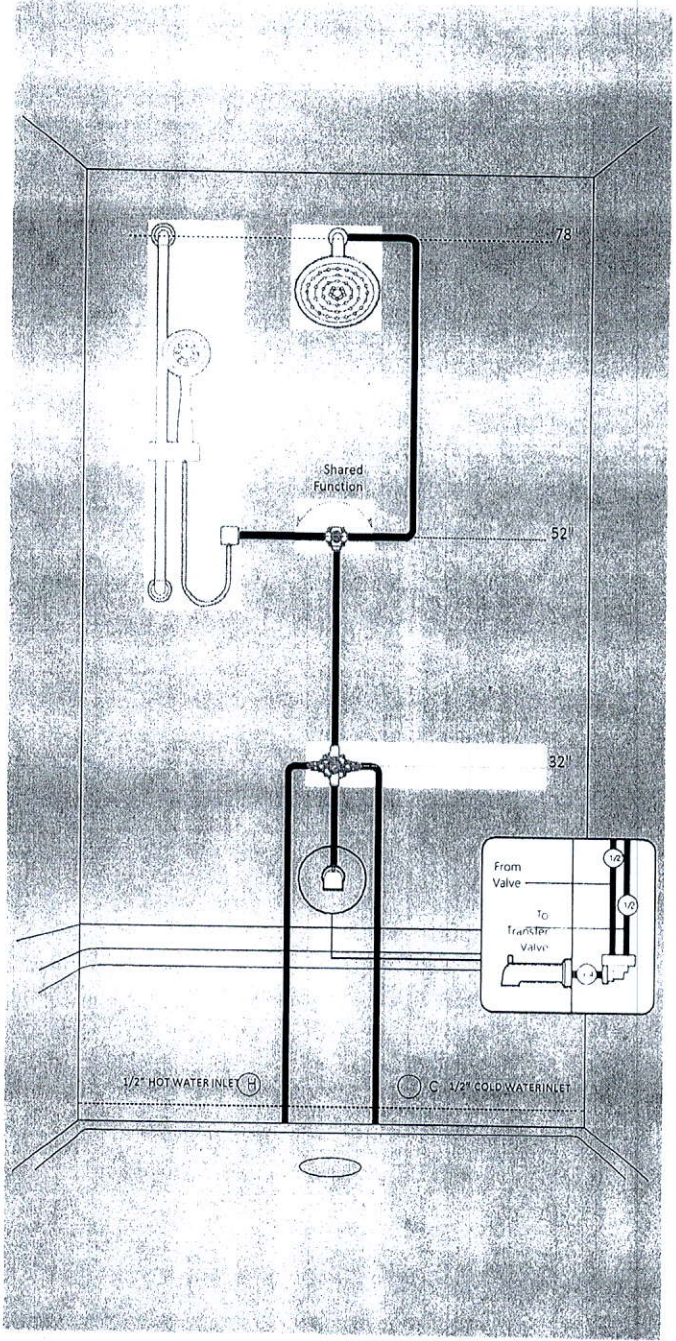

All vertical dimensions measured from the floor. Dimensions listed are suggested. Refer to specification sheet for critical dimensions for installation.

Product Specification Sheet

BLANCO QUATRUS R15 U 1 MEDIUM

Satin brushed finish



PRODUCT DIMENSIONS

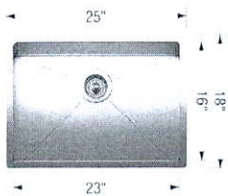

BLANCO QUATRUS R15 U 1 MEDIUM	Colour Finish	Model No.	FEATURES / SPECIFICATIONS
-------------------------------------	---------------	-----------	---------------------------

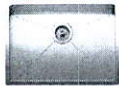

Satin brushed
finish

401517

- German designed and engineered
- Premium 304 series, 18 gauge stainless steel
- 18/10 chrome-nickel content for exceptional lustre, durability and strength
- Rear-positioned drain hole for maximum usable bowl and cabinet storage space
- Compact size, X-pattern drain grooves
- 15 mm radius corners for easy cleaning
- 3 1/2" (90mm) stainless steel strainer included
- Clips, template included
- Limited Lifetime Warranty

DESIGN AND PLANNING TIPS

Cabinet Size: 27" (685 mm)
Bowl depth: 9" (230 mm)
Depending on cabinet construction, a different cabinet size may be required.
Consult the cabinet manufacturer.

WARRANTY

Limited Lifetime warranty

Code/Standards Compliance

BLANCO sinks and faucets are third-party tested and certified to CSA, cUPC, ANSI/ASME and NSF standards and listed by applicable certification bodies. For more information on individual product listings, contact our office or listing organization.

SCHEDULE 'A'

330

RICHMOND

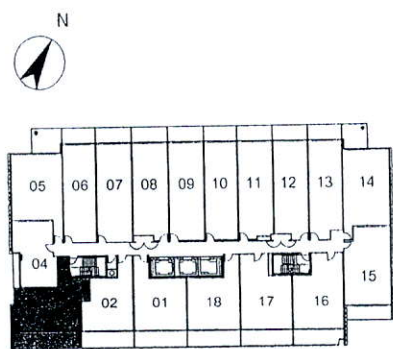
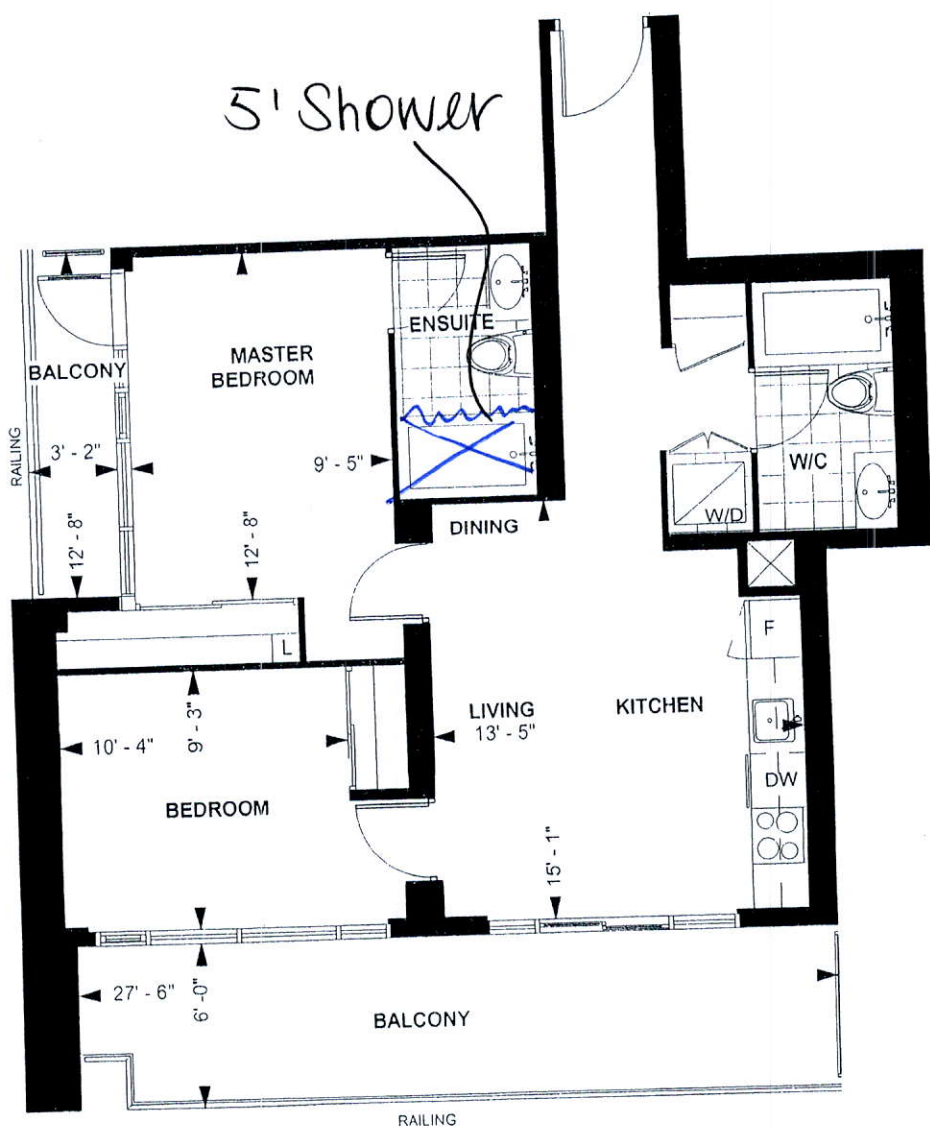

TOWER SUITE
E 771
9' CEILING *
771 sq. ft.
2-BEDROOM

[Signature] *[Signature]* 26/03/16
Purchaser Initials Purchaser Initials Date
Unit No. 3 Level No. 6 Suite No. 703

Dimensions, specification, tile floor pattern and architectural detailing (including window size and location) are approximate and subject to modifications without notice. Orientation of suite may vary from the stated floor area.
*Ceiling height measured from top of floor slab to underside of slab above before finishes, and excluding bulkheads and required drop ceilings. E.&O.E.

[Signature]

RECEIVED
SEP 16 2019

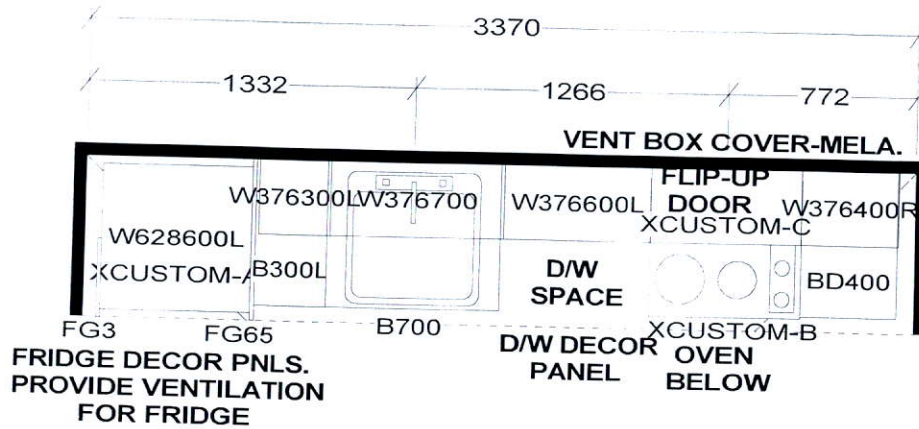

KITCHEN

- 34" uppers
- up. counter Edge

APPLIANCE PACKAGE:

- 24" INTEGRATED FRIDGE W/ DECOR PNLS
- 24" INTEGRATED DISHWASHER W/ DECOR PNL
- 24" BUILT-IN OVEN
- 24" COOKTOP
- 24" MICROWAVE HOOD FAN

KITCHEN BASES & VANITIES INSTALLED
WITH ADJUSTABLE LEGS

Selba Industries

W WIDTH _____ W HGHT _____ W CNT _____ FL HGHT _____ DWY H _____ ST CENT _____ 2X4 _____ VENT BOX COVER _____

TOWER SUITES:
760MM HIGH UPPER CABINETS
WHITE STEEL DRAWER BOXES
COUNTERTOPS BY OTHERS
VENT BOX COVERS
CUSTOM VANITIES

This drawing is the intellectual property of
SELBA INDUSTRIES INC. and is an
original design which must not be released
or copied unless applicable fee has been
paid or job order placed.



JOB NUMBER:
BUILDER: GREENPARK
SITE NAME: PETALUMA
MODEL: 2 BEDROOM - E 771
LOT #:
DESIGNER: KS
DATE: JAN 8 18

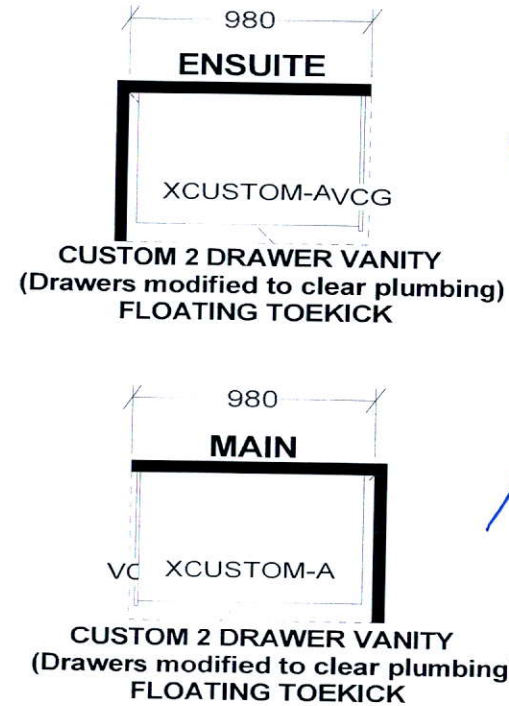

up. counter Edge