



|  |                    |                                |  |
|--|--------------------|--------------------------------|--|
| <b>CONSTRUCTION SUMMARY</b><br><b>330 Richmond - Petaluma Building Corp.</b> |                    |                                |  |
| <b>PURCHASER:</b> M. Patricia CACCAVELLA                                     |                    | <b>TEL:</b> RES.: 416-271-1305 |  |
| Unit 9, Level 17 (2010-1)  | Floor Plan<br>E721 |                                |  |

**CABINETRY**

|   |  |
|---|--|
| 1 - KITCHEN - 41" UPPER CABINETRY<br>30Jul19    Note: |  |
|---|--|

**CERAMIC TILE**

|   |  |
|---|--|
| 1 - BATHROOMS - DELETE STANDARD WHITE ACCESSORIES - DO NOT INSTALL SOAP DISH, TOWEL RACK OR TISSUE HOLDER<br>30Jul19    Note: |  |
|---|--|

**COUNTER TOP**

|   |  |
|---|--|
| 1 - KITCHEN - UPGRADED EDGE ON COUNTERTOP<br>30Jul19    Note:                                 |  |
| 1 - KITCHEN - HIGH-END QUARTZ COUNTERTOP IN LIEU OF STANDARD AS PER OFFER<br>30Jul19    Note: |  |

**HARDWOOD FLOORING**

|   |  |
|---|--|
| 1 - THROUGHOUT - UPGRADE 2 HARDWOOD FLOORING IN LIEU OF STANDARD AS PER OFFER<br>30Jul19    Note: |  |
|---|--|

**MIRRORS AND GLASS**

|   |  |
|---|--|
| 1 - FOYER - FRAMELESS SLIDING CLOSET DOORS WITH MIRROR FASCIA<br>30Jul19    Note: |  |
|---|--|

**PLUMBING**

|  |  |
|--|--|
| 2 - BATHROOMS - MOEN 90 DEGREE BATHROOM ACCESSORIES - CHROME<br>TOILET PAPER HOLDER #YB8808<br>TOWEL RING #YB8886<br>TOWEL BAR #YB8824<br>30Jul19    Note: |  |
|--|--|

This Document is Extremely Time Sensitive - Printed 30 Jul 19 at 10:14

RECEIVED AUG 13 2019

Purchaser: M. Patricia CACCAVELLA  
Telephone Res. / Bus: (416) 271-1305 /  
Decor Advisor: Candace Forza  
Lock Date: 7/30/2019 10:14:43

Const. No.: Unit 9, Level 17  
Municipal: 2010  
Suite Type: E721  
Project/Phase: Petaluma Building Corp./1

Layout Changes: ☐ Yes ☒ No Sketch Attached: ☒ Yes ☐ No Exterior Colour Scheme:

1. Kitchen and Vanities

|                         | Style and Colour           | Counter                               | Hardware |
|-------------------------|----------------------------|---------------------------------------|----------|
| Kitchen / Breakfast     | SEE BELOW                  | QUARTZ-FROSTY CARRARA-#360 EDGE       | STD      |
| Main Bath               | DORAL H3078-HACIENDA WHITE | QUARTZ-TORRONE-STRAIGHT POLISHED EDGE | STD      |
| Master Ensuite Bathroom | DORAL H3078-HACIENDA WHITE | QUARTZ-TORRONE-STRAIGHT POLISHED EDGE | STD      |
|                         | N/A                        | N/A                                   | N/A      |

Appliances: Built In Appliances ☒ Yes ☐ No 41" Upper Cabinets ☒ Yes ☐ No Slide In Stove ☐ Yes ☒ No

Comment

KITCHEN CABINETRY - BASES - DORAL H3078-HACIENDA WHITE \*\*\* UPPERS - SENOSAN WHITE

2. Flooring

|                         |   | Grout-If App. | At a 45                  |
|-------------------------|---|---------------|--------------------------|
| Entrance Vestibule      | STRIP-MIRAGE-LOCK-BRUSHED-RED OAK-DURAMATT-TREASURE-4 5/16" |               | <input type="checkbox"/> |
| Main Hall               | STRIP-MIRAGE-LOCK-BRUSHED-RED OAK-DURAMATT-TREASURE-4 5/16" |               | <input type="checkbox"/> |
| Kitchen / Breakfast     | STRIP-MIRAGE-LOCK-BRUSHED-RED OAK-DURAMATT-TREASURE-4 5/16" |               | <input type="checkbox"/> |
| Laundry Room            | TILE-WHITE-8X8  | STANDARD      | <input type="checkbox"/> |
| Main Bath               | TILE-LIFE SILVER-12X24                                      | STANDARD      | <input type="checkbox"/> |
| Master Ensuite Bathroom | TILE-LIFE SILVER-12X24                                      | STANDARD      | <input type="checkbox"/> |
|                         | N/A   |               | <input type="checkbox"/> |
| Living Room             | STRIP-MIRAGE-LOCK-BRUSHED-RED OAK-DURAMATT-TREASURE-4 5/16" |               | <input type="checkbox"/> |
| Dining Room             | STRIP-MIRAGE-LOCK-BRUSHED-RED OAK-DURAMATT-TREASURE-4 5/16" |               | <input type="checkbox"/> |
| Den / Library / Study   | N/A   |               | <input type="checkbox"/> |
| Master Bedroom          | STRIP-MIRAGE-LOCK-BRUSHED-RED OAK-DURAMATT-TREASURE-4 5/16" |               | <input type="checkbox"/> |
| Bedroom #2              | STRIP-MIRAGE-LOCK-BRUSHED-RED OAK-DURAMATT-TREASURE-4 5/16" |               | <input type="checkbox"/> |
| Bedroom #3              | N/A   |               | <input type="checkbox"/> |
|                         |   |               | <input type="checkbox"/> |

Comment

3. Wall Tile

|                          | Selection                   | Grout    | Describe |
|--------------------------|-----------------------------|----------|----------|
| Main Bath                |                             |          |          |
| Tub Deck Wall            | N/A                         |          |          |
| Shower Stall             | TILE-GLOSSY WHITE-3X6       | STANDARD |          |
| Bathtub Enclosure Walls  | N/A                         |          |          |
| Master Ensuite Bathroom  |                             |          |          |
| Tub Deck Wall            | TILE-GLOSSY WHITE-3X6       | STANDARD |          |
| Shower Stall             | N/A                         |          |          |
| Bathtub Enclosure Walls  | N/A                         |          |          |
|                          |                             |          |          |
| Kitchen Backsplash       | BACK PAINTED GLASS-BM-OC-16 | STANDARD |          |
| Backsplash Behind Fridge | N/A                         |          |          |
|                          |                             |          |          |

Comment

\*\* Refer to Construction Summary

4. Misc

Water Line for Fridge NO  
Interior Door Handles AS PER CONSTRUCTION SPECS  
Ceramic Bathroom Accessories NO - UPGRADED - MOEN 90 DEGREE ☐ Yes ☒ No

Comment



Purchaser:

M. Patricia CACCAVELLA

Telephone Res. / Bus:

(416) 271-1305 /

Decor Advisor:

Candace Forza

Lock Date:

7/30/2019 10:14:43

Const. No.:

Unit 9, Level 17

Municipal:

2010

Suite Type:

E721

Project/Phase:

Petaluma Building Corp./1

5. Plaster Mouldings and Medallions

|                         |     |  |                      |     |  |
|-------------------------|-----|--|----------------------|-----|--|
| Entrance Vestibule      | N/A |  | Living Room          | N/A |  |
| Main Hall               | N/A |  | Dining Room          | N/A |  |
| Kitchen/Breakfast       | N/A |  | Den / Library /Study | N/A |  |
| Laundry Room            | N/A |  | Master BedRoom       | N/A |  |
| Main Bath               | N/A |  | BedRoom #2           | N/A |  |
| Master Ensuite Bathroom | N/A |  | BedRoom #3           | N/A |  |
|                         |     |  |                      |     |  |

Comment

\*\* Refer to Construction Summary

6. Wall Paint

|                     |                |                |                |
|---------------------|----------------|----------------|----------------|
| Entrance Vestibule  | 43-BIRCH WHITE | Living Room    | 43-BIRCH WHITE |
| Main Hall           | 43-BIRCH WHITE | Dining Room    | 43-BIRCH WHITE |
| Kitchen / Breakfast | 43-BIRCH WHITE | Den/Library    | N/A            |
| Laundry Room        | 43-BIRCH WHITE | Master Bedroom | 43-BIRCH WHITE |
| Main Bath           | 43-BIRCH WHITE | Bedroom #2     | 43-BIRCH WHITE |
| Master Ensuite      | 43-BIRCH WHITE | Bedroom #3     | N/A            |
|                     | N/A            |                |                |

Comment

7. General Comments

\*\* Refer to Construction Summary

Disclaimers and Notes

- 1)

Colours of all materials are as close as possible to builder's selection, but not necessarily identical due to variances in manufacturing.
- 2)

Any extras listed above are null and void unless accompanied by a separate invoice/amendment. Said invoice must be paid in full.
- 3)

The Purchaser agrees that this colour selection is final and that no changes will be permitted, unless required by the Vendor.
- 4)

The Purchaser acknowledges reading and accepting document which contains other miscellaneous disclaimers.



Signature:\_\_\_\_\_

Date:\_\_\_\_\_



Signature:\_\_\_\_\_

Date:\_\_\_\_\_

# 90°™

Traditional | Transitional | Modern

*Geometric forms, squared corners and straight lines create an urban focal point for today's contemporary baths.*



**Toilet Tank Lever**  
Model YB8801

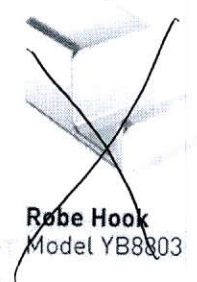

**Robe Hook**  
Model YB8803

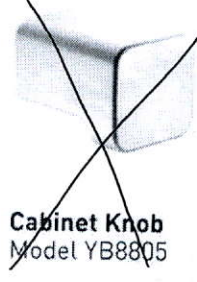

**Cabinet Knob**  
Model YB8805

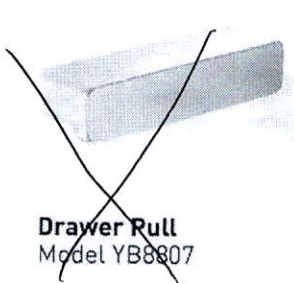

**Drawer Pull**  
Model YB8807

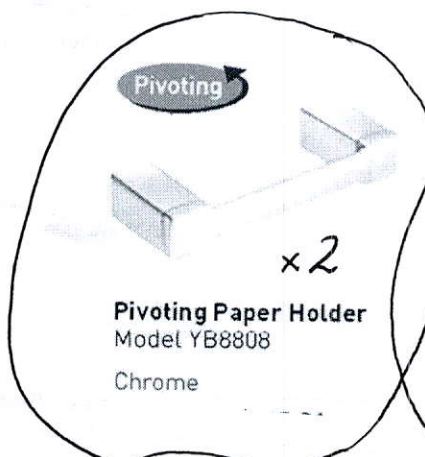

**Pivoting Paper Holder**  
Model YB8808  
Chrome

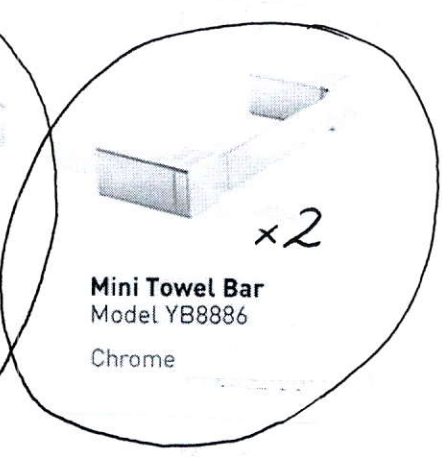

**Mini Towel Bar**  
Model YB8886  
Chrome

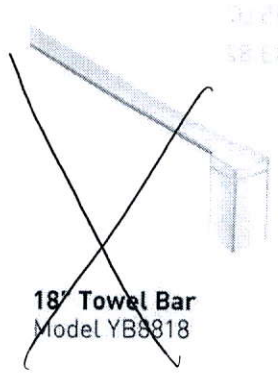

**18" Towel Bar**  
Model YB8818

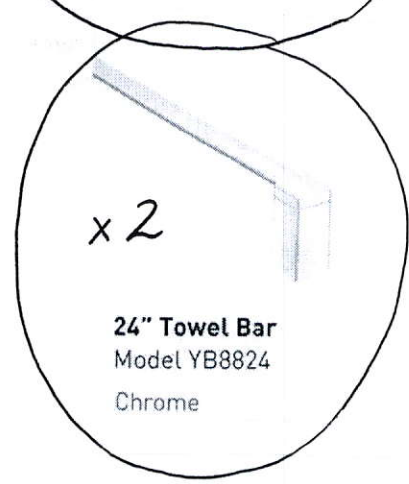

**24" Towel Bar**  
Model YB8824  
Chrome

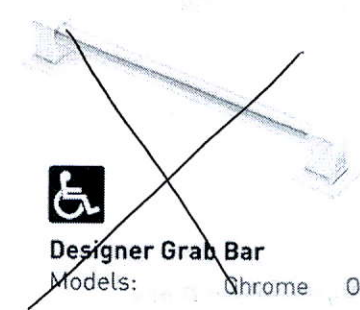

**Designer Grab Bar**  
Models: Chrome Other

**FINISH OPTIONS:**

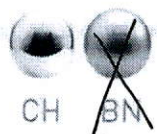

To order, combine the model number with one of these finish letter(s):  
Chrome (CH), LifeShine® Brushed Nickel (BN).

# SCHEDULE 'A'

## 330

RICHMOND

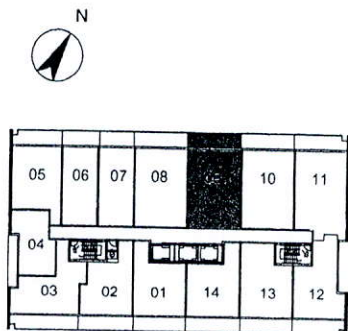
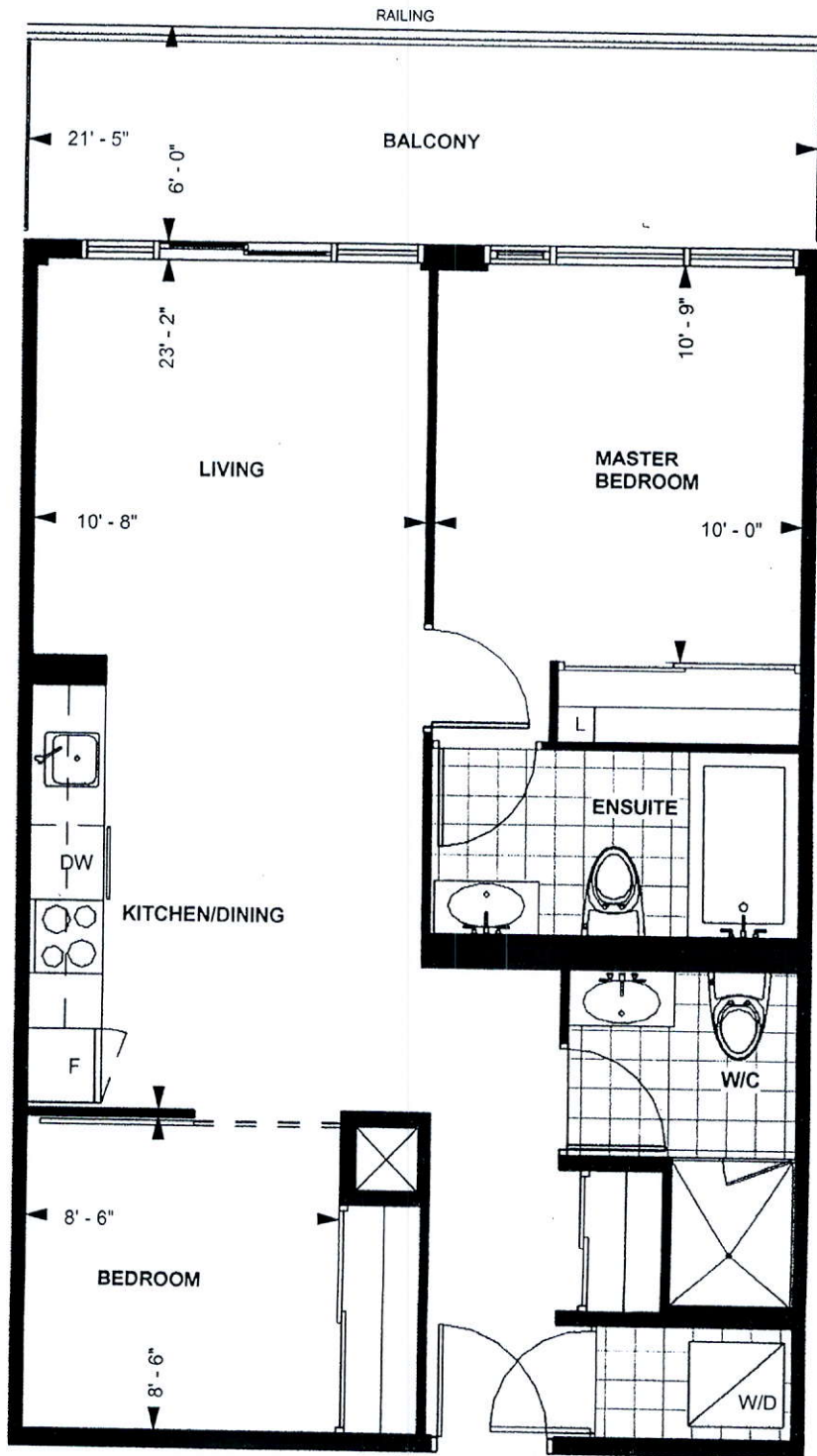

LEVEL 13-20

TOWER SUITE  
E 721  
9' CEILING \*  
721 sq. ft.  
2-BEDROOM

P.C. mar 24 2010  
Purchaser Initials Purchaser Initials Date

Unit No. 9 Level No. 17 Suite No. 2010

Dimensions, specification, tile floor pattern and architectural detailing (including window size and location) are approximate and subject to modifications without notice. Orientation of suite may vary from the stated floor area.  
\*Ceiling height measured from top of floor slab to underside of slab above before finishes, and excluding bulkheads and required drop ceilings. E.&O.E.



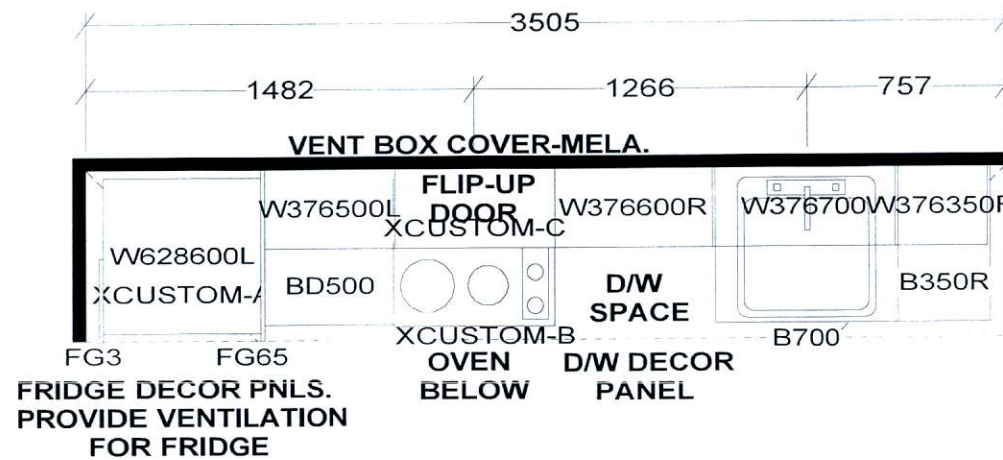

### KITCHEN

• 41" Upper Cabinetry  
• upg. Edge on Countertop

#### APPLIANCE PACKAGE:

24" INTEGRATED FRIDGE W/ DECOR PNLS  
24" INTEGRATED DISHWASHER W/ DECOR PNL  
24" BUILT-IN OVEN  
24" COOKTOP  
24" MICROWAVE HOOD FAN

KITCHEN BASES & VANITIES INSTALLED  
WITH ADJUSTABLE LEGS

*S e l b a I n d u s t r i e s*

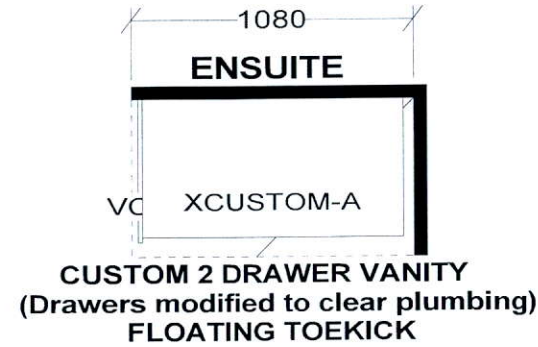

**CUSTOM 2 DRAWER VANITY**  
(Drawers modified to clear plumbing)  
FLOATING TOEKICK

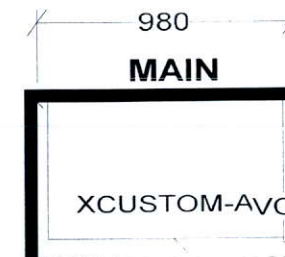

**CUSTOM 2 DRAWER VANITY**  
(Drawers modified to clear plumbing)  
FLOATING TOEKICK

| / W D T H   |  | W | H G H T | W | C N T | FL   | H G H T | D W Y | H | S T   | C E N T | 2 X 4  | V E N T | B O X | C O V E R |
|---|--|---|---------|---|-------|--|---------|-------|---|---|---------|--|---------|-------|-----------|
| TOWER SUITES:<br>760MM HIGH UPPER CABINETS<br>WHITE STEEL DRAWER BOXES<br>COUNTERTOPS BY OTHERS<br>VENT BOX COVERS<br>CUSTOM VANITIES |  |   |         |   |       | This drawing is the intellectual property of<br>SELBA INDUSTRIES INC. and is an<br>original design which must not be released<br>or copied unless applicable fee has been<br>paid or job order placed. |         |       |   |  |         | JOB NUMBER:<br>BUILDER: GREENPARK<br>SITE NAME: PETALUMA<br>MODEL: 2 BEDROOM - E 721<br>LOT #:<br>DESIGNER: KS<br>DATE: JAN 8 18 |         |       |           |



