

CONSTRUCTION SUMMARY  
330 Richmond - Petaluma Building Corp.

PURCHASER: Silvio E DELUCA TEL: RES.: 905-653-9241 BUS.: 416-736-6500

|                           |                    |  |  |
|---------------------------|--------------------|--|--|
| Unit 9, Level 19 (2210-1) | Floor Plan<br>E721 |  |  |
|---------------------------|--------------------|--|--|

CABINETRY

|  |  |
|--|--|
| 1 - KITCHEN - 41" UPPER CABINETRY<br>21Jun19 Note: |  |
|--|--|

CERAMIC TILE

|  |  |
|--|--|
| 1 - LAUNDRY ROOM - FLOOR - UPGRADE 2 TILE<br>21Jun19 Note:   |  |
| 1 - BATHROOMS - DELETE STANDARD WHITE CERAMIC ACCESSORIES - DO NOT INSTALL SOAP DISH, TOWEL RACK OR TISSUE HOLDER<br>21Jun19 Note: |  |

CONSTRUCTION

|   |  |
|---|--|
| 2 - BEDROOMS - SMOOTH CEILINGS<br>21Jun19 Note:   |  |
| 1 - ENSUITE BATH - 5 FOOT SHOWER WITH SLIDING CHROME FRAMED GLASS DOORS IN LIEU OF TUB<br>25Jul18 Note: |  |

COUNTER TOP

|  |  |
|--|--|
| 2 - MAIN & MASTER ENSUITE BATHROOMS - UPGRADED EDGE ON COUNTERTOP<br>21Jun19 Note:         |  |
| 1 - KITCHEN - FULL HEIGHT HIGH-END QUARTZ BACKSPLASH<br>21Jun19 Note:                      |  |
| 1 - KITCHEN - UPGRADED EDGE ON COUNTERTOP<br>21Jun19 Note:                                 |  |
| 1 - KITCHEN - HIGH-END QUARTZ COUNTERTOP IN LIEU OF STANDARD AS PER OFFER<br>21Jun19 Note: |  |

MIRRORS AND GLASS

|   |  |
|---|--|
| 3 - FOYER, BEDROOM 2 & MASTER BEDROOM - FRAMELESS MIRROR SLIDING CLOSET DOORS WITH MIRROR FASCIA<br>21Jun19 Note:           |  |
| 1 - MASTER ENSUITE BATHROOM - FRAMELESS GLASS SHOWER DOOR AND PANEL ON 5' OPENING - CHROME KNOB AND HINGES<br>21Jun19 Note: |  |
| 1 - MAIN BATHROOM - FRAMELESS GLASS SHOWER DOOR - CHROME KNOB AND HINGES<br>21Jun19 Note:                                   |  |

MISCELLANEOUS

|  |  |
|--|--|
| 1 - TOTAL FOR THE ABOVE UPGRADES AMOUNTS TO \$5000.00<br>21Jun19 Note: |  |
|--|--|

PLUMBING

|  |  |
|--|--|
| 2 - BATHROOMS - MOEN 90 DEGREE BATHROOM ACCESSORIES - CHROME TOILET PAPER HOLDER #YB8808<br>TOWEL RING #YB8886<br>TOWEL BAR #YB8824<br>21Jun19 Note: |  |
|--|--|

PROMOTIONAL

|   |  |
|---|--|
| 1 - LESS CREDIT FROM PURCHASERS EXTRA SHEET IN OFFER<br>21Jun19 Note: |  |
|---|--|

RECEIVED JUL 0 3 2019

|   |                    |  |  |
|---|--------------------|--|--|
| <b>CONSTRUCTION SUMMARY</b><br>330 Richmond - Petaluma Building Corp. |                    |  |  |
| PURCHASER: Silvio E DELUCA  |                    | TEL: RES.: 905-653-9241 BUS.: 416-736-6500 |  |
| Unit 9, Level 19 (2210-1)   | Floor Plan<br>E721 |  |  |

EXTRAS AS PER OFFER

|  |  |
|--|--|
| The Vendor agrees that notwithstanding any other term or provision in this Agreement included in the Purchase Price and in addition to those items detailed in Schedule D to the Agreement of Purchase and Sale, the Purchaser is entitled to a credit of Fiv<br>Worksheet Note: |  |
|--|--|

This Document is Extremely Time Sensitive - Printed 21 Jun 19 at 13:14



Purchaser: Silvio E DELUCA  
Telephone Res. / Bus: (905) 653-9241 / (416) 736-6500  
Decor Advisor: Candace Forza  
Lock Date: 5/27/2019 15:53:09

Const. No.: Unit 9, Level 19  
Municipal: 2210  
Suite Type: E721  
Project/Phase: Petaluma Building Corp./1

Layout Changes: ☐ Yes ☒ No      Sketch Attached: ☒ Yes ☐ No      Exterior Colour Scheme:

1. Kitchen and Vanities

|                         | Style and Colour           | Counter                         | Hardware |
|-------------------------|----------------------------|---------------------------------|----------|
| Kitchen / Breakfast     | SEE BELOW                  | QUARTZ-FROSTY CARRARA-#360 EDGE | STD      |
| Main Bath               | DORAL H3081-HACIENDA BLACK | QUARTZ-AMIATA-#360 EDGE         | STD      |
| Master Ensuite Bathroom | DORAL H3081-HACIENDA BLACK | QUARTZ-AMIATA-#360 EDGE         | STD      |
|                         | N/A                        | N/A                             | N/A      |

Appliances:      Built In Appliances ☒ Yes ☐ No      41" Upper Cabinets ☒ Yes ☐ No      Slide In Stove ☐ Yes ☒ No

Comment

KITCHEN CABINETRY - BASE-DORAL H3081-HACIENDA BLACK \*\*\* UPPERS-SENOSANLIGHT GREY

2. Flooring

|                         |   | Grout-If App. | At a 45                  |
|-------------------------|---|---------------|--------------------------|
| Entrance Vestibule      | STRIP-MIRAGE-LOCK-RED OAK-CASHMERE-GRAPHITE-4 5/16" |               | <input type="checkbox"/> |
| Main Hall               | STRIP-MIRAGE-LOCK-RED OAK-CASHMERE-GRAPHITE-4 5/16" |               | <input type="checkbox"/> |
| Kitchen / Breakfast     | STRIP-MIRAGE-LOCK-RED OAK-CASHMERE-GRAPHITE-4 5/16" |               | <input type="checkbox"/> |
| Laundry Room            | TILE-LIFE ICE-12X24                                 | STANDARD      | <input type="checkbox"/> |
| Main Bath               | TILE-LIFE ICE-12X24                                 | STANDARD      | <input type="checkbox"/> |
| Master Ensuite Bathroom | TILE-LIFE ICE-12X24                                 | STANDARD      | <input type="checkbox"/> |
|                         | N/A   |               | <input type="checkbox"/> |
| Living Room             | STRIP-MIRAGE-LOCK-RED OAK-CASHMERE-GRAPHITE-4 5/16" |               | <input type="checkbox"/> |
| Dining Room             | STRIP-MIRAGE-LOCK-RED OAK-CASHMERE-GRAPHITE-4 5/16" |               | <input type="checkbox"/> |
| Den / Library / Study   | N/A   |               | <input type="checkbox"/> |
| Master Bedroom          | STRIP-MIRAGE-LOCK-RED OAK-CASHMERE-GRAPHITE-4 5/16" |               | <input type="checkbox"/> |
| Bedroom #2              | STRIP-MIRAGE-LOCK-RED OAK-CASHMERE-GRAPHITE-4 5/16" |               | <input type="checkbox"/> |
| Bedroom #3              | N/A   |               | <input type="checkbox"/> |
|                         |   |               | <input type="checkbox"/> |

Comment

3. Wall Tile

|                          | Selection             | Grout    | Describe |
|--------------------------|-----------------------|----------|----------|
| Main Bath                |                       |          |          |
| Tub Deck Wall            | N/A                   |          |          |
| Shower Stall             | TILE-GLOSSY WHITE-3X6 | STANDARD |          |
| Bathtub Enclosure Walls  | N/A                   |          |          |
| Master Ensuite Bathroom  |                       |          |          |
| Tub Deck Wall            | N/A                   |          |          |
| Shower Stall             | TILE-GLOSSY WHITE-3X6 | STANDARD |          |
| Bathtub Enclosure Walls  | N/A                   |          |          |
|                          |                       |          |          |
| Kitchen Backsplash       | QUARTZ-FROSTY CARRARA | STANDARD |          |
| Backsplash Behind Fridge | N/A                   |          |          |
|                          |                       |          |          |

Comment

\*\* Refer to Construction Summary

4. Misc

|                              |                               |
|------------------------------|-------------------------------|
| Water Line for Fridge        | N/A                           |
| Interior Door Handles        | AS PER CONSTRUCTION SPECS     |
| Ceramic Bathroom Accessories | NO - UPGRADE - MOEN 90 DEGREE |

☐ Yes ☒ No

Comment



Purchaser: Silvio E DELUCA  
Telephone Res. / Bus: (905) 653-9241 / (416) 736-6500  
Decor Advisor: Candace Forza  
Lock Date: 5/27/2019 15:53:09

Const. No.: Unit 9, Level 19  
Municipal: 2210  
Suite Type: E721  
Project/Phase: Petaluma Building Corp./1

5. Plaster Mouldings and Medallions

|                         |     |  |                      |     |  |
|-------------------------|-----|--|----------------------|-----|--|
| Entrance Vestibule      | N/A |  | Living Room          | N/A |  |
| Main Hall               | N/A |  | Dining Room          | N/A |  |
| Kitchen/Breakfast       | N/A |  | Den / Library /Study | N/A |  |
| Laundry Room            | N/A |  | Master BedRoom       | N/A |  |
| Main Bath               | N/A |  | BedRoom #2           | N/A |  |
| Master Ensuite Bathroom | N/A |  | BedRoom #3           | N/A |  |
|                         |     |  |                      |     |  |

Comment

\*\* Refer to Construction Summary

6. Wall Paint

|                     |                |                |                |
|---------------------|----------------|----------------|----------------|
| Entrance Vestibule  | 43-BIRCH WHITE | Living Room    | 43-BIRCH WHITE |
| Main Hall           | 43-BIRCH WHITE | Dining Room    | 43-BIRCH WHITE |
| Kitchen / Breakfast | 43-BIRCH WHITE | Den/Library    | N/A            |
| Laundry Room        | 43-BIRCH WHITE | Master Bedroom | 43-BIRCH WHITE |
| Main Bath           | 43-BIRCH WHITE | Bedroom #2     | 43-BIRCH WHITE |
| Master Ensuite      | 43-BIRCH WHITE | Bedroom #3     | N/A            |
|                     | N/A            |                |                |

Comment

7. General Comments

\*\* Refer to Construction Summary

Disclaimers and Notes

- Colours of all materials are as close as possible to builder's selection, but not necessarily identical due to variances in manufacturing.
- Any extras listed above are null and void unless accompanied by a separate invoice/amendment. Said invoice must be paid in full.
- The Purchaser agrees that this colour selection is final and that no changes will be permitted, unless required by the Vendor.
- The Purchaser acknowledges reading and accepting document which contains other miscellaneous disclaimers.

Signature:  \_\_\_\_\_ Date: \_\_\_\_\_ Signature: \_\_\_\_\_ Date: \_\_\_\_\_

# 90°™

Traditional | Transitional | Modern

*Geometric forms, squared corners and straight lines create an urban focal point for today's contemporary baths.*

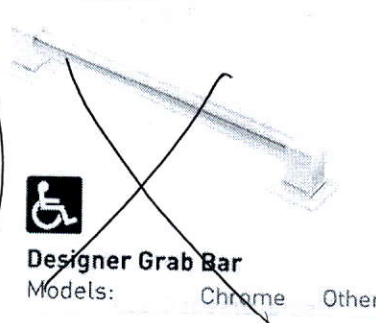
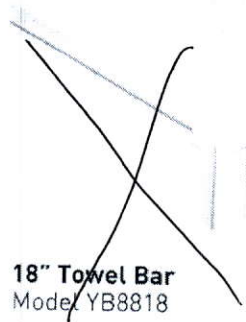
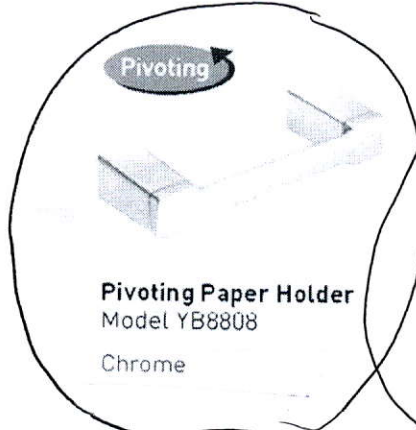
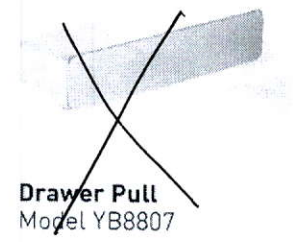
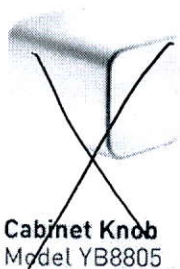
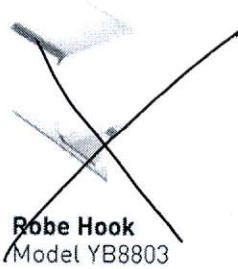

## FINISH OPTIONS:

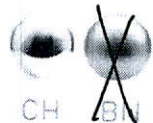

To order, combine the model number with one of these finish letter(s):  
Chrome (CH), LifeShine® Brushed Nickel (BN).

# SCHEDULE 'A'

## 330

RICHMOND

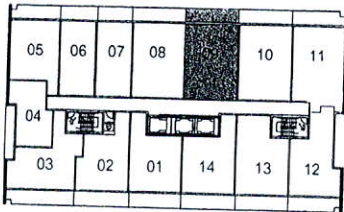
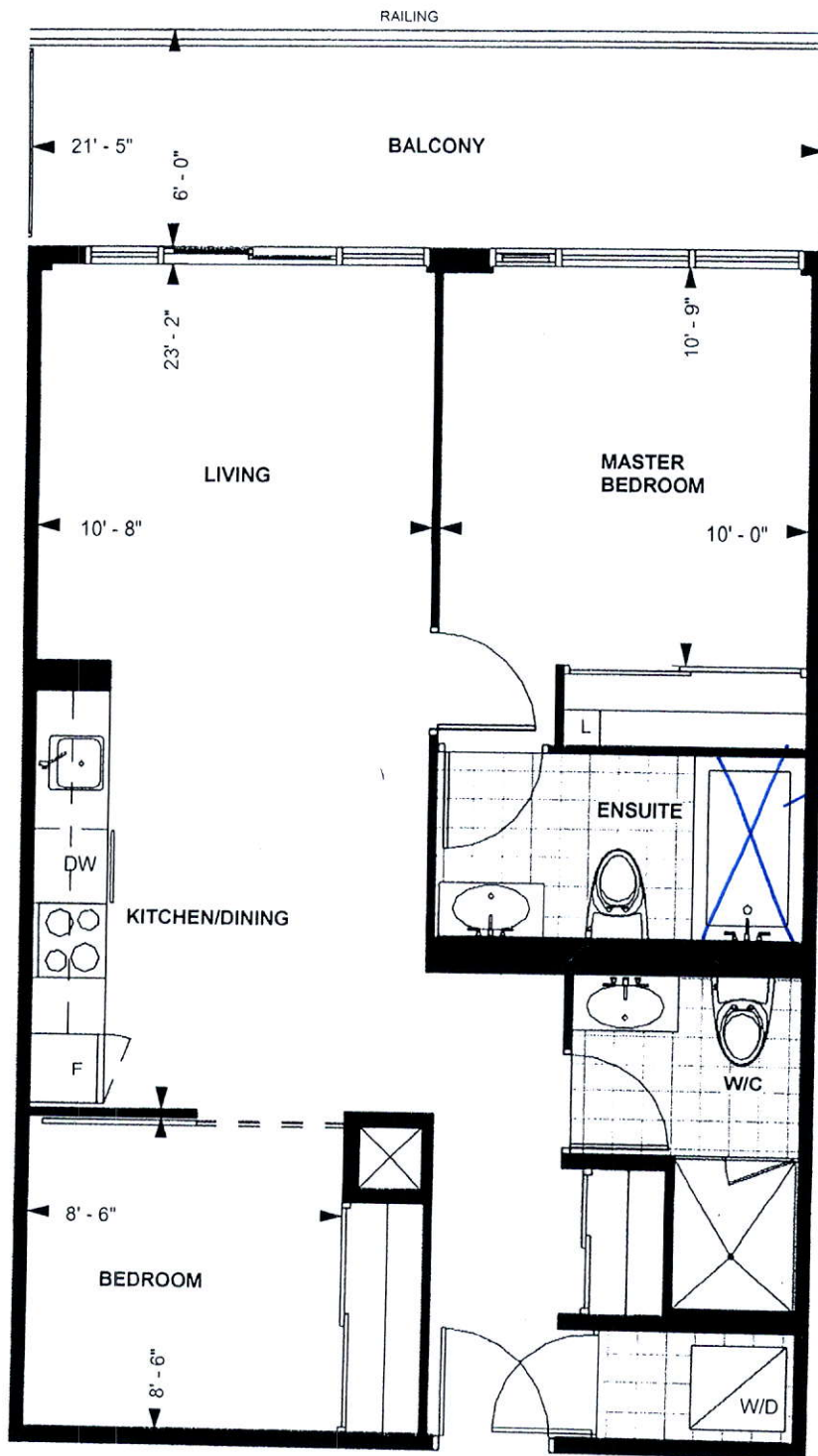

LEVEL 13-20

TOWER SUITE

E 721

9' CEILING \*

721 sq. ft.

2-BEDROOM

Purchaser Initials Purchaser Initials

Date

Unit No. 9 Level No. 19 Suite No. 2210

Dimensions, specification, tile floor pattern and architectural detailing (including window size and location) are approximate and subject to modifications without notice. Orientation of suite may vary from the stated floor area.  
\*Ceiling height measured from top of floor slab to underside of slab above before finishes, and excluding bulkheads and required drop ceilings. E.&O.E.



\* Upgrade Countertop Edge in Kitchen & Baths

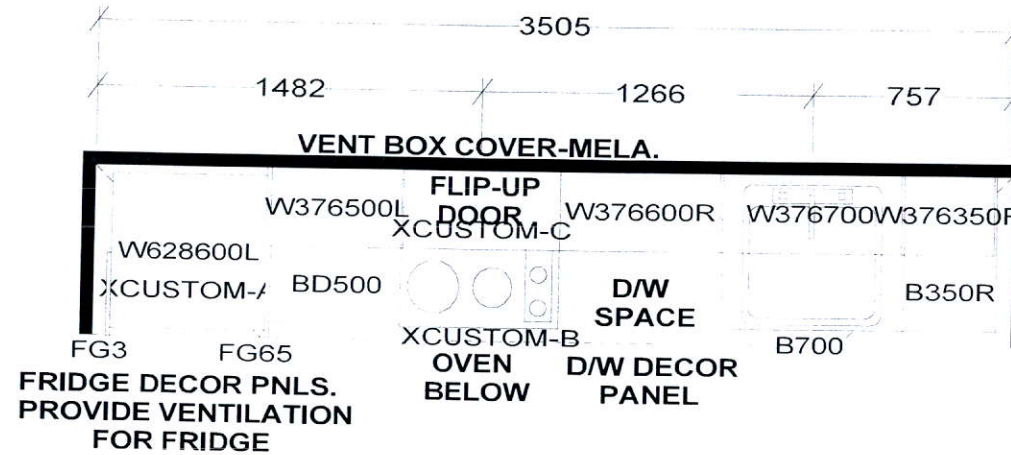

**KITCHEN**

*41" Upper Cabinetry.*

APPLIANCE PACKAGE:  
 24" INTEGRATED FRIDGE W/ DECOR PNLS  
 24" INTEGRATED DISHWASHER W/ DECOR PNL  
 24" BUILT-IN OVEN  
 24" COOKTOP  
 24" MICROWAVE HOOD FAN

KITCHEN BASES & VANITIES INSTALLED  
 WITH ADJUSTABLE LEGS

*Selba Industries*

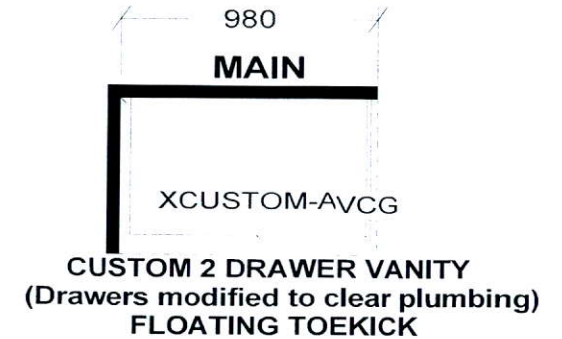
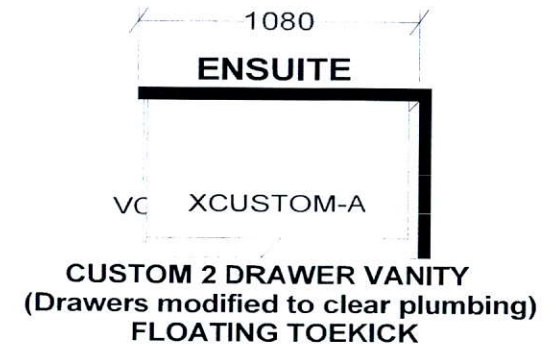

WDTH \_\_\_\_\_ W HGHT \_\_\_\_\_ W CNT \_\_\_\_\_ FL HGHT \_\_\_\_\_ DWY H \_\_\_\_\_ ST CENT \_\_\_\_\_ 2X4 \_\_\_\_\_ VENT BOX COVER \_\_\_\_\_

TOWER SUITES:  
 760MM HIGH UPPER CABINETS  
 WHITE STEEL DRAWER BOXES  
 COUNTERTOPS BY OTHERS  
 VENT BOX COVERS  
 CUSTOM VANITIES

This drawing is the intellectual property of  
 SELBA INDUSTRIES INC. and is an  
 original design which must not be released  
 or copied unless applicable fee has been  
 paid or job order placed.



JOB NUMBER:  
 BUILDER: GREENPARK  
 SITE NAME: PETALUMA  
 MODEL: 2 BEDROOM - E 721  
 LOT #:  
 DESIGNER: KS  
 DATE: JAN 8 18



Frameless Mirror Sliding Door with Mirror Fascia - 4082

