



CONSTRUCTION SUMMARY
330 Richmond - Petaluma Building Corp.

PURCHASER: Jim WONG

TEL:

Unit 1, Level 25 (2901-1)

Floor Plan
F925

CONSTRUCTION

1 - MASTER ENSUITE - 5 FOOT SHOWER WITH SLIDING CHROME FRAMED GLASS DOORS IN LIEU OF TUB

27Mar18 Note:

COUNTER TOP

2 - UPGRADE COUNTERTOP EDGE IN BOTH BATHROOMS

18Jun19 Note:

1 - UPGRADE COUNTERTOP EDGE- KITCHEN

18Jun19 Note:

1 - UPGRADE COUNTERTOP IN KITCHEN

18Jun19 Note:

PLUMBING

2 - UPGRADE BATHROOM ACCESSORIES IN BOTH BATHROOMS- MOEN 90 DEGREE CHROME

TOILET PAPER HOLDER#8808

TOWEL RING #8886

24" TOWEL BAR #8824

18Jun19 Note:

PROMOTIONAL

1 - LESS CREDIT FROM PURCHASER EXTRA SHEET IN OFFER

18Jun19 Note:

1 - PARTIAL REDEMPTION OF PROMOTIONAL PACKAGE \$2,800.00 BALANCE (\$2,200.00) FORWARD TO BE USED AT A LATER DATE. ORIGINAL PROMOTIONAL PACKAGE OF \$5,000.00 AS PER SCHEDULE PE.

27Mar18 Note:

EXTRAS AS PER OFFER

1 Parking Unit

Worksheet Note:

The Vendor agrees that notwithstanding any other term or provision in this Agreement included in the Purchase Price and in addition to those items

detailed in Schedule D to the Agreement of Purchase and Sale, the Purchaser is entitled to a credit of Fiv

Worksheet Note:

This Document is Extremely Time Sensitive - Printed 18 Jun 19 at 11:09

RECEIVED JUN 20 2019

Purchaser: Jim WONG

Const. No.: Unit 1, Level 25

Telephone Res. / Bus: /

Municipal: 2901

Decor Advisor: Natalie Mancuso

Suite Type: F925

Lock Date: 6/18/2019 11:08:19

Project/Phase: Petaluma Building Corp./1

Layout Changes: ☒ Yes ☐ NoSketch Attached: ☒ Yes ☐ No

Exterior Colour Scheme:

1. Kitchen and Vanities

Style and Colour

Counter

Hardware

Kitchen / Breakfast

SEE BELOW

QUARTZ- LYSKAMM- #360 EDGE

STD

Main Bath

DORAL H3081 HACIENDA BLACK

QUARTZ- AMIATA- #360 EDGE

STD

Master Ensuite Bathroom

DORAL H3081 HACIENDA BLACK

QUARTZ- AMIATA- #360 EDGE

STD

Appliances:

Built In Appliances ☒ Yes ☐ No41" Upper Cabinets ☒ Yes ☐ NoSlide In Stove ☐ Yes ☒ No

Comment

KITCHEN UPPER CABINETS- SENOSAN LIGHT GREY
KITCHEN BASE CABINETS- DORAL H3081 HACIENDA BLACK

2. Flooring

Grout-If App.

At a 45

Entrance Vestibule

HARDWOOD- MIRAGE 4 5/16 LOCK RED OAK- GRAPHITE- CASHMERE

Main Hall

HARDWOOD- MIRAGE 4 5/16 LOCK RED OAK- GRAPHITE- CASHMERE

Kitchen / Breakfast

HARDWOOD- MIRAGE 4 5/16 LOCK RED OAK- GRAPHITE- CASHMERE

Laundry Room

TILE- MATTE WHITE 8X8

STD

Main Bath

TILE- LIFE ICE 12X24

STD

Master Ensuite Bathroom

TILE- LIFE ICE 12X24

STD

Living Room

HARDWOOD- MIRAGE 4 5/16 LOCK RED OAK- GRAPHITE- CASHMERE

Dining Room

HARDWOOD- MIRAGE 4 5/16 LOCK RED OAK- GRAPHITE- CASHMERE

Den / Library / Study

HARDWOOD- MIRAGE 4 5/16 LOCK RED OAK- GRAPHITE- CASHMERE

Master Bedroom

HARDWOOD- MIRAGE 4 5/16 LOCK RED OAK- GRAPHITE- CASHMERE

Bedroom #2

HARDWOOD- MIRAGE 4 5/16 LOCK RED OAK- GRAPHITE- CASHMERE

Bedroom #3

Comment

3. Wall Tile

Selection

Grout

Describe

Main Bath

Tub Deck Wall

Shower Stall

TILE- GLOSSY WHITE 3X6

STD

Bathtub Enclosure Walls

Master Ensuite Bathroom

Tub Deck Wall

Shower Stall

TILE- GLOSSY WHITE 3X6

STD

Bathtub Enclosure Walls

Kitchen Backsplash

Backsplash Behind Fridge

Painted glass BM# HC-170

Comment

** Refer to Construction Summary

4. Misc

Water Line for Fridge

NO

Interior Door Handles

STANDARD

Ceramic Bathroom Accessories

MOEN 90 DEGREE CHROME

☒ Yes ☐ No

Comment

Initial:

Purchaser: Jim WONG
Telephone Res. / Bus: /
Decor Advisor: Natalie Mancuso
Lock Date: 6/18/2019 11:08:19

Const. No.: Unit 1, Level 25
Municipal: 2901
Suite Type: F925
Project/Phase: Petaluma Building Corp./1

5. Plaster Mouldings and Medallions

Entrance Vestibule			Living Room		
Main Hall			Dining Room		
Kitchen/Breakfast			Den / Library /Study		
Laundry Room			Master BedRoom		
Main Bath			BedRoom #2		
Master Ensuite Bathroom			BedRoom #3		

Comment
** Refer to Construction Summary

6. Wall Paint

Entrance Vestibule	BIRCH WHITE	Living Room	BIRCH WHITE
Main Hall	BIRCH WHITE	Dining Room	BIRCH WHITE
Kitchen / Breakfast	BIRCH WHITE	Den/Library	BIRCH WHITE
Laundry Room	BIRCH WHITE	Master Bedroom	BIRCH WHITE
Main Bath	BIRCH WHITE	Bedroom #2	BIRCH WHITE
Master Ensuite	BIRCH WHITE	Bedroom #3	

Comment

7. General Comments

** Refer to Construction Summary

Disclaimers and Notes

- 1) Colours of all materials are as close as possible to builder's selection, but not necessarily identical due to variances in manufacturing.
- 2) Any extras listed above are null and void unless accompanied by a separate invoice/amendment. Said invoice must be paid in full.
- 3) The Purchaser agrees that this colour selection is final and that no changes will be permitted, unless required by the Vendor.
- 4) The Purchaser acknowledges reading and accepting document which contains other miscellaneous disclaimers.

Signature: _____ Date: _____ Signature: _____ Date: June 18, 2019
Initial: 

90°™

Traditional | Transitional | Modern

Geometric forms, squared corners and straight lines create an urban focal point for today's contemporary baths.



Toilet Tank Lever
Model YB8801



Robe Hook
Model YB8803

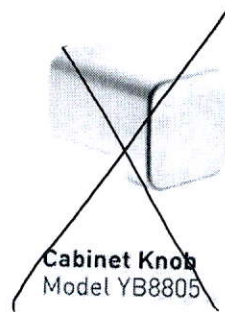

Cabinet Knob
Model YB8805

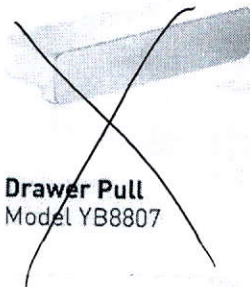

Drawer Pull
Model YB8807

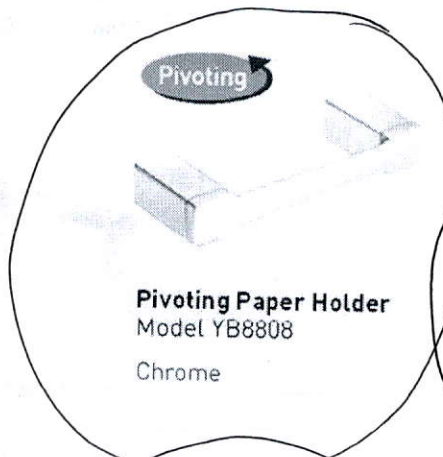

Pivoting Paper Holder
Model YB8808
Chrome

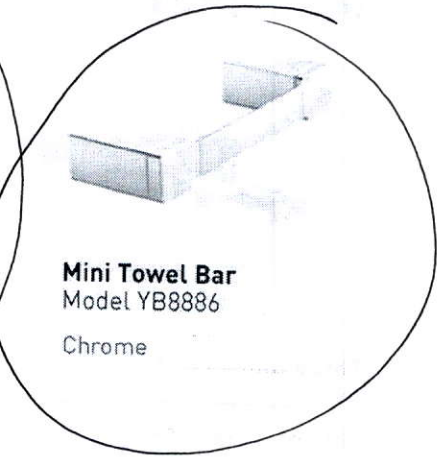

Mini Towel Bar
Model YB8886
Chrome

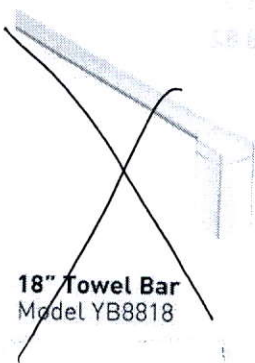

18" Towel Bar
Model YB8818



24" Towel Bar
Model YB8824
Chrome

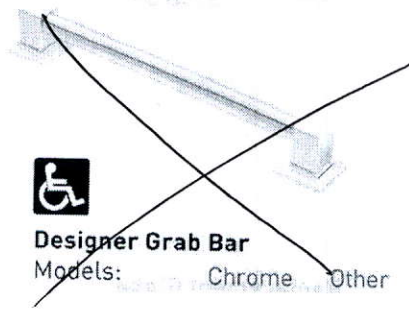

Designer Grab Bar
Models: Chrome Other

FINISH OPTIONS:

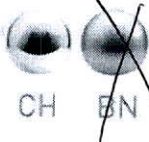

To order, combine the model number with one of these finish letter(s):
Chrome (CH), LifeShine® Brushed Nickel (BN).

SCHEDULE 'A'

330

RICHMOND

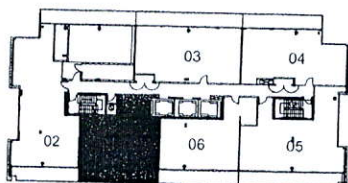
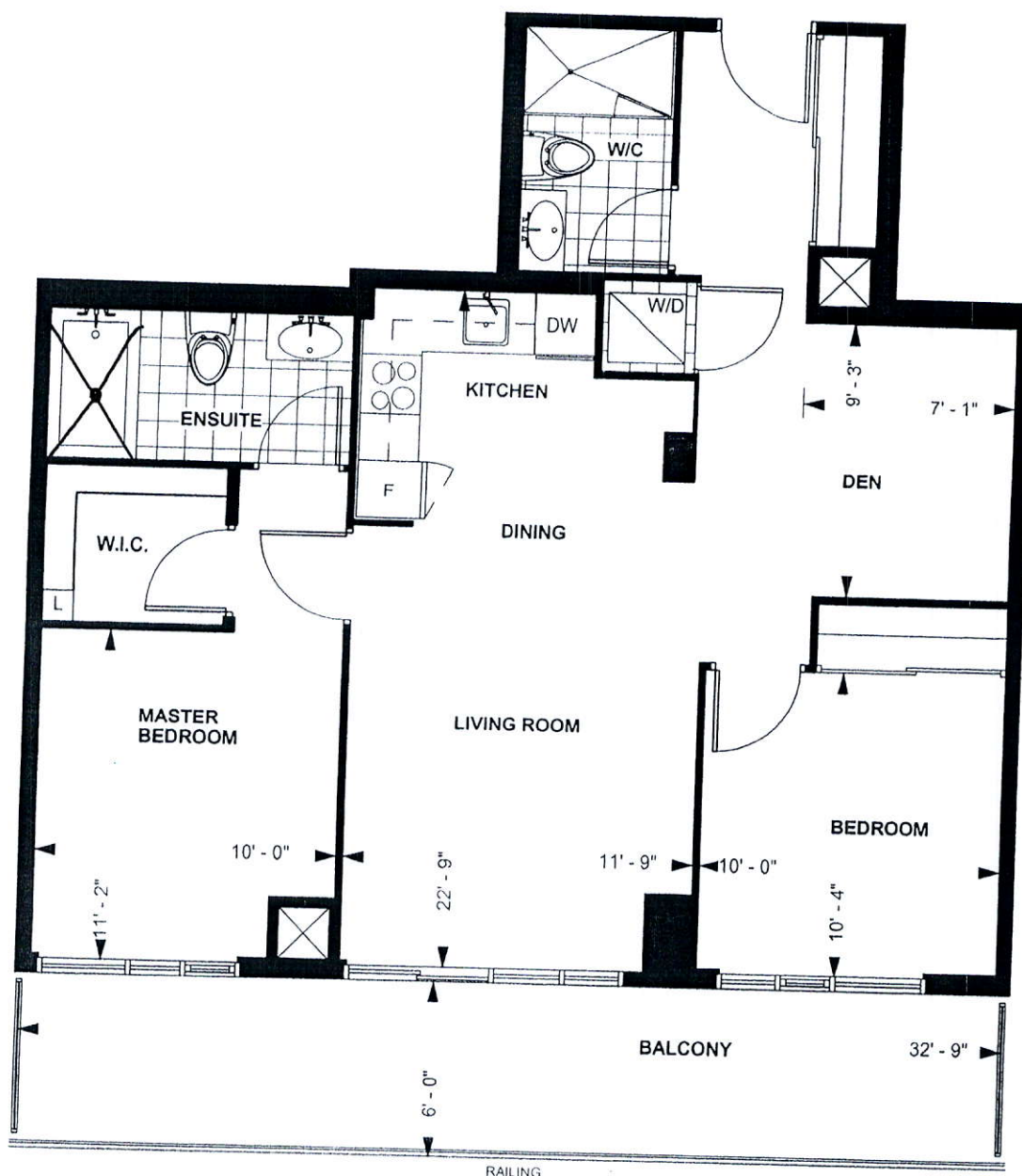

RICHMOND SUITE
F 925

11' 6" CEILING*

925 sq. ft.

2-BEDROOM PLUS DEN

Purchaser Initials Purchaser Initials

Date

Unit No. Level No. Suite No.

Dimensions, specification, tile floor pattern and architectural detailing (including window size and location) are approximate and subject to modifications without notice. Orientation of suite may vary from the stated floor area.
*Ceiling height measured from top of floor slab to underside of slab above before finishes, and excluding bulkheads and required drop ceilings. E.&O.E.

*Upgrade Countertop Edge throughout Kitchen + Baths

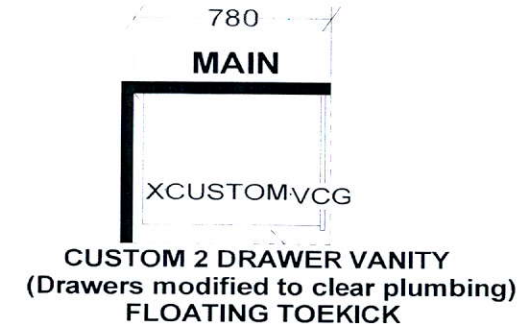
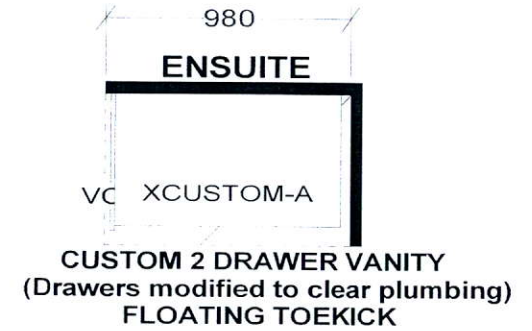
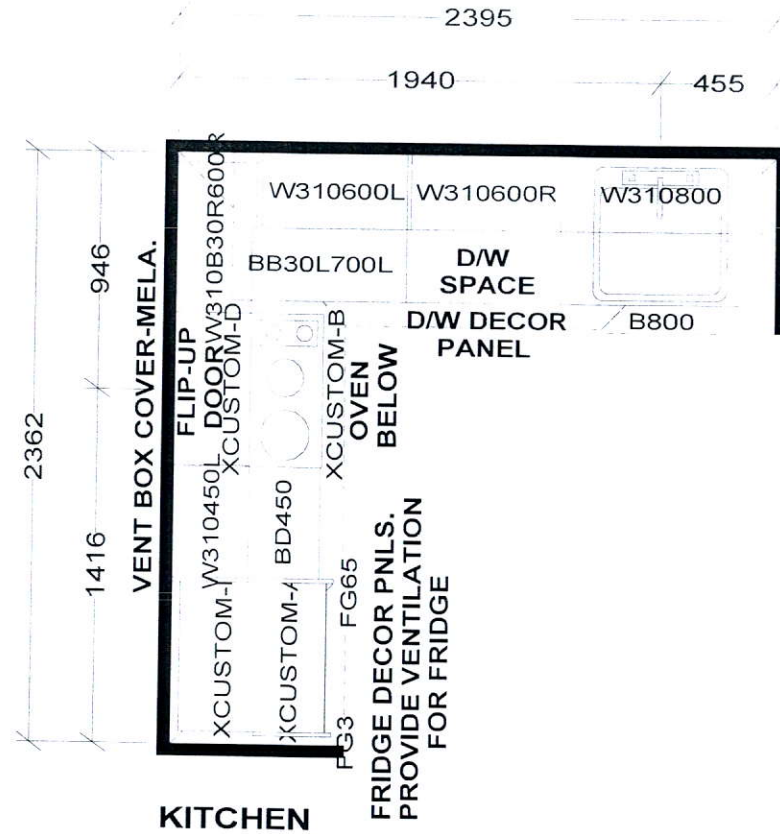

KITCHEN BASES & VANITIES INSTALLED
WITH ADJUSTABLE LEGS

APPLIANCE PACKAGE:
24" INTEGRATED FRIDGE W/ DECOR PNLS
24" INTEGRATED DISHWASHER W/ DECOR PNL
24" BUILT-IN OVEN
24" COOKTOP
24" MICROWAVE HOOD FAN

Selba Industries

W W D T H W H G H T W C N T F L H G H T D W Y H S T C E N T 2 X 4 V E N T B O X C O V E R

RICHMOND SUITES (10' Ceilings):
1040MM HIGH UPPER CABINETS
WHITE STEEL DRAWER BOXES
COUNTERTOPS BY OTHERS
VENT BOX COVERS
CUSTOM VANITIES

This drawing is the intellectual property of
SELBA INDUSTRIES INC. and is an
original design which must not be released
or copied unless applicable fee has been
paid or job order placed.



JOB NUMBER:
BUILDER: GREENPARK
SITE NAME: PETALUMA
MODEL: RICHMOND 2 BDRM + DEN - F 925
LOT #:
DESIGNER: KS
DATE: JAN 8 18