



CONSTRUCTION SUMMARY

330 Richmond - Petaluma Building Corp.

PURCHASERS: Roberto SALITURO and Bruno IERULLO

TEL: RES.: 905-893-2514 BUS.: 416-725-2144

Unit 2, Level 27 (PH02-1)

Floor Plan  
E746

CERAMIC TILE

1 - UPGRADE 3 FLOOR AND WALL TILES IN MAIN BATHROOM

07Jun19 Note:

1 - UPGRADE 3 FLOOR AND WALL TILES IN MASTER ENSUITE

07Jun19 Note:

CONSTRUCTION

1 - SMOOTH CEILINGS IN BEDROOMS

07Jun19 Note:

COUNTER TOP

1 - UPGRADE COUNTERTOP EDGE IN KITCHEN AND BATHROOMS

07Jun19 Note:

HARDWOOD FLOORING

1 - UPGRADE HARDWOOD THROUGHOUT

07Jun19 Note:

PLUMBING

1 - UPGRADE BATHROOM ACCESSORIES IN BOTH BATHROOMS- MOEN 90 DEGREE CHROME

TOILET PAPER HOLDER #YB8808

TOWEL RING #8886

24" TOWEL BAR #YB8824

07Jun19 Note:

PROMOTIONAL

1 - LESS CREDIT FROM PURCHASERS EXTRA SHEET IN OFFER

07Jun19 Note:

EXTRAS AS PER OFFER

The Vendor agrees that notwithstanding any other term or provision in this Agreement included in the Purchase Price and in addition to those items

detailed in Schedule D to the Agreement of Purchase and Sale, the Purchaser is entitled to a credit of Ten

Worksheet Note:

1 Parking Unit

Worksheet Note:

This Document is Extremely Time Sensitive - Printed 7 Jun 19 at 11:36

RECEIVED JUN 12 2019



Purchasers: Roberto SALITURO & Bruno IERULLO  
Telephone Res. / Bus: (905) 893-2514 / (416) 725-2144  
Decor Advisor: Natalie Mancuso  
Lock Date: 6/7/2019 11:38:37

Const. No.: Unit 2, Level 27  
Municipal: PH02  
Suite Type: E746  
Project/Phase: Petaluma Building Corp./1

Layout Changes: ☐ Yes ☒ No      Sketch Attached: ☒ Yes ☐ No      Exterior Colour Scheme:

1. Kitchen and Vanities

	Style and Colour	Counter	Hardware
Kitchen / Breakfast	SEE BELOW	QUARTZ- LYSKAMM #360 EDGE	STD
Main Bath	ARUBA L602XZ4	QUARTZ- LYSKAMM #360 EDGE	STD
Master Ensuite Bathroom	ARUBA L602XZ4	QUARTZ- LYSKAMM #360 EDGE	STD

Appliances:      Built In Appliances ☒ Yes ☐ No      41" Upper Cabinets ☒ Yes ☐ No      Slide In Stove ☐ Yes ☒ No

Comment  
KITCHEN UPPER CABINETS- SENOSAN DARK GREY  
KITCHEN BASE CABINETS- ARUBA L602XZ4

2. Flooring

		Grout-If App.	At a 45
Entrance Vestibule	HARDWOOD- MIRAGE 4 5/16 LOCK RED OAK- HOPSCOTCH CHARACTER-BRUSHED		
Main Hall	HARDWOOD- MIRAGE 4 5/16 LOCK RED OAK- HOPSCOTCH CHARACTER-BRUSHED		
Kitchen / Breakfast	HARDWOOD- MIRAGE 4 5/16 LOCK RED OAK- HOPSCOTCH CHARACTER-BRUSHED		
Laundry Room	TILE- MATTE WHITE 8X8	STD	
Main Bath	TILE- RMD STATUARIO BRILL 10X30	STD	
Master Ensuite Bathroom	TILE- RMD STATUARIO BRILL 10X30	STD	
Living Room	HARDWOOD- MIRAGE 4 5/16 LOCK RED OAK- HOPSCOTCH CHARACTER-BRUSHED		
Dining Room	HARDWOOD- MIRAGE 4 5/16 LOCK RED OAK- HOPSCOTCH CHARACTER-BRUSHED		
Den / Library / Study			
Master Bedroom	HARDWOOD- MIRAGE 4 5/16 LOCK RED OAK- HOPSCOTCH CHARACTER-BRUSHED		
Bedroom #2	HARDWOOD- MIRAGE 4 5/16 LOCK RED OAK- HOPSCOTCH CHARACTER-BRUSHED		
Bedroom #3			

Comment

3. Wall Tile

	Selection	Grout	Describe
Main Bath			
Tub Deck Wall			
Shower Stall			
Bathtub Enclosure Walls	TILE- RMD STATUARIO BRILL 10X30	STD	
Master Ensuite Bathroom			
Tub Deck Wall			
Shower Stall	TILE- RMD STATUARIO BRILL 10X30	STD	
Bathtub Enclosure Walls			
Kitchen Backsplash	QUARTZ- LYSKAMM		
Backsplash Behind Fridge			

Comment  
\*\* Refer to Construction Summary

4. Misc

Water Line for Fridge: NI  
Interior Door Handles: STANDARD  
Ceramic Bathroom Accessories: UPGRADE MOEN 90 DEGREE CHROME      ☒ Yes      ☐ No  
Comment



Purchasers: Roberto SALITURO & Bruno IERULLO  
Telephone Res. / Bus: (905) 893-2514 / (416) 725-2144  
Decor Advisor: Natalie Mancuso  
Lock Date: 6/7/2019 11:38:37

Const. No.: Unit 2, Level 27  
Municipal: PH02  
Suite Type: E746  
Project/Phase: Petaluma Building Corp./1

5. Plaster Mouldings and Medallions

Entrance Vestibule			Living Room		
Main Hall			Dining Room		
Kitchen/Breakfast			Den / Library /Study		
Laundry Room			Master BedRoom		
Main Bath			BedRoom #2		
Master Ensuite Bathroom			BedRoom #3		

Comment  
\*\* Refer to Construction Summary

6. Wall Paint

Entrance Vestibule	BIRCH WHITE	Living Room	BIRCH WHITE
Main Hall	BIRCH WHITE	Dining Room	BIRCH WHITE
Kitchen / Breakfast	BIRCH WHITE	Den/Library	
Laundry Room	BIRCH WHITE	Master Bedroom	BIRCH WHITE
Main Bath	BIRCH WHITE	Bedroom #2	BIRCH WHITE
Master Ensuite	BIRCH WHITE	Bedroom #3	

Comment

7. General Comments

\*\* Refer to Construction Summary

Disclaimers and Notes

- 1) Colours of all materials are as close as possible to builder's selection, but not necessarily identical due to variances in manufacturing.
- 2) Any extras listed above are null and void unless accompanied by a separate invoice/amendment. Said invoice must be paid in full.
- 3) The Purchaser agrees that this colour selection is final and that no changes will be permitted, unless required by the Vendor.
- 4) The Purchaser acknowledges reading and accepting document which contains other miscellaneous disclaimers.

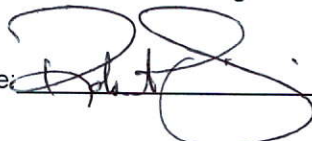
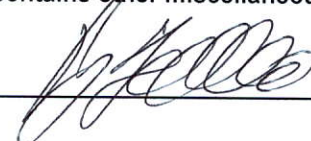
Signature:  Date: June 7/19  
Signature:  Date: June 6/7/19  
Initials: \_\_\_\_\_ Page 2 of 2

# 90°™

Traditional | Transitional | Modern

Geometric forms, squared corners and straight lines create an urban focal point for today's contemporary baths.

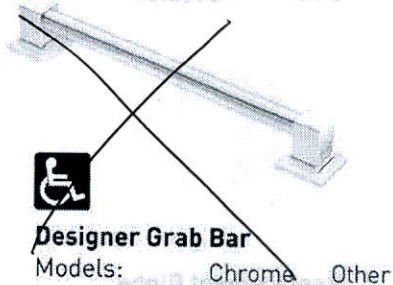
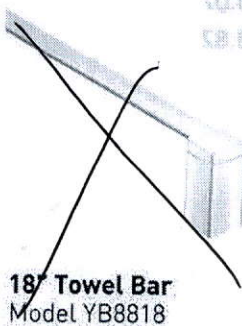
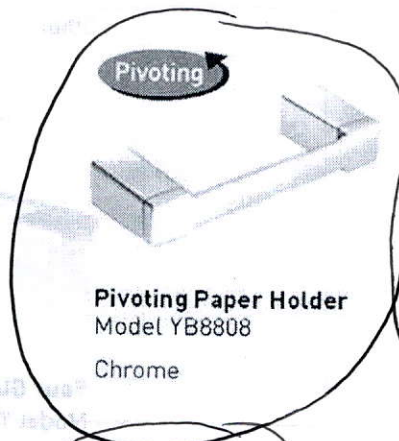
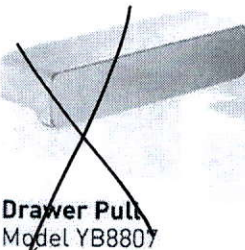
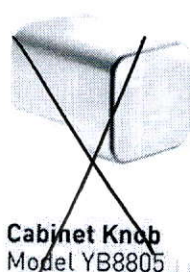
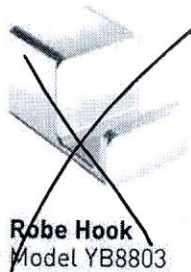

## FINISH OPTIONS:

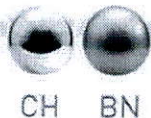

To order, combine the model number with one of these finish letter(s):  
Chrome (CH), LifeShine® Brushed Nickel (BN).

SCHEDULE 'A'

330

RICHMOND

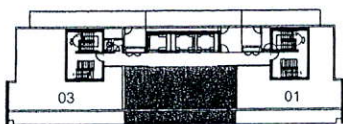
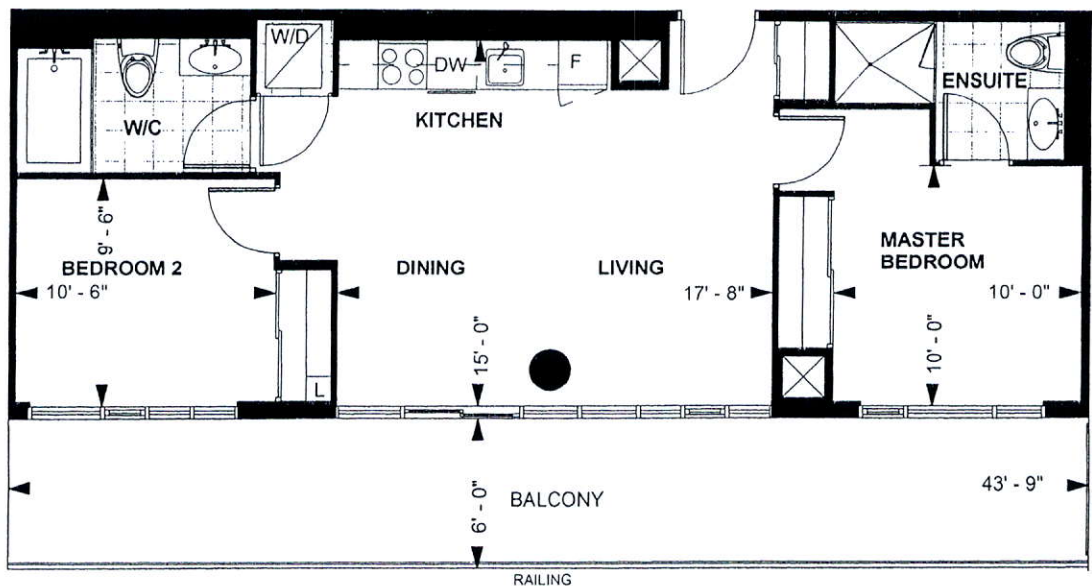

LEVEL 25

PENTHOUSE SUITE  
E 746  
10' CEILING \*  
746 sq. ft.  
2-BEDROOM

Purchaser Initials Purchaser Initials Date

Unit No. 2 Level No. 25 Suite No. PH02

Dimensions, specification, tile floor pattern and architectural detailing (including window size and location) are approximate and subject to modifications without notice. Orientation of suite may vary from the stated floor area.  
\*Ceiling height measured from top of floor slab to underside of slab above before finishes, and excluding bulkheads and required drop ceilings. E.&O.E.



\*Upgrade Counter top Edge in Kitchen + Baths

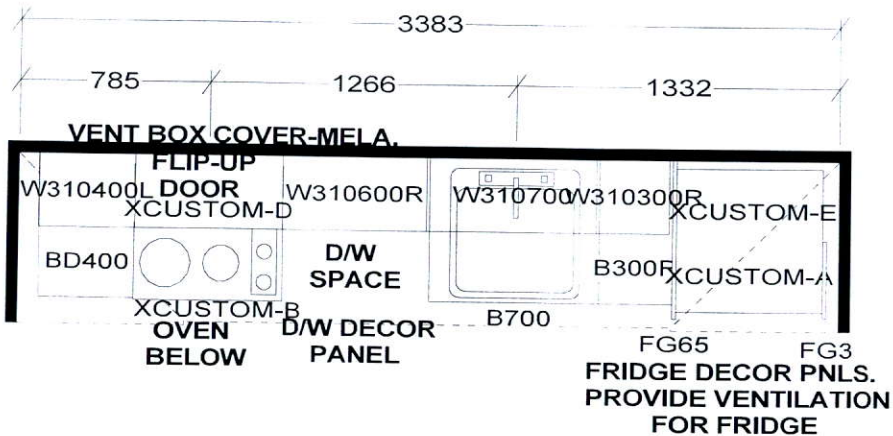

KITCHEN

KITCHEN BASES & VANITIES INSTALLED  
WITH ADJUSTABLE LEGS

APPLIANCE PACKAGE:  
24" INTEGRATED FRIDGE W/ DECOR PNLS  
24" INTEGRATED DISHWASHER W/ DECOR PNL  
24" BUILT-IN OVEN  
24" COOKTOP  
24" MICROWAVE HOOD FAN

Selba Industries

W	WDTH	W	HGHT	W	CNT	FL	HGHT	DWY	H	ST	CENT	2X4	VENT BOX COVER

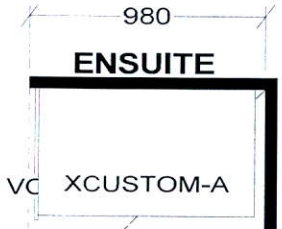

CUSTOM 2 DRAWER VANITY  
(Drawers modified to clear plumbing)  
FLOATING TOEKICK

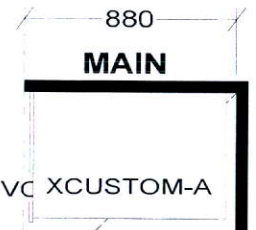

CUSTOM 2 DRAWER VANITY  
(Drawers modified to clear plumbing)  
FLOATING TOEKICK

This drawing is the intellectual property of  
SELBA INDUSTRIES INC. and is an  
original design which must not be released  
or copied unless applicable fee has been  
paid or job order placed.



JOB NUMBER:  
BUILDER: GREENPARK  
SITE NAME: PETALUMA  
MODEL: PENTHOUSE 2 BDRM - E 746, E 861  
LOT #:  
DESIGNER: KS  
DATE: JAN 8 18