



CONSTRUCTION SUMMARY  
330 Richmond - Petaluma Building Corp.

PURCHASERS: Jing Jie CHEN and Hong Guo WANG

TEL:

Unit 13, Level 19 (2216-1)

Floor Plan  
C649

CABINETRY

1 - 41" UPPER CABINETS KITCHEN  
29May19 Note:

CONSTRUCTION

1 - SMOOTH CEILING IN BEDROOM  
29May19 Note:

1 - MAIN BATH - 5 FOOT SHOWER WITH SLIDING CHROME FRAMED GLASS DOORS IN LIEU OF TUB  
19Jun18 Note:

COUNTER TOP

1 - UPGRADE KITCHEN COUNTERTOP EDGE  
29May19 Note:

PLUMBING

1 - UPGRADE BATHROOM ACCESSORIES- MOEN 90 DEGREE CHROME  
TOILET PAPER HOLDER #YB8808  
TOWEL RING#YB8886  
24 INCH TOWEL BAR #YB8824  
29May19 Note:

PROMOTIONAL

1 - LESS CREDIT FROM PURCHASER EXTRA SHEET IN OFFER  
29May19 Note:

1 - PARTIAL REDEPTION OF PROMOTIONAL PACKAGE \$2,800.00 BALANCE (\$2,200) FORWARD TO BE USED AT A LATER DATE.  
ORIGINAL PROMOTIONAL PACKAGE OF \$5,000 AS PER SCHEDULE PE DATED -OCTOBER 8, 2015.  
19Jun18 Note:

EXTRAS AS PER OFFER

The Vendor agrees that notwithstanding any other term or provision in this Agreement included in the Purchase Price and in addition to those items detailed in Schedule D to the Agreement of Purchase and Sale, the Purchaser is entitled to a credit of Fiv  
Worksheet Note:

This Document is Extremely Time Sensitive - Printed 29 May 19 at 14:20

RECEIVED MAY 29 2019

Purchasers: Jing Jie CHEN & Hong Guo WANG  
Telephone Res. / Bus: /  
Decor Advisor: Natalie Mancuso  
Lock Date: 5/29/2019 14:14:52

Const. No.: Unit 13, Level 19  
Municipal: 2216  
Suite Type: C649  
Project/Phase: Petaluma Building Corp./1

Layout Changes: ☒ Yes ☐ No Sketch Attached: ☒ Yes ☐ No Exterior Colour Scheme:

1. Kitchen and Vanities

	Style and Colour	Counter	Hardware
Kitchen / Breakfast	SEE BELOW	QUARTZ- TORRONE- #360 EDGE	STD
Main Bath	DORAL H3078 HACIENDA WHITE	QUARTZ- TORRONE- STRAIGHT POLISHED EDGE	STD
Master Ensuite Bathroom			

Appliances: Built In Appliances ☒ Yes ☐ No 41" Upper Cabinets ☒ Yes ☐ No Slide In Stove ☐ Yes ☒ No

Comment

KITCHEN UPPER CABINETS- SENOSAN WHITE  
KITCHEN BASE CABINETS- DORAL H3078 HACIENDA WHITE

2. Flooring

		Grout-If App.	At a 45
Entrance Vestibule	HARDWOD- MIRAGE 4 5/16 LOCK RED OAK- NORDIC- CASHMERE		
Main Hall	HARDWOD- MIRAGE 4 5/16 LOCK RED OAK- NORDIC- CASHMERE		
Kitchen / Breakfast	HARDWOD- MIRAGE 4 5/16 LOCK RED OAK- NORDIC- CASHMERE		
Laundry Room	TILE- MATTE WHITE 8X8	STD	
Main Bath	TILE- LIFE SILVER 12X24	STD	
Master Ensuite Bathroom			
Living Room	HARDWOD- MIRAGE 4 5/16 LOCK RED OAK- NORDIC- CASHMERE		
Dining Room	HARDWOD- MIRAGE 4 5/16 LOCK RED OAK- NORDIC- CASHMERE		
Den / Library / Study	HARDWOD- MIRAGE 4 5/16 LOCK RED OAK- NORDIC- CASHMERE		
Master Bedroom	HARDWOD- MIRAGE 4 5/16 LOCK RED OAK- NORDIC- CASHMERE		
Bedroom #2			
Bedroom #3			

Comment

3. Wall Tile

	Selection	Grout	Describe
Main Bath			
Tub Deck Wall			
Shower Stall	TILE- GLOSSY WHITE 3X6	STD	
Bathtub Enclosure Walls			
Master Ensuite Bathroom			
Tub Deck Wall			
Shower Stall			
Bathtub Enclosure Walls			
Kitchen Backsplash	PAINTED GLASS BM#OC-16		
Backsplash Behind Fridge			

Comment

\*\* Refer to Construction Summary

4. Misc

Water Line for Fridge: NI  
Interior Door Handles: STANDARD  
Ceramic Bathroom Accessories: UPGRADE MOEN 90 DEGREE CHROME ☒ Yes ☐ No

Comment

Initials:

Purchasers: Jing Jie CHEN & Hong Guo WANG  
Telephone Res. / Bus: /  
Decor Advisor: Natalie Mancuso  
Lock Date: 5/29/2019 14:14:52

Const. No.: Unit 13, Level 19  
Municipal: 2216  
Suite Type: C649  
Project/Phase: Petaluma Building Corp./1

5. Plaster Mouldings and Medallions

Entrance Vestibule			Living Room		
Main Hall			Dining Room		
Kitchen/Breakfast			Den / Library /Study		
Laundry Room			Master BedRoom		
Main Bath			BedRoom #2		
Master Ensuite Bathroom			BedRoom #3		

Comment

\*\* Refer to Construction Summary

6. Wall Paint

Entrance Vestibule	BIRCH WHITE	Living Room	BIRCH WHITE
Main Hall	BIRCH WHITE	Dining Room	BIRCH WHITE
Kitchen / Breakfast	BIRCH WHITE	Den/Library	BIRCH WHITE
Laundry Room	BIRCH WHITE	Master Bedroom	BIRCH WHITE
Main Bath	BIRCH WHITE	Bedroom #2	
Master Ensuite		Bedroom #3	

Comment

7. General Comments

\*\* Refer to Construction Summary

Disclaimers and Notes

- Colours of all materials are as close as possible to builder's selection, but not necessarily identical due to variances in manufacturing.
- Any extras listed above are null and void unless accompanied by a separate invoice/amendment. Said invoice must be paid in full.
- The Purchaser agrees that this colour selection is final and that no changes will be permitted, unless required by the Vendor.
- The Purchaser acknowledges reading and accepting document which contains other miscellaneous disclaimers.

Signature:

Date:

Signature:

Date:

Signature:

Date:

Initials:

# 90°™

Traditional | Transitional | Modern

*Geometric forms, squared corners and straight lines create an urban focal point for today's contemporary baths.*

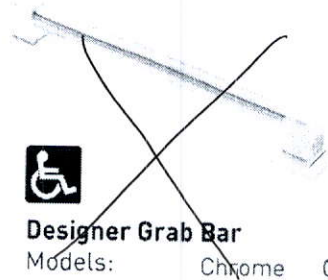
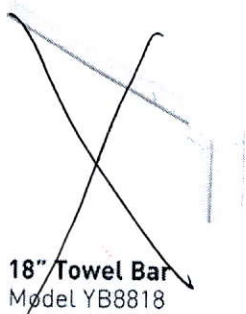
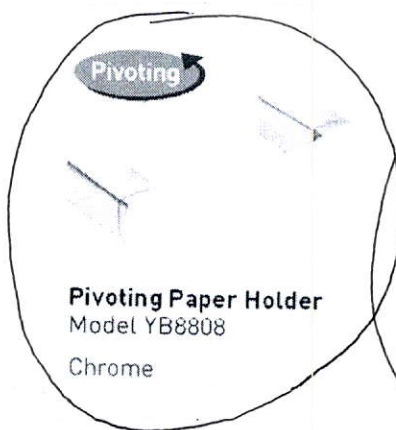
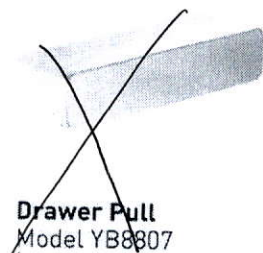
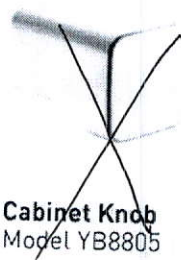
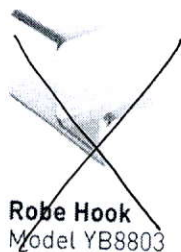
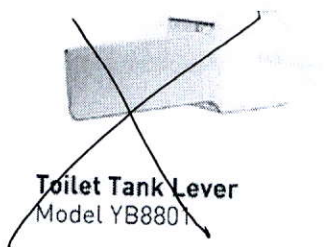

**FINISH OPTIONS:**

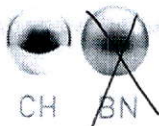

To order, combine the model number with one of these finish letter(s):  
Chrome (CH), LifeShine® Brushed Nickel (BN).

# SCHEDULE 'A'

**330**  
RICHMOND

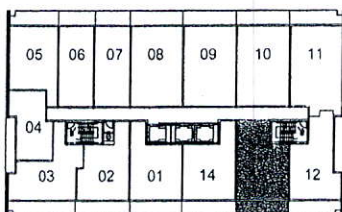
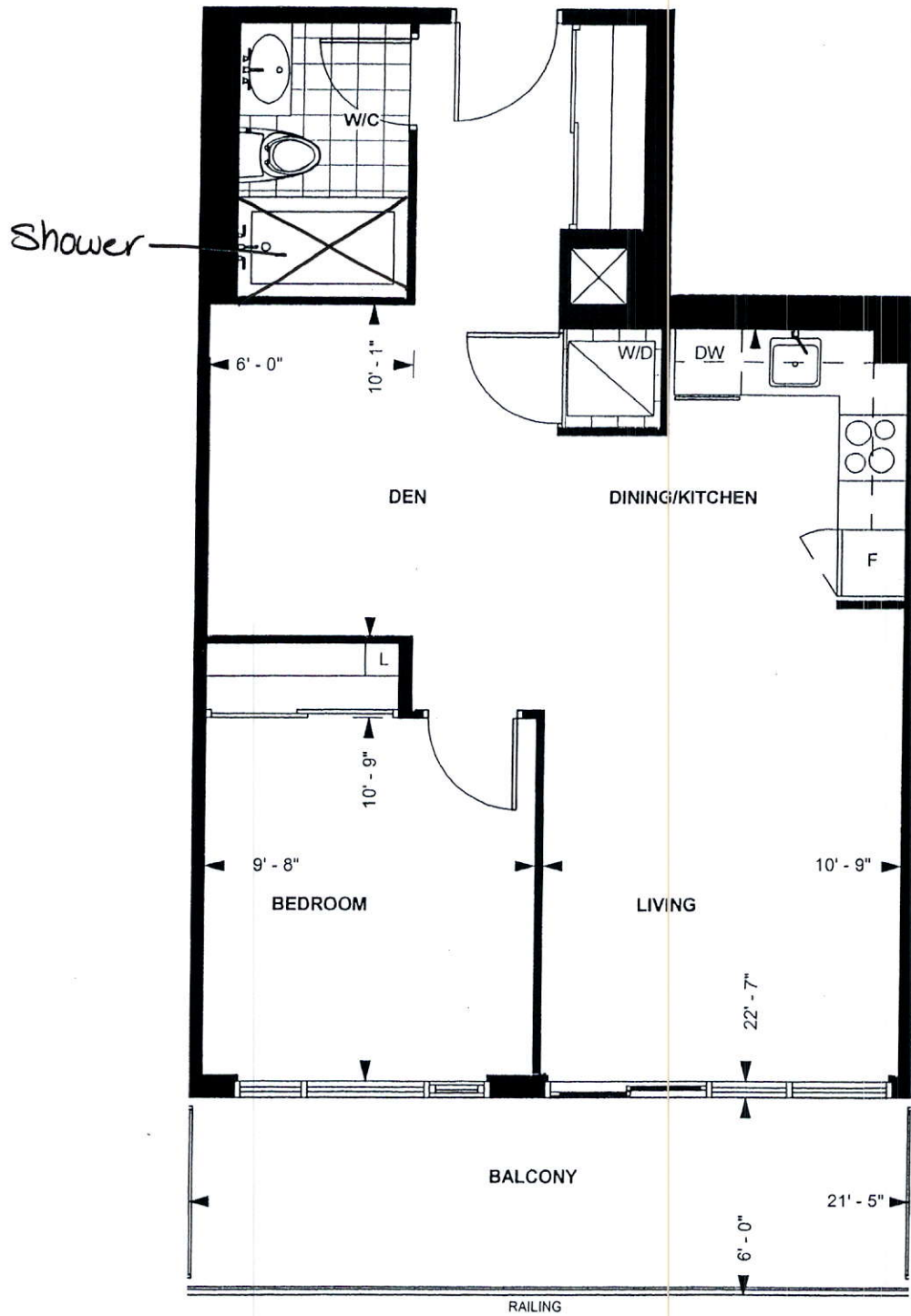

LEVEL 13-20

TOWER SUITE

**C 649**

**9' CEILING \***

649 sq. ft.

**1-BEDROOM PLUS DEN**

Purchaser Initials Purchaser Initials

Date

Unit No. 13 Level No. 19 Suite No. 2216

Dimensions, specification, tile floor pattern and architectural detailing (including window size and location) are approximate and subject to modifications without notice. Orientation of suite may vary from the stated floor area.  
\*Ceiling height measured from top of floor slab to underside of slab above before finishes, and excluding bulkheads and required drop ceilings. E.&O.E.

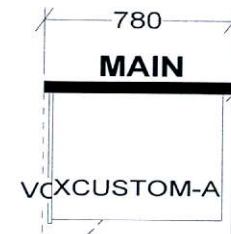
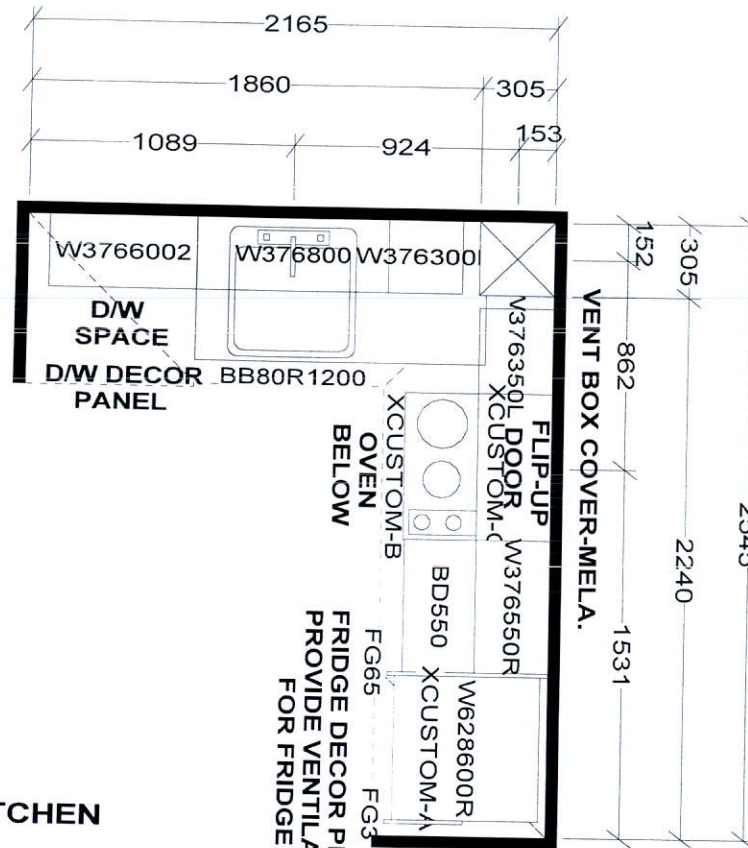

**CUSTOM 2 DRAWER VANITY**  
(Drawers modified to clear plumbing)  
FLOATING TOEKICK

**KITCHEN BASES & VANITIES INSTALLED  
WITH ADJUSTABLE LEGS**

### KITCHEN

- 41" uppers
- up. countertop Edge

**APPLIANCE PACKAGE:**  
24" INTEGRATED FRIDGE W/ DECOR PNLS  
24" INTEGRATED DISHWASHER W/ DECOR PNL  
24" BUILT-IN OVEN  
24" COOKTOP  
24" MICROWAVE HOOD FAN

*Selba Industries*

W WIDTH \_\_\_\_\_ W HGHT \_\_\_\_\_ W CNT \_\_\_\_\_ FL HGHT \_\_\_\_\_ DWY H \_\_\_\_\_ ST CENT \_\_\_\_\_ 2X4 \_\_\_\_\_ VENT BOX COVER \_\_\_\_\_

**TOWER SUITES:**  
760MM HIGH UPPER CABINETS  
WHITE STEEL DRAWER BOXES  
COUNTERTOPS BY OTHERS  
VENT BOX COVERS  
CUSTOM VANITIES

This drawing is the intellectual property of  
SELBA INDUSTRIES INC. and is an  
original design which must not be released  
or copied unless applicable fee has been  
paid or job order placed.



**JOB NUMBER:**  
**BUILDER:** GREENPARK  
**SITE NAME:** PETALUMA  
**MODEL:** 1 BEDROOM + DEN - C 649  
**LOT #:**  
**DESIGNER:** KS  
**DATE:** JAN 8 18