



CONSTRUCTION SUMMARY  
330 Richmond - Petaluma Building Corp.

PURCHASER: Franco DE CARIA

TEL:

Unit 13, Level 20 (2316-1)

Floor Plan  
C649

CERAMIC TILE

1 - 41" UPPER CABINETS IN KITCHEN

24May19 Note:

CONSTRUCTION

1 - SMOOTH CEILING IN BEDROOM

24May19 Note:

1 - MAIN BATH - 5 FOOT SHOWER WITH SLIDING CHROME FRAMED GLASS DOORS IN LIEU OF TUB

30Apr18 Note:

PLUMBING

1 - UPGRADE BATHROOM ACCESSORIES- MOEN 90 DEGREE CHROME

TOILET PAPER HOLDER #YB8808

TOWEL RING #YB8886

24" TOWEL BAR # 8824

24May19 Note:

PROMOTIONAL

1 - LESS CREDIT FROM PURCHASER EXTRA SHEET IN OFFER

24May19 Note:

1 - PARTIAL REDEPTION OF PROMOTIONAL PACKAGE \$2,800.00 BALANCE (\$2,200) FORWARD TO BE USED AT A LATER DATE.  
ORIGINAL PROMOTIONAL PACKAGE OF \$5,000 AS PER SCHEDULE PE DATED -  
OCTOBER 26, 2015.

30Apr18 Note:

EXTRAS AS PER OFFER

The Vendor agrees that notwithstanding any other term or provision in this Agreement included in the Purchase Price and in addition to those items

detailed in Schedule D to the Agreement of Purchase and Sale, the Purchaser is entitled to a credit of Fiv

Worksheet Note:

1 Parking Unit

Worksheet Note:

This Document is Extremely Time Sensitive - Printed 24 May 19 at 10:57

RECEIVED MAY 24 2019

Purchaser: Franco DE CARIA  
 Telephone Res. / Bus: /  
 Decor Advisor: Natalie Mancuso  
 Lock Date: 5/24/2019 10:54:01

Const. No.: Unit 13, Level 20  
 Municipal: 2316  
 Suite Type: C649  
 Project/Phase: Petaluma Building Corp./1

Layout Changes: ☐ Yes ☒ No Sketch Attached: ☒ Yes ☐ No Exterior Colour Scheme:

### 1. Kitchen and Vanities

	Style and Colour	Counter	Hardware
Kitchen / Breakfast	SEE BELOW	QUARTZ- AMIATA- STRAIGHT POLISHED EDGE	STD
Main Bath	DORAL H3081 HACIENDA BLACK	QUARTZ- AMIATA- STRAIGHT POLISHED EDGE	STD
Master Ensuite Bathroom			

Appliances: Built In Appliances ☒ Yes ☐ No 41" Upper Cabinets ☒ Yes ☐ No Slide In Stove ☐ Yes ☒ No

#### Comment

KITCHEN UPPER CABINETS- SENOSAN WHITE  
 KITCHEN BASE CABINETS- DORAL H3081 HACIENDA BLACK

### 2. Flooring

		Grout-If App.	At a 45
Entrance Vestibule	HARDWOOD- MIRAGE 4 5/16 LOCK RED OAK- GRAPHITE -CASHMERE		<input type="checkbox"/>
Main Hall	HARDWOOD- MIRAGE 4 5/16 LOCK RED OAK- GRAPHITE -CASHMERE		<input type="checkbox"/>
Kitchen / Breakfast	HARDWOOD- MIRAGE 4 5/16 LOCK RED OAK- GRAPHITE -CASHMERE		<input type="checkbox"/>
Laundry Room	TILE- MATTE WHITE 8X8	STD	<input type="checkbox"/>
Main Bath	TILE- LIFE ICE 12X24	STD	<input type="checkbox"/>
Master Ensuite Bathroom			<input type="checkbox"/>
			<input type="checkbox"/>
Living Room	HARDWOOD- MIRAGE 4 5/16 LOCK RED OAK- GRAPHITE -CASHMERE		<input type="checkbox"/>
Dining Room	HARDWOOD- MIRAGE 4 5/16 LOCK RED OAK- GRAPHITE -CASHMERE		<input type="checkbox"/>
Den / Library / Study	HARDWOOD- MIRAGE 4 5/16 LOCK RED OAK- GRAPHITE -CASHMERE		<input type="checkbox"/>
Master Bedroom	HARDWOOD- MIRAGE 4 5/16 LOCK RED OAK- GRAPHITE -CASHMERE		<input type="checkbox"/>
Bedroom #2			<input type="checkbox"/>
Bedroom #3			<input type="checkbox"/>
			<input type="checkbox"/>

#### Comment

### 3. Wall Tile

	Selection	Grout	Describe
Main Bath			
Tub Deck Wall			
Shower Stall			
Bathtub Enclosure Walls	TILE- GLOSSY WHITE 3X6	STD	
Master Ensuite Bathroom			
Tub Deck Wall			
Shower Stall			
Bathtub Enclosure Walls			
Kitchen Backsplash	PAINTED GLASS BM#HC-170		
Backsplash Behind Fridge			

#### Comment

\*\* Refer to Construction Summary

### 4. Misc

Water Line for Fridge NO  
 Interior Door Handles STANDARD  
 Ceramic Bathroom Accessories UPGRADE MOEN 90 DEGREE ☒ Yes ☐ No

#### Comment

Purchaser: Franco DE CARIA  
Telephone Res. / Bus: /  
Decor Advisor: Natalie Mancuso  
Lock Date: 5/24/2019 10:54:01

Const. No.: Unit 13, Level 20  
Municipal: 2316  
Suite Type: C649  
Project/Phase: Petaluma Building Corp./1

5. Plaster Mouldings and Medallions

Entrance Vestibule			Living Room		
Main Hall			Dining Room		
Kitchen/Breakfast			Den / Library /Study		
Laundry Room			Master BedRoom		
Main Bath			BedRoom #2		
Master Ensuite Bathroom			BedRoom #3		

Comment  
\*\* Refer to Construction Summary

6. Wall Paint

Entrance Vestibule	BIRCH WHITE	Living Room	BIRCH WHITE
Main Hall	BIRCH WHITE	Dining Room	BIRCH WHITE
Kitchen / Breakfast	BIRCH WHITE	Den/Library	BIRCH WHITE
Laundry Room	BIRCH WHITE	Master Bedroom	BIRCH WHITE
Main Bath	BIRCH WHITE	Bedroom #2	
Master Ensuite		Bedroom #3	

Comment

7. General Comments

\*\* Refer to Construction Summary

Disclaimers and Notes

- 1) Colours of all materials are as close as possible to builder's selection, but not necessarily identical due to variances in manufacturing.
- 2) Any extras listed above are null and void unless accompanied by a separate invoice/amendment. Said invoice must be paid in full.
- 3) The Purchaser agrees that this colour selection is final and that no changes will be permitted, unless required by the Vendor.
- 4) The Purchaser acknowledges reading and accepting document which contains other miscellaneous disclaimers.

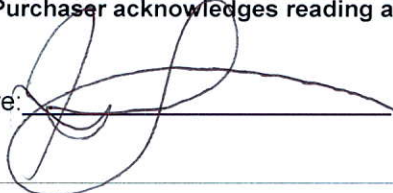
Signature:  Date: 05/24/19 Signature: \_\_\_\_\_ Date: \_\_\_\_\_

Initial:  Page 2 of 2

# 90°™

Traditional | Transitional | Modern

*Geometric forms, squared corners and straight lines create an urban focal point for today's contemporary baths.*

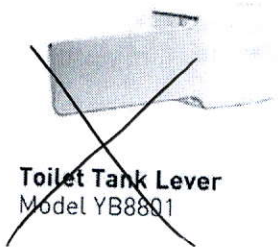

**Toilet Tank Lever**  
Model YB8801

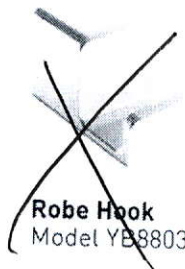

**Robe Hook**  
Model YB8803

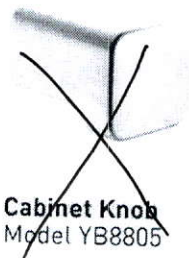

**Cabinet Knob**  
Model YB8805

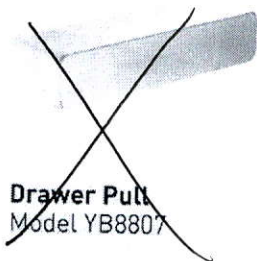

**Drawer Pull**  
Model YB8807

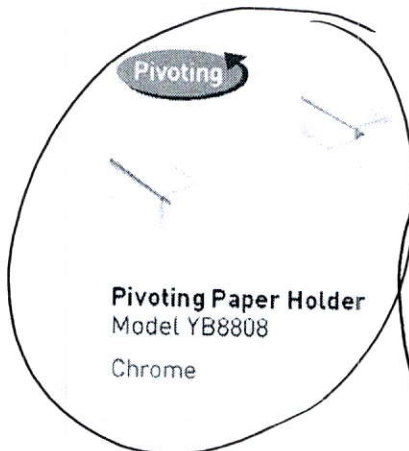

**Pivoting Paper Holder**  
Model YB8808  
Chrome



**Mini Towel Bar**  
Model YB8886  
Chrome



**18" Towel Bar**  
Model YB8818



**24" Towel Bar**  
Model YB8824  
Chrome



**Designer Grab Bar**  
Models: Chrome Other

**FINISH OPTIONS:**

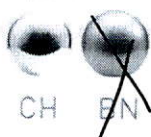

To order, combine the model number with one of these finish letter(s):  
Chrome (CH), LifeShine® Brushed Nickel (BN).

# SCHEDULE 'A'

330  
RICHMOND

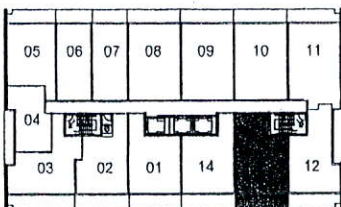
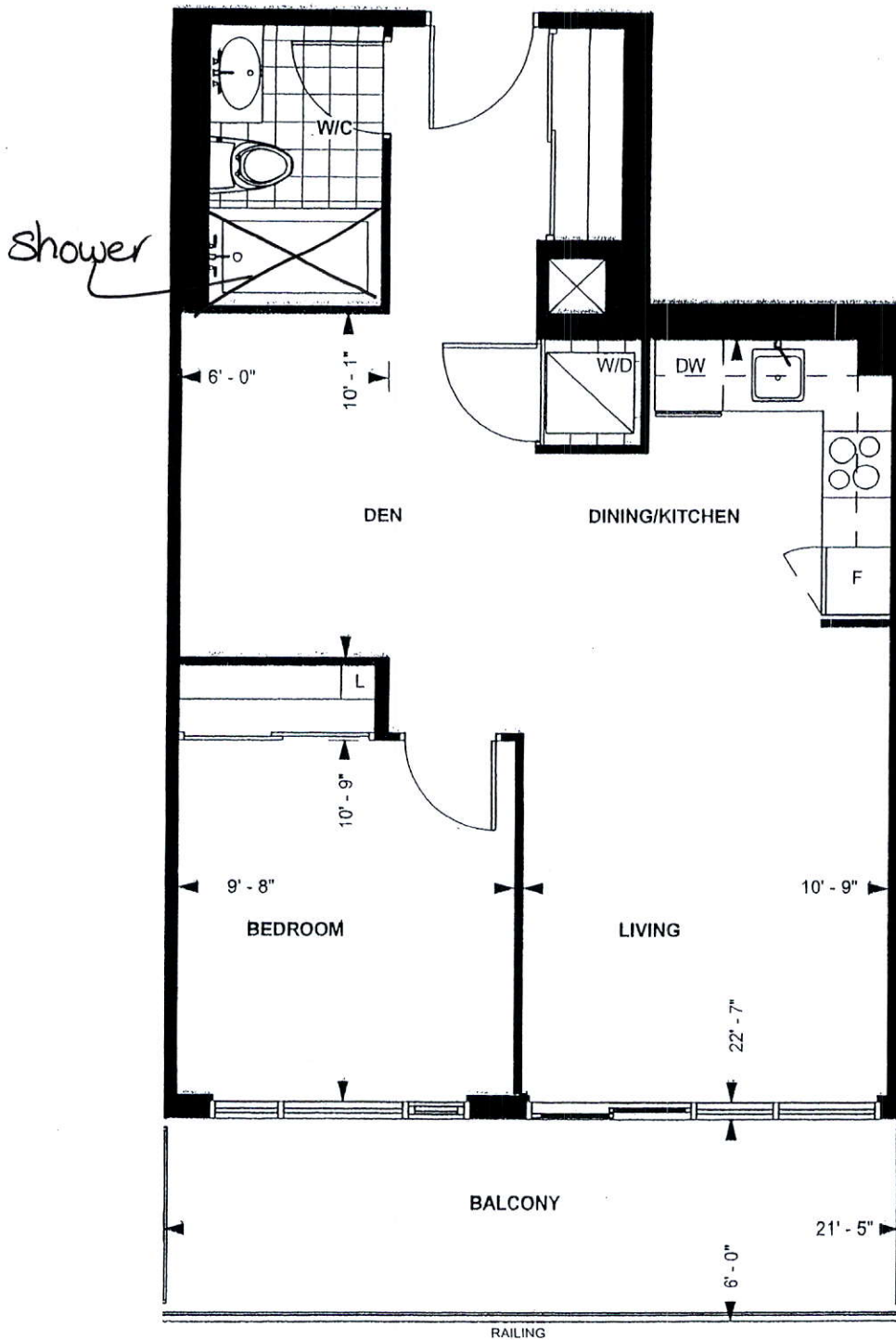

LEVEL 13-20

TOWER SUITE

C 649

9' CEILING \*

649 sq. ft.

1-BEDROOM PLUS DEN

Purchaser Initials Purchaser Initials

Date

Unit No. 13 Level No. 20 Suite No. 2316

Dimensions, specification, tile floor pattern and architectural detailing (including window size and location) are approximate and subject to modifications without notice. Orientation of suite may vary from the stated floor area.  
\*Ceiling height measured from top of floor slab to underside of slab above before finishes, and excluding bulkheads and required drop ceilings. E & O.E.

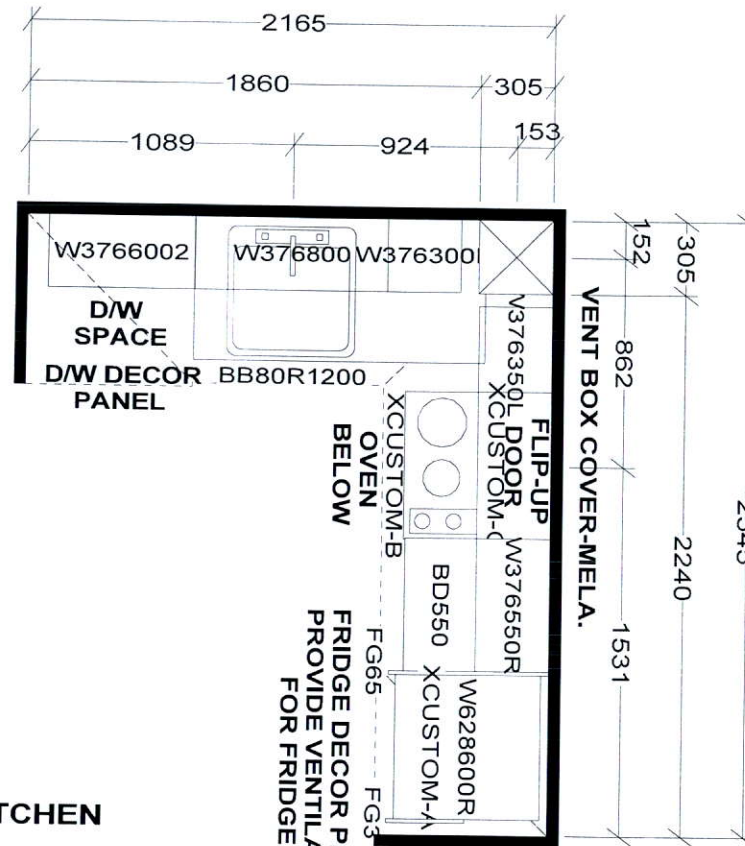

KITCHEN  
41" uppers

FRIDGE DECOR PNLS.  
PROVIDE VENTILATION  
FOR FRIDGE

KITCHEN BASES & VANITIES INSTALLED  
WITH ADJUSTABLE LEGS

APPLIANCE PACKAGE:  
24" INTEGRATED FRIDGE W/ DECOR PNLS  
24" INTEGRATED DISHWASHER W/ DECOR PNL  
24" BUILT-IN OVEN  
24" COOKTOP  
24" MICROWAVE HOOD FAN

*Selba Industries*

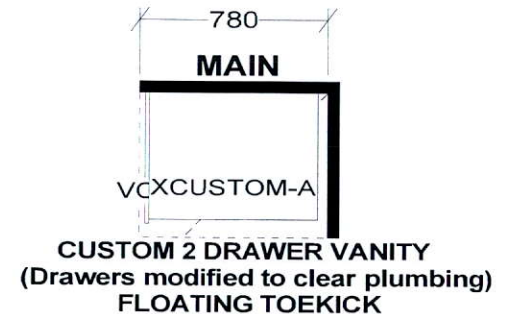

W WIDTH	W HIGHT	W CNT	FL HIGHT	DWY H	ST CENT	2X4	VENT BOX COVER
TOWER SUITES: 760MM HIGH UPPER CABINETS WHITE STEEL DRAWER BOXES COUNTERTOPS BY OTHERS VENT BOX COVERS CUSTOM VANITIES				<small>This drawing is the intellectual property of SELBA INDUSTRIES INC. and is an original design which must not be released or copied unless applicable fee has been paid or job order placed.</small>		JOB NUMBER: BUILDER: GREENPARK SITE NAME: PETALUMA MODEL: 1 BEDROOM + DEN - C 649 LOT #: DESIGNER: KS DATE: JAN 8 18	