

CONSTRUCTION SUMMARY
330 Richmond - Petaluma Building Corp.

PURCHASER: Alexandra Maria-Cristina URSO TEL: RES.: 905-850-7836

Unit 3, Level 23 (2703-1)	Floor Plan E771		
---------------------------	--------------------	--	--

CABINETRY

1 - MAIN & MASTER BATHROOMS - UPGRADE 2 - HAMPTON CABINETRY 14Mar19 Note:	
1 - MAIN & MASTER BATHROOMS - UPGRADED MONACO CABINETRY WITH STAINLESS STEEL SINKS 14Mar19 Note:	
1 - MAIN & MASTER BATHROOMS - UPGRADED MONACO CABINETRY WITH STAINLESS STEEL SINKS 02Oct18 Note:	
1 - KITCHEN - 41" UPPER CABINETRY 02Oct18 Note:	
1 - KITCHEN - UPPER AND BASE CABINETRY - MISSION UPGRADE 5 CABINETRY 02Oct18 Note:	

CERAMIC TILE

1 - MASTER ENSUITE BATHROOM - SHOWER STALL - SUL 1001 LATERN WHITE GLOSSY (6.5X5.5) 02Oct18 Note:	
1 - MASTER ENSUITE BATHROOM - FLOOR - UPGRADE 5 TILE - LAID STRAIGHT 02Oct18 Note:	
1 - DELETE STANDARD BATHROOM ACCESSORIES - DO NOT INSTALL SOAP DISH, TOWEL RACK OR TISSUE HOLDER 02Oct18 Note:	
1 - MAIN BATHROOM - TUB ENCLOSURE WALLS - UPGRADED BF1312 FAN DARK GREY GLOSS SHEET TILES - (3.5X3.25") 02Oct18 Note:	
1 - MAIN BATHROOM - FLOOR - UPGRADE 5 TILE - LAID STRAIGHT 02Oct18 Note:	

CONSTRUCTION

2 - BEDROOMS - SMOOTH CEILINGS 02Oct18 Note:	
1 - MASTER ENSUITE BATHROOM - ADD NICHE 02Oct18 Note: NOT POSSIBLE	
1 - ENSUITE BATH - 5 FOOT SHOWER DOOR IN LIEU OF TUB 24Apr18 Note: Upgrade Shower Door	

COUNTER TOP

1 - MASTER ENSUITE BATHROOM - UPGRADED EDGE ON COUNTERTOP 02Oct18 Note:	
1 - MASTER ENSUITE BATHROOM - HIGH-END QUARTZ COUNTERTOP IN LIEU OF STANDARD AS PER OFFER 02Oct18 Note:	
1 - MAIN BATHROOM - UPGRADED EDGE ON COUNTERTOP 02Oct18 Note:	
1 - MAIN BATHROOM - HIGH-END QUARTZ COUNTERTOP IN LIEU OF STANDARD AS PER OFFER 02Oct18 Note:	
1 - KITCHEN - HIGH-END QUARTZ FULL BACKSPLASH 02Oct18 Note:	
1 - KITCHEN - UPGRADED EDGE ON COUNTERTOP 02Oct18 Note:	



CONSTRUCTION SUMMARY
330 Richmond - Petaluma Building Corp.

PURCHASER: Alexandra Maria-Cristina URSO TEL: RES.: 905-850-7836

Unit 3, Level 23 (2703-1)	Floor Plan E771		
---------------------------	--------------------	--	--

1 - KITCHEN - HIGH-END QUARTZ COUNTERTOP IN LIEU OF STANDARD AS PER OFFER 02Oct18 Note:	
--	--

DOORS AND TRIM

1 - THROUGHOUT - 7 1/4" MDF STEP BEVEL BASEBOARD WITH 3" MDF STEP BEVEL CASING WITH BACKBEND 02Oct18 Note: WHERE CONSTRUCTION PERMITS	
--	--

ELECTRICAL

1 - LIVING ROOM - ADD LIGHT - IF CONSTRUCTION PERMITS - KEEP STANDARD PLUG TO SWITCH AS WELL 02Oct18 Note:	
---	--

HARDWOOD FLOORING

1 - THROUGHOUT - STANDARD NON-TILED AREAS - UPGRADE MAPLE HARDWOOD FLOORING IN LIEU OF STANDARD AS PER OFFER 02Oct18 Note:	
---	--

MIRRORS AND GLASS

1 - MASTER ENSUITE BATHROOM - SHOWER STALL - FRAMELESS GLASS SHOWER WITH D-RING AND TOWEL BAR 02Oct18 Note:	
--	--

MISCELLANEOUS

1 - FURTHER DISCOUNT AS PER VENDOR 02Oct18 Note:	
---	--

PLUMBING

1 - MAIN & MASTER ENSUITE BATHROOMS - 90 DEGREE BATHROOM ACCESSORIES - TOILET PAPER HOLDER #YB8808, TOWEL RING #YB8886 & 24" TOWEL BAR #YB8824 02Oct18 Note:	
1 - MASTER BATHROOM - ADD MOEN 90 DEGREE ECO-PERFORMANCE 1 FUNCTION HAND SHOWER WITH SLIDE BAR - CHROME - WITH 3 FUNCTION DIVERTER - #TS4172/3372 S3879EP/A721 02Oct18 Note:	
1 - MAIN BATHROOM - ADD MOEN 90 DEGREE ECO-PERFORMANCE 1 FUNCTION HAND SHOWER WITH SLIDE BAR - CHROME - WITH 3 FUNCTION DIVERTER - #128284/TS4172/3372 S3879EP/A721 02Oct18 Note:	
1 - KITCHEN - BLANCO QUATRUS R15 U 1 MEDIUM UNDERMOUNT SINK - #401517 02Oct18 Note:	

PROMOTIONAL

1 - LESS BALANCE OF CREDIT FROM PURCHASER EXTRA SHEET IN OFFER 14Mar19 Note:	
1 - REDEPTION OF PROMOTIONAL PACKAGE \$1,500 . ORIGINAL PROMOTIONAL PACKAGE OF \$1,500 AS PER SCHEDULE PE DATED -MARCH 12, 2016. 24Apr18 Note:	

EXTRAS AS PER OFFER

The Vendor agrees that notwithstanding any other term or provision in this Agreement included in the Purchase Price and in addition to those items detailed in Schedule D to the Agreement of Purchase and Sale, the Purchaser is entitled to a credit of One Worksheet Note:	
1 Parking Unit Worksheet Note:	

<div>CONSTRUCTION SUMMARY</div> <div>330 Richmond - Petaluma Building Corp.</div> <div>PURCHASER: Alexandra Maria-Cristina URSO</div> <div>TEL: RES.: 905-850-7836</div>			
Unit 3, Level 23 (2703-1)	Floor Plan E771		

This Document is Extremely Time Sensitive - Printed 21 May 19 at 10:16

Purchaser: Alexandra Maria-Cristina URSO

Telephone Res. / Bus: (905) 850-7836 /

Decor Advisor: Candace Forza

Lock Date: 10/2/2018 14:50:14

Const. No.: Unit 3, Level 23

Municipal: 2703

Suite Type: E771

Project/Phase: Petaluma Building Corp./1

Layout Changes: ☐ Yes ☒ NoSketch Attached: ☒ Yes ☐ No

Exterior Colour Scheme:

1. Kitchen and Vanities

	Style and Colour	Counter	Hardware
Kitchen / Breakfast	MISSION L614XZ4	QUARTZ-VIRGINA-#360 PENCIL EDGE	STD
Main Bath	Hampton W814XZ4	QUARTZ-PAPIRO-#360 PENCIL EDGE	STD
Master Ensuite Bathroom	Hampton W814XZ4	QUARTZ-VEGA-#360 PENCIL EDGE	STD

Appliances:

Built In Appliances ☒ Yes ☐ No41" Upper Cabinets ☒ Yes ☐ NoSlide In Stove ☐ Yes ☒ No

Comment

2. Flooring

		Grout-If App.	At a 45
Entrance Vestibule	STRIP-MIRAGE-LOCK-ADMIRATION-MAPLE-CASHMERE-UMBRIA-4 5/16"		
Main Hall	STRIP-MIRAGE-LOCK-ADMIRATION-MAPLE-CASHMERE-UMBRIA-4 5/16"		
Kitchen / Breakfast	STRIP-MIRAGE-LOCK-ADMIRATION-MAPLE-CASHMERE-UMBRIA-4 5/16"		
Laundry Room	TILE-WHITE-8X8		
Main Bath	TILE-CALCATT (CA6082P)-24X24	STANDARD	
Master Ensuite Bathroom	TILE-CALCATT (CA6082P)-24X24	TITANIUM 50	
	N/A	TITANIUM 50	
Living Room	STRIP-MIRAGE-LOCK-ADMIRATION-MAPLE-CASHMERE-UMBRIA-4 5/16"		
Dining Room	STRIP-MIRAGE-LOCK-ADMIRATION-MAPLE-CASHMERE-UMBRIA-4 5/16"		
Den / Library / Study	N/A		
Master Bedroom	STRIP-MIRAGE-LOCK-ADMIRATION-MAPLE-CASHMERE-UMBRIA-4 5/16"		
Bedroom #2	STRIP-MIRAGE-LOCK-ADMIRATION-MAPLE-CASHMERE-UMBRIA-4 5/16"		
Bedroom #3	N/A		

Comment

3. Wall Tile

	Selection	Grout	Describe
Main Bath			
Tub Deck Wall	N/A		
Shower Stall	N/A		
Bathtub Enclosure Walls	TILE-BF1312 FAN DARK GREY GLOSSY	WINTER SKY 45	3.5X3.25"
Master Ensuite Bathroom			
Tub Deck Wall	N/A		
Shower Stall	TILE-SUL1001 LATERN WHITE GLOSSY	TITANIUM 50	6.5X5.5"
Bathtub Enclosure Walls	N/A		
Kitchen Backsplash	QUARTZ-VIRGINA		
Backsplash Behind Fridge	N/A		

Comment

** Refer to Construction Summary

4. Misc

Water Line for Fridge

N/A

Interior Door Handles

AS PER CONSTRUCTION SPECS

Ceramic Bathroom Accessories

NO - UPGRADED MOEN 90 DEGREE

Comment

☐ Yes ☒ No

Purchaser: Alexandra Maria-Cristina URSO
 Telephone Res. / Bus: (905) 850-7836 /
 Decor Advisor: Candace Forza
 Lock Date: 10/2/2018 14:50:14

Const. No.: Unit 3, Level 23
 Municipal: 2703
 Suite Type: E771
 Project/Phase: Petaluma Building Corp./1

5. Plaster Mouldings and Medallions

Entrance Vestibule	N/A		Living Room	N/A	
Main Hall	N/A		Dining Room	N/A	
Kitchen/Breakfast	N/A		Den / Library /Study	N/A	
Laundry Room	N/A		Master BedRoom	N/A	
Main Bath	N/A		BedRoom #2	N/A	
Master Ensuite Bathroom	N/A		BedRoom #3	N/A	

Comment

** Refer to Construction Summary

6. Wall Paint

Entrance Vestibule	43 BIRCH WHITE	Living Room	43 BIRCH WHITE
Main Hall	43 BIRCH WHITE	Dining Room	43 BIRCH WHITE
Kitchen / Breakfast	43 BIRCH WHITE	Den/Library	N/A
Laundry Room	43 BIRCH WHITE	Master Bedroom	43 BIRCH WHITE
Main Bath	43 BIRCH WHITE	Bedroom #2	43 BIRCH WHITE
Master Ensuite	43 BIRCH WHITE	Bedroom #3	N/A
	N/A		

Comment

7. General Comments

** Refer to Construction Summary

Disclaimers and Notes

- Colours of all materials are as close as possible to builder's selection, but not necessarily identical due to variances in manufacturing.
- Any extras listed above are null and void unless accompanied by a separate invoice/amendment. Said invoice must be paid in full.
- The Purchaser agrees that this colour selection is final and that no changes will be permitted, unless required by the Vendor.
- The Purchaser acknowledges reading and accepting document which contains other miscellaneous disclaimers.

Signature:  aurso Date: 05/18/19 Signature: _____ Date: _____

90°™

Traditional | Transitional | Modern

Geometric forms, squared corners and straight lines create an urban focal point for today's contemporary baths.

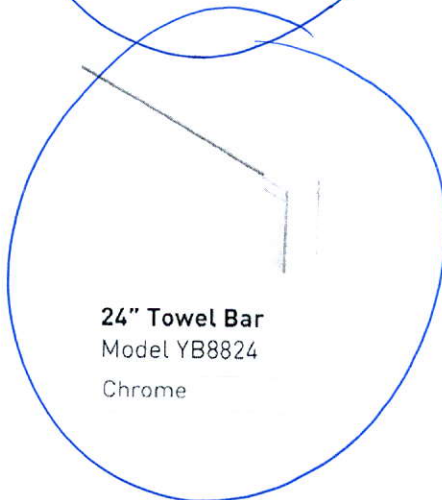
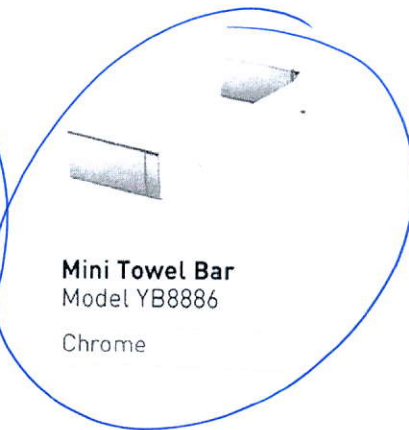
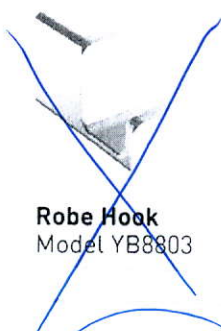

FINISH OPTIONS:

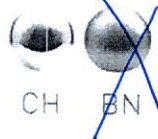

To order, combine the model number with one of these finish letter(s):
Chrome (CH), LifeShine® Brushed Nickel (BN).

90°™

Traditional | Transitional | Modern

Geometric forms, squared corners and straight lines create an urban focal point for today's contemporary baths.

Main Bathroom

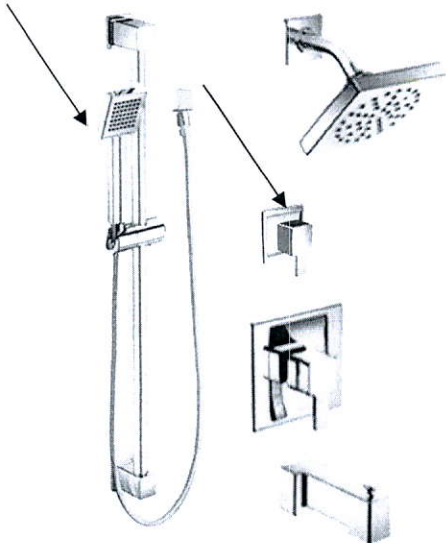

Posi-Temp® Tub/Shower Faucet
Function Transfer Valve/Trim
Bar with Hand Shower *

with 3
and Slide

Posi-Temp® Shower Only
with 3 Function Transfer Valve/Trim
Slide Bar with Hand Shower *

and

Model TS2713EP / 62380 –Standard /

Model TS2712EP / 62380 –Standard /

Upgrade 128284 / TS4172 / 3372
(Three Function transfer valve and trim)

Upgrade TS4172 / 3372
(Three Function transfer valve and trim)

S3879EP / A721 -> Slide bar and Drop ell

S3879EP / A721 -> Slide bar and Drop ell

FINISH OPTIONS:



C BN

To order, combine the model number with one of these finish letter(s):
LifeShine® Brushed Nickel (BN).
To order Chrome (C) model, use model number only.
* Please see vertical spa guide for installation #700106

with Transfer Valve

Geometric forms, squared corners and straight lines create an urban focal point for today's contemporary baths.

One-Wall Posi-Temp Used with 2- or 3-Function Transfer Valve

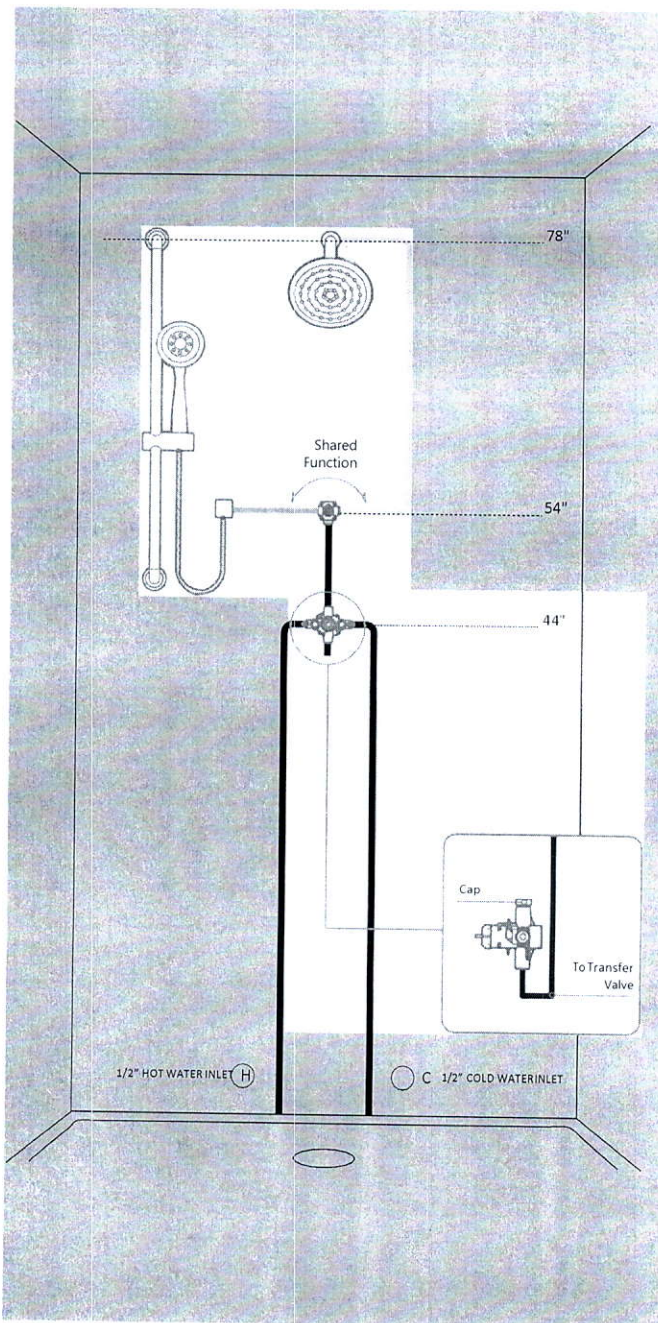

- * Use tub port to supply shower and plug shower port.
- * Primary showerhead.
- * Moen handshower comes with an integrated double check valve to prevent back-siphon.



Showerhead,
Arm and Flange



Handshower,
Drop Fill sold separately

Transfer Valve Trim



Valve Trim



Shower spa trim is compatible with the
M•PACT® Common Valve System.

with Transfer Valve

Geometric forms, squared corners and straight lines create an urban focal point for today's contemporary baths.

One-Wall Posi-Temp Used with 2- or 3-Function Transfer Valve and TubSpout

- TUBSPOUT:



NOTE: This configuration is intended for use with a diverter tubspout.

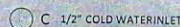

All vertical dimensions measured from the floor. Dimensions listed are suggested. Refer to specification sheet for critical dimensions for installation.

Product Specification Sheet

BLANCO QUATRUS R15 U 1 MEDIUM

Satin brushed finish

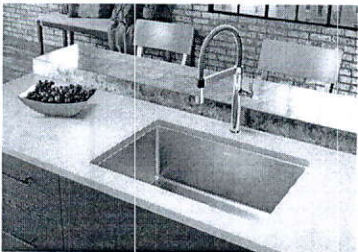

PRODUCT DIMENSIONS

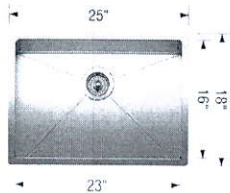

BLANCO QUATRUS R15 U 1 MEDIUM	Colour Finish	Model No.	FEATURES / SPECIFICATIONS
	Satin brushed finish	401517	<ul style="list-style-type: none">• German designed and engineered• Premium 304 series, 18 gauge stainless steel• 18/10 chrome-nickel content for exceptional lustre, durability and strength• Rear-positioned drain hole for maximum usable bowl and cabinet storage space• Compact size, X-pattern drain grooves• 15 mm radius corners for easy cleaning• 3 1/2" (90mm) stainless steel strainer included• Clips, template included• Limited Lifetime Warranty
DESIGN AND PLANNING TIPS			
Cabinet Size: 27" (685 mm) Bowl depth: 9" (230 mm) Depending on cabinet construction, a different cabinet size may be required. Consult the cabinet manufacturer.			

WARRANTY

Limited Lifetime warranty

Code/Standards Compliance

BLANCO sinks and faucets are third-party tested and certified to CSA, cUPC, ANSI/ASME and NSF standards and listed by applicable certification bodies. For more information on individual product listings, contact our office or listing organization.

BLANCO CANADA
100 Corporation Drive
Brampton, ON L6S 6B5

Tel: 905 494 2400
Fax: 905 494 2425
www.blancocanada.com

Toll Free: 1 877 425 2626
Toll Free: 1 877 825 2626

© 2016 BLANCO CANADA

SCHEDULE 'A'

330

RICHMOND

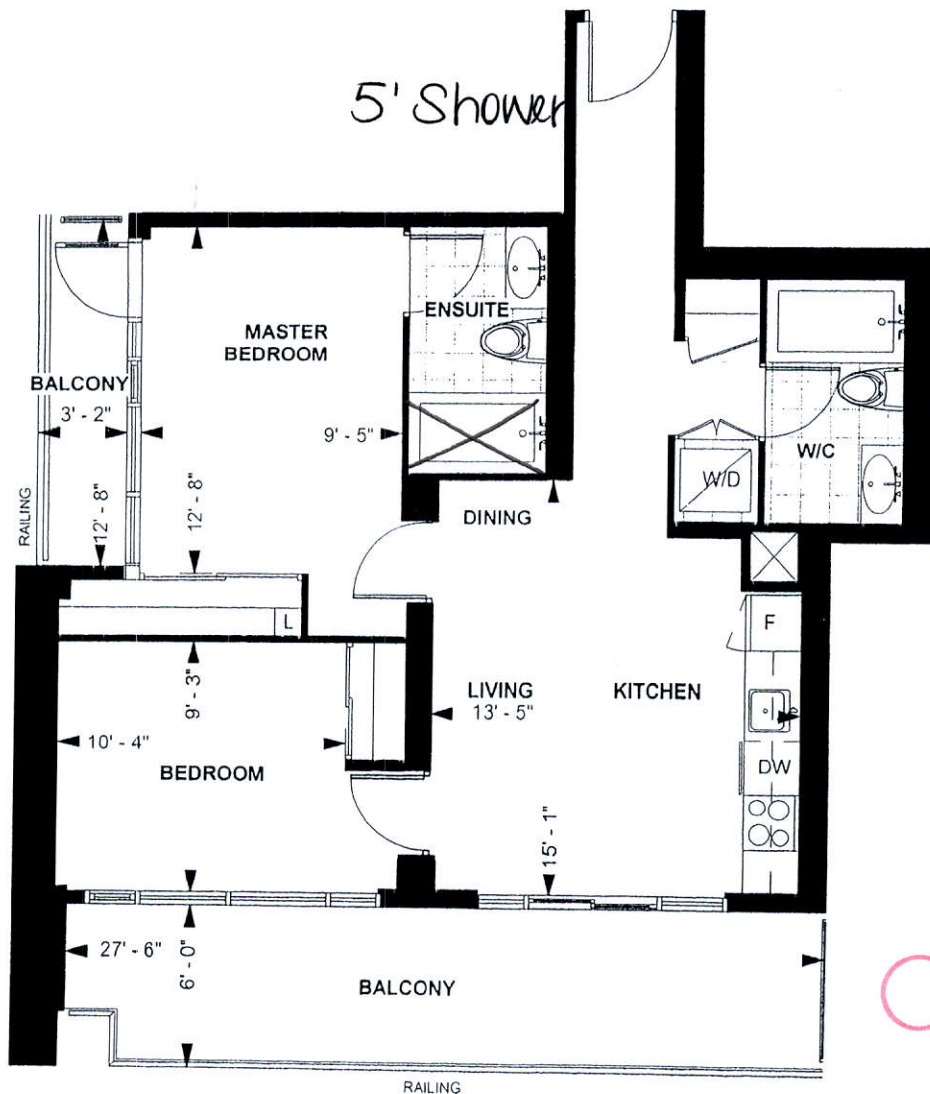

TOWER SUITE

E 771

9' 6" CEILING*

771 sq. ft.

2-BEDROOM

am

Purchaser Initials

03/12/16

Date

Unit No. ___ Level No. ___ Suite No. 771

Dimensions, specification, tile floor pattern and architectural detailing (including window size and location) are approximate and subject to modifications without notice. Orientation of suite may vary from the stated floor area.
*Ceiling height measured from top of floor slab to underside of slab above before finishes, and excluding bulkheads and required drop ceilings. E.&O.E.

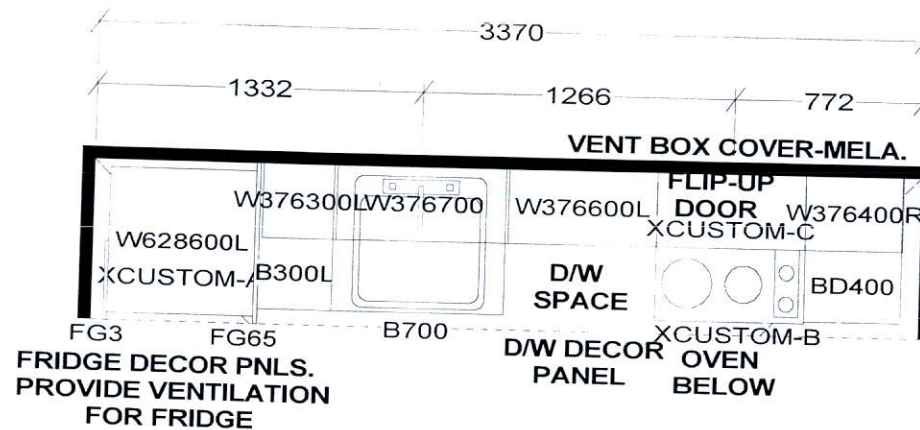

KITCHEN
 • Mission Cabinetry
 • 41" uppers
 • up.counter Edge

APPLIANCE PACKAGE:
 24" INTEGRATED FRIDGE W/ DECOR PNLS
 24" INTEGRATED DISHWASHER W/ DECOR PNL
 24" BUILT-IN OVEN
 24" COOKTOP
 24" MICROWAVE HOOD FAN

KITCHEN BASES & VANITIES INSTALLED
 WITH ADJUSTABLE LEGS

Selba Industries

W WIDTH _____ W HGHT _____ W CNT _____ FL HGHT _____ DWY H _____ ST CENT _____ 2X4 _____ VENT BOX COVER _____

TOWER SUITES:
 760MM HIGH UPPER CABINETS
 WHITE STEEL DRAWER BOXES
 COUNTERTOPS BY OTHERS
 VENT BOX COVERS
 CUSTOM VANITIES

This drawing is the intellectual property of
 SELBA INDUSTRIES INC. and is an
 original design which must not be released
 or copied unless applicable fee has been
 paid or job order placed.



JOB NUMBER:
BUILDER: GREENPARK
SITE NAME: PETALUMA
MODEL: 2 BEDROOM - E 771
LOT #:
DESIGNER: KS
DATE: JAN 8 18

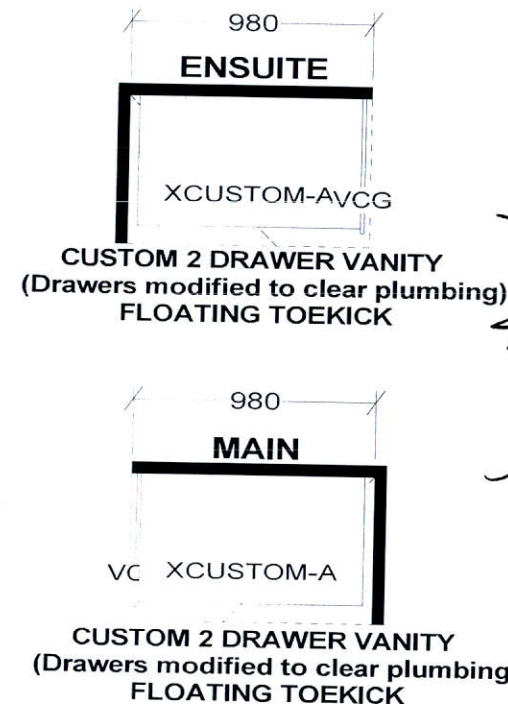

• Monaco
 Cabinetry
 • up.counter
 Edge