



CONSTRUCTION SUMMARY  
330 Richmond - Petaluma Building Corp.

PURCHASER: Aly K. LALANI  
TEL: RES.: 416-569-1571

Unit 10, Level 20 (2311-1)	Floor Plan C683		
----------------------------	--------------------	--	--

CABINETRY

1 - 41" UPPER CABINETS IN KITCHEN 22May19 Note:	
--	--

CONSTRUCTION

1 - SMOOTH CEILING IN BEDROOM 22May19 Note:	
--	--

HARDWOOD FLOORING

1 - UPGRADE 2 HARDWOOD THROUGHOUT IN LIEU OF STANDARD 22May19 Note:	
--	--

PLUMBING

1 - UPGRADE BATHROOM ACCESSORIES- MOEN 90 DEGREE CHROME TOILET PAPER HOLDER #YB8808 TOWEL RING #YB8886 24" TOWEL BAR # YB8824 22May19 Note:	
---	--

PROMOTIONAL

1 - PURCHASER FOREFITS REMAINDER OF UPGRADE CREDIT 22May19 Note:	
1 - LESS CREDIT FROM PURCHASERS EXTRA SHEET IN OFFER 22May19 Note:	

EXTRAS AS PER OFFER

The Vendor agrees that notwithstanding any other term or provision in this Agreement included in the Purchase Price and in addition to those items detailed in Schedule D to the Agreement of Purchase and Sale, the Purchaser is entitled to a credit of Fiv Worksheet Note:	
--	--

This Document is Extremely Time Sensitive - Printed 22 May 19 at 10:52

RECEIVED MAY 22 2019

Purchaser: Aly K. LALANI  
Telephone Res. / Bus: (416) 569-1571 /  
Decor Advisor: Natalie Mancuso  
Lock Date: 5/22/2019 10:49:31

Const. No.: Unit 10, Level 20  
Municipal: 2311  
Suite Type: C683  
Project/Phase: Petaluma Building Corp./1

Layout Changes: ☐ Yes ☐ No      Sketch Attached: ☒ Yes ☐ No      Exterior Colour Scheme:

1. Kitchen and Vanities

	Style and Colour	Counter	Hardware
Kitchen / Breakfast	SEE BELOW	QUARTZ- TORRONE- STRAIGHT POLISHED EDGE	STD
Main Bath	DORAL H3078 HACIENDA WHITE	QUARTZ- TORRONE- STRAIGHT POLISHED EDGE	STD
Master Ensuite Bathroom			

Appliances:      Built In Appliances ☒ Yes ☐ No      41" Upper Cabinets ☒ Yes ☐ No      Slide In Stove ☐ Yes ☒ No

Comment  
KITCHEN UPPER CABINETS- SENOSAN WHITE  
KITCHEN BASE CABINETS- DORAL H3078 HACIENDA WHITE

2. Flooring

		Grout-If App.	At a 45
Entrance Vestibule	HARDWOOD- MIRAGE 4 5/16 LOCK MAPLE CHARACTER- PEPPERMINT- CASHMERE		
Main Hall	HARDWOOD- MIRAGE 4 5/16 LOCK MAPLE CHARACTER- PEPPERMINT- CASHMERE		
Kitchen / Breakfast	HARDWOOD- MIRAGE 4 5/16 LOCK MAPLE CHARACTER- PEPPERMINT- CASHMERE		
Laundry Room	TILE- MATTE WHITE 8X8	STD	
Main Bath	TILE- LIFE SILVER 12X24	STD	
Master Ensuite Bathroom			
Living Room	HARDWOOD- MIRAGE 4 5/16 LOCK MAPLE CHARACTER- PEPPERMINT- CASHMERE		
Dining Room	HARDWOOD- MIRAGE 4 5/16 LOCK MAPLE CHARACTER- PEPPERMINT- CASHMERE		
Den / Library / Study	HARDWOOD- MIRAGE 4 5/16 LOCK MAPLE CHARACTER- PEPPERMINT- CASHMERE		
Master Bedroom	HARDWOOD- MIRAGE 4 5/16 LOCK MAPLE CHARACTER- PEPPERMINT- CASHMERE		
Bedroom #2			
Bedroom #3			

Comment

3. Wall Tile

	Selection	Grout	Describe
Main Bath			
Tub Deck Wall			
Shower Stall			
Bathtub Enclosure Walls	TILE- GLOSSY WHITE 3X6	STD	
Master Ensuite Bathroom			
Tub Deck Wall			
Shower Stall			
Bathtub Enclosure Walls			
Kitchen Backsplash	PAINTED GLASS BM#OC-16		
Backsplash Behind Fridge			

Comment  
\*\* Refer to Construction Summary

4. Misc

Water Line for Fridge      NO  
Interior Door Handles      STANDARD  
Ceramic Bathroom Accessories      UPGRADE MOEN 90 DEGREE CHROME      ☒ Yes      ☐ No

Comment



Initial: \_\_\_\_\_



Purchaser: Aly K. LALANI  
Telephone Res. / Bus: (416) 569-1571 /  
Decor Advisor: Natalie Mancuso  
Lock Date: 5/22/2019 10:49:31

Const. No.: Unit 10, Level 20  
Municipal: 2311  
Suite Type: C683  
Project/Phase: Petaluma Building Corp./1

5. Plaster Mouldings and Medallions

Entrance Vestibule			Living Room		
Main Hall			Dining Room		
Kitchen/Breakfast			Den / Library /Study		
Laundry Room			Master BedRoom		
Main Bath			BedRoom #2		
Master Ensuite Bathroom			BedRoom #3		

Comment

\*\* Refer to Construction Summary

6. Wall Paint

Entrance Vestibule	BIRCH WHITE	Living Room	BIRCH WHITE
Main Hall	BIRCH WHITE	Dining Room	BIRCH WHITE
Kitchen / Breakfast	BIRCH WHITE	Den/Library	Birch white
Laundry Room	BIRCH WHITE	Master Bedroom	BIRCH WHITE
Main Bath	BIRCH WHITE	Bedroom #2	
Master Ensuite		Bedroom #3	

Comment

7. General Comments

\*\* Refer to Construction Summary

Disclaimers and Notes

- Colours of all materials are as close as possible to builder's selection, but not necessarily identical due to variances in manufacturing.
- Any extras listed above are null and void unless accompanied by a separate invoice/amendment. Said invoice must be paid in full.
- The Purchaser agrees that this colour selection is final and that no changes will be permitted, unless required by the Vendor.
- The Purchaser acknowledges reading and accepting document which contains other miscellaneous disclaimers.

Signature: \_\_\_\_\_ Date: May 22/19 Signature: \_\_\_\_\_ Date: \_\_\_\_\_

Initial:

# 90°™

Traditional | Transitional | Modern

*Geometric forms, squared corners and straight lines create an urban focal point for today's contemporary baths*



**Toilet Tank Lever**  
Model YB8801

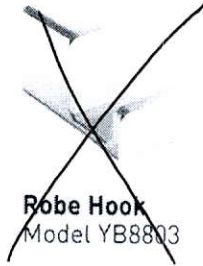

**Robe Hook**  
Model YB8803

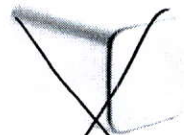

**Cabinet Knob**  
Model YB8805

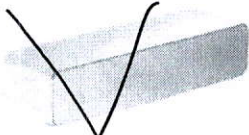

**Drawer Pull**  
Model YB8807

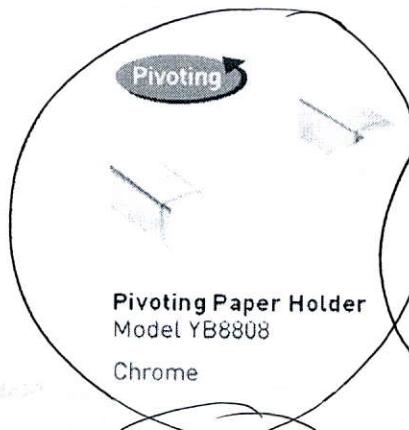

**Pivoting Paper Holder**  
Model YB8808  
Chrome

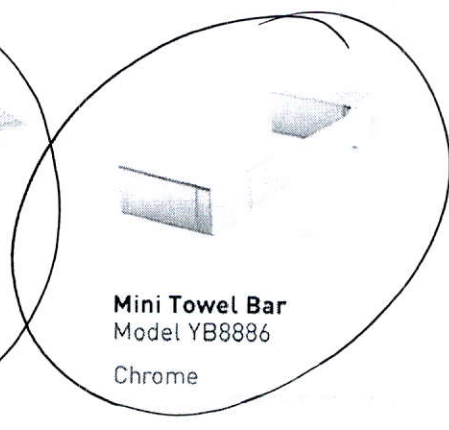

**Mini Towel Bar**  
Model YB8886  
Chrome

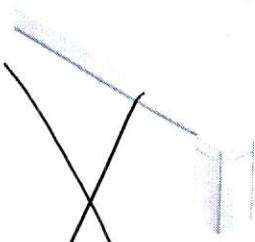

**18" Towel Bar**  
Model YB8818



**24" Towel Bar**  
Model YB8824  
Chrome



**Designer Grab Bar**  
Models: Chrome Other

## FINISH OPTIONS:

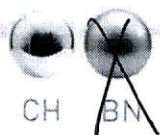

To order, combine the model number with one of these finish letter(s):  
Chrome (CH), LifeShine® Brushed Nickel (BN).

# SCHEDULE 'A'

## 330

RICHMOND

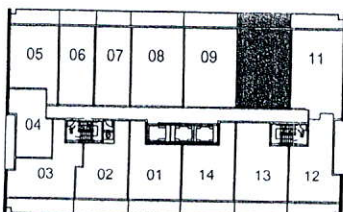
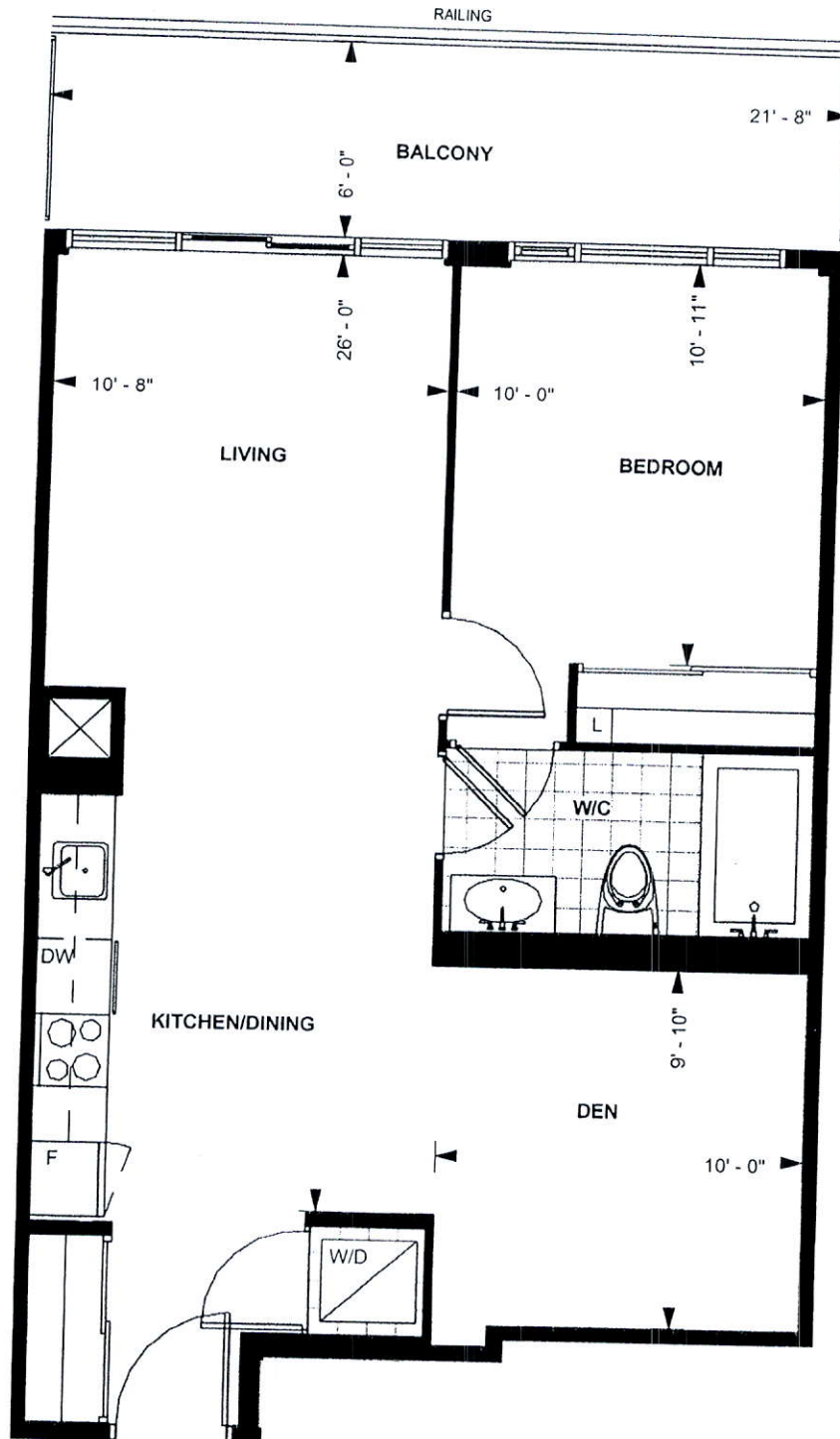

LEVEL 13-20

TOWER SUITE

**C 683**

**9' CEILING \***

683 sq. ft.

**1-BEDROOM PLUS DEN**

Purchaser Initials Purchaser Initials

Date

Unit No. 10 Level No. 20 Suite No. 2311

Dimensions, specification, tile floor pattern and architectural detailing (including window size and location) are approximate and subject to modifications without notice. Orientation of suite may vary from the stated floor area.

\*Ceiling height measured from top of floor slab to underside of slab above before finishes, and excluding bulkheads and required drop ceilings. E.&O.E.



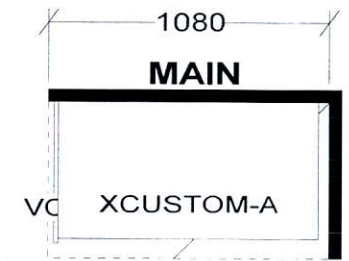
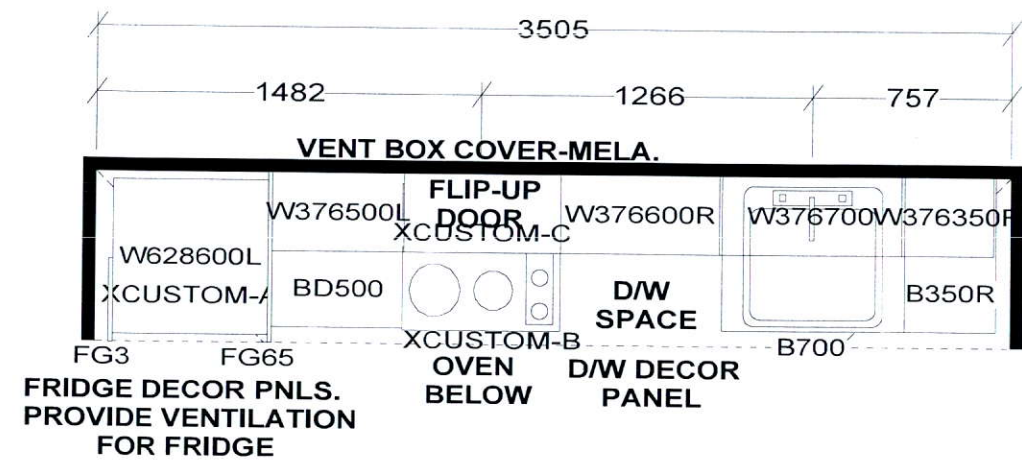

**KITCHEN**  
- 41" uppers

KITCHEN BASES & VANITIES INSTALLED  
WITH ADJUSTABLE LEGS

**CUSTOM 2 DRAWER VANITY**  
(Drawers modified to clear plumbing)  
FLOATING TOEKICK

- APPLIANCE PACKAGE:**  
24" INTEGRATED FRIDGE W/ DECOR PNLS  
24" INTEGRATED DISHWASHER W/ DECOR PNL  
24" BUILT-IN OVEN  
24" COOKTOP  
24" MICROWAVE HOOD FAN

*S e l b a I n d u s t r i e s*

/ WIDTH	W HGHT	W CNT	FL HGHT	DWY H	ST CENT	2X4	VENT BOX COVER
TOWER SUITES: 760MM HIGH UPPER CABINETS WHITE STEEL DRAWER BOXES COUNTERTOPS BY OTHERS VENT BOX COVERS CUSTOM VANITIES				This drawing is the intellectual property of SELBA INDUSTRIES INC. and is an original design which must not be released or copied unless applicable fee has been paid or job order placed.		JOB NUMBER: BUILDER: GREENPARK SITE NAME: PETALUMA MODEL: 1 BEDROOM + DEN - C 683, C 702 LOT #: DESIGNER: KS DATE: JAN 8 18	

