



CONSTRUCTION SUMMARY

330 Richmond - Petaluma Building Corp.

PURCHASERS: Ajair S. GILL and Parminder GILL// 2516744 ONTARIO INC. Aj

TEL: RES.: 905-956-2828 BUS.: 905-625-8452

Unit 7, Level 16 (1908-1)

Floor Plan  
B493

CABINETRY

1 - 41" UPPER CABINETS IN KITCHEN

09May19 Note:

CERAMIC TILE

1 - UPGRADE 3 FLOOR AND WALL TILES IN BATHROOM - INCLUDING LAUNDRY FLOOR AREA

09May19 Note:

1 - UPGRADE 2 MOSAICS ON SHOWER FLOOR IN LIEU OF STANDARD

09May19 Note:

CONSTRUCTION

1 - SMOOTH CEILING IN BEDROOM

09May19 Note:

1 - MAIN BATH - 5 FOOT SHOWER [REDACTED] IN LIEU OF TUB

27Mar18 Note:

COUNTER TOP

1 - UPGRADE COUNTERTOP EDGE IN KITCHEN AND BATHROOM

09May19 Note:

HARDWOOD FLOORING

1 - UPGRADE 2 HARDWOOD THROUGHOUT

09May19 Note:

MIRRORS AND GLASS

1 - FRAMELESS GLASS SHOWER DOOR WITH PANEL- 5FT SHOWER

09May19 Note:

MISCELLANEOUS

1 - TOTAL FOR ABOVE ITEMS

09May19 Note:

PLUMBING

1 - UPGRADE BATHROOM ACCESSORIES- MOEN 90 DEGREE

TOILET PAPER HOLDER #YB8808

TOWEL RING #YB8886

24" TOWEL BAR #YB8824

09May19 Note:

PROMOTIONAL

1 - LESS CREDIT FROM PURCHASERS EXTRA SHEET IN OFFER

09May19 Note:

1 - PARTIAL REDEMPTION OF PROMOTIONAL PACKAGE \$2,800.00 BALANCE (\$2,200.00) FORWARD TO BE USED AT A LATER DATE. ORIGINAL PROMOTIONAL PACKAGE OF \$5,000.00 AS PER SCHEDULE PE.

27Mar18 Note:

RECEIVED MAY 10 2019

<div>CONSTRUCTION SUMMARY</div> <div>330 Richmond - Petaluma Building Corp.</div> <div>PURCHASERS: Ajair S. GILL and Parminder GILL// 2516744 ONTARIO INC. AjTEL: RES.: 905-956-2828 BUS.: 905-625-8452</div>			
Unit 7, Level 16 (1908-1)	Floor Plan B493		

EXTRAS AS PER OFFER

The Vendor agrees that notwithstanding any other term or provision in this Agreement included in the Purchase Price and in addition to those items detailed in Schedule D to the Agreement of Purchase and Sale, the Purchaser is entitled to a credit of Fiv <i>Worksheet</i> Note:	
The Vendor agrees that notwithstanding any other term or provision in this Agreement included in the Purchase Price and in addition to those items detailed in Schedule D to the Agreement of Purchase and Sale, the Purchaser is entitled to a credit of Five <i>Worksheet</i> Note:	

This Document is Extremely Time Sensitive - Printed 9 May 19 at 14:09



Purchasers: Ajair S. GILL & Parminder GILL// 2516744 ONTAF

Const. No.: Unit 7, Level 16

Telephone Res. / Bus: (905) 956-2828 / (905) 625-8452

Municipal: 1908

Decor Advisor: Natalie Mancuso

Suite Type: B493

Lock Date: 5/9/2019 14:07:25

Project/Phase: Petaluma Building Corp./1

Layout Changes: ☒ Yes ☐ No

Sketch Attached: ☒ Yes ☐ No

Exterior Colour Scheme:

1. Kitchen and Vanities

	Style and Colour	Counter	Hardware
Kitchen / Breakfast	SEE BELOW	QUARTZ- TORRONE- #360 EDGE	STD
Main Bath	DORAL H3078 HACIENDA WHITE	QUARTZ- TORRONE- #360 EDGE	STD
Master Ensuite Bathroom			

Appliances:

Built In Appliances ☒ Yes ☐ No

41" Upper Cabinets ☒ Yes ☐ No

Slide In Stove ☐ Yes ☒ No

Comment

KITCHEN UPPER CABINETS- SENOSAN WHITE

KITCHEN BASE CABINETS- DORAL H3078 HACIENDA WHITE

2. Flooring

		Grout-If App.	At a 45
Entrance Vestibule	HARDWOOD-MIRAGE 4 5/16 LOCK- MAPLE CHARACTER- GELATO- DURAMATT		<input type="checkbox"/>
Main Hall	HARDWOOD-MIRAGE 4 5/16 LOCK- MAPLE CHARACTER- GELATO- DURAMATT		<input type="checkbox"/>
Kitchen / Breakfast	HARDWOOD-MIRAGE 4 5/16 LOCK- MAPLE CHARACTER- GELATO- DURAMATT		<input type="checkbox"/>
Laundry Room	TILE- RMD CALACATTA BRILL 10X30	STD	<input type="checkbox"/>
Main Bath	TILE- RMD CALACATTA BRILL 10X30	STD	<input type="checkbox"/>
Master Ensuite Bathroom			<input type="checkbox"/>
			<input type="checkbox"/>
Living Room	HARDWOOD-MIRAGE 4 5/16 LOCK- MAPLE CHARACTER- GELATO- DURAMATT		<input type="checkbox"/>
Dining Room	HARDWOOD-MIRAGE 4 5/16 LOCK- MAPLE CHARACTER- GELATO- DURAMATT		<input type="checkbox"/>
Den / Library / Study			<input type="checkbox"/>
Master Bedroom	HARDWOOD-MIRAGE 4 5/16 LOCK- MAPLE CHARACTER- GELATO- DURAMATT		<input type="checkbox"/>
Bedroom #2			<input type="checkbox"/>
Bedroom #3			<input type="checkbox"/>
			<input type="checkbox"/>

Comment

SHOWER FLOOR MOSAICS- BIANCO HEX.POL.- MB067B1-P 12X12

3. Wall Tile

	Selection	Grout	Describe
Main Bath			
Tub Deck Wall			
Shower Stall	TILE- RMD CALACATTA BRILL 10X30	STD	
Bathtub Enclosure Walls			
Master Ensuite Bathroom			
Tub Deck Wall			
Shower Stall			
Bathtub Enclosure Walls			
Kitchen Backsplash	PAINTED GLASS-BM#OC-16		
Backsplash Behind Fridge			

Comment

SHOWER FLOOR MOSAICS- BIANCO HEX.POL.- MB067B1-P 12X12

4. Misc

Water Line for Fridge

NO

Interior Door Handles

STANDARD

Ceramic Bathroom Accessories

DO NOT INSTALL

☐ Yes ☒ No

Comment



Purchasers: Ajair S. GILL & Parminder GILL// 2516744 ONTAF

Const. No.: Unit 7, Level 16

Telephone Res. / Bus: (905) 956-2828 / (905) 625-8452

Municipal: 1908

Decor Advisor: Natalie Mancuso

Suite Type: B493

Lock Date: 5/9/2019 14:07:25

Project/Phase: Petaluma Building Corp./1

5. Plaster Mouldings and Medallions

Entrance Vestibule			Living Room		
Main Hall			Dining Room		
Kitchen/Breakfast			Den / Library /Study		
Laundry Room			Master BedRoom		
Main Bath			BedRoom #2		
Master Ensuite Bathroom			BedRoom #3		

Comment

\*\* Refer to Construction Summary

6. Wall Paint

Entrance Vestibule	BIRCH WHITE	Living Room	BIRCH WHITE
Main Hall	BIRCH WHITE	Dining Room	BIRCH WHITE
Kitchen / Breakfast	BIRCH WHITE	Den/Library	
Laundry Room	BIRCH WHITE	Master Bedroom	BIRCH WHITE
Main Bath	BIRCH WHITE	Bedroom #2	
Master Ensuite		Bedroom #3	

Comment

7. General Comments

\*\* Refer to Construction Summary

Disclaimers and Notes

- 1) Colours of all materials are as close as possible to builder's selection, but not necessarily identical due to variances in manufacturing.

2) Any extras listed above are null and void unless accompanied by a separate invoice/amendment. Said invoice must be paid in full.

3) The Purchaser agrees that this colour selection is final and that no changes will be permitted, unless required by the Vendor.

4) The Purchaser acknowledges reading and accepting document which contains other miscellaneous disclaimers.

Signature: Ajair S Gill Date: 9 May 2015

Signature: \_\_\_\_\_ Date: \_\_\_\_\_

Signature: \_\_\_\_\_ Date: \_\_\_\_\_

Initials: JS

Page 2 of 2

# 90°™

Traditional | Transitional | Modern

*Geometric forms, squared corners and straight lines create an urban focal point for today's contemporary baths.*



**Toilet Tank Lever**  
Model YB8801



**Robe Hook**  
Model YB8803

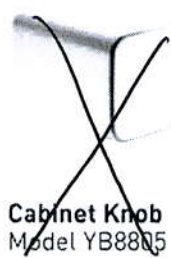

**Cabinet Knob**  
Model YB8805

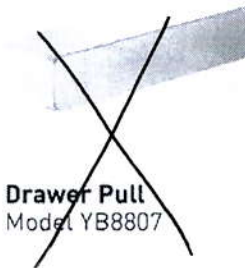

**Drawer Pull**  
Model YB8807

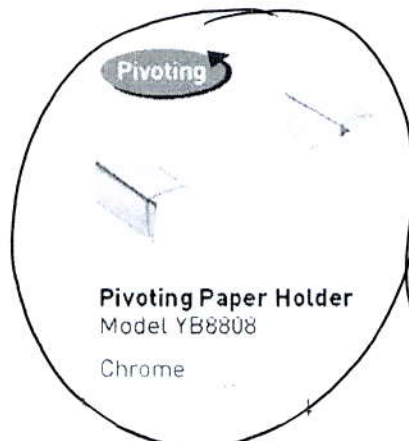

**Pivoting Paper Holder**  
Model YB8808  
Chrome



**Mini Towel Bar**  
Model YB8886  
Chrome



**18" Towel Bar**  
Model YB8818

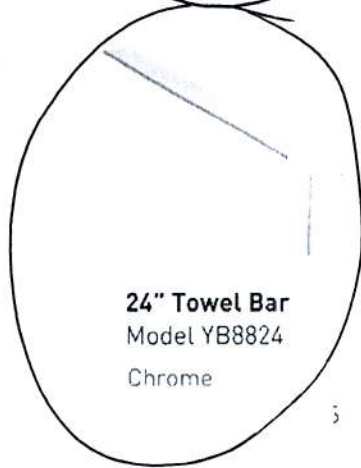

**24" Towel Bar**  
Model YB8824  
Chrome

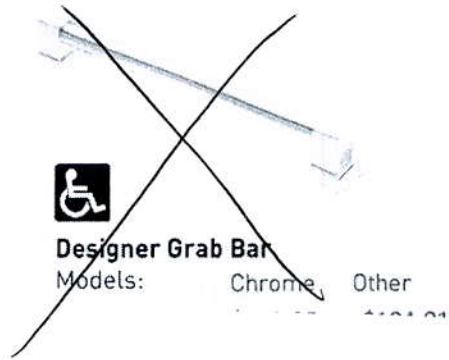

**Designer Grab Bar**  
Models: Chrome, Other

## FINISH OPTIONS:

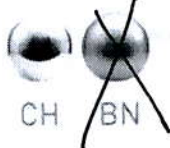

CH BN

To order, combine the model number with one of these finish letter(s):  
Chrome (CH), LifeShine® Brushed Nickel (BN).

# SCHEDULE 'A'

**330**  
RICHMOND

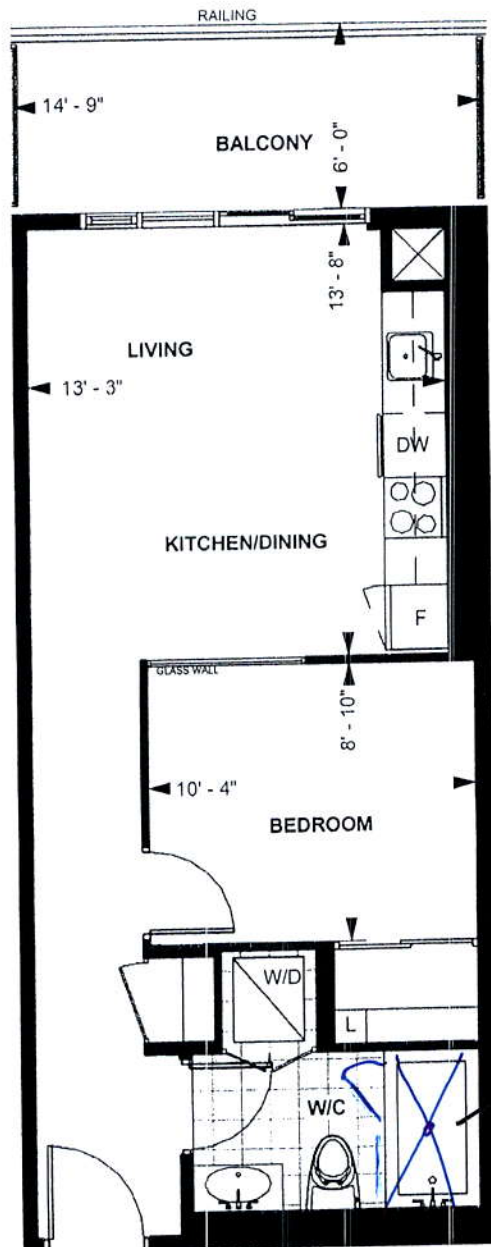

*shower with  
Frameless Door*

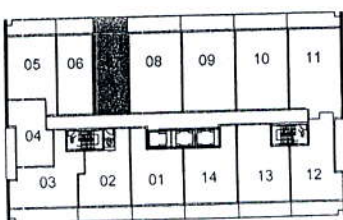

LEVEL 13-20

**TOWER SUITE  
B 493**

**9' CEILING \***

493 sq. ft.  
**1-BEDROOM**

Purchaser Initials *AS* Purchaser Initials *Jan 23/16*

Date

Unit No. 7 Level No. 16 Suite No. 1908

Dimensions, specification, tile floor pattern and architectural detailing (including window size and location) are approximate and subject to modifications without notice. Orientation of suite may vary from the stated floor area.  
\*Ceiling height measured from top of floor slab to underside of slab above before finishes, and excluding bulkheads and required drop ceilings. E.&O.E.



\*Upgrade Countertop Edge in Kitchen + Bath

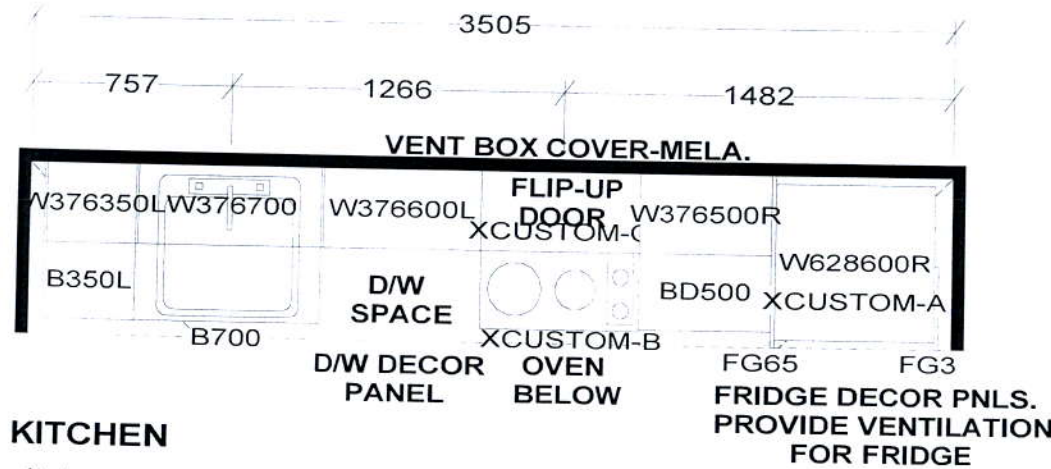

KITCHEN

41" uppers

KITCHEN BASES & VANITIES INSTALLED WITH ADJUSTABLE LEGS

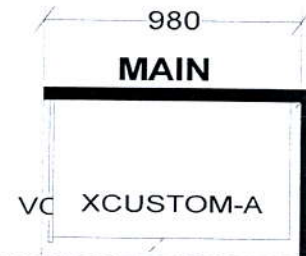

CUSTOM 2 DRAWER VANITY  
(Drawers modified to clear plumbing)  
FLOATING TOEKICK

APPLIANCE PACKAGE:  
24" INTEGRATED FRIDGE W/ DECOR PNLS  
24" INTEGRATED DISHWASHER W/ DECOR PNL  
24" BUILT-IN OVEN  
24" COOKTOP  
24" MICROWAVE HOOD FAN

*Selba Industries*

WIDTH	W	HGHT	W	CNT	FL	HGHT	DWY	H	ST	CENT	2X4	VENT BOX COVER
TOWER SUITES: 760MM HIGH UPPER CABINETS WHITE STEEL DRAWER BOXES COUNTERTOPS BY OTHERS VENT BOX COVERS CUSTOM VANITIES					This drawing is the intellectual property of SELBA INDUSTRIES INC. and is an original design which must not be released or copied unless applicable fee has been paid or job order placed.							
										JOB NUMBER: BUILDER: GREENPARK SITE NAME: PETALUMA MODEL: 1 BEDROOM-B 463, B 493, B 610 LOT #: DESIGNER: KS DATE: JAN 8 18		