

CONSTRUCTION SUMMARY
330 Richmond - Petaluma Building Corp.

PURCHASER: Dar'ya GONCHAROVA		TEL:	
Unit 8, Level 18 (2109-1)	Floor Plan E698		

CABINETRY

1 - KITCHEN - 41" UPPER CABINETRY 30Apr19 Note:	
----------------------------------------------------	--

CERAMIC TILE

1 - BATHROOMS - DELETE STANDARD WHITE CERAMIC ACCESSORIES - DO NOT INSTALL SOAP DISH, TOWEL BAR OR TISSUE HOLDER 30Apr19 Note:	
-----------------------------------------------------------------------------------------------------------------------------------	--

CONSTRUCTION

2 - BEDROOMS - SMOOTH CEILINGS 30Apr19 Note:	
-------------------------------------------------	--

COUNTER TOP

2 - BATHROOMS - UPGRADED EDGE ON COUNTERTOP 30Apr19 Note:	
1 - KITCHEN - UPGRADED EDGE ON COUNTERTOP 30Apr19 Note:	

MIRRORS AND GLASS

1 - FOYER - FRAMELESS MIRROR SLIDING CLOSET DOORS WITH MIRROR FASCIA 30Apr19 Note:	
---------------------------------------------------------------------------------------	--

MISCELLANEOUS

1 - COLOUR CHANGE ADMINISTRATION FEE 30Apr19 Note:	
-------------------------------------------------------	--

PLUMBING

2 - BATHROOMS - MOEN 90 DEGREE BATHROOM ACCESSORIES - CHROME TOILET PAPER HOLDER #YB8808 TOWEL RING #YB8886 TOWEL BAR #YB8824 30Apr19 Note:	
---------------------------------------------------------------------------------------------------------------------------------------------------------	--

PROMOTIONAL

1 - LESS CREDIT FROM PURCHASERS EXTRAS 30Apr19 Note:	
---------------------------------------------------------	--

EXTRAS AS PER OFFER

The Vendor agrees that notwithstanding any other term or provision in this Agreement included in the Purchase Price and in addition to those items detailed in Schedule D to the Agreement of Purchase and Sale, the Purchaser is entitled to a credit of Fiv Worksheet Note:	
1 Parking Unit Worksheet Note:	

Purchaser: Dar'ya GONCHAROVA
Telephone Res. / Bus: /
Decor Advisor: Candace Forza
Lock Date: 4/30/2019 15:14:28

Const. No.: Unit 8, Level 18
Municipal: 2109
Suite Type: E698
Project/Phase: Petaluma Building Corp./1

Layout Changes: ☐ Yes ☒ No Sketch Attached: ☒ Yes ☐ No Exterior Colour Scheme:

1. Kitchen and Vanities

	Style and Colour	Counter	Hardware
Kitchen / Breakfast	SEE BELOW	QUARTZ-TORRONE-#360 EDGE	STD
Main Bath	DORAL 1267-SAND MOLINA ASH	QUARTZ-TORRONE-#360 EDGE	STD
Master Ensuite Bathroom	DORAL 1267-SAND MOLINA ASH	QUARTZ-TORRONE-#360 EDGE	STD

Appliances: Built In Appliances ☒ Yes ☐ No 41" Upper Cabinets ☒ Yes ☐ No Slide In Stove ☐ Yes ☒ No

Comment
KITCHEN CABINETRY - BASE-DORAL 1267-SAND MOLINA ASH *** UPPERS-SENOSAN WHITE

2. Flooring

		Grout-If App.	At a 45
Entrance Vestibule	STRIP-MIRAGE LOCK-RED OAK-CASHMERE-RIO-4 5/16"		<input type="checkbox"/>
Main Hall	STRIP-MIRAGE LOCK-RED OAK-CASHMERE-RIO-4 5/16"		<input type="checkbox"/>
Kitchen / Breakfast	STRIP-MIRAGE LOCK-RED OAK-CASHMERE-RIO-4 5/16"		<input type="checkbox"/>
Laundry Room	TILE-WHITE-8X8		<input type="checkbox"/>
Main Bath	TILE-ASPEN BIANCO-12X24	STANDARD	<input type="checkbox"/>
Master Ensuite Bathroom	TILE-ASPEN BIANCO-12X24	STANDARD	<input type="checkbox"/>
	N/A	STANDARD	<input type="checkbox"/>
Living Room	STRIP-MIRAGE LOCK-RED OAK-CASHMERE-RIO-4 5/16"		<input type="checkbox"/>
Dining Room	STRIP-MIRAGE LOCK-RED OAK-CASHMERE-RIO-4 5/16"		<input type="checkbox"/>
Den / Library / Study	N/A		<input type="checkbox"/>
Master Bedroom	STRIP-MIRAGE LOCK-RED OAK-CASHMERE-RIO-4 5/16"		<input type="checkbox"/>
Bedroom #2	STRIP-MIRAGE LOCK-RED OAK-CASHMERE-RIO-4 5/16"		<input type="checkbox"/>
Bedroom #3	N/A		<input type="checkbox"/>
			<input type="checkbox"/>

Comment

3. Wall Tile

	Selection	Grout	Describe
Main Bath			
Tub Deck Wall	N/A		
Shower Stall	TILE-GLOSSY WHITE-3X6	STANDARD	
Bathtub Enclosure Walls	N/A		
Master Ensuite Bathroom			
Tub Deck Wall	N/A		
Shower Stall	N/A		
Bathtub Enclosure Walls	TILE-GLOSSY WHITE-3X6	STANDARD	
Kitchen Backsplash	BACK PAINTED GLASS-BM-OC-16	STANDARD	
Backsplash Behind Fridge	N/A		

Comment
** Refer to Construction Summary

4. Misc

Water Line for Fridge	N/A
Interior Door Handles	AS PER CONSTRUCTION SPECS
Ceramic Bathroom Accessories	NO - UPGRADED - MOEN 90 DEGREE
	<input type="radio"/> Yes <input checked="" type="radio"/> No

Comment

Purchaser: Dar'ya GONCHAROVA
Telephone Res. / Bus: /
Decor Advisor: Candace Forza
Lock Date: 4/30/2019 15:14:28

Const. No.: Unit 8, Level 18
Municipal: 2109
Suite Type: E698
Project/Phase: Petaluma Building Corp./1

5. Plaster Mouldings and Medallions

Entrance Vestibule	N/A		Living Room	N/A	
Main Hall	N/A		Dining Room	N/A	
Kitchen/Breakfast	N/A		Den / Library /Study	N/A	
Laundry Room	N/A		Master BedRoom	N/A	
Main Bath	N/A		BedRoom #2	N/A	
Master Ensuite Bathroom	N/A		BedRoom #3	N/A	

Comment

** Refer to Construction Summary

6. Wall Paint

Entrance Vestibule	43 - BIRCH WHITE	Living Room	43 - BIRCH WHITE
Main Hall	43 - BIRCH WHITE	Dining Room	43 - BIRCH WHITE
Kitchen / Breakfast	43 - BIRCH WHITE	Den/Library	N/A
Laundry Room	43 - BIRCH WHITE	Master Bedroom	43 - BIRCH WHITE
Main Bath	43 - BIRCH WHITE	Bedroom #2	43 - BIRCH WHITE
Master Ensuite	43 - BIRCH WHITE	Bedroom #3	N/A
	N/A		

Comment

7. General Comments

** Refer to Construction Summary

Disclaimers and Notes

- Colours of all materials are as close as possible to builder's selection, but not necessarily identical due to variances in manufacturing.
- Any extras listed above are null and void unless accompanied by a separate invoice/amendment. Said invoice must be paid in full.
- The Purchaser agrees that this colour selection is final and that no changes will be permitted, unless required by the Vendor.
- The Purchaser acknowledges reading and accepting document which contains other miscellaneous disclaimers.

Signature:  Date: Apr. 30 2019 Signature: _____ Date: _____

90°™

Traditional | Transitional | Modern

Geometric forms, squared corners and straight lines create an urban focal point for today's contemporary baths.



Toilet Tank Lever
Model YB8801

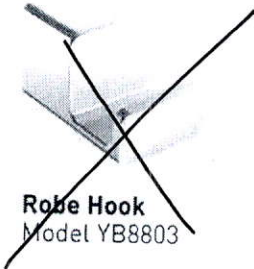

Robe Hook
Model YB8803



Cabinet Knob
Model YB8805

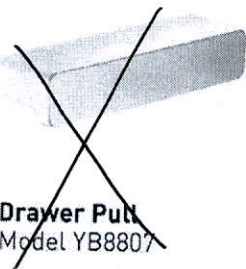

Drawer Pull
Model YB8807

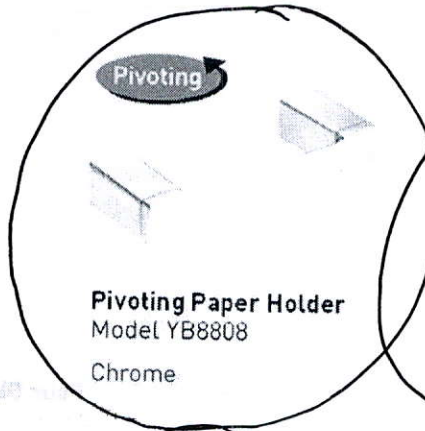

Pivoting Paper Holder
Model YB8808
Chrome

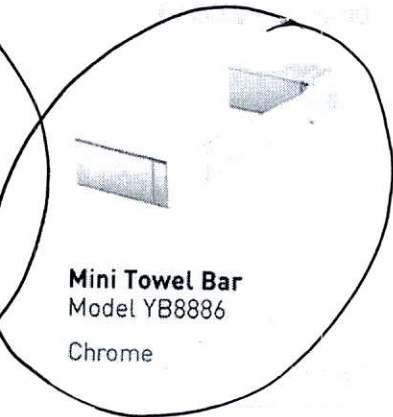

Mini Towel Bar
Model YB8886
Chrome

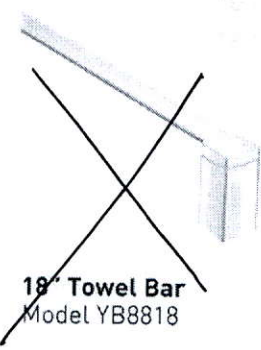

18" Towel Bar
Model YB8818



24" Towel Bar
Model YB8824
Chrome

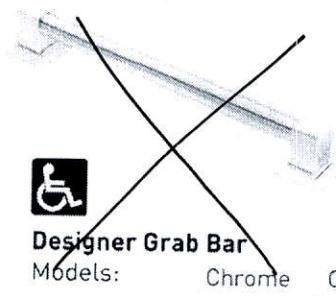

Designer Grab Bar
Models: Chrome Other

FINISH OPTIONS:

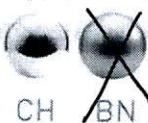

To order, combine the model number with one of these finish letter(s):
Chrome (CH), LifeShine® Brushed Nickel (BN).

SCHEDULE 'A'

330

RICHMOND

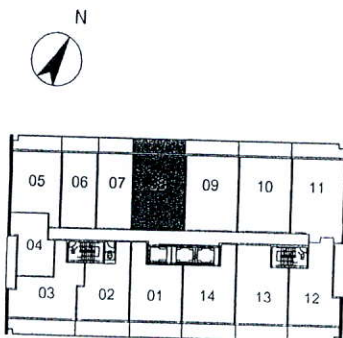
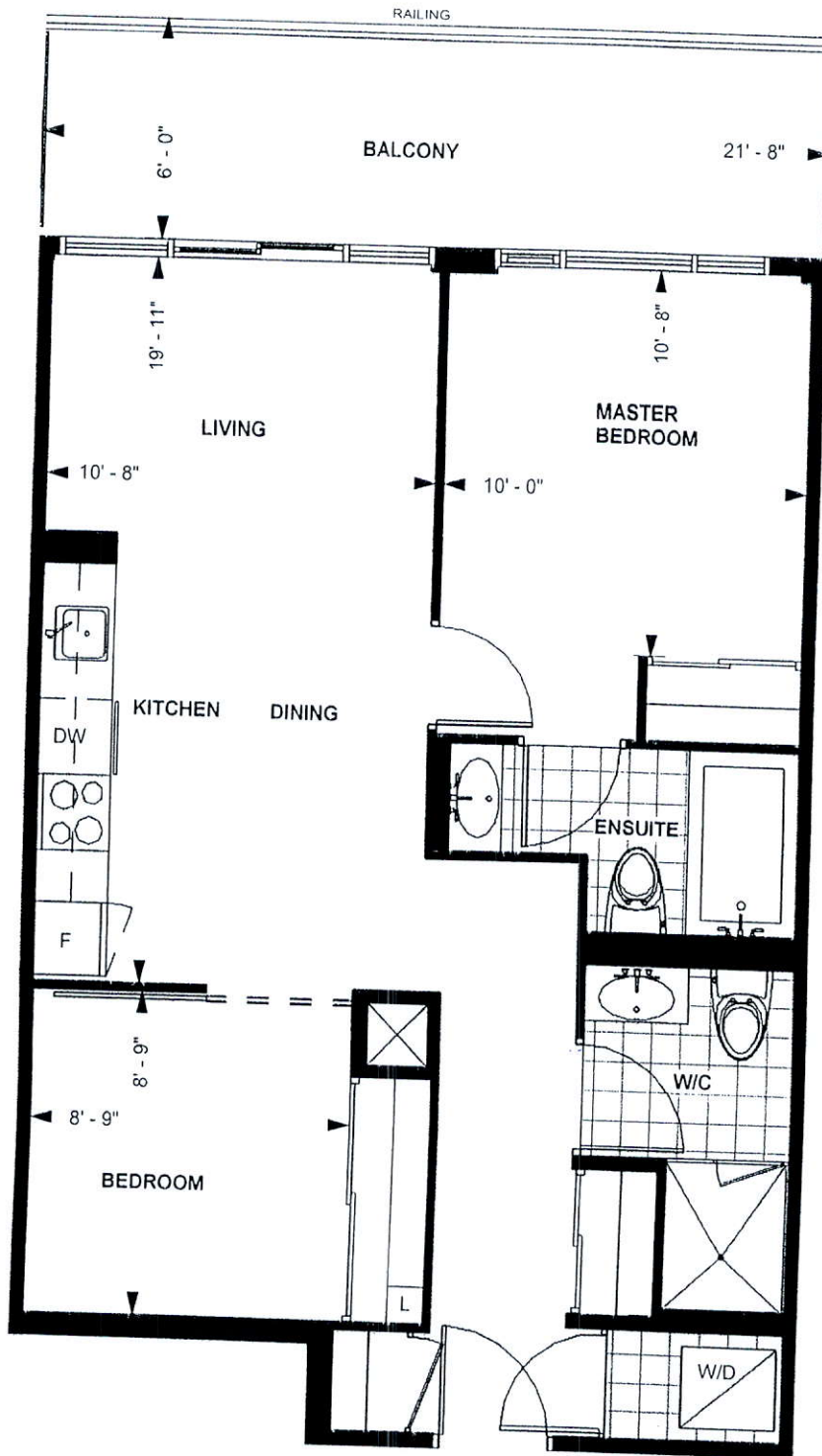

LEVEL 13-20

TOWER SUITE

E 698

9' CEILING *

698 sq. ft.

2-BEDROOM

DG

NOV 26, 2015

Purchaser Initials Purchaser Initials

Date

Unit No. 8 Level No. 18 Suite No. 2109

Dimensions, specification, tile floor pattern and architectural detailing (including window size and location) are approximate and subject to modifications without notice. Orientation of suite may vary from the stated floor area.

*Ceiling height measured from top of floor slab to underside of slab above before finishes, and excluding bulkheads and required drop ceilings. E.&O.E.

*Upgrade Countertop Edge for Kitchen + Baths

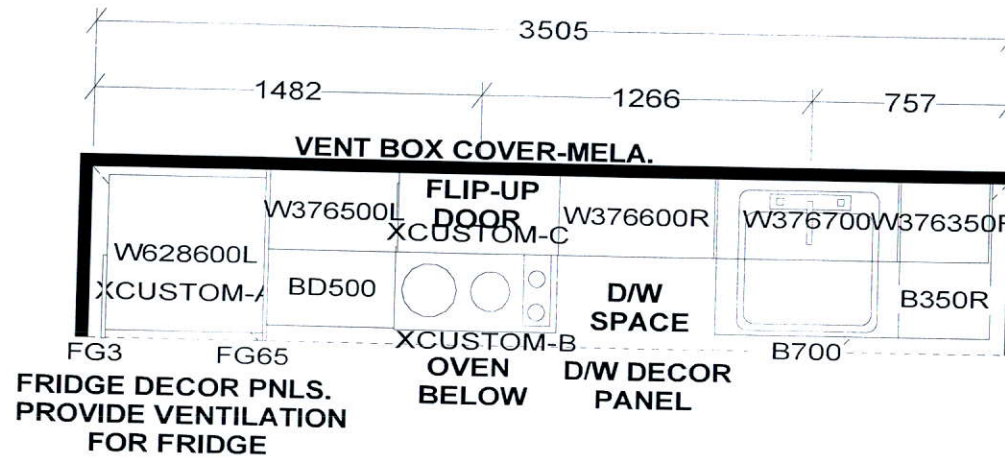

KITCHEN

41" Upper Cabinetry.

KITCHEN BASES & VANITIES INSTALLED WITH ADJUSTABLE LEGS

APPLIANCE PACKAGE:
24" INTEGRATED FRIDGE W/ DECOR PNLS
24" INTEGRATED DISHWASHER W/ DECOR PNL
24" BUILT-IN OVEN
24" COOKTOP
24" MICROWAVE HOOD FAN

Selba Industries

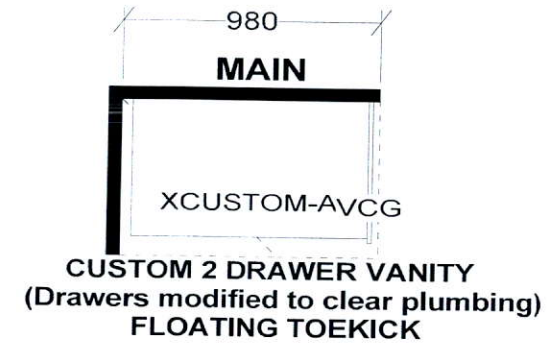
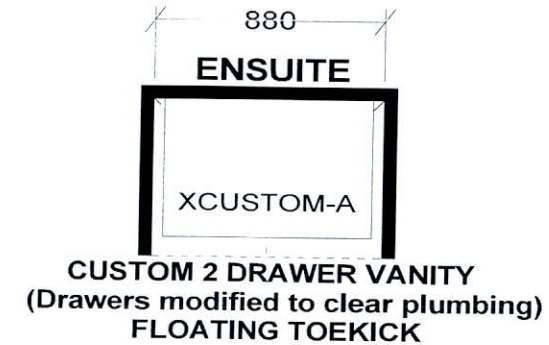

WDTH W HGHT W CNT FL HGHT DWY H ST CENT 2X4 VENT BOX COVER

TOWER SUITES:
760MM HIGH UPPER CABINETS
WHITE STEEL DRAWER BOXES
COUNTERTOPS BY OTHERS
VENT BOX COVERS
CUSTOM VANITIES

This drawing is the intellectual property of SELBA INDUSTRIES INC. and is an original design which must not be released or copied unless applicable fee has been paid or job order placed.



JOB NUMBER:
BUILDER: GREENPARK
SITE NAME: PETALUMA
MODEL: 2 BEDROOM - E 698
LOT #:
DESIGNER: KS
DATE: JAN 8 18

Frameless Mirror Sliding Door with Mirror Fascia - \$682

