

CONSTRUCTION SUMMARY

330 Richmond - Petaluma Building Corp.

PURCHASER: Saverio PATELLA

TEL: RES.: 905-265-8778 BUS.: 905-265-8860

Unit 3, Level 20 (2303-1)

Floor Plan
E771

CABINETRY

1 - KITCHEN - 41" UPPER CABINETRY

15Apr19 Note:

CERAMIC TILE

2 - ALL BATHROOMS - MOEN 90 DEGREE BATHROOM ACCESSORIES - CHROME

TOILET PAPER HOLDER #YB8808

TOWEL RING #YB8886

TOWEL BAR #YB8824

15Apr19 Note:

1 - ALL BATHROOMS - DELETE STANDARD WHITE CERAMIC ACCESSORIES - DO NOT INSTALL SOAP DISH, TOWEL RACK OR TISSUE HOLDER

15Apr19 Note:

CONSTRUCTION

2 - BEDROOMS - SMOOTH CEILING

15Apr19 Note:

1 - MAIN BATH - 5 FOOT SHOWER WITH SLIDING CHROME FRAMED GLASS DOORS IN LIEU OF TUB

23Apr18 Note:

COUNTER TOP

1 - KITCHEN - UPGRADED EDGE ON COUNTERTOP

15Apr19 Note:

MISCELLANEOUS

1 - COLOUR CHANGE ADMINISTRATION FEE

15Apr19 Note:

PROMOTIONAL

1 - LESS REMAINING BALANCE OF CREDIT FROM PURCHASERS EXTRA SHEET

15Apr19 Note:

1 - PARTIAL REDEPTION OF PROMOTIONAL PACKAGE \$2,800.00 BALANCE (\$2,200) FORWARD TO BE USED AT A LATER DATE. ORIGINAL PROMOTIONAL PACKAGE OF \$5,000 AS PER SCHEDULE PE DATED - OCTOBER 26, 2015

23Apr18 Note:

EXTRAS AS PER OFFER

The Vendor agrees that notwithstanding any other term or provision in this Agreement included in the Purchase Price and in addition to those items detailed in Schedule D to the Agreement of Purchase and Sale, the Purchaser is entitled to a credit of Fiv

Worksheet Note:

1 Parking Unit

Worksheet Note:

This Document is Extremely Time Sensitive - Printed 15 Apr 19 at 10:57

RECEIVED APR 15 2019

Purchaser: Saverio PATELLA
Telephone Res. / Bus: (905) 265-8778 / (905) 265-8860
Decor Advisor: Candace Forza
Lock Date: 4/15/2019 10:55:17

Const. No.: Unit 3, Level 20
Municipal: 2303
Suite Type: E771
Project/Phase: Petaluma Building Corp./1

Layout Changes: ☐ Yes ☒ No Sketch Attached: ☒ Yes ☐ No Exterior Colour Scheme:

1. Kitchen and Vanities

	Style and Colour	Counter	Hardware
Kitchen / Breakfast	SEE BELOW	QUARTZ-TORRONE-#360 EDGE	STD
Main Bath	DORAL 1267-SAND MOLINA ASH	QUARTZ-TORRONE-STRAIGHT POLISHED EDGE	STD
Master Ensuite Bathroom	DORAL 1267-SAND MOLINA ASH	QUARTZ-TORRONE-STRAIGHT POLISHED EDGE	STD
	N/A	N/A	N/A

Appliances: Built In Appliances ☒ Yes ☐ No 41" Upper Cabinets ☒ Yes ☐ No Slide In Stove ☐ Yes ☒ No

Comment

KITCHEN - CABINETRY - BASE DORAL 1267-SAND MOLINA ASH *** UPPERS - SENOSAN WHITE

2. Flooring

		Grout-If App.	At a 45
Entrance Vestibule	STRIP-MIRAGE-LOCK RED OAK-CASHMERE-RIO-4 5/16"		<input type="checkbox"/>
Main Hall	STRIP-MIRAGE-LOCK RED OAK-CASHMERE-RIO-4 5/16"		<input type="checkbox"/>
Kitchen / Breakfast	STRIP-MIRAGE-LOCK RED OAK-CASHMERE-RIO-4 5/16"		<input type="checkbox"/>
Laundry Room	TILE-WHITE-8X8	STANDARD	<input type="checkbox"/>
Main Bath	TILE-ASPEN BIANCO-12X24	STANDARD	<input type="checkbox"/>
Master Ensuite Bathroom	TILE-ASPEN BIANCO-12X24	STANDARD	<input type="checkbox"/>
	N/A		<input type="checkbox"/>
Living Room	STRIP-MIRAGE-LOCK RED OAK-CASHMERE-RIO-4 5/16"		<input type="checkbox"/>
Dining Room	STRIP-MIRAGE-LOCK RED OAK-CASHMERE-RIO-4 5/16"		<input type="checkbox"/>
Den / Library / Study	N/A		<input type="checkbox"/>
Master Bedroom	STRIP-MIRAGE-LOCK RED OAK-CASHMERE-RIO-4 5/16"		<input type="checkbox"/>
Bedroom #2	STRIP-MIRAGE-LOCK RED OAK-CASHMERE-RIO-4 5/16"		<input type="checkbox"/>
Bedroom #3	N/A		<input type="checkbox"/>
			<input type="checkbox"/>

Comment

3. Wall Tile

	Selection	Grout	Describe
Main Bath			
Tub Deck Wall	N/A		
Shower Stall	TILE-GLOSSY WHITE-3X6	STANDARD	
Bathtub Enclosure Walls	N/A		
Master Ensuite Bathroom			
Tub Deck Wall	N/A		
Shower Stall	N/A		
Bathtub Enclosure Walls	TILE-GLOSSY WHITE-3X6	STANDARD	
Kitchen Backsplash	BACK PAINTED GLASS-BM-#OC-16		
Backsplash Behind Fridge	N/A		

Comment

** Refer to Construction Summary

4. Misc

Water Line for Fridge: N/A
Interior Door Handles: AS PER CONSTRUCTION SPECS
Ceramic Bathroom Accessories: NO - UPGRADED - MOEN 90 DEGREE ☐ Yes ☒ No

Comment

Purchaser: Saverio PATELLA
Telephone Res. / Bus: (905) 265-8778 / (905) 265-8860
Decor Advisor: Candace Forza
Lock Date: 4/15/2019 10:55:17

Const. No.: Unit 3, Level 20
Municipal: 2303
Suite Type: E771
Project/Phase: Petaluma Building Corp./1

5. Plaster Mouldings and Medallions

Entrance Vestibule	N/A		Living Room	N/A	
Main Hall	N/A		Dining Room	N/A	
Kitchen/Breakfast	N/A		Den / Library /Study	N/A	
Laundry Room	N/A		Master BedRoom	N/A	
Main Bath	N/A		BedRoom #2	N/A	
Master Ensuite Bathroom	N/A		BedRoom #3	N/A	

Comment

** Refer to Construction Summary

6. Wall Paint

Entrance Vestibule	43 - BIRCH WHITE	Living Room	43 - BIRCH WHITE
Main Hall	43 - BIRCH WHITE	Dining Room	43 - BIRCH WHITE
Kitchen / Breakfast	43 - BIRCH WHITE	Den/Library	N/A
Laundry Room	43 - BIRCH WHITE	Master Bedroom	43 - BIRCH WHITE
Main Bath	43 - BIRCH WHITE	Bedroom #2	43 - BIRCH WHITE
Master Ensuite	43 - BIRCH WHITE	Bedroom #3	N/A
	N/A		

Comment

7. General Comments

** Refer to Construction Summary

Disclaimers and Notes

- 1) Colours of all materials are as close as possible to builder's selection, but not necessarily identical due to variances in manufacturing.
- 2) Any extras listed above are null and void unless accompanied by a separate invoice/amendment. Said invoice must be paid in full.
- 3) The Purchaser agrees that this colour selection is final and that no changes will be permitted, unless required by the Vendor.
- 4) The Purchaser acknowledges reading and accepting document which contains other miscellaneous disclaimers.

Signature: 

Date: April 15/19

Signature: _____

Date: _____

Initial: _____

90°™

Traditional | Transitional | Modern

Geometric forms, squared corners and straight lines create an urban focal point for today's contemporary baths.



Toilet Tank Lever
Model YB8801

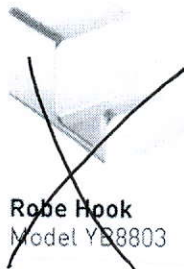

Robe Hook
Model YB8803



Cabinet Knob
Model YB8805

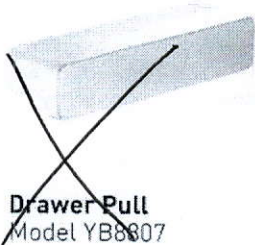

Drawer Pull
Model YB8807

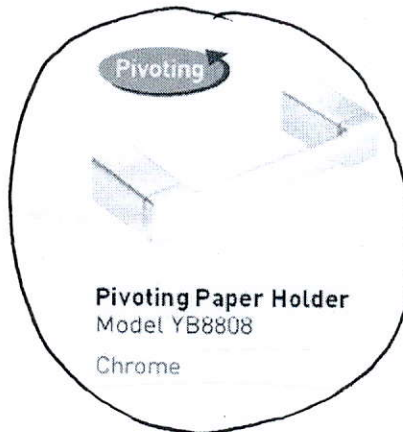

Pivoting Paper Holder
Model YB8808
Chrome



Mini Towel Bar
Model YB8886
Chrome

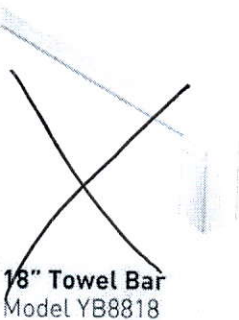

18" Towel Bar
Model YB8818



24" Towel Bar
Model YB8824
Chrome

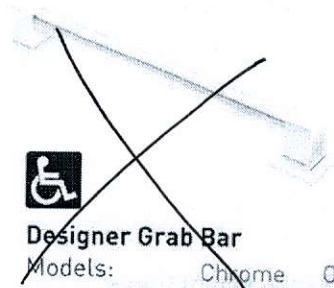

Designer Grab Bar

Models: Chrome Other

FINISH OPTIONS:

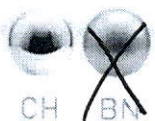

CH BN

To order, combine the model number with one of these finish letter(s):
Chrome (CH), LifeShine® Brushed Nickel (BN).

SCHEDULE 'A'
330
 RICHMOND

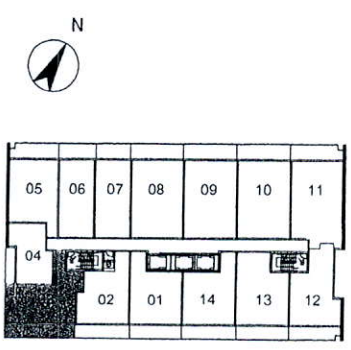
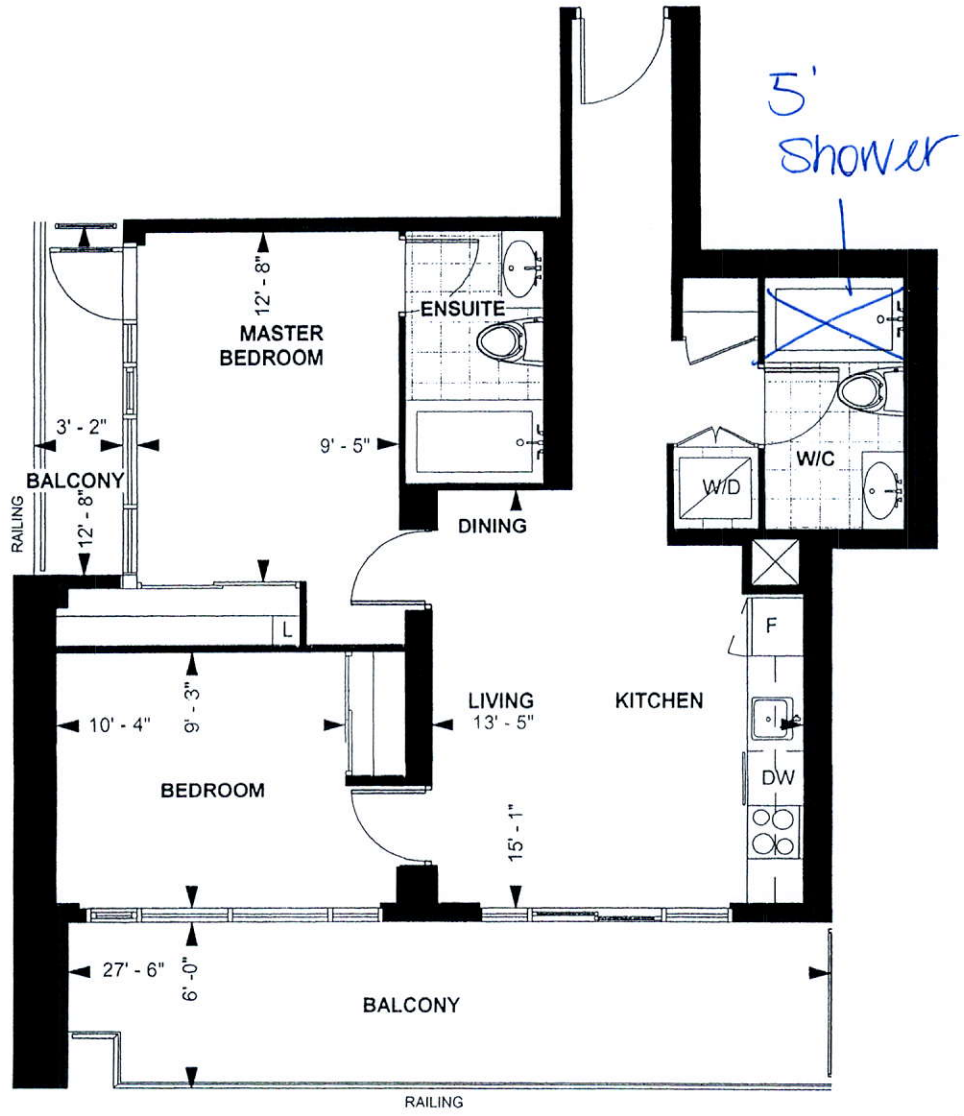

LEVEL 13-20

TOWER SUITE
E 771
9' CEILING *
 771 sq. ft
2-BEDROOM

[Handwritten signature]

Purchaser Initials *[Signature]* Purchaser Initials *[Signature]* Date *26/10/15*

Unit No. 3 Level No. 20 Suite No. 2303

Dimensions, specification, tile floor pattern and architectural detailing (including window size and location) are approximate and subject to modifications without notice. Orientation of suite may vary from the stated floor area.
 *Ceiling height measured from top of floor slab to underside of slab above before finishes, and excluding bulkheads and required drop ceilings. E.&O.E.

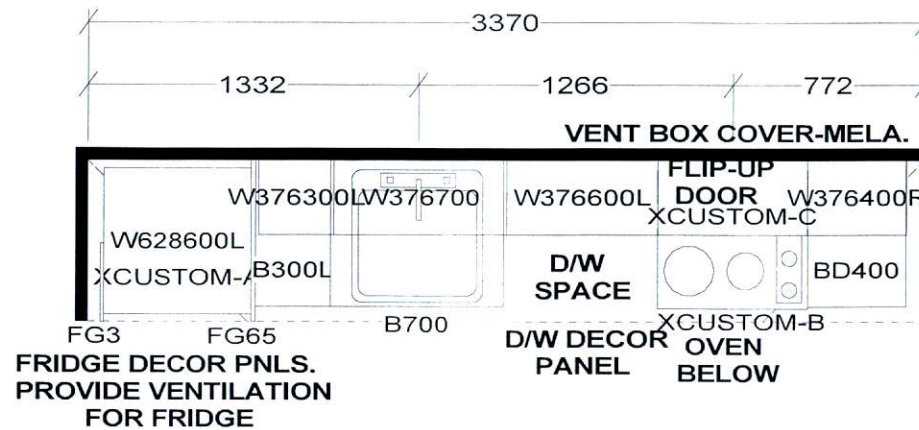

KITCHEN

- 41" uppers
- up. countertop Edge

KITCHEN BASES & VANITIES INSTALLED WITH ADJUSTABLE LEGS

APPLIANCE PACKAGE:
 24" INTEGRATED FRIDGE W/ DECOR PNLS
 24" INTEGRATED DISHWASHER W/ DECOR PNL
 24" BUILT-IN OVEN
 24" COOKTOP
 24" MICROWAVE HOOD FAN

Selba Industries

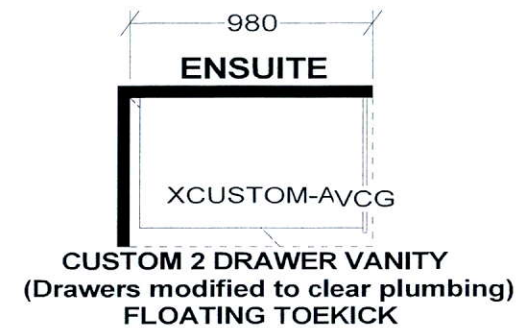

ENSUITE

CUSTOM 2 DRAWER VANITY
 (Drawers modified to clear plumbing)
 FLOATING TOEKICK

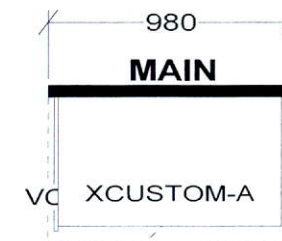

MAIN

CUSTOM 2 DRAWER VANITY
 (Drawers modified to clear plumbing)
 FLOATING TOEKICK

W WIDTH _____ W HGHT _____ W CNT _____ FL HGHT _____ DWY H _____ ST CENT _____ 2X4 _____ VENT BOX COVER _____

TOWER SUITES:
 760MM HIGH UPPER CABINETS
 WHITE STEEL DRAWER BOXES
 COUNTERTOPS BY OTHERS
 VENT BOX COVERS
 CUSTOM VANITIES

This drawing is the intellectual property of SELBA INDUSTRIES INC. and is an original design which must not be released or copied unless applicable fee has been paid or job order placed.



JOB NUMBER:
BUILDER: GREENPARK
SITE NAME: PETALUMA
MODEL: 2 BEDROOM - E 771
LOT #:
DESIGNER: KS
DATE: JAN 8 18