



CONSTRUCTION SUMMARY

330 Richmond - Petaluma Building Corp.

PURCHASERS: Milton N. HERNANDEZ and Narcisa E. HERNANDEZ

TEL: RES.: 905-625-8452

Unit 14, Level 19 (2217-1)

Floor Plan
B597

CABINETRY

1 - 41" UPPER CABINETS IN KITCHEN

12Apr19 Note:

CONSTRUCTION

1 - SMOOTH CEILING IN BEDROOM

12Apr19 Note:

1 - MAIN BATH - 5 FOOT SHOWER WITH SLIDING CHROME FRAMED GLASS DOORS IN LIEU OF TUB

12Jun18 Note:

COUNTER TOP

1 - UPGRADE COUNTERTOP EDGE- KITCHEN AND BATHROOM

12Apr19 Note:

PLUMBING

1 - UPGRADE BATHROOM ACCESSORIES- MOEN 90 DEGREE

TOILET PAPER HOLDER #TB8808

TOWEL RING #YB8886

24" TOWEL BAR #YB8824

12Apr19 Note:

PROMOTIONAL

1 - LESS CREDIT FROM PURCHASERS EXTRA SHEET IN OFFER

12Apr19 Note:

1 - PARTIAL REDEPTION OF PROMOTIONAL PACKAGE \$2,800.00 BALANCE (\$2,200) FORWARD TO BE USED AT A LATER DATE. ORIGINAL PROMOTIONAL PACKAGE OF \$5,000 AS PER SCHEDULE PE DATED - January 15, 2016

12Jun18 Note:

EXTRAS AS PER OFFER

The Vendor agrees that notwithstanding any other term or provision in this Agreement included in the Purchase Price and in addition to those items

detailed in Schedule D to the Agreement of Purchase and Sale, the Purchaser is entitled to a credit of Fiv

Worksheet Note:

This Document is Extremely Time Sensitive - Printed 12 Apr 19 at 10:51

RECEIVED APR 12 2019

Purchasers:

Milton N. HERNANDEZ & Narcisa E. HERNANDE

Const. No.:

Unit 14, Level 19

Telephone Res. / Bus:

(905) 625-8452 /

Municipal:

2217

Decor Advisor:

Natalie Mancuso

Suite Type:

B597

Lock Date:

4/12/2019 10:50:47

Project/Phase:

Petaluma Building Corp./1

Layout Changes:

☒ Yes ☐ No

Sketch Attached:

☒ Yes ☐ No

Exterior Colour Scheme:

1. Kitchen and Vanities	Style and Colour	Counter	Hardware
Kitchen / Breakfast	SEE BELOW	QUARTZ- AMIATA- #360 EDGE	STD
Main Bath	DORAL H3081 HACIENDA BLACK	QUARTZ- AMIATA- #360 EDGE	STD
Master Ensuite Bathroom			

Appliances:

Built In Appliances

☒ Yes ☐ No

41" Upper Cabinets

☒ Yes ☐ No

Slide In Stove

☐ Yes ☒ No

Comment

KITCHEN UPPER CABINETS- SENOSAN LIGHT GREY
KITCHEN BASE CABINETS- DORAL H3081 HACIENDA BLACK

2. Flooring		Grout-If App.	At a 45
Entrance Vestibule	HARDWOOD- MIRAGE 4 5/16 LOCK RED OAK- GRAPHITE- CASHMERE		<input type="checkbox"/>
Main Hall	HARDWOOD- MIRAGE 4 5/16 LOCK RED OAK- GRAPHITE- CASHMERE		<input type="checkbox"/>
Kitchen / Breakfast	HARDWOOD- MIRAGE 4 5/16 LOCK RED OAK- GRAPHITE- CASHMERE		<input type="checkbox"/>
Laundry Room	TILE- MATTE WHITE 8X8	STD	<input type="checkbox"/>
Main Bath	TILE- LIFE ICE 12X24	STD	<input type="checkbox"/>
Master Ensuite Bathroom			<input type="checkbox"/>
			<input type="checkbox"/>
Living Room	HARDWOOD- MIRAGE 4 5/16 LOCK RED OAK- GRAPHITE- CASHMERE		<input type="checkbox"/>
Dining Room	HARDWOOD- MIRAGE 4 5/16 LOCK RED OAK- GRAPHITE- CASHMERE		<input type="checkbox"/>
Den / Library / Study			<input type="checkbox"/>
Master Bedroom	HARDWOOD- MIRAGE 4 5/16 LOCK RED OAK- GRAPHITE- CASHMERE		<input type="checkbox"/>
Bedroom #2			<input type="checkbox"/>
Bedroom #3			<input type="checkbox"/>
			<input type="checkbox"/>

Comment

3. Wall Tile	Selection	Grout	Describe
Main Bath			
Tub Deck Wall			
Shower Stall	TILE- GLOSSY WHITE 3X6	STD	
Bathtub Enclosure Walls			
Master Ensuite Bathroom			
Tub Deck Wall			
Shower Stall			
Bathtub Enclosure Walls			
Kitchen Backsplash	PAINTED GLASS BM#HC-170		
Backsplash Behind Fridge			

Comment

** Refer to Construction Summary

4. Misc

Water Line for Fridge

NO

Interior Door Handles

STANDARD

Ceramic Bathroom Accessories

UPGRADE MOEN 90 DEGREE

☒ Yes ☐ No

Comment

Purchasers:

Telephone Res. / Bus:

Decor Advisor:

Lock Date:

Milton N. HERNANDEZ & Narcisa E. HERNANDE

(905) 625-8452 /

Natalie Mancuso

4/12/2019 10:50:47

Const. No.:

Municipal:

Suite Type:

Project/Phase:

Unit 14, Level 19

2217

B597

Petaluma Building Corp./1

5. Plaster Mouldings and Medallions

Entrance Vestibule			Living Room		
Main Hall			Dining Room		
Kitchen/Breakfast			Den / Library /Study		
Laundry Room			Master BedRoom		
Main Bath			BedRoom #2		
Master Ensuite Bathroom			BedRoom #3		

Comment

** Refer to Construction Summary

6. Wall Paint

Entrance Vestibule	BIRCH WHITE	Living Room	BIRCH WHITE
Main Hall	BIRCH WHITE	Dining Room	BIRCH WHITE
Kitchen / Breakfast	BIRCH WHITE	Den/Library	
Laundry Room	BIRCH WHITE	Master Bedroom	BIRCH WHITE
Main Bath	BIRCH WHITE	Bedroom #2	
Master Ensuite		Bedroom #3	

Comment

7. General Comments

** Refer to Construction Summary

Disclaimers and Notes

- 1) Colours of all materials are as close as possible to builder's selection, but not necessarily identical due to variances in manufacturing.

2) Any extras listed above are null and void unless accompanied by a separate invoice/amendment. Said invoice must be paid in full.

3) The Purchaser agrees that this colour selection is final and that no changes will be permitted, unless required by the Vendor.

4) The Purchaser acknowledges reading and accepting document which contains other miscellaneous disclaimers.

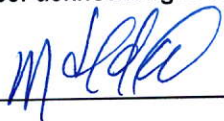
Signature: 

Date: _____

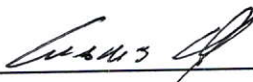
Signature: 

Date: APR 11 2019

Signature: _____

Date: _____

90°™

Traditional | Transitional | Modern

Geometric forms, squared corners and straight lines create an urban focal point for today's contemporary baths.



Toilet Tank Lever
Model YB8801

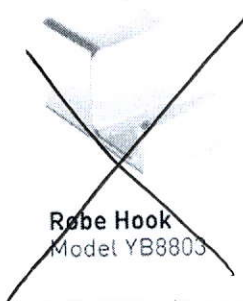

Robe Hook
Model YB8803

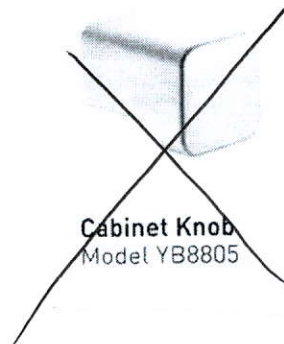

Cabinet Knob
Model YB8805

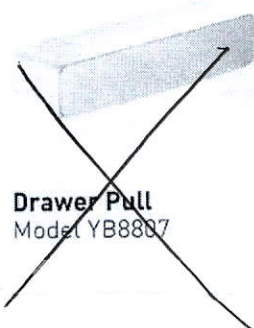

Drawer Pull
Model YB8807

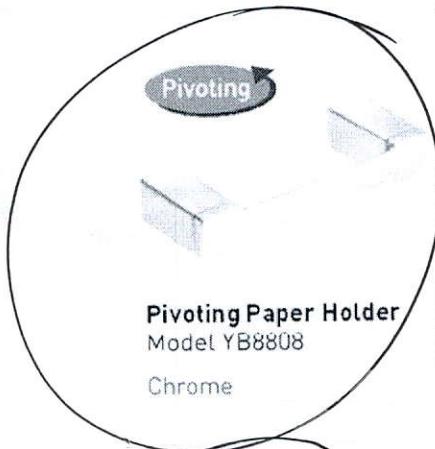

Pivoting Paper Holder
Model YB8808
Chrome



Mini Towel Bar
Model YB8886
Chrome

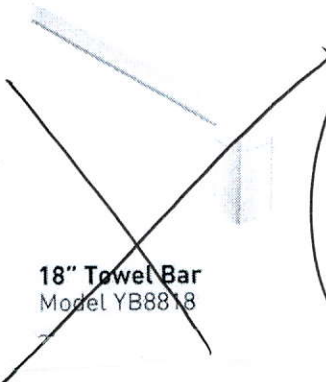

18" Towel Bar
Model YB8818



24" Towel Bar
Model YB8824
Chrome



Designer Grab Bar
Models: Chrome Other

FINISH OPTIONS:



To order, combine the model number with one of these finish letter(s):
Chrome (CH), LifeShine® Brushed Nickel (BN).

SCHEDULE 'A'

330
RICHMOND

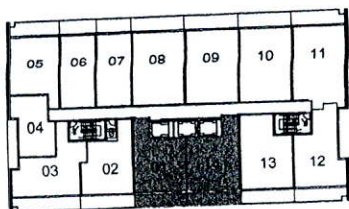
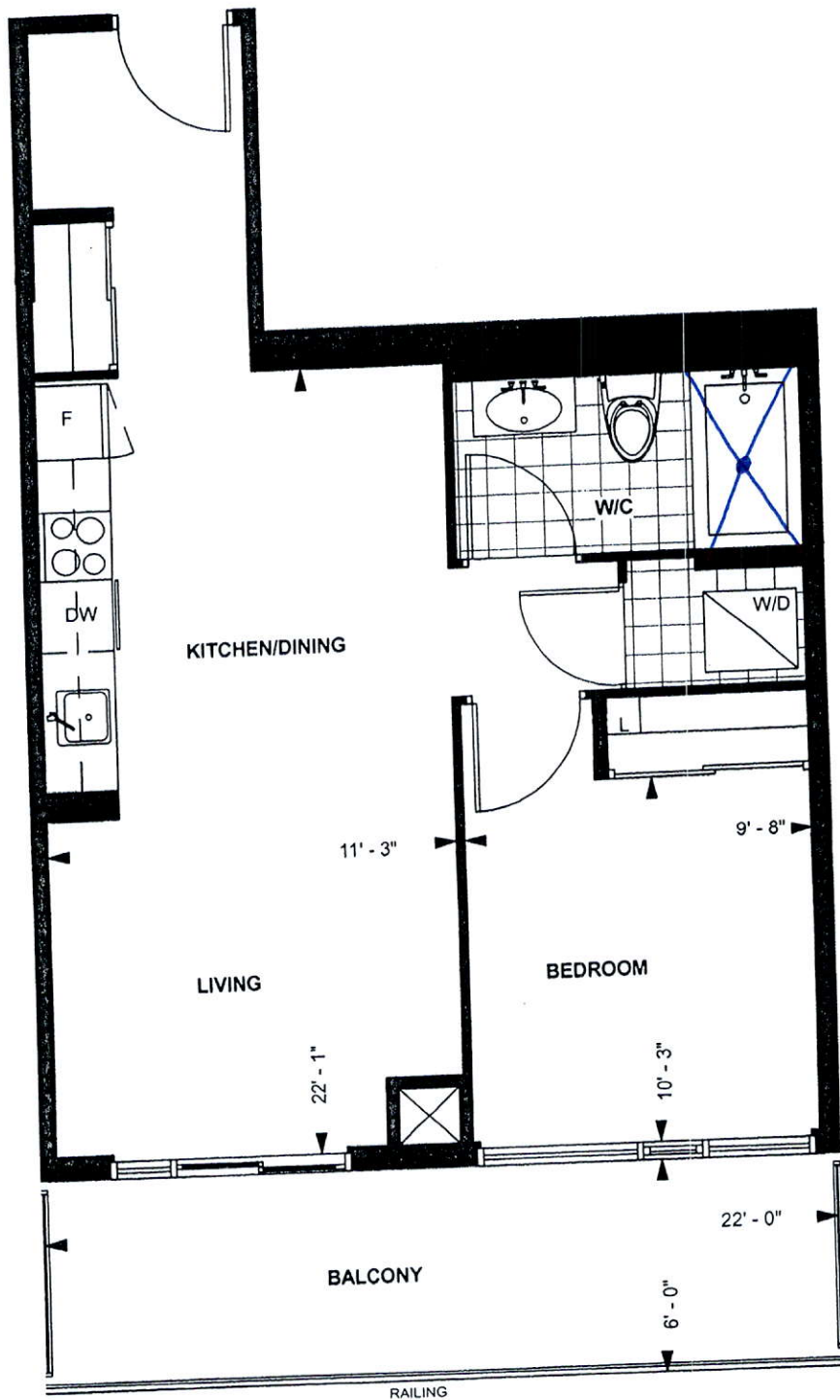

LEVEL 13 - 20

TOWER SUITE
B 597

9' CEILING *

597 sq. ft.

1-BEDROOM

Purchaser Initials Purchaser Initials

Date

Unit No. 14 Level No. 19 Suite No. 2217

Dimensions, specification, tile floor pattern and architectural detailing (including window size and location) are approximate and subject to modifications without notice. Orientation of suite may vary from the stated floor area.

*Ceiling height measured from top of floor slab to underside of slab above before finishes, and excluding bulkheads and required drop ceilings. E.&O.E.

upgrade countertop Edge in Kitchen + Bath

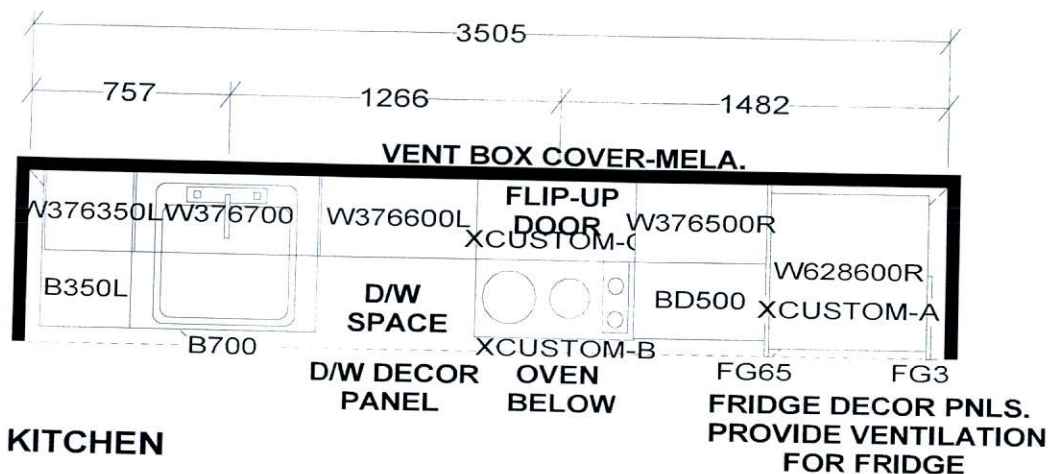

KITCHEN

41" uppers

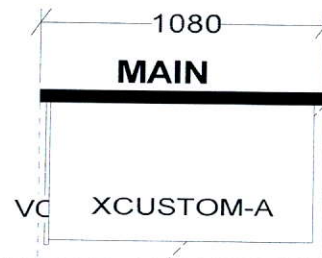

CUSTOM 2 DRAWER VANITY
(Drawers modified to clear plumbing)
FLOATING TOEKICK

KITCHEN BASES & VANITIES INSTALLED
WITH ADJUSTABLE LEGS

APPLIANCE PACKAGE:

- 24" INTEGRATED FRIDGE W/ DECOR PNLS
- 24" INTEGRATED DISHWASHER W/ DECOR PNL
- 24" BUILT-IN OVEN
- 24" COOKTOP
- 24" MICROWAVE HOOD FAN

Selba Industries

WDTH	W HGHT	W CNT	FL HGHT	DWY H	ST CENT	2X4	VENT BOX COVER
TOWER SUITES: 760MM HIGH UPPER CABINETS WHITE STEEL DRAWER BOXES COUNTERTOPS BY OTHERS VENT BOX COVERS CUSTOM VANITIES				This drawing is the intellectual property of SELBA INDUSTRIES INC. and is an original design which must not be released or copied unless applicable fee has been paid or job order placed.		JOB NUMBER: BUILDER: GREENPARK SITE NAME: PETALUMA MODEL: 1 BEDROOM - B 583, B 597 LOT #: DESIGNER: KS DATE: JAN 8 18	