

CONSTRUCTION SUMMARY
330 Richmond - Petaluma Building Corp.

PURCHASER: ELLIOT VELOCCHI		TEL: RES.: 647-464-5709	
Unit 7, Level 7 (808-1)	Floor Plan B635		

CABINETRY

1 - KITCHEN - 41" UPPER CABINETRY 04Apr19 Note:	
--	--

CERAMIC TILE

1 - BATHROOM - DELETE STANDARD WHITE CERAMIC ACCESSORIES - DO NOT INSTALL SOAP DISH, TOWEL RACK OR TISSUE HOLDER 04Apr19 Note:	
---	--

MIRRORS AND GLASS

2 - FOYER & BEDROOM - FRAMELESS MIRROR SLIDING CLOSET DOORS WITH MIRROR FASCIA 04Apr19 Note:	
---	--

PLUMBING

1 - BATHROOM - MOEN 90 DEGREE BATHROOM ACCESSORIES - CHROME TOILET PAPER HOLDER #YB8808 TOWEL RING #YB8886 TOWEL BAR #YB8824 04Apr19 Note:	
--	--

This Document is Extremely Time Sensitive - Printed 4 Apr 19 at 16:58

RECEIVED APR 10 2019

Purchaser: ELLIOT VELOCCI
Telephone Res. / Bus: (647) 464-5709 /
Decor Advisor: Candace Forza
Lock Date: 4/4/2019 16:58:41

Const. No.: Unit 7, Level 7
Municipal: 808
Suite Type: B635
Project/Phase: Petaluma Building Corp./1

Layout Changes: ☐ Yes ☒ No Sketch Attached: ☒ Yes ☐ No Exterior Colour Scheme:

1. Kitchen and Vanities

	Style and Colour	Counter	Hardware
Kitchen / Breakfast	SEE BELOW	QUARTZ-TORRONE-STRAIGHT POLISHED EDGE	STD
Main Bath	DORAL H3078-HACIENDA WHITE	QUARTZ-TORRONE-STRAIGHT POLISHED EDGE	STD
Master Ensuite Bathroom	N/A	N/A	N/A

Appliances: Built In Appliances ☒ Yes ☐ No 41" Upper Cabinets ☒ Yes ☐ No Slide In Stove ☐ Yes ☒ No

Comment

KITCHEN CABINETRY - BASE DORAL H3078-HACIENDA WHITE *** UPPERS SENOSAN WHITE

2. Flooring

		Grout-If App.	At a 45
Entrance Vestibule	STRIP-MIRAGE-LOCK-RED OAK-CASHMERE-NORDIC-4 5/16"		<input type="checkbox"/>
Main Hall	STRIP-MIRAGE-LOCK-RED OAK-CASHMERE-NORDIC-4 5/16"		<input type="checkbox"/>
Kitchen / Breakfast	STRIP-MIRAGE-LOCK-RED OAK-CASHMERE-NORDIC-4 5/16"		<input type="checkbox"/>
Laundry Room	TILE-LIFE SILVER-12X24	STANDARD	<input type="checkbox"/>
Main Bath	TILE-LIFE SILVER-12X24	STANDARD	<input type="checkbox"/>
Master Ensuite Bathroom	N/A		<input type="checkbox"/>
	N/A		<input type="checkbox"/>
Living Room	STRIP-MIRAGE-LOCK-RED OAK-CASHMERE-NORDIC-4 5/16"		<input type="checkbox"/>
Dining Room	STRIP-MIRAGE-LOCK-RED OAK-CASHMERE-NORDIC-4 5/16"		<input type="checkbox"/>
Den / Library / Study	N/A		<input type="checkbox"/>
Master Bedroom	STRIP-MIRAGE-LOCK-RED OAK-CASHMERE-NORDIC-4 5/16"		<input type="checkbox"/>
Bedroom #2	N/A		<input type="checkbox"/>
Bedroom #3	N/A		<input type="checkbox"/>
			<input type="checkbox"/>

Comment

3. Wall Tile

	Selection	Grout	Describe
Main Bath			
Tub Deck Wall	N/A		
Shower Stall	N/A		
Bathtub Enclosure Walls	TILE-GLOSSY WHITE-3X6	STANDARD	
Master Ensuite Bathroom			
Tub Deck Wall	N/A		
Shower Stall	N/A		
Bathtub Enclosure Walls	N/A		
Kitchen Backsplash	BACK PAINTED GLASS-BM-#OC-16	STANDARD	
Backsplash Behind Fridge	N/A		

Comment

** Refer to Construction Summary

4. Misc

Water Line for Fridge	N/A
Interior Door Handles	AS PER CONSTRUCTION SPECS
Ceramic Bathroom Accessories	NO - UPGRADED - MOEN 90 DEGREE

☐ Yes ☒ No

Comment

Purchaser:

ELLIOT VELOCCI

Telephone Res. / Bus:

(647) 464-5709 /

Decor Advisor:

Candace Forza

Lock Date:

4/4/2019 16:58:41

Const. No.:

Unit 7, Level 7

Municipal:

808

Suite Type:

B635

Project/Phase:

Petaluma Building Corp./1

5. Plaster Mouldings and Medallions

Entrance Vestibule	N/A		Living Room	N/A	
Main Hall	N/A		Dining Room	N/A	
Kitchen/Breakfast	N/A		Den / Library /Study	N/A	
Laundry Room	N/A		Master BedRoom	N/A	
Main Bath	N/A		BedRoom #2	N/A	
Master Ensuite Bathroom	N/A		BedRoom #3	N/A	

Comment

** Refer to Construction Summary

6. Wall Paint

Entrance Vestibule	43-BIRCH WHITE	Living Room	43-BIRCH WHITE
Main Hall	43-BIRCH WHITE	Dining Room	43-BIRCH WHITE
Kitchen / Breakfast	43-BIRCH WHITE	Den/Library	N/A
Laundry Room	43-BIRCH WHITE	Master Bedroom	43-BIRCH WHITE
Main Bath	43-BIRCH WHITE	Bedroom #2	N/A
Master Ensuite	N/A	Bedroom #3	N/A
	N/A		

Comment

7. General Comments

** Refer to Construction Summary

Disclaimers and Notes

- 1) Colours of all materials are as close as possible to builder's selection, but not necessarily identical due to variances in manufacturing.
- 2) Any extras listed above are null and void unless accompanied by a separate invoice/amendment. Said invoice must be paid in full.
- 3) The Purchaser agrees that this colour selection is final and that no changes will be permitted, unless required by the Vendor.
- 4) The Purchaser acknowledges reading and accepting document which contains other miscellaneous disclaimers.



Signature: _____

Date: _____

Signature: _____

Date: _____

90°™

Traditional | Transitional | Modern

Geometric forms, squared corners and straight lines create an urban focal point for today's contemporary baths.



Toilet Tank Lever
Model YB8801



Robe Hook
Model YB8803

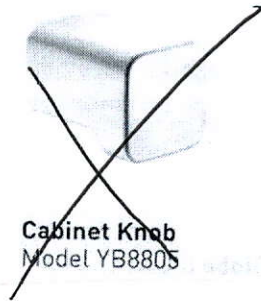

Cabinet Knob
Model YB8805

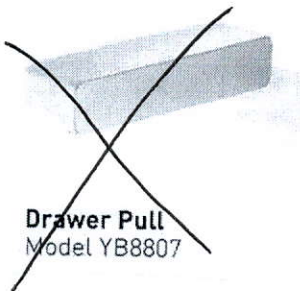

Drawer Pull
Model YB8807

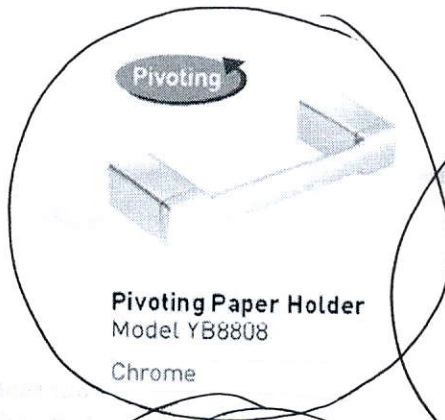

Pivoting Paper Holder
Model YB8808
Chrome



Mini Towel Bar
Model YB8886
Chrome



18" Towel Bar
Model YB8818



24" Towel Bar
Model YB8824
Chrome



Designer Grab Bar
Models: Chrome Other

FINISH OPTIONS:

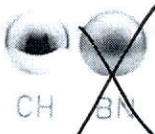

CH BN

To order, combine the model number with one of these finish letter(s):
Chrome (CH), LifeShine® Brushed Nickel (BN).

SCHEDULE 'A'

330

RICHMOND

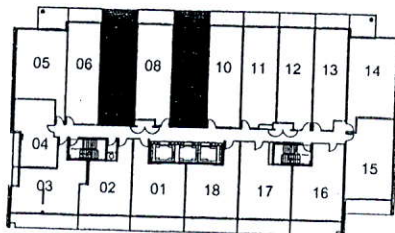
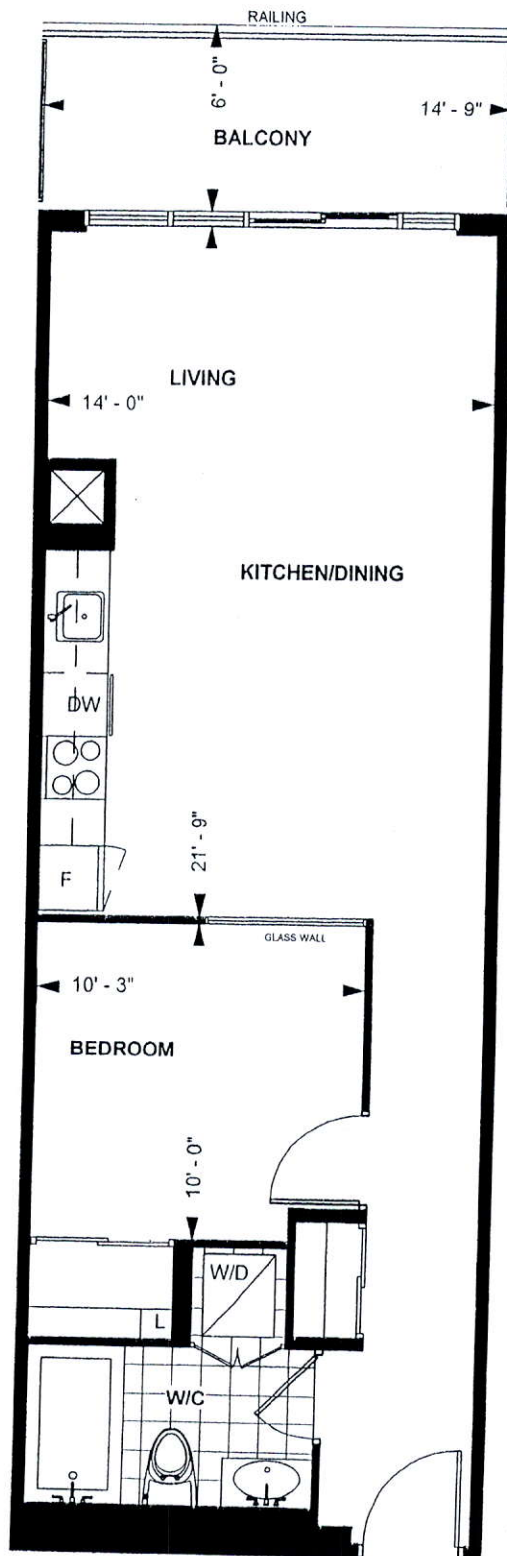

LEVEL 5 - 9

TOWER SUITE

B 635

9' CEILING *

635 sq. ft.

1-BEDROOM

Purchaser Initials Purchaser Initials

Date

Unit No. 7 Level No. 7 Suite No. 808

Dimensions, specification, tile floor pattern and architectural detailing (including window size and location) are approximate and subject to modifications without notice. Orientation of suite may vary from the stated floor area.
*Ceiling height measured from top of floor slab to underside of slab above before finishes, and excluding bulkheads and required drop ceilings. E.&O.E.

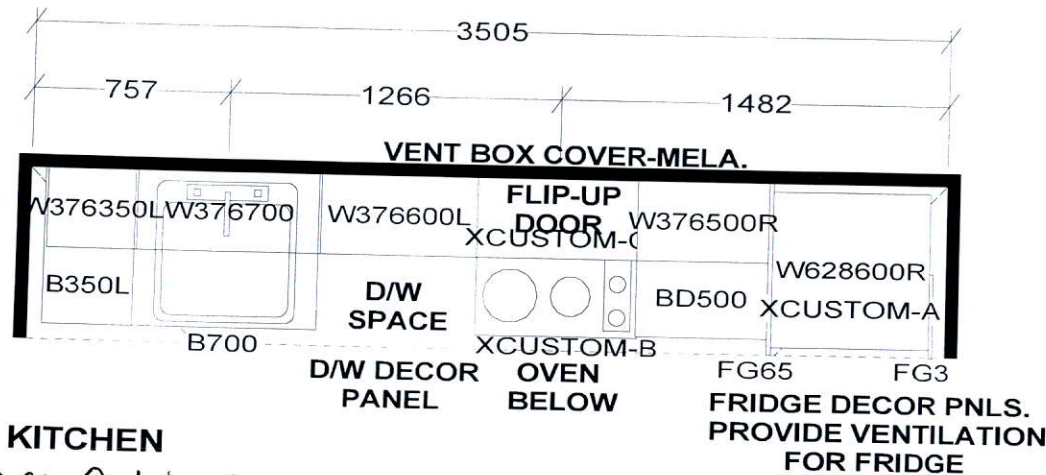

KITCHEN
 41" Upper Cabinetry.

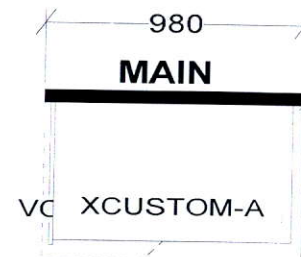

CUSTOM 2 DRAWER VANITY
 (Drawers modified to clear plumbing)
 FLOATING TOEKICK

**KITCHEN BASES & VANITIES INSTALLED
 WITH ADJUSTABLE LEGS**

APPLIANCE PACKAGE:
 24" INTEGRATED FRIDGE W/ DECOR PNLS
 24" INTEGRATED DISHWASHER W/ DECOR PNL
 24" BUILT-IN OVEN
 24" COOKTOP
 24" MICROWAVE HOOD FAN

Selba Industries

WDTH _____ W HGHT _____ W CNT _____ FL HGHT _____ DWY H _____ ST CENT _____ 2X4 _____ VENT BOX COVER _____

TOWER SUITES:
 760MM HIGH UPPER CABINETS
 WHITE STEEL DRAWER BOXES
 COUNTERTOPS BY OTHERS
 VENT BOX COVERS
 CUSTOM VANITIES

This drawing is the intellectual property of
 SELBA INDUSTRIES INC. and is an
 original design which must not be released
 or copied unless applicable fee has been
 paid or job order placed.



JOB NUMBER:
BUILDER: GREENPARK
SITE NAME: PETALUMA
MODEL: 1 BEDROOM-B 592, B 609, B 635
LOT #:
DESIGNER: KS
DATE: JAN 8 18

Frameless Mirror Sliding Door with Mirror Fascia - \$680

