



CONSTRUCTION SUMMARY
330 Richmond - Petaluma Building Corp.

PURCHASER: Leonid ORLOVSKY
TEL: RES.: 647-338-3859

Unit 16, Level 9 (1019-1)	Floor Plan C658		
---------------------------	--------------------	--	--

CABINETRY

1 - KITCHEN - ADD 5FT ISLAND WITH BREAFAST BAR- AS PER SKETCH 20Feb19 Note:	
1 - BATHROOM - RAISE VANITY HEIGHT TO 36" 20Feb19 Note:	
1 - KITCHEN - 41" UPPER CABINETS 20Feb19 Note:	

CABINETRY ACCESSORIES

2 - KITCHEN- ADD 2 SETS OF POT AND PAN DRAWERS TO ISLAND 20Feb19 Note:	
---	--

CERAMIC TILE

1 - KITCHEN BACKSPLASH - UPGRADE MOSAICS IN LIEU OF STANDARD 20Feb19 Note:	
1 - SHOWER FLOOR- UPGRADE 3 MOSAICS 20Feb19 Note:	
1 - SHOWER WALLS - UPGRADE 3 WALL TILES 20Feb19 Note:	

CONSTRUCTION

1 - MAIN BATH - 5 FOOT SHOWER WITH SLIDING CHROME FRAMED GLASS DOORS IN LIEU OF TUB 15Jan18 Note:	
--	--

COUNTER TOP

1 - BATHROOM- UPGRADE QUARTZ COUNTERTOP 20Feb19 Note:	
1 - KITCHEN- UPGRADE QUARTZ COUNTERTOP 20Feb19 Note:	
1 - UPGRADE COUNTERTOP EDGE IN KITCHEN AND BATHROOM 20Feb19 Note:	

DOORS AND TRIM

1 - UPGRADE INTERIOR DOORS- MELROSE 7FT 20Feb19 Note:	
1 - FOYER CLOSET DOORS TO BE FRAMED MIRROR SLIDERS 20Feb19 Note:	
1 - UPGRADE TRIM TO 4 1/4 ONE STEP 20Feb19 Note:	

HARDWOOD FLOORING

1 - UPGRADE HARDWOOD FLOORING TO 4 5/16 MAPLE IN LIEU OF STANDARD 20Feb19 Note:	
--	--

MIRRORS AND GLASS

1 - FRAMELESS GLASS SHOWER DOOR WITH PANEL IN LIEU OF STANDARD CHROME SLIDERS 20Feb19 Note:	
--	--

MISCELLANEOUS

RECEIVED MAR 26 2019



CONSTRUCTION SUMMARY
330 Richmond - Petaluma Building Corp.

PURCHASER: Leonid ORLOVSKY
TEL: RES.: 647-338-3859

Unit 16, Level 9 (1019-1)	Floor Plan C658		
---------------------------	--------------------	--	--

1 - further vendor discount 20Feb19 Note:	
--	--

PLUMBING

1 - UPGRADE BATHROOM ACCESSORIES- MOEN 90 DEGREE TOILET PAPER HOLDER #YB8808 CHROME 24" TOWEL BAR #YB8824 CHROME 20Feb19 Note:	
---	--

1 - UPGRADE KITCHEN SINK- BLANCO QUATRUS R15 U1 MEDIUM #401517 20Feb19 Note:	
---	--

PROMOTIONAL

1 - LESS CREDIT FROM PURCHASER EXTRA SHEET IN OFFER 20Feb19 Note:	
1 - PARTIAL REDEPTION OF PROMOTIONAL PACKAGE \$2,800.00 BALANCE (\$2,200) FORWARD TO BE USED AT A LATER DATE. ORIGINAL PROMOTIONAL PACKAGE OF \$5,000 AS PER SCHEDULE PE DATED MAY 2, 2016. 15Jan18 Note:	

This Document is Extremely Time Sensitive - Printed 20 Feb 19 at 16:30

Purchaser: Leonid ORLOVSKY
Telephone Res. / Bus: (647) 338-3859 /
Decor Advisor: Natalie Mancuso
Lock Date: 2/20/2019 16:30:49

Const. No.: Unit 16, Level 9
Municipal: 1019
Suite Type: C658
Project/Phase: Petaluma Building Corp./1

Layout Changes: ☒ Yes ☐ No Sketch Attached: ☒ Yes ☐ No Exterior Colour Scheme:

1. Kitchen and Vanities

	Style and Colour	Counter	Hardware
Kitchen / Breakfast	SEE BELOW	QUARTZ- CREMA AVORIO- #360 EDGE	STD
Main Bath	DORAL H3078 HACIENDA WHITE	QUARTZ- CREMA AVORIO- #360 EDGE	STD
Master Ensuite Bathroom			

Appliances: Built In Appliances ☒ Yes ☐ No 41" Upper Cabinets ☒ Yes ☐ No Slide In Stove ☐ Yes ☒ No

Comment

KITCHEN UPPER CABINETS- SENOSAN WHITE
KITCHEN BASE CABINETS -DORAL H3078 HACIENDA WHITE

2. Flooring

		Grout-If App.	At a 45
Entrance Vestibule	HARDWOOD- MIRAGE 4 5/16 LOCK MAPLE CHARACTER- PEPPERMINT-CASHMERE		<input type="checkbox"/>
Main Hall	HARDWOOD- MIRAGE 4 5/16 LOCK MAPLE CHARACTER- PEPPERMINT-CASHMERE		<input type="checkbox"/>
Kitchen / Breakfast	HARDWOOD- MIRAGE 4 5/16 LOCK MAPLE CHARACTER- PEPPERMINT-CASHMERE		<input type="checkbox"/>
Laundry Room	TILE- MATTE WHITE 8X8	STD	<input type="checkbox"/>
Main Bath	TILE-LIFE SILVER 12X24	STD	<input type="checkbox"/>
Master Ensuite Bathroom			<input type="checkbox"/>
			<input type="checkbox"/>
Living Room	HARDWOOD- MIRAGE 4 5/16 LOCK MAPLE CHARACTER- PEPPERMINT-CASHMERE		<input type="checkbox"/>
Dining Room	HARDWOOD- MIRAGE 4 5/16 LOCK MAPLE CHARACTER- PEPPERMINT-CASHMERE		<input type="checkbox"/>
Den / Library / Study	HARDWOOD- MIRAGE 4 5/16 LOCK MAPLE CHARACTER- PEPPERMINT-CASHMERE		<input type="checkbox"/>
Master Bedroom	HARDWOOD- MIRAGE 4 5/16 LOCK MAPLE CHARACTER- PEPPERMINT-CASHMERE		<input type="checkbox"/>
Bedroom #2			<input type="checkbox"/>
Bedroom #3			<input type="checkbox"/>
			<input type="checkbox"/>

Comment

3. Wall Tile

	Selection	Grout	Describe
Main Bath			
Tub Deck Wall			
Shower Stall	TILE- RMD STATUARIO BRILL 10X30	STD	INSTALLED VERTICALLY
Bathtub Enclosure Walls			
Master Ensuite Bathroom			
Tub Deck Wall			
Shower Stall			
Bathtub Enclosure Walls			
Kitchen Backsplash	DIAMOND INTR MOS. PLATINUM LUX 12X12	STD	
Backsplash Behind Fridge			

Comment

SHOWER FLOOR MOSAICS- PLATINUM NATURAL MOSAIC 2X2

4. Misc

Water Line for Fridge: NO
Interior Door Handles: STANDARD
Ceramic Bathroom Accessories: MOEN 90 DEGREE- TOWEL BAR & TOILET PAPER ☒ Yes ☐ No

Comment

Initial: 

Purchaser:Leonid ORLOVSKY

Telephone Res. / Bus: (647) 338-3859 /

Decor Advisor: Natalie Mancuso

Lock Date: 2/20/2019 16:30:49

Const. No.: Unit 16, Level 9

Municipal: 1019

Suite Type: C658

Project/Phase: Petaluma Building Corp./1

5. Plaster Mouldings and Medallions

Entrance Vestibule			Living Room		
Main Hall			Dining Room		
Kitchen/Breakfast			Den / Library /Study		
Laundry Room			Master BedRoom		
Main Bath			BedRoom #2		
Master Ensuite Bathroom			BedRoom #3		

Comment

** Refer to Construction Summary

6. Wall Paint

Entrance Vestibule	BIRCH WHITE	Living Room	BIRCH WHITE
Main Hall	BIRCH WHITE	Dining Room	BIRCH WHITE
Kitchen / Breakfast	BIRCH WHITE	Den/Library	BIRCH WHITE
Laundry Room	BIRCH WHITE	Master Bedroom	BIRCH WHITE
Main Bath	BIRCH WHITE	Bedroom #2	
Master Ensuite		Bedroom #3	

Comment

7. General Comments

** Refer to Construction Summary

Disclaimers and Notes

- 1) Colours of all materials are as close as possible to builder's selection, but not necessarily identical due to variances in manufacturing.

2) Any extras listed above are null and void unless accompanied by a separate invoice/amendment. Said invoice must be paid in full.

3) The Purchaser agrees that this colour selection is final and that no changes will be permitted, unless required by the Vendor.

4) The Purchaser acknowledges reading and accepting document which contains other miscellaneous disclaimers.

★

Signature:_____

★

Date:_____

★

Signature:_____

★

Date:_____

Initial:

Product Specification Sheet

BLANCO QUATRUS R15 U 1 MEDIUM

Satin brushed finish



PRODUCT DIMENSIONS

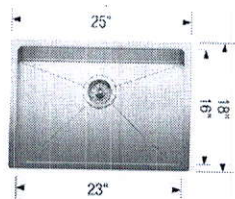

BLANCO QUATRUS R15 U 1 MEDIUM	Colour Finish	Model No.	FEATURES / SPECIFICATIONS
	Satin brushed finish	401517	<ul style="list-style-type: none">• German designed and engineered• Premium 304 series, 18 gauge stainless steel• 18/10 chrome-nickel content for exceptional lustre, durability and strength• Rear-positioned drain hole for maximum usable bowl and cabinet storage space• Compact size, X-pattern drain grooves• 15 mm radius corners for easy cleaning• 3 1/2" (90mm) stainless steel strainer included• Clips, template included• Limited Lifetime Warranty
DESIGN AND PLANNING TIPS			
Cabinet Size: 27" (685 mm) Bowl depth: 9" (230 mm) Depending on cabinet construction, a different cabinet size may be required. Consult the cabinet manufacturer.			

WARRANTY

Limited Lifetime warranty

Code/Standards Compliance

BLANCO sinks and faucets are third-party tested and certified to CSA, cUPC, ANSI/ASME and NSF standards and listed by applicable certification bodies. For more information on individual product listings, contact our office or listing organization.

BLANCO CANADA 100 Corporation Drive Brampton, ON L6S 6B5	Tel: 905 494 2400 Fax: 905 494 2425 www.blancocanada.com	Toll Free: 1 877 425 2626 Toll Free: 1 877 825 2626
--	--	--

90°™

Traditional | Transitional | Modern

Geometric forms, squared corners and straight lines create an urban focal point for today's contemporary baths.



Toilet Tank Lever
Model YB8801

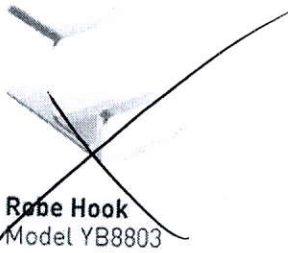

Robe Hook
Model YB8803



Cabinet Knob
Model YB8805

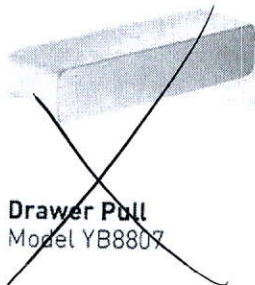

Drawer Pull
Model YB8807

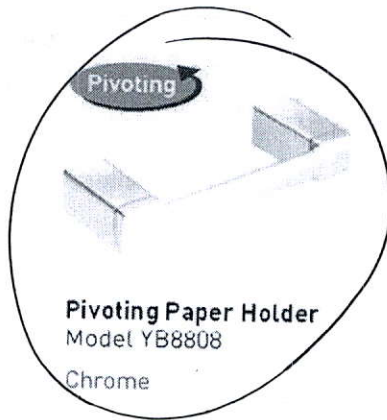

Pivoting Paper Holder
Model YB8808
Chrome



Mini Towel Bar
Model YB8886



18" Towel Bar
Model YB8818



24" Towel Bar
Model YB8824
Chrome

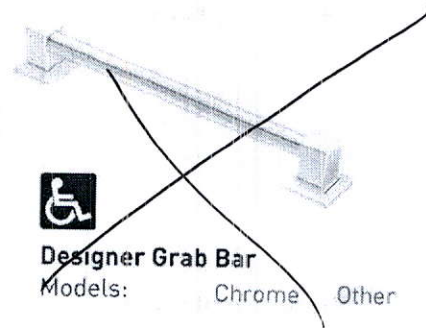

Designer Grab Bar
Models: Chrome Other

FINISH OPTIONS:

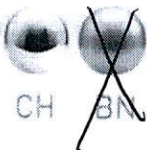

To order, combine the model number with one of these finish letter(s):
Chrome (CH), LifeShine® Brushed Nickel (BN).

SCHEDULE 'A'

330

RICHMOND

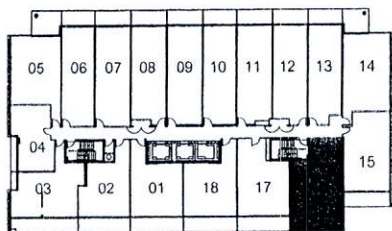
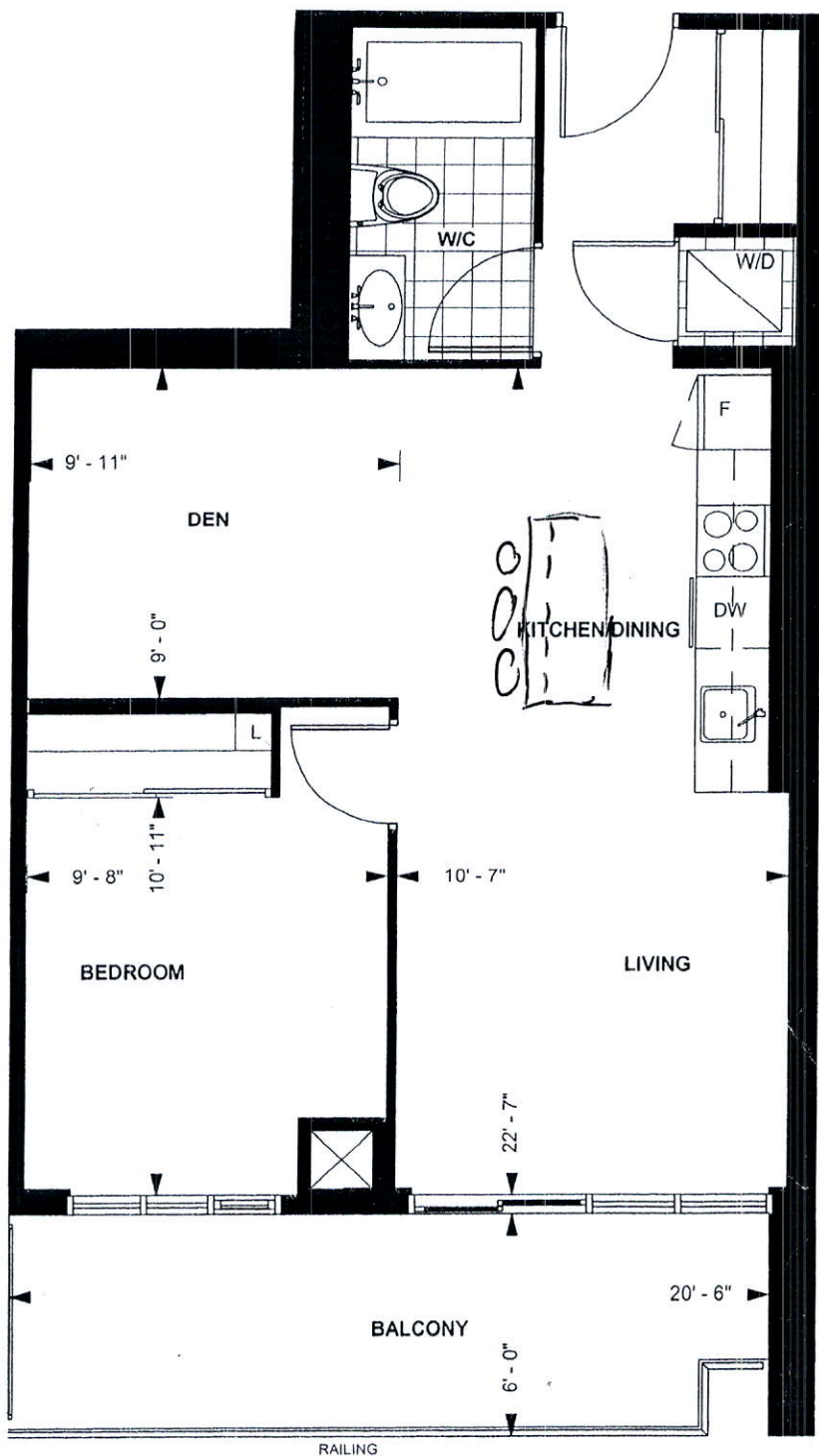

LEVEL 5 - 9

TOWER SUITE

C 658

9' CEILING *

658 sq. ft.

1-BEDROOM PLUS DEN

Purchaser Initials Purchaser Initials

Date

Unit No. 16 Level No. 9 Suite No. 1019

Dimensions, specification, tile floor pattern and architectural detailing (including window size and location) are approximate and subject to modifications without notice. Orientation of suite may vary from the stated floor area.

*Ceiling height measured from top of floor slab to underside of slab above before finishes, and excluding bulkheads and required drop ceilings. E.&O.E.

330 RICHMOND
SUITE 1019

PAULINE
MAR 23 19

THIS LAYOUT CONTAINS EXTRA
THAT ARE NOT PART OF CONTRACT

PROTOTYPE FOR EXTRAS

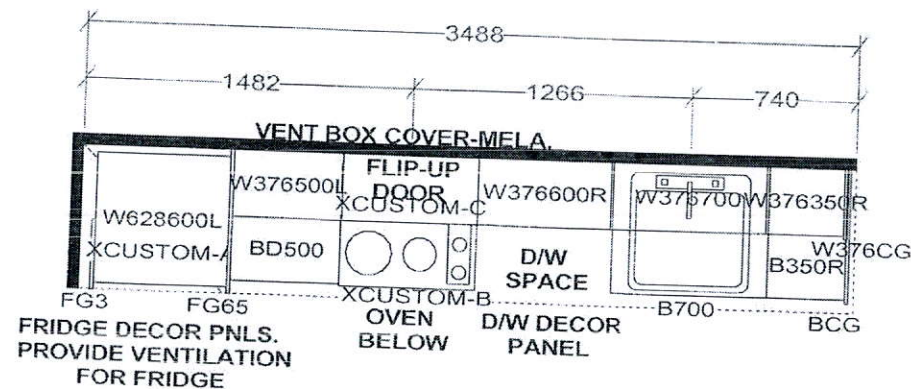

KITCHEN

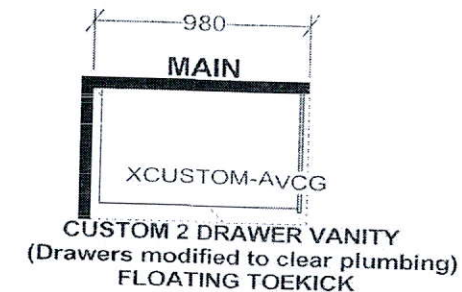
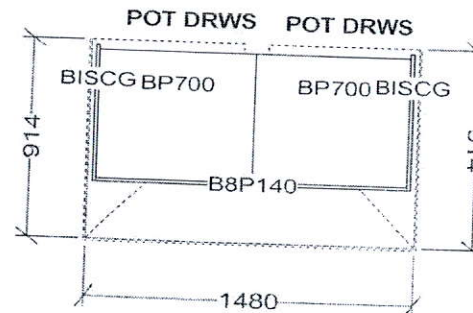

VANITY UPGRADE
TO 36" HIGH

APPLIANCE PACKAGE:

24" INTEGRATED FRIDGE W/ DECOR PNLS KITCHEN BASES & VANITIES INSTALLED
24" INTEGRATED DISHWASHER W/ DECOR PNL WITH ADJUSTABLE LEGS
24" BUILT-IN OVEN
24" COOKTOP
24" MICROWAVE HOOD FAN

Selba Industries

W WIDTH	W HGHT	W CNT	FL HGHT	DWY H	ST CENT	2X4	VENT BOX COVER
TOWER SUITES: 760MM HIGH UPPER CABINETS WHITE STEEL DRAWER BOXES COUNTERTOPS BY OTHERS VENT BOX COVERS CUSTOM VANITIES				This drawing is the intellectual property of SELBA INDUSTRIES INC. and is an original design which must not be released or copied unless applicable fee has been paid or job order placed.			
				JOB NUMBER: BUILDER: GREENPARK SITE NAME: PETALUMA MODEL: 1 BEDROOM + DEN - C 658 LOT #: DESIGNER: KS DATE: JAN 8 18			



Frameless Minor Sliding Door with Minor Fascia - \$650