

<div>CONSTRUCTION SUMMARY</div> <div>330 Richmond - Petaluma Building Corp.</div>			
PURCHASER: Maria Assunta CANDITO			TEL:
Unit 8, Level 15 (1809-1)	Floor Plan E698		

CABINETRY

1 - KITCHEN - 41" UPPER CABINETRY	
13Mar19 Note:	

CERAMIC TILE

1 - DELETE STANDARD WHITE CERAMIC ACCESSORIES - DO NOT INTSTALL SOAP DISH, TOWEL RACK OR TISUE HOLDER	
13Mar19 Note:	

CONSTRUCTION

2 - BEDROOMS - SMOOTH CEILING	
13Mar19 Note:	

COUNTER TOP

1 - KITCHEN - HIGH-END QUARTZ COUNTERTOP IN LIEU OF STANDARD AS PER OFFER	
13Mar19 Note:	
2 - BATHROOMS - UPGRADED EDGE ON COUNTERTOP	
13Mar19 Note:	
1 - KICTHEN - UPGRADED EDGE ON COUNTERTOP	
13Mar19 Note:	

MISCELLANEOUS

1 - COLOUR CHANGE ADMINISTRATION FEE	
13Mar19 Note:	

PLUMBING

2 - BATHROOMS - MOEN 90 DEGREE BATHROOM ACCESSORIES - CHROME TOILET PAPER HOLDER #YB8808 TOWEL RING #YB8886 TOWEL BAR #YB8824	
13Mar19 Note:	

PROMOTIONAL

1 - LESS CREDIT FROM PURCAHSERS EXTRA SHEET AS PER OFFER	
13Mar19 Note:	

EXTRAS AS PER OFFER

The Vendor agrees that notwithstanding any other term or provision in this Agreement included in the Purchase Price and in addition to those items detailed in Schedule D to the Agreement of Purchase and Sale, the Purchaser is entitled to a credit of Fiv	
Worksheet Note:	
1 Parking Unit	
Worksheet Note:	

This Document is Extremely Time Sensitive - Printed 13 Mar 19 at 10:36

RECEIVED MAR 13 2019

Purchaser: Maria Assunta CANDITO

Const. No.: Unit 8, Level 15

Telephone Res. / Bus: /

Municipal: 1809

Decor Advisor: Candace Forza

Suite Type: E698

Lock Date: 3/13/2019 10:31:49

Project/Phase: Petaluma Building Corp./1

Layout Changes: ☐ Yes ☒ No

Sketch Attached: ☒ Yes ☐ No

Exterior Colour Scheme:

1. Kitchen and Vanities	Style and Colour	Counter	Hardware
Kitchen / Breakfast	SEE BELOW	QUARTZ-FROSTY CARRARA-#360 EDGE	STD
Main Bath	DORAL 1267-SAND MOLINA ASH	QUARTZ-TORRONE-#360 EDGE	STD
Master Ensuite Bathroom	DORAL 1267-SAND MOLINA ASH	QUARTZ-TORRONE-#360 EDGE	STD
	N/A	N/A	N/A

Appliances:

Built In Appliances ☒ Yes ☐ No

41" Upper Cabinets ☒ Yes ☐ No

Slide In Stove ☐ Yes ☒ No

Comment

KITCHEN CABINETRY - BASE DORAL 1267-SAND MOLINA ASH - UPPERS SENOSAN WHITE

2. Flooring		Grout-If App.	At a 45
Entrance Vestibule	STRIP-MIRAGE-LOCK-RED OAK-RIO-CASHMERE-4 5/16"		<input type="checkbox"/>
Main Hall	STRIP-MIRAGE-LOCK-RED OAK-RIO-CASHMERE-4 5/16"		<input type="checkbox"/>
Kitchen / Breakfast	STRIP-MIRAGE-LOCK-RED OAK-RIO-CASHMERE-4 5/16"		<input type="checkbox"/>
Laundry Room	TILE-WHITE-8X8	STANDARD	<input type="checkbox"/>
Main Bath	TILE-ASPEN BIANCO-12X24	STANDARD	<input type="checkbox"/>
Master Ensuite Bathroom	TILE-ASPEN BIANCO-12X24	STANDARD	<input type="checkbox"/>
	N/A		<input type="checkbox"/>
Living Room	STRIP-MIRAGE-LOCK-RED OAK-RIO-CASHMERE-4 5/16"		<input type="checkbox"/>
Dining Room	STRIP-MIRAGE-LOCK-RED OAK-RIO-CASHMERE-4 5/16"		<input type="checkbox"/>
Den / Library / Study	N/A		<input type="checkbox"/>
Master Bedroom	STRIP-MIRAGE-LOCK-RED OAK-RIO-CASHMERE-4 5/16"		<input type="checkbox"/>
Bedroom #2	STRIP-MIRAGE-LOCK-RED OAK-RIO-CASHMERE-4 5/16"		<input type="checkbox"/>
Bedroom #3	N/A		<input type="checkbox"/>
			<input type="checkbox"/>

Comment

3. Wall Tile	Selection	Grout	Describe
Main Bath			
Tub Deck Wall	N/A		
Shower Stall	TILE-GLOSSY WHITE-3X6	STANDARD	
Bathtub Enclosure Walls	N/A		
Master Ensuite Bathroom			
Tub Deck Wall	N/A		
Shower Stall	N/A		
Bathtub Enclosure Walls	TILE-GLOSSY WHITE-3X6	STANDARD	
Kitchen Backsplash	BACK PAINTED GLASS-BM-#OC-16	STANDARD	
Backsplash Behind Fridge	N/A		

Comment

** Refer to Construction Summary

4. Misc

Water Line for Fridge

N/A

Interior Door Handles

AS PER CONSTRUCTION SPECS

Ceramic Bathroom Accessories

NO - UPGRADED - MOEN 90 DEGREE

☐ Yes ☒ No

Comment

Initial: 

Purchaser: Maria Assunta CANDITO
Telephone Res. / Bus: /
Decor Advisor: Candace Forza
Lock Date: 3/13/2019 10:31:49

Const. No.: Unit 8, Level 15
Municipal: 1809
Suite Type: E698
Project/Phase: Petaluma Building Corp./1

5. Plaster Mouldings and Medallions

Entrance Vestibule	N/A		Living Room	N/A	
Main Hall	N/A		Dining Room	N/A	
Kitchen/Breakfast	N/A		Den / Library /Study	N/A	
Laundry Room	N/A		Master BedRoom	N/A	
Main Bath	N/A		BedRoom #2	N/A	
Master Ensuite Bathroom	N/A		BedRoom #3	N/A	
	N/A				

Comment
** Refer to Construction Summary

6. Wall Paint

Entrance Vestibule	43-BIRCH WHITE	Living Room	43-BIRCH WHITE
Main Hall	43-BIRCH WHITE	Dining Room	43-BIRCH WHITE
Kitchen / Breakfast	43-BIRCH WHITE	Den/Library	N/A
Laundry Room	43-BIRCH WHITE	Master Bedroom	43-BIRCH WHITE
Main Bath	43-BIRCH WHITE	Bedroom #2	43-BIRCH WHITE
Master Ensuite	43-BIRCH WHITE	Bedroom #3	N/A
	N/A		

Comment

7. General Comments

** Refer to Construction Summary

Disclaimers and Notes

- 1) Colours of all materials are as close as possible to builder's selection, but not necessarily identical due to variances in manufacturing.
- 2) Any extras listed above are null and void unless accompanied by a separate invoice/amendment. Said invoice must be paid in full.
- 3) The Purchaser agrees that this colour selection is final and that no changes will be permitted, unless required by the Vendor.
- 4) The Purchaser acknowledges reading and accepting document which contains other miscellaneous disclaimers.

Signature:  Date: March 13/19 Signature: _____ Date: _____

90°™

Traditional | Transitional | Modern

Geometric forms, squared corners and straight lines create an urban focal point for today's contemporary baths.



Toilet Tank Lever
Model YB8801



Robe Hook
Model YB8803



Cabinet Knob
Model YB8805

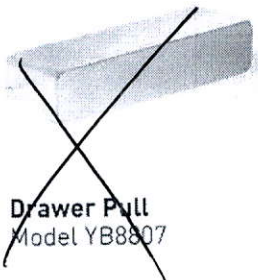

Drawer Pull
Model YB8807

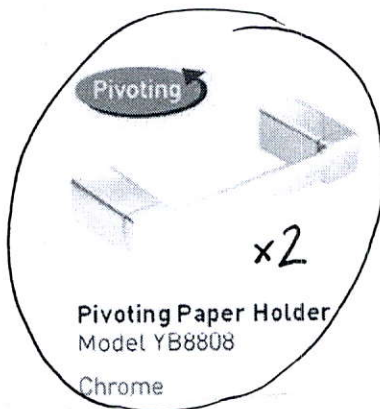

Pivoting Paper Holder
Model YB8808
Chrome

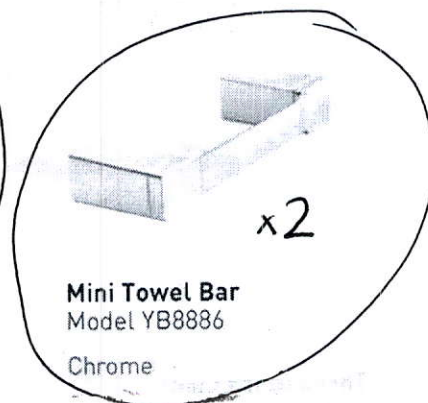

Mini Towel Bar
Model YB8886
Chrome

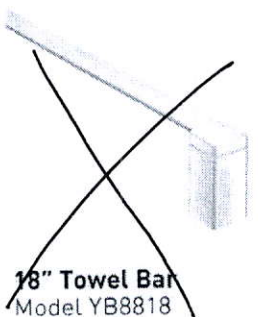

18" Towel Bar
Model YB8818

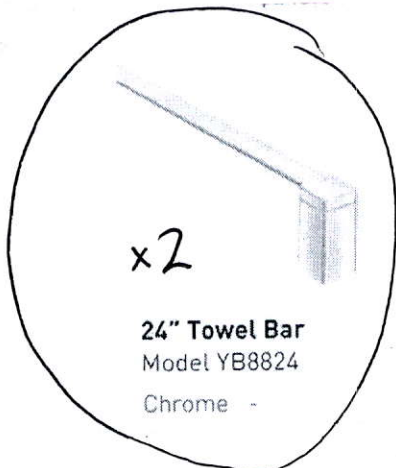

24" Towel Bar
Model YB8824
Chrome

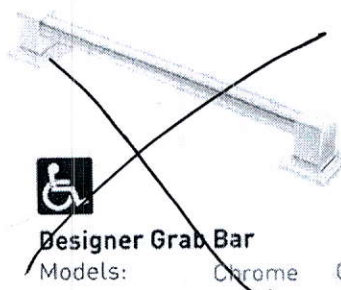

Designer Grab Bar
Models: Chrome Other

FINISH OPTIONS:

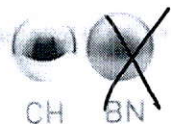

CH

BN

To order, combine the model number with one of these finish letter(s):
Chrome (CH), LifeShine® Brushed Nickel (BN).

SCHEDULE 'A'

330

RICHMOND

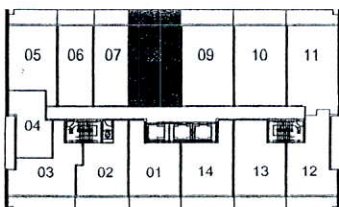
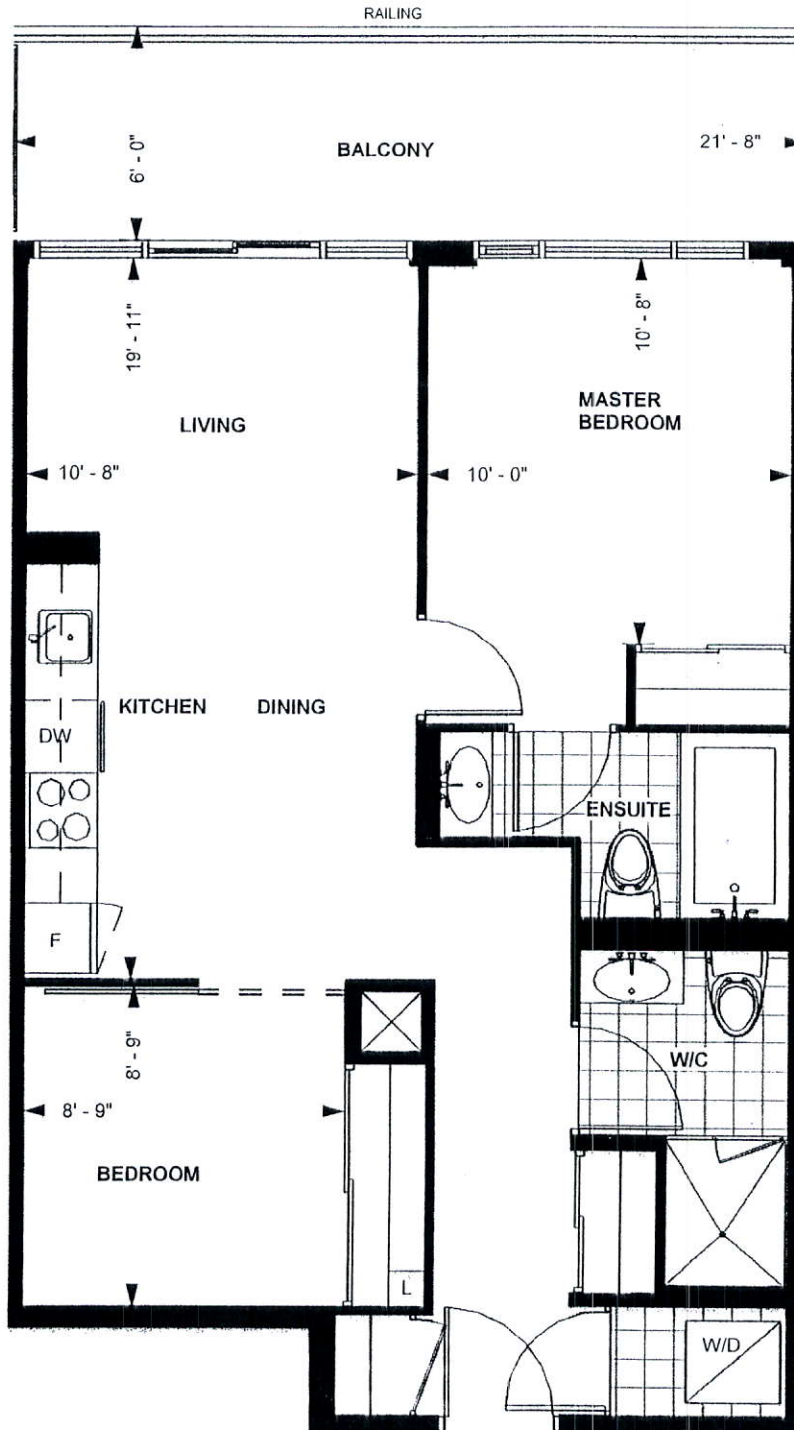

LEVEL 13-20

TOWER SUITE

E 698

9' CEILING *

698 sq. ft.

2-BEDROOM

M.C.

Purchaser Initials Purchaser Initials

Sept 30 15

Date

Unit No. 8 Level No. 15 Suite No. 1809

Dimensions, specification, tile floor pattern and architectural detailing (including window size and location) are approximate and subject to modifications without notice. Orientation of suite may vary from the stated floor area.
*Ceiling height measured from top of floor slab to underside of slab above before finishes, and excluding bulkheads and required drop ceilings. E.&O.E.

* Upgrade Edge throughout Kitchen & Baths
countertop

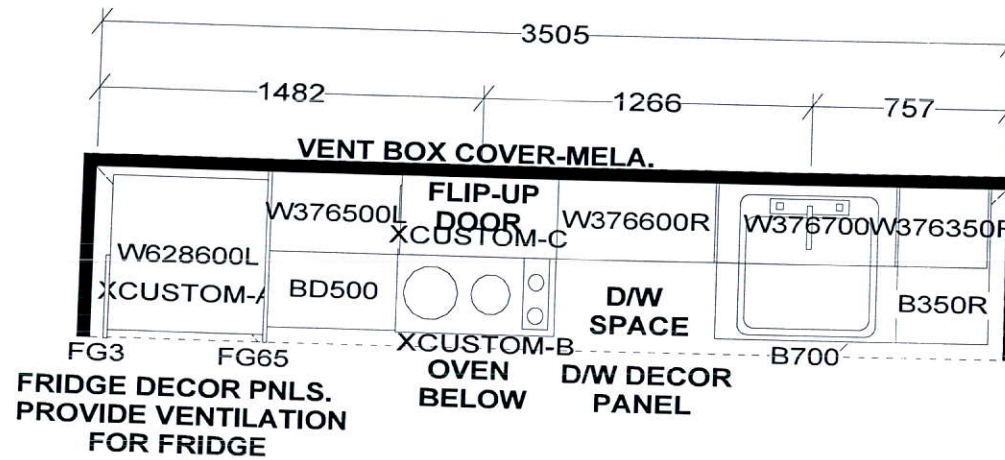

KITCHEN

KITCHEN BASES & VANITIES INSTALLED
WITH ADJUSTABLE LEGS

APPLIANCE PACKAGE:
24" INTEGRATED FRIDGE W/ DECOR PNLS
24" INTEGRATED DISHWASHER W/ DECOR PNL
24" BUILT-IN OVEN
24" COOKTOP
24" MICROWAVE HOOD FAN

Selba Industries

WDTH W HGHT W CNT FL HGHT DWY H ST CENT 2X4 VENT BOX COVER

TOWER SUITES:
760MM HIGH UPPER CABINETS
WHITE STEEL DRAWER BOXES
COUNTERTOPS BY OTHERS
VENT BOX COVERS
CUSTOM VANITIES

This drawing is the intellectual property of
SELBA INDUSTRIES INC. and is an
original design which must not be released
or copied unless applicable fee has been
paid or job order placed.



JOB NUMBER:
BUILDER: GREENPARK
SITE NAME: PETALUMA
MODEL: 2 BEDROOM - E 698
LOT #:
DESIGNER: KS
DATE: JAN 8 18

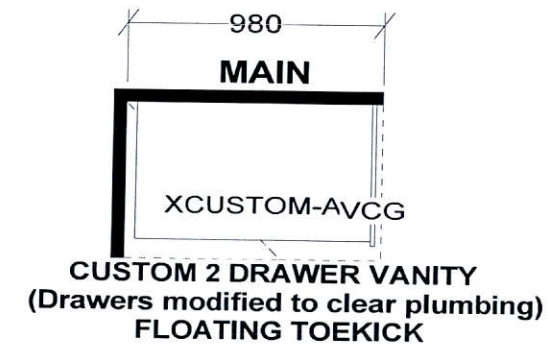

41" upper
cabinetry.

