

CONSTRUCTION SUMMARY			
330 Richmond - Petaluma Building Corp.			
PURCHASER: 2120070 ONTARIO INC.			TEL:
Unit 13, Level 13 (1616-1)	Floor Plan C649		

CABINETRY

1 - KITCHEN 41" UPPER CABINETS	
11Mar19 Note:	

CONSTRUCTION

1 - SMOOTH CEILING IN BEDROOM	
11Mar19 Note:	

COUNTER TOP

1 - UPGRADE COUNTERTOP EDGE KITCHEN AND BATHROOM	
11Mar19 Note:	
1 - UPGRADE COUNTERTOP IN BATHROOM	
11Mar19 Note:	
1 - UPGRADE COUNTERTOP IN KITCHEN	
11Mar19 Note:	

MIRRORS AND GLASS

1 - KITCHEN BACKSPLASH - EXTEND GLASS BACKSPLASH TO SIDE WALL WHERE DISHWASHER IS	
11Mar19 Note:	

MISCELLANEOUS

1 - FURTHER VENDOR DISCOUNT	
11Mar19 Note:	
1 - PACKAGE CHANGE FEE	
11Mar19 Note:	

PLUMBING

1 - UPGRADE BATHROOM ACCESSORIES- MOEN 90 DEGREE TOILET PAPER HOLDER #Z3YB8808	
90 DEGREE TOWEL RING #YB8886	
90 DEGREE 24" TOWEL BAR #YB8824	
11Mar19 Note:	

PROMOTIONAL

1 - LESS CREDIT IN OFFER FROM PURCHASERS EXTR SHEET	
11Mar19 Note:	

EXTRAS AS PER OFFER

The Vendor agrees that notwithstanding any other term or provision in this Agreement included in the Purchase Price and in addition to those items detailed in Schedule D to the Agreement of Purchase and Sale, the Purchaser is entitled to a credit of Fiv	
Worksheet Note:	

This Document is Extremely Time Sensitive - Printed 11 Mar 19 at 11:37

RECEIVED MAR 12 2019

Purchaser:2120070 ONTARIO INC.

Telephone Res. / Bus: /

Decor Advisor:Natalie Mancuso

Lock Date:3/11/2019 11:36:13

Const. No.: Unit 13, Level 13

Municipal: 1616

Suite Type: C649

Project/Phase: Petaluma Building Corp./1

Layout Changes:☐ Yes☒ No

Sketch Attached:☒ Yes☐ No

Exterior Colour Scheme:

1. Kitchen and Vanities	Style and Colour	Counter	Hardware
Kitchen / Breakfast	SEE BELOW	QUARTZ- VIRGINIA-#360 EDGE	STD
Main Bath	DORAL H3078 HACIENDA WHITE	QUARTZ- VIRGINIA-#360 EDGE	STD
Master Ensuite Bathroom			

Appliances:

Built In Appliances☒ Yes☐ No

41" Upper Cabinets☒ Yes☐ No

Slide In Stove☐ Yes☒ No

Comment

KITCHEN UPPER CABINETS- SENOSAN WHITE

KITCHEN BASE CABINETS- DORAL 1267 SAND MOLINA ASH

2. Flooring		Grout-If App.	At a 45
Entrance Vestibule	HARDWOOD- MIRAGE 4 5/16 LOCK RED OAK- RIO- CASHMERE		
Main Hall	HARDWOOD- MIRAGE 4 5/16 LOCK RED OAK- RIO- CASHMERE		
Kitchen / Breakfast	HARDWOOD- MIRAGE 4 5/16 LOCK RED OAK- RIO- CASHMERE		
Laundry Room	TILE- MATTE WHITE 8X8	STD	
Main Bath	TILE- ASPEN BIANCO 12X24	STD	
Master Ensuite Bathroom			
Living Room	HARDWOOD- MIRAGE 4 5/16 LOCK RED OAK- RIO- CASHMERE		
Dining Room	HARDWOOD- MIRAGE 4 5/16 LOCK RED OAK- RIO- CASHMERE		
Den / Library / Study	HARDWOOD- MIRAGE 4 5/16 LOCK RED OAK- RIO- CASHMERE		
Master Bedroom	HARDWOOD- MIRAGE 4 5/16 LOCK RED OAK- RIO- CASHMERE		
Bedroom #2			
Bedroom #3			

Comment

3. Wall Tile	Selection	Grout	Describe
Main Bath			
Tub Deck Wall			
Shower Stall			
Bathtub Enclosure Walls	TILE- GLOSSY WHITE 3X6 VERTICAL	STD	
Master Ensuite Bathroom			
Tub Deck Wall			
Shower Stall			
Bathtub Enclosure Walls			
Kitchen Backsplash	PAINTED GLASS BM#OC-16		
Backsplash Behind Fridge			

Comment

** Refer to Construction Summary

4. Misc	
Water Line for Fridge	NO
Interior Door Handles	STANDARD
Ceramic Bathroom Accessories	MOEN 90 DEGREE CHROME
Comment	

Initial: 

Page 1 of 2

Purchaser: 2120070 ONTARIO INC.
Telephone Res. / Bus: /
Decor Advisor: Natalie Mancuso
Lock Date: 3/11/2019 11:36:13

Const. No.: Unit 13, Level 13
Municipal: 1616
Suite Type: C649
Project/Phase: Petaluma Building Corp./1

5. Plaster Mouldings and Medallions

Entrance Vestibule
Main Hall
Kitchen/Breakfast
Laundry Room
Main Bath
Master Ensuite Bathroom

Living Room
Dining Room
Den / Library /Study
Master BedRoom
BedRoom #2
BedRoom #3

Comment
** Refer to Construction Summary

6. Wall Paint

Entrance Vestibule
Main Hall
Kitchen / Breakfast
Laundry Room
Main Bath
Master Ensuite

BIRCH WHITE
BIRCH WHITE
BIRCH WHITE
BIRCH WHITE
BIRCH WHITE

Living Room
Dining Room
Den/Library
Master Bedroom
Bedroom #2
Bedroom #3

BIRCH WHITE
BIRCH WHITE
BIRCH WHITE
BIRCH WHITE

Comment

7. General Comments

** Refer to Construction Summary

Disclaimers and Notes

- 1) Colours of all materials are as close as possible to builder's selection, but not necessarily identical due to variances in manufacturing.
- 2) Any extras listed above are null and void unless accompanied by a separate invoice/amendment. Said invoice must be paid in full.
- 3) The Purchaser agrees that this colour selection is final and that no changes will be permitted, unless required by the Vendor.
- 4) The Purchaser acknowledges reading and accepting document which contains other miscellaneous disclaimers.

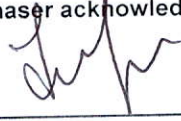
Signature:  Date: Mar. 11, 2019 Signature: _____ Date: _____

Initial: 

90°™

Traditional | Transitional | Modern

Geometric forms, squared corners and straight lines create an urban focal point for today's contemporary baths.

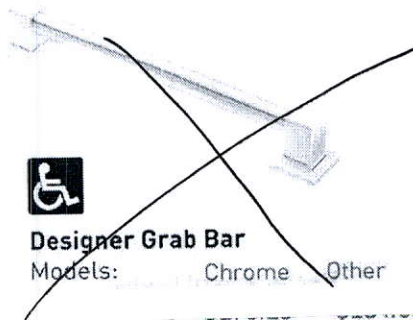
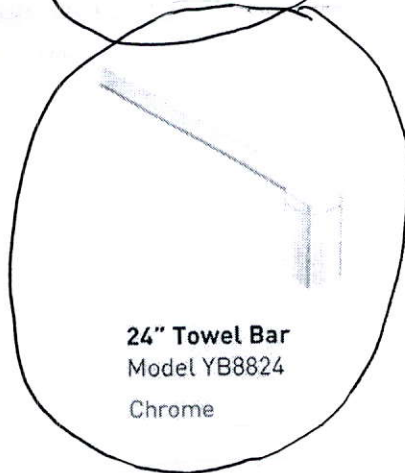
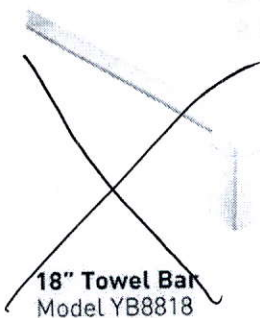
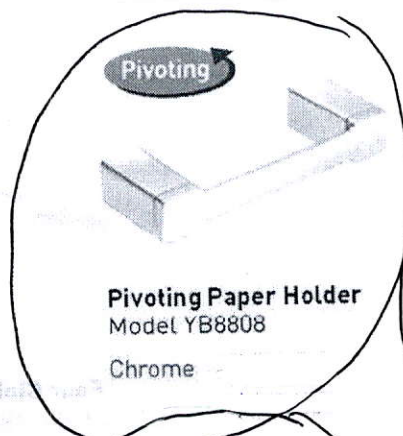
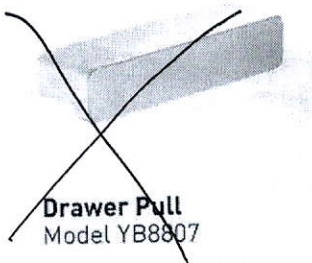
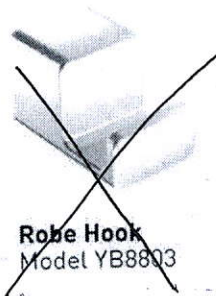
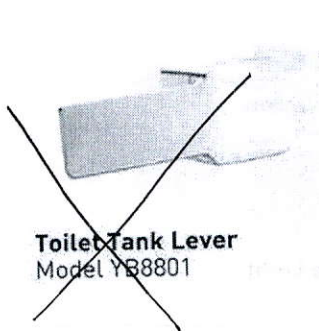

FINISH OPTIONS:



To order, combine the model number with one of these finish letter(s):
Chrome (CH), LifeShine® Brushed Nickel (BN).

SCHEDULE 'A'

330
RICHMOND

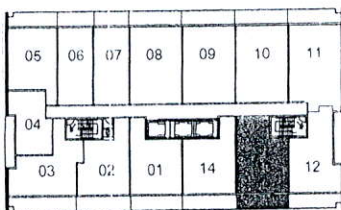
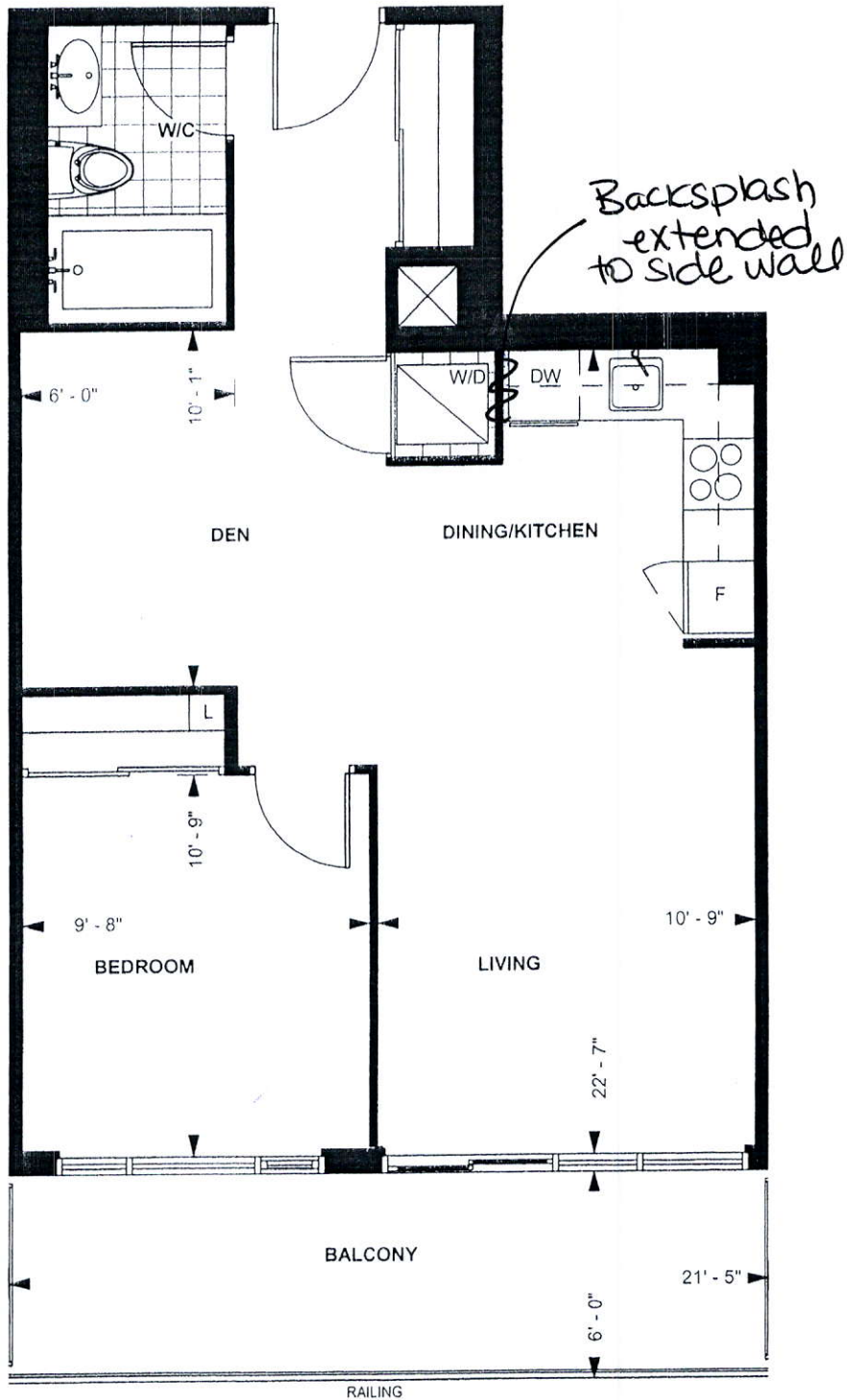

LEVEL 13-20

TOWER SUITE

C 649

9' CEILING *

649 sq. ft.

1-BEDROOM PLUS DEN

Purchaser Initials Purchaser Initials

Date

Unit No. 13 Level No. 13 Suite No. 1616

Dimensions, specification, tile floor pattern and architectural detailing (including window size and location) are approximate and subject to modifications without notice. Orientation of suite may vary from the stated floor area.
*Ceiling height measured from top of floor slab to underside of slab above before finishes, and excluding bulkheads and required drop ceilings. E.&O.E.

SW

Oct. 15, 2015

* Upgrade countertop Edge
in Kitchen & Bath

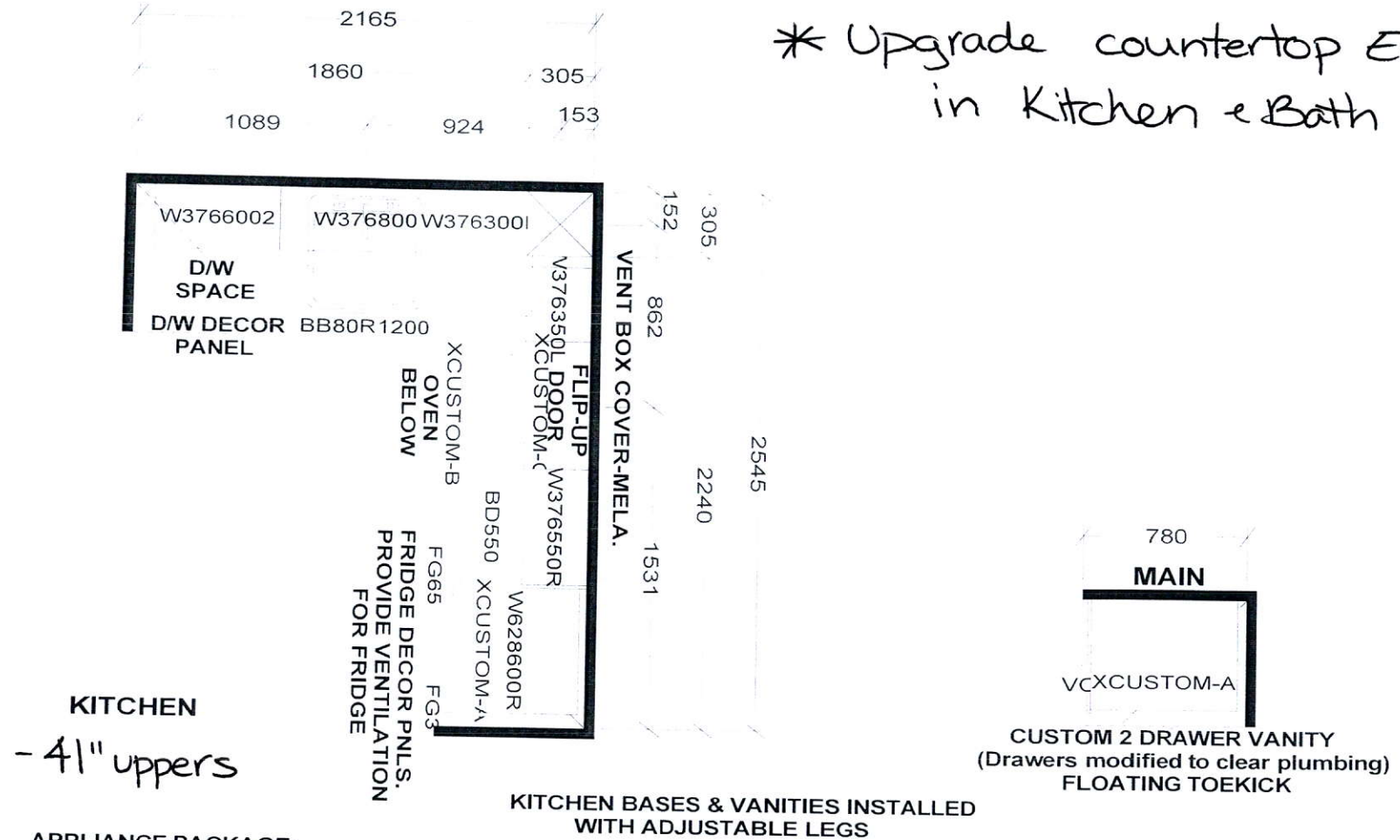

Selba Industries

W WIDTH _____ W HGHT _____ W CNT _____ FL HGHT _____ DWY H _____ ST CENT 2X4 _____ VENT BOX COVER _____

TOWER SUITES:
760MM HIGH UPPER CABINETS
WHITE STEEL DRAWER BOXES
COUNTERTOPS BY OTHERS
VENT BOX COVERS
CUSTOM VANITIES

This drawing is the intellectual property of
SELBA INDUSTRIES INC. and is an
original design which must not be released
or copied unless applicable fee has been
paid or job order placed.



JOB NUMBER:
BUILDER: GREENPARK
SITE NAME: PETALUMA
MODEL: 1 BEDROOM + DEN - C 649
LOT #:
DESIGNER: KS
DATE: JAN 8 18