



|   |                    |                         |  |
|---|--------------------|-------------------------|--|
| <div>CONSTRUCTION SUMMARY</div> <div>330 Richmond - Petaluma Building Corp.</div> |                    |                         |  |
| PURCHASER: 2013973 ONTARIO LIMITED  |                    | TEL: RES.: 416-725-9775 |  |
| Unit 7, Level 13 (1608-1)   | Floor Plan<br>B493 |                         |  |

CABINETRY

|   |  |
|---|--|
| I - 41" UPPER KITCHEN CABINETS<br>04Mar19 Note: |  |
|---|--|

CONSTRUCTION

|  |  |
|--|--|
| I - SMOOTH CEILING IN BEDROOM<br>04Mar19 Note:   |  |
| I - MAIN BATH - 5 FOOT SHOWER WITH SLIDING CHROME FRAMED GLASS DOORS IN LIEU OF TUB<br>12Mar18 Note: |  |

COUNTER TOP

|   |  |
|---|--|
| I - UPGRADE COUNTERTOP EDGE IN KITCHEN<br>04Mar19 Note: |  |
|---|--|

MISCELLANEOUS

|  |  |
|--|--|
| <del>I - 1/2" BATHROOM DOWN SINK ATTACHED TO SHOWER IN RE-BATHED UNIT B-2700</del><br><del>04Mar19 Note:</del> |  |
|--|--|

PLUMBING

|  |  |
|--|--|
| I - UPGRADE BATHROOM ACCESSORIES- MOEN<br>90 DEGREE TOILET PAPER HOLDER #YB8808 CHROME<br>90 DEGREE TOWEL RING #YB8886 CHROME<br>04Mar19 Note: |  |
|--|--|

PROMOTIONAL

|  |  |
|--|--|
| I - LESS CREDIT FROM PURCHASER EXTRA SHEET IN OFFER<br>04Mar19 Note:   |  |
| I - PARTIAL REDEPTION OF PROMOTIONAL PACKAGE \$1,400 BALANCE (\$3,600) FORWARD TO BE USED AT A LATER DATE. ORIGINAL PROMOTIONAL PACKAGE OF \$5,000 AS PER SCHEDULE PE DATED OCTOBER 26, 2015.<br>12Mar18 Note: |  |

EXTRAS AS PER OFFER

|  |  |
|--|--|
| The Vendor agrees that notwithstanding any other term or provision in this Agreement included in the Purchase Price and in addition to those items detailed in Schedule D to the Agreement of Purchase and Sale, the Purchaser is entitled to a credit of Fiv<br>Worksheet Note: |  |
|--|--|

This Document is Extremely Time Sensitive - Printed 4 Mar 19 at 11:10

RECEIVED MAR 04 2019

Purchaser:2013973 ONTARIO LIMITED

Const. No.: Unit 7, Level 13

Telephone Res. / Bus: (416) 725-9775 /

Municipal: 1608

Decor Advisor: Natalie Mancuso

Suite Type: B493

Lock Date: 3/4/2019 11:10:06

Project/Phase: Petaluma Building Corp./1

Layout Changes: ☒ Yes ☐ No

Sketch Attached: ☒ Yes ☐ No

Exterior Colour Scheme:

1. Kitchen and Vanities

|                         | Style and Colour           | Counter                                 | Hardware |
|-------------------------|----------------------------|---|----------|
| Kitchen / Breakfast     | SEE BELOW                  | QUARTZ- TORRONE- #360 EDGE              | STD      |
| Main Bath               | DORAL H3078 HACIENDA WHITE | QUARTZ- TORRONE- STRAIGHT POLISHED EDGE | STD      |
| Master Ensuite Bathroom |                            |   |          |
|                         |                            |   |          |

Appliances:

Built In Appliances ☒ Yes ☐ No

41" Upper Cabinets ☒ Yes ☐ No

Slide In Stove ☐ Yes ☒ No

Comment

KITCHEN UPPER CABINETS- SENOSAN WHITE

KITCHEN BASE CABINETS- DORAL H3078 HACIENDA WHITE

2. Flooring

|                         |  | Grout-If App. | At a 45                  |
|-------------------------|--|---------------|--------------------------|
| Entrance Vestibule      | HARDWOOD- MIRAGE 4 5/16 LOCK RED OAK- NORDIC- CASHMERE |               | <input type="checkbox"/> |
| Main Hall               | HARDWOOD- MIRAGE 4 5/16 LOCK RED OAK- NORDIC- CASHMERE |               | <input type="checkbox"/> |
| Kitchen / Breakfast     | HARDWOOD- MIRAGE 4 5/16 LOCK RED OAK- NORDIC- CASHMERE |               | <input type="checkbox"/> |
| Laundry Room            | TILE- LIFE SILVER 12X24                                | STD           | <input type="checkbox"/> |
| Main Bath               | TILE- LIFE SILVER 12X24                                | STD           | <input type="checkbox"/> |
| Master Ensuite Bathroom |  |               | <input type="checkbox"/> |
|                         |  |               | <input type="checkbox"/> |
| Living Room             | HARDWOOD- MIRAGE 4 5/16 LOCK RED OAK- NORDIC- CASHMERE |               | <input type="checkbox"/> |
| Dining Room             | HARDWOOD- MIRAGE 4 5/16 LOCK RED OAK- NORDIC- CASHMERE |               | <input type="checkbox"/> |
| Den / Library / Study   |  |               | <input type="checkbox"/> |
| Master Bedroom          | HARDWOOD- MIRAGE 4 5/16 LOCK RED OAK- NORDIC- CASHMERE |               | <input type="checkbox"/> |
| Bedroom #2              |  |               | <input type="checkbox"/> |
| Bedroom #3              |  |               | <input type="checkbox"/> |

Comment

3. Wall Tile

|                          | Selection              | Grout | Describe |
|--------------------------|------------------------|-------|----------|
| Main Bath                |                        |       |          |
| Tub Deck Wall            |                        |       |          |
| Shower Stall             | TILE- GLOSSY WHITE 3X6 | STD   |          |
| Bathtub Enclosure Walls  |                        |       |          |
| Master Ensuite Bathroom  |                        |       |          |
| Tub Deck Wall            |                        |       |          |
| Shower Stall             |                        |       |          |
| Bathtub Enclosure Walls  |                        |       |          |
| Kitchen Backsplash       | PAINTED GLASS BM#OC-16 |       |          |
| Backsplash Behind Fridge |                        |       |          |

Comment

\*\* Refer to Construction Summary

4. Misc

Water Line for FridgeNO

Interior Door HandlesSTANDARD

Ceramic Bathroom AccessoriesUPG MOEN TOILET HOLDER AND TOWEL RING ONLY ☐ Yes ☒ No

Comment

Initial:



Purchaser: 2013973 ONTARIO LIMITED  
Telephone Res. / Bus: (416) 725-9775 /  
Decor Advisor: Natalie Mancuso  
Lock Date: 3/4/2019 11:10:06

Const. No.: Unit 7, Level 13  
Municipal: 1608  
Suite Type: B493  
Project/Phase: Petaluma Building Corp./1

5. Plaster Mouldings and Medallions

|                         |  |                      |  |
|-------------------------|--|----------------------|--|
| Entrance Vestibule      |  | Living Room          |  |
| Main Hall               |  | Dining Room          |  |
| Kitchen/Breakfast       |  | Den / Library /Study |  |
| Laundry Room            |  | Master BedRoom       |  |
| Main Bath               |  | BedRoom #2           |  |
| Master Ensuite Bathroom |  | BedRoom #3           |  |

Comment  
\*\* Refer to Construction Summary

6. Wall Paint

|                     |             |                |             |
|---------------------|-------------|----------------|-------------|
| Entrance Vestibule  | BIRCH WHITE | Living Room    | BIRCH WHITE |
| Main Hall           | BIRCH WHITE | Dining Room    | BIRCH WHITE |
| Kitchen / Breakfast | BIRCH WHITE | Den/Library    |             |
| Laundry Room        | BIRCH WHITE | Master Bedroom | BIRCH WHITE |
| Main Bath           | BIRCH WHITE | Bedroom #2     |             |
| Master Ensuite      |             | Bedroom #3     |             |

Comment

7. General Comments

\*\* Refer to Construction Summary

Disclaimers and Notes

- 1) Colours of all materials are as close as possible to builder's selection, but not necessarily identical due to variances in manufacturing.
- 2) Any extras listed above are null and void unless accompanied by a separate invoice/amendment. Said invoice must be paid in full.
- 3) The Purchaser agrees that this colour selection is final and that no changes will be permitted, unless required by the Vendor.
- 4) The Purchaser acknowledges reading and accepting document which contains other miscellaneous disclaimers.

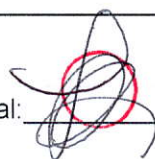
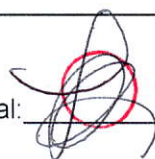
Signature:  Date: 03/04/19 Signature:  Date:   
Initial: 

# 90°™

Traditional | Transitional | Modern

*Geometric forms, squared corners and straight lines create an urban focal point for today's contemporary baths.*

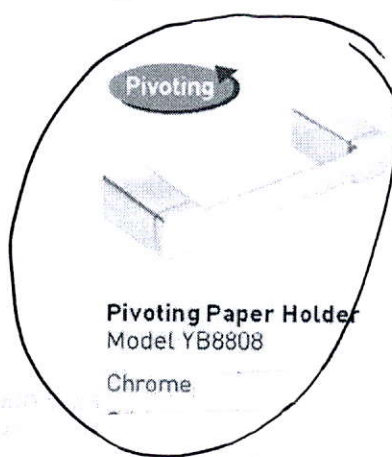
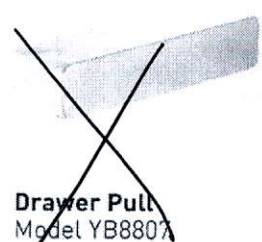
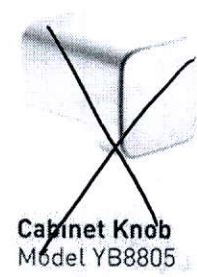
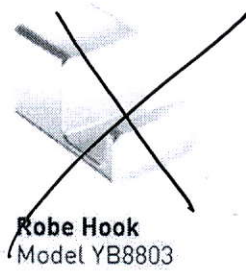

## FINISH OPTIONS:



To order, combine the model number with one of these finish letter(s):  
Chrome (CH), LifeShine® Brushed Nickel (BN).

# SCHEDULE 'A'

## 330

RICHMOND

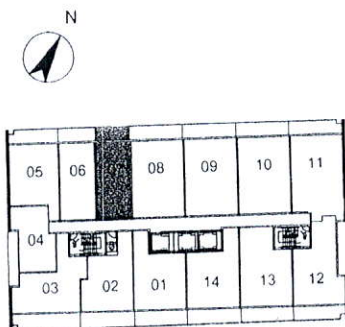
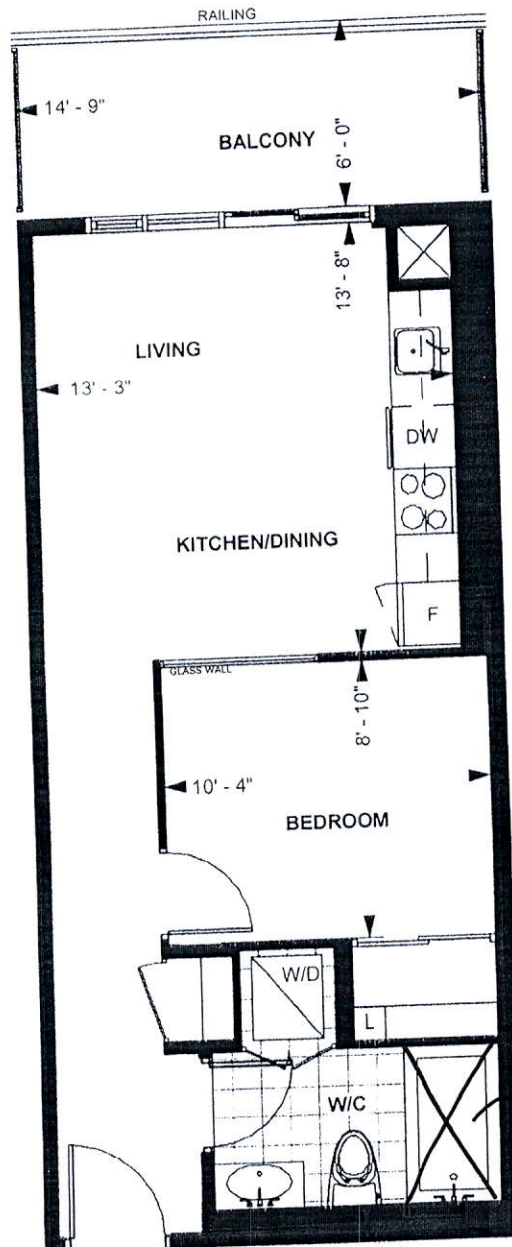

LEVEL 13-20

TOWER SUITE  
B 493

9' CEILING \*

493 sq. ft.

1-BEDROOM

Purchaser Initials Purchaser Initials

Date

Unit No. 7 Level No. 13 Suite No. 1608

Dimensions, specification, tile floor pattern and architectural detailing (including window size and location) are approximate and subject to modifications without notice. Orientation of suite may vary from the stated floor area.

\*Ceiling height measured from top of floor slab to underside of slab above before finishes, and excluding bulkheads and required drop ceilings. E.&O.E.



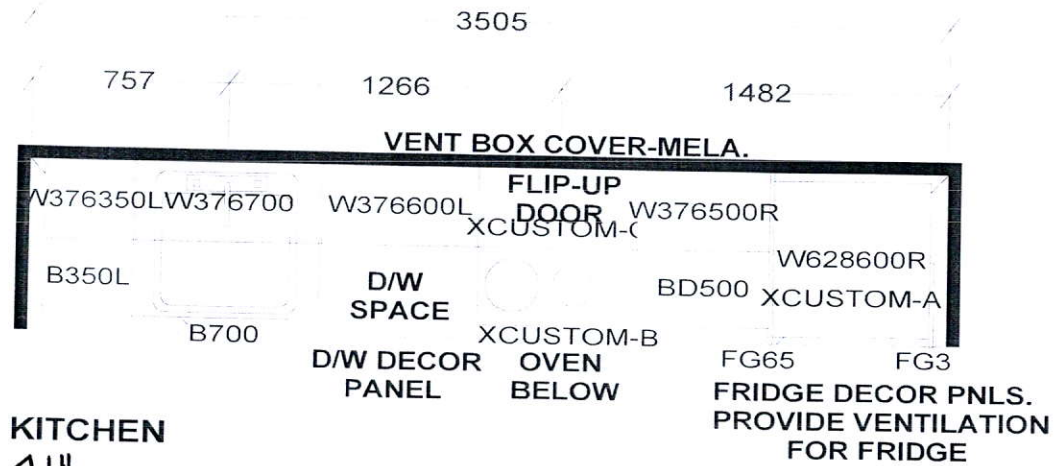

KITCHEN  
 - 41" upper  
 - up. counter Edge

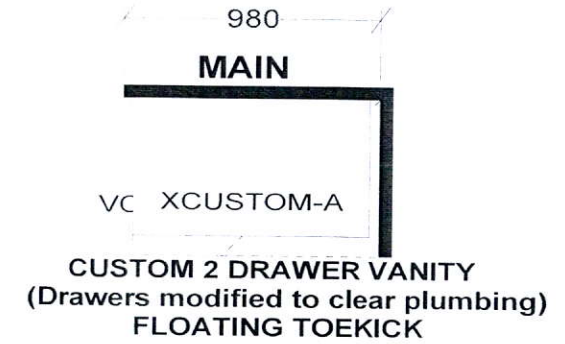

KITCHEN BASES & VANITIES INSTALLED  
 WITH ADJUSTABLE LEGS

APPLIANCE PACKAGE:  
 24" INTEGRATED FRIDGE W/ DECOR PNLS  
 24" INTEGRATED DISHWASHER W/ DECOR PNL  
 24" BUILT-IN OVEN  
 24" COOKTOP  
 24" MICROWAVE HOOD FAN

*S e l b a I n d u s t r i e s*

WIDTH \_\_\_\_\_ W HGHT \_\_\_\_\_ W CNT \_\_\_\_\_ FL HGHT \_\_\_\_\_ DWY H \_\_\_\_\_ ST CENT \_\_\_\_\_ 2X4 \_\_\_\_\_ VENT BOX COVER \_\_\_\_\_

TOWER SUITES:  
 760MM HIGH UPPER CABINETS  
 WHITE STEEL DRAWER BOXES  
 COUNTERTOPS BY OTHERS  
 VENT BOX COVERS  
 CUSTOM VANITIES

This drawing is the intellectual property of  
 SELBA INDUSTRIES INC. and is an  
 original design which must not be released  
 or copied unless applicable fee has been  
 paid or job order placed.



JOB NUMBER:  
 BUILDER: GREENPARK  
 SITE NAME: PETALUMA  
 MODEL: 1 BEDROOM-B 463, B 493, B 610  
 LOT #:  
 DESIGNER: KS  
 DATE: JAN 8 18