



CONSTRUCTION SUMMARY  
330 Richmond - Petaluma Building Corp.

PURCHASER: Gillian A. KIRSH TEL: RES.: 416-781-8488

Unit 9, Level 14 (1710-1)	Floor Plan E721		
---------------------------	--------------------	--	--

CABINETRY

1 - KITCHEN - 41" UPPER CABINETRY 22Feb19 Note:	
--	--

CERAMIC TILE

1 - BATHROOMS - DELETE STANDARD WHITE CERAMIC ACCESSORIES - DO NOT INSTALL SOAP DISH, TOWEL RACK OR TISSUE HOLDER 22Feb19 Note:	
--	--

CONSTRUCTION

2 - BEDROOMS - SMOOTH CEILINGS 22Feb19 Note:	
1 - ENSUITE BATH - 5 FOOT SHOWER WITH SLIDING CHROME FRAMED GLASS DOORS IN LIEU OF TUB 07Mar18 Note:	

COUNTER TOP

1 - KITCHEN -HIGH-END QUARTZ COUNTERTOP IN LIEU OF STANDARD AS PER OFFER 22Feb19 Note:	
---	--

MISCELLANEOUS

1 - LESS BALANCE OF CREDIT FROM PURCHASERS EXTRA SHEET 22Feb19 Note:	
---	--

PLUMBING

2 - BATHROOMS - MOEN 90 DEGREE BATHROOM ACCESSORIES - CHROME TOILET PAPER HOLDER #YB8808 TOWEL RING #YB8886 TOWEL BAR #YB8824 22Feb19 Note:	
---	--

PROMOTIONAL

1 - PARTIAL REDEPTION OF PROMOTIONAL PACKAGE \$2,800.00 BALANCE (\$2,200) FORWARD TO BE USED AT A LATER DATE. ORIGINAL PROMOTIONAL PACKAGE OF \$5,000 AS PER SCHEDULE PE DATED OCTOBER 10, 2015. 07Mar18 Note:	
---	--

EXTRAS AS PER OFFER

The Vendor agrees that notwithstanding any other term or provision in this Agreement included in the Purchase Price and in addition to those items detailed in Schedule D to the Agreement of Purchase and Sale, the Purchaser is entitled to a credit of Fiv Worksheet Note:	
--	--

This Document is Extremely Time Sensitive - Printed 22 Feb 19 at 10:58

RECEIVED FEB 22 2019



Purchaser: Gillian A. KIRSH

Telephone Res. / Bus: (416) 781-8488 /

Decor Advisor: Candace Forza

Lock Date: 2/22/2019 10:55:30

Const. No.: Unit 9, Level 14

Municipal: 1710

Suite Type: E721

Project/Phase: Petaluma Building Corp./1

Layout Changes: ☐ Yes ☒ No

Sketch Attached: ☒ Yes ☐ No

Exterior Colour Scheme:

1. Kitchen and Vanities

	Style and Colour	Counter	Hardware
Kitchen / Breakfast	SEE BELOW	QUARTZ-CALACATTA SM-STRAIGHT POLISHED EDGE	STD
Main Bath	DORAL H3078-HACIENDA WHITE	QUARTZ-TORRONE-STRAIGHT POLISHED EDGE	STD
Master Ensuite Bathroom	DORAL H3078-HACIENDA WHITE	QUARTZ-TORRONE-STRAIGHT POLISHED EDGE	STD
	N/A	N/A	N/A

Appliances:

Built In Appliances ☒ Yes ☐ No

41" Upper Cabinets ☒ Yes ☐ No

Slide In Stove ☐ Yes ☒ No

Comment

KITCHEN CABINETRY - BASE DORAL H3078-HACIENDA WHITE \*\*\* UPPERS SENOSAN WHITE

2. Flooring

		Grout-If App.	At a 45
Entrance Vestibule	STRIP-MIRAGE-LOCK-RED OAK-CASHMERE-CHARCOAL-4 5/16"		<input type="checkbox"/>
Main Hall	STRIP-MIRAGE-LOCK-RED OAK-CASHMERE-CHARCOAL-4 5/16"		<input type="checkbox"/>
Kitchen / Breakfast	STRIP-MIRAGE-LOCK-RED OAK-CASHMERE-CHARCOAL-4 5/16"		<input type="checkbox"/>
Laundry Room	TILE-WHITE-8X8	STANDARD	<input type="checkbox"/>
Main Bath	TILE-LIFE SILVER-12X24	STANDARD	<input type="checkbox"/>
Master Ensuite Bathroom	TILE-LIFE SILVER-12X24	STANDARD	<input type="checkbox"/>
	N/A		<input type="checkbox"/>
Living Room	STRIP-MIRAGE-LOCK-RED OAK-CASHMERE-CHARCOAL-4 5/16"		<input type="checkbox"/>
Dining Room	STRIP-MIRAGE-LOCK-RED OAK-CASHMERE-CHARCOAL-4 5/16"		<input type="checkbox"/>
Den / Library / Study	N/A		<input type="checkbox"/>
Master Bedroom	STRIP-MIRAGE-LOCK-RED OAK-CASHMERE-CHARCOAL-4 5/16"		<input type="checkbox"/>
Bedroom #2	STRIP-MIRAGE-LOCK-RED OAK-CASHMERE-CHARCOAL-4 5/16"		<input type="checkbox"/>
Bedroom #3	N/A		<input type="checkbox"/>
			<input type="checkbox"/>

Comment

3. Wall Tile

	Selection	Grout	Describe
Main Bath			
Tub Deck Wall	N/A		
Shower Stall	TILE-GLOSSY WHITE-3X6	STANDARD	
Bathtub Enclosure Walls	N/A		
Master Ensuite Bathroom			
Tub Deck Wall	N/A		
Shower Stall	TILE-GLOSSY WHITE-3X6	STANDARD	
Bathtub Enclosure Walls	N/A		
Kitchen Backsplash	BACK PAINTED GLASS-BM #OC-16	STANDARD	
Backsplash Behind Fridge	N/A		

Comment

\*\* Refer to Construction Summary

4. Misc

Water Line for Fridge	N/A
Interior Door Handles	AS PER CONSTRUCTION SPECS
Ceramic Bathroom Accessories	NO -UPGRADED - MOEN 90 DEGREE <input type="radio"/> Yes <input checked="" type="radio"/> No

Comment



Purchaser: Gillian A. KIRSH

Telephone Res. / Bus: (416) 781-8488 /

Decor Advisor: Candace Forza

Lock Date: 2/22/2019 10:55:30

Const. No.: Unit 9, Level 14

Municipal: 1710

Suite Type: E721

Project/Phase: Petaluma Building Corp./1

5. Plaster Mouldings and Medallions

Entrance Vestibule	N/A		Living Room	N/A	
Main Hall	N/A		Dining Room	N/A	
Kitchen/Breakfast	N/A		Den / Library /Study	N/A	
Laundry Room	N/A		Master BedRoom	N/A	
Main Bath	N/A		BedRoom #2	N/A	
Master Ensuite Bathroom	N/A		BedRoom #3	N/A	

Comment

\*\* Refer to Construction Summary

6. Wall Paint

Entrance Vestibule	43-BIRCH WHITE	Living Room	43-BIRCH WHITE
Main Hall	43-BIRCH WHITE	Dining Room	43-BIRCH WHITE
Kitchen / Breakfast	43-BIRCH WHITE	Den/Library	N/A
Laundry Room	43-BIRCH WHITE	Master Bedroom	43-BIRCH WHITE
Main Bath	43-BIRCH WHITE	Bedroom #2	43-BIRCH WHITE
Master Ensuite	43-BIRCH WHITE	Bedroom #3	N/A
	N/A		

Comment

7. General Comments

\*\* Refer to Construction Summary

Disclaimers and Notes

- 1) Colours of all materials are as close as possible to builder's selection, but not necessarily identical due to variances in manufacturing.

2) Any extras listed above are null and void unless accompanied by a separate invoice/amendment. Said invoice must be paid in full.

3) The Purchaser agrees that this colour selection is final and that no changes will be permitted, unless required by the Vendor.

4) The Purchaser acknowledges reading and accepting document which contains other miscellaneous disclaimers.

Signature: 

Date: Feb 21/19

Signature: \_\_\_\_\_

Date: \_\_\_\_\_

Initial: \_\_\_\_\_

Page 2 of 2

# 90°™

Traditional | Transitional | Modern

Geometric forms, squared corners and straight lines create an urban focal point for today's contemporary baths.



**Toilet Tank Lever**  
Model YB8801

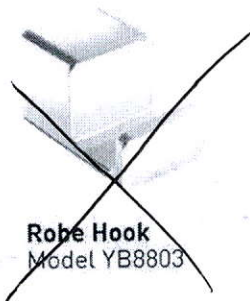

**Robe Hook**  
Model YB8803

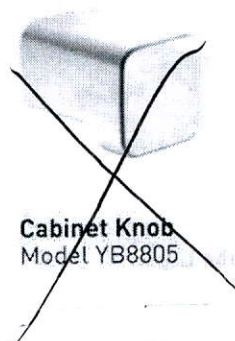

**Cabinet Knob**  
Model YB8805

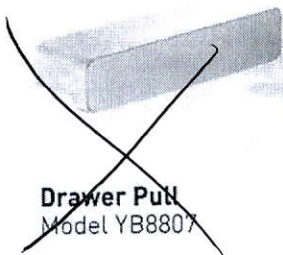

**Drawer Pull**  
Model YB8807

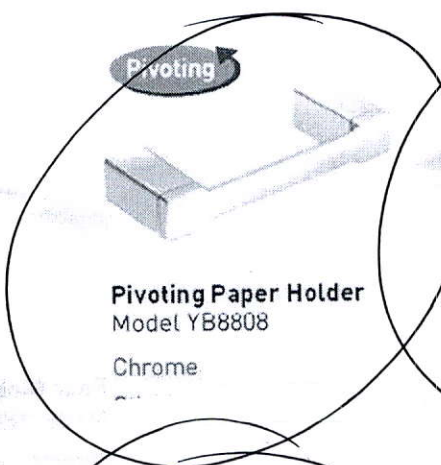

**Pivoting Paper Holder**  
Model YB8808  
Chrome

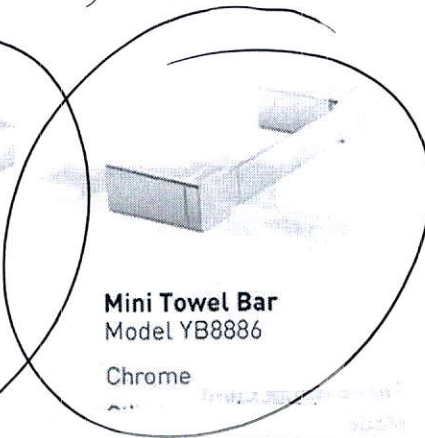

**Mini Towel Bar**  
Model YB8886  
Chrome

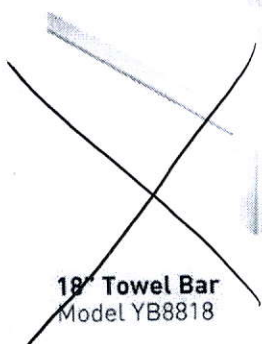

**18" Towel Bar**  
Model YB8818



**24" Towel Bar**  
Model YB8824  
Chrome



**Designer Grab Bar**  
Models: Chrome Other

**FINISH OPTIONS:**

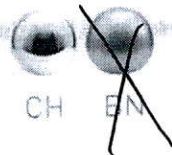

To order, combine the model number with one of these finish letter(s):  
Chrome (CH), LifeShine® Brushed Nickel (BN).



# SCHEDULE 'A'

## 330

RICHMOND

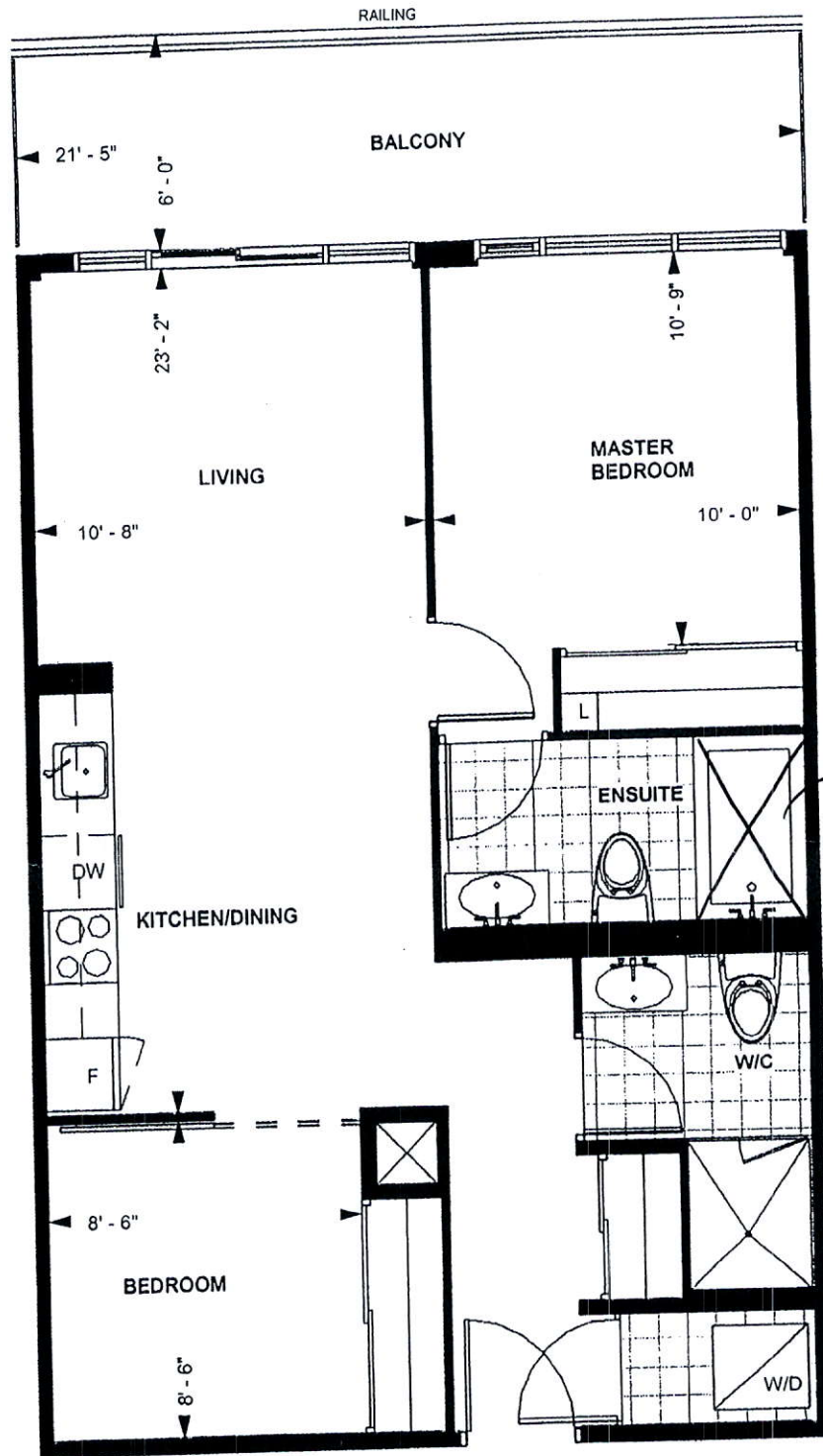

shower

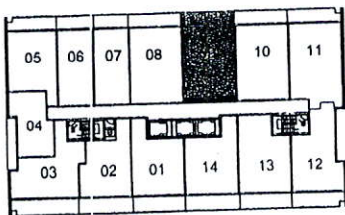

LEVEL 13-20

TOWER SUITE

E 721

9' CEILING \*

721 sq. ft.

2-BEDROOM

Purchaser Initials Purchaser Initials Date

Unit No. 9 Level No. 14 Suite No. 1710

Dimensions, specification, tile floor pattern and architectural detailing (including window size and location) are approximate and subject to modifications without notice. Orientation of suite may vary from the stated floor area.  
\*Ceiling height measured from top of floor slab to underside of slab above before finishes, and excluding bulkheads and required drop ceilings. E.&O.E.

MK

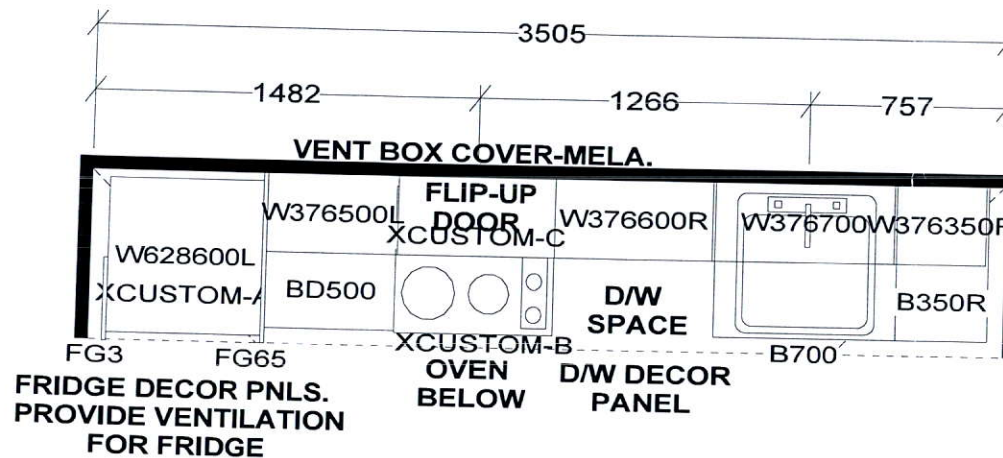

### KITCHEN

041" Upper Cabinetry.

KITCHEN BASES & VANITIES INSTALLED WITH ADJUSTABLE LEGS

#### APPLIANCE PACKAGE:

- 24" INTEGRATED FRIDGE W/ DECOR PNLS
- 24" INTEGRATED DISHWASHER W/ DECOR PNL
- 24" BUILT-IN OVEN
- 24" COOKTOP
- 24" MICROWAVE HOOD FAN

Selba Industries

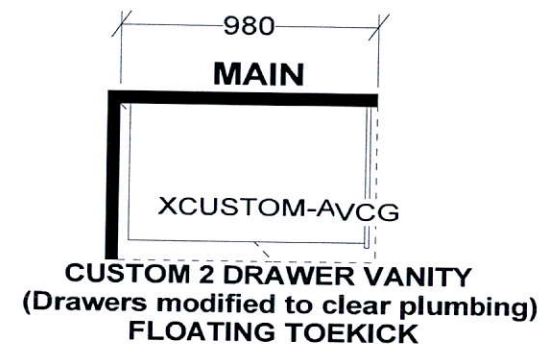
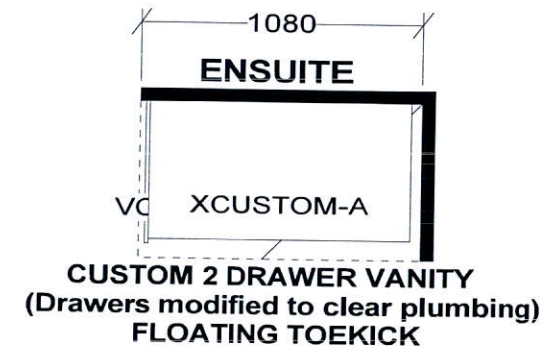

WDTH W HGHT W CNT FL HGHT DWY H ST CENT 2X4 VENT BOX COVER

TOWER SUITES:  
760MM HIGH UPPER CABINETS  
WHITE STEEL DRAWER BOXES  
COUNTERTOPS BY OTHERS  
VENT BOX COVERS  
CUSTOM VANITIES

This drawing is the intellectual property of SELBA INDUSTRIES INC. and is an original design which must not be released or copied unless applicable fee has been paid or job order placed.



JOB NUMBER:  
BUILDER: GREENPARK  
SITE NAME: PETALUMA  
MODEL: 2 BEDROOM - E 721  
LOT #:  
DESIGNER: KS  
DATE: JAN 8 18