

CONSTRUCTION SUMMARY
330 Richmond - Petaluma Building Corp.

PURCHASER: John DELIA

TEL:

Unit 12, Level 15 (1815-1)

Floor Plan
B636

CABINETRY

1 - KITCHEN - 41" UPPER CABINETRY

20Feb19 Note:

CERAMIC TILE

1 - KITCHEN - UPGRADE 2 MOSAIC BACKSPLASH

20Feb19 Note:

1 - BATHROOM - DELETE STANDARD WHITE ACCESSORIES - DO NOT INSTALL SOAP DISH, TOWEL RACK OR TISSUE HOLDER

20Feb19 Note:

CONSTRUCTION

1 - BEDROOM - SMOOTH CEILING

20Feb19 Note:

COUNTER TOP

1 - BATHROOM - UPGRADED EDGE ON COUNTERTOP

20Feb19 Note:

1 - KITCHEN - UPGRADED EDGE ON COUNTERTOP

20Feb19 Note:

1 - KITCHEN - HIGH-END QUARTZ COUNTERTOP

20Feb19 Note:

DOORS AND TRIM

1 - BEDROOM - FRAMELESS SLIDING MIRRORS CLOSET DOORS WITH MIRROR FASCIA

20Feb19 Note:

PLUMBING

1 - MOEN 90 DEGREE BATHROOM ACCESSORIES - CHROME

TOILET PAPER HOLDER #YB8808

TOWEL RING #YB8886

TOWEL BAR #YB8824

20Feb19 Note:

PROMOTIONAL

1 - LESS CREDIT FROM PURCHASERS EXTRA SHEET AS PER OFFER

20Feb19 Note:

EXTRAS AS PER OFFER

The Vendor agrees that notwithstanding any other term or provision in this Agreement included in the Purchase Price and in addition to those items detailed in Schedule D to the Agreement of Purchase and Sale, the Purchaser is entitled to a credit of Five

Worksheet Note:

This Document is Extremely Time Sensitive - Printed 20 Feb 19 at 10:44

Purchaser: John DELIA
Telephone Res. / Bus: /
Decor Advisor: Candace Forza
Lock Date: 2/20/2019 10:42:14

Const. No.: Unit 12, Level 15
Municipal: 1815
Suite Type: B636
Project/Phase: Petaluma Building Corp./1

Layout Changes: ☐ Yes ☒ No Sketch Attached: ☒ Yes ☐ No Exterior Colour Scheme:

1. Kitchen and Vanities

	Style and Colour	Counter	Hardware
Kitchen / Breakfast	SEE BELOW	QUARTZ-FROSTY CARRARA-#360 EDGE	STD
Main Bath	DORAL H3081-HACIENDA BLACK	QUARTZ-AMIATA-#360 EDGE	STD
Master Ensuite Bathroom	N/A	N/A	N/A

Appliances: Built In Appliances ☒ Yes ☐ No 41" Upper Cabinets ☒ Yes ☐ No Slide In Stove ☐ Yes ☒ No

Comment

KITCHEN CABINETRY - BASE DORAL H3081-HACIENDA BLACK *** UPPER SENOSAN LIGHT GREY

2. Flooring

		Grout-If App.	At a 45
Entrance Vestibule	STRIP-MIRAGE-LOCK-RED OAK-CASHMERE-GRAPHITE-4 5/16"		<input type="checkbox"/>
Main Hall	STRIP-MIRAGE-LOCK-RED OAK-CASHMERE-GRAPHITE-4 5/16"		<input type="checkbox"/>
Kitchen / Breakfast	STRIP-MIRAGE-LOCK-RED OAK-CASHMERE-GRAPHITE-4 5/16"		<input type="checkbox"/>
Laundry Room	TILE-WHITE-8X8		<input type="checkbox"/>
Main Bath	TILE-LIFE ICE-12X24	STANDARD	<input type="checkbox"/>
Master Ensuite Bathroom	N/A	STANDARD	<input type="checkbox"/>
	N/A		<input type="checkbox"/>
Living Room	STRIP-MIRAGE-LOCK-RED OAK-CASHMERE-GRAPHITE-4 5/16"		<input type="checkbox"/>
Dining Room	STRIP-MIRAGE-LOCK-RED OAK-CASHMERE-GRAPHITE-4 5/16"		<input type="checkbox"/>
Den / Library / Study	N/A		<input type="checkbox"/>
Master Bedroom	STRIP-MIRAGE-LOCK-RED OAK-CASHMERE-GRAPHITE-4 5/16"		<input type="checkbox"/>
Bedroom #2	N/A		<input type="checkbox"/>
Bedroom #3	N/A		<input type="checkbox"/>
			<input type="checkbox"/>

Comment

3. Wall Tile

	Selection	Grout	Describe
Main Bath			
Tub Deck Wall	N/A		
Shower Stall	N/A		
Bathtub Enclosure Walls	TILE-GLOSSY WHITE-3X6	STANDARD	
Master Ensuite Bathroom			
Tub Deck Wall	N/A		
Shower Stall	N/A		
Bathtub Enclosure Walls	N/A		
Kitchen Backsplash	TILE-ARISTONE WHITE (MB022J2-BP)HERR		1X3 - 13X13
Backsplash Behind Fridge	N/A		

Comment

** Refer to Construction Summary

4. Misc

Water Line for Fridge N/A
Interior Door Handles AS PER CONSTRUCTION SPECS
Ceramic Bathroom Accessories NO - MOEN 90 DEGREE ☐ Yes ☒ No

Comment

Purchaser: John DELIA
 Telephone Res. / Bus: /
 Decor Advisor: Candace Forza
 Lock Date: 2/20/2019 10:42:14

Const. No.: Unit 12, Level 15
 Municipal: 1815
 Suite Type: B636
 Project/Phase: Petaluma Building Corp./1

5. Plaster Mouldings and Medallions

Entrance Vestibule	N/A		Living Room	N/A	
Main Hall	N/A		Dining Room	N/A	
Kitchen/Breakfast	N/A		Den / Library /Study	N/A	
Laundry Room	N/A		Master BedRoom	N/A	
Main Bath	N/A		BedRoom #2	N/A	
Master Ensuite Bathroom	N/A		BedRoom #3	N/A	

Comment

** Refer to Construction Summary

6. Wall Paint

Entrance Vestibule	43-BIRCH WHITE	Living Room	43-BIRCH WHITE
Main Hall	43-BIRCH WHITE	Dining Room	43-BIRCH WHITE
Kitchen / Breakfast	43-BIRCH WHITE	Den/Library	N/A
Laundry Room	43-BIRCH WHITE	Master Bedroom	43-BIRCH WHITE
Main Bath	43-BIRCH WHITE	Bedroom #2	N/A
Master Ensuite	N/A	Bedroom #3	N/A
	N/A		

Comment

7. General Comments

** Refer to Construction Summary

Disclaimers and Notes

- Colours of all materials are as close as possible to builder's selection, but not necessarily identical due to variances in manufacturing.
- Any extras listed above are null and void unless accompanied by a separate invoice/amendment. Said invoice must be paid in full.
- The Purchaser agrees that this colour selection is final and that no changes will be permitted, unless required by the Vendor.
- The Purchaser acknowledges reading and accepting document which contains other miscellaneous disclaimers.

Signature:  Date: Feb 20/19 Signature: _____ Date: _____

Initial: _____

Page 2 of 2

Titanless Minor Sliding Door with Minor Fascia - \$680



90°™

Traditional | Transitional | Modern

Geometric forms, squared corners and straight lines create an urban focal point for today's contemporary baths.

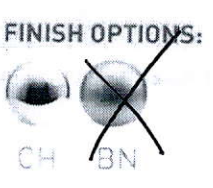
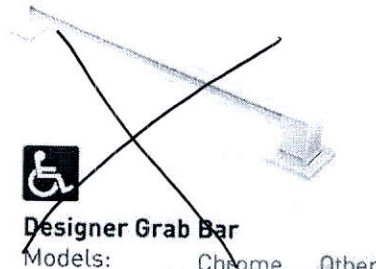
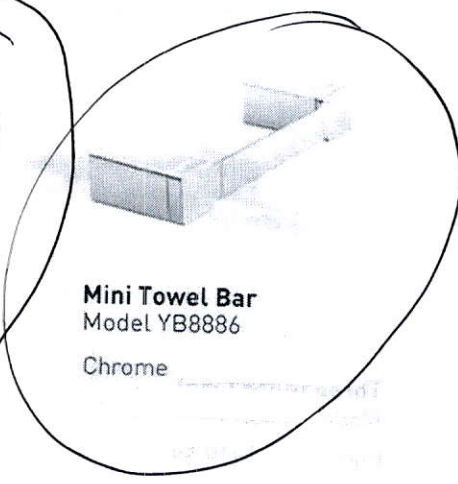
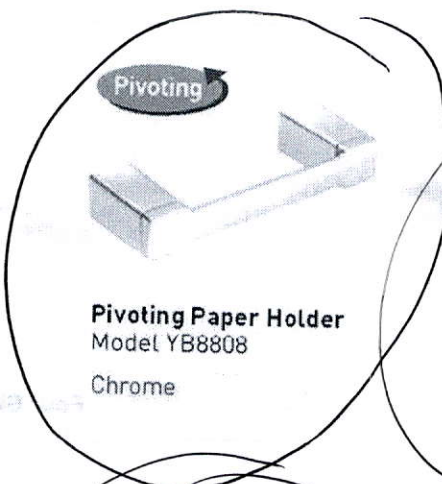
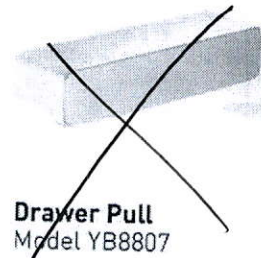
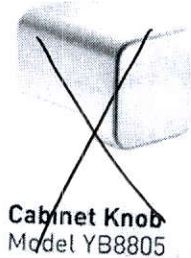
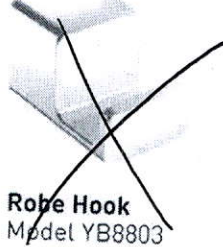

To order, combine the model number with one of these finish letter(s):
Chrome (CH), LifeShine® Brushed Nickel (BN).

SCHEDULE 'A'

330
RICHMOND

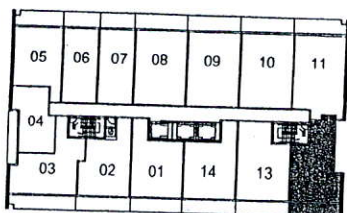
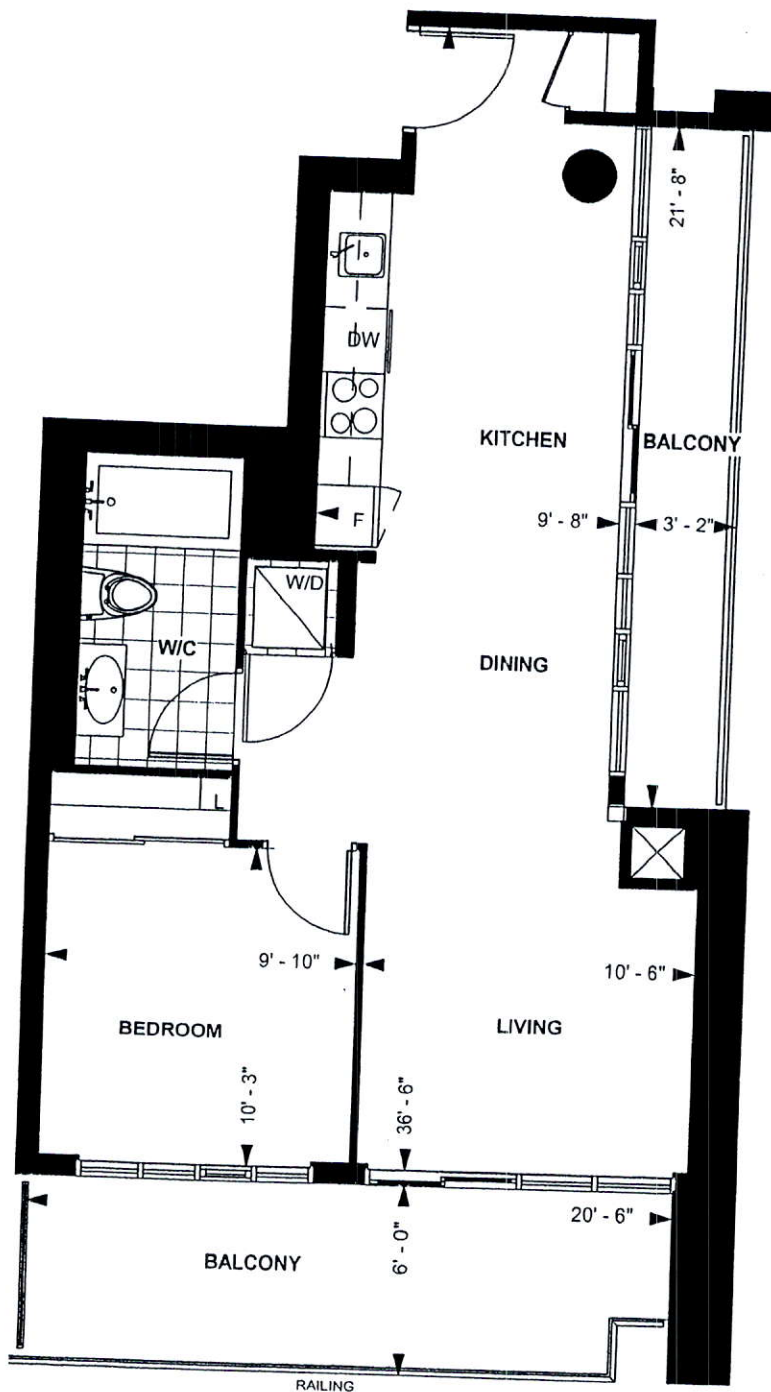

LEVEL 13-20

TOWER SUITE
B 636

9' CEILING *

636 sq. ft.
1-BEDROOM

Purchaser Initials Purchaser Initials

Date

Unit No. 12 Level No. 15 Suite No. 1815

Dimensions, specification, tile floor pattern and architectural detailing (including window size and location) are approximate and subject to modifications without notice. Orientation of suite may vary from the stated floor area.
*Ceiling height measured from top of floor slab to underside of slab above before finishes, and excluding bulkheads and required drop ceilings. E.&O.E.

* up. countertop Edge in Kitchen + Bath

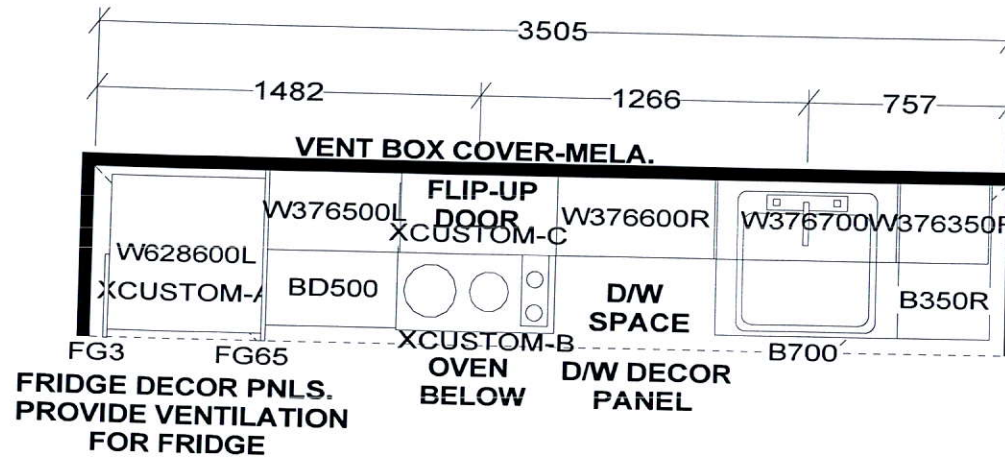

KITCHEN

• 41" Upper Cabinetry.

KITCHEN BASES & VANITIES INSTALLED WITH ADJUSTABLE LEGS

APPLIANCE PACKAGE:
24" INTEGRATED FRIDGE W/ DECOR PNLS
24" INTEGRATED DISHWASHER W/ DECOR PNL
24" BUILT-IN OVEN
24" COOKTOP
24" MICROWAVE HOOD FAN

Selba Industries

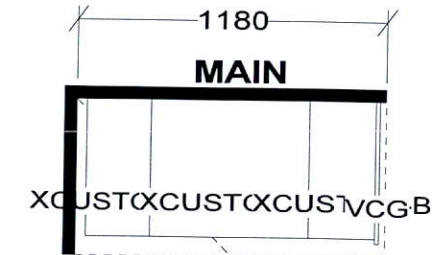

CUSTOM 2 DRAWER VANITY
(Drawers modified to clear plumbing)
FLOATING TOEKICK

V W D T H		W H G H T		W C N T		F L H G H T		D W Y H		S T C E N T		2 X 4		V E N T B O X C O V E R	
TOWER SUITES: 760MM HIGH UPPER CABINETS WHITE STEEL DRAWER BOXES COUNTERTOPS BY OTHERS VENT BOX COVERS CUSTOM VANITIES						This drawing is the intellectual property of SELBA INDUSTRIES INC. and is an original design which must not be released or copied unless applicable fee has been paid or job order placed.						JOB NUMBER: BUILDER: GREENPARK SITE NAME: PETALUMA MODEL: 1 BEDROOM - B 636 LOT #: DESIGNER: KS DATE: JAN 8 18			

(Handwritten signature)