



CONSTRUCTION SUMMARY  
330 Richmond - Petaluma Building Corp.

PURCHASER: Isachar BIRMAN		TEL: RES.: 905-597-2711	
Unit 2, Level 12 (1502-1)	Floor Plan B544		

CABINETRY

1 - KITCHEN- 41" UPPER CABINETS 19Feb19 Note:	
--	--

CERAMIC TILE

1 - DELETE STANDARD BATHROOM ACCESSORIES 19Feb19 Note:	
---	--

CONSTRUCTION

1 - SMOOTH CELING IN BEDROOM 19Feb19 Note:	
1 - MAIN BATH - 5 FOOT SHOWER WITH SLIDING CHROME FRAMED GLASS DOORS IN LIEU OF TUB 07Feb18 Note:	

COUNTER TOP

1 - UPGRADE COUNTERTOP EDGE- KITCHEN AND BATHROOM 19Feb19 Note:	
--	--

PLUMBING

1 - UPGRADE TOWEL RING IN BATHROOM ONLY- MOEN- 90 DEGREE #YB8886 CHROME 19Feb19 Note:	
1 - PARTIAL REDEPTION OF PROMOTIONAL PACKAGE \$2,800.00 BALANCE (\$2,200) FORWARD TO BE USED AT A LATER DATE. ORIGINAL PROMOTIONAL PACKAGE OF \$5,000 AS PER SCHEDULE PE DATED OCTOBER 21, 2015 07Feb18 Note:	

PROMOTIONAL

1 - LESS CREDIT FROM PURCHASER EXTRA SHEET IN OFFER 19Feb19 Note:	
--	--

EXTRAS AS PER OFFER

The Vendor agrees that notwithstanding any other term or provision in this Agreement included in the Purchase Price and in addition to those items detailed in Schedule D to the Agreement of Purchase and Sale, the Purchaser is entitled to a credit of Fiv Worksheet Note:	
--	--

This Document is Extremely Time Sensitive - Printed 19 Feb 19 at 14:22

RECEIVED FEB 21 2019

Purchaser: Isachar BIRMAN  
Telephone Res. / Bus: (905) 597-2711 /  
Decor Advisor: Natalie Mancuso  
Lock Date: 2/19/2019 14:27:19

Const. No.: Unit 2, Level 12  
Municipal: 1502  
Suite Type: B544  
Project/Phase: Petaluma Building Corp./1

Layout Changes: ☐ Yes ☒ No      Sketch Attached: ☒ Yes ☐ No      Exterior Colour Scheme:

1. Kitchen and Vanities

	Style and Colour	Counter	Hardware
Kitchen / Breakfast	SEE BELOW	QUARTZ- TORRONE- #360 EDGE	STD
Main Bath	DORAL H3078 HACIENDA WHITE	QUARTZ- TORRONE- #360 EDGE	STD
Master Ensuite Bathroom			

Appliances:      Built In Appliances ☒ Yes ☐ No      41" Upper Cabinets ☒ Yes ☐ No      Slide In Stove ☐ Yes ☒ No

Comment

KITCHEN UPPER CABINETS- SENOSAN WHITE  
KITCHEN BASE CABINETS- DORAL H3078 HACIENDA WHITE

2. Flooring

		Grout-If App.	At a 45
Entrance Vestibule	HARDWOOD- MIRAGE 4 5/16 LOCK RED OAK- NORDIC- CASHMERE		<input type="checkbox"/>
Main Hall	HARDWOOD- MIRAGE 4 5/16 LOCK RED OAK- NORDIC- CASHMERE		<input type="checkbox"/>
Kitchen / Breakfast	HARDWOOD- MIRAGE 4 5/16 LOCK RED OAK- NORDIC- CASHMERE		<input type="checkbox"/>
Laundry Room	TILE- MATTE WHITE 8X8	STD	<input type="checkbox"/>
Main Bath	TILE- LIFE SILVER 12X24	STD	<input type="checkbox"/>
Master Ensuite Bathroom			<input type="checkbox"/>
			<input type="checkbox"/>
Living Room	HARDWOOD- MIRAGE 4 5/16 LOCK RED OAK- NORDIC- CASHMERE		<input type="checkbox"/>
Dining Room	HARDWOOD- MIRAGE 4 5/16 LOCK RED OAK- NORDIC- CASHMERE		<input type="checkbox"/>
Den / Library / Study			<input type="checkbox"/>
Master Bedroom	HARDWOOD- MIRAGE 4 5/16 LOCK RED OAK- NORDIC- CASHMERE		<input type="checkbox"/>
Bedroom #2			<input type="checkbox"/>
Bedroom #3			<input type="checkbox"/>
			<input type="checkbox"/>

Comment

3. Wall Tile

	Selection	Grout	Describe
Main Bath			
Tub Deck Wall			
Shower Stall	TILE- GLOSSY WHITE 3X6	STD	
Bathtub Enclosure Walls			
Master Ensuite Bathroom			
Tub Deck Wall			
Shower Stall			
Bathtub Enclosure Walls			
Kitchen Backsplash	PAINTED GLASS BM #OC-16		
Backsplash Behind Fridge			

Comment

\*\* Refer to Construction Summary

4. Misc

Water Line for Fridge      NO  
Interior Door Handles      STANDARD  
Ceramic Bathroom Accessories      ONLY INSTALL UPGRADED TOWEL RING      ☐ Yes      ☒ No

Comment

IB



**Const. No.:** Unit 2, Level 12  
**Municipal:** 1502  
**Suite Type:** B544  
**Project/Phase:** Petaluma Building Corp./1

## 5. Plaster Mouldings and Medallions

## Entrance Vestibule

## Main Hall

### Kitchen/Breakfast

## Laundry Room

## Main Bath

### Master Ensuite Bathroom

## Living Room

## Dining Room

Den / Library / Study

## Master BedRoom

## BedRoom #2

### BedRoom #3

### Comment

\*\* Refer to Construction Summary

## 6. Wall Paint

## Entrance Vestibule

## Main Hall

### Kitchen / Breakfast

## Laundry Room

### Main Bath

### Master Ensuite

BIRCH WHITE

BIRCH WHITE

BIRCH WHITE

BIRCH WHITE

BIRCH WHITE

### Living Room

### Dining Room

Den/Library

### Master Bedroom

### Bedroom #2

### Bedroom #3

BIRCH WHITE

**BIRCH WHITE**

BIRCH WHITE

### Comment

## 7. General Comments

\*\* Refer to Construction Summary

## Disclaimers and Notes

- 1) Colours of all materials are as close as possible to builder's selection, but not necessarily identical due to variances in manufacturing.
- 2) Any extras listed above are null and void unless accompanied by a separate invoice/amendment. Said invoice must be paid in full.
- 3) The Purchaser agrees that this colour selection is final and that no changes will be permitted, unless required by the Vendor.
- 4) The Purchaser acknowledges reading and accepting document which contains other miscellaneous disclaimers.

Signature: [Signature] Date: FEB-19-19 Signature: \_\_\_\_\_ Date: \_\_\_\_\_

Initial: I.B.

# 90°™

Traditional | Transitional | Modern

Geometric forms, squared corners and straight lines create an urban focal point for today's contemporary baths.

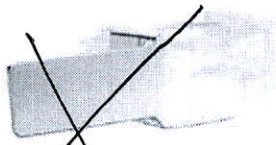

**Toilet Tank Lever**  
Model YB8801

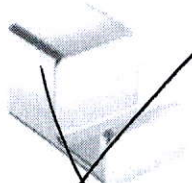

**Rope Hook**  
Model YB8803

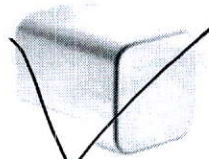

**Cabinet Knob**  
Model YB8805



**Drawer Pull**  
Model YB8807

Pivoting



**Pivoting Paper Holder**  
Model YB8808



**Mini Towel Bar**  
Model YB8886

Chrome

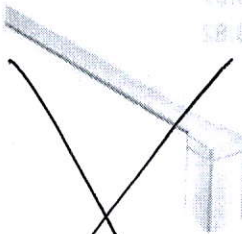

**18" Towel Bar**  
Model YB8818

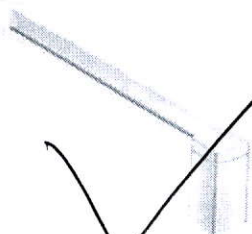

**24" Towel Bar**  
Model YB8824

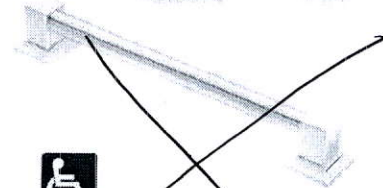

**Designer Grab Bar**  
Models: Chrome Other

## FINISH OPTIONS:

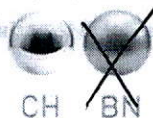

To order, combine the model number with one of these finish letter(s):  
Chrome (CH), LifeShine® Brushed Nickel (BN).

1502

SCHEDULE 'A'

330

RICHMOND

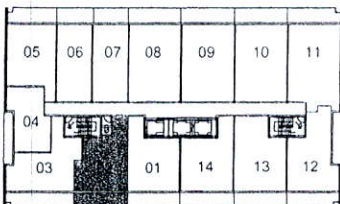
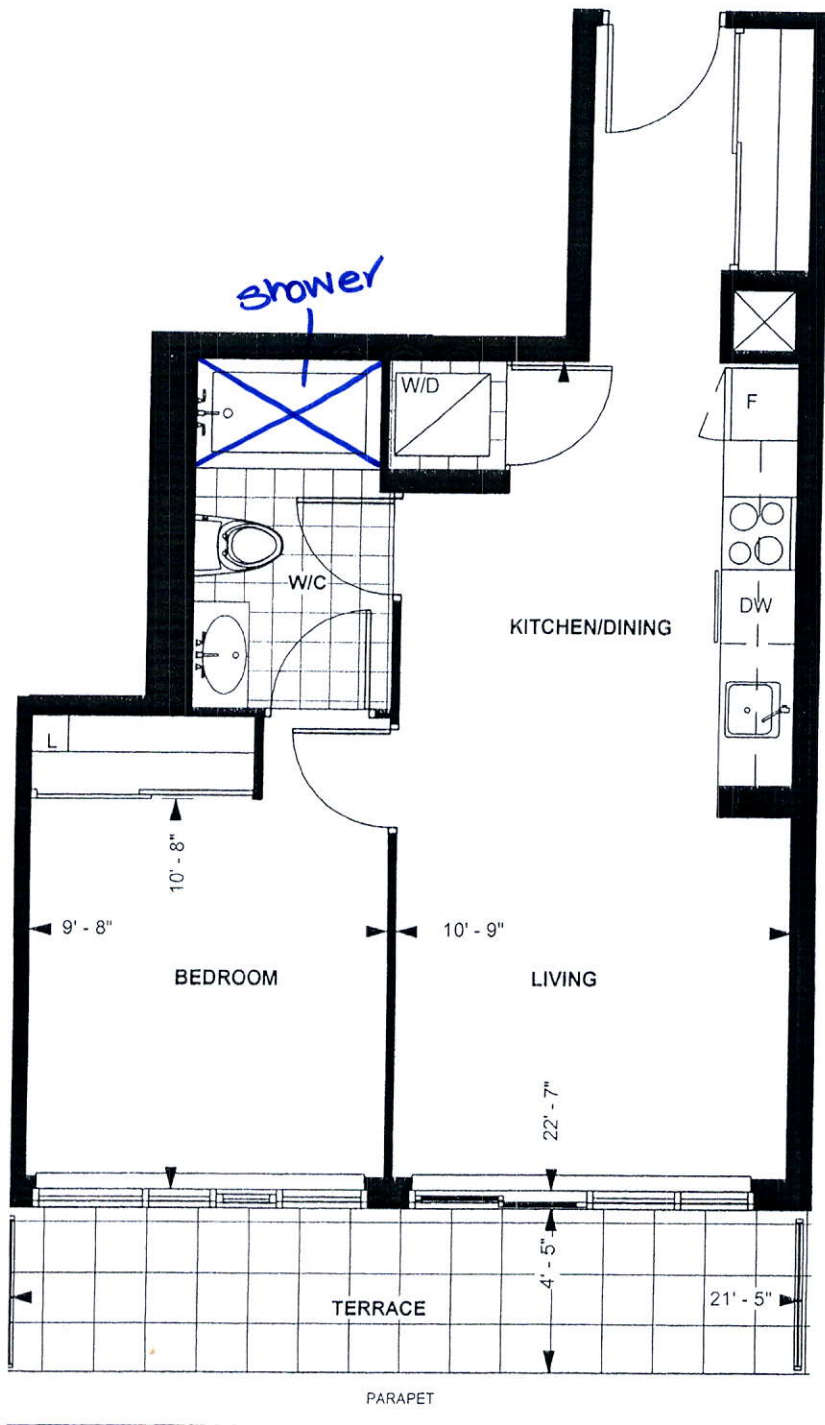

LEVEL 12

TOWER SUITE

B 544

9' CEILING \*

544 sq. ft.

1-BEDROOM

Purchaser Initials Purchaser Initials

Date

Unit No. 2 Level No. 12 Suite No. 1502

Dimensions, specification, tile floor pattern and architectural detailing (including window size and location) are approximate and subject to modifications without notice. Orientation of suite may vary from the stated floor area.

\*Ceiling height measured from top of floor slab to underside of slab above before finishes, and excluding bulkheads and required drop ceilings. E.&O.E.



\* Up. Countertop Edge in Kitchen + Bath

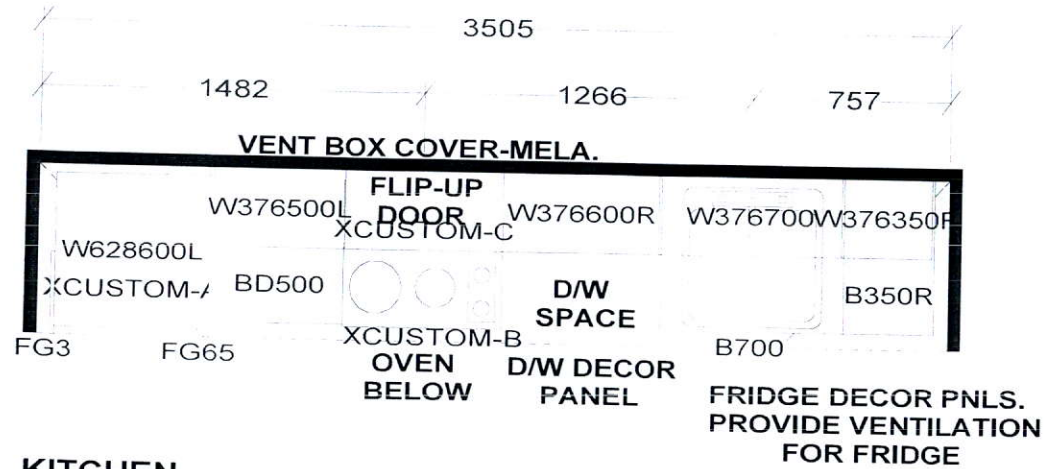

KITCHEN  
41" uppers

KITCHEN BASES & VANITIES INSTALLED  
WITH ADJUSTABLE LEGS

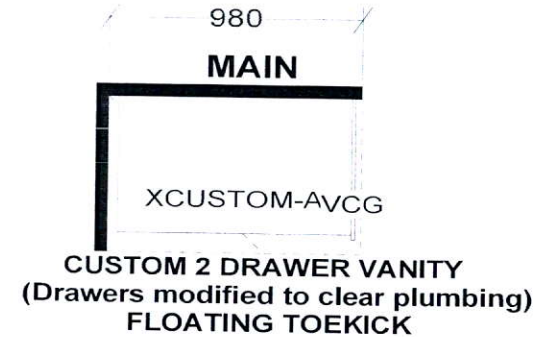

APPLIANCE PACKAGE:  
24" INTEGRATED FRIDGE W/ DECOR PNLS  
24" INTEGRATED DISHWASHER W/ DECOR PNL  
24" BUILT-IN OVEN  
24" COOKTOP  
24" MICROWAVE HOOD FAN

Selba Industries

WIDTH	W HGT	W CNT	FL HGT	DWY H	ST CENT	2X4	VENT BOX COVER
<p>TOWER SUITES: 760MM HIGH UPPER CABINETS WHITE STEEL DRAWER BOXES COUNTERTOPS BY OTHERS VENT BOX COVERS CUSTOM VANITIES</p>							
<p>This drawing is the intellectual property of SELBA INDUSTRIES INC. and is an original design which must not be released or copied unless applicable fee has been paid or job order placed.</p>				<p>JOB NUMBER: BUILDER: GREENPARK SITE NAME: PETALUMA MODEL: 1 BEDROOM - B 544, B 604 LOT #: DESIGNER: KS DATE: JAN 8 18</p>			