



CONSTRUCTION SUMMARY
330 Richmond - Petaluma Building Corp.

PURCHASER: Milica POPOVIC

TEL: RES.: 416-499-5032

Unit 6, Level 14 (1707-1)

Floor Plan
B463

CABINETRY

1 - KITCHEN - 41" UPPER CABINETRY

11Feb19 Note:

1 - KITCHEN - SENOSAN CABINETRY ON BASE AND UPPER CABINETRY

11Feb19 Note:

CERAMIC TILE

1 - BATHROOM - DELETE STANDARD WHITE CERAMIC ACCESSORIES - DO NOT INSTALL SOAP DISH, TOWEL RACK OR TISSUE HOLDER

11Feb19 Note:

1 - KITCHEN - MOSAIC BACKSPLASH

11Feb19 Note:

CONSTRUCTION

1 - BEDROOM - SMOOTH CEILING

11Feb19 Note:

COUNTER TOP

1 - KITCHEN - HIGH-END QUARTZ COUNTEROP IN LIEU OF STANDARD AS PER OFFER

11Feb19 Note:

DOORS AND TRIM

1 - BEDROOM - FRAMELESS MIRROR CLOSET DOORS WITH MIRROR FASCIA

11Feb19 Note:

MISCELLANEOUS

1 - TOTAL OF UPGRADES-

11Feb19 Note:

PLUMBING

1 - MOEN 90 DEGREE BATHROOM ACCESSORIES - CHROME

TOILET PAPER HOLDER #YB8808

TOWEL RING #YB8886

TOWEL BAR #YB8824

11Feb19 Note:

PROMOTIONAL

1 - LESS CREDIT FROM PURCHASERS EXTRA SHEET IN OFFER

11Feb19 Note:

EXTRAS AS PER OFFER

The Vendor agrees that notwithstanding any other term or provision in this Agreement included in the Purchase Price and in addition to those items

detailed in Schedule D to the Agreement of Purchase and Sale, the Purchaser is entitled to a credit of Fiv

Worksheet Note:

This Document is Extremely Time Sensitive - Printed 11 Feb 19 at 10:24

RECEIVED FEB 13 2019

Purchaser: Milica POPOVIC
Telephone Res. / Bus: (416) 499-5032 /
Decor Advisor: Anne Federico
Lock Date: 2/11/2019 10:22:24

Const. No.: Unit 6, Level 14
Municipal: 1707
Suite Type: B463
Project/Phase: Petaluma Building Corp./1

Layout Changes: ☐ Yes ☒ No Sketch Attached: ☒ Yes ☐ No Exterior Colour Scheme:

1. Kitchen and Vanities

	Style and Colour	Counter	Hardware
Kitchen / Breakfast	SENOSAN WHITE	QUARTZ-CALACATTA SM-STRAIGHT POLISHED EDGE	STD
Main Bath	DORAL HACIENDA BLACK	QUARTZ-AMIATA-STRAIGHT POLISHED EDGE	STD
Master Ensuite Bathroom	N/A	N/A	N/A

Appliances: Built In Appliances ☒ Yes ☐ No 41" Upper Cabinets ☒ Yes ☐ No Slide In Stove ☐ Yes ☒ No

Comment

2. Flooring

		Grout-If App.	At a 45
Entrance Vestibule	STRIP-MIRAGE-LOCK-RED OAK-CASHMERE-CHARCOAL-4 5/16"		<input type="checkbox"/>
Main Hall	STRIP-MIRAGE-LOCK-RED OAK-CASHMERE-CHARCOAL-4 5/16"		<input type="checkbox"/>
Kitchen / Breakfast	STRIP-MIRAGE-LOCK-RED OAK-CASHMERE-CHARCOAL-4 5/16"		<input type="checkbox"/>
Laundry Room	TILE-LIFE ICE-12X24		<input type="checkbox"/>
Main Bath	TILE-LIFE ICE-12X24	STD	<input type="checkbox"/>
Master Ensuite Bathroom	N/A	STD	<input type="checkbox"/>
	N/A		<input type="checkbox"/>
Living Room	STRIP-MIRAGE-LOCK-RED OAK-CASHMERE-CHARCOAL-4 5/16"		<input type="checkbox"/>
Dining Room	STRIP-MIRAGE-LOCK-RED OAK-CASHMERE-CHARCOAL-4 5/16"		<input type="checkbox"/>
Den / Library / Study	N/A		<input type="checkbox"/>
Master Bedroom	STRIP-MIRAGE-LOCK-RED OAK-CASHMERE-CHARCOAL-4 5/16"		<input type="checkbox"/>
Bedroom #2	N/A		<input type="checkbox"/>
Bedroom #3	N/A		<input type="checkbox"/>
			<input type="checkbox"/>

Comment

3. Wall Tile

	Selection	Grout	Describe
Main Bath			
Tub Deck Wall	N/A		
Shower Stall	N/A		
Bathtub Enclosure Walls	TILE-GLOSSY WHITE-3X6	STD	
Master Ensuite Bathroom			
Tub Deck Wall	N/A		
Shower Stall	N/A		
Bathtub Enclosure Walls	N/A		
Kitchen Backsplash	TILE-THASSOS WHITE(MB067B3-AP)HEX2"	STD	13X13
Backsplash Behind Fridge	N/A		

Comment

** Refer to Construction Summary

4. Misc

Water Line for Fridge N/A

Interior Door Handles AS PER CONSTRUCTION SPECS

Ceramic Bathroom Accessories NO - UPGRADED - MOEN 90 DEGREE ☐ Yes ☒ No

Comment

Purchaser: Milica POPOVIC
Telephone Res. / Bus: (416) 499-5032 /
Decor Advisor: Anne Federico
Lock Date: 2/11/2019 10:22:24

Const. No.: Unit 6, Level 14
Municipal: 1707
Suite Type: B463
Project/Phase: Petaluma Building Corp./1

5. Plaster Mouldings and Medallions

Entrance Vestibule	N/A		Living Room	N/A	
Main Hall	N/A		Dining Room	N/A	
Kitchen/Breakfast	N/A		Den / Library /Study	N/A	
Laundry Room	N/A		Master BedRoom	N/A	
Main Bath	N/A		BedRoom #2	N/A	
Master Ensuite Bathroom	N/A		BedRoom #3	N/A	

Comment

** Refer to Construction Summary

6. Wall Paint

Entrance Vestibule	43 BIRCH WHITE	Living Room	43 BIRCH WHITE
Main Hall	43 BIRCH WHITE	Dining Room	43 BIRCH WHITE
Kitchen / Breakfast	43 BIRCH WHITE	Den/Library	N/A
Laundry Room	43 BIRCH WHITE	Master Bedroom	43 BIRCH WHITE
Main Bath	43 BIRCH WHITE	Bedroom #2	N/A
Master Ensuite	N/A	Bedroom #3	N/A
	N/A		

Comment

7. General Comments

** Refer to Construction Summary

Disclaimers and Notes

- 1) Colours of all materials are as close as possible to builder's selection, but not necessarily identical due to variances in manufacturing.
- 2) Any extras listed above are null and void unless accompanied by a separate invoice/amendment. Said invoice must be paid in full.
- 3) The Purchaser agrees that this colour selection is final and that no changes will be permitted, unless required by the Vendor.
- 4) The Purchaser acknowledges reading and accepting document which contains other miscellaneous disclaimers.

Signature:  Date: _____

Signature: _____ Date: _____

90°™

Traditional | Transitional | Modern

Geometric forms, squared corners and straight lines create an urban focal point for today's contemporary baths.



Toilet Tank Lever
Model YB8801

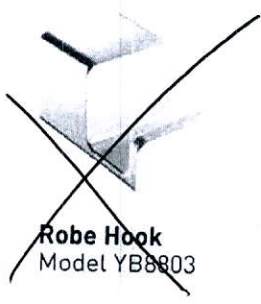

Robe Hook
Model YB8803

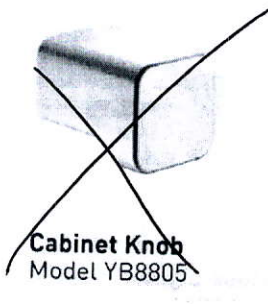

Cabinet Knob
Model YB8805

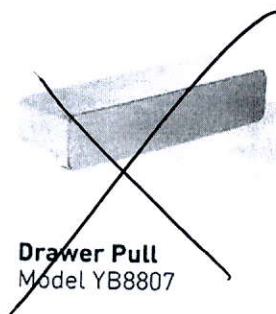

Drawer Pull
Model YB8807

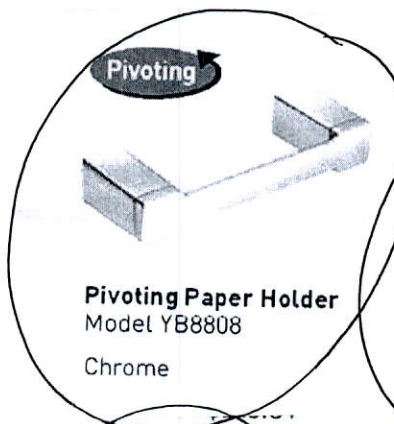

Pivoting Paper Holder
Model YB8808
Chrome

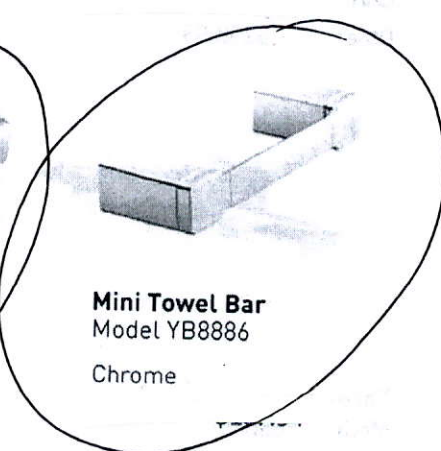

Mini Towel Bar
Model YB8886
Chrome

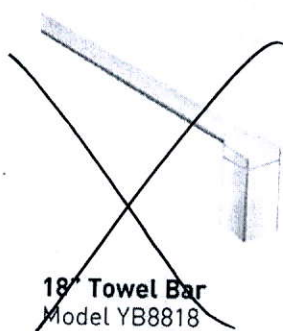

18" Towel Bar
Model YB8818

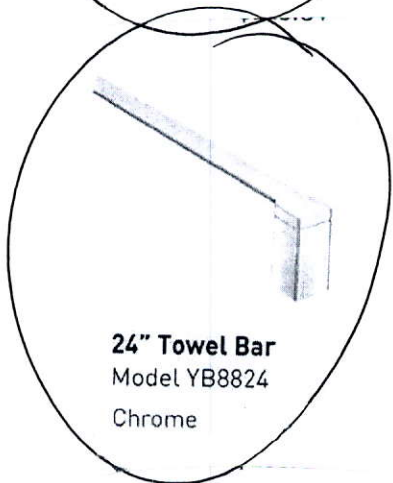

24" Towel Bar
Model YB8824
Chrome



Designer Grab Bar
Models: Chrome Other

FINISH OPTIONS:

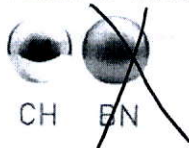

To order, combine the model number with one of these finish letter(s):
Chrome (CH), LifeShine® Brushed Nickel (BN).

SCHEDULE 'A'

330

RICHMOND

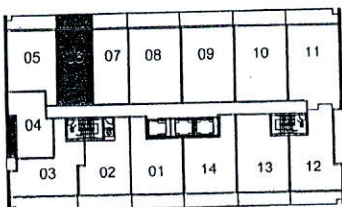
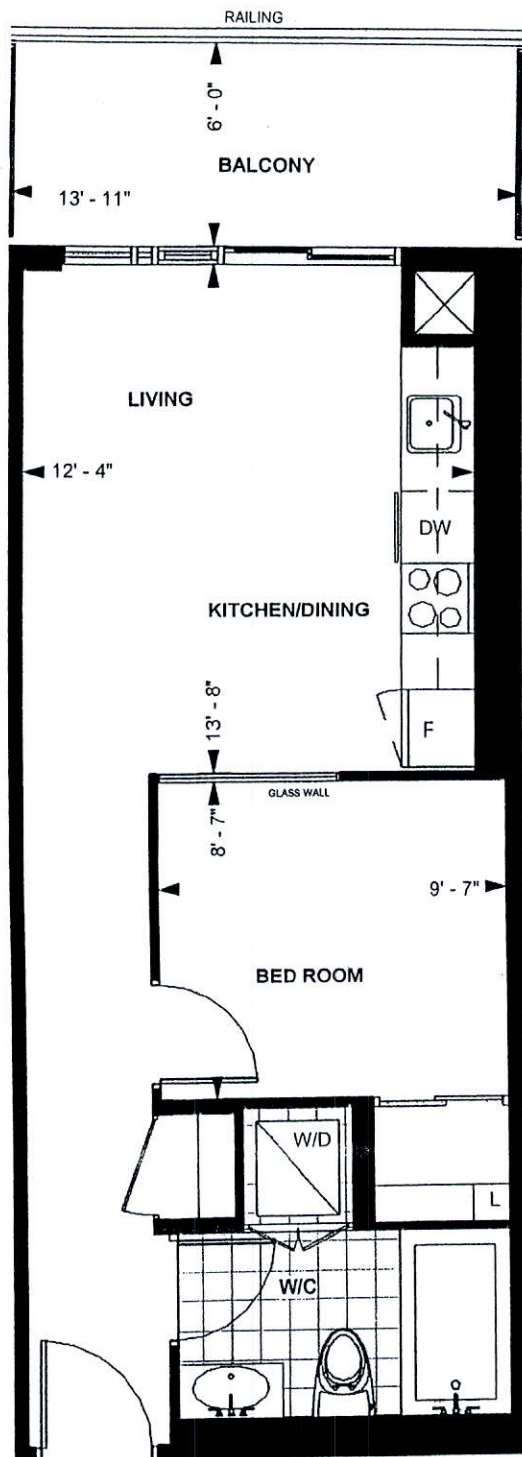

LEVEL 13-20

TOWER SUITE

B 463

9' CEILING *

463 sq. ft.

1-BEDROOM

Purchaser Initials MP Purchaser Initials Nov. 14/15 Date
 Unit No. 6 Level No. 14 Suite No. 1707

Dimensions, specification, tile floor pattern and architectural detailing (including window size and location) are approximate and subject to modifications without notice. Orientation of suite may vary from the stated floor area.

*Ceiling height measured from top of floor slab to underside of slab above before finishes, and excluding bulkheads and required drop ceilings. E.&O.E.

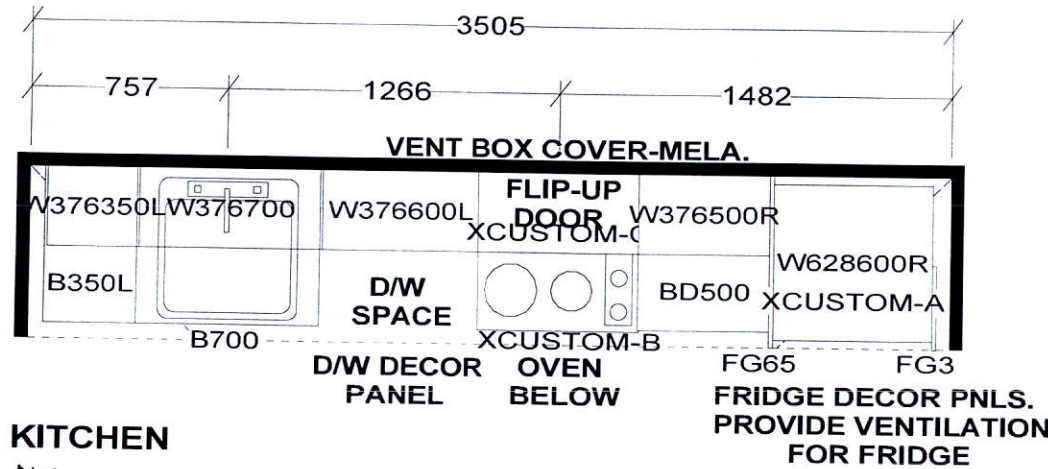

KITCHEN
- 41" uppers

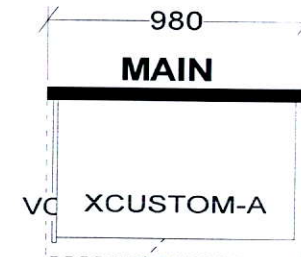

CUSTOM 2 DRAWER VANITY
(Drawers modified to clear plumbing)
FLOATING TOEKICK

KITCHEN BASES & VANITIES INSTALLED
WITH ADJUSTABLE LEGS

APPLIANCE PACKAGE:
24" INTEGRATED FRIDGE W/ DECOR PNLS
24" INTEGRATED DISHWASHER W/ DECOR PNL
24" BUILT-IN OVEN
24" COOKTOP
24" MICROWAVE HOOD FAN

S e l b a I n d u s t r i e s

WDTH _____ W HGHT _____ W CNT _____ FL HGHT _____ DWY H _____ ST CENT _____ 2X4 _____ VENT BOX COVER _____

TOWER SUITES:
760MM HIGH UPPER CABINETS
WHITE STEEL DRAWER BOXES
COUNTERTOPS BY OTHERS
VENT BOX COVERS
CUSTOM VANITIES

This drawing is the intellectual property of
SELBA INDUSTRIES INC. and is an
original design which must not be released
or copied unless applicable fee has been
paid or job order placed.



JOB NUMBER:
BUILDER: GREENPARK
SITE NAME: PETALUMA
MODEL: 1 BEDROOM-B 463, B 493, B 610
LOT #:
DESIGNER: KS
DATE: JAN 8 18



Frameless Mirror Sliding Door with Mirror Fascia - \$680