

CONSTRUCTION SUMMARY

330 Richmond - Petaluma Building Corp.

PURCHASER: Kambiz KONESHLO

TEL: RES.: 416-223-5728

Unit 7, Level 9 (1008-1)

Floor Plan
B635

CABINETRY

1 - KITCHEN - 41" UPPER CABINETRY

31Jan19 Note:

CABINETRY ACCESSORIES

1 - KITCHEN - ADD APPROX 5' ISLAND WITH FLUSH OVERHANG - STANDARD CABINETRY AND COUNTERTOP

31Jan19 Note:

CONSTRUCTION

1 - BEDROOM - SMOOTH CEILING

31Jan19 Note:

This Document is Extremely Time Sensitive - Printed 31 Jan 19 at 16:44

RECEIVED FEB 07 2019

Purchaser: Kambiz KONESHLO
Telephone Res. / Bus: (416) 223-5728 /
Decor Advisor: Candace Forza
Lock Date: 1/31/2019 16:44:35

Const. No.: Unit 7, Level 9
Municipal: 1008
Suite Type: B635
Project/Phase: Petaluma Building Corp./1

Layout Changes: ☐ Yes ☒ No Sketch Attached: ☒ Yes ☐ No Exterior Colour Scheme:

1. Kitchen and Vanities

	Style and Colour	Counter	Hardware
Kitchen / Breakfast	SEE BELOW	QUARTZ-TORRONE-STRAIGHT POLISHED EDGE	STD
Main Bath	DORAL H3078-HACIENDA WHITE	QUARTZ-TORRONE-STRAIGHT POLISHED EDGE	STD
Master Ensuite Bathroom	N/A	N/A	N/A

Appliances: Built In Appliances ☒ Yes ☐ No 41" Upper Cabinets ☒ Yes ☐ No Slide In Stove ☐ Yes ☒ No

Comment

KITCHEN- CABINETRY- BASE DORAL H3078-HACIENDA WHITE *** UPPERS SENOSAN WHITE

2. Flooring

		Grout-If App.	At a 45
Entrance Vestibule	STRIP-MIRAGE-LOCK-RED OAK-CASHMERE-CHARCOAL-4 5/16"		<input type="checkbox"/>
Main Hall	STRIP-MIRAGE-LOCK-RED OAK-CASHMERE-CHARCOAL-4 5/16"		<input type="checkbox"/>
Kitchen / Breakfast	STRIP-MIRAGE-LOCK-RED OAK-CASHMERE-CHARCOAL-4 5/16"		<input type="checkbox"/>
Laundry Room	TILE-LIFE SILVER-12X24		<input type="checkbox"/>
Main Bath	TILE-LIFE SILVER-12X24	STANDARD	<input type="checkbox"/>
Master Ensuite Bathroom	N/A	STANDARD	<input type="checkbox"/>
	N/A		<input type="checkbox"/>
Living Room	STRIP-MIRAGE-LOCK-RED OAK-CASHMERE-CHARCOAL-4 5/16"		<input type="checkbox"/>
Dining Room	STRIP-MIRAGE-LOCK-RED OAK-CASHMERE-CHARCOAL-4 5/16"		<input type="checkbox"/>
Den / Library / Study	N/A		<input type="checkbox"/>
Master Bedroom	STRIP-MIRAGE-LOCK-RED OAK-CASHMERE-CHARCOAL-4 5/16"		<input type="checkbox"/>
Bedroom #2	N/A		<input type="checkbox"/>
Bedroom #3	N/A		<input type="checkbox"/>
			<input type="checkbox"/>

Comment

3. Wall Tile

	Selection	Grout	Describe
Main Bath			
Tub Deck Wall	N/A		
Shower Stall	N/A		
Bathtub Enclosure Walls	TILE-GLOSSY WHITE-3X6	STANDARD	
Master Ensuite Bathroom			
Tub Deck Wall	N/A		
Shower Stall	N/A		
Bathtub Enclosure Walls	N/A		
Kitchen Backsplash	BACK PAINTED GLASS-BM-#OC-16	STANDARD	
Backsplash Behind Fridge	N/A		

Comment

** Refer to Construction Summary

4. Misc

Water Line for Fridge	N/A	
Interior Door Handles	AS PER CONSTRUCTION SPECS	
Ceramic Bathroom Accessories	YES	<input checked="" type="radio"/> Yes <input type="radio"/> No

Comment

Purchaser: Kambiz KONESHLO
Telephone Res. / Bus: (416) 223-5728 /
Decor Advisor: Candace Forza
Lock Date: 1/31/2019 16:44:35

Const. No.: Unit 7, Level 9
Municipal: 1008
Suite Type: B635
Project/Phase: Petaluma Building Corp./1

5. Plaster Mouldings and Medallions

Entrance Vestibule	N/A	
Main Hall	N/A	
Kitchen/Breakfast	N/A	
Laundry Room	N/A	
Main Bath	N/A	
Master Ensuite Bathroom	N/A	

Living Room	N/A	
Dining Room	N/A	
Den / Library /Study	N/A	
Master BedRoom	N/A	
BedRoom #2	N/A	
BedRoom #3	N/A	

Comment

** Refer to Construction Summary

6. Wall Paint

Entrance Vestibule	43-BIRCH WHITE
Main Hall	43-BIRCH WHITE
Kitchen / Breakfast	43-BIRCH WHITE
Laundry Room	43-BIRCH WHITE
Main Bath	43-BIRCH WHITE
Master Ensuite	N/A
	N/A

Living Room	43-BIRCH WHITE
Dining Room	43-BIRCH WHITE
Den/Library	N/A
Master Bedroom	43-BIRCH WHITE
Bedroom #2	N/A
Bedroom #3	N/A

Comment

7. General Comments

** Refer to Construction Summary

Disclaimers and Notes

- 1) Colours of all materials are as close as possible to builder's selection, but not necessarily identical due to variances in manufacturing.
- 2) Any extras listed above are null and void unless accompanied by a separate invoice/amendment. Said invoice must be paid in full.
- 3) The Purchaser agrees that this colour selection is final and that no changes will be permitted, unless required by the Vendor.
- 4) The Purchaser acknowledges reading and accepting document which contains other miscellaneous disclaimers.



Signature: _____ Date: _____

Signature: _____ Date: _____

SCHEDULE 'A'

330
RICHMOND

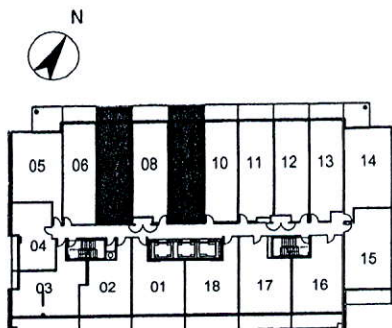
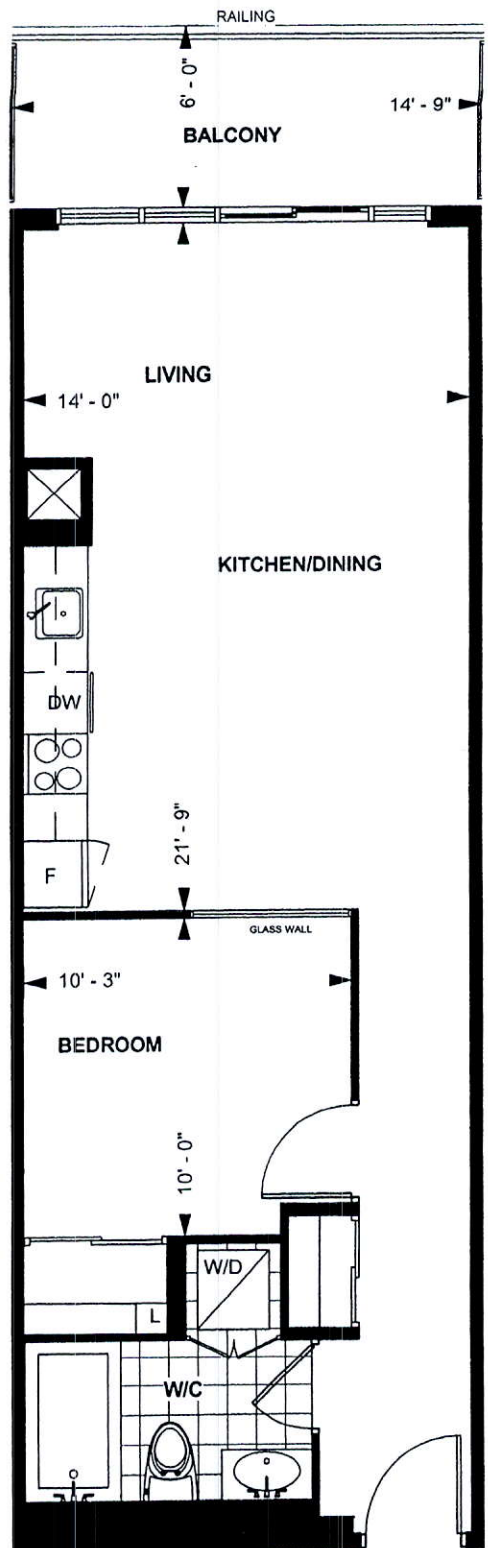

LEVEL 5 - 9

TOWER SUITE

B 635

9' CEILING *

635 sq. ft.

1-BEDROOM

Purchaser Initials Purchaser Initials

Date

Unit No. 7 Level No. 9 Suite No. 1008

Dimensions, specification, tile floor pattern and architectural detailing (including window size and location) are approximate and subject to modifications without notice. Orientation of suite may vary from the stated floor area.
*Ceiling height measured from top of floor slab to underside of slab above before finishes, and excluding bulkheads and required drop ceilings. E.&O.E.

Handwritten signature

K.C.

FILE NAME:
GLOSS CONDO

330 RICHMOND
PROTOTYPE FOR EXTRA

SEP 27 18 FB

THIS LAYOUT CONTAINS EXTRAS
THAT ARE NOT PART OF CONTRACT

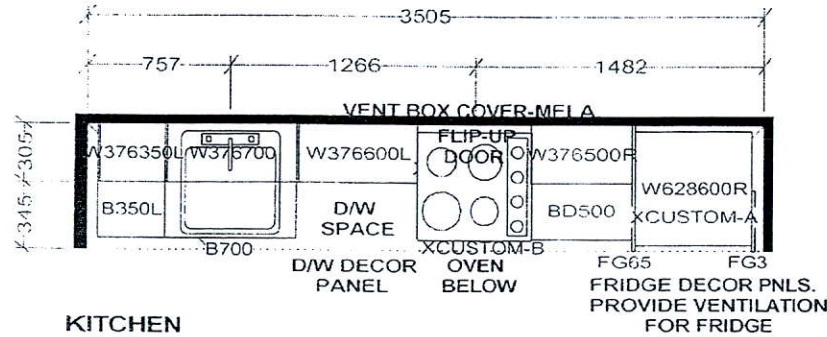

KITCHEN BASES & VANITIES INSTALLED
WITH ADJUSTABLE LEGS

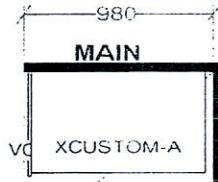
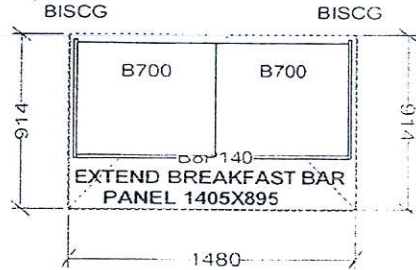

CUSTOM 2 DRAWER VANITY
(Drawers modified to clear plumbing)
FLOATING TOEKICK

APPLIANCE PACKAGE:
24" INTEGRATED FRIDGE W/ DECOR PNLS
24" INTEGRATED DISHWASHER W/ DECOR PNL
24" BUILT-IN OVEN
24" COOKTOP
24" MICROWAVE HOOD FAN

Selba Industries

W	WDTH	W	HGHT	W	CNT	FL	HGHT	DWY	H	ST	CENT	2X4	VENT BOX COVER
TOWER SUITES: 760MM HIGH UPPER CABINETS WHITE STEEL DRAWER BOXES COUNTERTOPS BY OTHERS VENT BOX COVERS CUSTOM VANITIES													JOB NUMBER: BUILDER: GREENPARK SITE NAME: PETALUMA MODEL: 1 BEDROOM-B 592, B 605, B 635 LOT #: DESIGNER: KS DATE: JAN 8 18

This drawing is the intellectual property of
SELBA INDUSTRIES INC, and is an
original design which must not be released
or copied unless applicable fee has been
paid or job order placed.

