

CONSTRUCTION SUMMARY
330 Richmond - Petaluma Building Corp.

PURCHASER: Alexandra PELTS

TEL: RES.: 416-417-7706

Unit 10, Level 14 (1711-1)

Floor Plan
C683

CABINETRY

1 - KITCHEN - 41" UPPER CABINETRY

04Feb19 Note:

CERAMIC TILE

1 - BATHROOM - DELETE STANDARD WHITE CERAMIC ACCESSORIES - DO NOT INSTALL SOAP DISH, TOWEL RACK OR TISSUE HOLDER

04Feb19 Note:

CONSTRUCTION

1 - BEDROOM - SMOOTH CEILING

04Feb19 Note:

COUNTER TOP

1 - BATHROOM - UPGRADED EDGE ON COUNTERTOP

04Feb19 Note:

1 - KITCHEN - UPGRADED EDGE ON COUNTERTOP

04Feb19 Note:

1 - BATHROOM - HIGH-END QUARTZ COUNTERTOP IN LIEU OF STANDARD AS PER OFFER

04Feb19 Note:

1 - KITCHEN - HIGH-END QUARTZ COUNTERTOP IN LIEU OF STANDARD AS PER OFFER

04Feb19 Note:

DOORS AND TRIM

2 - FOYER & BEDROOM - FRAMELESS MIRROR CLOSET SLIDING DOORS WITH MIRROR FASCIA

04Feb19 Note:

HARDWOOD FLOORING

1 - THROUGHOUT - STANDARD NON-TILED AREAS - UPGRADE 2 HARDWOOD FLOORING IN LIEU OF STANDARD AS PER OFFER

04Feb19 Note:

PLUMBING

1 - BATHROOM - MOEN 90 DEGREE BATHROOM ACCESSORIES - CHROME

TOILET PAPER HOLDER #YB8808

TOWEL RING #YB8886

TOWEL BAR #YB8824

04Feb19 Note:

PROMOTIONAL

1 - LESS CREDIT FROM PURCHASERS EXTRA SHEET IN OFFER

04Feb19 Note:

EXTRAS AS PER OFFER

The Vendor agrees that notwithstanding any other term or provision in this Agreement included in the Purchase Price and in addition to those items

detailed in Schedule D to the Agreement of Purchase and Sale, the Purchaser is entitled to a credit of Fiv

Worksheet Note:

This Document is Extremely Time Sensitive - Printed 4 Feb 19 at 14:58

RECEIVED FEB 05 2019

Purchaser: Alexandra PELTS
Telephone Res. / Bus: (416) 417-7706 /
Decor Advisor: Candace Forza
Lock Date: 2/4/2019 14:47:56

Const. No.: Unit 10, Level 14
Municipal: 1711
Suite Type: C683
Project/Phase: Petaluma Building Corp./1

Layout Changes: ☐ Yes ☒ No Sketch Attached: ☒ Yes ☐ No Exterior Colour Scheme:

1. Kitchen and Vanities

	Style and Colour	Counter	Hardware
Kitchen / Breakfast	SEE BELOW	QUARTZ-FROSTY CARRARA-#360 EDGE	STD
Main Bath	DORAL H3081-HACIENDA BLACK	QUARTZ-FROSTY CARRARA-#360 EDGE	STD
Master Ensuite Bathroom	N/A	N/A	N/A

Appliances: Built In Appliances ☒ Yes ☐ No 41" Upper Cabinets ☒ Yes ☐ No Slide In Stove ☐ Yes ☒ No

Comment
KITCHEN CABINETRY - BASE - DORAL H3081-HACIENDA BLACK *** UPPERS - SENOSAN LIGHT GREY

2. Flooring

		Grout-If App.	At a 45
Entrance Vestibule	STRIP-MIRAGE-LOCK-RED OAK-BRUSHED-DURA MATT-HOPSCOTCH-4 5/16"		<input type="checkbox"/>
Main Hall	STRIP-MIRAGE-LOCK-RED OAK-BRUSHED-DURA MATT-HOPSCOTCH-4 5/16"		<input type="checkbox"/>
Kitchen / Breakfast	STRIP-MIRAGE-LOCK-RED OAK-BRUSHED-DURA MATT-HOPSCOTCH-4 5/16"		<input type="checkbox"/>
Laundry Room	TILE-WHITE-8X8	STANDARD	<input type="checkbox"/>
Main Bath	TILE-LIFE ICE-12X24	STANDARD	<input type="checkbox"/>
Master Ensuite Bathroom	N/A		<input type="checkbox"/>
	N/A		<input type="checkbox"/>
Living Room	STRIP-MIRAGE-LOCK-RED OAK-BRUSHED-DURA MATT-HOPSCOTCH-4 5/16"		<input type="checkbox"/>
Dining Room	STRIP-MIRAGE-LOCK-RED OAK-BRUSHED-DURA MATT-HOPSCOTCH-4 5/16"		<input type="checkbox"/>
Den / Library / Study	STRIP-MIRAGE-LOCK-RED OAK-BRUSHED-DURA MATT-HOPSCOTCH-4 5/16"		<input type="checkbox"/>
Master Bedroom	STRIP-MIRAGE-LOCK-RED OAK-BRUSHED-DURA MATT-HOPSCOTCH-4 5/16"		<input type="checkbox"/>
Bedroom #2	N/A		<input type="checkbox"/>
Bedroom #3	N/A		<input type="checkbox"/>
			<input type="checkbox"/>

Comment

3. Wall Tile

	Selection	Grout	Describe
Main Bath			
Tub Deck Wall	N/A		
Shower Stall	TILE-GLOSSY WHITE-3X6	STANDARD	
Bathtub Enclosure Walls	N/A		
Master Ensuite Bathroom			
Tub Deck Wall	N/A		
Shower Stall	N/A		
Bathtub Enclosure Walls	N/A		
Kitchen Backsplash	BACK PAINTED GLASS-BM-#HC-170	STANDARD	
Backsplash Behind Fridge	N/A		

Comment
** Refer to Construction Summary

4. Misc

Water Line for Fridge	N/A
Interior Door Handles	AS PER CONSTRUCTION SPECS
Ceramic Bathroom Accessories	NO - UPGRADED MOEN 90 DEGREE
Comment	<div><input type="radio"/> Yes <input checked="" type="radio"/> No</div>

Purchaser: Alexandra PELTS
Telephone Res. / Bus: (416) 417-7706 /
Decor Advisor: Candace Forza
Lock Date: 2/4/2019 14:47:56

Const. No.: Unit 10, Level 14
Municipal: 1711
Suite Type: C683
Project/Phase: Petaluma Building Corp./1

5. Plaster Mouldings and Medallions

Entrance Vestibule	N/A		Living Room	N/A	
Main Hall	N/A		Dining Room	N/A	
Kitchen/Breakfast	N/A		Den / Library /Study	N/A	
Laundry Room	N/A		Master Bedroom	N/A	
Main Bath	N/A		BedRoom #2	N/A	
Master Ensuite Bathroom	N/A		BedRoom #3	N/A	

Comment

** Refer to Construction Summary

6. Wall Paint

Entrance Vestibule	43- BIRCH WHITE	Living Room	43- BIRCH WHITE
Main Hall	43- BIRCH WHITE	Dining Room	43- BIRCH WHITE
Kitchen / Breakfast	43- BIRCH WHITE	Den/Library	43- BIRCH WHITE
Laundry Room	43- BIRCH WHITE	Master Bedroom	43- BIRCH WHITE
Main Bath	43- BIRCH WHITE	Bedroom #2	N/A
Master Ensuite	N/A	Bedroom #3	N/A
	N/A		

Comment

7. General Comments

** Refer to Construction Summary

Disclaimers and Notes

- 1) Colours of all materials are as close as possible to builder's selection, but not necessarily identical due to variances in manufacturing.
- 2) Any extras listed above are null and void unless accompanied by a separate invoice/amendment. Said invoice must be paid in full.
- 3) The Purchaser agrees that this colour selection is final and that no changes will be permitted, unless required by the Vendor.
- 4) The Purchaser acknowledges reading and accepting document which contains other miscellaneous disclaimers.

Signature: 

Date: Feb 4 '19

Signature: _____

Date: _____

90°™

Traditional | Transitional | Modern

Geometric forms, squared corners and straight lines create an urban focal point for today's contemporary baths.

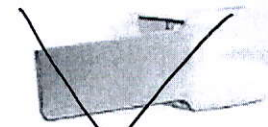

Toilet Tank Lever
Model YB8801



Robe Hook
Model YB8803

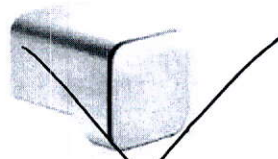

Cabinet Knob
Model YB8805

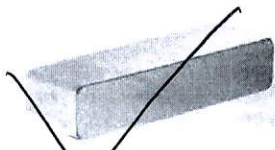

Drawer Pull
Model YB8807

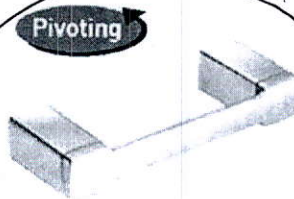

Pivoting Paper Holder
Model YB8808
Chrome

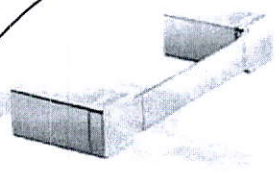

Mini Towel Bar
Model YB8886
Chrome

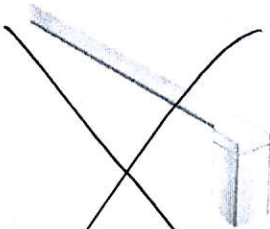

18" Towel Bar
Model YB8818

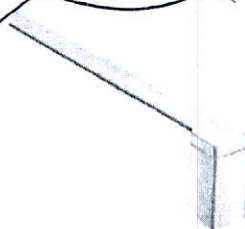

24" Towel Bar
Model YB8824
Chrome



Designer Grab Bar
Models: Chrome Other

FINISH OPTIONS:



CH

BN

To order, combine the model number with one of these finish letter(s):
Chrome (CH), LifeShine® Brushed Nickel (BN).

SCHEDULE 'A'

330
RICHMOND

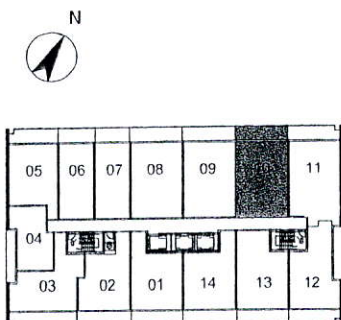
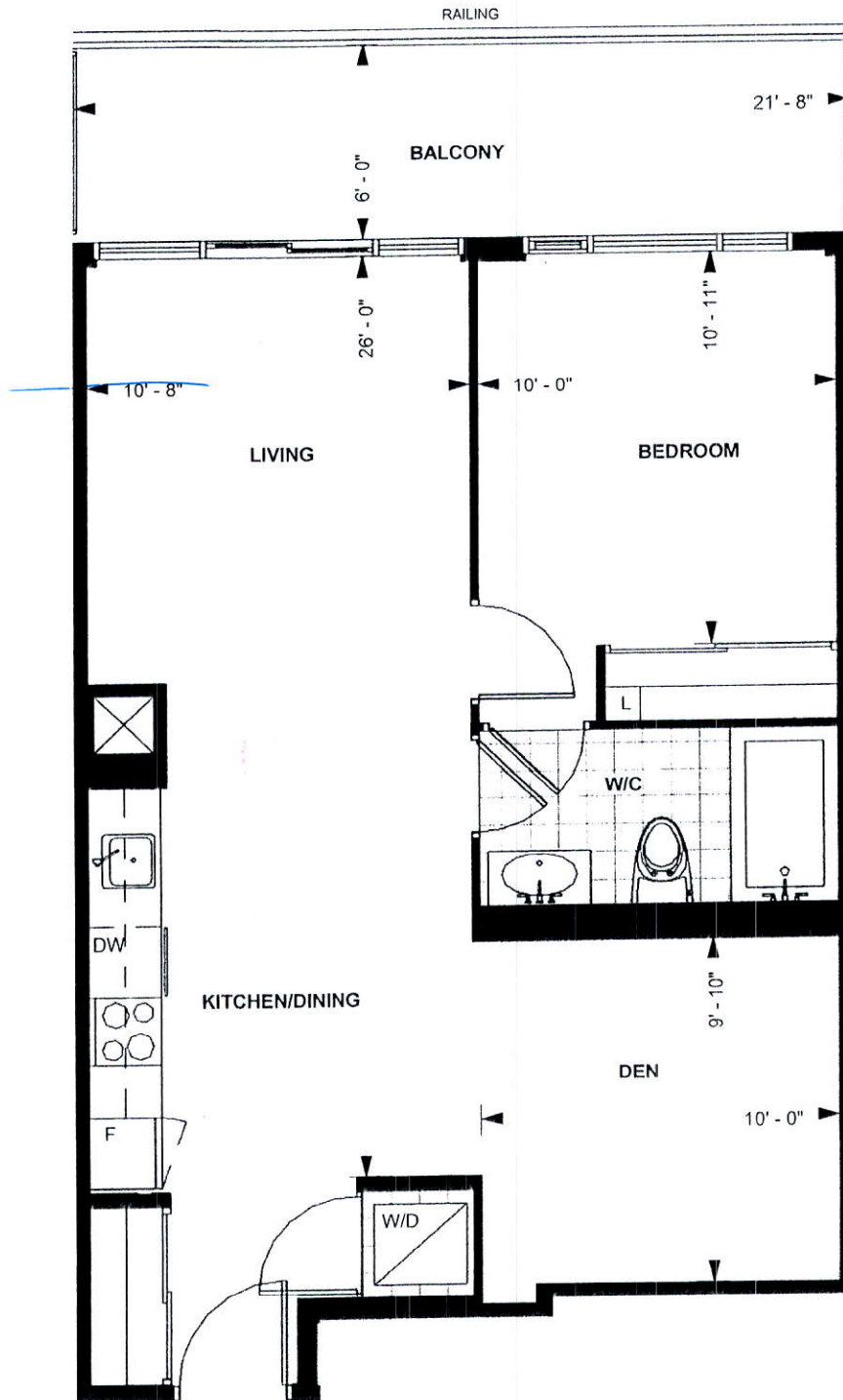

LEVEL 13-20

TOWER SUITE

C 683

9' CEILING *

683 sq. ft.

1-BEDROOM PLUS DEN

Purchaser Initials Purchaser Initials

Date

Unit No. 10 Level No. 14 Suite No. 1711

Dimensions, specification, tile floor pattern and architectural detailing (including window size and location) are approximate and subject to modifications without notice. Orientation of suite may vary from the stated floor area.
*Ceiling height measured from top of floor slab to underside of slab above before finishes, and excluding bulkheads and required drop ceilings. E.&O.E.

*up. countertop Edge
in Kitchen + Bath

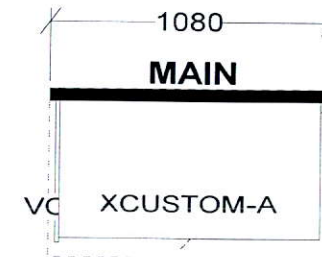
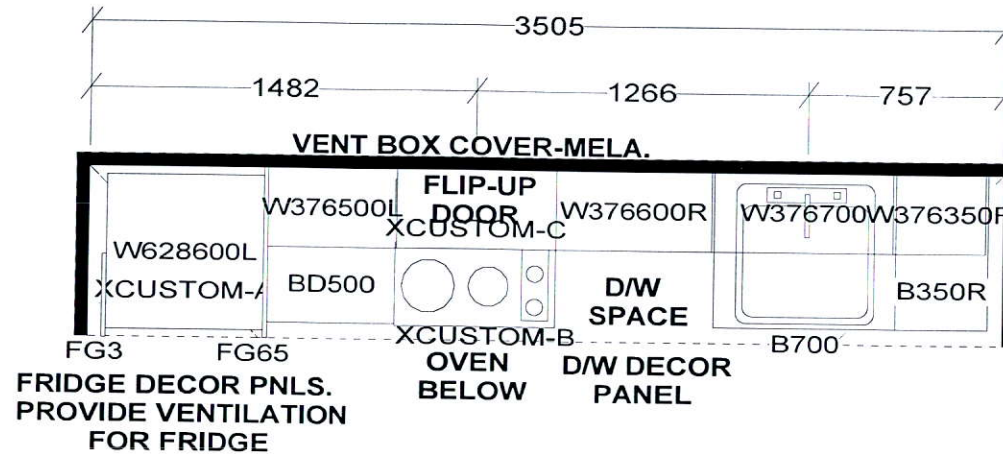

KITCHEN

41" uppers

KITCHEN BASES & VANITIES INSTALLED
WITH ADJUSTABLE LEGS

CUSTOM 2 DRAWER VANITY
(Drawers modified to clear plumbing)
FLOATING TOEKICK

APPLIANCE PACKAGE:

- 24" INTEGRATED FRIDGE W/ DECOR PNLS
- 24" INTEGRATED DISHWASHER W/ DECOR PNL
- 24" BUILT-IN OVEN
- 24" COOKTOP
- 24" MICROWAVE HOOD FAN

Selba Industries

WDTH W HGT W CNT FL HGT DWY H ST CENT 2X4 VENT BOX COVER

TOWER SUITES:
760MM HIGH UPPER CABINETS
WHITE STEEL DRAWER BOXES
COUNTERTOPS BY OTHERS
VENT BOX COVERS
CUSTOM VANITIES

This drawing is the intellectual property of
SELBA INDUSTRIES INC. and is an
original design which must not be released
or copied unless applicable fee has been
paid or job order placed.



JOB NUMBER:
BUILDER: GREENPARK
SITE NAME: PETALUMA
MODEL: 1 BEDROOM + DEN - C 683, C 702
LOT #:
DESIGNER: KS
DATE: JAN 8 18

AP



Frameless Mirror Sliding Door with Mirror Fascia - 8682c