

CONSTRUCTION SUMMARY  
330 Richmond - Petaluma Building Corp.

PURCHASER: Rajesh N. KHANNA

TEL: RES.: 905-712-3278

Unit 10, Level 12 (1511-1)

Floor Plan  
C683

CABINETRY

1 - KITCHEN - 41" UPPER CABINETRY

03Jan19 Note:

CERAMIC TILE

1 - BATHROOM - DELETE WHITE CERAMIC ACCESSORIES - DO NOT INTSALL SOAP DISH, TOWEL RACK OR TISSUE HOLDER

03Jan19 Note:

CONSTRUCTION

1 - BEDROOM - SMOOTH CEILING

03Jan19 Note:

1 - MAIN BATH - 5 FOOT SHOWER ~~WITH SLIDING CHROME FRAMED GLASS DOORS~~ IN LIEU OF TUB

27Jun18 Note:

COUNTER TOP

1 - KITCHEN - UPGRADED EDGE ON COUNTERTOP

03Jan19 Note:

MIRRORS AND GLASS

1 - BATHROOM - FRAMELESS GLASS DOOR AND PANEL FOR 5' OPENING - CHROME KNOBA ND HINGES

03Jan19 Note:

2 - FOYER & BEDROOM - FRAMELESS MIRROR SLIDING CLOSET DOORS WITH MIRROR FASCIA

03Jan19 Note:

PLUMBING

1 - BATHROOM - MOEN 90 DEGREE BATHROOM ACCESSORIES - CHROME  
TOILET PAPER HOLDER #YB8808  
TOWEL RING #YB8886  
TOWEL BAR #YB8824

03Jan19 Note:

PROMOTIONAL

1 - LESS BALANCE OF CREDIT FROM PURCHASER EXTRA SHEET IN OFFER

03Jan19 Note:

1 - PARTIAL REDEPTION OF PROMOTIONAL PACKAGE \$2,800.00 BALANCE (\$2,200) FORWARD TO BE USED AT A LATER DATE.  
ORIGINAL PROMOTIONAL PACKAGE OF \$5,000 AS PER SCHEDULE PE DATED -OCTOBER 18, 2015

27Jun18 Note:

EXTRAS AS PER OFFER

The Vendor agrees that notwithstanding any other term or provision in this Agreement included in the Purchase Price and in addition to those items detailed in Schedule D to the Agreement of Purchase and Sale, the Purchaser is entitled to a credit of Fiv

Worksheet Note:

This Document is Extremely Time Sensitive - Printed 3 Jan 19 at 14:49

RECEIVED JAN 25 2019



Purchaser: Rajesh N. KHANNA  
Telephone Res. / Bus: (905) 712-3278 /  
Decor Advisor: Candace Forza  
Lock Date: 1/3/2019 14:49:03

Const. No.: Unit 10, Level 12  
Municipal: 1511  
Suite Type: C683  
Project/Phase: Petaluma Building Corp./1

Layout Changes: ☐ Yes ☒ No Sketch Attached: ☒ Yes ☐ No Exterior Colour Scheme:

1. Kitchen and Vanities

	Style and Colour	Counter	Hardware
Kitchen / Breakfast	SEE BELOW	QUARTZ-AMIATA-#360 EDGE	STD
Main Bath	DORAL H3081-HACIENDA BLACK	QUARTZ-AMIATA-STRAIGHT POLISHED EDGE	STD
Master Ensuite Bathroom	N/A	N/A	N/A

Appliances: Built In Appliances ☒ Yes ☐ No 41" Upper Cabinets ☒ Yes ☐ No Slide In Stove ☐ Yes ☒ No

Comment

Kitchen-Cabinetry- Base- Doral H3081- Hacienda Black .  
uppers- Senosan Light Grey

2. Flooring

		Grout-If App.	At a 45
Entrance Vestibule	STRIP-MIRAGE-LOCK-RED OAK-CASHMERE-GRAPHITE-4 5/16"		<input type="checkbox"/>
Main Hall	STRIP-MIRAGE-LOCK-RED OAK-CASHMERE-GRAPHITE-4 5/16"		<input type="checkbox"/>
Kitchen / Breakfast	STRIP-MIRAGE-LOCK-RED OAK-CASHMERE-GRAPHITE-4 5/16"		<input type="checkbox"/>
Laundry Room	TILE-WHITE-8X8		<input type="checkbox"/>
Main Bath	TILE-LIFE ICE-12X24	STANDARD	<input type="checkbox"/>
Master Ensuite Bathroom	N/A	STANDARD	<input type="checkbox"/>
	N/A		<input type="checkbox"/>
Living Room	STRIP-MIRAGE-LOCK-RED OAK-CASHMERE-GRAPHITE-4 5/16"		<input type="checkbox"/>
Dining Room	STRIP-MIRAGE-LOCK-RED OAK-CASHMERE-GRAPHITE-4 5/16"		<input type="checkbox"/>
Den / Library / Study	STRIP-MIRAGE-LOCK-RED OAK-CASHMERE-GRAPHITE-4 5/16"		<input type="checkbox"/>
Master Bedroom	STRIP-MIRAGE-LOCK-RED OAK-CASHMERE-GRAPHITE-4 5/16"		<input type="checkbox"/>
Bedroom #2	N/A		<input type="checkbox"/>
Bedroom #3	N/A		<input type="checkbox"/>
			<input type="checkbox"/>

Comment

3. Wall Tile

	Selection	Grout	Describe
Main Bath			
Tub Deck Wall	N/A		
Shower Stall	TILE-GLOSSY WHITE-3X6	STANDARD	
Bathtub Enclosure Walls	N/A		
Master Ensuite Bathroom			
Tub Deck Wall	N/A		
Shower Stall	N/A		
Bathtub Enclosure Walls	N/A		
Kitchen Backsplash	BACK PAINTED GLASS-BM-#HC-170	STANDARD	
Backsplash Behind Fridge	N/A		

Comment

\*\* Refer to Construction Summary

4. Misc

Water Line for Fridge N/A  
Interior Door Handles AS PER CONSTRUCTION SPECS  
Ceramic Bathroom Accessories NO - UPGRADED -MOEN 90 DEGREE ☐ Yes ☒ No

Comment



Purchaser: Rajesh N. KHANNA  
Telephone Res. / Bus: (905) 712-3278 /  
Decor Advisor: Candace Forza  
Lock Date: 1/3/2019 14:49:03

Const. No.: Unit 10, Level 12  
Municipal: 1511  
Suite Type: C683  
Project/Phase: Petaluma Building Corp./1

5. Plaster Mouldings and Medallions

Entrance Vestibule	N/A	
Main Hall	N/A	
Kitchen/Breakfast	N/A	
Laundry Room	N/A	
Main Bath	N/A	
Master Ensuite Bathroom	N/A	
	N/A	

Living Room	N/A	
Dining Room	N/A	
Den / Library /Study	N/A	
Master BedRoom	N/A	
BedRoom #2	N/A	
BedRoom #3	N/A	

Comment

\*\* Refer to Construction Summary

6. Wall Paint

Entrance Vestibule	43 BIRCH WHITE
Main Hall	43 BIRCH WHITE
Kitchen / Breakfast	43 BIRCH WHITE
Laundry Room	43 BIRCH WHITE
Main Bath	43 BIRCH WHITE
Master Ensuite	N/A
	N/A

Living Room	43 BIRCH WHITE
Dining Room	43 BIRCH WHITE
Den/Library	43 BIRCH WHITE
Master Bedroom	43 BIRCH WHITE
Bedroom #2	N/A
Bedroom #3	N/A

Comment

7. General Comments

\*\* Refer to Construction Summary

Disclaimers and Notes

- Colours of all materials are as close as possible to builder's selection, but not necessarily identical due to variances in manufacturing.
- Any extras listed above are null and void unless accompanied by a separate invoice/amendment. Said invoice must be paid in full.
- The Purchaser agrees that this colour selection is final and that no changes will be permitted, unless required by the Vendor.
- The Purchaser acknowledges reading and accepting document which contains other miscellaneous disclaimers.

Signature:  Date: 03 JAN 2019 Signature: \_\_\_\_\_ Date: \_\_\_\_\_

# 90°™

Traditional | Transitional | Modern

*Geometric forms, squared corners and straight lines create an urban focal point for today's contemporary baths.*



**Toilet Tank Lever**  
Model YB8801

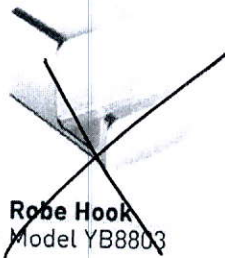

**Robe Hook**  
Model YB8803

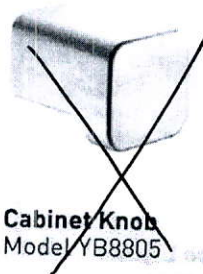

**Cabinet Knob**  
Model YB8805

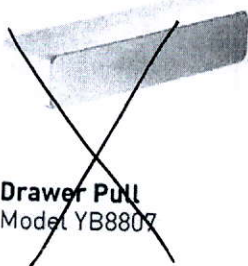

**Drawer Pull**  
Model YB8807

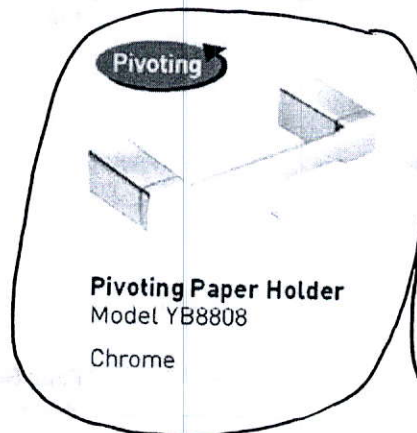

**Pivoting Paper Holder**  
Model YB8808  
Chrome

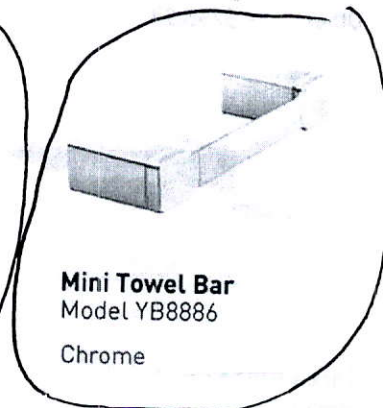

**Mini Towel Bar**  
Model YB8886  
Chrome

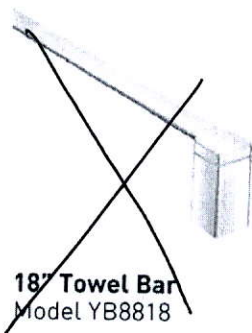

**18" Towel Bar**  
Model YB8818



**24" Towel Bar**  
Model YB8824  
Chrome

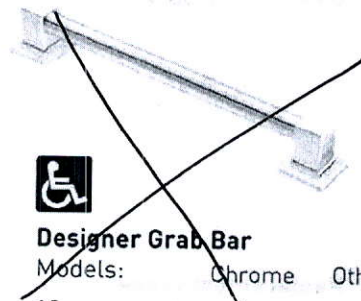

**Designer Grab Bar**  
Models: Chrome Other

## FINISH OPTIONS:

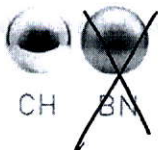

To order, combine the model number with one of these finish letter(s):  
Chrome (CH), LifeShine® Brushed Nickel (BN).

# SCHEDULE 'A'

## 330

RICHMOND

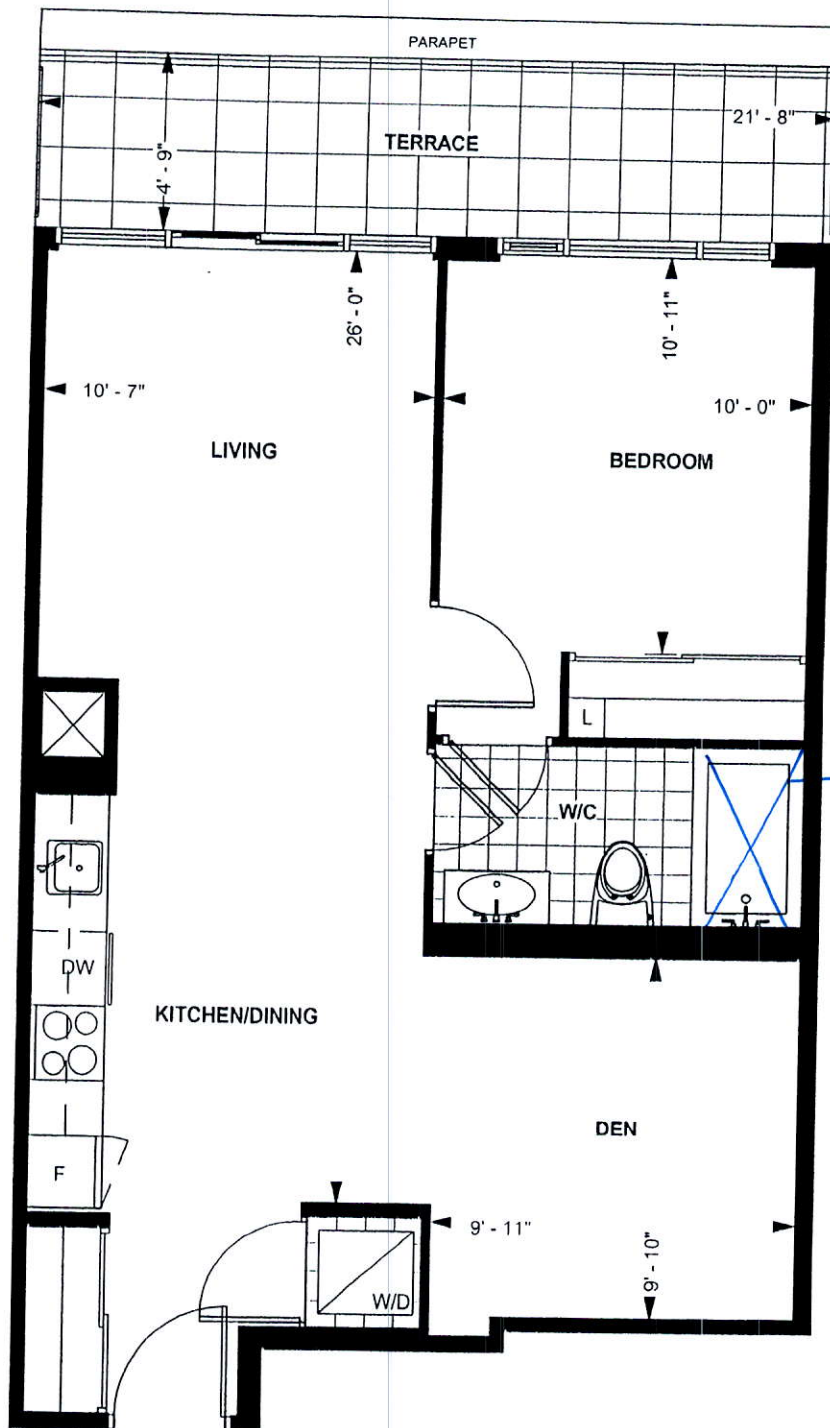

5' Shower  
With Frameless  
Door + Panel.

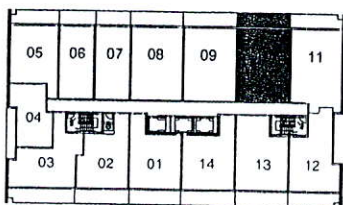

LEVEL 12

TOWER SUITE

C 683

9' CEILING \*

683 sq. ft.

1-BEDROOM PLUS DEN

Purchaser Initials Purchaser Initials

Date

Unit No. 10 Level No. 12 Suite No. 1511

Dimensions, specification, tile floor pattern and architectural detailing (including window size and location) are approximate and subject to modifications without notice. Orientation of suite may vary from the stated floor area.  
\*Ceiling height measured from top of floor slab to underside of slab above before finishes, and excluding bulkheads and required drop ceilings. E.&O.E.



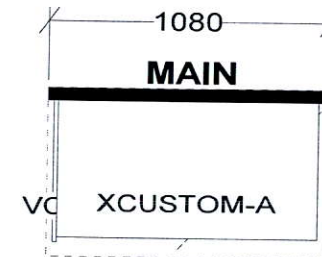
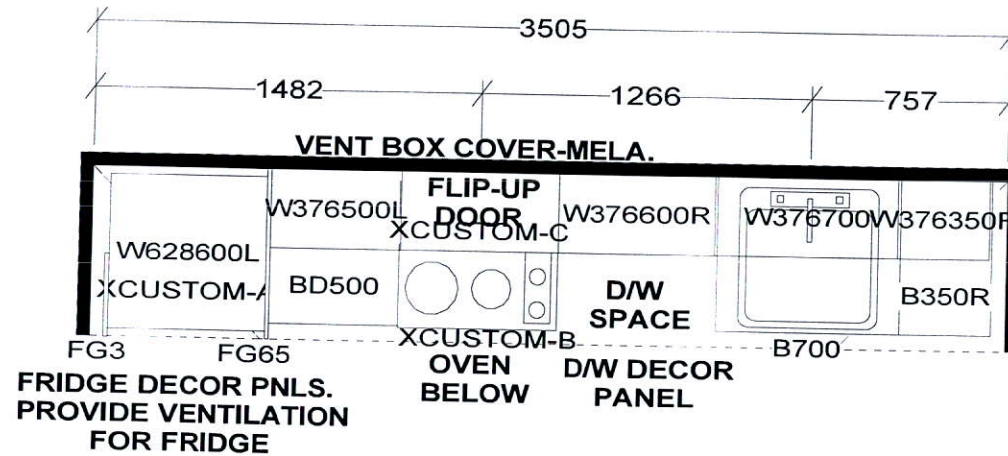

- KITCHEN**
- 41" Upper Cabinetry
  - upgrade counter Edge

KITCHEN BASES & VANITIES INSTALLED  
WITH ADJUSTABLE LEGS

CUSTOM 2 DRAWER VANITY  
(Drawers modified to clear plumbing)  
FLOATING TOEKICK

APPLIANCE PACKAGE:  
24" INTEGRATED FRIDGE W/ DECOR PNLS  
24" INTEGRATED DISHWASHER W/ DECOR PNL  
24" BUILT-IN OVEN  
24" COOKTOP  
24" MICROWAVE HOOD FAN

*S e l b a I n d u s t r i e s*

/ WIDTH \_\_\_\_\_ W H G H T \_\_\_\_\_ W C N T \_\_\_\_\_ F L H G H T \_\_\_\_\_ D W Y H \_\_\_\_\_ S T C E N T \_\_\_\_\_ 2X4 \_\_\_\_\_ V E N T B O X C O V E R \_\_\_\_\_

TOWER SUITES:  
760MM HIGH UPPER CABINETS  
WHITE STEEL DRAWER BOXES  
COUNTERTOPS BY OTHERS  
VENT BOX COVERS  
CUSTOM VANITIES

This drawing is the intellectual property of  
SELBA INDUSTRIES INC. and is an  
original design which must not be released  
or copied unless applicable fee has been  
paid or job order placed.



JOB NUMBER:  
BUILDER: GREENPARK  
SITE NAME: PETALUMA  
MODEL: 1 BEDROOM + DEN - C 683, C 702  
LOT #:  
DESIGNER: KS  
DATE: JAN 8 18





Frameless Minor Sliding Door with Minor Fascia - \$682