



CONSTRUCTION SUMMARY
330 Richmond - Petaluma Building Corp.

PURCHASER: Altamash KHAN
TEL: RES.: 416-554-4499

Unit 7, Level 8 (908-1)	Floor Plan B635		
-------------------------	--------------------	--	--

CABINETRY

1 - KITCHEN - 41" UPPER CABINETRY 24Oct18 Note:	
--	--

CABINETRY ACCESSORIES

1 - KITCHEN - ADD APPROX. 4' ISLAND WITH OVERHANG 24Oct18 Note:	
--	--

CERAMIC TILE

1 - BATHROOM - DELETE STANDARD CERMAIC BATHROOM ACCESSORIES - DO NOT INSTALL SOAP DISH, TOWEL RACK OR TISSUE HOLDER 24Oct18 Note:	
--	--

CONSTRUCTION

1 - BEDROOM - SMOOTH CEILING 24Oct18 Note:	
---	--

PLUMBING

3 - BATHROOM - MOEN MASON CHROME ACCESSORIES - TOWEL RING, TOILET PAPER HOLDER AND 24" TOWEL BAR 24Oct18 Note:	
---	--

This Document is Extremely Time Sensitive - Printed 24 Oct 18 at 11:18

RECEIVED OCT 30 2018

Purchaser: Altamash KHAN
Telephone Res. / Bus: (416) 554-4499 /
Decor Advisor: Candace Forza
Lock Date: 10/24/2018 11:18:23

Const. No.: Unit 7, Level 8
Municipal: 908
Suite Type: B635
Project/Phase: Petaluma Building Corp./1

Layout Changes: ☐ Yes ☒ No Sketch Attached: ☒ Yes ☐ No Exterior Colour Scheme:

1. Kitchen and Vanities

	Style and Colour	Counter	Hardware
Kitchen / Breakfast	SEE BELOW	QUARTZ-TORRONE-STRAIGHT POLISHED EDGE	STD
Main Bath	DORAL H3078-HACIENDA WHITE	QUARTZ-TORRONE-STRAIGHT POLISHED EDGE	STD
Master Ensuite Bathroom	N/A	N/A	N/A

Appliances: Built In Appliances ☒ Yes ☐ No 41" Upper Cabinets ☒ Yes ☐ No Slide In Stove ☐ Yes ☒ No

Comment

2. Flooring

		Grout-If App.	At a 45
Entrance Vestibule	STRIP-MIRAGE-LOCK-RED OAK-CASHMERE-NORDIC-4 5/16"		<input type="checkbox"/>
Main Hall	STRIP-MIRAGE-LOCK-RED OAK-CASHMERE-NORDIC-4 5/16"		<input type="checkbox"/>
Kitchen / Breakfast	STRIP-MIRAGE-LOCK-RED OAK-CASHMERE-NORDIC-4 5/16"		<input type="checkbox"/>
Laundry Room	TILE-LIFE SILVER-12X24		<input type="checkbox"/>
Main Bath	TILE-LIFE SILVER-12X24	STANDARD	<input type="checkbox"/>
Master Ensuite Bathroom	N/A	STANDARD	<input type="checkbox"/>
	N/A		<input type="checkbox"/>
Living Room	STRIP-MIRAGE-LOCK-RED OAK-CASHMERE-NORDIC-4 5/16"		<input type="checkbox"/>
Dining Room	STRIP-MIRAGE-LOCK-RED OAK-CASHMERE-NORDIC-4 5/16"		<input type="checkbox"/>
Den / Library / Study	N/A		<input type="checkbox"/>
Master Bedroom	STRIP-MIRAGE-LOCK-RED OAK-CASHMERE-NORDIC-4 5/16"		<input type="checkbox"/>
Bedroom #2	N/A		<input type="checkbox"/>
Bedroom #3	N/A		<input type="checkbox"/>
			<input type="checkbox"/>

Comment

3. Wall Tile

	Selection	Grout	Describe
Main Bath			
Tub Deck Wall	N/A		
Shower Stall	N/A		
Bathtub Enclosure Walls	TILE-GLOSSY WHITE-3X6	STANDARD	
Master Ensuite Bathroom			
Tub Deck Wall	N/A		
Shower Stall	N/A		
Bathtub Enclosure Walls	N/A		
Kitchen Backsplash	BACK PAINTED GLASS-BM-#OC-16	STANDARD	
Backsplash Behind Fridge	N/A		

Comment

** Refer to Construction Summary

4. Misc

Water Line for Fridge	N/A
Interior Door Handles	AS PER CONSTRUCTION SPECS
Ceramic Bathroom Accessories	NO - UPGRADE - MOEN MASON <input type="radio"/> Yes <input checked="" type="radio"/> No

Comment

Purchaser: Altamash KHAN
Telephone Res. / Bus: (416) 554-4499 /
Decor Advisor: Candace Forza
Lock Date: 10/24/2018 11:18:23

Const. No.: Unit 7, Level 8
Municipal: 908
Suite Type: B635
Project/Phase: Petaluma Building Corp./1

5. Plaster Mouldings and Medallions

Entrance Vestibule	N/A		Living Room	N/A	
Main Hall	N/A		Dining Room	N/A	
Kitchen/Breakfast	N/A		Den / Library /Study	N/A	
Laundry Room	N/A		Master BedRoom	N/A	
Main Bath	N/A		BedRoom #2	N/A	
Master Ensuite Bathroom	N/A		BedRoom #3	N/A	

Comment

** Refer to Construction Summary

6. Wall Paint

Entrance Vestibule	43-BIRCH WHITE	Living Room	43-BIRCH WHITE
Main Hall	43-BIRCH WHITE	Dining Room	43-BIRCH WHITE
Kitchen / Breakfast	43-BIRCH WHITE	Den/Library	N/A
Laundry Room	43-BIRCH WHITE	Master Bedroom	43-BIRCH WHITE
Main Bath	43-BIRCH WHITE	Bedroom #2	N/A
Master Ensuite	N/A	Bedroom #3	N/A
	N/A		

Comment

7. General Comments

** Refer to Construction Summary

Disclaimers and Notes

- 1) Colours of all materials are as close as possible to builder's selection, but not necessarily identical due to variances in manufacturing.
- 2) Any extras listed above are null and void unless accompanied by a separate invoice/amendment. Said invoice must be paid in full.
- 3) The Purchaser agrees that this colour selection is final and that no changes will be permitted, unless required by the Vendor.
- 4) The Purchaser acknowledges reading and accepting document which contains other miscellaneous disclaimers.

Signature:  _____ Date: _____ Signature: _____ Date: _____

Mason™

Traditional | Transitional | Modern

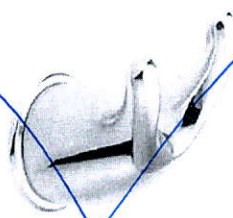

Double Robe Hook
Model YB8003

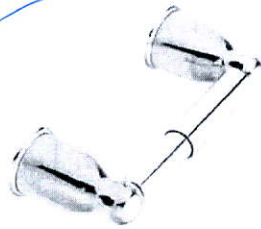

Paper Holder
Model YB8099 / YB8000
Chrome

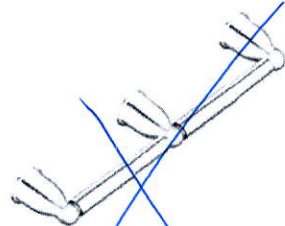

Double Paper Holder
Model YB8088
Not available in BC



Towel Ring
Model YB8086
Chrome

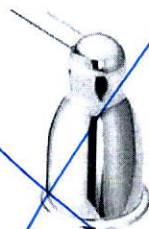

18" Towel Bar
Model YB8098 / YB8000

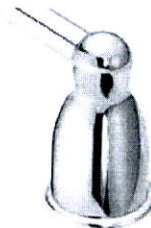

24" Towel Bar
Model YB8094 / YB8000
Chrome

FINISH OPTIONS:



CH BC

To order, combine the model number with one of these finish letter(s):
Chrome (CH) & Brushed Chrome (BC).

PRO+FIT™
INSTALLATION SYSTEM

SCHEDULE 'A'

330

RICHMOND

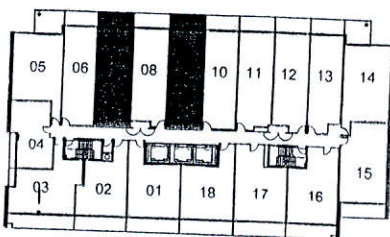
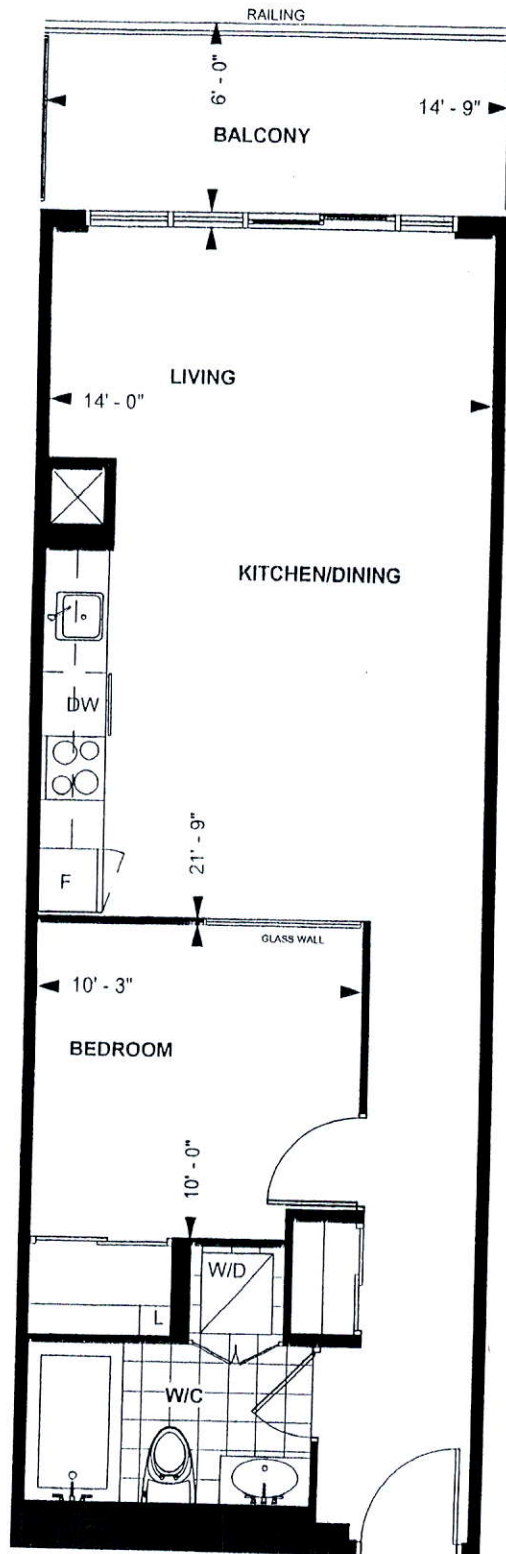

LEVEL 5 - 9

TOWER SUITE

B 635

9' CEILING *

635 sq. ft.

1-BEDROOM

Purchaser Initials Purchaser Initials

Date

Unit No. 7 Level No. 8 Suite No. 908

Dimensions, specification, tile floor pattern and architectural detailing (including window size and location) are approximate and subject to modifications without notice. Orientation of suite may vary from the stated floor area.

*Ceiling height measured from top of floor slab to underside of slab above before finishes, and excluding bulkheads and required drop ceilings. E.&O.E.

FILE NAME:
GLOSS CONDO 908

SEP 27 18 FB
REV OCT 5 18 PB

330 RICHMOND UNIT 908
PROTOTYPE FOR EXTRA

THIS LAYOUT CONTAINS EXTRAS
THAT ARE NOT PART OF CONTRACT

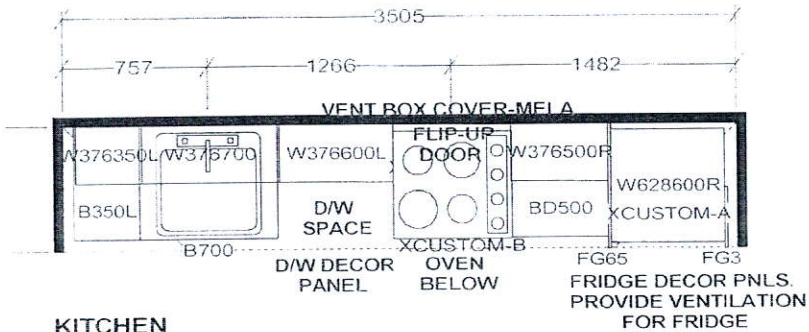

KITCHEN BASES & VANITIES INSTALLED
WITH ADJUSTABLE LEGS

KITCHEN

• 41" Upper
Cabinetry
• Add Island.

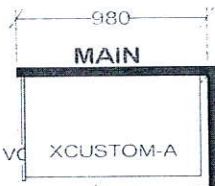
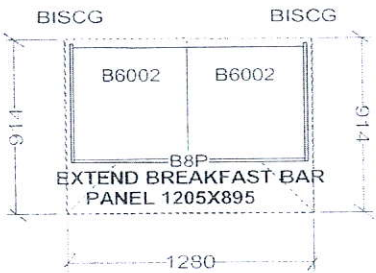

CUSTOM 2 DRAWER VANITY
(Drawers modified to clear plumbing)
FLOATING TOEKICK

APPLIANCE PACKAGE:
24" INTEGRATED FRIDGE W/ DECOR PNLS
24" INTEGRATED DISHWASHER W/ DECOR PNL
24" BUILT-IN OVEN
24" COOKTOP
24" MICROWAVE HOOD FAN

S e l b a I n d u s t r i e s

W	WDTH	W	HGHT	W	CNT	FL	HGHT	DWY	H	ST	CENT	2X4	VENT BOX COVER
TOWER SUITES:													
760MM HIGH UPPER CABINETS													
WHITE STEEL DRAWER BOXES													
COUNTERTOPS BY OTHERS													
VENT BOX COVERS													
CUSTOM VANITIES													

This drawing is the intellectual property of SELBA INDUSTRIES INC. and is an original design which must not be released or copied unless applicable fee has been paid or job order placed.



JOB NUMBER:
BUILDER: GREENPARK
SITE NAME: PETALUMA
MODEL: 1 BEDROOM-B 592, B 609, B 635
LOT #: 908
DESIGNER: KS
DATE: JAN 8 18