

330 Richmond - Petaluma Building Corp.

TEL: RES.: 416-318-3120

Unit 6, Level 7 (807-1)	Floor Plan B592		
-------------------------	--------------------	--	--

04Oct18 Note:

04Oct18 Note:

04Oct18 Note:

RECEIVED OCT 09 2018

Purchaser:

Siu Mei LEE

Telephone Res. / Bus:

(416) 318-3120 /

Decor Advisor:

Candace Forza

Lock Date:

10/4/2018 15:08:53

Const. No.:

Unit 6, Level 7

Municipal:

807

Suite Type:

B592

Project/Phase:

Petaluma Building Corp./1

Layout Changes:

☐ Yes ☒ No

Sketch Attached:

☒ Yes ☐ No

Exterior Colour Scheme:

1. Kitchen and Vanities	Style and Colour	Counter	Hardware
Kitchen / Breakfast	SEE BELOW	QUARTZ-CONTRACT WHITE-STRAIGHT POLISHED EDGE	STD
Main Bath	DORAL 1267-SAND MOLINA ASH	QUARTZ-CONTRACT WHITE-STRAIGHT POLISHED EDGE	STD
Master Ensuite Bathroom	N/A	N/A	N/A

Appliances:

Built In Appliances

☒ Yes ☐ No

41" Upper Cabinets

☒ Yes ☐ No

Slide In Stove

☐ Yes ☒ No

Comment

KITCHEN CABINETRY - BASE DORAL 1267-SAND MOLINA ASH *** UPPERS - SENOSAN BEIGE

2. Flooring		Grout-If App.	At a 45
Entrance Vestibule	STRIP-MIRAGE-LOCK-RED OAK-CASHMERE-RIO-4 5/16"		<input type="checkbox"/>
Main Hall	STRIP-MIRAGE-LOCK-RED OAK-CASHMERE-RIO-4 5/16"		<input type="checkbox"/>
Kitchen / Breakfast	STRIP-MIRAGE-LOCK-RED OAK-CASHMERE-RIO-4 5/16"		<input type="checkbox"/>
Laundry Room	TILE-ASPEN BIANCO-12X24	STANDARD	<input type="checkbox"/>
Main Bath	TILE-ASPEN BIANCO-12X24	STANDARD	<input type="checkbox"/>
Master Ensuite Bathroom	N/A		<input type="checkbox"/>
	N/A		<input type="checkbox"/>
Living Room	STRIP-MIRAGE-LOCK-RED OAK-CASHMERE-RIO-4 5/16"		<input type="checkbox"/>
Dining Room	STRIP-MIRAGE-LOCK-RED OAK-CASHMERE-RIO-4 5/16"		<input type="checkbox"/>
Den / Library / Study	N/A		<input type="checkbox"/>
Master Bedroom	STRIP-MIRAGE-LOCK-RED OAK-CASHMERE-RIO-4 5/16"		<input type="checkbox"/>
Bedroom #2	N/A		<input type="checkbox"/>
Bedroom #3	N/A		<input type="checkbox"/>
			<input type="checkbox"/>

Comment

3. Wall Tile	Selection	Grout	Describe
Main Bath			
Tub Deck Wall	N/A		
Shower Stall	N/A		
Bathtub Enclosure Walls	TILE-GLOSSY WHITE-3X6	STANDARD	
Master Ensuite Bathroom			
Tub Deck Wall	N/A		
Shower Stall	N/A		
Bathtub Enclosure Walls	N/A		
Kitchen Backsplash	BACK PAINTED GLASS-BM-#OC-14	STANDARD	
Backsplash Behind Fridge	N/A		

Comment

** Refer to Construction Summary

4. Misc

Water Line for Fridge

N/A

Interior Door Handles

AS PER CONSTRUCTION SPECS

Ceramic Bathroom Accessories

NO - UPGRADED MOEN MASON

Yes

☒ No

Comment

Purchaser: Siu Mei LEE
Telephone Res. / Bus: (416) 318-3120 /
Decor Advisor: Candace Forza
Lock Date: 10/4/2018 15:08:53

Const. No.: Unit 6, Level 7
Municipal: 807
Suite Type: B592
Project/Phase: Petaluma Building Corp./1

5. Plaster Mouldings and Medallions

Entrance Vestibule	N/A		Living Room	N/A	
Main Hall	N/A		Dining Room	N/A	
Kitchen/Breakfast	N/A		Den / Library /Study	N/A	
Laundry Room	N/A		Master BedRoom	N/A	
Main Bath	N/A		BedRoom #2	N/A	
Master Ensuite Bathroom	N/A		BedRoom #3	N/A	

Comment

** Refer to Construction Summary

6. Wall Paint

Entrance Vestibule	43-BIRCH WHITE	Living Room	43-BIRCH WHITE
Main Hall	43-BIRCH WHITE	Dining Room	43-BIRCH WHITE
Kitchen / Breakfast	43-BIRCH WHITE	Den/Library	N/A
Laundry Room	43-BIRCH WHITE	Master Bedroom	43-BIRCH WHITE
Main Bath	43-BIRCH WHITE	Bedroom #2	N/A
Master Ensuite	N/A	Bedroom #3	N/A
	N/A		

Comment

7. General Comments

** Refer to Construction Summary

Disclaimers and Notes

- 1) Colours of all materials are as close as possible to builder's selection, but not necessarily identical due to variances in manufacturing.
- 2) Any extras listed above are null and void unless accompanied by a separate invoice/amendment. Said invoice must be paid in full.
- 3) The Purchaser agrees that this colour selection is final and that no changes will be permitted, unless required by the Vendor.
- 4) The Purchaser acknowledges reading and accepting document which contains other miscellaneous disclaimers.

Signature:  Date: Oct 4/18

Signature: _____ Date: _____

Initial: _____

Mason™

Traditional | Transitional | Modern

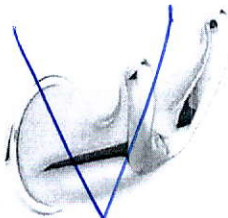

Double Robe Hook
Model YB8003

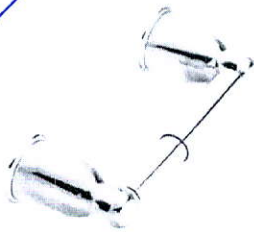

Paper Holder
Model YB8099 / YB8000
Chrome

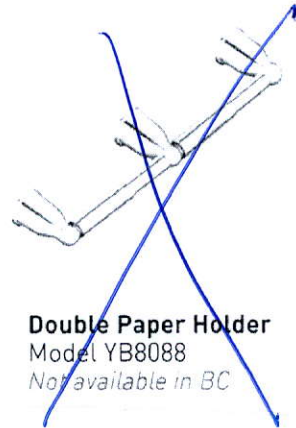

Double Paper Holder
Model YB8088
Not available in BC



Towel Ring
Model YB8086
Chrome

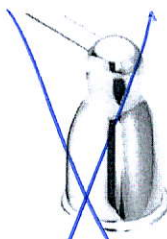

18" Towel Bar
Model YB8098 / YB8000



24" Towel Bar
Model YB8094 / YB8000
Chrome

PRO+FIT™
INSTALLATION SYSTEM

FINISH OPTIONS:



To order, combine the model number with one of these finish letter(s):
Chrome (CH) & Brushed Chrome (BC).

RAY

SCHEDULE 'A'

330

RICHMOND

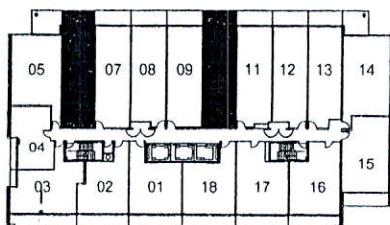
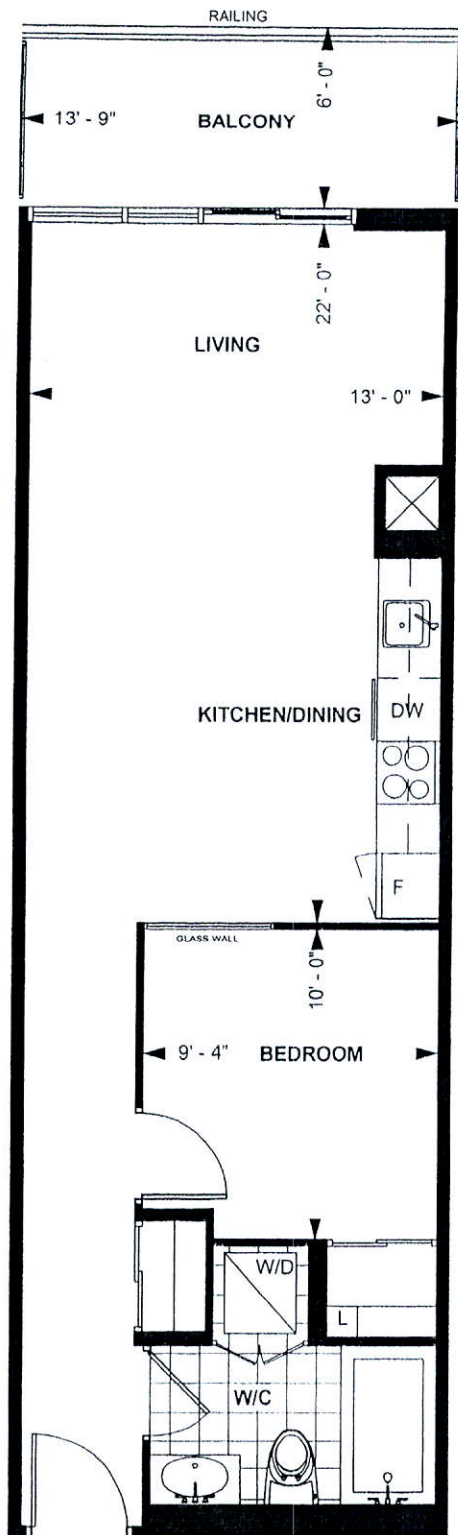

LEVEL 5 - 9

TOWER SUITE

B 592

9' CEILING *

592 sq. ft.

1-BEDROOM

Purchaser Initials Purchaser Initials

Date

Unit No. 6 Level No. 7 Suite No. 807

Dimensions, specification, tile floor pattern and architectural detailing (including window size and location) are approximate and subject to modifications without notice. Orientation of suite may vary from the stated floor area.

*Ceiling height measured from top of floor slab to underside of slab above before finishes, and excluding bulkheads and required drop ceilings. E.&O.E.

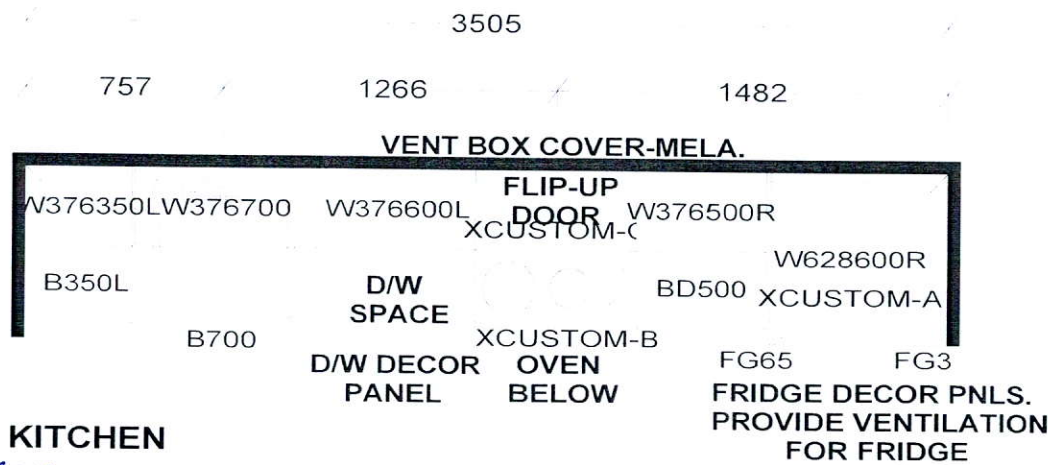

KITCHEN
41" uppers

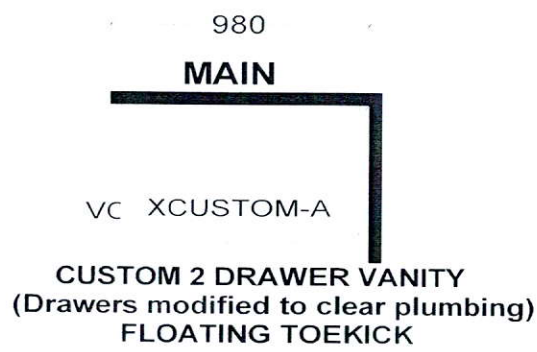

KITCHEN BASES & VANITIES INSTALLED
WITH ADJUSTABLE LEGS

- APPLIANCE PACKAGE:
- 24" INTEGRATED FRIDGE W/ DECOR PNLS
 - 24" INTEGRATED DISHWASHER W/ DECOR PNL
 - 24" BUILT-IN OVEN
 - 24" COOKTOP
 - 24" MICROWAVE HOOD FAN

S e l b a I n d u s t r i e s

WDTH _____ W HGHT _____ W CNT _____ FL HGHT _____ DWY H _____ ST CENT _____ 2X4 _____ VENT BOX COVER _____

- TOWER SUITES:
- 760MM HIGH UPPER CABINETS
 - WHITE STEEL DRAWER BOXES
 - COUNTERTOPS BY OTHERS
 - VENT BOX COVERS
 - CUSTOM VANITIES

This drawing is the intellectual property of SELBA INDUSTRIES INC. and is an original design which must not be released or copied unless applicable fee has been paid or job order placed.

HA
GB
FC
ED

JOB NUMBER:
BUILDER: GREENPARK
SITE NAME: PETALUMA
MODEL: 1 BEDROOM-B 592, B 609, B 635
LOT #:
DESIGNER: KS
DATE: JAN 8 18