		CONSTRUCTION SUMMARY	
PURCHASER: Chensu YU		330 Richmond - Petaluma Building Corp.	
TEL: RES.: 416-786-5245			
Unit 1, Level 6 (701-1)	Floor Plan B597		

CABINETRY

1 - KITCHEN - 41" UPPER CABINETRY	
14Sep18 Note:	

CABINETRY ACCESSORIES

1 - KITCHEN - SLOW CLOSING CABINETRY & BLU MOTION DRAWERS	
14Sep18 Note: PURCHASER IS AWARE FLIP UP CABINETRY MAY NOT BE INCLUDED	

CERAMIC TILE

1 - DELETE STANDARD WHITE CERAMIC ACCESSORIES - DO NOT INSTALL SOAP DISH, TOWEL RACK OR TISSUE HOLDER	
14Sep18 Note:	

CONSTRUCTION

1 - BEDROOM - SMOOTH CEILING	
14Sep18 Note:	

MISCELLANEOUS

1 - MIX N' MATCH FEE	
14Sep18 Note:	

PLUMBING

1 - BATHROOM - 90 BATH ACCESSORIES - CHROME - TOILET PAPER HOLDER #YB8808 & TOWEL BAR 24" #YB8824	
14Sep18 Note:	

This Document is Extremely Time Sensitive - Printed 14 Sep 18 at 11:38

RECEIVED SEP 18 2018

Purchaser:Chensu YU

Telephone Res. / Bus: (416) 786-5245 /

Decor Advisor: Candace Forza

Lock Date: 9/14/2018 11:38:07

Const. No.: Unit 1, Level 6

Municipal: 701

Suite Type: B597

Project/Phase: Petaluma Building Corp./1

Layout Changes: ☐ Yes ☒ No

Sketch Attached: ☐ Yes ☒ No

Exterior Colour Scheme:

1. Kitchen and Vanities

	Style and Colour	Counter	Hardware
Kitchen / Breakfast	SEE BELOW	QUARTZ-TORRONE-STRAIGHT POLISHED EDGE	STD
Main Bath	DORAL 1267-SAND MOLINA ASH	QUARTZ-TORRONE-STRAIGHT POLISHED EDGE	STD
Master Ensuite Bathroom	N/A	N/A	N/A

Appliances:

Built In Appliances ☒ Yes ☐ No

41" Upper Cabinets ☒ Yes ☐ No

Slide In Stove ☐ Yes ☒ No

Comment

KITCHEN - CABINETRY - BASE DORAL 1267-SAND MOLINA ASH *** UPPERS SENOSAN WHITE

2. Flooring

		Grout-If App.	At a 45
Entrance Vestibule	STRIP-MIRAGE-LOCK-RED OAK-CASHMERE-RIO-4 5/16"		<input type="checkbox"/>
Main Hall	STRIP-MIRAGE-LOCK-RED OAK-CASHMERE-RIO-4 5/16"		<input type="checkbox"/>
Kitchen / Breakfast	STRIP-MIRAGE-LOCK-RED OAK-CASHMERE-RIO-4 5/16"		<input type="checkbox"/>
Laundry Room	TILE-WHITE-8X8	STANDARD	<input type="checkbox"/>
Main Bath	TILE-ASPEN BIANCO-12X24	STANDARD	<input type="checkbox"/>
Master Ensuite Bathroom	N/A		<input type="checkbox"/>
	N/A		<input type="checkbox"/>
Living Room	STRIP-MIRAGE-LOCK-RED OAK-CASHMERE-RIO-4 5/16"		<input type="checkbox"/>
Dining Room	STRIP-MIRAGE-LOCK-RED OAK-CASHMERE-RIO-4 5/16"		<input type="checkbox"/>
Den / Library / Study	N/A		<input type="checkbox"/>
Master Bedroom	STRIP-MIRAGE-LOCK-RED OAK-CASHMERE-RIO-4 5/16"		<input type="checkbox"/>
Bedroom #2	N/A		<input type="checkbox"/>
Bedroom #3	N/A		<input type="checkbox"/>
			<input type="checkbox"/>

Comment

3. Wall Tile

	Selection	Grout	Describe
Main Bath			
Tub Deck Wall	N/A		
Shower Stall	N/A		
Bathtub Enclosure Walls	TILE-GLOSSY WHITE-3X6	STANDARD	
Master Ensuite Bathroom			
Tub Deck Wall	N/A		
Shower Stall	N/A		
Bathtub Enclosure Walls	N/A		
Kitchen Backsplash	BACK PAINTED GLASS-BM- #OC-14	STANDARD	
Backsplash Behind Fridge	N/A		

Comment

** Refer to Construction Summary

4. Misc

Water Line for FridgeN/A

Interior Door HandlesAS PER CONSTRUCTION SPECS

Ceramic Bathroom AccessoriesN/A - upgraded 90° ☐ Yes ☒ No

Comment

cd.

Initial:_____

5. Plaster Mouldings and Medallions

Entrance Vestibule	N/A		Living Room	N/A	
Main Hall	N/A		Dining Room	N/A	
Kitchen/Breakfast	N/A		Den / Library /Study	N/A	
Laundry Room	N/A		Master BedRoom	N/A	
Main Bath	N/A		BedRoom #2	N/A	
Master Ensuite Bathroom	N/A		BedRoom #3	N/A	

Comment

** Refer to Construction Summary

6. Wall Paint

Entrance Vestibule	43 BIRCH WHITE	Living Room	43 BIRCH WHITE
Main Hall	43 BIRCH WHITE	Dining Room	43 BIRCH WHITE
Kitchen / Breakfast	43 BIRCH WHITE	Den/Library	N/A
Laundry Room	43 BIRCH WHITE	Master Bedroom	43 BIRCH WHITE
Main Bath	43 BIRCH WHITE	Bedroom #2	N/A
Master Ensuite	N/A	Bedroom #3	N/A
	N/A		

Comment

7. General Comments

** Refer to Construction Summary

Disclaimers and Notes

- 1) Colours of all materials are as close as possible to builder's selection, but not necessarily identical due to variances in manufacturing.

2) Any extras listed above are null and void unless accompanied by a separate invoice/amendment. Said invoice must be paid in full.

3) The Purchaser agrees that this colour selection is final and that no changes will be permitted, unless required by the Vendor.

4) The Purchaser acknowledges reading and accepting document which contains other miscellaneous disclaimers.

★



Signature:_____

Date: Sep 14, 2018

Signature:_____

Date: _____

Initial: _____

Page 2 of 2

Printed 9/14/2018 11:38:09

90°™

Traditional | Transitional | Modern

Geometric forms, squared corners and straight lines create an urban focal point for today's contemporary baths.

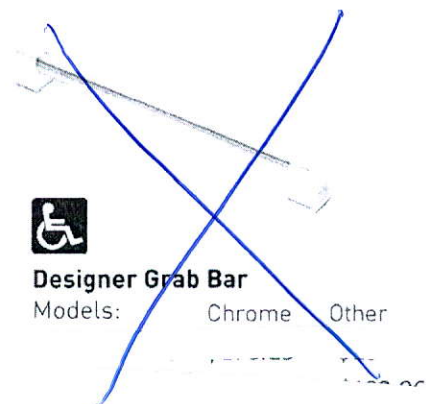
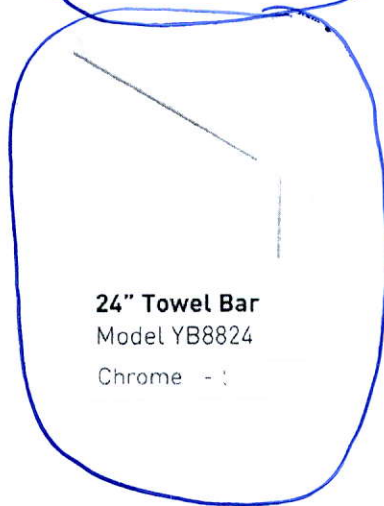
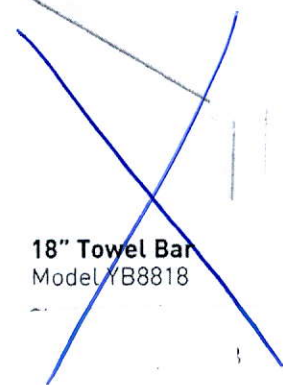
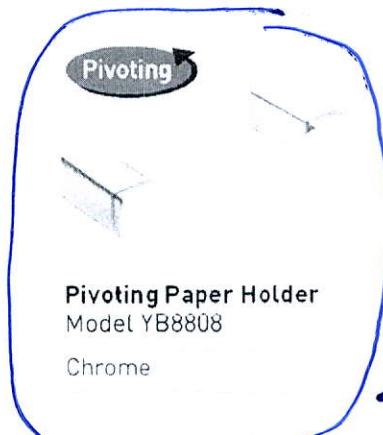
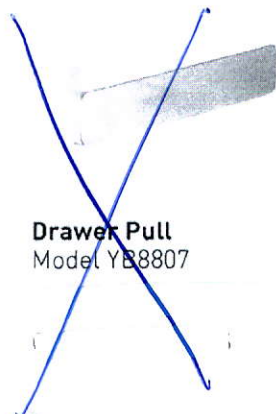
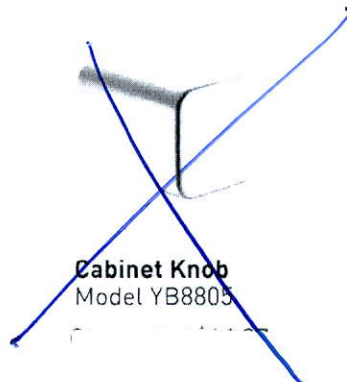
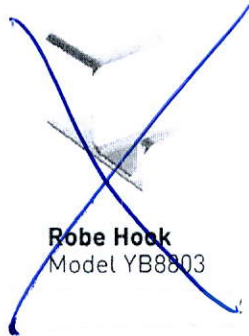

FINISH OPTIONS:

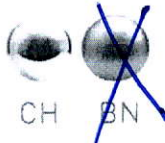

To order, combine the model number with one of these finish letter(s):
Chrome (CH), LifeShine® Brushed Nickel (BN).

SCHEDULE 'A'

330

RICHMOND

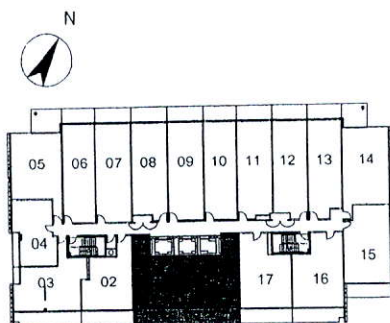
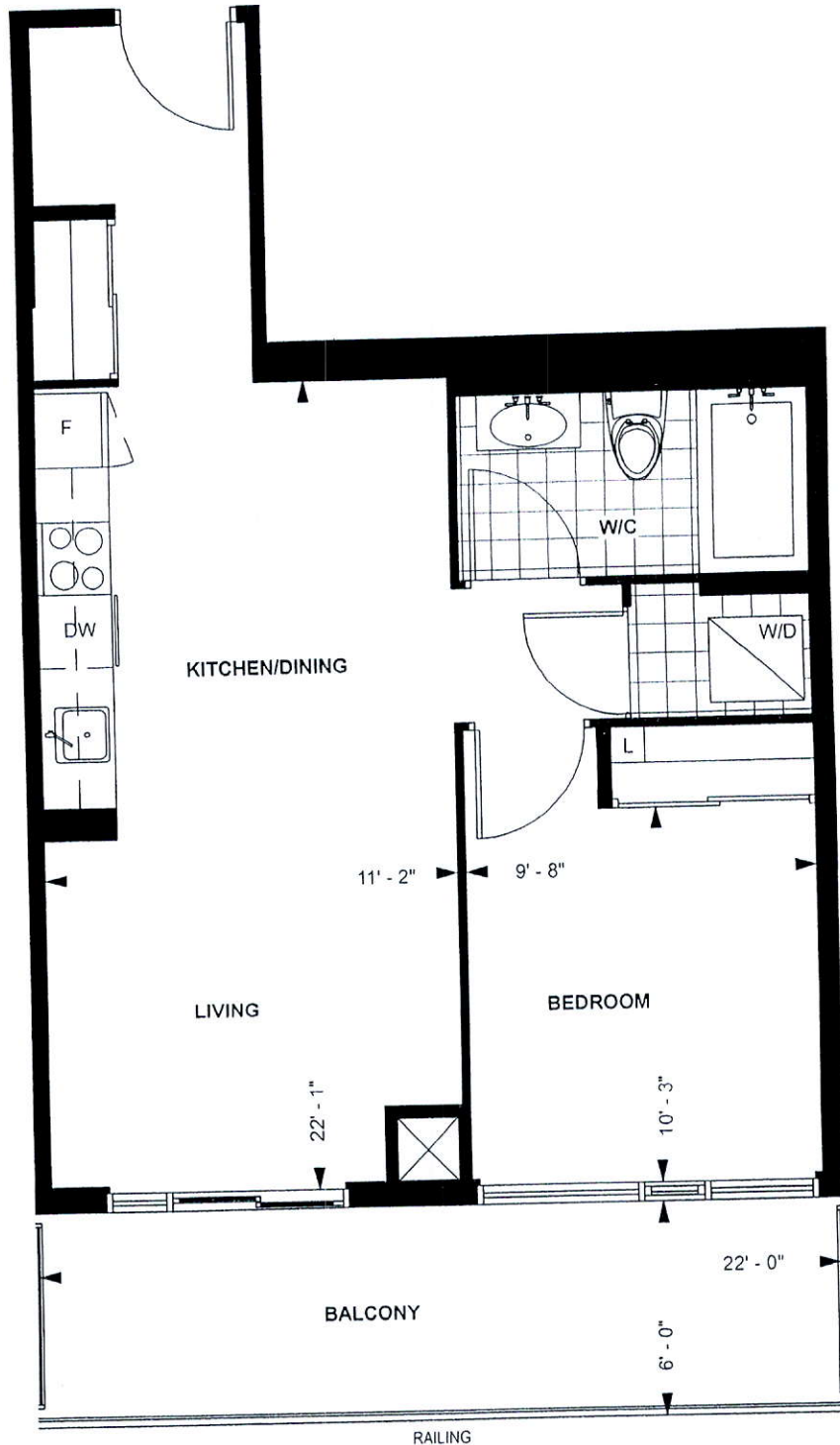

LEVEL 6 & 7

TOWER SUITE

B 597

9' CEILING *

597 sq. ft.

1-BEDROOM

Purchaser Initials Purchaser Initials

Date

Unit No. 1 Level No. 6 Suite No. 701

Dimensions, specification, tile floor pattern and architectural detailing (including window size and location) are approximate and subject to modifications without notice. Orientation of suite may vary from the stated floor area.

*Ceiling height measured from top of floor slab to underside of slab above before finishes, and excluding bulkheads and required drop ceilings. E.&O.E.

Kitchen

- 41" uppers
- Slow closing Cabinetry
- Blue motion Drawers

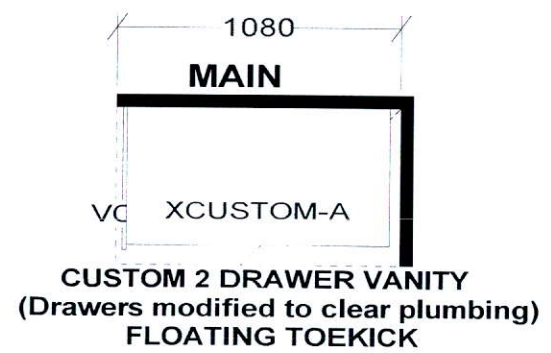
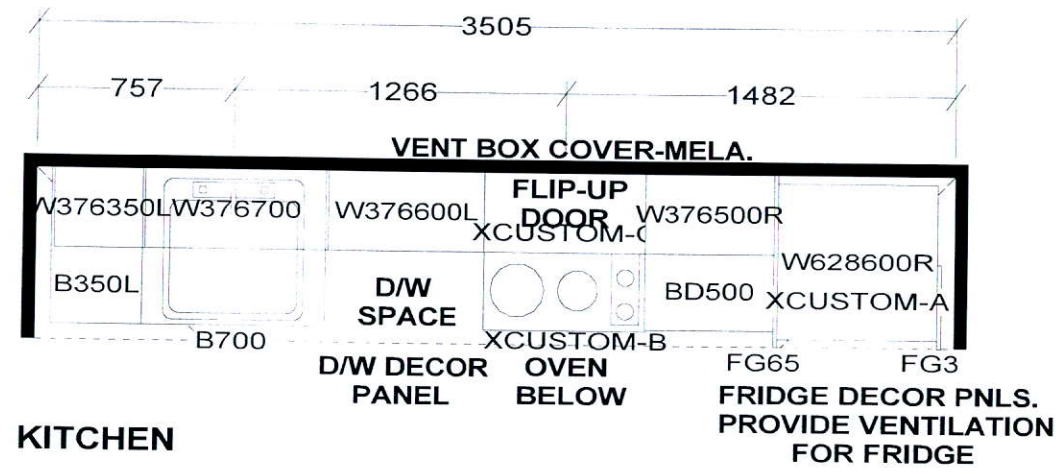

KITCHEN BASES & VANITIES INSTALLED WITH ADJUSTABLE LEGS

APPLIANCE PACKAGE:
24" INTEGRATED FRIDGE W/ DECOR PNLS
24" INTEGRATED DISHWASHER W/ DECOR PNL
24" BUILT-IN OVEN
24" COOKTOP
24" MICROWAVE HOOD FAN

Selba Industries

WDTH	W	HGHT	W	CNT	FL	HGHT	DWY	H	ST	CENT	2X4	VENT BOX COVER
TOWER SUITES: 760MM HIGH UPPER CABINETS WHITE STEEL DRAWER BOXES COUNTERTOPS BY OTHERS VENT BOX COVERS CUSTOM VANITIES					This drawing is the intellectual property of SELBA INDUSTRIES INC. and is an original design which must not be released or copied unless applicable fee has been paid or job order placed.					JOB NUMBER: BUILDER: GREENPARK SITE NAME: PETALUMA MODEL: 1 BEDROOM - B 583, B 597 LOT #: DESIGNER: KS DATE: JAN 8 18		

