

<div></div> <div><b>CONSTRUCTION SUMMARY</b> 330 Richmond - Petaluma Building Corp.</div>			
PURCHASER: Kokulathas CHANDRASEGERAM		TEL: BUS.: 514-947-6457	
Unit 5, Level 3 (306-1)	Floor Plan C702		

CABINETRY

1 - KITCHEN - 41" UPPER CABINETRY 01Oct18 Note:	
--	--

CERAMIC TILE

3 - MOEN MASON BATHROOM ACCESSORIES - CHROME TISSUE HOLDER-#YB8099/YB8000 TOWEL RING - #YB8086 24" TOWEL BAR - #YB8094 / YB8000 01Oct18 Note:	
---	--

CONSTRUCTION

1 - MAIN BATH - 5 FOOT SHOWER WITH SLIDING CHROME FRAMED GLASS DOORS IN LIEU OF TUB 15Jan18 Note:	
--	--

PLUMBING

1 - BATHROOM - DELETE STANDARD CERAMIC BATHROOM ACCESSORIES - DO NOT INSTALL SOAP DISH, TOWEL RACK OR TISSUE HOLDER 01Oct18 Note:	
---	--

This Document is Extremely Time Sensitive - Printed 1 Oct 18 at 10:25

RECEIVED OCT 01 2018

Purchaser:Kokulathas CHANDRASEGERAM

Telephone Res. / Bus: / (514) 947-6457

Decor Advisor:Candace Forza

Lock Date:10/1/2018 10:25:00

Const. No.: Unit 5, Level 3

Municipal: 306

Suite Type: C702

Project/Phase: Petaluma Building Corp./1

Layout Changes: ☐ Yes ☒ No      Sketch Attached: ☒ Yes ☐ No      Exterior Colour Scheme:

1. Kitchen and Vanities

	Style and Colour	Counter	Hardware
Kitchen / Breakfast	SEE BELOW	QUARTZ-AMIATA-STRAIGHT POLISHED EDGE	STD
Main Bath	DORAL H3081-HACIENDA BLACK	QUARTZ-AMIATA-STRAIGHT POLISHED EDGE	STD
Master Ensuite Bathroom	N/A	N/A	N/A

Appliances:      Built In Appliances ☒ Yes ☐ No      41" Upper Cabinets ☒ Yes ☐ No      Slide In Stove ☐ Yes ☒ No

Comment  
KITCHEN - CABINETRY - BASE DORAL H3081-HACIENDA BLACK \*\*\* UPPERS SENOSAN LIGHT GREY

2. Flooring

		Grout-If App.	At a 45
Entrance Vestibule	STRIP-MIRAGE-LOCK-RED OAK-CASHMERE-GRAPHITE-4 5/16"		<input type="checkbox"/>
Main Hall	STRIP-MIRAGE-LOCK-RED OAK-CASHMERE-GRAPHITE-4 5/16"		<input type="checkbox"/>
Kitchen / Breakfast	STRIP-MIRAGE-LOCK-RED OAK-CASHMERE-GRAPHITE-4 5/16"		<input type="checkbox"/>
Laundry Room	TILE-WHITE-8X8	STANDARD	<input type="checkbox"/>
Main Bath	TILE-LIFE ICE-12X24	STANDARD	<input type="checkbox"/>
Master Ensuite Bathroom	N/A		<input type="checkbox"/>
	N/A		<input type="checkbox"/>
Living Room	STRIP-MIRAGE-LOCK-RED OAK-CASHMERE-GRAPHITE-4 5/16"		<input type="checkbox"/>
Dining Room	STRIP-MIRAGE-LOCK-RED OAK-CASHMERE-GRAPHITE-4 5/16"		<input type="checkbox"/>
Den / Library / Study	STRIP-MIRAGE-LOCK-RED OAK-CASHMERE-GRAPHITE-4 5/16"		<input type="checkbox"/>
Master Bedroom	STRIP-MIRAGE-LOCK-RED OAK-CASHMERE-GRAPHITE-4 5/16"		<input type="checkbox"/>
Bedroom #2	N/A		<input type="checkbox"/>
Bedroom #3	N/A		<input type="checkbox"/>
			<input type="checkbox"/>
			<input type="checkbox"/>

Comment

3. Wall Tile

	Selection	Grout	Describe
Main Bath			
Tub Deck Wall	N/A		
Shower Stall	TILE-GLOSSY WHITE-3X6	STANDARD	
Bathtub Enclosure Walls	N/A		
Master Ensuite Bathroom			
Tub Deck Wall	N/A		
Shower Stall	N/A		
Bathtub Enclosure Walls	N/A		
Kitchen Backsplash	BACK PAINTED GLASS-BM-#HC-170	STANDARD	
Backsplash Behind Fridge	N/A		

Comment  
\*\* Refer to Construction Summary

4. Misc

Water Line for Fridge

Interior Door Handles

Ceramic Bathroom Accessories

Comment

N/A

AS PER CONSTRUCTION SPECS

NO -UPGRADED - MOEN MASON

☐ Yes ☒ No



Purchaser: Kokulathas CHANDRASEGERAM  
Telephone Res. / Bus: / (514) 947-6457  
Decor Advisor: Candace Forza  
Lock Date: 10/1/2018 10:25:00

Const. No.: Unit 5, Level 3  
Municipal: 306  
Suite Type: C702  
Project/Phase: Petaluma Building Corp./1

5. Plaster Mouldings and Medallions

Entrance Vestibule	N/A		Living Room	N/A	
Main Hall	N/A		Dining Room	N/A	
Kitchen/Breakfast	N/A		Den / Library /Study	N/A	
Laundry Room	N/A		Master BedRoom	N/A	
Main Bath	N/A		BedRoom #2	N/A	
Master Ensuite Bathroom	N/A		BedRoom #3	N/A	

Comment

\*\* Refer to Construction Summary

6. Wall Paint

Entrance Vestibule	43-BIRCH WHITE	Living Room	43-BIRCH WHITE
Main Hall	43-BIRCH WHITE	Dining Room	43-BIRCH WHITE
Kitchen / Breakfast	43-BIRCH WHITE	Den/Library	43-BIRCH WHITE
Laundry Room	43-BIRCH WHITE	Master Bedroom	43-BIRCH WHITE
Main Bath	43-BIRCH WHITE	Bedroom #2	N/A
Master Ensuite	N/A	Bedroom #3	N/A
	N/A		

Comment

7. General Comments

\*\* Refer to Construction Summary

Disclaimers and Notes

- 1) Colours of all materials are as close as possible to builder's selection, but not necessarily identical due to variances in manufacturing.
- 2) Any extras listed above are null and void unless accompanied by a separate invoice/amendment. Said invoice must be paid in full.
- 3) The Purchaser agrees that this colour selection is final and that no changes will be permitted, unless required by the Vendor.
- 4) The Purchaser acknowledges reading and accepting document which contains other miscellaneous disclaimers.

Signature:  Date: 01-10-2018

Signature: \_\_\_\_\_ Date: \_\_\_\_\_

# Mason™

Traditional | Transitional | Modern

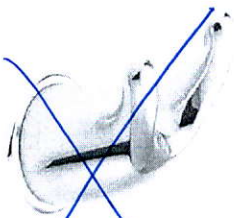

**Double Robe Hook**  
Model YB8003

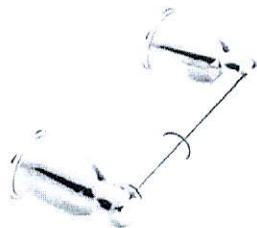

**Paper Holder**  
Model YB8099 / YB8000  
Chrome

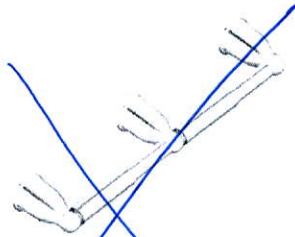

**Double Paper Holder**  
Model YB8088  
*Not available in BC*



**Towel Ring**  
Model YB8086  
Chrome

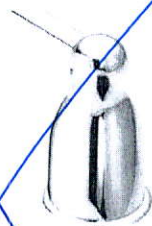

**18" Towel Bar**  
Model YB8098 / YB8000



**24" Towel Bar**  
Model YB8094 / YB8000  
Chrome

## FINISH OPTIONS:

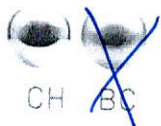

To order, combine the model number with one of these finish letter(s):  
Chrome (CH) & Brushed Chrome (BC).

**PRO-FIT™**  
INSTALLATION SYSTEM

# SCHEDULE 'A'

## 330

RICHMOND

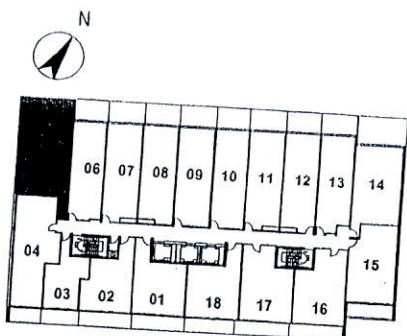
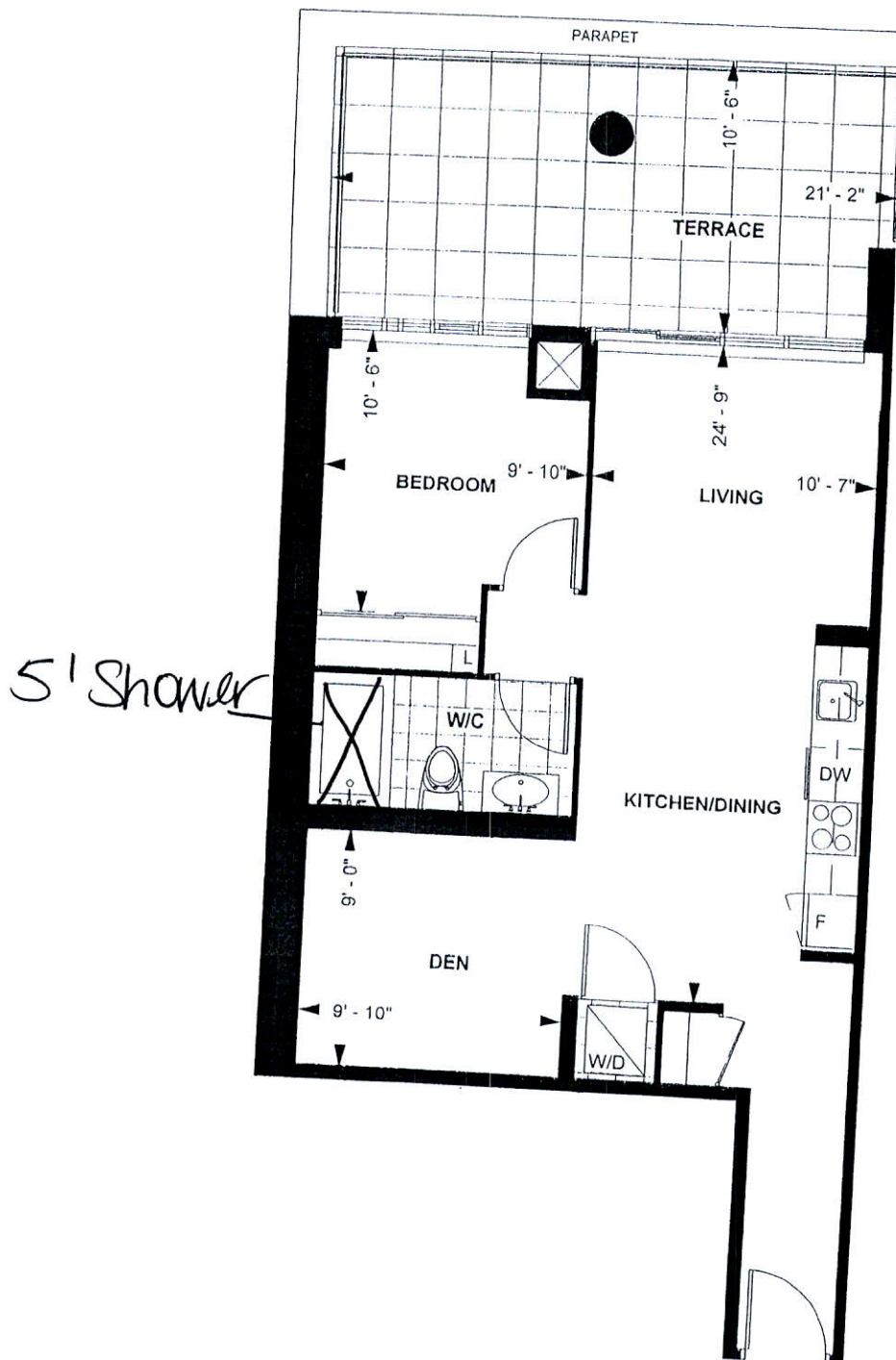

LEVEL 3

TOWER SUITE

C 702

9' CEILING \*

702 sq. ft.

1-BEDROOM PLUS DEN

Purchaser Initials C-R Purchaser Initials 27-02-2016

Date

Unit No. 5 Level No. 3 Suite No. 306

Dimensions, specification, tile floor pattern and architectural detailing (including window size and location) are approximate and subject to modifications without notice. Orientation of suite may vary from the stated floor area.

\*Ceiling height measured from top of floor slab to underside of slab above before finishes, and excluding bulkheads and required drop ceilings. E.&O.E.



Kitchen  
 ~41" uppers

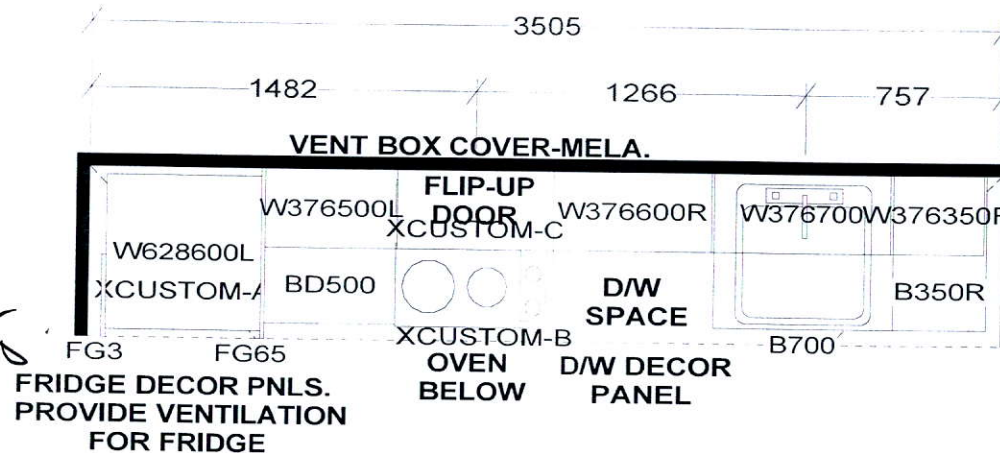

# KITCHEN

KITCHEN BASES & VANITIES INSTALLED  
 WITH ADJUSTABLE LEGS

APPLIANCE PACKAGE:  
 24" INTEGRATED FRIDGE W/ DECOR PNLS  
 24" INTEGRATED DISHWASHER W/ DECOR PNL  
 24" BUILT-IN OVEN  
 24" COOKTOP  
 24" MICROWAVE HOOD FAN

*S e l b a I n d u s t r i e s*

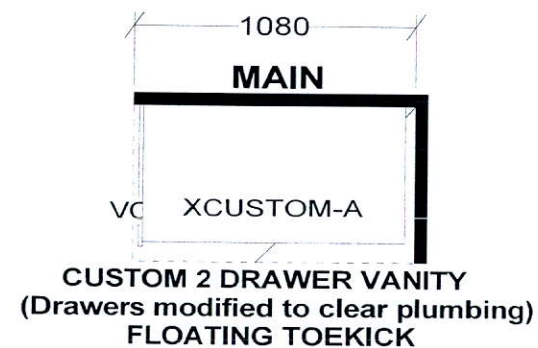

/ WIDTH \_\_\_\_\_ W HGT \_\_\_\_\_ W CNT \_\_\_\_\_ FL HGT \_\_\_\_\_ DWY H \_\_\_\_\_ ST CENT \_\_\_\_\_ 2X4 \_\_\_\_\_ VENT BOX COVER \_\_\_\_\_

TOWER SUITES:  
 760MM HIGH UPPER CABINETS  
 WHITE STEEL DRAWER BOXES  
 COUNTERTOPS BY OTHERS  
 VENT BOX COVERS  
 CUSTOM VANITIES

This drawing is the intellectual property of  
 SELBA INDUSTRIES INC. and is an  
 original design which must not be released  
 or copied unless applicable fee has been  
 paid or job order placed.



JOB NUMBER:  
 BUILDER: GREENPARK  
 SITE NAME: PETALUMA  
 MODEL: 1 BEDROOM + DEN - C 683, C 702  
 LOT #:  
 DESIGNER: KS  
 DATE: JAN 8 18

C-4