



CONSTRUCTION SUMMARY
330 Richmond - Petaluma Building Corp.

PURCHASER: Mauro MATTEI

TEL:

Unit 5, Level 10 (1106-1)

Floor Plan
C702

CABINETRY

1 - KITCHEN - 41" UPPER CABINETRY
30Oct18 Note:

CABINETRY ACCESSORIES

1 - KITCHEN - ADD APPROX 5' ISLAND - STANDARD CABINETRY AND COUNTERTOP WITH OVERHANG
30Oct18 Note:

CERAMIC TILE

1 - BATHROOM - DELETE STANDARD WHITE CERAMIC ACCESSORIES - DO NOT INSTALL SOAP DISH, TOWEL RACK OR TISSUE HOLDER
30Oct18 Note:

CONSTRUCTION

1 - BEDROOM - SMOOTH CEILING
30Oct18 Note:

1 - MAIN BATH - 5 FOOT SHOWER [REDACTED] IN LIEU OF TUB
10Jan18 Note:

HARDWOOD FLOORING

1 - THROUGHOUT - STANDARD NON-TILED AREAS - UPGRADE 2 HARDWOOD FLOORING IN LIEU OF STANDARD AS PER OFFER
30Oct18 Note:

MIRRORS AND GLASS

1 - BATHROOM - FRAMELESS GLASS SHOWER DOOR AND PANEL - CHROME KNOB AND HINGES
30Oct18 Note:

PLUMBING

1 - BATHROOM - MOEN 90 DEGREE BATHROOM ACCESSORIES - CHROME
TOILET PAPER HOLDER #YB8808
TOWEL RING #YB8886
TOWEL BAR #YB8824
30Oct18 Note:

This Document is Extremely Time Sensitive - Printed 30 Oct 18 at 10:55

RECEIVED NOV 20 2018

Purchaser: Mauro MATTEI
Telephone Res. / Bus: /
Decor Advisor: Candace Forza
Lock Date: 10/30/2018 10:58:10

Const. No.: Unit 5, Level 10
Municipal: 1106
Suite Type: C702
Project/Phase: Petaluma Building Corp./1

Layout Changes: ☐ Yes ☒ No Sketch Attached: ☒ Yes ☐ No Exterior Colour Scheme:

1. Kitchen and Vanities

| | Style and Colour | Counter | Hardware |
|-------------------------|----------------------------|--------------------------------------|----------|
| Kitchen / Breakfast | SEE BELOW | QUARTZ-AMIATA-STRAIGHT POLISHED EDGE | STD |
| Main Bath | DORAL H3081-HACIENDA BLACK | QUARTZ-AMIATA-STRAIGHT POLISHED EDGE | STD |
| Master Ensuite Bathroom | N/A | N/A | N/A |

Appliances: Built In Appliances ☒ Yes ☐ No 41" Upper Cabinets ☒ Yes ☐ No Slide In Stove ☐ Yes ☒ No

Comment
Kitchen-Cabinetry- Base - Doral H3081-Hacienda Black.
Upper - Senosan Light Grey.

2. Flooring

| | | Grout-If App. | At a 45 |
|-------------------------|--|---------------|---------|
| Entrance Vestibule | STRIP-MIRAGE-LOCK-SWEET MEMORIES-CHARACTER-HOPSCOTCH-4 5/16" | | |
| Main Hall | STRIP-MIRAGE-LOCK-SWEET MEMORIES-CHARACTER-HOPSCOTCH-4 5/16" | | |
| Kitchen / Breakfast | STRIP-MIRAGE-LOCK-SWEET MEMORIES-CHARACTER-HOPSCOTCH-4 5/16" | | |
| Laundry Room | TILE-WHITE-8X8 | | |
| Main Bath | TILE-LIFE ICE-12X24 | STANDARD | |
| Master Ensuite Bathroom | N/A | STANDARD | |
| | N/A | | |
| Living Room | STRIP-MIRAGE-LOCK-SWEET MEMORIES-CHARACTER-HOPSCOTCH-4 5/16" | | |
| Dining Room | STRIP-MIRAGE-LOCK-SWEET MEMORIES-CHARACTER-HOPSCOTCH-4 5/16" | | |
| Den / Library / Study | STRIP-MIRAGE-LOCK-SWEET MEMORIES-CHARACTER-HOPSCOTCH-4 5/16" | | |
| Master Bedroom | STRIP-MIRAGE-LOCK-SWEET MEMORIES-CHARACTER-HOPSCOTCH-4 5/16" | | |
| Bedroom #2 | N/A | | |
| Bedroom #3 | N/A | | |

Comment

3. Wall Tile

| | Selection | Grout | Describe |
|--------------------------|-------------------------------|----------|----------|
| Main Bath | | | |
| Tub Deck Wall | N/A | | |
| Shower Stall | N/A | | |
| Bathtub Enclosure Walls | TILE-GLOSSY WHITE-3X6 | STANDARD | |
| Master Ensuite Bathroom | | | |
| Tub Deck Wall | N/A | | |
| Shower Stall | N/A | | |
| Bathtub Enclosure Walls | N/A | | |
| Kitchen Backsplash | BACK PAINTED GLASS-BM-#HC-170 | STANDARD | |
| Backsplash Behind Fridge | N/A | | |

Comment
** Refer to Construction Summary

4. Misc

| | |
|------------------------------|---------------------------------|
| Water Line for Fridge | N/A |
| Interior Door Handles | AS PER CONSTRUCTION SPECS |
| Ceramic Bathroom Accessories | NO - UPGRADED - MOEN 90 DEGREES |

Comment

Purchaser: Mauro MATTEI
Telephone Res. / Bus: /
Decor Advisor: Candace Forza
Lock Date: 10/30/2018 10:58:10

Const. No.: Unit 5, Level 10
Municipal: 1106
Suite Type: C702
Project/Phase: Petaluma Building Corp./1

5. Plaster Mouldings and Medallions

| | | | | | |
|-------------------------|-----|--|----------------------|-----|--|
| Entrance Vestibule | N/A | | Living Room | N/A | |
| Main Hall | N/A | | Dining Room | N/A | |
| Kitchen/Breakfast | N/A | | Den / Library /Study | N/A | |
| Laundry Room | N/A | | Master BedRoom | N/A | |
| Main Bath | N/A | | BedRoom #2 | N/A | |
| Master Ensuite Bathroom | N/A | | BedRoom #3 | N/A | |
| | | | | | |

Comment

** Refer to Construction Summary

6. Wall Paint

| | | | |
|---------------------|----------------|----------------|----------------|
| Entrance Vestibule | 43-BIRCH WHITE | Living Room | 43-BIRCH WHITE |
| Main Hall | 43-BIRCH WHITE | Dining Room | 43-BIRCH WHITE |
| Kitchen / Breakfast | 43-BIRCH WHITE | Den/Library | 43-BIRCH WHITE |
| Laundry Room | 43-BIRCH WHITE | Master Bedroom | 43-BIRCH WHITE |
| Main Bath | 43-BIRCH WHITE | Bedroom #2 | N/A |
| Master Ensuite | N/A | Bedroom #3 | N/A |
| | N/A | | |

Comment

7. General Comments

** Refer to Construction Summary

Disclaimers and Notes

- 1) Colours of all materials are as close as possible to builder's selection, but not necessarily identical due to variances in manufacturing.
- 2) Any extras listed above are null and void unless accompanied by a separate invoice/amendment. Said invoice must be paid in full.
- 3) The Purchaser agrees that this colour selection is final and that no changes will be permitted, unless required by the Vendor.
- 4) The Purchaser acknowledges reading and accepting document which contains other miscellaneous disclaimers.

Signature:  _____ Date: _____ Signature: _____ Date: _____

90°™

Traditional | Transitional | Modern

Geometric forms, squared corners and straight lines create an urban focal point for today's contemporary baths.

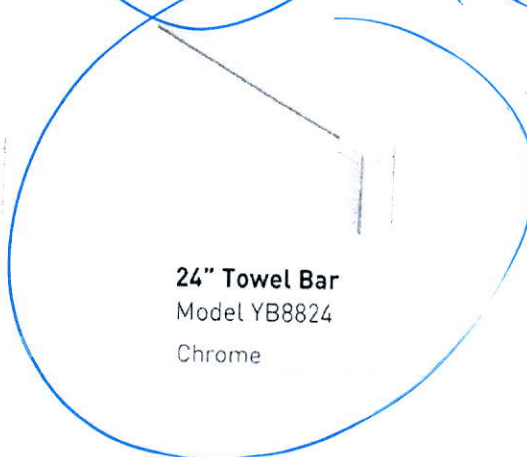
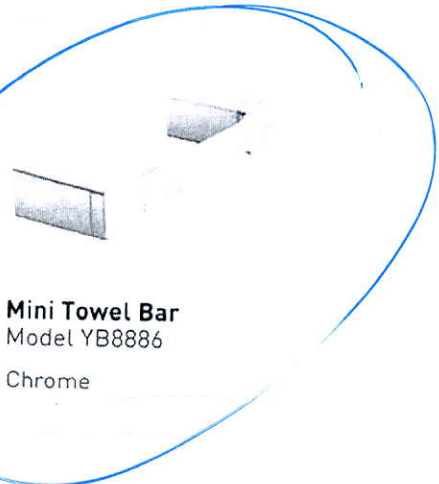
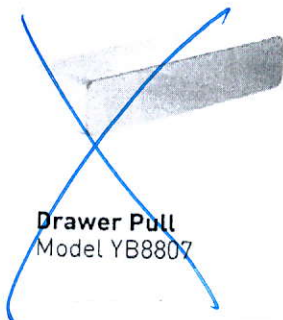
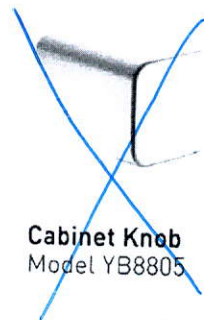
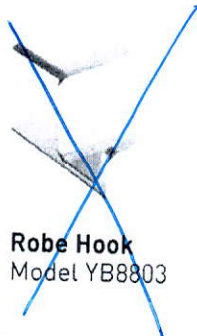

FINISH OPTIONS:

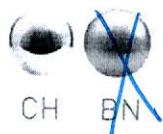

To order, combine the model number with one of these finish letter(s):
Chrome (CH), LifeShine® Brushed Nickel (BN).

SCHEDULE 'A'

330

RICHMOND

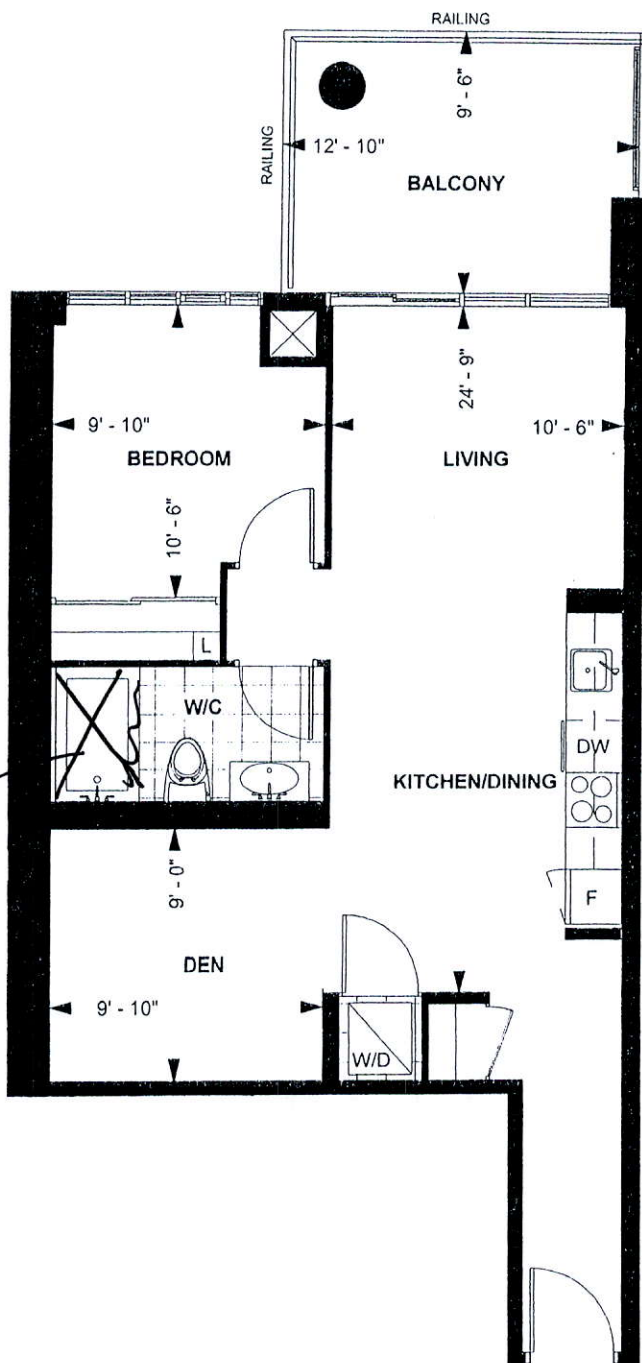

5' Shower
With Frameless
Glass Door
+ panel

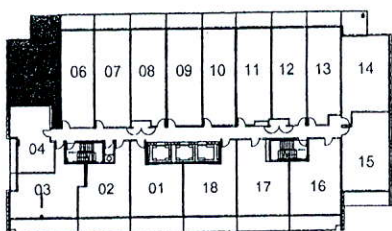

LEVEL 10

TOWER SUITE

C 702

9' CEILING *

702 sq. ft.

1-BEDROOM PLUS DEN

Purchaser Initials Purchaser Initials Date

Unit No. 5 Level No. 10 Suite No. 1106

Dimensions, specification, tile floor pattern and architectural detailing (including window size and location) are approximate and subject to modifications without notice. Orientation of suite may vary from the stated floor area.

*Ceiling height measured from top of floor slab to underside of slab above before finishes, and excluding bulkheads and required drop ceilings. E.&O.E.

[Handwritten signature]

THIS LAYOUT CONTAINS EXTRAS
THAT ARE NOT PART OF CONTRACT

PROTOTYPE
FOR EXTRAS

PAULINE
SEP 17 18

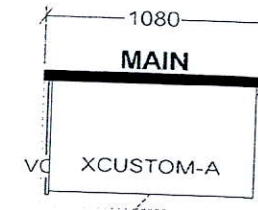
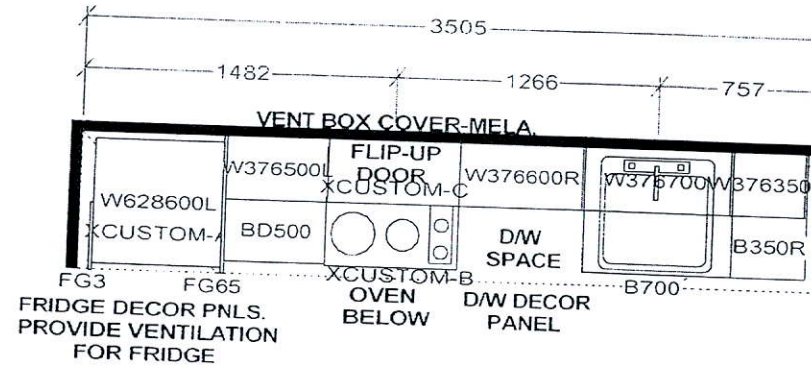

CUSTOM 2 DRAWER VANITY
(Drawers modified to clear plumbing)
FLOATING TOEKICK

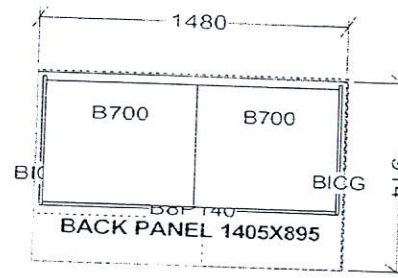

KITCHEN

41" uppers

KITCHEN BASES & VANITIES INSTALLED
WITH ADJUSTABLE LEGS

APPLIANCE PACKAGE:
24" INTEGRATED FRIDGE W/ DECOR PNLS
24" INTEGRATED DISHWASHER W/ DECOR PNL
24" BUILT-IN OVEN
24" COOKTOP
24" MICROWAVE HOOD FAN

Selba Industries

| W W DTH | W H GHT | W C N T | FL H GHT | D W Y H | ST C E N T | 2 X 4 | V E N T B O X C O V E R |
|---|---------|---------|----------|--|------------|---|-------------------------|
| TOWER SUITES: 760MM HIGH UPPER CABINETS WHITE STEEL DRAWER BOXES COUNTERTOPS BY OTHERS VENT BOX COVERS CUSTOM VANITIES | | | | This drawing is the intellectual property of SELBA INDUSTRIES INC. and is an original design which must not be released or copied unless applicable fee has been paid or job order placed. | | JOB NUMBER: BUILDER: GREENPARK SITE NAME: PETALUMA MODEL: 1 BEDROOM + DEN - C 683, C 702 LOT #: DESIGNER: KS DATE: JAN 8 18 | |