

CONSTRUCTION SUMMARY
Legacy Hill - Trinigroup Development Inc.

PURCHASER: CHENGYI DENG

TEL:

LOT / PHASE 36 / 1	REG. PLAN # 65M-4818	HOUSE TYPE Villa 6 Elev 3		
-----------------------	-------------------------	------------------------------	--	--

CABINETRY

1 - KITCHEN - SHIFT FRIDGE TO ACCOMODATE BUILT INS 07Apr25 Note:	
1 - KITCHEN - DELETE CABINETS ABOVE STOVE AND HOOD FAN - VENDOR WILL SUPPLY 6 INCH VENT AS PER CONSTRUCTION SPECIFICATIONS AND VENT MAY NOT BE IN THE APPROPRIATE LOCATION FOR INSTALLATION OF PURCHASER SUPPLIED FAN 04Apr25 Note: PURCHASER TO SUPPLY AND INSTALL OWN FAN AFTER CLOSING	
1 - CABINETRY PROVISION - PROVISION FOR PLUG ON ISLAND (PLUG EXTRA ORDERED SEPARATELY) 14Jun24 Note:	

CABINETRY ACCESSORIES

1 - CABINETRY FEE FOR FLUSH CUTOUT ON WALL OVEN/MICROWAVE COMBO CABINET ONLY 03Apr25 Note:	
1 - KITCHEN CABINETRY UPPER - FULL DEPTH ABOVE FRIDGE UPPER WITH GABLES - 650MM DEEP - PRICE IS EACH 26Mar25 Note:	
1 - KITCHEN CABINETRY - BUILT-IN MICROWAVE/OVEN COMBO WITH ONE POT DRAWER - STANDARD LEVEL 26Mar25 Note:	
1 - KITCHEN CABINETRY BASE - COOKTOP CABINET WITH POT DRAWERS (2 DRAWERS) - STANDARD LEVEL 26Mar25 Note:	

CERAMIC TILE

1 - TILE - UPGRADE 4 FLOOR TILE - MASTER ENSUITE FLOOR 26Mar25 Note:	
1 - ENSUITE 3/4 - IN FLOOR HEATING 14Jun24 Note:	
1 - ENSUITE 2 - IN FLOOR HEATING 14Jun24 Note:	
1 - MASTER ENSUITE - IN FLOOR HEATING 14Jun24 Note:	

CONSTRUCTION

1 - ENLARGED BASEMENT WINDOWS (MAY REQUIRE WINDOW WELLS) - WINDOW IS 30 INCHES X 24 INCHES 29May24 Note:	
1 - LOWER LEVEL - BASEMENT 8 FOOT 6 INCH CONCRETE POUR - MEASURED FROM TOP OF FOOTING TO TOP OF FOUNDATION WALL 29May24 Note:	
1 - FIRST FLOOR INCREASE CEILING HEIGHT FROM 9 FEET TO 10 FEET 29May24 Note:	

COUNTER TOP

1 - KITCHEN COUNTERTOP - UPGRADE STONE COUNTERTOP 26Mar25 Note:	
---	--

RECEIVED

CONSTRUCTION SUMMARY
Legacy Hill - Trinigroup Development Inc.

PURCHASER: CHENGYI DENG TEL:

LOT / PHASE 36 / 1	REG. PLAN # 65M-4818	HOUSE TYPE Villa 6 Elev 3		
-----------------------	-------------------------	------------------------------	--	--

ELECTRICAL

1 - BUILT IN OVEN AND COOKTOP PROVISION - PROVISION ONLY - ELECTRICAL ONLY 26Mar25 Note:	
1 - ELECTRICAL PROVISIONS FOR IN FLOOR HEATING IN - MASTER ENSUITE , ENSUITE 2 AND ENSUITE 3/4 17Jun24 Note:	
3 - POT LIGHT - LED - FIRST FLOOR INSTALLATION 1 POT ON SEPEARTE SWITCH - FAMILY ROOM- SEE SKETCH 1 POT ON 1 POT ON SEPEARTE SWITCH - LIVING/DINING ROOM - SEE SKETCH 1 POT ON SEPEARTE SWITCH - KITCHEN - SEE SKETCH 14Jun24 Note:	
1 - PLUG - ELECTRICAL PLUG WITH GFI AND SWITCH - FOR FESTIVE LIGHTING 14Jun24 Note:	
1 - FAMILY ROOM - ELECTRICAL PLUG - SEE SKETCH FOR LOCATION 14Jun24 Note:	
1 - PLUG - ELECTRICAL PLUG - TO BE INSTALLED OVER FIREPLACE- 4.5FT FROM FLOOR 14Jun24 Note:	
1 - PLUG - ELECTRICAL PLUG - ADD TO ISLAND 14Jun24 Note:	
2 - PLUG - ELECTRICAL PLUG WITH GFI - NEXT TO TOILET MASTER ENSUITE & POWDER ROOM 14Jun24 Note:	
1 - RELOCATE STANDARD KITCHEN LIGHT TO BE CENTERED OVER ISLAND 14Jun24 Note:	
1 - STANDARD DINING ROOM LIGHT TO BE CENTERED BETWEEN LIVING AND DINING ROOM 14Jun24 Note:	
1 - ELECTRIC VEHICLE ROUGH-IN PROVISION ONLY FOR FUTURE ELECTRIC CAR (CONDUIT FROM BASEMENT INTO JUNCTION BOX IN GARAGE WITH PULL STRING, NO WIRE) 14Jun24 Note:	

FIREPLACE AND ACCESSORIES

1 - GAS LINE ROUGH-IN FOR STOVE (INCLUDES ELECTRICAL OUTLET) - FIRST FLOOR 14Jun24 Note:	
1 - GAS LINE ROUGH-IN FOR BARBECUE - FIRST FLOOR 14Jun24 Note:	

PLUMBING

1 - SINK - UNDERMOUNT - BLANCO PRECIS SILGRANIT U 1 3/4 LOW DIVIDE #402875 SOFT WHITE - INCLUDES METAL STRAINER #203439 26Mar25 Note:	
1 - MASTER ENSUITE - DELTA - SHOWER KIT - ROUND SHOWER KIT #DF-TKIT1-PBR/R2200-WS CHROME 14Jun24 Note:	



CONSTRUCTION SUMMARY				
PURCHASER: CHENGYI DENG				TEL:
LOT / PHASE 36 / 1	REG. PLAN # 65M-4818	HOUSE TYPE Villa 6 Elev 3		
1 - WATER LINE FOR FRIDGE - ROUGH-IN ONLY 14Jun24 Note:				

PROMOTIONAL

1 - LESS BALANCE OF CREDIT FROM PURCHASER EXTRA SHEET IN OFFER 26Mar25 Note:	
1 - PARTIAL REDEMPTION OF PROMOTIONAL PACKAGE \$18,570.00 BALANCE FORWARD \$15,780.00 TO BE USED AT A LATER DATE. ORIGINAL PROMOTIONAL PACKAGE OF \$80,000.00 AS PER SCHEDULE PE. 14Jun24 Note:	
1 - PARTIAL REDEMPTION OF PROMOTIONAL PACKAGE \$45,650.00 BALANCE FORWARD \$34,350.00 TO BE USED AT A LATER DATE. ORIGINAL PROMOTIONAL PACKAGE OF \$80,000.00 AS PER SCHEDULE PE. 29May24 Note:	

EXTRAS AS PER OFFER

The Vendor agrees that notwithstanding any other term or provision in this Agreement included in the Purchase Price and in addition to those items detailed in Schedule GP to the Agreement of Purchase and Sale, the Purchaser is entitled to a credit of eig Worksheet Note:	
---	--

This Document is Extremely Time Sensitive - Printed 7 Apr 25 at 10:16

Purchaser:CHENGYI DENG

Property: 36

Telephone Res. / Bus: /

Project: Trinigroup Development Inc.

Decor Advisor: Ida Viola

Model and Elevation: Villa 6 Elev 3

Lock Date: 3-Apr-25

3-Apr-25

Plan #: 65M-4818

1. Cabinetry

	Style and Colour	Hardware
Kitchen / Breakfast	DORAL W500	465SA
Laundry Room	ELISSE	Standard
Powder Room	DORAL W500	464SA
Master Ensuite Bathroom	DORAL W500	464SA
Ensuite Bath - Bedroom 2	DORAL W500	464SA
Ensuite Bath - Bedroom 3/4	DORAL W500	464SA
Stove Opening	SEE SPECS	NOTE: If not specified, opening will be set to builder's standard opening of approximately 30" width
Fridge Opening	SEE SPECS	NOTE: If not specified, opening will be set to builder's standard opening of approximately 37" width x 74" height

** Refer to Construction Summary

2. Counters

	Counter	Edge	Niche
Kitchen / Breakfast	QZITE TAJ MAHAL	#370 EDGE	
Laundry Room	N/A		
Powder Room	LAMINATE-WHITE CARRARA 4924-38		
Master Ensuite Bathroom	LAMINATE-WHITE CARRARA 4924-38		
Ensuite Bath - Bedroom 2	LAMINATE-WHITE CARRARA 4924-38		
Ensuite Bath - Bedroom 3/4	LAMINATE-WHITE CARRARA 4924-38		
Kitchen Backsplash	N/A		

** Refer to Construction Summary

Purchaser:

CHENGYI DENG

Telephone Res. / Bus:

/

Decor Advisor:

Ida Viola

Lock Date:

3-Apr-25

Property:

36

Project:

Trinigroup Development Inc.

Model and Elevation:

Villa 6 Elev 3

Plan #:

65M-4818

3. Ceramic Flooring

		At a 45
Entrance Vestibule	TILE-LOFT CENDRA 12.5 X 12.5	<input type="checkbox"/>
Main Hall	HARDWOOD	<input type="checkbox"/>
Kitchen / Breakfast	TILE-LOFT CENDRA 12.5 X 12.5	<input type="checkbox"/>
Laundry Room	TILE-LOFT CENDRA 12.5 X 12.5	<input type="checkbox"/>
Powder Room	TILE-LOFT CENDRA 12.5 X 12.5	<input type="checkbox"/>
Master Ensuite Bathroom	TILE-MAINSTONE SILVER NAT 24X24	<input type="checkbox"/>
Ensuite Bath - Bedroom 2	TILE-LOFT CENDRA 12.5 X 12.5	<input type="checkbox"/>
Ensuite Bath - Bedroom 3/4	TILE-LOFT CENDRA 12.5 X 12.5	<input type="checkbox"/>
Mud Room	TILE-LOFT CENDRA 12.5 X 12.5	<input type="checkbox"/>
		<input type="checkbox"/>
		<input type="checkbox"/>

** Refer to Construction Summary ** METAL STRIP THRESHOLD WHERE APPLICABLE UNLESS SPECIFIED **

4. Ceramic Wall Tile

Master Ensuite Bathroom	Selection	Describe
Tub Deck Wall		
Shower Stall	TILE-EXTRA WHITE/BEIGE (719) 8X16	
Bathtub Enclosure Walls		
Ensuite Bath - Bedroom 2	TILE-EXTRA WHITE/BEIGE (719) 8X16	
Ensuite Bath - Bedroom 3/4	TILE-EXTRA WHITE/BEIGE (719) 8X16	
Mud Room	N/A	
Kitchen Backsplash	N/A	

** Refer to Construction Summary - STANDARD GROUT THROUGHOUT UNLESS SPECIFIED

5. Trim Carpentry

Interior Doors

CARRARA-SMOOTH

Interior Trim

As Per Construction Specifications

** Refer to Construction Summary

6. Plaster Mouldings and Medallions

Entrance Vestibule			Kitchen/Breakfast		
Main Hall			Den/Library		
Living Room			Lower Landing		
Dining Room					
Family Room					

** Refer to Construction Summary

Purchaser: CHENGYI DENG

Property: 36

Telephone Res. / Bus: /

Project: Trinigroup Development Inc.

Decor Advisor: Ida Viola

Model and Elevation: Villa 6 Elev 3

Lock Date: 3-Apr-25

3-Apr-25

Plan #: 65M-4818

7. Other Flooring

Main Hall	HARDWOOD - STANDARD 3 1/4" NATURAL RED OAK
Living Room	HARDWOOD - STANDARD 3 1/4" NATURAL RED OAK
Dining Room	HARDWOOD - STANDARD 3 1/4" NATURAL RED OAK
Family Room	HARDWOOD - STANDARD 3 1/4" NATURAL RED OAK
Den / Library / Study	HARDWOOD - STANDARD 3 1/4" NATURAL RED OAK
Basement Landing(If Applies)	N/A
Lower Landing (If Applies)	N/A
Upper Landing	HARDWOOD - STANDARD 3 1/4" NATURAL RED OAK
Upper Hall	LAMINATE-LEXINGTON CHARLEROI OAK TL LW1314 PEFC
Master Bedroom	LAMINATE-LEXINGTON CHARLEROI OAK TL LW1314 PEFC
Bedroom #2	LAMINATE-LEXINGTON CHARLEROI OAK TL LW1314 PEFC
Bedroom #3	LAMINATE-LEXINGTON CHARLEROI OAK TL LW1314 PEFC
Bedroom #4	LAMINATE-LEXINGTON CHARLEROI OAK TL LW1314 PEFC
Bedroom #5	N/A
Flex	LAMINATE-LEXINGTON CHARLEROI OAK TL LW1314 PEFC
Underpad	Standard <input type="checkbox"/> Upgrade <input type="text"/>

** Refer to Construction Summary

8. Railings and Pickets

Railing Type	AS PER CONSTRUCTION SPECIFICATIONS	Colour	AS PER CONSTRUCTION SPECIFICATIONS
Picket Type	AS PER CONSTRUCTION SPECIFICATIONS	Colour	AS PER CONSTRUCTION SPECIFICATIONS
Stringer / Riser	AS PER CONSTRUCTION SPECIFICATIONS	Colour	AS PER CONSTRUCTION SPECIFICATIONS
Treads	AS PER CONSTRUCTION SPECIFICATIONS	Colour	AS PER CONSTRUCTION SPECIFICATIONS
Red Oak Stairs as Per Vendor's Standard			
** Refer to Construction Summary THE STAIN COLOURS OR FINISH AVAILABLE ON RISERS, TREADS, PICKETS AND RAILS (STAIRCASES), WILL NOT BE AN EXACT MATCH TO PREFINISHED HARDWOOD OR LAMINATE FLOORS.			

9. Wall Paint Flat Finish

Main & Upper Hall	43 BIRCH WHITE	Master Bedroom	43 BIRCH WHITE
Living Room	43 BIRCH WHITE	Bedroom #2	43 BIRCH WHITE
Dining Room	43 BIRCH WHITE	Bedroom #3	43 BIRCH WHITE
Kitchen / Breakfast	43 BIRCH WHITE	Bedroom #4	43 BIRCH WHITE
Family Room	43 BIRCH WHITE	Bedroom #5	43 BIRCH WHITE
Powder Room	43 BIRCH WHITE	Master Ensuite	43 BIRCH WHITE
Laundry Room	43 BIRCH WHITE	Ensuite Bath - Bedroom 2	43 BIRCH WHITE
Den/Library	43 BIRCH WHITE	Ensuite Bath - Bedroom 3/4	43 BIRCH WHITE
Trim & Door Paint-Semi Gloss	BIRCH WHITE	Mud Room	43 BIRCH WHITE
		Flex	43 BIRCH WHITE

** Refer to Construction Summary

Initial: 

Purchaser:CHENGYI DENG

Property: 36

Telephone Res. / Bus: /

Project: Trinigroup Development Inc.

Decor Advisor: Ida Viola

Model and Elevation: Villa 6 Elev 3

Lock Date: 3-Apr-25

3-Apr-25

Plan #: 65M-4818

10. Fireplace

	Living Room			Family Room			Other Room - Specify		
	Purchased	As Per Plan	N/A	Purchased	As Per Plan	N/A	Purchased	As Per Plan	N/A
	<input type="radio"/>	<input type="radio"/>	<input type="radio"/>	<input type="radio"/>	<input checked="" type="radio"/>	<input type="radio"/>	<input type="radio"/>	<input type="radio"/>	<input type="radio"/>
Fireplace Type				As Per Construction Specifications					
Mantle Type				MANTLE M1-STANDARD					
Colour / Stain				AS PER CONSTRUCTION SPECIFICATIONS					
Surround				BIANCO					
Hearth				NO					

** Refer to Construction Summary

11. Air Conditioning

Air ConditioningNO

Comment

** Refer to Construction Summary

12. General Comments

** Refer to Construction Summary

Disclaimers and Notes

- 1) Colours of all materials are as close as possible to builder's selection, but not necessarily identical due to variances in manufacturing.

2) Any extras listed above are null and void unless accompanied by a separate invoice/amendment. Said invoice must be paid in full.

3) The Purchaser agrees that this colour selection is final and that no changes will be permitted, unless required by the Vendor.

4) The Purchaser acknowledges reading and accepting document which contains other miscellaneous disclaimers.

5) In the event of a conflict between the Standard Features schedule of the Agreement of Purchase and Sale and the Interior Colour Scheme, the Interior Colour Scheme shall prevail.

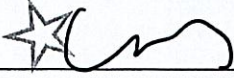
Signature:

Date: 4/3/2025

Lot 36 Legacy

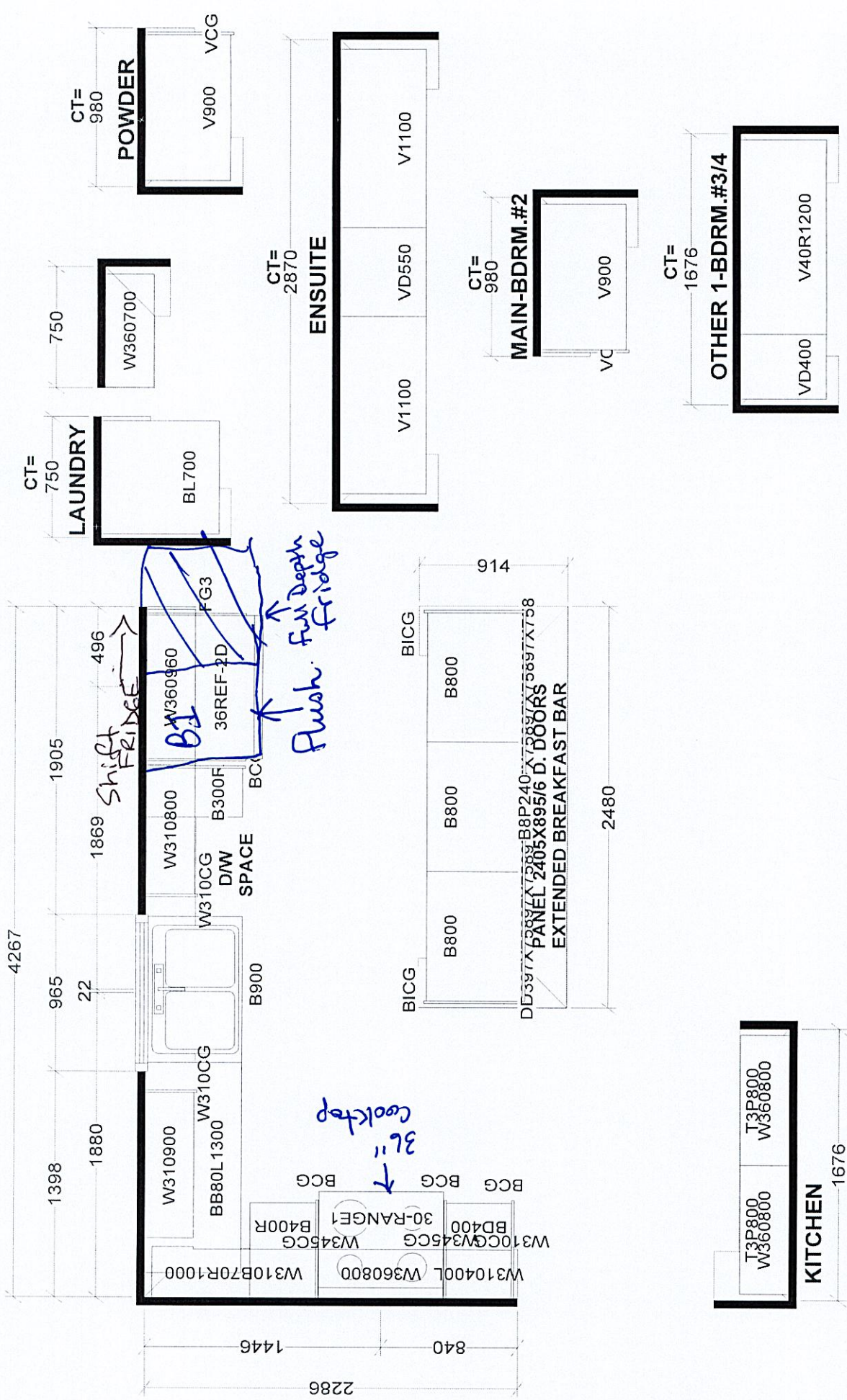

Selba Industries		J #
This drawing is the intellectual property of SELBA INDUSTRIES INC. and is an original design which must not be released or copied unless applicable fee has been paid or job order placed.		
JOB NUMBER:		
BUILDER: GREENPARK HOMES		
SITE: TRINI GROUP, Richmond Hill		
MODEL: VILLA 6X EL 1,2,3		
LOT #:		
W WDTH	W HGHT	W CNT
FLOOR HGHT	DOOR HGHT	
ST CENT	2X4	VENT BOX COVER
DESIGNER: KS		DATE: OCT 19 23

LG STUDIO

WCES6428F
1.7 / 4.7 cu. ft. STUDIO Smart wi-fi Enabled
Combination Double Wall Oven

7" Color LCD Touch Display

Soft Close Door

Air Fry Setting

InstaView® Window (WideView)

Steam Sous Vide

Optional Flush Installation

EasyClean®

LG Exclusive 4-Mode True Convection

ThinQ® Technology



SUMMARY		LOWER OVEN FEATURES		SMART FEATURES		
Type	Combi Wall Oven	Capacity (cu.ft)	4.7	ThinQ® (Wi-Fi Enabled)	Yes	
Total Oven Capacity (cu. ft.)	6.4 (Upper & Lower)	EasyClean®	Yes	Check & Control	Yes	
Color	Stainless Steel	EasyClean(SpeedClean) time	10 mins	Voice Control	Yes	
UPPER OVEN FEATURES		Self Clean	Yes	Smart Recipe (3rd Party Recipe App)	Innit, Sidechef	
Capacity (cu.ft)	1.7	Variable cleaning time	Yes	SmartDiagnosis™	Yes	
Interior(Cavity) - Upper MWO / Lower Oven	Stainless / Enamel Coating	Steam Assist	Yes	DIMENSIONS/CLEARANCES/WEIGHTS		
Microwave Power output	950W	Steam element	1,960 watts	Product Weight (lbs)	204	
Microwave mode power consumption	1650W	Convection Type	True Convection	Shipping Weight (lbs)	239	
Convection Bake mode power consumption	1600W	Convection element	2,000 watts	Product (W x H x D) : Including Door	29 3/4" x 43 13/16" x 24 15/32"	
Broil mode power consumption	1300W	Convection Fan	Single Speed	Product (W x H x D) : Including Handle	29 3/4" x 43 13/16" x 26 29/32"	
Convection Element (W)	1500W (Sheath heater)	Convection conversion	Yes	Product (W x H x D) : Opening Door	29 3/4" x 43 13/16" x 45 21/32"	
Broil Upper Element (W)	1200W (500W Infrared Heating™ + 700W Miraclon heater)	Bake element	2,500 watts	Cut-out (W x H x D) : Standard	Min-28-1/2" x 43-7/16" x 24" Max-28-5/8" x 43-1/2" x 24"	
Bake Element (W)	375W	Bake element type	Hidden (8 pass)	Cut-out (W x H x D) : Flush	30" x 44" x 25"	
Microwave	Yes	Broil element	2,500 watts inner / 1,500 watts outer	Overall Depth (in) - including handle	TBD	
Convection Bake	Yes	Broil element pass	8	Oven Interior Dimensions (Upper) (in) (W x H x D)	20-8/11"(W) x 8-9/25"(H) x 17-5/13"(D)	
Broil	Yes	Oven Cooking Modes	Air Fry / Warm / Proof / Steam Cook(Steam Bake, Sous-Vide) / Auto Cook / Favorite / Clean(Self Clean, Easy Clean, Steam Maintenance)	Oven Interior Dimensions (Lower) (in) (W x H x D)	24-1/2"(W) x 17-5/8"(H) x 18-7/8"(D)	
Speed cook	Yes		Carton Dimensions (in) (W x H x D)	33" x 50" x 30"		
- # of Defrost (4 Menu)	Meat / Poultry / Fish / Bread		POWER/RATINGS			
- # of Sensor cook (9Menu)	Beverage / Casserole / Chicken / Pasta / Pizza / Plate of food / Rice / Soup / Vegetable		Max. Amp load	40A		
- # of Auto cook	Bacon(regular sliced) / Bagels(frozen) / Baked potatoes(7-9oz/ea) / Brownie / Cod fillets(1 lb) / Corn dog(frozen) / Fresh vegetable / Frozen chicken wings / Frozen fries / Frozen chicken nuggets / Frozen pizza(regular crust) / Frozen soft pretzels / Frozen vegetable / Garlic bread(sliced, frozen) / Hamburger(1/2" thick) / Lamb chops(1/2" thick, 6-7oz) / Meat loaf(9" X 5") / Nachos / Oatmeal / Pork chops(1/2" thick, 6-7oz) / Quinoa / Ribeye steak(1" thick 14-15oz) / Rice / Salmon steak(1" thick) / Sausage / Sirloin steak(1" thick, 18-21oz) / Tenderloin / Vegetable-canned		No of Auto cook	Upper (28EA), Lower (45EA) except miscellaneous	Required Power Supply	60 Hz / 240 V, 208 V
	Butter / Cream Cheese / Frosting / Ice Cream		No of Favorite	40EA	Rating	7.8kW
	Butter / Caramel / Cheese / Chocolate / Marshmallow		No of rack position	5	Requirements	60 Hz / 240 V, 208 V
			No of light	2 (Halogen Lamp)	ACCESSORIES	
			Proof	Yes	Glass Tray(Upper)	1EA
			Drying / Dehydrating	Yes	Metal Tray(Upper)	1EA
			Temp probe	Yes	Rack(Upper)	1EA
			12 hrs. shut-off	Yes	Broiler pan	1EA
			Variable warm	Yes (High,Med,Low)	Griddle(Lower)	1EA
				Meat probe	1EA	
			Heavy Duty Rack	2EA		
			Gliding Rack	1EA		
			Air Fry Rack(Lower)	1EA		
		CONTROL		LIMITED WARRANTY		
		Oven Control Type	Glass Touch	Parts & Labor	2 Years	
		Display	7" TFT LCD	UPC CODES		
		Language	English / Spanish / French	WCES6428F (Printproof™ Stainless Steel)	195174024133	
		Clock	12 hr or 24 hr (option)	WCES6428N (Essence White)	195174070079	
		Kitchen Timer	Yes			
		Timed Cook	Yes			
		Temperature Unit of Measure	Fahrenheit / Celsius			
		Cooking Complete Reminder	Beeper (Hi, Lo, Off)			
		Volume				
		Certified Sabbath mode	Yes			
		APPEARANCE				
		All Available Colors	Stainless Steel			
		Handle	Stainless Steel			
		Printproof™ Finish	Yes			
		Oven Door Feature	WideView™ Window			
		InstaView®	Yes (Lower Only)			

LG STUDIO

WCES6428F

1.7 / 4.7 cu. ft. STUDIO Smart wi-fi Enabled
Combination Double Wall Oven

QUICK INSTALL & CLEARANCES

For full installation directions/clearances please refer to the corresponding User Manual and Installation Guide.

IMPORTANT

PROPER LOCATION AND DIMENSIONS

- Measure the current cutout dimensions and compare them to the cutout dimensions shown below. Little or no cabinet work may be necessary.
- The cabinet base platform must be able to support 202 lbs (92 kg) for this appliance. If the cabinet does not have a solid bottom, two braces or runners must be installed level with the bottom of the cutout to support the weight of the appliance. Make sure the base is level and the front of the cabinet is square. If the cabinet base is not level, the oven racks will tend to slide out when opening the door.
 - Make sure the cabinets and wall coverings around the oven can withstand the temperature (up to 194 °F (90 °C)) generated by the oven. Discoloration, delamination or melting may occur.
 - DO NOT remove spacers ③ on the side walls of the built-in oven. These spacers center the oven in the space provided. The oven must be centered to prevent excess heat buildup that may result in heat damage or fire.
 - Kitchen cabinets in contact with the oven must be heat resistant up to 194 °F (90 °C), and fronts of nearby units up to at least 158 °F (70 °C).
 - The information in this manual should be followed exactly. Failure to do so could result in fire or electrical shock, causing property damage, personal injury or death.
 - DO NOT put any weight on the oven door. Never allow anyone to climb, sit, stand or hang on the oven door. The oven could be tipped and injury might result from contact with hot food or the oven itself.
 - DO NOT block the oven air exhaust located at the bottom of the oven. Blocking the exhaust may cause cabinet damage and product malfunction.

NOTE

- If marks, blemishes or the cutout opening are visible above the installed appliance, it may be necessary to add wood shims under the runners and front trim until the marks or opening are covered.
- If the cabinet does not have a front frame and the sides are less than 3/4" (1.9 cm) thick, shim both sides equally to establish the cutout width.
- The junction box ① must be flush with the conduit opening ② of the cabinet as shown.
- Allow at least a 23" clearance for the door depth when it is open.
- Do not remove the gliding racks from the base packing. Gliding racks are attached separately to the top and bottom of the oven.

POWER / RATINGS

Max. Amp load	40A
Required Power Supply	60 Hz / 240 V, 208 V
Rating	7.8kW
Requirements	60 Hz / 240 V, 208 V



DIMENSIONS / CLEARANCES	
A Height	43 13/16"
B Width	29 3/4"
C Depth	23 3/8"
D Height (standard installation)	43 3/16"
E Height (power cord)	25 7/8"
F Length (power cord)	60"
G Width (standard installation)	27 3/8"

③ Cleat (Spacer)

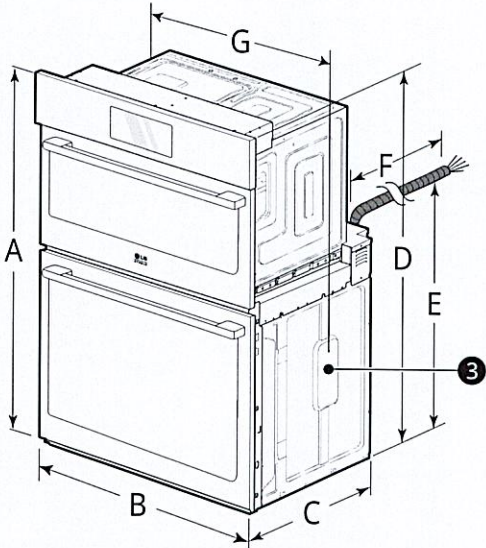

DIMENSIONS / CLEARANCES	
H Cabinet Width	30"
I Overlap of oven	1"
J Cutout width	28 1/2" Min. 28 5/8" Max.
K Depth of open door	23"
L Cutout location from floor	12"
M Cutout depth	24" Min.
N Cutout height	43 7/16" Min. 43 1/2" Max.
O Height of conduit opening from floor of cutout	39 27/32"
P Distance of conduit opening from side of cabinet	5"

① Junction box

② Conduit opening

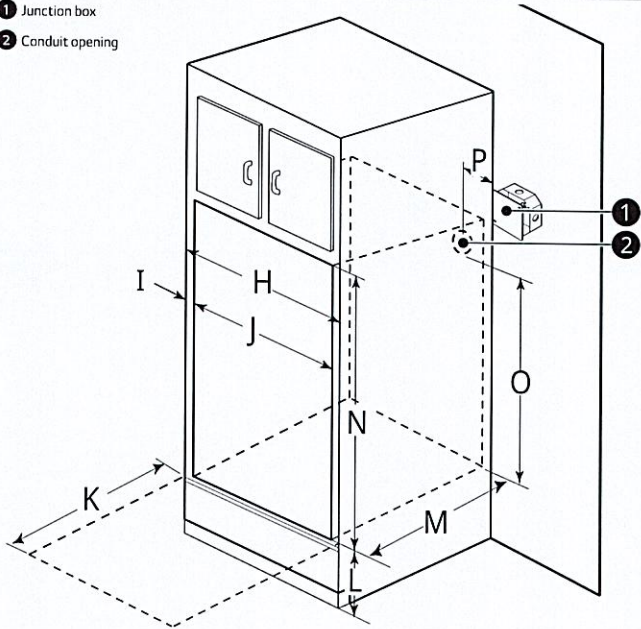

6 INSTALLATION

Cutout Dimensions (Flush)

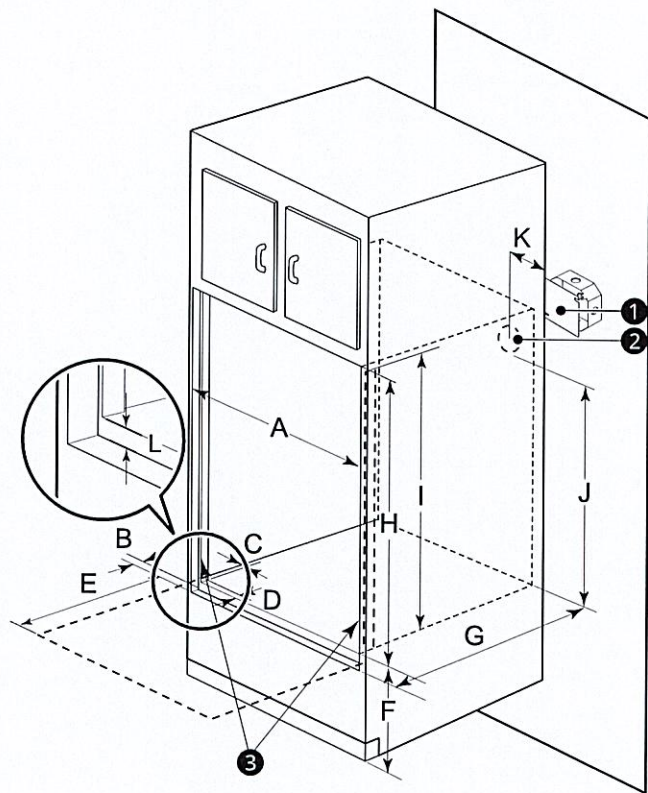

❶ Junction box	❷ Conduit opening	❸ Cleat (Spacer)
----------------	-------------------	------------------

List		Dimensions
A	Cutout width	30" (76.2 cm)
B	Cleat (spacer) inset from front of cabinet	1 3/8" (3.5 cm)
C	Cleat (spacer) width	3/16" (0.5 cm)
D	Cleat (spacer) depth	1" (2.5 cm)
E	Depth of open door	23" (58.4 cm)
F	Bottom of cutout from floor	12" (30.5 cm)
G	Cutout depth	25" (63.5 cm)
H	Cutout height	44" (111.8 cm)
I	Cleat (spacer) height	43 13/16" (111.3 cm)
J	Height of conduit opening from floor of cutout	39 7/8" (101.2 cm)
K	Distance of conduit opening from side of cabinet	5" (12.7 cm)
L	Bottom of bottom decorative trim to vent opening	3/4" (1.9 cm)

When Installing Flush Cabinet

- The provided cover brackets are only used for flush cabinet installations.

PRODUCT DIMENSIONS

TOP VIEW

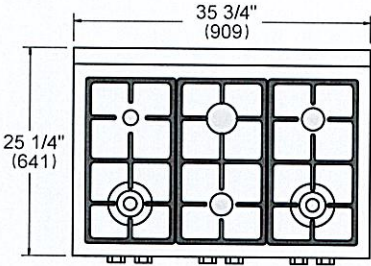

FRONT VIEW

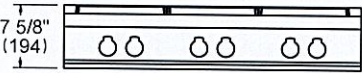

SIDE VIEW

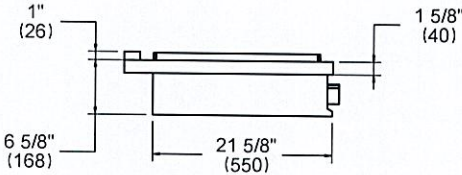

ELECTRICAL & GAS CONNECTION

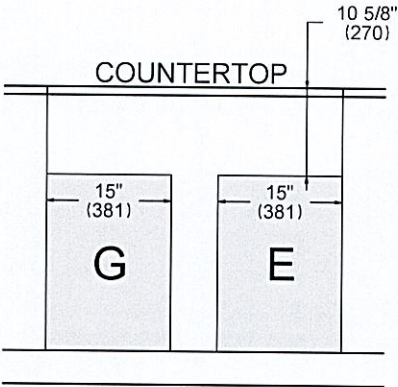

- E** A properly-grounded, horizontally-mounted electrical receptacle should be installed according to this drawing.
- G** An agency-approved, properly-sized manual shut-off valve should be installed according to this drawing.

INSTALLATION REQUIREMENTS

Combustible material cannot be installed within shaded area.

For installation with an updraft or downdraft hood as well as any OTR, refer to the hood/OTR manufacturer's installation requirements.

CUTOUT DIMENSIONS

TOP VIEW

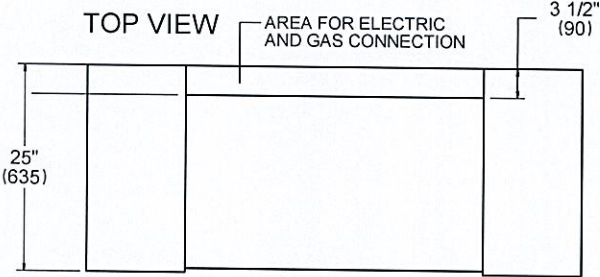

SIDE VIEW

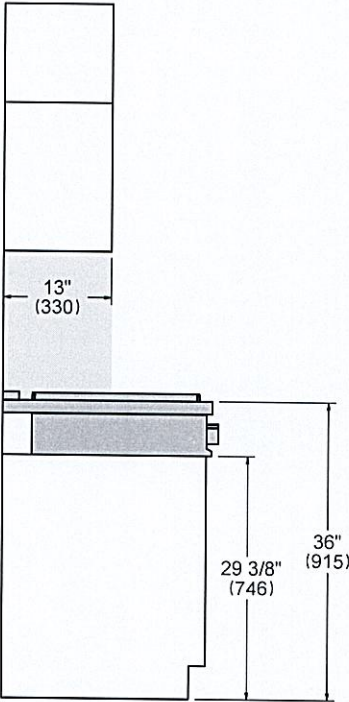

FRONT VIEW

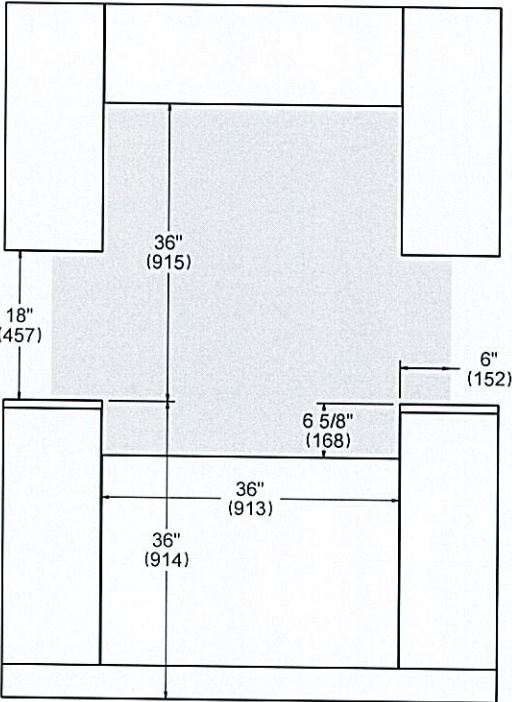

10 INSTALLATION

Electrical Requirements

Ensure that dedicated circuit protection is prepared as recommended and that the appliance is grounded properly.

This wall oven must be electrically grounded in accordance with local codes or, in their absence, with the National Electrical Code ANSI/NFPA No.70- latest edition* in United States, or with CSA Standard C22.1-1982 and C22.2 No.01982 (or latest

edition)**, Canadian Electrical Code, Part1, and all local codes and ordinances.

All wiring should conform to Local and NEC codes. This appliance requires a single-phase, 3 wire, A.C 120/208 V or 120/240 V 60 Hz electrical system. Use only a 3-conductor or a 4-conductor UL - listed cord with closed-loop terminals, open-end spade lugs with upturned ends or similar termination. Do not install the power cord without a strain relief.

Appliance rating Watts 240 V	
Power consumption	Protection circuit recommended
7800 W (WCES6428*, WCEP6427*) 5800 W (WCEP6423*)	50 A (WCES6428*, WCEP6427*) 40 A (WCEP6423*)

⚠ WARNING

- Do Not ground to a gas pipe.
- Do Not have a fuse in the neutral or grounding circuit.
- A U.L.-listed conduit connector must be provided at the junction box.
- The appliance must be hard wired (direct wired) into an approved junction box. A plug and receptacle is not permitted on these products.
- DO NOT shorten the flexible conduit. The conduit connector must be securely attached to the junction box and the flexible conduit must be securely attached to the conduit connector. If the flexible conduit will not fit within the connector, do not install the oven until a connector of the proper size is obtained.

NOTE

- The power leads supplied with the appliance are UL, CSA recognized for connection to larger gauge household wiring. The insulation of these leads is rated at temperatures much higher than the temperature rating of household wiring. The current carrying capacity of the conductor is governed by the wire gauge and the temperature rating of the insulation around the wire.
- You will need to purchase an appropriate conduit connector to complete the connection of the conduit to the junction box.

Making Electrical Connections

⚠ WARNING

- New branch-circuit installations (1996 NEC), mobile homes, recreational vehicles, or installations where local codes prohibit grounding through the neutral conductor require 4-wire branch-circuit connection.
- Improper connection of aluminum house wiring to copper leads can result in an electrical hazard or fire. Use only connectors designed for joining copper to aluminum and follow the manufacturer's recommended procedure closely.

- 1 Turn off the circuit breaker or remove fuses to the oven branch circuit.
- 2 With the oven positioned directly in front of the cabinet opening, connect the flexible conduit to the electrical junction box. Position the conduit in such a manner that it will lie on top of the oven in a natural loop when the oven is installed.
- 3 If local codes permit connection of the frame grounding conductor to the neutral (white) wire, follow the instructions for a 3-wire circuit connection.
- 4 If used in mobile homes or new construction, or a recreational vehicle, or local codes do not permit connection of the frame grounding conductor to the neutral (white) wire, follow the instructions for a 4-wire circuit connection.

3-Wire Connection from Home Power Supply

⚠ WARNING

- The middle (neutral or ground) wire, which is white, of a 3-wire power cord or a 3-wire conduit has to be connected to the middle post of the main terminal block. The remaining two wires of the power cord or conduit have to be connected to the outside posts of the main terminal connection block. Failure to do so can result in electrical shock, severe personal injury or death.

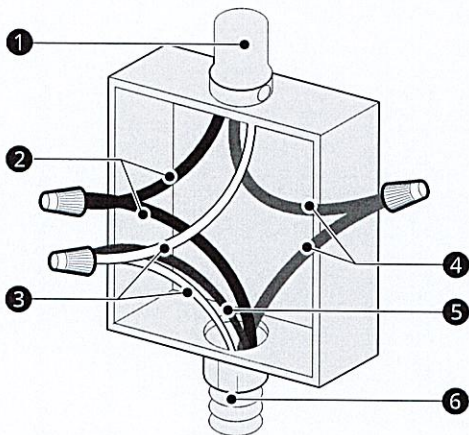

- 1 Cable from home power supply
- 2 Black wires
- 3 White wires
- 4 Red wires
- 5 Green (or bare) ground wires
- 6 4-wire flexible conduit from oven

- 1 Connect the oven ground (green) wire and neutral (white) wire to the branch circuit neutral (white or gray) wire, using a wire nut.
- 2 Connect the oven red wire to the branch circuit red (L2) wire in accordance with local codes, using a wire nut.
- 3 Connect the oven black wire to the branch circuit black (L1) wire in accordance with local codes, using a wire nut.
- 4 Install the junction box cover.

4-Wire Connection from Home Power Supply

⚠ WARNING

- Only use a 4-conductor power-supply cord kit rated 120/240 volts, 50 amperes and marked for use with ranges with closed-loop connectors or open spade lugs with upturned ends. The white middle (neutral) wire of the power cord or 4-wire conduit has to be connected to the middle post of the main terminal block. The other two wires of the power cord or conduit have to be connected to the outside posts of the main terminal connection block. The 4th ground wire (green) must be connected to the frame of the oven with the ground screw. Failure to do so can result in electrical shock, severe personal injury or death.

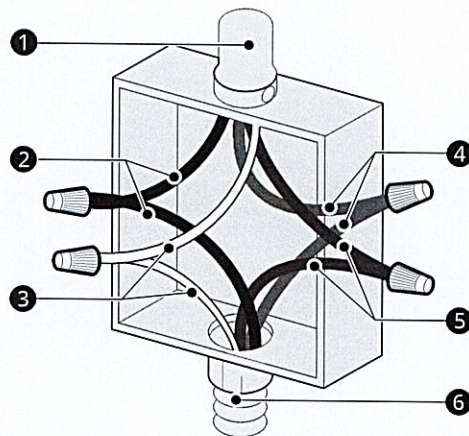

- 1 Cable from home power supply
- 2 Black wires
- 3 White wires
- 4 Red wires
- 5 Green (or bare) ground wires
- 6 4-wire flexible conduit from oven

- 1 Separate the oven ground and white wires if necessary.
- 2 Connect the oven ground (green) wire to the branch circuit ground (green) wire in accordance with local codes, using a wire nut.
- 3 Connect the oven white wire to the branch circuit neutral (white or gray) wire in accordance with local codes, using a wire nut.



LG Refrigeration

LF24Z6530S S

Counter-Depth MAX™ with Zero Clearance™
3-Door French Door Refrigerator with
Thin Door Design

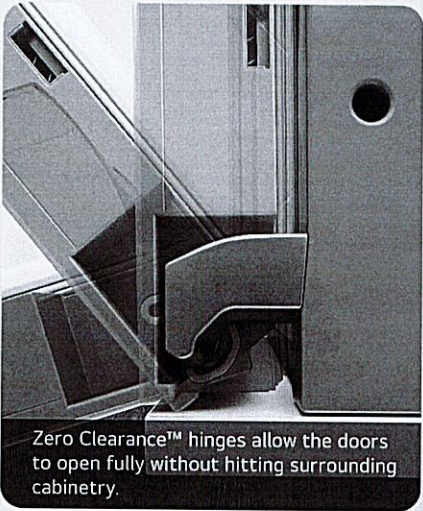

Zero Clearance™ hinges allow the doors to open fully without hitting surrounding cabinetry.

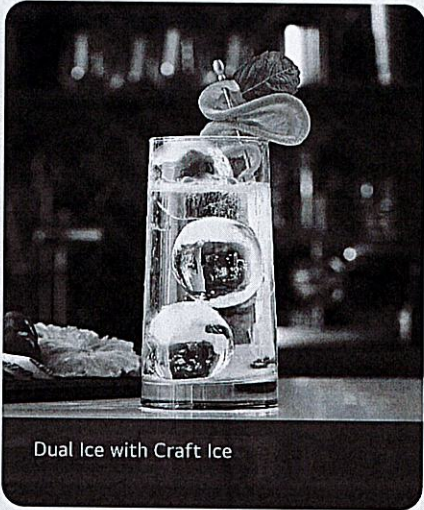

Dual Ice with Craft Ice



Capacity	
Refrigerator (cu. ft.)	15.8 cu.ft.
Freezer (cu. ft.)	7.9 cu.ft.
Total capacity (cu. ft.)	23.7 cu.ft.
Energy	
Energy Star® qualified	Yes
Energy consumption (kWh/year)	699
Water & Ice System	
Dispenser Type	Ice & Water
No. of In-door Ice Maker	1
In-door Ice Maker Ice Type	Cubed / Crushed
In-door Daily Ice Production	3.0/3.3 (Ice Plus) lbs
In-door Ice storage capacity	3.0 lbs
No. Freezer Ice Maker	1
Freezer Ice Type	Craft Ice
Freezer Daily Ice Production	0.7 (Ice Plus) lbs
Freezer Ice storage capacity	4.0 lbs
Ice Plus	Yes
Filteration System	1 Stage
Filter	LT1000P
Dispenser Light Decoration	No
Cooling	
Temperature Sensors	2
Compressor Type	Smart Inverter Compressor
Refrigerant	Low GWP, Zero ODP and More Energy Efficient Refrigerant (R600a / 78g / 2.75oz)
Multi Air Flow Cooling	Yes
Evaporator	1
Convenience	
Display type	Smooth Touch Control / White LED
Temperature controls	Electronic/digital
Door alarm	Yes

Control Lock	Yes
Smart Diagnosis™	Yes
Auto Closing Door Hinge	Yes
Wi-Fi Enabled	Yes
ThinQ®	Yes
Sabbath Mode	Yes
ADA compliant	Yes
Refrigerator	
No. of shelves	4 Split (4 Fixed)
Shelf construction	Spill Protector Tempered Glass
Shelf trim	White decor
No. of crisper bins	2
Pantry (Glide N' Serve)	Yes (normal)
Cool Guard	Yes
Fresh Air Filter	Yes
Light	Yes
Light (Back Lit Lighting)	No
Refrigerator Door	
No. of Door Bins	2 Left, 3 Right
Door shape	Flat
Handle type	Bar
Freezer	
Door type	Flat
Handle type	Pocket
Drawers / shelves	2-tier organization
Drawer divider	No
Freezer light	LED lighting
Materials and Finishes	
Hidden hinges	Yes
All available colours	Smudge resistant stainless steel
Insulation	Low GWP and zero ODP blowing agent

Dimensions/Clearances/Weights	
Product (W x H x D)	35 3/4" x 70 1/4" x 30 1/8"
Width	35 3/4"
Height (to top of hinge)	70 1/4"
Depth (with handles)	29 7/8"
Width (door open 90° without handle)	35 1/8"
Width (door open 90° with handle)	40"
Width (door fully open without handle)	45 1/2"
Height (to top of case)	68 7/8"
Depth without door	23 3/4"
Depth without handles	27 5/8"
Depth (to hinge cover)	18 1/4"
Depth (total with door open)	43 3/4"
Depth (draw open fully without handle)	43 7/8"
Installation clearance	Sides 1/8", Top 1", Back 2"*
Carton dimensions (WxHxD)	38" x 72" x 29"
Weight (unit/carton)	261 lbs /280.9 lbs
Limited Warranty	
Parts & labour	1 Year
Sealed System (Parts & Labor)	5 Years
Compressor (Parts & Labor)	5 Years
Inverter compressor (Parts & Labor)	6-10 Years
UPC Codes	
LF24Z6530S smudge resistant stainless steel	195174092453

© 2024 LG Electronics Canada, Inc. All rights reserved. "LG Life's Good" is a registered trademark of LG Corp. All other product and brand names are trademarks or registered trademarks of their respective owners. Design, features and specifications are subject to change without notice. Non-metric weights and measurements are approximate. Some features may require Internet access. Content and services may vary by product and are subject to change without notice. 9/22/2024
*For optimal performance, LG recommends 0.16 inches (4 mm) clearance between the sides of the refrigerator and the wall.

ELICA PRO SERIES
LEONE



HEAT GUARD



HUSH SYSTEM



LED REPLACEABLE



SEAMLESS LOOK



GREASE COLLECTORS



PROFESSIONAL PERFORMANCE

ELICA'S EXCLUSIVE PLUS FEATURES

Give a splash of Italian design to your professional kitchen with Leone's crisp lines, seamless welded corner craftsmanship, beveled rim and gleaming stainless steel.

Leone has the extra depth (24") and power (1200 CFM on 36",42" & 48" W) & 36" in 600 CFM needed to support professional ranges and cooktops. No ear plugs required with Leone's HUSH sound suppression system, which enables you to comfortably talk and entertain, even when cooking up a storm. Available in 30", 36" and 42" widths, Leone features backlit hidden knob controls, which operate the 4-speed blower and LED lighting. Designed for standard ducted ventilation only.

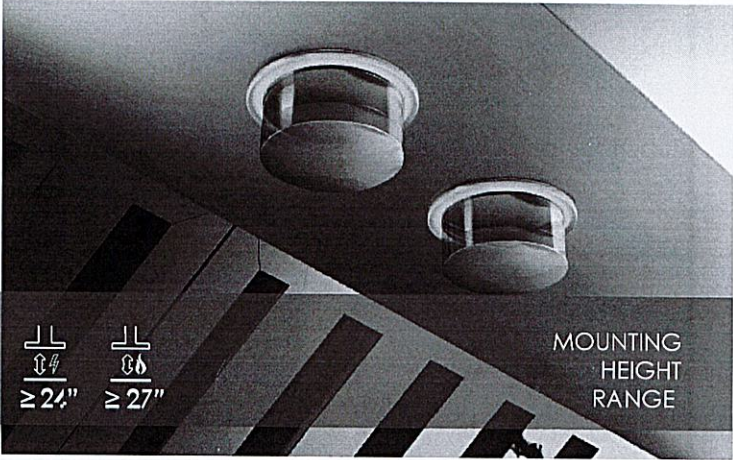
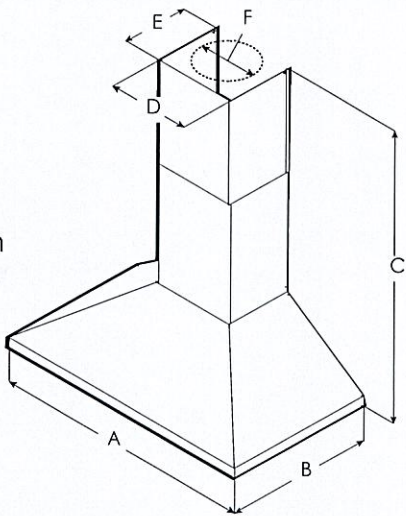

	ELN630S2	ELN636SS ELN1 36S2	ELN142S2	ELN148SS
A	30" (76.2 cm)	36" (91.4 cm)	42" (106.7 cm)	48" (121.9 cm)
B	24" (61 cm)			
C	Max: 47 5/8" (120.9 cm) Min: 30" (76.2 cm)			
D	13 1/8" (33.2 cm)			
E	10 5/8" (27 cm)			
F	8" (20.3 cm)			

Miele

G 7606 SCU AutoDos
Pre-finished, full-size dishwasher
with automatic dispensing thanks to AutoDos with integrated PowerDisk.

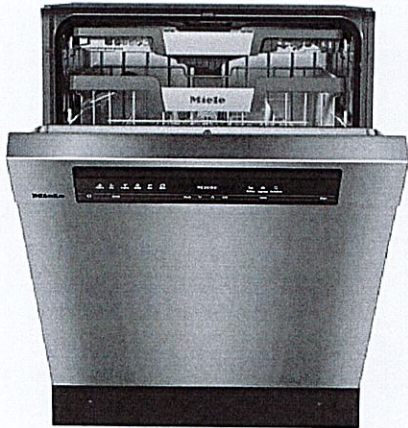

- Innovative design and maximum convenience – 3D MultiFlex Tray
- Communication with the machine could not be easier – Miele@home
- Perfect results in less than one hour – QuickIntenseWash
- Incredibly low sound emissions of just 40 dB(A)
- Versatile and secure – ExtraComfort basket design

EAN: 4002516770985 / Material number: 12497390 / Article Number: 21760637CDN

Type	
Pre-finished dishwashers	•
60 cm dishwashers	•
Design	
Control panel colour	CleanTouch Steel
Control panel version	Straight fascia
Control type	Program selector button
Display	1-line text display
Display colour	White
Language Options	•
Convenience	
Networking with Miele@home	•
Automatic dispensing with PowerDisk	•
Door closing aid	ComfortClose
Operating noise dB(A) re 1 pW	40
Time left display	•
Delay start up to 24 h	•
In-operation indicator light	Display, acoustic, volume control
Display language selection	•
Efficiency and sustainability	
EcoPower technology	•
Proven hygiene	•
Hot-water connection	•
Half load	•
Quality of results	
Fresh-water dishwasher	•
AutoOpen drying	•
SensorDry	•
Recirculation turbothermic drying	•
PerfectGlassCare	•
Wash programs	
Intensive 75°C	•
QuickIntenseWash	•
Sanitize	•
ExtraQuiet 37 dB(A)	•
Clean Machine	•
Rinse & Hold	•
Filters	•
Cleaning options	
AutoDos	•
IntenseZone	•
Express	•
Extra clean	•
Extra dry	•
Basket design	
Cutlery loading	3D MultiFlex tray
FlexCare glass holder	2
FlexCare cup rack	1
Basket design	ExtraComfort

more information you can find here:
<http://www.miele.ca/en/>



G 7606 SCU AutoDos
Pre-finished, full-size dishwasher
with automatic dispensing thanks to AutoDos with integrated PowerDisk.

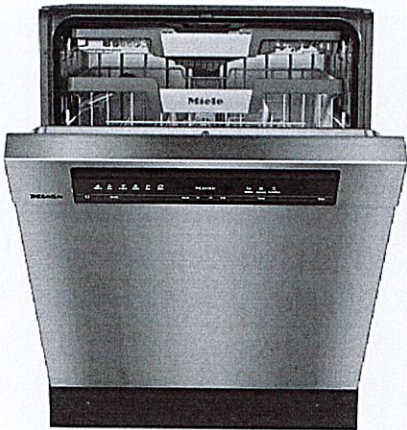

EAN: 4002516770985 / Material number: 12497390 / Article Number: 21760637CDN

MultiClip	•
Safety	
Waterproof system	•
Check filter indicator	•
Child lock	•
Technical data	
Minimum niche width in mm	23 5/8 (600)
Maximum niche width in mm	23 5/8 (600)
Minimum niche height in mm	33 3/4 (855)
Maximum niche height in mm	36 1/4 (920)
Niche depth in mm	22 1/2 (570)
Appliance width in mm	23 5/8 (598)
Appliance height in mm	33 3/4 (855)
Appliance depth in mm	22 1/2 (570)
Appliance depth with door open in cm	47 1/2 (120.5)
Net weight in kg	112 (50.5)
Total rated load in kW	1.40
Voltage in V	120
Fuse rating in A	15
Number of phases	1
Electrical frequency standard	60
Length of water inlet hose in cm	5 (1.50)
Length of water drain hose in cm	5 (1.50)
Length of power cable in m	4 (1.20)
Min. front panel weight in kg	3.0
Max. front panel weight in kg	11.0
[retro-fittable by Service to min.]	6.0
[retro-fittable by Service to max.]	15.0
Available display languages	
Available display languages via Language Options	deutsch, english (US), español, français (CA). ???
Accessories supplied	
1 x PowerDisk	•

Miele

G 7606 SCU AutoDos

Pre-finished, full-size dishwasher

with automatic dispensing thanks to AutoDos with integrated PowerDisk.

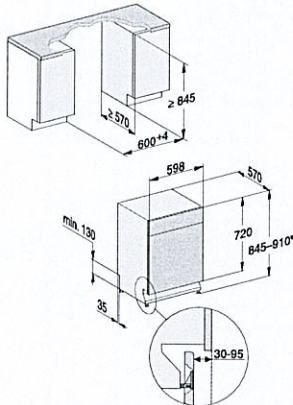

G7000, built under, XXL, dishwasher, 60cm (installation drawing)

1) Appliance height max. 970 mm with plinth height conversion kit (Mat.-No. 6.394.761)

Villa 6 36' Lot

Elev. 1: 3,038 sq.ft. Elev. 2: 3,047 sq.ft. Elev. 3: 3,047 sq.ft.

14

Lot 36 Legacy
plug above fireplace 4.5 ft from floor
GHS add plug 5 ft from floor
sidelight
Add Plug

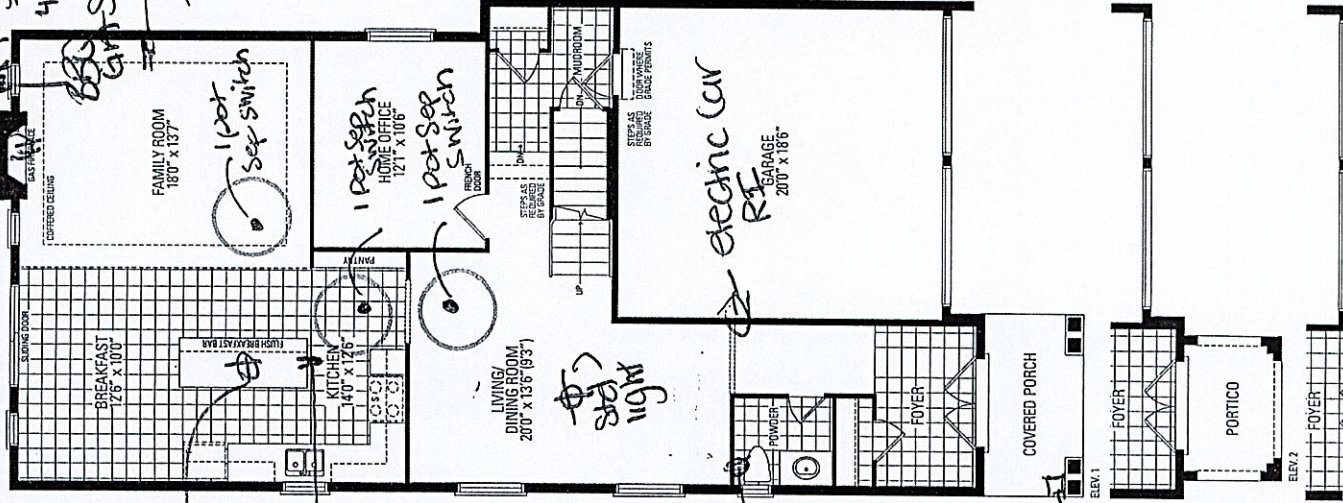

8 ft 6 inch Concrete Pour
Increase 1st Floor Ceiling to 10 ft.
Enlarge Basement Window

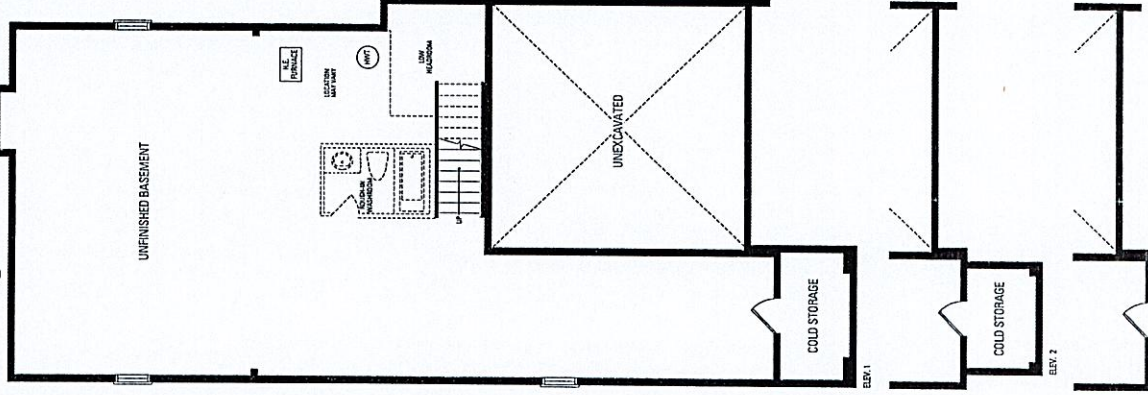

Lot 36

