

CONSTRUCTION SUMMARY  
Legacy Hill - Trinigroup Development Inc.

PURCHASER: Peter Yen-Hao YAO

TEL:

LOT / PHASE 22 / 1	REG. PLAN # 65M-4818	HOUSE TYPE Rose 6 Elev 3 (4 Bedroom)		
-----------------------	-------------------------	-----------------------------------------	--	--

BACKSPLASH - COUNTER TOP MATERIAL

1 - FURTHER VENDOR DISCOUNT 26Feb25 Note:	
----------------------------------------------	--

CABINETRY

1 - CABINETRY - BEDROOM 4 ENSUITE VANITY - UPGRADE 2 26Feb25 Note:	
1 - CABINETRY - BEDROOM 3 ENSUITE VANITY - UPGRADE 2 26Feb25 Note:	
1 - CABINETRY - BEDROOM 2 ENSUITE VANITY - UPGRADE 2 26Feb25 Note:	
1 - CABINETRY - MASTER ENSUITE VANITY - UPGRADE 1 26Feb25 Note:	
1 - CABINETRY - POWDER ROOM VANITY - UPGRADE 1 26Feb25 Note:	
1 - CABINETRY - BEDROOM 4 ENSUITE HARDWARE - UPGRADE 2 26Feb25 Note:	
1 - CABINETRY - BEDROOM 3 ENSUITE HARDWARE - UPGRADE 2 26Feb25 Note:	
1 - CABINETRY - BEDROOM 2 ENSUITE HARDWARE - UPGRADE 2 26Feb25 Note:	
1 - CABINETRY - MASTER ENSUITE HARDWARE - UPGRADE 2 26Feb25 Note:	
1 - CABINETRY - POWDER ROOM HARDWARE - UPGRADE 2 26Feb25 Note:	
1 - CABINETRY - KITCHEN - HARDWARE UPGRADE 2 26Feb25 Note:	
1 - CABINETRY - POWDER ROOM RAISE VANITY TO 36" HIGH VANITY IN LIEU OF STANDARD HEIGHT 26Feb25 Note:	
1 - CABINETRY - MASTER ENSUITE RAISE VANITY TO 36" HIGH VANITY IN LIEU OF STANDARD HEIGHT 26Feb25 Note:	
1 - CABINETRY - BEDROOM 4 ENSUITE RAISE VANITY TO 36" HIGH VANITY IN LIEU OF STANDARD HEIGHT 26Feb25 Note:	
1 - CABINETRY - BEDROOM 3 ENSUITE RAISE VANITY TO 36" HIGH VANITY IN LIEU OF STANDARD HEIGHT 26Feb25 Note:	
1 - CABINETRY - BEDROOM 2 ENSUITE RAISE VANITY TO 36" HIGH VANITY IN LIEU OF STANDARD HEIGHT 26Feb25 Note:	

RECEIVED

APR 02 2025



CONSTRUCTION SUMMARY

Legacy Hill - Trinigroup Development Inc.

PURCHASER: Peter Yen-Hao YAO

TEL:

LOT / PHASE	REG. PLAN #	HOUSE TYPE		
22 / 1	65M-4818	Rose 6 Elev 3 (4 Bedroom)		
1 - KITCHEN CABINETRY - TWO COLOUR KITCHEN - FLAT FEE 26Feb25 Note:				
1 - CABINETRY - KITCHEN - UPGRADE 2 26Feb25 Note:				
1 - KITCHEN CABINETRY - MINI STACKED UPPER CABINETS - UPGRADE 2 - KITCHEN (BASED ON STANDARD PLAN) 26Feb25 Note:				
1 - CABINETRY - KITCHEN - CROWN MOULDING WITH HEADER 26Feb25 Note:				
1 - CABINETRY - KITCHEN - LIGHT VALANCE 26Feb25 Note:				
1 - KITCHEN - DELETE CABINETS ABOVE STOVE AND HOOD FAN - VENDOR WILL SUPPLY 6 INCH VENT AS PER CONSTRUCTION SPECIFICATIONS AND VENT MAY NOT BE IN THE APPROPRIATE LOCATION FOR INSTALLATION OF PURCHASER SUPPLIED FAN 26Feb25 Note: PURCHASER TO SUPPLY AND INSTALL OWN FAN AFTER CLOSING				
1 - CABINETRY PROVISION - PROVISION FOR PLUG ON ISLAND (PLUG EXTRA ORDERED SEPARATELY) 08May24 Note:				

CABINETRY ACCESSORIES

3 - KITCHEN CABINETRY ACCESSORIES - ADD 18" APPLIANCE PULLS FOR FRIDGE/FREEZER #BP873304195 BRUSHED NICKEL 3 IN TOTAL - 2 DOOR FRIDGE WITH BOTTOM DOOR FREEZER 02Apr25 Note:	
1 - KITCHEN CABINETRY ACCESSORIES - ADD HARDWARE FOR DISHWASHER DOOR PANEL #738SD 02Apr25 Note:	
1 - KITCHEN CABINETRY - APPLIANCE DOOR PANELS - 24" DISHWASHER DOOR PANEL (SUPPLY ONLY, INSTALLATION NOT INCLUDED, HARDWARE NOT INCLUDED) - UPGRADE 2 26Feb25 Note:	
1 - KITCHEN CABINETRY - APPLIANCE DOOR PANELS - FRIDGE DOOR PANELS - SUPPLY ONLY, INSTALLATION NOT INCLUDED, HARDWARE NOT INCLUDED - 30"-36" WIDE FRIDGES - UPGRADE 2 26Feb25 Note:	
1 - KITCHEN CABINETRY - BUILT-IN FRIDGE FEE - PRICE IS EACH 26Feb25 Note:	
1 - KITCHEN CABINETRY - PANTRY UNIT UPGRADE - TO GO FROM 300MM TO 600MM DEEP - PRICE IS PER FOOT - UPGRADE 2 26Feb25 Note:	
1 - KITCHEN CABINETRY UPPER - FULL DEPTH ABOVE FRIDGE UPPER WITH GABLES - 650MM DEEP - PRICE IS EACH 26Feb25 Note:	
1 - KITCHEN CABINETRY BASE - PULLOUT WIRE SPICE RACK - PRICE IS EACH 26Feb25 Note:	
1 - KITCHEN CABINETRY BASE - PULLOUT RECYCLE 2 BIN - PRICE IS EACH 26Feb25 Note:	

CERAMIC TILE



CONSTRUCTION SUMMARY  
Legacy Hill - Trinigroup Development Inc.

PURCHASER: Peter Yen-Hao YAO

TEL:

LOT / PHASE	REG. PLAN #	HOUSE TYPE		
22 / 1	65M-4818	Rose 6 Elev 3 (4 Bedroom)		
1 - TILE - UPGRADE 1 FLOOR TILE - BEDROOM 4 ENSUITE FLOOR 26Feb25 Note:				
1 - TILE - UPGRADE 1 FLOOR TILE - BEDROOM 3 ENSUITE FLOOR 26Feb25 Note:				
1 - TILE - UPGRADE 1 FLOOR TILE - BEDROOM 2 ENSUITE FLOOR 26Feb25 Note:				
1 - TILE - UPGRADE 4 WALL TILE - MASTER ENSUITE WALL - SHOWER 26Feb25 Note:				
1 - TILE - UPGRADE 6 FLOOR TILE - MASTER ENSUITE FLOOR 26Feb25 Note:				
1 - TILE - UPGRADE 5 FLOOR TILE - GARAGE ENTRANCE/MUD ROOM 26Feb25 Note:				
1 - TILE - UPGRADE 1 FLOOR TILE - LAUNDRY ROOM 26Feb25 Note:				
1 - TILE - UPGRADE 5 FLOOR TILE - KITCHEN/BREAKFAST AREA 26Feb25 Note:				
1 - TILE - UPGRADE 5 FLOOR TILE - FOYER 26Feb25 Note:				
1 - TILE - UPGRADE 5 FLOOR TILE - POWDER ROOM 26Feb25 Note:				
1 - DELETE ALL CERAMIC BATHROOM ACCESSORIES - DELETE TOWEL BAR, PAPER HOLDER & SOAP DISH THROUGHOUT 26Feb25 Note:				

CONSTRUCTION

1 - MASTER ENSUITE - REMOVE WATER CLOSET WALLS AND DOOR AND ROTATE TOILET REVISE SHOWER SIZE TO 42" X 72" WITH CURB AND FRAMELESS GLASS ENCLOSURE 08May24 Note: AS PER SKETCH	
1 - PROVISION FOR FRAMELESS GLASS SHOWER ENCLOSURE - REMOVE SIDE WALL AND REPLACE WITH GLASS TO ACCOMMODATE FRAMELESS GLASS SHOWER ENCLOSURE SEE SKETCH 08May24 Note:	
MASTER ENSUITE	
1 - PROVISION FOR SHAMPOO NICHE APPROX. 24" WIDE X 20" HIGH AS PER SKETCH – IF CONSTRUCTION PERMITS 08May24 Note: MASTER ENSUITE - SEE SKETCH	
1 - SMOOTH CEILINGS ON FIRST FLOOR 08May24 Note:	
2 - ENLARGED BASEMENT WINDOWS (MAY REQUIRE WINDOW WELLS) - WINDOW IS 30 INCHES X 24 INCHES 18Oct23 Note:	
1 - LOWER LEVEL - BASEMENT 8 FOOT 6 INCH CONCRETE POUR - MEASURED FROM TOP OF FOOTING TO TOP OF FOUNDATION WALL 18Oct23 Note:	



CONSTRUCTION SUMMARY  
Legacy Hill - Trinigroup Development Inc.

PURCHASER: Peter Yen-Hao YAO TEL:

LOT / PHASE 22 / 1	REG. PLAN # 65M-4818	HOUSE TYPE Rose 6 Elev 3 (4 Bedroom)		
-----------------------	-------------------------	-----------------------------------------	--	--

1 - FIRST FLOOR INCREASE CEILING HEIGHT FROM 9 FEET TO 10 FEET 18Oct23 Note:	
---------------------------------------------------------------------------------	--

COUNTER TOP

1 - KITCHEN BACKSPLASH EXTRA AREA FOR QUARTZ BACKSPLASH - EXTRA AREA BEHIND CHIMNEY HOOD FAN TO CEILING - FOR PORCELAIN OR SILESTONE 26Feb25 Note:	
1 - KITCHEN BACKSPLASH FULL HEIGHT - UPGRADE STONE COUNTERTOP - SILESTONE LEVEL 2 26Feb25 Note: DOES NOT INCLUDE AREA BEHIND CHIMNEY HOOD TO CEILING	
1 - KITCHEN COUNTERTOP - UPGRADE STONE COUNTERTOP - SILESTONE LEVEL 2 26Feb25 Note:	
1 - BEDROOM 4 ENSUITE COUNTERTOP - UPGRADE STONE COUNTERTOP 26Feb25 Note:	
1 - BEDROOM 3 ENSUITE COUNTERTOP - UPGRADE STONE COUNTERTOP 26Feb25 Note:	
1 - BEDROOM 2 ENSUITE COUNTERTOP - UPGRADE STONE COUNTERTOP 26Feb25 Note:	
1 - POWDER ROOM COUNTERTOP - UPGRADE STONE COUNTERTOP 26Feb25 Note:	
1 - MASTER ENSUITE COUNTERTOP - UPGRADE STONE COUNTERTOP 26Feb25 Note:	
1 - KITCHEN - ADD WATERFALL LEG TO ISLAND 26Feb25 Note:	
1 - SHAMPOO NICHE 24" WIDE X 20" HIGH AS PER SKETCH – MARBLE, GRANITE OR QUARTZ – IF CONSTRUCTION PERMITS - REQUIRES PROVISION FROM CONSTRUCTION 08May24 Note: SUPPLY & INSTALL  MASTER ENSUITE - SEE SKETCH	

DOORS AND TRIM

1 - TRIM - 7 1/4 INCH BASEBOARD AND 3 1/4 INCH BB CASING - STEP 26Feb25 Note:	
----------------------------------------------------------------------------------	--

ELECTRICAL

1 - KITCHEN - VALANCE LIGHTING - LED LIGHTING 26Feb25 Note:	
1 - POT LIGHT - TUB/SHOWER POT LIGHT, FLAT PANEL LED 08May24 Note: ENSUITE 4	
1 - PLUG - ELECTRICAL PLUG - TO BE INSTALLED OVER FIREPLACE 08May24 Note: SEE SKETCH FOR LOCATION - IF CONSTRUCTION PERMITS	
1 - PLUG - ELECTRICAL PLUG - ADD TO ISLAND 08May24 Note: SEE SKETCH FOR LOCATION	



CONSTRUCTION SUMMARY  
Legacy Hill - Trinigroup Development Inc.

PURCHASER: Peter Yen-Hao YAO

TEL:

LOT / PHASE 22 / 1	REG. PLAN # 65M-4818	HOUSE TYPE Rose 6 Elev 3 (4 Bedroom)		
-----------------------	-------------------------	-----------------------------------------	--	--

1 - RELOCATE STANDARD KITCHEN LIGHT TO BE CENTERED OVER ISLAND 08May24 Note: SEE SKETCH FOR LOCATION - IF CONSTRUCTION PERMITS	
1 - STANDARD DINING ROOM LIGHT TO BE CENTERED BETWEEN LIVING AND DINING ROOM 08May24 Note: SEE SKETCH FOR LOCATION - IF CONSTRUCTION PERMITS	
1 - PLUG - ELECTRICAL PLUG WITH GFI AND SWITCH - FOR FESTIVE LIGHTING 08May24 Note: @ COVERED PORCH - IF CONSTRUCTION PERMITS	
1 - ELECTRIC VEHICLE ROUGH-IN PROVISION ONLY FOR FUTURE ELECTRIC CAR (CONDUIT FROM BASEMENT INTO JUNCTION BOX IN GARAGE WITH PULL STRING, NO WIRE) 08May24 Note: SEE SKETCH FOR LOCATION - IF CONSTRUCTION PERMITS	

FIREPLACE AND ACCESSORIES

1 - GAS LINE ROUGH-IN FOR STOVE (INCLUDES ELECTRICAL OUTLET) - FIRST FLOOR 08May24 Note:	
1 - GAS LINE ROUGH-IN FOR BARBECUE - FIRST FLOOR 08May24 Note:	

HARDWOOD FLOORING

1 - HARDWOOD - GROUP B SERIES 6 1/2 INCH - UPPER HALL AND FLEX AREA 26Feb25 Note:	
1 - HARDWOOD - GROUP B SERIES 6 1/2 INCH - IN LIEU OF 3 1/4 INCH NATURAL RED OAK - FIRST FLOOR HARDWOOD AREAS INCLUDING STAIR LANDINGS 26Feb25 Note:	

MIRRORS AND GLASS

1 - PROVISION FOR FRAMELESS GLASS SHOWER ENCLOSURE AS PER SKETCH  SHOWER TO INCLUDE CHROME CLIPS AND CHROME KNOB 08May24 Note:	
MASTER ENSUITE	

PAINTING

1 - WHITE PAINT TRIM PACKAGE - WHITE PAINT FOR BASEBOARDS, TRIM, DOORS & FIREPLACE IN LIEU OF STANDARD 26Feb25 Note:	
-------------------------------------------------------------------------------------------------------------------------	--

PLUMBING

6 - SINK - UNDERMOUNT SINK - CONTRAC COLLETTE #4220CIY 26Feb25 Note: All Baths	
1 - KITCHEN SINK - UNDERMOUNT SINK - TECO KITCHEN #170 26Feb25 Note: BOTTOM GRID INCLUDED #GR1516RC	
1 - MASTER ENSUITE - REMOVE WATER CLOSET WALLS AND DOOR AND ROTATE TOILET REVISE SHOWER SIZE TO 42" X 72" WITH CURB AND FRAMELESS GLASS ENCLOSURE 08May24 Note: AS PER SKETCH	
1 - HOT WATER VALVE NEXT TO TOILET - PRICE IS EACH 08May24 Note: MASTER ENSUITE	
1 - WATER LINE FOR FRIDGE - ROUGH-IN ONLY 08May24 Note:	



CONSTRUCTION SUMMARY  
Legacy Hill - Trinigroup Development Inc.

PURCHASER: Peter Yen-Hao YAO TEL:

LOT / PHASE 22 / 1	REG. PLAN # 65M-4818	HOUSE TYPE Rose 6 Elev 3 (4 Bedroom)		
-----------------------	-------------------------	-----------------------------------------	--	--

PROMOTIONAL

1 - LESS CREDIT FROM PURCHASER EXTRA SHEET IN OFFER 18Oct23 Note:	
----------------------------------------------------------------------	--

STAIRS AND RAILINGS

1 - HANDRAIL - V-GROOVE HANDRAIL 26Feb25 Note:	
1 - PICKETS - EUROLINE 1 - BLACK PICKETS 26Feb25 Note:	
1 - STAINED STAIRS - STANDARD STAIRCASE - INCLUDES EXTRA STEPS 26Feb25 Note:	

EXTRAS AS PER OFFER

The Vendor agrees that notwithstanding any other term or provision in this Agreement included in the Purchase Price and in addition to those items detailed in Schedule GP to the Agreement of Purchase and Sale, the Purchaser is entitled to a credit of Ten Worksheet Note:	
--------------------------------------------------------------------------------------------------------------------------------------------------------------------------------------------------------------------------------------------------------------------------------	--

This Document is Extremely Time Sensitive - Printed 2 Apr 25 at 13:47



Purchaser:

Telephone Res. / Bus:

Decor Advisor:

Lock Date:

Peter Yen-Hao YAO

/

Ida Viola

2-Apr-25

Property: 22

Project: Trinigroup Development Inc.

Model and Elevation: Rose 6 Elev 3 (4 Bedroom)

Plan #: 65M-4818

26-Feb-25

1. Cabinetry

	Style and Colour	Hardware
Kitchen / Breakfast	SEE BELOW	738SD
Laundry Room	ELISSE	Standard
Powder Room	DANA 823 DRIFTWOOD	741SD
Master Ensuite Bathroom	DANA 1048 FLAX	738SD
Ensuite Bath - Bedroom 2	SONATA SATIN SNOW	738SD
Ensuite Bath - Bedroom 3	SONATA SATIN SNOW	738SD
Ensuite Bath - Bedroom 4	SONATA SATIN SNOW	738SD
Stove Opening	STANDARD	NOTE: If not specified, opening will be set to builder's standard opening of approximately 30" width
Fridge Opening	SEE SPECS	NOTE: If not specified, opening will be set to builder's standard opening of approximately 37" width x 74" height

\*\* Refer to Construction Summary    KITCHEN PERIMETER - SONATA SATIN SNOW  
                                                         KITCHEN ISLAND        - SONATA FOSSIL

2. Counters

	Counter	Edge	Niche
Kitchen / Breakfast	SILESTONE-BLANC ELYSEE POLISHED	#370 EDGE	
Laundry Room	N/A	N/A	
Powder Room	QUARTZ-MISTRAL	#370 EDGE	
Master Ensuite Bathroom	QUARTZ-MISTRAL	#370 EDGE	QUARTZ- MISTRAL
Ensuite Bath - Bedroom 2	QUARTZ-TIVOLI T5R8	#370 EDGE	
Ensuite Bath - Bedroom 3	QUARTZ-TIVOLI T5R8	#370 EDGE	
Ensuite Bath - Bedroom 4	QUARTZ-TIVOLI T5R8	#370 EDGE	
Kitchen Backsplash	SILESTONE-BLANC ELYSEE POLISHED		

\*\* Refer to Construction Summary



Purchaser: Peter Yen-Hao YAO

Telephone Res. / Bus: /

Decor Advisor: Ida Viola

Lock Date: 26-Feb-25

Property: 22

Project: Trinigroup Development Inc.

Model and Elevation: Rose 6 Elev 3 (4 Bedroom)

26-Feb-25

Plan #: 65M-4818

3. Ceramic Flooring

At a 45

Entrance Vestibule	TILE- AGATA WHITE POLISHED 24X24	<input type="checkbox"/>
Main Hall	HARDWOOD	<input type="checkbox"/>
Kitchen / Breakfast	TILE- AGATA WHITE POLISHED 24X24	<input type="checkbox"/>
Laundry Room	TILE-VIENNA BIANCO 12X24	<input type="checkbox"/>
Powder Room	TILE- AGATA WHITE POLISHED 24X24	<input type="checkbox"/>
Master Ensuite Bathroom	TILE-KAIROS GRAPHITE MATTE 24X48	<input type="checkbox"/>
Ensuite Bath - Bedroom 2	TILE-VIENNA BIANCO 12X24	<input type="checkbox"/>
Ensuite Bath - Bedroom 3	TILE-VIENNA BIANCO 12X24	<input type="checkbox"/>
Ensuite Bath - Bedroom 4	TILE-VIENNA BIANCO 12X24	<input type="checkbox"/>
Mud Room	TILE- AGATA WHITE POLISHED 24X24	<input type="checkbox"/>
		<input type="checkbox"/>

\*\* Refer to Construction Summary \*\* METAL STRIP THRESHOLD WHERE APPLICABLE UNLESS SPECIFIED \*\*

4. Ceramic Wall Tile

Master Ensuite Bathroom	Selection	Describe
Tub Deck Wall	N/A	
Shower Stall	TILE-EMPORIO CALACUTTA POLISHED 12X24	
Bathtub Enclosure Walls	N/A	
Ensuite Bath - Bedroom 2	TILE-BIANCO LUCIDO 8X16	
Ensuite Bath - Bedroom 3	TILE-BIANCO LUCIDO 8X16	
Ensuite Bath - Bedroom 4	TILE-BIANCO LUCIDO 8X16	
Mud Room	N/A	
Kitchen Backsplash		

\*\* Refer to Construction Summary - STANDARD GROUT THROUGHOUT UNLESS SPECIFIED

5. Trim Carpentry

Interior Doors	CARRARA-SMOOTH
Interior Trim	3 1/4" BB CASING WITH 7 1/4" BASEBOARD - ONE STEP

\*\* Refer to Construction Summary

6. Plaster Mouldings and Medallions

Entrance Vestibule	N/A		Kitchen/Breakfast	N/A	
Main Hall	N/A		Den/Library	N/A	
Living Room	N/A		Lower Landing	N/A	
Dining Room	N/A				
Family Room	N/A				

\*\* Refer to Construction Summary



Purchaser: Peter Yen-Hao YAO

Telephone Res. / Bus: /

Decor Advisor: Ida Viola

Lock Date: 26-Feb-25

Property: 22

Project: Trinigroup Development Inc.

Model and Elevation: Rose 6 Elev 3 (4 Bedroom)

Plan #: 65M-4818

7. Other Flooring

Main Hall	HARDWOOD - VINTAGE NORTHERN SOLID SAWN WIRE BRUSHED RED OAK CHARACTER 6 1/2" TITANIUM UVF
Living Room	HARDWOOD - VINTAGE NORTHERN SOLID SAWN WIRE BRUSHED RED OAK CHARACTER 6 1/2" TITANIUM UVF
Dining Room	HARDWOOD - VINTAGE NORTHERN SOLID SAWN WIRE BRUSHED RED OAK CHARACTER 6 1/2" TITANIUM UVF
Family Room	HARDWOOD - VINTAGE NORTHERN SOLID SAWN WIRE BRUSHED RED OAK CHARACTER 6 1/2" TITANIUM UVF
Den / Library / Study	HARDWOOD - VINTAGE NORTHERN SOLID SAWN WIRE BRUSHED RED OAK CHARACTER 6 1/2" TITANIUM UVF
Basement Landing(If Applies)	N/A
Lower Landing (If Applies)	HARDWOOD - VINTAGE NORTHERN SOLID SAWN WIRE BRUSHED RED OAK CHARACTER 6 1/2" TITANIUM UVF
Upper Landing	HARDWOOD - VINTAGE NORTHERN SOLID SAWN WIRE BRUSHED RED OAK CHARACTER 6 1/2" TITANIUM UVF
Upper Hall	HARDWOOD - VINTAGE NORTHERN SOLID SAWN WIRE BRUSHED RED OAK CHARACTER 6 1/2" TITANIUM UVF
Master Bedroom	LAMINATE - LEXINGTON BRUSSELS OAK TL LW 1316 PEFC
Bedroom #2	LAMINATE - LEXINGTON BRUSSELS OAK TL LW 1316 PEFC
Bedroom #3	LAMINATE - LEXINGTON BRUSSELS OAK TL LW 1316 PEFC
Bedroom #4	LAMINATE - LEXINGTON BRUSSELS OAK TL LW 1316 PEFC
Bedroom #5	N/A
Flex Area	HARDWOOD - VINTAGE NORTHERN SOLID SAWN WIRE BRUSHED RED OAK CHARACTER 6 1/2" TITANIUM UVF
Underpad	Standard <input type="checkbox"/> Upgrade <input type="checkbox"/>

\*\* Refer to Construction Summary

8. Railings and Pickets

Railing Type	V-GROOVE	Colour	VINTAGE TITANIUM RED OAK
Picket Type	EUROLINE 1	Colour	BLACK
Stringer / Riser	AS PER CONSTRUCTION SPECIFICATIONS	Colour	VINTAGE TITANIUM RED OAK
Treads	AS PER CONSTRUCTION SPECIFICATIONS	Colour	VINTAGE TITANIUM RED OAK

Red Oak Stairs as Per Vendor's Standard

\*\* Refer to Construction Summary THE STAIN COLOURS OR FINISH AVAILABLE ON RISERS, TREADS, PICKETS AND RAILS (STAIRCASES), WILL NOT BE AN EXACT MATCH TO PREFINISHED HARDWOOD OR LAMINATE FLOORS.

9. Wall Paint Flat Finish

Main & Upper Hall	22 WARM GREY	Master Bedroom	22 WARM GREY
Living Room	22 WARM GREY	Bedroom #2	22 WARM GREY
Dining Room	22 WARM GREY	Bedroom #3	22 WARM GREY
Kitchen / Breakfast	22 WARM GREY	Bedroom #4	22 WARM GREY
Family Room	22 WARM GREY	Bedroom #5	N/A
Powder Room	22 WARM GREY	Master Ensuite	22 WARM GREY
Laundry Room	22 WARM GREY	Ensuite Bath - Bedroom 2	22 WARM GREY
Den/Library	22 WARM GREY	Ensuite Bath - Bedroom 3	22 WARM GREY
Trim & Door Paint-Semi Gloss	WHITE - UPGRADE	Ensuite Bath - Bedroom 4	22 WARM GREY
		Mud Room	22 WARM GREY
		Flex Area	22 WARM GREY

\*\* Refer to Construction Summary



Purchaser: Peter Yen-Hao YAO

Telephone Res. / Bus: /

Decor Advisor: Ida Viola

Lock Date: 26-Feb-25

Property: 22

Project: Trinigroup Development Inc.

Model and Elevation: Rose 6 Elev 3 (4 Bedroom)

26-Feb-25

Plan #: 65M-4818

10. Fireplace

	Living Room			Family Room			Other Room - Specify		
	Purchased	As Per Plan	N/A	Purchased	As Per Plan	N/A	Purchased	As Per Plan	N/A
	<input type="radio"/>	<input type="radio"/>	<input checked="" type="radio"/>	<input type="radio"/>	<input checked="" type="radio"/>	<input type="radio"/>	<input type="radio"/>	<input type="radio"/>	<input checked="" type="radio"/>
Fireplace Type				As Per Construction Specifications					
Mantle Type				MANTLE M2-STANDARD					
Colour / Stain				AS PER CONSTRUCTION SPECIFICATIONS					
Surround				NERO					
Hearth				NO					
** Refer to Construction Summary									

11. Air Conditioning

Air Conditioning	NO
Comment	
** Refer to Construction Summary	

12. General Comments

\*\* Refer to Construction Summary

Disclaimers and Notes

- 1) Colours of all materials are as close as possible to builder's selection, but not necessarily identical due to variances in manufacturing.

2) Any extras listed above are null and void unless accompanied by a separate invoice/amendment. Said invoice must be paid in full.

3) The Purchaser agrees that this colour selection is final and that no changes will be permitted, unless required by the Vendor.

4) The Purchaser acknowledges reading and accepting document which contains other miscellaneous disclaimers.

5) In the event of a conflict between the Standard Features schedule of the Agreement of Purchase and Sale and the Interior Colour Scheme, the Interior Colour Scheme shall prevail.

Signature: 

Date: 26 Feb 2025



**LOT 22**  
**TRINIGROUP**  
LEGACY HILL  
CITY OF RICHMOND HILL

**ROSE 6**  
**ELEVATION 3**

REVISIONS:

- REMOVE WATER CLOSET WALLS & DOOR AND ROTATE TOILET.
- REVISE SHOWER SIZE TO 42X72 WITH CURB AND FRAMELESS GLASS.

**UPPER LEVEL**

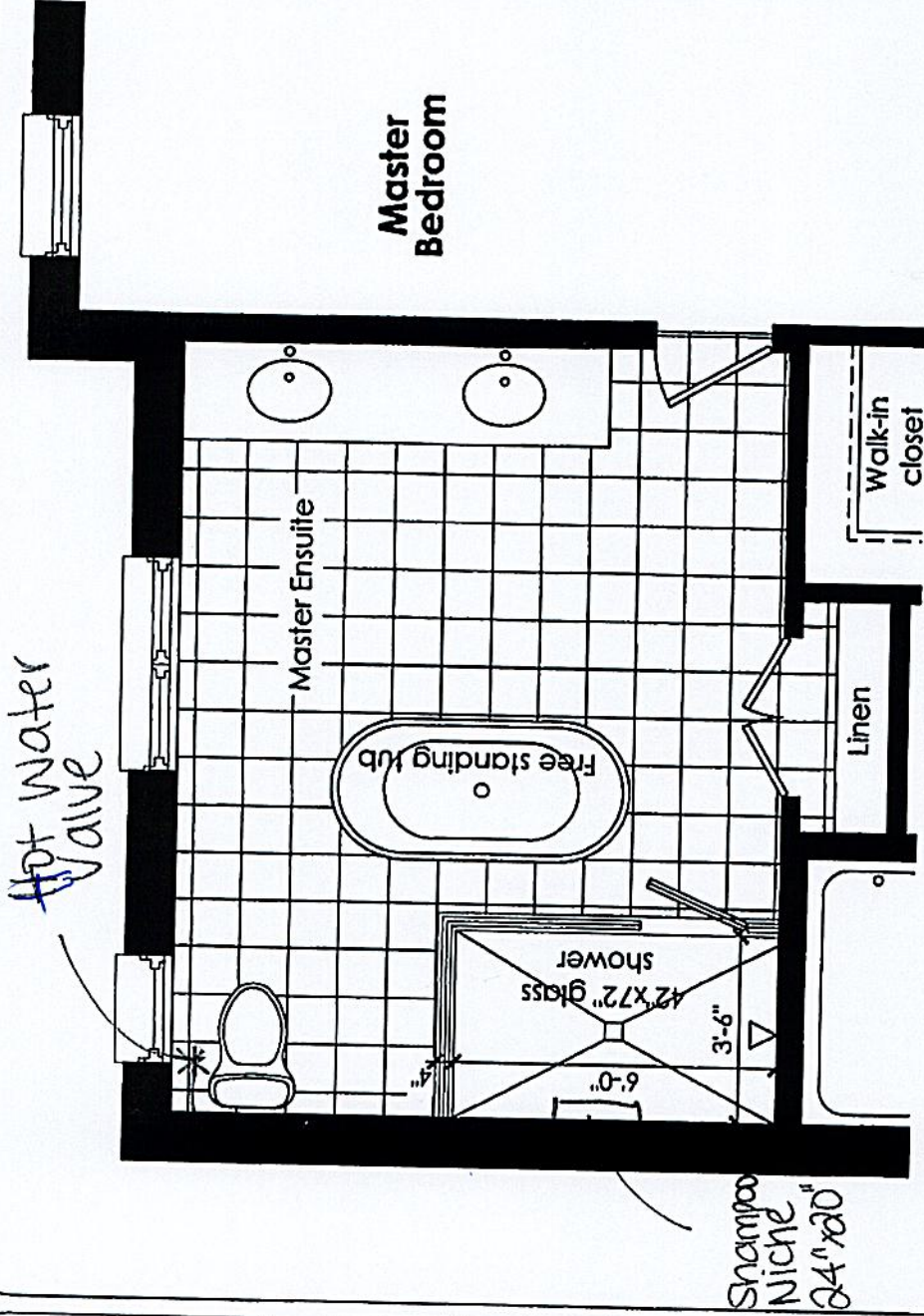

2. SLAVES: SKETCH NOT TO SCALE. DIMENSIONS, SPECIFICATIONS AND ARCHITECTURAL DETAILS SUBJECT TO MODIFICATION BY THE VENDOR. SKETCHES ONLY FOR THE PURPOSE OF ILLUSTRATING REVISIONS REQUESTED BY THE PURCHASER AND ALL REVISIONS ARE SUBJECT TO VENDOR'S FINAL APPROVAL. ONLY REVISIONS ACCEPTED IN WRITING BY THE PURCHASER AND VENDOR ON A PURCHASER'S EXTRA SHEET WILL BE INCORPORATED INTO THE PLANS FILED WITH THE MUNICIPALITY. E. & O.E.

REVISION  
BY  
DATE

SCALE  
BY  
DATE

H.T.S.  
PAGE NO.  
1 OF 1

**Greenpark**

*[Signature]*

MAY 29, 2024



LOT #22

ROSEBUD 4U LOL

Elev. 1: 3,243 sq.ft. Elev. 2: 3,197 sq.ft. Elev. 3: 3,197 sq.ft.

Includes 11 sq.ft. of Open Area

Gas line r/l for BBQ

Add Plug

Relocate str. light above island

Add plug

Hot water Valve

Shampoo Niche 24" x 20"

Add pot light

Relocating dining light to be centered

Enlarge basement windows

Electric vehicle r/l (conduit)

Festive plug

MAIN LEVEL

\*Smooth ceiling - 1st

\*8'-6" concrete pour

\*Gas line r/l for stove

\*Gas line r/l for BBQ

\*Waterline r/l for fridge

\*10'-ceiling height - 1st Floor

Refer to purchaser alteration form

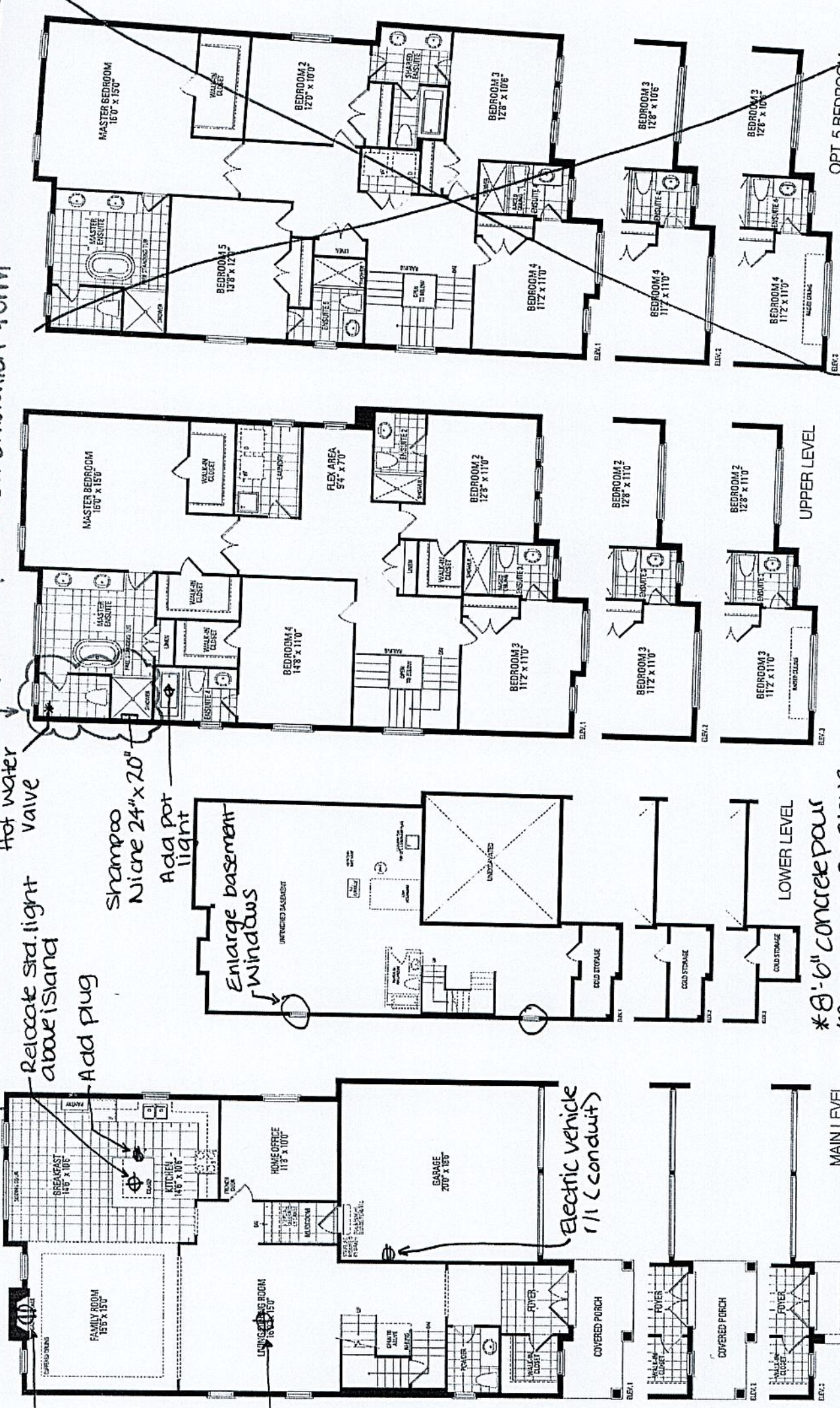

OPT. 5 BEDROOM UPPER LEVEL



- 2 colour Kitchen
- Island only
- Sonata fossil
- uppers & Bases
- Sonata Satin S
- mini stacked uppers -
- CH3
- light valand

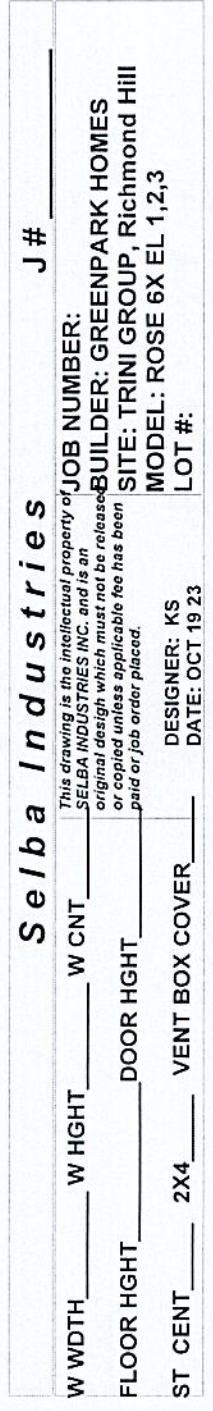



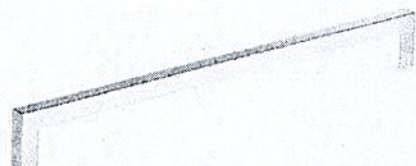

## Modern Metal Pull - 873

X3

**Product #** BP873457195

**Type** Appliance Pulls

**Center to Center** 18 in

**Finish** Brushed Nickel

**Length - Overall Dimensions** 476 mm

**Width - Overall Dimensions** 19 mm

**Screw/Nail** M6 (Included)

### DESCRIPTION

This modern right-angled Richelieu pull gives a distinguished look to any interior décor and enhances the style of your kitchen and bathroom cabinets.

Model 873 is available in 8 finishes in all center-to-center options, including 12- and 18-inch (304.8 and 457.2 mm) appliance pulls.

A matching-finish knob from the 810 series can be found in the suggested products section when a handle in a particular finish is selected.

### TECHNICAL SPECIFICATIONS

<b>Product #</b>	BP873457195
<b>Pulls and Knobs Style</b>	Modern
<b>Material</b>	Zamak
<b>Complete Collection by Model</b>	All Collections, 873/810
<b>Collection Completeness</b>	Level A
<b>Color Group</b>	Gray and Chrome Group
<b>Finish Number</b>	195
<b>Suggested Price</b>	From \$200.00 to \$500.00
<b>Projection - Overall Dimensions</b>	58 mm

### DISCLAIMER

Although our black finish is achieved through a rigorous process, it may show signs of normal usage faster than other finishes.

### PRODUCT PHOTOS



36" CLASSIC FRENCH DOOR REFRIGERATOR/FREEZER WITH INTERNAL DISPENSER -  
PANEL READY



CL3650UFDID/O



FEATURES

- Legacy product image shown; actual product varies slightly.
- Split Climate™ intelligent cooling system revolutionizes Sub-Zero's already-superior preservation capabilities, keeping food even fresher for longer
- ClearSight™ LED lighting system fully illuminates the interior and reduces shadows
- Sleek stainless accents trim the interior, matching the sophistication of the exterior
- Touch control panel is conveniently located for easy access at the tap of a finger
- Night Mode optimizes the interior lighting based on the detected ambient light, reducing the brightness by 90% in dim environments
- Delivers fresh, filtered water through an internal dispenser located discreetly within the refrigerator
- Activate Max Ice Mode to temporarily increase ice production
- Lift the base of the flip-up dairy compartments to store taller items on the shelf below
- The base of the expandable freezer basket conveniently slides out of the way, offering customizable storage for taller items below
- Wi-Fi enabled for convenient remote access using your mobile device or smart home system
- Sub-Zero offers an industry-leading full two-year warranty on appliances, along with a full five-year sealed system warranty

ACCESSORIES

- 90° Door Stop
- Air Purification Cartridge
- Custom Front Panel Mounting Kit
- Custom Side Panel Mounting Kit
- Egg Container
- Grille Frame - 84"
- Stainless Steel Flush Inset Grille Panel
- Stainless Steel Side Panel
- Water Filter
- Stainless Steel Flush Inset Door and Drawer Panels with Pro Handle
- Stainless Steel Flush Inset Door and Drawer Panels with Tubular Handle
- Classic Stainless Steel Pro Louvered Grilles
- Stainless Steel Pro Handles
- Stainless Steel Tubular Handles
- Stainless Steel Kickplate

Accessories are available through an authorized dealer.  
For local dealer information, visit [subzero-wolf.com/locator](http://subzero-wolf.com/locator).



HANDLE ACCESSORIES

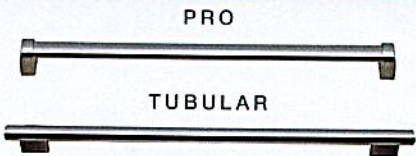

PRODUCT DETAILS

REFRIGERATOR

- 4 glass refrigerator shelves (3 adjustable; 1 stationary)
- 2 crisper drawers with removable dividers
- 4 adjustable refrigerator door bins
- 1 flip-up dairy compartment
- Air purification system
- Internal water dispenser
- LED refrigerator and freezer lights

FREEZER

- Full-extension drawer with expandable freezer basket
- Water filtration system
- Automatic ice maker with removable ice container

Specifications are subject to change without notice. This information was generated on March 22, 2025. Verify specifications prior to finalizing your cabinetry/enclosures.



36" CLASSIC FRENCH DOOR REFRIGERATOR/FREEZER WITH INTERNAL DISPENSER -  
PANEL READY



PRODUCT SPECIFICATIONS

Model	CL3650UFDID/O
Dimensions	36"W x 84"H x 24"D
Refrigerator Capacity	15.3 cu. ft.
Freezer Capacity	5.2 cu. ft.
Weight	573 lbs
Electrical Supply	115 VAC, 60 Hz
Electrical Service	15 amp dedicated circuit
Plumbing Supply	1/4" OD copper, braided stainless steel or PEX tubing
Plumbing Pressure	35–120 psi
Receptacle	3-prong grounding-type

ELECTRICAL

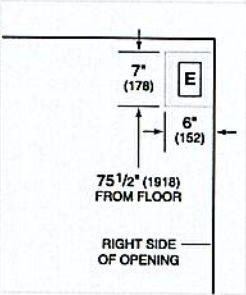

PLUMBING

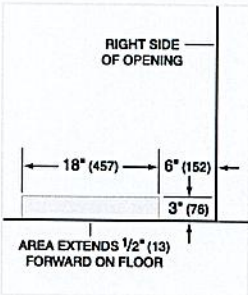

PANEL SPECIFICATIONS For complete panels specifications including width/height, weight requirements, thickness requirements and offset details visit [subzero-wolf.com/builtinconfigurator](http://subzero-wolf.com/builtinconfigurator).

NOTE: Dimensions in parenthesis are in millimeters unless otherwise specified

INTERIOR VIEW

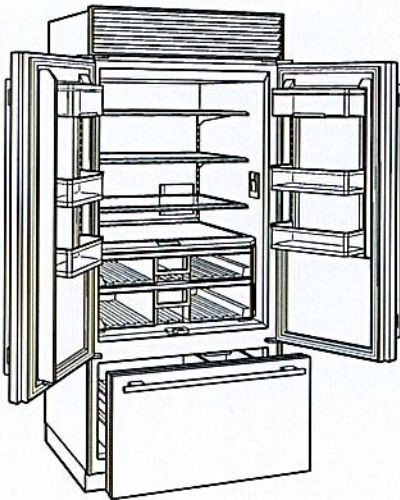

This illustration is intended for interior reference only and may not represent the exterior of the model being specified.

DIMENSIONS

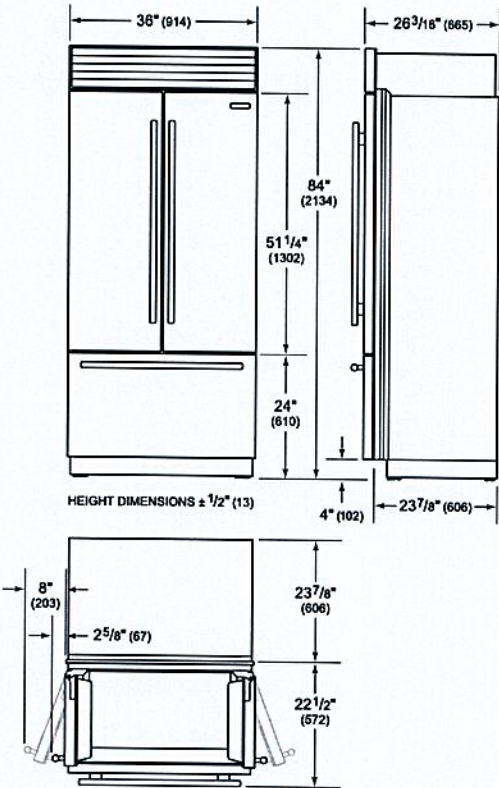

FLUSH INSET INSTALLATION

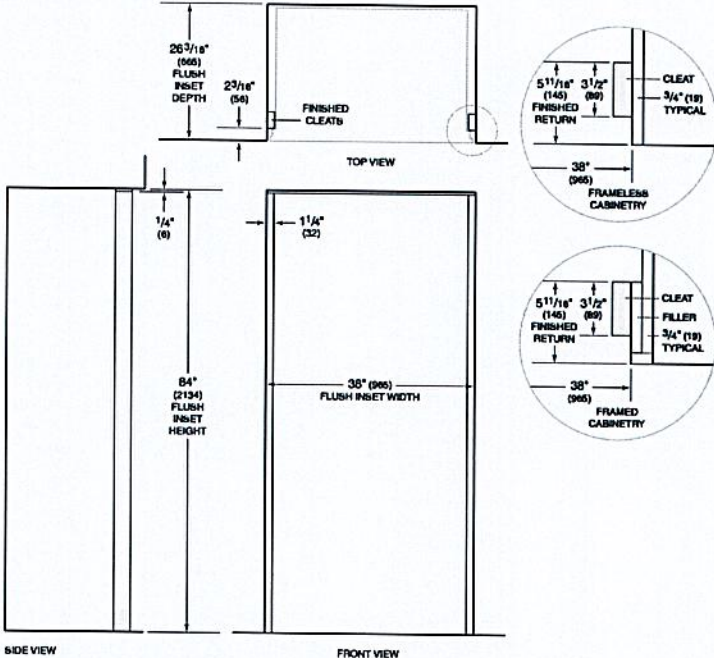

NOTE: 3/16" (5mm) finished returns and shaded areas will be visible and should be finished to match cabinetry. Shaded line represents profile of unit with 3/4" (19mm) panel.



Specifications Summary

Single Model: CL3650UFDID/O

MODEL	OVERALL DIMENSIONS	WEIGHT	FLUSH INSET OPENING DIMENSIONS
<b>CL3650UFDID/O</b> - <a href="#">Model Detail</a>  <b>CAD Libraries:</b> <a href="#">3D Studio Max (3DS)</a> <a href="#">3D Studio Max (MAX)</a> <a href="#">2D AutoCad (DWG)</a> <a href="#">Wavefront 3D (OBJ)</a> <a href="#">3D AutoCad (DWG)</a> <a href="#">Revit Files (RFA)</a> <a href="#">SketchUp (SKP)</a> <a href="#">ArchiCad (GSM)</a> <a href="#">AutoCad (DXF)</a>  <b>User Guides:</b> <a href="#">QR SHEET</a> <a href="#">Subzero Design Guide</a>	36" <b>W</b> 84" <b>H</b> 24" <b>D</b>	573 lbs	38" <b>W</b> 84" <b>H</b> 26 3/16" <b>D</b>

Front View

Single Model: CL3650UFDID/O

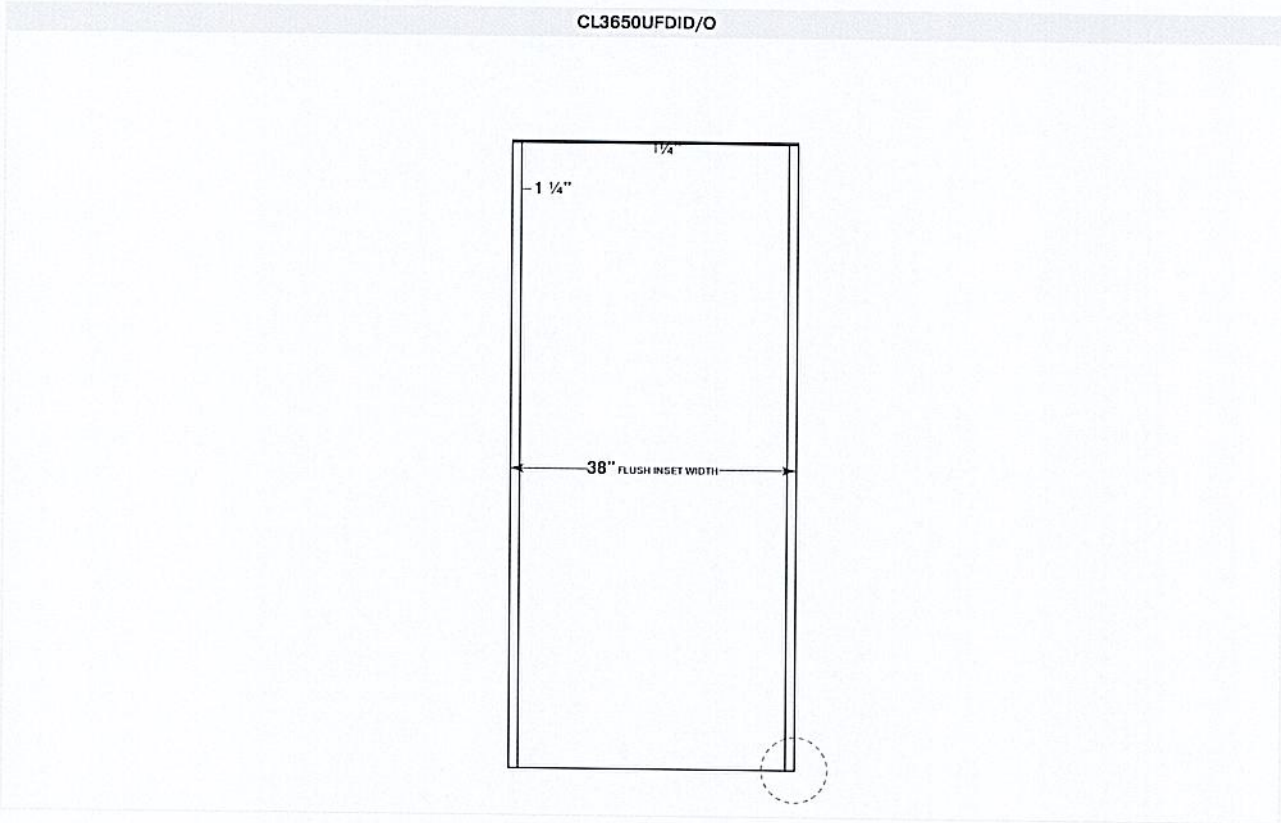



Top View

Single Model: CL3650UFDID/O

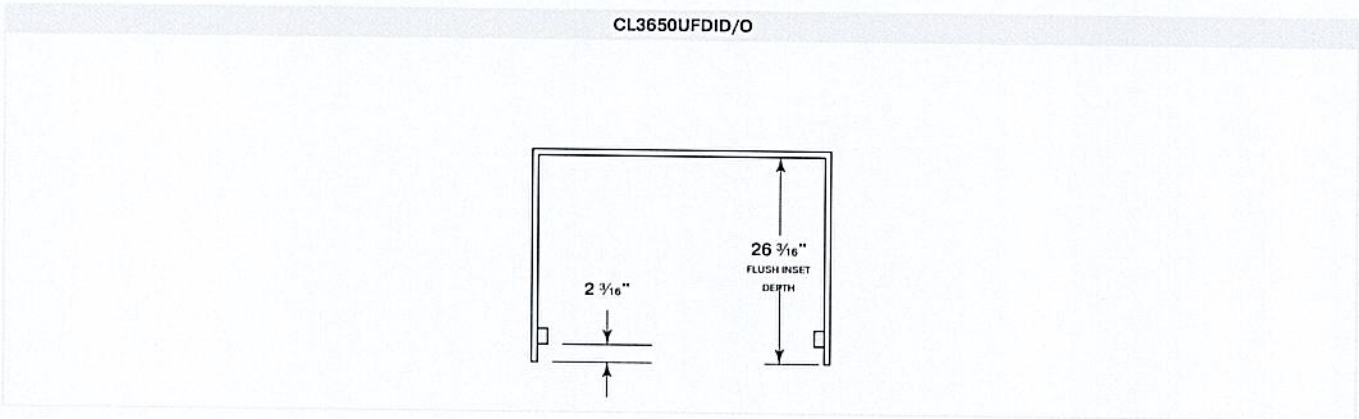

Top View Detail

Single Model: CL3650UFDID/O

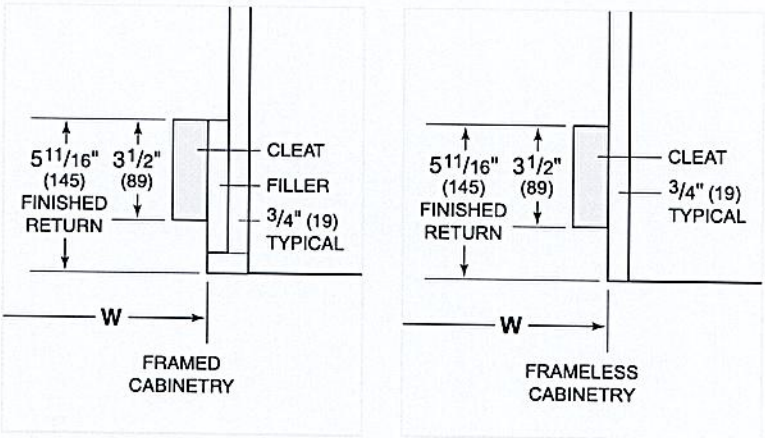

Shaded areas will be visible and should be finished to match cabinetry.



Side View

Single Model: CL3650UFDID/O

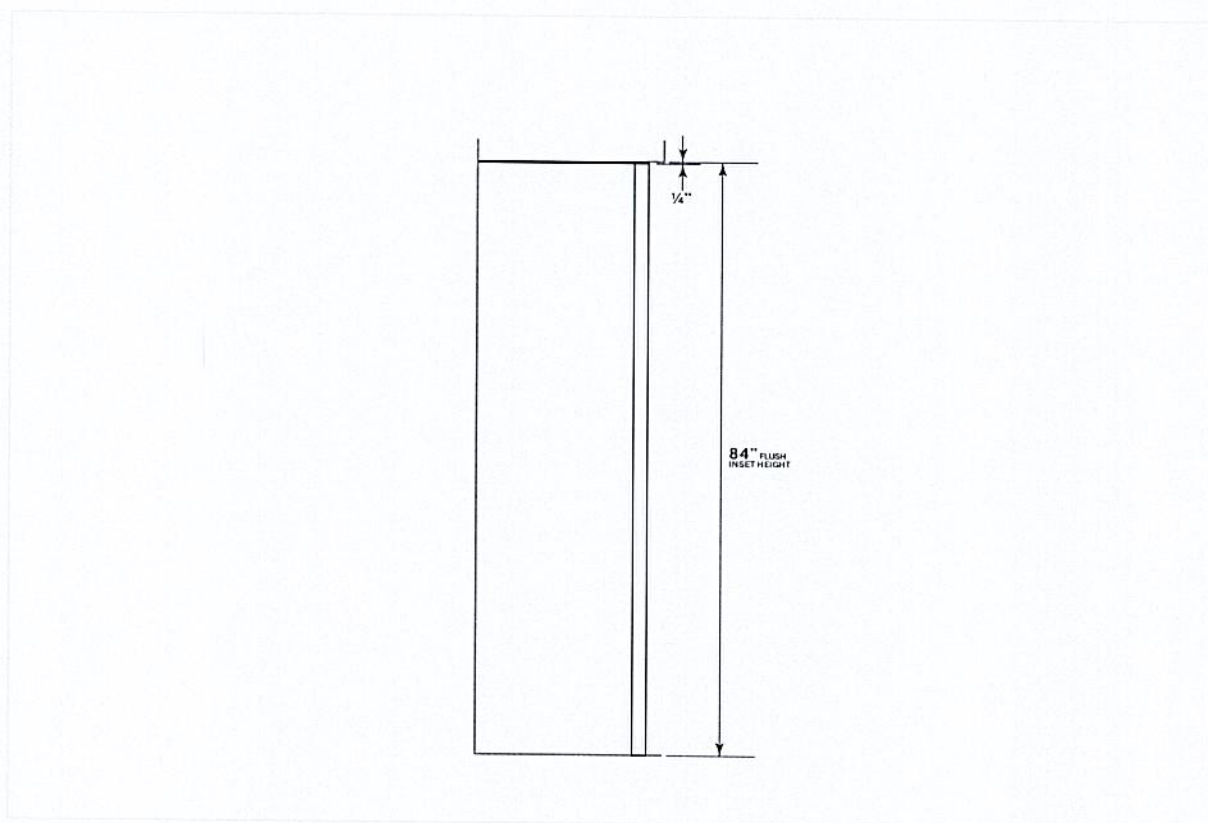



Panel Specifications

Single Model: CL3650UFDID/O

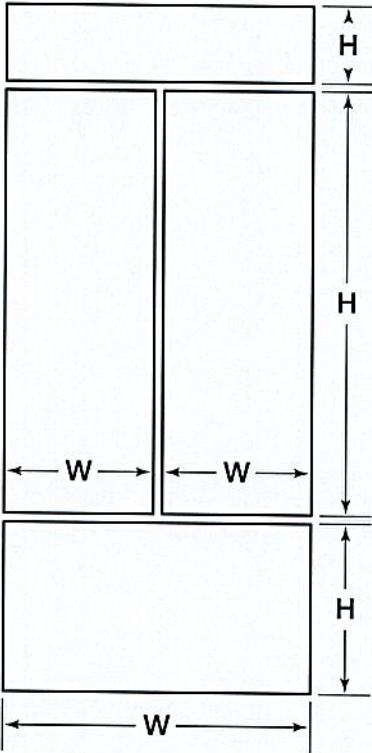

PANEL	FRONT	SPACER	BACKER	MAX WEIGHT
Door (2)	18 3⁄8" <b>W</b> 50 5⁄8" <b>H</b>	17" <b>W</b> 49 13⁄16" <b>H</b>	17 5⁄8" <b>W</b> 50 7⁄16" <b>H</b>	50 lbs
Drawer	37" <b>W</b> 20" <b>H</b>	35 1⁄8" <b>W</b> 19 1⁄16" <b>H</b>	35 3⁄4" <b>W</b> 19 11⁄16" <b>H</b>	50 lbs
Grille	37" <b>W</b> 7 3⁄4" <b>H</b>	35 1⁄8" <b>W</b> 6 13⁄16" <b>H</b>	35 3⁄4" <b>W</b> 7 7⁄16" <b>H</b>	13 lbs



Panel Planning Notes

Single Model: CL3650UFDID/O

The flush inset application is an overlay model with flush inset panels. It is not a separate model.

The flush inset design allows custom panels to be installed flush with adjacent cabinets. Similar to overlay, flush inset panels are typically created by combining a 3/4" (19) custom panel, a .10" (3) spacer panel and a 1/4" (6) backer panel.

For flush inset panels thicker than 3/4" (19), a 90° door stop may be required to prevent interference with adjacent cabinets.

Minimum Panel Thickness

3/4"

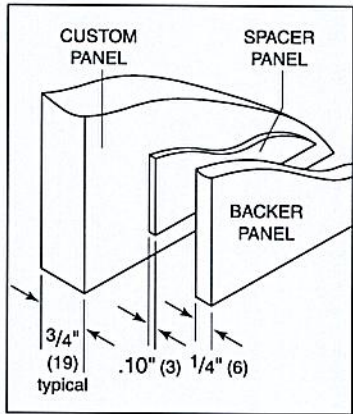

Panel assembly (rear view).

Standard Handle Lengths (Optional)

HANDLE	TUBULAR	PRO
CL3650UFDID/O Door	40 1/8"	36 1/16"
CL3650UFDID/O Drawer	31"	30"



Panel Offsets

Single Model: CL3650UFDID/O

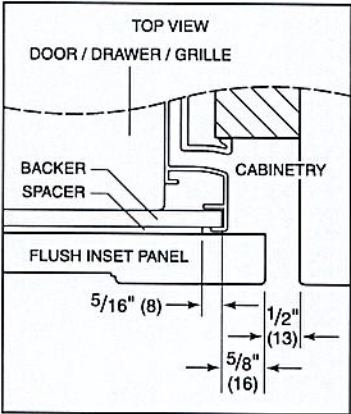

Door (hinge) / Drawer / Grille Sides

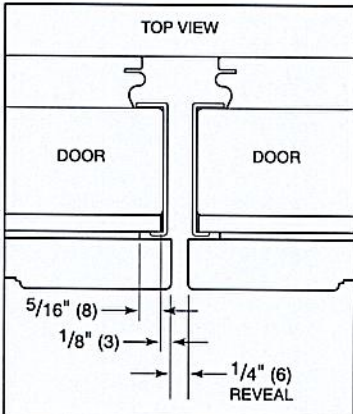

Doors (handle) Sides

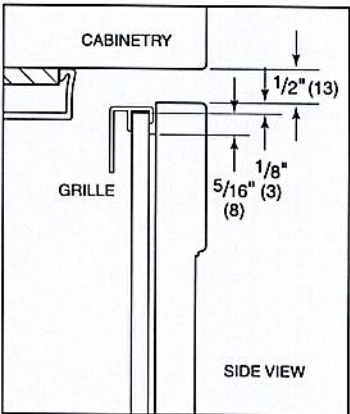

Grille Top

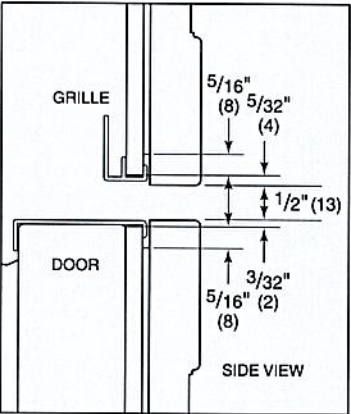

Grille Bottom / Door Top

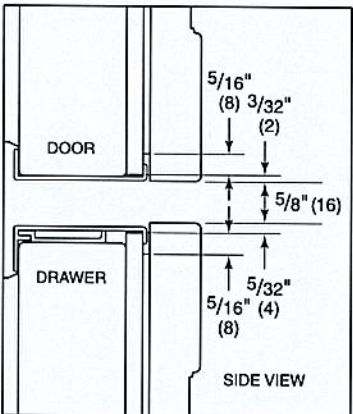

Door Bottom / Drawer Top

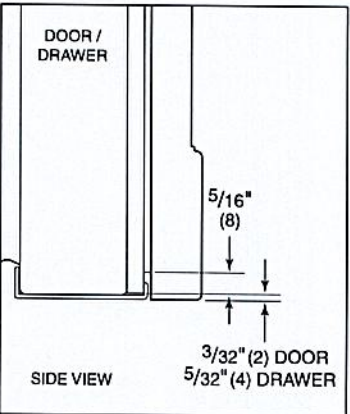

Door/Drawer Bottom



Templates

Single Model: CL3650UFDID/O

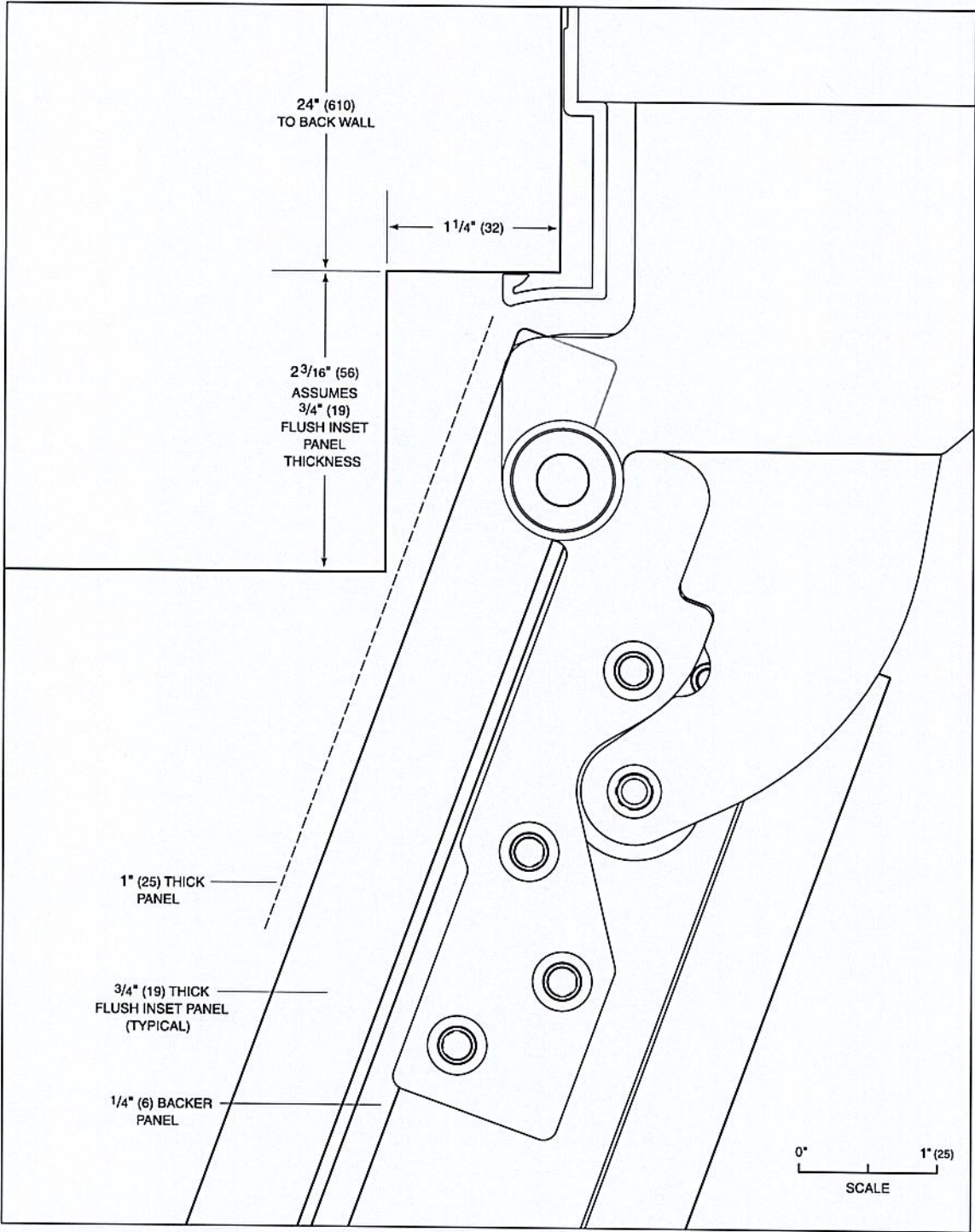

Flush inset application—110° door opening (top view).



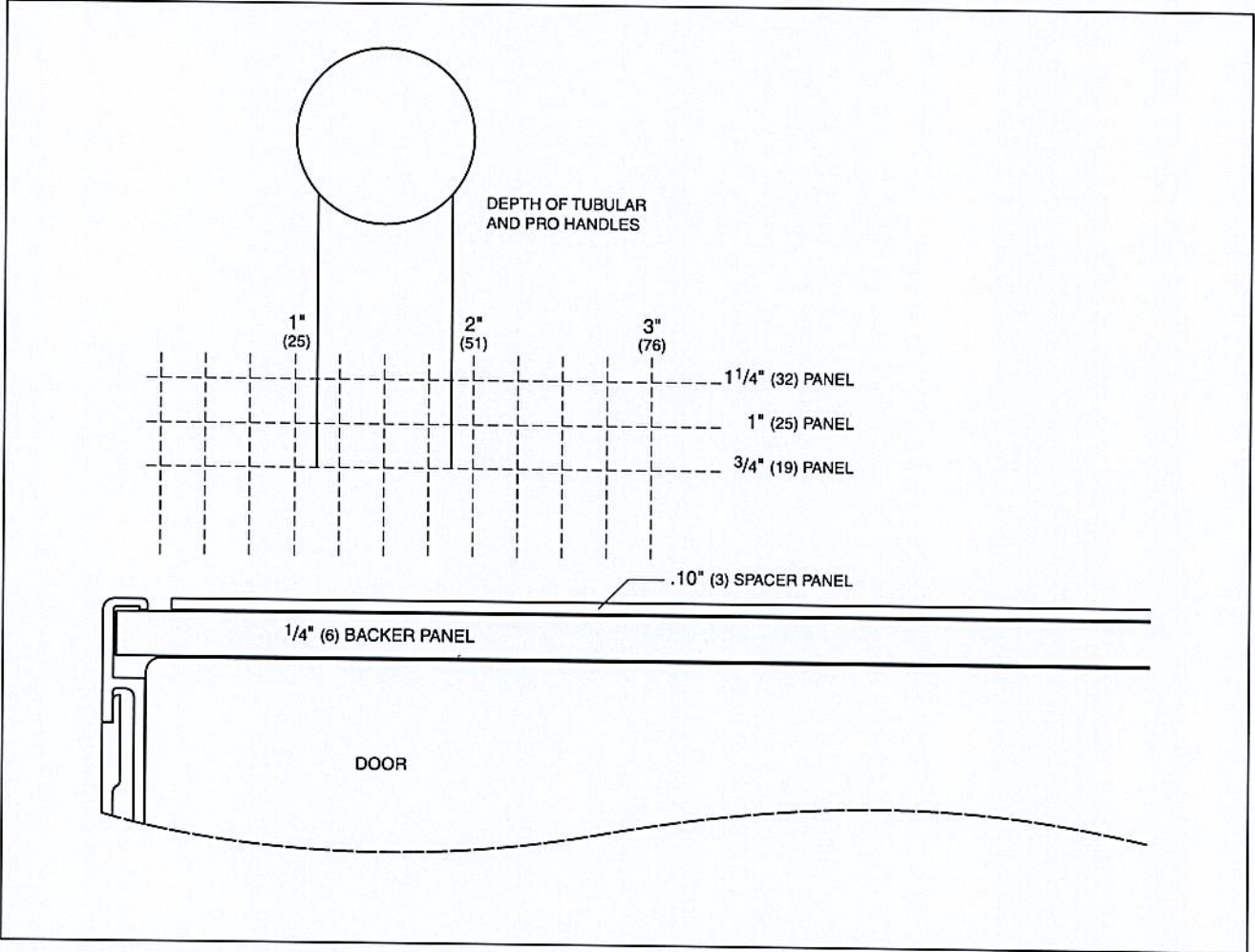

Overlay and flush inset panel thickness.



Overall Dimensions

Single Model: CL3650UFDID/O

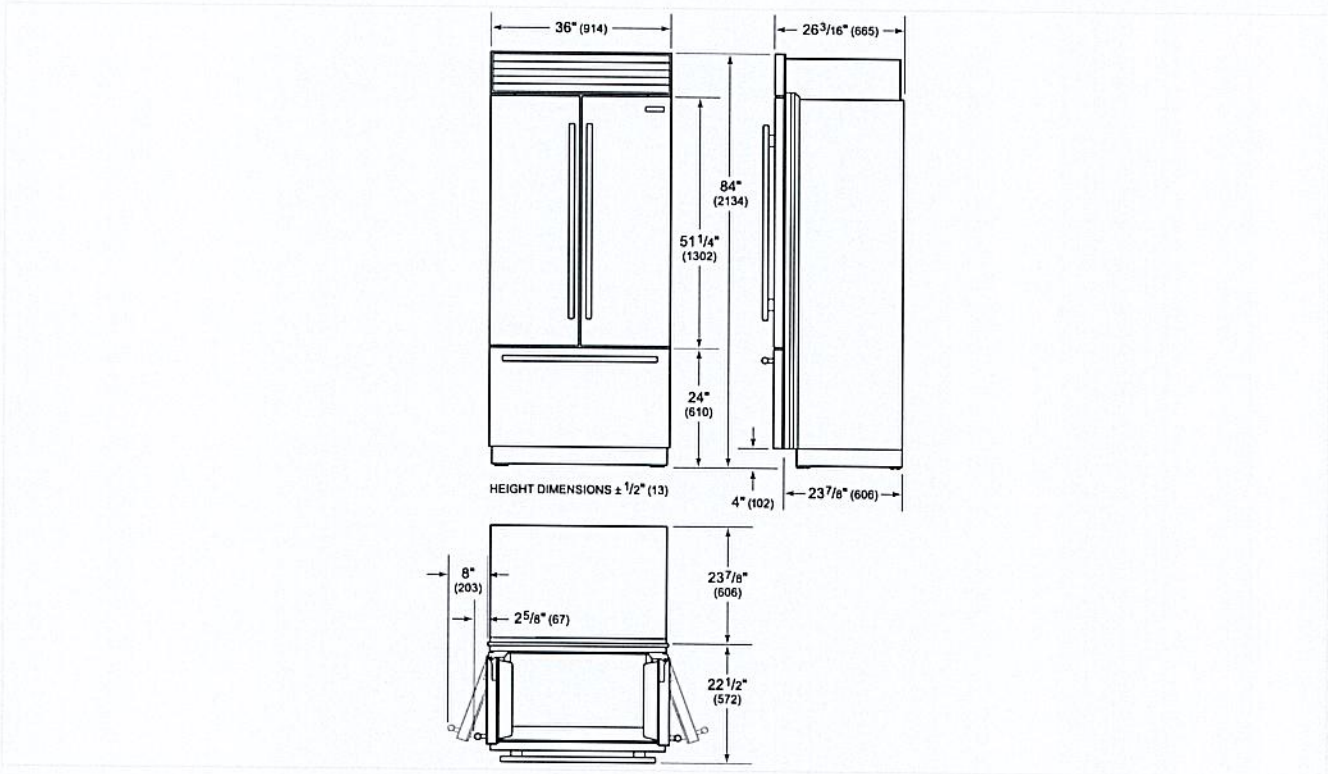

Electrical

Single Model: CL3650UFDID/O

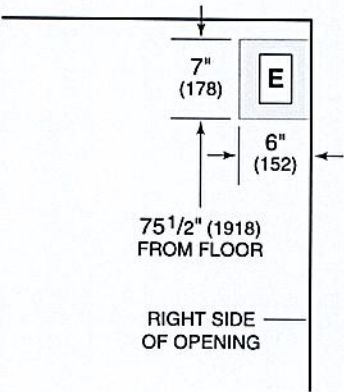

Electrical Supply	grounded, 115 VAC, 60 Hz
Electrical Service	15 amp dedicated circuit
Receptacle	3-prong grounding-type

**WARNING**

Installation must comply with all applicable electrical codes.

A separate circuit, servicing only this appliance is required. A ground fault circuit interrupter (GFCI) is not recommended and may cause interruption of operation. Installation must comply with all applicable electrical codes.



Plumbing

Single Model: CL3650UFDID/O

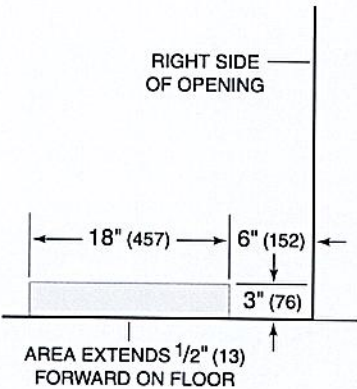

Water Supply	1/4" OD copper, braided stainless steel or PEX tubing
Pressure	35–120 psi
Excess Line For Connection	36"

The water supply line should be connected to the house supply with an easily accessible shut-off valve. Do not use self-piercing valves. The water supply line must not interfere with installation of the anti-tip brackets. A reverse osmosis system can be used provided there is constant water pressure of 35–120 psi (2.4–8.3 bar) supplied to the unit at all times. A copper line is not recommended for this application. Installation must comply with all applicable plumbing codes.



30" DUAL FUEL RANGE - 4 BURNERS



DF30450/S/P



FEATURES

Make a statement with your choice of door colors and finishes for your Wolf Dual Fuel Range—classic stainless or new powder-coated black or white

Patented dual-stacked, sealed burners offer precise temperature adjustment

Wolf's Dual VertiFlow™ convection system provides reliably even heat, reduces hot and cold spots, and enables consistent multi-rack cooking

Gourmet Mode features nearly 50 presets that automatically control the oven to ensure delicious results

Take the guesswork out of cooking with 10 chef-created cooking modes, including Bake, Broil, Convection, Convection Roast, Dehydrate, Gourmet, Proof, Roast, Stone, and Warm

Burners produce up to 20,000 Btu for fast boils and intense sears and as low as 300 Btu for true simmers and melts

For improved temperature control and safety, the spark ignition system reignites burners automatically

The full-color touchscreen is intuitive and easy to read, discreetly hiding away when not in use

LED backlit control bezels illuminate when in use, indicating which burners are active

The oven offers self-clean, delayed start, timed cook, and Sabbath features

The temperature probe alerts you when your dish has reached the desired temperature

Control your oven from wherever you are using our convenient Owner's App—remotely preheat, adjust temperatures, select modes, and more

ACCESSORIES

2-Burner Wok Grate

30" Broiler Pan and Rack

30" Dehydration Rack Set

30" Dual Fuel Brushed Brass Bezel Kit

30" Full-Extension Ball-Bearing Oven Rack

30" Multifunction Pan

30" Premier Baking Sheet

30" Standard Oven Rack

Bake Stone Kit

Filler Trim (2-pc)

Temperature Probe

Red, black, brushed stainless, brushed brass, and brushed gray knob kits

Rear Caster Covers

Front Leg Extension Covers

Stainless Steel Kickplates

5" and 10" stainless steel risers, and 20" riser with shelf



KNOB OPTIONS



TOP CONFIGURATION

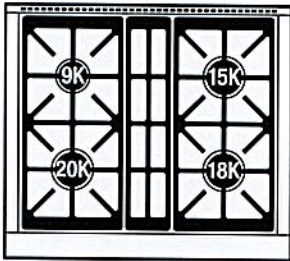

RANGETOP SPECIFICATIONS

- 1 - 9,200 Btu burner
- 1 - 15,000 Btu burner
- 1 - 18,000 Btu burner
- 1 - 20,000 Btu burner
- Stainless-steel island trim



30" DUAL FUEL RANGE - 4 BURNERS



PRODUCT SPECIFICATIONS

Model	DF30450/S/P
Dimensions	29 7/8"W x 36 1/2"H x 29 1/2"D
Oven 1 Interior Dimensions	25 1/4"W x 17 1/2"H x 20"D
Oven 1 Usable Capacity	3.2 cu. ft.
Oven 1 Overall Capacity	5.1 cu. ft.
Door Clearance	21"
Weight	413 lbs
Electrical Supply	240/208 VAC, 60 Hz
Electrical Service	30 amp dedicated circuit
Gas Supply	3/4" ID line
Gas Inlet	1/2" NPT female

DIMENSIONS

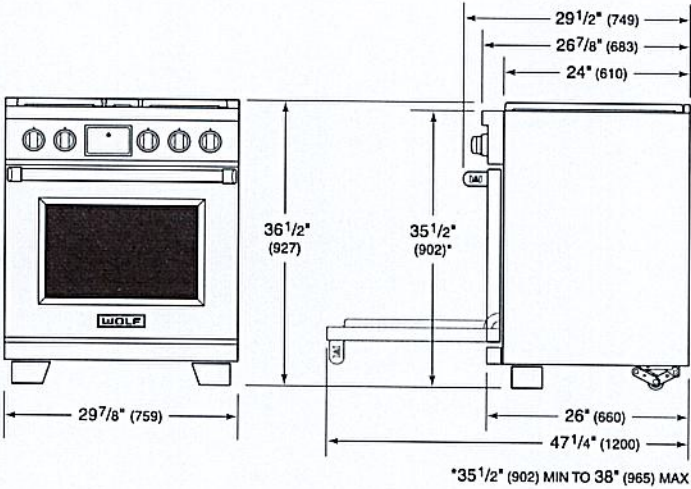

ELECTRICAL

GAS

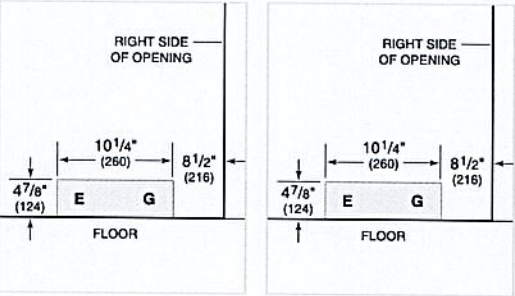

NOTE: Dimensions in parenthesis are in millimeters unless otherwise specified

STANDARD INSTALLATION

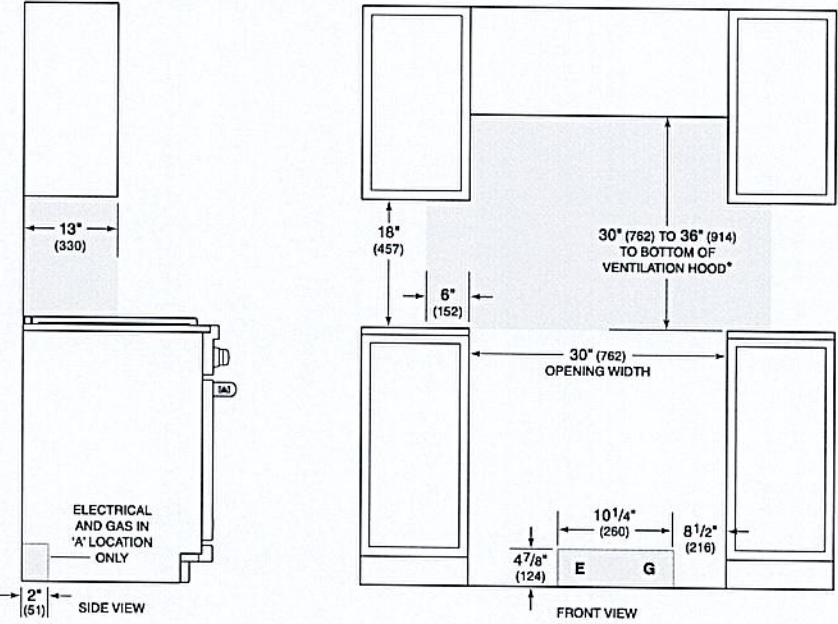

*\*Without ventilation hood, 36\" (914) minimum clearance countertop to combustible materials, 44\" (1118) for charbroiler.*  
*NOTE: Shaded area above countertop indicates minimum clearance to combustible surfaces, combustible materials cannot be located within this area.*  
*For island installation, 12\" (305) minimum clearance back of range to combustible rear wall above countertop.*



SU5430X  
~~SU5436X~~  
~~SU5442X~~  
~~SU5448X~~

SU 54  
stainless steel AISI 430

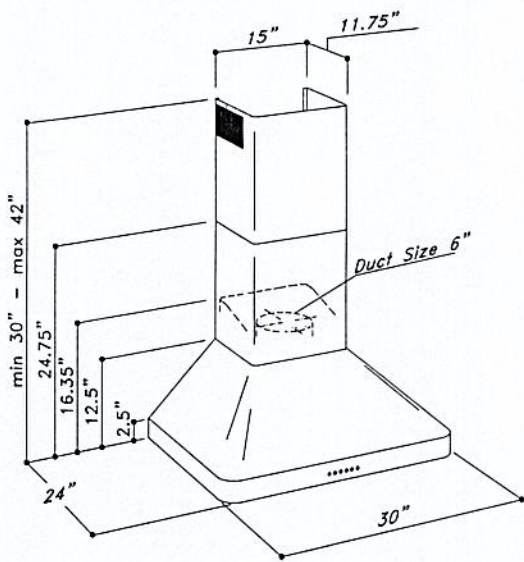
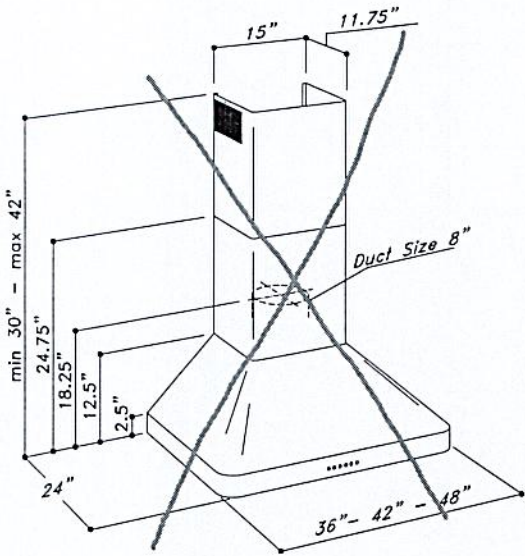

MOTOR

Dual motor: EBM 1100 CFM for SU54 36"42"48" version  
One motor: EBM 600 cfm for SU54 30" version  
Pressure: 800 Pa  
Noise level: 66 dBA/5.1 sones

LIGHTING

Led spot 2x2,1W in 30" version  
~~Led spot 2x2,1W in 36" version~~  
~~Led spot 3x2,1W in 42" version~~  
~~Led spot 4x2,1W in 48" version~~

CONTROL PANEL

4 speed push-button + delay off timer + light switch

GREASE FILTER

Commercial style baffle filters

AIR OUTLET

~~8" round for SU54 36"42"48"~~  
6" round for SU54 30"

DISCHARGE

Vertical

ACCESSORIES

Charcoal filters: KF2 (Order 1 pc for 30" version and 2 pcs for 48" version) Cod. 60071099999  
KF7 (Order 2 pcs for 36" and 42" version) Cod. 60080477002  
Air deviator: Def S51 75005100105  
Flue Extension: FLUEXSU54 cod. 20001154886



## G 7186 SCVi AutoDos

Fully-integrated, full-size dishwasher

with automatic dispensing thanks to AutoDos with integrated PowerDisk.

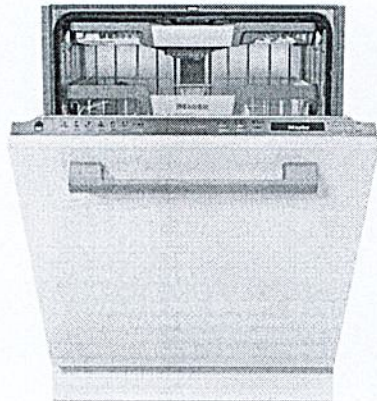

- Innovative design and maximum convenience – 3D MultiFlex Tray
- Communication with the machine could not be easier – Miele@home
- Perfect results in less than one hour – QuickIntenseWash
- Incredibly low sound emissions of just 42 dB(A)
- Very easy door opening and closing – ComfortClose

EAN: 4002516770954 / Material number: 12497350 / Article Number: 21718662CDN

Type	
Fully integrated dishwashers	•
60 cm dishwashers	•
Design	
Control panel colour	Stainless Steel
Control panel version	Fully integrated fascia
Control type	Program selector button
Display	1-line text display
Display colour	White
Language Options	•
Convenience	
Networking with Miele@home	•
Automatic dispensing with PowerDisk	•
Door closing aid	ComfortClose
Operating noise dB(A) re 1 pW	42
Time left display	•
Delay start up to 24 h	•
In-operation indicator light	optical and acoustic
Display language selection	•
Efficiency and sustainability	
EcoPower technology	•
Proven hygiene	•
Hot-water connection	•
Half load	•
ENERGY STAR® Most Efficient	•
Quality of results	
Fresh-water dishwasher	•
AutoOpen drying	•
SensorDry	•
Recirculation turbothermic drying	•
PerfectGlassCare	•
Wash programs	
Intensive 75°C	•
QuickIntenseWash	•
Sanitize	•
Clean Machine	•
Rinse & Hold	•
Cleaning options	
AutoDos	•
IntenseZone	•
Extra clean	•
Extra dry	•
Basket design	
Cutlery loading	3D MultiFlex tray
FlexCare glass holder	2
FlexCare cup rack	2
Basket design	ExtraComfort
MultiClip	•
Safety	
Waterproof system	•

more information you can find here:  
<http://www.miele.ca/en/>





G 7186 SCVi AutoDos  
Fully-integrated, full-size dishwasher  
with automatic dispensing thanks to AutoDos with integrated PowerDisk.

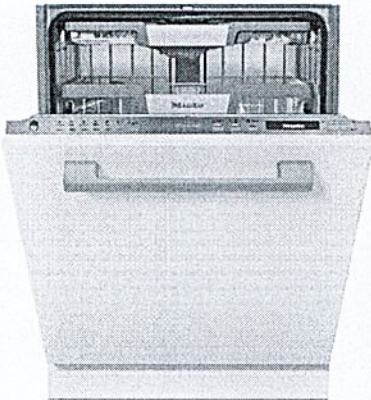

EAN: 4002516770954 / Material number: 12497350 / Article Number: 21718662CDN

Check filter indicator	•
Child lock	•
Technical data	
Minimum niche width in mm	23 5/8 (600)
Maximum niche width in mm	23 5/8 (600)
Minimum niche height in mm	33 3/4 (855)
Maximum niche height in mm	36 1/4 (920)
Niche depth in mm	21 3/4 (550)
Appliance width in mm	23 5/8 (598)
Appliance height in mm	33 3/4 (855)
Appliance depth in mm	21 3/4 (550)
Appliance depth with door open in cm	47 1/2 (120.5)
Net weight in kg	106 (48.0)
Total rated load in kW	1.40
Voltage in V	120
Fuse rating in A	15
Number of phases	1
Electrical frequency standard	60
Length of water inlet hose in cm	5 (1.50)
Length of water drain hose in cm	5 (1.50)
Length of power cable in m	4 (1.20)
Min. front panel weight in kg	4.0
Max. front panel weight in kg	12.0
Available display languages	
Available display languages via Language Options	
deutsch, english (US), español, français (CA).	
0113	
Accessories supplied	
1 x PowerDisk	



## G 7186 SCVi AutoDos

Fully-integrated, full-size dishwasher

with automatic dispensing thanks to AutoDos with integrated PowerDisk.

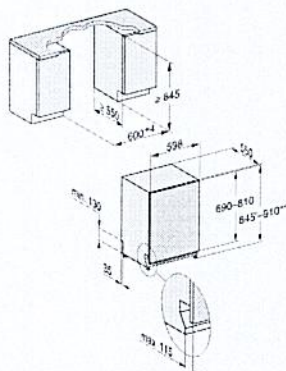

G7000, fully integrated dishwasher, 60cm (installation drawing)

1) Plinth height 35-155 mm, 2) Plinth height 100-220 mm,

3) Appliance height max. 970 mm with plinth height conversion kit (Mat.-Nr. 6.394.761).