

PURCHASER: Rong ZHUANG		CONSTRUCTION SUMMARY Legacy Hill - Trinigroup Development Inc.		RECEIVED FEB 24 2025		TEL:	
LOT / PHASE 79 / 1		REG. PLAN # 65M-4818		HOUSE TYPE Villa 6 Elev 3			

CERAMIC TILE

1 - DELETE ALL CERAMIC BATHROOM ACCESSORIES - DELETE TOWEL BAR, PAPER HOLDER & SOAP DISH THROUGHOUT 18Feb25    Note:	
1 - TILE - UPGRADE 4 FLOOR TILE - LAUNDRY ROOM 18Feb25    Note:	
1 - TILE - UPGRADE 4 FLOOR TILE - BEDROOM 3/4 SHARED ENSUITE FLOOR 18Feb25    Note:	
1 - TILE - UPGRADE 4 FLOOR TILE - BEDROOM 2 ENSUITE FLOOR 18Feb25    Note:	
1 - TILE - UPGRADE 4 FLOOR TILE - MASTER ENSUITE FLOOR 18Feb25    Note:	
1 - TILE - UPGRADE 4 FLOOR TILE - GARAGE ENTRANCE/MUD ROOM 18Feb25    Note:	
1 - TILE - UPGRADE 4 FLOOR TILE - POWDER ROOM 18Feb25    Note:	
1 - TILE - UPGRADE 4 FLOOR TILE - KITCHEN/BREAKFAST AREA 18Feb25    Note:	
1 - TILE - UPGRADE 4 FLOOR TILE - FOYER 18Feb25    Note:	

CONSTRUCTION

3 - ENLARGED BASEMENT WINDOWS (MAY REQUIRE WINDOW WELLS) - WINDOW IS 30 INCHES X 24 INCHES 13Oct23    Note:	
1 - FIRST FLOOR INCREASE CEILING HEIGHT FROM 9 FEET TO 10 FEET 13Oct23    Note:	
1 - LOWER LEVEL - BASEMENT 8 FOOT 6 INCH CONCRETE POUR - MEASURED FROM TOP OF FOOTING TO TOP OF FOUNDATION WALL 13Oct23    Note:	

ELECTRICAL

1 - PLUG - ELECTRICAL PLUG - TO BE INSTALLED OVER FIREPLACE 29May24    Note: SEE SKETCH	
1 - LIGHT AND SWITCH - NO FIXTURE INCLUDED - LIVING ROOM 29May24    Note: SEE SKETCH	
1 - RELOCATE STANDARD KITCHEN LIGHT TO BE CENTERED OVER ISLAND 29May24    Note: SEE SKETCH	
7 - POT LIGHT - EXTERIOR - SOFFIT MOUNT - REGULAR VOLTAGE 29May24    Note: SEE SKETCH	
1 - PLUG - ELECTRICAL PLUG WITH GFI AND SWITCH - FOR FESTIVE LIGHTING 29May24    Note: @COVERED PORCH - IF CONSTRUCTION PERMITS	



CONSTRUCTION SUMMARY				
Legacy Hill - Trinigroup Development Inc.				
PURCHASER: Rong ZHUANG				TEL:

LOT / PHASE	REG. PLAN #	HOUSE TYPE		
79 / 1	65M-4818	Villa 6 Elev 3		

FIREPLACE AND ACCESSORIES

1 - GAS LINE ROUGH-IN FOR STOVE (INCLUDES ELECTRICAL OUTLET) - FIRST FLOOR	
29May24 Note:	

HARDWOOD FLOORING

1 - LAMINATE – UPGRADE TO AVENUE SERIES IN LIEU OF STANDARD LAMINATE	
18Feb25 Note:	
1 - HARDWOOD - GROUP C SERIES 6 1/2 INCH - IN LIEU OF 3 1/4 INCH NATURAL RED OAK - FIRST FLOOR HARDWOOD AREAS INCLUDING STAIR LANDINGS	
18Feb25 Note:	

HEATING AND AIR CONDITIONING

1 - HUMIDIFER (MANUAL)	
29May24 Note:	

PLUMBING

1 - WATER LINE FOR FRIDGE - ROUGH-IN ONLY	
29May24 Note:	

PROMOTIONAL

1 - LESS CREDIT FROM PURCHASER EXTRA SHEET IN OFFER	
13Oct23 Note:	

STAIRS AND RAILINGS

1 - STAINED STAIRS - STANDARD STAIRCASE - INCLUDES EXTRA STEP	
18Feb25 Note:	

EXTRAS AS PER OFFER

The Vendor agrees that notwithstanding any other term or provision in this Agreement included in the Purchase Price and in addition to those items detailed in Schedule GP to the Agreement of Purchase and Sale, the Purchaser is entitled to a credit of Ten	
Worksheet Note:	

This Document is Extremely Time Sensitive - Printed 18 Feb 25 at 12:35



Purchaser: Rong ZHUANG

Property: 79

Telephone Res. / Bus: /

Project: Trinigroup Development Inc.

Decor Advisor: Ida Viola

Model and Elevation: Villa 6 Elev 3

Lock Date: 18-Feb-25

18-Feb-25

Plan #: 65M-4818

1. Cabinetry

	Style and Colour	Hardware
Kitchen / Breakfast	DORAL W500 WHITE	467SA
Laundry Room	ELISSE	Standard
Powder Room	DORAL W500 WHITE	467SA
Master Ensuite Bathroom	DORAL W500 WHITE	467SA
Ensuite Bath - Bedroom 2	DORAL W500 WHITE	467SA
Ensuite Bath - Bedroom 3/4	DORAL W500 WHITE	467SA
Stove Opening	STANDARD	NOTE: If not specified, opening will be set to builder's standard opening of approximately 30" width
Fridge Opening	STANDARD	NOTE: If not specified, opening will be set to builder's standard opening of approximately 37" width x 74" height

\*\* Refer to Construction Summary

2. Counters

	Counter	Edge	Niche
Kitchen / Breakfast	GRANITE-NERO IMPALA	#370 EDGE	
Laundry Room	N/A		
Powder Room	LAMINATE-WHITE CARRARA 4924-38		
Master Ensuite Bathroom	LAMINATE-WHITE CARRARA 4924-38		
Ensuite Bath - Bedroom 2	LAMINATE-WHITE CARRARA 4924-38		
Ensuite Bath - Bedroom 3/4	LAMINATE-WHITE CARRARA 4924-38		
Kitchen Backsplash	N/A		

\*\* Refer to Construction Summary



Purchaser:Rong ZHUANG

Property: 79

Telephone Res. / Bus: /

Project: Trinigroup Development Inc.

Decor Advisor: Ida Viola

Model and Elevation: Villa 6 Elev 3

Lock Date: 18-Feb-25

18-Feb-25

Plan #: 65M-4818

3. Ceramic Flooring

At a 45

Entrance Vestibule	TILE-MAINSTONE SILVER POLISHED 24X24	<input type="checkbox"/>
Main Hall	HARDWOOD	<input type="checkbox"/>
Kitchen / Breakfast	TILE-MAINSTONE SILVER POLISHED 24X24	<input type="checkbox"/>
Laundry Room	TILE-SMOT WHITE LAPP 24X24	<input type="checkbox"/>
Powder Room	TILE-MAINSTONE SILVER POLISHED 24X24	<input type="checkbox"/>
Master Ensuite Bathroom	TILE-SMOT WHITE LAPP 24X24	<input type="checkbox"/>
Ensuite Bath - Bedroom 2	TILE-SMOT WHITE LAPP 24X24	<input type="checkbox"/>
Ensuite Bath - Bedroom 3/4	TILE-SMOT WHITE LAPP 24X24	<input type="checkbox"/>
Mud Room	TILE-MAINSTONE SILVER POLISHED 24X24	<input type="checkbox"/>
		<input type="checkbox"/>
		<input type="checkbox"/>

\*\* Refer to Construction Summary \*\* METAL STRIP THRESHOLD WHERE APPLICABLE UNLESS SPECIFIED \*\*

4. Ceramic Wall Tile

Master Ensuite Bathroom	Selection	Describe
Tub Deck Wall	N/A	
Shower Stall	TILE-EXTRA DARK GREY (724) 8X16	
Bathtub Enclosure Walls	N/A	
Ensuite Bath - Bedroom 2	TILE-EXTRA DARK GREY (724) 8X16	
Ensuite Bath - Bedroom 3/4	TILE-EXTRA DARK GREY (724) 8X16	
Mud Room	N/A	
Kitchen Backsplash	N/A	

\*\* Refer to Construction Summary - STANDARD GROUT THROUGHOUT UNLESS SPECIFIED

5. Trim Carpentry

Interior Doors	CARRARA-SMOOTH
Interior Trim	As Per Construction Specifications

\*\* Refer to Construction Summary

6. Plaster Mouldings and Medallions

Entrance Vestibule	N/A		Kitchen/Breakfast	N/A	
Main Hall	N/A		Den/Library	N/A	
Living Room	N/A		Lower Landing	N/A	
Dining Room	N/A				
Family Room	N/A				

\*\* Refer to Construction Summary



Purchaser:

Rong ZHUANG

Telephone Res. / Bus:

/

Decor Advisor:

Ida Viola

Lock Date:

18-Feb-25

Property: 79

Project: Trinigroup Development Inc.

Model and Elevation: Villa 6 Elev 3

Plan #: 65M-4818

18-Feb-25

7. Other Flooring

Main Hall	HARDWOOD - MIRAGE SNOWDRIFT WHITE OAK CHARACTER BRUSHED 6 1/2" DURAMATT
Living Room	HARDWOOD - MIRAGE SNOWDRIFT WHITE OAK CHARACTER BRUSHED 6 1/2" DURAMATT
Dining Room	HARDWOOD - MIRAGE SNOWDRIFT WHITE OAK CHARACTER BRUSHED 6 1/2" DURAMATT
Family Room	HARDWOOD - MIRAGE SNOWDRIFT WHITE OAK CHARACTER BRUSHED 6 1/2" DURAMATT
Den / Library / Study	HARDWOOD - MIRAGE SNOWDRIFT WHITE OAK CHARACTER BRUSHED 6 1/2" DURAMATT
Basement Landing(If Applies)	N/A
Lower Landing (If Applies)	N/A
Upper Landing	HARDWOOD - MIRAGE SNOWDRIFT WHITE OAK CHARACTER BRUSHED 6 1/2" DURAMATT
Upper Hall	LAMINATE-AVENUE LAUREL OAK TL AV233 PEFC
Master Bedroom	LAMINATE-AVENUE LAUREL OAK TL AV233 PEFC
Bedroom #2	LAMINATE-AVENUE LAUREL OAK TL AV233 PEFC
Bedroom #3	LAMINATE-AVENUE LAUREL OAK TL AV233 PEFC
Bedroom #4	LAMINATE-AVENUE LAUREL OAK TL AV233 PEFC
Bedroom #5	N/A
Flex Area	LAMINATE-AVENUE LAUREL OAK TL AV233 PEFC

Underpad

Standard ☐

Upgrade

\*\* Refer to Construction Summary

8. Railings and Pickets

Railing Type	AS PER CONSTRUCTION SPECIFICATIONS	Colour	MIRAGE SNOWDRIFT WHITE OAK
Picket Type	AS PER CONSTRUCTION SPECIFICATIONS	Colour	MIRAGE SNOWDRIFT WHITE OAK
Stringer / Riser	AS PER CONSTRUCTION SPECIFICATIONS	Colour	MIRAGE SNOWDRIFT WHITE OAK
Treads	AS PER CONSTRUCTION SPECIFICATIONS	Colour	MIRAGE SNOWDRIFT WHITE OAK

Red Oak Stairs as Per Vendor's Standard

\*\* Refer to Construction Summary THE STAIN COLOURS OR FINISH AVAILABLE ON RISERS, TREADS, PICKETS AND RAILS (STAIRCASES), WILL NOT BE AN EXACT MATCH TO PREFINISHED HARDWOOD OR LAMINATE FLOORS.

9. Wall Paint Flat Finish

Main & Upper Hall	22 WARM GREY	Master Bedroom	22 WARM GREY
Living Room	22 WARM GREY	Bedroom #2	22 WARM GREY
Dining Room	22 WARM GREY	Bedroom #3	22 WARM GREY
Kitchen / Breakfast	22 WARM GREY	Bedroom #4	22 WARM GREY
Family Room	22 WARM GREY	Bedroom #5	N/A
Powder Room	22 WARM GREY	Master Ensuite	22 WARM GREY
Laundry Room	22 WARM GREY	Ensuite Bath - Bedroom 2	22 WARM GREY
Den/Library	22 WARM GREY	Ensuite Bath - Bedroom 3/4	22 WARM GREY
Trim & Door Paint-Semi Gloss	BIRCH WHITE	Mud Room	22 WARM GREY
		Flex Area	22 WARM GREY

\*\* Refer to Construction Summary



Purchaser:

Rong ZHUANG

Telephone Res. / Bus:

/

Decor Advisor:

Ida Viola

Lock Date:

18-Feb-25

Property: 79

Project: Trinigroup Development Inc.

Model and Elevation: Villa 6 Elev 3

Plan #: 65M-4818

10. Fireplace

	Living Room			Family Room			Other Room - Specify		
	Purchased	As Per Plan	N/A	Purchased	As Per Plan	N/A	Purchased	As Per Plan	N/A
Fireplace Type	<input type="radio"/>	<input type="radio"/>	<input checked="" type="radio"/>	<input type="radio"/>	<input checked="" type="radio"/>	<input type="radio"/>	<input type="radio"/>	<input type="radio"/>	<input checked="" type="radio"/>
Mantle Type				As Per Construction Specifications					
Colour / Stain				MANTLE M1-STANDARD					
Surround				AS PER CONSTRUCTION SPECIFICATIONS					
Hearth				BIANCO					
				N/A					
** Refer to Construction Summary									

11. Air Conditioning

Air Conditioning

NO

Comment

\*\* Refer to Construction Summary

12. General Comments

\*\* Refer to Construction Summary

Disclaimers and Notes

1) Colours of all materials are as close as possible to builder's selection, but not necessarily identical due to variances in manufacturing.

2) Any extras listed above are null and void unless accompanied by a separate invoice/amendment. Said invoice must be paid in full.

3) The Purchaser agrees that this colour selection is final and that no changes will be permitted, unless required by the Vendor.

4) The Purchaser acknowledges reading and accepting document which contains other miscellaneous disclaimers.

5) In the event of a conflict between the Standard Features schedule of the Agreement of Purchase and Sale and the Interior Colour Scheme, the Interior Colour Scheme shall prevail.

Signature:

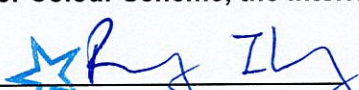

Date:

Feb 18, 2025



Lot 79 Legacy

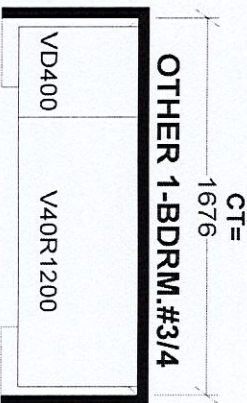
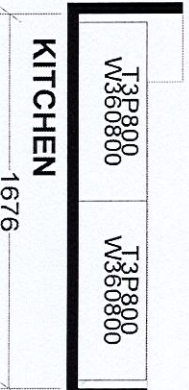
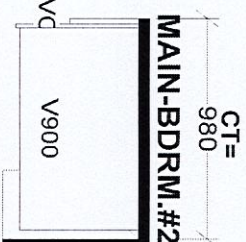
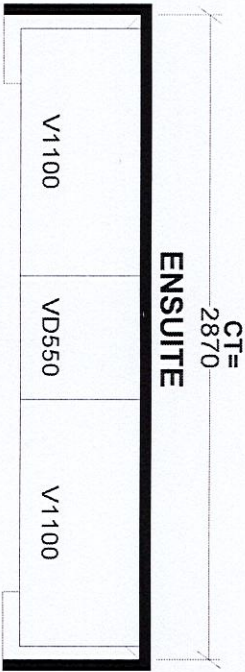
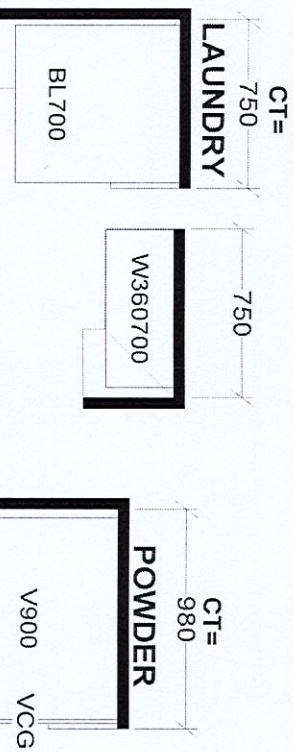
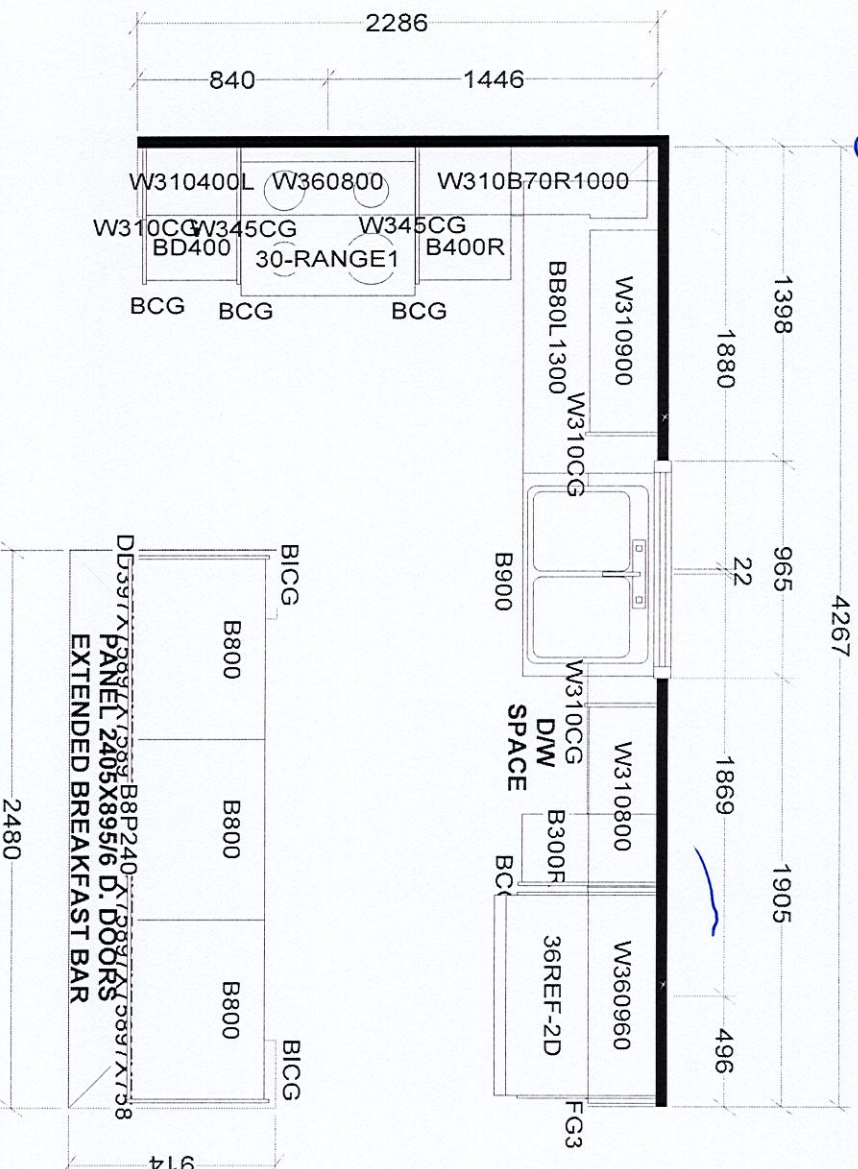

Selba Industries				J #
W WDT	W HGT	W CNT	This drawing is the intellectual property of JOB NUMBER:	
FLOOR HGHT			SEBELA INDUSTRIES INC., and is an original design which must not be released or copied unless applicable fee has been paid or job order placed.	
DOOR HGHT			BUILDER: GREENPARK HOMES	
ST CENT 2X4 VENT BOX COVER			SITE: TRINI GROUP, Richmond Hill	
DESIGNER: KS			MODEL: VILLA 6X EL 1,2,3	
DATE: OCT 19 23			LOT #:	



Villa 6 36' Lot

Elev. 1: 3,038 sq.ft. Elev. 2: 3,047 sq.ft. Elev. 3: 3,047 sq.ft.

LOT #79

