

**LOADING:**  
LIVE LOAD: 40.0 lb/ft<sup>2</sup>  
DEAD LOAD: 15.0 lb/ft<sup>2</sup>  
TILE LOAD: +5.0 lb/ft<sup>2</sup>  
JOIST LL DEFLECTION LIMIT: L/480  
**SUBFLOOR:** 3/4" GLUED AND NAILED

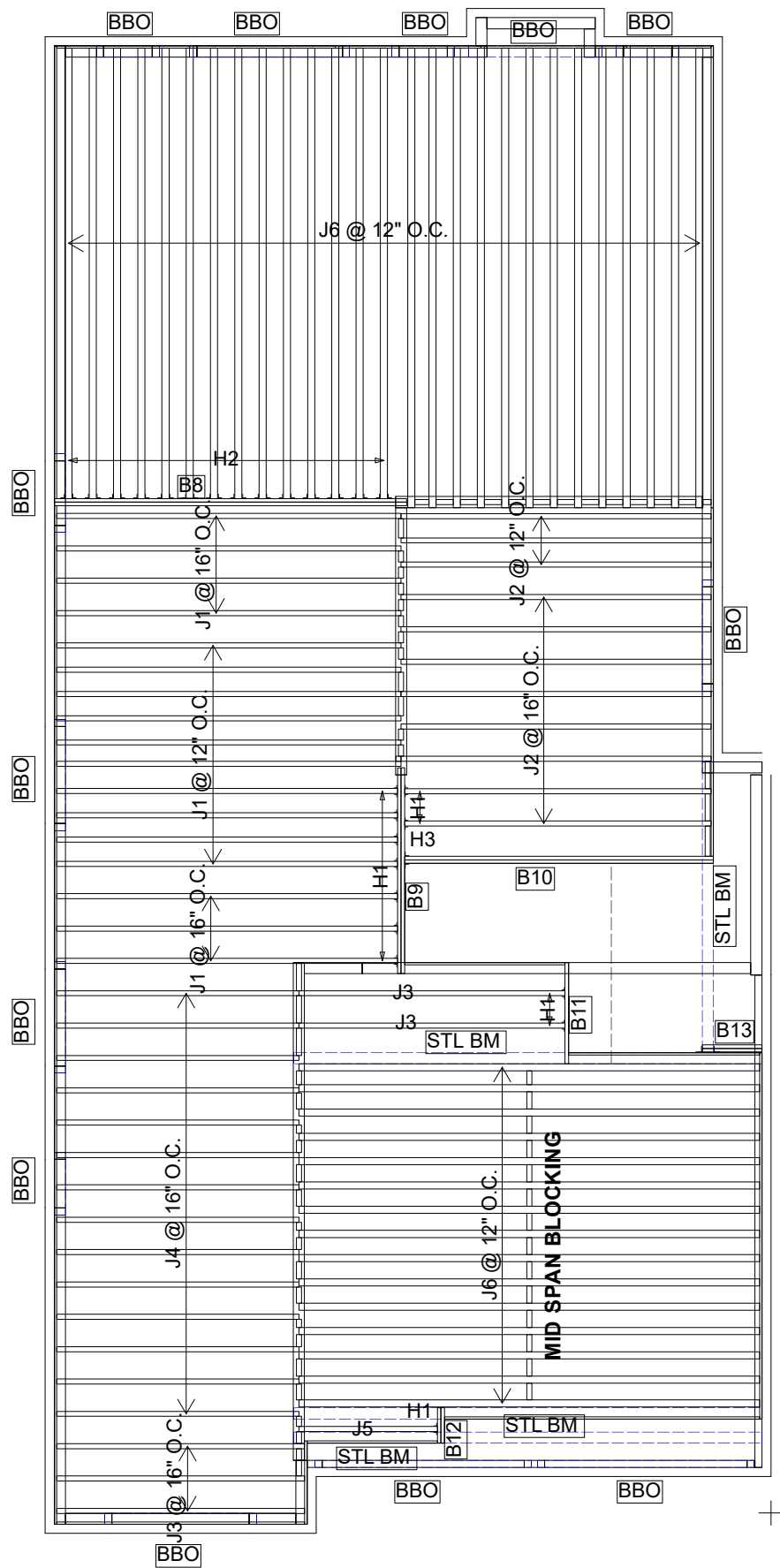



Products				
PlotID	Length	Product	Plies	Net Qty
J1	16-00-00	11 7/8" NI-40x	1	17
J2	14-00-00	11 7/8" NI-40x	1	11
J3	12-00-00	11 7/8" NI-40x	1	5
J4	10-00-00	11 7/8" NI-40x	1	14
J5	6-00-00	11 7/8" NI-40x	1	1
J6	20-00-00	11 7/8" NI-80	1	42
B8	16-00-00	1 3/4" x 11 7/8" (2.0E 3100) WestFraser LVL	2	2
B10	14-00-00	1 3/4" x 11 7/8" (2.0E 3100) WestFraser LVL	2	2
B9	10-00-00	1 3/4" x 11 7/8" (2.0E 3100) WestFraser LVL	2	2
B11	6-00-00	1 3/4" x 11 7/8" (2.0E 3100) WestFraser LVL	1	1
B13	4-00-00	1 3/4" x 11 7/8" (2.0E 3100) WestFraser LVL	2	2
B12	2-00-00	1 3/4" x 11 7/8" (2.0E 3100) WestFraser LVL	2	2

Connector Summary		
Qty	Manuf	Product
2	H1	IUS2.56/11.88
10	H1	IUS2.56/11.88
14	H2	IUS3.56/11.88
1	H3	HGUS410

DATE: 2023-09-12

2nd FLOOR FRAMING



FROM PLAN DATED: 2023-07-18  
BUILDER: GREEN PARK HOMES  
SITE: Trinigroup Developments Inc.  
MODEL: VILLA 6  
ELEVATION: 1  
LOT:  
CITY: RICHMOND HILL  
SALESMAN: Rick DiCiano  
DESIGNER: PL  
REVISION:

REFER TO THE **NORDIC INSTALLATION GUIDE** FOR PROPER STORAGE AND INSTALLATION.  
**SQUASH BLOCKS** OF 2x4, 2x6, 2x8 SPF #2 REQ'D UNDER INTERIOR UNIFORM LOAD BEARING WALLS.  
**MULTIPLE SQUASH BLOCKS** REQ'D UNDER CONCENTRATED LOADS. SEE FIGURE 1.  
**CANTILEVERED JOISTS** INCLUDING **CANT' OVER BRICK** REQ. I-JOIST BLOCKING ALONG BEARING AND RIMBOARD CLOSURE AT ENDS. SEE FIGURES 4/5 FOR REINFORCEMENT REQUIREMENTS.  
FOR **HOLES** INCLUDING **DUCT CHASE** AND **FIELD CUT OPENINGS** SEE FIGURE 6 AND TABLES 6.1/6.2.  
**CERAMIC TILE** APPLICATION AS PER OBC 9.30.6.

ALL **CONNECTORS** MUST BE INSTALLED AS PER THE **MANUFACTURER'S SPECIFICATIONS** USING THE MANUFACTURER **SPECIFIED FASTENERS**.  
ALL **BEAM HANGER FASTENERS** INSTALLED INTO THE **SUPPORTING MEMBER** **MUST** BE A MINIMUM OF **3.5"** IN LENGTH UNLESS OTHERWISE SPECIFIED BY THE SUPPORTING MEMBER ENGINEER OF RECORD.

**LOADING:**  
LIVE LOAD: 40.0 lb/ft<sup>2</sup>  
DEAD LOAD: 15.0 lb/ft<sup>2</sup>  
TILE LOAD: +5.0 lb/ft<sup>2</sup>  
JOIST LL DEFLECTION LIMIT: L/480  
SUBFLOOR: 5/8" GLUED AND NAILED

CITY OF RICHMOND HILL  
BUILDING DIVISION  
05/01/2024  
RECEIVED  
AND NAILED



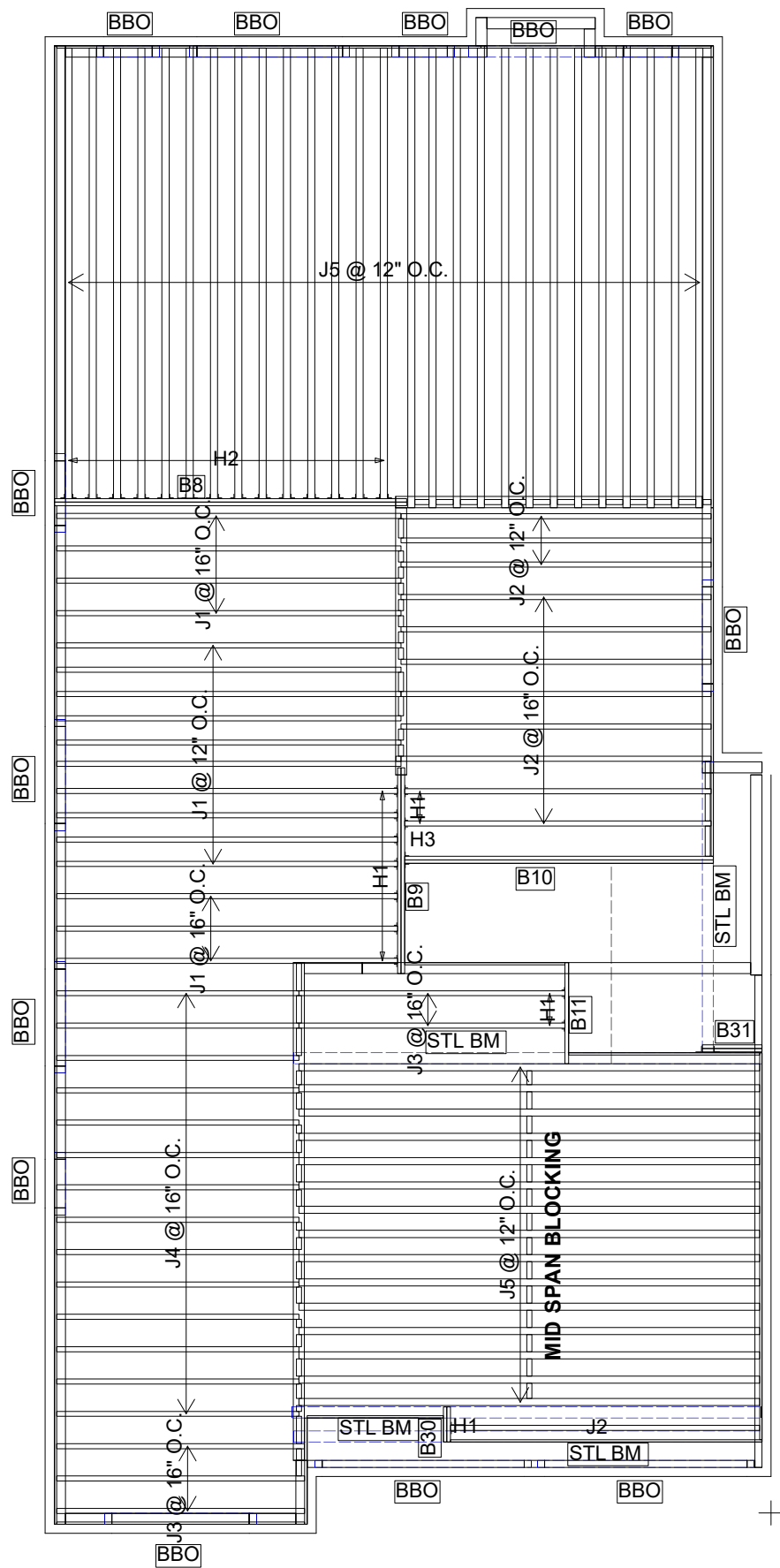

Products				
PlotID	Length	Product	Plies	Net Qty
J1	16-00-00	11 7/8" NI-40x	1	17
J2	14-00-00	11 7/8" NI-40x	1	12
J3	12-00-00	11 7/8" NI-40x	1	5
J4	10-00-00	11 7/8" NI-40x	1	14
J5	20-00-00	11 7/8" NI-80	1	42
B8	16-00-00	1 3/4" x 11 7/8" (2.0E 3100) WestFraser LVL	2	2
B10	14-00-00	1 3/4" x 11 7/8" (2.0E 3100) WestFraser LVL	2	2
B9	10-00-00	1 3/4" x 11 7/8" (2.0E 3100) WestFraser LVL	2	2
B11	6-00-00	1 3/4" x 11 7/8" (2.0E 3100) WestFraser LVL	1	1
B31	4-00-00	1 3/4" x 11 7/8" (2.0E 3100) WestFraser LVL	2	2
B30	2-00-00	1 3/4" x 11 7/8" (2.0E 3100) WestFraser LVL	2	2

Connector Summary		
Qty	Manuf	Product
2	H1	IUS2.56/11.88
10	H1	IUS2.56/11.88
14	H2	IUS3.56/11.88
1	H3	HGUS410

DATE: 2023-09-12

2nd FLOOR FRAMING



FROM PLAN DATED: 2023-07-18  
BUILDER: GREEN PARK HOMES  
SITE: Trinigroup Developments Inc.  
MODEL: VILLA 6  
ELEVATION: 2 & 3  
LOT:  
CITY: RICHMOND HILL  
SALESMAN: Rick DiCiano  
DESIGNER: PL  
REVISION:

REFER TO THE **NORDIC INSTALLATION GUIDE** FOR PROPER STORAGE AND INSTALLATION.  
**SQUASH BLOCKS** OF 2x4, 2x6, 2x8 SPF #2 REQ'D UNDER INTERIOR UNIFORM LOAD BEARING WALLS.  
**MULTIPLE SQUASH BLOCKS** REQ'D UNDER CONCENTRATED LOADS. SEE FIGURE 1.  
**CANTILEVERED JOISTS** INCLUDING **CANT' OVER BRICK** REQ. I-JOIST BLOCKING ALONG BEARING AND RIMBOARD CLOSURE AT ENDS. SEE FIGURES 4/5 FOR REINFORCEMENT REQUIREMENTS.  
FOR **HOLES** INCLUDING **DUCT CHASE** AND **FIELD CUT OPENINGS** SEE FIGURE 6 AND TABLES 6.1/6.2.  
**CERAMIC TILE** APPLICATION AS PER OBC 9.30.6.

ALL **CONNECTORS** MUST BE INSTALLED AS PER THE **MANUFACTURER'S SPECIFICATIONS** USING THE MANUFACTURER **SPECIFIED FASTENERS**.  
ALL **BEAM HANGER FASTENERS** INSTALLED INTO THE **SUPPORTING MEMBER** **MUST** BE A MINIMUM OF **3.5"** IN LENGTH UNLESS OTHERWISE SPECIFIED BY THE SUPPORTING MEMBER ENGINEER OF RECORD.

**LOADING:**  
LIVE LOAD: 40.0 lb/ft²  
DEAD LOAD: 15.0 lb/ft²  
TILE LOAD: +5.0 lb/ft²  
JOIST LL DEFLECTION LIMIT: L/480  
SUBFLOOR: 5/8" GLUED AND NAILED

CITY OF RICHMOND HILL  
BUILDING DIVISION  
05/01/2024  
RECEIVED  
AND N/A



# NORDIC

## INSTALLATION GUIDE NORDIC JOIST

NS-G133   
ENGLISH  
VERSION  
2020-10-01

Engineered Wood Products

## BASIC INSTALLATION GUIDE FOR RESIDENTIAL FLOORS



NORDIC  
STRUCTURES

nordic.ca

### INSTALLING NORDIC I-JOISTS

1. Installation of Nordic I-joists shall be as shown in details 1.
2. Except for cutting to length, I-joist flanges should never be cut, drilled or notched.
3. Install I-joists so that top and bottom flanges are within 1/2 inch of true vertical alignment.
4. Concentrated loads should only be applied to the top surface of the top flange. Concentrated loads should not be suspended from the bottom flange with the exception of light loads, such as ceiling fans or light fixtures.
5. I-joists must be protected from the weather prior to installation.
6. I-joists must not be used in applications where they will be permanently exposed to weather, or will reach a moisture content of 15 percent or greater, such as in swimming pool or hot tub areas. They must not be installed where they will remain in direct contact with concrete or masonry.
7. End bearing length must be at least 1-3/4 inch. For multiple-span joists, intermediate bearing length must be at least 3-1/2 inches.
8. Ends of floor joists shall be restrained to prevent rollover. Use rim board or I-joist blocking panels.
9. I-joists installed beneath bearing walls perpendicular to the joists shall have full-depth blocking panels, rim board, or squash blocks (cripple blocks) to transfer gravity loads from above the floor system to the wall or foundation below.
10. For I-joists installed directly beneath bearing walls parallel to the joists or used as rim board or blocking panels, the maximum vertical load using a single I-joist is 3,300 plf, and 6,000 plf if double I-joists are used.
11. Continuous lateral support of the I-joist's compression flange is required to prevent rotation and buckling. In simple span uses, lateral support of the top flange is normally supplied by the floor sheathing. In multiple-span or cantilever applications, bracing of the I-joist's bottom flange is also required at interior supports of multiple-span joists, and at the end support next to the cantilever extension. The ends of all cantilever extensions must be laterally braced as shown in details 3, 4, or 5.
12. Nails installed in flange face or edge shall be spaced in accordance with the applicable building code requirements or approved building plans, but should not be closer than those specified on page 3.3 of the Nordic Joist Technical Guide (NS-GT3).
13. Details 1 show only I-joist-specific fastener requirements. For other fastener requirements, see the applicable building code.
14. For proper temporary bracing of wood I-joists and placement of temporary construction loads, see **APA Technical Note: Temporary Construction Loads over I-Joist Roofs and Floors, Form J735**.

All nails shown in the details are assumed to be common nails unless otherwise noted. Nails shall have a diameter not less than 0.128 inch for 2-1/2-inch nails, or 0.144 inch for 3-inch nails. Individual components not shown to scale for clarity.

### SAFETY AND CONSTRUCTION PRECAUTIONS

I-joists are not stable until completely installed, and will not carry any load until fully braced and sheathed.

#### Avoid Accidents by Following these Important Guidelines:

1. Brace and nail each I-joist as it is installed, using hangers, blocking panels, rim board, and/or cross-briding at joist ends. When I-joists are applied continuous over interior supports and a load-bearing wall is planned at that location, blocking will be required at the interior support.
  2. When the building is completed, the floor sheathing will provide lateral support for the top flanges of the I-joists. Until this sheathing is applied, temporary bracing, often called struts, or temporary sheathing must be applied to prevent I-joist rollover or buckling.
    - Temporary bracing or struts must be 1x4 inch minimum, at least 8 feet long and spaced no more than 8 feet on centre, and must be secured with a minimum of two 2-1/2-inch nails fastened to the top surface of each I-joist. Nail the bracing to a lateral restraint at the end of each bay. Lap ends of adjoining bracing over at least two I-joists.
    - Or, sheathing (temporary or permanent) can be nailed to the top flange of the first 4 feet of I-joists at the end of the bay.
  3. For cantilevered I-joists, brace top and bottom flanges, and brace ends with closure panels, rim board, or cross-briding.
  4. Install and fully nail permanent sheathing to each I-joist before placing loads on the floor system. Then, stack building materials over beams or walls only.
  5. Never install a damaged I-joist.
- Improper storage or installation, failure to follow applicable building codes, failure to follow span ratings for Nordic I-joists, failure to follow allowable hole sizes and locations, or failure to use web stiffeners when required can result in serious accidents. Follow these installation guidelines carefully.



Do not walk on I-joists until fully fastened and braced, or serious injuries can result.



Never stack building materials over sheathed I-joists. Once sheathed, do not overstress I-joist with concentrated loads from building materials.

### NORDIC I-JOIST SERIES

### RESIDENTIAL SERIES

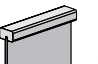
	<b>NI-20</b> <b>2x3</b> S-P-F No. 2 3/8 in. web Depths 9-1/2 and 11-7/8 in. 33 pieces per unit
---	---

	<b>NI-40x</b> <b>2x3</b> 1950F MSR 3/8 in. web Depths 9-1/2, 11-7/8 and 14 in. 33 pieces per unit
---	--

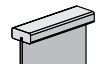
	<b>NI-60</b> <b>2x3</b> 2100F MSR 3/8 in. web Depths 9-1/2, 11-7/8, 14 and 16 in. 33 pieces per unit
---	---

	<b>NI-80</b> <b>2x4</b> 2100F MSR 3/8 in. web Depths 9-1/2, 11-7/8, 14 and 16 in. 23 pieces per unit
---	---

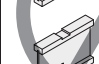
	<b>NI-90</b> <b>2x4</b> 2400F MSR 3/8 in. web Depths 11-7/8, 14 and 16 in. 23 pieces per unit
---	--

<b>RIM BOARDS</b>	<b>Width</b> 1-1/8 in.	<b>Length</b> 16 ft
	<b>Depths</b> 9-1/2 to 16 in.	APA Rim Board Plus

### WEB STIFFENERS

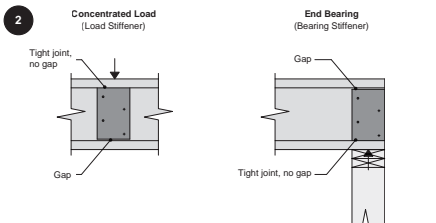

Stiffener Size Requirements	
Flange width (in.)	Web stiffener size each side of web (in.)
2-1/2	1 x 2-5/16 Minimum width
3-1/2	1-1/2 x 2-5/16 Minimum width

### NAIL SPACING

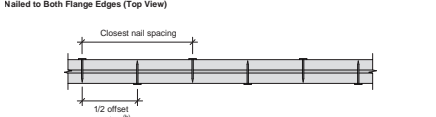
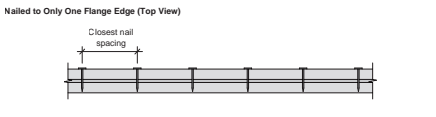
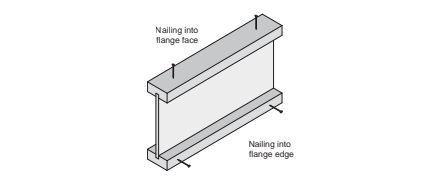

Recommended Closest Nail Spacing for Fastening Sheathing to I-Joist Flanges to Minimize Splitting	
Flange face nailing <sup>(a)</sup>	Flange edge nailing <sup>(a)</sup>
Fastener size (diameter x length)	Nail spacing (in.)
End distance (in.)	Nailed to both flange edges
0.128" or smaller in diameter, and 3-1/4" or shorter in length	2 2 2 2 4
Greater than 0.128" up to 0.148" in diameter, and 3-1/4" or shorter in length	2 3 2 3 6
<sup>(a)</sup> If more than one row is required, offset rows a minimum of 1/2 inch and stagger. <sup>(b)</sup> Closest nail spacing measured from one flange edge. Nails on opposite flange edge must be offset one-half the minimum spacing.	

- Notes:**
1. An occasional blocking panel (one per line of blocking) may be left out for the passage of plumbing or ventilation ducts. For other applications, contact Nordic Structures.
  2. For other options, see details 1g-1 to 1g-5.

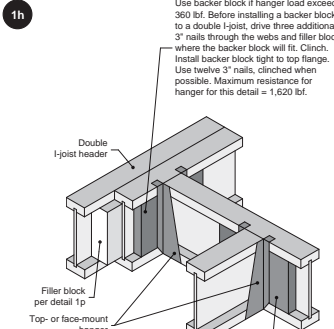

Flange width (in.)	Material thickness required (in.) <sup>(a)</sup>	Minimum depth (in.) <sup>(b)</sup>
2-1/2	1	5-1/2
3-1/2	1-1/2	7-1/4

<sup>(a)</sup> Minimum grade for backer block material shall be S-P-F No. 2 or better for solid sawn lumber and wood structural panels conforming to CAN/CSA-Q325 Standard.

<sup>(b)</sup> For face-mount hangers use net joist depth minus 3-1/4 inches for joists with 1-1/2-inch-thick flanges.

**Notes:**

1. Unless hanger sides laterally support the top flange, bearing stiffeners shall be used.
2. For hanger resistance, see manufacturer's recommendations.
3. Verify double I-joist resistance to support concentrated loads.
4. Backer blocks must be long enough to permit required nailing without splitting.

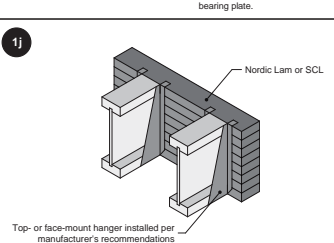
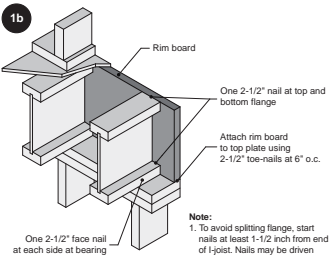

- Notes:**
1. Unless hanger sides laterally support the top flange, bearing stiffeners shall be used.
  2. For nailing schedules for multiple Nordic Lam or SCL beams, see the manufacturer's recommendations.

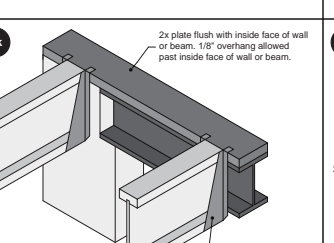
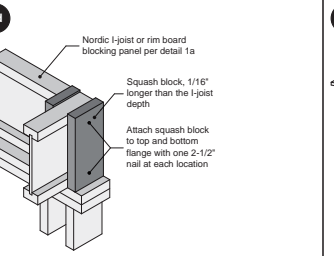
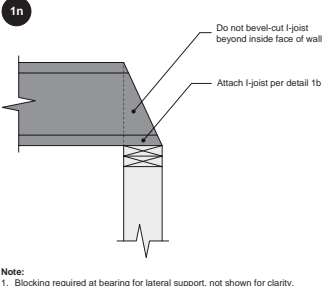
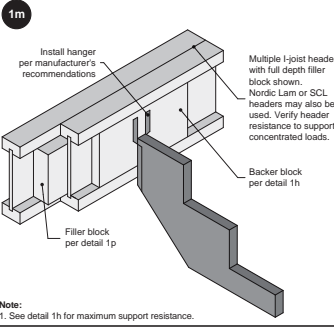

- Notes:**
1. Unless hanger sides laterally support the top flange, bearing stiffeners shall be used.

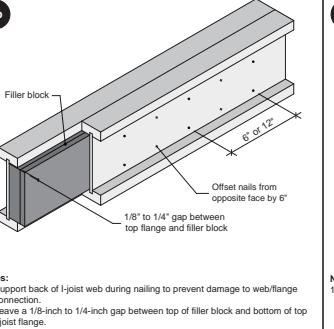

Filler Block Requirements for Double I-Joist Construction			
Flange width (in.)	Net depth (in.)	Filler block size (in.)	Example
2-1/2	9-1/2	2-1/8 to 2-1/4 x 6	2x6 x 5/8" or 3/4" sheathing
	11-7/8	2-1/8 to 2-1/4 x 8	2x8 x 5/8" or 3/4" sheathing
	14	2-1/8 to 2-1/4 x 10	2x10 x 5/8" or 3/4" sheathing
3-1/2	9-1/2	3 x 6	2 x 2x6
	11-7/8	3 x 8	2 x 2x8
	14	3 x 10	2 x 2x10

**Notes:**

1. The height of the filler block may be different from that specified in the table, as long as it allows nailing and respects the required gap.

### WEB HOLES AND OPENINGS

#### WEB HOLES IN I-JOISTS

##### Rules for Cutting Holes in I-Joists

1. The distance between the inside edge of the support and the centreline of any hole shall be in compliance with the requirements of Table 6.1.
2. I-joist top and bottom flanges must never be cut, notched or otherwise modified.
3. Whenever possible, field-cut holes should be centred on the middle of the web.
4. The maximum size hole that can be cut into an I-joist web shall equal the clear distance between the flanges of the I-joist minus 1/4 inch. A minimum of 1/8 inch should always be maintained between the top or bottom of the opening and the adjacent I-joist flange.
5. The sides of square holes or longest sides of rectangular holes should not exceed 3/4 of the diameter of the maximum round hole permitted at that location.
6. Where more than one hole is necessary, the distance between adjacent hole edges shall exceed twice the diameter of the largest round hole or twice the size of the square hole - or twice the length of the longest side of the longest rectangular hole - and each hole must be sized and located in compliance with the requirements of Table 6.1.
7. Holes measuring 1-1/2 inch or smaller shall be permitted anywhere in a cantilevered section of a joist. Holes of greater size may be permitted subject to verification.
8. A 1-1/2 inch hole or smaller can be placed anywhere in the web provided that it meets the requirements of rule number 6 above.
9. All holes shall be cut in accordance with the restrictions listed above and as illustrated in detail 6a.
10. Limit three maximum-size holes per span.
11. A group of round holes at approximately the same location shall be permitted if it meets the requirements for a single round hole circumscribed around them.

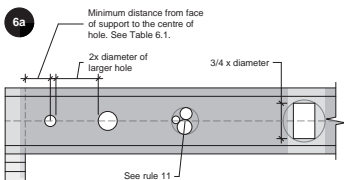

- Notes:**
1. Never drill, cut or notch the flange, or over-cut the web.
  2. Holes in web should be cut with a sharp saw.
  3. For rectangular holes, avoid over-cutting the corners, as this can cause unnecessary stress concentrations. Slightly rounding the corners is recommended. Starting the rectangular hole by drilling a 1-inch-diameter hole in each of the four corners and then making the cuts between the holes is another good method to minimize damage to the I-joist.

#### DUCT CHASE OPENINGS

##### Rules for Cutting Duct Chase Openings in I-Joists

1. The distance between the inside edge of the support and the centreline of a duct chase opening shall be in compliance with the requirements of Table 6.2.
2. I-joist top and bottom flanges must never be cut, notched or otherwise modified.
3. The maximum depth of a duct chase opening that can be cut into an I-joist web shall equal the clear distance between the flanges of the I-joist minus 1/4 inch. A minimum of 1/8 inch should always be maintained between the top or bottom of the opening and the adjacent I-joist flange.
4. All openings shall be cut in accordance with the restrictions listed above and as illustrated in detail 6b.
5. Limit one maximum-size duct chase opening per span.

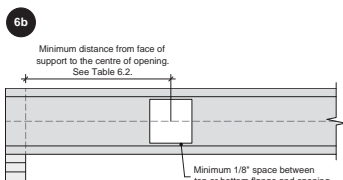

- Notes:**
1. Never drill, cut or notch the flange, or over-cut the web.
  2. Holes in web should be cut with a sharp saw.
  3. Avoid over-cutting the corners, as this can cause unnecessary stress concentrations. Slightly rounding the corners is recommended. Starting the rectangular hole by drilling a 1-inch-diameter hole in each of the four corners and then making the cuts between the holes is another good method to minimize damage to the I-joist.

#### HOLES IN BLOCKING PANELS

##### Maximum Allowable Hole Size in Lateral-restraint-only Blocking Panels

1. The maximum allowable hole size for a lateral-restraint-only blocking panel is 2/3 of the lesser dimension of the blocking's depth or length. Assuming the blocking panel is longer than its height (or depth), the table aside applies. For other applications, contact Nordic Structures.
2. Holes cut into the blocking panels are subject to the following limitations:
  - The top and bottom flanges of an I-joist blocking panel must never be cut, notched or otherwise modified.
  - Field-cut holes must be centred in the blocking horizontally.
  - While round holes are preferred, rectangle holes may be used provided the corners are not over cut. Slightly rounding corners or pre-drilling corners with a 1-inch-diameter bit is recommended.
3. All holes must be cut in a workman-like manner in accordance with the limitations listed above.

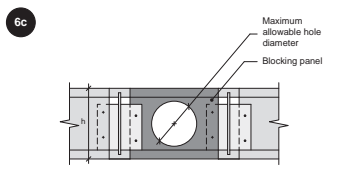

I-joist or rim board blocking depth (in.)	Maximum allowable hole diameter or (in.) <sup>(a)</sup>
9-1/2	6-1/4
11-7/8	7-3/4
14	9-3/4
16	10-1/2

<sup>(a)</sup> Maximum allowable hole diameter in blocking panel, where the blocking panel is longer than its height.

TABLE 6.1 - LOCATION OF WEB HOLES

Simple or multiple span		Minimum distance from inside face of any support to centre of hole (ft.-in.)															
Joist depth	Joist series	2	3	4	5	6	6-1/4	7	8	8-5/8	9	10	10-3/4	11	12	12-3/4	
9-1/2"	NI-20	0'-7"	1'-6"	2'-10"	4'-3"	5'-8"	6'-0"	-	-	-	-	-	-	-	-	-	-
	NI-40x	0'-7"	1'-6"	3'-0"	4'-4"	6'-0"	6'-4"	-	-	-	-	-	-	-	-	-	-
	NI-60	1'-3"	2'-6"	4'-0"	5'-4"	7'-0"	7'-5"	-	-	-	-	-	-	-	-	-	-
	NI-80	2'-3"	3'-6"	5'-0"	6'-6"	8'-2"	8'-8"	-	-	-	-	-	-	-	-	-	-
11-7/8"	NI-20	0'-7"	0'-8"	1'-0"	2'-4"	3'-8"	4'-0"	5'-0"	6'-8"	7'-9"	-	-	-	-	-	-	-
	NI-40x	0'-7"	0'-8"	1'-3"	2'-8"	4'-0"	4'-4"	5'-5"	7'-0"	8'-4"	-	-	-	-	-	-	-
	NI-60	0'-7"	1'-8"	3'-0"	4'-3"	5'-9"	6'-0"	7'-3"	8'-10"	10'-0"	-	-	-	-	-	-	-
	NI-80	1'-6"	2'-10"	4'-2"	5'-6"	7'-0"	7'-5"	8'-6"	10'-3"	11'-4"	-	-	-	-	-	-	-
14"	NI-20	0'-7"	0'-8"	1'-5"	3'-2"	4'-10"	5'-4"	6'-9"	8'-9"	10'-2"	-	-	-	-	-	-	-
	NI-40x	0'-7"	0'-8"	1'-0"	2'-4"	2'-9"	3'-9"	5'-2"	6'-0"	6'-6"	8'-3"	10'-2"	-	-	-	-	-
	NI-60	0'-7"	0'-8"	1'-8"	3'-0"	4'-3"	4'-8"	5'-8"	7'-2"	8'-0"	8'-8"	10'-4"	11'-9"	-	-	-	-
	NI-80	0'-10"	2'-0"	3'-4"	4'-9"	6'-2"	6'-5"	7'-6"	9'-0"	10'-0"	10'-8"	12'-4"	13'-9"	-	-	-	-
16"	NI-20	0'-7"	0'-8"	1'-0"	2'-5"	4'-0"	4'-5"	5'-9"	7'-5"	8'-8"	9'-4"	11'-4"	12'-11"	-	-	-	-
	NI-40x	0'-7"	0'-8"	1'-0"	2'-5"	4'-0"	4'-5"	5'-9"	7'-5"	8'-8"	9'-4"	11'-4"	12'-11"	-	-	-	-
	NI-60	0'-7"	0'-8"	1'-0"	2'-5"	4'-0"	4'-5"	5'-9"	7'-5"	8'-8"	9'-4"	11'-4"	12'-11"	-	-	-	-
	NI-80	0'-7"	0'-8"	1'-0"	2'-5"	4'-0"	4'-5"	5'-9"	7'-5"	8'-8"	9'-4"	11'-4"	12'-11"	-	-	-	-

- Notes:**
1. Tabulated values are applicable to residential floor construction meeting the above design criteria.
  2. The above table is based on the I-joists being used at their maximum spans. The minimum distance as given above may be reduced for shorter spans; contact your local distributor.

Design Criteria	
Joist spacing	Up to 24 inches
Loads	Live load = 40 psf and dead load = 15 psf
Deflection limits	L/480 under live load and L/240 under total load

TABLE 6.2 - LOCATION OF DUCT CHASE OPENINGS

Simple span		Minimum distance from inside face of any support to centre of opening (ft.-in.)															
Joist depth	Joist series	Duct chase length (in.)															
		8	10	12	14	16	18	20	22	24							
9-1/2"	NI-20	4'-1"	4'-5"	4'-10"	-	-	-	-	-	-	-	-	-	-	-	-	-
	NI-40x	5'-3"	5'-8"	6'-0"	6'-5"	6'-10"	7'-3"	7'-8"	-	-	-	-	-	-	-	-	-
	NI-60	5'-4"	5'-9"	6'-2"	6'-7"	7'-1"	7'-5"	8'-0"	-	-	-	-	-	-	-	-	-
	NI-80	5'-3"	5'-8"	6'-0"	6'-5"	6'-10"	7'-3"	7'-8"	8'-2"	8'-6"	-	-	-	-	-	-	-
11-7/8"	NI-20	5'-9"	6'-2"	6'-6"	-	-	-	-	-	-	-	-	-	-	-	-	-
	NI-40x	6'-8"	7'-2"	7'-6"	8'-1"	8'-6"	9'-1"	9'-6"	-	-	-	-	-	-	-	-	-
	NI-60	7'-3"	7'-8"	8'-0"	8'-6"	9'-0"	9'-3"	9'-9"	-	-	-	-	-	-	-	-	-
	NI-80	7'-2"	7'-7"	8'-0"	8'-5"	8'-10"	9'-3"	9'-8"	10'-2"	10'-8"	-	-	-	-	-	-	-
14"	NI-20	7'-6"	7'-11"	8'-4"	8'-9"	9'-2"	9'-7"	10'-1"	10'-7"	10'-11"	-	-	-	-	-	-	-
	NI-40x	8'-1"	8'-7"	9'-0"	9'-6"	10'-1"	10'-7"	11'-2"	-	-	-	-	-	-	-	-	-
	NI-60	8'-9"	9'-3"	9'-8"	10'-11"	10'-6"	11'-1"	11'-6"	-	-	-	-	-	-	-	-	-
	NI-80	9'-0"	9'-3"	9'-9"	10'-11"	10'-7"	11'-1"	11'-6"	12'-1"	12'-6"	-	-	-	-	-	-	-
16"	NI-20	9'-2"	9'-8"	10'-0"	10'-6"	10'-11"	11'-5"	11'-9"	12'-4"	12'-11"	-	-	-	-	-	-	-
	NI-40x	10'-3"	10'-8"	11'-2"	11'-6"	12'-1"	12'-6"	13'-2"	-	-	-	-	-	-	-	-	-
	NI-60	10'-4"	10'-9"	11'-3"	11'-9"	12'-1"	12'-7"	13'-1"	13'-8"	14'-4"	-	-	-	-	-	-	-
	NI-80	10'-0"	11'-2"	11'-8"	12'-0"	12'-6"	13'-0"	13'-6"	14'-2"	14'-10"	-	-	-	-	-	-	-





BUILDER: **GREEN PARK HOMES**  
SITE: **Trinigroup Developments Inc.**  
MODEL: **VILLA 6**  
CITY: **RICHMOND HILL**

Job Name: **VILLA 6**  
Level: **1ST FLOOR**  
Label: **B1 - i1036**  
Type: **Beam**

**1 Ply Member**  
**1 3/4" x 11 7/8" (2.0E 3100)**  
**WestFraser LVL**

Status:  
**Design Passed**

Illustration Not to Scale. Pitch: 0/12

Designed by Single Member Design Engine in MiTek® Structure Version  
8.6.3.353.Update16.11

Report Version: 2021.03.26 09/27/2023 08:17

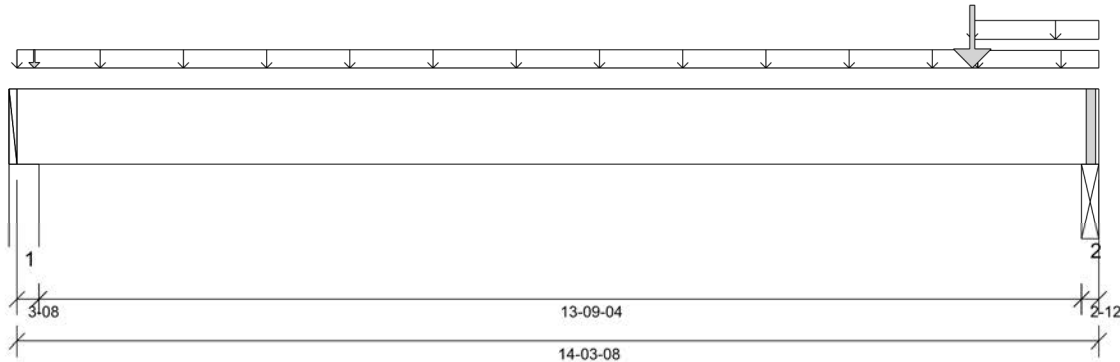

#### DESIGN INFORMATION

Building Code: NBCC 2015, Part9, BCBC 2018, ABC 2019, OBC 2012 (2019 Amendment)  
Design Methodology: LSD  
Service Condition: Dry  
LL Deflection Limit: L/360,  
TL Deflection Limit: L/240,

#### Lateral Restraint Requirements:

Both ends of the member and the outer supports must be laterally restrained. Top and bottom edges of the member must be fully restrained or have the following maximum unbraced length:

Top: 0' Bottom: 12'- 3 1/16"

#### Factored Resistance of Support Material:

- 615 psi Wall @ 0'- 2 1/2"
- 615 psi Beam @ 14'- 1 3/4"

#### ANALYSIS RESULTS

Design Criteria	Location	Load Combination	LDF	Design	Limit	Result
Factored Pos. Moment:	10'- 2 3/16"	1.25D + 1.5L	1.00	3953 lb ft	17672 lb ft	Passed - 22%
Factored Shear:	13'- 7/8"	1.25D + 1.5L	1.00	2397 lb	6908 lb	Passed - 35%
Live Load (LL) Pos. Defl.:	7'- 8 3/8"	L		0.128"	L/360	Passed - L/999
Total Load (TL) Pos. Defl.:	7'- 8 1/8"	D + L		0.206"	L/240	Passed - L/803

#### SUPPORT AND REACTION INFORMATION

ID	Input Bearing Length	Controlling Load Combination	LDF	Factored Downward Reaction	Factored Uplift Reaction	Factored Resistance of Member	Factored Resistance of Support	Result
1	3'-08"	1.25D + 1.5L	1.00	927 lb		6370 lb	3768 lb	Passed - 25%
2	2'-12"	1.25D + 1.5L	1.00	2557 lb		5005 lb	2960 lb	Passed - 86%

#### SPECIFIED LOADS

Type	Start Loc	End Loc	Source	Face	Dead (D)	Live (L)	Snow (S)	Wind (W)
Self Weight	0'	14'- 3 1/2"	Self Weight	Top	6 lb/ft	-	-	-
Uniform	0'	12'- 8 5/16"	FC1 Floor Decking (Plan View Fill)	Top	17 lb/ft	34 lb/ft	-	-
Uniform	12'- 7 7/16"	14'- 3 1/2"	User Load	Top	60 lb/ft	-	-	-
Uniform	12'- 8 5/16"	14'- 3 1/2"	FC1 Floor Decking (Plan View Fill)	Top	12 lb/ft	23 lb/ft	-	-
Point	12'- 7 7/16"	12'- 7 7/16"	B2(i1037)	Front	512 lb	1001 lb	-	-
Point	0'- 2 3/4"	0'- 2 3/4"	E35(i479)	Top	50 lb	37 lb	-	-

#### UNFACTORED REACTIONS

ID	Start Loc	End Loc	Source	Dead (D)	Live (L)	Snow (S)	Wind (W)
1	0'	0'- 3 1/2"	W22(i39)	273 lb	385 lb	-	-
2	14'- 3/4"	14'- 3 1/2"	STL BM (i45)	708 lb	1121 lb	-	-

#### DESIGN NOTES

- The dead loads used in the design of this member were applied to the structure as projected dead loads.
- Analysis and Design has been performed using precision loading from actual modeled conditions. Some loads may have been modified to simplify reporting.
- Tributary Loads have been generated based on actual spacing between members in the model which may differ from the default system spacing. The actual loads applied to the member are shown in the Specified Loads table.
- Transfer reactions may differ from design results as allowed per building codes and standard load distribution practices.
- This report is based on modeled conditions input by the user. Source information for the loads and supports are provided for reference only. Verify that all loads and support conditions are correct.
- Review all loads and reactions to ensure that the member/bearing/connector/structure can resist adequately. Unless already specified on this report, anchorage for uplift reactions to be specified by others. Installation of member and accessories (if required) as per manufacturer's instruction.
- Beam Stability Factor used in the calculation for Allowable Max Pos Moment (KL) = 1.00
- When the applied loads are coming from a member/post/wall above that does not sit directly on this beam, adequate load transfer elements, such as squash blocks, wall studs, or beveled plates are required to transfer the loads to this beam.



STRUCTURAL COMPONENT ONLY  
DWG # TF23091253

CITY OF RICHMOND HILL  
BUILDING DIVISION

05/01/2024

RECEIVED  
Per: joshua.nabua





BUILDER: **GREEN PARK HOMES**  
SITE: **Trinigroup Developments Inc.**  
MODEL: **VILLA 6**  
CITY: **RICHMOND HILL**

Job Name: **VILLA 6**  
Level: **1ST FLOOR**  
Label: **B2 - i1037**  
Type: **Beam**

**1 Ply Member**  
**1 3/4" x 11 7/8" (2.0E 3100)**  
**WestFraser LVL**

Status:  
**Design**  
**Passed**

Illustration Not to Scale. Pitch: 0/12

Designed by Single Member Design Engine in MiTek® Structure Version  
8.6.3.353.Update16.11

Report Version: 2021.03.26 09/27/2023 08:17

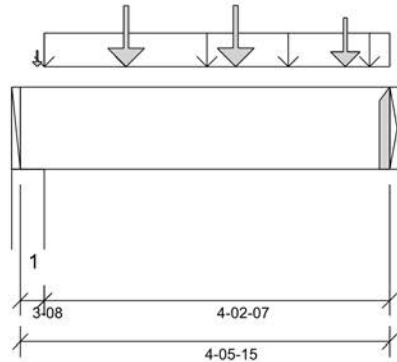

#### DESIGN INFORMATION

Building Code: NBCC 2015, Part9, BCBC 2018,  
ABC 2019, OBC 2012 (2019  
Amendment)

Design Methodology: LSD

Service Condition: Dry

LL Deflection Limit: L/360,

TL Deflection Limit: L/240,

#### Lateral Restraint Requirements:

Both ends of the member and the outer supports  
must be laterally restrained. Top and bottom edges  
of the member must be fully restrained or have the  
following maximum unbraced length:

Top: 0' Bottom: 1'- 1 1/2"

#### Factored Resistance of Support Material:

- 615 psi Wall @ 0'- 2 1/2"
- 615 psi Beam @ 4'- 5 15/16"

#### ANALYSIS RESULTS

Design Criteria	Location	Load Combination	LDF	Design	Limit	Result
Factored Pos. Moment:	2'- 7 7/16"	1.25D + 1.5L	1.00	2418 lb ft	17672 lb ft	Passed - 14%
Factored Shear:	1'- 3 3/8"	1.25D + 1.5L	1.00	1465 lb	6908 lb	Passed - 21%
Total Load (TL) Pos. Defl.:	2'- 4 1/4"	D + L		0.012"	L/240	Passed - L/999

#### SUPPORT AND REACTION INFORMATION

ID	Input Bearing Length	Controlling Load Combination	LDF	Factored Downward Reaction	Factored Uplift Reaction	Factored Resistance of Member	Factored Resistance of Support	Result
1	3-08	1.25D + 1.5L	1.00	1994 lb		6370 lb	3768 lb	Passed - 53%
2	1-08	1.25D + 1.5L	1.00	2147 lb		2730 lb	-	Passed - 79%

#### CONNECTOR INFORMATION

ID	Part No.	Manufacturer	Nailing Requirements			Other Information or Requirement for Reinforcement Accessories
			Top	Face	Member	
2	HUS1.81/10		-	-	-	Connector manually specified by the user.

\* Connectors: Refer to manufacturer's specifications, fasteners requirements and installation instruction. Where header fasteners are longer than the width of the supporting member, install backer block or clinch header nails.

#### SPECIFIED LOADS

Type	Start Loc	End Loc	Source	Face	Dead (D)	Live (L)	Snow (S)	Wind (W)
Self Weight	0'	4'- 5 15/16"	Self Weight	Top	6 lb/ft	-	-	-
Uniform	0'- 3 1/2"	4'- 5 15/16"	User Load	Top	120 lb/ft	240 lb/ft	-	-
Point	1'- 3 7/16"	1'- 3 7/16"	J2(i933)	Back	167 lb	335 lb	-	-
Point	2'- 7 7/16"	2'- 7 7/16"	J2(i932)	Back	168 lb	337 lb	-	-
Point	3'- 11 7/16"	3'- 11 7/16"	J2(i930)	Back	123 lb	246 lb	-	-
Point	0'- 2 7/16"	0'- 2 7/16"	11(i745)	Top	12 lb	-	-	-

#### UNFACTORED REACTIONS

ID	Start Loc	End Loc	Source	Dead (D)	Live (L)	Snow (S)	Wind (W)
1	0'	0'- 3 1/2"	W15(i23)	489 lb	926 lb	-	-
2	4'- 5 15/16"	4'- 5 15/16"	B1(i1036)	512 lb	1001 lb	-	-

#### DESIGN NOTES

- The dead loads used in the design of this member were applied to the structure as projected dead loads.
- Analysis and Design has been performed using precision loading from actual modeled conditions. Some loads may have been modified to simplify reporting.
- Tributary Loads have been generated based on actual spacing between members in the model which may differ from the default system spacing. The actual loads applied to the member are shown in the Specified Loads table.
- Transfer reactions may differ from design results as allowed per building codes and standard load distribution practices.
- This report is based on modeled conditions input by the user. Source information for the loads and supports are provided for reference only. Verify that all loads and support conditions are correct.
- Review all loads and reactions to ensure that the member/bearing/connector/structure can resist adequately. Unless already specified on this report, anchorage for uplift reactions to be specified by others. Installation of member and accessories (if required) as per manufacturer's instruction.
- Beam Stability Factor used in the calculation for Allowable Max Pos Moment (KL) = 1.00
- When the applied loads are coming from a member/post/wall above that does not sit directly on this beam, adequate load transfer elements, such as squash blocks, wall studs, or beveled plates are required to transfer the loads to this beam.
- Bearing length at support 1 was calculated based on the actual bearing area divided by the supported member width and may not match expected value when bearing is not rectangular or when the supported member is not supported by its full width.



STRUCTURAL COMPONENT ONLY  
DWG # TF23091254

CITY OF RICHMOND HILL  
BUILDING DIVISION  
05/01/2024  
RECEIVED  
Per: joshua.nabua





BUILDER: **GREEN PARK HOMES**  
SITE: **Trinigroup Developments Inc.**  
MODEL: **VILLA 6**  
CITY: **RICHMOND HILL**

Job Name: **VILLA 6**  
Level: **1ST FLOOR**  
Label: **B3 - i1132**  
Type: **Beam**

**2 Ply Member**  
**1 3/4" x 11 7/8" (2.0E 3100)**  
**WestFraser LVL**

Status:  
**Design Passed**

Illustration Not to Scale. Pitch: 0/12

Designed by Single Member Design Engine in MiTek® Structure Version  
8.6.3.353.Update16.11

Report Version: 2021.03.26 09/27/2023 08:17

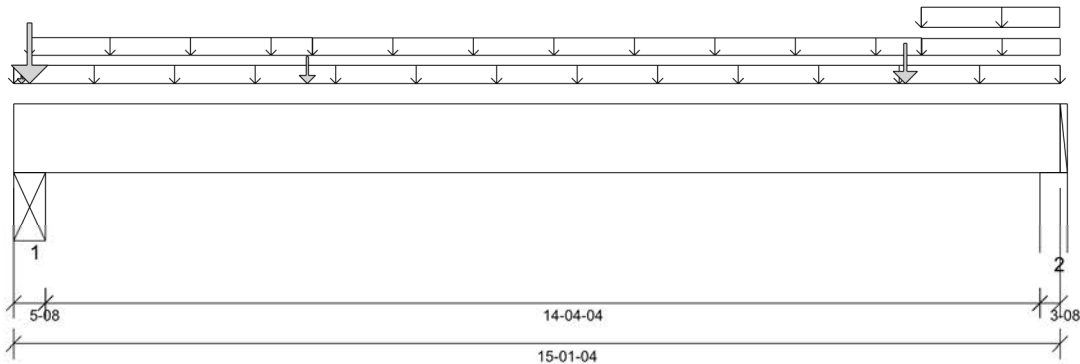

### DESIGN INFORMATION

Building Code: NBCC 2015, Part9, BCBC 2018, ABC 2019, OBC 2012 (2019 Amendment)  
Design Methodology: LSD  
Service Condition: Dry  
LL Deflection Limit: L/360,  
TL Deflection Limit: L/240,

#### Lateral Restraint Requirements:

Both ends of the member and the outer supports must be laterally restrained. Top and bottom edges of the member must be fully restrained or have the following maximum unbraced length:

Top: 0' Bottom: 8'- 8 3/8"

#### Factored Resistance of Support Material:

- 615 psi Beam @ 0'- 4 1/2"
- 615 psi Wall @ 14'- 10 3/4"

**PLY TO PLY CONNECTION:**  
**4 ROWS OF 3.25" PNEUMATIC GUN**  
**NAILS (0.120"x3.25") @ 12" O/C**

PLY TO PLY CONNECTION ASSUMES ANY  
SUPPORTED BEAM HANGERS ARE FASTENED  
TO THIS BEAM WITH MIN. 3.5" FASTENERS.

### ANALYSIS RESULTS

Design Criteria	Location	Load Combination	LDF	Design	Limit	Result
Factored Pos. Moment:	8'- 1 3/8"	1.25D + 1.5L	0.97	8603 lb ft	34398 lb ft	Passed - 25%
Factored Neg. Moment:	0'- 4 1/2"	1.25D + 1.5L	0.97	673 lb ft	30823 lb ft	Passed - 2%
Factored Shear:	13'- 9 7/8"	1.25D + 1.5L	0.97	3378 lb	13445 lb	Passed - 25%
Live Load (LL) Pos. Defl.:	7'- 7 13/16"	L		0.106"	L/360	Passed - L/999
Total Load (TL) Pos. Defl.:	7'- 9 7/16"	D + L		0.272"	L/240	Passed - L/633

### SUPPORT AND REACTION INFORMATION

ID	Input Bearing Length	Controlling Load Combination	LDF	Factored Downward Reaction	Factored Uplift Reaction	Factored Resistance of Member	Factored Resistance of Support	Result
1	5-08	1.25D + 1.5L	0.97	7027 lb		19484 lb	11522 lb	Passed - 61%
2	3-08	1.4D	0.65	2547 lb		8281 lb	4899 lb	Passed - 52%

### SPECIFIED LOADS

Type	Start Loc	End Loc	Source	Face	Dead (D)	Live (L)	Snow (S)	Wind (W)
Self Weight	0'	15'- 1 1/4"	Self Weight	Top	12 lb/ft	-	-	-
Uniform	0'	15'- 1 1/4"	User Load	Top	60 lb/ft	-	-	-
Uniform	0'- 2 3/4"	4'- 3 3/4"	FC1 Floor Decking (Plan View Fill)	Top	17 lb/ft	34 lb/ft	-	-
Uniform	4'- 3 3/4"	13'- 1 1/4"	FC1 Floor Decking (Plan View Fill)	Top	15 lb/ft	30 lb/ft	-	-
Uniform	13'- 1 3/16"	15'- 1 3/16"	E7(i446)	Top	100 lb/ft	-	-	-
Uniform	13'- 1 1/4"	15'- 1 1/4"	FC1 Floor Decking (Plan View Fill)	Top	11 lb/ft	22 lb/ft	-	-
Point	4'- 2 7/8"	4'- 2 7/8"	B4(i1038)	Front	289 lb	557 lb	-	-
Point	0'- 1 3/8"	0'- 1 3/8"	FC1 Floor Decking (Plan View Fill)	Top	1 lb	1 lb	-	-
Point	0'- 2 3/4"	0'- 2 3/4"	2(i457)	Top	1297 lb	1961 lb	-	-
Point	12'- 10 7/16"	12'- 10 7/16"	E24(i468)	Top	1075 lb	722 lb	-	-

### UNFACTORED REACTIONS

ID	Start Loc	End Loc	Source	Dead (D)	Live (L)	Snow (S)	Wind (W)
1	0'	0'- 5 1/2"	STL BM (i45)	2351 lb	2742 lb	-	-
2	14'- 9 3/4"	15'- 1 1/4"	-	1818 lb	944 lb	-	-
++>	14'- 11 3/4"	14'- 11 3/4"	W8(i26)	1566 lb	813 lb	-	-
++>	15'- 1"	15'- 1"	W7(i18)	252 lb	131 lb	-	-

### DESIGN NOTES

- CAUTION: One or more plies are not supported properly at 14-11-08. At least 75% of every ply must be contacting support.
- CAUTION: One or more plies are not supported properly at 14-11-08. At least 75% of every ply must be contacting support.
- The dead loads used in the design of this member were applied to the structure as projected dead loads.
- Lateral stability factor (KL) was based on user preference to use the width of all plies. (Consult with manufacturer for guideline pertaining to this design option.)
- Analysis and Design has been performed using precision loading from actual modeled conditions. Some loads may have been modified to simplify reporting.
- Tributary Loads have been generated based on actual spacing between members in the model which may differ from the default system spacing. The actual loads applied to the member are shown in the Specified Loads table.
- Transfer reactions may differ from design results as allowed per building codes and standard load distribution practices.
- This report is based on modeled conditions input by the user. Source information for the loads and supports are provided for reference only. Verify that all loads and support conditions are correct.
- Review all loads and reactions to ensure that the member/bearing/connector/structure can resist adequately. Unless already specified on this report, anchorage for uplift reactions to be specified by others. Installation of member and accessories (if required) as per manufacturer's instruction.
- Beam Stability Factor used in the calculation for Allowable Max Pos Moment (KL) = 1.00
- When the applied loads are coming from a member/post/wall above that does not sit directly on this beam, adequate load transfer elements, such as squash blocks, wall studs, or beveled plates are required to transfer the loads to this beam.
- Bearing capacity of member at support 1, 2 was verified for the effect of concentrated load applied near the support. At support 1. Required Load Area: L=1.500", W=3.500". LDF=0.97, Pf=4688 lb, Qr=5460 lb, Result=85.87%.



STRUCTURAL COMPONENT ONLY  
DWG # TF23091255 PG 1/2

CITY OF RICHMOND HILL  
05/01/2024  
RECEIVED  
Per: joshua.nabua





BUILDER:	<b>GREEN PARK HOMES</b>	Job Name:	<b>VILLA 6</b>	<b>2 Ply Member</b>	Status:
SITE:	<b>Trinigroup Developments Inc.</b>	Level:	<b>1ST FLOOR</b>	<b>1 3/4" x 11 7/8" (2.0E 3100)</b>	<b>Design</b>
MODEL:	<b>VILLA 6</b>	Label:	<b>B3 - i1132</b>	<b>WestFraser LVL</b>	<b>Passed</b>
CITY:	<b>RICHMOND HILL</b>	Type:	<b>Beam</b>		

- Bearing length at support 2 was calculated based on the actual bearing area divided by the supported member width and may not match expected value when bearing is not rectangular or when the supported member is not supported by its full width.
- One or more plies are not properly supported at 2. Verify with structural engineer or EWP manufacturer if this condition is acceptable.

#### PLY TO PLY CONNECTION

- Member design assumed proper ply to ply connection by others. Fastener spacing along length of member must not exceed 4 times depth of member. Verify connection between plies according to code specification and follow the manufacturer's installation instruction. Loads assumed to be distributed equally to each ply.



CITY OF RICHMOND HILL  
BUILDING DIVISION

05/01/2024

RECEIVED  
Per: joshua.nabua





BUILDER: **GREEN PARK HOMES**  
SITE: **Trinigroup Developments Inc.**  
MODEL: **VILLA 6**  
CITY: **RICHMOND HILL**

Job Name: **VILLA 6**  
Level: **1ST FLOOR**  
Label: **B4 - i1038**  
Type: **Beam**

**1 Ply Member**  
**1 3/4" x 11 7/8" (2.0E 3100)**  
**WestFraser LVL**

Status:  
**Design Passed**

Illustration Not to Scale. Pitch: 0/12

Designed by Single Member Design Engine in MiTek® Structure Version  
8.6.3.353.Update16.11

Report Version: 2021.03.26 09/27/2023 08:17

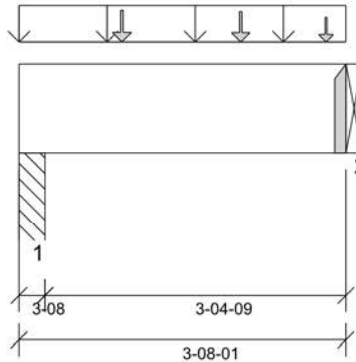

#### DESIGN INFORMATION

Building Code: NBCC 2015, Part9, BCBC 2018, ABC 2019, OBC 2012 (2019 Amendment)

Design Methodology: LSD

Service Condition: Dry

LL Deflection Limit: L/360,

TL Deflection Limit: L/240,

#### Lateral Restraint Requirements:

Both ends of the member and the outer supports must be laterally restrained. Top and bottom edges of the member must be fully restrained or have the following maximum unbraced length:

Top: 0' Bottom: 1'- 1 1/2"

#### Factored Resistance of Support Material:

- 615 psi Column @ 0'- 2 1/2"
- 615 psi Beam @ 3'- 8 1/16"

#### ANALYSIS RESULTS

Design Criteria	Location	Load Combination	LDF	Design	Limit	Result
Factored Pos. Moment:	1'- 11 3/4"	1.25D + 1.5L	1.00	1002 lb ft	17672 lb ft	Passed - 6%
Factored Shear:	2'- 8 3/16"	1.25D + 1.5L	1.00	563 lb	6908 lb	Passed - 8%

#### SUPPORT AND REACTION INFORMATION

ID	Input Bearing Length	Controlling Load Combination	LDF	Factored Downward Reaction	Factored Uplift Reaction	Factored Resistance of Member	Factored Resistance of Support	Result
1	3-08	1.25D + 1.5L	1.00	1238 lb		6370 lb	3767 lb	Passed - 33%
2	1-08	1.25D + 1.5L	1.00	1189 lb		2730 lb	-	Passed - 44%

#### CONNECTOR INFORMATION

ID	Part No.	Manufacturer	Nailing Requirements			Other Information or Requirement for Reinforcement Accessories
			Top	Face	Member	
2	HUS1.81/10		-	-	-	Connector manually specified by the user.
* Connectors: Refer to manufacturer's specifications, fasteners requirements and installation instruction. Where header fasteners are longer than the width of the supporting member, install backer block or clinch header nails.						

#### SPECIFIED LOADS

Type	Start Loc	End Loc	Source	Face	Dead (D)	Live (L)	Snow (S)	Wind (W)
Self Weight	0'	3'- 8 1/16"	Self Weight	Top	6 lb/ft	-	-	-
Uniform	0'	3'- 8 1/16"	User Load	Top	120 lb/ft	240 lb/ft	-	-
Point	1'- 1 7/8"	1'- 1 7/8"	J6(i344)	Back	51 lb	101 lb	-	-
Point	2'- 5 7/8"	2'- 5 7/8"	J6(i345)	Back	47 lb	93 lb	-	-
Point	3'- 5 3/8"	3'- 5 3/8"	J6(i337)	Back	27 lb	54 lb	-	-

#### UNFACTORED REACTIONS

ID	Start Loc	End Loc	Source	Dead (D)	Live (L)	Snow (S)	Wind (W)
1	0'	0'- 3 1/2"	PBO2(i52)	298 lb	572 lb	-	-
2	3'- 8 1/16"	3'- 8 1/16"	B3(i1132)	289 lb	557 lb	-	-

#### DESIGN NOTES

- The dead loads used in the design of this member were applied to the structure as projected dead loads.
- Analysis and Design has been performed using precision loading from actual modeled conditions. Some loads may have been modified to simplify reporting.
- Tributary Loads have been generated based on actual spacing between members in the model which may differ from the default system spacing. The actual loads applied to the member are shown in the Specified Loads table.
- Transfer reactions may differ from design results as allowed per building codes and standard load distribution practices.
- This report is based on modeled conditions input by the user. Source information for the loads and supports are provided for reference only. Verify that all loads and support conditions are correct.
- Review all loads and reactions to ensure that the member/bearing/connector/structure can resist adequately. Unless already specified on this report, anchorage for uplift reactions to be specified by others. Installation of member and accessories (if required) as per manufacturer's instruction.
- Beam Stability Factor used in the calculation for Allowable Max Pos Moment (KL) = 1.00
- When the applied loads are coming from a member/post/wall above that does not sit directly on this beam, adequate load transfer elements, such as squash blocks, wall studs, or beveled plates are required to transfer the loads to this beam.



STRUCTURAL COMPONENT ONLY  
DWG # TF23091256

CITY OF RICHMOND HILL  
BUILDING DIVISION

05/01/2024

RECEIVED  
Per: joshua.nabua





BUILDER: **GREEN PARK HOMES**  
SITE: **Trinigroup Developments Inc.**  
MODEL: **VILLA 6**  
CITY: **RICHMOND HILL**

Job Name: **VILLA 6**  
Level: **1ST FLOOR**  
Label: **B5 - i1039**  
Type: **Beam**

**1 Ply Member**  
**1 3/4" x 11 7/8" (2.0E 3100)**  
**WestFraser LVL**

Status:  
**Design  
Passed**

Illustration Not to Scale. Pitch: 0/12

Designed by Single Member Design Engine in MiTek® Structure Version  
8.6.3.353.Update16.11

Report Version: 2021.03.26 09/27/2023 08:17

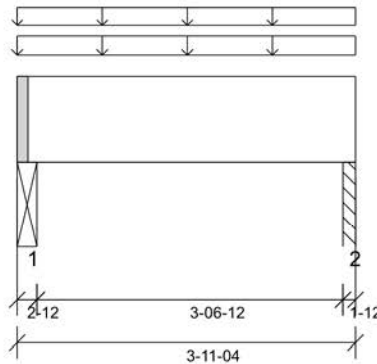

#### DESIGN INFORMATION

Building Code: NBCC 2015, Part9, BCBC 2018,  
ABC 2019, OBC 2012 (2019  
Amendment)

Design Methodology: LSD

Service Condition: Dry

LL Deflection Limit: L/360,

TL Deflection Limit: L/240,

#### Lateral Restraint Requirements:

Both ends of the member and the outer supports  
must be laterally restrained. Top and bottom edges  
of the member must be fully restrained or have the  
following maximum unbraced length:

Top: 0' Bottom: 3'- 8 1/2"

#### Factored Resistance of Support Material:

- 615 psi Beam @ 0'- 1 3/4"
- 615 psi Column @ 3'- 10 1/2"

#### ANALYSIS RESULTS

Design Criteria	Location	Load Combination	LDF	Design	Limit	Result
Factored Pos. Moment:	2'- 1/8"	1.25D + 1.5L	0.74	227 lb ft	13151 lb ft	Passed - 2%
Factored Shear:	1'- 2 5/8"	1.25D + 1.5L	0.74	104 lb	5140 lb	Passed - 2%

#### SUPPORT AND REACTION INFORMATION

ID	Input Bearing Length	Controlling Load Combination	LDF	Factored Downward Reaction	Factored Uplift Reaction	Factored Resistance of Member	Factored Resistance of Support	Result
1	2'-12	1.25D + 1.5L	0.74	265 lb		3725 lb	2203 lb	Passed - 12%
2	1'-12	1.25D + 1.5L	0.74	260 lb		2370 lb	1402 lb	Passed - 19%

#### SPECIFIED LOADS

Type	Start Loc	End Loc	Source	Face	Dead (D)	Live (L)	Snow (S)	Wind (W)
Self Weight	0'	3'- 11 1/4"	Self Weight	Top	6 lb/ft	-	-	-
Uniform	0'	3'- 11 1/4"	User Load	Top	60 lb/ft	-	-	-
Uniform	0'	3'- 11 1/4"	FC1 Floor Decking (Plan View Fill)	Top	12 lb/ft	23 lb/ft	-	-

#### UNFACTORED REACTIONS

ID	Start Loc	End Loc	Source	Dead (D)	Live (L)	Snow (S)	Wind (W)
1	0'	0'- 2 3/4"	STL BM (i45)	156 lb	47 lb	-	-
2	3'- 9 1/2"	3'- 11 1/4"	PBO2(i52)	151 lb	48 lb	-	-

#### DESIGN NOTES

- The dead loads used in the design of this member were applied to the structure as projected dead loads.
- Analysis and Design has been performed using precision loading from actual modeled conditions. Some loads may have been modified to simplify reporting.
- Tributary Loads have been generated based on actual spacing between members in the model which may differ from the default system spacing. The actual loads applied to the member are shown in the Specified Loads table.
- Transfer reactions may differ from design results as allowed per building codes and standard load distribution practices.
- This report is based on modeled conditions input by the user. Source information for the loads and supports are provided for reference only. Verify that all loads and support conditions are correct.
- Review all loads and reactions to ensure that the member/bearing/connector/structure can resist adequately. Unless already specified on this report, anchorage for uplift reactions to be specified by others. Installation of member and accessories (if required) as per manufacturer's instruction.
- Beam Stability Factor used in the calculation for Allowable Max Pos Moment (KL) = 1.00
- When the applied loads are coming from a member/post/wall above that does not sit directly on this beam, adequate load transfer elements, such as squash blocks, wall studs, or beveled plates are required to transfer the loads to this beam.



STRUCTURAL COMPONENT ONLY  
DWG # TF23091257

CITY OF RICHMOND HILL  
BUILDING DIVISION

05/01/2024

RECEIVED  
Per: joshua.nabua





BUILDER: **GREEN PARK HOMES**  
SITE: **Trinigroup Developments Inc.**  
MODEL: **VILLA 6**  
CITY: **RICHMOND HILL**

Job Name: **VILLA 6**  
Level: **1ST FLOOR**  
Label: **B6 - i1105**  
Type: **Beam**

**2 Ply Member**  
**1 3/4" x 11 7/8" (2.0E 3100)**  
**WestFraser LVL**

Status:  
**Design Passed**

Illustration Not to Scale. Pitch: 0/12

Designed by Single Member Design Engine in MiTek® Structure Version 8.6.3.353.Update16.11

Report Version: 2021.03.26 09/27/2023 08:17

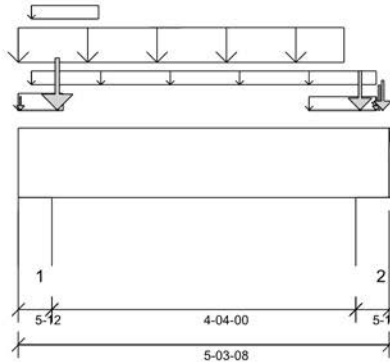

### DESIGN INFORMATION

Building Code: NBCC 2015, Part9, BCBC 2018, ABC 2019, OBC 2012 (2019 Amendment)  
Design Methodology: LSD  
Service Condition: Dry  
LL Deflection Limit: L/360,  
TL Deflection Limit: L/240,

#### Lateral Restraint Requirements:

Both ends of the member and the outer supports must be laterally restrained. Top and bottom edges of the member must be fully restrained or have the following maximum unbraced length:

Top: 0' Bottom: 0'- 8 1/2"

#### Factored Resistance of Support Material:

- 615 psi Wall @ 0'- 4 3/4"
- 615 psi Wall @ 4'- 10 3/4"

**PLY TO PLY CONNECTION:**  
**4 ROWS OF 3.25" PNEUMATIC GUN**  
**NAILS (0.120"x3.25") @ 6" O/C**

PLY TO PLY CONNECTION ASSUMES ANY  
SUPPORTED BEAM HANGERS ARE FASTENED  
TO THIS BEAM WITH MIN. 3.5" FASTENERS.

### ANALYSIS RESULTS

Design Criteria	Location	Load Combination	LDF	Design	Limit	Result
Factored Pos. Moment:	2'- 1 3/4"	1.25D + 1.5L	1.00	1998 lb ft	35345 lb ft	Passed - 6%
Factored Neg. Moment:	4'- 10 3/4"	1.25D + 1.5L	1.00	533 lb ft	35345 lb ft	Passed - 2%
Factored Shear:	3'- 9 7/8"	1.25D + 1.5L	1.00	1774 lb	13815 lb	Passed - 13%

### SUPPORT AND REACTION INFORMATION

ID	Input Bearing Length	Controlling Load Combination	LDF	Factored Downward Reaction	Factored Uplift Reaction	Factored Resistance of Member	Factored Resistance of Support	Result
1	5'-12	1.25D + 1.5L	1.00	5011 lb		20930 lb	12381 lb	Passed - 40%
2	5'-12	1.25D + 1.5L	1.00	5461 lb		20930 lb	12381 lb	Passed - 44%

### SPECIFIED LOADS

Type	Start Loc	End Loc	Source	Face	Dead (D)	Live (L)	Snow (S)	Wind (W)
Self Weight	0'	5'- 3 1/2"	Self Weight	Top	12 lb/ft	-	-	-
Uniform	0'	0'- 7 11/16"	E21(i465)	Top	100 lb/ft	-	-	-
Uniform	0'- 2 1/4"	5'- 1 1/4"	FC1 Floor Decking (Plan View Fill)	Top	6 lb/ft	12 lb/ft	-	-
Uniform	0'- 2 1/4"	1'- 1 3/4"	FC1 Floor Decking (Plan View Fill)	Top	3 lb/ft	6 lb/ft	-	-
Uniform	4'- 1 3/4"	5'- 1 1/4"	FC1 Floor Decking (Plan View Fill)	Top	3 lb/ft	6 lb/ft	-	-
Tapered	0'	4'- 7 3/4"	Smoothed Load	Front	198 To 199 lb/ft	396 To 400 lb/ft	-	-
Point	5'- 1 3/4"	5'- 1 3/4"	J8(i1103)	Front	200 lb	366 lb	-	-
Point	0'- 3/8"	0'- 3/8"	E21(i465)	Top	9 lb	18 lb	-	-
Point	0'- 6 11/16"	0'- 6 11/16"	E21(i465)	Top	843 lb	1018 lb	-	-
Point	4'- 10 1/2"	4'- 10 1/2"	E4(i443)	Top	579 lb	667 lb	-	-
Point	5'- 1 1/4"	5'- 1 1/4"	FC1 Floor Decking (Plan View Fill)	Top	0 lb	0 lb	-	-
Point	5'- 2 3/8"	5'- 2 3/8"	E5(i447)	Top	369 lb	424 lb	-	-

### UNFACTORED REACTIONS

ID	Start Loc	End Loc	Source	Dead (D)	Live (L)	Snow (S)	Wind (W)
1	0'	0'- 5 3/4"	W1(i21)	1505 lb	2174 lb	-	-
2	4'- 9 3/4"	5'- 3 1/2"	W4(i19)	1579 lb	2236 lb	-	-

### DESIGN NOTES

- The dead loads used in the design of this member were applied to the structure as projected dead loads.
- Lateral stability factor (KL) was based on user preference to use the width of all plies. (Consult with manufacturer for guideline pertaining to this design option.)
- Analysis and Design has been performed using precision loading from actual modeled conditions. Some loads may have been modified to simplify reporting.
- Tributary Loads have been generated based on actual spacing between members in the model which may differ from the default system spacing. The actual loads applied to the member are shown in the Specified Loads table.
- Transfer reactions may differ from design results as allowed per building codes and standard load distribution practices.
- This report is based on modeled conditions input by the user. Source information for the loads and supports are provided for reference only. Verify that all loads and support conditions are correct.
- Review all loads and reactions to ensure that the member/bearing/connector/structure can resist adequately. Unless already specified on this report, anchorage for uplift reactions to be specified by others. Installation of member and accessories (if required) as per manufacturer's instruction.
- Beam Stability Factor used in the calculation for Allowable Max Pos Moment (KL) = 1.00
- When the applied loads are coming from a member/post/wall above that does not sit directly on this beam, adequate load transfer elements, such as squash blocks, wall studs, or beveled plates are required to transfer the loads to this beam.
- Bearing capacity of member at support 1, 2 was verified for the effect of concentrated load applied near the support. At support 1. Required Load Area: L=1.500", W=3.497". LDF=1.00, Pf=2581 lb, Qr=5455 lb, Result=47.31%.

### PLY TO PLY CONNECTION

- Member design assumed proper ply to ply connection by others. Fastener spacing along length of member must not exceed 4 times depth of member. Verify connection between plies according to code specification and follow the manufacturer's installation instruction. Loads assumed to be distributed equally to each ply.



STRUCTURAL COMPONENT ONLY  
DWG # TF23091258

CITY OF RICHMOND HILL  
PLANNING DIVISION  
05/01/2024  
RECEIVED  
Per: joshua.nabua





BUILDER: **GREEN PARK HOMES**  
SITE: **Trinigroup Developments Inc.**  
MODEL: **VILLA 6**  
CITY: **RICHMOND HILL**

Job Name: **VILLA 6**  
Level: **1ST FLOOR**  
Label: **B7 - i378**  
Type: **Beam**

**2 Ply Member**  
**1 3/4" x 11 7/8" (2.0E 3100)**  
**WestFraser LVL**

Status:  
**Design  
Passed**

Illustration Not to Scale. Pitch: 0/12

Designed by Single Member Design Engine in MiTek® Structure Version  
8.6.3.353.Update16.11

Report Version: 2021.03.26 09/27/2023 08:17

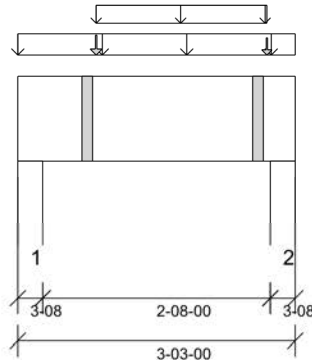

#### DESIGN INFORMATION

Building Code: NBCC 2015, Part9, BCBC 2018,  
ABC 2019, OBC 2012 (2019  
Amendment)

Design Methodology: LSD

Service Condition: Dry

LL Deflection Limit: L/360,

TL Deflection Limit: L/240,

#### Lateral Restraint Requirements:

Both ends of the member and the outer supports  
must be laterally restrained. Top and bottom edges  
of the member must be fully restrained or have the  
following maximum unbraced length:

Top: 0' Bottom: 1'- 9 1/2"

#### Factored Resistance of Support Material:

- 615 psi Wall @ 0'- 2 1/2"
- 615 psi Wall @ 3'- 1/2"

#### ANALYSIS RESULTS

Design Criteria	Location	Load Combination	LDF	Design	Limit	Result
Factored Pos. Moment:	1'- 6 15/16"	1.25D + 1.5L	0.67	209 lb ft	23837 lb ft	Passed - 1%
Factored Shear:	1'- 3 3/8"	1.25D + 1.5L	0.67	118 lb	9317 lb	Passed - 1%

#### SUPPORT AND REACTION INFORMATION

ID	Input Bearing Length	Controlling Load Combination	LDF	Factored Downward Reaction	Factored Uplift Reaction	Factored Resistance of Member	Factored Resistance of Support	Result
1	3-08	1.25D + 1.5L	0.67	318 lb		8592 lb	5082 lb	Passed - 6%
2	3-08	1.25D + 1.5L	0.67	331 lb		8592 lb	5082 lb	Passed - 7%

#### SPECIFIED LOADS

Type	Start Loc	End Loc	Source	Face	Dead (D)	Live (L)	Snow (S)	Wind (W)
Self Weight	0'	3'- 3"	Self Weight	Top	12 lb/ft	-	-	-
Uniform	-0'	3'- 3"	E30(i474)	Top	100 lb/ft	-	-	-
Uniform	0'- 11"	2'- 11"	FC1 Floor Decking (Plan View Fill)	Top	13 lb/ft	27 lb/ft	-	-
Point	0'- 11"	0'- 11"	Bk1(i353)	Back	14 lb	28 lb	-	-
Point	2'- 11"	2'- 11"	Bk1(i352)	Back	5 lb	10 lb	-	-

#### UNFACTORED REACTIONS

ID	Start Loc	End Loc	Source	Dead (D)	Live (L)	Snow (S)	Wind (W)
1	0'	0'- 3 1/2"	W26(i50)	202 lb	41 lb	-	-
2	2'- 11 1/2"	3'- 3"	W17(i28)	207 lb	50 lb	-	-

#### DESIGN NOTES

- The dead loads used in the design of this member were applied to the structure as projected dead loads.
- Lateral stability factor (KL) was based on user preference to use the width of all plies. (Consult with manufacturer for guideline pertaining to this design option.)
- Analysis and Design has been performed using precision loading from actual modeled conditions. Some loads may have been modified to simplify reporting.
- Tributary Loads have been generated based on actual spacing between members in the model which may differ from the default system spacing. The actual loads applied to the member are shown in the Specified Loads table.
- Transfer reactions may differ from design results as allowed per building codes and standard load distribution practices.
- This report is based on modeled conditions input by the user. Source information for the loads and supports are provided for reference only. Verify that all loads and support conditions are correct.
- Review all loads and reactions to ensure that the member/bearing/connector/structure can resist adequately. Unless already specified on this report, anchorage for uplift reactions to be specified by others. Installation of member and accessories (if required) as per manufacturer's instruction.
- Beam Stability Factor used in the calculation for Allowable Max Pos Moment (KL) = 1.00
- When the applied loads are coming from a member/post/wall above that does not sit directly on this beam, adequate load transfer elements, such as squash blocks, wall studs, or beveled plates are required to transfer the loads to this beam.

#### PLY TO PLY CONNECTION

- Member design assumed proper ply to ply connection by others. Fastener spacing along length of member must not exceed 4 times depth of member. Verify connection between plies according to code specification and follow the manufacturer's installation instruction. Loads assumed to be distributed equally to each ply.



STRUCTURAL COMPONENT ONLY  
DWG # TF23091259

CITY OF RICHMOND HILL  
BUILDING DIVISION

05/01/2024

RECEIVED  
Per: joshua.nabua





BUILDER: **GREEN PARK HOMES**  
SITE: **Trinigroup Developments Inc.**  
MODEL: **VILLA 6**  
CITY: **RICHMOND HILL**

Job Name: **VILLA 6**  
Level: **2ND FLOOR**  
Label: **B8 - i1115**  
Type: **Beam**

**2 Ply Member**  
**1 3/4" x 11 7/8" (2.0E 3100)**  
**WestFraser LVL**

Status:  
**Design Passed**

Illustration Not to Scale. Pitch: 0/12

Designed by Single Member Design Engine in MiTek® Structure Version  
8.6.3.353.Update16.11

Report Version: 2021.03.26 09/27/2023 08:17

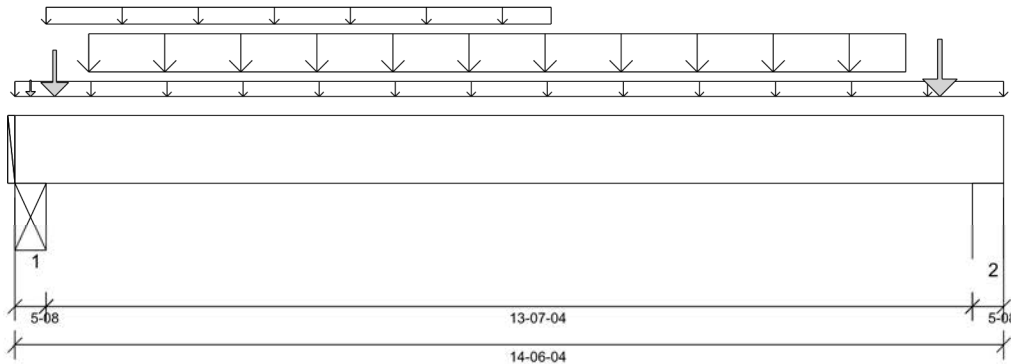

### DESIGN INFORMATION

Building Code: NBCC 2015, Part9, BCBC 2018, ABC 2019, OBC 2012 (2019 Amendment)  
Design Methodology: LSD  
Service Condition: Dry  
LL Deflection Limit: L/360,  
TL Deflection Limit: L/240,

#### Lateral Restraint Requirements:

Both ends of the member and the outer supports must be laterally restrained. Top and bottom edges of the member must be fully restrained or have the following maximum unbraced length:

Top: 0' Bottom: 0'- 9 1/2"

#### Factored Resistance of Support Material:

- 615 psi Beam @ 0'- 4 1/2"
- 615 psi Wall @ 14'- 1 3/4"

**PLY TO PLY CONNECTION:**  
4 ROWS OF 3.25" PNEUMATIC GUN NAILS (0.120"x3.25") @ 8" O/C

PLY TO PLY CONNECTION ASSUMES ANY SUPPORTED BEAM HANGERS ARE FASTENED TO THIS BEAM WITH MIN. 3.5" FASTENERS.

### ANALYSIS RESULTS

Design Criteria	Location	Load Combination	LDF	Design	Limit	Result
Factored Pos. Moment:	7'- 7"	1.25D + 1.5L	1.00	20664 lb ft	35345 lb ft	Passed - 58%
Factored Shear:	1'- 5 3/8"	1.25D + 1.5L	1.00	6062 lb	13815 lb	Passed - 44%
Live Load (LL) Pos. Defl.:	7'- 3 3/16"	L		0.327"	L/360	Passed - L/499
Total Load (TL) Pos. Defl.:	7'- 2 13/16"	D + L		0.529"	L/240	Passed - L/308
Permanent Deflection:	7'- 2 5/16"			-	L/360	Passed - L/829

### SUPPORT AND REACTION INFORMATION

ID	Input Bearing Length	Controlling Load Combination	LDF	Factored Downward Reaction	Factored Uplift Reaction	Factored Resistance of Member	Factored Resistance of Support	Result
1	5'-08	1.25D + 1.5L	1.00	6229 lb		20020 lb	11839 lb	Passed - 53%
2	5'-08	1.25D + 1.5L	1.00	5862 lb		20020 lb	11843 lb	Passed - 49%

### SPECIFIED LOADS

Type	Start Loc	End Loc	Source	Face	Dead (D)	Live (L)	Snow (S)	Wind (W)
Self Weight	0'	14'- 6 1/4"	Self Weight	Top	12 lb/ft	-	-	-
Uniform	-0'	14'- 6 1/4"	FC2 Floor Decking (Plan View Fill)	Top	6 lb/ft	11 lb/ft	-	-
Uniform	0'- 5 1/2"	7'- 10 1/2"	User Load	Top	60 lb/ft	-	-	-
Uniform	1'- 1"	13'- 1"	Smoothed Load	Back	186 lb/ft	371 lb/ft	-	-
Point	0'- 7"	0'- 7"	J6(i806)	Back	147 lb	294 lb	-	-
Point	13'- 7"	13'- 7"	J6(i838)	Back	197 lb	394 lb	-	-
Point	0'- 2 3/4"	0'- 2 3/4"	E79(i546)	Top	29 lb	-	-	-

### UNFACTORED REACTIONS

ID	Start Loc	End Loc	Source	Dead (D)	Live (L)	Snow (S)	Wind (W)
1	0'	0'- 5 1/2"	BBO(i497)	1781 lb	2677 lb	-	-
2	14'- 3/4"	14'- 6 1/4"	1(i456)	1524 lb	2630 lb	-	-

### DESIGN NOTES

- The dead loads used in the design of this member were applied to the structure as projected dead loads.
- Lateral stability factor (KL) was based on user preference to use the width of all plies. (Consult with manufacturer for guideline pertaining to this design option.)
- Analysis and Design has been performed using precision loading from actual modeled conditions. Some loads may have been modified to simplify reporting.
- Tributary Loads have been generated based on actual spacing between members in the model which may differ from the default system spacing. The actual loads applied to the member are shown in the Specified Loads table.
- Transfer reactions may differ from design results as allowed per building codes and standard load distribution practices.
- This report is based on modeled conditions input by the user. Source information for the loads and supports are provided for reference only. Verify that all loads and support conditions are correct.
- Review all loads and reactions to ensure that the member/bearing/connector/structure can resist adequately. Unless already specified on this report, anchorage for uplift reactions to be specified by others. Installation of member and accessories (if required) as per manufacturer's instruction.
- Beam Stability Factor used in the calculation for Allowable Max Pos Moment (KL) = 1.00
- When the applied loads are coming from a member/post/wall above that does not sit directly on this beam, adequate load transfer elements, such as squash blocks, wall studs, or beveled plates are required to transfer the loads to this beam.

### PLY TO PLY CONNECTION

- Member design assumed proper ply to ply connection by others. Fastener spacing along length of member must not exceed 4 times depth of member. Verify connection between plies according to code specification and follow the manufacturer's installation instruction. Loads assumed to be distributed equally to each ply.



STRUCTURAL COMPONENT ONLY  
DWG # TF23091260

100505065  
BUILDING DIVISION  
05/01/2024  
RECEIVED  
Per: joshua.nabua





BUILDER: **GREEN PARK HOMES**  
SITE: **Trinigroup Developments Inc.**  
MODEL: **VILLA 6**  
CITY: **RICHMOND HILL**

Job Name: **VILLA 6**  
Level: **2ND FLOOR**  
Label: **B9 - i1053**  
Type: **Beam**

**2 Ply Member**  
**1 3/4" x 11 7/8" (2.0E 3100)**  
**WestFraser LVL**

Status:  
**Design Passed**

Illustration Not to Scale. Pitch: 0/12

Designed by Single Member Design Engine in MiTek® Structure Version  
8.6.3.353.Update16.11

Report Version: 2021.03.26 09/27/2023 08:17

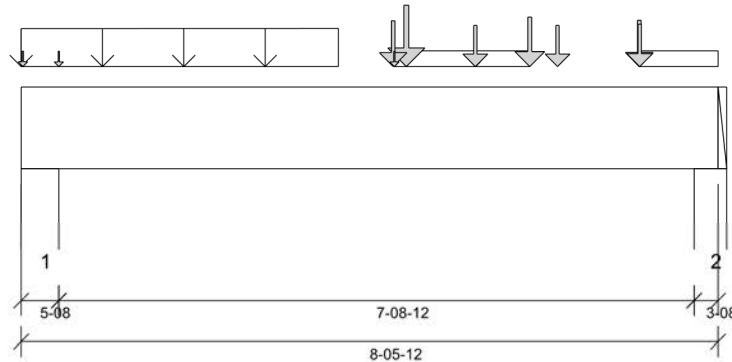

#### DESIGN INFORMATION

Building Code: NBCC 2015, Part9, BCBC 2018, ABC 2019, OBC 2012 (2019 Amendment)  
Design Methodology: LSD  
Service Condition: Dry  
LL Deflection Limit: L/360,  
TL Deflection Limit: L/240,

#### Lateral Restraint Requirements:

Both ends of the member and the outer supports must be laterally restrained. Top and bottom edges of the member must be fully restrained or have the following maximum unbraced length:

Top: 0' Bottom: 1'- 1 1/2"

#### Factored Resistance of Support Material:

- 615 psi Wall @ 0'- 4 1/2"
- 615 psi Wall @ 8'- 3 1/4"

**PLY TO PLY CONNECTION:**  
**4 ROWS OF 3.25" PNEUMATIC GUN**  
**NAILS (0.120"x3.25") @ 6" O/C**

PLY TO PLY CONNECTION ASSUMES ANY  
SUPPORTED BEAM HANGERS ARE FASTENED  
TO THIS BEAM WITH MIN. 3.5" FASTENERS.

#### ANALYSIS RESULTS

Design Criteria	Location	Load Combination	LDF	Design	Limit	Result
Factored Pos. Moment:	4'- 8 1/4"	1.25D + 1.5L	1.00	7976 lb ft	35345 lb ft	Passed - 23%
Factored Shear:	7'- 2 3/8"	1.25D + 1.5L	1.00	4079 lb	13815 lb	Passed - 30%
Live Load (LL) Pos. Defl.:	4'- 5 1/8"	L		0.037"	L/360	Passed - L/999
Total Load (TL) Pos. Defl.:	4'- 5 1/8"	D + L		0.065"	L/240	Passed - L/999

#### SUPPORT AND REACTION INFORMATION

ID	Input Bearing Length	Controlling Load Combination	LDF	Factored Downward Reaction	Factored Uplift Reaction	Factored Resistance of Member	Factored Resistance of Support	Result
1	5-08	1.25D + 1.5L	1.00	3511 lb		20020 lb	11843 lb	Passed - 30%
2	3-08	1.25D + 1.5L	1.00	4111 lb		12740 lb	7536 lb	Passed - 55%

#### SPECIFIED LOADS

Type	Start Loc	End Loc	Source	Face	Dead (D)	Live (L)	Snow (S)	Wind (W)
Self Weight	0'	8'- 5 3/4"	Self Weight	Top	12 lb/ft	-	-	-
Uniform	4'- 6 1/2"	6'- 2 1/4"	FC2 Floor Decking (Plan View Fill)	Top	3 lb/ft	6 lb/ft	-	-
Tapered	0'	3'- 10 5/16"	Smoothed Load	Back	147 To 149 lb/ft	294 To 299 lb/ft	-	-
Tapered	7'- 6 1/4"	8'- 5 3/4"	FC2 Floor Decking (Plan View Fill)	Top	3 lb/ft	6 To 6 lb/ft	-	-
Point	4'- 8 1/4"	4'- 8 1/4"	B10(i1058)	Front	546 lb	206 lb	-	-
Point	6'- 2 1/4"	6'- 2 1/4"	J2(i910)	Front	186 lb	372 lb	-	-
Point	7'- 6 1/4"	7'- 6 1/4"	J2(i908)	Front	168 lb	337 lb	-	-
Point	4'- 6 5/16"	4'- 6 5/16"	J1(i943)	Back	166 lb	332 lb	-	-
Point	5'- 6 5/16"	5'- 6 5/16"	J1(i575)	Back	141 lb	281 lb	-	-
Point	6'- 6 5/16"	6'- 6 5/16"	J1(i576)	Back	140 lb	281 lb	-	-
Point	7'- 6 5/16"	7'- 6 5/16"	J1(i960)	Back	148 lb	296 lb	-	-
Point	0'- 1/4"	0'- 1/4"	FC2 Floor Decking (Plan View Fill)	Top	1 lb	3 lb	-	-
Point	0'- 5 1/2"	0'- 5 1/2"	FC2 Floor Decking (Plan View Fill)	Top	0 lb	0 lb	-	-
Point	4'- 6 1/2"	4'- 6 1/2"	FC2 Floor Decking (Plan View Fill)	Top	-	0 lb	-	-

#### UNFACTORED REACTIONS

ID	Start Loc	End Loc	Source	Dead (D)	Live (L)	Snow (S)	Wind (W)
1	0'	0'- 5 1/2"	4(i459)	1017 lb	1515 lb	-	-
2	8'- 2 1/4"	8'- 5 3/4"	2(i457)	1159 lb	1753 lb	-	-

#### DESIGN NOTES

- The dead loads used in the design of this member were applied to the structure as projected dead loads.
- Lateral stability factor (KL) was based on user preference to use the width of all plies. (Consult with manufacturer for guideline pertaining to this design option.)
- Analysis and Design has been performed using precision loading from actual modeled conditions. Some loads may have been modified to simplify reporting.
- Tributary Loads have been generated based on actual spacing between members in the model which may differ from the default system spacing. The actual loads applied to the member are shown in the Specified Loads table.
- Transfer reactions may differ from design results as allowed per building codes and standard load distribution practices.
- This report is based on modeled conditions input by the user. Source information for the loads and supports are provided for reference only. Verify that all loads and support conditions are correct.
- Review all loads and reactions to ensure that the member/bearing/connector/structure can resist adequately. Unless already specified on this report, anchorage for uplift reactions to be specified by others. Installation of member and accessories (if required) as per manufacturer's instruction.
- Beam Stability Factor used in the calculation for Allowable Max Pos Moment (KL) = 1.00
- When the applied loads are coming from a member/post/wall above that does not sit directly on this beam, adequate load transfer elements, such as squash blocks, wall studs, or beveled plates are required to transfer the loads to this beam.

#### PLY TO PLY CONNECTION



STRUCTURAL COMPONENT ONLY  
DWG # TF23091261 PG 1/2

CITY OF RICHMOND HILL  
BUILDING DIVISION  
05/01/2024  
**RECEIVED**  
Per: joshua.nabua



	<b>BUILDER:</b> GREEN PARK HOMES <b>SITE:</b> Trinigroup Developments Inc. <b>MODEL:</b> VILLA 6 <b>CITY:</b> RICHMOND HILL	<b>Job Name:</b> VILLA 6 <b>Level:</b> 2ND FLOOR <b>Label:</b> B9 - i1053 <b>Type:</b> Beam	<b>2 Ply Member</b> <b>1 3/4" x 11 7/8" (2.0E 3100)</b> <b>WestFraser LVL</b>	<b>Status:</b> <b>Design Passed</b>
---	--	--	---	--

**PLY TO PLY CONNECTION**

- Member design assumed proper ply to ply connection by others. Fastener spacing along length of member must not exceed 4 times depth of member. Verify connection between plies according to code specification and follow the manufacturer's installation instruction. Loads assumed to be distributed equally to each ply.



CITY OF RICHMOND HILL  
 BUILDING DIVISION

05/01/2024

**RECEIVED**  
 Per: joshua.nabua





BUILDER: **GREEN PARK HOMES**  
SITE: **Trinigroup Developments Inc.**  
MODEL: **VILLA 6**  
CITY: **RICHMOND HILL**

Job Name: **VILLA 6**  
Level: **2ND FLOOR**  
Label: **B10 - i1058**  
Type: **Beam**

**2 Ply Member**  
**1 3/4" x 11 7/8" (2.0E 3100)**  
**WestFraser LVL**

Status:  
**Design  
Passed**

Illustration Not to Scale. Pitch: 0/12

Designed by Single Member Design Engine in MiTek® Structure Version  
8.6.3.353.Update16.11

Report Version: 2021.03.26

09/27/2023 08:17

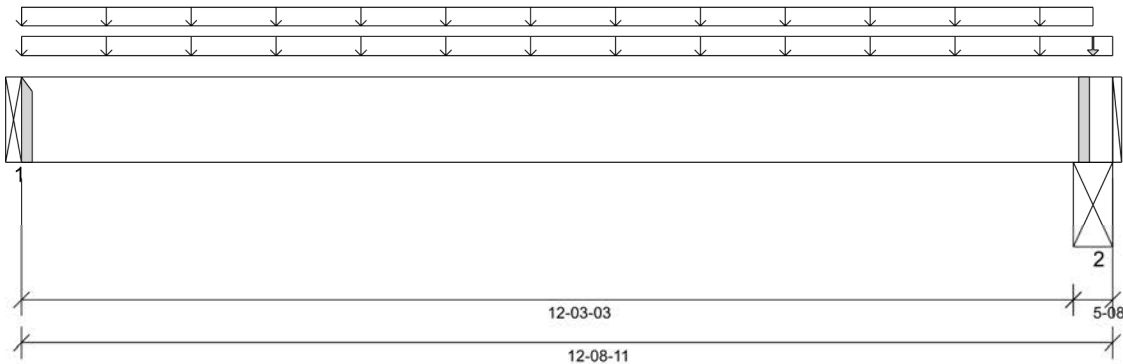

#### DESIGN INFORMATION

Building Code: NBCC 2015, Part9, BCBC 2018, ABC 2019, OBC 2012 (2019 Amendment)  
Design Methodology: LSD  
Service Condition: Dry  
LL Deflection Limit: L/360,  
TL Deflection Limit: L/240,

#### Lateral Restraint Requirements:

Both ends of the member and the outer supports must be laterally restrained. Top and bottom edges of the member must be fully restrained or have the following maximum unbraced length:

Top: 0' Bottom: 12'- 3 3/16"

#### Factored Resistance of Support Material:

- 615 psi Beam @ 0'
- 615 psi Beam @ 12'- 4 3/16"

#### ANALYSIS RESULTS

Design Criteria	Location	Load Combination	LDF	Design	Limit	Result
Factored Pos. Moment:	6'- 2"	1.25D + 1.5L	0.78	3040 lb ft	27470 lb ft	Passed - 11%
Factored Shear:	0'- 11 7/8"	1.25D + 1.5L	0.78	828 lb	10737 lb	Passed - 8%
Live Load (LL) Pos. Defl.:	6'- 2 1/16"	L		0.018"	L/360	Passed - L/999
Total Load (TL) Pos. Defl.:	6'- 2 1/16"	D + L		0.067"	L/240	Passed - L/999

#### SUPPORT AND REACTION INFORMATION

ID	Input Bearing Length	Controlling Load Combination	LDF	Factored Downward Reaction	Factored Uplift Reaction	Factored Resistance of Member	Factored Resistance of Support	Result
1	1-08	1.25D + 1.5L	0.78	986 lb		4244 lb	-	Passed - 23%
2	5-08	1.25D + 1.5L	0.78	1068 lb		15560 lb	9201 lb	Passed - 12%

#### CONNECTOR INFORMATION

ID	Part No.	Manufacturer	Top	Face	Member	Other Information or Requirement for Reinforcement Accessories
1	HGUS410		-	-	-	Connector manually specified by the user.

\* Connectors: Refer to manufacturer's specifications, fasteners requirements and installation instruction. Where header fasteners are longer than the width of the supporting member, install backer block or clinch header nails.

#### SPECIFIED LOADS

Type	Start Loc	End Loc	Source	Face	Dead (D)	Live (L)	Snow (S)	Wind (W)
Self Weight	0'	12'- 8 11/16"	Self Weight	Top	12 lb/ft	-	-	-
Uniform	0'	12'- 8 11/16"	User Load	Top	60 lb/ft	-	-	-
Uniform	-0'	12'- 5 15/16"	FC2 Floor Decking (Plan View Fill)	Top	17 lb/ft	33 lb/ft	-	-
Point	12'- 5 15/16"	12'- 5 15/16"	E63(i530)	Top	29 lb	-	-	-

#### UNFACTORED REACTIONS

ID	Start Loc	End Loc	Source	Dead (D)	Live (L)	Snow (S)	Wind (W)
1	0'	0'	B9(i1053)	546 lb	206 lb	-	-
2	12'- 3 3/16"	12'- 8 11/16"	STL BM (i504)	603 lb	206 lb	-	-

#### DESIGN NOTES

- The dead loads used in the design of this member were applied to the structure as projected dead loads.
- Lateral stability factor (KL) was based on user preference to use the width of all plies. (Consult with manufacturer for guideline pertaining to this design option.)
- Analysis and Design has been performed using precision loading from actual modeled conditions. Some loads may have been modified to simplify reporting.
- Tributary Loads have been generated based on actual spacing between members in the model which may differ from the default system spacing. The actual loads applied to the member are shown in the Specified Loads table.
- Transfer reactions may differ from design results as allowed per building codes and standard load distribution practices.
- This report is based on modeled conditions input by the user. Source information for the loads and supports are provided for reference only. Verify that all loads and support conditions are correct.
- Review all loads and reactions to ensure that the member/bearing/connector/structure can resist adequately. Unless already specified on this report, anchorage for uplift reactions to be specified by others. Installation of member and accessories (if required) as per manufacturer's instruction.
- Beam Stability Factor used in the calculation for Allowable Max Pos Moment (KL) = 1.00
- When the applied loads are coming from a member/post/wall above that does not sit directly on this beam, adequate load transfer elements, such as squash blocks, wall studs, or beveled plates are required to transfer the loads to this beam.

#### PLY TO PLY CONNECTION

- Member design assumed proper ply to ply connection by others. Fastener spacing along length of member must not exceed 4 times depth of member. Verify connection between plies according to code specification and follow the manufacturer's installation instruction. Loads assumed to be distributed equally to each ply.



STRUCTURAL COMPONENT ONLY  
DWG # TF23091262

CITY OF RICHMOND HILL  
BUILDING DIVISION

05/01/2024

RECEIVED  
Per: joshua.nabua





BUILDER: **GREEN PARK HOMES**  
SITE: **Trinigroup Developments Inc.**  
MODEL: **VILLA 6**  
CITY: **RICHMOND HILL**

Job Name: **VILLA 6**  
Level: **2ND FLOOR**  
Label: **B11 - i1040**  
Type: **Beam**

**1 Ply Member**  
**1 3/4" x 11 7/8" (2.0E 3100)**  
**WestFraser LVL**

Status:  
**Design Passed**

Illustration Not to Scale. Pitch: 0/12

Designed by Single Member Design Engine in MiTek® Structure Version  
8.6.3.353.Update16.11

Report Version: 2021.03.26 09/27/2023 08:18

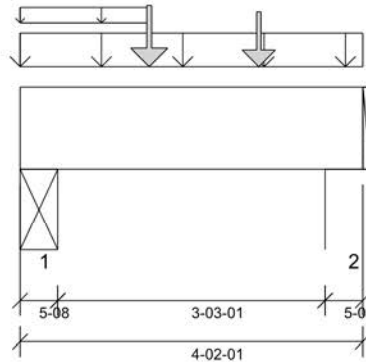

#### DESIGN INFORMATION

Building Code: NBCC 2015, Part9, BCBC 2018,  
ABC 2019, OBC 2012 (2019  
Amendment)

Design Methodology: LSD

Service Condition: Dry

LL Deflection Limit: L/360,

TL Deflection Limit: L/240,

#### Lateral Restraint Requirements:

Both ends of the member and the outer supports  
must be laterally restrained. Top and bottom edges  
of the member must be fully restrained or have the  
following maximum unbraced length:

Top: 0' Bottom: 1'- 1 1/2"

#### Factored Resistance of Support Material:

- 615 psi Beam @ 0'- 4 1/2"
- 615 psi Wall @ 3'- 9 9/16"

#### ANALYSIS RESULTS

Design Criteria	Location	Load Combination	LDF	Design	Limit	Result
Factored Pos. Moment:	1'- 10 15/16"	1.25D + 1.5L	1.00	1431 lb ft	17672 lb ft	Passed - 8%
Factored Shear:	2'- 8 11/16"	1.25D + 1.5L	1.00	1036 lb	6908 lb	Passed - 15%

#### SUPPORT AND REACTION INFORMATION

ID	Input Bearing Length	Controlling Load Combination	LDF	Factored Downward Reaction	Factored Uplift Reaction	Factored Resistance of Member	Factored Resistance of Support	Result
1	5'-08"	1.25D + 1.5L	1.00	1713 lb		10010 lb	5919 lb	Passed - 29%
2	5'-08"	1.25D + 1.5L	1.00	1785 lb		10010 lb	5921 lb	Passed - 30%

#### SPECIFIED LOADS

Type	Start Loc	End Loc	Source	Face	Dead (D)	Live (L)	Snow (S)	Wind (W)
Self Weight	0'	4'- 2 1/16"	Self Weight	Top	6 lb/ft	-	-	-
Uniform	0'	4'- 2 1/16"	User Load	Top	120 lb/ft	240 lb/ft	-	-
Uniform	0'	1'- 6 7/8"	FC2 Floor Decking (Plan View Fill)	Top	2 lb/ft	3 lb/ft	-	-
Point	1'- 6 7/8"	1'- 6 7/8"	J3(i639)	Back	168 lb	336 lb	-	-
Point	2'- 10 7/8"	2'- 10 7/8"	J3(i638)	Back	145 lb	290 lb	-	-

#### UNFACTORED REACTIONS

ID	Start Loc	End Loc	Source	Dead (D)	Live (L)	Snow (S)	Wind (W)
1	0'	0'- 5 1/2"	STL BM (i503)	412 lb	799 lb	-	-
2	3'- 8 9/16"	4'- 2 1/16"	4(i459)	429 lb	833 lb	-	-

#### DESIGN NOTES

- The dead loads used in the design of this member were applied to the structure as projected dead loads.
- Analysis and Design has been performed using precision loading from actual modeled conditions. Some loads may have been modified to simplify reporting.
- Tributary Loads have been generated based on actual spacing between members in the model which may differ from the default system spacing. The actual loads applied to the member are shown in the Specified Loads table.
- Transfer reactions may differ from design results as allowed per building codes and standard load distribution practices.
- This report is based on modeled conditions input by the user. Source information for the loads and supports are provided for reference only. Verify that all loads and support conditions are correct.
- Review all loads and reactions to ensure that the member/bearing/connector/structure can resist adequately. Unless already specified on this report, anchorage for uplift reactions to be specified by others. Installation of member and accessories (if required) as per manufacturer's instruction.
- Beam Stability Factor used in the calculation for Allowable Max Pos Moment (KL) = 1.00
- When the applied loads are coming from a member/post/wall above that does not sit directly on this beam, adequate load transfer elements, such as squash blocks, wall studs, or beveled plates are required to transfer the loads to this beam.



STRUCTURAL COMPONENT ONLY  
DWG # TF23091263

CITY OF RICHMOND HILL  
BUILDING DIVISION

05/01/2024

RECEIVED  
Per: joshua.nabua





BUILDER: **GREEN PARK HOMES**  
SITE: **Trinigroup Developments Inc.**  
MODEL: **VILLA 6**  
CITY: **RICHMOND HILL**

Job Name: **VILLA 6**  
Level: **2ND FLOOR**  
Label: **B12 - i1071**  
Type: **Beam**

**2 Ply Member**  
**1 3/4" x 11 7/8" (2.0E 3100)**  
**WestFraser LVL**

Status:  
**Design Passed**

Illustration Not to Scale. Pitch: 0/12

Designed by Single Member Design Engine in MiTek® Structure Version 8.6.3.353.Update16.11

Report Version: 2021.03.26 09/27/2023 08:18

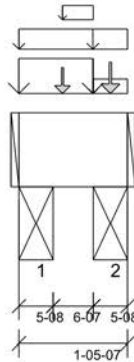

#### DESIGN INFORMATION

Building Code: NBCC 2015, Part9, BCBC 2018, ABC 2019, OBC 2012 (2019 Amendment)

Design Methodology: LSD

Service Condition: Dry

LL Deflection Limit: L/360,

TL Deflection Limit: L/240,

#### Lateral Restraint Requirements:

Both ends of the member and the outer supports must be laterally restrained. Top and bottom edges of the member must be fully restrained or have the following maximum unbraced length:

Top: 0' Bottom: 0'- 3 11/16"

#### Factored Resistance of Support Material:

- 615 psi Beam @ 0'- 4 1/2"
- 615 psi Beam @ 1'- 15/16"

#### ANALYSIS RESULTS

Design Criteria	Location	Load Combination	LDF	Design	Limit	Result
Factored Pos. Moment:	0'- 7"	1.25D + 1.5L	0.67	24 lb ft	23708 lb ft	Passed - 0%
Factored Shear:	1'- 5 3/8"	0.9D + 1.5L	0.67	98 lb	9267 lb	Passed - 1%

#### SUPPORT AND REACTION INFORMATION

ID	Input Bearing Length	Controlling Load Combination	LDF	Factored Downward Reaction	Factored Uplift Reaction	Factored Resistance of Member	Factored Resistance of Support	Result
1	5-08	1.25D + 1.5S + L	1.00	718 lb		20020 lb	11839 lb	Passed - 6%
2	5-08	1.25D + 1.5S + L	1.00	663 lb		20020 lb	11839 lb	Passed - 6%

#### SPECIFIED LOADS

Type	Start Loc	End Loc	Source	Face	Dead (D)	Live (L)	Snow (S)	Wind (W)
Self Weight	0'	1'- 5 7/16"	Self Weight	Top	12 lb/ft	-	-	-
Uniform	0'	1'- 5 7/16"	User Load	Top	60 lb/ft	-	77 lb/ft	-
Uniform	-0'	0'- 11 15/16"	E45(i513)	Top	216 lb/ft	-	240 lb/ft	-
Uniform	0'- 7"	0'- 11 15/16"	FC2 Floor Decking (Plan View Fill)	Top	3 lb/ft	6 lb/ft	-	-
Uniform	0'- 11 15/16"	1'- 5 7/16"	FC2 Floor Decking (Plan View Fill)	Top	4 lb/ft	8 lb/ft	-	-
Point	0'- 7"	0'- 7"	J5(i1074)	Back	48 lb	97 lb	-	-
Point	1'- 2 11/16"	1'- 2 11/16"	E71(i538)	Top	99 lb	-	110 lb	-

#### UNFACTORED REACTIONS

ID	Start Loc	End Loc	Source	Dead (D)	Live (L)	Snow (S)	Wind (W)
1	0'	0'- 5 1/2"	STL BM (i502)	269 lb	98 lb	243 lb	-
2	0'- 11 15/16"	1'- 5 7/16"	STL BM (i501)	201 lb	5 lb	218 lb	-

#### DESIGN NOTES

- The dead loads used in the design of this member were applied to the structure as projected dead loads.
- Lateral stability factor (KL) was based on user preference to use the width of all plies. (Consult with manufacturer for guideline pertaining to this design option.)
- Analysis and Design has been performed using precision loading from actual modeled conditions. Some loads may have been modified to simplify reporting.
- Tributary Loads have been generated based on actual spacing between members in the model which may differ from the default system spacing. The actual loads applied to the member are shown in the Specified Loads table.
- Transfer reactions may differ from design results as allowed per building codes and standard load distribution practices.
- This report is based on modeled conditions input by the user. Source information for the loads and supports are provided for reference only. Verify that all loads and support conditions are correct.
- Review all loads and reactions to ensure that the member/bearing/connector/structure can resist adequately. Unless already specified on this report, anchorage for uplift reactions to be specified by others. Installation of member and accessories (if required) as per manufacturer's instruction.
- Beam Stability Factor used in the calculation for Allowable Max Pos Moment (KL) = 1.00
- When the applied loads are coming from a member/post/wall above that does not sit directly on this beam, adequate load transfer elements, such as squash blocks, wall studs, or beveled plates are required to transfer the loads to this beam.

#### PLY TO PLY CONNECTION

- Member design assumed proper ply to ply connection by others. Fastener spacing along length of member must not exceed 4 times depth of member. Verify connection between plies according to code specification and follow the manufacturer's installation instruction. Loads assumed to be distributed equally to each ply.



STRUCTURAL COMPONENT ONLY  
DWG # TF23091264

CITY OF RICHMOND HILL  
BUILDING DIVISION

05/01/2024

RECEIVED  
Per: joshua.nabua





BUILDER: **GREEN PARK HOMES**  
SITE: **Trinigroup Developments Inc.**  
MODEL: **VILLA 6**  
CITY: **RICHMOND HILL**

Job Name: **VILLA 6 ELEV 1**  
Level: **2ND FLOOR**  
Label: **B13 - i1199**  
Type: **Beam**

**2 Ply Member**  
**1 3/4" x 11 7/8" (2.0E 3100)**  
**WestFraser LVL**

Status:  
**Design Passed**

Illustration Not to Scale. Pitch: 0/12

Designed by Single Member Design Engine in MiTek® Structure Version 8.6.3.353.Update16.11

Report Version: 2021.03.26 09/27/2023 09:34

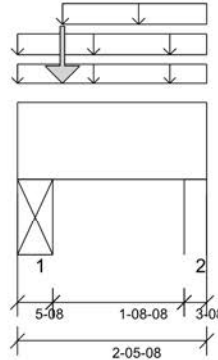

#### DESIGN INFORMATION

Building Code: NBCC 2015, Part9, BCBC 2018, ABC 2019, OBC 2012 (2019 Amendment)

Design Methodology: LSD

Service Condition: Dry

LL Deflection Limit: L/360,

TL Deflection Limit: L/240,

#### Lateral Restraint Requirements:

Both ends of the member and the outer supports must be laterally restrained. Top and bottom edges of the member must be fully restrained or have the following maximum unbraced length:

Top: 2'- 5 1/2" Bottom: 1'- 8 1/2"

#### Factored Resistance of Support Material:

- 615 psi Beam @ 0'- 4 1/2"
- 615 psi Wall @ 2'- 3"

#### ANALYSIS RESULTS

Design Criteria	Location	Load Combination	LDF	Design	Limit	Result
Factored Pos. Moment:	0'- 10 7/8"	1.25D + 1.5S	1.00	461 lb ft	35345 lb ft	Passed - 1%
Factored Shear:	1'- 5 3/8"	1.25D + 1.5S	1.00	283 lb	13815 lb	Passed - 2%

#### SUPPORT AND REACTION INFORMATION

ID	Input Bearing Length	Controlling Load Combination	LDF	Factored Downward Reaction	Factored Uplift Reaction	Factored Resistance of Member	Factored Resistance of Support	Result
1	5'-08	1.25D + 1.5S	1.00	2347 lb		20020 lb	11839 lb	Passed - 20%
2	3'-08	1.25D + 1.5S	1.00	811 lb		12740 lb	7536 lb	Passed - 11%

#### SPECIFIED LOADS

Type	Start Loc	End Loc	Source	Face	Dead (D)	Live (L)	Snow (S)	Wind (W)
Self Weight	0'	2'- 5 1/2"	Self Weight	Top	12 lb/ft	-	-	-
Uniform	0'	2'- 5 1/2"	User Load	Top	60 lb/ft	-	77 lb/ft	-
Uniform	0'- 7"	2'- 5 1/2"	E82(i1159)	Top	60 lb/ft	-	77 lb/ft	-
Tapered	0'	2'- 5 1/2"	E82(i1159)	Top	101 To 101 lb/ft	-	-	-
Point	0'- 7"	0'- 7"	E82(i1159)	Top	465 lb	-	936 lb	-

#### UNFACTORED REACTIONS

ID	Start Loc	End Loc	Source	Dead (D)	Live (L)	Snow (S)	Wind (W)
1	0'	0'- 5 1/2"	STL BM (i504)	746 lb	-	1102 lb	-
2	2'- 2"	2'- 5 1/2"	E14(i455)	257 lb	-	167 lb	-

#### DESIGN NOTES

- The dead loads used in the design of this member were applied to the structure as projected dead loads.
- Lateral stability factor (KL) was based on user preference to use the width of all plies. (Consult with manufacturer for guideline pertaining to this design option.)
- Analysis and Design has been performed using precision loading from actual modeled conditions. Some loads may have been modified to simplify reporting.
- Tributary Loads have been generated based on actual spacing between members in the model which may differ from the default system spacing. The actual loads applied to the member are shown in the Specified Loads table.
- Transfer reactions may differ from design results as allowed per building codes and standard load distribution practices.
- This report is based on modeled conditions input by the user. Source information for the loads and supports are provided for reference only. Verify that all loads and support conditions are correct.
- Review all loads and reactions to ensure that the member/bearing/connector/structure can resist adequately. Unless already specified on this report, anchorage for uplift reactions to be specified by others. Installation of member and accessories (if required) as per manufacturer's instruction.
- Beam Stability Factor used in the calculation for Allowable Max Pos Moment (KL) = 1.00
- When the applied loads are coming from a member/post/wall above that does not sit directly on this beam, adequate load transfer elements, such as squash blocks, wall studs, or beveled plates are required to transfer the loads to this beam.

#### PLY TO PLY CONNECTION

- Member design assumed proper ply to ply connection by others. Fastener spacing along length of member must not exceed 4 times depth of member. Verify connection between plies according to code specification and follow the manufacturer's installation instruction. Loads assumed to be distributed equally to each ply.

#### PLY TO PLY CONNECTION:

4 ROWS OF 3.25" PNEUMATIC GUN NAILS (0.120"x3.25") @ 4" O/C

PLY TO PLY CONNECTION ASSUMES ANY SUPPORTED BEAM HANGERS ARE FASTENED TO THIS BEAM WITH MIN. 3.5" FASTENERS.



STRUCTURAL COMPONENT ONLY  
DWG # TF23091265

CITY OF RICHMOND HILL  
BUILDING DIVISION

05/01/2024

RECEIVED  
Per: joshua.nabua





BUILDER: **GREEN PARK HOMES**  
SITE: **Trinigroup Developments Inc.**  
MODEL: **VILLA 6**  
CITY: **RICHMOND HILL**

Job Name: **VILLA 6**  
Level: **2ND FLOOR**  
Label: **B30 - i1096**  
Type: **Beam**

**2 Ply Member**  
**1 3/4" x 11 7/8" (2.0E 3100)**  
**WestFraser LVL**

Status:  
**Design Passed**

Illustration Not to Scale. Pitch: 0/12

Designed by Single Member Design Engine in MiTek® Structure Version  
8.6.3.353.Update16.11

Report Version: 2021.03.26 09-12-2023 09:51

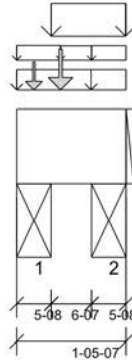

#### DESIGN INFORMATION

Building Code: NBCC 2015, Part9, BCBC 2018, ABC 2019, OBC 2012 (2019 Amendment)

Design Methodology: LSD

Service Condition: Dry

LL Deflection Limit: L/360,

TL Deflection Limit: L/240,

#### Lateral Restraint Requirements:

Both ends of the member and the outer supports must be laterally restrained. Top and bottom edges of the member must be fully restrained or have the following maximum unbraced length:

Top: 0' Bottom: 0'- 3 11/16"

#### Factored Resistance of Support Material:

- 615 psi Beam @ 0'- 4 1/2"
- 615 psi Beam @ 1'- 15/16"

**PLY TO PLY CONNECTION:**  
**4 ROWS OF 3.25" PNEUMATIC GUN**  
**NAILS (0.120"x3.25") @ 4" O/C**

PLY TO PLY CONNECTION ASSUMES ANY  
SUPPORTED BEAM HANGERS ARE FASTENED  
TO THIS BEAM WITH MIN. 3.5" FASTENERS.

#### ANALYSIS RESULTS

Design Criteria	Location	Load Combination	LDF	Design	Limit	Result
Factored Pos. Moment:	0'- 7"	1.25D + 1.5L	0.83	61 lb ft	29445 lb ft	Passed - 0%
Factored Shear:	1'- 5 3/8"	0.9D + 1.5L	0.83	220 lb	11509 lb	Passed - 2%

#### SUPPORT AND REACTION INFORMATION

ID	Input Bearing Length	Controlling Load Combination	LDF	Factored Downward Reaction	Factored Uplift Reaction	Factored Resistance of Member	Factored Resistance of Support	Result
1	5-08	1.25D + 1.5S + L	1.00	779 lb		20020 lb	11839 lb	Passed - 7%
2	5-08	1.25D + 1.5S + L	1.00	664 lb		20020 lb	11839 lb	Passed - 6%

#### SPECIFIED LOADS

Type	Start Loc	End Loc	Source	Face	Dead (D)	Live (L)	Snow (S)	Wind (W)
Self Weight	0'	1'- 5 7/16"	Self Weight	Top	12 lb/ft	-	-	-
Uniform	-0'	1'- 5 7/16"	User Load	Top	60 lb/ft	-	77 lb/ft	-
Uniform	-0'	0'- 7"	FC2 Floor Decking (Plan View Fill)	Top	6 lb/ft	12 lb/ft	-	-
Uniform	0'- 5 1/2"	1'- 5 7/16"	E82(i1363)	Top	196 lb/ft	-	203 lb/ft	-
Uniform	0'- 7"	0'- 11 15/16"	FC2 Floor Decking (Plan View Fill)	Top	3 lb/ft	6 lb/ft	-	-
Uniform	0'- 11 15/16"	1'- 5 7/16"	FC2 Floor Decking (Plan View Fill)	Top	4 lb/ft	8 lb/ft	-	-
Point	0'- 7"	0'- 7"	J2(i1421)	Front	106 lb	212 lb	-	-
Point	0'- 2 3/4"	0'- 2 3/4"	E69(i536)	Top	73 lb	-	93 lb	-

#### UNFACTORED REACTIONS

ID	Start Loc	End Loc	Source	Dead (D)	Live (L)	Snow (S)	Wind (W)
1	0'	0'- 5 1/2"	STL BM (i502)	312 lb	220 lb	236 lb	-
2	0'- 11 15/16"	1'- 5 7/16"	STL BM (i501)	174 lb	5 lb	171 lb	-

#### DESIGN NOTES

- The dead loads used in the design of this member were applied to the structure as projected dead loads.
- Lateral stability factor (KL) was based on user preference to use the width of all plies. (Consult with manufacturer for guideline pertaining to this design option.)
- Analysis and Design has been performed using precision loading from actual modeled conditions. Some loads may have been modified to simplify reporting.
- Tributary Loads have been generated based on actual spacing between members in the model which may differ from the default system spacing. The actual loads applied to the member are shown in the Specified Loads table.
- Transfer reactions may differ from design results as allowed per building codes and standard load distribution practices.
- This report is based on modeled conditions input by the user. Source information for the loads and supports are provided for reference only. Verify that all loads and support conditions are correct.
- Review all loads and reactions to ensure that the member/bearing/connector/structure can resist adequately. Unless already specified on this report, anchorage for uplift reactions to be specified by others. Installation of member and accessories (if required) as per manufacturer's instruction.
- Beam Stability Factor used in the calculation for Allowable Max Pos Moment (KL) = 1.00
- When the applied loads are coming from a member/post/wall above that does not sit directly on this beam, adequate load transfer elements, such as squash blocks, wall studs, or beveled plates are required to transfer the loads to this beam.

#### PLY TO PLY CONNECTION

- Member design assumed proper ply to ply connection by others. Fastener spacing along length of member must not exceed 4 times depth of member. Verify connection between plies according to code specification and follow the manufacturer's installation instruction. Loads assumed to be distributed equally to each ply.



STRUCTURAL COMPONENT ONLY  
DWG # TF23091266

CITY OF RICHMOND HILL  
BUILDING DIVISION

05/01/2024

RECEIVED  
Per: joshua.nabua





BUILDER: **GREEN PARK HOMES**  
SITE: **Trinigroup Developments Inc.**  
MODEL: **VILLA 6**  
CITY: **RICHMOND HILL**

Job Name: **VILLA 6 ELEV 2 &3**  
Level: **2ND FLOOR**  
Label: **B31 - i1438**  
Type: **Beam**

**2 Ply Member**  
**1 3/4" x 11 7/8" (2.0E 3100)**  
**WestFraser LVL**

Status:  
**Design Passed**

Illustration Not to Scale. Pitch: 0/12

Designed by Single Member Design Engine in MiTek® Structure Version 8.6.3.353.Update16.11

Report Version: 2021.03.26 09/27/2023 09:35

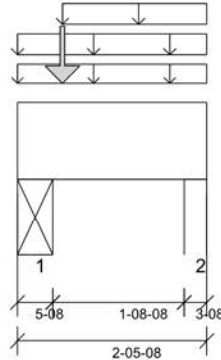

#### DESIGN INFORMATION

Building Code: NBCC 2015, Part9, BCBC 2018, ABC 2019, OBC 2012 (2019 Amendment)

Design Methodology: LSD

Service Condition: Dry

LL Deflection Limit: L/360,

TL Deflection Limit: L/240,

#### Lateral Restraint Requirements:

Both ends of the member and the outer supports must be laterally restrained. Top and bottom edges of the member must be fully restrained or have the following maximum unbraced length:

Top: 2'- 5 1/2" Bottom: 1'- 8 1/2"

#### Factored Resistance of Support Material:

- 615 psi Beam @ 0'- 4 1/2"
- 615 psi Wall @ 2'- 3"

#### ANALYSIS RESULTS

Design Criteria	Location	Load Combination	LDF	Design	Limit	Result
Factored Pos. Moment:	0'- 10 9/16"	1.25D + 1.5S	1.00	479 lb ft	35345 lb ft	Passed - 1%
Factored Shear:	1'- 5 3/8"	1.25D + 1.5S	1.00	296 lb	13815 lb	Passed - 2%

#### SUPPORT AND REACTION INFORMATION

ID	Input Bearing Length	Controlling Load Combination	LDF	Factored Downward Reaction	Factored Uplift Reaction	Factored Resistance of Member	Factored Resistance of Support	Result
1	5-08	1.25D + 1.5S	1.00	2451 lb		20020 lb	11839 lb	Passed - 21%
2	3-08	1.25D + 1.5S	1.00	824 lb		12748 lb	7541 lb	Passed - 11%

#### SPECIFIED LOADS

Type	Start Loc	End Loc	Source	Face	Dead (D)	Live (L)	Snow (S)	Wind (W)
Self Weight	0'	2'- 5 1/2"	Self Weight	Top	12 lb/ft	-	-	-
Uniform	0'	2'- 5 1/2"	User Load	Top	60 lb/ft	-	77 lb/ft	-
Uniform	0'- 7"	2'- 5 1/2"	E83(i1422)	Top	60 lb/ft	-	77 lb/ft	-
Tapered	0'	2'- 5 1/2"	E83(i1422)	Top	101 To 101 lb/ft	-	-	-
Point	0'- 7"	0'- 7"	E83(i1422)	Top	469 lb	-	1011 lb	-

#### UNFACTORED REACTIONS

ID	Start Loc	End Loc	Source	Dead (D)	Live (L)	Snow (S)	Wind (W)
1	0'	0'- 5 1/2"	STL BM (i504)	750 lb	-	1177 lb	-
2	2'- 2"	2'- 5 1/2"	E14(i455)	257 lb	-	167 lb	-

#### DESIGN NOTES

- The dead loads used in the design of this member were applied to the structure as projected dead loads.
- Lateral stability factor (KL) was based on user preference to use the width of all plies. (Consult with manufacturer for guideline pertaining to this design option.)
- Analysis and Design has been performed using precision loading from actual modeled conditions. Some loads may have been modified to simplify reporting.
- Tributary Loads have been generated based on actual spacing between members in the model which may differ from the default system spacing. The actual loads applied to the member are shown in the Specified Loads table.
- Transfer reactions may differ from design results as allowed per building codes and standard load distribution practices.
- This report is based on modeled conditions input by the user. Source information for the loads and supports are provided for reference only. Verify that all loads and support conditions are correct.
- Review all loads and reactions to ensure that the member/bearing/connector/structure can resist adequately. Unless already specified on this report, anchorage for uplift reactions to be specified by others. Installation of member and accessories (if required) as per manufacturer's instruction.
- Beam Stability Factor used in the calculation for Allowable Max Pos Moment (KL) = 1.00
- When the applied loads are coming from a member/post/wall above that does not sit directly on this beam, adequate load transfer elements, such as squash blocks, wall studs, or beveled plates are required to transfer the loads to this beam.

#### PLY TO PLY CONNECTION

- Member design assumed proper ply to ply connection by others. Fastener spacing along length of member must not exceed 4 times depth of member. Verify connection between plies according to code specification and follow the manufacturer's installation instruction. Loads assumed to be distributed equally to each ply.

#### PLY TO PLY CONNECTION:

4 ROWS OF 3.25" PNEUMATIC GUN NAILS (0.120"x3.25") @ 4" O/C

PLY TO PLY CONNECTION ASSUMES ANY SUPPORTED BEAM HANGERS ARE FASTENED TO THIS BEAM WITH MIN. 3.5" FASTENERS.



STRUCTURAL COMPONENT ONLY  
DWG # TF23091267

CITY OF RICHMOND HILL  
BUILDING DIVISION

05/01/2024

RECEIVED  
Per: joshua.nabua

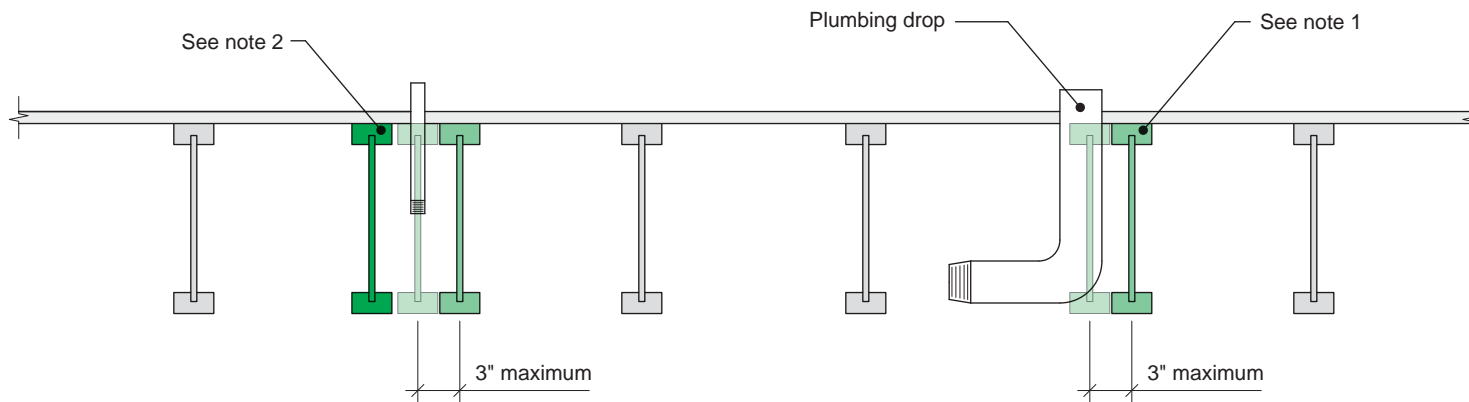

7c

**Notes:**

1. To prevent interference with plumbing, a joist may be shifted up to 3 inches if the edge of the floor panel is supported and the span rating is not exceeded.
2. In all other cases, an additional joist is required.

All nails shown in the details are assumed to be common nails unless otherwise noted. Nails shall have a diameter not less than 0.128 inch for 2-1/2-inch nails, or 0.144 inch for 3-inch nails. Individual components not shown to scale for clarity.



7d

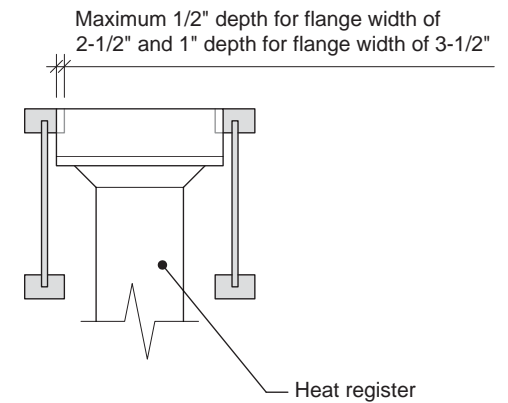
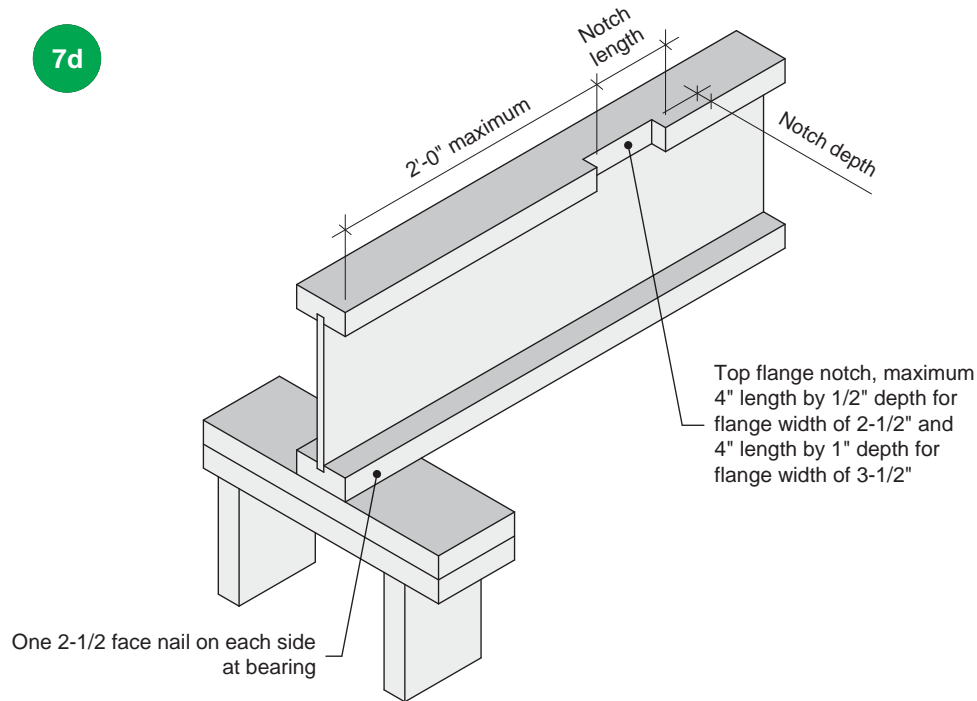

**Notes:**

1. Blocking required at bearing for lateral support, not shown for clarity.
2. The maximum dimensions for a notch on the side of the top flange are 4-inch length by 1/2-inch depth for flange width of 2-1/2 inches, and 4-inch length by 1-inch depth for flange width of 3-1/2 inches.
3. This detail applies to simple-span joists and multiple-span joists where the notch is located at the end half-span.
4. For other applications, contact Nordic Structures.

All nails shown in the details are assumed to be common nails unless otherwise noted. Nails shall have a diameter not less than 0.128 inch for 2-1/2-inch nails, or 0.144 inch for 3-inch nails. Individual components not shown to scale for clarity.



### Maximum Floor Spans – S2.1

#### Design Criteria

Spans:	Simple span
Loads:	Live load = 40 psf and dead load = 15 psf
Deflection limits:	L/480 under live load and L/240 under total load
Sheathing:	5/8 in. nailed-glued oriented strand board (OSB) sheathing

#### Maximum Floor Spans

Joist depth	Joist series	Bare On centre spacing				1/2 in. gypsum ceiling On centre spacing			
		12"	16"	19.2"	24"	12"	16"	19.2"	24"
9-1/2"	NI-20	15'-1"	14'-3"	13'-10"	-	15'-7"	14'-9"	14'-3"	-
	NI-40x	16'-2"	15'-3"	14'-8"	-	16'-7"	15'-8"	15'-1"	-
	NI-60	16'-4"	15'-4"	14'-10"	-	16'-9"	15'-9"	15'-3"	-
	NI-80	17'-3"	16'-3"	15'-8"	-	17'-8"	16'-7"	16'-0"	-
11-7/8"	NI-20	17'-0"	16'-0"	15'-6"	-	17'-6"	16'-7"	16'-0"	-
	NI-40x	18'-2"	17'-1"	16'-6"	-	18'-9"	17'-6"	16'-11"	-
	NI-60	18'-5"	17'-3"	16'-8"	-	19'-0"	17'-8"	17'-1"	-
	NI-80	19'-9"	18'-3"	17'-7"	-	20'-4"	18'-10"	18'-0"	-
	NI-90	20'-2"	18'-8"	17'-10"	-	20'-9"	19'-2"	18'-4"	-
14"	NI-40x	20'-1"	18'-8"	17'-10"	-	20'-10"	19'-4"	18'-6"	-
	NI-60	20'-6"	18'-11"	18'-2"	-	21'-2"	19'-8"	18'-9"	-
	NI-80	21'-11"	20'-3"	19'-4"	-	22'-7"	20'-11"	20'-0"	-
	NI-90	22'-5"	20'-8"	19'-9"	-	23'-0"	21'-4"	20'-4"	-
16"	NI-60	22'-4"	20'-8"	19'-9"	-	23'-1"	21'-5"	20'-6"	-
	NI-80	23'-11"	22'-1"	21'-1"	-	24'-8"	22'-10"	21'-9"	-
	NI-90	24'-5"	22'-6"	21'-6"	-	25'-1"	23'-2"	22'-2"	-

Joist depth	Joist series	Mid-span blocking with 1x4 inch strap On centre spacing				Mid-span blocking and 1/2 in. gypsum ceiling On centre spacing			
		12"	16"	19.2"	24"	12"	16"	19.2"	24"
9-1/2"	NI-20	16'-8"	15'-3"	14'-5"	-	16'-8"	15'-3"	14'-5"	-
	NI-40x	17'-11"	17'-0"	16'-1"	-	18'-5"	17'-1"	16'-1"	-
	NI-60	18'-2"	17'-1"	16'-4"	-	18'-8"	17'-4"	16'-4"	-
	NI-80	19'-5"	18'-0"	17'-5"	-	19'-10"	18'-5"	17'-8"	-
11-7/8"	NI-20	19'-7"	18'-2"	17'-3"	-	19'-11"	18'-3"	17'-3"	-
	NI-40x	21'-1"	19'-7"	18'-8"	-	21'-8"	20'-2"	19'-2"	-
	NI-60	21'-4"	19'-9"	18'-11"	-	21'-11"	20'-5"	19'-6"	-
	NI-80	22'-9"	21'-1"	20'-2"	-	23'-3"	21'-8"	20'-8"	-
	NI-90	23'-3"	21'-6"	20'-6"	-	23'-9"	22'-0"	21'-0"	-
14"	NI-40x	23'-8"	21'-11"	20'-11"	-	24'-4"	22'-8"	21'-8"	-
	NI-60	24'-0"	22'-3"	21'-3"	-	24'-8"	22'-11"	21'-11"	-
	NI-80	25'-7"	23'-9"	22'-7"	-	26'-2"	24'-4"	23'-3"	-
	NI-90	26'-1"	24'-2"	23'-0"	-	26'-8"	24'-9"	23'-7"	-
16"	NI-60	26'-5"	24'-6"	23'-5"	-	27'-2"	25'-3"	24'-2"	-
	NI-80	28'-2"	26'-1"	24'-10"	-	28'-10"	26'-9"	25'-6"	-
	NI-90	28'-8"	26'-6"	25'-3"	-	29'-3"	27'-2"	25'-11"	-

#### Notes:

- The tabulated clear spans are based on CSA O86-14 and NBC 2015, and are applicable to residential floor construction meeting the above design criteria.
- For multiple-span applications, the end spans shall be 40% or more of the adjacent span.
- Minimum bearing length shall be 1-3/4 inch for end bearings, and 3-1/2 inches for intermediate bearings.
- Bearing stiffeners are not required when I-joists are used in accordance with this table, except as required for hangers.
- Nordic I-joists are listed in CCMC Evaluation Report 13032-R and APA Product Report PR-L274C.



## Maximum Floor Spans – S4.1

### Design Criteria

Spans:	Simple span
Loads:	Live load = 40 psf and dead load = 15 psf
Deflection limits:	L/480 under live load and L/240 under total load
Sheathing:	3/4 in. nailed-glued oriented strand board (OSB) sheathing

### Maximum Floor Spans

Joist depth	Joist series	Bare On centre spacing				1/2 in. gypsum ceiling On centre spacing			
		12"	16"	19.2"	24"	12"	16"	19.2"	24"
9-1/2"	NI-20	15'-11"	15'-0"	14'-6"	13'-5"	16'-5"	15'-5"	14'-6"	13'-5"
	NI-40x	17'-0"	16'-0"	15'-5"	14'-10"	17'-5"	16'-5"	15'-10"	15'-2"
	NI-60	17'-2"	16'-2"	15'-7"	14'-11"	17'-7"	16'-7"	16'-0"	15'-4"
	NI-80	18'-3"	17'-1"	16'-5"	15'-9"	18'-8"	17'-5"	16'-9"	16'-1"
11-7/8"	NI-20	17'-11"	16'-11"	16'-3"	15'-8"	18'-7"	17'-5"	16'-10"	16'-2"
	NI-40x	19'-4"	17'-11"	17'-3"	16'-7"	19'-11"	18'-6"	17'-9"	17'-0"
	NI-60	19'-7"	18'-2"	17'-6"	16'-9"	20'-2"	18'-9"	17'-11"	17'-2"
	NI-80	21'-1"	19'-6"	18'-6"	17'-7"	21'-7"	20'-0"	19'-0"	18'-0"
	NI-90	21'-6"	19'-10"	18'-11"	17'-11"	22'-0"	20'-4"	19'-5"	18'-4"
14"	NI-40x	21'-5"	19'-11"	18'-11"	18'-0"	22'-1"	20'-7"	19'-7"	18'-7"
	NI-60	21'-10"	20'-2"	19'-3"	18'-3"	22'-6"	20'-10"	19'-11"	18'-10"
	NI-80	23'-5"	21'-7"	20'-7"	19'-5"	24'-0"	22'-3"	21'-2"	20'-0"
	NI-90	23'-10"	22'-1"	21'-0"	19'-10"	24'-5"	22'-7"	21'-6"	20'-4"
16"	NI-60	23'-9"	22'-0"	21'-0"	19'-10"	24'-6"	22'-9"	21'-8"	20'-7"
	NI-80	25'-6"	23'-7"	22'-5"	21'-2"	26'-2"	24'-3"	23'-1"	21'-10"
	NI-90	26'-0"	24'-0"	22'-10"	21'-6"	26'-7"	24'-8"	23'-5"	22'-2"

Joist depth	Joist series	Mid-span blocking with 1x4 inch strap On centre spacing				Mid-span blocking and 1/2 in. gypsum ceiling On centre spacing			
		12"	16"	19.2"	24"	12"	16"	19.2"	24"
9-1/2"	NI-20	16'-10"	15'-5"	14'-6"	13'-5"	16'-10"	15'-5"	14'-6"	13'-5"
	NI-40x	18'-8"	17'-2"	16'-3"	15'-2"	18'-10"	17'-2"	16'-3"	15'-2"
	NI-60	18'-11"	17'-6"	16'-6"	15'-5"	19'-2"	17'-6"	16'-6"	15'-5"
	NI-80	20'-3"	18'-10"	17'-11"	16'-10"	20'-8"	19'-3"	18'-2"	16'-10"
11-7/8"	NI-20	20'-1"	18'-5"	17'-5"	16'-2"	20'-1"	18'-5"	17'-5"	16'-2"
	NI-40x	21'-10"	20'-4"	19'-4"	17'-8"	22'-5"	20'-6"	19'-4"	17'-8"
	NI-60	22'-1"	20'-7"	19'-8"	18'-4"	22'-8"	20'-10"	19'-8"	18'-4"
	NI-80	23'-8"	22'-0"	20'-11"	19'-10"	24'-1"	22'-6"	21'-6"	20'-0"
	NI-90	24'-1"	22'-5"	21'-4"	20'-2"	24'-7"	22'-11"	21'-10"	20'-7"
14"	NI-40x	24'-5"	22'-9"	21'-9"	19'-5"	25'-1"	23'-2"	21'-9"	19'-5"
	NI-60	24'-10"	23'-2"	22'-1"	20'-10"	25'-6"	23'-8"	22'-4"	20'-10"
	NI-80	26'-6"	24'-8"	23'-6"	22'-2"	27'-1"	25'-3"	24'-1"	22'-9"
	NI-90	27'-0"	25'-1"	23'-11"	22'-7"	27'-6"	25'-8"	24'-6"	23'-2"
16"	NI-60	27'-3"	25'-5"	24'-3"	22'-11"	28'-0"	26'-2"	24'-9"	23'-1"
	NI-80	29'-1"	27'-1"	25'-9"	24'-4"	29'-8"	27'-9"	26'-5"	25'-0"
	NI-90	29'-7"	27'-6"	26'-2"	24'-9"	30'-2"	28'-2"	26'-10"	25'-5"

### Notes:

1. The tabulated clear spans are based on CSA O86-14 and NBC 2015, and are applicable to residential floor construction meeting the above design criteria.
2. For multiple-span applications, the end spans shall be 40% or more of the adjacent span.
3. Minimum bearing length shall be 1-3/4 inch for end bearings, and 3-1/2 inches for intermediate bearings.
4. Bearing stiffeners are not required when I-joists are used in accordance with this table, except as required for hangers.
5. Nordic I-joists are listed in CCMC Evaluation Report 13032-R and APA Product Report PR-L274C.



## Maximum Floor Spans – S6.1

### Design Criteria

Spans:	Simple span
Loads:	Live load = 40 psf and dead load = 15 psf
Deflection limits:	L/480 under live load and L/240 under total load
Sheathing:	5/8 in. nailed-glued Canadian softwood plywood

### Maximum Floor Spans

Joist depth	Joist series	Bare On centre spacing				1/2 in. gypsum ceiling On centre spacing			
		12"	16"	19.2"	24"	12"	16"	19.2"	24"
9-1/2"	NI-20	14'-11"	14'-1"	13'-7"	-	15'-4"	14'-6"	14'-1"	-
	NI-40x	15'-11"	15'-0"	14'-6"	-	16'-4"	15'-5"	14'-11"	-
	NI-60	16'-1"	15'-2"	14'-8"	-	16'-6"	15'-7"	15'-1"	-
	NI-80	17'-1"	16'-1"	15'-6"	-	17'-5"	16'-5"	15'-10"	-
11-7/8"	NI-20	16'-9"	15'-10"	15'-4"	-	17'-4"	16'-4"	15'-10"	-
	NI-40x	17'-10"	16'-10"	16'-3"	-	18'-6"	17'-4"	16'-9"	-
	NI-60	18'-1"	17'-0"	16'-5"	-	18'-9"	17'-6"	16'-11"	-
	NI-80	19'-6"	18'-0"	17'-4"	-	20'-1"	18'-7"	17'-9"	-
	NI-90	19'-11"	18'-4"	17'-8"	-	20'-5"	18'-11"	18'-1"	-
14"	NI-40x	19'-10"	18'-4"	17'-8"	-	20'-6"	19'-1"	18'-3"	-
	NI-60	20'-2"	18'-8"	17'-11"	-	20'-10"	19'-4"	18'-6"	-
	NI-80	21'-8"	20'-0"	19'-1"	-	22'-4"	20'-8"	19'-9"	-
	NI-90	22'-1"	20'-5"	19'-6"	-	22'-9"	21'-0"	20'-1"	-
16"	NI-60	22'-0"	20'-4"	19'-6"	-	22'-9"	21'-1"	20'-2"	-
	NI-80	23'-7"	21'-10"	20'-10"	-	24'-4"	22'-6"	21'-6"	-
	NI-90	24'-1"	22'-2"	21'-2"	-	24'-9"	22'-11"	21'-10"	-

Joist depth	Joist series	Mid-span blocking with 1x4 inch strap On centre spacing				Mid-span blocking and 1/2 in. gypsum ceiling On centre spacing			
		12"	16"	19.2"	24"	12"	16"	19.2"	24"
9-1/2"	NI-20	16'-6"	15'-1"	14'-3"	-	16'-6"	15'-1"	14'-3"	-
	NI-40x	17'-9"	16'-10"	15'-11"	-	18'-2"	16'-11"	15'-11"	-
	NI-60	17'-11"	16'-11"	16'-2"	-	18'-5"	17'-2"	16'-2"	-
	NI-80	19'-3"	17'-10"	17'-3"	-	19'-8"	18'-3"	17'-7"	-
11-7/8"	NI-20	19'-4"	18'-0"	17'-1"	-	19'-9"	18'-1"	17'-1"	-
	NI-40x	20'-10"	19'-4"	18'-6"	-	21'-5"	19'-11"	19'-0"	-
	NI-60	21'-1"	19'-7"	18'-8"	-	21'-8"	20'-2"	19'-3"	-
	NI-80	22'-6"	20'-10"	19'-11"	-	23'-1"	21'-5"	20'-5"	-
	NI-90	23'-0"	21'-3"	20'-4"	-	23'-6"	21'-10"	20'-10"	-
14"	NI-40x	23'-5"	21'-8"	20'-9"	-	24'-0"	22'-5"	21'-5"	-
	NI-60	23'-9"	22'-0"	21'-0"	-	24'-5"	22'-8"	21'-8"	-
	NI-80	25'-4"	23'-6"	22'-5"	-	25'-11"	24'-1"	23'-0"	-
	NI-90	25'-10"	23'-11"	22'-9"	-	26'-5"	24'-6"	23'-4"	-
16"	NI-60	26'-2"	24'-3"	23'-2"	-	26'-11"	25'-0"	23'-11"	-
	NI-80	27'-11"	25'-10"	24'-7"	-	28'-7"	26'-6"	25'-3"	-
	NI-90	28'-5"	26'-3"	25'-0"	-	29'-0"	26'-11"	25'-8"	-

### Notes:

1. The tabulated clear spans are based on CSA O86-14 and NBC 2015, and are applicable to residential floor construction meeting the above design criteria.
2. For multiple-span applications, the end spans shall be 40% or more of the adjacent span.
3. Minimum bearing length shall be 1-3/4 inch for end bearings, and 3-1/2 inches for intermediate bearings.
4. Bearing stiffeners are not required when I-joists are used in accordance with this table, except as required for hangers.
5. Nordic I-joists are listed in CCMC Evaluation Report 13032-R and APA Product Report PR-L274C.



## Maximum Floor Spans – S7.1

### Design Criteria

Spans:	Simple span
Loads:	Live load = 40 psf and dead load = 15 psf
Deflection limits:	L/480 under live load and L/240 under total load
Sheathing:	3/4 in. nailed-glued Canadian softwood plywood

### Maximum Floor Spans

Joist depth	Joist series	Bare On centre spacing				1/2 in. gypsum ceiling On centre spacing			
		12"	16"	19.2"	24"	12"	16"	19.2"	24"
9-1/2"	NI-20	15'-10"	15'-0"	14'-5"	13'-5"	16'-4"	15'-5"	14'-6"	13'-5"
	NI-40x	16'-11"	15'-11"	15'-4"	14'-9"	17'-4"	16'-4"	15'-9"	15'-1"
	NI-60	17'-1"	16'-1"	15'-6"	14'-10"	17'-6"	16'-6"	15'-11"	15'-3"
	NI-80	18'-1"	17'-0"	16'-4"	15'-8"	18'-7"	17'-4"	16'-8"	16'-0"
11-7/8"	NI-20	17'-10"	16'-10"	16'-2"	15'-7"	18'-5"	17'-4"	16'-9"	16'-1"
	NI-40x	19'-3"	17'-10"	17'-2"	16'-6"	19'-10"	18'-5"	17'-8"	16'-11"
	NI-60	19'-6"	18'-1"	17'-4"	16'-8"	20'-1"	18'-8"	17'-10"	17'-1"
	NI-80	20'-11"	19'-4"	18'-5"	17'-7"	21'-5"	19'-10"	18'-11"	17'-11"
	NI-90	21'-4"	19'-9"	18'-9"	17'-10"	21'-10"	20'-3"	19'-3"	18'-3"
14"	NI-40x	21'-4"	19'-9"	18'-10"	17'-11"	22'-0"	20'-5"	19'-6"	18'-6"
	NI-60	21'-8"	20'-1"	19'-2"	18'-2"	22'-4"	20'-9"	19'-9"	18'-9"
	NI-80	23'-3"	21'-6"	20'-5"	19'-4"	23'-10"	22'-1"	21'-0"	19'-11"
	NI-90	23'-9"	21'-11"	20'-10"	19'-8"	24'-3"	22'-6"	21'-5"	20'-3"
16"	NI-60	23'-7"	21'-10"	20'-10"	19'-9"	24'-4"	22'-7"	21'-7"	20'-5"
	NI-80	25'-4"	23'-5"	22'-3"	21'-1"	26'-0"	24'-1"	22'-11"	21'-8"
	NI-90	25'-10"	23'-10"	22'-8"	21'-5"	26'-5"	24'-6"	23'-4"	22'-0"

Joist depth	Joist series	Mid-span blocking with 1x4 inch strap On centre spacing				Mid-span blocking and 1/2 in. gypsum ceiling On centre spacing			
		12"	16"	19.2"	24"	12"	16"	19.2"	24"
9-1/2"	NI-20	16'-10"	15'-5"	14'-6"	13'-5"	16'-10"	15'-5"	14'-6"	13'-5"
	NI-40x	18'-7"	17'-2"	16'-3"	15'-2"	18'-10"	17'-2"	16'-3"	15'-2"
	NI-60	18'-10"	17'-6"	16'-6"	15'-5"	19'-1"	17'-6"	16'-6"	15'-5"
	NI-80	20'-2"	18'-9"	17'-11"	16'-10"	20'-7"	19'-2"	18'-2"	16'-10"
11-7/8"	NI-20	20'-1"	18'-5"	17'-5"	16'-2"	20'-1"	18'-5"	17'-5"	16'-2"
	NI-40x	21'-9"	20'-3"	19'-4"	17'-8"	22'-4"	20'-5"	19'-4"	17'-8"
	NI-60	22'-0"	20'-6"	19'-7"	18'-4"	22'-7"	20'-10"	19'-8"	18'-4"
	NI-80	23'-6"	21'-10"	20'-10"	19'-9"	24'-0"	22'-5"	21'-4"	20'-0"
	NI-90	24'-0"	22'-4"	21'-3"	20'-1"	24'-6"	22'-10"	21'-9"	20'-7"
14"	NI-40x	24'-4"	22'-8"	21'-8"	19'-5"	25'-0"	23'-2"	21'-9"	19'-5"
	NI-60	24'-9"	23'-0"	22'-0"	20'-9"	25'-5"	23'-8"	22'-4"	20'-10"
	NI-80	26'-5"	24'-6"	23'-4"	22'-1"	27'-0"	25'-2"	24'-0"	22'-8"
	NI-90	26'-11"	25'-0"	23'-10"	22'-6"	27'-5"	25'-7"	24'-5"	23'-1"
16"	NI-60	27'-2"	25'-4"	24'-2"	22'-10"	27'-11"	26'-1"	24'-9"	23'-1"
	NI-80	29'-0"	26'-11"	25'-8"	24'-3"	29'-7"	27'-7"	26'-4"	24'-11"
	NI-90	29'-6"	27'-5"	26'-1"	24'-8"	30'-1"	28'-1"	26'-9"	25'-4"

### Notes:

1. The tabulated clear spans are based on CSA O86-14 and NBC 2015, and are applicable to residential floor construction meeting the above design criteria.
2. For multiple-span applications, the end spans shall be 40% or more of the adjacent span.
3. Minimum bearing length shall be 1-3/4 inch for end bearings, and 3-1/2 inches for intermediate bearings.
4. Bearing stiffeners are not required when I-joists are used in accordance with this table, except as required for hangers.
5. Nordic I-joists are listed in CCMC Evaluation Report 13032-R and APA Product Report PR-L274C.



## Maximum Floor Spans – M2.1

### Design Criteria

Spans:	Simple span
Loads:	Live load = 40 psf and dead load = 20 psf
Deflection limits:	L/480 under live load and L/240 under total load
Sheathing:	5/8 in. nailed-glued oriented strand board (OSB) sheathing

### Maximum Floor Spans

Joist depth	Joist series	Bare On centre spacing				1/2 in. gypsum ceiling On centre spacing			
		12"	16"	19.2"	24"	12"	16"	19.2"	24"
9-1/2"	NI-20	15'-1"	14'-3"	13'-10"	-	15'-7"	14'-9"	14'-3"	-
	NI-40x	16'-2"	15'-3"	14'-8"	-	16'-7"	15'-8"	15'-1"	-
	NI-60	16'-4"	15'-4"	14'-10"	-	16'-9"	15'-9"	15'-3"	-
	NI-80	17'-3"	16'-3"	15'-8"	-	17'-8"	16'-7"	16'-0"	-
11-7/8"	NI-20	17'-0"	16'-0"	15'-6"	-	17'-6"	16'-7"	16'-0"	-
	NI-40x	18'-2"	17'-1"	16'-6"	-	18'-9"	17'-6"	16'-11"	-
	NI-60	18'-5"	17'-3"	16'-8"	-	19'-0"	17'-8"	17'-1"	-
	NI-80	19'-9"	18'-3"	17'-7"	-	20'-4"	18'-10"	18'-0"	-
	NI-90	20'-2"	18'-8"	17'-10"	-	20'-9"	19'-2"	18'-4"	-
14"	NI-40x	20'-1"	18'-8"	17'-10"	-	20'-10"	19'-4"	18'-6"	-
	NI-60	20'-6"	18'-11"	18'-2"	-	21'-2"	19'-8"	18'-9"	-
	NI-80	21'-11"	20'-3"	19'-4"	-	22'-7"	20'-11"	20'-0"	-
	NI-90	22'-5"	20'-8"	19'-9"	-	23'-0"	21'-4"	20'-4"	-
16"	NI-60	22'-4"	20'-8"	19'-9"	-	23'-1"	21'-5"	20'-6"	-
	NI-80	23'-11"	22'-1"	21'-1"	-	24'-8"	22'-10"	21'-9"	-
	NI-90	24'-5"	22'-6"	21'-6"	-	25'-1"	23'-2"	22'-2"	-

Joist depth	Joist series	Mid-span blocking with 1x4 inch strap On centre spacing				Mid-span blocking and 1/2 in. gypsum ceiling On centre spacing			
		12"	16"	19.2"	24"	12"	16"	19.2"	24"
9-1/2"	NI-20	16'-8"	15'-3"	14'-5"	-	16'-8"	15'-3"	14'-5"	-
	NI-40x	17'-11"	17'-0"	16'-1"	-	18'-5"	17'-1"	16'-1"	-
	NI-60	18'-2"	17'-1"	16'-4"	-	18'-8"	17'-4"	16'-4"	-
	NI-80	19'-5"	18'-0"	17'-5"	-	19'-10"	18'-5"	17'-8"	-
11-7/8"	NI-20	19'-7"	18'-2"	17'-3"	-	19'-11"	18'-3"	17'-3"	-
	NI-40x	21'-1"	19'-7"	18'-8"	-	21'-8"	20'-2"	19'-0"	-
	NI-60	21'-4"	19'-9"	18'-11"	-	21'-11"	20'-5"	19'-6"	-
	NI-80	22'-9"	21'-1"	20'-2"	-	23'-3"	21'-8"	20'-8"	-
	NI-90	23'-3"	21'-6"	20'-6"	-	23'-9"	22'-0"	21'-0"	-
14"	NI-40x	23'-8"	21'-11"	20'-11"	-	24'-4"	22'-8"	20'-11"	-
	NI-60	24'-0"	22'-3"	21'-3"	-	24'-8"	22'-11"	21'-11"	-
	NI-80	25'-7"	23'-9"	22'-7"	-	26'-2"	24'-4"	23'-3"	-
	NI-90	26'-1"	24'-2"	23'-0"	-	26'-8"	24'-9"	23'-7"	-
16"	NI-60	26'-5"	24'-6"	23'-5"	-	27'-2"	25'-3"	24'-2"	-
	NI-80	28'-2"	26'-1"	24'-10"	-	28'-10"	26'-9"	25'-6"	-
	NI-90	28'-8"	26'-6"	25'-3"	-	29'-3"	27'-2"	25'-11"	-

### Notes:

1. The tabulated clear spans are based on CSA O86-14 and NBC 2015, and are applicable to residential floor construction meeting the above design criteria.
2. For multiple-span applications, the end spans shall be 40% or more of the adjacent span.
3. Minimum bearing length shall be 1-3/4 inch for end bearings, and 3-1/2 inches for intermediate bearings.
4. Bearing stiffeners are not required when I-joists are used in accordance with this table, except as required for hangers.
5. Nordic I-joists are listed in CCMC Evaluation Report 13032-R and APA Product Report PR-L274C.



## Maximum Floor Spans – M4.1

### Design Criteria

Spans:	Simple span
Loads:	Live load = 40 psf and dead load = 20 psf
Deflection limits:	L/480 under live load and L/240 under total load
Sheathing:	3/4 in. nailed-glued oriented strand board (OSB) sheathing

### Maximum Floor Spans

Joist depth	Joist series	Bare On centre spacing				1/2 in. gypsum ceiling On centre spacing			
		12"	16"	19.2"	24"	12"	16"	19.2"	24"
9-1/2"	NI-20	15'-11"	15'-0"	14'-6"	13'-5"	16'-5"	15'-5"	14'-6"	13'-5"
	NI-40x	17'-0"	16'-0"	15'-5"	14'-10"	17'-5"	16'-5"	15'-10"	14'-11"
	NI-60	17'-2"	16'-2"	15'-7"	14'-11"	17'-7"	16'-7"	16'-0"	15'-4"
	NI-80	18'-3"	17'-1"	16'-5"	15'-9"	18'-8"	17'-5"	16'-9"	16'-1"
11-7/8"	NI-20	17'-11"	16'-11"	16'-3"	15'-8"	18'-7"	17'-5"	16'-10"	16'-1"
	NI-40x	19'-4"	17'-11"	17'-3"	16'-7"	19'-11"	18'-6"	17'-9"	17'-0"
	NI-60	19'-7"	18'-2"	17'-6"	16'-9"	20'-2"	18'-9"	17'-11"	17'-2"
	NI-80	21'-1"	19'-6"	18'-6"	17'-7"	21'-7"	20'-0"	19'-0"	18'-0"
	NI-90	21'-6"	19'-10"	18'-11"	17'-11"	22'-0"	20'-4"	19'-5"	18'-4"
14"	NI-40x	21'-5"	19'-11"	18'-11"	18'-0"	22'-1"	20'-7"	19'-7"	18'-7"
	NI-60	21'-10"	20'-2"	19'-3"	18'-3"	22'-6"	20'-10"	19'-11"	18'-10"
	NI-80	23'-5"	21'-7"	20'-7"	19'-5"	24'-0"	22'-3"	21'-2"	20'-0"
	NI-90	23'-10"	22'-1"	21'-0"	19'-10"	24'-5"	22'-7"	21'-6"	20'-4"
16"	NI-60	23'-9"	22'-0"	21'-0"	19'-10"	24'-6"	22'-9"	21'-8"	20'-7"
	NI-80	25'-6"	23'-7"	22'-5"	21'-2"	26'-2"	24'-3"	23'-1"	21'-10"
	NI-90	26'-0"	24'-0"	22'-10"	21'-6"	26'-7"	24'-8"	23'-5"	22'-2"

Joist depth	Joist series	Mid-span blocking with 1x4 inch strap On centre spacing				Mid-span blocking and 1/2 in. gypsum ceiling On centre spacing			
		12"	16"	19.2"	24"	12"	16"	19.2"	24"
9-1/2"	NI-20	16'-10"	15'-5"	14'-6"	13'-5"	16'-10"	15'-5"	14'-6"	13'-5"
	NI-40x	18'-8"	17'-2"	16'-3"	14'-11"	18'-10"	17'-2"	16'-3"	14'-11"
	NI-60	18'-11"	17'-6"	16'-6"	15'-5"	19'-2"	17'-6"	16'-6"	15'-5"
	NI-80	20'-3"	18'-10"	17'-11"	16'-10"	20'-8"	19'-3"	18'-2"	16'-10"
11-7/8"	NI-20	20'-1"	18'-5"	17'-5"	16'-1"	20'-1"	18'-5"	17'-5"	16'-1"
	NI-40x	21'-10"	20'-4"	19'-0"	17'-0"	22'-5"	20'-6"	19'-0"	17'-0"
	NI-60	22'-1"	20'-7"	19'-8"	18'-4"	22'-8"	20'-10"	19'-8"	18'-4"
	NI-80	23'-8"	22'-0"	20'-11"	19'-10"	24'-1"	22'-6"	21'-6"	20'-0"
	NI-90	24'-1"	22'-5"	21'-4"	20'-2"	24'-7"	22'-11"	21'-10"	20'-7"
14"	NI-40x	24'-5"	22'-9"	20'-11"	18'-8"	25'-1"	22'-11"	20'-11"	18'-8"
	NI-60	24'-10"	23'-2"	22'-1"	20'-10"	25'-6"	23'-8"	22'-4"	20'-10"
	NI-80	26'-6"	24'-8"	23'-6"	22'-2"	27'-1"	25'-3"	24'-1"	22'-9"
	NI-90	27'-0"	25'-1"	23'-11"	22'-7"	27'-6"	25'-8"	24'-6"	23'-2"
16"	NI-60	27'-3"	25'-5"	24'-3"	22'-11"	28'-0"	26'-2"	24'-9"	23'-1"
	NI-80	29'-1"	27'-1"	25'-9"	24'-4"	29'-8"	27'-9"	26'-5"	25'-0"
	NI-90	29'-7"	27'-6"	26'-2"	24'-9"	30'-2"	28'-2"	26'-10"	25'-5"

### Notes:

1. The tabulated clear spans are based on CSA O86-14 and NBC 2015, and are applicable to residential floor construction meeting the above design criteria.
2. For multiple-span applications, the end spans shall be 40% or more of the adjacent span.
3. Minimum bearing length shall be 1-3/4 inch for end bearings, and 3-1/2 inches for intermediate bearings.
4. Bearing stiffeners are not required when I-joists are used in accordance with this table, except as required for hangers.
5. Nordic I-joists are listed in CCMC Evaluation Report 13032-R and APA Product Report PR-L274C.



## Maximum Floor Spans – M6.1

### Design Criteria

Spans:	Simple span
Loads:	Live load = 40 psf and dead load = 20 psf
Deflection limits:	L/480 under live load and L/240 under total load
Sheathing:	5/8 in. nailed-glued Canadian softwood plywood

### Maximum Floor Spans

Joist depth	Joist series	Bare On centre spacing				1/2 in. gypsum ceiling On centre spacing			
		12"	16"	19.2"	24"	12"	16"	19.2"	24"
9-1/2"	NI-20	14'-11"	14'-1"	13'-7"	-	15'-4"	14'-6"	14'-1"	-
	NI-40x	15'-11"	15'-0"	14'-6"	-	16'-4"	15'-5"	14'-11"	-
	NI-60	16'-1"	15'-2"	14'-8"	-	16'-6"	15'-7"	15'-1"	-
	NI-80	17'-1"	16'-1"	15'-6"	-	17'-5"	16'-5"	15'-10"	-
11-7/8"	NI-20	16'-9"	15'-10"	15'-4"	-	17'-4"	16'-4"	15'-10"	-
	NI-40x	17'-10"	16'-10"	16'-3"	-	18'-6"	17'-4"	16'-9"	-
	NI-60	18'-1"	17'-0"	16'-5"	-	18'-9"	17'-6"	16'-11"	-
	NI-80	19'-6"	18'-0"	17'-4"	-	20'-1"	18'-7"	17'-9"	-
	NI-90	19'-11"	18'-4"	17'-8"	-	20'-5"	18'-11"	18'-1"	-
14"	NI-40x	19'-10"	18'-4"	17'-8"	-	20'-6"	19'-1"	18'-3"	-
	NI-60	20'-2"	18'-8"	17'-11"	-	20'-10"	19'-4"	18'-6"	-
	NI-80	21'-8"	20'-0"	19'-1"	-	22'-4"	20'-8"	19'-9"	-
	NI-90	22'-1"	20'-5"	19'-6"	-	22'-9"	21'-0"	20'-1"	-
16"	NI-60	22'-0"	20'-4"	19'-6"	-	22'-9"	21'-1"	20'-2"	-
	NI-80	23'-7"	21'-10"	20'-10"	-	24'-4"	22'-6"	21'-6"	-
	NI-90	24'-1"	22'-2"	21'-2"	-	24'-9"	22'-11"	21'-10"	-

Joist depth	Joist series	Mid-span blocking with 1x4 inch strap On centre spacing				Mid-span blocking and 1/2 in. gypsum ceiling On centre spacing			
		12"	16"	19.2"	24"	12"	16"	19.2"	24"
9-1/2"	NI-20	16'-6"	15'-1"	14'-3"	-	16'-6"	15'-1"	14'-3"	-
	NI-40x	17'-9"	16'-10"	15'-11"	-	18'-2"	16'-11"	15'-11"	-
	NI-60	17'-11"	16'-11"	16'-2"	-	18'-5"	17'-2"	16'-2"	-
	NI-80	19'-3"	17'-10"	17'-3"	-	19'-8"	18'-3"	17'-7"	-
11-7/8"	NI-20	19'-4"	18'-0"	17'-1"	-	19'-9"	18'-1"	17'-1"	-
	NI-40x	20'-10"	19'-4"	18'-6"	-	21'-5"	19'-11"	19'-0"	-
	NI-60	21'-1"	19'-7"	18'-8"	-	21'-8"	20'-2"	19'-3"	-
	NI-80	22'-6"	20'-10"	19'-11"	-	23'-1"	21'-5"	20'-5"	-
	NI-90	23'-0"	21'-3"	20'-4"	-	23'-6"	21'-10"	20'-10"	-
14"	NI-40x	23'-5"	21'-8"	20'-9"	-	24'-0"	22'-5"	20'-11"	-
	NI-60	23'-9"	22'-0"	21'-0"	-	24'-5"	22'-8"	21'-8"	-
	NI-80	25'-4"	23'-6"	22'-5"	-	25'-11"	24'-1"	23'-0"	-
	NI-90	25'-10"	23'-11"	22'-9"	-	26'-5"	24'-6"	23'-4"	-
16"	NI-60	26'-2"	24'-3"	23'-2"	-	26'-11"	25'-0"	23'-11"	-
	NI-80	27'-11"	25'-10"	24'-7"	-	28'-7"	26'-6"	25'-3"	-
	NI-90	28'-5"	26'-3"	25'-0"	-	29'-0"	26'-11"	25'-8"	-

### Notes:

- The tabulated clear spans are based on CSA O86-14 and NBC 2015, and are applicable to residential floor construction meeting the above design criteria.
- For multiple-span applications, the end spans shall be 40% or more of the adjacent span.
- Minimum bearing length shall be 1-3/4 inch for end bearings, and 3-1/2 inches for intermediate bearings.
- Bearing stiffeners are not required when I-joists are used in accordance with this table, except as required for hangers.
- Nordic I-joists are listed in CCMC Evaluation Report 13032-R and APA Product Report PR-L274C.



## Maximum Floor Spans – M7.1

### Design Criteria

Spans:	Simple span
Loads:	Live load = 40 psf and dead load = 20 psf
Deflection limits:	L/480 under live load and L/240 under total load
Sheathing:	3/4 in. nailed-glued Canadian softwood plywood

### Maximum Floor Spans

Joist depth	Joist series	Bare On centre spacing				1/2 in. gypsum ceiling On centre spacing			
		12"	16"	19.2"	24"	12"	16"	19.2"	24"
9-1/2"	NI-20	15'-10"	15'-0"	14'-5"	13'-5"	16'-4"	15'-5"	14'-6"	13'-5"
	NI-40x	16'-11"	15'-11"	15'-4"	14'-9"	17'-4"	16'-4"	15'-9"	14'-11"
	NI-60	17'-1"	16'-1"	15'-6"	14'-10"	17'-6"	16'-6"	15'-11"	15'-3"
	NI-80	18'-1"	17'-0"	16'-4"	15'-8"	18'-7"	17'-4"	16'-8"	16'-0"
11-7/8"	NI-20	17'-10"	16'-10"	16'-2"	15'-7"	18'-5"	17'-4"	16'-9"	16'-1"
	NI-40x	19'-3"	17'-10"	17'-2"	16'-6"	19'-10"	18'-5"	17'-8"	16'-11"
	NI-60	19'-6"	18'-1"	17'-4"	16'-8"	20'-1"	18'-8"	17'-10"	17'-1"
	NI-80	20'-11"	19'-4"	18'-5"	17'-7"	21'-5"	19'-10"	18'-11"	17'-11"
	NI-90	21'-4"	19'-9"	18'-9"	17'-10"	21'-10"	20'-3"	19'-3"	18'-3"
14"	NI-40x	21'-4"	19'-9"	18'-10"	17'-11"	22'-0"	20'-5"	19'-6"	18'-6"
	NI-60	21'-8"	20'-1"	19'-2"	18'-2"	22'-4"	20'-9"	19'-9"	18'-9"
	NI-80	23'-3"	21'-6"	20'-5"	19'-4"	23'-10"	22'-1"	21'-0"	19'-11"
	NI-90	23'-9"	21'-11"	20'-10"	19'-8"	24'-3"	22'-6"	21'-5"	20'-3"
16"	NI-60	23'-7"	21'-10"	20'-10"	19'-9"	24'-4"	22'-7"	21'-7"	20'-5"
	NI-80	25'-4"	23'-5"	22'-3"	21'-1"	26'-0"	24'-1"	22'-11"	21'-8"
	NI-90	25'-10"	23'-10"	22'-8"	21'-5"	26'-5"	24'-6"	23'-4"	22'-0"

Joist depth	Joist series	Mid-span blocking with 1x4 inch strap On centre spacing				Mid-span blocking and 1/2 in. gypsum ceiling On centre spacing			
		12"	16"	19.2"	24"	12"	16"	19.2"	24"
9-1/2"	NI-20	16'-10"	15'-5"	14'-6"	13'-5"	16'-10"	15'-5"	14'-6"	13'-5"
	NI-40x	18'-7"	17'-2"	16'-3"	14'-11"	18'-10"	17'-2"	16'-3"	14'-11"
	NI-60	18'-10"	17'-6"	16'-6"	15'-5"	19'-1"	17'-6"	16'-6"	15'-5"
	NI-80	20'-2"	18'-9"	17'-11"	16'-10"	20'-7"	19'-2"	18'-2"	16'-10"
11-7/8"	NI-20	20'-1"	18'-5"	17'-5"	16'-1"	20'-1"	18'-5"	17'-5"	16'-1"
	NI-40x	21'-9"	20'-3"	19'-0"	17'-0"	22'-4"	20'-5"	19'-0"	17'-0"
	NI-60	22'-0"	20'-6"	19'-7"	18'-4"	22'-7"	20'-10"	19'-8"	18'-4"
	NI-80	23'-6"	21'-10"	20'-10"	19'-9"	24'-0"	22'-5"	21'-4"	20'-0"
	NI-90	24'-0"	22'-4"	21'-3"	20'-1"	24'-6"	22'-10"	21'-9"	20'-7"
14"	NI-40x	24'-4"	22'-8"	20'-11"	18'-8"	25'-0"	22'-11"	20'-11"	18'-8"
	NI-60	24'-9"	23'-0"	22'-0"	20'-9"	25'-5"	23'-8"	22'-4"	20'-10"
	NI-80	26'-5"	24'-6"	23'-4"	22'-1"	27'-0"	25'-2"	24'-0"	22'-8"
	NI-90	26'-11"	25'-0"	23'-10"	22'-6"	27'-5"	25'-7"	24'-5"	23'-1"
16"	NI-60	27'-2"	25'-4"	24'-2"	22'-10"	27'-11"	26'-1"	24'-9"	23'-1"
	NI-80	29'-0"	26'-11"	25'-8"	24'-3"	29'-7"	27'-7"	26'-4"	24'-11"
	NI-90	29'-6"	27'-5"	26'-1"	24'-8"	30'-1"	28'-1"	26'-9"	25'-4"

### Notes:

- The tabulated clear spans are based on CSA O86-14 and NBC 2015, and are applicable to residential floor construction meeting the above design criteria.
- For multiple-span applications, the end spans shall be 40% or more of the adjacent span.
- Minimum bearing length shall be 1-3/4 inch for end bearings, and 3-1/2 inches for intermediate bearings.
- Bearing stiffeners are not required when I-joists are used in accordance with this table, except as required for hangers.
- Nordic I-joists are listed in CCMC Evaluation Report 13032-R and APA Product Report PR-L274C.