

CONSTRUCTION SUMMARY

Palmetto - Zadorra Estates Corp.

RECEIVED

PURCHASERS: Ziyad OVINAGATH KAMOOKAGATH and Shanima Mohammed CHALUPARAMBATH
CHULLIAM

JAN 16 2024

TEL: RES.: 416-371-7925

LOT / PHASE 156 / 1	REG. PLAN #	HOUSE TYPE Penrose 2 Elev 2		
------------------------	-------------	--------------------------------	--	--

CABINETRY

1 - KITCHEN CABINETRY - TWO COLOUR KITCHEN - FLAT FEE 15Jan24 Note:	
1 - KITCHEN - DELETE CABINETS ABOVE STOVE AND HOOD FAN - VENDOR WILL SUPPLY 6 INCH VENT AS PER CONSTRUCTION SPECIFICATIONS AND VENT MAY NOT BE IN THE APPROPRIATE LOCATION FOR INSTALLATION OF PURCHASER SUPPLIED FAN 15Jan24 Note: PURCHASER TO SUPPLY AND INSTALL OWN FAN AFTER CLOSING PURCHASER IS AWARE THAT SPECS SHOW 8" VENT VENDOR WILL ONLY PROVIDE 6" VENT	
1 - CABINETRY - KITCHEN - UPGRADE 3 15Jan24 Note:	
1 - CABINETRY PROVISION - PROVISION FOR PLUG ON ISLAND (PLUG EXTRA ORDERED SEPARATELY) 23Oct23 Note:	

CABINETRY ACCESSORIES

1 - KITCHEN CABINETRY - PANTRY UNIT UPGRADE - TO GO FROM 300MM TO 600MM DEEP - PRICE IS PER FOOT - UPGRADE 3 15Jan24 Note:	
1 - KITCHEN CABINETRY UPPER - FULL DEPTH ABOVE FRIDGE UPPER WITH GABLES - 650MM DEEP - PRICE IS EACH 15Jan24 Note:	
1 - KITCHEN CABINETRY BASE - COOKTOP CABINET WITH POT DRAWERS (2 DRAWERS) - UPGRADE 3 15Jan24 Note:	
1 - KITCHEN CABINETRY - BUILT-IN MICROWAVE/OVEN COMBO WITH ONE POT DRAWER - UPGRADE 3 15Jan24 Note:	
1 - KITCHEN CABINETRY BASE - PIE CUT CORNER CABINET - BASE CABINETRY - UPGRADE 3 15Jan24 Note:	
1 - KITCHEN CABINETRY BASE - PULLOUT RECYCLE 2 BIN - PRICE IS EACH 15Jan24 Note:	

CONSTRUCTION

1 - PROVISION FOR POT FILLER IN KITCHEN - IF CONSTRICITION PERMITS 23Oct23 Note:	
1 - PRIMARY ENSUITE - PROVISION FOR SHAMPOO NICHE APPROX. 14" WIDE X 20" HIGH AS PER SKETCH – IF CONSTRUCTION PERMITS PRIMARY ENSUITE 23Oct23 Note:	
3 - ENLARGED BASEMENT WINDOWS (MAY REQUIRE WINDOW WELLS) - WINDOW IS 30 INCHES X 24 INCHES 05Jul23 Note:	
1 - FIRST FLOOR INCREASE CEILING HEIGHT FROM 9 FEET TO 10 FEET 05Jul23 Note:	

COUNTER TOP

CONSTRUCTION SUMMARY

Palmetto - Zadorra Estates Corp.

PURCHASERS: Ziyad OVINAGATH KAMOOKAGATH and Shanima Mohammed CHALUPARAMBATH
CHULLIAM

TEL: RES.: 416-371-7925

LOT / PHASE 156 / 1	REG. PLAN #	HOUSE TYPE Penrose 2 Elev 2		
------------------------	-------------	--------------------------------	--	--

1 - SHAMPOO NICHE 14" WIDE X 20" HIGH AS PER SKETCH – MARBLE, GRANITE OR QUARTZ – IF CONSTRUCTION PERMITS - REQUIRES PROVISION FROM CONSTRUCTION	
PRIMARY ENSUITE 23Oct23 Note: SUPPLY & INSTALL	

ELECTRICAL

1 - BUILT IN OVEN AND COOKTOP PROVISION - PROVISION ONLY - ELECTRICAL ONLY 15Jan24 Note:	
3 - PLUG - ELECTRICAL PLUG WITH GFI - NEXT TO TOILET PRIMARY ENSUITE/ENSUITE 3/4/ENSUITE 2 23Oct23 Note:	
1 - PLUG - ELECTRICAL PLUG - ADD TO ISLAND 23Oct23 Note:	
1 - STANDARD DINING ROOM LIGHT TO BE CENTERED BETWEEN LIVING AND DINING ROOM 23Oct23 Note:	
1 - ABOVE KITCHEN ISLAND - ADD LIGHT AND SWITCH - NO FIXTURE INCLUDED 23Oct23 Note:	

FIREPLACE AND ACCESSORIES

1 - GAS LINE ROUGH-IN FOR STOVE (INCLUDES ELECTRICAL OUTLET) - FIRST FLOOR 23Oct23 Note:	
--	--

HARDWOOD FLOORING

1 - HARDWOOD - GROUP A SERIES 5 INCH - KITCHEN/BREAKFAST AREA 15Jan24 Note:	
1 - HARDWOOD - GROUP A SERIES 5 INCH - FIRST FLOOR HARDWOOD AREAS INCLUDING STAIR LANDINGS 15Jan24 Note:	

HEATING AND AIR CONDITIONING

1 - HUMIDIFER (MANUAL) 23Oct23 Note:	
--	--

MISCELLANEOUS

1 - FURTHER VENDOR DISCOUNT 15Jan24 Note:	
---	--

PLUMBING

1 - MOEN KITCHEN POT FILLER – TRADITIONAL TWO HANDLE POT FILLER FAUCET WITH DUAL SHUT OFFS – #S664 CHROME 23Oct23 Note:	
1 - WATER LINE FOR FRIDGE - ROUGH-IN ONLY 23Oct23 Note:	

PROMOTIONAL

CONSTRUCTION SUMMARY

Palmetto - Zadorra Estates Corp.

PURCHASERS: Ziyad OVINAGATH KAMOOKAGATH and Shanima Mohammed CHALUPARAMBATH
CHULLIAM

TEL: RES.: 416-371-7925

LOT / PHASE 156 / 1	REG. PLAN #	HOUSE TYPE Penrose 2 Elev 2		
------------------------	-------------	--------------------------------	--	--

1 - LESS CREDIT FROM PURCHASER EXTRA SHEET IN OFFER

05Jul23 Note:

STAIRS AND RAILINGS

1 - PICKETS - EUROLINE 1 - BLACK PICKETS

15Jan24 Note:

1 - STAINED STAIRS - STANDARD STAIRCASE

15Jan24 Note:

EXTRAS AS PER OFFER

The Vendor agrees that notwithstanding any other term or provision in this Agreement included in the Purchase Price and in addition to those items detailed in Schedule GP to the Agreement of Purchase and Sale, the Purchaser is entitled to a credit of Fif
Worksheet Note:

This Document is Extremely Time Sensitive - Printed 15 Jan 24 at 14:31

PURCHASER'S EXTRA
Sold By:

Vendor: Zadorra Estates Corp.
c.o.b. Greenpark
Purchasers: Ziyad OVINAGATH KAMOOKAG/
Shanima Mohammed CHALUPARAMBATH
Telephone Number: Cell: (416) 371-7925

Unit Number 156
Penrose 2 Elev 2 Elev.
Reg. Plan #
Closing Date As Per Agreement
Date Ordered 05-Dec-2023

DESCRIPTION	AMOUNT
Complete Central Air Conditioning, Supplied and Installed	

- 1). All extras must be paid in full prior to the installation of said extras. The Purchaser shall forfeit any partial payments, if full payment of the said extras cannot be made prior to time of installation.
- 2). All extras are non refundable and cannot be changed once this contract has been submitted to the Vendor.
- 3). All parties are in agreement to the prices and extras depicted in this contract.
- 4). The Vendor at any given time, without reason may declare this contract null and void. In doing so, all payments or partial payments will be returned in full to the Purchaser.

DocuSigned by:
Ziyad Kamookagath 14-Dec-23
Purchaser - Ziyad OVINAGATH KAMOOKAGATH
DocuSigned by:
Shanima Mohammed 14-Dec-23
Purchaser - Shanima Mohammed CHALUPARAMBATH
CHULLIAM

Vendor: Zadorra Estates Corp.

Construction Scheduling Approval
Per: _____
Date: _____

☐ Greenpark ☐ Metropark ☐ Purchaser ☐ Construction ☐ Site Office ☐ Purchaser's Lawyer

Tower: 1 Suite: 156 Penrose 2 Elev 2 Vendor: Zadorra Estates Corp.

Purchasers:

Telephone Res. / Bus:

Decor Advisor:

Lock Date:

Ziyad OVINAGATH KAMOOKAGATH & Shanima

(416) 371-7925 /

Ida Viola

15-Jan-24

Property: 156

Project: Zadorra Estates Corp.

Model and Elevation: Penrose 2 Elev 2

15-Jan-24

Plan #:

1. Cabinetry

	Style and Colour	Hardware
Kitchen / Breakfast	SEE BELOW	465SA
Laundry Room	ELISSE	Standard
Powder Room	MONACO 826 AUTUMN CHESTNUT	465SA
Master Ensuite Bathroom	MONACO 826 AUTUMN CHESTNUT	465SA
Ensuite Bath - Bedroom 2	MONACO 826 AUTUMN CHESTNUT	465SA
Ensuite Bath - Bedroom 3/4	MONACO 826 AUTUMN CHESTNUT	465SA

Stove Opening

36"

NOTE: If not specified, opening will be set to builder's standard opening of approximately 30" width

Fridge Opening

SEE SPECS

NOTE: If not specified, opening will be set to builder's standard opening of approximately 37" width x 74" height

** Refer to Construction Summary -
KITCHEN CABINETRY: UPPER CABINETS, BUILT-IN TOWER, FRIDGE & PANTRY - LEGACY 662 CREMA
BASE CABINETS & ISLAND CABINETS - BANCROFT 352 WILD MUSHROOM

2. Counters

	Counter	Edge	Niche
Kitchen / Breakfast	LAMINATE-PALOMA POLAR 6698-46		
Laundry Room	N/A		
Powder Room	LAMINATE-WHITE CARRARA 4924-38		
Master Ensuite Bathroom	LAMINATE-PALOMA POLAR 6698-46		
Ensuite Bath - Bedroom 2	LAMINATE-PALOMA POLAR 6698-46		
Ensuite Bath - Bedroom 3/4	LAMINATE-PALOMA POLAR 6698-46		
Kitchen Backsplash	N/A		

** Refer to Construction Summary

Purchasers: Ziyad OVINAGATH KAMOOKAGATH & Shanima

Property: 156

Telephone Res. / Bus: (416) 371-7925 /

Project: Zadorra Estates Corp.

Decor Advisor: Ida Viola

Model and Elevation: Penrose 2 Elev 2

Lock Date: 15-Jan-24

15-Jan-24

Plan #:

3. Ceramic Flooring

At a 45

Entrance Vestibule	TILE-KALMA BIANCO GLOSSY 12.5X12.5	<input type="checkbox"/>
Main Hall	HARDWOOD	<input type="checkbox"/>
Kitchen / Breakfast	HARDWOOD	<input type="checkbox"/>
Laundry Room	TILE-KALMA BIANCO GLOSSY 12.5X12.5	<input type="checkbox"/>
Powder Room	TILE-KALMA BIANCO GLOSSY 12.5X12.5	<input type="checkbox"/>
Master Ensuite Bathroom	TILE-KALMA BIANCO GLOSSY 12.5X12.5	<input type="checkbox"/>
Ensuite Bath - Bedroom 2	TILE-KALMA BIANCO GLOSSY 12.5X12.5	<input type="checkbox"/>
Ensuite Bath - Bedroom 3/4	TILE-KALMA BIANCO GLOSSY 12.5X12.5	<input type="checkbox"/>
Mud Room	TILE-KALMA BIANCO GLOSSY 12.5X12.5	<input type="checkbox"/>
		<input type="checkbox"/>
		<input type="checkbox"/>

** Refer to Construction Summary ** METAL STRIP THRESHOLD WHERE APPLICABLE UNLESS SPECIFIED **

4. Ceramic Wall Tile

Master Ensuite Bathroom	Selection	Describe
Tub Deck Wall		
Shower Stall	TILE-SILVIA WHITE 8X16	NICHE - NERO STARDUST T603
Bathtub Enclosure Walls		
Ensuite Bath - Bedroom 2	TILE-SILVIA WHITE 8X16	
Ensuite Bath - Bedroom 3/4	TILE-SILVIA WHITE 8X16	
Mud Room	N/A	
Kitchen Backsplash	N/A	

** Refer to Construction Summary - STANDARD GROUT THROUGHOUT UNLESS SPECIFIED

5. Trim Carpentry

Interior Doors	CARRARA-SMOOTH
Interior Trim	As Per Construction Specifications

** Refer to Construction Summary

6. Plaster Mouldings and Medallions

Entrance Vestibule	N/A		Kitchen/Breakfast	N/A	
Main Hall	N/A		Den/Library	N/A	
Living Room	N/A		Lower Landing	N/A	
Dining Room	N/A				
Family Room	N/A				

** Refer to Construction Summary

Purchasers:Ziyad OVINAGATH KAMOOKAGATH & Shanima

Property: 156

Telephone Res. / Bus: (416) 371-7925 /

Project: Zadorra Estates Corp.

Decor Advisor: Ida Viola

Model and Elevation: Penrose 2 Elev 2

Lock Date: 15-Jan-24

15-Jan-24

Plan #:

7. Other Flooring

Main Hall	HARDWOOD-MIRAGE RIO MAPLE EXCLUSIVE 5" CASHMERE
Living Room	HARDWOOD-MIRAGE RIO MAPLE EXCLUSIVE 5" CASHMERE
Dining Room	HARDWOOD-MIRAGE RIO MAPLE EXCLUSIVE 5" CASHMERE
Family Room	HARDWOOD-MIRAGE RIO MAPLE EXCLUSIVE 5" CASHMERE
Den / Library / Study	HARDWOOD-MIRAGE RIO MAPLE EXCLUSIVE 5" CASHMERE
Basement Landing(If Applies)	N/A
Lower Landing (If Applies)	N/A
Upper Landing	HARDWOOD-MIRAGE RIO MAPLE EXCLUSIVE 5" CASHMERE
Upper Hall	LAMINATE - LEXINGTON BRUSSELS OAK TL LW1316 PEFC
Master Bedroom	LAMINATE - LEXINGTON BRUSSELS OAK TL LW1316 PEFC
Bedroom #2	LAMINATE - LEXINGTON BRUSSELS OAK TL LW1316 PEFC
Bedroom #3	LAMINATE - LEXINGTON BRUSSELS OAK TL LW1316 PEFC
Bedroom #4	LAMINATE - LEXINGTON BRUSSELS OAK TL LW1316 PEFC
Bedroom #5	N/A
KITCHEN/BREAKFAST	HARDWOOD-MIRAGE RIO MAPLE EXCLUSIVE 5" CASHMERE
Underpad	Standard <input type="checkbox"/> Upgrade <input type="text"/>

** Refer to Construction Summary

8. Railings and Pickets

Railing Type	AS PER CONSTRUCTION SPECIFICATIONS	Colour	MIRAGE RIO MAPLE
Picket Type	EUROLINE 1	Colour	BLACK
Stringer / Riser	AS PER CONSTRUCTION SPECIFICATIONS	Colour	MIRAGE RIO MAPLE
Treads	AS PER CONSTRUCTION SPECIFICATIONS	Colour	MIRAGE RIO MAPLE

Red Oak Stairs as Per Vendor's Standard

** Refer to Construction Summary THE STAIN COLOURS OR FINISH AVAILABLE ON RISERS, TREADS, PICKETS AND RAILS (STAIRCASES), WILL NOT BE AN EXACT MATCH TO PREFINISHED HARDWOOD OR LAMINATE FLOORS.

9. Wall Paint Flat Finish

Main & Upper Hall	43 BIRCH WHITE	Master Bedroom	43 BIRCH WHITE
Living Room	43 BIRCH WHITE	Bedroom #2	43 BIRCH WHITE
Dining Room	43 BIRCH WHITE	Bedroom #3	43 BIRCH WHITE
Kitchen / Breakfast	43 BIRCH WHITE	Bedroom #4	43 BIRCH WHITE
Family Room	43 BIRCH WHITE	Bedroom #5	N/A
Powder Room	43 BIRCH WHITE	Master Ensuite	43 BIRCH WHITE
Laundry Room	43 BIRCH WHITE	Ensuite Bath - Bedroom 2	43 BIRCH WHITE
Den/Library	43 BIRCH WHITE	Ensuite Bath - Bedroom 3/4	43 BIRCH WHITE
Trim & Door Paint-Semi Gloss	BIRCH WHITE	Mud room	43 BIRCH WHITE

** Refer to Construction Summary

Initials: ZK SC

Purchasers: Ziyad OVINAGATH KAMOOKAGATH & Shanima

Property: 156

Telephone Res. / Bus: (416) 371-7925 /

Project: Zadorra Estates Corp.

Decor Advisor: Ida Viola

Model and Elevation: Penrose 2 Elev 2

Lock Date: 15-Jan-24

15-Jan-24

Plan #:

10. Fireplace

	Living Room			Family Room			Other Room - Specify		
	Purchased	As Per Plan	N/A	Purchased	As Per Plan	N/A	Purchased	As Per Plan	N/A
	<input type="radio"/>	<input type="radio"/>	<input type="radio"/>	<input type="radio"/>	<input checked="" type="radio"/>	<input type="radio"/>	<input type="radio"/>	<input type="radio"/>	<input type="radio"/>
Fireplace Type				As Per Construction Specifications					
Mantle Type				MANTLE M1-STANDARD					
Colour / Stain				AS PER CONSTRUCTION SPECIFICATIONS					
Surround				NERO					
Hearth				NO					
** Refer to Construction Summary									

11. Air Conditioning

Air Conditioning

YES

Comment

** Refer to Construction Summary

12. General Comments

** Refer to Construction Summary

Disclaimers and Notes

1) Colours of all materials are as close as possible to builder's selection, but not necessarily identical due to variances in manufacturing.

2) Any extras listed above are null and void unless accompanied by a separate invoice/amendment. Said invoice must be paid in full.

3) The Purchaser agrees that this colour selection is final and that no changes will be permitted, unless required by the Vendor.

4) The Purchaser acknowledges reading and accepting document which contains other miscellaneous disclaimers.

5) In the event of a conflict between the Standard Features schedule of the Agreement of Purchase and Sale and the Interior Colour Scheme, the Interior Colour Scheme shall prevail.

Signature: 

Date: 01/15/2024

Signature: 

Date: 1/15/2024

Lot 156 Zadorra

Penrose 2 40' LOT

ELEVATION 1 3,045 sq.ft. • ELEVATION 2 3,045 sq.ft. • ELEVATION 3 3,042 sq.ft.

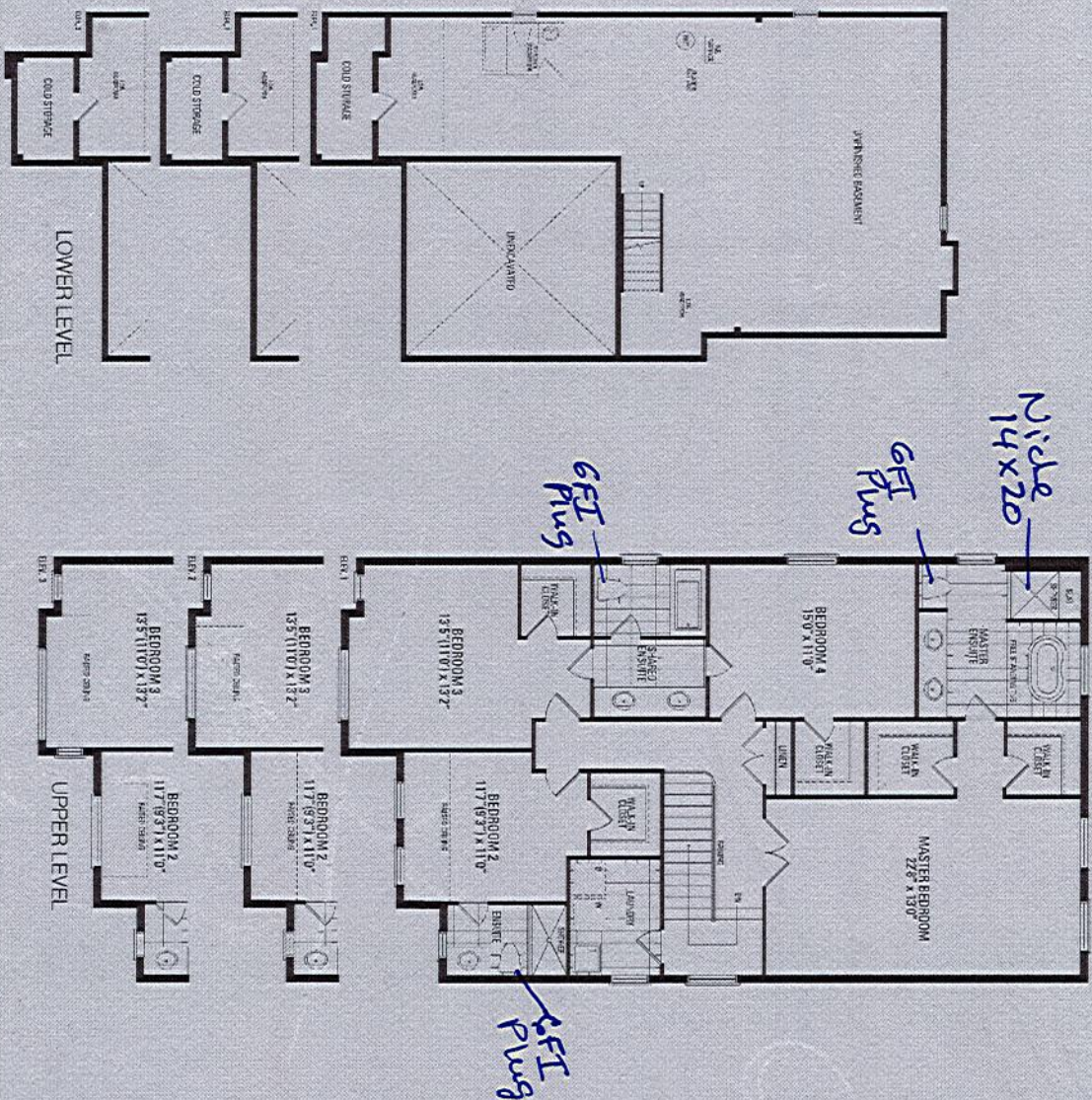
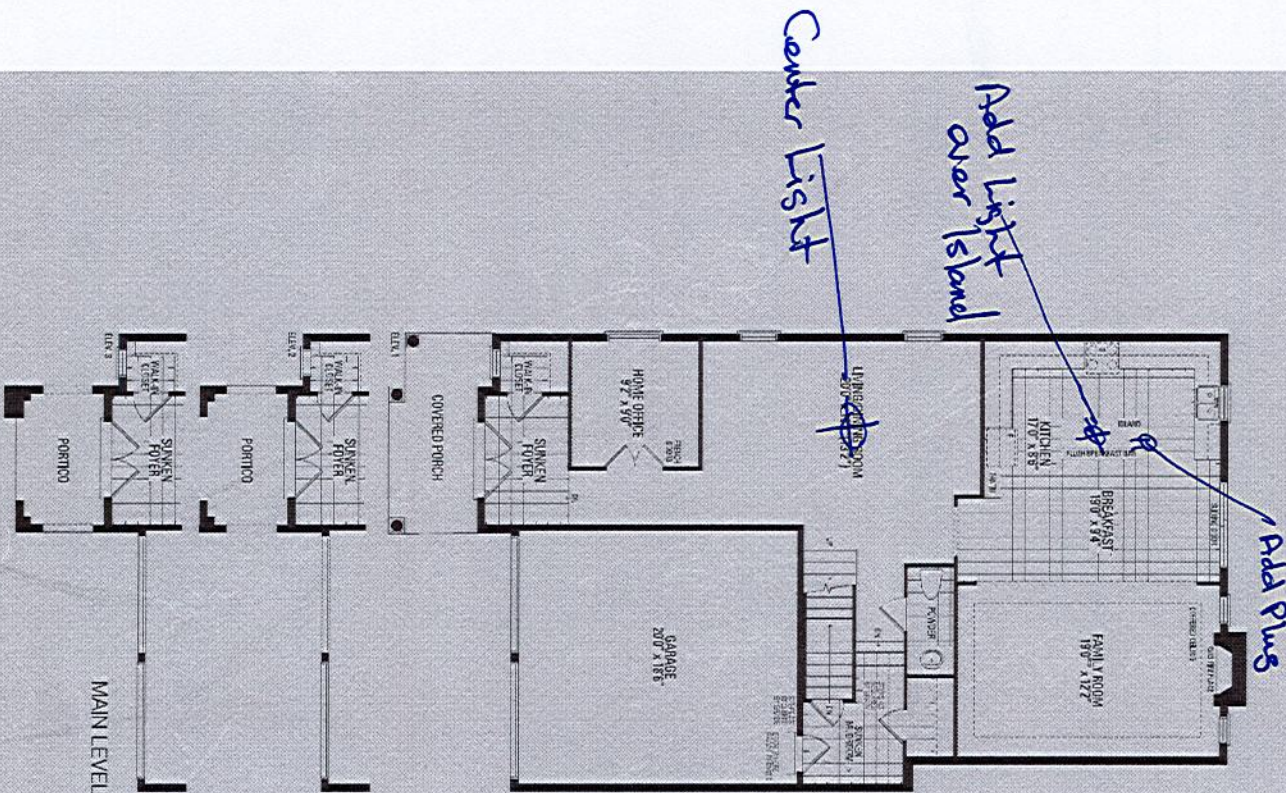

Kitchen cabinets:
- uppers, pantry, Fridge, Built in tower to be - Legacy-662 cream
- Island Bases & Kitchen Base cabinets to be - Bancroft
352 wild mushroom

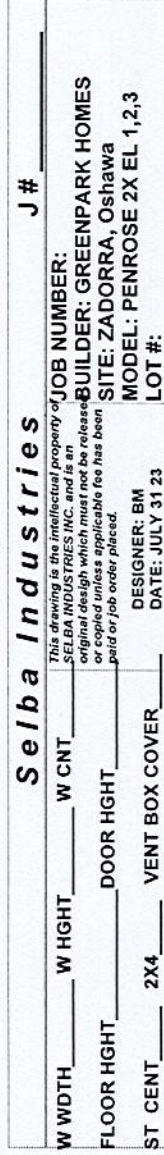

Lot 156 Zadorra



ELN136S2

36" Professional Wall Mount Hood

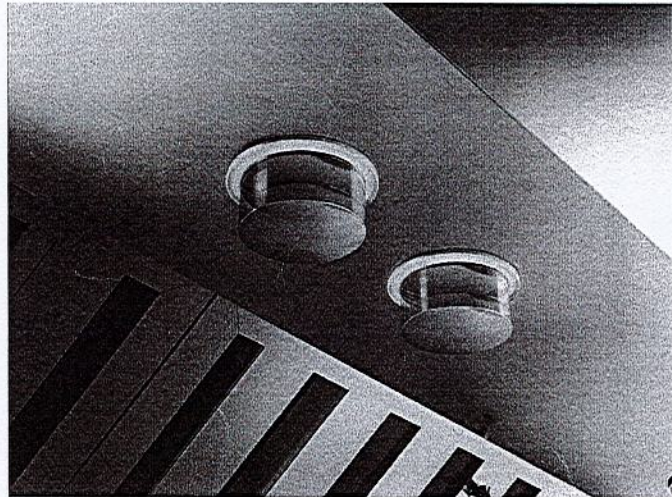
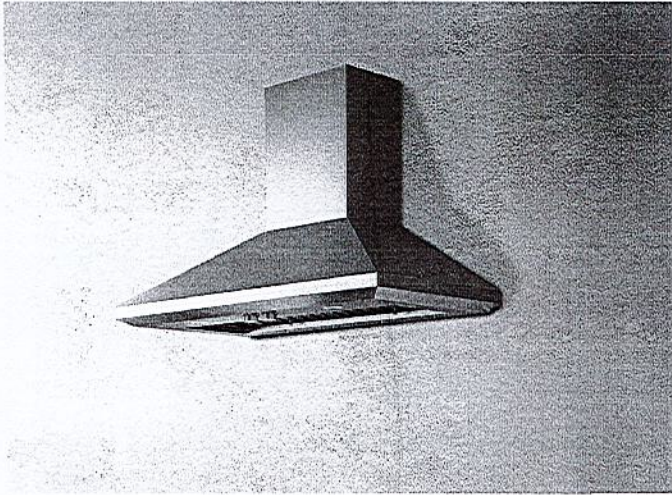

Selected Model	
Model number	ELN630S2
Exterior Appearance	
Color	Stainless Steel
Dimensions	
Dimensions	36" (W) X 24" (D) X 12 1/8" (H)
Features	
Controls	Fully recessing stainless rotating knobs with illumination
Illumination	2 2.5W Premium LED lamps, 1 intensity (bulbs included)
Blower Type	Hush Silence System 1200 CFM, 4-speed
Blower Performance	Speed 2, 640 CFM, 4.7 Sones
	Speed 3, 940 CFM, 8.1 Sones
	Speed 4, 1200 CFM, 7.7 Sones
	Speed 1, 375 CFM, 3.2 Sones
Filter Type	Stainless Steel Baffle filters (3X)
Ducting	Ducted Installation Only
Duct transition	8" round with Back Draft Damper included
Chimney (ducted out)	For ceiling height 7'6" to 9'11" (elect cooking) & 8'0" to 9'11" (gas cooking)
Accessories (optional)	
Chimney extension kit	KIT02785 (Ceiling 9'3" - 13'0" (electric cooking) 9'9"-13'0" (gas cooking)
External Blower Kit	KIT0153054 (1200 CFM compatible 8" & 10" duct transition)
Inline blower kit	KIT0154387 (1200 CFM compatible 8" & 10" duct transition)
Warranty	
Complete 2 years warranty	Entire Appliance; In-Home; Parts & Labour

The information contained herein is based on sources that we believe to be reliable, but is not guaranteed by us, may be incomplete or may change without notice

10611

Dimensions

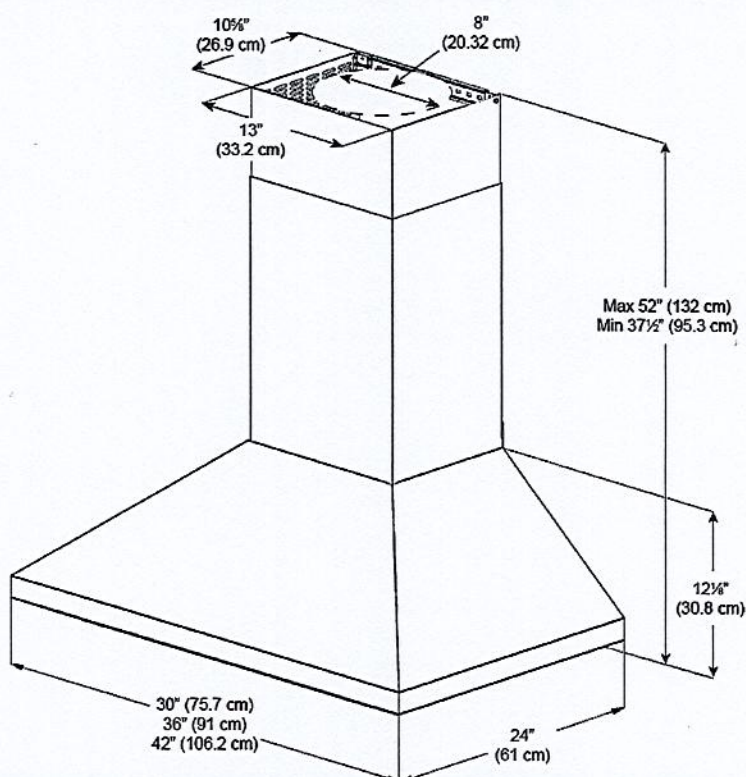

Installation

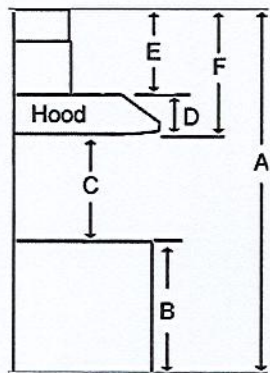

A	Floor to ceiling Height	TBD
B	Floor to counter Top Height (standard)	36"
C	Recommended Height between cooking surface and bottom of the hood	27" min. - 30" max
D	Hood Height	12 1/8"
E	Chimney Height	25 3/8" to 39 7/8"

Duct transition

8" Round (Top)

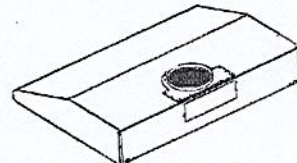

The information contained herein is based on sources that we believe to be reliable, but is not guaranteed by us, may be incomplete or may change without notice

Need technical assistance ? 1(888) 651-2534

NQ70C*700D

Lot 156 Zadora

SAMSUNG

Bespoke 30" Microwave Combination Wall Oven

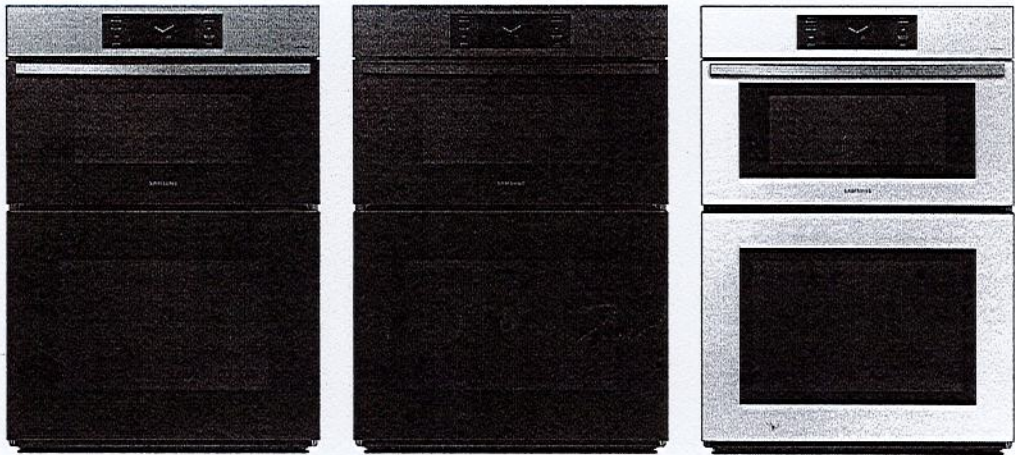

Available Colors

-  **Stainless Steel**
NQ70CG700DSR
-  **Matte Black**
NQ70CG700DMT
-  **White Glass**
NQ70CB700D12

Design

- Push to Open
- Full Glass Door
- Drop-Down Door Design
- Modern Design

Features

- AI Pro Cooking™ Camera:
 - Monitor food
 - Recognize ingredients
 - Record time lapse videos
- Flex Duo™ (Oven)
- Air Sous Vide (Oven)
- Air Fry, Tray Included (Oven)
- Steam Cook Plus (Oven)
- Convection Vegetable (Oven)
- Steam Cook (Oven)
- 7-Inch LCD Display
- Digital Touch Controls
- Wi-Fi Connectivity
- Dual Convection
- Guided Cook
- Steam Clean & Self-Clean (Oven)
- LED Lights
- 2 Heavy-Duty Racks
- Gliding Rack
- Broil Element
- 6 Rack Positions (Oven)

Convenience

- Sabbath Mode (Oven)
- Delay Start (Oven)
- Child Safety Lock
- Warming Mode
- Kitchen Timer

Specifications

- Microwave Capacity: 1.9 cu. ft.**
- Sensor Cook
 - Speed Power Convection: 100°F–450°F
 - Speed Broil
 - Air Fry Auto Cook
- Oven Capacity: 5.1 cu. ft.**
- Hidden Bake Element
 - Convection Bake: 175°F–550°F
 - Convection Roast: 175°F–550°F
 - Convection Vegetables: 350°F–450°F
 - Steam Cook Plus: 230°F–550°F
 - Steam Roast: 230°F–550°F
 - Steam Cook: 230°F–550°F
 - Bake: 175°F–550°F
 - Broil: Low-High
 - Air Sous Vide: 100°F–205°F
 - Air Fry: 350°F–500°F
 - Steam Proof
 - Dehydrate

Dimensions

- Product Dimensions & Weight (WxHxD)**
Outside (Max) Wall Oven Dimensions:
29³/₄" x 43¹/₄" x 24³/₈"
- Wall Oven Cut-Out Dimensions:**
28⁵/₈" x 42¹/₄" x 23¹/₂"
- Weight: 278.9 lbs

- Shipping Dimensions & Weight (WxHxD)**
Dimensions: 33³/₄" x 48¹/₄" x 29⁷/₁₆"
- Weight: 308.6 lbs

Warranty

Two (2) Years All Parts and Labor*
*Effective for purchases made between 10/1/22 - 9/30/23; proof of purchase required.

UPC

Microwave Combination Wall Oven	Model #	UPC Code
Stainless Steel	NQ70CG700DSR	887276757629
Matte Black	NQ70CG700DMT	887276757612
White Glass	NQ70CB700D12	887276757582



NQ70C*700D

Lot 156 Zadorra

SAMSUNG

Bespoke 30" Microwave Combination Wall Oven

Product Dimensions

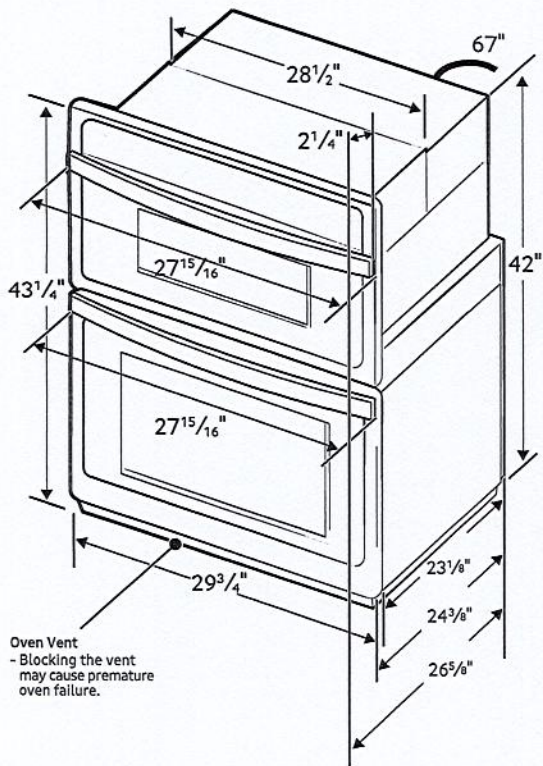

Electrical Requirements

KW RATING	
240V	9.5 kW
208V	7.2 kW
BREAKER SIZE	
240V	40 Amps
208V	30 Amps

Cabinet Dimensions

Combination Oven Installed in Cabinet

* Junction Box.

** Allow a minimum of 22" for clearance to adjacent corners, drawers, walls, etc. when door is open.

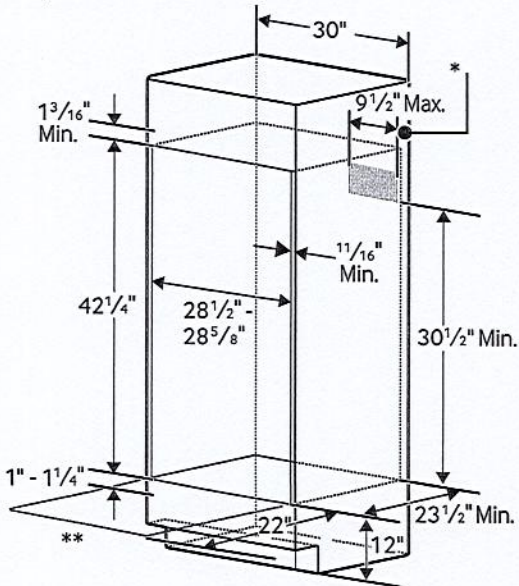

Actual color may vary. Design, specifications, and color availability are subject to change without notice. Non-metric weights and measurements are approximate.
©2023 Samsung Electronics America, Inc. 85 Challenger Road, Ridgefield Park, NJ 07660. Tel: 800-SAMSUNG. samsung.com. Samsung is a registered trademark of Samsung Electronics Co. Ltd.

40611

Lot 156 Zadorra

36" Gas Cooktop

Benchmark® Series – Stainless Steel NGMP658UC



NGMP658UC
Stainless Steel

The Benchmark® Series gas cooktop with FlameSelect® is a better way to cook with gas and delivers precision flame levels for consistent results.

Features & Benefits

- FlameSelect® offers 9 distinct power levels and delivers precision flame height every time for consistent, repeatable results.
- Digital display indicates the power level selected and informs you of the burner's residual heat.
- Dual-ring power burner has 2 rings for low and high flame settings so you can go from simmer to sear with ease.
- Dishwasher safe heavy-duty enameled cast iron grates makes cleanup simple and convenient.
- OptiSim® burner offers more flame control at the lowest settings for precise simmering and melting.

General Properties	
No. of burners	5
Knob color	Stainless Steel Appearance
Control location	Front-Center
Sealed burners	Yes
Valves	Five 9-Level Gas Step Valves
Ignition system	Electronic; Thermocouple Flame Monitor Control
Cooktop surface material	Stainless Steel
Grate material	Cast Iron
Grate features	Continuous Grates, Dishwasher Safe

Element Performance	
Total BTU load (NG / LP)	43,750 / 36,800
Power of front left burner (NG / LP)	3,400 / 3,400
Power of back left burner (NG / LP)	6,000 / 6,000
Power of center burner (NG / LP)	18,050 / 11,100
Power of back right burner (NG / LP)	10,300 / 10,300
Power of front right burner (NG / LP)	6,000 / 6,000



Technical Details	
Circuit breaker	15 A
Volts	120 V
Frequency	60 Hz
Plug type	3-Prong
Power cord length	40"
Fuel type	Natural Gas (Factory Set)
Convertible to LP (kit required)	Yes

Dimensions & Weight	
Overall appliance dimensions (HxWxD)	3 1/4" x 37" x 21 1/4"
Required cutout size (HxWxD)	2" x 34 15/16" x 19 1/8"
Minimum distance from counter front	1 7/8"
Minimum distance from rear wall	3"
Net weight	45 lbs

Accessories – Included	
Included	LP Conversion Kit, OptiSim® Cap

Accessories – Optional



HEZ9GR58UC
Griddle



HEZ298102
Wok Ring

*To be fully ADA compliant, these units must be installed according to ADA guidelines. Please check current ADA requirements for guidance on installation.

Accessories: To purchase Bosch accessories, cleaners & parts please visit www.bosch-home.com/us/store or call 1-800-944-2904 (Mon to Fri 5 am to 6 pm PST, Sat 6 am to 3 pm PST).

Notes: All height, width and depth dimensions are shown in inches. BSH reserves the absolute and unrestricted right to change product materials and specifications, at any time, without notice. Consult the product's installation instructions for final dimensional data and other details prior to making cutout.

Warranties: Please see Use & Care manual or Bosch website for statement of limited warranty.

For more information on our entire line of products, go to www.bosch-home.com/us or call 1-800-944-2904

© BSH Home Appliances Corporation. All rights reserved. Bosch is a registered trademark of Robert Bosch GmbH.

50611

36" Gas Cooktop

Lot 156 Zadorra

Benchmark® Series – Stainless Steel NGMP658UC



Installation Details

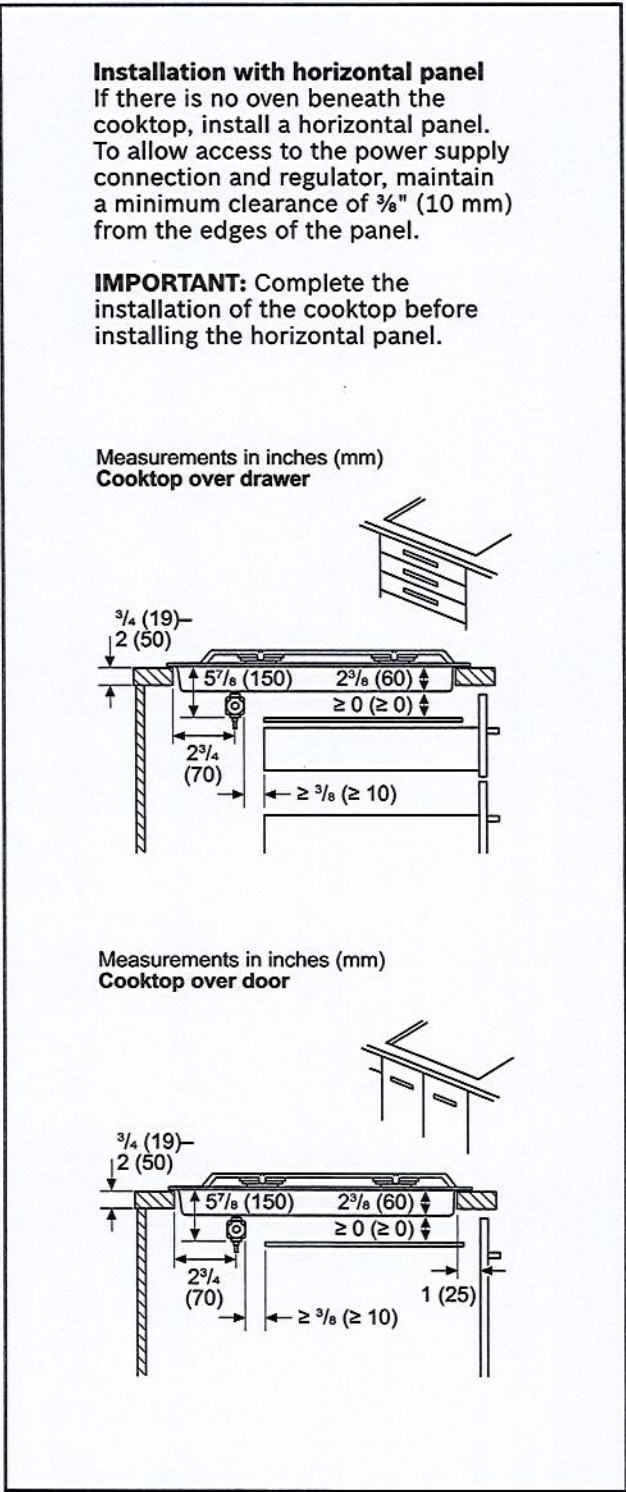
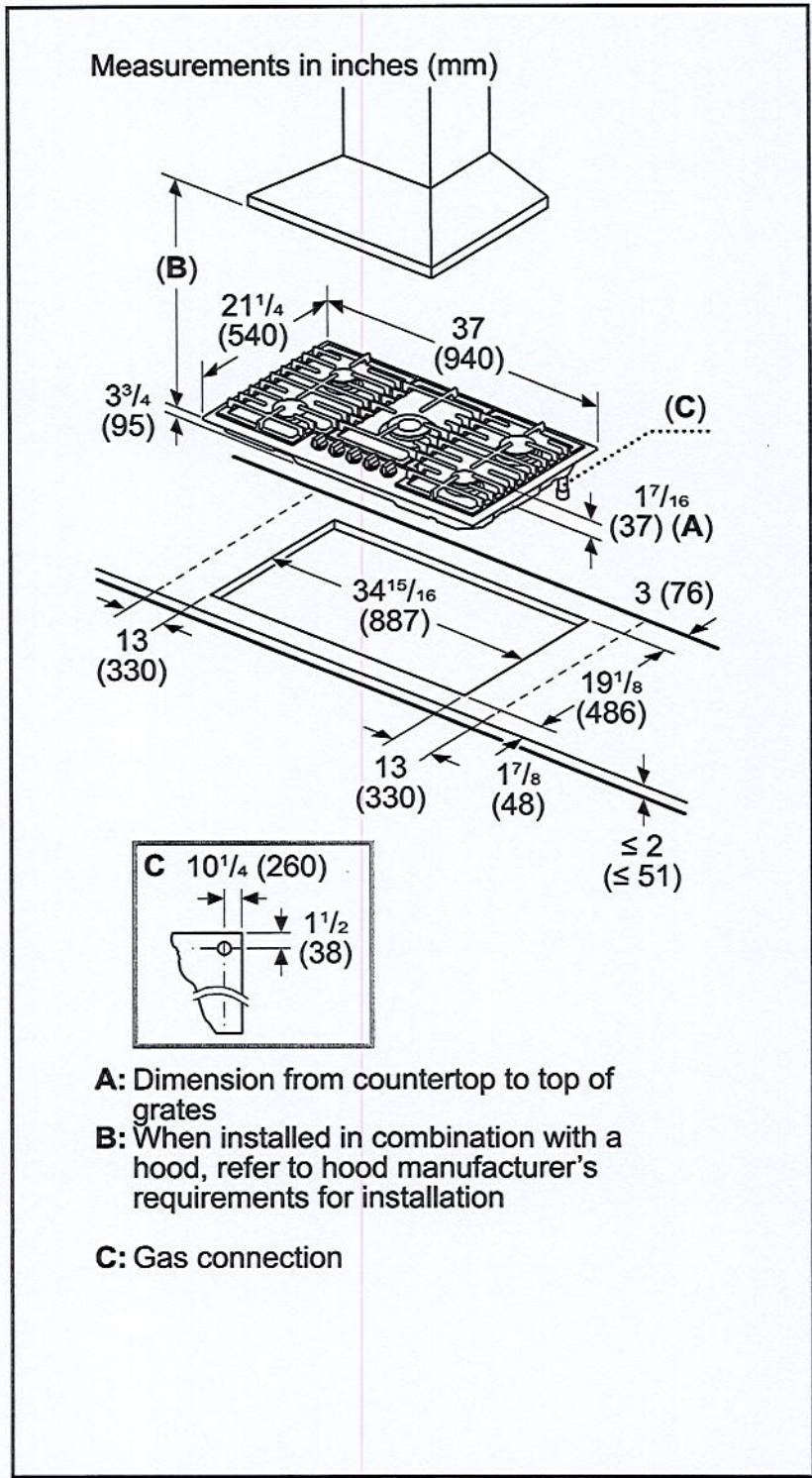

Accessories: To purchase Bosch accessories, cleaners & parts please visit www.bosch-home.com/us/store or call 1-800-944-2904 (Mon to Fri 5 am to 6 pm PST, Sat 6 am to 3 pm PST).

Notes: All height, width and depth dimensions are shown in inches. BSH reserves the absolute and unrestricted right to change product materials and specifications, at any time, without notice. Consult the product's installation instructions for final dimensional data and other details prior to making cutout.

Warranties: Please see Use & Care manual or Bosch website for statement of limited warranty.

For more information on our entire line of products, go to www.bosch-home.com/us or call 1-800-944-2904

© BSH Home Appliances Corporation. All rights reserved. Bosch is a registered trademark of Robert Bosch GmbH.

6 of 11

36" Gas Cooktop

Benchmark® Series – Stainless Steel NGMP658UC

Lot 156 Zadorra



Installation Details

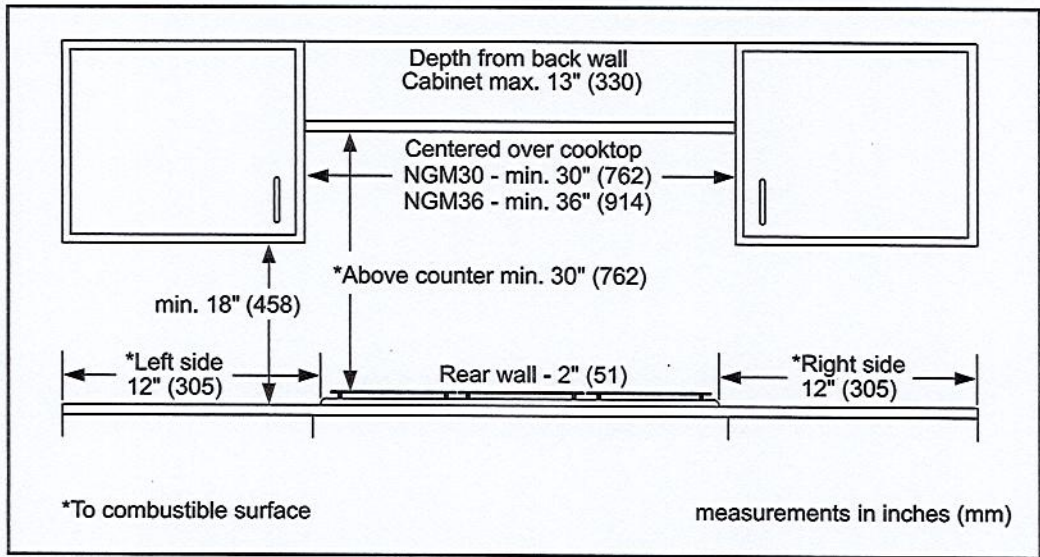
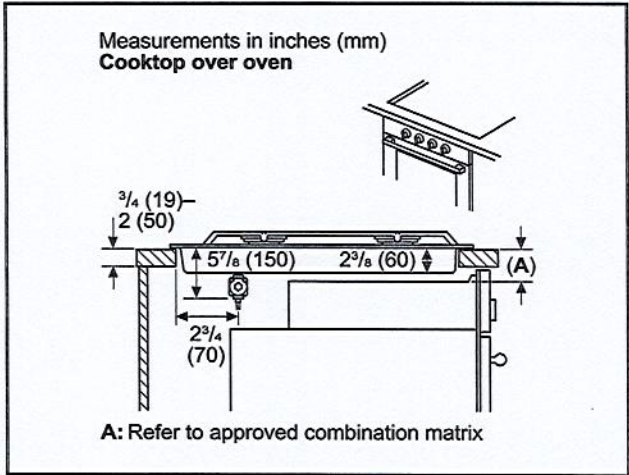

Accessories: To purchase Bosch accessories, cleaners & parts please visit www.bosch-home.com/us/store or call 1-800-944-2904 (Mon to Fri 5 am to 6 pm PST, Sat 6 am to 3 pm PST).

Notes: All height, width and depth dimensions are shown in inches. BSH reserves the absolute and unrestricted right to change product materials and specifications, at any time, without notice. Consult the product's installation instructions for final dimensional data and other details prior to making cutout.

Warranties: Please see Use & Care manual or Bosch website for statement of limited warranty.

For more information on our entire line of products, go to www.bosch-home.com/us or call 1-800-944-2904

© BSH Home Appliances Corporation. All rights reserved. Bosch is a registered trademark of Robert Bosch GmbH.

7 of 11

RF23A9675AP

Lot 156 Zadoria

SAMSUNG

BESPOKE 4-Door Flex Counter-Depth Refrigerator
22.8 cu. ft.

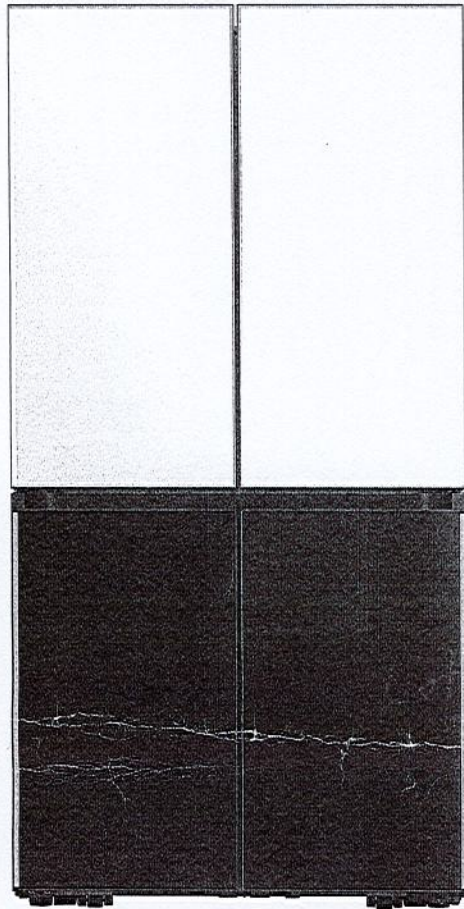

Signature Features

Customizable Door Panels

Customize the design of your refrigerator with changeable colour door panels. Choose from 8 colours and 2 finishes to create a space that fits your style – the options are endless.

Beverage Center

Quick access to refreshingly cool, filtered water two ways. Choose from an internal dispenser or a built-in pitcher that automatically refills, with the option to infuse with a flavour.

Dual Ice Maker with Ice Bites

Be prepared for any occasion with two different types of ice. The Dual auto ice maker makes both cubed ice and ice bites.

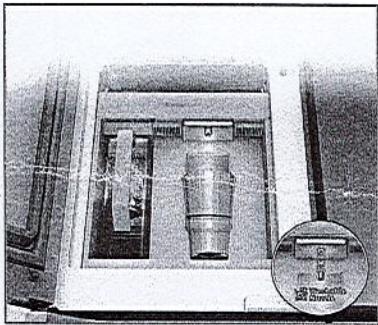

Beverage Center™ with
AutoFill™ Water Pitcher

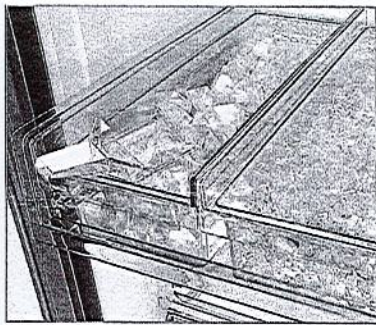

Dual Ice Maker with Cubed Ice
and IceBites™

BESPOKE Panel Colour Selection

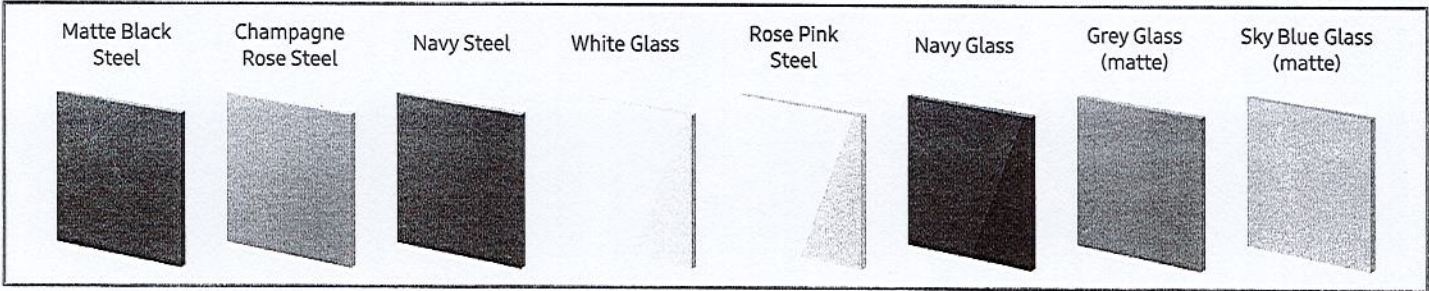

Design

- Customizable Door Colours
- Beverage Center
- Modern Design
- LED Lighting

Technology

- Dual Ice Maker with Ice Bites and Cubed Ice
- UV Deodorizing Filter
- Wi-Fi Enabled

Performance

- FlexZone™
- FlexCrisper
- Triple Cooling

Rating



- ENERGY STAR® - Rated
- Energy Consumption (annual) = 634 kWh/yr

80611

RF23A9675AP

Lot 156 Zadorra

SAMSUNG

BESPOKE 4-Door Flex Counter-Depth Refrigerator

22.8 cu. ft.

Installation Specifications

1. Measure the height, width and depth of the opening, making sure to include baseboards, molding tile, countertop overhang, etc. Check to be sure there is enough room to open the door (consider walls, islands or other obstacles when measuring).
2. Refer to illustration below to determine dimensions.
3. Allow 11 7/8" of clearance on hinge side of refrigerator when installing next to a wall where door may make contact.
4. Allow 2" minimum clearance at rear for proper air circulation and water/electrical connections. Allow a 3/8" minimum clearance at sides and top for ease of installation.
5. Ensure each door and entryway in the home is wide enough for the refrigerator to be moved through easily.

For optimal usage and to be able to open refrigerator doors completely, do not install next to a wall.

Please note: The following dimension and cutout information is for planning purposes only. For complete installation details, consult manual packed with product, or download manual online at samsung.com.

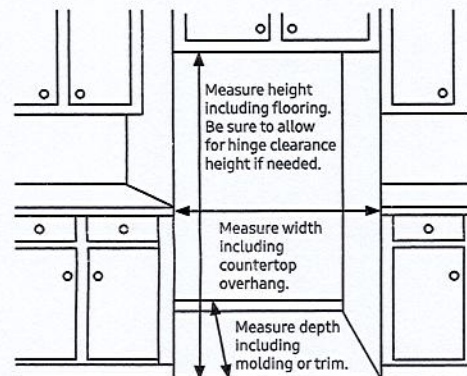

Dimensions

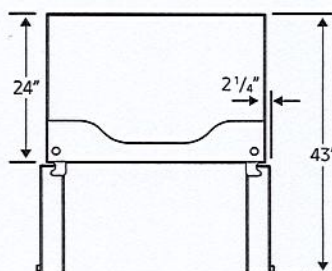
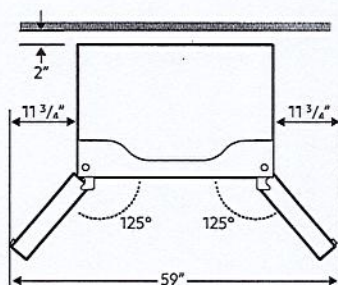
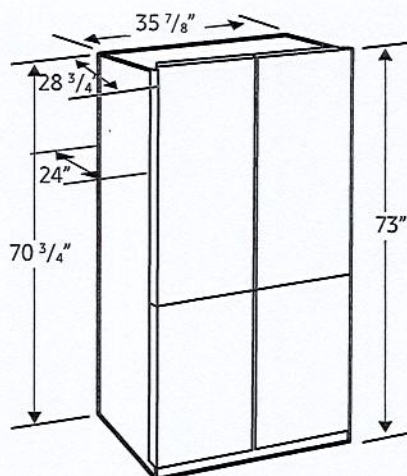

Total Capacity: 22.8 cu. ft.

Refrigerator: 14.0 cu. ft.

- 4 Tempered Glass Spill-Proof Shelves
- 2 Clear Drawers: FlexCrisper and Crisper+
- 6 Door Bins

- Right: 1 Gallon Bin, 2 Regular Bins
- Left: 1 Gallon Bin, 2 Regular Bins

LED Lighting

Freezer: 8.8 cu. ft.

Dual Ice Maker in Freezer (Cubed Ice or Ice Bites)

- 2 Ice Buckets with Cover and 1 Scoop

3 Slide-Out Shelves

2 Clear Drawers

6 Door Bins

LED Lighting

Accessories

Water Filter: HAF-QIN

Volt/Amps	115V / 60Hz / 3.5A
Power Cord Length	2 meters

Warranty

One (1) Year Parts and Labour on Refrigerator

Ten (10) Years Parts on Digital Inverter Compressor

Product Dimensions & Weight (WxHxD)

Dimensions (WxHxD with hinges, handles and doors):

35 7/8" x 73" x 28 3/4"

Dimensions (WxHxD without hinges and door):

35 7/8" x 70 3/4" x 24"

Dimensions (WxHxD with hinge and door, no handle):

35 7/8" x 73" x 28 3/4"

Weight: 317.5 lbs (144 kg)

Shipping Dimensions & Weight (WxHxD)

Dimensions: 38 1/4" x 78 5/8" x 31 1/4"

Weight: 339.5 lbs (154 kg)

Style	Model #	UPC
Counter-Depth	RF23A9675AP/AC	887276593159
Standard-Depth	RF29A9675AP/AC	887276593203

Actual colour may vary. Design, specifications and colour availability are subject to change without notice. Non-metric weights and measurements are approximate. © 2021 Samsung Electronics Canada Inc. All rights reserved. Samsung is a registered trademark of Samsung Electronics Co., Ltd., used with permission.

9 of 11

DW80B7070

lot 156 Zadorra

SAMSUNG

Smart Dishwasher with StormWash+™ 42dBA with Smart Dry

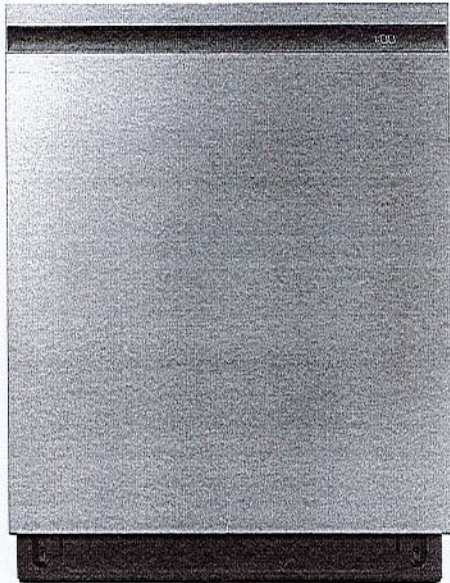

Signature Features

Smart Dry with AutoRelease™ Door

- The Smart Dry with AutoRelease™ Door system circulates warm air to deliver 2.5x better drying performance¹ without damaging plastic ware.

StormWash+™

- The new dual wash arms and rotating spray jet delivers more intense cleaning performance, and cleans at every angle to cover 1.5x more space.²

Whisper Quiet 42 dBA

- So quiet you don't even know its on with Whisper Quiet 42dBA operation.³



¹Based on internal testing, compared to Samsung's conventional dishwashers with AutoRelease™ doors.

²Based on internal testing compared to conventional StormWash™ models.

³Based on internal testing. Results may vary depending on the actual usage conditions.

Available Colors

Standard Finishes

-  Fingerprint Resistant Stainless Steel (shown)
-  Fingerprint Resistant Black Stainless Steel

BESPOKE Finishes

-  White Glass (panel sold separately)

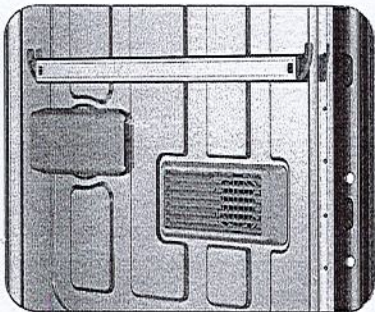

Smart Dry with AutoRelease™ Door



StormWash+™

Features

- Smart Dry with AutoRelease™ Door
- StormWash+™ with Dual Wash Arms
- Whisper Quiet 42 dBA
- SmartThings App
- 3rd Rack
- Smart Reorder
- Pre Blast Cycle
- Fingerprint Resistant Finishes and BESPOKE Glass Finishes
- FlexLoad™ Rack System

Convenience

- Wi-Fi Connectivity
- LED Time Remaining Display
- Control Lock
- Delay Start
- Digital Leak Sensor

Rating

 Most Efficient
2022
www.energystar.gov
239 kWh/yr

Lot 156 Zedorra

DW80B7070

SAMSUNG

Smart Dishwasher with StormWash+™ 42dBA with Smart Dry

Installation Specifications

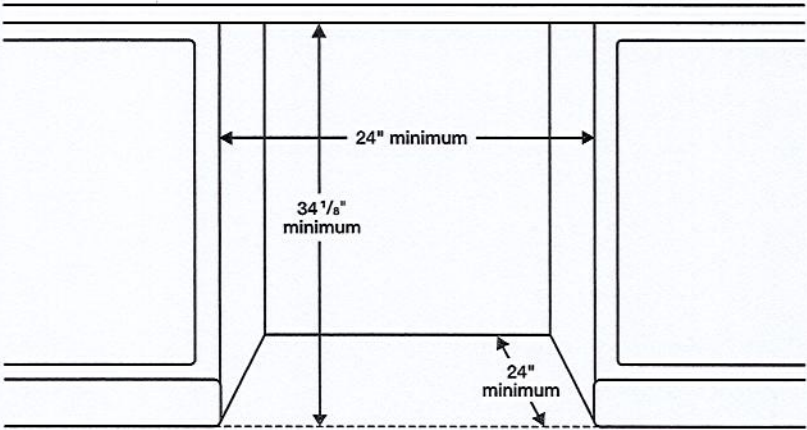

Dimensions

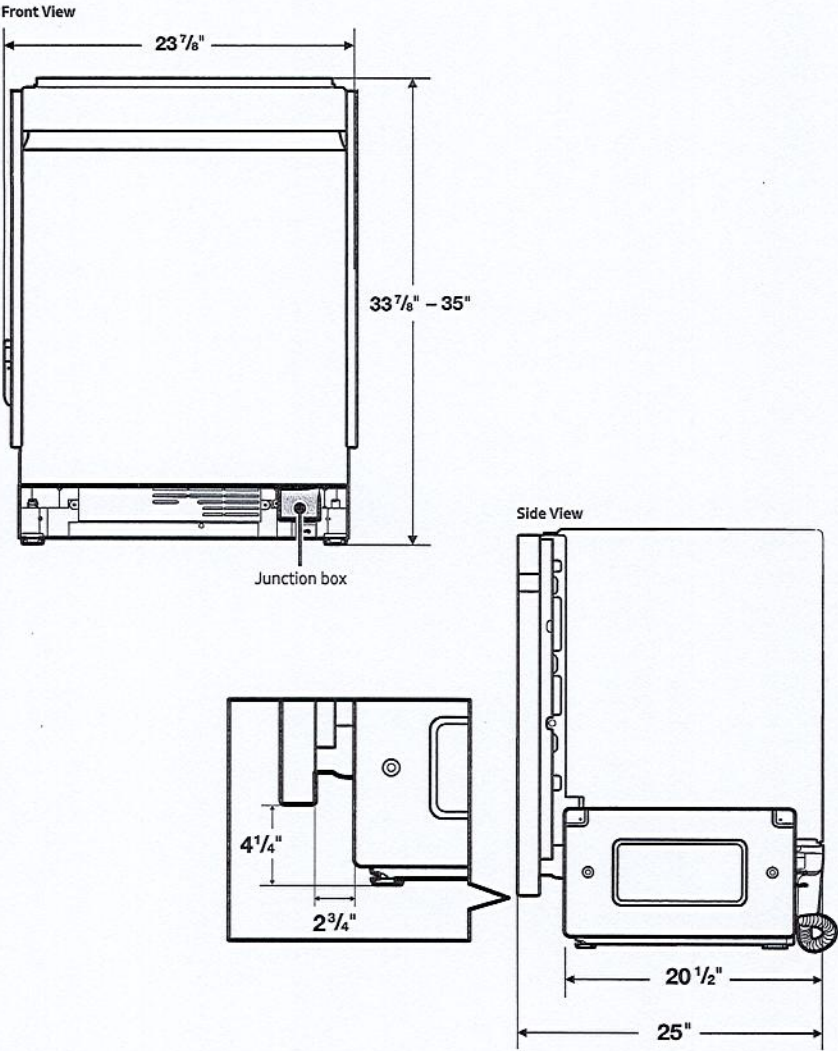

Features

- 7 Wash Cycles: Auto, Normal, Heavy, Delicate, Express 60, Pre Blast, Download Cycle
- 8 Options: Half load (Lower Rack), StormWash+™ Hi-Temp Wash, Sanitize (NSF Certified), Delay Start, Control Lock, Smart Control (Wi-Fi), Smart Dry
- AutoRelease™ Door
- Stainless Steel Interior Tub

Convenience

- Control Lock
- Digital Water Leakage Sensor
- 3rd Rack
- One-Touch Adjustable Racking System
- Silverware Basket
- Upper Rack: Foldable Cup Shelves, Adjustable Tines
- Lower Rack: Fold-Down Tines

Warranty

One (1) Year Parts and Labor
Five (5) Years, Printed Circuit Board, Racking and Stainless Door Liner & Tub for leakage (Parts Only)

Product Dimensions & Weight (WxHxD)

Dimensions (height is adjustable):
23 7/8" x 33 7/8" – 35" x 25"

Weight: 91.5 lbs

Shipping Dimensions & Weight (WxHxD)

Dimensions:
26" x 34 3/4" x 29 3/4"

Weight: 98.1 lbs

Standard Finishes	Model #	UPC Code
Fingerprint Resistant Stainless Steel	DW80B7070US	887276609706
Fingerprint Resistant Black Stainless Steel	DW80B7070UG	887276616414
BESPOKE Finishes		
Custom Panel-Ready	DW80B7070AP	887276609690
White Glass Panel (sold separately)	DW-T24PNA12	887276622255

Actual color may vary. Design, specifications, and color availability are subject to change without notice. Non-metric weights and measurements are approximate.
©2021 Samsung Electronics America, Inc., 85 Challenger Road, Ridgefield Park, NJ 07660. Tel: 800-SAMSUNG. samsung.com. Samsung is a registered trademark of Samsung Electronics Co., Ltd.

11 of 11