

CONSTRUCTION SUMMARY

RECEIVED

Red Oaks - Roundel Homes Inc.

OCT 06 2023

PURCHASER: Xiangwen WANG

TEL: RES.: 647-863-3909

LOT / PHASE 52 / 2	REG. PLAN # 65M-4737	HOUSE TYPE Pinetree 3 Elev 3		
-----------------------	-------------------------	---------------------------------	--	--

CABINETRY

1 - KITCHEN - DELETE CABINETS ABOVE STOVE AND HOOD FAN - VENDOR WILL SUPPLY 6 INCH VENT AS PER CONSTRUCTION SPECIFICATIONS AND VENT MAY NOT BE IN THE APPROPRIATE LOCATION FOR INSTALLATION OF PURCHASER SUPPLIED FAN 25Sep23 Note: PURCHASER TO SUPPLY AND INSTALL OWN FAN AFTER CLOSING	
1 - VANITY - SHARED ENSUITE 3/4 - RAISE VANITY TO 36" HIGH VANITY IN LIEU OF STANDARD HEIGHT 25Sep23 Note:	
1 - VANITY - PRIMARY ENSUITE - RAISE VANITY TO 36" HIGH VANITY IN LIEU OF STANDARD HEIGHT 25Sep23 Note:	
1 - VANITY - POWDER ROOM - RAISE VANITY TO 36" HIGH VANITY IN LIEU OF STANDARD HEIGHT 25Sep23 Note:	
1 - VANITY - ENSUITE 2 - RAISE VANITY TO 36" HIGH VANITY IN LIEU OF STANDARD HEIGHT 25Sep23 Note:	

CABINETRY ACCESSORIES

1 - KITCHEN CABINETRY UPPER - FULL DEPTH ABOVE FRIDGE - WITH GABLES - 650 DEEP - PRICE IS EACH 25Sep23 Note:	
1 - KITCHEN CABINETRY BASE - POT/PAN DRAWERS (CABINET) - STANDARD LEVEL 25Sep23 Note:	
1 - KITCHEN CABINETRY BASE - PULLOUT WIRE SPICE RACK - PRICE IS EACH 25Sep23 Note:	
NEXT TO STOVE - SEE SKETCH	
1 - KITCHEN CABINETRY BASE - PULLOUT RECYCLE 2 BIN - PRICE IS EACH 25Sep23 Note:	

CERAMIC TILE

1 - DELETE ALL CERAMIC BATHROOM ACCESSORIES - DELETE TOWEL BAR, PAPER HOLDER & SOAP DISH THROUGHOUT 25Sep23 Note:	
--	--

CONSTRUCTION

1 - FRAMELESS GLASS SHOWER ENCLOSURE PROVISION - REMOVE SIDE WALL AND REPLACE WITH GLASS TO ACCOMODATE FRAMELESS GLASS SHOWER ENCLOSURE SEE SKETCH 16May23 Note:	
---	--

ELECTRICAL

1 - PLUG - ELECTRICAL PLUG - TO BE INSTALLED OVER FIREPLACE 16May23 Note:	
1 - RELOCATE STANDARD KITCHEN LIGHT TO BE CENTERED OVER ISLAND 16May23 Note:	
1 - STANDARD DINING ROOM LIGHT TO BE CENTERED BETWEEN LIVING AND DINING ROOM 16May23 Note:	
1 - PLUG - ELECTRICAL PLUG WITH GFI AND SWITCH - FOR FESTIVE LIGHTING 16May23 Note:	



CONSTRUCTION SUMMARY

Red Oaks - Roundel Homes Inc.

PURCHASER: Xiangwen WANG

TEL: RES.: 647-863-3909

LOT / PHASE 52 / 2	REG. PLAN # 65M-4737	HOUSE TYPE Pinetree 3 Elev 3		
-----------------------	-------------------------	---------------------------------	--	--

1 - ELECTRIC VEHICLE ROUGH-IN PROVISION ONLY FOR FUTURE ELECTRIC CAR (CONDUIT FROM BASEMENT INTO JUNCTION BOX IN GARAGE WITH PULL STRING, NO WIRE)
16May23 Note:

FIREPLACE AND ACCESSORIES

1 - GAS LINE ROUGH-IN FOR STOVE (INCLUDES ELECTRICAL OUTLET) - FIRST FLOOR

16May23 Note:

1 - GAS LINE ROUGH-IN FOR BARBECUE - FIRST FLOOR

16May23 Note:

HARDWOOD FLOORING

1 - HARDWOOD - GROUP A SERIES 3 1/4 INCH - IN LIEU OF 3 1/4 INCH NATURAL RED OAK - - FIRST FLOOR IN STANDARD HARDWOOD AREAS

25Sep23 Note:

MIRRORS AND GLASS

1 - MASTER ENSUITE – FRAMELESS GLASS SHOWER ENCLOSURE – INCLUDES CHROME KNOB AND HINGES

16May23 Note:

PLUMBING

1 - SINK - UNDERMOUNT SINK - BLANCO QUATRUS R15 U2 #401519

05Oct23 Note:

KITCHEN

6 - MOEN EVA SINGLE HANDLE LAV FAUCET #6400 CHROME

ALL BATHROOMS

05Oct23 Note:

1 - KITCHEN - ALIGN 7565 SINGLE HANDLE PULLDOWN

05Oct23 Note:

6 - SINK - DROP IN SINK CONTRACT REAVES 4" CENTER 6440STZ

05Oct23 Note:

ALL BATHROOMS

2 - MOEN ALIGN FAUCET T2193EP/62380CHROME FINISH

ENSUITE 2 & ENSUITE 3/4

25Sep23 Note:

TUB/SHOWER FAUCET

1 - PRIMARY ENSUITE - MOEN CHATEAU POSI-TEMP TUB/SHOWER FAUCET WITH 3 FUNCTION TRANSFER VALVE/TRIM AND SLIDE BAR WITH HAND SHOWER – CHROME TL183EP/U361CI/UT2721/3669EP/A725/62320

16May23 Note: PRICE INCLUDES TO TESTER

1 - WATER LINE FOR FRIDGE - ROUGH-IN ONLY

16May23 Note:

1 - ENSUITE 3/4 - TUB TO SHOWER CONVERSION - 5 FOOT SHOWER WITH SLIDING GLASS CHROME DOORS IN LIEU OF TUB

16May23 Note:

PROMOTIONAL

1 - LESS CREDIT FROM PURCHASER EXTRA SHEET IN OFFER

16May23 Note:

STAIRS AND RAILINGS



CONSTRUCTION SUMMARY

Red Oaks - Roundel Homes Inc.

PURCHASER: Xiangwen WANG

TEL: RES.: 647-863-3909

LOT / PHASE 52 / 2	REG. PLAN # 65M-4737	HOUSE TYPE Pinetree 3 Elev 3		
-----------------------	-------------------------	---------------------------------	--	--

1 - STAINED STAIRS – STANDARD STAIRCASE - PRICE IS PER SET 25Sep23 Note:	
--	--

EXTRAS AS PER OFFER

The Vendor agrees that notwithstanding any other term or provision in this Agreement included in the Purchase Price and in addition to those items detailed in Schedule GP to the Agreement of Purchase and Sale, the Purchaser is entitled to a credit of Ten Worksheet Note:	
--	--

10 foot ceiling height on Main Floor. The Purchaser acknowledges that as a result of the increased ceiling height from the Vendor?s standard ceiling height, various modifications to the interior and exterior of the dwelling unit may be made, including Worksheet Note:	
---	--

This Document is Extremely Time Sensitive - Printed 6 Oct 23 at 10:35

Purchaser:

Telephone Res. / Bus:

Decor Advisor:

Lock Date:

Xiangwen WANG

(647) 863-3909 /

Ida Viola

28-Sep-23

Property: 52

Project: Roundel Homes Inc.

Model and Elevation: Pinetree 3 Elev 3

25-Sep-23

Plan #:

65M-4737

1. Cabinetry

	Style and Colour	Hardware
Kitchen / Breakfast	MONACO 350 PLATINUM SILVER	464SA
Laundry Room	ELISSE	Standard
Powder Room	DORAL WHITE W500	464SA
Master Ensuite Bathroom	DORAL WHITE W500	464SA
Ensuite Bath - Bedroom 2	DORAL WHITE W500	464SA
Ensuite Bath - Bedroom 3/4	DORAL WHITE W500	464SA
Stove Opening	STANDARD	NOTE: If not specified, opening will be set to builder's standard opening of approximately 30" width
Fridge Opening	STANDARD	NOTE: If not specified, opening will be set to builder's standard opening of approximately 37" width x 74" height

** Refer to Construction Summary

2. Counters

	Counter	Edge	Niche
Kitchen / Breakfast	GRANITE-NERO IMPALA	#360 EDGE	
Laundry Room	N/A		
Powder Room	LAMINATE-CALCUTTA MARBLE 4925K-07		
Master Ensuite Bathroom	LAMINATE-CALCUTTA MARBLE 4925K-07		
Ensuite Bath - Bedroom 2	LAMINATE-CALCUTTA MARBLE 4925K-07		
Ensuite Bath - Bedroom 3/4	LAMINATE-CALCUTTA MARBLE 4925K-07		
Kitchen Backsplash	N/A		

** Refer to Construction Summary

Purchaser:

Xiangwen WANG

Telephone Res. / Bus:

(647) 863-3909 /

Decor Advisor:

Ida Viola

Lock Date:

28-Sep-23

Property: 52

Project: Roundel Homes Inc.

Model and Elevation: Pinetree 3 Elev 3

Plan #: 65M-4737

25-Sep-23

3. Ceramic Flooring

Entrance Vestibule	TILE-EMOTIONS GRIS 12.5 X 12.5	At a 45
Main Hall	HARDWOOD	
Kitchen / Breakfast	TILE-EMOTIONS GRIS 12.5 X 12.5	
Laundry Room	TILE-EMOTIONS GRIS 12.5 X 12.5	
Powder Room	TILE-EMOTIONS GRIS 12.5 X 12.5	
Master Ensuite Bathroom	TILE-EMOTIONS GRIS 12.5 X 12.5	
Ensuite Bath - Bedroom 2	TILE-EMOTIONS GRIS 12.5 X 12.5	
Ensuite Bath - Bedroom 3/4	TILE-EMOTIONS GRIS 12.5 X 12.5	
Mud Room	TILE-EMOTIONS GRIS 12.5 X 12.5	

** Refer to Construction Summary ** METAL STRIP THRESHOLD WHERE APPLICABLE UNLESS SPECIFIED **

4. Ceramic Wall Tile

Master Ensuite Bathroom	Selection	Describe
Tub Deck Wall		
Shower Stall	TILE-EXTRA LIGHT GREY 8X16	
Bathtub Enclosure Walls		
Ensuite Bath - Bedroom 2	TILE-EXTRA LIGHT GREY 8X16	
Ensuite Bath - Bedroom 3/4	TILE-EXTRA LIGHT GREY 8X16	
Mud Room	N/A	
Kitchen Backsplash	N/A	

** Refer to Construction Summary - STANDARD GROUT THROUGHOUT UNLESS SPECIFIED

5. Trim Carpentry

Interior Doors	CARRARA-SMOOTH
Interior Trim	As Per Construction Specifications

** Refer to Construction Summary

6. Plaster Mouldings and Medallions

Entrance Vestibule	N/A		Kitchen/Breakfast	N/A	
Main Hall	N/A		Den/Library	N/A	
Living Room	N/A		Lower Landing	N/A	
Dining Room	N/A				
Family Room	N/A				

** Refer to Construction Summary

Purchaser: Xiangwen WANG

Telephone Res. / Bus: (647) 863-3909 /

Decor Advisor: Ida Viola

Lock Date: 28-Sep-23

Property: 52

Project: Roundel Homes Inc.

Model and Elevation: Pinetree 3 Elev 3

25-Sep-23

Plan #: 65M-4737

7. Other Flooring

Main Hall	HARDWOOD - MIRAGE RIO RED OAK EXCLUSIVE 3 1/4" CASHMERE
Living Room	HARDWOOD - MIRAGE RIO RED OAK EXCLUSIVE 3 1/4" CASHMERE
Dining Room	HARDWOOD - MIRAGE RIO RED OAK EXCLUSIVE 3 1/4" CASHMERE
Family Room	HARDWOOD - MIRAGE RIO RED OAK EXCLUSIVE 3 1/4" CASHMERE
Den / Library / Study	N/A
Basement Landing(If Applies)	N/A
Lower Landing (If Applies)	HARDWOOD - MIRAGE RIO RED OAK EXCLUSIVE 3 1/4" CASHMERE
Upper Landing	HARDWOOD - MIRAGE RIO RED OAK EXCLUSIVE 3 1/4" CASHMERE
Upper Hall	LAMINATE-LEXINGTON BRUSSELS OAK TL LW1316 PEFC
Master Bedroom	LAMINATE-LEXINGTON BRUSSELS OAK TL LW1316 PEFC
Bedroom #2	LAMINATE-LEXINGTON BRUSSELS OAK TL LW1316 PEFC
Bedroom #3	LAMINATE-LEXINGTON BRUSSELS OAK TL LW1316 PEFC
Bedroom #4	LAMINATE-LEXINGTON BRUSSELS OAK TL LW1316 PEFC
Bedroom #5	N/A

Underpad

Standard ☐

Upgrade

** Refer to Construction Summary

8. Railings and Pickets

Railing Type	AS PER CONSTRUCTION SPECIFICATIONS	Colour	MIRAGE RIO RED OAK
Picket Type	AS PER CONSTRUCTION SPECIFICATIONS	Colour	MIRAGE RIO RED OAK
Stringer / Riser	AS PER CONSTRUCTION SPECIFICATIONS	Colour	MIRAGE RIO RED OAK
Treads	AS PER CONSTRUCTION SPECIFICATIONS	Colour	MIRAGE RIO RED OAK

Red Oak Stairs as Per Vendor's Standard

** Refer to Construction Summary THE STAIN COLOURS OR FINISH AVAILABLE ON RISERS, TREADS, PICKETS AND RAILS (STAIRCASES), WILL NOT BE AN EXACT MATCH TO PREFINISHED HARDWOOD OR LAMINATE FLOORS.

9. Wall Paint Flat Finish

Main & Upper Hall	22 WARM GREY	Master Bedroom	22 WARM GREY
Living Room	22 WARM GREY	Bedroom #2	22 WARM GREY
Dining Room	22 WARM GREY	Bedroom #3	22 WARM GREY
Kitchen / Breakfast	22 WARM GREY	Bedroom #4	22 WARM GREY
Family Room	22 WARM GREY	Bedroom #5	N/A
Powder Room	22 WARM GREY	Master Ensuite	22 WARM GREY
Laundry Room	22 WARM GREY	Ensuite Bath - Bedroom 2	22 WARM GREY
Den/Library	22 WARM GREY	Ensuite Bath - Bedroom 3/4	22 WARM GREY
Trim & Door Paint-Semi Gloss	BIRCH WHITE	Mud Room	22 WARM GREY

** Refer to Construction Summary

Purchaser: Xiangwen WANG

Telephone Res. / Bus: (647) 863-3909 /

Decor Advisor: Ida Viola

Lock Date: 28-Sep-23

Property: 52

Project: Roundel Homes Inc.

Model and Elevation: Pinetree 3 Elev 3

25-Sep-23

Plan #: 65M-4737

10. Fireplace

	Living Room			Family Room			Other Room - Specify		
	Purchased	As Per Plan	N/A	Purchased	As Per Plan	N/A	Purchased	As Per Plan	N/A
Fireplace Type	<input type="radio"/>	<input type="radio"/>	<input type="radio"/>	<input type="radio"/>	<input checked="" type="radio"/>	<input type="radio"/>	<input type="radio"/>	<input type="radio"/>	<input type="radio"/>
Mantle Type				As Per Construction Specifications					
Colour / Stain				MANTLE M2-STANDARD					
Surround				AS PER CONSTRUCTION SPECIFICATIONS					
Hearth				NERO					
				NO					
** Refer to Construction Summary									

11. Air Conditioning

Air Conditioning

NO

Comment

** Refer to Construction Summary

12. General Comments

** Refer to Construction Summary

Disclaimers and Notes

- 1) Colours of all materials are as close as possible to builder's selection, but not necessarily identical due to variances in manufacturing.

2) Any extras listed above are null and void unless accompanied by a separate invoice/amendment. Said invoice must be paid in full.

3) The Purchaser agrees that this colour selection is final and that no changes will be permitted, unless required by the Vendor.

4) The Purchaser acknowledges reading and accepting document which contains other miscellaneous disclaimers.

5) In the event of a conflict between the Standard Features schedule of the Agreement of Purchase and Sale and the Interior Colour Scheme, the Interior Colour Scheme shall prevail.

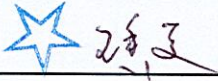
Signature: 

Date: Sep 28th 2023

Lot 52 Roundel 2

Pinetree 3

ELEV. 1 • 2,682 sq. ft. | ELEV. 2 • 2,673 sq. ft. | ELEV. 3 • 2,686 sq. ft.
Includes 38 sq. ft. of open area.

Center Light
Between
Living/Dining

Center light
over Island
Add Plug
over Airplace

Electric Car
Rough IN
19'11" x 17'8"

1 ft x 10' Ceiling

Festive Plug

TUB
TO SHOWER

Frameless Glass
Shower Enclosure



Orientation of home may be reversed and purchaser agrees to accept the same. Steps and porches may vary at any exterior entrance ways due to grading variance. Actual usable floor space may vary from the stated floor areas. All renderings are artist's concept. Dimensions, specifications and architectural detailing subject to modifications. Roofline and adjoining model types may vary due to siting. E. & O. E. June 2022

Lot 52 Roundel 2

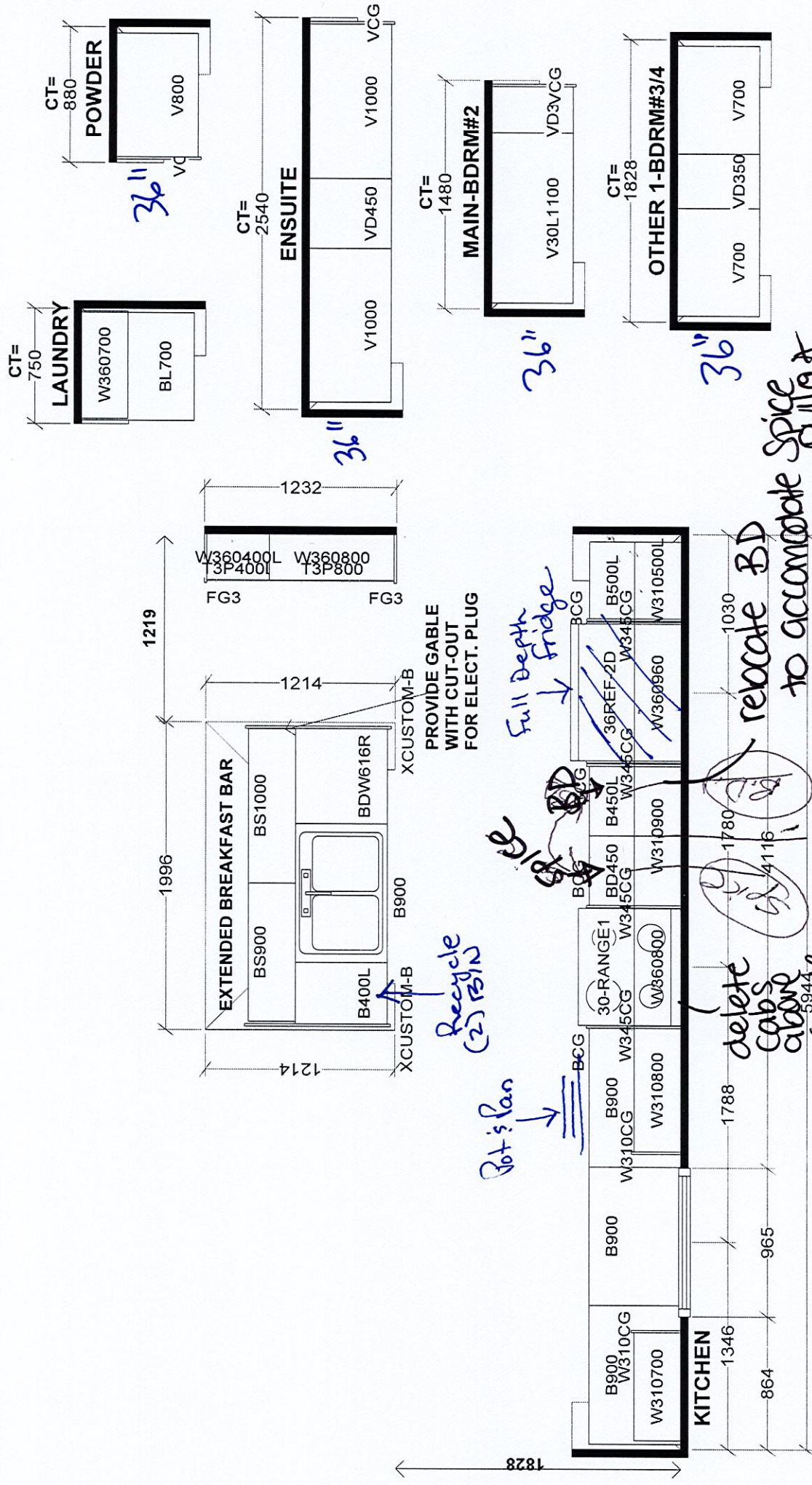

<div style="display: flex; justify-content: space-between;"> range Selba Industries J # _____ </div>			
<small>(This drawing is the intellectual property of SELBA INDUSTRIES INC. and is an original design which must not be released or copied unless applicable fee has been paid or job order placed.)</small>			
W WIDTH _____	W HIGHT _____	W CNT _____	JOB NUMBER: _____
FLOOR HIGHT _____	DOOR HIGHT _____		BUILDER: GREENPARK
			SITE: ROUNDLE, Richmond Hill
ST CNT _____	2X4 _____	VENT BOX COVER _____	MODEL: PINETREE 3X EL 1,2,3
			LOT #:
			DESIGNER: KS
			DATE: JUNE 7 21

ELICA PRO SERIES
LEONE

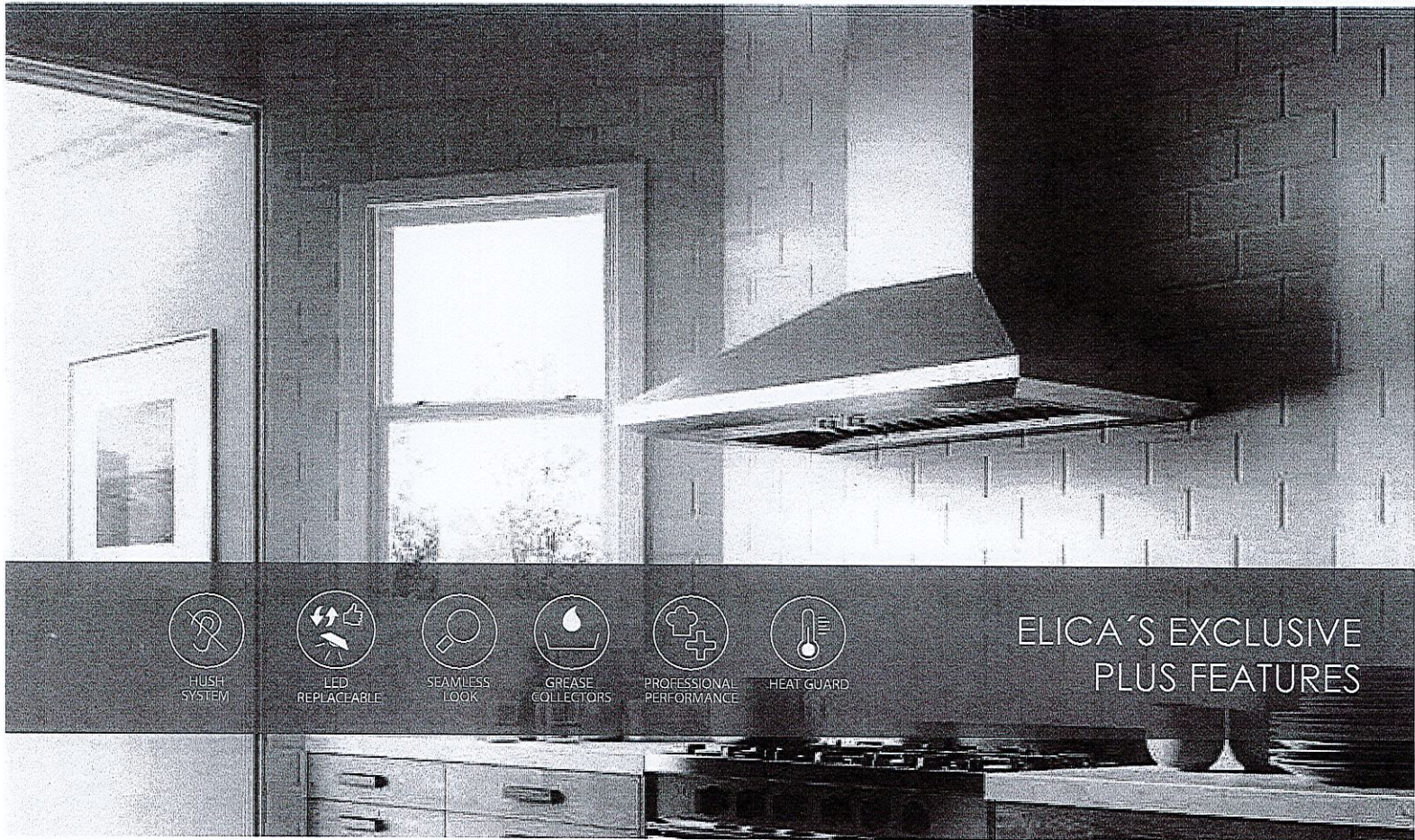

Give a splash of Italian design to your professional kitchen with Leone's crisp lines, seamless welded corner craftsmanship, beveled rim and gleaming stainless steel.

Leone has the extra depth (24") and power (1200 CFM on 36", 42" & 48" W) & 36" in 600 CFM needed to support professional ranges and cooktops. No ear plugs required with Leone's HUSH sound suppression system, which enables you to comfortably talk and entertain, even when cooking up a storm. Available in 30", 36" and 42" widths, Leone features backlit hidden knob controls, which operate the 4-speed blower and LED lighting. Designed for standard ducted ventilation only.

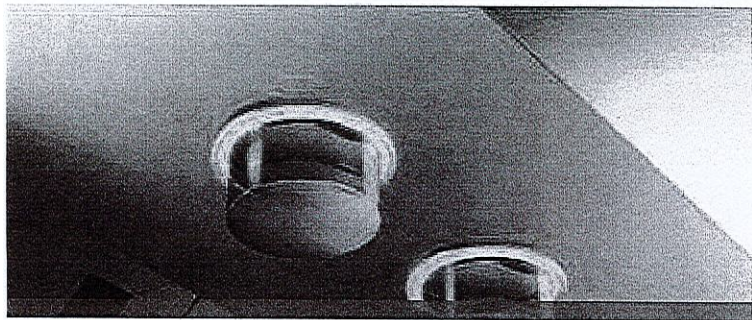
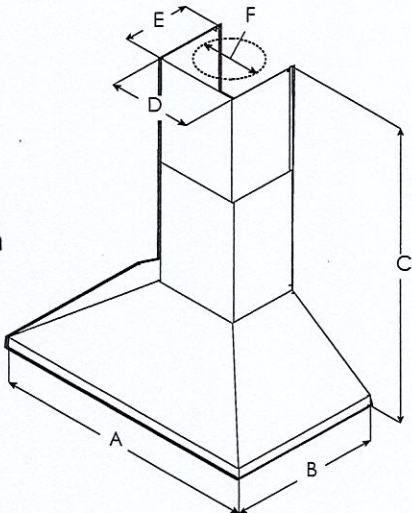

	ELN630S2	ELN636SS ELN136S2	ELN142S2	ELN148SS
A	30" (76.2 cm)	36" (91.4 cm)	42" (106.7 cm)	48" (121.9 cm)
B	24" (61 cm)			
C	Max: 47 5/8" (120.9 cm) Min: 30" (76.2 cm)			
D	13 2/16" (33.2 cm)			



SPECIFICATIONS

	30" Unit	36" Unit	42" Unit	48" Unit
Model:	ELN630S2	ELN636SS (600 CFM) ELN136S2 (1200 CFM)	ELN142S2	ELN148SS
Dimensions:	30"W x 24"D x 12 1/8"H	36"W x 24"D x 12 1/8"H	42"W x 24"D x 12 1/8"H	48"W x 24"D x 12 1/8"H
Blower Type(internal):	600 CFM(4-speed)	600 CFM & 1200 CFM (4-speed)	1200 CFM(4-speed)	1200 CFM(4-speed)
Blower Performance:				
Speed 1	205 CFM	205 CFM 375 CFM	375 CFM	375 CFM
Speed 2	350 CFM	350 CFM 640 CFM	640 CFM	640 CFM
Speed 3	510 CFM	510 CFM 940 CFM	940 CFM	940 CFM
Speed 4	600 CFM	600 CFM 1200 CFM	1200 CFM	1200 CFM
Noise (sones):	Min:2.01, Max:6	Min: .8 , Max: 9.5	Min:3.21, Max:7.7	Min:3.21, Max:7.7
Working Speed				
Finish:	Stainless Steel			
Controls:	Fully retractable rotating knobs with blue backlighting			
Illumination:	2 LED, 7.5 Watts	2 LED, 6.5 Watts (ELN636SS) 2 LED, 7.5 Watts (ELN136S2)	2 LED, 7.5 Watts	2 LED, 7.5 Watts
(replaceable lamps 1 intensity)				
Filter Type:	Dishwasher-Safe, Professional Stainless Steel, Angles baffled filters			
Angled Baffle Filters:	1	2	2	3
Duct Transition:	8" Round with BackDraft Damper (top only)			
Installation Type:	Ducted Installation Only			
Electrical:	120V - 60 Hz			
KITS:				
Long Chimney Ext.	KIT02785 (13') & KIT01935 (11' 4")			
1200 CFM External Blower	KIT0153054			
1200 CFM In Line Blower	KIT0154387			
Replacement Grease Filter (1):	GF09EA			
Replacement Light Bulb (1):	LMP0131098	LMP0131098A (ELN636SS) LMP0131098 (ELN136S2)	LMP0131098	LMP0131098
	*Consumable parts are sold in units of one (1). Order accordingly			
INSTALL HEIGHTS:				
Ranger Hood:	Min: 8' , Max 10'			
Ranger Hood with extension duct covers:	Min: 9'9" , Max 13'			
WARRANTY:	2 YEARS PARTS AND LABOR, EARN A 3RD YEAR OF FULL FACTORY WARRANTY REGISTERING YOUR PRODUCT ON ELICA.COM			

PLUS FEATURES

** For valid warranty extension, register within 3 months from purchase. For USA & Canada Users only

*The product images shown are for illustration purposes only and may not be an exact representation of the product.



HUSH SYSTEM - An exclusive sound deadening technology that effectively reduces sound levels by over 35%



LED CONSUMER REPLACEABLE BULB - High quality LED lighting usually requires a skilled technician to replace lamps. Avoid this expense with Elica's new LED lamps that enable homeowners to replace in seconds



STAINLESS STEEL BAFFLE FILTERS WITH GREASE COLLECTORS - Designed for high airflow cooking, the "S" shape design traps high volumes of grease



PROFESSIONAL PERFORMANCE - Special features and high performances for models with aspiration capacity between 600 and 1200 CFM's



Roundel Lot # 52
Moen - Align T2193EP/62380-(CHROME)

ensuite 2
ENSUITE 3/4

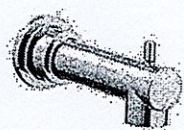
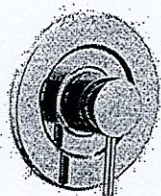
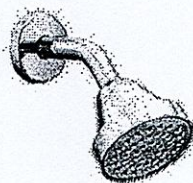

Model: T2193EP

Align Chrome Posi-Temp® Eco-Performance Tub/Shower

★★★★☆ 4.0 | 1 Review

[3 questions](#) and [3 answers](#) for this product

[Write a review](#)

[Ask a question](#)

Align faucets and accessories bring a refreshed Modern look to your home. Use them in large master baths or small powder rooms. The simple lines and contemporary style are beautiful. A full line of coordinating products is available to complete the look of your bath. The clear laminar stream produces a beautiful water presentation.



Required for Installation

Valve

Please select



XWW



REAVES

ITEM DETAILS

DIMENSIONS 20¼" W x 17¾" D x 7½" H

MATERIAL Fine fireclay

COLOUR Soft white

Rectangular drop-in sink | Rear overflow | Available in single hole, 4" faucet center, or 8" faucet center | Template supplied | Faucet not included

CERTIFICATIONS

- | IAPMO cUPC
- | ASME A112.19.2 / CSA B45.1
- | ANSI A117.1 ADA Guideline
- | NBC and OBC Section 3.8 barrier free design and CSA B651 Standard



SINGLE HOLE
6410STZ

4" CENTER
6440STZ

8" CENTER
6480STZ

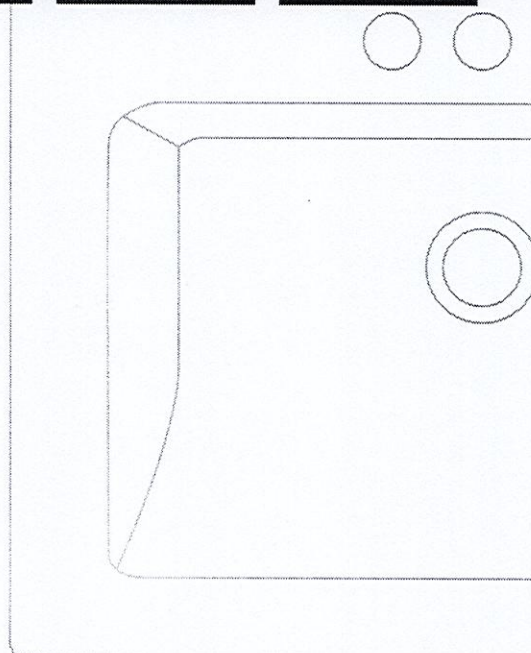

ISSUED JULY 2019

All Bathrooms

XWW

Lot 52
Roundel

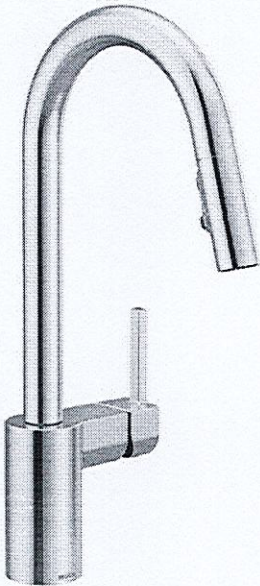

Model: 7565

Align Chrome One-Handle High Arc Pulldown Kitchen Faucet

From intimate galley kitchens to large gourmet workstations, Align faucets bring a refreshed, Modern look to your home. Simple lines create the contemporary style.

Where to Buy



Kitchen

Align Chrome One-Handle High Arc Pulldown Kitchen Faucet

GALLERY 

Where to Buy



Application

One Or Three Hole

Connection
Size



Lot 52
Roude1

Kitchen Sink - Undermount Blanco Quatrus
R15 U2 401519