

CONSTRUCTION SUMMARY

Red Oaks - Roundel Homes Inc.

RECEIVED

AUG 18 2023

TEL: RES.: 416-835-3638

PURCHASER: Jing YANG

LOT / PHASE	REG. PLAN #	HOUSE TYPE		
72 / 2	65M-4737	Glenrowan 1 Elev 3		

CABINETRY ACCESSORIES

1 - CABINETRY FEE FOR FLUSH DISHWASHER - PROVIDE EXTRA DEPTH FOR DISHWASHER SEE SPECS. 17Aug23 Note:	New	★
1 - KITCHEN CABINETRY - APPLIANCE DOOR PANELS - 24" DISHWASHER DOOR PANEL (SUPPLY ONLY, INSTALLATION NOT INCLUDED, HARDWARE NOT INCLUDED) - STANDARD LEVEL 17Aug23 Note: PURCHASER TO SUPPLY AND INSTALL OWN HARDWARE AFTER CLOSING	New	★
1 - CABINETRY FLUSH FEE FOR INTEGRATED FRIDGE 17Aug23 Note:	New	★
1 - KITCHEN CABINETRY - APPLIANCE DOOR PANELS - FRIDGE DOOR PANELS - SUPPLY ONLY, INSTALLATION NOT INCLUDED, HARDWARE NOT INCLUDED - 30"-36" WIDE FRIDGES - STANDARD LEVEL 17Aug23 Note: PURCHASER TO SUPPLY AND INSTALL OWN HARDWARE AFTER CLOSING	New	★
1 - KITCHEN CABINETRY - BUILT-IN FRIDGE FEE - PRICE IS EACH 17Aug23 Note:	New	★
1 - KITCHEN CABINETRY BASE - POT/PAN DRAWERS (CABINET) - STANDARD LEVEL 08Aug23 Note: NEXT TO STOVE - SEE SKETCH		
1 - KITCHEN CABINETRY UPPER - FULL DEPTH ABOVE FRIDGE - WITH GABLES - 650 DEEP - PRICE IS EACH 08Aug23 Note:		
5 - PANTRY UNIT UPGRADE - TO GO FROM 300MM TO 600MM DEEP - PRICE IS PER FOOT - STANDARD LEVEL 08Aug23 Note: PANTRY ON STOVE WALL		
1 - PANTRY UNIT UPGRADE - TO GO FROM 300MM TO 600MM DEEP - PRICE IS PER FOOT - STANDARD LEVEL 08Aug23 Note: PANTRY NEXT TO FRIDGE		

CERAMIC TILE

1 - DELETE ALL CERAMIC BATHROOM ACCESSORIES - DELETE TOWEL BAR, PAPER HOLDER & SOAP DISH THROUGHOUT 08Aug23 Note:	
--	--

CONSTRUCTION

1 - PROVISION FOR SHAMPOO NICHE APPROX. 14" WIDE X 20" HIGH AS PER SKETCH - IF CONSTRUCTION PERMITS 27Apr23 Note: MASTER ENSUITE	
1 - FRAMELESS GLASS SHOWER ENCLOSURE PROVISION - REMOVE SIDE WALL AND REPLACE WITH GLASS TO ACCOMODATE FRAMELESS GLASS SHOWER ENCLOSURE SEE SKETCH 27Apr23 Note:	

COUNTER TOP

1 - UPGRADE STONE COUNTER TOP MATERIAL - KITCHEN BACKSPLASH 08Aug23 Note:	
1 - UPGRADE STONE COUNTER TOP - KITCHEN - IN LIEU OF STANDARD MATERIAL 08Aug23 Note:	
1 - SHAMPOO NICHE 14" WIDE X 20" HIGH AS PER SKETCH - MARBLE, GRANITE OR QUARTZ - IF CONSTRUCTION PERMITS - REQUIRES PROVISION FROM CONSTRUCTION 27Apr23 Note: SUPPLY & INSTALL MASTER ENSUITE	

ELECTRICAL

CONSTRUCTION SUMMARY

Red Oaks - Roundel Homes Inc.

PURCHASER: Jing YANG

TEL: RES.: 416-835-3638

LOT / PHASE	REG. PLAN #	HOUSE TYPE		
72 / 2	65M-4737	Glenrowan 1 Elev 3		
1 - PLUG - ELECTRICAL PLUG - TO BE INSTALLED OVER FIREPLACE 27Apr23 Note:				
1 - RELOCATE STANDARD KITCHEN LIGHT TO BE CENTERED OVER ISLAND 27Apr23 Note:				
7 - POT LIGHT - EXTERIOR - SOFFIT MOUNT - REGULAR VOLTAGE 27Apr23 Note: SEE SKETCH				
1 - PLUG - ELECTRICAL PLUG WITH GFI AND SWITCH - FOR FESTIVE LIGHTING 27Apr23 Note: PORTICO				
1 - ELECTRIC VEHICLE ROUGH-IN PROVISION ONLY FOR FUTURE ELECTRIC CAR (CONDUIT FROM BASEMENT INTO JUNCTION BOX IN GARAGE WITH PULL STRING, NO WIRE) 27Apr23 Note:				

FIREPLACE AND ACCESSORIES

1 - GAS LINE ROUGH-IN FOR BARBECUE - FIRST FLOOR 27Apr23 Note:	
1 - GAS LINE ROUGH-IN FOR STOVE (INCLUDES ELECTRICAL OUTLET) - FIRST FLOOR 27Apr23 Note:	

HARDWOOD FLOORING

1 - HARDWOOD - GROUP B SERIES 5 INCH - IN LIEU OF 3 1/4 INCH NATURAL RED OAK - - FIRST FLOOR IN STANDARD HARDWOOD AREAS 08Aug23 Note:	
--	--

HEATING AND AIR CONDITIONING

1 - HUMIDIFER 27Apr23 Note:	
--------------------------------	--

MIRRORS AND GLASS

1 - SHOWER DOOR HANDLE - SQUARE D-RING/TOWEL BAR COMBO #SQ6X18MBL - MATTE BLACK FINISH 08Aug23 Note: INCLUDES CLIPS IN MATTE BLACK FINISH	
MASTER ENSUITE	
1 - MASTER ENSUITE – FRAMELESS GLASS SHOWER ENCLOSURE – INCLUDES CHROME KNOB AND HINGES 27Apr23 Note:	

PLUMBING

3 - TOE TESTER - ADD TOE TESTER TO SHOWER 27Apr23 Note: MASTER ENSUITE ENSUITE 2 ENSUITE 3/4	
1 - HOSE BIB - EXTERIOR FROST FREE 27Apr23 Note: 1 @ REAR OF HOUSE	
1 - WATER LINE FOR FRIDGE - ROUGH-IN ONLY 27Apr23 Note:	
1 - TUB TO SHOWER CONVERSION - 5 FOOT SHOWER WITH SLIDING GLASS CHROME DOORS IN LIEU OF TUB 27Apr23 Note: ENSUITE 3/4	

CONSTRUCTION SUMMARY

Red Oaks - Roundel Homes Inc.

PURCHASER: Jing YANG

TEL: RES.: 416-835-3638

LOT / PHASE 72 / 2	REG. PLAN # 65M-4737	HOUSE TYPE Glenrowan 1 Elev 3		
-----------------------	-------------------------	----------------------------------	--	--

PROMOTIONAL

1 - LESS CREDIT FROM PURCHASER EXTRA SHEET IN OFFER 27Apr23 Note:	
--	--

STAIRS AND RAILINGS

1 - STAINED STAIRS – STANDARD STAIRCASE - PRICE IS PER SET 08Aug23 Note:	
1 - EUROLINE 1 BLACK PICKETS 08Aug23 Note:	

EXTRAS AS PER OFFER

The Vendor agrees that notwithstanding any other term or provision in this Agreement included in the Purchase Price and in addition to those items detailed in Schedule GP to the Agreement of Purchase and Sale, the Purchaser is entitled to a credit of Ten Worksheet Note:	
10 foot ceiling height on Main Floor. The Purchaser acknowledges that as a result of the increased ceiling height from the Vendor?s standard ceiling height, various modifications to the interior and exterior of the dwelling unit may be made, including bu Worksheet Note:	

This Document is Extremely Time Sensitive - Printed 17 Aug 23 at 13:58

Purchaser:Jing YANG

Telephone Res. / Bus: (416) 835-3638 /

Decor Advisor:Giulia Di Girolamo

Lock Date:17-Aug-23

Property: 72

Project: Roundel Homes Inc.

Model and Elevation: Glenrowan 1 Elev 3

8-Aug-23

Plan #: 65M-4737

1. Cabinetry

	Style and Colour	Hardware
Kitchen / Breakfast	DORAL - WHITE W500	464SA
Laundry Room	ELISSE	Standard
Powder Room	DORAL - K43 SUMMIT WHITE	179SA
Master Ensuite Bathroom	DORAL - K43 SUMMIT WHITE	179SA
Ensuite Bath - Bedroom 2	DORAL - K43 SUMMIT WHITE	179SA
Ensuite Bath - Bedroom 3/4	DORAL - K43 SUMMIT WHITE	179SA
Stove Opening	STANDARD	NOTE: If not specified, opening will be set to builder's standard opening of approximately 30" width
Fridge Opening	36"-SEE SPECS	NOTE: If not specified, opening will be set to builder's standard opening of approximately 37" width x 74" height

** Refer to Construction Summary

2. Counters

	Counter	Edge	Niche
Kitchen / Breakfast	QUARTZ-MISTRAL	#360 EDGE	
Laundry Room	N/A		
Powder Room	LAMINATE-CALCUTTA MARBLE 4925K-07		
Master Ensuite Bathroom	LAMINATE-CALCUTTA MARBLE 4925K-07		
Ensuite Bath - Bedroom 2	LAMINATE-CALCUTTA MARBLE 4925K-07		
Ensuite Bath - Bedroom 3/4	LAMINATE-CALCUTTA MARBLE 4925K-07		
Kitchen Backsplash	QUARTZ-MISTRAL -FULL HEIGHT		

** Refer to Construction Summary

Purchaser:

Jing YANG

Telephone Res. / Bus:

(416) 835-3638 /

Decor Advisor:

Giulia Di Girolamo

Lock Date:

8-Aug-23

Property: 72

Project: Roundel Homes Inc.

Model and Elevation: Glenrowan 1 Elev 3

Plan #: 65M-4737

3. Ceramic Flooring

At a 45

Entrance Vestibule	TILE-CONCRETE WHITE 13X13	<input type="checkbox"/>
Main Hall	HARDWOOD	<input type="checkbox"/>
Kitchen / Breakfast	TILE-CONCRETE WHITE 13X13	<input type="checkbox"/>
Laundry Room	TILE-CONCRETE WHITE 13X13	<input type="checkbox"/>
Powder Room	TILE-CONCRETE WHITE 13X13	<input type="checkbox"/>
Master Ensuite Bathroom	TILE-FORM LIGHT GREY 12X12	<input type="checkbox"/>
Ensuite Bath - Bedroom 2	TILE-FORM LIGHT GREY 12X12	<input type="checkbox"/>
Ensuite Bath - Bedroom 3/4	TILE-FORM LIGHT GREY 12X12	<input type="checkbox"/>
		<input type="checkbox"/>
		<input type="checkbox"/>
		<input type="checkbox"/>

** Refer to Construction Summary

4. Ceramic Wall Tile

Master Ensuite Bathroom	Selection	Describe
Tub Deck Wall	N/A	
Shower Stall	TILE-CONCEPT NEVE MATTE 8X16	NICHE:QUARTZ-MISTRAL
Bathtub Enclosure Walls	N/A	
Ensuite Bath - Bedroom 2	TILE-CONCEPT NEVE MATTE 8X16	
Ensuite Bath - Bedroom 3/4	TILE-CONCEPT NEVE MATTE 8X16	
Kitchen Backsplash	QUARTZ-MISTRAL -FULL HEIGHT	

** Refer to Construction Summary - STANDARD GROUT THROUGHOUT UNLESS SPECIFIED

5. Trim Carpentry

Interior Doors	CARRARA-SMOOTH
Interior Trim	3" BB CASING WITH 5 1/4" BASEBOARD - COLONIAL

** Refer to Construction Summary

6. Plaster Mouldings and Medallions

Entrance Vestibule			Kitchen/Breakfast		
Main Hall			Den/Library		
Living Room			Lower Landing		
Dining Room					
Family Room					

** Refer to Construction Summary

Purchaser:

Jing YANG

Telephone Res. / Bus:

(416) 835-3638 /

Decor Advisor:

Giulia Di Girolamo

Lock Date:

8-Aug-23

Property: 72

Project: Roundel Homes Inc.

Model and Elevation: Glenrowan 1 Elev 3

Plan #: 65M-4737

7. Other Flooring

Main Hall	HARDWOOD-IMAGINE COLLECTION-DRIFTWOOD RED OAK CHARACTER-5" CORK-DURAMATT
Living Room	N/A
Dining Room	HARDWOOD-IMAGINE COLLECTION-DRIFTWOOD RED OAK CHARACTER-5" CORK-DURAMATT
Family Room	HARDWOOD-IMAGINE COLLECTION-DRIFTWOOD RED OAK CHARACTER-5" CORK-DURAMATT
Den / Library / Study	N/A
Basement Landing(If Applies)	N/A
Lower Landing (If Applies)	HARDWOOD-IMAGINE COLLECTION-DRIFTWOOD RED OAK CHARACTER-5" CORK-DURAMATT
Upper Landing	HARDWOOD-IMAGINE COLLECTION-DRIFTWOOD RED OAK CHARACTER-5" CORK-DURAMATT
Upper Hall	LAMINATE-LEXINGTON-ROCHEFORT OAK-TL-LW1317
Master Bedroom	LAMINATE-LEXINGTON-ROCHEFORT OAK-TL-LW1317
Bedroom #2	LAMINATE-LEXINGTON-ROCHEFORT OAK-TL-LW1317
Bedroom #3	LAMINATE-LEXINGTON-ROCHEFORT OAK-TL-LW1317
Bedroom #4	LAMINATE-LEXINGTON-ROCHEFORT OAK-TL-LW1317
Bedroom #5	N/A
Underpad	Standard <input type="checkbox"/> Upgrade <input type="checkbox"/> N/A

** Refer to Construction Summary

8. Railings and Pickets

Railing Type	AS PER CONSTRUCTION SPECIFICATIONS	Colour	MIRAGE-RED OAK-DRIFTWOOD
Picket Type	EUROLINE 1	Colour	BLACK
Stringer / Riser	AS PER CONSTRUCTION SPECIFICATIONS	Colour	MIRAGE-RED OAK-DRIFTWOOD
Treads	AS PER CONSTRUCTION SPECIFICATIONS	Colour	MIRAGE-RED OAK-DRIFTWOOD

Red Oak Stairs as Per Vendor's Standard

** Refer to Construction Summary THE STAIN COLOURS OR FINISH AVAILABLE ON RISERS, TREADS, PICKETS AND RAILS (STAIRCASES), WILL NOT BE AN EXACT MATCH TO PREFINISHED HARDWOOD OR LAMINATE FLOORS.

9. Wall Paint Flat Finish

Main & Upper Hall	22 WARM GREY	Master Bedroom	22 WARM GREY
Living Room	N/A	Bedroom #2	22 WARM GREY
Dining Room	22 WARM GREY	Bedroom #3	22 WARM GREY
Kitchen / Breakfast	22 WARM GREY	Bedroom #4	22 WARM GREY
Family Room	22 WARM GREY	Bedroom #5	N/A
Powder Room	22 WARM GREY	Master Ensuite	22 WARM GREY
Laundry Room	22 WARM GREY	Ensuite Bath - Bedroom 2	22 WARM GREY
Den/Library	N/A	Ensuite Bath - Bedroom 3/4	22 WARM GREY
Trim & Door Paint-Semi Gloss	BIRCH WHITE		

** Refer to Construction Summary

Purchaser:

Jing YANG

Telephone Res. / Bus:

(416) 835-3638 /

Decor Advisor:

Giulia Di Girolamo

Lock Date:

8-Aug-23

Property: 72

Project: Roundel Homes Inc.

Model and Elevation: Glenrowan 1 Elev 3

Plan #: 65M-4737

10. Fireplace

Living Room

Purchased

As Per Plan

N/A

☐

☐

☒

Family Room

Purchased

As Per Plan

N/A

☐

☒

☐

Other Room - Specify

Purchased

As Per Plan

N/A

☐

☐

☒

Fireplace Type

As Per Construction Specifications

Mantle Type

MANTLE M2-STANDARD

Colour / Stain

BIRCH WHITE

Surround

NERO

Hearth

NO

** Refer to Construction Summary

11. Air Conditioning

Air Conditioning

NO

Comment

** Refer to Construction Summary

12. General Comments

** Refer to Construction Summary

Disclaimers and Notes

1) Colours of all materials are as close as possible to builder's selection, but not necessarily identical due to variances in manufacturing.

2) Any extras listed above are null and void unless accompanied by a separate invoice/amendment. Said invoice must be paid in full.

3) The Purchaser agrees that this colour selection is final and that no changes will be permitted, unless required by the Vendor.

4) The Purchaser acknowledges reading and accepting document which contains other miscellaneous disclaimers.

5) In the event of a conflict between the Standard Features schedule of the Agreement of Purchase and Sale and the Interior Colour Scheme, the Interior Colour Scheme shall prevail.

Signature:



Date:

8-8-2023

LOT #72

Glenrowan 1

ELEV. 3 • 2,624 sq.ft.
Includes 12 sq.ft. of open area.

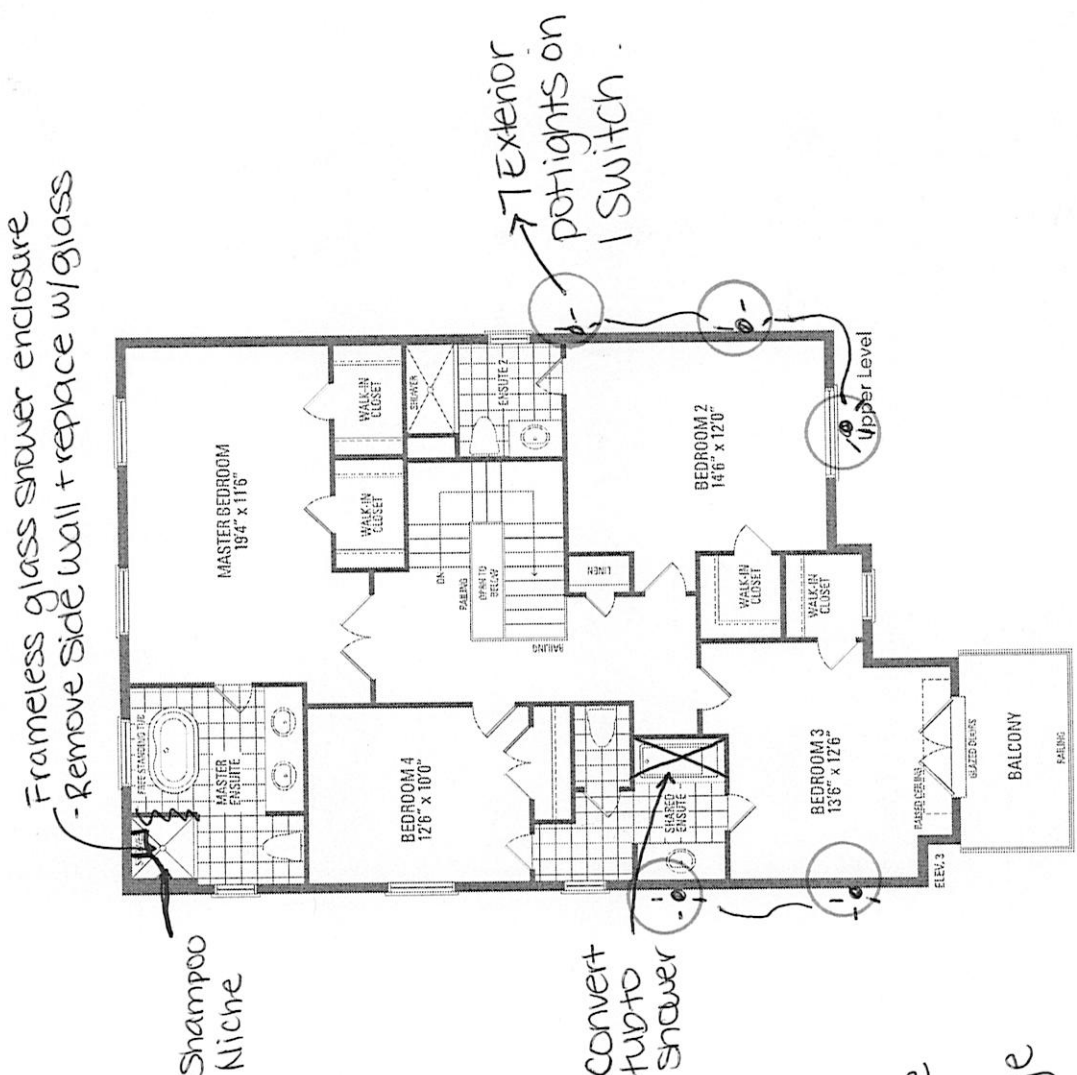
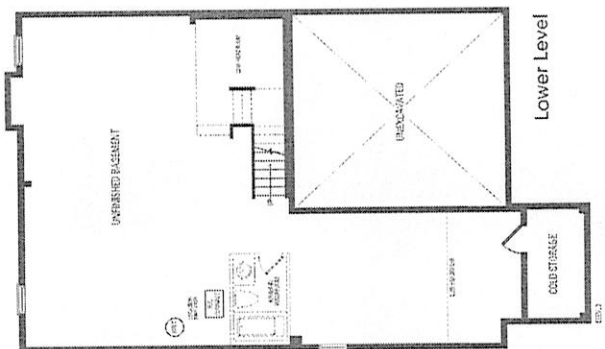
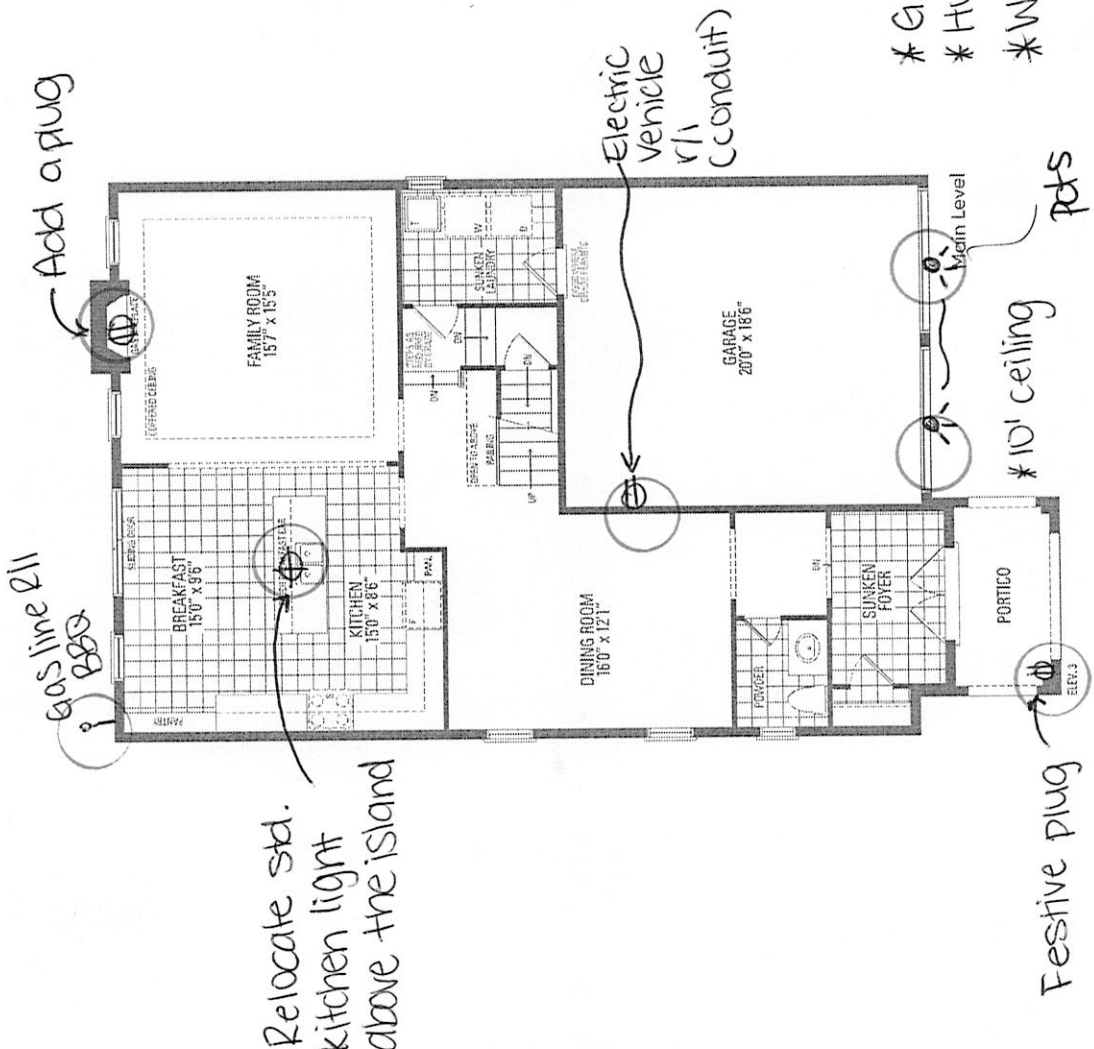

- * Gas line r/i for stove
- * Humidifier
- * Waterline r/i for fridge

Orientation of home may be reversed and purchaser agrees to accept the same. Steps and porches may vary at any exterior entrance ways due to grading variance. Actual usable floor space may vary from the stated floor areas. All renderings are artist's concept. Dimensions, specifications and architectural detailing subject to modifications. Roofline and adjoining model types may vary due to siting. E. & O. E. March 2023

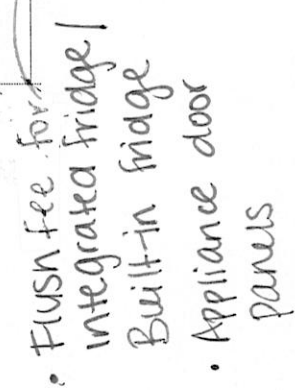

Selba Industries				J #	
<small>This drawing is the intellectual property of SELBA INDUSTRIES INC. and is an original design which must not be released or copied unless applicable fee has been paid or job order placed.</small>					
W WDTH		W HGHT		W CNT	
FLOOR HGHT		DOOR HGHT		JOB NUMBER:	
2X4		VENT BOX COVER		BUILDER: GREENPARK	
CENT		DESIGNER: KS		SITE: ROUND, Richmond Hill	
		DATE: JUNE 7 21		MODEL: GLENROWAN 1X EL 1,2,3	
				LOT #: 20ndel 10-11	

36" Panel-Ready Built-In French Door Refrigerator



<http://www.jennair.com>

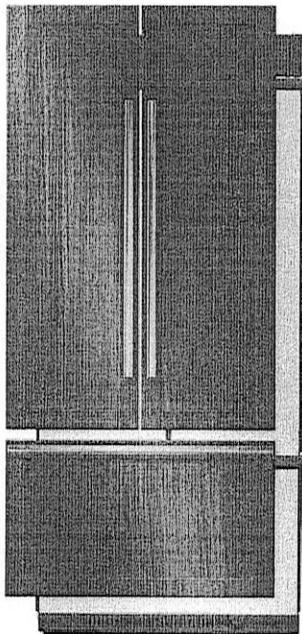

Key Features:

- Daring Obsidian Interior
- Multi-Point Cinematic Lighting
- Fully Flush, Fully Integrated Design
- Precision Temperature Management™ System
- Glass Shelving
- Light-Guided Capacitive Touch Controls
- Soft-Close Crisper Drawers
- Elegance Shelving
- Produce Preserver
- FreshFlow™ Air Filter
- Variable Capacity Compressor
- Automatic Ice Maker with Storage Drawer

Product Dimensions:

- Height: 84
- Width: 35 3/4
- Depth: 24

Electrical Requirements:

- 20. 115 V.

Additional Information:

- [Owners Manual](#)
- [Dimension Guide](#)
- [Installation Guide](#)
- [Energy Guide](#)
- [Warranty Certificate](#)

Available in:

☒ Panel Ready

®Registered trademark/TM Trademark of Whirlpool, U.S.A. © 2023 Whirlpool Corporation. All Rights Reserved.
All other trademarks are owned by their respective companies.
Because Whirlpool Corporation policy includes a continuous commitment to improve our products, we reserve the right to change materials and specifications without notice. We also reserve the right to discontinue or transition products without notice.
Manufacturer's Suggested Retail Price (MSRP) and Minimum Advertised Price (MAP) provided for reference purposes only. Dealer alone determines advertised and retail prices.
Created On: Wednesday, April 05, 2023 10:20:07

Roundel Lot #72
Page 1 of 16





36" FULLY INTEGRATED BOTTOM FREEZER REFRIGERATORS

DETAILED PLANNING DIMENSIONS GUIDE

(BASE UNIT REQUIRES SUITE-COORDINATING FULL HEIGHT PANEL KIT OR CUSTOM PANELS AND HANDLES)

JF36NFXDE – 35¾" (W) x 82⅞" (H) x 24" (depth without door panels/handles)

BASE UNIT + FULL HEIGHT PANEL KIT = FINISHED REFRIGERATOR

Easily transform these overlay refrigerators into one of our signature kitchen suite designs with one of our suite-coordinating stainless steel panel kits. To do so, you must order one of the overlay base units (left column) and one of the suite-coordinating panel kits. The kits include refrigerator and freezer door panels, air grille and pre-installed handles.

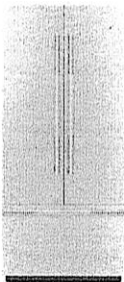
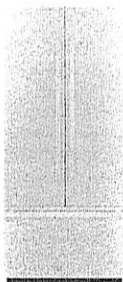
Base Unit Model Number	Coordinating Stainless Full Height Panel Kits			
	RISE™ Stainless		NOIR™ Stainless	
French Door JF36NFXDE	JBFFS36NHL		JBFFS36NHM	

OPTIONAL ACCESSORIES FOR CUSTOM OVERLAY DESIGNS

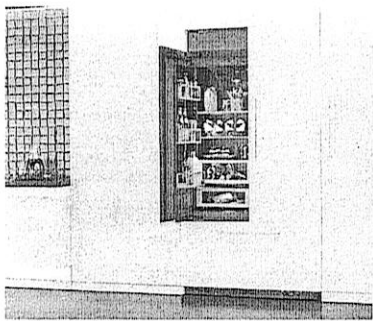

ARMOIRE-STYLE DOOR PANEL KIT

W10663562 – 36" – Obsidian Interior

- For use with fully integrated and flush refrigerators
- Enables installation and proper venting of full height custom door panels (not included) that hide the top panel
- Includes left and right grille brackets and machine compartment cover

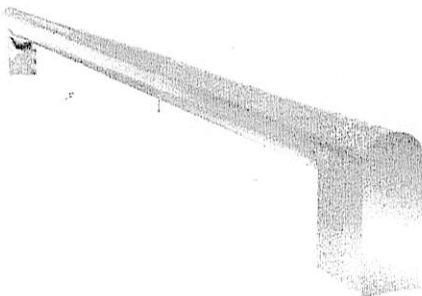

RISE™ STAINLESS HANDLE KIT

W11231247 – 36" French Door

- For use with Custom Overlay fully integrated built-in refrigerators

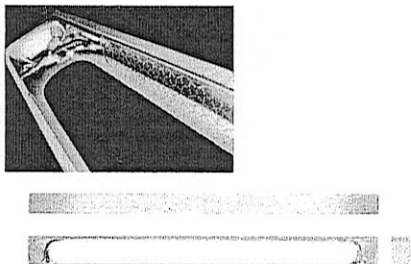

NOIR™ STAINLESS HANDLE KIT

W11194768 – 36" French Door

- For use with Custom Overlay fully integrated built-in refrigerators

Because Whirlpool Corporation policy includes a continuous commitment to improve our products, we reserve the right to change materials and specifications without notice.

W11356541C

Dimensions are for planning purposes only. For complete details, see Installation Instructions packed with product. Specifications subject to change without notice.

Roundel Lot #72

page 2 of 16





36" FULLY INTEGRATED BOTTOM FREEZER REFRIGERATORS

DETAILED PLANNING DIMENSIONS GUIDE

(BASE UNIT REQUIRES SUITE-COORDINATING FULL HEIGHT PANEL KIT OR CUSTOM PANELS AND HANDLES)

JF36NFXDE – 35³/₄" (W) x 82⁷/₈" (H) x 24" (depth without door panels/handles)

PRODUCT DIMENSIONS

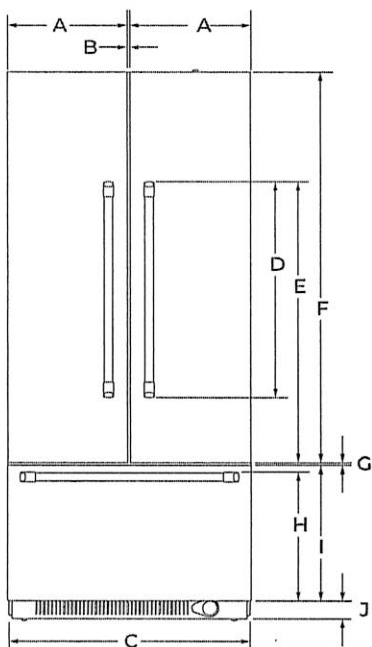

FRONT VIEW

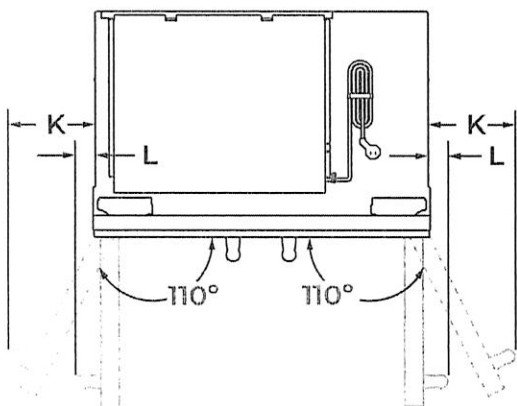

TOP VIEW

DIMENSION	DESCRIPTION	JF36NFXDE
A	Width of each door	17 ¹³ / ₁₆ " (45.2 cm)
B	Space between doors	1/8" (0.3 cm)
C	Overall width (including vinyl side trims)	35 ³ / ₄ " (90.8 cm)
D	Height of door handle	
	RISE™ Stainless	40 ⁷ / ₈ " (103.8 cm)
	NOIR™ Stainless	40 ⁵ / ₈ " (103.2 cm)
E	Height to top of door handle	
	RISE™ Stainless	49 ⁷ / ₈ " (126.6 cm)
	NOIR™ Stainless	47 ¹⁵ / ₁₆ " (121.8 cm)
F	Height of door	59 ¹ / ₄ " (150.5 cm)
G	Space between door and drawer	1/8" (0.3 cm)
H	Height to top of drawer handle	
	RISE™ Stainless	19 ⁵ / ₁₆ " (49.1 cm)
	NOIR™ Stainless	19 ³ / ₈ " (49.2 cm)
I	Height of drawer	20 ¹ / ₂ " (52.1 cm)
J	Height of bottom grille	3" (7.6 cm)
K	Width from side of refrigerator to handle – door fully open 110°	
	RISE™ Stainless	7 ¹ / ₄ " (18.4 cm)
	NOIR™ Stainless	6 ¹ / ₁₆ " (17 cm)
L	Width from side of refrigerator to handle – door open 90°	
	RISE™ Stainless	2 ³ / ₈ " (6.1 cm)
	NOIR™ Stainless	1 ⁵ / ₈ " (4.1 cm)

Because Whirlpool Corporation policy includes a continuous commitment to improve our products, we reserve the right to change materials and specifications without notice.

Dimensions are for planning purposes only. For complete details, see Installation Instructions packed with product. Specifications subject to change without notice.

Roundel Lot #72
page 3 of 16





36" FULLY INTEGRATED BOTTOM
FREEZER REFRIGERATORS
DETAILED PLANNING DIMENSIONS GUIDE
(BASE UNIT REQUIRES SUITE-COORDINATING FULL HEIGHT PANEL KIT OR CUSTOM
PANELS AND HANDLES)
JF36NFXDE – 35¾" (W) x 82⅞" (H) x 24" (depth without door panels/handles)

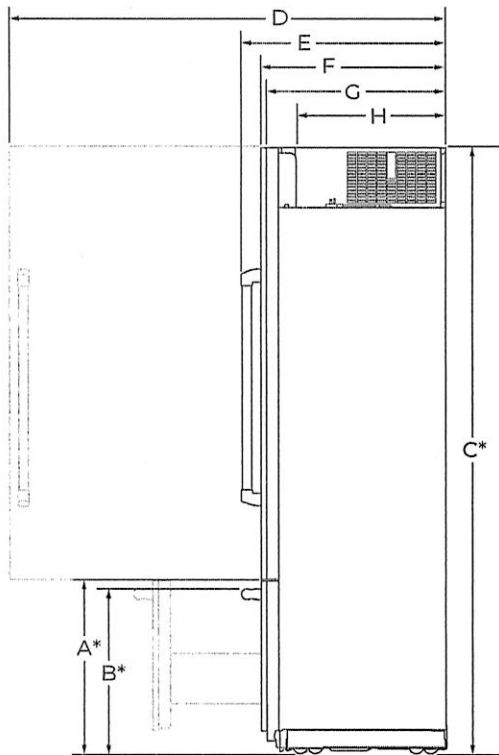

SIDE VIEW

DIMENSION	DESCRIPTION	JF36NFXDE
A*	Height to top of drawer (min.)	23½" (59.7 cm)
B*	Height to top of drawer handle (min.)	
	RISE™ Stainless	22⅞" (56.7 cm)
	NOIR™ Stainless	22⅞" (56.8 cm)
C*	Height to top of door (min.)	82⅞" (210.5 cm)
D	Depth with door open 90° (min.)	41" (104.1 cm)
E	Depth with handle (min.)	
	RISE™ Stainless	27⅞" (70.2 cm)
	NOIR™ Stainless	26⅞" (68.2 cm)
F	Depth with door (min.)	
	RISE™ Stainless	24¾" (62.9 cm)
	NOIR™ Stainless	24¾" (62.9 cm)
	Custom panel (¾"/1.9 cm)	24¾" (62.9 cm)
G	Depth without door panel kit (min.)	24" (61 cm)
H	Depth of compressor cover (min.)	19⅞" (50.5 cm)

*Add 1¼" (3.2 cm) to the height dimension when leveling legs are fully extended.

Because Whirlpool Corporation policy includes a continuous commitment to improve our products, we reserve the right to change materials and specifications without notice.

Dimensions are for planning purposes only. For complete details, see Installation Instructions packed with product. Specifications subject to change without notice

Roundel Lot #72
Page 4 of 16





36" FULLY INTEGRATED BOTTOM FREEZER REFRIGERATORS

DETAILED PLANNING DIMENSIONS GUIDE

(BASE UNIT REQUIRES SUITE-COORDINATING FULL HEIGHT PANEL KIT OR CUSTOM PANELS AND HANDLES)

JF36NFXDE - 35 $\frac{3}{4}$ " (W) x 82 $\frac{7}{8}$ " (H) x 24" (depth without door panels/handles)

AIRFLOW VENTING RECOMMENDATIONS

CLOSED SOFFIT CABINET

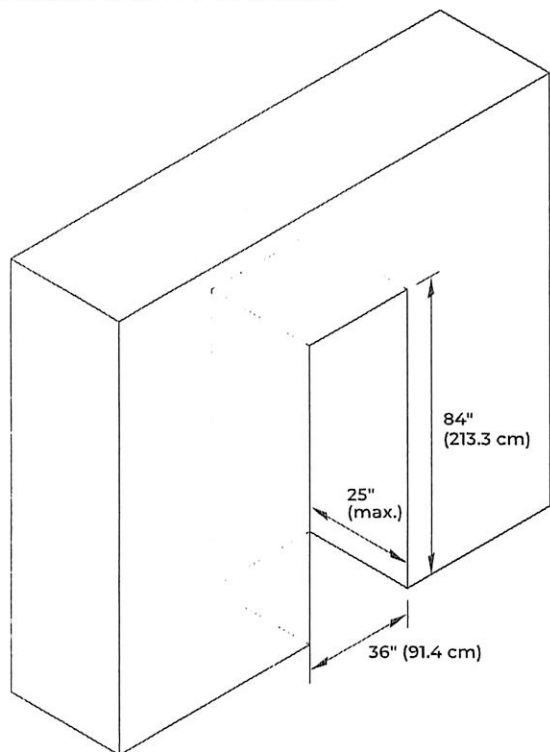

- Depth of cabinet must be less than 25" (63.5 cm).
- Height of soffit must not exceed 84" (213.3 cm).
- Following illustrations explain the cabinet construction (soffit and rear wall positions) required for optimum ventilation and airflow.

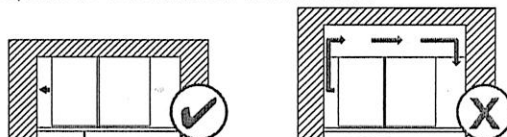

Top View



Front View

Grey arrow = ambient air; Black arrow = warm air

Cabinet depth 25" and soffit located at 84", provides proper airflow/ventilation to the refrigerator. Efficient cooling is achieved.

Cabinet depth more than 25" and/or soffit located at more than 84", causes air gap at back and/or top of the refrigerator. Air gap allows warm air recirculation causing loss in cooling efficiency.

- If your opening does not meet these requirements, you will need to make modifications.

Because Whirlpool Corporation policy includes a continuous commitment to improve our products, we reserve the right to change materials and specifications without notice.

Dimensions are for planning purposes only. For complete details, see Installation Instructions packed with product. Specifications subject to change without notice.

Roundel Lot #72
Page 5 of 16





36" FULLY INTEGRATED BOTTOM FREEZER REFRIGERATORS

DETAILED PLANNING DIMENSIONS GUIDE

(BASE UNIT REQUIRES SUITE-COORDINATING FULL HEIGHT PANEL KIT OR CUSTOM PANELS AND HANDLES)

JF36NFXDE - 35³/₄" (W) x 82⁷/₈" (H) x 24" (depth without door panels/handles)

CLEARANCE DIMENSIONS

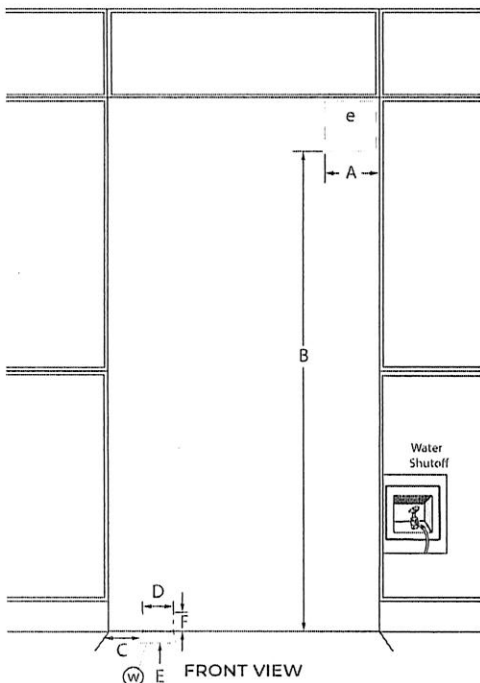

DIMENSION	DESCRIPTION	JF36NFXDE
A	Width of recommended electrical location	4" (10.2 cm)
B	Height to recommended electrical location	77" (195.6 cm)
C	Distance from side of cabinet to recommended water connection location	6 ¹ / ₂ " (16.5 cm)
D	Width of recommended water location	1 ¹ / ₂ " (3.81 cm)
E	Depth of recommended water connection location (max.)	2" (5 cm)
F	Height of recommended water connection location (behind the unit)	2 ¹ / ₂ " (6.35 cm)
e	Recommended electrical connection location	
w	Recommended water connection location	

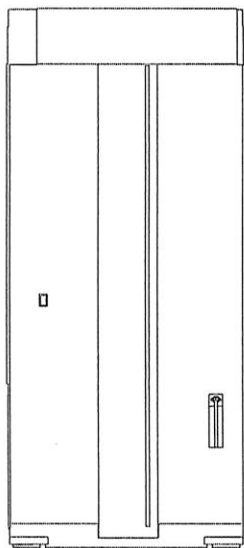

Because Whirlpool Corporation policy includes a continuous commitment to improve our products, we reserve the right to change materials and specifications without notice.

Dimensions are for planning purposes only. For complete details, see Installation Instructions packed with product. Specifications subject to change without notice.

Roundel Lot #72
page 6 of 16



Roundel LOT# 72
page 7 of 16

SITE PREPARATION INSTALLATION REQUIREMENTS

PLAN THE INSTALLATION

IMPORTANT:

- Install the handles on the panels prior to panel installation. Follow the instructions received with handle kit to install the handles.
- Plan your installation using these instructions in conjunction with the Installation Instructions provided with the refrigerator. Modifications must be made to the refrigerator to accommodate the Armoire-style door panels.

Required parts

- One of the following built-in refrigerator models:
 - 42" Side-by-Side: JS42NXXFXDE
 - 48" Side-by-Side: JS48NXXFXDE
 - 36" Bottom Mount: JB36NXXFXLE, JB36NXXFXRE
 - 36" French Door Bottom Mount: JF36NXXFXDE
 - 42" French Door Bottom Mount: JF42NXXFXDE
 - Accessory Armoire-Style Door Panel Kit which includes (Grille Assembly and Grille Bracket Assembly)
 - Custom Panels
- NOTE:** The required thickness for all panels is 3/4" (1.91 cm).

OPENING REQUIREMENTS

IMPORTANT:

- The width of the opening, from side to side, must be as specified for your model, for at least 3" (7.62 cm) back from the face of the cabinet. If your opening does not meet this requirement, you will need to make modifications.
- The depth of the opening from the front of the cabinet to the back wall must be 25" (63.5 cm) minimum to achieve a flush installation.

CABINET AND PANEL INSTALLATION OPTIONS

Cabinet Depth - 25" (63.5 cm)

Grille Bracket - Top View

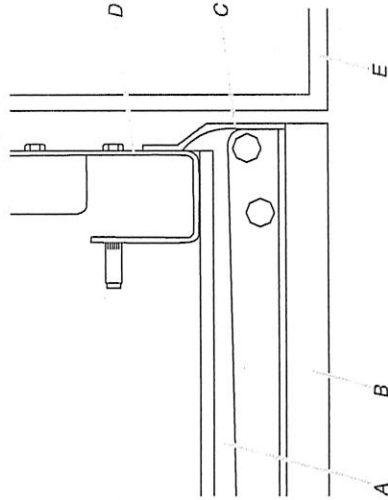

- A. Refrigerator door
- B. Armoire-style door panel
- C. Side trim
- D. Grille bracket
- E. Adjacent cabinet

Grille Bracket - Side View

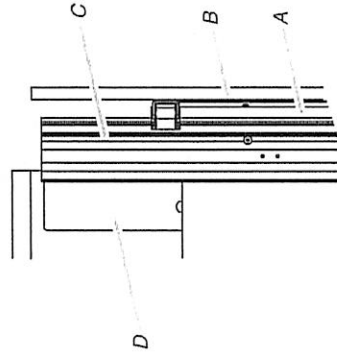

- A. Refrigerator door
- B. Armoire-style door panel
- C. Side trim
- D. Grille bracket

SITE PREPARATION CABINET CUTOUT OPTIONS

AIRFLOW VENTING RECOMMENDATIONS

IMPORTANT:

- Armoire-style installations recommends a minimum of 1/8" (3.2 mm) of open space above the refrigerator. It is recommended that this space not be blocked in any way, including soffits.
- Models may be installed using either Option 1, Option 2 or option 3.

Option 1 - Open to Ceiling

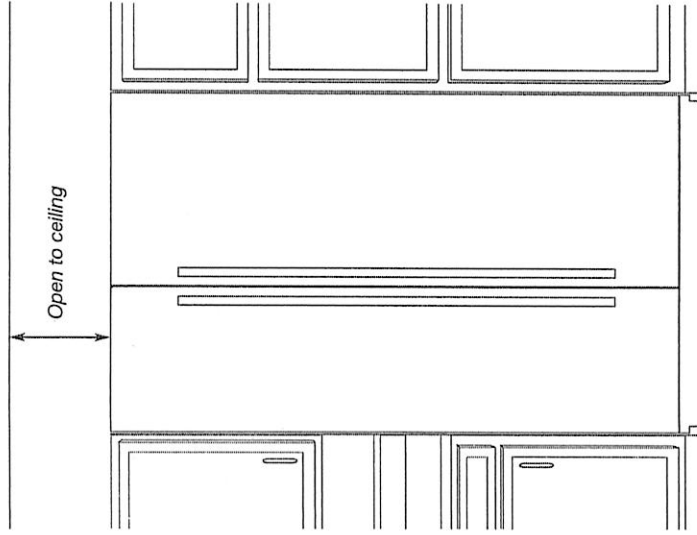

Option 2 - False Front (cabinet face only)

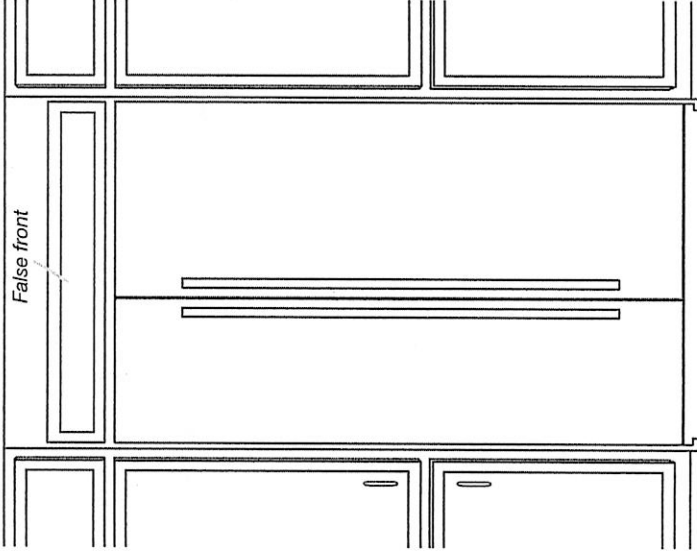

Option 3 - Closed Soffit

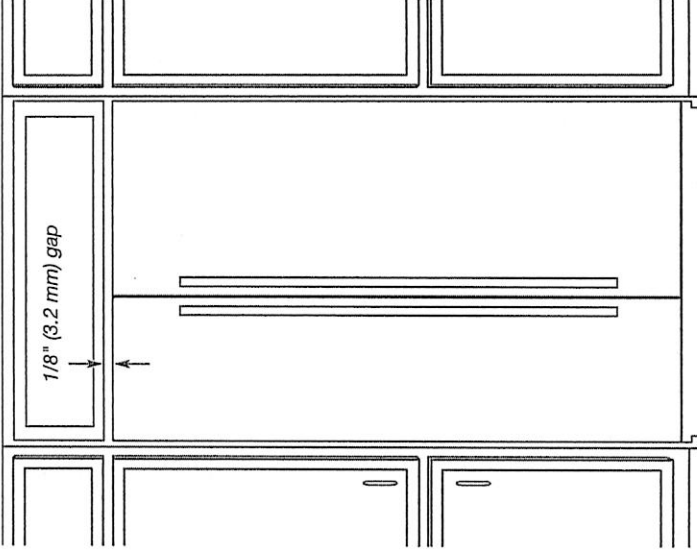

SITE PREPARATION
PANEL DIMENSIONS

BOTTOM MOUNT MODEL

1

Maximum allowable weights:

- Door panel - 60 lbs (27.2 kg)
- Drawer panel - 25 lbs (11.3 kg)

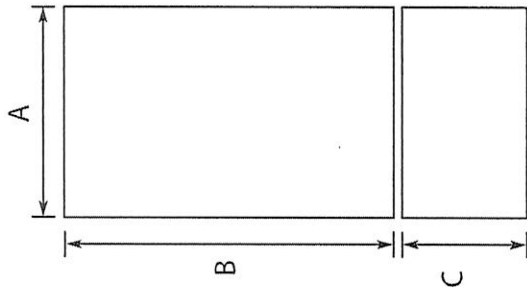

Legend	Model	Dimension
A	36"	35 ³ / ₄ " (90.81 cm)
B	36"	59 ¹ / ₈ " (150.2 cm)
C	36"	20 ¹ / ₂ " (52.07 cm)

FRENCH DOOR BOTTOM MOUNT
MODELS

1

Maximum allowable weights:

- Door panel - 38 lbs (17.2 kg)
- Drawer panel (36" model) - 25 lbs (11.3 kg)
- Drawer panel (42" model) - 30 lbs (13.6 kg)

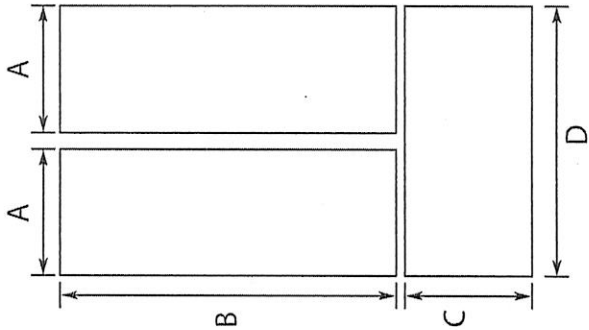

Legend	Model	Dimension
A		17 ³ / ₄ " (45.24 cm)
B		59 ¹ / ₈ " (150.2 cm)
C		20 ¹ / ₂ " (52.07 cm)
D		35 ³ / ₄ " (90.81 cm)
A		20 ³ / ₄ " (52.86 cm)
B		59 ¹ / ₈ " (150.2 cm)
C		20 ¹ / ₂ " (52.07 cm)
D		41 ³ / ₄ " (106.05 cm)

SIDE BY SIDE MODELS

1

Maximum allowable weights (42" models):

- Refrigerator Door panel - 65 lbs (29.5 kg)
- Freezer Door panel - 49 lbs (22.2 kg)

Maximum allowable weights (48" models):

- Refrigerator Door panel - 65 lbs (29.9 kg)
- Freezer Door panel - 50 lbs (23 kg)

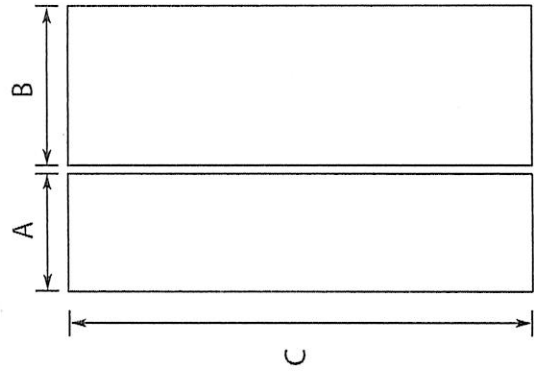

Legend	Model	Dimension
A		17 ³ / ₄ " (45.24 cm)
B		23 ³ / ₄ " (60.48 cm)
C		81" (205.7 cm)
A		20 ¹ / ₄ " (51.59 cm)
B		27 ¹ / ₄ " (69.37 cm)
C		81" (205.7 cm)

30" NOIR™ Gas Professional-Style Range

<http://www.jennair.com>

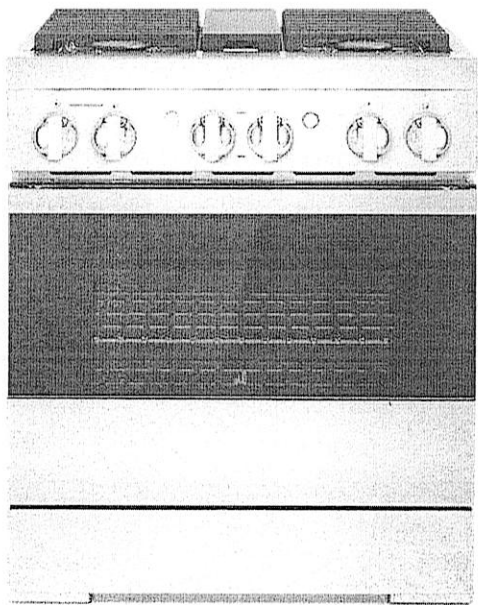

Key Features:

- 34 Range Configurations
- Flat Tine Racks
- Remote Access
- Dual-Stacked PowerBurners
- JennAir® Culinary Center
- Halo-Effect Knobs
- Glide Racks
- Cast Iron Grates
- Cinematic Lighting
- Dual-Fan True Convection
- Smart Integration
- Culinary Intelligence

Product Dimensions:

- Height: 38 3/4
- Width: 29 7/8
- Depth: 29 13/16

Additional Information:

- [Owners Manual](#)
- [Dimension Guide](#)
- [Installation Guide](#)

Available in:

- Floating Glass
- Black

INVESTED
IN
AMERICA

®Registered trademark/TM Trademark of Whirlpool, U.S.A. © 2021 Whirlpool Corporation. All Rights Reserved.
All other trademarks are owned by their respective companies.
Because Whirlpool Corporation policy includes a continuous commitment to improve our products, we reserve the right to change materials and specifications without notice. We also reserve the right to discontinue or transition products without notice.
Manufacturer's Suggested Retail Price (MSRP) and Minimum Advertised Price (MAP) provided for reference purposes only. Dealer alone determines advertised and retail prices.
Created On: Tuesday, May 17, 2022 09:57:23

Roundel Lot #72
page 10 of 16



Location Requirements

IMPORTANT: Observe all governing codes and ordinances. Do not obstruct flow of combustion and ventilation air.

- It is the installer's responsibility to comply with installation clearances specified on the model/serial/rating plate. The model/serial/rating plate is located under the console on the right-hand side.
- It is recommended that a 585 CFM (993.9 m³/hr) or larger range hood be installed above the range.
- Follow the range hood or microwave hood combination installation instructions for dimensional clearances above the cooktop surface.
- Recessed installations must provide complete enclosure of the sides and rear of the range.
- All openings in the wall or floor where range is to be installed must be sealed.
- Do not seal the range to the side cabinets.
- Cabinet opening dimensions that are shown must be used. Given dimensions are minimum clearances.
- The anti-tip bracket must be installed. To install the anti-tip bracket shipped with the range, see the "Install Anti-Tip Bracket" section.
- Grounded electrical supply is required. See the "Electrical Requirements" section.
- Proper gas supply connection must be available. See the "Gas Supply Requirements" section.
- Contact a qualified floor covering installer to check that the floor covering can withstand at least 200°F (93°C). Use an insulated pad or 1/4" (6.4 cm) plywood over carpet and under range if installing range over carpeting.

IMPORTANT: To avoid damage to your cabinets, check with your builder or cabinet supplier to make sure that the materials used will not discolor, delaminate, or sustain other damage. This oven has been designed in accordance with the requirements of UL and CSA International and complies with the maximum allowable wood cabinet temperatures of 194°F (90°C).

Mobile Home - Additional Installation Requirements

The installation of this range must conform to the Manufactured Home Construction and Safety Standard, Title 24 CFR, Part 3280 (formerly the Federal Standard for Mobile Home Construction and Safety, Title 24, HUD Part 280). When such standard is not applicable, use the Standard for Manufactured Home Installations, ANSI A225.1/NFPA 501A or local codes.

In Canada, the installation of this cooktop must conform with the current standards CAN/CSA-A240-latest edition or with local codes.

Mobile Home Installations Require:

- When this range is installed in a mobile home, it must be secured to the floor during transit. Any method of securing the range is adequate as long as it conforms to the standards listed above.
- The installation of appliances designed for recreational park trailers must conform with state or other codes or, in the absence of such codes, with the Standard for Recreational Park Trailers, ANSI A119.5.

Product Dimensions

NOTE: Cooktop features may differ.

30" (76.2 cm) models

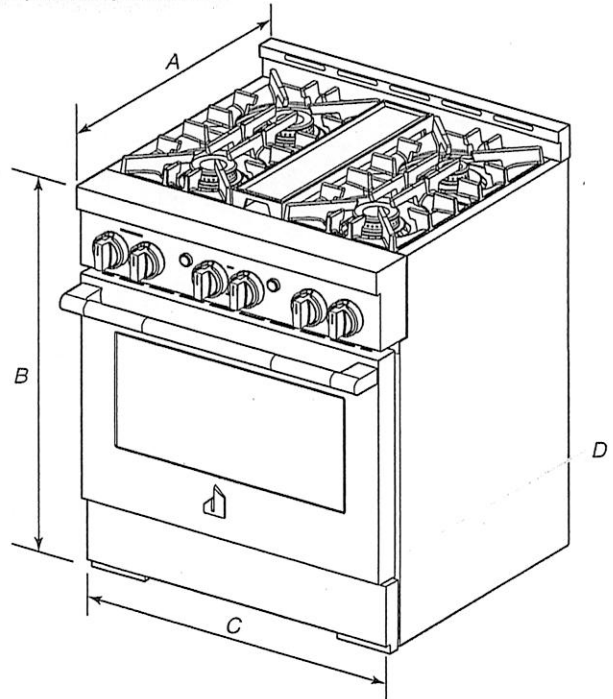

- A. 27³/₄" (70.5 cm) depth with control panel (See NOTE)
- B. 35³/₄" (90.8 cm) range height when sitting on the wheels
- C. 29⁷/₈" (75.7 cm) width
- D. Model/serial/rating plate location/SAID label

36" (91.4 cm) models

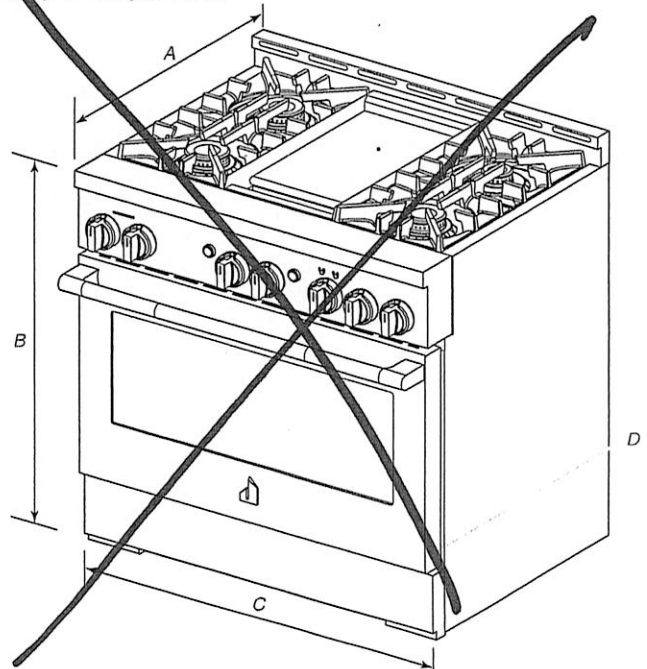

- A. 27¹/₂" (68.9 cm) depth with control panel (See NOTE)
- B. 35³/₄" (90.8 cm) range height when sitting on the wheels
- C. 36" (91.4 cm) width
- D. Model/serial/rating plate location/SAID label

Roundel Lot #72
page 11 of 16

48" (121.9 cm) models

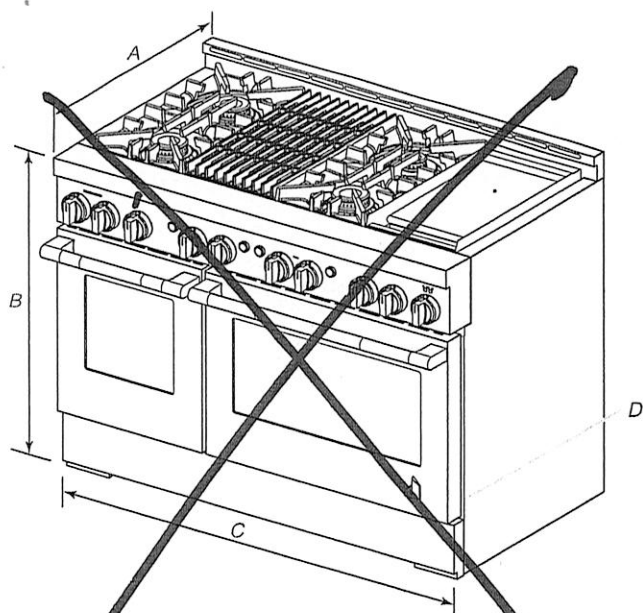

- A. 21 1/8" (68.9 cm) depth with control panel (See NOTE)
- B. 35 3/4" (90.8 cm) range height when sitting on the wheels
- C. 48" (121.9 cm) width
- D. Model/serial/rating plate location/SAID label

NOTE: When installed in a 24" (61.0 cm) base cabinet with 25" (63.5 cm) countertop; front of oven door protrudes 1 7/8" (4.8 cm) beyond 24" (61.0 cm) base cabinet.

Cabinet Requirements

Cabinet opening dimensions shown are for 25" (64.0 cm) countertop depth, 24" (61.0 cm) base cabinet depth, and 36" (91.4 cm) countertop height. Dimensions must be met in order to ensure a flush fit to back wall.

IMPORTANT: If installing a range hood, hood liner, or microwave hood combination above the cooking surface, follow the range hood or microwave hood combination installation instructions for dimensional clearances above the cooking surface.

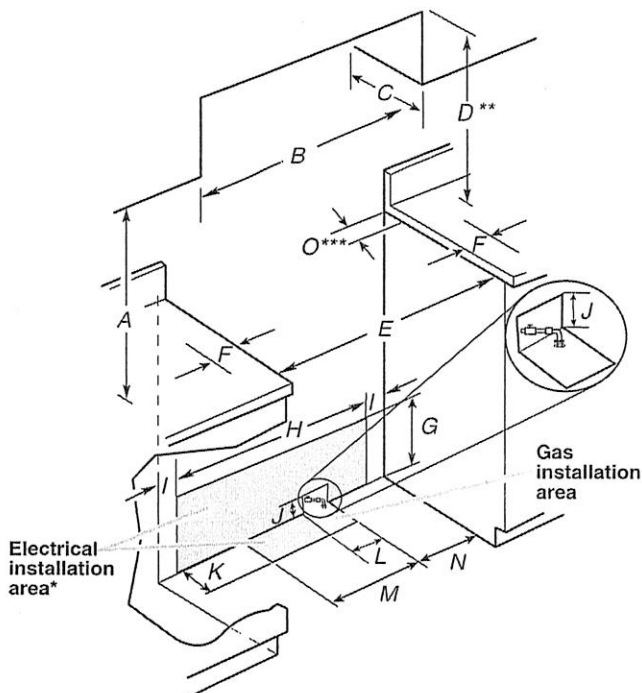

- A. 18" (45.7 cm) upper cabinet to countertop
- B. 30" (76.2 cm) model: 30" (76.2 cm) minimum upper cabinet width
36" (91.4 cm) model: 36" (91.4 cm) minimum upper cabinet width
48" (121.9 cm) model: 48" (121.9 cm) minimum upper cabinet width
- C. 13" (33 cm) maximum upper cabinet depth
- D. For minimum clearance to top of range.**
- E. 30" (76.2 cm) on 30" (76.2 cm) models
36" (91.4 cm) on 36" (91.4 cm) models
48" (121.9 cm) on 48" (121.9 cm) models
- F. 12" (30.4 cm) minimum clearance from both sides of range to side wall or other combustible material
- G. 15" (38.1 cm)
- H. 22" (55.9 cm) on 30" (76.2 cm) models
28" (71.1 cm) on 36" (91.4 cm) models
40" (101.6 cm) on 48" (121.9 cm) models
- I. 4" (10.1 cm)
- J. 3" (7.6 cm)
- K. 5" (12.7 cm)
- L. 6" (15.2 cm) on 30" (76.2 cm) models
12" (30.5 cm) on 36" (91.4 cm) models
24" (61.0 cm) on 48" (121.9 cm) models
- M. 10 1/2" (26.7 cm)
- N. 9" (22.9 cm)
- O. 6" (15.2 cm)***

**If not using ventilation, Minimum Clearances

30" (76.2 cm) models: 42" (106.7 cm) minimum clearance between the top of the cooking platform and the bottom of a combustible surface.

36" (91.4 cm) models: 42" (106.7 cm) minimum clearance between the top of the cooking platform and the bottom of a combustible surface.

48" (121.9 cm) models: 48" (121.9 cm) minimum clearance between the top of the cooking platform and the bottom of a combustible surface.

***If the surface of the back wall is constructed of a combustible material and a backguard is not installed, a 6" (15.2 cm) minimum clearance is required for all models.

Roundel Lot #72
page 12 of 16

Handwritten signature or mark.

DRAIN REQUIREMENTS

- A new drain hose is supplied with your dishwasher. If drain hose is not long enough, use a new drain hose with a maximum length of 12 ft (3.7 m) that meets all current AHAM/IAPMO test standards, is resistant to heat and detergent, and fits the 1" (25 mm) drain connector of the dishwasher.

NOTE: Do not connect multiple drain hoses together.

- Make sure to connect drain hose to waste tee or disposer inlet above drain trap in house plumbing and 20" (508 mm) minimum above the floor. It is recommended that the drain hose either be looped up and securely fastened to the underside of the counter or be connected to an air gap.
- Make sure to use an air gap if the drain hose is connected to house plumbing lower than 20" (508 mm) above subfloor or floor.

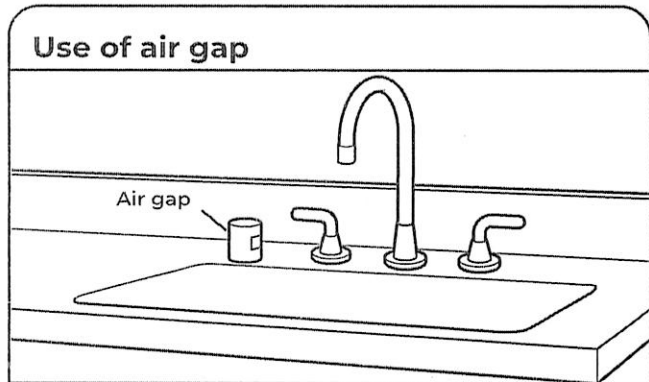

- If required, the air gap should be installed in accordance with the air gap installation instructions. When you are connecting the air gap, a rubber hose (not provided) will be needed to connect to the waste tee or disposer inlet.
- Use 1/2" (1.3 cm) minimum I.D. drain line fittings.

WATER SUPPLY REQUIREMENTS

- This dishwasher has a water heating feature and also requires a connection to a hot water supply line.
- A hot water line with 20 psi to 120 psi (138 kPa to 862 kPa) water pressure can be verified by a licensed plumber.
- 120°F (49°C) water at dishwasher.
- 3/8" (0.95 cm) O.D. copper tubing with compression fitting or flexible braided water supply line.
- NOTE:** 1/2" (1.3 cm) minimum plastic tubing is not recommended.
- A 90° elbow with 3/4" (0.95 cm) hose connection with rubber washer.
- Do not solder within 6" (15.2 cm) of the water inlet valve.
- If installed in new construction, make sure the house water supply lines have been flushed prior to connecting the dishwasher to remove any debris that may exist in the supply line.

NOTE: If replacing an existing dishwasher, it is recommended to install a new water line and drain hose (supplied) with the new dishwasher.

ELECTRICAL REQUIREMENTS

⚠ WARNING



Electrical Shock Hazard

Plug into a grounded 3 prong outlet.

Do not remove ground prong.

Do not use an adapter.

Do not use an extension cord.

Failure to follow these instructions can result in death, fire, or electrical shock.

Be sure that the electrical connection and wire size are adequate and in conformance with the National Electrical Code, ANSI/NFPA 70 - latest edition, and all local codes and ordinances.

A copy of the above code standards can be obtained from:

National Fire Protection Association
1 Batterymarch Park
Quincy, MA 02169-7471

You Must Have:

- 120 V, 60 Hz, AC only, 15 A or 20 A, fused electrical supply
- Copper wire only
- A maximum of 2 field wiring supply conductors (12 AWG largest size) plus 1 grounding conductor are permitted in the terminal box.

We Recommend:

- A time-delay fuse or circuit breaker.

Circuit Requirements:

- The dishwasher may be installed on the same circuit as a garbage disposal providing that the branch circuit cannot exceed rated circuit load and must comply with all governing codes and regulations such as but not limited to National Electrical Code, ANSI/NFPA 70 - latest edition.
- No electrical connections other than the dishwasher power and ground connections can be made inside of the dishwasher terminal box.

If connecting dishwasher with a power supply cord:

- Use UL Listed power cord kit marked for use with dishwasher.
- Plug into a grounded 3 prong outlet. Outlet must meet all local codes and ordinances.



If connecting dishwasher with direct wiring:

- Use flexible, armored, or nonmetallic sheathed copper wire with grounding wire that meets the wiring requirements for your home and local codes and ordinances.
- Use a UL Listed/CSA Approved metallic strain relief.

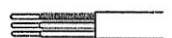
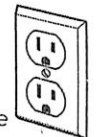

Roundel Lot #72
page 13 of 16



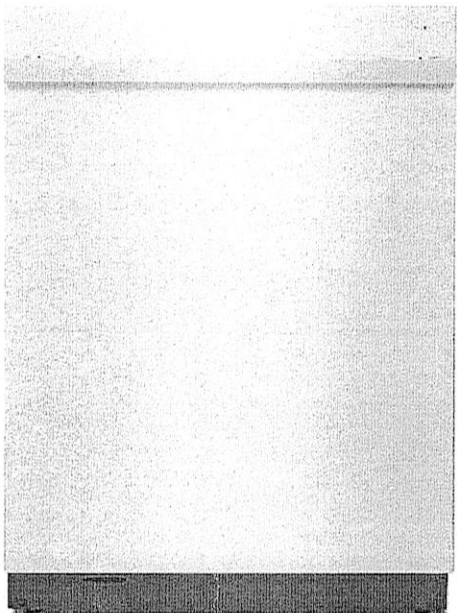

Key Features:

- Quietest Luxury Dishwasher Brand
- Precise Fit 3rd Rack for Cutlery
- 11% More Loading Height
- Superior Glide Middle Rack
- Waterlock Leak Detection System
- 14 Place Setting Capacity
- 2 Position Fold-Away™ Tines
- Daring Obsidian Middle and Bottom Racks
- 3-Stage Filtration
- Emotive Feedback
- Concealed Controls
- Condensation Drying

Product Dimensions:

Height: 33 1/2
Width: 23 7/8
Depth: 26 3/4

Additional Information:

- [Owners Manual](#)
- [Dimension Guide](#)
- [Installation Guide](#)
- [Warranty Certificate](#)

Available in:

☒ Stainless Steel



®Registered trademark/TM Trademark of Whirlpool, U.S.A. © 2023 Whirlpool Corporation. All Rights Reserved.
All other trademarks are owned by their respective companies.
Because Whirlpool Corporation policy includes a continuous commitment to improve our products, we reserve the right to change materials and specifications without notice. We also reserve the right to discontinue or transition products without notice.
Manufacturer's Suggested Retail Price (MSRP) and Minimum Advertised Price (MAP) provided for reference purposes only. Dealer alone determines advertised and retail prices.
Created On: Wednesday, April 05, 2023 04:46:37

Roundel Lot #72
page 14 of 16





2 1/4" DISHWASHER

DETAILED PLANNING DIMENSIONS GUIDE

JDPSS246LL, JDPSS246LM, JDPSS244LS, JDPSS244LL,
JDPSS244LM
23 7/8" (W) x 33 5/8" (H) x 24 1/2" (Depth without Handle)
JDPSS245LX
23 7/8" (W) x 33 5/8" (H) x 24 3/4" (Depth without Handle)

PRODUCT DIMENSIONS

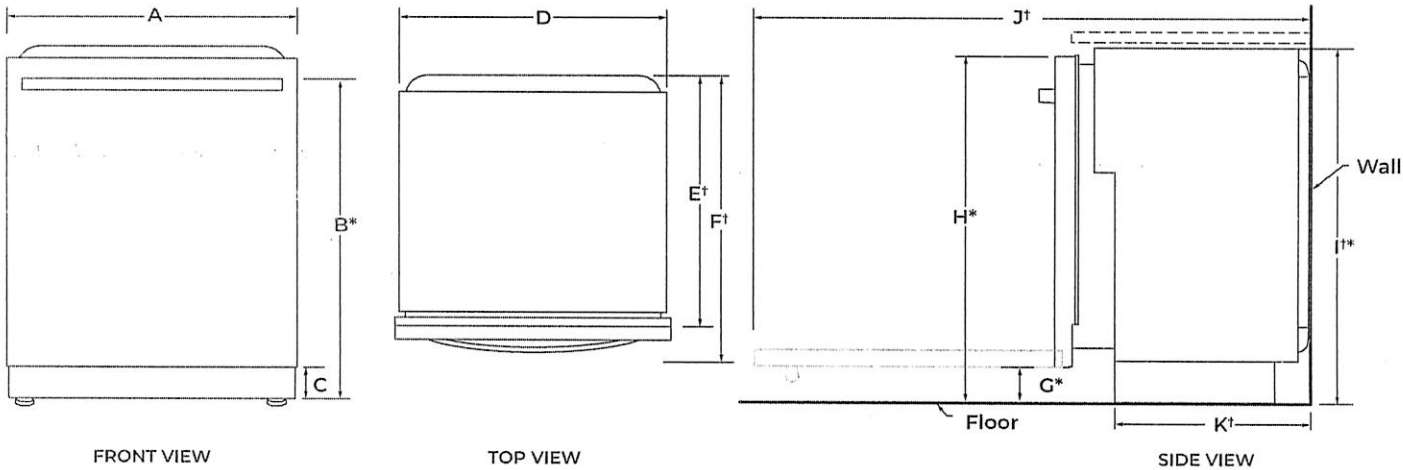

	DESCRIPTION	DIMENSIONS
A	Width of door	23 7/8" (60.6 cm)
B*	Height to top of handle	31 1/16" (80.1 cm)
C	Height of adjustable toe kick	3 1/2" (8.8 cm) - min. 4 1/4" (10.8 cm) - max.
D	Width of recessed dishwasher	23 7/8" (60.6 cm)
E†	Depth without door	22 5/8" (57.5 cm)
F†	Depth with Towel Bar Handle	27 1/4" (69.2 cm)
	Depth with Pocket Handle	24 1/2" (62.2 cm)
	Depth with Wood panel	24 3/4" (62.9 cm)**
G*	Height to bottom of door (min.)	3 5/16" (8.4 cm)
H*	Height to top of door (min.)	33 7/16" (84.9 cm)
I*	Height of recessed dishwasher (min.)	33 5/8" (85.4 cm)
J†	Depth with door fully open (min.)	50 3/16" (127.4 cm)
K†	Depth with toe kick (min.)	20 1 3/16" (52.9 cm)

†Insulation blanket thickness adds up to 11/16" (1.8 cm) but can crush up to 1/8" (0.3 cm).

*Dishwasher can be raised 1 7/16" (3.7 cm) with feet fully extended.

**Considering 3/4" wood panel thickness.

Because Whirlpool Corporation policy includes a continuous commitment to improve our products, we reserve the right to change materials and specifications without notice

Dimensions are for planning purposes only. For complete details, see Installation Instructions packed with product. Specifications subject to change without notice

Roundel Lot #72
page 15 of 16





24" DISHWASHER DETAILED PLANNING DIMENSIONS GUIDE

JDPSS246LL, JDPSS246LM, JDPSS244LS, JDPSS244LL,
JDPSS244LM
23⁷/₈" (W) x 33⁵/₈" (H) x 24¹/₂" (Depth without Handle)

JDPSS245LX
23⁷/₈" (W) x 33⁵/₈" (H) x 24³/₄" (Depth without Handle)

OPENING/CLEARANCE DIMENSIONS

IMPORTANT: Check that all surfaces have no protrusions that would prohibit dishwasher installation.

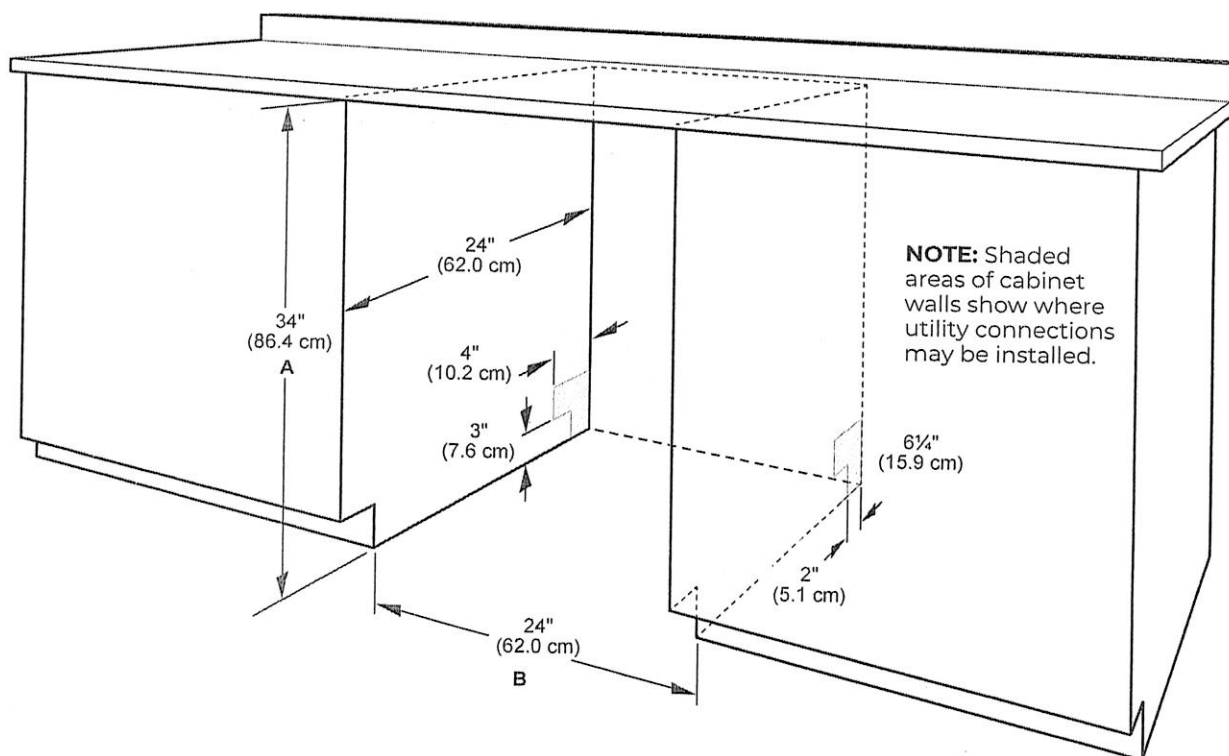

A. Measured from the lowest point on the underside of the countertop. May be reduced to 33¹/₂" (85.1 cm) by removing the wheels and perforated area of insulation (blanket) on dishwasher.

B. Minimum, measured from narrowest point of opening.

NOTE: Corner locations require a 2" (5.1 cm) minimum clearance between the side of the dishwasher door and the wall or cabinet.

Because Whirlpool Corporation policy includes a continuous commitment to improve our products, we reserve the right to change materials and specifications without notice.

Dimensions are for planning purposes only. For complete details, see Installation Instructions packed with product. Specifications subject to change without notice.

Roundel Lot #72
page 16 of 16

