

CONSTRUCTION SUMMARY				
PURCHASER: KOMAL SINGH			RECEIVED	
			SEP 18 2023	
			TEL: RES.: 647-804-9571	
LOT / PHASE		REG. PLAN #	HOUSE TYPE	
Block 119 TH30 / 1			Cherry 3E Elev 2	

CABINETRY

1 - KITCHEN - DELETE CABINETS ABOVE STOVE AND HOOD FAN - VENDOR WILL SUPPLY 6 INCH VENT AS PER CONSTRUCTION SPECIFICATIONS AND VENT MAY NOT BE IN THE APPROPRIATE LOCATION FOR INSTALLATION OF PURCHASER SUPPLIED FAN 16Aug23 Note: PURCHASER TO SUPPLY AND INSTALL OWN FAN AFTER CLOSING	
1 - KITCHEN- DELETE PANTRY AND SHIFT FRIDGE OVER TO ACCOMODATE BUILT IN MICRO/OVEN - SEE SKETCH 04Aug23 Note:	

CABINETRY ACCESSORIES

1 - KITCHEN CABINETRY UPPER - FULL DEPTH ABOVE FRIDGE UPPER WITH GABLES - 650MM DEEP - PRICE IS EACH 04Aug23 Note:	
1 - KITCHEN CABINETRY - BUILT-IN MICROWAVE/OVEN COMBO WITH ONE POT DRAWER - STANDARD LEVEL 04Aug23 Note:	
1 - KITCHEN CABINETRY BASE - COOKTOP CABINET WITH POT DRAWERS (2 DRAWERS) - STANDARD LEVEL 04Aug23 Note:	

DOORS AND TRIM

1 - INTERIOR DOORS - UPGRADE TO CARRARA SMOOTH HALLOW IN LIEU OF STANDARD SERIES - TOWNS 04Aug23 Note:	
---	--

ELECTRICAL

1 - KITCHEN- FRIDGE PLUG TO BE IN NEW FRIDGE LOCATION SEE KITCHEN SKETCH 04Aug23 Note:	
1 - BUILT IN OVEN AND COOKTOP PROVISION - PROVISION ONLY - ELECTRICAL ONLY 04Aug23 Note:	
1 - PLUG - ELECTRICAL PLUG - 5 FEET FROM FINISHED FLOOR FOR FUTURE WALL MOUNTED TV - SEE SKETCH 16Mar23 Note:	
1 - LIGHT AND SWITCH - NO FIXTURE INCLUDED - LIVING ROOM 16Mar23 Note:	
1 - ABOVE KITCHEN ISLAND - ADD LIGHT AND SWITCH - NO FIXTURE INCLUDED 16Mar23 Note:	
1 - PLUG - ELECTRICAL PLUG WITH GFI AND SWITCH - FOR FESTIVE LIGHTING 16Mar23 Note:	

FIREPLACE AND ACCESSORIES

1 - GAS LINE ROUGH-IN FOR STOVE (INCLUDES ELECTRICAL OUTLET) - FIRST FLOOR 16Mar23 Note:	
---	--

PLUMBING

1 - KITCHEN SINK - BLANCO QUARTUS R15 DROP IN SUPER SINGLE #402612 04Aug23 Note:	
2 - TOE TESTER - ADD TOE TESTER TO SHOWER - MASTER ENSUITE AND MAIN BATHROOM SHOWERS 16Mar23 Note:	

CONSTRUCTION SUMMARY				
PURCHASER: KOMAL SINGH			TEL: RES.: 647-804-9571	
LOT / PHASE Block 119 TH30 / 1	REG. PLAN #	HOUSE TYPE Cherry 3E Elev 2		
1 - WATER LINE FOR FRIDGE - ROUGH-IN ONLY 16Mar23 Note:				
1 - WASHROOM - 3 PIECE ROUGH-IN IN BASEMENT 16Mar23 Note:				
1 - TUB TO SHOWER CONVERSION - 5 FOOT SHOWER WITH SLIDING GLASS CHROME DOORS IN LIEU OF TUB INCLUDES SHOWER POT LIGHT 16Mar23 Note:				

PROMOTIONAL

1 - LESS BALANCE OF CREDIT FROM PURCHASER EXTRA SHEET IN OFFER 04Aug23 Note:	
1 - PARTIAL REDEMPTION OF PROMOTIONAL PACKAGE \$7,530 BALANCE FORWARD \$2,470 TO BE USED AT A LATER DATE. ORIGINAL PROMOTIONAL PACKAGE OF \$10,000 AS PER SCHEDULE PE DATED MMMDDYYYY. 16Mar23 Note:	

STAIRS AND RAILINGS

1 - PICKETS - EUROLINE 0 - BLACK PICKETS 04Aug23 Note:	
1 - STAINED STAIRS - STANDARD STAIRCASE - INCLUDING EXTRA STEPS TO LOWER LANDING 04Aug23 Note:	

EXTRAS AS PER OFFER

The Vendor agrees that notwithstanding any other term or provision in this Agreement included in the Purchase Price and in addition to those items detailed in Schedule GP to the Agreement of Purchase and Sale, the Purchaser is entitled to a credit of Ten Worksheet Note:	
---	--

This Document is Extremely Time Sensitive - Printed 16 Aug 23 at 10:20

1. Cabinetry

	Style and Colour	Hardware
Kitchen / Breakfast	MONACO 908 COLUMBIAN COFFE	464SA
Laundry Room	ELISSE	Standard
Powder Room	DORAL W500	464SA
Master Ensuite Bathroom	DORAL W500	464SA
Main Bathroom	DORAL W500	464SA
Stove Opening	36"	NOTE: If not specified, opening will be set to builder's standard opening of approximately 30" width
Fridge Opening	STANDARD	NOTE: If not specified, opening will be set to builder's standard opening of approximately 37" width x 74" height

** Refer to Construction Summary

2. Counters

	Counter	Edge	Niche
Kitchen / Breakfast	LAMINATE-CALCUTTA MARBLE 4925K-07		
Laundry Room	N/A		
Powder Room	LAMINATE-WHITE CARRARA 4924-38		
Master Ensuite Bathroom	LAMINATE-WHITE CARRARA 4924-38		
Main Bathroom	LAMINATE-WHITE CARRARA 4924-38		
Kitchen Backsplash	N/A		

** Refer to Construction Summary

Initial: 

3. Ceramic Flooring

At a 45

Entrance Vestibule	TILE-WHITE CONCRETE 13X13	<input type="checkbox"/>
Main Hall	LAMINATE	<input type="checkbox"/>
Kitchen / Breakfast	LAMINATE	<input type="checkbox"/>
Laundry Room	TILE-WHITE CONCRETE 13X13	<input type="checkbox"/>
Powder Room	TILE-WHITE CONCRETE 13X13	<input type="checkbox"/>
Master Ensuite Bathroom	TILE-WHITE CONCRETE 13X13	<input type="checkbox"/>
Main Bathroom	TILE-WHITE CONCRETE 13X13	<input type="checkbox"/>
GARAGE ENTRANCE	TILE-WHITE CONCRETE 13X13	<input type="checkbox"/>
		<input type="checkbox"/>
		<input type="checkbox"/>
		<input type="checkbox"/>

** Refer to Construction Summary ** METAL STRIP THRESHOLD WHERE APPLICABLE UNLESS SPECIFIED **

4. Ceramic Wall Tile

Master Ensuite Bathroom	Selection	Describe
Tub Deck Wall	TILE-NATURALE NERO 8X10	
Shower Stall	TILE-NATURALE NERO 8X10	
Bathtub Enclosure Walls	N/A	
Main Bathroom	TILE-NATURALE NERO 8X10	
GARAGE ENTRANCE	N/A	
Kitchen Backsplash	N/A	

** Refer to Construction Summary - STANDARD GROUT THROUGHOUT UNLESS SPECIFIED

5. Trim Carpentry

Interior Doors	CARRARA-SMOOTH
Interior Trim	As Per Construction Specifications

** Refer to Construction Summary

6. Plaster Mouldings and Medallions

Entrance Vestibule	N/A		Kitchen/Breakfast	N/A	
Main Hall	N/A		Den/Library	N/A	
Living Room	N/A		Lower Landing	N/A	
Dining Room	N/A				
Family Room	N/A				

** Refer to Construction Summary

Purchaser:KOMAL SINGH

Property: Block 119 TH30

Telephone Res. / Bus: (647) 804-9571 /

Project: Barlassina Construction Inc.

Decor Advisor: Ida Viola

Model and Elevation: Cherry 3E Elev 2

Lock Date: 29-Aug-23

4-Aug-23

Plan #:

7. Other Flooring

Main Hall	LAMINATE-LEXINGTON-WALCOURT HICKORY-TL-LW1315 PEFC
Living Room	LAMINATE-LEXINGTON-WALCOURT HICKORY-TL-LW1315 PEFC
Dining Room	LAMINATE-LEXINGTON-WALCOURT HICKORY-TL-LW1315 PEFC
Family Room	N/A
Den / Library / Study	N/A
Basement Landing(If Applies)	N/A
Lower Landing (If Applies)	N/A
Upper Landing	LAMINATE-LEXINGTON-WALCOURT HICKORY-TL-LW1315 PEFC
Upper Hall	CARPET-SPARTACUS 87354 OVERCAST TEMPS GRIS
Master Bedroom	CARPET-SPARTACUS 87354 OVERCAST TEMPS GRIS
Bedroom #2	CARPET-SPARTACUS 87354 OVERCAST TEMPS GRIS
Bedroom #3	CARPET-SPARTACUS 87354 OVERCAST TEMPS GRIS
Bedroom #4	N/A
Bedroom #5	N/A
Kitchen/Breakfast	LAMINATE-LEXINGTON-WALCOURT HICKORY-TL-LW1315 PEFC
FLEX AREA	CARPET-SPARTACUS 87354 OVERCAST TEMPS GRIS

Underpad

Standard☒

Upgrade

** Refer to Construction Summary

8. Railings and Pickets

Railing Type	AS PER CONSTRUCTION SPECIFICATIONS	Colour	TORLYS-WALCOURT HICKORY-TL-LW1315
Picket Type	EUROLINE 0	Colour	BLACK
Stringer / Riser	AS PER CONSTRUCTION SPECIFICATIONS	Colour	TORLYS-WALCOURT HICKORY-TL-LW1315
Treads	AS PER CONSTRUCTION SPECIFICATIONS	Colour	TORLYS-WALCOURT HICKORY-TL-LW1315

Red Oak Stairs as Per Vendor's Standard

** Refer to Construction Summary THE STAIN COLOURS OR FINISH AVAILABLE ON RISERS, TREADS, PICKETS AND RAILS (STAIRCASES), WILL NOT BE AN EXACT MATCH TO PREFINISHED HARDWOOD OR LAMINATE FLOORS.

9. Wall Paint Flat Finish

Main & Upper Hall	22 WARM GREY	Master Bedroom	22 WARM GREY
Living Room	22 WARM GREY	Bedroom #2	22 WARM GREY
Dining Room	22 WARM GREY	Bedroom #3	22 WARM GREY
Kitchen / Breakfast	22 WARM GREY	Bedroom #4	N/A
Family Room	N/A	Bedroom #5	N/A
Powder Room	22 WARM GREY	Master Ensuite	22 WARM GREY
Laundry Room	22 WARM GREY	Main Bathroom	22 WARM GREY
Den/Library	N/A	Flex Room	22 WARM GREY
Trim & Door Paint-Semi Gloss	BIRCH WHITE	Garage Entrance	22 WARM GREY

** Refer to Construction Summary

Purchaser:

KOMAL SINGH

Telephone Res. / Bus:

(647) 804-9571 /

Decor Advisor:

Ida Viola

Lock Date:

4-Aug-23

Property:

Block 119 TH30

Project:

Barlassina Construction Inc.

Model and Elevation:

Cherry 3E Elev 2

Plan #:

10. Fireplace

Living Room

Purchased

As Per Plan

N/A

Family Room

Purchased

As Per Plan

N/A

Other Room - Specify

Fireplace Type

Mantle Type

Colour / Stain

Surround

Hearth

** Refer to Construction Summary

11. Air Conditioning

Air Conditioning

NO

Comment

** Refer to Construction Summary

12. General Comments

** Refer to Construction Summary

Disclaimers and Notes

1) Colours of all materials are as close as possible to builder's selection, but not necessarily identical due to variances in manufacturing.

2) Any extras listed above are null and void unless accompanied by a separate invoice/amendment. Said invoice must be paid in full.

3) The Purchaser agrees that this colour selection is final and that no changes will be permitted, unless required by the Vendor.

4) The Purchaser acknowledges reading and accepting document which contains other miscellaneous disclaimers.

5) In the event of a conflict between the Standard Features schedule of the Agreement of Purchase and Sale and the Interior Colour Scheme, the Interior Colour Scheme shall prevail.

Signature:

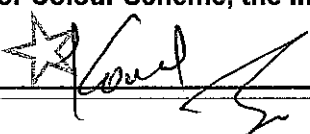

Date:

04/08/23

Page 4 of 4

Printed 8/4/2023 11:38:23

BLK 119 TH30 Barlassina

HAZEL
GLENN
NEW

Cherry 3E

ELEVATION 1 & 2 - 2,154 sq.ft.
Includes 14 sq.ft. of open area

add light

plug 5ft from floor

add light

add light

Tub to shower

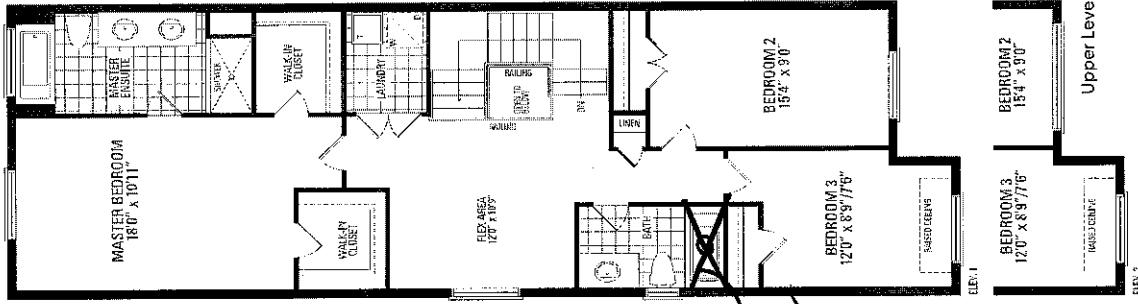
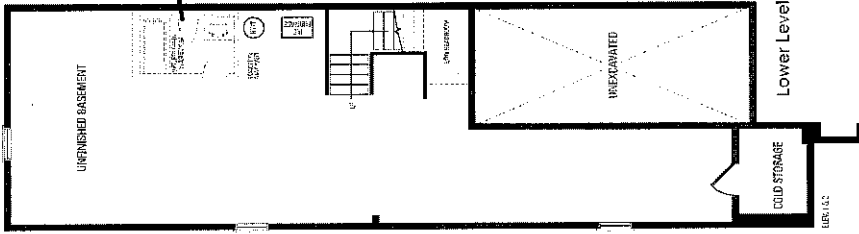
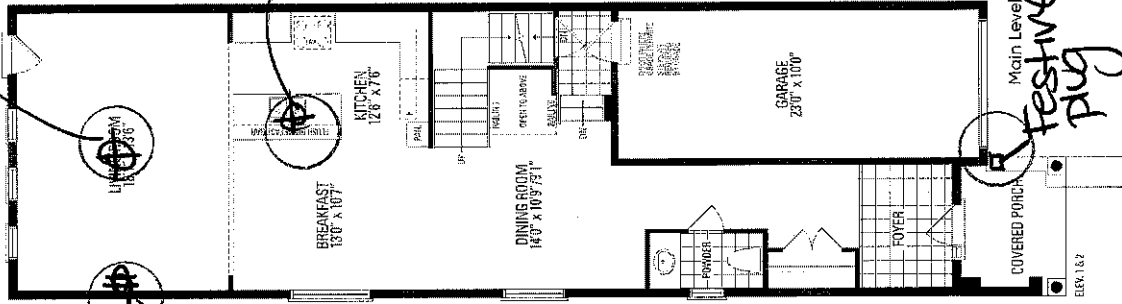

Orientation of home may be reversed and purchaser agrees to accept the same. Steps and porches may vary at any exterior entrance ways due to grading variance. Actual usable floor space may vary from the stated floor areas. All renderings are artist's concept. Dimensions, specifications and architectural detailing subject to modifications. Roofline and adjoining model types may vary due to siting. E. & O.E. October 2022

THIS LAYOUT CONTAINS EXTRAS
THAT ARE NOT PART OF CONTRACT

FILE NAME: BARLASSINA BLK 119 TH 30 AUG 9 23
BM/AUG 9 23

PROTOTYPE FOR EXTRAS

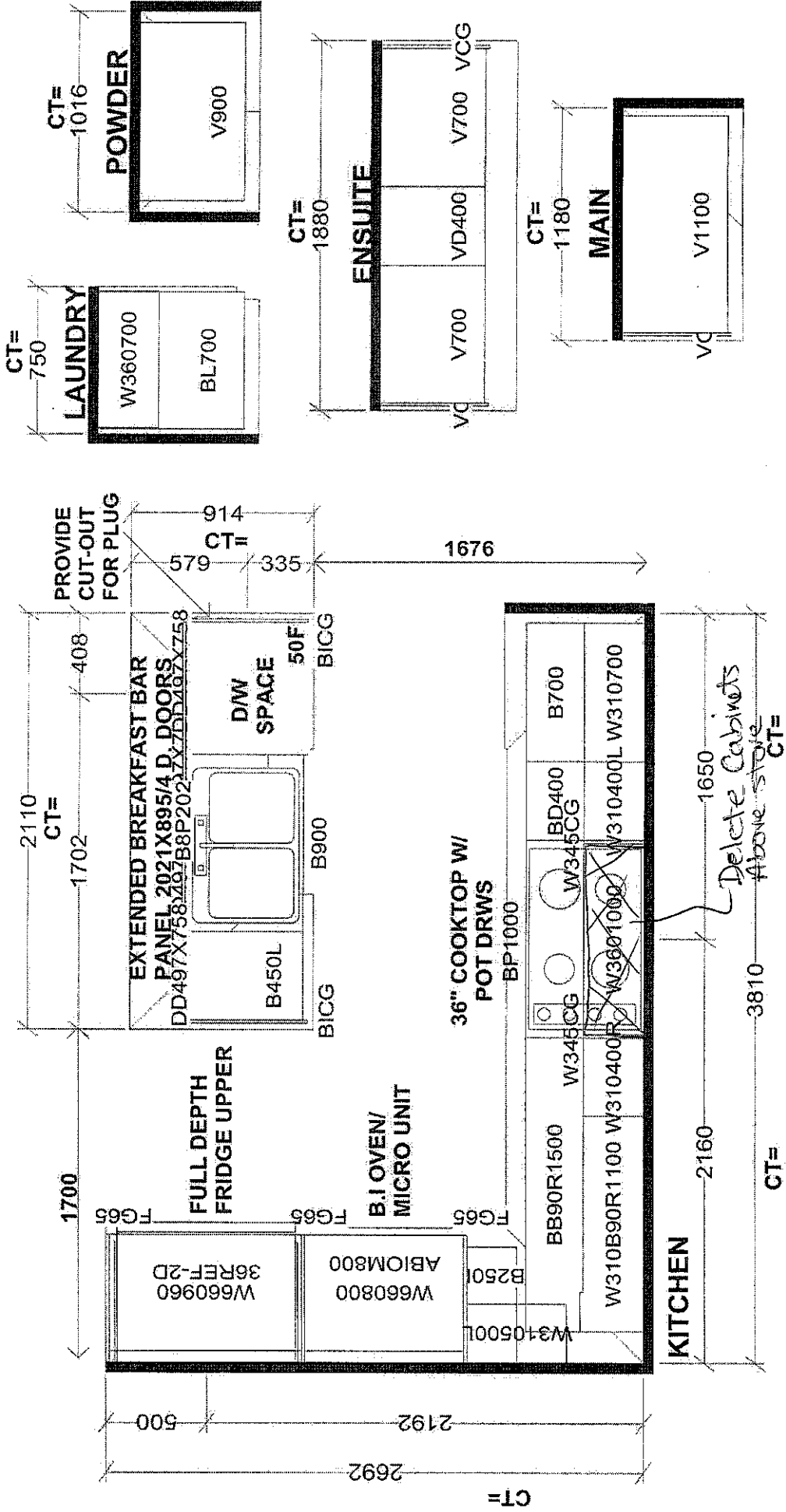

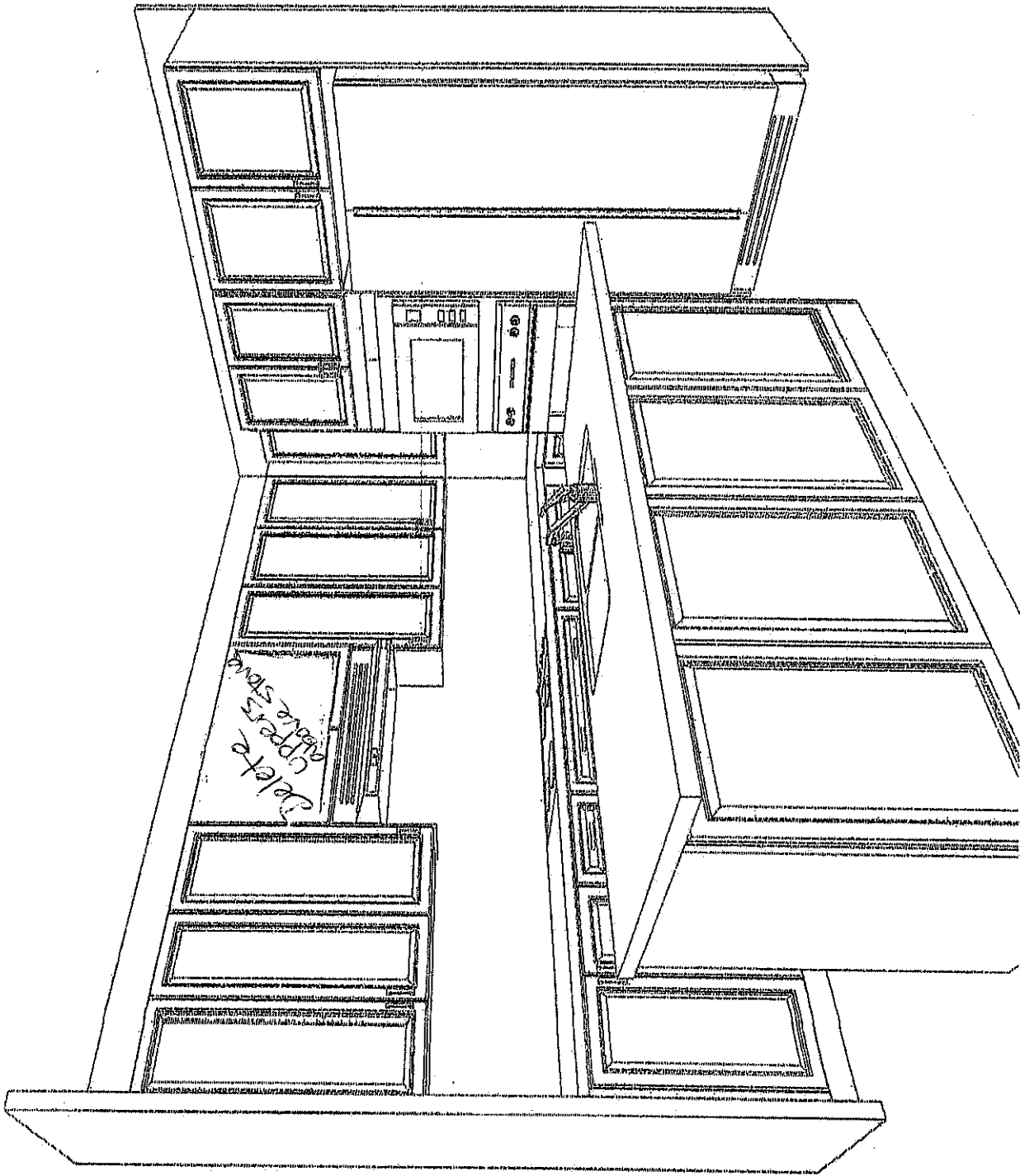

S e l b a I n d u s t r i e s J #			
W WIDTH	W HGT	W CNT	JOB NUMBER:
FLOOR HGT	DOOR HGT		BUILDER: GREENPARK
ST CENT	2X4	VENT BOX COVER	SITE: BARLASSINA, Cambridge
			MODEL: CHERRY 3X
			LOT #: BLK 119 TH 30
		DESIGNER: KS	
		DATE: SEPT 16 22	



delete
copper stone
above stove

Designed: 8/8/2023 Printed: 8/8/2023	 Kitchen + Bath Designs	This drawing is the intellectual property of SELBA INDUSTRIES INC. and is an artistic interpretation of the general appearance of the design. It is not meant to be an exact rendition.
LAYOUT		Drawing #: 1

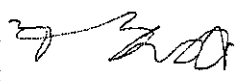
BARLASSENA BLK 119 TH 30 AUG 9 23



Sink Specifications

Colour	SKU
brushed finish	402612

Design and planning tips

- Min cabinet size: 33 in (840 mm)

Specifications:
3 ½" (90 mm) stainless steel strainer(s)
Installation Instructions
Cut-out template
Mounting clips
Limited lifetime warranty

Depending on cabinet construction, a different cabinet size may be required. Consult the cabinet manufacturer.
Cubed weight: 97 lbs.

Optional Accessories

Sink Grid	402125
CapFlow Strainer Cover	517666

QUATRUS R15 Drop-in Super Single

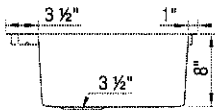
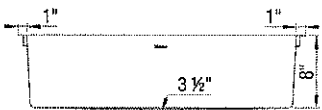
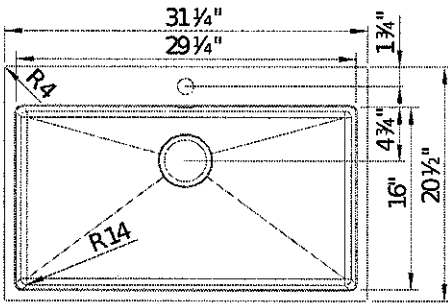

Warranty
Limited lifetime warranty on all sinks and faucets. One-year warranty on all accessories and soap dispensers.

Code/Standards Compliance
BLANCO sinks and faucets are third-party tested and certified to CSA, cUPC, ANSI/ASME, IAPMO and NSF standards and listed by applicable certification bodies. For more information on individual product listings, contact our office or listing organization.

 Need support? Learn more by watching our sink & faucet How-to videos:
<https://www.blanco.com/ca-en/support/how-to-videos/how-to-videos-for-sinks/>

 BLANCO Canada Inc 100 Corporation Drive Brampton ON L6S 6B5	Tel & Fax Tel: 905-494-2400 Toll free: 1-877-425-2626 Fax: 905-494-2425 Toll free: 1-877-825-2626
--	---

While BLANCO strives to provide accurate information, all images and dimensions in this document are intended for reference only and are subject to change at any time without notice. This document is not intended for use as an installation guide. For technical installation details, refer to installation instructions provided with the product. BLANCO assumes no responsibility for the use of superseded or voided specifications.

BLK 119 TH 30 Barlassina
Kitchen Sink

BLK 119 TH 30 Barlassina

October 4, 2018 - 11:47 AM

HOME DEPOT CANADA

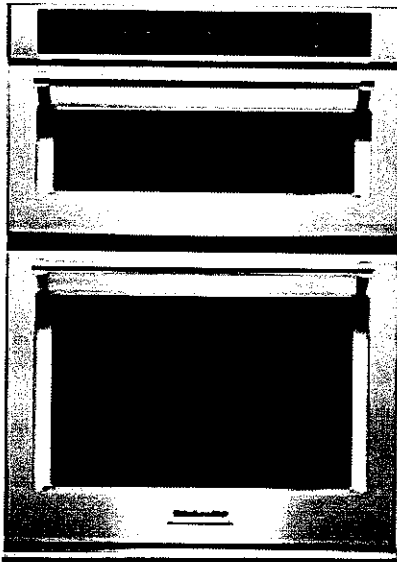

KitchenAid® 30" Combination Wall Oven with Even-Heat™ True Convection (Lower Oven)

KOCE500ESS

Available Finishes/Colours

KOCE500EBL
Other

KOCE500EWH
Other

KOCE500ESS
Other

Dimensions	
Depth	27 1/8
Height	42 1/2
Width	30
Cutout Height	41 5/16
Cutout Width	28 1/2

Microwave Details	
Door Release	Handle
Door Swing	Drop Down
Grill Wattage	1600
Interior Light	Halogen
Turntable	Yes
Turntable Diameter Size	14 1/8

Configuration and Overview	
Fuel Type	Electric
Oven Type	Combination
Oven Cooking System	Convection

Microwave Controls	
Sensor Cooking	Yes - Microwave

Oven Features	
Self-Cleaning	Adjustable Self-Cleaning

Controls	
Door Type	Metal & Glass
Flush Installation Approved	Yes
Handle Color	Stainless Steel
Handle Material	Metal
Oven Window Size	Extra Large
ADA Compliant	No

Oven Controls	
Convection Functions	Bake, Broil, Roast
Display Color	White

Microwave Details	
Cooking Power Wattage	900
Convection	Yes
Convection Power Wattage	1600

This 30" Combination Wall Oven with Even-Heat™ True Convection provides consistent heating and even cooking. A unique box-be shaped design and convection fan helps ensure there are no burnt edges or under cooked centers. Its upper Microwave Convection Cooking Oven combines a 900 watt microwave with a 1600 watt convection element for high speed cooking. Bold design details are the perfect balance of elegance and functionality.

Top Features

Even-Heat™ True Convection Oven (lower oven)

Microwave Convection Cooking (upper oven)

Professionally-Inspired Design (VBL Light)

Manuals & Literature:

[see Use and Care](#) [see Dimension Guide](#)

[see Installation Instructions](#) [see Warranty](#)

Scanned with CamScanner

BLK 119 TH 30 Barlassina

KitchenAid® 27" (68.6 cm) and 30" (76.2 cm) Electric Built-In Microwave/Oven Combination

PRODUCT MODEL NUMBERS

KEMS300E KOCE500E KOCE507E

ELECTRICAL CONNECTION

If codes permit and a separate ground wire is used, it is recommended that a qualified electrical installer determine that the ground path and the wire gauge are in accordance with local codes.

Check with a qualified electrical installer if you are not sure the oven is properly grounded.

The oven must be connected to a grounded metal, permanent wiring system.

Be sure that the electrical connection and wire size are adequate and in conformance with the National Electrical Code, ANSI/NFPA 70-latest edition or CSA Standards C22.1-94, Canadian Electrical Code, Part 1 and C22.2 No. 0-M91-latest edition, and all local codes and ordinances.

To properly install your oven, you must determine the type of electrical connection you will be using and follow the instructions provided for it here.

• Oven must be connected to the proper electrical voltage and frequency as specified on the model/rating plate. See the following illustration.

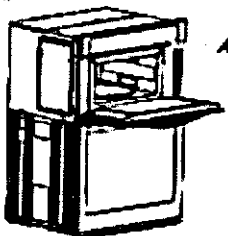

A. Model/rating plate

• Models rated from 7.3 to 9.6 kW at 240 volts (5.4 to 7.4 kW at 208 volts) require a separate 40-amp circuit. Models rated at 4.8 kW and below at 240 volts (3.6 kW and below at 208 volts) require a separate 30-amp circuit.

• A circuit breaker is recommended.

• Connect directly to the fused disconnect (or circuit breaker box) through flexible, armored or nonmetallic sheathed, copper cable (with grounding wire). See "Make Electrical Connection" section.

• Flexible conduit from the oven should be connected directly to the junction box.

• Do not cut the conduit. The length of conduit provided is for serviceability of the oven.

• A UL listed or CSA approved conduit connector must be provided.

• If the house has aluminum wiring, follow the procedure below:

1. Connect a section of solid copper wire to the pigtail leads.
2. Connect the aluminum wiring to the added section of copper wire using special connectors and/or tools designed and UL listed for joining copper to aluminum.

Follow the electrical connector manufacturer's recommended procedure. Aluminum/copper connection must conform with local codes and industry accepted wiring practices.

For power requirements, refer to the following table.

Model	Voltage	Ampere (L1)*	Ampere (L2)*	Rating (W)
KOCE507E/KOCE500E	120/240	32	30	8000
KOCE507E/KOCE500E	120/208	30	28	6800

*Ampere values noted above are for information purposes only; the units are rated in watts.

Because Whirlpool Corporation reserves a continuous commitment to improve our products, we reserve the right to change materials and specifications without notice.

PRODUCT DIMENSIONS

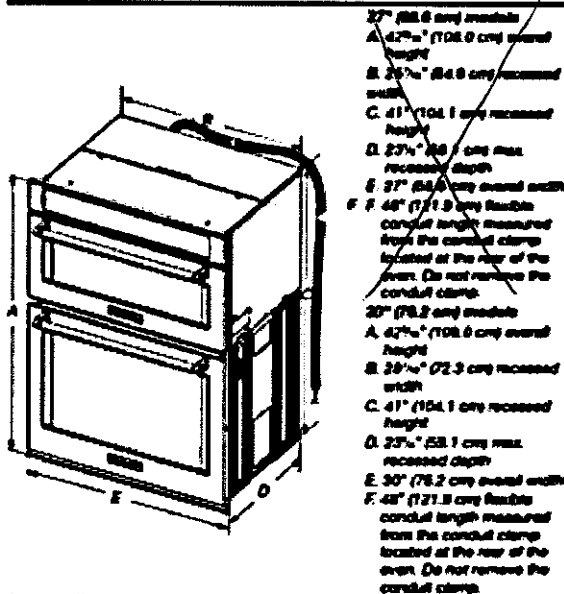

Cabinet Dimensions

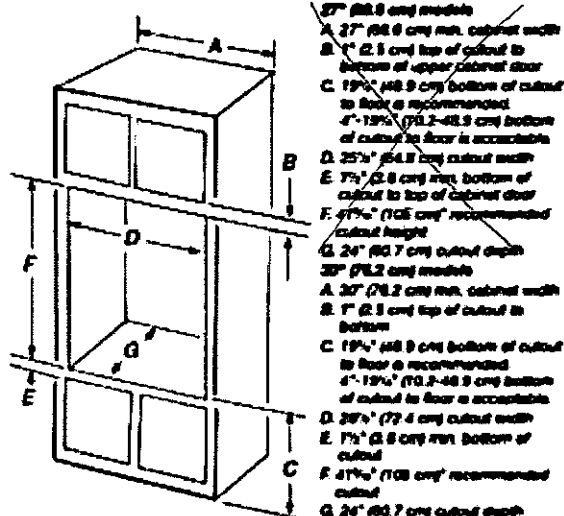

* NOTE: The cabinet height can be between 41" (104.1 cm) and 41 1/2" (105.5 cm) for microwave/oven combination.

Dimensions are for planning purposes only. For complete details, see installation instructions posted with product. Specifications subject to change without notice.

Ref. 19107250025 2-0-99

Scanned with CamScanner



KitchenAid® 25.8 Cu. Ft. 36" Multi-Door Freestanding Refrigerator with Platinum Interior Design

KRMF706ESS

Available Finishes/Colours

KRMF706ESS
Other

KRMF706ESS
Other

Dimensions	
Depth	36 1/4
Height	70 1/8
Width	36
Cutout Height	69
Cutout Width	36
Height To Top Of Cabinet	68 3/8
Depth With Door Open 90 Degree	49
Depth Excluding Handles	34 1/2
Depth Closed Including Handles	36 1/4
Width with Doors Closed	36

Performance	
Refrigerator Capacity	18.15
Energy Star® Qualified	No

Refrigerator Features	
Humidity-Controlled Drawers	2 Half-Width
Lighting	LED
Number of Interior Shelf(s)	5
Spill-Proof Glass Shelf(s)	1 Adjustable Fold, 1 Fixed Full-Width, 3 Adjustable Half-Width
Temperature-Controlled Drawers	2 External Refrigerated Drawers

Performance	
Freezer Capacity	7.61

Door Bins	1 Fixed Full-Width, 3 Adjustable Gallon
-----------	---

This uniquely versatile, platinum interior refrigerator offers 5 doors, including 2 soft-close drawers, to deliver optimized storage. This refrigerator also features the Preserva® Food Care System which uses two independent cooling systems to help keep food fresh longer, while under-shelf LED lighting beautifully displays the food below for greater visibility.

- Top Features
- 5-Door Configuration
 - Preserva® Food Care System
 - Herb Storage

- Manuals & Literature:
- Use and Care
 - Dimension Guide
 - Energy Guide
 - Warranty

KitchenAid®

Because Whirlpool Corporation policy includes a continuous commitment to improve our products, we reserve the right to change materials and specifications without notice. Dimensions are for planning purposes only. For complete details, see Installation Instructions packed with product. Specifications subject to change without notice.

KitchenAid® FOR THE WAY IT'S MADE.®

PRODUCT MODEL NUMBERS

KRMF606E **KRMF706E**

Electrical: A 115 volt, 60 Hz, AC only, 15- or 20-amp fused, grounded electrical supply is required. It is recommended that a separate circuit serving only your refrigerator be provided. Use an outlet that cannot be turned off by a switch. Do not use an extension cord.

Water: A cold water supply with water pressure between 35 and 120 psi (241 and 827 kPa) is required to operate the water dispenser and ice maker. If you have questions about your water pressure, call a licensed, qualified plumber.

NOTE: If the water pressure is less than what is required, the flow of water from the water dispenser could decrease or ice cubes could be hollow or irregular shaped.

Reverse Osmosis Water Supply:
IMPORTANT: The pressure of the water supply coming out of a reverse osmosis system going to the water inlet valve of the refrigerator needs to be between 35 and 120 psi (241 and 827 kPa).

If a reverse osmosis water filtration system is connected to your cold water supply, the water pressure to the reverse osmosis system needs to be a minimum of 40 to 60 psi (276 to 414 kPa).

Bottom Mount Refrigerator

PRODUCT DIMENSIONS

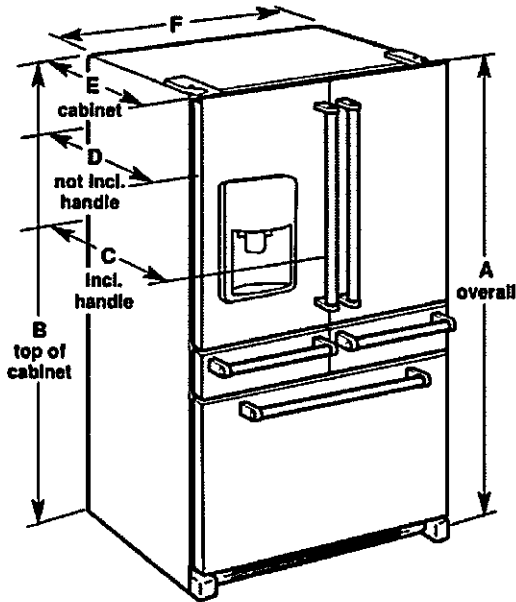

Model Size	Height - Overall "A"	Height - Top of Cabinet "B"	Depth - With Handles "C"	Depth - Without Handles "D"	Depth - Cabinet Only "E"	Width - Cabinet "F"
25.8	70 1/2" (178.1 cm)	68 1/2" (173.7 cm)	36 1/2" (92.1 cm)	34 1/2" (87.7 cm)	29" (73.7 cm)	35 3/4" (90.5 cm)

LOCATION REQUIREMENTS

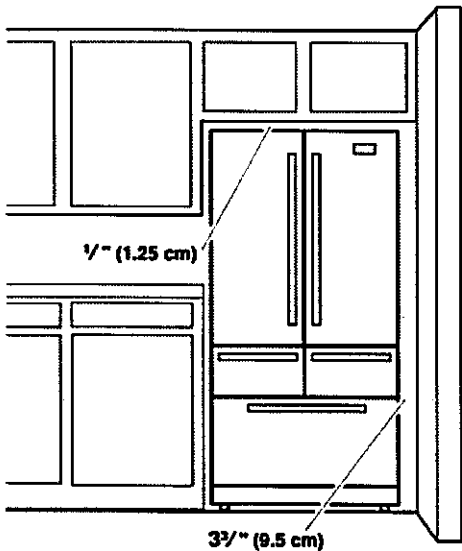

IMPORTANT: This refrigerator is designed for indoor, household use only.

To ensure proper ventilation for your refrigerator, allow for a 1/2" (1.25 cm) of space on each side and at the top. Allow for a 1" (2.54 cm) space behind the refrigerator. If your refrigerator has an ice maker, allow extra space at the back for the water line connections. When installing your refrigerator next to a fixed wall, leave a 3 3/8" (9.5 cm) minimum space between the refrigerator and wall to allow the door to swing open.

NOTE: This refrigerator is intended for use in a location where the temperature ranges from a minimum of 55°F (13°C) to a maximum of 110°F (43°C). The preferred room temperature range for optimum performance, which reduces electricity usage and provides superior cooling, is between 60°F (15°C) and 90°F (32°C). It is recommended that you do not install the refrigerator near a heat source, such as an oven or radiator.

KitchenAid®

24" Dishwasher

DETAILED PLANNING DIMENSIONS GUIDE

Applies to all model numbers starting with:

KDFE104K, KDFE204K, KDTE204K, KDTE204LPA, KDFM404K,
KDTM404K, KDPM604K, KDTM604K, KDPM704K, KDTM704K,
KDTM704LPA, KDPM804K, KDTM804K

PRODUCT DIMENSIONS

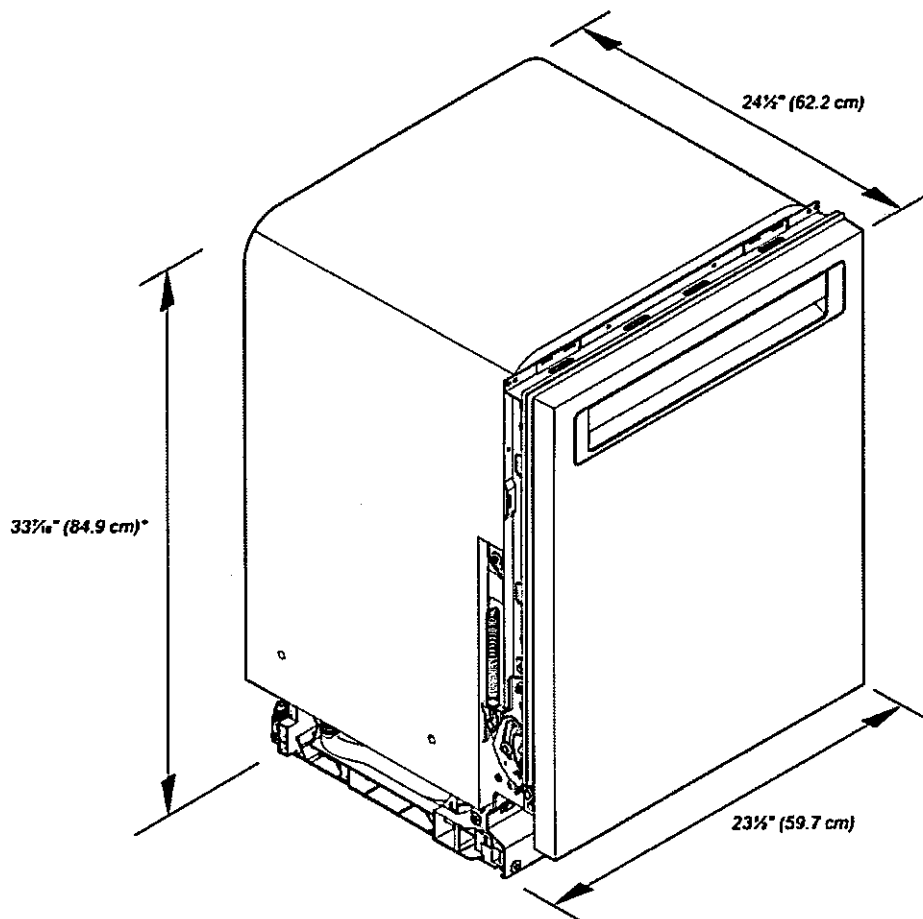

*Dishwasher can be raised 1 1/8" (3.7 cm) with feet fully extended.

Because Whirlpool Corporation policy includes a continuous commitment to improve our products, we reserve the right to change materials and specifications without notice.

Dimensions are for planning purposes only. For complete details, see installation instructions packed with product. Specifications subject to change without notice.

KitchenAid®

24" Dishwasher
DETAILED PLANNING DIMENSIONS GUIDE

PRODUCT DIMENSIONS (CONTD.)

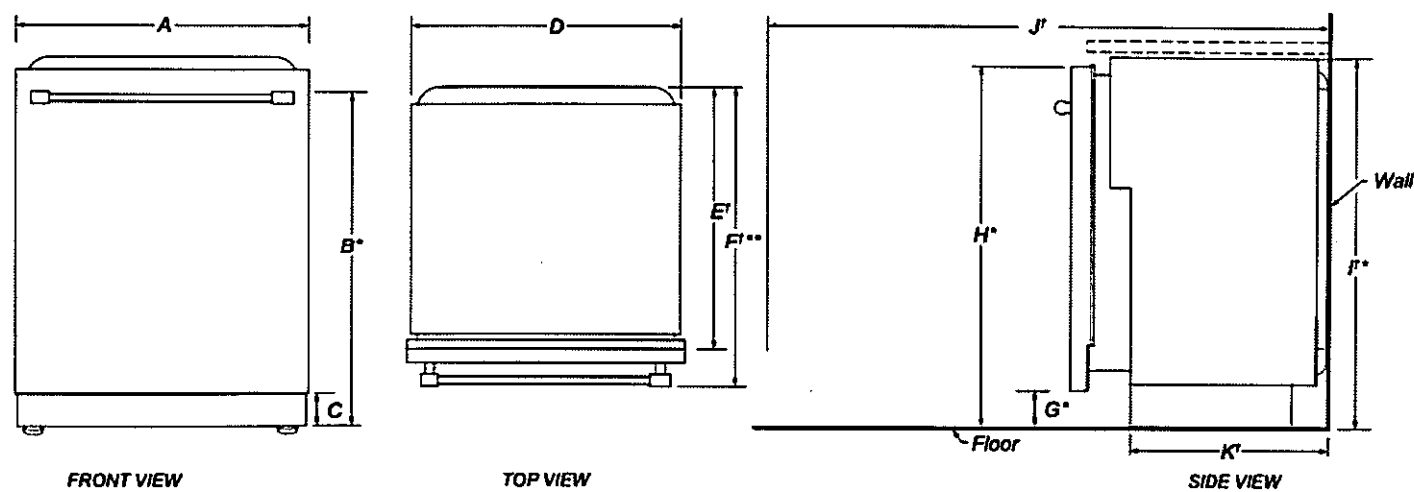

	DESCRIPTION	DIMENSIONS
A	Width of door	23½" (59.7 cm)
B*	Height to top of handle	30⅞" (78.3 cm)
C	Height of adjustable toe kick	3⅞" (8.4 cm) - min. 4⅞" (11.8 cm) - max.
D	Width of recessed dishwasher	22⅞" (57.4 cm)
E†	Depth without door	22⅞" (57.5 cm)
F**	Depth with Towel Bar Handle	26⅞" (68.3 cm)
	Depth with Pocket Handle	24⅞" (62.6 cm)
	Depth of Panel-Ready Models	24" (61.0 cm)
G*	Height to bottom of door (min.)	3⅞" (8.4 cm)
H*	Height to top of door (min.)	33⅞" (84.9 cm)
J*	Height of recessed dishwasher (min.)	33⅞" (85.4 cm)
J	Depth with door fully open (min.)	50⅞" (127.4 cm)
K*	Depth with toe kick (min.)	20⅞" (52.9 cm)

†Insulation blanket thickness adds up to 11/16" (1.8 cm) but can crush up to 1/8" (0.3 cm).
*Dishwasher can be raised 1⅞" (3.7 cm) with feet fully extended.
**For panel-ready models, dishwasher depth is 24" (61.0 cm), not including the 3/4" (1.9 cm) custom door panel.

Because Whirlpool Corporation policy includes a continuous commitment to improve our products, we reserve the right to change materials and specifications without notice.

Dimensions are for planning purposes only. For complete details, see Installation Instructions packed with product. Specifications subject to change without notice.

BLK 119 TH 30 Barlassina

KitchenAid® 24" Dishwasher

DETAILED PLANNING DIMENSIONS GUIDE

OPENING/CLEARANCE DIMENSIONS

IMPORTANT: Check that all surfaces have no protrusions that would prohibit dishwasher installation.

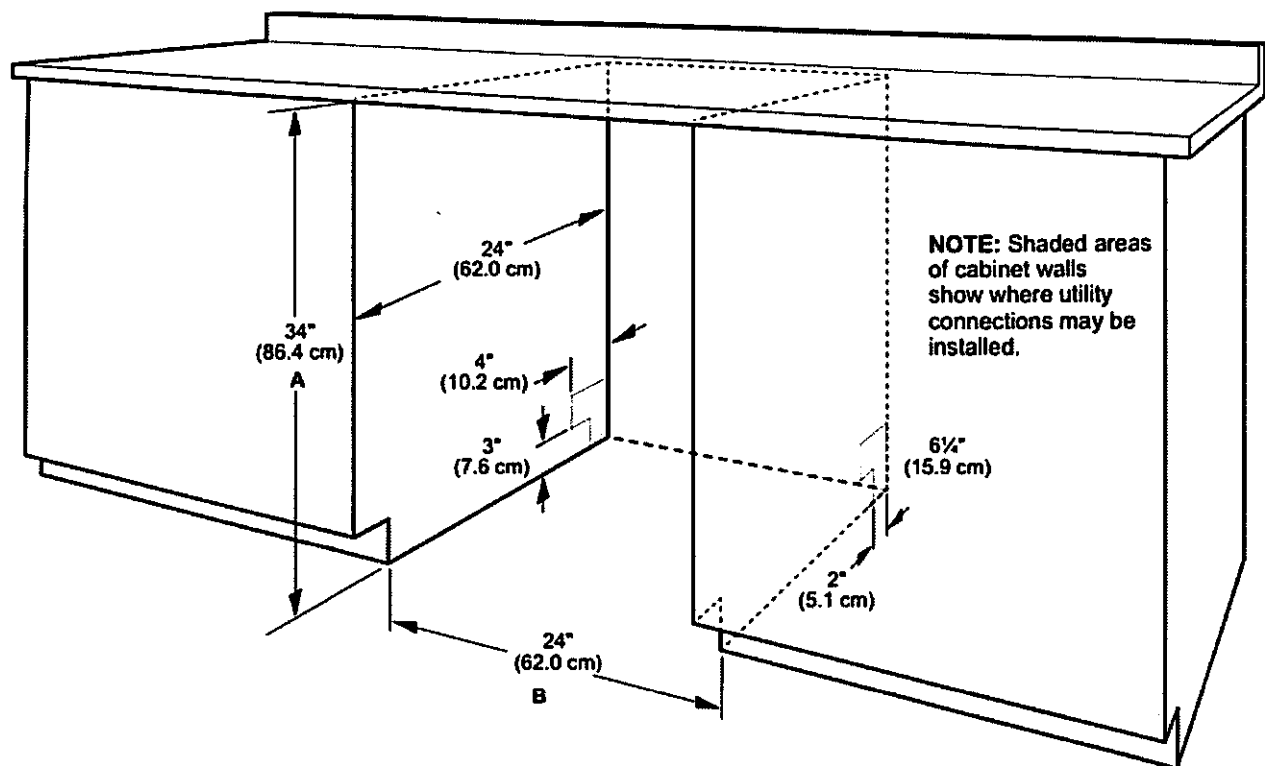

A. Measured from the lowest point on the underside of the countertop. May be reduced to 33½" (85.1 cm) by removing the wheels and perforated area of insulation (blanket) on dishwasher.

B. Minimum, measured from narrowest point of opening.

NOTE: Corner locations require a 2" (5.1 cm) minimum clearance between the side of the dishwasher door and the wall or cabinet.

Because Whirlpool Corporation policy includes a continuous commitment to improve our products, we reserve the right to change materials and specifications without notice.

Dimensions are for planning purposes only. For complete details, see Installation Instructions packed with product. Specifications subject to change without notice.

4 of 12 REQUIREMENTS

■ The drain hose is supplied with your dishwasher. If drain hose is not long enough, use a new drain hose with a maximum length of 12 ft (3.7 m) that meets all current AHAM/ IAPMO test standards, is resistant to heat and detergent, and fits the 1" (2.5 cm) drain connector of the dishwasher.

NOTE: Do not connect multiple drain hoses together.

- Make sure to connect drain hose to waste tee or disposer inlet above drain trap in house plumbing and 20" (50.8 cm) minimum above the floor. It is recommended that the drain hose either be looped up and securely fastened to the underside of the counter or be connected to an air gap.
- Make sure to use an air gap if the drain hose is connected to house plumbing lower than 20" (50.8 cm) above subfloor or floor.

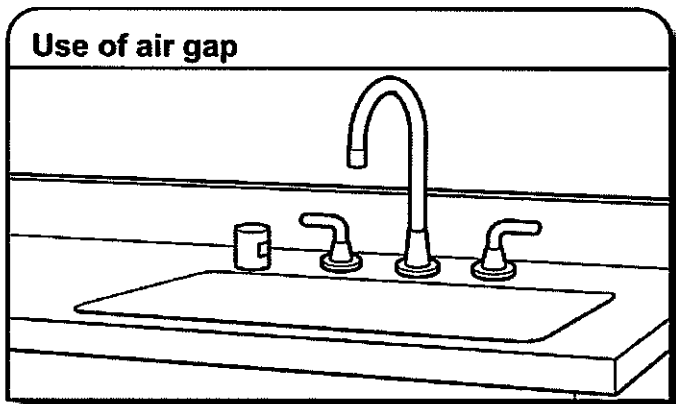

- If required, the air gap should be installed in accordance with the air gap installation instructions. When you are connecting the air gap, a rubber hose (not provided) will be needed to connect to the waste tee or disposer inlet.
- Use 1/2" (1.3 cm) minimum I.D. drain line fittings.

WATER SUPPLY REQUIREMENTS

- This dishwasher has a water heating feature and also requires a connection to a hot water supply line.
- A hot water line with 20 psi to 120 psi (138 kPa to 862 kPa) water pressure can be verified by a licensed plumber.
- 120°F (49°C) water at dishwasher.
- 3/8" (0.95 cm) O.D. copper tubing with compression fitting or flexible braided water supply line.

NOTE: 1/2" (1.3 cm) minimum plastic tubing is not recommended.

- A 90° elbow with 3/4" (0.95 cm) hose connection with rubber washer.
- Do not solder within 6" (15.2 cm) of the water inlet valve.
- If installed in new construction, make sure the house water supply lines have been flushed prior to connecting the dishwasher to remove any debris that may exist in the supply line.

NOTE: If replacing an existing dishwasher, it is recommended to install a new water line and drain hose (supplied) with the new dishwasher.

ELECTRICAL REQUIREMENTS

⚠ WARNING



Electrical Shock Hazard

Plug into a grounded 3 prong outlet.

Do not remove ground prong.

Do not use an adapter.

Do not use an extension cord.

Failure to follow these instructions can result in death, fire, or electrical shock.

Be sure that the electrical connection and wire size are adequate and in conformance with the National Electrical Code, ANSI/NFPA 70 - latest edition, and all local codes and ordinances.

A copy of the above code standards can be obtained from:

National Fire Protection Association
1 Batterymarch Park
Quincy, MA 02169-7471

You Must Have:

- 120 V, 60 Hz, AC only, 15 A or 20 A, fused electrical supply
- Copper wire only
- A maximum of 2 field wiring supply conductors (12 AWG largest size) plus 1 grounding conductor are permitted in the terminal box.

We Recommend:

- A time-delay fuse or circuit breaker.

Circuit Requirements:

- The dishwasher may be installed on the same circuit as a garbage disposal providing that the branch circuit cannot exceed rated circuit load and must comply with all governing codes and regulations such as but not limited to National Electrical Code, ANSI/NFPA 70 - latest edition.
- No electrical connections other than the dishwasher power and ground connections can be made inside of the dishwasher terminal box.

If connecting dishwasher with a power supply cord:

- Use UL Listed power cord kit marked for use with dishwasher.



- Plug into a grounded 3 prong outlet. Outlet must meet all local codes and ordinances.

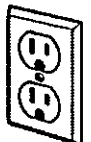

If connecting dishwasher with direct wiring:

- Use flexible, armored, or nonmetallic sheathed copper wire with grounding wire that meets the wiring requirements for your home and local codes and ordinances.
- Use a UL Listed/CSA Approved metallic strain relief.



JENN-AIR® DETAILED PLANNING DIMENSIONS

2 of 2

36" GAS COOKTOP

JGC3536G – 36" x 4³/₈" x 21"

OPENING/CLEARANCE DIMENSIONS

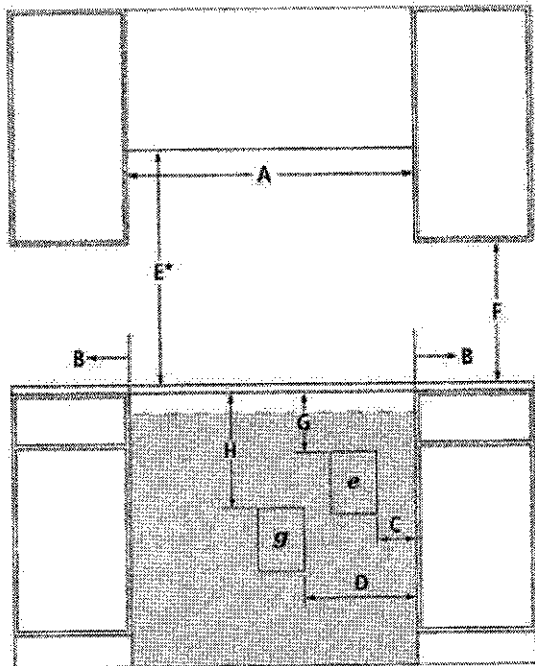

FRONT VIEW

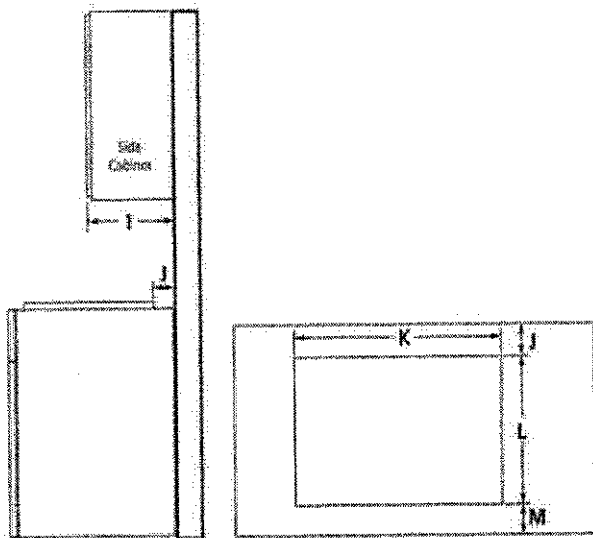

SIDE VIEW

TOP VIEW – CUTOUT

MODEL #		JGC3536G	
		in	cm
A	Width of combustible area above cooking surface (min.)	36	91.4
B	Width from cooktop to fixed wall or other combustible material (min.)	6	15.2
C	Width to outer edge of electrical outlet (recommended)	9	22.9
D	Width to gas supply line location (recommended)	12	30.5
E*	Height to bottom of uncovered wood or metal cabinet above cooking surface (min.)	30	76.2
F	Height to bottom of uncovered wood or metal cabinet (min.)	18	45.7
G	Height to top edge of electrical outlet (recommended)	9	22.9
H	Height to gas supply line location (recommended)	18	45.7
I	Depth of upper cabinet (recommended)	13	33.0
J	Depth from cutout to wall (min.)	2 ³ / ₁₆	5.9
K	Width of cutout	35 ³ / ₈	89.9
L	Depth of cutout	20 ³ / ₈	51.8
M	Depth from cutout to front of countertop	2 ³ / ₁₆	5.9
e	Recommended electrical access location		
g	Recommended gas supply line location		

*Dimension can be reduced by 6" (15.2 cm) when bottom of wood or metal cabinet is covered by not less than 1/4" (0.6 cm) flame retardant millboard covered with not less than No. 28 MSG sheet metal, 0.015" (0.4 mm) stainless steel, 0.024" (0.6 mm) aluminum or 0.020" (0.5 mm) copper. If installing a hood or microwave hood combination above the cooktop, follow the hood or microwave hood combination instructions for dimensional clearances above the cooking surface.

GAS REQUIREMENTS

Natural Gas

This cooktop is factory-set for use with natural gas.

LP Gas Conversion

Conversion must be done by a qualified service technician. To convert to LP gas, use an LP gas conversion kit.

ELECTRICAL REQUIREMENTS

120 volt, 60 Hz, AC only, 15-amp fused, electrical circuit is required. A time-delay fuse or dedicated circuit is recommended.

LOCATION REQUIREMENTS

- To ensure cooktop base clearance, cabinet side walls need to be wider than the cutout.
- If cabinet has a drawer, allow a 4" (10.2 cm) minimum clearance between countertop and top of drawer. Drawer depth may need to be shortened to avoid interfering with the regulator.

IMPORTANT: Dimensional specifications are provided for planning purposes only. Do not make any cutouts based on this information. Refer to the Installation Guide before selecting cabinetry, verifying electrical/gas connections, making cutouts or beginning installation. All Jenn-Air® appliances are appropriately UL, CUL or CSA approved.

JENN-AIR®

8993dZw217

P2 9 12

JENN-AIR® DETAILED PLANNING DIMENSIONS

1 of 2

36" GAS COOKTOP

JGC3536G - 36" x 4 $\frac{1}{4}$ " x 21"

PRODUCT DIMENSIONS

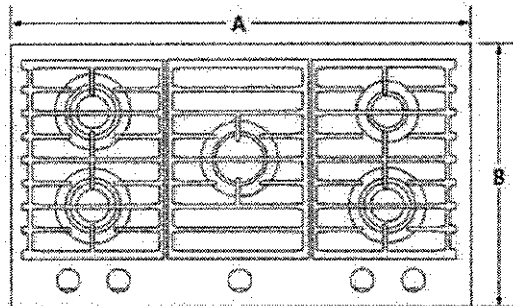

TOP VIEW



FRONT VIEW

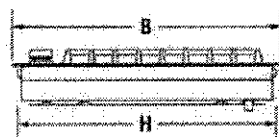

SIDE VIEW

MODEL #		JGC3536G	
		in	cm
A	Overall width	36	91.4
B	Overall depth	21	53.3
C	Center of cooktop to center of gas inlet	14 $\frac{1}{2}$	36.6
D*	Width of cooktop base	35 $\frac{5}{8}$	74.5
E	Height of cooktop base	3 $\frac{3}{8}$	8.1
F	Height from gas inlet to underside of cooktop	4 $\frac{1}{8}$	10.6
G	Height of cooktop with grates	1 $\frac{1}{4}$	3.1
H	Depth of cooktop base	20 $\frac{1}{4}$	51.8

*Measured from tab to tab. Tabs should not be bent during installation.

IMPORTANT: Dimensional specifications are provided for planning purposes only. Do not make any cutouts based on this information. Refer to the Installation Guide before selecting cabinetry, verifying electrical/gas connections, making cutouts or beginning installation. All Jenn-Air® appliances are appropriately UL, CUL or CSA approved.

JENN-AIR®

8993dZw217

Configuration and Overview

Hood TypeWall Mount

Size91.44 cm, 36 in

Details

Night LightYes

Night Light TypeHalogen

Feedback

Number of Night Light Settings1

Number of Task Light Settings1

Task Light TypeLED

Task LightingYes

BLK 119 TH 30 Barkassina

Specifications

Height:

62.55 cm

24-5/8 in

Width:

91.44 cm

36 in

Depth:

50.01 cm

19-11/16 in

Certifications

Prop 65



**CALIFORNIA
RESIDENTS
ONLY -
WARNING:**

Cancer and Reproductive
Harm -
www.P65Warnings.ca.gov.

Feedback

Dimensions

Depth

50.01 cm, 19-11/16 in

Height

62.55 cm, 24-5/8 in