

CONSTRUCTION SUMMARY
Hazel Glenn - Barlassina Construction Inc.

RECEIVED

AUG - 9 2023

TEL: RES.: 437-220-4620

PURCHASER: Syed Muhammad Ahmad SALEH

| | | | | |
|-----------------------------------|-------------|-------------------------------|--|--|
| LOT / PHASE Block 120 TH15 / 1 | REG. PLAN # | HOUSE TYPE Cherry 1 Elev 2 | | |
|-----------------------------------|-------------|-------------------------------|--|--|

CABINETRY

| | |
|--|--|
| 1 - CABINETRY - KITCHEN - LIGHT VALANCE 01Aug23 Note: CABINETRY ONLY - ELECTRICAL PRICED SEPARATELY | |
| 1 - CABINETRY - KITCHEN - UPGRADE 1 01Aug23 Note: | |

CABINETRY ACCESSORIES

| | |
|---|--|
| 1 - ***INSERT*** - KITCHEN CABINETRY - PANTRY UNIT UPGRADE - TO GO FROM 300MM TO 600MM DEEP - PRICE IS PER FOOT - UPGRADE 1 04Aug23 Note: | |
| 1 - ***DELETE*** - KITCHEN CABINETRY - PANTRY UNIT UPGRADE - TO GO FROM 300MM TO 600MM DEEP - PRICE IS PER FOOT - STANDARD LEVEL 04Aug23 Note: | |
| 1 - KITCHEN CABINETRY - PANTRY UNIT UPGRADE - TO GO FROM 300MM TO 600MM DEEP - PRICE IS PER FOOT - STANDARD LEVEL 01Aug23 Note: | |
| 1 - KITCHEN CABINETRY UPPER - FULL DEPTH ABOVE FRIDGE UPPER WITH GABLES - 650MM DEEP - PRICE IS EACH 01Aug23 Note: | |

CONSTRUCTION

| | |
|---|--|
| 1 - SMOOTH CEILINGS FIRST FLOOR ONLY 30Mar23 Note: | |
|---|--|

COUNTER TOP

| | |
|--|--|
| 1 - UPGRADE STONE COUNTER TOP - POWDER ROOM COUNTER TOP 01Aug23 Note: | |
| 1 - UPGRADE STONE COUNTER TOP - KITCHEN FULL HEIGHT BACKSPLASH 01Aug23 Note: DOES NOT INCLUDE AREA BEHIND CHIMNEY HOOD TO CEILING | |
| 1 - UPGRADE STONE COUNTER TOP - KITCHEN COUNTER TOP 01Aug23 Note: | |

DOORS AND TRIM

| | |
|---|--|
| 1 - INTERIOR DOORS - UPGRADE TO CARRARA SMOOTH HALLOW IN LIEU OF STANDARD SERIES - TOWNS 01Aug23 Note: | |
|---|--|

ELECTRICAL

| | |
|---|--|
| 1 - KITCHEN - VALANCE LIGHTING - LED LIGHTING 01Aug23 Note: | |
| 1 - STANDARD DINING ROOM LIGHT TO BE CENTERED BETWEEN LIVING AND DINING ROOM 30Mar23 Note: | |
| 1 - RELOCATE STANDARD KITCHEN LIGHT TO BE CENTERED OVER ISLAND 30Mar23 Note: | |

FIREPLACE AND ACCESSORIES



CONSTRUCTION SUMMARY

Hazel Glenn - Barlassina Construction Inc.

PURCHASER: Syed Muhammad Ahmad SALEH

TEL: RES.: 437-220-4620

| | | | | |
|-----------------------------------|-------------|-------------------------------|--|--|
| LOT / PHASE Block 120 TH15 / 1 | REG. PLAN # | HOUSE TYPE Cherry 1 Elev 2 | | |
|-----------------------------------|-------------|-------------------------------|--|--|

1 - GAS LINE ROUGH-IN FOR STOVE (INCLUDES ELECTRICAL OUTLET) - FIRST FLOOR

30Mar23 Note:

HARDWOOD FLOORING

1 - LAMINATE - LEXINGTON SERIES - Upper Hall and Flex Area

04Aug23 Note:

HEATING AND AIR CONDITIONING

1 - HUMIDIFER

30Mar23 Note:

PLUMBING

1 - SINK - UNDERMOUNT SINK - TECO KITCHEN #170

01Aug23 Note:

1 - POWDER ROOM - SINK - UNDERMOUNT SINK - TECO BATH #4815

01Aug23 Note:

1 - TOE TESTER - ADD TOE TESTER TO SHOWER- MASTER ENSUITE SHOWER

30Mar23 Note:

1 - WATER LINE FOR FRIDGE - ROUGH-IN ONLY

30Mar23 Note:

1 - WASHROOM - 3 PIECE ROUGH-IN IN BASEMENT

30Mar23 Note:

PROMOTIONAL

1 - LESS BALANCE OF CREDIT FROM PURCHASER EXTRA SHEET IN OFFER

01Aug23 Note:

1 - PARTIAL REDEMPTION OF PROMOTIONAL PACKAGE \$6,495 BALANCE FORWARD \$3,505 TO BE USED AT A LATER DATE. ORIGINAL PROMOTIONAL PACKAGE OF \$10,000 AS PER SCHEDULE PE

30Mar23 Note:

STAIRS AND RAILINGS

1 - PICKETS - EUROLINE 2 - BLACK PICKETS

01Aug23 Note:

1 - STAINED STAIRS - STANDARD STAIRCASE - INCLUDING EXTRA STEPS TO LOWER LANDING

01Aug23 Note:

EXTRAS AS PER OFFER

The Vendor agrees that notwithstanding any other term or provision in this Agreement included in the Purchase Price and in addition to those items detailed in Schedule GP to the Agreement of Purchase and Sale, the Purchaser is entitled to a credit of Ten *Worksheet* Note:

This Document is Extremely Time Sensitive - Printed 4 Aug 23 at 13:25

Purchaser:

Syed Muhammad Ahmad SALEH

Telephone Res. / Bus:

(437) 220-4620 /

Decor Advisor:

Ida Viola

Lock Date:

1-Aug-23

Property:

Block 120 TH15

Project:

Barlassina Construction Inc.

Model and Elevation:

Cherry 1 Elev 2

Plan #:

1. Cabinetry

| | Style and Colour | Hardware |
|-------------------------|--------------------------------|----------|
| Kitchen / Breakfast | DANA 823 DRIFTWOOD | 464SA |
| Laundry Room | ELISSE | Standard |
| Powder Room | MONACO 821 INDUSTRIAL GRAPHITE | 464SA |
| Master Ensuite Bathroom | MONACO 821 INDUSTRIAL GRAPHITE | 464SA |
| Main Bathroom | MONACO 821 INDUSTRIAL GRAPHITE | 464SA |
| | | |
| | | |
| | | |
| | | |

Stove Opening



STANDARD

NOTE: If not specified, opening will be set to builder's standard opening of approximately 30" width

Fridge Opening

STANDARD

NOTE: If not specified, opening will be set to builder's standard opening of approximately 37" width x 74" height

** Refer to Construction Summary

2. Counters

| | Counter | Edge | Niche |
|-------------------------|--------------------------------|-----------|-------|
| Kitchen / Breakfast | QUARTZ-MISTRAL | #360 EDGE | |
| Laundry Room | N/A | | |
| Powder Room | QUARTZ-MISTRAL | #360 EDGE | |
| Master Ensuite Bathroom | LAMINATE-WHITE CARRARA 4924-38 | | |
| Main Bathroom | LAMINATE-WHITE CARRARA 4924-38 | | |
| | | | |
| | | | |
| | | | |
| | | | |

Kitchen Backsplash

QUARTZ-MISTRAL FULL HEIGHT

** Refer to Construction Summary

Purchaser:

Syed Muhammad Ahmad SALEH

Telephone Res. / Bus:

(437) 220-4620 /

Decor Advisor:

Ida Viola

Lock Date:

1-Aug-23

Property:

Block 120 TH15

Project:

Barlassina Construction Inc.

Model and Elevation:

Cherry 1 Elev 2

Plan #:

3. Ceramic Flooring

At a 45

| | | |
|-------------------------|---------------------------|--------------------------|
| Entrance Vestibule | TILE-CONCRETE WHITE 13X13 | <input type="checkbox"/> |
| Main Hall | LAMINATE | <input type="checkbox"/> |
| Kitchen / Breakfast | LAMINATE | <input type="checkbox"/> |
| Laundry Room | TILE-CONCRETE WHITE 13X13 | <input type="checkbox"/> |
| Powder Room | TILE-CONCRETE WHITE 13X13 | <input type="checkbox"/> |
| Master Ensuite Bathroom | TILE-CONCRETE WHITE 13X13 | <input type="checkbox"/> |
| Main Bathroom | TILE-CONCRETE WHITE 13X13 | <input type="checkbox"/> |
| | | <input type="checkbox"/> |
| | | <input type="checkbox"/> |
| | | <input type="checkbox"/> |
| | | <input type="checkbox"/> |

** Refer to Construction Summary ** METAL STRIP THRESHOLD WHERE APPLICABLE UNLESS SPECIFIED **

4. Ceramic Wall Tile

| Master Ensuite Bathroom | Selection | Describe |
|-------------------------|------------------------|----------|
| Tub Deck Wall | TILE-NEO LTE GREY 8X10 | |
| Shower Stall | TILE-NEO LTE GREY 8X10 | |
| Bathtub Enclosure Walls | | |
| Main Bathroom | TILE-NEO LTE GREY 8X10 | |
| | | |
| | | |
| | | |
| | | |
| Kitchen Backsplash | QUARTZ | |

** Refer to Construction Summary - STANDARD GROUT THROUGHOUT UNLESS SPECIFIED

5. Trim Carpentry

| | |
|----------------|------------------------------------|
| Interior Doors | CARRARA-SMOOTH |
| Interior Trim | As Per Construction Specifications |

** Refer to Construction Summary

6. Plaster Mouldings and Medallions

| | | | | | |
|--------------------|-----|--|-------------------|-----|--|
| Entrance Vestibule | N/A | | Kitchen/Breakfast | N/A | |
| Main Hall | N/A | | Den/Library | N/A | |
| Living Room | N/A | | Lower Landing | N/A | |
| Dining Room | N/A | | | | |
| Family Room | N/A | | | | |

** Refer to Construction Summary

Purchaser: Syed Muhammad Ahmad SALEH
Telephone Res. / Bus: (437) 220-4620 /
Decor Advisor: Ida Viola
Lock Date: 4-Aug-23

Property: Block 120 TH15
Project: Barlassina Construction Inc.
Model and Elevation: Cherry 1 Elev 2
Plan #:

7. Other Flooring

| | |
|------------------------------|---|
| Main Hall | LAMINATE-LEXINGTON-ROCHEFORT OAK-TL-LW1317 PEFC |
| Living Room | LAMINATE-LEXINGTON-ROCHEFORT OAK-TL-LW1317 PEFC |
| Dining Room | LAMINATE-LEXINGTON-ROCHEFORT OAK-TL-LW1317 PEFC |
| Family Room | N/A |
| Den / Library / Study | N/A |
| Basement Landing(If Applies) | N/A |
| Lower Landing (If Applies) | LAMINATE-LEXINGTON-ROCHEFORT OAK-TL-LW1317 PEFC |
| Upper Landing | LAMINATE-LEXINGTON-ROCHEFORT OAK-TL-LW1317 PEFC |
| Upper Hall | LAMINATE-LEXINGTON-ROCHEFORT OAK-TL-LW1317 PEFC |
| Master Bedroom | CARPET - SPARTACUS 89418 BLACK ICE |
| Bedroom #2 | CARPET - SPARTACUS 89418 BLACK ICE |
| Bedroom #3 | CARPET - SPARTACUS 89418 BLACK ICE |
| Bedroom #4 | N/A |
| Bedroom #5 | N/A |
| Flex Room | LAMINATE-LEXINGTON-ROCHEFORT OAK-TL-LW1317 PEFC |
| Kitchen/Breakfast | LAMINATE-LEXINGTON-ROCHEFORT OAK-TL-LW1317 PEFC |
| | |

Underpad Standard ☒ Upgrade ☐

** Refer to Construction Summary

8. Railings and Pickets

| | | | |
|------------------|------------------------------------|--------|--------------------------------|
| Railing Type | AS PER CONSTRUCTION SPECIFICATIONS | Colour | TORLYS ROCHEFORT OAK-TL-LW1317 |
| Picket Type | EUROLINE 2 | Colour | BLACK |
| Stringer / Riser | AS PER CONSTRUCTION SPECIFICATIONS | Colour | TORLYS ROCHEFORT OAK-TL-LW1317 |
| Treads | AS PER CONSTRUCTION SPECIFICATIONS | Colour | TORLYS ROCHEFORT OAK-TL-LW1317 |

Red Oak Stairs as Per Vendor's Standard

** Refer to Construction Summary THE STAIN COLOURS OR FINISH AVAILABLE ON RISERS, TREADS, PICKETS AND RAILS (STAIRCASES), WILL NOT BE AN EXACT MATCH TO PREFINISHED HARDWOOD OR LAMINATE FLOORS.

9. Wall Paint Flat Finish

| | | | |
|------------------------------|--------------|----------------|--------------|
| Main & Upper Hall | 22 WARM GREY | Master Bedroom | 22 WARM GREY |
| Living Room | 22 WARM GREY | Bedroom #2 | 22 WARM GREY |
| Dining Room | 22 WARM GREY | Bedroom #3 | 22 WARM GREY |
| Kitchen / Breakfast | 22 WARM GREY | Bedroom #4 | N/A |
| Family Room | N/A | Bedroom #5 | N/A |
| Powder Room | 22 WARM GREY | Master Ensuite | 22 WARM GREY |
| Laundry Room | 22 WARM GREY | Main Bathroom | 22 WARM GREY |
| Den/Library | N/A | Flex Room | 22 WARM GREY |
| Trim & Door Paint-Semi Gloss | BIRCH WHITE | | |
| | | | |
| | | | |

* Refer to Construction Summary

Initial 

Purchaser:

Syed Muhammad Ahmad SALEH

Telephone Res. / Bus:

(437) 220-4620 /

Decor Advisor:

Ida Viola

Lock Date:

1-Aug-23

Property:

Block 120 TH15

Project:

Barlassina Construction Inc.

Model and Elevation:

Cherry 1 Elev 2

Plan #:

10. Fireplace

| | Living Room | | | Family Room | | | Other Room - Specify | | |
|----------------|-----------------------|-----------------------|----------------------------------|-----------------------|-----------------------|----------------------------------|-----------------------|-----------------------|----------------------------------|
| | Purchased | As Per Plan | N/A | Purchased | As Per Plan | N/A | Purchased | As Per Plan | N/A |
| Fireplace Type | <input type="radio"/> | <input type="radio"/> | <input checked="" type="radio"/> | <input type="radio"/> | <input type="radio"/> | <input checked="" type="radio"/> | <input type="radio"/> | <input type="radio"/> | <input checked="" type="radio"/> |
| Mantle Type | | | | | | | | | |
| Colour / Stain | | | | | | | | | |
| Surround | | | | | | | | | |
| Hearth | | | | | | | | | |

** Refer to Construction Summary

11. Air Conditioning

Air Conditioning

Comment

** Refer to Construction Summary

12. General Comments

** Refer to Construction Summary

Disclaimers and Notes

- 1) Colours of all materials are as close as possible to builder's selection, but not necessarily identical due to variances in manufacturing.

2) Any extras listed above are null and void unless accompanied by a separate invoice/amendment. Said invoice must be paid in full.

3) The Purchaser agrees that this colour selection is final and that no changes will be permitted, unless required by the Vendor.

4) The Purchaser acknowledges reading and accepting document which contains other miscellaneous disclaimers.

5) In the event of a conflict between the Standard Features schedule of the Agreement of Purchase and Sale and the Interior Colour Scheme, the Interior Colour Scheme shall prevail.

Signature:

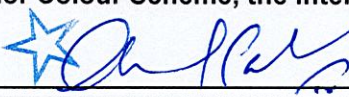

Date:

August 01, 2023.

BLK 120 TH15 Barlassina

-Valance

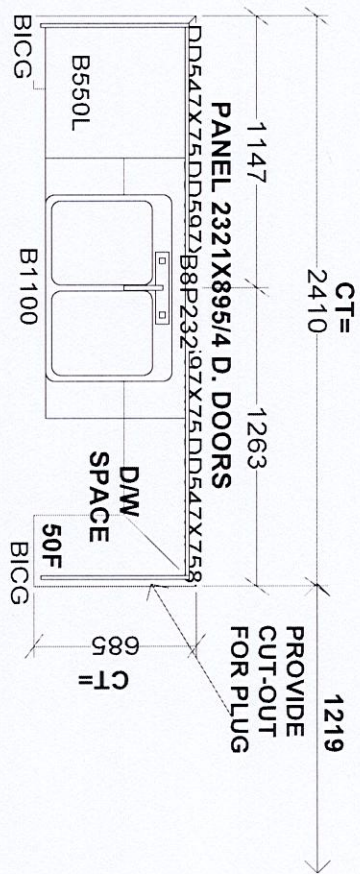

Full Depth
Cupboard
Full Depth
Fridge

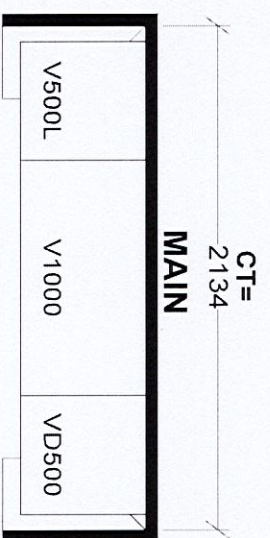
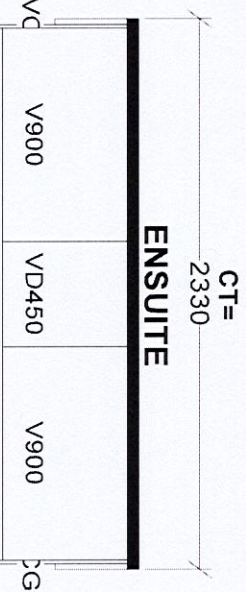
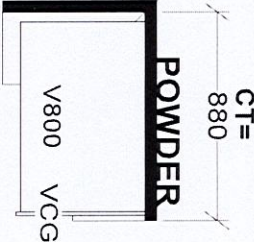
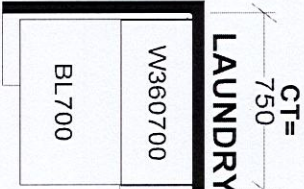
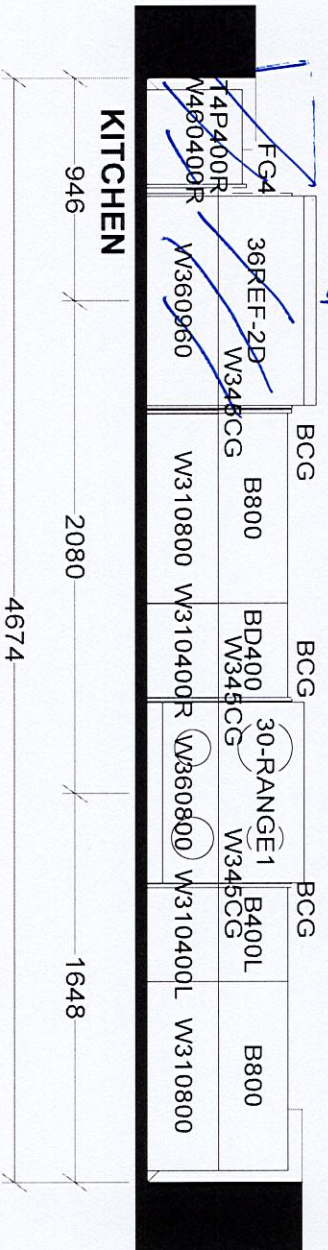

| | | |
|--|----------|------------------|
| Selba Industries | | J# |
| W WDT | W HGT | W CNT |
| This drawing is the intellectual property of SELBA INDUSTRIES INC. and is an original design which must not be released or copied unless applicable fee has been paid or job order placed. | | |
| FLOOR HGT | DOOR HGT | VENT BOX COVER |
| ST CENT | 2X4 | DATE: SEPT 16 22 |
| DESIGNER: KS | | LOT #: |
| SITE: BARLASSINA, Cambridge | | |
| MODEL: CHERRY 1X | | |

BLK 120 THIS Barlassine

HAZEL
GLENN
ARCHITECTS

Cherry 1

ELEVATION 1 - 1,951 sq.ft. • ELEVATION 2 - 1,960 sq.ft.
Includes 14 sq.ft. of open area

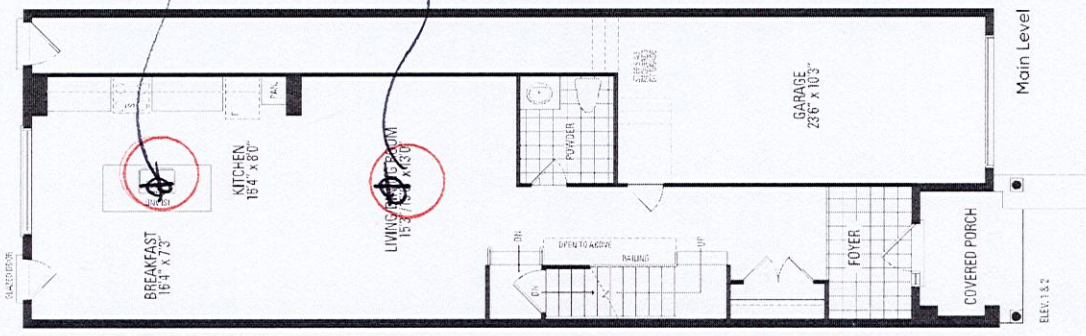

relocate
std kit light
to be centered
over island

Center
std light

★ Add
R.I.

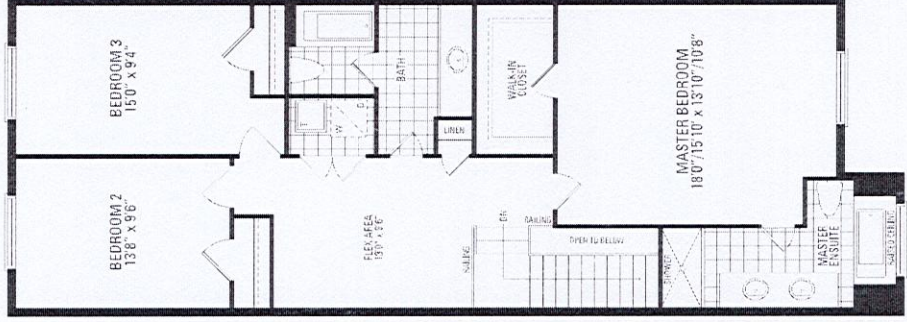

ELEV. 1

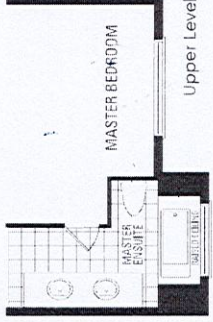

ELEV. 2

Smooth Ceiling 1st floor

Orientation of home may be reversed and purchaser agrees to accept the same. Steps and porches may vary at any exterior entrance ways due to grading variance. Actual usable floor space may vary from the stated floor areas. All renderings are artist's concept. Dimensions, specifications and architectural detailing subject to modifications. Roofline and adjoining model types may vary due to siting. E. & O.E. October 2022