

CONSTRUCTION SUMMARY				
PURCHASERS: Indrea Duvashanie BHOJ and Ryan Robert ROOPCHAND			RECEIVED JUN 26 2023	TEL:
LOT / PHASE Block 120 TH22 / 1	REG. PLAN #	HOUSE TYPE Cherry 1 Elev 1		

CABINETRY ACCESSORIES

1 - KITCHEN CABINETRY - PANTRY UNIT UPGRADE - TO GO FROM 300MM TO 600MM DEEP - PRICE IS PER FOOT - STANDARD LEVEL 22Jun23 Note:	
1 - KITCHEN CABINETRY UPPER - FULL DEPTH ABOVE FRIDGE UPPER WITH GABLES - 650MM DEEP - PRICE IS EACH 22Jun23 Note:	

CERAMIC TILE

1 - GROUT COLOUR - UPGRADE GROUT COLOUR THROUGHOUT - FLAT FEE 22Jun23 Note:	
1 - TILE - UPGRADE 1 FLOOR TILE - Master Ensuite Bathroom - Floor 22Jun23 Note:	
1 - TILE - UPGRADE 1 WALL TILE - Master Ensuite Wall - Shower 22Jun23 Note:	
1 - TILE - UPGRADE 1 WALL TILE - Master Ensuite Tub - Surround 22Jun23 Note:	
1 - TILE - UPGRADE 1 FLOOR TILE - Powder Room 22Jun23 Note:	
1 - DELETE ALL CERAMIC BATHROOM ACCESSORIES - DELETE TOWEL BAR, PAPER HOLDER & SOAP DISH THROUGHOUT 22Jun23 Note:	

DOORS AND TRIM

1 - INTERIOR DOORS - UPGRADE TO CARRARA SMOOTH HALLOW IN LIEU OF STANDARD SERIES - TOWNS 22Jun23 Note:	
---	--

ELECTRICAL

1 - STANDARD DINING ROOM LIGHT TO BE CENTERED BETWEEN LIVING AND DINING ROOM 24Mar23 Note:	
1 - PLUG - ELECTRICAL PLUG WITH GFI AND SWITCH - FOR FESTIVE LIGHTING 24Mar23 Note:	
1 - RELOCATE STANDARD KITCHEN LIGHT TO BE CENTERED OVER ISLAND 24Mar23 Note:	
1 - PLUG - ELECTRICAL PLUG - 5 FEET FROM FINISHED FLOOR FOR FUTURE WALL MOUNTED TV - SEE SKETCH 24Mar23 Note:	

MISCELLANEOUS

1 - GARAGE DOOR OPENER – LIFEMASTER 8155 WITH BELT DRIVE – INLCUDES 1 KEYPAD AND 2 HANDHELD CONTROL - PRICE IS PER GARAGE DOOR 24Mar23 Note:	
---	--

PLUMBING

1 - WASHROOM - 3 PIECE ROUGH-IN IN BASEMENT 24Mar23 Note:	
--	--



<div>CONSTRUCTION SUMMARY</div> <div>Hazel Glenn - Barlassina Construction Inc.</div> <div>PURCHASERS: Indrea Duvashanie BHOJ and Ryan Robert ROOPCHAND<div>TEL:</div></div>				
--	--	--	--	--

LOT / PHASE Block 120 TH22 / 1	REG. PLAN #	HOUSE TYPE Cherry 1 Elev 1		
-----------------------------------	-------------	-------------------------------	--	--

PROMOTIONAL

1 - LESS BALANCE OF CREDIT FROM PURCHASER EXTRA SHEET IN OFFER 22Jun23 Note:	
1 - PARTIAL REDEMPTION OF PROMOTIONAL PACKAGE \$2,845 BALANCE FORWARD \$7,155 TO BE USED AT A LATER DATE. ORIGINAL PROMOTIONAL PACKAGE OF \$10,000 AS PER SCHEDULE PE 24Mar23 Note:	

STAIRS AND RAILINGS

1 - STAINED STAIRS - STANDARD STAIRCASE - INCLUDING EXTRA STEPS TO LOWER LANDING 22Jun23 Note:	
--	--

EXTRAS AS PER OFFER

The Vendor agrees that notwithstanding any other term or provision in this Agreement included in the Purchase Price and in addition to those items detailed in Schedule GP to the Agreement of Purchase and Sale, the Purchaser is entitled to a credit of Ten Worksheet Note:	
--	--

This Document is Extremely Time Sensitive - Printed 22 Jun 23 at 11:10

Purchasers:

Indrea Duvashanie BHOJ & Ryan Robert ROOP

Telephone Res. / Bus:

/

Decor Advisor:

Giulia Di Girolamo

Lock Date:

22-Jun-23

Property:

Block 120 TH22

Project:

Barlassina Construction Inc.

Model and Elevation:

Cherry 1 Elev 1

Plan #:

1. Cabinetry

	Style and Colour	Hardware
Kitchen / Breakfast	MONACO - 350 PLATINUM SILVER	467SA
Laundry Room	ELISSE	Standard
Powder Room	MONACO - 350 PLATINUM SILVER	467SA
Master Ensuite Bathroom	MONACO -823 DRIFTWOOD	467SA
Main Bathroom	MONACO - 350 PLATINUM SILVER	467SA
Stove Opening	STANDARD	NOTE: If not specified, opening will be set to builder's standard opening of approximately 30" width
Fridge Opening	STANDARD	NOTE: If not specified, opening will be set to builder's standard opening of approximately 37" width x 74" height

** Refer to Construction Summary

2. Counters

	Counter	Edge	Niche
Kitchen / Breakfast	LAMINATE-CARRARA BIANCO 6696-46		
Laundry Room	N/A		
Powder Room	LAMINATE-CALCUTTA MARBLE 4925K-07		
Master Ensuite Bathroom	LAMINATE-WHITE CARRARA 4924-38		
Main Bathroom	LAMINATE-CALCUTTA MARBLE 4925K-07		
Kitchen Backsplash	N/A		

** Refer to Construction Summary

Initials:  

Purchasers:

Indrea Duvashanie BHOJ & Ryan Robert ROOPC

Telephone Res. / Bus:

/

Decor Advisor:

Giulia Di Girolamo

Lock Date:

22-Jun-23

Property:

Block 120 TH22

Project:

Barlassina Construction Inc.

Model and Elevation:

Cherry 1 Elev 1

Plan #:

3. Ceramic Flooring

Entrance Vestibule	TILE-FRIGIA WHITE 13X13	At a 45
Main Hall	LAMINATE	
Kitchen / Breakfast	LAMINATE	
Laundry Room	TILE-NEO GREY 12X12	
Powder Room	TILE-AXIS BIANCO 12X24	
Master Ensuite Bathroom	TILE-AXIS LIGHT GREY 12X24	
Main Bathroom	TILE-CONCRETE WHITE 13X13	

** Refer to Construction Summary ** METAL STRIP THRESHOLD WHERE APPLICABLE UNLESS SPECIFIED **

** GROUT #50 TITANIUM THROUGHOUT FIRST AND SECOND FLOOR IN ALL TILED AREAS**

4. Ceramic Wall Tile

Master Ensuite Bathroom	Selection	Describe
Tub Deck Wall	TILE-AXIS LIGHT GREY 12X24	
Shower Stall	TILE-AXIS LIGHT GREY 12X24	
Bathtub Enclosure Walls	N/A	
Main Bathroom	TILE-NEO LTE GREY 8X8	
Kitchen Backsplash	N/A	

** GROUT #50 TITANIUM THROUGHOUT FIRST AND SECOND FLOOR IN ALL TILED AREAS**

5. Trim Carpentry

Interior Doors	CARRARA-SMOOTH
Interior Trim	As Per Construction Specifications

** Refer to Construction Summary

6. Plaster Mouldings and Medallions

Entrance Vestibule			Kitchen/Breakfast		
Main Hall			Den/Library		
Living Room			Lower Landing		
Dining Room					
Family Room					

** Refer to Construction Summary

7. Other Flooring

Main Hall	LAMINATE-LEXINGTON-ROCHEFORT OAK-TL-LW1317
Living Room	LAMINATE-LEXINGTON-ROCHEFORT OAK-TL-LW1317
Dining Room	LAMINATE-LEXINGTON-ROCHEFORT OAK-TL-LW1317
Familly Room	N/A
Den / Library / Study	N/A
Basement Landing(If Applies)	N/A
Lower Landing (If Applies)	LAMINATE-LEXINGTON-ROCHEFORT OAK-TL-LW1317
Upper Landing	LAMINATE-LEXINGTON-ROCHEFORT OAK-TL-LW1317
Upper Hall	CARPET-SPARTACUS-87354 OVERCAST
Master Bedroom	CARPET-SPARTACUS-87354 OVERCAST
Bedroom #2	CARPET-SPARTACUS-87354 OVERCAST
Bedroom #3	CARPET-SPARTACUS-87354 OVERCAST
Bedroom #4	N/A
Bedroom #5	N/A
Flex Area	CARPET-SPARTACUS-87354 OVERCAST
Kitchen/Breakfast	LAMINATE-LEXINGTON-ROCHEFORT OAK-TL-LW1317
Underpad	Standard <input checked="" type="checkbox"/> Upgrade

** Refer to Construction Summary

8. Railings and Pickets

Railing Type	AS PER CONSTRUCTION SPECIFICATIONS	Colour	TORLYS-ROCHEFORT OAK-TL-LW1317
Picket Type	AS PER CONSTRUCTION SPECIFICATIONS	Colour	TORLYS-ROCHEFORT OAK-TL-LW1317
Stringer / Riser	AS PER CONSTRUCTION SPECIFICATIONS	Colour	TORLYS-ROCHEFORT OAK-TL-LW1317
Treads	AS PER CONSTRUCTION SPECIFICATIONS	Colour	TORLYS-ROCHEFORT OAK-TL-LW1317
Red Oak Stairs as Per Vendor's Standard			

** Refer to Construction Summary THE STAIN COLOURS OR FINISH AVAILABLE ON RISERS, TREADS, PICKETS AND RAILS (STAIRCASES), WILL NOT BE AN EXACT MATCH TO PREFINISHED HARDWOOD OR LAMINATE FLOORS.

9. Wall Paint Flat Finish

Main & Upper Hall	22 WARM GREY	Master Bedroom	22 WARM GREY
Living Room	22 WARM GREY	Bedroom #2	22 WARM GREY
Dining Room	22 WARM GREY	Bedroom #3	22 WARM GREY
Kitchen / Breakfast	22 WARM GREY	Bedroom #4	N/A
Family Room	N/A	Bedroom #5	N/A
Powder Room	22 WARM GREY	Master Ensuite	22 WARM GREY
Laundry Room	22 WARM GREY	Main Bathroom	22 WARM GREY
Den/Library	N/A	Flex Area	22 WARM GREY
Trim & Door Paint-Semi Gloss	BIRCH WHITE		

** Refer to Construction Summary

Purchasers:Indrea Duvashanie BHOJ & Ryan Robert ROOPC

Telephone Res. / Bus: /

Decor Advisor:Giulia Di Girolamo

Lock Date:22-Jun-23

Property: Block 120 TH22

Project: Barlassina Construction Inc.

Model and Elevation: Cherry 1 Elev 1

22-Jun-23

Plan #:

10. Fireplace

	Living Room			Family Room			Other Room - Specify		
	Purchased	As Per Plan	N/A	Purchased	As Per Plan	N/A	Purchased	As Per Plan	N/A
Fireplace Type	<input type="radio"/>	<input type="radio"/>	<input checked="" type="radio"/>	<input type="radio"/>	<input type="radio"/>	<input checked="" type="radio"/>	<input type="radio"/>	<input type="radio"/>	<input checked="" type="radio"/>
Mantle Type									
Colour / Stain									
Surround									
Hearth									
** Refer to Construction Summary									

11. Air Conditioning

Air Conditioning	<input type="text" value="NO"/>
Comment	
** Refer to Construction Summary	

12. General Comments

** Refer to Construction Summary

Disclaimers and Notes

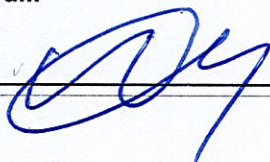
<div>1) Colours of all materials are as close as possible to builder's selection, but not necessarily identical due to variances in manufacturing.</div> <div>2) Any extras listed above are null and void unless accompanied by a separate invoice/amendment. Said invoice must be paid in full.</div> <div>3) The Purchaser agrees that this colour selection is final and that no changes will be permitted, unless required by the Vendor.</div> <div>4) The Purchaser acknowledges reading and accepting document which contains other miscellaneous disclaimers.</div> <div>5) In the event of a conflict between the Standard Features schedule of the Agreement of Purchase and Sale and the Interior Colour Scheme, the Interior Colour Scheme shall prevail.</div>			
Signature: 	Date: 22/06/23	Signature: 	Date: 06/22/23
Page 4 of 4			

HAZEL GLENN
ARCHT

Cherry 1

ELEVATION 1 - 1,951 sq.ft. • ELEVATION 2 - 1,960 sq.ft.
Includes 14 sq.ft. of open area



Signature: J. Glavin

Orientation of home may be reversed and purchaser agrees to accept the same. Steps and porches may vary at any exterior entrance ways due to grading variance. Actual usable floor space may vary from the stated floor areas. All renderings are artist's concept. Dimensions, specifications and architectural detailing subject to modifications. Roofline and adjoining model types may vary due to siting. E. & O.E. October 2022

BLK 120 TH22

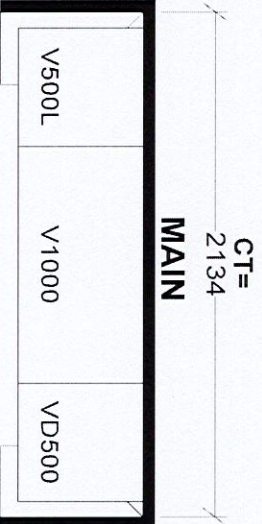
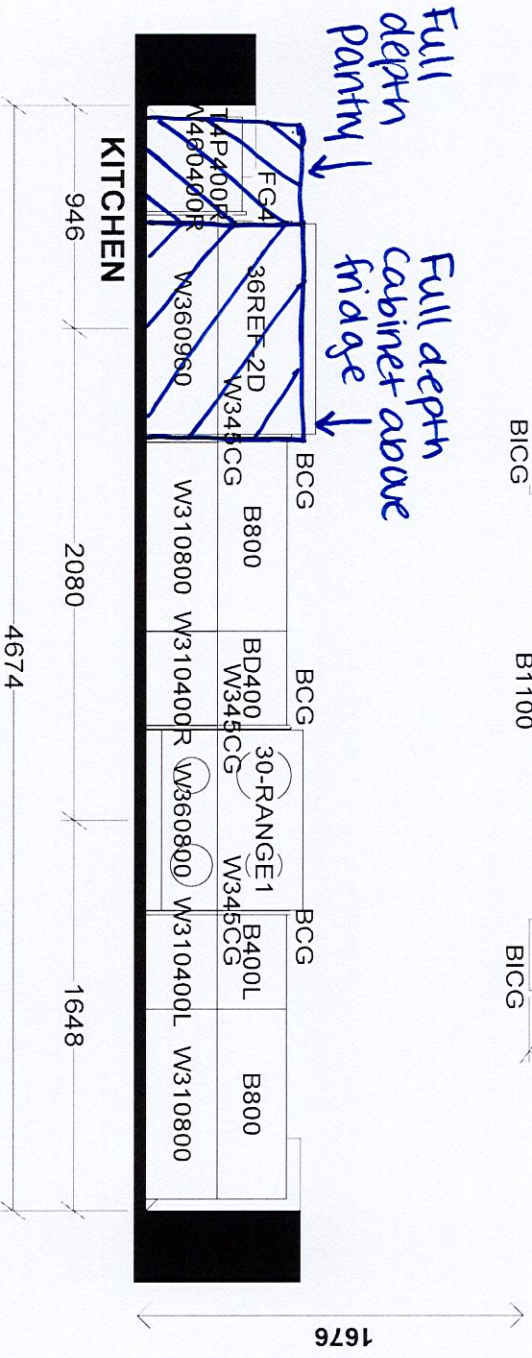
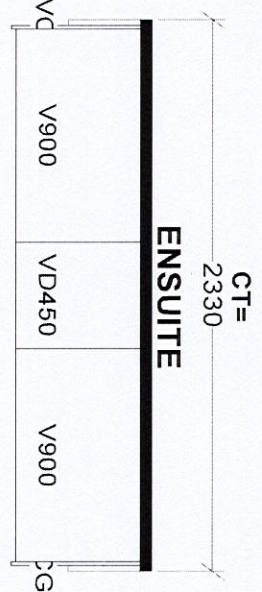
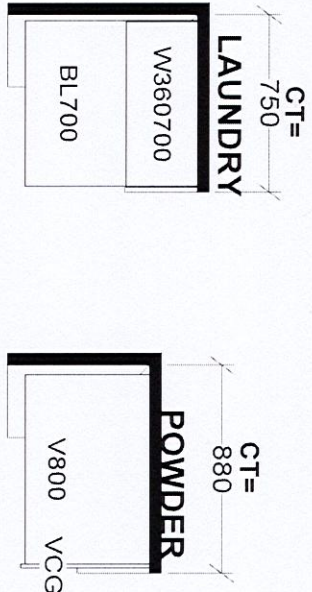
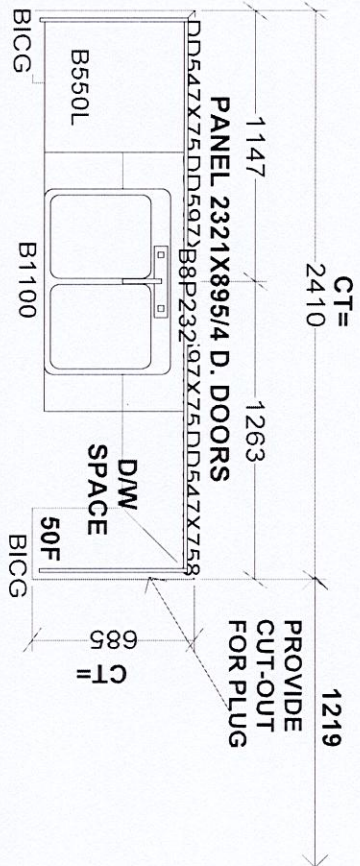

Selba Industries

W WDT _____ W HGHT _____ W CNT _____

FLOOR HGHT _____ DOOR HGHT _____

ST CENT _____ 2X4 _____ VENT BOX COVER _____

DESIGNER: KS DATE: SEPT 16 22

J# _____

LOT #: _____

115