

CONSTRUCTION SUMMARY				
Hazel Glenn - Barlassina Construction Inc.				
PURCHASERS: Adesh CHAWLA and Sonia CHAWLA			TEL: RES.: 416-984-3569	

LOT / PHASE	REG. PLAN #	HOUSE TYPE		
Block 122 TH54 / 1		Willow 3E Elev 1		

CABINETRY

1 - CABINETRY PROVISION - PROVISION FOR PLUG ON ISLAND (PLUG EXTRA ORDERED SEPARATELY)	
11Apr23    Note:	

CONSTRUCTION

1 - SMOOTH CEILINGS - FIRST FLOOR ONLY	
11Apr23    Note:	

ELECTRICAL

1 - PLUG - ELECTRICAL PLUG - 5 FEET FROM FINISHED FLOOR FOR FUTURE WALL MOUNTED TV - SEE SKETCH	
11Apr23    Note: SEE SKETCH FOR LOCATION	
1 - PLUG - ELECTRICAL PLUG - ADD TO ISLAND	
11Apr23    Note:	
1 - LIGHT AND SWITCH - NO FIXTURE INCLUDED - LIVING ROOM	
11Apr23    Note:	
1 - RELOCATE STANDARD KITCHEN LIGHT TO BE CENTERED OVER ISLAND	
11Apr23    Note:	
1 - PLUG - ELECTRICAL PLUG WITH GFI AND SWITCH - FOR FESTIVE LIGHTING	
11Apr23    Note: @COVERED PORCH - SEE SKETCH FOR LOCATION	
1 - ELECTRIC VEHICLE ROUGH-IN PROVISION ONLY FOR FUTURE ELECTRIC CAR (CONDUIT FROM BASEMENT INTO JUNCTION BOX IN GARAGE WITH PULL STRING, NO WIRE)	
11Apr23    Note:	

PLUMBING

1 - TOE TESTER - ADD TOE TESTER TO SHOWER	
11Apr23    Note: MASTER ENSUITE	
1 - WATER LINE FOR FRIDGE - ROUGH-IN ONLY	
11Apr23    Note:	
1 - WASHROOM - 3 PIECE ROUGH-IN IN BASEMENT	
11Apr23    Note:	

PROMOTIONAL

1 - PARTIAL REDEMPTION OF PROMOTIONAL PACKAGE \$6,210.00. BALANCE FORWARD \$3,790.00 TO BE USED AT A LATER DATE. ORIGINAL PROMOTIONAL PACKAGE OF \$10,000.00 AS PER SCHEDULE PE.	
11Apr23    Note:	

This Document is Extremely Time Sensitive - Printed 17 Apr 23 at 15:23



BLK 122 TH54

Willow 3E

ELEVATION 1 - 1,775 sq.ft. ~~ELEVATION 2 - 891 sq.ft.~~ ~~1,765 sq.ft.~~

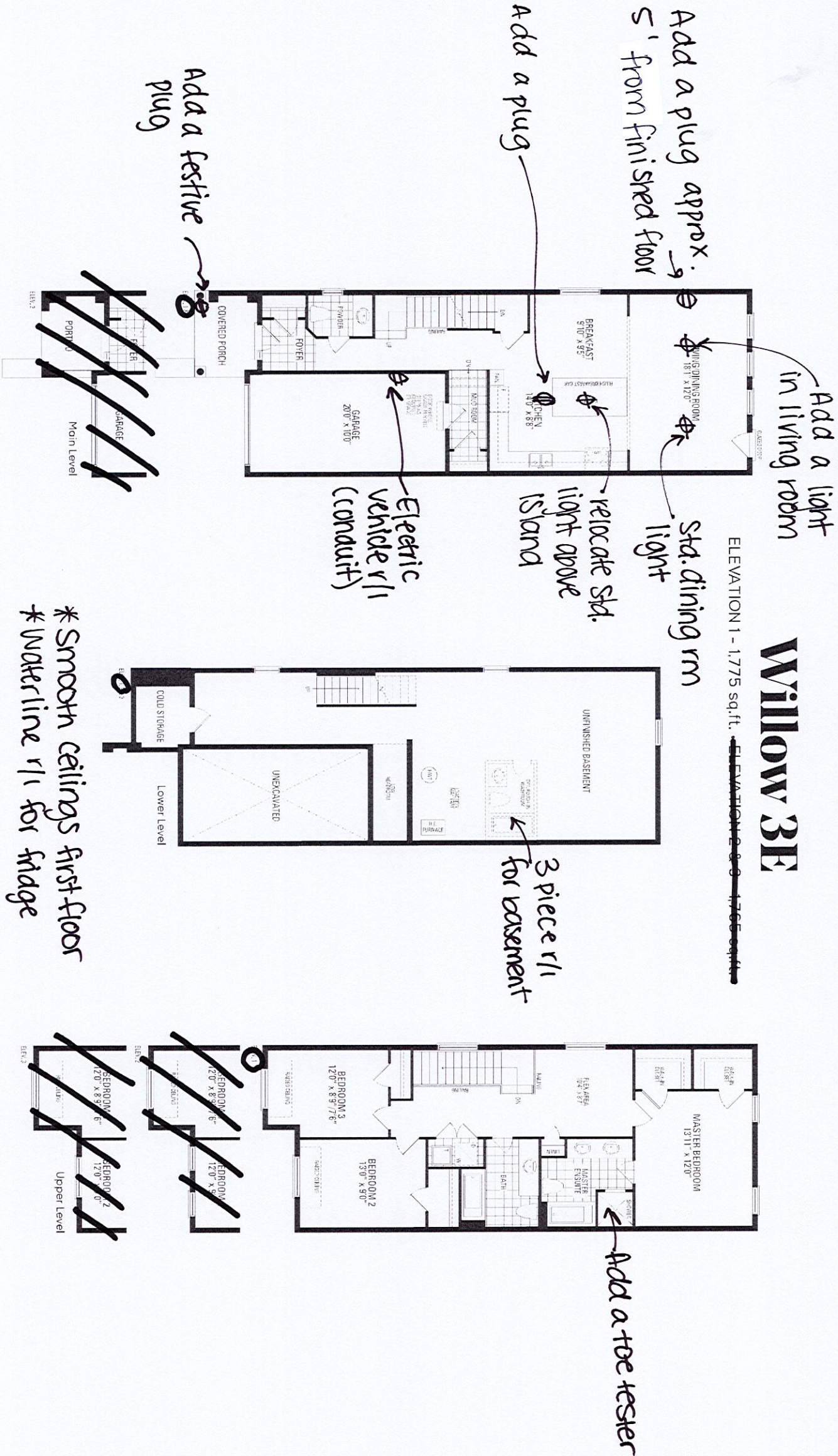

\* Smooth ceilings first floor  
\* Waterline r/i for fridge

Orientation of home may be reversed and purchaser agrees to accept the same. Steps and porches may vary at any exterior entrance ways due to grading variance. Actual usable floor space may vary from the stated floor areas. All renderings are artist's concept. Dimensions, specifications and architectural detailing subject to modifications. Roofline and adjoining model types may vary due to siting. E. & O.E. October 2022