

CONSTRUCTION SUMMARY

Mountainview Heights 3 (G) - Russell Gardens Building Ltd.

RECEIVED

PURCHASER: Aliya ARIZ

JUL 19 2022

TEL:

LOT / PHASE 568 / 4	REG. PLAN # 62M-1266	HOUSE TYPE Springfield Three (4 Bed with Guest Suite) Elev 1		
------------------------	-------------------------	---	--	--

CABINETRY

1 - VANITY - POWDER ROOM - UPGRADE 3 22Jun22 Note:	
GUEST ENSUITE BATHROOM	
1 - KITCHEN CABINETRY - DIFFERENT COLOUR ISLAND - FLAT FEE 22Jun22 Note:	
1 - KITCHEN - LIGHT VALANCE 22Jun22 Note:	
1 - CABINETRY - KITCHEN - UPGRADE 3 22Jun22 Note:	
1 - MASTER ENSUITE- CABINETS REVISED SEE SKETCH ATTACHED 17Jun21 Note:	

CABINETRY ACCESSORIES

1 - KITCHEN - RELOCATE BANK OF DRAWERS TO ISLAND - SEE SKETCH 22Jun22 Note:	
1 - KITCHEN - REDUCE PANTRY TO ACCOMMODATE 48" FRIDGE 22Jun22 Note:	
1 - KITCHEN - REDUCE ISLAND TO MAKE 3 SIDES OF OVERHANG - IN LIEU OF 1 STANDARD OVERHANG 22Jun22 Note:	
1 - KITCHEN HOOD CABINETS - CONTEMPORARY WOOD HOOD – UPGRADE 3 22Jun22 Note: PURCHASER TO SUPPLY AND INSTALL HOOD FAN AFTER CLOSING	
1 - CABINETRY FEE FOR FLUSH CUTOUT ON WALL BUILT-IN OVEN CABINET 22Jun22 Note:	
1 - KITCHEN CABINETRY - BUILT-IN FRIDGE CABINET - PRICE IS EACH 22Jun22 Note:	
1 - KITCHEN CABINETRY UPPER - FULL DEPTH ABOVE FRIDGE - WITH GABLES - 600MM - PRICE IS EACH - UPGRADE 3 22Jun22 Note:	
1 - PANTRY UNIT UPGRADE - TO GO FROM 300MM TO 600MM DEEP - UPGRADE 3 22Jun22 Note:	
1 - KITCHEN CABINETRY BASE - PULLOUT WIRE SPICE RACK 22Jun22 Note:	
2 - KITCHEN CABINETRY UPPER - ANGLED CORNER CABINET - FITS TALL UPPER CABINETS - PER UNIT - UPGRADE 3 22Jun22 Note:	
1 - KITCHEN CABINETRY - BUILT-IN MICROWAVE/OVEN COMBO - UPGRADE 3 22Jun22 Note:	
1 - KITCHEN CABINETRY BASE - COOKTOP CABINET WITH POT DRAWERS (2 DRAWERS) - UPGRADE 3 22Jun22 Note:	
1 - KITCHEN CABINETRY – CM 3 CROWM MOULDING WITH HEADER 22Jun22 Note:	
1 - KITCHEN CABINETRY – MINI STACKED UPPER CABINETS – UPGRADE 3 CABINETRY 22Jun22 Note:	
1 - KITCHEN CABINETRY UPPER - EXTEND STANDARD ELISSE 600 UPPER CABINETRY ABOVE WASHER AND DRYER, EXTEND STANDARD BASE CABINETRY BY APPROX 2' AND ADD SUPPORT FOR GRANITE COUNTERTOP 22Jun22 Note:	

CONSTRUCTION SUMMARY

Mountainview Heights 3 (G) - Russell Gardens Building Ltd.

PURCHASER: Aliya ARIZ

TEL:

LOT / PHASE 568 / 4	REG. PLAN # 62M-1266	HOUSE TYPE Springfield Three (4 Bed with Guest Suite) Elev 1		
------------------------	-------------------------	---	--	--

CERAMIC TILE

1 - DELETE ALL CERAMIC BATHROOM ACCESSORIES - DELETE TOWEL BAR, PAPER HOLDER & SOAP DISH THROUGHOUT 22Jun22 Note:	
1 - TILE - UPGRADE 4 WALL TILE - - OPTIONAL ENSUITE - SHOWER WALLS 22Jun22 Note:	
1 - TILE - UPGRADE 4 FLOOR TILE - - OPTIONAL ENSUITE - FLOOR AREA 22Jun22 Note:	
1 - TILE - UPGRADE 4 FLOOR TILE - - KITCHEN 22Jun22 Note:	
1 - TILE - UPGRADE 4 FLOOR TILE - - FOYER 22Jun22 Note:	
1 - TILE - UPGRADE 4 WALL TILE - - ENSUITE BATHROOM - SHOWER WALLS 22Jun22 Note:	
1 - TILE - UPGRADE 4 FLOOR TILE - - ENSUITE BATHROOM - FLOOR 22Jun22 Note:	
1 - UPGRADE 4 FLOOR TILE- - MAIN HALL 22Jun22 Note:	

CONSTRUCTION

1 - PROVISION FOR SHAMPOO NICHE APPROX. 14" WIDE X 20" HIGH AS PER SKETCH – IF CONSTRUCTION PERMITS - GUEST ENSUITE BATHROOM 22Jun22 Note:	
1 - ADD BASEMENT WALK-UP 23Jun21 Note:	
1 - MASTER ENSUITE- DELETE DOOR AND ADD A KNEE WALL IN FRONT OF TOILET- 17Jun21 Note:	
1 - OAK STAIRS TO BASEMENT FROM MAIN FLOOR-NATURAL FINISH 17Jun21 Note:	
1 - SMOOTH CEILINGS ON FIRST FLOOR ONLY - DET 17Jun21 Note:	

COUNTER TOP

1 - UPGRADE COUNTERTOP MATERIAL Full Height Backsplash - Kitchen 22Jun22 Note:	
1 - UPGRADE COUNTERTOP MATERIAL - Kitchen 22Jun22 Note:	
1 - UPGRADE COUNTERTOP MATERIAL - Opt Powder/Guest 22Jun22 Note:	
1 - UPGRADE COUNTERTOP MATERIAL - Master 22Jun22 Note:	
1 - LAUNDRY ROOM - PROMO GRANITE COUNTERTOP 22Jun22 Note:	
1 - UPGRADE COUNTERTOP MATERIAL - Bdrm 3/4 22Jun22 Note:	
1 - UPGRADE COUNTERTOP MATERIAL - Main 2 22Jun22 Note:	

CONSTRUCTION SUMMARY				
Mountainview Heights 3 (G) - Russell Gardens Building Ltd.				
PURCHASER: Aliya ARIZ				TEL:
LOT / PHASE	REG. PLAN #	HOUSE TYPE		
568 / 4	62M-1266	Springfield Three (4 Bed with Guest Suite) Elev 1		
1 - SHAMPOO NICHE 14" WIDE X 20" HIGH AS PER SKETCH – MARBLE, GRANITE OR QUARTZ – IF CONSTRUCTION PERMITS - REQUIRES PROVISION FROM CONSTRUCTION				
17Jun21 Note: SUPPLY & -FOR GUEST SUITE				

DOORS AND TRIM

1 - DOORS - EXTERIOR GARDEN DOORS (CLEAR GLASS) IN PLACE OF SLIDING DOOR - DOES NOT INCLUDE GRILLS WITH FIXED DOOR PANEL AND SLIDING SCREEN	
06Jul21 Note:	
1 - INSERT-----DOOR - EXTERIOR - FRENCH - CLEAR GLASS - BOTH DOORS ARE OPERABLE - IN LIEU OF SLIDING PATIO DOOR	
06Jul21 Note:	
1 - DOORS - EXTERIOR GARDEN DOORS (CLEAR GLASS) IN PLACE OF SLIDING DOOR - DOES NOT INCLUDE GRILLS WITH FIXED DOOR PANEL AND SLIDING SCREEN	
17Jun21 Note:	

ELECTRICAL

1 - POT LIGHT - LED - FIRST FLOOR INSTALLATION - KITCHEN	
22Jun22 Note:	
1 - FOYER HALL & LIVING/DINING ROOM HALL - DELETE STANDARD LIGHTS TO ACCOMMODATE POTLIGHTS	
22Jun22 Note:	
1 - KITCHEN - DELETE STANDARD LIGHT TO ACCOMMODATE POTLIGHTS	
22Jun22 Note:	
1 - KITCHEN - VALANCE LIGHTING - LED LIGHTING	
22Jun22 Note:	
4 - POT LIGHT - LED - FIRST FLOOR INSTALLATION - INSTALLED ON A SERPERATE SWITCH FROM STANDARD LIGHT - KITCHEN WORKSPACE	
22Jun22 Note: ADD 4 TO MAKE 5 IN TOTAL	
SEE SKETCH FOR POTLIGHT LOCATIONS (5 POTLIGHTS IN TOTAL)	
4 - POT LIGHT - LED - FIRST FLOOR INSTALLATION - INSTALLED ON A SERPERATE SWITCH FROM STANDARD LIGHT - KITCHEN BREAKFAST	
22Jun22 Note:	
5 - POT LIGHT - LED - FIRST FLOOR INSTALLATION - INSTALLED ON A SERPERATE SWITCH FROM STANDARD LIGHT - FAMILY ROOM	
22Jun22 Note: ADD 5 TO MAKE 6 IN TOTAL	
SEE SKETCH FOR APPROXIMATE LOCATION (6 POTLIGHTS IN TOTAL)	
4 - POT LIGHT - LED - FIRST FLOOR INSTALLATION - INSTALLED ON A SERPERATE SWITCH FROM STANDARD LIGHT - GUEST SUITE	
22Jun22 Note:	
3 - POT LIGHT - LED - FIRST FLOOR INSTALLATION - INSTALLED ON A SERPERATE SWITCH FROM STANDARD LIGHT - DINING ROOM	
22Jun22 Note: ADD 3 TO MAKE 4 POTLIGHTS IN TOTAL	
SEE SKETCH FOR POT LIGHT LOCATIONS (4 POTLIGHTS IN TOTAL TO BE INSTALLED)	
4 - POT LIGHT - LED - FIRST FLOOR INSTALLATION - - INSTALLED ON A SERPERATE SWITCH FROM STANDARD LIGHT - LIVING ROOM	
22Jun22 Note:	
4 - POT LIGHT - LED - FIRST FLOOR INSTALLATION - LIVING/DINING ROOM HALL	
22Jun22 Note:	
7 - POT LIGHT - LED - FIRST FLOOR INSTALLATION - INSTALLED ON A SERPERATE SWITCH FROM STANDARD LIGHT - 2 SWITCHES - SEE SKETCH - FOYER	
22Jun22 Note:	
INCLUDES FOYER HALL	
1 - BUILT IN OVEN AND COOKTOP PROVISION - PROVISION ONLY - ELECTRICAL ONLY	
09May22 Note:	
2 - PLUG - ELECTRICAL PLUG - INSTALLED 5' FROM FLOOR - FLEX ROOM & MASTER BEDROOM	
09May22 Note:	

CONSTRUCTION SUMMARY				
Mountainview Heights 3 (G) - Russell Gardens Building Ltd.				TEL:
PURCHASER: Aliya ARIZ				
LOT / PHASE	REG. PLAN #	HOUSE TYPE		
568 / 4	62M-1266	Springfield Three (4 Bed with Guest Suite) Elev 1		
1 - LIGHT - EXTERIOR WITH INTERIOR SWITCH - LEFT SIDE ELEVATION - SEE SKETCH				
09May22 Note:				
1 - LIGHT - EXTERIOR WITH INTERIOR SWITCH - RIGHT SIDE ELEVATION - SEE SKETCH				
09May22 Note:				
1 - FRONT PORCH - RELOCATE STANDARD LIGHT TO SOFFIT - SEE SKETCH - IF CONSTRUCTION PERMITS				
09May22 Note:				
3 - ABOVE KITCHEN ISLAND - ADD LIGHT AND SWITCH - NO FIXTURE INCLUDED				
09May22 Note:				
1 - PLUG - ELECTRICAL PLUG - TO BE INSTALLED OVER FIREPLACE				
09May22 Note:				
1 - POT LIGHT - LED - FIRST FLOOR INSTALLATION - INSTALLED ON SEPERATE SWITCH FROM STANDARD LIGHTS - LIVING/DINING ROOM				
09May22 Note:				
1 - POT LIGHT - LED - FIRST FLOOR INSTALLATION - INSTALLED ON SEPERATE SWITCH FROM STANDARD LIGHTS - LIVING/DINING ROOM				
09May22 Note:				
1 - POT LIGHT - LED - FIRST FLOOR INSTALLATION - INSTALLED ON SEPERATE SWITCH FROM STANDARD LIGHTS - FAMILY ROOM				
09May22 Note:				
1 - POT LIGHT - LED - FIRST FLOOR INSTALLATION - INSTALLED ON SEPERATE SWITCH FROM STANDARD LIGHTS - KITCHEN				
09May22 Note:				
1 - LIGHT AND SWITCH - NO FIXTURE INCLUDED - LIVING ROOM				
09May22 Note:				
1 - PLUG - ELECTRICAL PLUG WITH GFI AND SWITCH - FOR FESTIVE LIGHTING				
17Jun21 Note:				
1 - 200 AMP ELECTRICAL SERVICE				
17Jun21 Note:				
FIREPLACE AND ACCESSORIES				
1 - GAS LINE ROUGH-IN FOR BARBECUE - FIRST FLOOR				
09May22 Note:				
1 - GAS LINE ROUGH-IN FOR STOVE (INCLUDES ELECTRICAL OUTLET) - FIRST FLOOR				
09May22 Note:				
HARDWOOD FLOORING				
1 - HARDWOOD - GROUP B SERIES 5 INCH - IN LIEU OF 2 1/4 INCH NATURAL RED OAK - - LIVING AND DINING ROOM				
22Jun22 Note:				
1 - HARDWOOD - GROUP B SERIES 5 INCH - IN LIEU OF 2 1/4 INCH NATURAL RED OAK - - GUEST SUITE				
22Jun22 Note:				
1 - HARDWOOD - GROUP B SERIES 5 INCH - IN LIEU OF 2 1/4 INCH NATURAL RED OAK - - FAMILY ROOM				
22Jun22 Note:				
MIRRORS AND GLASS				
1 - ALL BATHROOMS - FULL HEIGHT & LENGTH MIRRORS WITH CUT OUTS FOR LIGHTS				
22Jun22 Note:				
2 - FRAMELESS GLASS SHOWER DOOR FOR 5 FOOT PAN - INCLUDES CHROME KNOB & HINGES - ENSUITE 2 & ENSUITE 3/4 BATHROOMS				
09May22 Note:				

CONSTRUCTION SUMMARY				
Mountainview Heights 3 (G) - Russell Gardens Building Ltd.				TEL:
PURCHASER: Aliya ARIZ				
LOT / PHASE	REG. PLAN #	HOUSE TYPE		
568 / 4	62M-1266	Springfield Three (4 Bed with Guest Suite) Elev 1		
1 - MASTER ENSUITE – FRAMELESS GLASS SHOWER ENCLOSURE – INCLUDES CHROME KNOB AND HINGES				
17Jun21 Note:				
1 - GUEST ENSUITE – FRAMELESS GLASS SHOWER ENCLOSURE – INCLUDES CHROME KNOB AND HINGES				
17Jun21 Note: FOR GUEST SUITE				

MISCELLANEOUS

1 - PURCHASER DELIVERS HERewith A FURTHER DEPOSIT OF \$15,518.00 PAID BY VISA AND TO BE APPLIED TO THE BALANCE OF PE# 27104	
04Jul22 Note:	

PLASTER MOULDINGS

1 - CORNICE MOULDING - - FAMILY ROOM	
22Jun22 Note:	
1 - CORNICE MOULDING - - MAIN HALL	
22Jun22 Note:	
1 - CORNICE MOULDING - - LIVING AND DINING ROOM	
22Jun22 Note:	
1 - CORNICE MOULDING - - FOYER	
22Jun22 Note:	

PLUMBING

3 - MOEN 90 DEGREE POSI-TEMP TUB/SHOWER FAUCET WITH LARGE SQUARE SHOWERHEAD – CHROME #TS2711EP/62320/151380/S1004EP/14572/S3896 - ENSUITE 2, ESNUITE 3/4 & GUEST ENSUITE BATHROOMS	
22Jun22 Note:	
1 - MOEN 90 DEGREE POSI-TEMP TUB/SHOWER FAUCET WITH 3 FUNCTION TRANSFER VALVE/TRIM AND SLIDE BAR WITH HAND SHOWER – CHROME #TS2713EP/U361CI/UTS4172/62320/S3879EP/A721 - MASTER ENSUITE BATHROOM	
22Jun22 Note:	
1 - SINK - UNDERMOUNT SINK - CONTRAC EMERY #4220CGY - GUEST BATHROOM	
22Jun22 Note:	
4 - SINK - UNDERMOUNT SINK - TECO BATH #4815 - ENSUITE2, ENSUITE 3/4 & MASTER ENSUITE BATHROOMS	
22Jun22 Note:	
4 - MOEN BATHROOM ACCESSORIES - MASON CHROME - TOWEL BAR 24" #YB8094/YB8000 - ALL BATHROOMS	
22Jun22 Note:	
4 - MOEN BATHROOM ACCESSORIES - MASON CHROME - PAPER HOLDER #YB8099/YB8000 - ALL BATHROOMS	
22Jun22 Note:	
1 - SOAP DISPENSER - CHROME FINISH - MOEN S3946C - KITCHEN	
22Jun22 Note:	
1 - SINK - UNDERMOUNT SINK - BLANCO QUATRUS R15 U SUPER SINGLE #401518 - KITCHEN	
22Jun22 Note:	
1 - KITCHEN - ISLAND - DELETE STANDARD BAR SINK - DO NOT INSTALL AS PER PURCHASERS REQUEST - INSTALL ROUGH-IN PLUMBING ONLY	
22Jun22 Note:	
1 - LAUNDRY ROOM - TECO 205 UNDERMOUNT SINK	
22Jun22 Note:	
1 - GARAGE- RELOCATE STANDARD HOSE BIB AS PER SKETCH - IF CONSTRUCTION PERMITS	
09May22 Note:	
2 - HOSE BIB - EXTERIOR FROST FREE - FRONT & REAR ELEVATION	
09May22 Note:	

CONSTRUCTION SUMMARY				
Mountainview Heights 3 (G) - Russell Gardens Building Ltd.				TEL:
PURCHASER: Aliya ARIZ				
LOT / PHASE	REG. PLAN #	HOUSE TYPE		
568 / 4	62M-1266	Springfield Three (4 Bed with Guest Suite) Elev 1		
2 - TOE TESTER - ADD TOE TESTER TO SHOWER - ENSUITE 2 & ENSUITE 3/4 BATHROOM				
09May22 Note:				
1 - WATER LINE FOR FRIDGE - ROUGH-IN ONLY				
17Jun21 Note:				
1 - 5 FOOT SHOWER WITH SLIDING GLASS CHROME DOORS IN LIEU OF TUB				
Ensuite 3/4				
17Jun21 Note:				
2 - TOE TESTER - ADD TOE TESTER TO SHOWER				
17Jun21 Note: MASTER ENSUITE AND GUEST SUITE				

PROMOTIONAL

1 - LESS CREDIT FROM PURCHASER EXTRA SHEET IN OFFER	
17Jun21 Note:	

STAIRS AND RAILINGS

1 - STAINED STAIRS – STANDARD STAIRCASE - MAIN FLOOR TO BASEMENT	
22Jun22 Note:	
1 - STAIRCASE - V GROOVE HANDRAIL	
22Jun22 Note:	
1 - STAIRCASE - EUROLINE I IRON PICKETS - BLACK	
22Jun22 Note:	
1 - STAINED STAIRS – STANDARD STAIRCASE - PRICE IS PER SET	
22Jun22 Note:	

EXTRAS AS PER OFFER

(1) The Vendor agrees that notwithstanding any other term or provision in this Agreement included in the Purchase Price and in addition to those items detailed in Schedule GP to the Agreement of Purchase and Sale, the Purchaser is entitled to a credit of	
Worksheet Note:	
Purchase Price includes 3 enlarged basement windows, and the obligation to construct the house with the enlarged basement windows is subject to the Vendors approval, in its sole and unfettered discretion The Purchaser acknowledges and agrees that the loc	
Worksheet Note:	
10 foot ceiling height on Main Level. The Purchaser acknowledges that as a result of the increased ceiling height from the Vendor?s standard ceiling height, various modifications to the interior and exterior of the dwelling unit may be made, including bu	
Worksheet Note:	
PURCHASER(S) ACKNOWLEDGES THAT THE PURCHASE PRICE IS INCLUSIVE OF ALL CREDITS AND PROMOTIONAL PACKAGES AVAILABLE AT TIME OF PURCHASE.	
Worksheet Note:	
Granite kitchen counter top, from Vendor?s standard samples	
Worksheet Note:	

This Document is Extremely Time Sensitive - Printed 18 Jul 22 at 15:31

Odd Plug
Above fireplace

Has Line
R.1 for ~~BBQ~~

Free nah
DOORS

Shampoo Niche

5 Potlights

3 POTS

BREAKFAST

FAMILY ROOM

KITCHEN

BREAKFAST

FAMILY ROOM

KITCHEN

LIVING/DINING ROOM

-4 Potlights

GARAGE
19'8" x 18'6"

Relocate Std
Hose Bib

- 10' Ceiling.
- Smooth Ceilings

Install Std. Light
On Soffit

Festive
Hug

OPTIONAL GUEST SUITE

SUNKEN LIBRARY
HOME OFFICE
110" x 10'8"

PORTICO

~~SUNKEN LIBRARY
HOME OFFICE
11'0" x 10'8"~~

PORTICO

MAIN LEVEL

Orientation of home may be reversed and purchaser agrees to accept same. Steps and porches may vary stated floor areas. All renderings are artist's concept. Dimensions, specifications and architectural details:



Add Plug
5' from floor

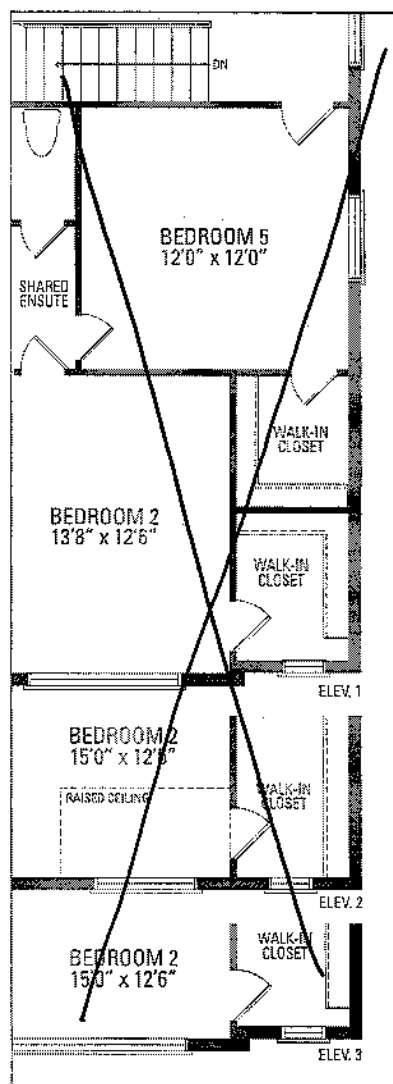

OPTIONAL 5 BEDROOM

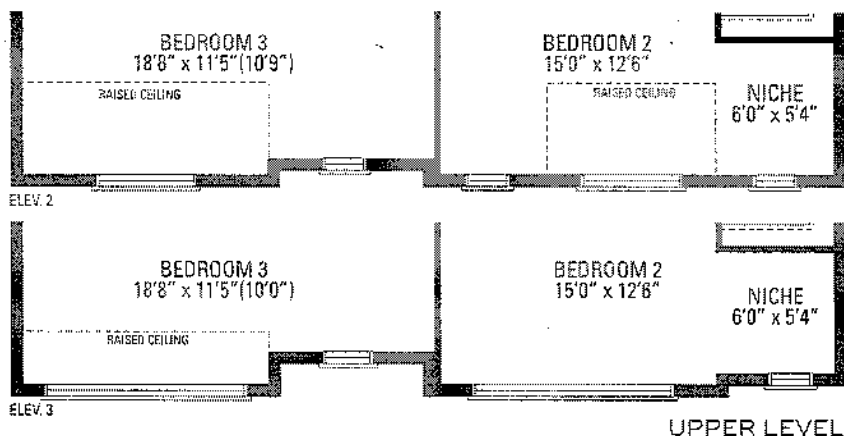

UPPER LEVEL

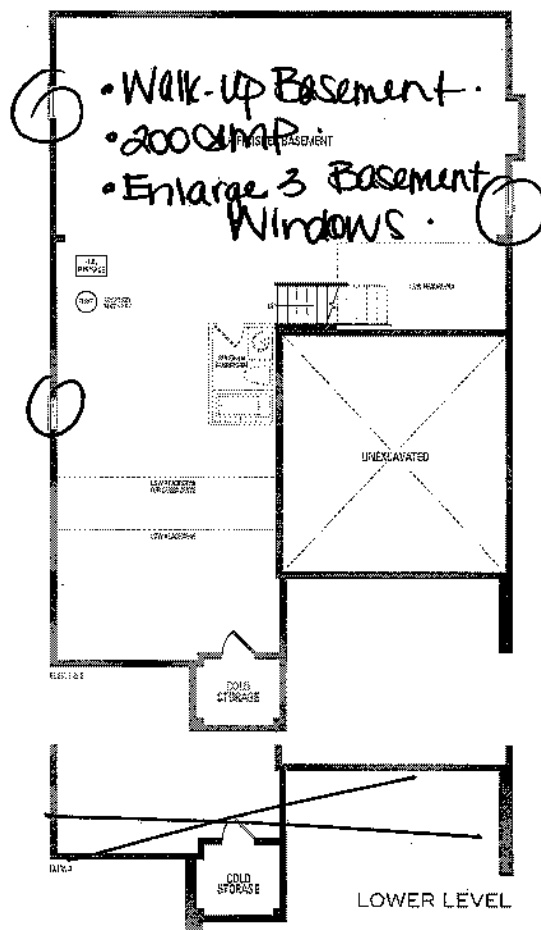

5 sq.ft. | ELEV. 2 • 3,744 sq.ft. | ELEV. 3 • 3,720 sq.ft.

at any exterior entrance ways due to grading variance. Actual usable floor space may vary from the
subject to modifications. Roofline and adjoining model types may vary due to siting. E. & O.E May 2021



568
RUSSELL GARDENS
PHASE 4
MOUNTAINVIEW HEIGHTS

SPRINGFIELD 3
ELEV. 1

- REVISIONS:
1. REPLACE 42X42 SHOWER WITH 60X36 SHOWER BASE. FLIP SEAT AND MAKE FRAMELESS GLASS. SHORTEN VANITY TO EXPOSE SHOWER FRONT.
-

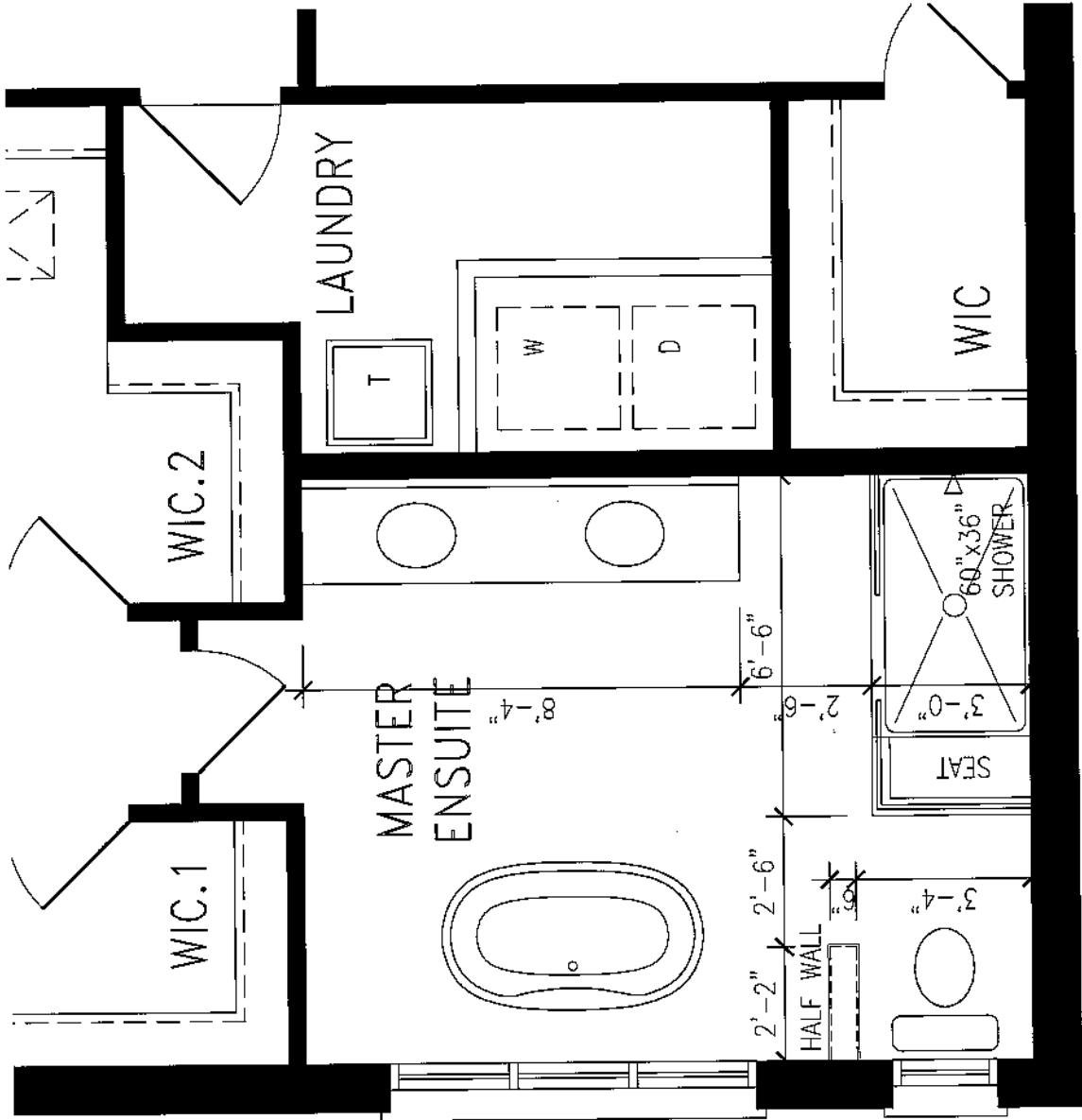

UPPER LEVEL

DISCLAIMERS: SKETCH NOT TO SCALE. DIMENSIONS, SPECIFICATIONS AND ARCHITECTURAL DETAILS SUBJECT TO MODIFICATION BY THE VENDOR. SKETCH IS ONLY FOR THE PURPOSE OF ILLUSTRATING REVISIONS REQUESTED BY THE PURCHASER AND ALL REVISIONS ARE SUBJECT TO VENDOR'S FINAL APPROVAL. ONLY REVISIONS ACCEPTED IN WRITING BY THE PURCHASER AND VENDOR ON A PURCHASER'S EXTRA SHEET WILL BE INCORPORATED INTO THE PLANS FILED WITH THE MUNICIPALITY. E. & O.E.

REGION
DESIGN
INC.

SCALE
BY
MIB

N.T.S.
PAGE NO.
1 OF 1



Kitchen

- Under Angled
Cabinet
Joiner

POOH POOM
POOH POOM

under angled
corner
cabinet

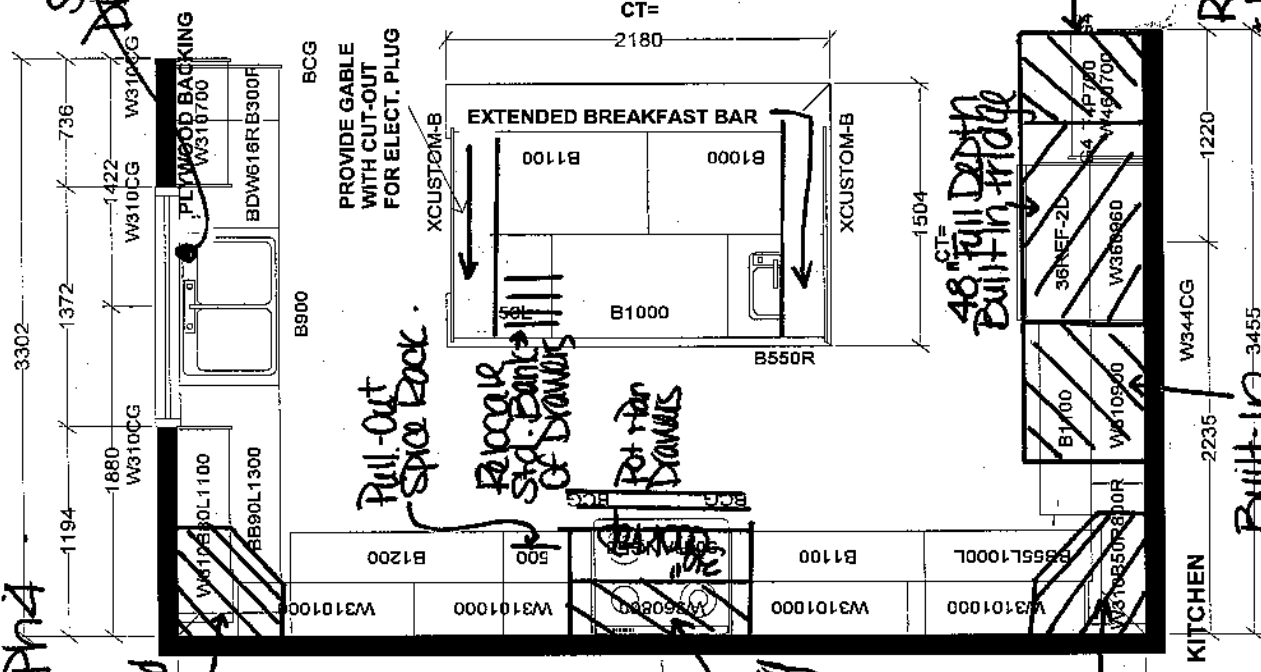

2235 — W344CG — 1220 —

Built-in 3455
microwave
Freezer

Reduce
* make
Pantry
Full Depth
(84" Deep).

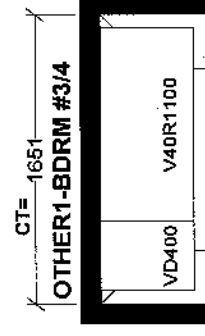
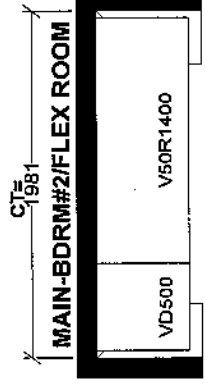
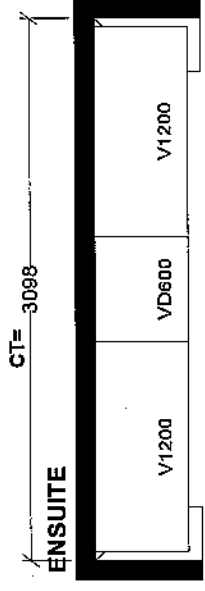
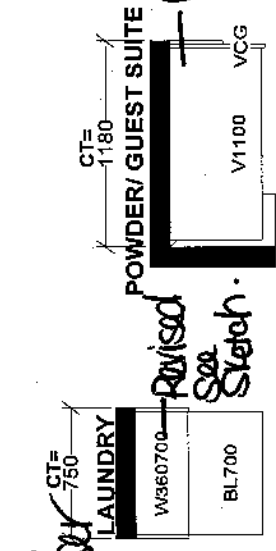

Selba Industries				J #
W WIDTH	W HGT	W CNT	JOB NUMBER: _____ THIS DRAWING IS THE INTELLECTUAL PROPERTY OF SELBA INDUSTRIES INC. AND IS AN ORIGINAL DESIGN. NO PARTS MAY BE REPRODUCED OR COPIED WITHOUT THE WRITTEN PERMISSION OF SELBA INDUSTRIES INC.	
FLOOR HGT	DOOR HGT		BUILDER: GREENPARK SITE: RUSSELL GARDENS PH.4 MODEL: SPRINGFIELD 3X 4&5 BD+OPT GR FLR EL 1,2,3	
ST CNT	2X4	VENT BOX COVER	DESIGNER: LR	LOT #:
			DATE: APR 28 21	

Lot 568 - Russell Gardens - Ph. 1
Laundry Room

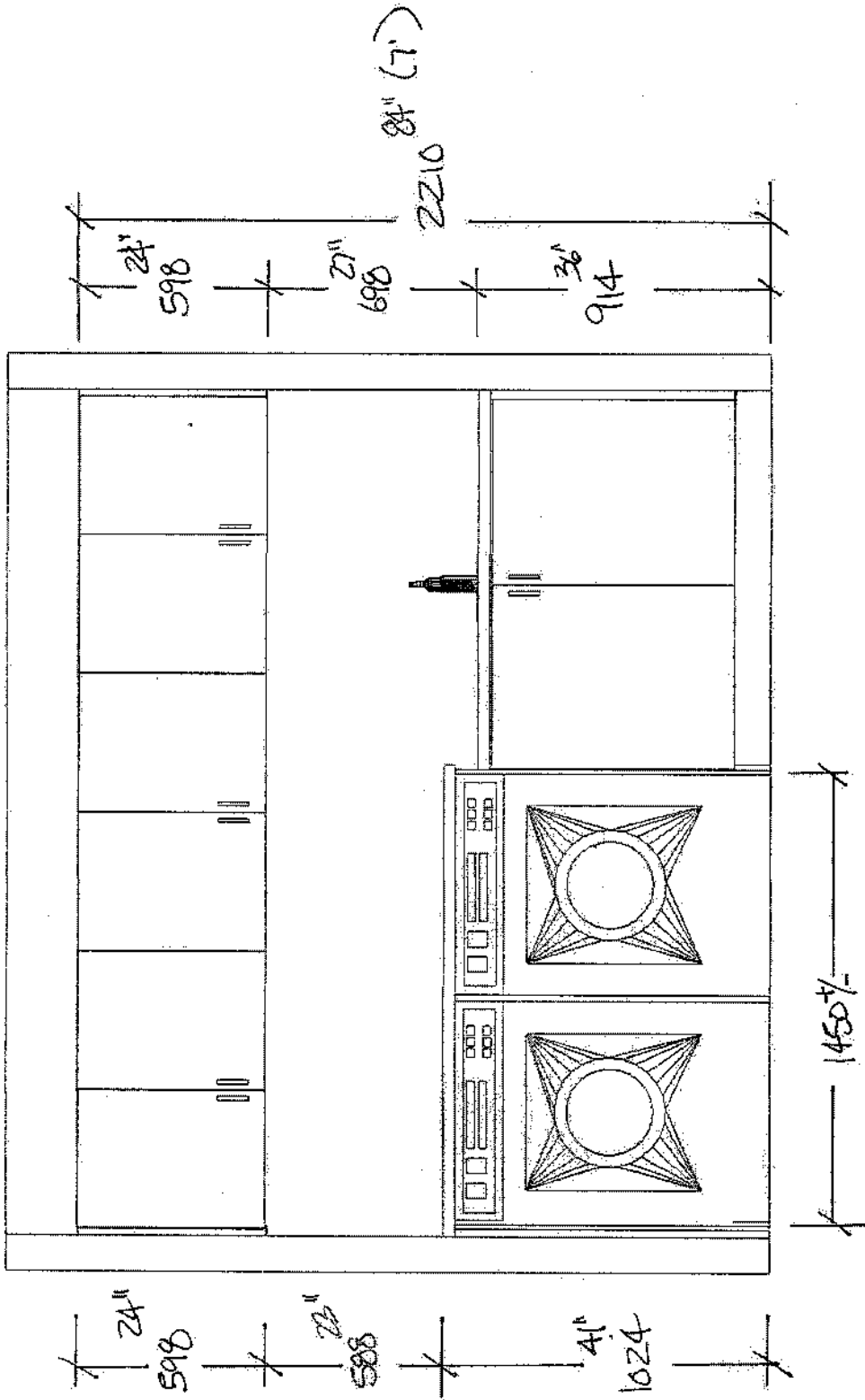

This drawing is the intellectual property of SELBA INDUSTRIES INC. and is an artistic interpretation of the general appearance of the design. It is not meant to be an exact rendition.	2020 TECHNOLOGIES	Designed: 5/9/2022 Printed: 5/9/2022
RUSSELL GARDENS 568	LAYOUT	Drawing #: 1

Purchaser: Aliya ARIZ

Property: 568

Telephone Res. / Bus: /

Project: Russell Gardens Building Ltd.

Decor Advisor: Candace Forza

Model and Elevation: Springfield Three (4 Bed with Guest Suite)

Lock Date: 22-Jun-22

22-Jun-22

Plan #: 62M-1266

Layout Changes: ☒ Yes ☐ No

Sketch Attached: ☒ Yes ☐ No

Exterior Colour Scheme:

1. Cabinetry

	Style and Colour	Hardware
Kitchen / Breakfast	PERIMETER-LEGACY 614 CRISP WHITE***ISLAND-LEGACY 701 PEWTER	468SA
Laundry Room	ELISSE	464SA
Powder Room	N/A	N/A
Master Ensuite Bathroom	MONACO 823 DRIFT WOOD	468SA
Ensuite Bath - Bedroom 2	SABRA 823 DRIFT WOOD	468SA
Ensuite Bath - Bedroom 3/4	DORAL W-500	464SA
GUEST ENSUITE BATH	LEGACY 682 VICTORIAN LACE	225SA
	N/A	N/A
	N/A	N/A

Appliances:

Built In Appliances ☒ Yes ☐ No

Slide In Stove ☐ Yes ☒ No

Dishwasher Cabinet

☐ Closed ☒ Open

41" Upper Cabinets ☒ Yes ☐ No

Please NOTE: Standard Cabinet Height is 30"

Stove Opening

NOTE: If not specified, opening will be set to builder's standard opening of approximately 30" width

Fridge Opening

NOTE: If not specified, opening will be set to builder's standard opening of approximately 37" width x 74" height

** Refer to Construction Summary

2. Counters

	Counter	Edge
Kitchen / Breakfast	QUARTZ-TRAMONTANA	#360
Laundry Room	GRANITE-MISTY NIGHT	#360
Powder Room	N/A	
Master Ensuite Bathroom	QUARTZ-TRAMONTANA	#360
Ensuite Bath - Bedroom 2	QUARTZ-VICTORIA	#360
Ensuite Bath - Bedroom 3/4	MARBLE-NERO MARQUINA	#360
GUEST ENSUITE BATH	MARBLE-SILVER WAVE	#360
	N/A	
	N/A	

** Refer to Construction Summary

3. Ceramic Flooring

At a 45° Threshold-If App.

Entrance Vestibule	TILE-DOZZA WHITE-24X24	<input type="checkbox"/>	metal strip where applicable
Main Hall	TILE-DOZZA WHITE-24X24	<input type="checkbox"/>	
Kitchen / Breakfast	TILE-DOZZA WHITE-24X24	<input type="checkbox"/>	
Laundry Room	TILE-CONCEPT 599 WHITE-13X13	<input type="checkbox"/>	
Powder Room	N/A	<input type="checkbox"/>	
Master Ensuite Bathroom	TILE-NANTES WHITE POLISHED-24X24	<input type="checkbox"/>	
Ensuite Bath - Bedroom 2	TILE-CONCEPT 599 WHITE-13X13	<input type="checkbox"/>	
Ensuite Bath - Bedroom 3/4	TILE-CONCEPT 599 WHITE-13X13	<input type="checkbox"/>	
MUD ROOM	TILE-COLOURS WHITE-13X13	<input type="checkbox"/>	
GUEST ENSUITE BATH	TILE-DOZZA WHITE-24X24	<input type="checkbox"/>	
	N/A	<input type="checkbox"/>	

** Refer to Construction Summary

4. Ceramic Wall Tile

Master Ensuite Bathroom	Selection	Describe
Tub Deck Wall	N/A	
Tub Deck	N/A	
Tub Deck Skirt	N/A	
Shower Stall	TILE-NANTES WHITE POLISHED-24X24	
Bathtub Enclosure Walls	N/A	
Ensuite Bath - Bedroom 2	TILE-SILVIA WHITE-8X16	
Ensuite Bath - Bedroom 3/4	TILE-SILVIA WHITE-8X16	
MUD ROOM	N/A	
GUEST ENSUITE BATH	TILE-DOZZA WHITE-24X24	SHAMPOO NICHE-MARBLE SILVER WAVE
	N/A	
Kitchen Backsplash	QUARTZ-TRAMONTANA	FULL HEIGHT

** Refer to Construction Summary - STANDARD GROUT THROUGHOUT UNLESS SPECIFIED

5. Plumbing Fixtures

All Bathrooms

White

N/A

N/A

N/A

N/A

N/A

Whirlpool

N/A

☐ Yes

☒ No

Dishwasher Rough-In

☒ Yes

☐ No

Waterline for Fridge

☒ Yes

☐ No

** Refer to Construction Summary

6. Trim Carpentry

Interior Doors	CARRARA-SMOOTH
Interior Trim	As Per Construction Specifications
Door Handles	As Per Construction Specifications
Exterior Front Door Handle	As Per Construction Specifications

** Refer to Construction Summary

Purchaser: Aliya ARIZ

Telephone Res. / Bus: /

Decor Advisor: Candace Forza

Lock Date: 22-Jun-22

Property: 568

Project: Russell Gardens Building Ltd.

Model and Elevation: Springfield Three (4 Bed with Guest Suite)

Plan #: 62M-1266

7. Other Flooring

Main Hall	STRIP-VINTAGE-NSS-CHARACTER-PEARL-WHITE OAK-BAUHAUS-5"	
Living Room	STRIP-VINTAGE-NSS-CHARACTER-PEARL-WHITE OAK-BAUHAUS-5"	
Dining Room	STRIP-VINTAGE-NSS-CHARACTER-PEARL-WHITE OAK-BAUHAUS-5"	
Family Room	STRIP-VINTAGE-NSS-CHARACTER-PEARL-WHITE OAK-BAUHAUS-5"	
Den / Library / Study	N/A	
Basement Landing(If Applies)	N/A	
Lower Landing (If Applies)	N/A	
Upper Landing	N/A	
Upper Hall	LAMINATE-LEXINGTON-W-WALCOURT HICKORY-TL-LW1315-PEFC	
Master Bedroom	LAMINATE-LEXINGTON-W-WALCOURT HICKORY-TL-LW1315-PEFC	
Bedroom #2	LAMINATE-LEXINGTON-W-WALCOURT HICKORY-TL-LW1315-PEFC	
Bedroom #3	LAMINATE-LEXINGTON-W-WALCOURT HICKORY-TL-LW1315-PEFC	
Bedroom #4	LAMINATE-LEXINGTON-W-WALCOURT HICKORY-TL-LW1315-PEFC	
Bedroom #5	N/A	
GUEST SUITE	STRIP-VINTAGE-NSS-CHARACTER-PEARL-WHITE OAK-BAUHAUS-5"	
FLEX ROOM	LAMINATE-LEXINGTON-W-WALCOURT HICKORY-TL-LW1315-PEFC	
	N/A	
Underpad	Type	Area
	N/A	N/A

** Refer to Construction Summary

8. Railings and Pickets

Railing Type	V-GROOVE	Complimenting Colour	VINTAGE BAUHAUS WHITE OAK
Picket Type	EUROLINE 1	Complimenting Colour	BLACK
Stringer / Riser	AS PER CONSTRUCTION SPECIFICATIO	Complimenting Colour	VINTAGE BAUHAUS WHITE OAK
Treads	AS PER CONSTRUCTION SPECIFICATIO	Complimenting Colour	VINTAGE BAUHAUS WHITE OAK

Red Oak Stairs ☒ Yes ☐ No

STAIN STAIRCASE TO BASEMENT - VINTAGE BAUHAUS WHITE OAK ** Refer to Construction Summary THE STAIN COLOURS OR FINISH AVAILABLE ON RISERS, TREADS, PICKETS AND RAILS (STAIRCASES), WILL NOT BE AN EXACT MATCH TO PREFINISHED HARDWOOD OR LAMINATE FLOORS.

9. Wall Paint Flat Finish

Main & Upper Hall	22 WARM GREY	Master Bedroom	22 WARM GREY
Living Room	22 WARM GREY	Bedroom #2	22 WARM GREY
Dining Room	22 WARM GREY	Bedroom #3	22 WARM GREY
Kitchen / Breakfast	22 WARM GREY	Bedroom #4	22 WARM GREY
Family Room	22 WARM GREY	Bedroom #5	N/A
Powder Room	N/A	Master Ensuite	22 WARM GREY
Laundry Room	22 WARM GREY	Ensuite Bath - Bedroom 2	22 WARM GREY
Den/Library	N/A	Ensuite Bath - Bedroom 3/4	22 WARM GREY
Trim & Door Paint-Semi Gloss	BIRCH WHITE	FLEX ROOM	22 WARM GREY
		GUEST SUITE	22 WARM GREY
		GUEST ENSUITE BATH	22 WARM GREY

Smooth Ceilings First Floor ☒ Yes ☐ No

** Refer to Construction Summary

Purchaser: Aliya ARIZ

Property: 568

Telephone Res. / Bus: /

Project: Russell Gardens Building Ltd.

Decor Advisor: Candace Forza

Model and Elevation: Springfield Three (4 Bed with Guest Suite)

Lock Date: 22-Jun-22

22-Jun-22

Plan #: 62M-1266

10. Plaster Mouldings and Medallions

Entrance Vestibule	UP814	N/A	Kitchen/Breakfast	N/A	N/A
Main Hall	UP814	N/A	Den/Library	N/A	N/A
Living Room	UP814	N/A	Lower Landing	N/A	N/A
Dining Room	UP814	N/A		N/A	N/A
Family Room	UP814	N/A			

** Refer to Construction Summary

11. Fireplace

Living Room			Family Room			Other Room - Specify		
Purchased	As Per Plan	N/A	Purchased	As Per Plan	N/A	Purchased	As Per Plan	N/A
<input type="radio"/>	<input type="radio"/>	<input checked="" type="radio"/>	<input type="radio"/>	<input checked="" type="radio"/>	<input type="radio"/>	<input type="radio"/>	<input type="radio"/>	<input checked="" type="radio"/>
Fireplace Type	N/A		FLAT ON WALL			N/A		
Mantle Type	N/A		MANTLE M2-STANDARD			N/A		
Colour / Stain	N/A		AS PER CONSTRUCTION SPECIFICATIONS			N/A		
Surround	N/A		NERO			N/A		
Hearth	N/A		NO			N/A		

** Refer to Construction Summary

12. Heating and Air Conditioning

Air Conditioning NO

Gas Provisions Stove YES

Gas Provisions Dryer NO

Gas Provisions Barbecue YES

Comment

** Refer to Construction Summary

13. Electrical

Plugs and Switches	<input checked="" type="radio"/> White	DECOR	Above Kitchen Cabinet Light <input type="radio"/> Yes <input checked="" type="radio"/> No	
Hood Fan	STANDARD WHITE		Below Kitchen Cabinet Light <input checked="" type="radio"/> Yes <input type="radio"/> No	
Appliances	Built in Cooktop		Gas Stove	
	<input checked="" type="radio"/> Yes <input type="radio"/> No	Built in Oven <input checked="" type="radio"/> Yes <input type="radio"/> No	Microwave <input checked="" type="radio"/> Yes <input type="radio"/> No	
Dishwasher Rough-in	Yes			

** Refer to Construction Summary

14. General Comments

** Refer to Construction Summary

Disclaimers and Notes

- Colours of all materials are as close as possible to builder's selection, but not necessarily identical due to variances in manufacturing.
- Any extras listed above are null and void unless accompanied by a separate invoice/amendment. Said invoice must be paid in full.
- The Purchaser agrees that this colour selection is final and that no changes will be permitted, unless required by the Vendor.
- The Purchaser acknowledges reading and accepting document which contains other miscellaneous disclaimers.
- In the event of a conflict between the Standard Features schedule of the Agreement of Purchase and Sale and the Interior Colour Scheme, the Interior Colour Scheme shall prevail.

Signature: 

Date: 22-Jun-22

VCIN36GWS
36-INCH CUSTOM INSERT
PROFESSIONAL® SERIES

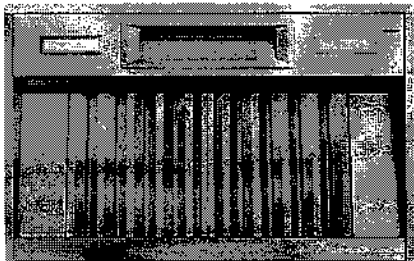

FEATURES & BENEFITS

- Revel in creative freedom with Professional® Series custom inserts that can blend in with cabinetry or make a bold statement
- ★ Equipped with the Thermador Connected Experience by Home Connect™
- Powerfully Quiet® system accepts integral, inline, and remote blowers
- Beautiful illumination with multi-level, vivid LED lights
- Features automatic mode, delay shut-off, and check filter light

ACCESSORIES (OPTIONAL)

25 ft. Blower Connector Cable - EXTNCB25W
For use with the following inline and remote blowers: VTR1FZ, VTR2FZ, VT11FZ, VT12FZ

Roofplates
RFPLT600P - For use with 600 CFM remote blower VTR1FZ
RFPLT1000P - For use with 1000 CFM remote blower VTR2FZ

VCIN Trim Notes
NOTE: VCIN_GWS series custom insert models include hood trim pieces to complete the installation.

Remote Control Panel
REMCPW - Ability to vertically install on cabinetry or wall to control hood in a convenient location



GENERAL PROPERTIES

Features	
Multi-Level LED Lights with Fading Transitions, Automatic Mode, Check Filter Reminder Light, Delay Shut-Off	
Operating Mode	Ducted
Maximum CFM	Blower Sold Separately
Number of Speed Settings	4-Stage
Number of Lights	2
Bulb Type	LED
Light Lumens	100 – 150
Light Color	3500 – 4000 °K
Total Power of the Lamps	2.4 W
Damper Included	Yes
Grease Filter Material	Aluminum*
Grease Filter Type	Commercial Style Baffle Filter
Home Connect™ (Wi-Fi Enabled)	Yes

TECHNICAL DETAILS

Watts	See Chart on Page 3
Current	See Chart on Page 3
Volts	120 V
Frequency	60 Hz
Plug Type	Fixed Connection

DIMENSIONS & WEIGHT

Overall Appliance Dimensions (Width of Canopy Included) (HxWxD)	12 13/16" x 33 3/4" x 22"
Minimum Distance Above Gas / Electric Cooking Surface	30" Electric / 30" Gas
Diameter of Air Duct Top	10"
Net Weight	54 lbs

ACCESSORIES (REQUIRED)

Blower (Sold Separately)

BLOWER OPTIONS

Remote Blowers (Mounted to Roof or External Wall)	VTR1FZ - 600 CFM
	VTR2FZ - 1000 CFM
Inline Blowers (Mounted Between Kitchen and External Wall)	VT11FZ - 600 CFM
	VT12FZ - 1000 CFM
Integrated Blower (Mounted in Hood)	VTN2FZ - 1000 CFM

WARRANTY

Limited Warranty Parts and Labor	2 Year
----------------------------------	--------

*Transition to aluminum starting in Fall 2022

★ THERMADOR® EXCLUSIVE

VCIN36GWS
36-INCH CUSTOM INSERT
PROFESSIONAL® SERIES



HOOD DIMENSIONS

NOTE: VCIN Custom Insert models include hood trim pieces.

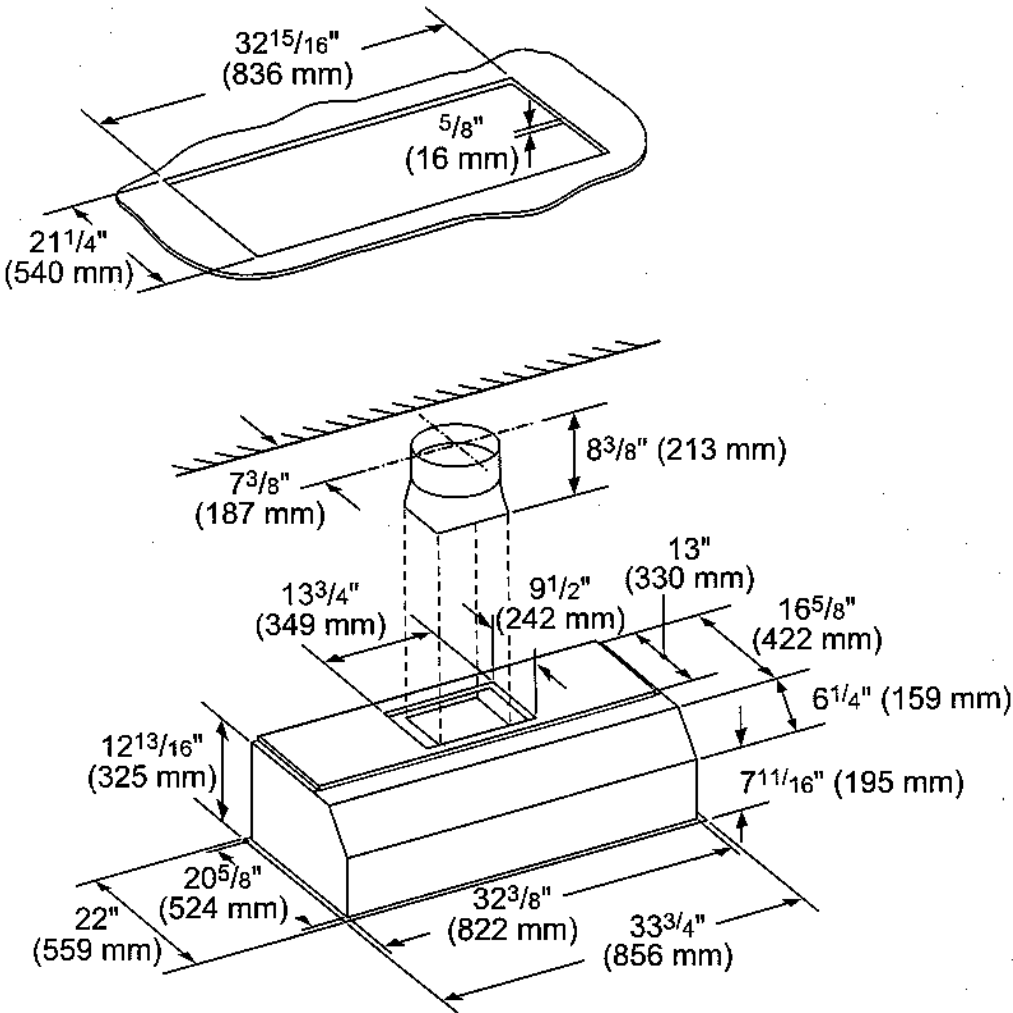

measurements in inches (mm)

VCIN36GWS
36-INCH CUSTOM INSERT
PROFESSIONAL® SERIES



ELECTRIC LOAD (120V, 60HZ)

		Remote Blower		Inline Blower		Integrated Blower
		VTR1FZ	VTR2FZ	VTI1FZ	VTI2FZ	VTN2FZ
VCIN36GWS	Amps	5.7	10.3	5.7	10.3	8.7
	Watts	684	1,236	684	1,236	1,044

REMOTE BLOWERS (MOUNTED TO ROOF OR EXTERNAL WALL)

VTR1FZ-600 CFM

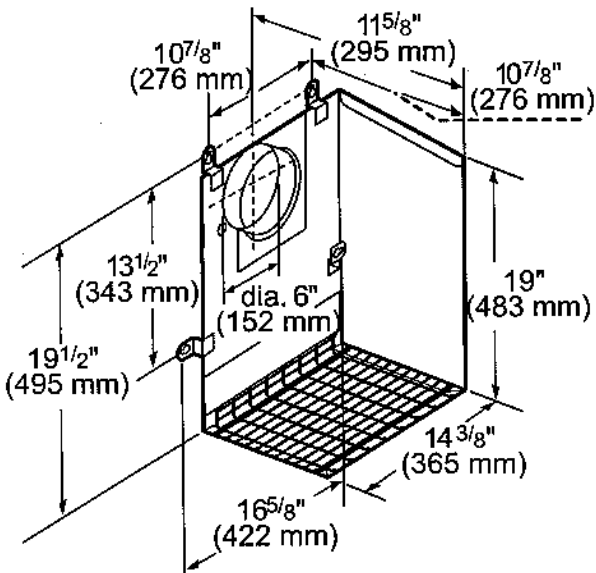

measurements in inches and mm

VTR2FZ-1000 CFM

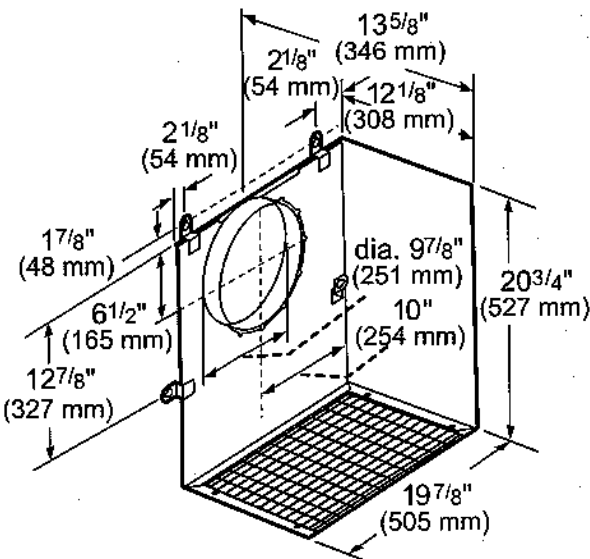

measurements in inches and mm

VCIN36GWS
36-INCH CUSTOM INSERT
PROFESSIONAL® SERIES



INLINE BLOWERS (MOUNTED BETWEEN KITCHEN AND EXTERNAL WALL)

VTI1FZ-600 CFM

VTI2FZ-1000 CFM

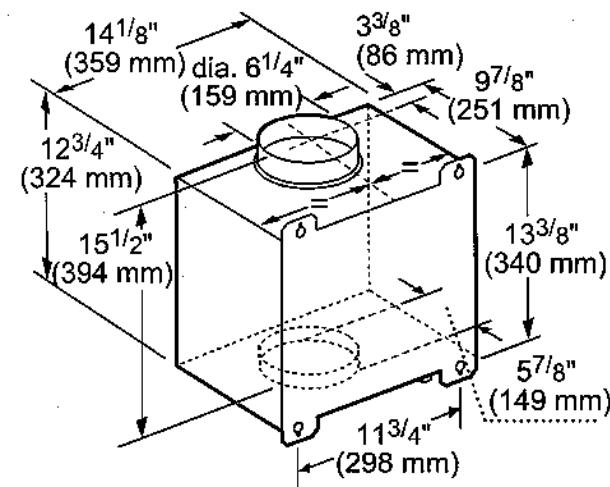

measurements in inches and mm

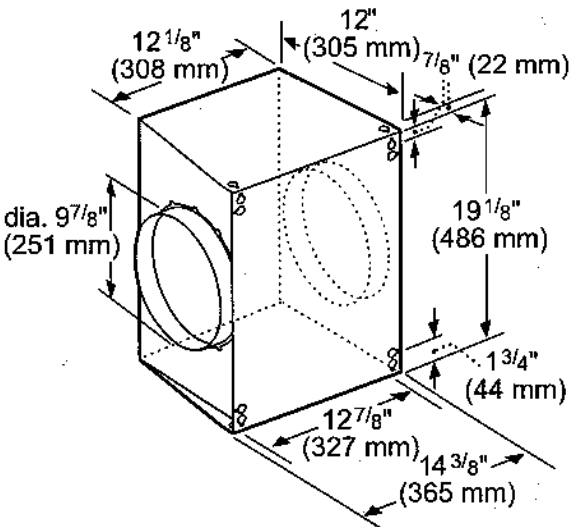

measurements in inches and mm

INTEGRATED BLOWERS (MOUNTED IN HOOD)

VTN2FZ-1000 CFM

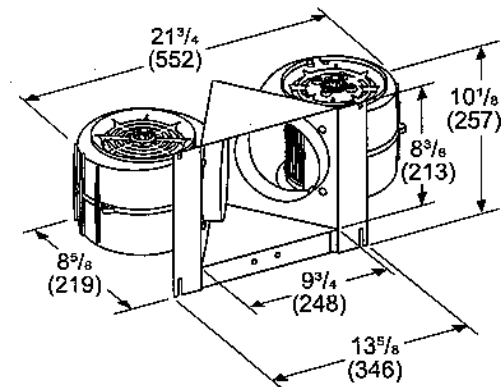

Measurements in inches (mm)

HVI PERFORMANCE VALUES (CFM & SONES)

VCIN36GWS WITH BLOWER VTN2FZ								
Exhaust	Pressure (in. H ₂ O)		Amps (@ 0.1 SP)		CFM		Sones	
	High Speed	Working Speed	High Speed	Working Speed	High Speed	Working Speed	High Speed	Working Speed
Vertical	0.1	0.018	6.92	3.27	920	380	14.5	3.0

VCIN36GWS
36-INCH CUSTOM INSERT
PROFESSIONAL® SERIES



REMOTE BLOWER ACCESSORIES

ROOFPLATE-RFPLT600P

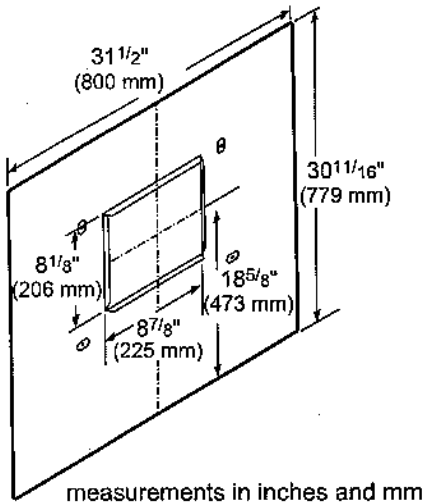

ROOFPLATE-RFPLT1000P

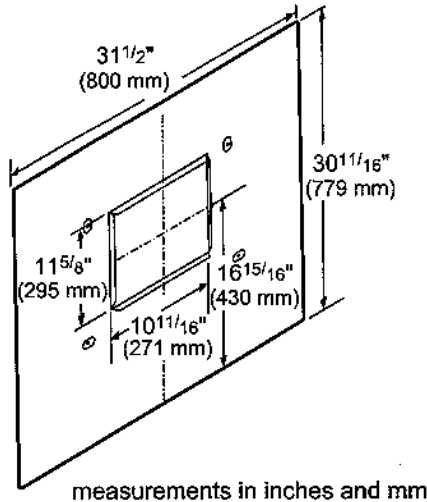

EXTNCB25W

For use with the following inline and Remote Blowers: VTR1FZ, VTR2FZ, VT11FZ, VT12FZ

OPTIONAL ACCESSORIES

REMOTE CONTROL PANEL
REMCPU



Convenience at your fingertips: The remote control accessory offers the freedom to extend your hood controls to a more reachable spot

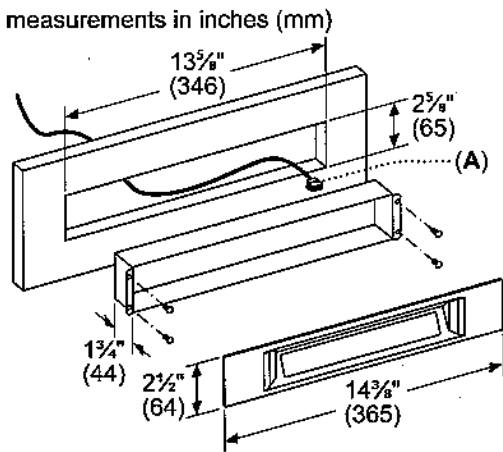

A: DBus Cable length: 30 feet (9180 mm)

These warranties give you specific legal rights and you may have other rights that vary from state to state. Limited warranty from date of purchase. For complete warranty details, refer to your Use & Care manual, or ask your dealer.

Specifications are for planning purposes only. Refer to installation instructions and consult your countertop supplier prior to making counter opening. Consult with a heating and ventilation engineer for your specific ventilation requirements. For the most detailed information, refer to installation instructions accompanying product or write to Thermador indicating the model number. Specifications are correct at time of printing. Thermador reserves the right to change product specifications or design without notice. Some models are certified for use in Canada. Thermador is not responsible for products that are transported from the U.S. for use in Canada.

1 800 735 4328 | USA THERMADOR.COM | CANADA THERMADOR.CA | ©2022 BSH HOME APPLIANCES CORPORATION. ALL RIGHTS RESERVED.

T18ID905LP
18-INCH BUILT-IN FREEZER COLUMN WITH
ICE & WATER DISPENSER
FREEDOM® COLLECTION, PANEL-READY, LEFT-HAND DOOR SWING

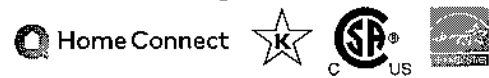

Also Available In:
T18ID905RP – Right-Hand Door Swing

FEATURES & BENEFITS

- Full Stainless Steel Inner Liner
- Freedom® Hinge enables true flush design
- Auto Door Opening provides the opening of the door with just a slight push or pull
- Energy Efficient Diamond Ice made with twist tray technology
- Smooth Filtered Lighting for clear and easy viewing of all product
- SoftClose® Drawers for easy and controlled storage
- Sleek clean design for the perfect symmetry when paired with additional columns
- TFT control panel managing all your columns functions

TEMPERATURE RANGES

Freezer	-11°F (-24°C) to 7°F (-14°C)
SuperFreeze®	-22°F (-30°C) for approximately 52 hours
Energy Saving (Economy) Mode	3°F (-16°C)

GENERAL PROPERTIES

Home Connect™ (Wi-Fi Enabled)	Yes
Panel Ready	Yes
Reversible Door Swing	No
SoftClose® Door	Yes
SoftClose® Drawers	Yes
Lighting	LED Sidewall and Theater Lighting
Freezer Shelves	4
Adjustable Shelves	2
Shelf Material	Glass w/Aluminum Profile
Full Extension Drawers @ 115° Door Opening Angle	Yes
General Use Drawer	2
Door Bins	0
External LED Proximity Sensor	Yes
Oversized Dispenser Opening	Yes
Chilled Water, Crushed and Cubed Ice	Yes
Rapid Water Replenishment System	Yes
Ice Maker with Diamond Ice System	Yes
Door Open Alarm	Yes
Open Door Assist	Yes
Special Modes	Sabbath, Economy, Vacation

CAPACITY

Total Capacity (cu. ft.)	7.8 cu. ft.
--------------------------	-------------

PERFORMANCE

Dedicated Evaporator & Compressor System	Yes
SuperFreeze®	Yes
Defrost Process	Frost-Free

TECHNICAL DETAILS

Watts (W)	350 W
Current (A)	15 A
Volts (V)	110-120 V
Frequency (Hz)	60 Hz
Power Cord Length (in.)	118
Plug Type	120V-3 Prong

DIMENSIONS & WEIGHT

Appliance Dimensions (H x W x D) (in.)	83 3/4** x 17 3/4" x 24"
Required Cutout Size (H x W x D) (in.)	84" x 18" x 25"
Net / Gross Weight (lbs)	289 / 319 lbs

EFFICIENCY

ENERGY STAR® Certified	Yes
Annual Energy Consumption	428 kWh

*Height adjustable + / -1/2" (+ / -13 mm)

T18ID905LP
18-INCH BUILT-IN FREEZER COLUMN WITH
ICE & WATER DISPENSER
FREEDOM® COLLECTION, PANEL-READY, LEFT-HAND DOOR SWING



WARRANTY	
Limited, Entire Appliance, Parts and Labor on Any Part of the Refrigerator that Fails Because of a Manufacturing Defect	2 Year
Limited Warranty for Sealed Refrigeration System*; Parts and Labor	3rd to 6th Year
Limited Warranty for Sealed Refrigeration System*; Parts Only	7th to 12th Year
Limited Warranty for Stainless Steel Rust-Through	Lifetime

*Sealed refrigeration system includes compressor, evaporator, condenser, dryer / strainer and connection tubing

CUTOUT DIMENSIONS

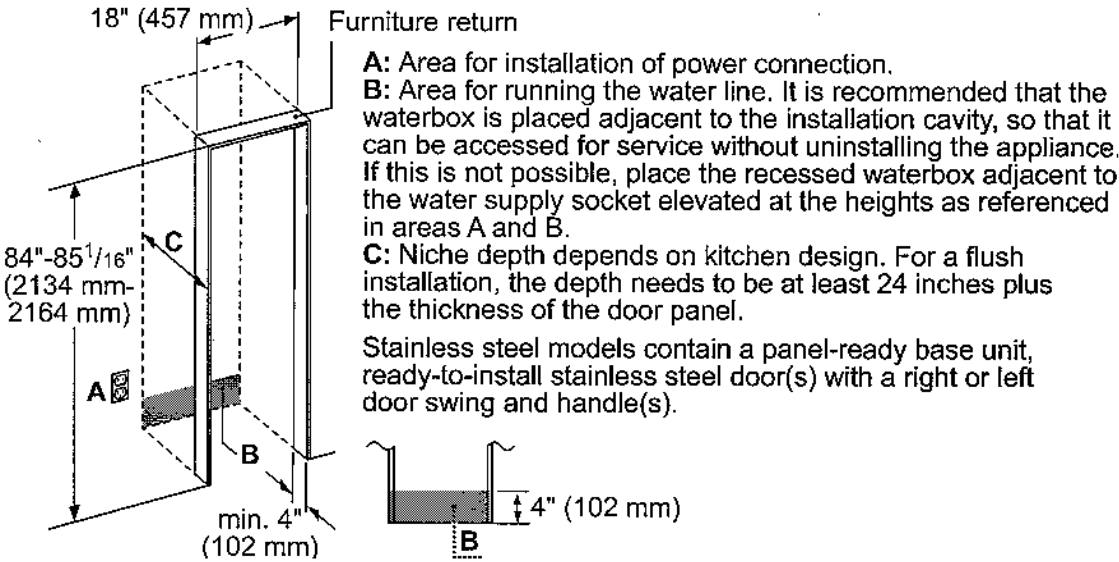

TOP VIEW CLEARANCE

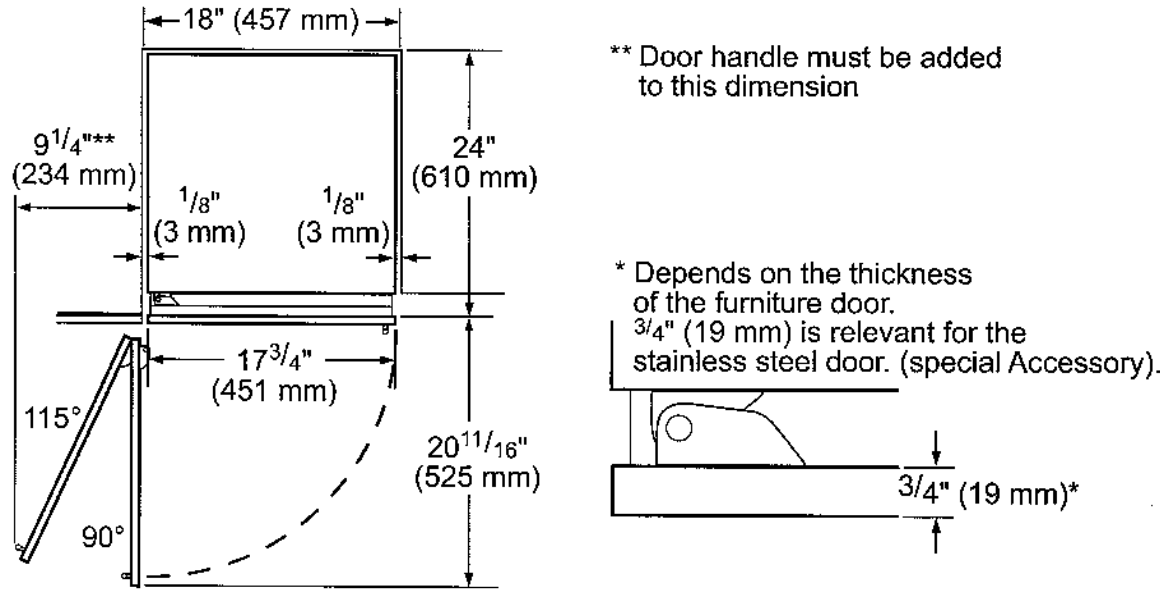

T18ID905LP
18-INCH BUILT-IN FREEZER COLUMN WITH
ICE & WATER DISPENSER
FREEDOM® COLLECTION, PANEL-READY, LEFT-HAND DOOR SWING



PRODUCT AND PANEL DIMENSIONS

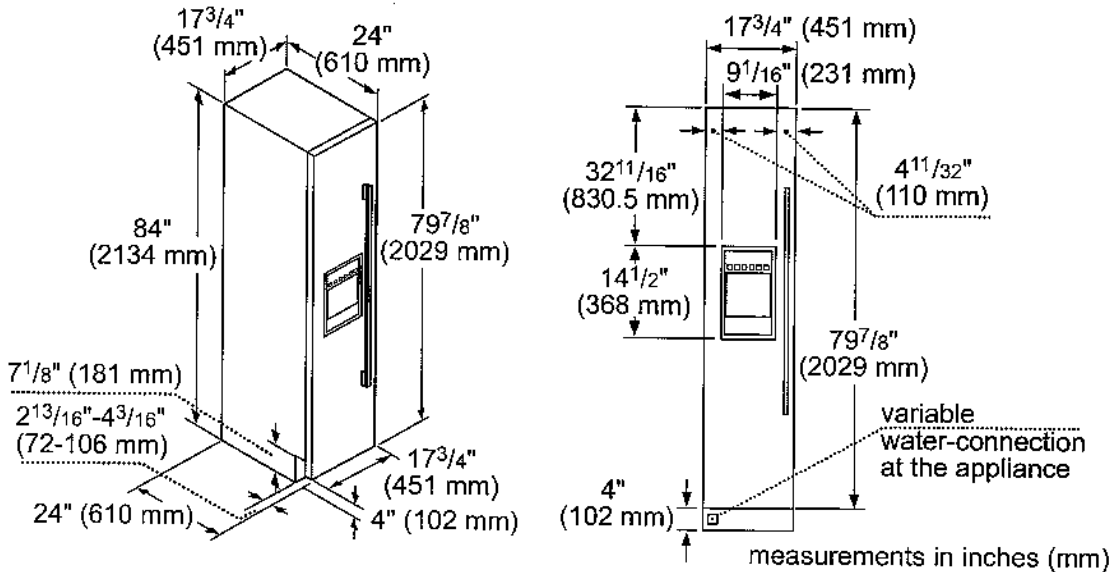

ACCESSORIES (OPTIONAL)

FLAT STAINLESS STEEL DOOR PANELS
18-Inch Flat Stainless Steel Door Panel With Dispenser

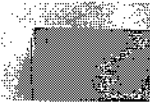

TFL18ID800
For use with Handle
TFL18ID905
Handleless

STORAGE

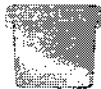

ICEBUCKETL
Large Ice Bucket

FRAMEKIT10

Freedom® Frame Kit
For any custom column installation in 24-inch deep cutouts. With two metal side trims whose placement between the interior cutout wall and the appliance helps overcome the challenge of unfinished cabinet returns.

HANDLES

Choose between two options:



PR36HNDL20
36-Inch Professional Series Handle

or



MS36HNDL20
36-Inch Masterpiece® Series Handle

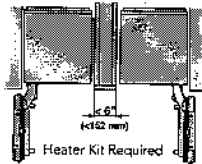

HEATRKIT20 - 13W @ 120V
Freedom® Heater Kit

When two appliances are installed side-by-side a sealing kit must be used. For combinations that involve a freezer column, this sealing kit is included. For all other (non-traditional, i.e. two wine columns, two bottom freezers, etc.) side-by-side combinations or instances where any appliances are installed less than 6-inches (152 mm) apart from one another but not connected side-by-side, purchase this kit. This kit is recommended for use with any installation in areas that are subject to humidity, or located next to an outside wall.

FILTERS



REPLFLTR55
Freedom® Water Filter
Replacement water filter for use in all freezer and bottom freezer models

These warranties give you specific legal rights and you may have other rights that vary from state to state. Limited warranty from date of purchase. For complete warranty details, refer to your Use & Care manual, or ask your dealer.

Specifications are for planning purposes only. Refer to installation instructions and consult your countertop supplier prior to making counter opening. Consult with a heating and ventilation engineer for your specific ventilation requirements. For the most detailed information, refer to installation instructions accompanying product or write to Thermador indicating the model number. Specifications are correct at time of printing. Thermador reserves the right to change product specifications or design without notice. Some models are certified for use in Canada. Thermador is not responsible for products that are transported from the U.S. for use in Canada.

1 800 735 4328 | USA THERMADOR.COM | CANADA THERMADOR.CA | ©2021 BSH HOME APPLIANCES CORPORATION. ALL RIGHTS RESERVED.

T30IR905SP
30-INCH BUILT-IN FRESH FOOD COLUMN
FREEDOM® COLLECTION, PANEL-READY

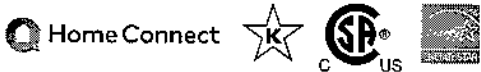
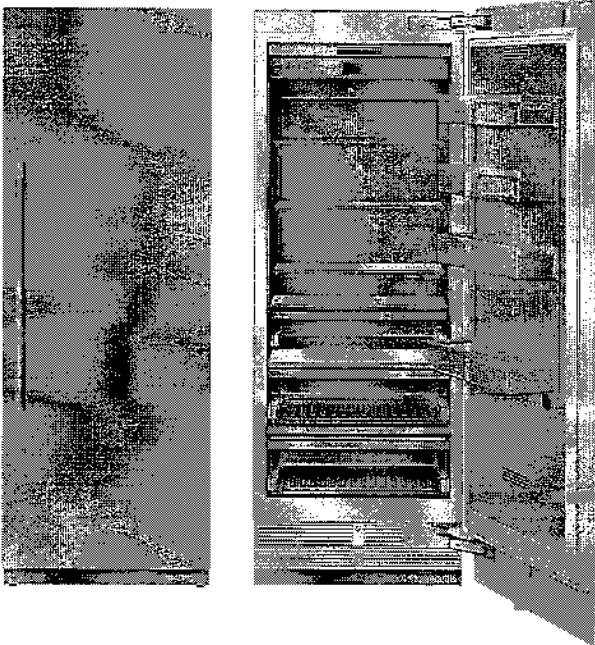

FEATURES & BENEFITS

- Full Stainless Steel Inner Liner
- Freedom® Hinge enables true flush design
- Auto Door Opening provides the opening of the door with just a slight push or pull
- ThermaFresh System, Humidity and Temperature controlled drawers
- SoftClose® Drawers for easy and controlled storage
- Sleek clean design for the perfect symmetry when paired with additional columns
- TFT control panel managing all your columns functions

TEMPERATURE RANGES

Refrigerator	36°F (2°C) to 46°F (8°C)
Temperature Controlled Drawer	30°F (-1°C) to 38°F (3°C)
SuperCool	36°F (2°C) for approximately 6 hours
Energy Saving (Economy) Mode	43°F (6°C)

GENERAL PROPERTIES

Home Connect™ (Wi-Fi Enabled)	Yes
Panel Ready	Yes
Reversible Door Swing	Yes
SoftClose® Door	Yes
SoftClose® Drawers	Yes
Carbon Air Filter	Yes
Lighting	LED Sidewall and Theater Lighting
Refrigerator Shelves	4
Adjustable Shelves	3
Shelf Material	Glass w/Aluminum Profile
Full Extension Drawers @ 115° Door Opening Angle	Yes
Full Extension Drawers @ 90° Door Opening Angle	Yes
General Use Drawer	1
Humidity Managed Drawer	1
Temperature Controlled Drawer	1
Door Bins	3
Gallon Door Bins	1
Door Open Alarm	Yes
Open Door Assist	Yes
Special Modes	Sabbath, Economy, Vacation

CAPACITY

Total Capacity (cu. ft.)	16.8 cu. ft.
--------------------------	--------------

PERFORMANCE

Dedicated Evaporator & Compressor System	Yes
Freeflow® Cold Air System	Yes
SuperCool	Yes

TECHNICAL DETAILS

Watts (W)	350 W
Current (A)	15 A
Volts (V)	110-120 V
Frequency (Hz)	60 Hz
Power Cord Length (in.)	118
Plug Type	120V-3 Prong

DIMENSIONS & WEIGHT

Appliance Dimensions (H x W x D) (in.)	83 3/4" x 29 3/4" x 24"
Required Cutout Size (H x W x D) (in.)	84" x 30" x 25"
Net / Gross Weight (lbs)	366 / 403 lbs

EFFICIENCY

ENERGY STAR® Certified	Yes
Annual Energy Consumption	279 kWh

*Height adjustable + / -1/2" (+ / -13 mm)

FREEDOM® COLLECTION, PANEL-READY



WARRANTY

Limited, Entire Appliance, Parts and Labor on Any Part of the Refrigerator that Fails Because of a Manufacturing Defect	2 Year
Limited Warranty for Sealed Refrigeration System*; Parts and Labor	3rd to 6th Year
Limited Warranty for Sealed Refrigeration System*; Parts Only	7th to 12th Year
Limited Warranty for Stainless Steel Rust-Through	Lifetime

*Sealed refrigeration system includes compressor, evaporator, condenser, dryer / strainer and connection tubing

CUTOUT DIMENSIONS

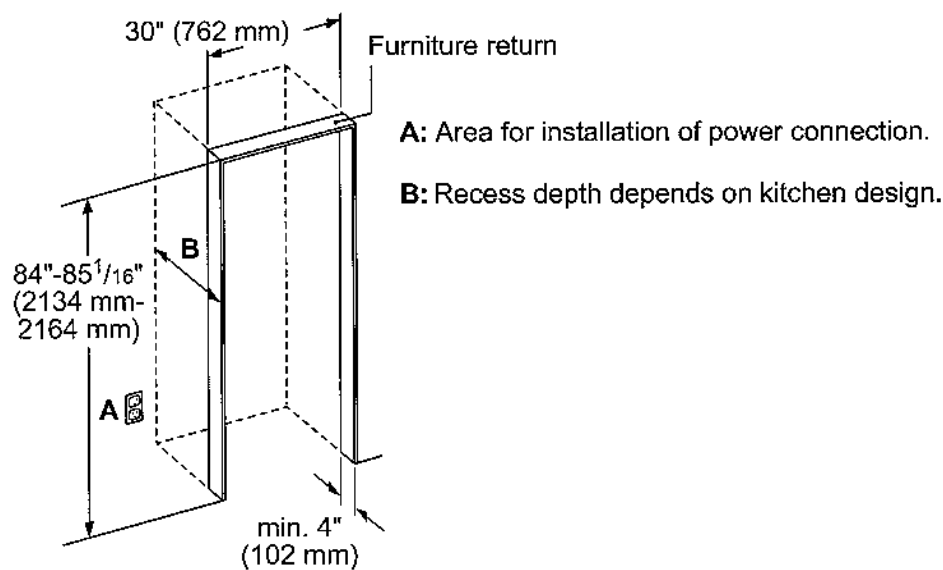

TOP VIEW CLEARANCE

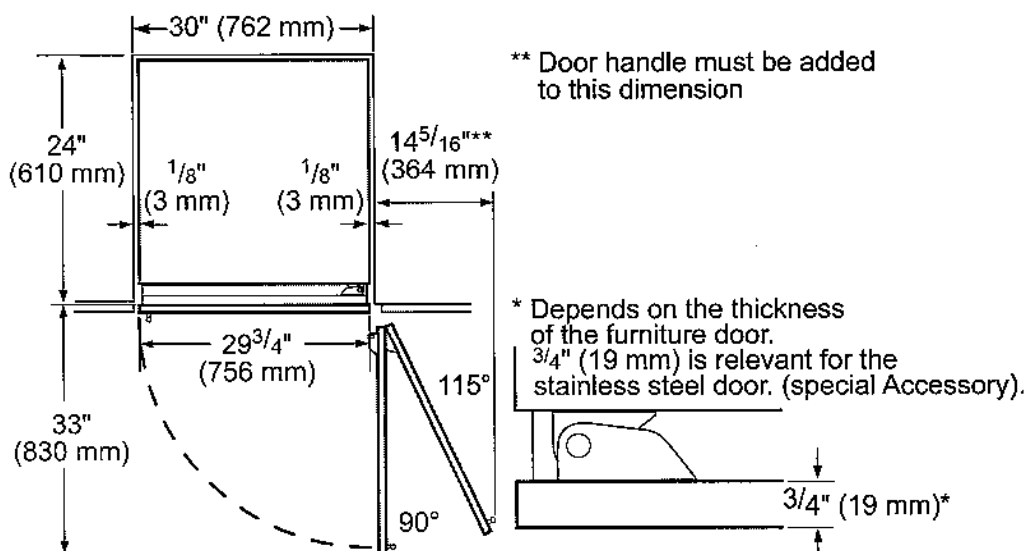

T30IR905SP
30-INCH BUILT-IN FRESH FOOD COLUMN
FREEDOM® COLLECTION, PANEL-READY



PRODUCT AND PANEL DIMENSIONS

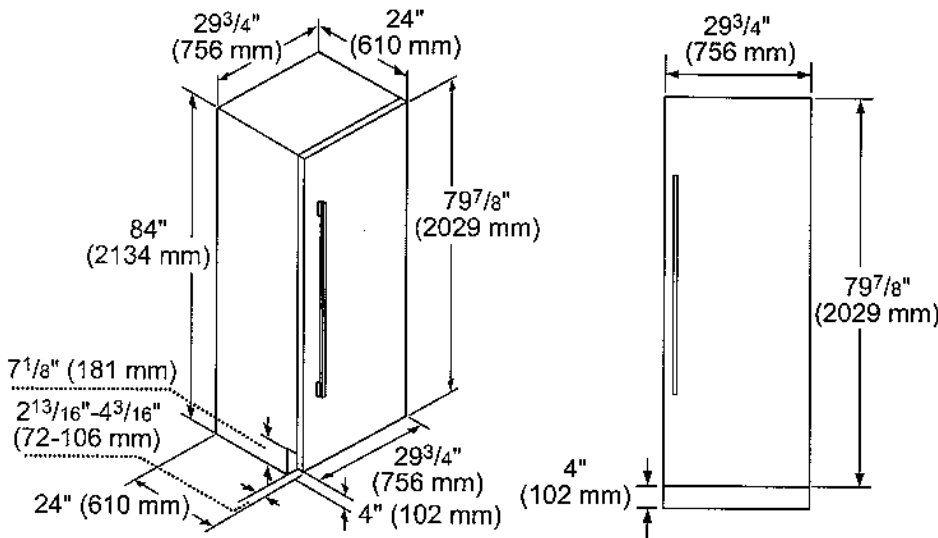

ACCESSORIES (OPTIONAL)

FLAT STAINLESS STEEL DOOR PANELS

30-Inch Flat Stainless Steel Door Panel

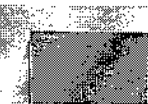

TFL30IR800
For use with Handle
TFL30IR905
Handleless

HANDLES

Choose between two options:



PR36HNDL20
36-Inch Professional Series Handle

or



MS36HNDL20
36-Inch Masterpiece® Series Handle

STORAGE



LPRODBIN10
Large Produce Bin



30PRODRAIL
30-Inch Produce Railing



30HFGALBIN
30-Inch Half Gallon Bin

FRAMEKIT10

Freedom® Frame Kit
For any custom column installation in 24-inch deep cutouts. With two metal side trims whose placement between the interior cutout wall and the appliance helps overcome the challenge of unfinished cabinet returns.

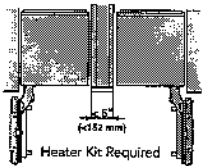

HEATKIT20 - 13W @ 120V

Freedom® Heater Kit
When two appliances are installed side-by-side a sealing kit must be used. For combinations that involve a freezer column, this sealing kit is included. For all other (non-traditional, i.e. two wine columns, two bottom freezers, etc.) side-by-side combinations or instances where any appliances are installed less than 6-inches (152 mm) apart from one another but not connected side-by-side, purchase this kit. This kit is recommended for use with any installation in areas that are subject to humidity, or located next to an outside wall.

These warranties give you specific legal rights and you may have other rights that vary from state to state. Limited warranty from date of purchase. For complete warranty details, refer to your Use & Care manual, or ask your dealer.

Specifications are for planning purposes only. Refer to installation instructions and consult your countertop supplier prior to making counter opening. Consult with a heating and ventilation engineer for your specific ventilation requirements. For the most detailed information, refer to installation instructions accompanying product or write to Thermador indicating the model number. Specifications are correct at time of printing. Thermador reserves the right to change product specifications or design without notice. Some models are certified for use in Canada. Thermador is not responsible for products that are transported from the U.S. for use in Canada.

1 800 735 4328 | USA THERMADOR.COM | CANADA THERMADOR.CA | ©2021 BSH HOME APPLIANCES CORPORATION. ALL RIGHTS RESERVED.

PCG366W
36-INCH GAS RANGETOP
PROFESSIONAL SERIES, PORCELAIN COOKTOP SURFACE

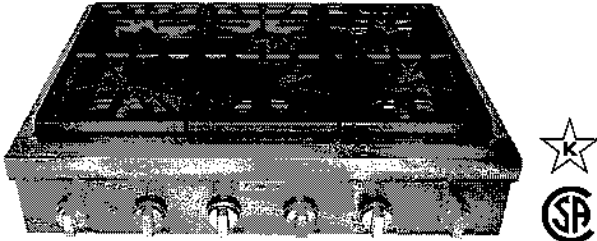

FEATURES & BENEFITS

- ★ Patented Pedestal Star® Burner with QuickClean Base® designed for easy surface cleaning and superior heat spread for any size pan
- ★ Precision simmering capabilities as low as 100°F (375 BTU) with 2 ExtraLow® Simmer burners
- ★ LED Downlighting—hidden discreetly above the control panel provides functional and stylish illumination

GENERAL PROPERTIES	
Controls	Metal Knobs
Sealed Burners	Yes
Grate Material	Cast Iron
BURNER PERFORMANCE	
Total Number of Cooktop Burners	6
Power of Front Left Burner (NG)	18,000 and XLO (NG)
Power of Back Left Burner (NG)	15,000 and XLO (NG)
Power of Back Center Burner (NG)	15,000 (NG)
Power of Front Center Burner (NG)	18,000 (NG)
Power of Center 12" Electric Griddle (W)	N/A
Power of Center 12" Electric Grill (W)	N/A
Power of Back Right Burner (NG)	15,000 (NG)
Power of Front Right Burner (NG)	18,000 (NG)
TECHNICAL DETAILS	
Circuit Breaker (A)	15 A
Volts (V)	120 V
Frequency (Hz)	60 Hz
Plug Type / Receptacle	120V-3 Prong NEMA 5-15
Power Cord Length (in)	65"
Energy Source	Gas
Gas Type	Natural Gas 6" Water Column (14.9 mb) Min. (USA)
Alternative Gas Type	LP 11" Water Column (27.4 mb) Min. (USA)
Convertible To LP (Kit Required)	Yes
DIMENSIONS & WEIGHT	
Overall Appliance Dimensions (HxWxD) (in)	8 1/8" x 35 15/16" x 25 13/16"
Required Cutout Size (HxWxD) (in)	7 11/16" x 35 1/8" x 22 13/16"
Minimum Distance From Rear Wall (in)	6" Min. to Combustible Surface
Net Weight (lbs)	142 lbs
WARRANTY	
Limited Warranty, Entire Appliance, Parts and Labor	2 Year

★ THERMADOR® EXCLUSIVE

PCG366W
36-INCH GAS RANGETOP
PROFESSIONAL SERIES, PORCELAIN COOKTOP SURFACE



ACCESSORIES (OPTIONAL)



PAGRIDDLE
Griddle Sits on Top of
Grates Over 2 Star Burners



PA12CHPBLK
12" Cutting Board



PWOKRINGHC
Wok Ring

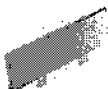

PA36WLBC
10" Low Backguard



PAKNOBLUWR
Metallic Blue Knob Kit



PALPKITHW
LP Conversion Kit, Pro
Rangetops (4 & 6 Burners)

36" RANGETOP SIDE VIEW

measurements in inches (mm)

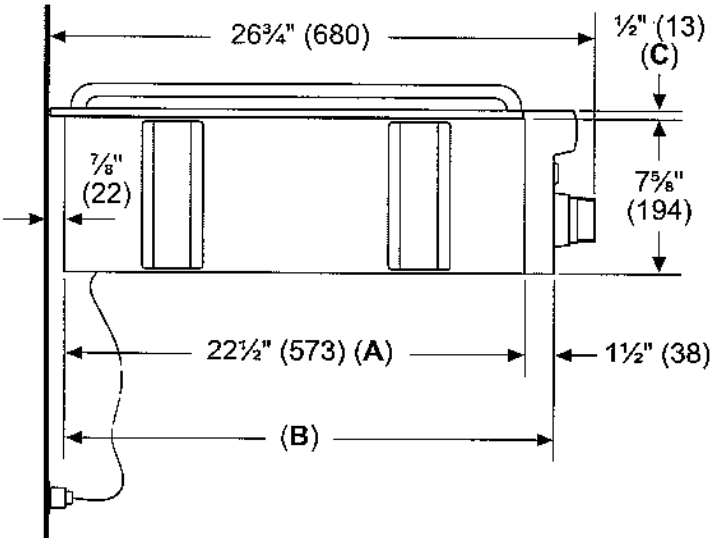

- A:** Cabinet face for installation with projecting control panel.
- B:** Cabinet face for installation with flush control panel.
- C:** Side flange

PCG366W **36-INCH GAS RANGETOP** PROFESSIONAL SERIES, PORCELAIN COOKTOP SURFACE



36-INCH RANGETOP CUTOUT DIMENSIONS

* Minimum recommended hood width equals that of the range or cooktop.

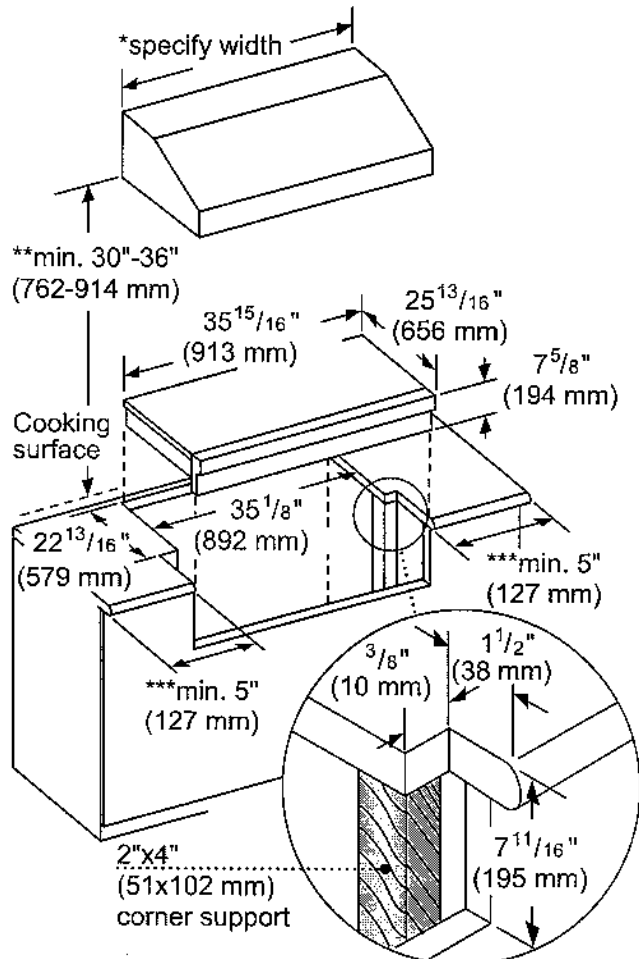

** 36" minimum clearance from cooking surface to combustible surfaces.

*** 5" minimum clearance from cooking surface to combustible side wall.

Note: Most hoods contain combustible components that must be considered when planning the installation.

measurements in inches (mm)

PODMCW31W
30-INCH TRIPLE COMBINATION BUILT-IN OVEN WITH
SPEED OVEN
PROFESSIONAL SERIES

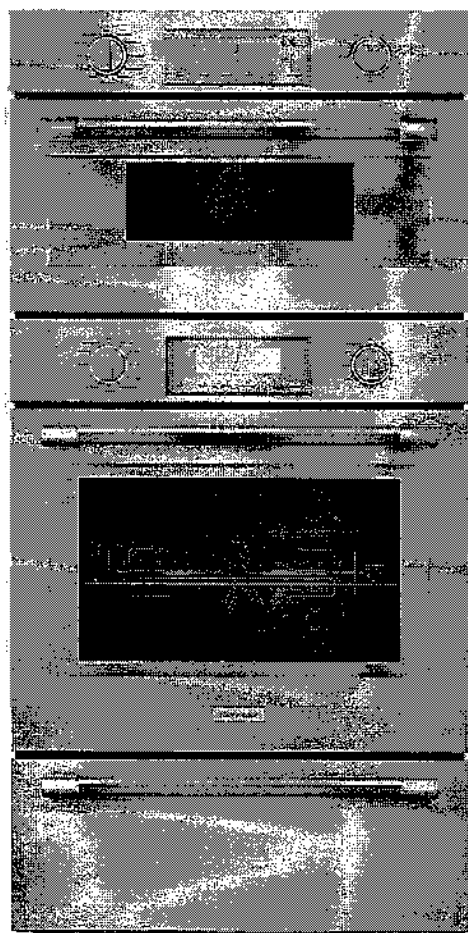

FEATURES & BENEFITS

- ★ - First triple combination oven with speed oven in the market
- Designed for flexibility—standard or flush installation into kitchen cabinets
- Specially crafted gray glass on stainless steel for a luxurious look and finish
- Speed oven with microwave capability can broil and convection bake
- Large commercial style rotisserie with 12 pound capacity

ACCESSORIES (INCLUDED)

Upper Cavity: Metal Turntable, Rack, Ceramic Tray; Lower Cavity: 3 Telescopic Racks, Multi-point Meat Probe, Max Broil Pan, Rotisserie

WARRANTY

Limited Warranty Parts and Labor	2 Year
----------------------------------	--------

★ THERMADOR® EXCLUSIVE

GENERAL PROPERTIES

Heating Modes – Upper Cavity		
36 CookSmart™ Auto Programs (including True Convection, Speed Convection, Broil, Convection Broil, Keep Warm) and Heating Programs and Microwave Programs		
Heating Modes – Lower Cavity		
(16) Bake, Broil, Max Broil, Roast, Convection Bake, Convection Broil, Max Convection Broil, Convection Roast, Proof, Warm, Pizza, True Convection, Dehydrate, Speed Convection, Slow Roast, Rotisserie		
Sabbath		Yes
Warming Drawer		Yes
Cleaning Type – Lower Cavity		Easy Clean and Self Clean
Telescopic Rack(s)		3
Illumination Type	Upper Cavity Lower Cavity	LED Halogen
Interior Lights	Upper Cavity Lower Cavity	1 2
Home Connect (Wi-Fi Enabled)		Yes, Lower Oven Only

OVEN PERFORMANCE

Microwave Power		1,000 W
Bake / Broil Element	Upper Cavity Lower Cavity	600 W / 1,750 W 2,400 / 1,000 / 3,800 W
Convection Element	Upper Cavity Lower Cavity	1,700 W 2,000 W
Warming Drawer		450 W

TECHNICAL DETAILS

Watts		10,200 W
Circuit Breaker		50 A
Volts; Frequency		240 / 208 V; 60 Hz
Plug Type		Fixed Connection, No Plug
Conduit		60" 4-Wire
Energy Source		Electric

DIMENSIONS & WEIGHT

Overall Appliance Dimensions (HxWxD)	61 3/16" x 29 3/4" x 24 1/2"
Trim Overlaps (Top – Sides – Bottom)	3/8 to 2" – 9/16" – 0"
Required Cutout Size (HxWxD) – Standard	60 3/4" x 28 1/2" x 23 1/2"
Required Cutout Size (HxWxD) – Flush	61 5/16" x 30" x 24 1/2"
Speed Oven Capacity	1.6 cu. ft.
Oven Capacity	4.5 cu. ft.
Warming Drawer Capacity	2.5 cu. ft.
Overall Lower Oven Interior Dimensions (HxWxD)	17 3/4" x 24" x 17 7/8"
Usable Lower Oven Interior Dimensions (HxWxD)	13 1/2" x 21 5/8" x 16 1/4"
Net Weight	346 lbs

PODMCW31W
30-INCH TRIPLE COMBINATION BUILT-IN OVEN WITH
SPEED OVEN
PROFESSIONAL SERIES



30-INCH TRIPLE COMBINATION OVEN WITH SPEED OVEN AND WARMING DRAWER

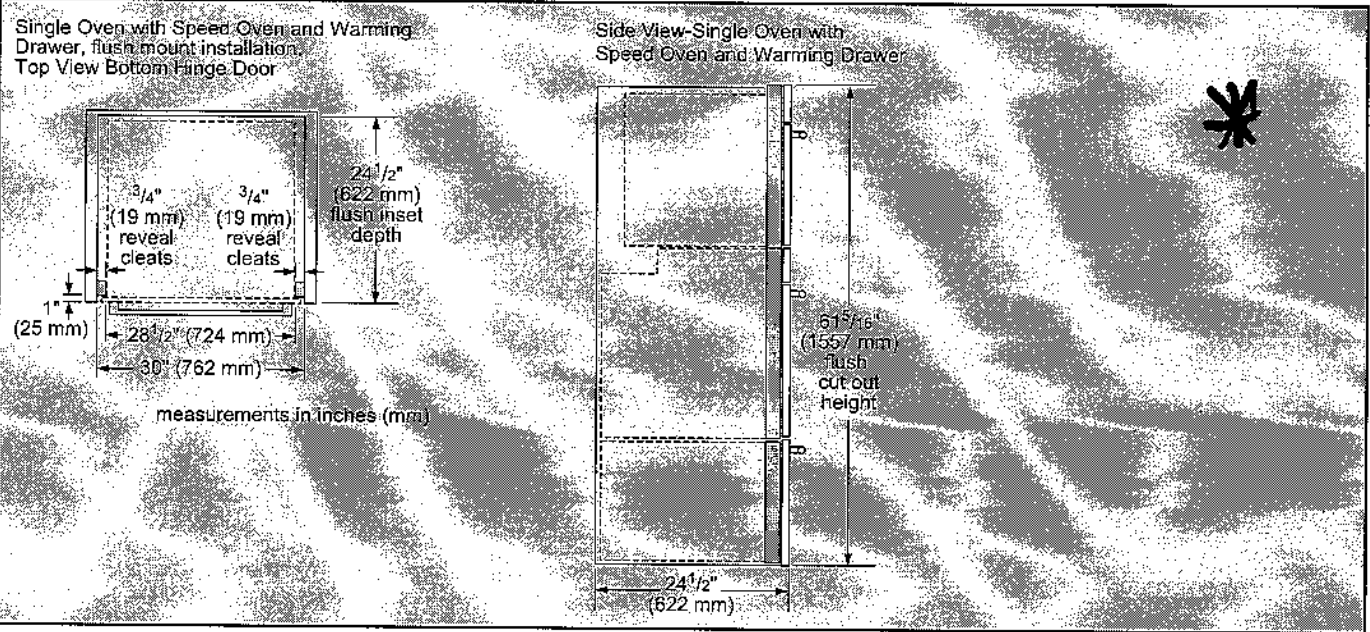
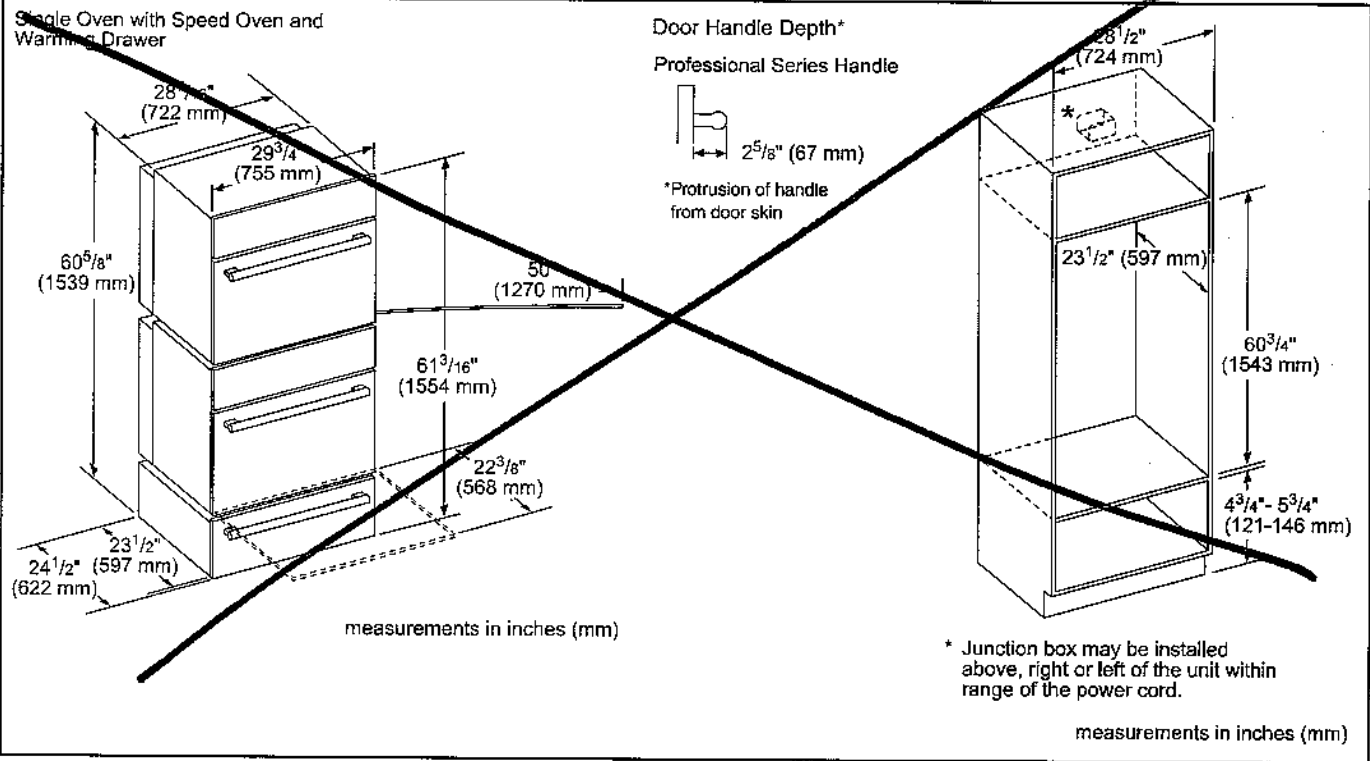

These warranties give you specific legal rights and you may have other rights that vary from state to state. Full warranty and limited warranty from date of installation. For complete warranty details, refer to your Use & Care manual, or ask your dealer.

Specifications are for planning purposes only. Refer to installation instructions and consult your countertop supplier prior to making counter opening. Consult with a heating and ventilation engineer for your specific ventilation requirements. For the most detailed information, refer to installation instructions accompanying product or write to Thermador indicating the model number. Specifications are correct at time of printing. Thermador reserves the right to change product specifications or design without notice. Some models are certified for use in Canada. Thermador is not responsible for products that are transported from the U.S. for use in Canada.

1 800 735 4328 | USA THERMADOR.COM | CANADA THERMADOR.CA | ©2020 BSH HOME APPLIANCES CORPORATION. ALL RIGHTS RESERVED.

DWHD770WFP
SAPPHIRE® 7-PROGRAM DISHWASHER
PROFESSIONAL SERIES HANDLE

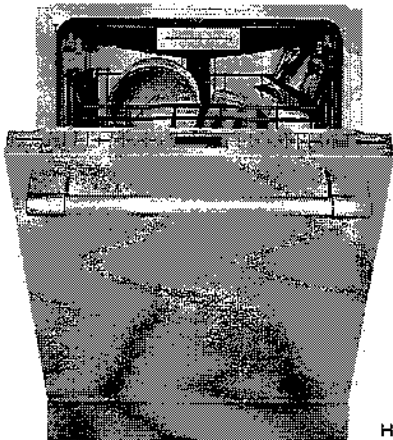

Home Connect

Also Available In:
DWHD770WFM – Flat Stainless Steel Panel with
Masterpiece® Series Handle
DWHD770WPR – Custom Panel

FEATURES & BENEFITS

- ★ - StarDry™ — No one dries better. Star Dry with Zeolite: the ultra-powerful program that dries dishes better so place settings, glassware, and even sturdy plastics and containers with hard-to-reach crevices are ready for use immediately after each cycle
- ★ - Push to Open dishwasher opens with either a push or pull, so loading is easier, even when your hands are full
- ★ - Sapphire Glow® light illuminates with the sparkling blue light when the dishwasher is open
 - Adjustable Chef's Tool Drawer® delivers added loading capacity as well as flexibility to accommodate larger or smaller items, wider ends and utensil handles
 - Flexible folding tines fold down to accommodate larger pots, pans, and dishes and add flexibility to hold items twice as wide as previous models and significantly wider than competitor
 - Exceptionally Quiet — 42 dBA for a peaceful kitchen experience
 - Thermador Connected Experience by Home Connect brings exclusive dish features that keep you connected. Always.

ACCESSORIES (OPTIONAL)

Dishwasher Supply and Drainage Hose Extension 76 3/4"	SGZ1010UC
Dishwasher Accessory Kit	SMZ5000
Fine Silverware Carafe	SMZ5002UC
Junction Box	SMZPCJB1UC



Accessory Kit includes Extra-Tall-Item Sprinkler, Vase / Bottle Holder, 3 Plastic Item Clips and Small Item Basket



Fine Silverware Carafe

★ THERMADOR® EXCLUSIVE

GENERAL PROPERTIES

Number Of Wash Cycles	7
Number Of Options	7
NSF®-Certified* Sanitize Option	Yes
dBA	42
Third Rack	Adjustable Chef's Tool Drawer®
Rack Adjustability	Rackmatic 3-Stage
Tub Material	Stainless Steel
Control Type	Premium Touch Control
Concealed Water Heating Element	Yes
Leak Protection System	24/7 AquaStop®
Water Softener	Yes
Five-Level Wash	Yes
Childlock	No
Home Connect (Wi-Fi Enabled)	Yes

EFFICIENCY

Water Usage Per Cycle (g)	3.5 g
Energy Efficiency Class	Tier 1
ENERGY STAR® Certified	Yes
Total Annual Energy Consumption (kWh)	269 kWh
Total Annual Water Consumption (g)	623.5 g

CAPACITY

Number Of Place Settings	16
--------------------------	----

TECHNICAL DETAILS

Watts (W)	1,440 W
Current (A)	12 A
Volts (V)	120 V
Frequency (Hz)	60 Hz
Power Cord Length (in)	67"
Power Cord Install Length from Corner of Unit when Facing the Door (in)**	Left - 45" Right - 56"
Minimum Water Pressure (lb/sin)	14
Max. Temperature for Water Intake	140° F
Length Inlet Hose (in)	N/A
Length Outlet Hose (in)	79"

DIMENSIONS & WEIGHT

Overall Appliance Dimensions (HxWxD) (in)	33 7/8" x 23 9/16" x 23 3/4"
Required Cutout Size (HxWxD) (in)	33 7/8" Min. x 23 5/8" Min. x 24"
Adjustable Feet	Yes
Net Weight (lbs)	109 lbs

*Certification to NSF/ANSI Standard 184 for residential dishwashers
**September 2020 running production change to remove adhesive routing clips for power cord. These clips and the edge protector are now included in the dishwasher accessory kit #SMZEPCC1UC.

DWHD770WFP
SAPPHIRE® 7-PROGRAM DISHWASHER
PROFESSIONAL SERIES HANDLE



WARRANTY	
Limited Warranty, Entire Appliance, Parts and Labor	2 Year
Limited Warranty for Microprocessor or Printed Circuit Board; Parts Only	3rd to 5th Year
Limited Warranty for Racks (Does Not Include Rack Components); Parts Only	3rd to 5th Year
Limited Warranty for Rust-through On Inner Tub Liner; Parts Only	Lifetime

DISHWASHER & CUTOUT DIMENSIONS

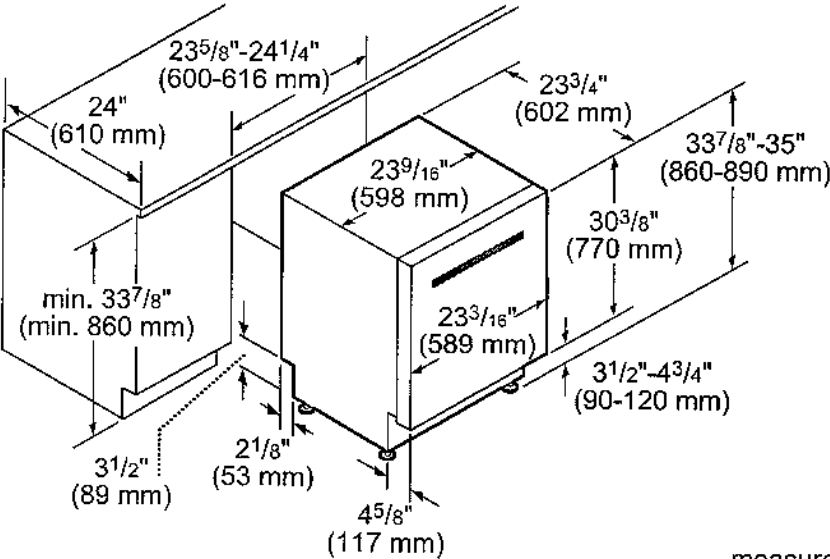

measurements in inches and mm

These warranties give you specific legal rights and you may have other rights that vary from state to state. Full warranty and limited warranty from date of installation. For complete warranty details, refer to your Use & Care manual, or ask your dealer.

Specifications are for planning purposes only. Refer to installation instructions and consult your countertop supplier prior to making counter opening. Consult with a heating and ventilation engineer for your specific ventilation requirements. For the most detailed information, refer to installation instructions accompanying product or write to Thermador indicating the model number. Specifications are correct at time of printing. Thermador reserves the right to change product specifications or design without notice. Some models are certified for use in Canada. Thermador is not responsible for products that are transported from the U.S. for use in Canada.

Dryer.

4/20/22, 11:49 AM

DIMENSIONS

SUMMARY

CAPACITY		DIMENSIONS (WXHxD)	
5.8 cu.ft.		27" x 39" x 33 1/4" (55" D with door open)	
STEAM TECHNOLOGY		THINQ®	
Yes		Yes	

CAPACITY

Capacity	5.8 cu.ft.
----------	------------

APPEARANCE

Design Look	Front Control
Intelligent Electronic Controls with LED Display	Yes
Touch Buttons	Yes
Dial-A-Cycle™	Yes

Washer

4/20/22, 11:50 AM

DIMENSIONS

SUMMARY

<p>CAPACITY</p> <p>7.4 cu.ft.</p>	<p>DIMENSIONS (WXHxD)</p> <p>27" x 39" x 30" (51" With door open)</p>
<p>STEAM TECHNOLOGY</p> <p>Yes</p>	<p>THINQ®</p> <p>Yes</p>

APPEARANCE

Design Look	Front Control
Intelligent Electronic Controls with LED Display	Yes
Touch Buttons	Yes
Dial-A-Cycle™	Yes

ENERGY

ENERGY STAR® Qualified	Yes
------------------------	-----

Purchaser: **Q112**
Lot: **568**

Schedule SMART
Russell Gardens Building Ltd. (Phase 4)

Smart Home System includes:

1. One (1) Smart Home Hub installed in a location as determined by the Vendor;
2. One (1) Doorbell camera supplied and installed at front door;
3. One (1) smart home thermostat to be installed in a location as determined by the Vendor;
4. One (1) smart Flood sensor to be installed in a location as determined by the Vendor which is designed to detect water in the location of the sensor only;
5. Smart light switches to be installed in such locations as determined by the Vendor;

Certain devices for The Smart Home System require a fully functioning WiFi network and internet connection and others work on the Zwave wireless network. Provision of WiFi, internet access and functionality shall be the sole responsibility of the Purchaser and the Vendor assumes no responsibility or obligation with respect to the functionality or performance of a homeowner's internet or WiFi network. The Vendor does not guarantee that networks, equipment, or services will meet all homeowner needs.

The Purchaser will be required to download the Homewave Smart Connect App (the "App") in order to configure and set up the Smart Home System devices. The Purchaser is responsible to ensure that they have the appropriate technology to download the App and any charges and fees for download and/or data usage shall be at the Purchaser's sole cost and expense. Access to the App shall be provided free of charge for 1 year from the Closing Date and thereafter the Purchaser may enter into an agreement with Homewave Smart Connect to continue the services for a monthly fee (currently \$10.00/month plus HST). Fees subject to change without notice.

Purchasers are responsible for configuring all security features. The Vendor does not warrant or represent that any network or Smart Home System devices are secure or can prevent all privacy intrusions, malware, or cyber-attacks, even when correctly configured. The products and services for the Smart Home System are provided by third parties, and not the Vendor. The Vendor does not guarantee any equipment or services provided by third parties. If the Purchaser contracts with the third-party provider to upgrade or purchase further devices, the Vendor has no responsibility for same, including but not limited to, the installation, service, safety or functionality of said products.

Energy claims are not based upon specific testing of an individual home but are general assumptions. Savings will vary due to many variables, including but not limited to, actual utility rates and fees, actual construction, floor plan, occupancy, appliance usage, thermostat settings, weather conditions, number of individuals occupying the home and orientation of the home.

The Vendor is providing only those Smart Home System's devices and components listed in this Schedule. Please see the balance of your Agreement of Purchase and Sale for additional information, disclosures, and disclaimers relating to your home and its features. The specific features in a home may vary from home to home and from one community to another. The Vendor reserves the right to substitute equipment, material, appliances and brand names with items of equal or higher value, in its sole and unfettered discretion. The Vendor reserves the right, in its sole and absolute discretion, to omit installation of the Smart Home System, in part or in whole, and the Purchaser shall have no claim, for abatement or reduction the Purchase Price or to any delay in closing. Installation of the Smart Home System may result in the elimination of other features listed in Schedule GP or other information material, such as but not limited to set back thermostat, rough-in for alarm or other features deemed redundant as a result of the installation of the Smart Home System.

Purchaser Initials 	Purchaser Initials
--	-----------------------