

CONSTRUCTION SUMMARY				
Mountainview Heights 3 (G) - Russell Gardens Building Ltd.				
PURCHASERS: Debashish ROY and Rinku CHOWDHURY			TEL: RES.: 647-236-2909	
LOT / PHASE	REG. PLAN #	HOUSE TYPE		
579 / 4	62M-1266	Springfield Four (4 Bedroom) Elev 2		

CABINETRY

1 - KITCHEN - LIGHT VALANCE - NO ELECTRICAL 12May22 Note:	
1 - CABINETRY - KITCHEN - UPGRADE 1 12May22 Note:	

CABINETRY ACCESSORIES

4 - KITCHEN CABINETRY UPPER - CLEAR GLASS DOOR - GROUP 1 GLASS - FINISHED INTERIOR - FITS TALL UPPER CABINETS - UPGRADE 1 - KITCHEN SERVERY - SEE SKETCH 12May22 Note:	
1 - KITCHEN CABINETRY BASE - PULLOUT RECYCLE 4 BIN - PRICE IS EACH 12May22 Note:	
1 - KITCHEN CABINETRY BASE - BANK OF DRAWERS - UPGRADE 1 12May22 Note:	
1 - KITCHEN CABINETRY BASE - COOKTOP CABINET WITH POT DRAWERS (2 DRAWERS) - UPGRADE 1 12May22 Note:	
1 - KITCHEN CABINETRY - BUILT-IN MICROWAVE/OVEN COMBO - UPGRADE 1 12May22 Note:	
1 - KITCHEN CABINETRY - BUILT-IN FRIDGE CABINET - PRICE IS EACH 12May22 Note:	
1 - KITCHEN CABINETRY UPPER - FULL DEPTH ABOVE FRIDGE - WITH GABLES - 600MM - PRICE IS EACH - UPGRADE 1 12May22 Note:	

CARPET

1 - ALL BEDROOMS - SPILLGAURD UNDER PAD 12May22 Note:	
1 - ALL BEDROOMS - UPGRADE 1 CARPETING 12May22 Note:	

CERAMIC TILE

1 - DELETE ALL CERAMIC BATHROOM ACCESSORIES - DELETE TOWEL BAR, PAPER HOLDER & SOAP DISH THROUGHOUT 12May22 Note:	
1 - TILE - UPGRADE 4 FLOOR TILE - - POWDER ROOM 12May22 Note:	
1 - TILE - UPGRADE 4 FLOOR TILE - - KITCHEN 12May22 Note:	
1 - TILE - UPGRADE 4 FLOOR TILE - - FOYER 12May22 Note:	
1 - TILE - UPGRADE 3 WALL TILE - - ENSUITE BATHROOM - SHOWER WALLS 12May22 Note:	

CONSTRUCTION SUMMARY

Mountainview Heights 3 (G) - Russell Gardens Building Ltd.

PURCHASERS: Debashish ROY and Rinku CHOWDHURY

TEL: RES.: 647-236-2909

LOT / PHASE	REG. PLAN #	HOUSE TYPE		
579 / 4	62M-1266	Springfield Four (4 Bedroom) Elev 2		

1 - TILE - UPGRADE 3 FLOOR TILE - - ENSUITE BATHROOM - FLOOR 12May22 Note:	
-------------------------------------------------------------------------------	--

CONSTRUCTION

1 - ENSUITE 2 BATHROOM - DELETE DOOR TO FLEX ROOM AND PROVIDE WALL TO CLOSE ACCESS TO SHARED ENSUITE - IF CONSTRUCTION PERMITS ***SEE SKETCH 12May22 Note:	
1 - FOR CONFIRMATION PURPOSES- HIGHER ARCHED AND DOORS THROUGHOUT FIRST FLOOR ONLY WHERE CONSTRUCTION PERMITS- 11May22 Note:	
1 - DELETE- ENLARGE BASEMENT WINDOWS (MAY REQUIRE WINDOW WELLS) - WINDOW IS 30 INCHES X 24 INCHES 11May22 Note: DUE TO WALK OUT WINDOW TO RIGHT MUST BE DELETED	
1 - MASTER ENSUITE BATHROOM - DELETE WALL ABOVE SEAT TO ACCOMMODATE FRAMELESS GLASS SHOWER ENCLOSURE 11May22 Note:	
3 - ENLARGE BASEMENT WINDOWS (MAY REQUIRE WINDOW WELLS) - WINDOW IS 30 INCHES X 24 INCHES 06Jul21 Note:	
1 - SMOOTH CEILINGS ON FIRST FLOOR ONLY - DET 06Jul21 Note:	

COUNTER TOP

1 - UPGRADE COUNTERTOP MATERIAL - Kitchen 12May22 Note:	
1 - UPGRADE COUNTERTOP MATERIAL - Powder 12May22 Note:	
1 - UPGRADE COUNTERTOP MATERIAL - Bdrm 4 12May22 Note:	
1 - UPGRADE COUNTERTOP MATERIAL - Bdrm 3 12May22 Note:	
1 - UPGRADE COUNTERTOP MATERIAL - Main 2 12May22 Note:	
1 - UPGRADE COUNTERTOP MATERIAL - Master 12May22 Note:	

DOORS AND TRIM

1 - ADD PLAIN SINGLE PANEL GLASS DOOR - SINGLE DOOR / CLEAR GLASS IN LIEU OF STANDARD DOOR - KITCHEN - WALK-IN PANTRY 12May22 Note:	
1 - TRIM - UPGRADE 3- 7-¼" ONE STEP BASEBOARD AND BB ONE STEP CASING 12May22 Note:	
1 - ADD HIGHER DOORS AND ARCHES THROUGHOUT FIRST FLOOR ONLY 06Jul21 Note:	

CONSTRUCTION SUMMARY

Mountainview Heights 3 (G) - Russell Gardens Building Ltd.

PURCHASERS: Debashish ROY and Rinku CHOWDHURY

TEL: RES.: 647-236-2909

LOT / PHASE	REG. PLAN #	HOUSE TYPE		
579 / 4	62M-1266	Springfield Four (4 Bedroom) Elev 2		

ELECTICAL

1 - PLUG – ROUGH-IN FOR ELECTRIC CAR PLUG IN GARAGE – FOR FUTURE ELECTRIC CAR – 240V / 40-50 AMPS 12May22 Note: SPECIFICATIONS REQUIRED	
--------------------------------------------------------------------------------------------------------------------------------------------	--

ELECTRICAL

1 - FRONT PORTICO - INSTALL STANDARD LIGHT ON SOFFIT - IF CONSTRUCTION PERMITS 12May22 Note:	
1 - BUILT IN OVEN AND COOKTOP PROVISION - PROVISION ONLY - ELECTRICAL ONLY 12May22 Note:	
2 - PLUG - ELECTRICAL PLUG - INSTALLED 5' FROM FLOOR - FLEX ROOM & MASTER BEDROOM 12May22 Note:	
1 - HUMIDIFIER - GENERAL AIRE 1099 12May22 Note:	
1 - PLUG - ELECTRICAL PLUG - TO BE INSTALLED OVER FIREPLACE 12May22 Note:	
3 - ABOVE KITCHEN ISLAND - ADD LIGHT AND SWITCH - NO FIXTURE INCLUDED 12May22 Note:	
1 - POT LIGHT - LED - FIRST FLOOR INSTALLATION - INSTALLED ON SEPERATE SWITCH FROM STANDARD LIGHT - LIVING/DINING ROOM 12May22 Note:	
1 - PLUG - ELECTRICAL PLUG WITH GFI AND SWITCH - FOR FESTIVE LIGHTING 06Jul21 Note:	
1 - 200 AMP ELECTRICAL SERVICE 06Jul21 Note:	

FIREPLACE AND ACCESSORIES

1 - GAS LINE ROUGH-IN FOR BARBECUE 12May22 Note:	
1 - GAS LINE ROUGH-IN FOR STOVE (INCLUDES ELECTRICAL OUTLET) - FIRST FLOOR 12May22 Note:	

HARDWOOD FLOORING

1 - HARDWOOD - GROUP C SERIES 5 INCH - - SECOND FLOOR FLEX ROOM 12May22 Note:	
1 - HARDWOOD - GROUP C SERIES 5 INCH - - UPPER HALL 12May22 Note:	
1 - HARDWOOD - GROUP C SERIES 5 INCH - IN LIEU OF 2 1/4 INCH NATURAL RED OAK - - MAIN HALL 12May22 Note:	
1 - HARDWOOD - GROUP C SERIES 5 INCH - IN LIEU OF 2 1/4 INCH NATURAL RED OAK - - LIVING AND DINING ROOM 12May22 Note:	

CONSTRUCTION SUMMARY				
Mountainview Heights 3 (G) - Russell Gardens Building Ltd.				
PURCHASERS: Debashish ROY and Rinku CHOWDHURY			TEL: RES.: 647-236-2909	
LOT / PHASE	REG. PLAN #	HOUSE TYPE		
579 / 4	62M-1266	Springfield Four (4 Bedroom) Elev 2		
1 - HARDWOOD - GROUP C SERIES 5 INCH - IN LIEU OF 2 1/4 INCH NATURAL RED OAK - - LIBRARY/DEN				
12May22 Note:				
1 - HARDWOOD - GROUP C SERIES 5 INCH - IN LIEU OF 2 1/4 INCH NATURAL RED OAK - - FAMILY ROOM				
12May22 Note:				

MIRRORS AND GLASS

1 - MASTER ENSUITE – FRAMELESS GLASS SHOWER ENCLOSURE – INCLUDES CHROME KNOB AND HINGES	
06Jul21 Note:	

PAINTING

1 - THROUGHOUT - TRIM, BASEBAORDS, INTERIOR DOORS & FIREPLACE MANTEL - UPGRADE WHITE PAINT	
12May22 Note:	

PLASTER MOULDINGS

1 - CORNICE MOULDING - - FAMILY ROOM - INSTALL INSIDE COFFERED CEILING	
12May22 Note:	
1 - CORNICE MOULDING - - LIVING AND DINING ROOM	
12May22 Note:	
1 - CORNICE MOULDING - - FOYER AND MAIN HALL	
12May22 Note:	

PLUMBING

1 - ALL BATHROOMS - DELETE PLATE FROM STANDARD FAUCET - INSTALL WITH SINGLE HOLE INSTALLATION - IF CONSTRUCTION PERMITS	
12May22 Note:	
6 - SINK - UNDERMOUNT SINK - TECO BATH #4815 - ALL BATHROOMS	
12May22 Note:	
1 - SOAP DISPENSER - CHROME FINISH - MOEN S3946C - KITCHEN	
12May22 Note:	
1 - ADD TO MASTER ENSUITE SHOWER --MOEN 90 DEGREE POSI-TEMP SHOWER ONLY WITH 3 FUNCTION TRANSFER VALVE/TRIM AND SLIDE BAR WITH HAND SHOWER – CHROME #TS2712EP/U361CI/UTS4172/62320/S3879EP/A721	
06Jul21 Note:	
1 - BED 2 ENSUITE- ADD 5 FOOT SHOWER WITH SLIDING GLASS CHROME DOORS IN LIEU OF TUB	
06Jul21 Note:	
1 - WATER LINE FOR FRIDGE - ROUGH-IN ONLY	
06Jul21 Note:	
4 - TOE TESTER - ADD TOE TESTER TO SHOWER	
06Jul21 Note: IN ALL SHOWERS	

PROMOTIONAL

1 - LESS CREDIT FROM PURCHASER EXTRA SHEET IN OFFER	
06Jul21 Note:	

STAIRS AND RAILINGS

CONSTRUCTION SUMMARY

Mountainview Heights 3 (G) - Russell Gardens Building Ltd.

PURCHASERS: Debashish ROY and Rinku CHOWDHURY

TEL: RES.: 647-236-2909

LOT / PHASE	REG. PLAN #	HOUSE TYPE		
579 / 4	62M-1266	Springfield Four (4 Bedroom) Elev 2		
1 - STAINED STAIRS – STANDARD STAIRCASE - PRICE IS PER SET 12May22 Note:				
1 - STAIRCASE - V GROOVE HANDRAIL 12May22 Note:				
1 - STAIRCASE - EUROLINE 1 IRON PICKETS - BLACK 12May22 Note:				

EXTRAS AS PER OFFER

PURCHASER(S) ACKNOWLEDGES THAT THE PURCHASE PRICE IS INCLUSIVE OF ALL CREDITS AND PROMOTIONAL PACKAGES AVAILABLE AT TIME OF PURCHASE. Worksheet Note:	
(1) The Vendor agrees that notwithstanding any other term or provision in this Agreement included in the Purchase Price and in addition to those items detailed in Schedule GP to the Agreement of Purchase and Sale, the Purchaser is entitled to a credit of Worksheet Note:	
Granite kitchen counter top, from Vendor?s standard samples Worksheet Note:	
(8?6? Pour) If the Purchaser has purchased or been provided with an 8-foot 6-inch basement concrete pour (being an increase from the Vendor?s standard basement depth) the depth is measured from the top of footing to the top of foundation wall. The incre Worksheet Note:	

This Document is Extremely Time Sensitive - Printed 12 May 22 at 17:03

Purchasers: Debashish ROY & Rinku CHOWDHURY

Property: 579

Telephone Res. / Bus: (647) 236-2909 /

Project: Russell Gardens Building Ltd.

Decor Advisor: Candace Forza

Model and Elevation: Springfield Four (4 Bedroom) Elev 2

Lock Date: 12-May-22

12-May-22

Plan #: 62M-1266

Layout Changes: ☒ Yes ☐ No

Sketch Attached: ☒ Yes ☐ No

Exterior Colour Scheme:

1. Cabinetry

	Style and Colour	Hardware
Kitchen / Breakfast	RICHMOND 823 DRIFT WOOD	464SA
Laundry Room	ELISSE	Standard
Powder Room	MONACO 823 DRIFT WOOD	464SA
Master Ensuite Bathroom	MONACO 350 PLATINUM SILVER	464SA
Ensuite Bath - Bedroom 2	MONACO 821 INDUSTRIAL GRAPHITE	464SA
Ensuite Bath - Bedroom 3	MONACO 821 INDUSTRIAL GRAPHITE	464SA
Ensuite Bath - Bedroom 4	MONACO 823 DRIFT WOOD	464SA

Appliances:

Built In Appliances ☒ Yes ☐ No

Slide In Stove ☐ Yes ☒ No

Dishwasher Cabinet ☐ Closed ☒ Open

41" Upper Cabinets ☒ Yes ☐ No

Please NOTE: Standard Cabinet Height is 30"

Stove Opening

NOTE: If not specified, opening will be set to builder's standard opening of approximately 30" width

Fridge Opening

NOTE: If not specified, opening will be set to builder's standard opening of approximately 37" width x 74" height

** Refer to Construction Summary

2. Counters

	Counter	Edge
Kitchen / Breakfast	QUARTZ-CALACATTA WAVE	#360 EDGE
Laundry Room	N/A	
Powder Room	QUARTZ-VERMONT	#360 EDGE
Master Ensuite Bathroom	QUARTZ-VEGA	#360 EDGE
Ensuite Bath - Bedroom 2	QUARTZ-GRECALE	#360 EDGE
Ensuite Bath - Bedroom 3	QUARTZ-GRECALE	#360 EDGE
Ensuite Bath - Bedroom 4	QUARTZ-LYSKAMM	#360 EDGE

** Refer to Construction Summary

Initials:  

Purchasers: Debashish ROY & Rinku CHOWDHURY

Telephone Res. / Bus: (647) 236-2909 /

Decor Advisor: Candace Forza

Lock Date: 12-May-22

Property: 579

Project: Russell Gardens Building Ltd.

Model and Elevation: Springfield Four (4 Bedroom) Elev 2

Plan #: 62M-1266

3. Ceramic Flooring

		At a 45	Threshold-If App.
Entrance Vestibule	TILE-DOZZA WHITE-24X24	<input type="checkbox"/>	metal strip where applicable
Main Hall	STRIP	<input type="checkbox"/>	
Kitchen / Breakfast	TILE-DOZZA WHITE-24X24	<input type="checkbox"/>	
Laundry Room	TILE-UNISTONE 609 WHITE-13X13	<input type="checkbox"/>	
Powder Room	TILE-DOZZA WHITE-24X24	<input type="checkbox"/>	
Master Ensuite Bathroom	TILE-RMD STATUARIO BRILL-10X30	<input type="checkbox"/>	
Ensuite Bath - Bedroom 2	TILE-RAINBOW LIGHT GREY-13X13	<input type="checkbox"/>	
Ensuite Bath - Bedroom 3	TILE-RAINBOW LIGHT GREY-13X13	<input type="checkbox"/>	
Ensuite Bath - Bedroom 4	TILE-CONCEPT GREY-13X13	<input type="checkbox"/>	
Mud Room	TILE-GARDA GREY-13X13	<input type="checkbox"/>	

** Refer to Construction Summary

4. Ceramic Wall Tile

Master Ensuite Bathroom	Selection	Describe
Tub Deck Wall	N/A	
Tub Deck	N/A	
Tub Deck Skirt	N/A	
Shower Stall	TILE-RMD STATUARIO BRILL-10X30	
Bathtub Enclosure Walls	N/A	
Ensuite Bath - Bedroom 2	TILE-SILVIA WHITE-8X16	
Ensuite Bath - Bedroom 3	TILE-SILVIA WHITE-8X16	
Ensuite Bath - Bedroom 4	TILE-SILVIA WHITE-8X16	
Mud Room	N/A	
Kitchen Backsplash	N/A	

** Refer to Construction Summary - STANDARD GROUT THROUGHOUT UNLESS SPECIFIED

5. Plumbing Fixtures

All Bathrooms

White

N/A

N/A

N/A

N/A

N/A

Whirlpool

N/A

Yes

No

Dishwasher Rough-In

Yes

No

Waterline for Fridge

Yes

No

** Refer to Construction Summary

6. Trim Carpentry

Interior Doors	CARRARA-SMOOTH
Interior Trim	BB CASING WITH 7 1/4" BASEBOARD - ONE STEP
Door Handles	As Per Construction Specifications
Exterior Front Door Handle	As Per Construction Specifications

** Refer to Construction Summary

Initials:  

Purchasers:Debashish ROY & Rinku CHOWDHURY

Property: 579

Telephone Res. / Bus: (647) 236-2909 /

Project: Russell Gardens Building Ltd.

Decor Advisor: Candace Forza

Model and Elevation: Springfield Four (4 Bedroom) Elev 2

Lock Date: 12-May-22

12-May-22

Plan #: 62M-1266

7. Other Flooring

Main Hall	STRIP-VINTAGE-NSS-SCULPTED-CHARACTER-UVF-MAPLE-PEGASUS-5"
Living Room	STRIP-VINTAGE-NSS-SCULPTED-CHARACTER-UVF-MAPLE-PEGASUS-5"
Dining Room	STRIP-VINTAGE-NSS-SCULPTED-CHARACTER-UVF-MAPLE-PEGASUS-5"
Family Room	STRIP-VINTAGE-NSS-SCULPTED-CHARACTER-UVF-MAPLE-PEGASUS-5"
Den / Library / Study	STRIP-VINTAGE-NSS-SCULPTED-CHARACTER-UVF-MAPLE-PEGASUS-5"
Basement Landing(If Applies)	N/A
Lower Landing (If Applies)	STRIP-VINTAGE-NSS-SCULPTED-CHARACTER-UVF-MAPLE-PEGASUS-5"
Upper Landing	STRIP-VINTAGE-NSS-SCULPTED-CHARACTER-UVF-MAPLE-PEGASUS-5"
Upper Hall	STRIP-VINTAGE-NSS-SCULPTED-CHARACTER-UVF-MAPLE-PEGASUS-5"
Master Bedroom	CARPET - STYLE ME E0688-FOSSIL 106
Bedroom #2	CARPET - STYLE ME E0688-FOSSIL 106
Bedroom #3	CARPET - STYLE ME E0688-FOSSIL 106
Bedroom #4	CARPET - STYLE ME E0688-FOSSIL 106
Bedroom #5	N/A
FLEX ROOM	STRIP-VINTAGE-NSS-SCULPTED-CHARACTER-UVF-MAPLE-PEGASUS-5"

Underpad

Type

Area

SPILLGAURD UNDERPAD

BEDROOMS ONLY

** Refer to Construction Summary

8. Railings and Pickets

Railing Type	V-GROOVE	Complimenting Colour	VINTAGE PEGASUS
Picket Type	EUROLINE 1	Complimenting Colour	BLACK
Stringer / Riser	AS PER CONSTRUCTION SPECIFICATIO	Complimenting Colour	VINTAGE PEGASUS
Treads	AS PER CONSTRUCTION SPECIFICATIO	Complimenting Colour	VINTAGE PEGASUS

Red Oak Stairs ☒ Yes ☐ No

** Refer to Construction Summary THE STAIN COLOURS OR FINISH AVAILABLE ON RISERS, TREADS, PICKETS AND RAILS (STAIRCASES), WILL NOT BE AN EXACT MATCH TO PREFINISHED HARDWOOD OR LAMINATE FLOORS.

9. Wall Paint Flat Finish

Main & Upper Hall	22 WARM GREY	Master Bedroom	22 WARM GREY
Living Room	22 WARM GREY	Bedroom #2	22 WARM GREY
Dining Room	22 WARM GREY	Bedroom #3	22 WARM GREY
Kitchen / Breakfast	22 WARM GREY	Bedroom #4	22 WARM GREY
Family Room	22 WARM GREY	Bedroom #5	N/A
Powder Room	22 WARM GREY	Master Ensuite	22 WARM GREY
Laundry Room	22 WARM GREY	Ensuite Bath - Bedroom 2	22 WARM GREY
Den/Library	22 WARM GREY	Ensuite Bath - Bedroom 3	22 WARM GREY
Trim & Door Paint-Semi Gloss	WHITE	Ensuite Bath - Bed 4	22 WARM GREY
		Flex Room	22 WARM GREY

Smooth Ceilings First Floor ☒ Yes ☐ No

** Refer to Construction Summary

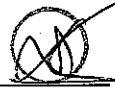
Initials:  

Purchasers: Debashish ROY & Rinku CHOWDHURY

Property: 579

Telephone Res. / Bus: (647) 236-2909 /

Project: Russell Gardens Building Ltd.

Decor Advisor: Candace Forza

Model and Elevation: Springfield Four (4 Bedroom) Elev 2

Lock Date: 12-May-22

12-May-22

Plan #: 62M-1266

10. Plaster Mouldings and Medallions

Entrance Vestibule	UP175	N/A	Kitchen/Breakfast	N/A	N/A
Main Hall	UP175	N/A	Den/Library	N/A	N/A
Living Room	UP175	N/A	Lower Landing	N/A	N/A
Dining Room	UP175	N/A		N/A	N/A
Family Room	UP175	N/A			

** Refer to Construction Summary

11. Fireplace

Living Room			Family Room			Other Room - Specify		
Purchased	As Per Plan	N/A	Purchased	As Per Plan	N/A	Purchased	As Per Plan	N/A
<input type="radio"/>	<input type="radio"/>	<input checked="" type="radio"/>	<input type="radio"/>	<input checked="" type="radio"/>	<input type="radio"/>	<input type="radio"/>	<input type="radio"/>	<input checked="" type="radio"/>
Fireplace Type	N/A		FLAT ON WALL			N/A		
Mantle Type	N/A		MANTLE M1-STANDARD			N/A		
Colour / Stain	N/A		AS PER CONSTRUCTION SPECIFICATIONS			N/A		
Surround	N/A		NERO			N/A		
Hearth	N/A		NO			N/A		

** Refer to Construction Summary

12. Heating and Air Conditioning

Air Conditioning	NO	Gas Provisions Stove	YES
Gas Provisions Dryer	NO	Gas Provisions Barbecue	YES
Comment			

** Refer to Construction Summary

13. Electrical

Plugs and Switches	<input checked="" type="radio"/> White	DECOR	Above Kitchen Cabinet Light	<input type="radio"/> Yes <input checked="" type="radio"/> No
Hood Fan	STANDARD WHITE		Below Kitchen Cabinet Light	<input type="radio"/> Yes <input checked="" type="radio"/> No
Appliances	Built in Cooktop	Built in Oven	Gas Stove	Microwave
	<input checked="" type="radio"/> Yes <input type="radio"/> No	<input checked="" type="radio"/> Yes <input type="radio"/> No	<input checked="" type="radio"/> Yes <input type="radio"/> No	<input checked="" type="radio"/> Yes <input type="radio"/> No
Dishwasher Rough-in	Yes			

** Refer to Construction Summary

14. General Comments

** Refer to Construction Summary

Disclaimers and Notes

- 1) Colours of all materials are as close as possible to builder's selection, but not necessarily identical due to variances in manufacturing.

2) Any extras listed above are null and void unless accompanied by a separate invoice/amendment. Said invoice must be paid in full.

3) The Purchaser agrees that this colour selection is final and that no changes will be permitted, unless required by the Vendor.

4) The Purchaser acknowledges reading and accepting document which contains other miscellaneous disclaimers.

5) In the event of a conflict between the Standard Features schedule of the Agreement of Purchase and Sale and the Interior Colour Scheme, the Interior Colour Scheme shall prevail.

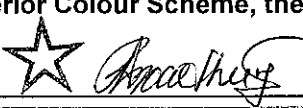
Signature: 

Date: May 12, 2022

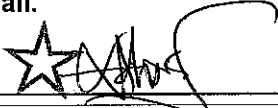
Signature: 

Date: May 12, 2022

Page 4 of 4

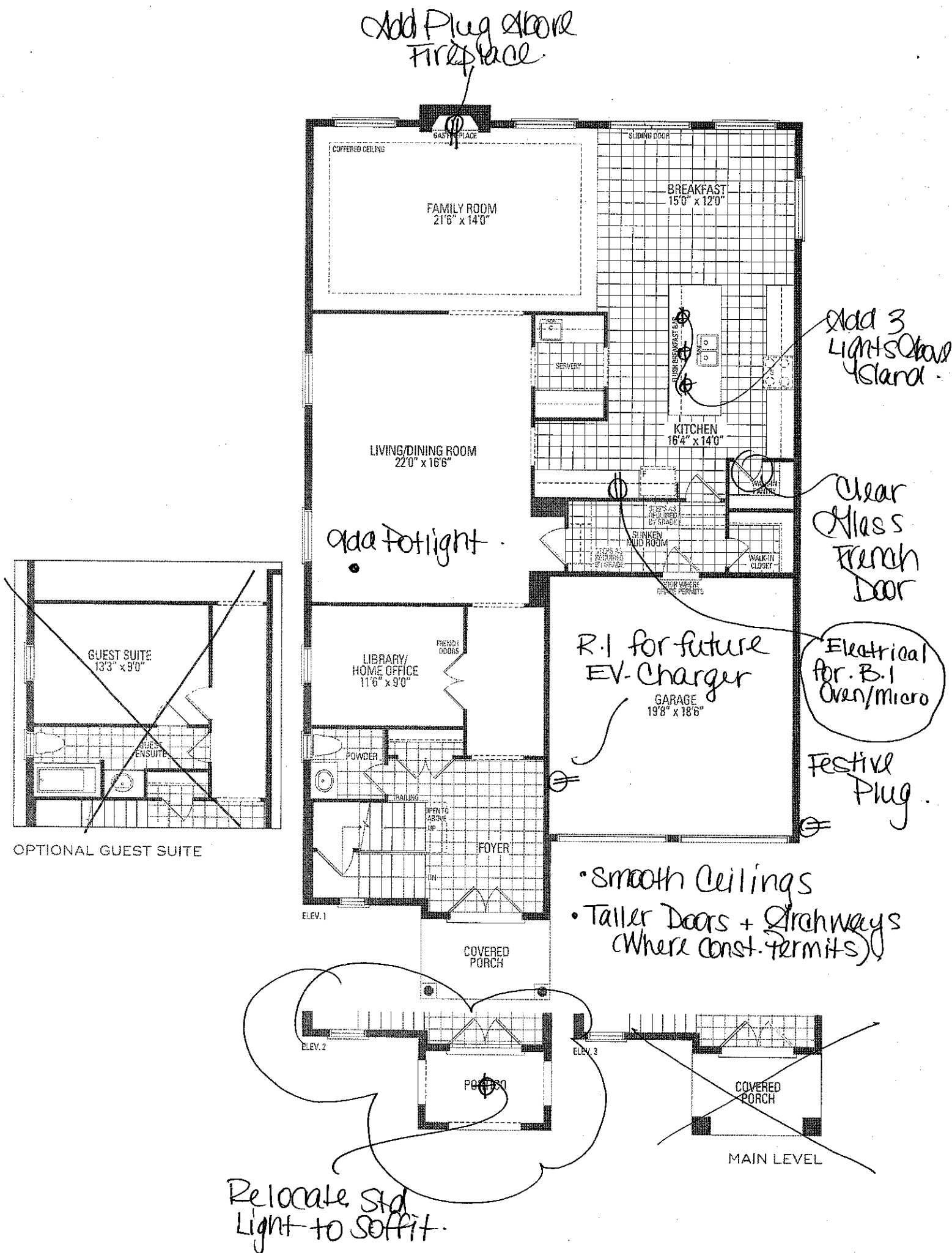

SPRINGFIELD FOUR ELEV. 1 • 4,080

Orientation of home may be reversed and purchaser agrees to accept same. Steps and porches may vary stated floor areas. All renderings are artist's concept. Dimensions, specifications and architectural detailing

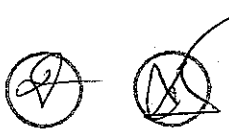

579-Russell
Gardens
Ph-4.

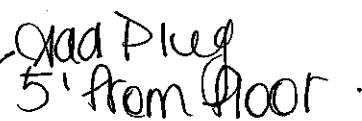

5' Shower
in lieu of
tub.

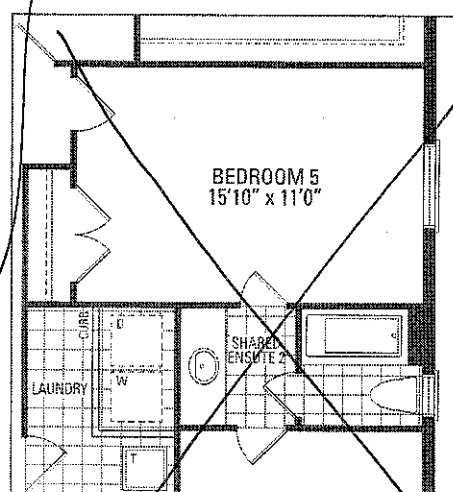

OPTIONAL 5 BEDROOM

Delete Door
to flex room
+ provide wall

Has Line R.1
for BPO.

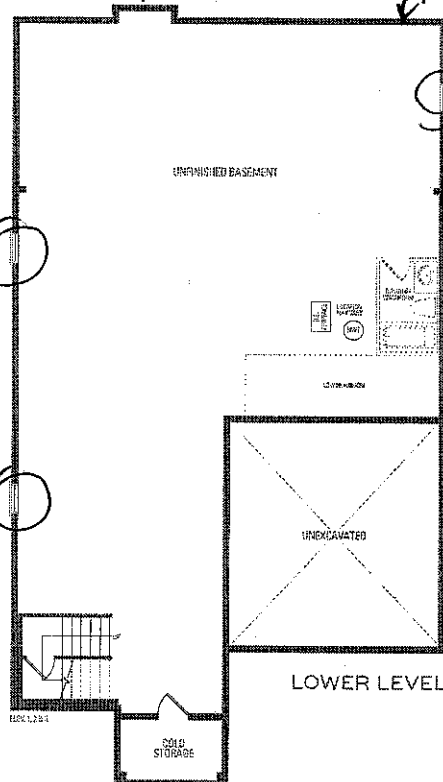

Window Deleted

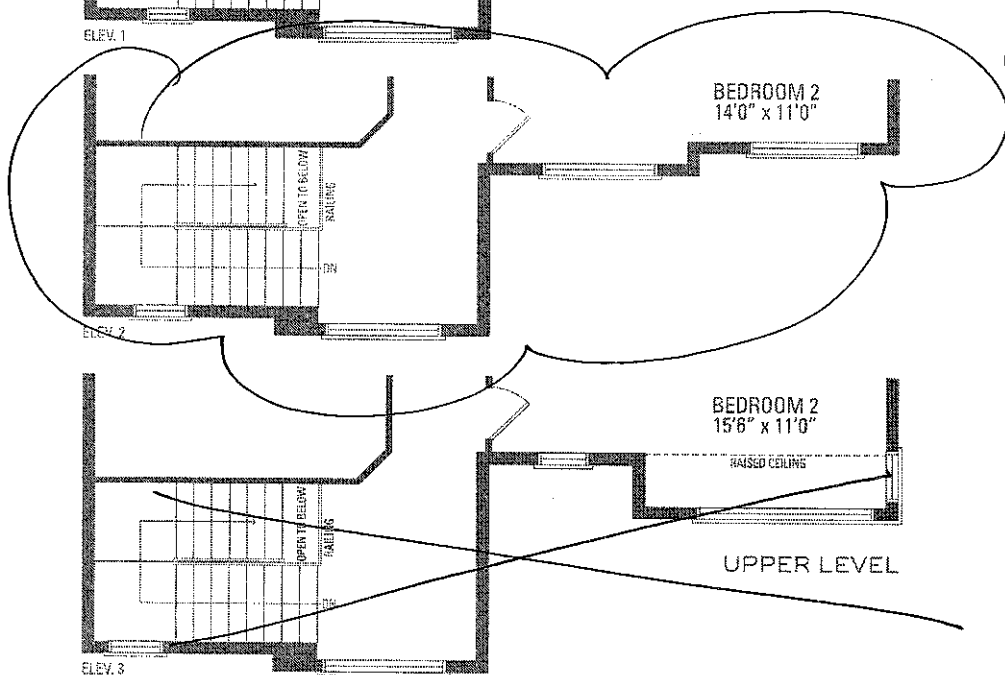

- Walk-Out Basement +
- 8'6" floor
- 200 AMP
- Enlarge 2 Basement Windows



0 sq.ft. | ELEV. 2 - 4,062 sq.ft. | ELEV. 3 - 4,082 sq.ft.

ary at any exterior entrance ways due to grading variance. Actual usable floor space may vary from the
ing subject to modifications. Roofline and adjoining model types may vary due to siding. E. & O.E. May 2021

W310800	W310800	W310800	W310800	W310800
B800	B800	B800	B800	B800
BC	BC	BC	BC	BC

• 479.1 Richmond
Cabinetry
• Light Valance

pot + tan
drawers

Full Depth
Fridge Upers
w/ Stable.
Built-In
Fridge.

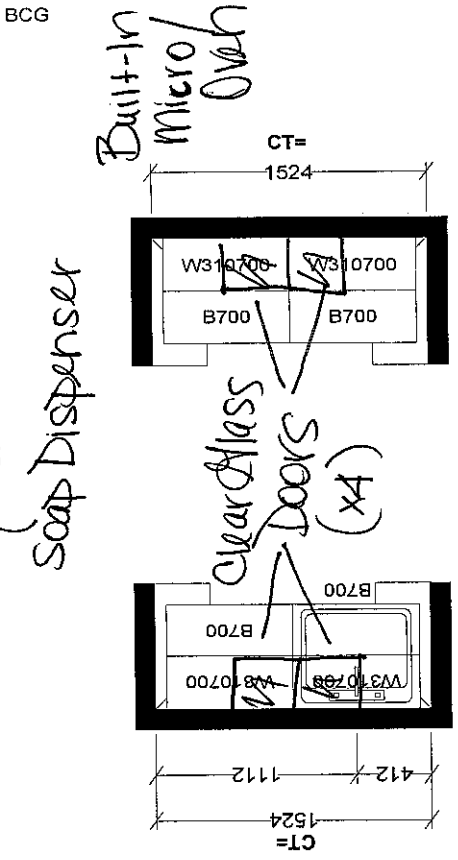
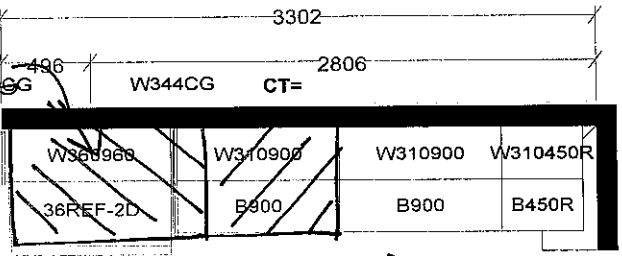
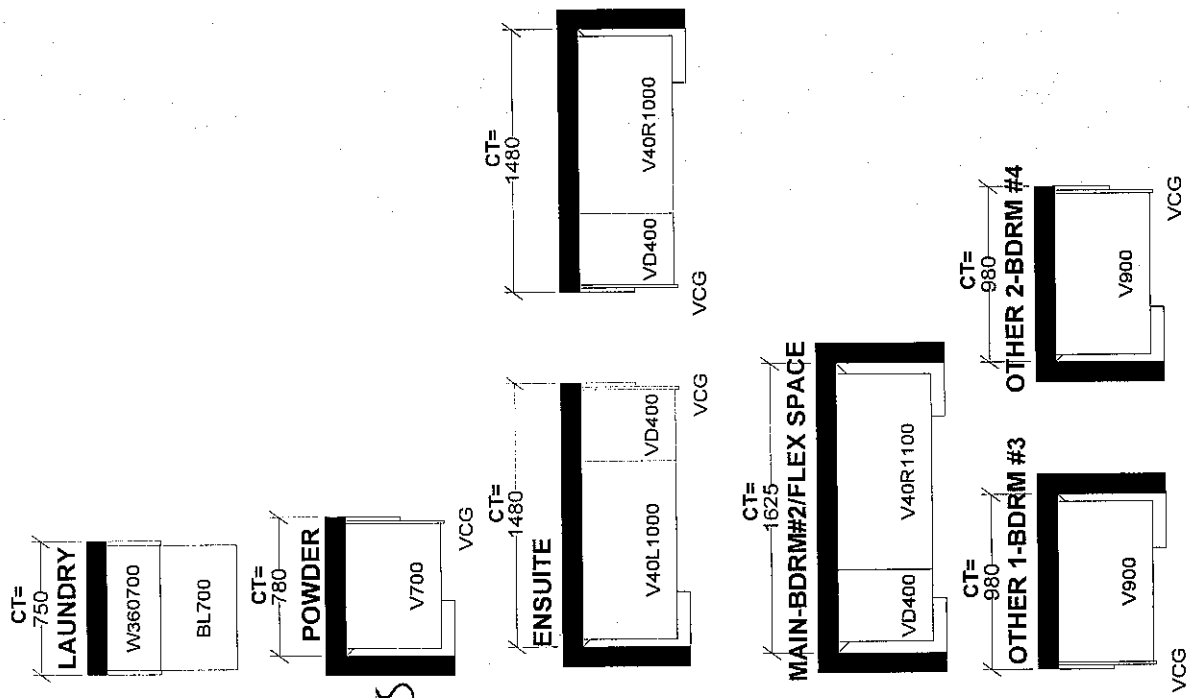

Selba Industries		J #	
<small>This drawing is the intellectual property of SELBA INDUSTRIES INC. and is an original design which must not be re-used, or copied unless applicable fee has been paid or job order placed.</small>			
W WIDTH	W HIGHT	W CNT	JOB NUMBER:
FLOOR HIGHT	DOOR HIGHT		BUILDER: GREENPARK
ST CENT	2X4	VENT BOX COVER	SITE: RUSSELL GARDENS PH.4
			MODEL: SPRINGFIELD 4X EL 1, 2, 3
			LOT #:
			DESIGNER: LF
			DATE: APR 28 21

Purchaser: Roy + Chowdhury.
Lot: 579.0

Schedule SMART
Russell Gardens Building Ltd. (Phase 4)

Smart Home System includes:

1. One (1) Smart Home Hub installed in a location as determined by the Vendor;
2. One (1) Doorbell camera supplied and installed at front door;
3. One (1) smart home thermostat to be installed in a location as determined by the Vendor;
4. One (1) smart Flood sensor to be installed in a location as determined by the Vendor which is designed to detect water in the location of the sensor only;
5. Smart light switches to be installed in such locations as determined by the Vendor;



Certain devices for The Smart Home System require a fully functioning WiFi network and internet connection and others work on the Zwave wireless network. Provision of WiFi, internet access and functionality shall be the sole responsibility of the Purchaser and the Vendor assumes no responsibility or obligation with respect to the functionality or performance of a homeowner's internet or WiFi network. The Vendor does not guarantee that networks, equipment, or services will meet all homeowner needs.

The Purchaser will be required to download the Homewave Smart Connect App (the "App") in order to configure and set up the Smart Home System devices. The Purchaser is responsible to ensure that they have the appropriate technology to download the App and any charges and fees for download and/or data usage shall be at the Purchaser's sole cost and expense. Access to the App shall be provided free of charge for 1 year from the Closing Date and thereafter the Purchaser may enter into an agreement with Homewave Smart Connect to continue the services for a monthly fee (currently \$10.00/month plus HST). Fees subject to change without notice.

Purchasers are responsible for configuring all security features. The Vendor does not warrant or represent that any network or Smart Home System devices are secure or can prevent all privacy intrusions, malware, or cyber-attacks, even when correctly configured. The products and services for the Smart Home System are provided by third parties, and not the Vendor. The Vendor does not guarantee any equipment or services provided by third parties. If the Purchaser contracts with the third-party provider to upgrade or purchase further devices, the Vendor has no responsibility for same, including but not limited to, the installation, service, safety or functionality of said products.

Energy claims are not based upon specific testing of an individual home but are general assumptions. Savings will vary due to many variables, including but not limited to, actual utility rates and fees, actual construction, floor plan, occupancy, appliance usage, thermostat settings, weather conditions, number of individuals occupying the home and orientation of the home.

The Vendor is providing only those Smart Home System's devices and components listed in this Schedule. Please see the balance of your Agreement of Purchase and Sale for additional information, disclosures, and disclaimers relating to your home and its features. The specific features in a home may vary from home to home and from one community to another. The Vendor reserves the right to substitute equipment, material, appliances and brand names with items of equal or higher value, in its sole and unfettered discretion. The Vendor reserves the right, in its sole and absolute discretion, to omit installation of the Smart Home System, in part or in whole, and the Purchaser shall have no claim for abatement or reduction the Purchase Price or to any delay in closing. Installation of the Smart Home System may result in the elimination of other features listed in Schedule GP or other information material, such as but not limited to set back thermostat, rough-in for alarm or other features deemed redundant as a result of the installation of the Smart Home System.

Purchaser Initials 	Purchaser Initials 
----------------------------------------------------------------------------------------------------------------	----------------------------------------------------------------------------------------------------------------