

CONSTRUCTION SUMMARY		RECEIVED
Mountainview Heights 3 (G) - Russell Gardens Building Ltd.		MAY - 5 2022
PURCHASER: 2816098 ONTARIO INC.		TEL:

LOT / PHASE	REG. PLAN #	HOUSE TYPE		
538 / 4	62M-1266	Valleycreek Twelve A Elev 3		

CABINETRY

1 - KITCHEN - DELETE CABINETS ABOVE STOVE - VENDOR WILL SUPPLY 6 INCH VENT AS PER CONSTRUCTION SPECIFICATIONS AND VENT MAY NOT BE IN THE APPROPRIATE LOCATION FOR INSTALLATION OF PURCHASER SUPPLIED VENT - PURCHASER TO SUPPLY OWN FAN AFTER CLOSING 22Apr22 Note: TEMPORARY HOOD FAN MAY BE PROVIDED	
---	--

CABINETRY ACCESSORIES

1 - PANTRY UNIT UPGRADE - TO GO FROM 300MM TO 600MM DEEP - STANDARD 22Apr22 Note:	
1 - KITCHEN CABINETRY UPPER - FULL DEPTH ABOVE FRIDGE - WITH GABLES - 600MM - PRICE IS EACH - STANDARD 22Apr22 Note:	
1 - KITCHEN CABINETRY - BUILT-IN MICROWAVE/OVEN COMBO - STANDARD 22Apr22 Note:	
1 - KITCHEN CABINETRY BASE - COOKTOP CABINET WITH POT DRAWERS (2 DRAWERS) - STANDARD 22Apr22 Note:	

CERAMIC TILE

1 - TILE - UPGRADE 1 FLOOR TILE - - LAUNDRY ROOM - 2ND FLOOR - FLOOR 22Apr22 Note:	
1 - DELETE ALL CERAMIC BATHROOM ACCESSORIES - DELETE TOWEL BAR, PAPER HOLDER & SOAP DISH THROUGHOUT 22Apr22 Note:	
1 - TILE - UPGRADE 1 FLOOR TILE - - BATHROOM 4 - FLOOR 22Apr22 Note:	
1 - TILE - UPGRADE 1 WALL TILE - - BATHROOM 4 - SHOWER 22Apr22 Note:	
1 - TILE - UPGRADE 1 WALL TILE - - BATHROOM 2/3 - TUB AREA 22Apr22 Note:	
1 - TILE - UPGRADE 1 FLOOR TILE - - BATHROOM 2/3 - FLOOR 22Apr22 Note:	
1 - TILE - UPGRADE 3 WALL TILE - - ENSUITE WALL TILE - SHOWER 22Apr22 Note:	
1 - TILE - UPGRADE 3 FLOOR TILE - - ENSUITE BATHROOM - FLOOR 22Apr22 Note:	
1 - TILE - UPGRADE 4 FLOOR TILE - - POWDER ROOM 22Apr22 Note:	
1 - TILE - UPGRADE 4 FLOOR TILE - - MUD ROOM 22Apr22 Note:	

CONSTRUCTION

1 - MASTER ENSUITE BATHROOM - DELETE WALL ABOVE SEAT TO ACCOMMODATE FRAMELESS GLASS SHOWER ENCLOSURE 02May22 Note:	
1 - SMOOTH CEILINGS ON FIRST FLOOR ONLY - DET 22Apr22 Note:	

COUNTER TOP

1 - KITCHEN - ISLAND - HIGH-END QUARTZ - WATERFALL LEGS ON BOTH SIDES 22Apr22 Note:	
--	--

CONSTRUCTION SUMMARY				
Mountainview Heights 3 (G) - Russell Gardens Building Ltd.				
PURCHASER: 2816098 ONTARIO INC.				TEL:
LOT / PHASE 538 / 4	REG. PLAN # 62M-1266	HOUSE TYPE Valleycreek Twelve A Elev 3		
1 - UPGRADE COUNTERTOP MATERIAL Full Height Backsplash - Kitchen - INCLUDES BEHIND CHIMENY HOOD 22Apr22 Note:				
1 - UPGRADE QUARTZ COUNTERTOP IN LIEU OF STANDARD AS PER OFFER - KITCHEN 22Apr22 Note:				

DOORS AND TRIM

1 - TRIM - UPGRADE 2- 7-¼” BASEBOARD AND 3” CASING 22Apr22 Note:	
--	--

ELECTRICAL

1 - BUILT IN OVEN AND COOKTOP PROVISION - PROVISION ONLY - ELECTRICAL ONLY 22Apr22 Note:	
1 - 200 AMP ELECTRICAL SERVICE - IF CONSTRUCTION PERMITS 22Apr22 Note:	
1 - PLUG - ELECTRICAL PLUG WITH GFI AND SWITCH - FOR FESTIVE LIGHTING 22Apr22 Note: SEE SKETCH FOR LOCATION	
1 - PLUG - ELECTRICAL PLUG - TO BE INSTALLED OVER FIREPLACE 22Apr22 Note:	
1 - RELOCATE STANDARD KITCHEN LIGHT TO BE CENTERED OVER ISLAND 22Apr22 Note:	

FIREPLACE AND ACCESSORIES

1 - MANTEL - PAINTED - M6 - IN LIEU OF STANDARD MANTEL 22Apr22 Note:	
--	--

HARDWOOD FLOORING

1 - HARDWOOD - GROUP B SERIES 6 1/2 INCH - IN LIEU OF STANDARD TILE- KITCHEN & BREAKFAST 22Apr22 Note:	
1 - HARDWOOD - GROUP B SERIES 6 1/2 INCH - IN LIEU OF STANDARD TILE - FOYER 22Apr22 Note:	
1 - HARDWOOD - GROUP B SERIES 6 1/2 INCH - IN LIEU OF 2 1/4 INCH NATURAL RED OAK - - LIBRARY/DEN 22Apr22 Note:	
1 - HARDWOOD - GROUP B SERIES 6 1/2 INCH - IN LIEU OF 2 1/4 INCH NATURAL RED OAK - - FAMILY ROOM 22Apr22 Note:	
1 - HARDWOOD - GROUP B SERIES 6 1/2 INCH - IN LIEU OF 2 1/4 INCH NATURAL RED OAK - - DINING ROOM 22Apr22 Note:	

MIRRORS AND GLASS

1 - MASTER ENSUITE – FRAMELESS GLASS SHOWER ENCLOSURE – INCLUDES CHROME KNOB AND HINGES 22Apr22 Note:	
---	--

PLUMBING

1 - WATER LINE FOR FRIDGE - ROUGH-IN ONLY 22Apr22 Note:	
1 - MASTER ENSUITE BATHROOM – RELOCATE PLUMBING TO ACCOMMODATE FRAMELESS SHOWER ENCLOSURE 22Apr22 Note:	
1 - MOEN BATHROOM ACCESSORIES - MASON CHROME - TOWEL RING #YB8086 - POWDER ROOM 22Apr22 Note:	

CONSTRUCTION SUMMARY				
Mountainview Heights 3 (G) - Russell Gardens Building Ltd.				
PURCHASER: 2816098 ONTARIO INC.				TEL:
LOT / PHASE 538 / 4	REG. PLAN # 62M-1266	HOUSE TYPE Valleycreek Twelve A Elev 3		
3 - MOEN BATHROOM ACCESSORIES - MASON CHROME - TOWEL BAR 24" #YB8094/YB8000 - ENSUITE BATHROOMS ONLY 22Apr22 Note:				
4 - MOEN BATHROOM ACCESSORIES - MASON CHROME - PAPER HOLDER #YB8099/YB8000 - ALL BATHROOMS 22Apr22 Note:				
2 - TOE TESTER - ADD TOE TESTER TO SHOWER - MASTER ENSUITE & ENSUITE 4 BATHROOM - IF CONSTRUCTION PERMITS 22Apr22 Note:				

PROMOTIONAL

1 - LESS BALANCE OF CREDIT FROM PURCHASER EXTRA SHEET IN OFFER 22Apr22 Note:	
---	--

STAIRS AND RAILINGS

1 - STAINED STAIRS – STANDARD STAIRCASE - PRICE IS PER SET 22Apr22 Note:	
1 - STAIRCASE - V GROOVE HANDRAIL 22Apr22 Note:	
1 - STAIRCASE - EUROLINE 0 IRON PICKETS - BLACK 22Apr22 Note:	

EXTRAS AS PER OFFER

(1) The Vendor agrees that notwithstanding any other term or provision in this Agreement included in the Purchase Price and in addition to those items detailed in Schedule GP to the Agreement of Purchase and Sale, the Purchaser is entitled to a credit of Worksheet Note:	
Purchase Price includes a walk up from the basement to the rear of the dwelling unit, and the obligation to construct the house with the walk up is subject to the Vendor?s approval, in its sole and unfettered discretion. The Purchaser acknowledges and ag Worksheet Note:	
PURCHASER(S) ACKNOWLEDGES THAT THE PURCHASE PRICE IS INCLUSIVE OF ALL CREDITS AND PROMOTIONAL PACKAGES AVAILABLE AT TIME OF PURCHASE. Worksheet Note:	
Granite kitchen counter top, from Vendor?s standard samples Worksheet Note:	

This Document is Extremely Time Sensitive - Printed 2 May 22 at 15:10

Purchaser:2816098 ONTARIO INC.

Property: 538

Telephone Res. / Bus: /

Project: Russell Gardens Building Ltd.

Decor Advisor: Candace Forza

Model and Elevation: Valleycreek Twelve A Elev 3

Lock Date: 22-Apr-22

22-Apr-22

Plan #: 62M-1266

Layout Changes: ☒ Yes ☐ No

Sketch Attached: ☒ Yes ☐ No

Exterior Colour Scheme:

1. Cabinetry

	Style and Colour	Hardware
Kitchen / Breakfast	DORAL W-500	465SA
Laundry Room	ELISSE	Standard
Powder Room	MONACO 350 PLATINUM SILVER	468SA
Master Ensuite Bathroom	DORAL W-500	631SB
Ensuite Bath - Bedroom 2/3	DORAL W-500	467SA
Ensuite Bath - Bedroom 4	DORAL W-500	467SA
	N/A	N/A
	N/A	N/A
	N/A	N/A

Appliances:

Built In Appliances ☒ Yes ☐ No

Slide In Stove ☐ Yes ☒ No

Dishwasher Cabinet ☐ Closed ☒ Open

41" Upper Cabinets ☒ Yes ☐ No

Please NOTE: Standard Cabinet Height is 30"

Stove Opening

NOTE: If not specified, opening will be set to builder's standard opening of approximately 30" width

Fridge Opening

NOTE: If not specified, opening will be set to builder's standard opening of approximately 37" width x 74" height

** Refer to Construction Summary

2. Counters

	Counter	Edge
Kitchen / Breakfast	QUARTZ-MISTRAL	#360
Laundry Room	N/A	
Powder Room	LAMINATE-PALOMA POLAR 6698-46	
Master Ensuite Bathroom	LAMINATE-BLACK ALICANTE 4926K-07	
Ensuite Bath - Bedroom 2/3	LAMINATE-WHITE CARRARA 4924-38	
Ensuite Bath - Bedroom 4	LAMINATE-WHITE CARRARA 4924-38	
	N/A	
	N/A	
	N/A	

KITCHEN - ISLAND - WATERFALL LEGS - QUARTZ-MISTRAL** Refer to Construction Summary

Initial: 

Page 1 of 4

Printed 4/22/2022 14:48:59

Purchaser:

2816098 ONTARIO INC.

Telephone Res. / Bus:

/

Decor Advisor:

Candace Forza

Lock Date:

22-Apr-22

Property:

538

Project:

Russell Gardens Building Ltd.

Model and Elevation:

Valleycreek Twelve A Elev 3

Plan #:

62M-1266

3. Ceramic Flooring

		At a 45	Threshold-If App.
Entrance Vestibule	STRIP	<input type="checkbox"/>	metal strip where applicable
Main Hall	N/A	<input type="checkbox"/>	
Kitchen / Breakfast	STRIP	<input type="checkbox"/>	
Laundry Room	TILE-STONE DARK GREY-12X24	<input type="checkbox"/>	
Powder Room	TILE-VARENNA CARRARA-24X24	<input type="checkbox"/>	
Master Ensuite Bathroom	TILE-RDM NERO REALA BRILL-10X30	<input type="checkbox"/>	
Ensuite Bath - Bedroom 2/3	TILE-STONE DARK GREY-12X24	<input type="checkbox"/>	
Ensuite Bath - Bedroom 4	TILE-STONE DARK GREY-12X24	<input type="checkbox"/>	
MUD ROOM	TILE-VARENNA CARRARA-24X24	<input type="checkbox"/>	
	N/A	<input type="checkbox"/>	
	N/A	<input type="checkbox"/>	

** Refer to Construction Summary

4. Ceramic Wall Tile

Master Ensuite Bathroom	Selection	Describe
Tub Deck Wall	N/A	
Tub Deck	N/A	
Tub Deck Skirt	N/A	
Shower Stall	TILE-RDM NERO REALA BRILL-10X30	
Bathtub Enclosure Walls	N/A	
Ensuite Bath - Bedroom 2/3	TILE-STONE WHITE-12X24	
Ensuite Bath - Bedroom 4	TILE-STONE WHITE-12X24	
MUD ROOM	N/A	
	N/A	
	N/A	
Kitchen Backsplash	QUARTZ-MISTRAL	FULL HEIGHT

** Refer to Construction Summary - STANDARD GROUT THROUGHOUT UNLESS SPECIFIED

5. Plumbing Fixtures

All Bathrooms

White

N/A

N/A

N/A

N/A

N/A

Whirlpool

N/A

Yes

No

Dishwasher Rough-In

Yes

No

Waterline for Fridge

Yes

No

** Refer to Construction Summary

6. Trim Carpentry

Interior Doors	CARRARA-SMOOTH
Interior Trim	3" BB CASING WITH 7 1/4" BASEBOARD - COLONIAL
Door Handles	As Per Construction Specifications
Exterior Front Door Handle	As Per Construction Specifications

** Refer to Construction Summary



Initial: _____

Purchaser:2816098 ONTARIO INC.

Telephone Res. / Bus: /

Decor Advisor:Candace Forza

Lock Date:22-Apr-22

Property: 538

Project: Russell Gardens Building Ltd.

Model and Elevation: Valleycreek Twelve A Elev 3

Plan #: 62M-1266

7. Other Flooring

Main Hall	N/A
Living Room	N/A
Dining Room	STRIP-VINTAGE-NSS-WIRE BRUSHED-CHARACTER-UV URETHANE OIL-WHITE OAK-ATLANTIS-6 1/2"
Family Room	STRIP-VINTAGE-NSS-WIRE BRUSHED-CHARACTER-UV URETHANE OIL-WHITE OAK-ATLANTIS-6 1/2"
Den / Library / Study	STRIP-VINTAGE-NSS-WIRE BRUSHED-CHARACTER-UV URETHANE OIL-WHITE OAK-ATLANTIS-6 1/2"
Basement Landing(If Applies)	N/A
Lower Landing (If Applies)	STRIP-VINTAGE-NSS-WIRE BRUSHED-CHARACTER-UV URETHANE OIL-WHITE OAK-ATLANTIS-6 1/2"
Upper Landing	STRIP-VINTAGE-NSS-WIRE BRUSHED-CHARACTER-UV URETHANE OIL-WHITE OAK-ATLANTIS-6 1/2"
Upper Hall	LAMINATE-LEXINGTON-BRUSSELS OAK-TL-LW1316
Master Bedroom	LAMINATE-LEXINGTON-BRUSSELS OAK-TL-LW1316
Bedroom #2	LAMINATE-LEXINGTON-BRUSSELS OAK-TL-LW1316
Bedroom #3	LAMINATE-LEXINGTON-BRUSSELS OAK-TL-LW1316
Bedroom #4	LAMINATE-LEXINGTON-BRUSSELS OAK-TL-LW1316
Bedroom #5	N/A
FOYER	STRIP-VINTAGE-NSS-WIRE BRUSHED-CHARACTER-UV URETHANE OIL-WHITE OAK-ATLANTIS-6 1/2"
KITCHEN & BREAKFAST	STRIP-VINTAGE-NSS-WIRE BRUSHED-CHARACTER-UV URETHANE OIL-WHITE OAK-ATLANTIS-6 1/2"
	N/A
Underpad	TypeArea
	N/AN/A

** Refer to Construction Summary

8. Railings and Pickets

Railing Type	V-GROOVE	Complimenting Colour	MIRAGE ATLANTIS RED OAK
Picket Type	EUROLINE 0	Complimenting Colour	BLACK
Stringer / Riser	AS PER CONSTRUCTION SPECIFICATIO	Complimenting Colour	MIRAGE ATLANTIS RED OAK
Treads	AS PER CONSTRUCTION SPECIFICATIO	Complimenting Colour	MIRAGE ATLANTIS RED OAK
Red Oak Stairs <input checked="" type="radio"/> Yes <input type="radio"/> No			

** Refer to Construction Summary THE STAIN COLOURS OR FINISH AVAILABLE ON RISERS, TREADS, PICKETS AND RAILS (STAIRCASES), WILL NOT BE AN EXACT MATCH TO PREFINISHED HARDWOOD OR LAMINATE FLOORS.

9. Wall Paint Flat Finish

Main & Upper Hall	22 WARM GREY	Master Bedroom	22 WARM GREY
Living Room	N/A	Bedroom #2	22 WARM GREY
Dining Room	22 WARM GREY	Bedroom #3	22 WARM GREY
Kitchen / Breakfast	22 WARM GREY	Bedroom #4	22 WARM GREY
Family Room	22 WARM GREY	Bedroom #5	N/A
Powder Room	22 WARM GREY	Master Ensuite	22 WARM GREY
Laundry Room	22 WARM GREY	Ensuite Bath - Bedroom 2/3	22 WARM GREY
Den/Library	22 WARM GREY	Ensuite Bath - Bedroom 4	22 WARM GREY
Trim & Door Paint-Semi Gloss	BIRCH WHITE		N/A
	N/A		N/A
	N/A		N/A
Smooth Ceilings First Floor <input checked="" type="radio"/> Yes <input type="radio"/> No			

** Refer to Construction Summary

Purchaser:2816098 ONTARIO INC.

Telephone Res. / Bus: /

Decor Advisor:Candace Forza

Lock Date:22-Apr-22

Property: 538

Project: Russell Gardens Building Ltd.

Model and Elevation: Valleycreek Twelve A Elev 3

Plan #: 62M-1266

10. Plaster Mouldings and Medallions

Entrance Vestibule	N/A	N/A	Kitchen/Breakfast	N/A	N/A
Main Hall	N/A	N/A	Den/Library	N/A	N/A
Living Room	N/A	N/A	Lower Landing	N/A	N/A
Dining Room	N/A	N/A		N/A	N/A
Family Room	N/A	N/A			

** Refer to Construction Summary

11. Fireplace

Living Room			Family Room			Other Room - Specify		
Purchased	As Per Plan	N/A	Purchased	As Per Plan	N/A	Purchased	As Per Plan	N/A
<input type="radio"/>	<input type="radio"/>	<input checked="" type="radio"/>	<input type="radio"/>	<input checked="" type="radio"/>	<input type="radio"/>	<input type="radio"/>	<input type="radio"/>	<input checked="" type="radio"/>
Fireplace Type	N/A		FLAT ON WALL		N/A			
Mantle Type	N/A		MANTLE M6		N/A			
Colour / Stain	N/A		AS PER CONSTRUCTION SPECIFICATIONS		N/A			
Surround	N/A		GRIGIO CARNICO		N/A			
Hearth	N/A		NO		N/A			

** Refer to Construction Summary

12. Heating and Air Conditioning

Air Conditioning	NO	Gas Provisions Stove	NO
Gas Provisions Dryer	NO	Gas Provisions Barbecue	NO
Comment			

** Refer to Construction Summary

13. Electrical

Plugs and Switches	<input checked="" type="radio"/> White	DECOR	Above Kitchen Cabinet Light	<input type="radio"/> Yes	<input checked="" type="radio"/> No
Hood Fan	STANDARD WHITE TEMP.		Below Kitchen Cabinet Light	<input type="radio"/> Yes	<input checked="" type="radio"/> No
Appliances	Built in Cooktop	Built in Oven	Gas Stove	Microwave	
	<input checked="" type="radio"/> Yes <input type="radio"/> No	<input checked="" type="radio"/> Yes <input type="radio"/> No	<input type="radio"/> Yes <input checked="" type="radio"/> No	<input checked="" type="radio"/> Yes	<input type="radio"/> No
Dishwasher Rough-in	Yes				

** Refer to Construction Summary

14. General Comments

** Refer to Construction Summary

Disclaimers and Notes

- 1) Colours of all materials are as close as possible to builder's selection, but not necessarily identical due to variances in manufacturing.
- 2) Any extras listed above are null and void unless accompanied by a separate invoice/amendment. Said invoice must be paid in full.
- 3) The Purchaser agrees that this colour selection is final and that no changes will be permitted, unless required by the Vendor.
- 4) The Purchaser acknowledges reading and accepting document which contains other miscellaneous disclaimers.
- 5) In the event of a conflict between the Standard Features schedule of the Agreement of Purchase and Sale and the Interior Colour Scheme, the Interior Colour Scheme shall prevail.

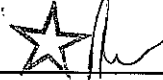
Signature:

Date: 22/04/22

530
Russell Gardens
Ph. 4

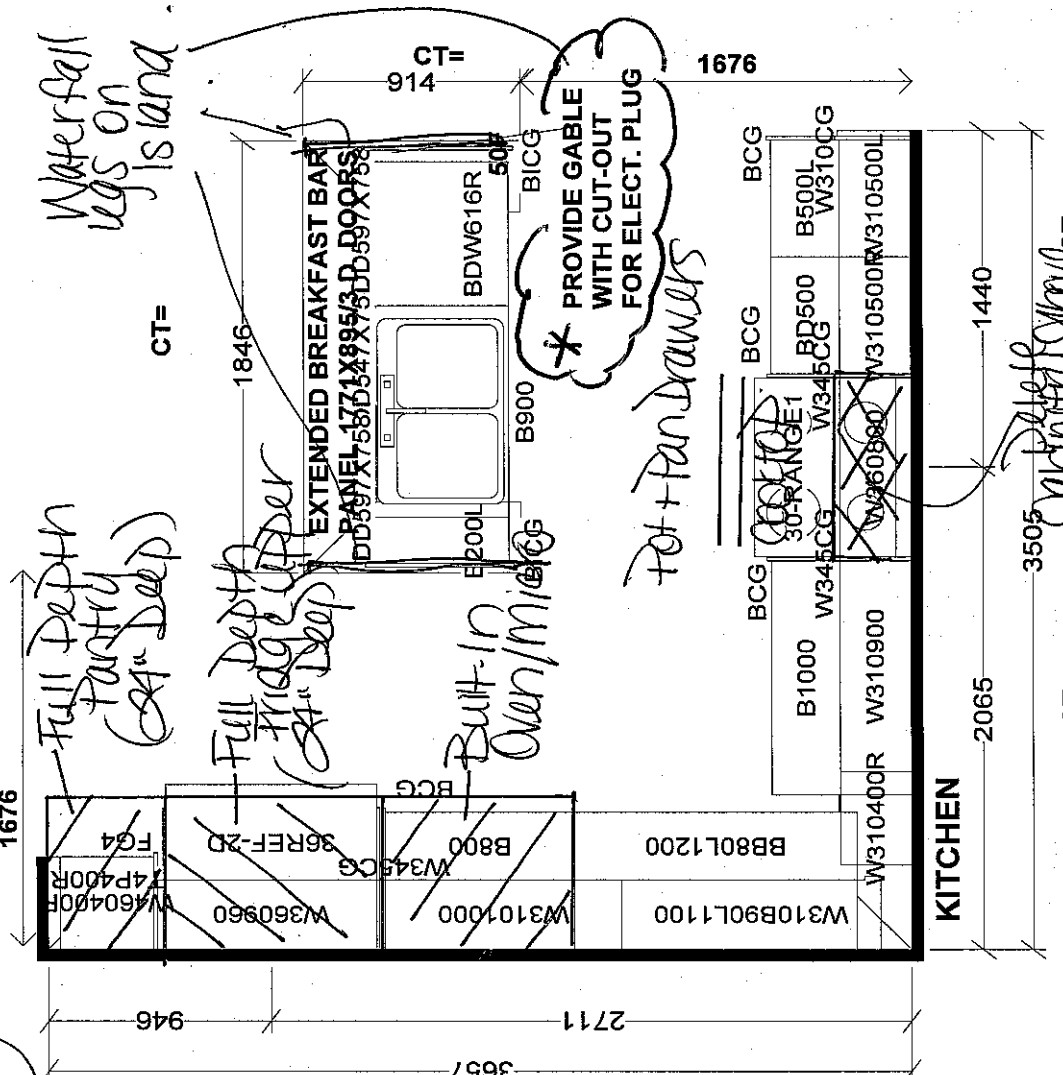

Selba Industries

W WDTH _____ W HGHT _____ W CNT _____

FLOOR HGHT _____ DOOR HGHT _____

ST CENT _____ 2X4 _____ VENT BOX COVER _____

J #

JOB NUMBER:

BUILDER: GREENPARK

SITE: RUSSELL GARDENS PH.4

MODEL: VALLEYCREEK 12AX EL 1

LOT #:

This drawing is the intellectual property of SELBA INDUSTRIES INC. and is an original design which must not be released or copied unless applicable fee has been paid or per order placed.



DESIGNER: KS

DATE: APR 28 21

Old Plug
above fireplace.

Relocate
Stair Light
Staircase.
Cooktop (Delete Cabinetry
+ RTT / PAN)
Delete Wall
to accommodate
Frameless Glass
Enclosure

Testive
Plug

Smooth
Ceilings

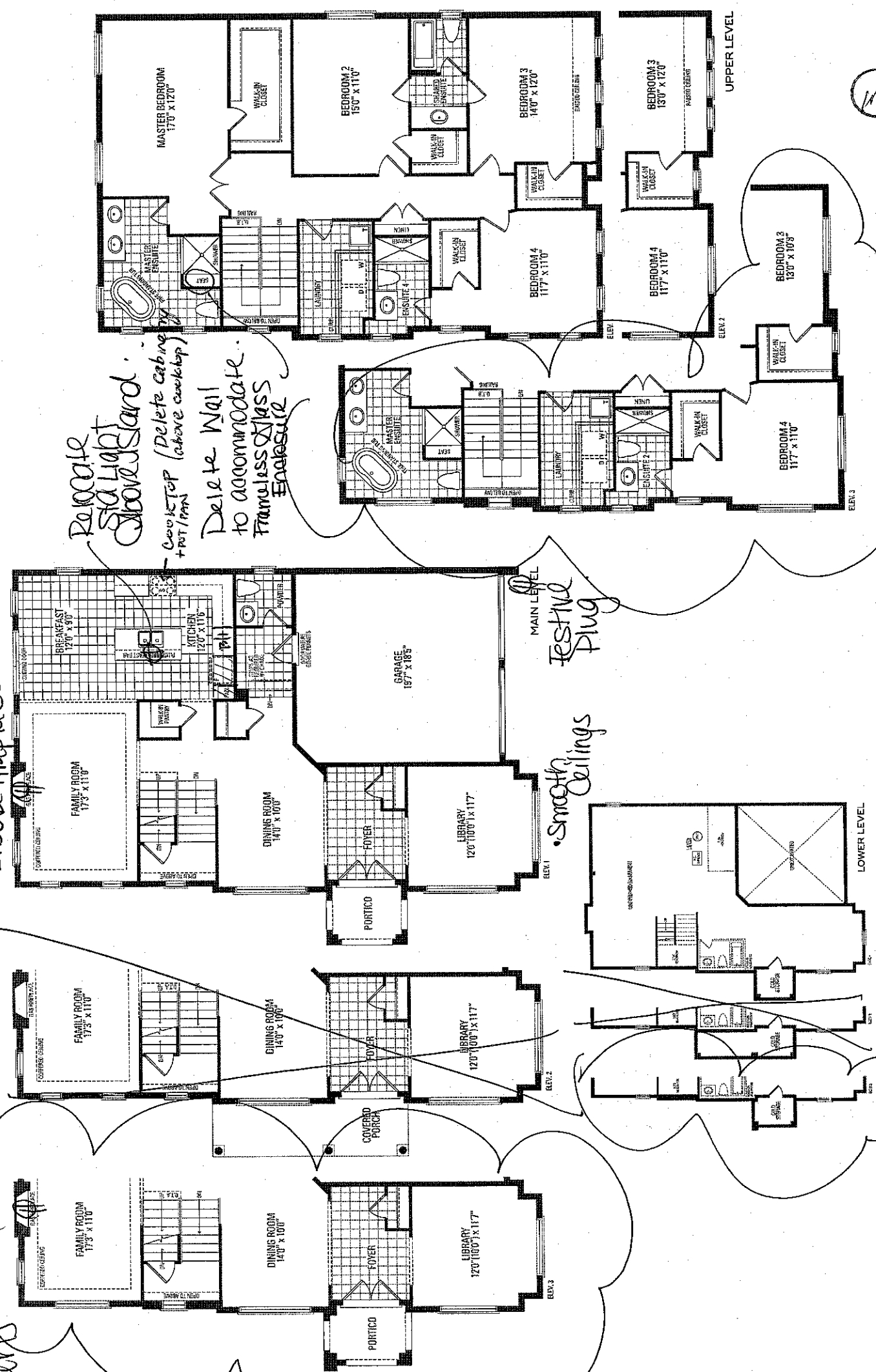

VALLEYCREEK TWELVE A ELEV. 1 • 2,742 sq.ft. | ELEV. 2 • 2,741 sq.ft. | ELEV. 3 • 2,729 sq.ft.



JENN-AIR® DETAILED PLANNING DIMENSIONS

1 of 3

72" COUNTER-DEPTH FRENCH DOOR REFRIGERATORS WITH EXTERNAL DISPENSER

JFFCC72EH – 35³/₄" x 71¹/₈" x 32¹/₈" (with handles)

PRODUCT DIMENSIONS

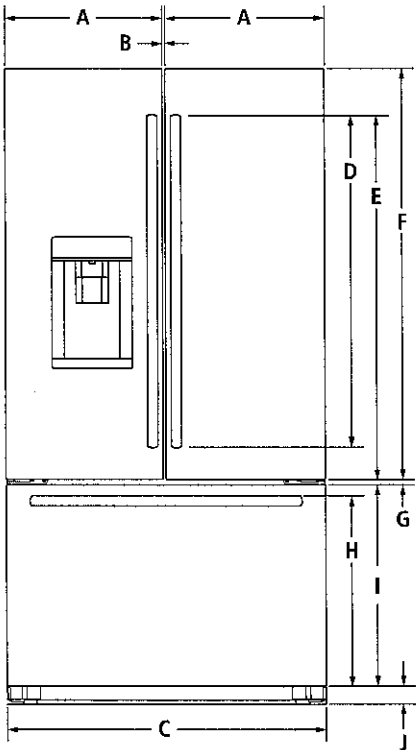

FRONT VIEW

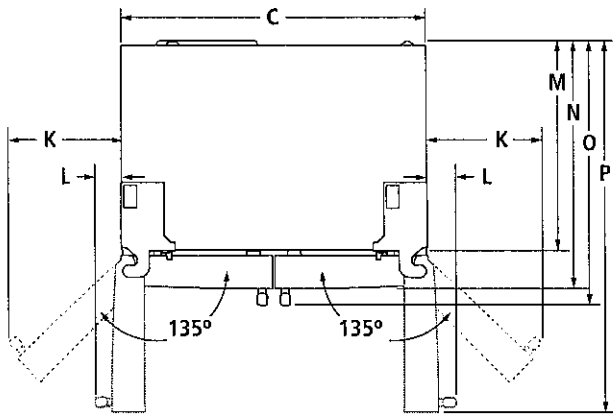

TOP VIEW

MODEL #		JFFCC72EH	
		in	cm
A	Width of each door	17 ¹ / ₁₆	45.0
B	Space between doors	³ / ₈	0.9
C	Overall width	35 ³ / ₄	90.5
D	Height of door handles		
	RISE™ Stainless	32 ³ / ₈	82.9
E	Height to top of door handles		
	RISE™ Stainless	38 ³ / ₈	98.2
F	Height of doors	46 ¹ / ₂	118.2
G	Space between doors and drawer	¹ / ₂	1.2
H	Height to top of drawer handle		
	RISE™ Stainless	21 ³ / ₄	55.3
I	Height of drawer	23	58.4
J	Height of grille	1 ¹ / ₂	3.9
K	Width from side of refrigerator to handle – door fully open 135°		
	RISE™ Stainless	14	35.5
L	Width from side of refrigerator to handle – door open 90°		
	RISE™ Stainless	4 ¹ / ₈	11.0
M	Depth without doors	24 ⁵ / ₈	62.6
N	Depth with doors	29 ⁵ / ₈	74.4
O	Depth with handles		
	RISE™ Stainless	32 ¹ / ₈	81.7
P	Depth with doors open 90°	44	111.7

IMPORTANT: Dimensional specifications are provided for planning purposes only.
Do not make any cutouts based on this information. Refer to the Installation Guide *before* selecting cabinetry, verifying electrical/gas connections, making cutouts or beginning installation.
All Jenn-Air® appliances are appropriately UL, CUL or CSA approved.



JENN-AIR® DETAILED PLANNING DIMENSIONS

2 of 3

72" COUNTER-DEPTH FRENCH DOOR REFRIGERATORS WITH EXTERNAL DISPENSER

JFFCC72EH – 35¾" x 71¹⁵/₁₆" x 32¹/₅" (with handles)

DIMENSIONS AS INSTALLED

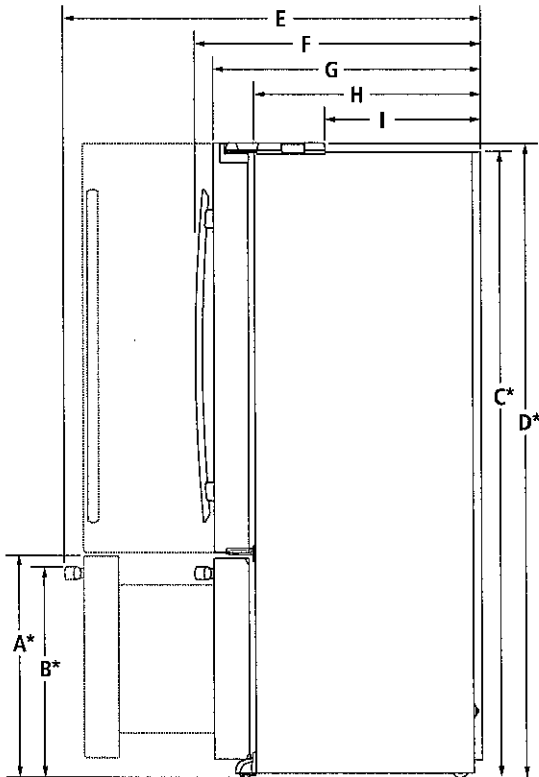

SIDE VIEW

MODEL #		JFFCC72EH	
		in	cm
A*	Height to top of drawer (min.)	24 ¹⁵ / ₁₆	63.3
B*	Height to top of drawer handle (min.) RISE™ Stainless	23 ³ / ₄	60.4
C*	Height of recessed refrigerator (min.)	70 ¹⁵ / ₁₆	180.1
D*	Height to top of hinges (min.)	71 ¹⁵ / ₁₆	182.7
E	Depth with drawer fully open including drawer handle (min.) RISE™ Stainless	46 ⁷ / ₈	118.8
F	Depth with handles (min.) RISE™ Stainless	32 ³ / ₄	83.1
G	Depth with doors (min.)	29 ⁵ / ₁₆	74.4
H	Depth without doors (min.)	24 ⁵ / ₁₆	62.6
I	Depth to back of hinges (min.)	16 ³ / ₄	42.6

*Add ¾" (1.9 cm) to the height dimension when leveling legs are fully extended.

IMPORTANT: Dimensional specifications are provided for planning purposes only.
Do not make any cutouts based on this information. Refer to the Installation Guide *before* selecting cabinetry, verifying electrical/gas connections, making cutouts or beginning installation.
All Jenn-Air® appliances are appropriately UL, CUL or CSA approved.



JENN-AIR® DETAILED PLANNING DIMENSIONS

3 of 3

72" COUNTER-DEPTH FRENCH DOOR REFRIGERATORS WITH EXTERNAL DISPENSER

JFFCC72EH – 35¾" x 71⅝" x 32⅞" (with handles)

OPENING/CLEARANCE DIMENSIONS

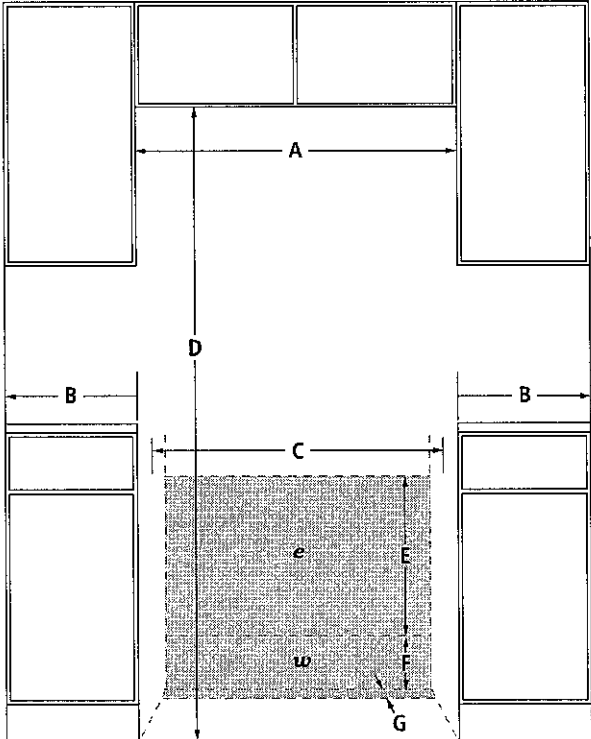

FRONT VIEW

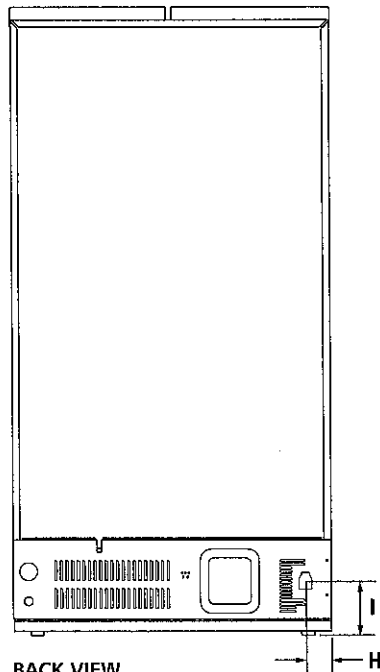

BACK VIEW

MODEL #		JFFCC72EH	
		in	cm
A	Width (min.)	36¾	93.3
B	Minimum width from side of refrigerator to fixed wall – door open 90°	3¾	9.5
	Minimum width from side of refrigerator to fixed wall – door open approx. 135°	12	30.5
C	Width of recommended electrical/water installation area	35½	90.2
D	Height (min.)	72⅞	184.0
E	Height of recommended electrical installation area (min.-max.)	24-36	61.0-91.4
F	Height of recommended water installation area	12	30.5
G	Depth of recommended water installation area	1	2.5
H	Water line location – distance from side	2½	6.4
I	Water line location – distance from bottom	7	17.8
e	Recommended electrical connection location		
w	Recommended water connection location		

ELECTRICAL REQUIREMENTS

115 volt, 60 Hz, AC only, 15- or 20-amp fused, grounded circuit is required. A dedicated circuit is recommended. Use an outlet that cannot be turned off by a switch.
Minimum length of power cord is 60" (152.0 cm). Do not use an extension cord.

WATER PRESSURE REQUIREMENTS

A cold water supply with water pressure between 30 and 120 psi (207 and 827 kPa) is required to operate the water dispenser and ice maker. Call a licensed, qualified plumber with any questions about the water pressure.

Reverse Osmosis Water Supply

IMPORTANT: The pressure of the water coming out of a reverse osmosis system going to the water inlet valve of the refrigerator needs to be between 30 and 120 psi (207 and 827 kPa).
If a reverse osmosis water filtration system is connected to the cold water supply, the water pressure to the reverse osmosis system needs to be a minimum of 40 to 60 psi (276 to 414 kPa).

IMPORTANT: Dimensional specifications are provided for planning purposes only.
Do not make any cutouts based on this information. Refer to the Installation Guide *before* selecting cabinetry, verifying electrical/gas connections, making cutouts or beginning installation.
All Jenn-Air® appliances are appropriately UL, CUL or CSA approved.



JENNAIR® DETAILED PLANNING DIMENSIONS

1 of 2

30" COMBINATION MICROWAVE/WALL OVENS
JMW2430I, JMW3430I – 30" x 43-3/4" x 25-5/16"

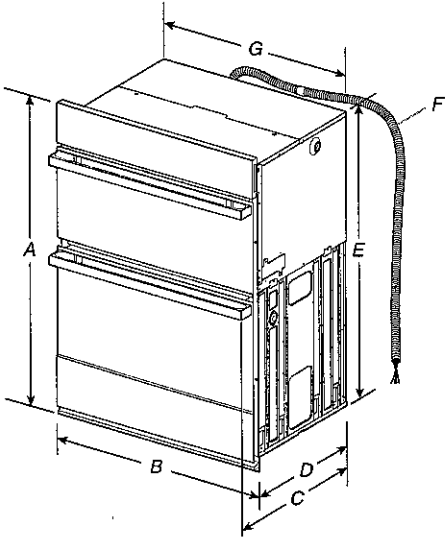

PRODUCT DIMENSIONS

30" (76.2 CM) MODELS

- A. 43-3/4" (111 cm) overall height
- B. 30" (76.2 cm) overall width
- C. JMW2430IM – 26-3/8" (67 cm)
JMW2430IL – 27-3/16" (69 cm)
JMW3430IM – 26-3/8" (67 cm)
JMW3430IL – 27-3/16" (69 cm)
- D. 23-1/4" (59.1 cm) max. recessed depth
- E. 41" (104.1 cm) recessed height
- F. 48" (121.9 cm) flexible conduit length measured from the conduit clamp located at the rear of the oven. Do not remove the conduit clamp.
- G. 28-7/16" (72.2 cm) recessed width

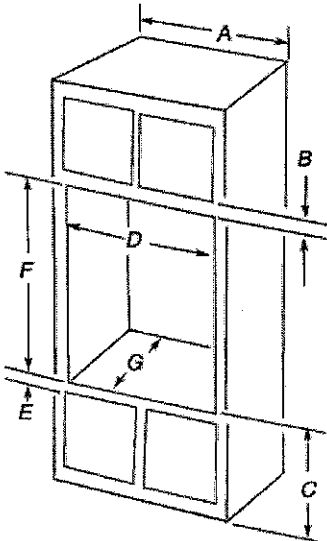

OPENING/CLEARANCE DIMENSIONS

30" (76.2 CM) MODELS

- A. 30" (76.2 cm) min. cabinet width
- B. 2-1/4" (5.7 cm) top of cutout to bottom of upper cabinet door
- C. 19-1/4" (48.9 cm) bottom of cutout to floor is recommended.
4"-19-1/4" (10.2-48.9 cm) bottom of cutout to floor is acceptable.
- D. 28-1/2" (72.4 cm) cutout width
- E. 1-1/2" (3.8 cm) min. bottom of cutout to top of cabinet door
- F. 41-5/16" (105 cm)* recommended cutout height
- G. 24" (60.7 cm) cutout depth

*NOTE: The cutout height can be between 41" and 41-1/2" (104.1 cm and 105.6 cm) for microwave/oven combination.

IMPORTANT: Dimensional specifications are provided for planning purposes only. Do not make any cutouts based on this information. Refer to the Installation or Use & Care Guide before selecting cabinetry, verifying electrical/gas connections, making cutouts or beginning installation. All JennAir® appliances are appropriately UL, CUL or CSA approved.



JENNAIR® DETAILED PLANNING DIMENSIONS

2 of 2

30" COMBINATION MICROWAVE/WALL OVENS
JMW2430I, JMW3430I – 30" x 43-3/4" x 25-5/16"

ELECTRICAL REQUIREMENTS

If codes permit and a separate ground wire is used, it is recommended that a qualified electrical installer determine that the ground path and the wire gauge are in accordance with local codes.

Check with a qualified electrical installer if you are not sure the oven is properly grounded.

This oven must be connected to a grounded metal, permanent wiring system.

Be sure that the electrical connection and wire size are adequate and in conformance with the National Electrical Code, ANSI/NFPA 70-latest edition or CSA Standards C22.1-94, Canadian Electrical Code, Part 1 and C22.2 No. 0-M91-latest edition, and all local codes and ordinances.

A copy of the above code standards can be obtained from:

National Fire Protection Association
1 Batterymarch Park
Quincy, MA 02169-7471

CSA International
8501 East Pleasant Valley Road
Cleveland, OH 44131-5575

- Models rated from 7.3 to 9.6 kW at 240 V (5.4 to 7.4 kW at A. Model/Serial/Rating Plate 208 V) require a separate 40 A circuit.
- A circuit breaker is recommended.
- Connect directly to the fused disconnect (or circuit breaker box) through flexible, armored or nonmetallic sheathed, copper cable (with grounding wire).
- Flexible conduit from the oven should be connected directly to the junction box.
- Do not cut the conduit. The length of conduit provided is for serviceability of the oven.
- A UL listed or CSA approved conduit connector must be provided.
- If the house has aluminum wiring, follow the procedure below:
Connect the aluminum wiring using special connectors and/or tools designed and UL listed for joining copper to aluminum.
Follow the electrical connector manufacturer's recommended procedure. Aluminum/copper connection must conform with local codes and industry-accepted wiring practices.

For power requirements, refer to the following table:

	240 VAC	208 VAC
Model	kW	kW
JMW2430I	8.0	6.6
JMW3430I	8.2	6.6

ELECTRICAL CONNECTION

To properly install your oven, you must determine the type of electrical connection you will be using and follow the instructions provided for it here.

- Oven must be connected to the proper electrical voltage, amperage and frequency as specified on the model/serial/rating plate. See the following illustration.

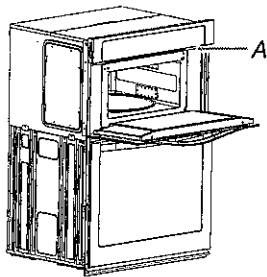

A. Model/Serial/Rating Plate

IMPORTANT: Dimensional specifications are provided for planning purposes only.
Do not make any cutouts based on this information. Refer to the Installation or Use & Care Guide before selecting cabinetry, verifying electrical/gas connections, making cutouts or beginning installation.
All JennAir® appliances are appropriately UL, CUL or CSA approved.





24" DISHWASHER

DETAILED PLANNING DIMENSIONS GUIDE

23⁷/₈" (W) x 33⁵/₈" (H) x 24¹/₂"

23⁷/₈" (W) x 33⁵/₈" (H) x 24³/₄"

PRODUCT DIMENSIONS

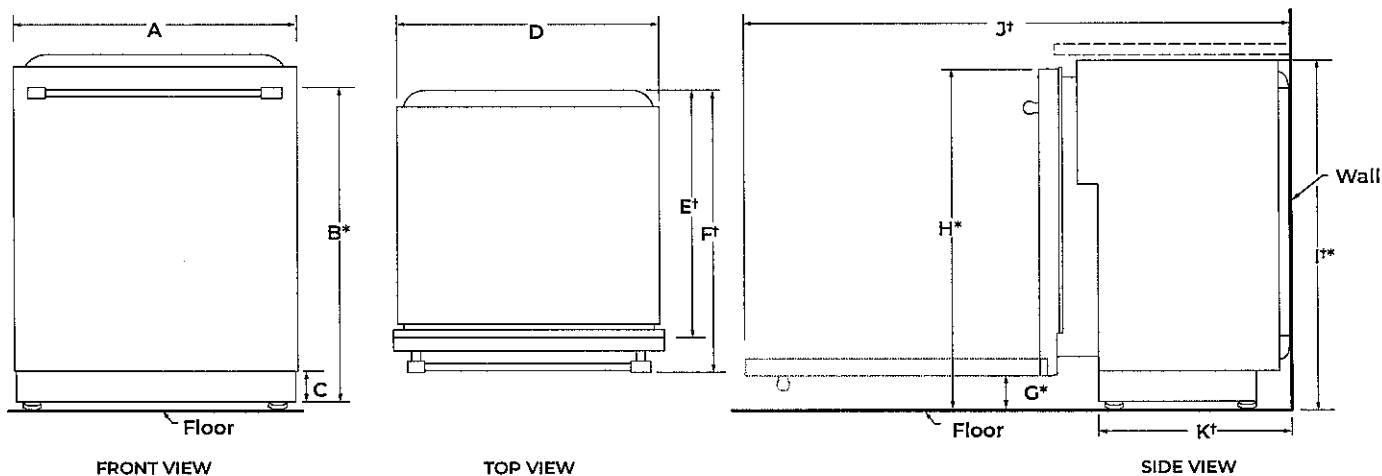

	DESCRIPTION	DIMENSIONS
A	Width of door	23 ⁷ / ₈ " (60.6 cm)
B*	Height to top of handle	31 ¹ / ₁₆ " (80.1 cm)
C	Height of adjustable toe kick	3 ¹ / ₂ " (8.8 cm) - min. 4 ¹ / ₄ " (10.8 cm) - max.
D	Width of recessed dishwasher	23 ⁷ / ₈ " (60.6 cm)
E†	Depth without door	22 ⁵ / ₈ " (57.5 cm)
F†	Depth with Towel Bar Handle	27 ¹ / ₄ " (69.2 cm)
	Depth with Pocket Handle	24 ¹ / ₂ " (62.2 cm)
	Depth with Wood panel	24 ³ / ₄ " (62.9 cm)**
G*	Height to bottom of door (min.)	3 ⁵ / ₁₆ " (8.4 cm)
H*	Height to top of door (min.)	33 ¹ / ₁₆ " (84.9 cm)
I**	Height of recessed dishwasher (min.)	33 ⁵ / ₈ " (85.4 cm)
J†	Depth with door fully open (min.)	50 ³ / ₁₆ " (127.4 cm)
K†	Depth with toe kick (min.)	20 ¹ / ₁₆ " (52.9 cm)

†Insulation blanket thickness not included, can be crushed up to 1/8" (0.3 cm), or removed along the top perforate section for additional clearance.

*Dishwasher can be raised 1⁷/₁₆" (3.7 cm) with feet fully extended.

**Considering 3/4" wood panel thickness.

Because Whirlpool Corporation policy includes a continuous commitment to improve our products, we reserve the right to change materials and specifications without notice.

Dimensions are for planning purposes only. For complete details, see Installation Instructions packed with product. Specifications subject to change without notice.



24" DISHWASHER DETAILED PLANNING DIMENSIONS GUIDE

23⁷/₈" (W) x 33⁵/₈" (H) x 24¹/₂"

23⁷/₈" (W) x 33⁵/₈" (H) x 24³/₄"

OPENING/CLEARANCE DIMENSIONS

IMPORTANT: Check that all surfaces have no protrusions that would prohibit dishwasher installation.

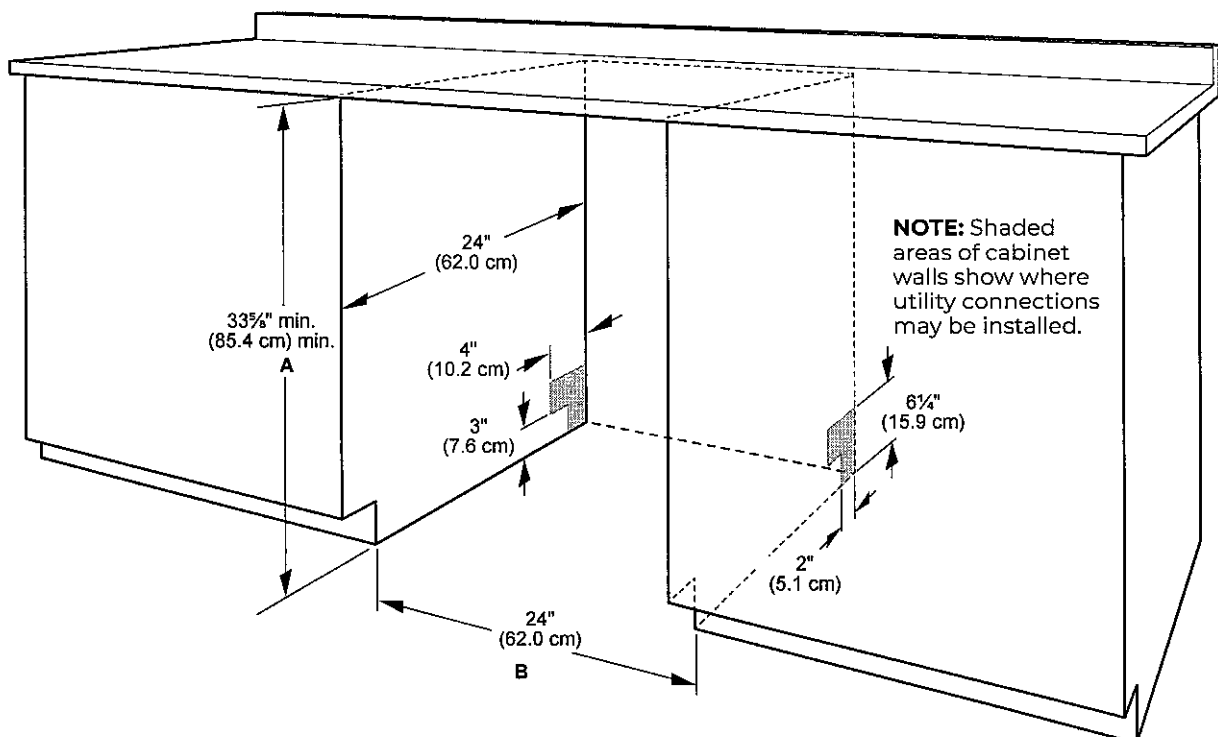

A. Measured from the lowest point on the underside of the countertop. May be reduced to 33⁵/₈" min. (85.4 cm) min. by removing the feet and perforated area of insulation (blanket) on dishwasher.

B. Minimum, measured from narrowest point of opening.

NOTE: Corner locations require a 2" (5.1 cm) minimum clearance between the side of the dishwasher door and the wall or cabinet.

Because Whirlpool Corporation policy includes a continuous commitment to improve our products, we reserve the right to change materials and specifications without notice.

Dimensions are for planning purposes only. For complete details, see Installation Instructions packed with product. Specifications subject to change without notice.

DIMENSIONS

JENNAIR® RANGETOPS

PRODUCT

	30" RANGETOP JGCP430H	36" RANGETOP JGCP436H	48" RANGETOP JGCP548H
Overall Width (A)	29-3/4" (75.5 cm)	35-3/4" (90.8 cm)	47-7/8" (121.6 cm)
Grate Depth (B)	22" (55.9 cm)	22" (55.9 cm)	22" (55.9 cm)
Depth without Control Panel (C)	23-1/4" (59.1 cm)	23-1/4" (59.1 cm)	23-1/4" (59.1 cm)
Depth with Control Panel Overhang (D)	27-1/2" (69.9 cm)	27-1/2" (69.9 cm)	27-1/2" (69.9 cm)
Depth with Knobs: RISE™ (E)	29-1/8" (74 cm)	29-1/8" (74 cm)	29-1/8" (74 cm)
Depth with Knobs: NOIR™ (E)	29" (73.7 cm)	29" (73.7 cm)	29" (73.7 cm)

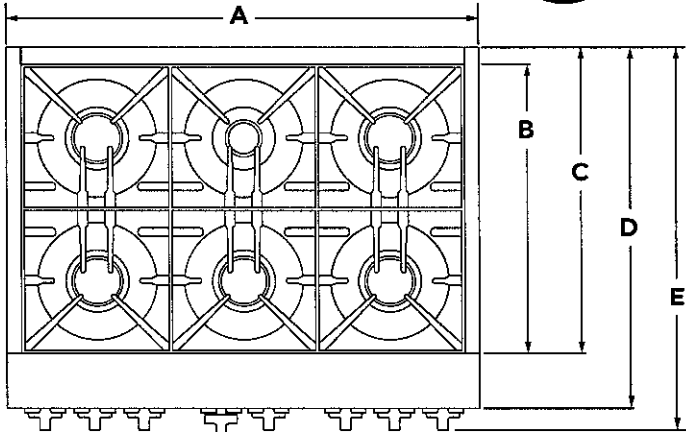

TOP VIEW

IMPORTANT: Dimensional specifications are provided for planning purposes only. Do not make any cutouts based on this information. Refer to the Installation Guide before selecting cabinetry, verifying electrical/gas connections, making cutouts or beginning installation. All JennAir® appliances are appropriately UL, CUL or CSA approved.

DIMENSIONS
JENNAIR® RANGETOPS
PRODUCT

	30" RANGETOP JGCP43JH	36" RANGETOP JGCP436H	48" RANGETOP JGCP548H
Grate Width (F)*	27-7/16" (69.7 cm)	33" (83.8 cm)	44-3/8"* (112.7 cm)
Gas Inlet to Surface (G)	10-3/4" (27.3 cm)	10-3/4" (27.3 cm)	10-3/4" (27.3 cm)
Center to Gas Inlet (H)	11" (27.9 cm)	14-1/8" (35.9 cm)	19-5/8" (49.8 cm)
Recessed Rangetop Width (I)	29-1/8" (74 cm)	35" (88.9 cm)	47-1/4" (120 cm)

*Includes width of grates and griddle.

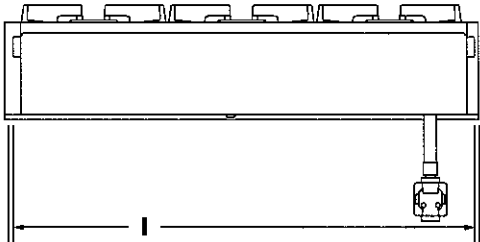
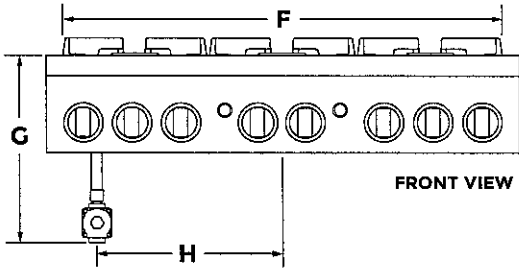

BACK VIEW

DIMENSIONS

JENNAIR® RANGETOPS

PRODUCT

	30" RANGETOP JGCP430H	36" RANGETOP JGCP436H	48" RANGETOP JCCP543H
Height with Grates (J)	9" (22.9 cm)	9" (22.9 cm)	9" (22.9 cm)
Control Panel Height (K)	7-13/16" (19.8 cm)	7-13/16" (19.8 cm)	7-13/16" (19.8 cm)
Recessed Rangetop Height (L)	7" (17.8 cm)	7" (17.8 cm)	7" (17.8 cm)
Cooking Surface Height (M)	7-7/16" (18.9 cm)	7-7/16" (18.9 cm)	7-7/16" (18.9 cm)
Recessed Rangetop Depth (N)	21-7/8" (55.6 cm)	21-7/8" (55.6 cm)	21-7/8" (55.6 cm)
Depth with Control Panel (O)	25-1/2" (64.8 cm)	25-1/2" (64.8 cm)	25-1/2" (64.8 cm)

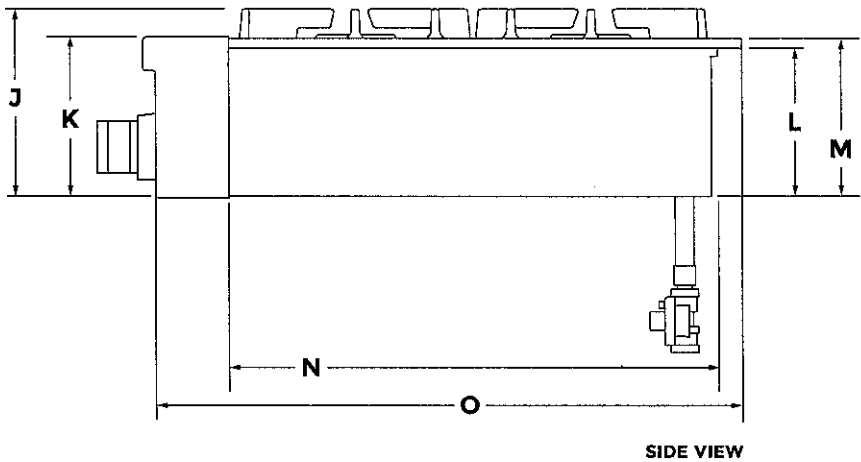

★ **IMPORTANT:** Supplied regulator does not come preattached and is pictured for reference purposes only.

DIMENSIONS
JENNAIR® RANGETOPS
OPENING AND CLEARANCE

	30" RANGETOP JGCP430H	36" RANGETOP JGCP436H	48" RANGETOP JGCP548H
Combustible Area Above Cooking Surface Width (A)	30" (76.2 cm) min.	36" (91.4 cm) min.	48" (121.9 cm) min.
Bottom of Cabinet Height Above Cooking Surface (B)*	42" (106.7 cm) min.	58" (147.3 cm) min.	58" (147.3 cm) min.
Bottom of Cabinet Height Above Countertop (C)	18" (45.7 cm) min.	18" (45.7 cm) min.	18" (45.7 cm) min.
Distance to Fixed Wall or Combustible Material (D)	12" (30.5 cm) min.	12" (30.5 cm) min.	12" (30.5 cm) min.

*Dimension reduced by 6" (15.2 cm) when bottom of wood or metal cabinet is covered by at least 1/4" (0.6 cm) flame retardant millboard, which is in turn covered with at least No. 28 MSG sheet metal, 0.015" (0.4 mm) stainless steel, 0.024" (0.6 mm) aluminum or 0.020" (0.5 mm) copper. If installing a hood above the rangetop, follow the hood instructions for dimensional clearances above the cooking surface.

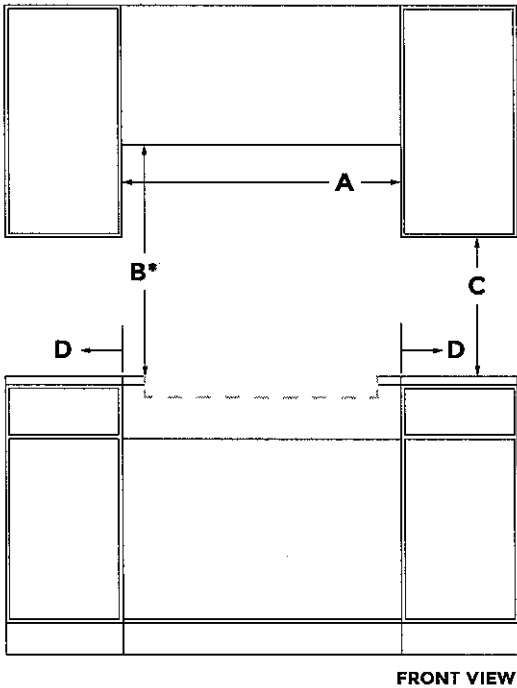

FRONT VIEW

DIMENSIONS
JENNAIR® RANGETOPS
OPENING AND CLEARANCE

	30" RANGETOP JGCP430H	36" RANGETOP JGCP436H	48" RANGETOP JGCP548H
Recommended Upper Cabinet Depth (E)	13" (33 cm)	13" (33 cm)	13" (33 cm)
Cutout to Wall Depth (F)*	1-1/2" (3.8 cm) min.	1-1/2" (3.8 cm) min.	1-1/2" (3.8 cm) min.
Cabinet to Countertop Height (G)	7-1/4" (18.4 cm)	7-1/4" (18.4 cm)	7-1/4" (18.4 cm)
Cabinet Depth (H)	24" (61 cm)	24" (61 cm)	24" (61 cm)

*If the back wall is constructed of a combustible material and a backsplash is not installed, a 7-1/2" (19.1 cm) minimum clearance is required from the cutout or 6" (15.2 cm) minimum clearance from the back edge of the rangetop.

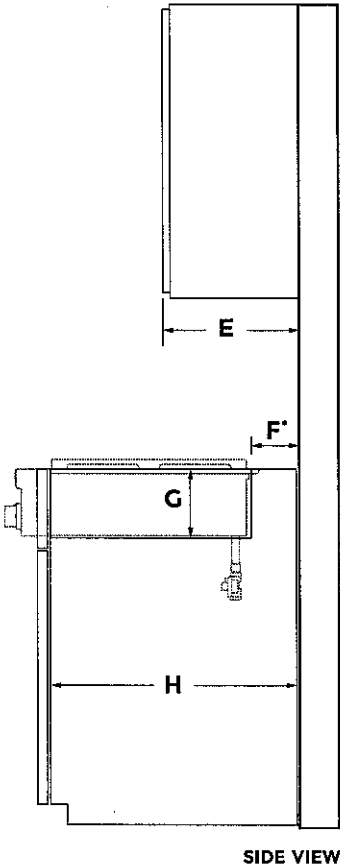

SIDE VIEW

DIMENSIONS
JENNAIR® RANGETOPS
OPENING AND CLEARANCE

	30" RANGETOP JCCP430H	36" RANGETOP JCCP436H	48" RANGETOP JCCP548H
Countertop and Cabinet Cutout Width (I)	29-1/4" (74.3 cm)	35-1/4" (89.5 cm)	47-3/8" (120.3 cm)
Countertop and Cutout Depth (J)	22-1/4" (56.5 cm)	22-1/4" (56.5 cm)	22-1/4" (56.5 cm)
Notch Width (K)	5/16" (0.8 cm)	5/16" (0.8 cm)	5/16" (0.8 cm)
Cutout Width (L)	29-7/8" (75.9 cm)	35-3/4" (90.8 cm)	47-7/8" (121.6 cm)

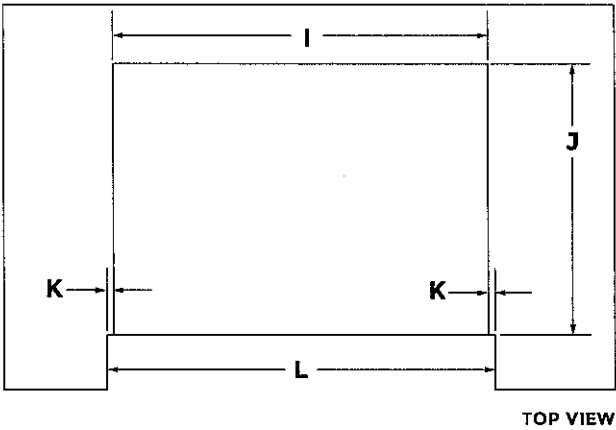

DIMENSIONS
JENNAIR® RANGETOPS
ELECTRICAL REQUIREMENTS

ELECTRIC REQUIREMENTS CHECKLIST

☐

A 120 volt, 60 Hz, AC only, 15-amp fused electrical circuit is required.

☐

A dedicated circuit is recommended.

RECOMMENDED ELECTRICAL OUTLET ZONE

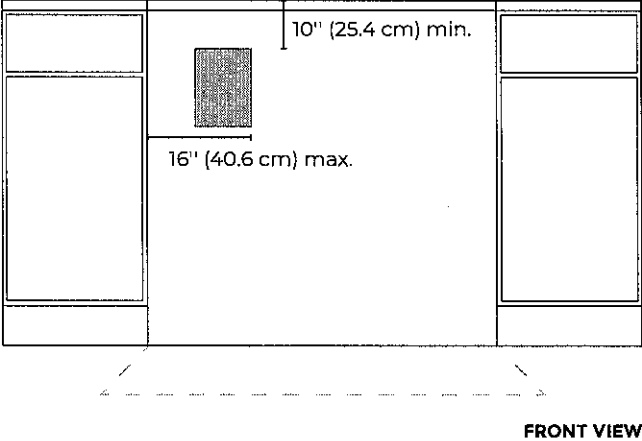

?

IF YOU HAVE QUESTIONS ABOUT YOUR ELECTRICAL SUPPLY, CALL A LICENSED, QUALIFIED ELECTRICIAN.

** Purchaser Supplying
gas line after closing **

DIMENSIONS

JENNAIR® RANGETOPS

GAS REQUIREMENTS

RECOMMENDED GAS SUPPLY LOCATION

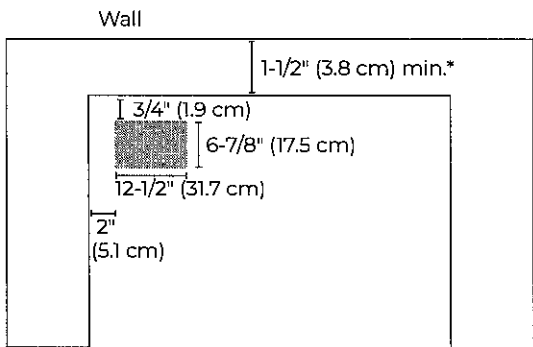

TOP VIEW

*If the back wall is constructed of a combustible material and a backsplash is not installed, a 7-1/2" (19.1 cm) minimum clearance is required from the cutout or 6" (15.2 cm) minimum clearance from the back edge of the rangetop.

GAS SUPPLY ZONE

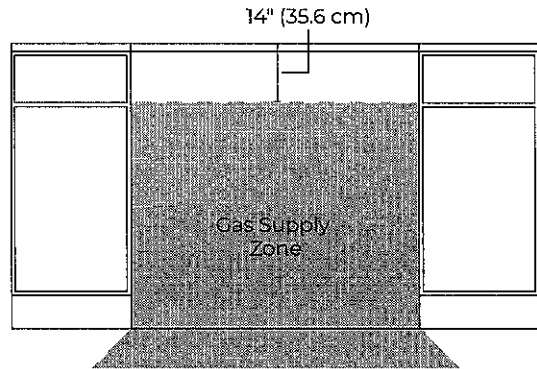

FRONT VIEW



IF YOU HAVE QUESTIONS ABOUT YOUR GAS SUPPLY,
CALL A LICENSED, QUALIFIED SERVICE TECHNICIAN.