

CONSTRUCTION SUMMARY

Mountainview Heights 3 (G) - Russell Gardens Building Ltd.

PURCHASERS: Choudary SHABIR and Sofia SHABIR

RECEIVED  
DEC 2 2021

TEL:

LOT / PHASE 604 / 4	REG. PLAN # 62M-1266	HOUSE TYPE Grandville Nine Elev 3		
------------------------	-------------------------	--------------------------------------	--	--

CABINETRY

1 - CABINETRY - KITCHEN - VALENCE 07Dec21 Note:	
1 - CABINETRY - KITCHEN - HARDWARE UPGRADE 2 17Nov21 Note:	
1 - CABINETRY - KITCHEN - CROWN - CM3 17Nov21 Note:	
1 - CABINETRY - KITCHEN - UPGRADE 3 17Nov21 Note:	

CABINETRY ACCESSORIES

1 - KITCHEN - COOKTOP - 48 INCH 17Dec21 Note:	
1 - KITCHEN - FRIDGE - 48 INCH OPENING IN LIEU OF STANDARD 36 INCH OPENING 17Dec21 Note:	
1 - KITCHEN CABINETRY - APPLIANCE DOOR PANELS - FRIDGE DOOR PANELS - SUPPLY ONLY - 42"-48" WIDE FRIDGES - UPGRADE 3 15Dec21 Note:	
1 - CABINETRY FEE FOR FLUSH CUTOUT ON WALL OVEN/MICROWAVE COMBO CABINET ONLY 15Dec21 Note:	
1 - KITCHEN CABINETRY - BUILT-IN FRIDGE CABINET - PRICE IS EACH 17Nov21 Note:	
2 - CABINETRY DECORATIVE ITEMS - POSTS - LEG POSTS - PRICE IS EACH 17Nov21 Note: ISLAND - REFER TO SKETCH	
1 - KITCHEN HOOD CABINETS - TRANSITIONAL WOOD HOOD (DHB) 800-1000 WIDE - UPGRADE 3 17Nov21 Note:	
1 - VANITY CABINETRY - RAISE VANITY TO 36" HIGH VANITY IN LIEU OF STANDARD HEIGHT - ENSUITE 5 17Nov21 Note:	
1 - VANITY CABINETRY - RAISE VANITY TO 36" HIGH VANITY IN LIEU OF STANDARD HEIGHT - ENSUITE 4 17Nov21 Note:	
1 - VANITY CABINETRY - RAISE VANITY TO 36" HIGH VANITY IN LIEU OF STANDARD HEIGHT - ENSUITE 3 17Nov21 Note:	
1 - VANITY CABINETRY - RAISE VANITY TO 36" HIGH VANITY IN LIEU OF STANDARD HEIGHT - ENSUITE 2 17Nov21 Note:	
1 - VANITY CABINETRY - RAISE VANITY TO 36" HIGH VANITY IN LIEU OF STANDARD HEIGHT - GUEST ENSUITE 17Nov21 Note:	
1 - VANITY CABINETRY - RAISE VANITY TO 36" HIGH VANITY IN LIEU OF STANDARD HEIGHT - ENSUITE 17Nov21 Note:	

CONSTRUCTION SUMMARY

Mountainview Heights 3 (G) - Russell Gardens Building Ltd.

PURCHASERS: Choudary SHABIR and Sofia SHABIR

TEL:

LOT / PHASE	REG. PLAN #	HOUSE TYPE		
604 / 4	62M-1266	Grandville Nine Elev 3		
1 - VANITY CABINETRY - RAISE VANITY TO 36" HIGH VANITY IN LIEU OF STANDARD HEIGHT - POWDER ROOM 17Nov21 Note:				
1 - KITCHEN CABINETRY BASE - PULLOUT RECYCLE 2 BIN - PRICE IS EACH 17Nov21 Note:				
2 - KITCHEN CABINETRY BASE - PULLOUT WIRE SPICE RACK - PRICE IS EACH 17Nov21 Note:				
1 - KITCHEN CABINETRY UPPER - FULL DEPTH ABOVE FRIDGE - WITH GABLES - 600MM - PRICE IS EACH - UPGRADE 3 17Nov21 Note:				
1 - KITCHEN CABINETRY - BUILT-IN MICROWAVE/OVEN COMBO - UPGRADE 3 17Nov21 Note:				
1 - KITCHEN CABINETRY BASE - COOKTOP CABINET WITH POT DRAWERS (2 DRAWERS) - UPGRADE 3 17Nov21 Note:				
1 - KITCHEN CABINETRY – MINI STACKED UPPER CABINETS – UPGRADE 3 CABINETRY 17Nov21 Note:				

CERAMIC TILE

1 - TILE - STANDARD WALL TILE - BATHROOM 5 - CEILING 07Dec21 Note:				
1 - TILE - STANDARD WALL TILE - BATHROOM 4 - CEILING 07Dec21 Note:				
1 - TILE - STANDARD WALL TILE - BATHROOM 3 - CEILING 07Dec21 Note:				
1 - TILE - STANDARD WALL TILE - BATHROOM 2 - CEILING 07Dec21 Note:				
1 - TILE - STANDARD WALL TILE - GUEST ENSUITE - CEILING 07Dec21 Note:				
1 - TILE - UPGRADE 4 WALL TILE - ENSUITE BATHROOM - CEILING 07Dec21 Note:				
1 - TILE - UPGRADE 1 FLOOR TILE - - LAUNDRY ROOM 17Nov21 Note:				
1 - TILE - UPGRADE 1 FLOOR TILE - GUEST ENSUITE - FLOOR AREA 17Nov21 Note:				
1 - TILE - UPGRADE 1 FLOOR TILE - - BATHROOM 5 - FLOOR 17Nov21 Note:				
1 - TILE - UPGRADE 1 FLOOR TILE - - BATHROOM 4 - FLOOR 17Nov21 Note:				
1 - TILE - UPGRADE 1 FLOOR TILE - - BATHROOM 3 - FLOOR 17Nov21 Note:				

CONSTRUCTION SUMMARY

Mountainview Heights 3 (G) - Russell Gardens Building Ltd.

PURCHASERS: Choudary SHABIR and Sofia SHABIR

TEL:

LOT / PHASE	REG. PLAN #	HOUSE TYPE		
604 / 4	62M-1266	Grandville Nine Elev 3		

1 - TILE - UPGRADE 1 FLOOR TILE - - BATHROOM 2 - FLOOR

17Nov21 Note:

1 - DELETE ALL CERAMIC BATHROOM ACCESSORIES - DELETE TOWEL BAR, PAPER HOLDER & SOAP DISH THROUGHOUT

17Nov21 Note:

1 - TILE - UPGRADE 4 FLOOR TILE - - ENSUITE BATHROOM - WALL

17Nov21 Note:

1 - TILE - UPGRADE 4 FLOOR TILE - - ENSUITE BATHROOM - FLOOR

17Nov21 Note:

1 - TILE - UPGRADE 4 FLOOR TILE - - POWDER ROOM

17Nov21 Note:

1 - TILE - UPGRADE 4 FLOOR TILE - - MUD ROOM

17Nov21 Note:

1 - TILE - UPGRADE 4 FLOOR TILE - - KITCHEN

17Nov21 Note:

1 - TILE - UPGRADE 4 FLOOR TILE - - FOYER

17Nov21 Note:

CONSTRUCTION

1 - LAUNDRY ROOM - EXTEND STANDARD CABINET, UNDERMOUNT SINK AND COUNTERTOP - REFER TO SKETCH

07Dec21 Note:

1 - WAFFLE CEILING - FAMILY ROOM

17Nov21 Note:

17Nov21 Note:

1 - PROVISION FOR SHAMPOO NICHE APPROX. 24" WIDE X 20" HIGH AS PER SKETCH - IF CONSTRUCTION PERMITS

17Nov21 Note: MASTER ENSUITE

1 - SMOOTH CEILINGS ON FIRST FLOOR ONLY - DET

17Nov21 Note:

COUNTER TOP

1 - KITCHEN COUNTER - BACKSPLASH

07Dec21 Note: INCLUDE FULL HEIGHT WALL BEHIND WINDOW

1 - KITCHEN COUNTER TOP

17Nov21 Note:

1 - COUNTERTOP CUTOUT PROVISION FOR COOKTOP

17Nov21 Note:

1 - GUEST ENSUITE VANITY COUNTER TOP

17Nov21 Note:

1 - ENSUITE BATHROOM VANITY COUNTER TOP

17Nov21 Note:

CONSTRUCTION SUMMARY

Mountainview Heights 3 (G) - Russell Gardens Building Ltd.

PURCHASERS: Choudary SHABIR and Sofia SHABIR

TEL:

LOT / PHASE	REG. PLAN #	HOUSE TYPE		
604 / 4	62M-1266	Grandville Nine Elev 3		
1 - ENSUITE BATHROOM 5 VANITY COUNTER TOP 17Nov21 Note:				
1 - ENSUITE BATHROOM 4 VANITY COUNTER TOP 17Nov21 Note:				
1 - ENSUITE BATHROOM 3 VANITY COUNTER TOP 17Nov21 Note:				
1 - ENSUITE BATHROOM 2 VANITY COUNTER TOP 17Nov21 Note:				
1 - SHAMPOO NICHE 24" WIDE X 20" HIGH AS PER SKETCH - MARBLE, GRANITE OR QUARTZ - IF CONSTRUCTION PERMITS - REQUIRES PROVISION FROM CONSTRUCTION 17Nov21 Note: SUPPLY & - MASTER ENSUITE				

DOORS AND TRIM

1 - ENSUITE BATHROOM 4 BASEBOARD AND 3" CASING 07Dec21 Note:	
1 - TRIM - UPGRADE 2- 7-1/4" BASEBOARD AND 3" CASING 17Nov21 Note:	

ELECTICAL

1 - PLUG - ROUGH-IN FOR ELECTRIC CAR PLUG IN GARAGE - FOR FUTURE ELECTRIC CAR - 240V / 40-50 AMPS 17Nov21 Note: SPECIFICATIONS REQUIRED	
--	--

ELECTRICAL

1 - KITCHEN - VALANCE LIGHTING - LED LIGHTING 07Dec21 Note:	
1 - BUILT IN OVEN AND COOKTOP PROVISION - PROVISION ONLY - ELECTRICAL ONLY 17Nov21 Note:	
7 - FAN - BATHROOM EXHAUST FAN - ENERGY STAR 80 CFM - IN LIEU OF STANDARD FAN 17Nov21 Note:	
1 - PLUG - ELECTRICAL PLUG WITH GFI AND SWITCH - FOR FESTIVE LIGHTING 17Nov21 Note:	
1 - PLUG - ELECTRICAL PLUG - TO BE INSTALLED APPROX. 5'-0" FROM THE FLOOR FOR A FUTURE WALL MOUNT TV 17Nov21 Note: MASTER BEDROOM - REFER TO SKETCH	
1 - PLUG - ELECTRICAL PLUG - TO BE INSTALLED OVER FIREPLACE 17Nov21 Note:	
1 - 200 AMP ELECTRICAL SERVICE 17Nov21 Note:	
1 - RELOCATE STANDARD KITCHEN LIGHT TO BE CENTERED OVER ISLAND 17Nov21 Note:	

FIREPLACE AND ACCESSORIES



CONSTRUCTION SUMMARY

Mountainview Heights 3 (G) - Russell Gardens Building Ltd.

PURCHASERS: Choudary SHABIR and Sofia SHABIR

TEL:

LOT / PHASE	REG. PLAN #	HOUSE TYPE		
604 / 4	62M-1266	Grandville Nine Elev 3		
1 - MANTEL - PAINTED - M 3 - IN LIEU OF STANDARD MANTEL 17Nov21 Note:				
1 - GAS LINE ROUGH-IN FOR BARBECUE - FIRST FLOOR 17Nov21 Note:				
1 - GAS LINE ROUGH-IN FOR STOVE (INCLUDES ELECTRICAL OUTLET) - FIRST FLOOR 17Nov21 Note:				

HARDWOOD FLOORING

1 - HARDWOOD - GROUP B SERIES 6 1/2 INCH - - UPPER HALL 17Nov21 Note:				
1 - HARDWOOD - GROUP B SERIES 6 1/2 INCH - IN LIEU OF 2 1/4 INCH NATURAL RED OAK - - DINING ROOM 17Nov21 Note:				
1 - HARDWOOD - GROUP B SERIES 6 1/2 INCH - IN LIEU OF 2 1/4 INCH NATURAL RED OAK - - FAMILY ROOM 17Nov21 Note:				
1 - HARDWOOD - GROUP B SERIES 6 1/2 INCH - IN LIEU OF 2 1/4 INCH NATURAL RED OAK - - LIBRARY/DEN 17Nov21 Note:				
1 - HARDWOOD - GROUP B SERIES 6 1/2 INCH - IN LIEU OF 2 1/4 INCH NATURAL RED OAK - - LIVING ROOM 17Nov21 Note:				
1 - HARDWOOD - GROUP B SERIES 6 1/2 INCH - IN LIEU OF 2 1/4 INCH NATURAL RED OAK - - MAIN HALL 17Nov21 Note:				

MIRRORS AND GLASS

1 - MASTER ENSUITE – FRAMELESS GLASS SHOWER ENCLOSURE – INCLUDES CHROME KNOB AND HINGES 17Nov21 Note:				
--	--	--	--	--

MISCELLANEOUS

1 - NO FURTHER CHANGES 15Dec21 Note:				
1 - GARAGE DOOR OPENER – LIFEMASTER 8355 WITH BELT DRIVE – INLCUDES 1 KEYPAD & 2 HANDHELD CONTROL 17Nov21 Note:				

PLUMBING

1 - KITCHEN – POT FILLER – DELTA CONTEMPORARY CHROME POT FILLER #1165LF 13Dec21 Note:				
7 - HOT WATER VALVE NEXT TO TOILET - PRICE IS EACH 07Dec21 Note: POWDER ROOM, GUEST ENSUITE, MASTER ENSUITE, ENSUITE 2,3,4&5				
7 - MOEN BATHROOM ACCESSORIES - MASON CHROME - TOWEL BAR 24" #YB8094/YB8000 - PRICE IS EACH 17Nov21 Note: POWDER GUEST ENSUITE MASTER ENSUITE BEDROOM 2,3,4,5				

CONSTRUCTION SUMMARY

Mountainview Heights 3 (G) - Russell Gardens Building Ltd.

PURCHASERS: Choudary SHABIR and Sofia SHABIR

TEL:

LOT / PHASE	REG. PLAN #	HOUSE TYPE		
604 / 4	62M-1266	Grandville Nine Elev 3		

7 - MOEN BATHROOM ACCESSORIES - MASON CHROME - PAPER HOLDER #YB8099/YB8000 - PRICE IS EACH 17Nov21 Note: POWDER GUEST ENSUITE MASTER ENSUITE BEDROOM 2,3,4,5	
1 - SINK - UNDERMOUNT SINK - BLANCO QUATRUS R15 U SUPER SINGLE #401518 17Nov21 Note:	
1 - MOEN BATHROOM ACCESSORIES - ROMAN TUB AND HANDHELD T991/9796 17Nov21 Note:	
5 - TOE TESTER - ADD TOE TESTER TO SHOWER 17Nov21 Note: GUEST ENSUITE MASTER ENSUITE ENSUITE 2,3, & 5	
8 - SINK - UNDERMOUNT SINK - CONTRAC EMERY #4220CGY 17Nov21 Note: GUEST ENSUITE POWDER MASTER ENSUITE X2 ENSUITE 2,3,4,5	
1 - WATER LINE FOR FRIDGE - ROUGH-IN ONLY 17Nov21 Note:	

PROMOTIONAL

1 - LESS BALANCE OF CREDIT FROM PURCHASER EXTRA SHEET IN OFFER 17Nov21 Note:	
---	--

STAIRS AND RAILINGS

1 - EUROLINE CONTEMPORARY PICKETS 17Dec21 Note:	
1 - ** DELETE ** EUROLINE R6-3 17Dec21 Note:	
1 - 4 X 4 POSTS 17Nov21 Note:	
1 - V GROOVE HANDRAIL 17Nov21 Note:	
1 - EUROLINE R6-3 17Nov21 Note:	
1 - STAINED STAIRS – STANDARD STAIRCASE - PRICE IS PER SET 17Nov21 Note:	

CONSTRUCTION SUMMARY

Mountainview Heights 3 (G) - Russell Gardens Building Ltd.

PURCHASERS: Choudary SHABIR and Sofia SHABIR

TEL:

LOT / PHASE 604 / 4	REG. PLAN # 62M-1266	HOUSE TYPE Grandville Nine Elev 3		
------------------------	-------------------------	--------------------------------------	--	--

EXTRAS AS PER OFFER

PURCHASER(S) ACKNOWLEDGES THAT THE PURCHASE PRICE IS INCLUSIVE OF ALL CREDITS AND PROMOTIONAL PACKAGES AVAILABLE AT TIME OF PURCHASE. <i>Worksheet Note:</i>	
Granite kitchen counter top, from Vendor?s standard samples <i>Worksheet Note:</i>	
(1) The Vendor agrees that notwithstanding any other term or provision in this Agreement included in the Purchase Price and in addition to those items detailed in Schedule GP to the Agreement of Purchase and Sale, the Purchaser is entitled to a credit of <i>Worksheet Note:</i>	
(8?6? Pour) If the Purchaser has purchased or been provided with an 8-foot 6-inch basement concrete pour (being an increase from the Vendor?s standard basement depth) the depth is measured from the top of footing to the top of foundation wall. The incre <i>Worksheet Note:</i>	
10 foot ceiling height on Main Level. The Purchaser acknowledges that as a result of the increased ceiling height from the Vendor?s standard ceiling height, various modifications to the interior and exterior of the dwelling unit may be made, including bu <i>Worksheet Note:</i>	
10 foot ceiling height on Upper Level. The Purchaser acknowledges that as a result of the increased ceiling height from the Vendors standard ceiling height, various modifications to the interior and exterior of the dwelling unit may be made, including bu <i>Worksheet Note:</i>	

This Document is Extremely Time Sensitive - Printed 17 Dec 21 at 16:22

Purchasers:Choudary SHABIR & Sofia SHABIR

Property: 604

Telephone Res. / Bus: /

Project: Russell Gardens Building Ltd.

Decor Advisor: Aly Aversa

Model and Elevation: Grandville Nine Elev 3

Lock Date: 17-Dec-21

17-Nov-21

Plan #: 62M-1266

Layout Changes: ☒ Yes ☐ No

Sketch Attached: ☒ Yes ☐ No

Exterior Colour Scheme:

1. Cabinetry

	Style and Colour	Hardware
Kitchen / Breakfast	LEGACY 701XZ4	722SC
Laundry Room	ELISSE	Standard
Powder Room	EVEREST WHITE CRYSTAL	431SA
Master Ensuite Bathroom	EVEREST WHITE CRYSTAL	431SA
Ensuite Bath - Bedroom 2	DORAL K43 SUMMIT WHITE	431SA
Ensuite Bath - Bedroom 3	DORAL H3078 HACIENDA WHITE	431SA
Ensuite Bath - Bedroom 4	DORAL K43 SUMMIT WHITE	431SA
Ensuite Bath - Bedroom 5	DORAL H3078 HACIENDA WHITE	431SA
Guest Ensuite	DORAL H3078 HACIENDA WHITE	431SA

Appliances:

Built In Appliances ☒ Yes ☐ No

Slide In Stove ☐ Yes ☒ No

Dishwasher Cabinet

☐ Closed ☒ Open

41" Upper Cabinets ☒ Yes ☐ No

Please NOTE: Standard Cabinet Height is 30"

Stove Opening

48

NOTE: If not specified, opening will be set to builder's standard opening of approximately 30" width

Fridge Opening

48

NOTE: If not specified, opening will be set to builder's standard opening of approximately 37" width x 74" height

\*\* Refer to Construction Summary

2. Counters

	Counter	Edge
Kitchen / Breakfast	GRANITE - WHITE ICE	#360 EDGE
Laundry Room	QUARTZ - CONTRACT GREY T503	#360 EDGE
Powder Room	GRANITE - DUKE WHITE	#360 EDGE
Master Ensuite Bathroom	GRANITE - DUKE WHITE	#360 EDGE
Ensuite Bath - Bedroom 2	QUARTZ - BELLAGIO T5R7	#360 EDGE
Ensuite Bath - Bedroom 3	QUARTZ - FUSION WHITE	#360 EDGE
Ensuite Bath - Bedroom 4	QUARTZ - BELLAGIO T5R7	#360 EDGE
Ensuite Bath - Bedroom 5	QUARTZ - TIVOLI T5R8	#360 EDGE
Guest Ensuite	QUARTZ - FUSION WHITE	#360 EDGE

\*\* Refer to Construction Summary \*\* MASTER ENSUITE: SHAMPOO NICHE: GRANITE - DUKE WHITE \*\*

Purchasers: Choudary SHABIR &amp; Sofia SHABIR

Property: 604

Telephone Res. / Bus: /

Project: Russell Gardens Building Ltd.

Decor Advisor: Aly Aversa

Model and Elevation: Grandville Nine Elev 3

Lock Date: 17-Dec-21

17-Nov-21

Plan #: 62M-1266

## 3. Ceramic Flooring

At a 45° Threshold-If App.

Entrance Vestibule	TILE - LITIUM SILVER POL 24X24	<input type="checkbox"/>	Metal Strip Where Applic.
Main Hall	HARDWOOD	<input type="checkbox"/>	
Kitchen / Breakfast	TILE - LITIUM SILVER POL 24X24	<input type="checkbox"/>	
Laundry Room	TILE - AXIS BIANCO 12X24	<input type="checkbox"/>	
Powder Room	TILE - LITIUM SILVER POL 24X24	<input type="checkbox"/>	
Master Ensuite Bathroom	TILE - TRAV. MEM GRIGIO 24X24	<input type="checkbox"/>	
Ensuite Bath - Bedroom 2	TILE - STONE BEIGE 12X24	<input type="checkbox"/>	
Ensuite Bath - Bedroom 3	TILE - STONE WHITE 12X24	<input type="checkbox"/>	
Ensuite Bath - Bedroom 4	TILE - STONE BEIGE 12X24	<input type="checkbox"/>	
Ensuite Bath - Bedroom 5	TILE - LIFE PEARL 12X24	<input type="checkbox"/>	
Mud Room	TILE - LITIUM SILVER POL 24X24	<input type="checkbox"/>	

\*\* Refer to Construction Summary \*\* GUEST ENSUITE - TILE - STONE WHITE 12X24 \*\*

## 4. Ceramic Wall Tile

Master Ensuite Bathroom	Selection	Describe
Tub Deck Wall	N/A	
Tub Deck	N/A	
Tub Deck Skirt	N/A	
Shower Stall	TILE - TRAV. MEM GRIGIO 12X24	Ceiling:Tile-Trav. Mem Grigio 24x24
Bathtub Enclosure Walls	N/A	
Ensuite Bath - Bedroom 2	TILE - EVERTON GREIGE 8X16	Ceiling:Tile-Everton Griega 8x16
Ensuite Bath - Bedroom 3	TILE - CONCEPT NEVE LUCIDO 8X16	Ceiling:Tile-Concept Neve Lucido 8x16
Ensuite Bath - Bedroom 4	TILE - EVERTON GREIGE 8X16	Ceiling:Tile-Everton Griega 8x16
Ensuite Bath - Bedroom 5	TILE - EVERTON STEEL 8X16	Ceiling:Tile-Everton Griega 8x16
Mud Room	N/A	
Kitchen Backsplash	GRANITE - WHITE ICE	

\*\* Refer to Construction Summary - STANDARD GROUT THROUGHOUT UNLESS SPECIFIED \*\* GUEST ENSUITE - TILE - CONCEPT NEVE LUCIDO 8X16 \*\* CEILING: TILE-CONCEPT NEVE LUCIDO 8X16

## 5. Plumbing Fixtures

All Bathrooms

White

Whirlpool

 ☐ Yes ☒ NoDishwasher Rough-In ☒ Yes ☐ NoWaterline for Fridge ☒ Yes ☐ No

\*\* Refer to Construction Summary

## 6. Trim Carpentry

Interior Doors	As Per Construction Specifications
Interior Trim	8050 CASING WITH 7 1/4" BASEBOARD - COLONIAL
Door Handles	As Per Construction Specifications
Exterior Front Door Handle	As Per Construction Specifications

\*\* Refer to Construction Summary

Initials: \_\_\_\_\_

Page 2 of 4



Purchasers:Choudary SHABIR & Sofia SHABIR

Property: 604

Telephone Res. / Bus: /

Project: Russell Gardens Building Ltd.

Decor Advisor: Aly Aversa

Model and Elevation: Grandville Nine Elev 3

Lock Date: 17-Dec-21

17-Nov-21

Plan #: 62M-1266

7. Other Flooring

Main Hall	HARDWOOD - MIRAGE - IMAGINE COLLECTION - DRIFTWOOD - RED OAK -CHARACTER CORK 6 1/2" DURAMAT	
Living Room	HARDWOOD - MIRAGE - IMAGINE COLLECTION - DRIFTWOOD - RED OAK -CHARACTER CORK 6 1/2" DURAMAT	
Dining Room	HARDWOOD - MIRAGE - IMAGINE COLLECTION - DRIFTWOOD - RED OAK -CHARACTER CORK 6 1/2" DURAMAT	
Family Room	HARDWOOD - MIRAGE - IMAGINE COLLECTION - DRIFTWOOD - RED OAK -CHARACTER CORK 6 1/2" DURAMAT	
Den / Library / Study	HARDWOOD - MIRAGE - IMAGINE COLLECTION - DRIFTWOOD - RED OAK -CHARACTER CORK 6 1/2" DURAMAT	
Basement Landing(If Applies)	N/A	
Lower Landing (If Applies)	N/A	
Upper Landing	HARDWOOD - MIRAGE - IMAGINE COLLECTION - DRIFTWOOD - RED OAK -CHARACTER CORK 6 1/2" DURAMAT	
Upper Hall	HARDWOOD - MIRAGE - IMAGINE COLLECTION - DRIFTWOOD - RED OAK -CHARACTER CORK 6 1/2" DURAMAT	
Master Bedroom	LAMINATE-LEXINGTON-ROCHEFORT OAK-TL-LW1317	
Bedroom #2	LAMINATE-LEXINGTON-ROCHEFORT OAK-TL-LW1317	
Bedroom #3	LAMINATE-LEXINGTON-ROCHEFORT OAK-TL-LW1317	
Bedroom #4	LAMINATE-LEXINGTON-ROCHEFORT OAK-TL-LW1317	
Bedroom #5	LAMINATE-LEXINGTON-ROCHEFORT OAK-TL-LW1317	
Guest Suite	HARDWOOD - MIRAGE - IMAGINE COLLECTION - DRIFTWOOD - RED OAK -CHARACTER CORK 6 1/2" DURAMAT	
Flex Room	HARDWOOD - MIRAGE - IMAGINE COLLECTION - DRIFTWOOD - RED OAK -CHARACTER CORK 6 1/2" DURAMAT	
Underpad	Type	Area
	N/A	

\*\* Refer to Construction Summary

8. Railings and Pickets

Railing Type	V-GROOVE w 4x4 POST	Complimenting Colour	MIRAGE - RED OAK - DRIFTWOOD
Picket Type	EUROLINE CONTEMPORARY	Complimenting Colour	BLACK
Stringer / Riser	AS PER CONSTRUCTION SPECIFICATIO	Complimenting Colour	MIRAGE - RED OAK - DRIFTWOOD
Treads	AS PER CONSTRUCTION SPECIFICATIO	Complimenting Colour	MIRAGE - RED OAK - DRIFTWOOD
Red Oak Stairs <input type="radio"/> Yes <input checked="" type="radio"/> No			

\*\* Refer to Construction Summary THE STAIN COLOURS OR FINISH AVAILABLE ON RISERS, TREADS, PICKETS AND RAILS (STAIRCASES), WILL NOT BE AN EXACT MATCH TO PREFINISHED HARDWOOD OR LAMINATE FLOORS.

9. Wall Paint Flat Finish

Main & Upper Hall	22 WARM GREY	Master Bedroom	22 WARM GREY
Living Room	22 WARM GREY	Bedroom #2	22 WARM GREY
Dining Room	22 WARM GREY	Bedroom #3	22 WARM GREY
Kitchen / Breakfast	22 WARM GREY	Bedroom #4	22 WARM GREY
Family Room	22 WARM GREY	Bedroom #5	22 WARM GREY
Powder Room	22 WARM GREY	Master Ensuite	22 WARM GREY
Laundry Room	22 WARM GREY	Ensuite Bath - Bedroom 2	22 WARM GREY
Den/Library	22 WARM GREY	Ensuite Bath - Bedroom 3	22 WARM GREY
Trim & Door Paint-Semi Gloss	BIRCH WHITE	Ensuite Bath - Bedroom 4	22 WARM GREY
		Ensuite Bath - Bedroom 5	22 WARM GREY
		Guest Bdrm & Ensuite	22 WARM GREY
Smooth Ceilings First Floor <input checked="" type="radio"/> Yes <input type="radio"/> No			

\*\* Refer to Construction Summary



Purchasers: Choudary SHABIR &amp; Sofia SHABIR

Property: 604

Telephone Res. / Bus: /

Project: Russell Gardens Building Ltd.

Decor Advisor: Aly Aversa

Model and Elevation: Grandville Nine Elev 3

Lock Date: 17-Dec-21

17-Nov-21

Plan #: 62M-1266

**10. Plaster Mouldings and Medallions**

Entrance Vestibule

Main Hall

Living Room

Dining Room

Family Room

Kitchen/Breakfast

Den/Library

Lower Landing

\*\* Refer to Construction Summary

**11. Fireplace**

Living Room

Purchased

As Per Plan

N/A

Family Room

Purchased

As Per Plan

N/A

Other Room - Specify

Purchased

As Per Plan

N/A

Fireplace Type

Mantle Type

Colour / Stain

Surround

Hearth

As Per Construction Specifications

MANTLE M3

AS PER CONSTRUCTION SPECIFICATIONS

NERO

N/A

\*\* Refer to Construction Summary

**12. Heating and Air Conditioning**

Air Conditioning

NO

Gas Provisions Dryer

NO

Gas Provisions Stove

YES

Gas Provisions Barbecue

YES

Comment

\*\* Refer to Construction Summary

**13. Electrical**

Plugs and Switches

☒ White

Standard

Hood Fan

PURCHASER TO SUPPLY AND INSTALL

Appliances

Built in Cooktop

Built in Oven

Above Kitchen Cabinet Light ☐ Yes ☒ NoBelow Kitchen Cabinet Light ☒ Yes ☐ No

Gas Stove

Microwave

☒ Yes ☐ No☒ Yes ☐ No☒ Yes ☐ No☒ Yes ☐ No

Dishwasher Rough-in

Yes

\*\* Refer to Construction Summary

**14. General Comments**

\*\* Refer to Construction Summary

**Disclaimers and Notes**

- 1) Colours of all materials are as close as possible to builder's selection, but not necessarily identical due to variances in manufacturing.
- 2) Any extras listed above are null and void unless accompanied by a separate invoice/amendment. Said invoice must be paid in full.
- 3) The Purchaser agrees that this colour selection is final and that no changes will be permitted, unless required by the Vendor.
- 4) The Purchaser acknowledges reading and accepting document which contains other miscellaneous disclaimers.
- 5) In the event of a conflict between the Standard Features schedule of the Agreement of Purchase and Sale and the Interior Colour Scheme, the Interior Colour Scheme shall prevail.

Signature: \_\_\_\_\_ Date: \_\_\_\_\_ Signature: \_\_\_\_\_ Date: \_\_\_\_\_

- Lot. 604
- Russell Gardens

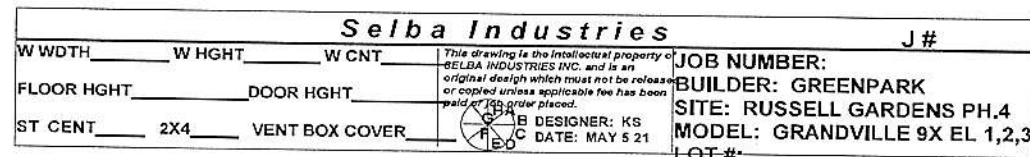

add plug (x1)

waffle ceiling

Center light to island

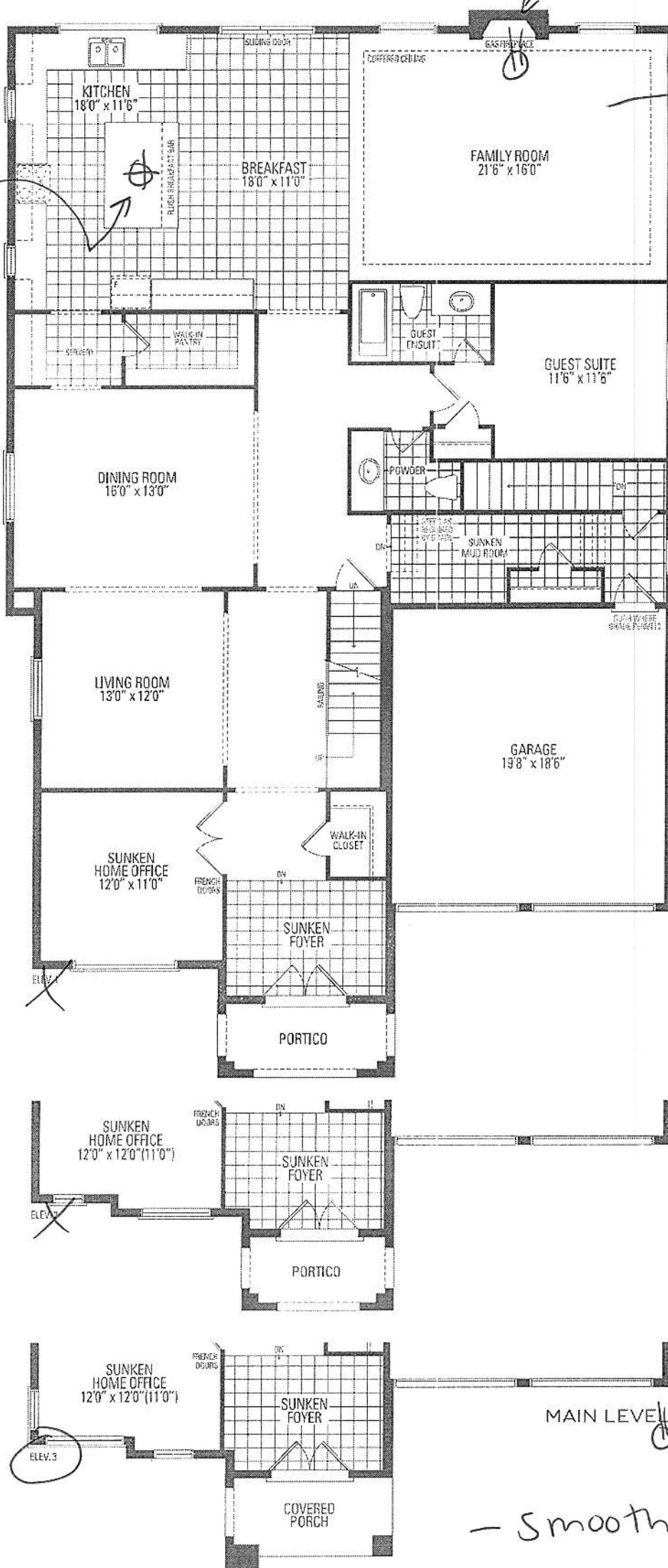

12

12

add festive plug

- smooth ceiling

# GRANDVILLE NINE

Orientation of home may be reversed and purchaser agrees to accept same stated floor areas. All renderings are artist's concept. Dimensions, specificat



✓



ing variance. Actual usable floor space may vary from the joining model types may vary due to siting. E. & O.E May 2021



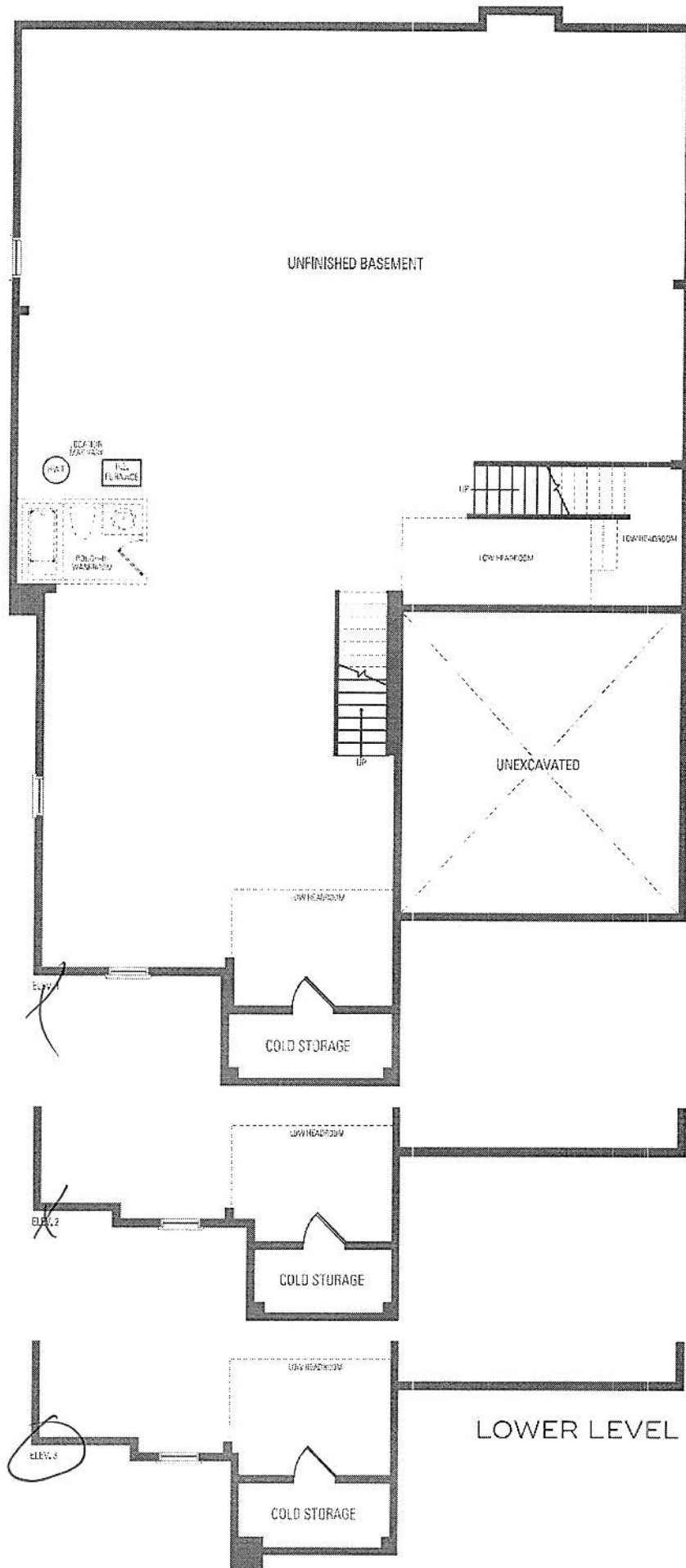

2

2

- 200 amp



604  
RUSSELL GARDENS  
PHASE 4  
MOUNTAINVIEW HEIGHTS

GRANDVILLE 9  
ELEV. 3

## REVISIONS

1. REMOVE LAUNDRY CURB
2. EXTEND COUNTER ACROSS WASHER DRYER



UPPER LEVEL

**DISCLAIMER:** SKETCH NOT TO SCALE. DIMENSIONS, SPECIFICATIONS AND ARCHITECTURAL DETAILS SUBJECT TO MODIFICATION BY THE VENDOR. SKETCH IS ONLY FOR THE PURPOSE OF ILLUSTRATING REVISIONS REQUESTED BY THE PURCHASER AND ALL REVISIONS ARE SUBJECT TO VENDOR'S FINAL APPROVAL. ONLY REVISIONS ACCEPTED IN WRITING BY THE PURCHASER AND VENDOR ON A PURCHASER'S EXTRA SHEET WILL BE INCORPORATED INTO THE PLANS FILED WITH THE MUNICIPALITY. E & OE

REGION  
DESIGN  
INC.

**Greenpark.**

...RICHARD GARDENS SPASGRANDVILLE Y LUT 641 641 641



Specifications for Project

## APPLIANCE SPEC

Location

Burlington

905-332-4264

**i REMINDER:** To ensure a smooth project it is the responsibility of the homeowner / purchaser of appliances for this project to share all the attached specifications to ensure the cabinet provider, contractor, or any other tradesperson have all the information required to complete their work accurately.

Specifications are subject to change. If any tradesperson has questions regarding the attached specifications please contact our sales associate.

Powered by SteelCod

APPLIANCE SPEC

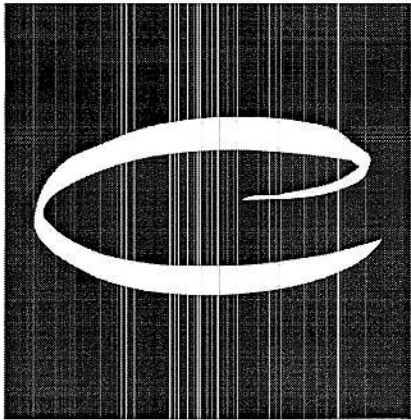

Coast Appliances  
coastappliances.com

katen kak  
Gen  
905-332-4264

Search 20211208223752477SC  
Version 1.1

Wed, Dec 8, 2021  
5:37 PM EST

To ensure a smooth project it is the responsibility of the homeowner / purchaser of appliances for this project to share all the attached specifications to ensure the cabinet provider, contractor, or any other tradesperson have all the information required to complete their work accurately.

Specifications are subject to change. If any tradesperson has questions regarding the attached specifications please contact our sales associate.



enterprise.steelcod.com/sp/csta/6IP6Z203

Models	Pages
<b>JS48NXFXDE</b> Jenn-Air Refrigeration	4-14
<b>JMC2430IM</b> Jenn-Air Wall Oven	15-23
<b>JJW2430IM</b> Jenn-Air Wall Oven	24-26
<b>JGCP548HM</b> Jenn-Air Rangetop	27-35
<b>EAR146S4</b> Elica Ventilation	36-37
<b>JDPSS246LM</b> Jenn-Air Dishwasher	38-40
<b>KRFC704FPS</b> KitchenAid Refrigeration	41-43
<b>KOCE500ESS</b> KitchenAid Wall Oven	44-45

**Note about page numbers:**  
Because the original manufacturer's documents are not altered in any way, the page numbers displayed on the page may not correspond to the page number within this package.

**All specifications are intended for initial planning purposes only.**  
Manufacturers reserve the right to change specifications at any time without notice. Always consult the installation instructions found on the manufacturer's website or included with the appliances before installation.

**KDTE204KPS**  
KitchenAid Dishwasher

46-50

**DTT36M876LS**  
Dacor Rangetop

51-53

**Note about page numbers:**  
Because the original manufacturer's documents are not altered in any way, the page numbers displayed on the page may not correspond to the page number within this package.

**All specifications are intended for initial planning purposes only.**  
Manufacturers reserve the right to change specifications at any time without notice. Always consult the installation instructions found on the manufacturer's website or included with the appliances before installation.



# 48" FULLY INTEGRATED BUILT-IN SIDE-BY-SIDE REFRIGERATOR

## Signature Features

### OBSIDIAN INTERIOR

Showcases food items throughout the refrigerator, and provides a sharper contrast than white interiors. Includes coordinating crisper drawers and freezer.

### FULLY INTEGRATED AND FLUSH DESIGN WITH ARTICULATING HINGE

Blends into custom cabinetry with a truly seamless appearance that ensures the opened door remains within the plane of surrounding cabinetry.

### PRECISION TEMPERATURE MANAGEMENT™ SYSTEM

A sensor-controlled system that uses a variable-speed compressor with an independent sensor in each compartment to monitor and adjust temperatures.

## Feature Listing

### PERFORMANCE FEATURES

#### Precision Temperature Management™ System

Capacitive Touch Controls with LED Display  
Pulsed Defrost  
Quiet Operation  
Sabbath Mode  
Star-K Certified

### CONTROL FEATURES

Max Cold Option  
Over Temp Alarm  
Door Open Alarm  
Water Filter with Replace Filter Indicator

### REFRIGERATOR FEATURES

#### Produce Preserver

Advanced Climate Control Drawer  
Soft, Auto-Close Crisper Drawers  
Gallon Door Storage Bin  
Adjustable Elegance Shelving  
Adjustable Door Bins with Metal Accents

### FREEZER FEATURES

Automatic Ice Maker with Storage Bin  
Adjustable Door Bins with Metal Accents

### DESIGN FEATURES

Obsidian Interior  
Fully Integrated and Flush Design with Articulating Hinge  
Multi-Point LED Theater Lighting  
Removable Base-Grille Water Filter  
90°/110° Door Stop Position

Four-Point Front Leveling

### OPTIONAL ACCESSORIES

48" Built-In Side By Side Panel RISE - JS48NXXFXDE - JBSFS48NHL  
Full Height Panel Kit (Euro-Style Stainless) - JBSFS48NHS  
Full Height Panel Kit (Pro-Style® Stainless) - JBSFS48NHP  
Pro-Style® Stainless Handle Kit - W10250643  
Euro-Style Stainless Steel Handle Kit - W10250640  
48" Armoire-Style Door Panel Kit - W10663565  
Handle Kit-JA,RISE,BIR,SxS (Qty=2 handles) - W11231243  
Handle Kit-JA,NOIR,BIR,SxS (Qty=2 handles) - W11194770  
EveryDrop® Filter by Whirlpool Water (Replacement Filter Cartridge) - EDR3RXD1  
Produce Preserver Keep Fresh Packet Refill - P1KC6R1  
Affresh™ Stainless Steel Cleaner, 16 oz. - W10355016  
48" Built-In Side By Side Panel NOIR - JS48NXXFXDE - JBSFS48NHL

## Specifications

Shipping Weight (lbs) 649  
Volts 115  
Amps 15-20  
Total Capacity (Cu. Ft. AHAM) 29.2  
Refrigerator Capacity (Cu. Ft. AHAM) 18.7  
Freezer Capacity (Cu. Ft. AHAM) 10.5

## Dimensions

JS48NXXFXDE

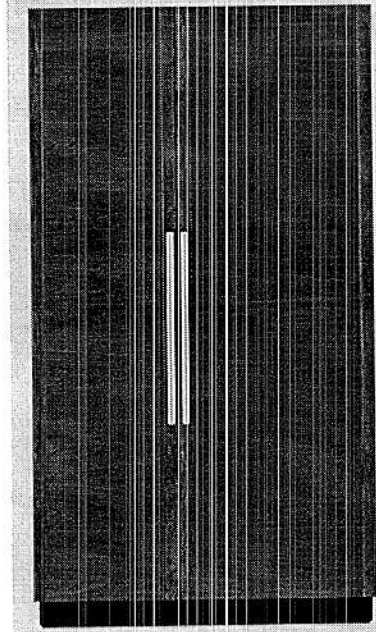

## Style Options

### RISE™

JS48NXXFXDE with JBSFS48NHL Kit

### EURO-STYLE

JS48NXXFXDE with JBSFS48NHS Kit

### BASE UNIT

JS48NXXFXDE

### PRO-STYLE®

JS48NXXFXDE with JBSFS48NHP Kit

### NOIR™

JS48NXXFXDE with JBSFS48NHL Kit

Overall Dimensions 47(3/4)" x 83(1/8)" x 24"  
Opening / Clearance Dimensions (Standard  
Flush Installation) 48" x 84" x 25"  
Opening / Clearance Dimensions (Retrofit  
Installation) 48" x 84" x 24"  
Do not make any cutouts based on this information



Bold = Top Features

JENNAIR®





# 48" FULLY INTEGRATED SIDE-BY-SIDE REFRIGERATOR

## DETAILED PLANNING DIMENSIONS GUIDE

(BASE UNIT REQUIRES SUITE-COORDINATING FULL HEIGHT PANEL KIT OR CUSTOM  
PANELS AND HANDLES)

70 1/2" (W) x 83 1/8" (H) x 24" (depth without door panels/handles)

### BASE UNIT + FULL HEIGHT PANEL KIT = FINISHED REFRIGERATOR

Easily transform these overlay refrigerators into one of our signature kitchen suite designs with one of our suite-coordinating stainless steel panel kits. To do so, you must order one of the overlay base units (left column) and one of the suite-coordinating panel kits. The kits include refrigerator and freezer door panels, air grille and pre-installed handles.

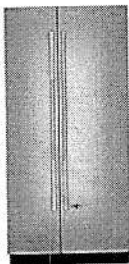
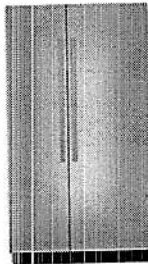
Base Unit Model Number	Coordinating Stainless Full Height Panel Kits			
	RISE™ Stainless		NOIR™ Stainless	
Side-by-Side JS48NXFXDE	JBSFS48NHL		JBSFS48NHM	

### OPTIONAL ACCESSORIES FOR CUSTOM OVERLAY DESIGNS

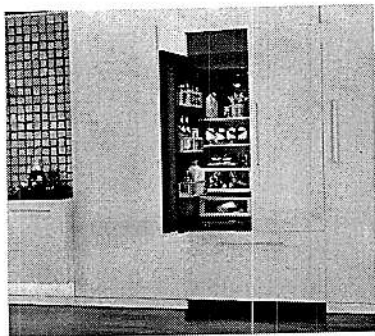

#### ARMOIRE-STYLE DOOR PANEL KIT W10663565 – 48" – Obsidian Interior

- For use with fully integrated and flush refrigerators
- Enables installation and proper venting of full height custom door panels (not included) that hide the top panel
- Includes left and right grille brackets and machine compartment cover

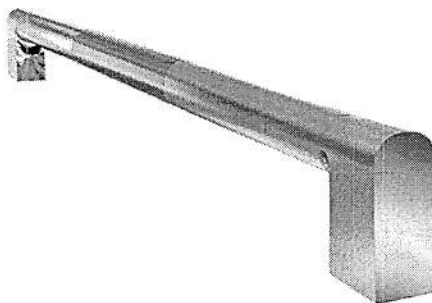

#### RISE™ STAINLESS HANDLE KIT W11231243 – 48" Side-by-Side

- For use with Custom Overlay fully integrated built-in refrigerators

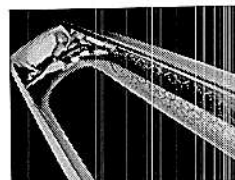

#### NOIR™ STAINLESS HANDLE KIT W11194770 – 48" Side-by-Side

- For use with Custom Overlay fully integrated built-in refrigerators

Because Whirlpool Corporation policy includes a continuous commitment to improve our products, we reserve the right to change materials and specifications without notice.

Dimensions are for planning purposes only. For complete details, see Installation Instructions packed with product. Specifications subject to change without notice.



# 48" FULLY INTEGRATED SIDE-BY-SIDE REFRIGERATOR

## DETAILED PLANNING DIMENSIONS GUIDE

(BASE UNIT REQUIRES SUITE-COORDINATING FULL HEIGHT PANEL KIT OR CUSTOM  
PANELS AND HANDLES)

48" (W) x 83 1/8" (H) x 24" (depth without door panels/handles)

### PRODUCT DIMENSIONS (INCLUDING STAINLESS STEEL DOOR PANEL KIT DIMENSIONS)

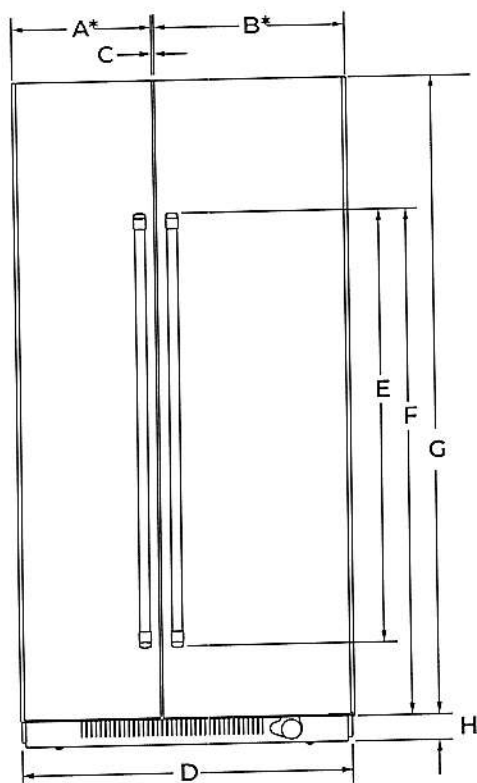

FRONT VIEW

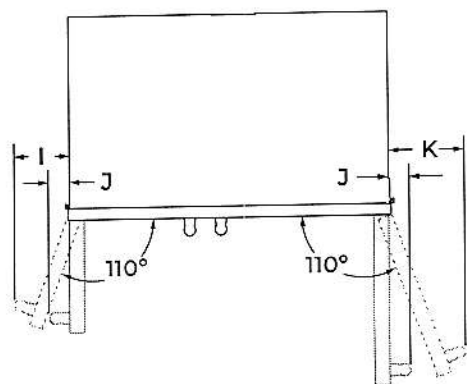

TOP VIEW

DIMENSION	DESCRIPTION	JS48NXFXIDE
A*	Width of freezer door	20 1/8" (51.6 cm)
B*	Width of refrigerator door	27 5/16" (69.4 cm)
C	Space between doors	1/8" (0.3 cm)
D	Overall width (including vinyl side trim)	47 3/4" (121.3 cm)
E	Height of door handle	
	RISE™ Stainless	58" (147.3 cm)
	NOIR™ Stainless	40 5/8" (103.2 cm)
F	Height to top of door handle	
	RISE™ Stainless	71 1/16" (182.1 cm)
	NOIR™ Stainless	69 1/16" (177.3 cm)
G	Height of door	81" (205.7 cm)
H	Height of bottom grille	3" (7.6 cm)
I	Width from side of refrigerator to freezer door handle - door fully open 110°	
	RISE™ Stainless	8 1/8" (20.7 cm)
	NOIR™ Stainless	7 5/8" (19.3 cm)
J	Width from side of refrigerator to handle - door open 90°	
	RISE™ Stainless	2 3/8" (6.1 cm)
	NOIR™ Stainless	1 5/8" (4.1 cm)
K	Width from side of refrigerator to refrigerator door handle - door fully open 110°	
	RISE™ Stainless	10 9/16" (26.8 cm)
	NOIR™ Stainless	10 1/16" (25.5 cm)

\*Door width dimensions are for stainless steel panel kit only.

Because Whirlpool Corporation policy includes a continuous commitment to improve our products, we reserve the right to change materials and specifications without notice.

Dimensions are for planning purposes only. For complete details, see Installation Instructions packed with product. Specifications subject to change without notice.



# 48" FULLY INTEGRATED SIDE-BY-SIDE REFRIGERATOR

## DETAILED PLANNING DIMENSIONS GUIDE

(BASE UNIT REQUIRES SUITE-COORDINATING FULL HEIGHT PANEL KIT OR CUSTOM  
PANELS AND HANDLES)

70" (W) x 83 1/8" (H) x 24" (depth without door panels/handles)

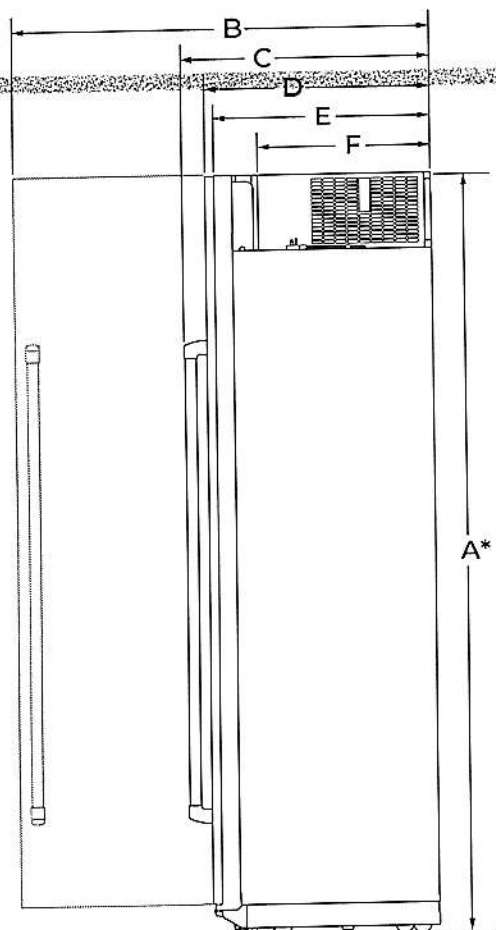

SIDE VIEW

DIMENSION	DESCRIPTION	JS48NFXDE
A*	Height of recessed refrigerator (min.)	83 1/8" (211.1 cm)
B	Depth with refrigerator door open 90° (min.)	50 3/4" (128.8 cm)
C	Depth with handles (min.)	
	RISE™ Stainless	27 1 1/16" (70.2 cm)
	NOIR™ Stainless	26 7/8" (68.2 cm)
D	Depth with doors (min.)	
	RISE™ Stainless	24 3/4" (62.8 cm)
	NOIR™ Stainless	24 3/4" (62.8 cm)
	Custom panel (3/4"/1.9 cm)	24 3/4" (62.8 cm)
E	Depth without door panel kit (min.)	24" (61 cm)
F	Depth of compressor cover (min.)	19 7/8" (50.5 cm)

\*Add 1 1/4" (3.2 cm) to the height dimension when leveling legs are fully extended.

Because Whirlpool Corporation policy includes a continuous commitment to improve our products, we reserve the right to change materials and specifications without notice.

Dimensions are for planning purposes only. For complete details, see Installation Instructions packed with product. Specifications subject to change without notice.



# 48" FULLY INTEGRATED SIDE-BY-SIDE REFRIGERATOR

## DETAILED PLANNING DIMENSIONS GUIDE

(BASE UNIT REQUIRES SUITE-COORDINATING FULL HEIGHT PANEL KIT OR CUSTOM PANELS AND HANDLES)

48" (W) x 83 1/8" (H) x 24" (depth without door panels/handles)

### AIRFLOW VENTING RECOMMENDATIONS

### CLOSED SOFFIT CABINET

### OPEN TO CEILING OR SOFFIT CABINET

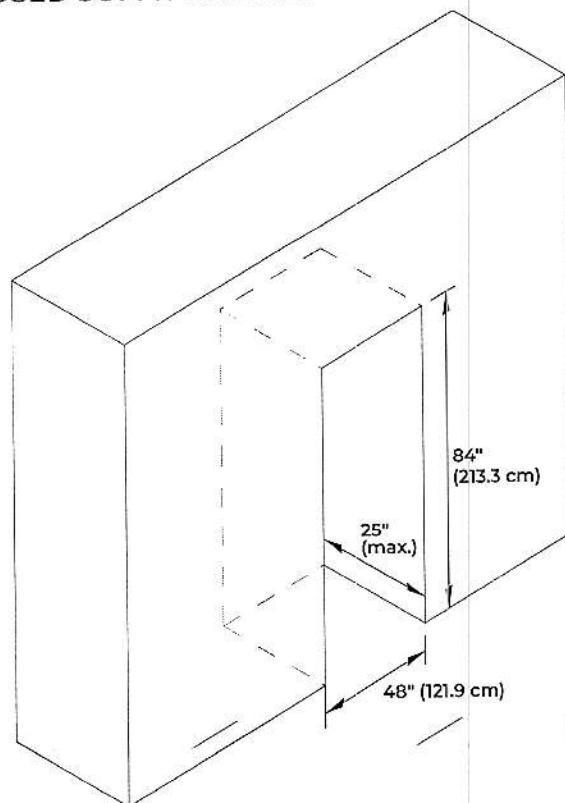
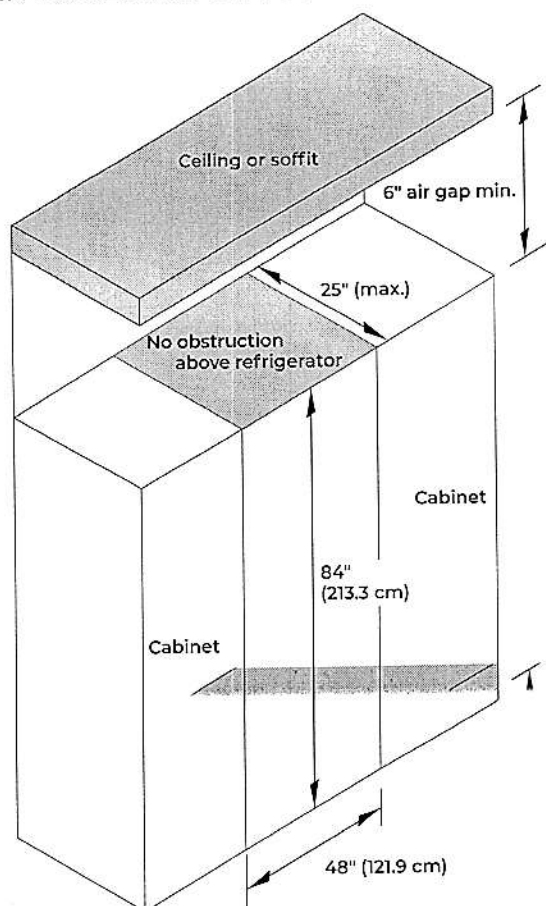

- These type of installations require a minimum of 6" (15.24 cm) of open space above the refrigerator. This space must not be blocked in any way, including soffits.
- Depth of cabinet must be less than 25" (63.5 cm).
- If your opening does not meet these requirements, you will need to make modifications.

- Depth of cabinet must be less than 25" (63.5 cm).
- Height of soffit must not exceed 84" (213.3 cm).
- Following illustrations explain the cabinet construction (soffit and rear wall positions) required for optimum ventilation and airflow.

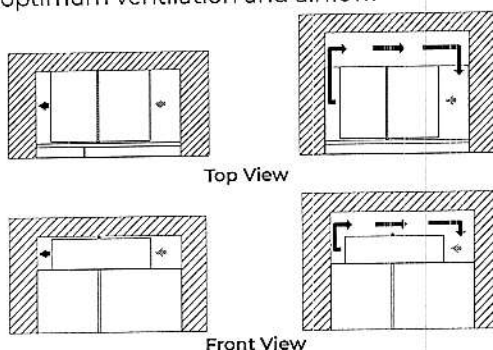

Grey arrow = ambient air; Black arrow = warm air  
Cabinet depth 25" and soffit located at 84", provides proper airflow/ventilation to the refrigerator. Efficient cooling is achieved.  
Cabinet depth more than 25" and/or soffit located at more than 84", causes air gap at back and/or top of the refrigerator. Air gap allows warm air recirculation causing loss in cooling efficiency.

- If your opening does not meet these requirements, you will need to make modifications.

Because Whirlpool Corporation policy includes a continuous commitment to improve our products, we reserve the right to change materials and specifications without notice.

Dimensions are for planning purposes only. For complete details, see Installation Instructions packed with product. Specifications subject to change without notice.



# 48" FULLY INTEGRATED SIDE-BY-SIDE REFRIGERATOR

## DETAILED PLANNING DIMENSIONS GUIDE

(BASE UNIT REQUIRES SUITE-COORDINATING FULL HEIGHT PANEL KIT OR CUSTOM  
PANELS AND HANDLES)

7 1/2" (W) x 83 1/8" (H) x 24" (depth without door panels/handles)

### CLEARANCE DIMENSIONS

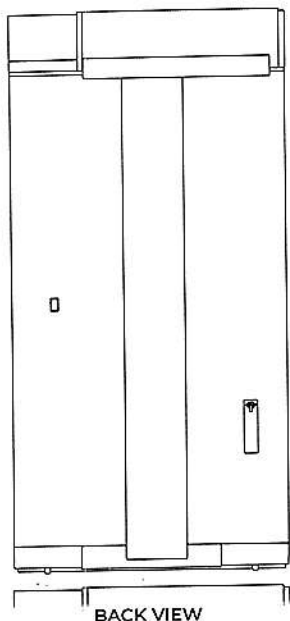
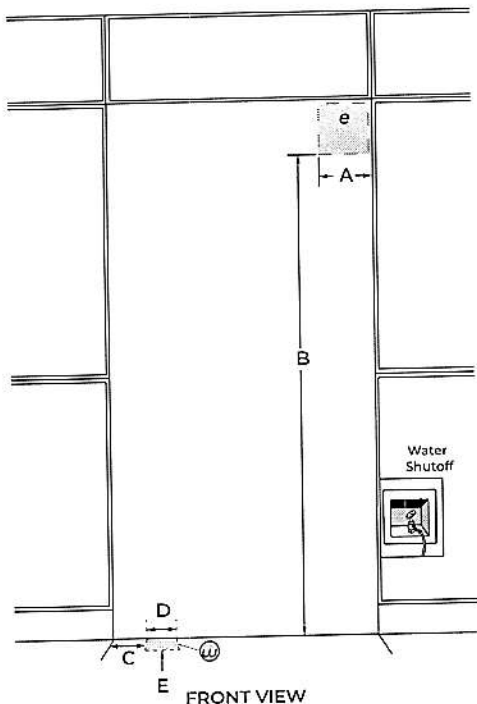

DIMENSION	DESCRIPTION	JF42NFXDE
A	Width of recommended electrical location	7 1/2" (19.1 cm)
B	Height to recommended electrical location	77" (195.6 cm)
C	Distance from side of cabinet to recommended water connection location	6 1/2" (16.5 cm)
D	Width of recommended water location	1 1/2" (3.81 cm)
E	Depth of recommended water connection location (max.)	2" (5 cm)
e	Recommended electrical connection location	
w	Recommended water connection location	

\*A minimum 2" (5.1 cm) furniture return must extend behind the face of the cabinet on all sides.

Because Whirlpool Corporation policy includes a continuous commitment to improve our products, we reserve the right to change materials and specifications without notice.

Dimensions are for planning purposes only. For complete details, see Installation Instructions packed with product. Specifications subject to change without notice.

ELECTRICAL REQUIREMENTS

**⚠ WARNING**



**Electrical Shock Hazard**

Plug into a grounded 3 prong outlet.

Do not remove ground prong.

Do not use an adapter.

Do not use an extension cord.

Failure to follow these instructions can result in death, fire, or electrical shock.

115 V, 60 Hz, AC only, 15 A or 20 A fused, grounded circuit is required. A dedicated circuit is recommended. Use an outlet that cannot be turned off by a switch. Do not use an extension cord.

WATER PRESSURE REQUIREMENTS

A cold water supply with water pressure between 30 psi and 120 psi (207 kPa and 827 kPa) is required to operate the ice maker. Call a licensed, qualified plumber with any questions about the water pressure.

Reverse Osmosis Water Supply

**IMPORTANT:** The pressure of the water coming out of a reverse osmosis system going to the water inlet valve of the refrigerator needs to be between 30 psi and 120 psi (207 kPa and 827 kPa).

If a reverse osmosis water filtration system is connected to the cold water supply, the water pressure to the reverse osmosis system needs to be a minimum of 40 psi to 60 psi (276 kPa to 414 kPa).

LOCATION REQUIREMENTS

**⚠ WARNING**



**Explosion Hazard**

Keep flammable materials and vapors, such as gasoline, away from refrigerator.

Failure to do so can result in death, explosion, or fire.

Floor must be able to support refrigerator (more than 600 lb [272 kg]), door panels and contents of the refrigerator and must be at the same level as flooring in the room.



SITE PREPARATION

INSTALLATION REQUIREMENTS

PLAN THE INSTALLATION

IMPORTANT:

- Install the handles on the panels prior to panel installation. Follow the instructions received with handle kit to install the handles.
- Plan your installation using these instructions in conjunction with the Installation Instructions must be made to the refrigerator to accommodate the Armoire-style door panels.

Required parts

- One of the following built-in refrigerator models:
    - 42" Side-by-Side: JS42NXFXDE
    - 48" Side-by-Side: JS48NXFXDE
    - 36" Bottom Mount: JB36NXFXLE, JB36NXFXRE
    - 36" French Door Bottom Mount: JF36NXFXDE
    - 42" French Door Bottom Mount: JF42NXFXDE
  - Accessory Armoire-Style Door Panel Kit which includes (Grille Assembly and Grille Bracket Assembly)
  - Custom Panels
- NOTE:** The required thickness for all panels is 3/4" (1.91 cm).

OPENING REQUIREMENTS

IMPORTANT:

- The width of the opening, from side to side, must be as specified for your model, for at least 3" (7.62 cm) back from the face of the cabinet. If your opening does not meet this requirement, you will need to make modifications.
- The depth of the opening from the front of the cabinet to the back wall must be 25" (63.5 cm) minimum to achieve a flush installation.

CABINET AND PANEL INSTALLATION OPTIONS

Cabinet Depth - 25" (63.5 cm)

Grille Bracket - Top View

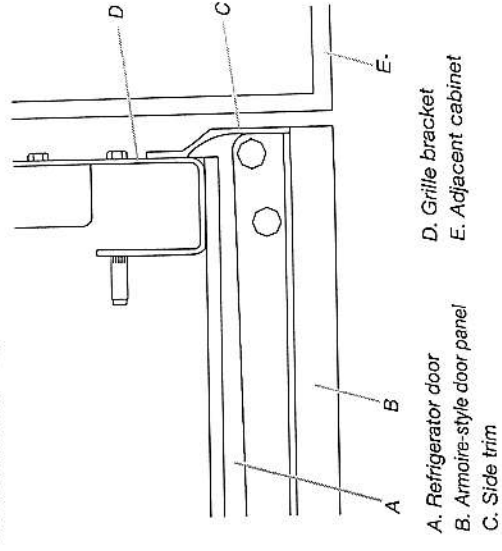

Grille Bracket - Side View

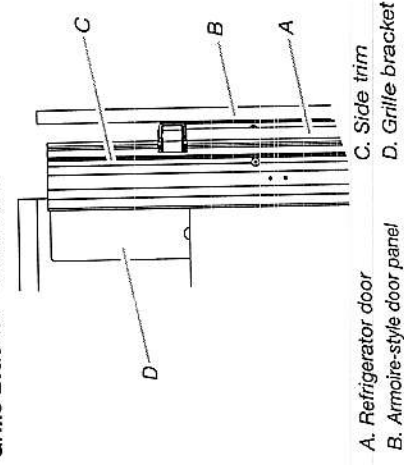

# SITE PREPARATION

## CABINET CUTOOUT OPTIONS

### AIRFLOW VENTING RECOMMENDATIONS

#### IMPORTANT:

- Armoire-style installations recommends a minimum of 1/8" (3.2 mm) of open space above the refrigerator. It is recommended that this space not be blocked in any way, including soffits.
- Models may be installed using either Option 1, Option 2 or option 3.

Option 1 - Open to Ceiling

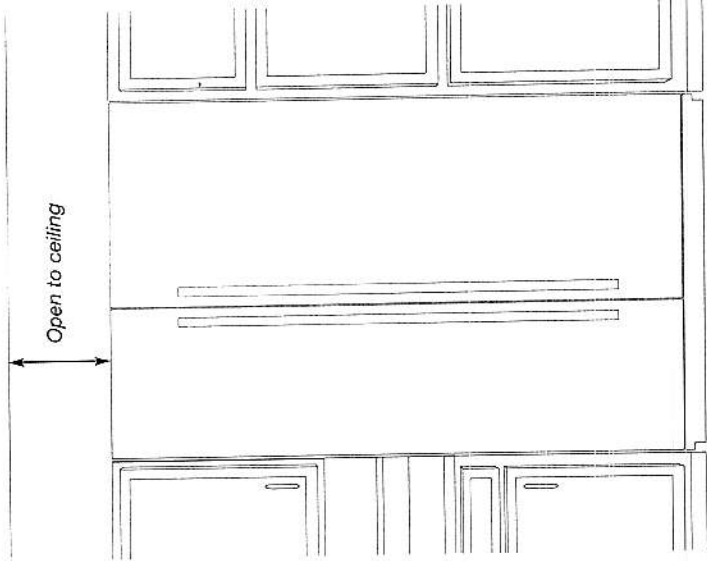

Option 2 - False Front (cabinet face only)

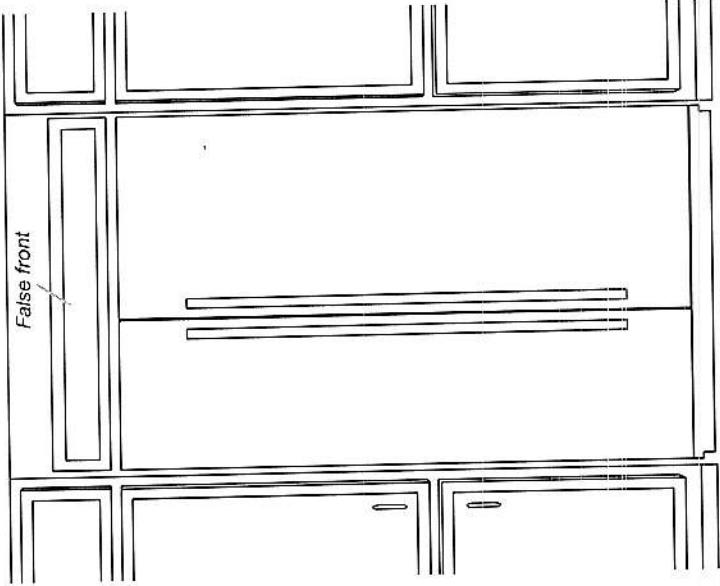

Option 3 - Closed Soffit

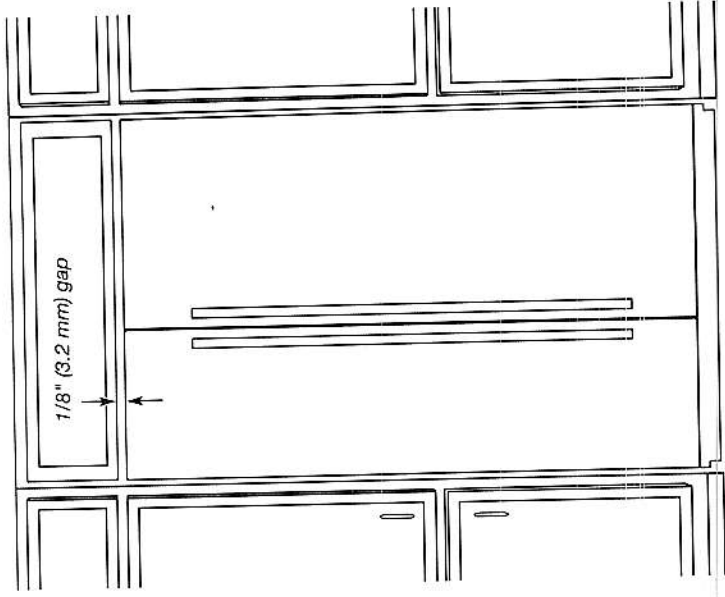

SITE PREPARATION

PANEL DIMENSIONS

BOTTOM MOUNT MODEL

Maximum allowable weights:

- Door panel - 60 lbs (27.2 kg)
- Drawer panel - 25 lbs (11.3 kg)

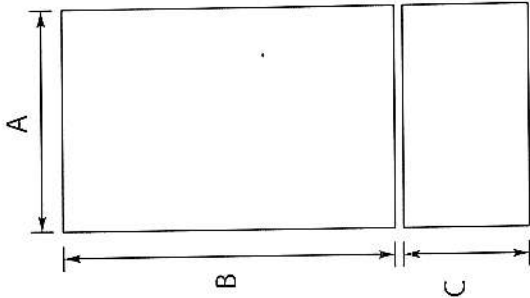

Legend	Model	Dimension
A	36"	35 <sup>3</sup> / <sub>4</sub> " (90.81 cm)
B	36"	59 <sup>1</sup> / <sub>8</sub> " (150.2 cm)
C	36"	20 <sup>1</sup> / <sub>2</sub> " (52.07 cm)

FRENCH DOOR BOTTOM MOUNT MODELS

Maximum allowable weights:

- Door panel - 38 lbs (17.2 kg)
- Drawer panel (36" model) - 25 lbs (11.3 kg)
- Drawer panel (42" model) - 30 lbs (13.6 kg)

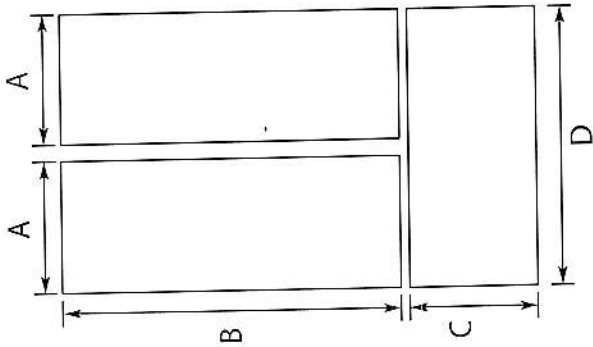

Legend	Model	Dimension
A	36"	17 <sup>3</sup> / <sub>4</sub> " (45.24 cm)
B		59 <sup>1</sup> / <sub>8</sub> " (150.2 cm)
C		20 <sup>1</sup> / <sub>2</sub> " (52.07 cm)
D		35 <sup>3</sup> / <sub>4</sub> " (90.81 cm)
A	42"	20 <sup>3</sup> / <sub>4</sub> " (52.86 cm)
B		59 <sup>1</sup> / <sub>8</sub> " (150.2 cm)
C		20 <sup>1</sup> / <sub>2</sub> " (52.07 cm)
D		41 <sup>3</sup> / <sub>4</sub> " (106.05 cm)

SIDE BY SIDE MODELS

Maximum allowable weights (42" models):

- Refrigerator Door panel - 65 lbs (29.5 kg)
- Freezer Door panel - 49 lbs (22.2 kg)

Maximum allowable weights (48" models):

- Refrigerator Door panel - 66 lbs (29.9 kg)
- Freezer Door panel - 50 lbs (23 kg)

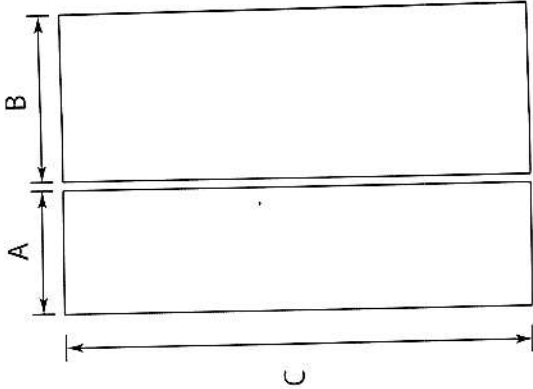

Legend	Model	Dimension
A	42"	17 <sup>3</sup> / <sub>4</sub> " (45.24 cm)
B		23 <sup>3</sup> / <sub>4</sub> " (60.48 cm)
C		81" (205.7 cm)
A	48"	20 <sup>1</sup> / <sub>4</sub> " (51.59 cm)
B		27 <sup>1</sup> / <sub>4</sub> " (69.37 cm)
C		81" (205.7 cm)

JennAir® NOIR™ 30" BUILT-IN MICROWAVE  
OVEN WITH SPEED-COOK

JMC2430IM

Available Finishes/Colours

JMC2430IM  
FA

Let your appetite run wild with microwave and convection energy. With curated recipes and full-color doneness images, an intelligent culinary experience awaits your touch.

Top Features

4.3-Inch Full Color LCD Display

Seamless Touches

Stainless Steel Microwave Interior

Manuals & Literature:

 [Use and Care](#)  [Installation Instructions](#)

 [Warranty](#)



Because Whirlpool Corporation policy includes a continuous commitment to improve our products, we reserve the right to change materials and specifications without notice. Dimensions are for planning purposes only. For complete details, see Installation Instructions packed with product. Specifications subject to change without notice.

# INSTALLATION REQUIREMENTS

## Tools and Parts

Gather the required tools and parts before starting installation. Read and follow the instructions provided with any tools listed here.

### Tools Needed

- Phillips screwdriver
- Flat-blade screwdriver
- Measuring tape
- Level
- Drill (for wall cabinet installations)
- 1/8" (3 mm) drill bit (for wall cabinet installations)
- 1" (2.5 cm) drill bit (for wall cabinet installations)

### Parts Needed

- UL listed or CSA approved conduit connector
- UL listed wire connectors

### Parts Needed – Flush Installation

- W10801485 Stainless steel flush installation kit for 27" (68.6 cm) models
- W10801486 Stainless steel flush installation kit for 30" (76.2 cm) models
- W10801487 Black flush installation kit for 30" (76.2 cm) models

To order, see the "Assistance or Service" section of the Use and Care Guide.

### Parts Supplied

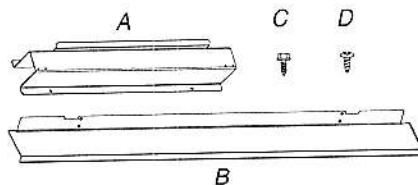

- A. Spacer bars (2)
- B. Bottom vent (1)
- C. 3/8" (9.5 mm) hex-head washer screws (4)
- D. 3/4" (1.9 cm) pan-head screws (4)

Check local codes. Check existing electrical supply. See "Electrical Requirements."

It is recommended that all electrical connections be made by a licensed, qualified electrical installer.

## Location Requirements

**IMPORTANT:** Observe all governing codes and ordinances.

- Cabinet opening dimensions that are shown must be used. Given dimensions provide minimum clearance with microwave oven.
- Recessed installation area must provide complete enclosure around the recessed portion of the microwave oven.
- Grounded electrical supply is required. See "Electrical Requirements" section.
- Electrical supply junction box should be located 3" (7.6 cm) maximum below the support surface when the microwave oven is installed in a wall cabinet. A 1" (2.5 cm) minimum diameter hole should have been drilled in the left rear corner of the support surface to pass the appliance cable through to the junction box.

- For installation above single built-in oven, the junction box must located inside upper cabinet.
- If you are installing the junction box on rear wall behind the microwave oven, the junction box must be recessed and located in the upper or lower right or left corner of the cabinet; otherwise, the microwave oven will not fit into the cabinet opening.
- Microwave oven support surface must be solid, level, and flush with bottom of cabinet cutout. Floor must be able to support a weight of 108 lbs (49.0 kg).

**IMPORTANT:** To avoid damage to your cabinets, check with your builder or cabinet supplier to make sure that the materials used will not discolor, delaminate, or sustain other damage. This oven has been designed in accordance with the requirements of UL and CSA International and complies with the maximum allowable wood cabinet temperatures of 194°F (90°C).

### Product Dimensions

#### 27" (68.6 cm) and 30" (76.2 cm) Microwave Ovens

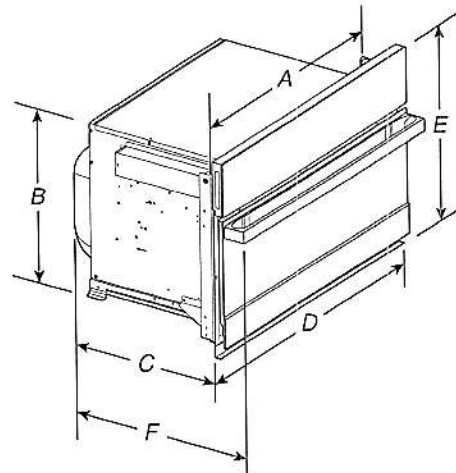

#### 27" (68.6 cm) models

- A. 25<sup>3</sup>/<sub>8</sub>" (64.5 cm)
- B. 17<sup>3</sup>/<sub>8</sub>" (44.1 cm)
- C. 22<sup>1</sup>/<sub>16</sub>" (57.7 cm)
- D. 26<sup>3</sup>/<sub>4</sub>" (68.0 cm) overall width
- E. 19<sup>7</sup>/<sub>8</sub>" (50.3 cm) overall height
- F. JMC2427IM: 25<sup>3</sup>/<sub>16</sub>" (64.9 cm)  
JMC2427IL: 24<sup>3</sup>/<sub>4</sub>" (62.9 cm)

#### 30" (76.2 cm) models

- A. 28<sup>3</sup>/<sub>8</sub>" (72.1 cm)
- B. 17<sup>3</sup>/<sub>8</sub>" (44.1 cm)
- C. 22<sup>1</sup>/<sub>16</sub>" (57.7 cm)
- D. 29<sup>3</sup>/<sub>4</sub>" (75.6 cm) overall width
- E. 19<sup>7</sup>/<sub>8</sub>" (50.3 cm) overall height
- F. JMC2430IM: 25<sup>3</sup>/<sub>16</sub>" (64.9 cm)  
JMC2430IL: 24<sup>3</sup>/<sub>4</sub>" (62.9 cm)

#### 27" (68.6 cm) and 30" (76.2 cm) Microwave Oven Spacer Kit

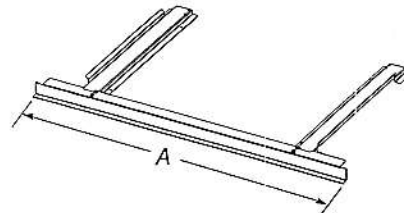

#### 27" (68.6 cm) models

- A. 26<sup>3</sup>/<sub>4</sub>" (67.9 cm) overall width

#### 30" (76.2 cm) models

- A. 29<sup>3</sup>/<sub>4</sub>" (75.6 cm) overall width

**NOTE:** The microwave oven spacer kit will allow the microwave oven to be installed in a 17<sup>3</sup>/<sub>8</sub>" to 17<sup>3</sup>/<sub>4</sub>" (44.1 to 45.1 cm) maximum cutout height.

# **INSTALLATION INSTRUCTIONS** **27" (68.6 CM) AND 30" (76.2 CM) ELECTRIC** **BUILT-IN MICROWAVE OVEN FLUSH** **INSTALLATION KIT** **INSTRUCTIONS D'INSTALLATION** **POUR ENSEMBLE D'INSTALLATION EN** **AFFLEUREMENT DE FOUR À MICRO-ONDES** **ÉLECTRIQUE ENCASTRÉ DE 27" (68,6 CM)** **ET 30" (76,2 CM)**

27" (68.6 cm) Flush Installation Kits  
 Ensembles d'installation en affleurement de 27" (68,6 cm)

	Stainless Steel Acier inoxydable	Stainless Steel/ Acier inoxydable, RISE™/NOIR™
Model#/ Modèle n°	Kit PN/ Ensemble référence: W10801485	Kit PN/ Ensemble référence: W11358283
JMC2427DS	★★	*
JMC2427IM, JMC2427IL	*	★★

30" (76.2 cm) Flush Installation Kits  
 Ensembles d'installation en affleurement de 30" (76,2 cm)

	Black Noir	Stainless Steel/ Acier inoxydable	Stainless Steel/ Acier inoxydable, RISE™/NOIR™
Model#/ Modèle n°	Kit PN/ Ensemble référence: W10801487	Kit PN/ Ensemble référence: W10801486	Kit PN/ Ensemble référence: W11358282
JMC2430DB	★★	*	*
JMC2430DP, JMC2430DS	*	★★	*
JMC2430IM, JMC2430IL	*	*	★★

- \* Approved for use.  
 \*\* Recommended color and approved for use.  
 \* Approuvé pour l'utilisation.  
 \*\* Couleur recommandée et approuvé pour l'utilisation.

## **Table of Contents/Table des matières**

<b>BUILT-IN MICROWAVE OVEN SAFETY</b> .....	2	<b>SÉCURITÉ DU FOUR À MICRO-ONDES ENCASTRÉ</b> .....	5
<b>INSTALLATION REQUIREMENTS</b> .....	2	<b>EXIGENCES D'INSTALLATION</b> .....	5
Tools and Parts.....	2	Outillage et pièces.....	5
Location Requirements.....	2	Exigences d'emplacement.....	5
<b>INSTALLATION INSTRUCTIONS</b> .....	4	<b>INSTRUCTIONS D'INSTALLATION</b> .....	7
Prepare Built-In Oven.....	4	Assemblage de la trousse d'entretoise.....	7
Install Spacer Kit.....	4	Installation de la trousse d'entretoise.....	7
Install Microwave Oven.....	4	Installation du four à micro-ondes.....	7
Complete Installation.....	4	Achever l'installation.....	7

### **IMPORTANT:**

Save for local electrical inspector's use.

### **IMPORTANT:**

À conserver pour consultation par l'inspecteur local des installations électriques.

W11356316A

In some European factories the letter "W" of the part code mentioned herein will be automatically  
 replaced by the number "4000" (e.g. "W12345678" becomes "400012345678")



### Cabinet Dimensions - Flush Installation

A 23 1/4" (59 cm) minimum cutout depth is required. These dimensions will result in a 1/4" (6.3 mm) reveal on the top, a 1/4" (6.3 mm) reveal on the sides, and a 1/8" (3.1 mm) reveal on the bottom of the microwave oven. The front face of the cleats and platform will be visible and should be treated as a finished surface.

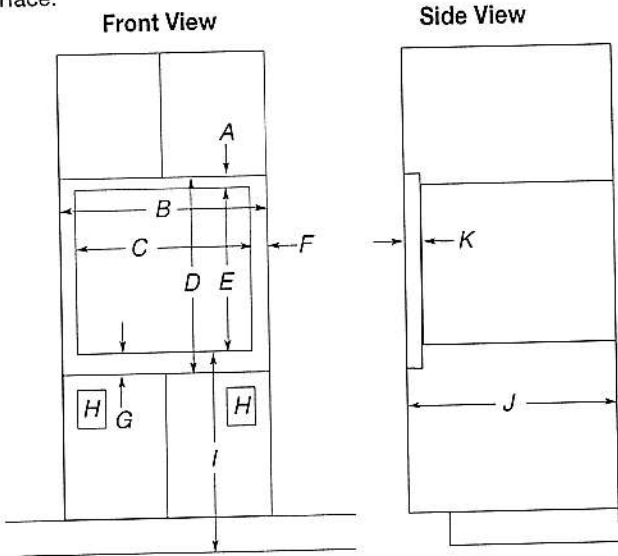

#### 27" (68.6 cm) Models

- A. 1 3/16" (4.7 cm) top cleat\*
- B. 27 1/4" (69.2 cm) minimum width of flush inset cutout
- C. 25 7/8" (65.7 cm) minimum width of opening
- D. 20 9/16" (51.3 cm) minimum height of flush inset cutout
- E. 17 5/8" (44.7 cm) recommended cutout height
- F. 1 1/16" (1.7 cm) side cleat\*
- G. 3/4" (1.9 cm) bottom cleat\*
- H. Recommended junction box location
- I. 40" (101.6 cm) bottom of cutout to floor (recommended)
- J. 23 1/4" (59.0 cm) minimum depth of cutout
- K. 1 3/8" (3.5 cm) recess from front of cabinet

#### 30" (76.2 cm) Models

- A. 1 3/16" (4.7 cm) top cleat\*
- B. 30 1/4" (76.8 cm) minimum width of flush inset cutout
- C. 28 7/8" (70.8 cm) minimum width of opening
- D. 20 9/16" (51.3 cm) minimum height of flush inset cutout
- E. 17 5/8" (44.7 cm) recommended cutout height
- F. 1 1/16" (1.7 cm) side cleat\*
- G. 3/4" (1.9 cm) bottom cleat\*
- H. Recommended junction box location
- I. 40" (101.6 cm) bottom of cutout to floor (recommended)
- J. 23 1/4" (59.0 cm) minimum depth of cutout
- K. 1 3/8" (3.5 cm) recess from front of cabinet

\*Cleats must be recessed 1 3/8" (3.5 cm) from the front of the cabinet.

### Minimum Installation Clearances

For proper installation, the following minimum clearances must exist below the cabinet opening.

#### Installation Above Single Built-In Oven

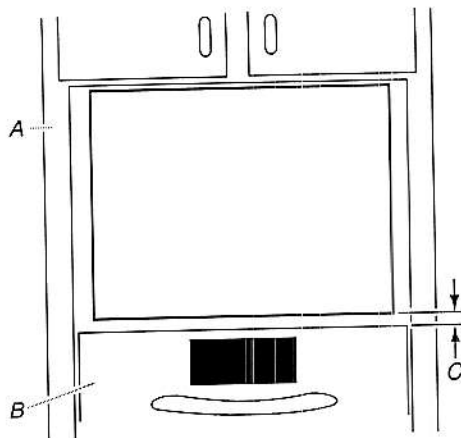

- A. Upper cabinet
- B. Lower single oven\*
- C. 1" (2.5 cm) from top of oven

# INSTALLATION REQUIREMENTS

## Tools and Parts

Gather the required tools and parts before starting installation. Read and follow the instructions provided with any tools listed here.

### Tools Needed

- Phillips screwdriver
- Flat-blade screwdriver
- Measuring tape
- Level
- Drill (for wall cabinet installations)
- 1/8" (3 mm) drill bit (for wall cabinet installations)
- 1" (2.5 cm) drill bit (for wall cabinet installations)

### Parts Needed

- UL listed or CSA approved conduit connector
- UL listed wire connectors

### Parts Needed – Flush Installation

- W10801485 Stainless steel flush installation kit for 27" (68.6 cm) models
- W10801486 Stainless steel flush installation kit for 30" (76.2 cm) models
- W10801487 Black flush installation kit for 30" (76.2 cm) models

To order, see the "Assistance or Service" section of the Use and Care Guide.

- Phillips screwdriver
- Drill (for wall cabinet installations)

### Parts Supplied

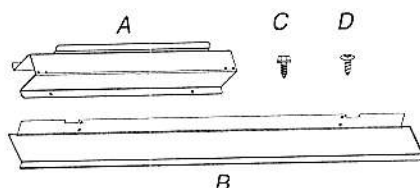

- A. Spacer bars (2)
- B. Bottom vent (1)
- C. 3/8" (9.5 mm) hex-head washer screws (4)
- D. 3/4" (1.9 cm) pan-head screws (4)

Check local codes. Check existing electrical supply. See "Electrical Requirements."

It is recommended that all electrical connections be made by a licensed, qualified electrical installer.

## Location Requirements

**IMPORTANT:** Observe all governing codes and ordinances.

- Cabinet opening dimensions that are shown must be used. Given dimensions provide minimum clearance with microwave oven.
- Recessed installation area must provide complete enclosure around the recessed portion of the microwave oven.
- Grounded electrical supply is required. See "Electrical Requirements" section.
- Electrical supply junction box should be located 3" (7.6 cm) maximum below the support surface when the microwave oven is installed in a wall cabinet. A 1" (2.5 cm) minimum diameter hole should have been drilled in the left rear corner of the support surface to pass the appliance cable through to the junction box.

- For installation above single built-in oven, the junction box must be located inside upper cabinet.
- If you are installing the junction box on rear wall behind the microwave oven, the junction box must be recessed and located in the upper or lower right or left corner of the cabinet; otherwise, the microwave oven will not fit into the cabinet opening.
- Microwave oven support surface must be solid, level, and flush with bottom of cabinet cutout. Floor must be able to support a weight of 108 lbs (49.0 kg).

**IMPORTANT:** To avoid damage to your cabinets, check with your builder or cabinet supplier to make sure that the materials used will not discolor, delaminate, or sustain other damage. This oven has been designed in accordance with the requirements of UL and CSA International and complies with the maximum allowable wood cabinet temperatures of 194°F (90°C).

## Product Dimensions

### 27" (68.6 cm) and 30" (76.2 cm) Microwave Ovens

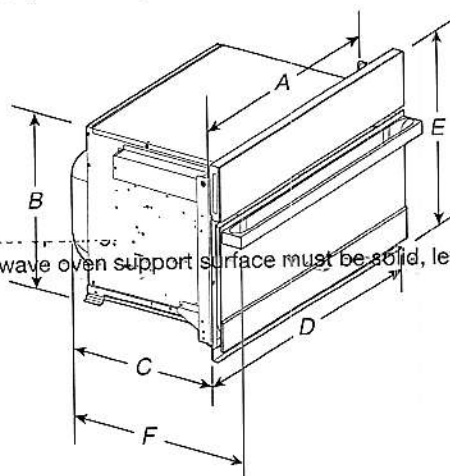

#### 27" (68.6 cm) models

- A. 25 3/8" (64.5 cm)
- B. 17 1/8" (44.1 cm)
- C. 22 1/16" (57.7 cm)
- D. 26 3/4" (68.0 cm) overall width
- E. 19 7/8" (50.3 cm) overall height
- F. JMC2427IM: 25 9/16" (64.9 cm)  
JMC2427IL: 24 3/4" (62.9 cm)

#### 30" (76.2 cm) models

- A. 28 3/8" (72.1 cm)
- B. 17 3/8" (44.1 cm)
- C. 22 1/16" (57.7 cm)
- D. 29 3/4" (75.6 cm) overall width
- E. 19 7/8" (50.3 cm) overall height
- F. JMC2430IM: 25 9/16" (64.9 cm)  
JMC2430IL: 24 3/4" (62.9 cm)

### 27" (68.6 cm) and 30" (76.2 cm) Microwave Oven Spacer Kit

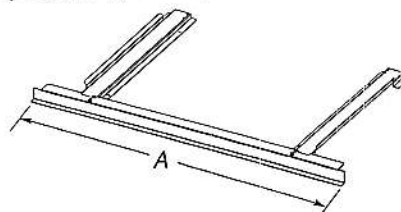

#### 27" (68.6 cm) models

- A. 26 3/4" (67.9 cm) overall width

#### 30" (76.2 cm) models

- A. 29 3/4" (75.6 cm) overall width

**NOTE:** The microwave oven spacer kit will allow the microwave oven to be installed in a 17 3/8" to 17 3/4" (44.1 to 45.1 cm) maximum cutout height.

A microwave oven spacer kit is available from your dealer that will allow the microwave oven to be installed in a 19" to 19<sup>13</sup>/<sub>16</sub>" (48.3 to 50.2 cm) maximum cutout height. Match the oven size to the following kits:

- 27" (68.6 cm) Stainless Steel – Model W10469901
  - 30" (76.2 cm) Stainless Steel – Model W10469903
- To order, see the "Assistance or Service" section of the Use and Care Guide.

### Cabinet Dimensions

27" (68.6 cm) and 30" (76.2 cm) Microwave Ovens

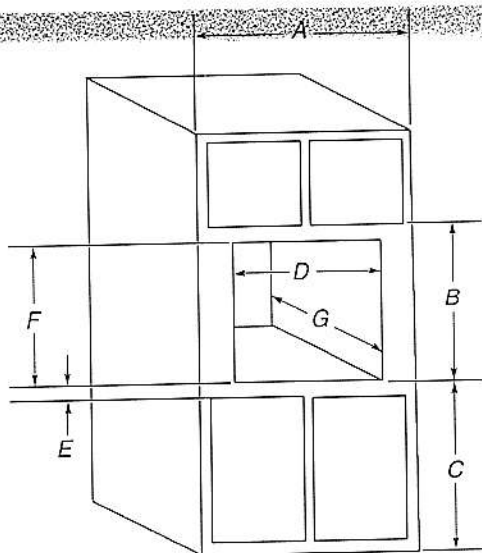

#### 27" (68.6 cm) models

- A. 27" (68.6 cm) min. cabinet width
- B. 19<sup>7</sup>/<sub>8</sub>" (50.3 cm) from bottom of cutout to bottom of upper cabinet door
- C. 40" (101.6 cm) bottom of cutout to floor (recommended)
- D. 25<sup>1</sup>/<sub>2</sub>" (64.8 cm) cutout width
- E. 1<sup>1</sup>/<sub>2</sub>" (3.8 cm) min. bottom of cutout to top of cabinet door
- F. 17<sup>3</sup>/<sub>8</sub>" (44.7 cm) recommended cutout height (will fit cutout height from 17<sup>3</sup>/<sub>8</sub>" [44.1 cm] to 17<sup>3</sup>/<sub>4</sub>" [45.1 cm])
- G. 21<sup>7</sup>/<sub>8</sub>" (55.5 cm) min. cutout depth

#### 30" (76.2 cm) models

- A. 30" (76.2 cm) min. cabinet width
- B. 19<sup>7</sup>/<sub>8</sub>" (50.3 cm) from bottom of cutout to bottom of upper cabinet door
- C. 40" (101.6 cm) bottom of cutout to floor (recommended)
- D. 28<sup>1</sup>/<sub>2</sub>" (72.4 cm) cutout width
- E. 1<sup>1</sup>/<sub>2</sub>" (3.8 cm) min. bottom of cutout to top of cabinet door
- F. 17<sup>3</sup>/<sub>8</sub>" (44.7 cm) recommended cutout height (will fit cutout height from 17<sup>3</sup>/<sub>8</sub>" [44.1 cm] to 17<sup>3</sup>/<sub>4</sub>" [45.1 cm])
- G. 21<sup>7</sup>/<sub>8</sub>" (55.5 cm) min. cutout depth

### Minimum Installation Clearances

For proper installation, the following minimum clearances must exist above and below the cabinet opening.

#### 27" (68.6 cm) models

- A. 27" (68.6 cm) min. cabinet

#### 30" (76.2 cm) models

- A. 30" (76.2 cm) min. cabinet

### Installation Above Single Built-In Oven

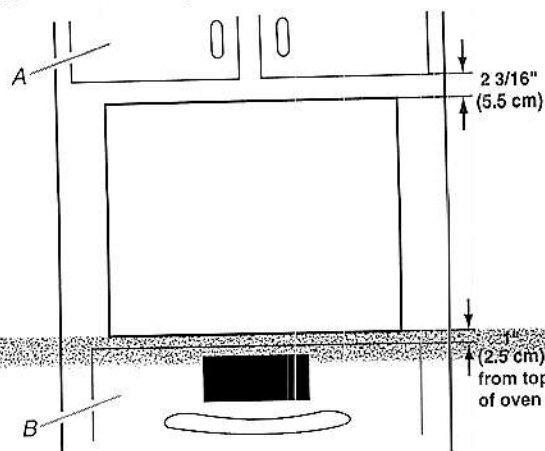

- A. Upper cabinet
- B. Lower single oven

## Electrical Requirements

### GROUNDING INSTRUCTIONS

For a permanently connected microwave oven:

The microwave oven must be connected to a grounded, metallic, permanent wiring system, or an equipment grounding conductor should be run with the circuit conductors and connected to the equipment grounding terminal or lead on the microwave oven.

### SAVE THESE INSTRUCTIONS

If codes permit and a separate ground wire is used, it is recommended that a qualified electrical installer determine that the ground path and wire gauge are in accordance with local codes.

Check with a qualified electrical installer if you are not sure the oven is properly grounded.

This oven must be connected to a grounded metal, permanent wiring system.

Be sure that the electrical connection and wire size are adequate and in conformance with the National Electrical Code, ANSI/NFPA 70 – latest edition or CSA Standards C22.1-94, Canadian Electrical Code, Part 1 and C22.2 No. O-M91 – latest edition, and all local codes and ordinances.

A copy of the above code standards can be obtained from:

National Fire Protection Association  
1 Batterymarch Park  
Quincy, MA 02169-7471  
CSA International  
8501 East Pleasant Valley Road  
Cleveland, OH 44131-5575

### Electrical Connection

To properly install your microwave oven, you must determine the type of electrical connection you will be using and follow the instructions provided for it here.



# 30" SINGLE WALL OVEN WITH MULTIMODE<sup>®</sup> CONVECTION SYSTEM

## Signature Features

### MULTIMODE<sup>®</sup> CONVECTION SYSTEM

Steady heat produced by three elements is circulated by whirling metal blades, weaving around every flat tine. Wield your cooking prowess from marbled meats to succulent roasts.

### MY CREATIONS

Curate recipe presets at will. Bake for 30 minutes, broil for 4 and keep dishes warm until you're ready to dine—all without lifting a finger.

### IRRESISTIBLE INTERIOR

Captivation cloaked in black. Beyond a dark glass expanse, cinematic lighting illuminates smooth racks, flat tines, and an enticing jet black interior.

## Feature Listing

### DESIGN & CRAFTSMANSHIP

Irresistible Interior  
4.3-Inch Full Color LCD Display  
Cinematic Lighting  
Seamless Touches  
Glide Rack  
Smooth Close Door  
5.0 Cu. Ft. Capacity

### PERFORMANCE

MultiMode<sup>®</sup> Convection System  
My Creations  
Closed Door Broiling  
Versatile Modes  
3,200-Watt Convection Element  
2,800-Watt Hidden Bake Element  
4,000-Watt Broil Element  
8-Pass Reflective Broil Element  
Temperature Probe

### ADDITIONAL FEATURES

Keep Warm<sup>™</sup> Option  
Auto Convection Conversion  
Auto Convection Modes  
Manual Convection Modes  
Rapid Preheat  
Proofing Option  
Control Lock  
Sabbath Mode  
ADA Compliant  
Badasses at the Ready  
Serviced by a Select Few

## Specifications

Shipping Weight (lbs) 184  
Volts 240  
Amps 20  
Capacity (Cu. Ft.) 5.0

## Dimensions

Overall Dimensions 30" x 29(7/8)" x 25(5/16)"  
Opening / Clearance Dimensions (Traditional Installation) 28(1/2)" x 28" x 24"  
Opening / Clearance Dimensions (Flush Installation) 30(1/4)" x 30(7/16)" x 25"

Do not make any cutouts based on this information

JJW2430I

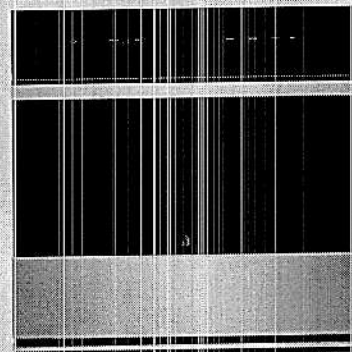

## Style Options

RISE<sup>™</sup>  
JJW2430IL

NOIR<sup>™</sup>  
JJW2430IM



LIMITED  
WARRANTY

Bold = Top Features

JENNAIR<sup>®</sup>

SINGLE WALL OVENS

JJW2427I – 27" x 29-7/8" x 25-5/16"  
JJW2430I, JJW3430I – 30" x 29-7/8" x 25-5/16"

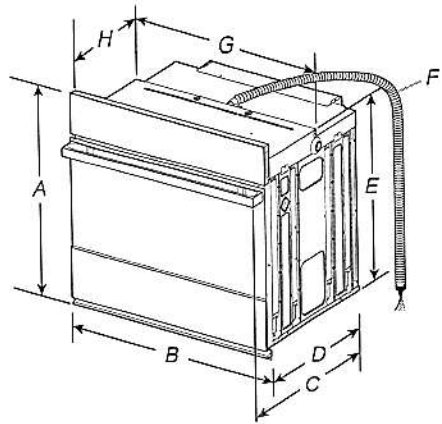

PRODUCT DIMENSIONS – SINGLE OVENS

27" (68.6 CM) MODELS

- A. 29-7/8" (75.8 cm) max. overall height
- B. 27" (68.6 cm) overall width
- C. JJW2427IM – 26-3/8" (67 cm)  
JJW2427IL – 27-3/16" (69 cm)
- D. 23-1/4" (59.1 cm) max. recessed depth
- E. 27-3/16" (69 cm) recessed height
- F. 48" (121.9 cm) flexible conduit length
- G. 25-7/16" (64.6 cm) max. recessed width
- H. 12" (30.5 cm) from back of control panel to start of strain relief

30" (76.2 CM) MODELS

- A. 29-7/8" (75.8 cm) max. overall height
- B. 30" (76.2 cm) overall width
- C. JJW2430IM – 26-3/8" (67 cm)  
JJW2430IL – 27-3/16" (69 cm)  
JJW3430IM – 26-3/8" (67 cm)  
JJW3430IL – 27-3/16" (69 cm)
- D. 23-1/4" (59.1 cm) max. recessed depth
- E. 27-3/16" (69 cm)
- F. 48" (121.9 cm) flexible conduit length
- G. 28-7/16" (72.2 cm) max. recessed width
- H. 12" (30.5 cm) from back of control panel to start of strain relief

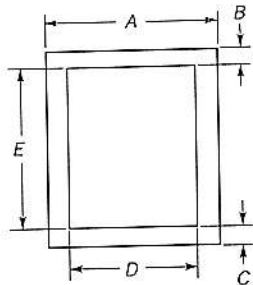

UNDERCOUNTER CABINET DIMENSIONS – SINGLE OVENS

27" (68.6 CM) MODELS

- A. 27" (68.6 cm) min. cabinet width
- B. 1-1/2" (3.8 cm) min. top of cutout to underside of countertop
- C. 5-1/4" (13.3 cm) bottom of cutout to floor
- D. 25-1/2" (64.8 cm) cutout width
- E. 28" (71.2 cm) min. cutout height

30" (76.2 CM) MODELS

- A. 30" (76.2 cm) min. cabinet width
- B. 1-1/2" (3.8 cm) min. top of cutout to underside of countertop
- C. 5-1/4" (13.3 cm) bottom of cutout to floor
- D. 28-1/2" (72.4 cm) cutout width
- E. 28" (71.2 cm) min. cutout height

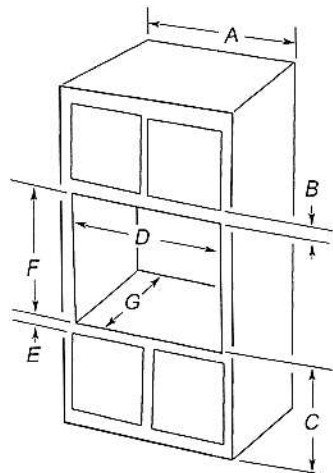

SINGLE OVENS INSTALLED IN CABINET

27" (68.6 CM) MODELS

- A. 27" (68.6 cm) min. cabinet width
- B. 2-3/16" (5.5 cm) top of cutout to bottom of upper cabinet door
- C. 32" (81.3 cm) bottom of cutout to floor
- D. 25-1/2" (64.8 cm) cutout width
- E. 1-1/2" (3.8 cm) min. bottom of cutout to top of cabinet door
- F. 28" (71.2 cm)\* recommended cutout height
- G. 24" (60.7 cm) cutout depth

\*NOTE: The cutout height can be between 27-1/4" (69.2cm) and 29-7/16" (74.8 cm) for 27" single ovens.

30" (76.2 CM) MODELS

- A. 30" (76.2 cm) min. cabinet width
- B. 2-3/16" (5.5 cm) top of cutout to bottom of upper cabinet door
- C. 32" (81.3 cm) bottom of cutout to floor
- D. 28-1/2" (72.4 cm) cutout width
- E. 1-1/2" (3.8 cm) min. bottom of cutout to top of cabinet door
- F. 28" (71.2 cm)\* recommended cutout height
- G. 24" (60.7 cm) cutout depth

\*NOTE: The cutout height can be between 27-1/4" (69.2 cm) and 29-7/16" (74.8 cm) for 30" single ovens.

**IMPORTANT:** Dimensional specifications are provided for planning purposes only. Do not make any cutouts based on this information. Refer to the Installation or Use & Care Guide before selecting cabinetry, verifying electrical/gas connections, making cutouts or beginning installation. All JennAir® appliances are appropriately UL, CUL or CSA approved.



SINGLE WALL OVENS

JJW2427I – 27" x 29-7/8" x 25-5/16"  
JJW2430I, JJW3430I – 30" x 29-7/8" x 25-5/16"

ELECTRICAL REQUIREMENTS

If codes permit and a separate ground wire is used, it is recommended that a qualified electrical installer determine that the ground path and the wire gauge are in accordance with local codes.

Check with a qualified electrical installer if you are not sure the oven is properly grounded.

This oven must be connected to a grounded metal, permanent wiring system.

Be sure that the electrical connection and wire size are adequate and in conformance with the National Electrical Code, ANSI/NFPA 70-latest edition or CSA Standards C22.1-94, Canadian Electrical Code, Part 1 and C22.2 No. 0-M91-latest edition, and all local codes and ordinances.

A copy of the above code standards can be obtained from:

National Fire Protection Association  
1 Batterymarch Park  
Quincy, MA 02169-7471

CSA International  
8501 East Pleasant Valley Road  
Cleveland, OH 44131-5575

ELECTRICAL CONNECTION

To properly install your oven, you must determine the type of electrical connection you will be using and follow the instructions provided for it here.

- Oven must be connected to the proper electrical voltage and frequency as specified on the model/serial/rating plate. The model/serial/rating plate is located under the control panel on single ovens. See the following illustration

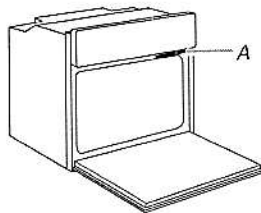

A. Model/Serial/Rating Plate

- Models rated from 7.3 to 9.6 kW at 240 V (5.4 to 7.4 kW at 208 V) require a separate 40 A circuit. Models rated at 4.8 kW and below at 240 V (3.6 kW and below at 208 V) require a separate 20 A circuit.
- A circuit breaker is recommended.
- Connect directly to the circuit breaker box (or fused disconnect) through flexible, armored, or nonmetallic sheathed, copper cable (with grounding wire).
- Flexible conduit from the oven should be connected directly to the junction box.
- Fuse both sides of the line.
- Do not cut the conduit. The length of conduit provided is for serviceability of the oven.
- A UL listed or CSA approved conduit connector must be provided.
- If the house has aluminum wiring, follow the procedure below:  
Connect the aluminum wiring using special connectors and/or tools designed and UL listed for joining copper to aluminum.  
Follow the electrical connector manufacturer's recommended procedure. Aluminum/copper connection must conform with local codes and industry accepted wiring practices.

For power requirements for models JJW2427I, JJW2430I and JJW3430I, refer to the following table.

Model	240 VAC	208 VAC
	kW	kW
JJW2427I	4.1	3.1
JJW2430I	4.1	3.1
JJW3430I	4.5	3.4

**IMPORTANT:** Dimensional specifications are provided for planning purposes only.  
Do not make any cutouts based on this information. Refer to the Installation or Use & Care Guide before selecting cabinetry, verifying electrical/gas connections, making cutouts or beginning installation.  
All JennAir® appliances are appropriately UL, CUL or CSA approved.







# 48" GAS PROFESSIONAL RANGETOP WITH CHROME-INFUSED GRIDDLE

JGCP548HM

## Signature Features

### 15 RANGETOP CONFIGURATIONS

With 15 unique configurations, it's up to you. Infused with chrome, our griddle cleans up well after heavy usage. Fire up the grill for indoor entertainment on your terms.

### HALO-EFFECT KNOBS

A halo of luminary LEDs glows softly when the burner is lit or the oven is on.

### DUAL-STACKED POWERBURNERS

Two stacked, symmetrical flames bloom and retreat at your inclination, offering total control over heat levels. High-heat searing and wok cooking. Low, slow simmer and melt. Infinite intermediate settings satisfy every appetite.

## Feature Listing

### PERFORMANCE FEATURES

#### Dual-Stacked PowerBurners

#### Chrome-Infused Griddle

20,000 BTU Dual-Stacked PowerBurner

18,000 BTU Dual-Stacked PowerBurner

9,000 BTU Dual-Stacked PowerBurner

Electronic Ignition with Flame-Sensing™ Reignition

### CONTROL FEATURES

Halo-Effect Knobs

### DESIGN FEATURES

15 Rangetop Configurations

Cast Iron Grates

### OPTIONAL ACCESSORIES

Gas Connector Kit (Required) – 30-48KITRC

High Altitude Kit (Natural Gas) – W10160841

High Altitude Kit (LP Gas) – W10237848

9" Stainless Steel Backsplash – W10115777

Stainless Steel Backsplash with Two Shelves (48") – W10285449

Wok Ring – W10216179

Stainless Steel Griddle Cover – W10160195

Affresh™ Kitchen & Appliance Cleaner, 16 oz. – W10355010

## Style Options

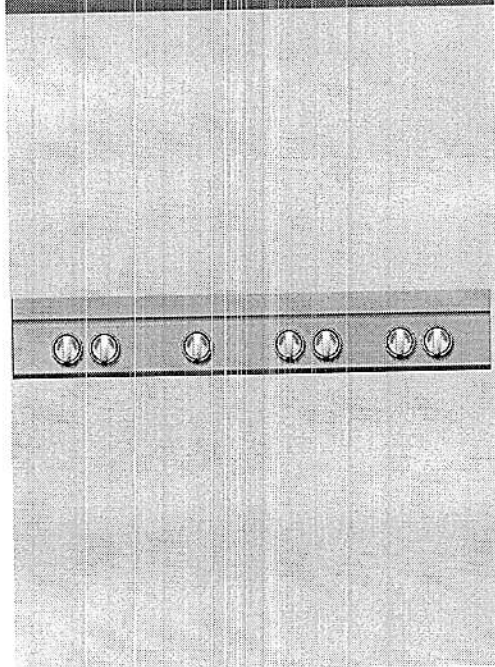

LIMITED  
WARRANTY

Bold = Top Features

JENNAIR®

JENNAIR® DIMENSIONS

RANGETOPS

PRODUCT

	30" RANGETOP JGCP430H	36" RANGETOP JGCP436H	48" RANGETOP JGCP548H
Overall Width (A)	29-3/4" (75.6 cm)	35-3/4" (90.8 cm)	47-7/8" (121.6 cm)
Grate Depth (B)	22" (55.9 cm)	22" (55.9 cm)	22" (55.9 cm)
Depth without Control Panel (C)	23-1/4" (59.1 cm)	23-1/4" (59.1 cm)	23-1/4" (59.1 cm)
Depth with Control Panel Overhang (D)	27-1/2" (69.9 cm)	27-1/2" (69.9 cm)	27-1/2" (69.9 cm)
Depth with Knobs: RISE™ (E)	29-1/8" (74 cm)	29-1/8" (74 cm)	29-1/8" (74 cm)
Depth with Knobs: NOIR™ (E)	29" (73.7 cm)	29" (73.7 cm)	29" (73.7 cm)

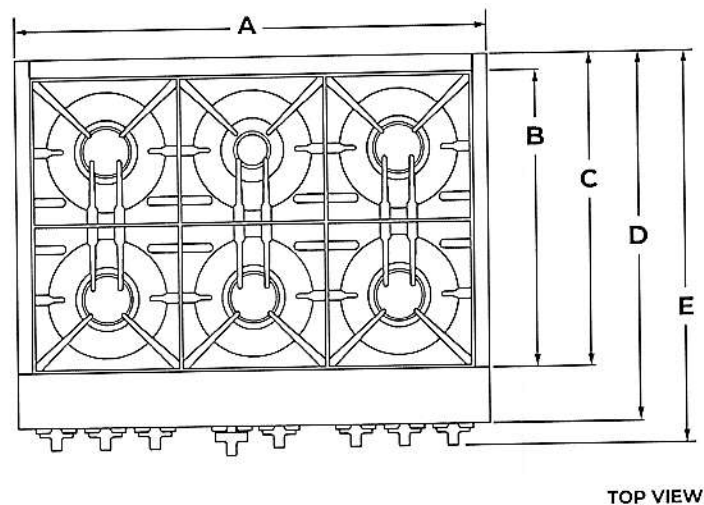

TOP VIEW

**IMPORTANT:** Dimensional specifications are provided for planning purposes only. Do not make any cutouts based on this information. Refer to the Installation Guide before selecting cabinetry, verifying electrical/gas connections, making cutouts or beginning installation. All JennAir® appliances are appropriately UL, CUL or CSA approved.

JENNAIR® DIMENSIONS

RANGETOPS

PRODUCT

		30" RANGETOP JGCP430H	36" RANGETOP JGCP436H	48" RANGETOP JGCP548H
Grate Width (F)*		27-7/16" (69.7 cm)	33" (83.8 cm)	44-3/8"* (112.7 cm)
Gas Inlet to Surface (G)		10-3/4" (27.3 cm)*	10-3/4" (27.3 cm)	10-3/4" (27.3 cm)
Center to Gas Inlet (H)		11" (27.9 cm)	14-1/8" (35.9 cm)	19-5/8" (49.8 cm)
Recessed Rangetop Width (I)		29-1/8" (74 cm)	35" (88.9 cm)	47-1/4" (120 cm)

\*Includes width of grates and griddle.

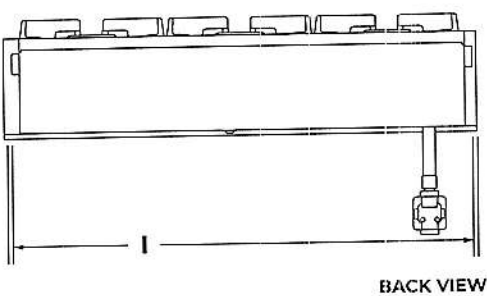
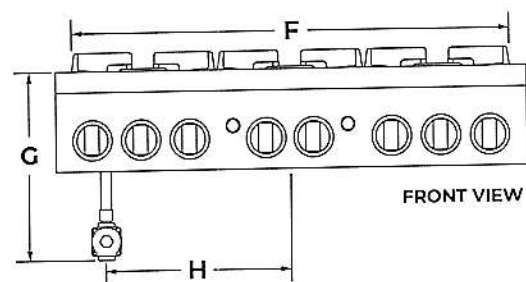

JENNAIR® DIMENSIONS

RANGETOPS

PRODUCT

	30" RANGETOP JGCP430H	36" RANGETOP JGCP436H	48" RANGETOP JGCP548H
Height with Grates (J)	9" (22.9 cm)	9" (22.9 cm)	9" (22.9 cm)
Control Panel Height (K)	7-13/16" (19.8 cm)	7-13/16" (19.8 cm)	7-13/16" (19.8 cm)
Recessed Rangetop Height (L)	7" (17.8 cm)	7" (17.8 cm)	7" (17.8 cm)
Cooking Surface Height (M)	7-7/16" (18.9 cm)	7-7/16" (18.9 cm)	7-7/16" (18.9 cm)
Recessed Rangetop Depth (N)	21-7/8" (55.6 cm)	21-7/8" (55.6 cm)	21-7/8" (55.6 cm)
Depth with Control Panel (O)	25-1/2" (64.8 cm)	25-1/2" (64.8 cm)	25-1/2" (64.8 cm)

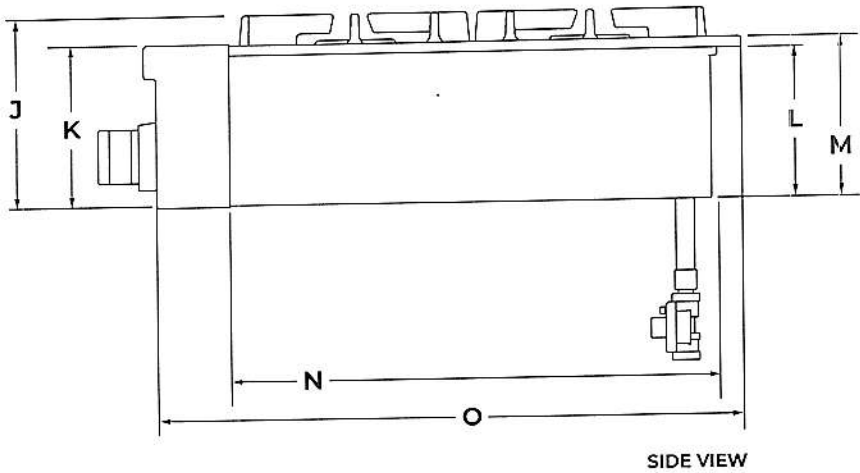

★

IMPORTANT: Supplied regulator does not come preattached and is pictured for reference purposes only.

# JENNAIR® DIMENSIONS

## RANGETOPS

### OPENING AND CLEARANCE

	30" RANGETOP JGCP430H	36" RANGETOP JGCP436H	48" RANGETOP JGCP548H
Combustible Area Above Cooking Surface Width (A)	30" (76.2 cm) min.	36" (91.4 cm) min.	48" (121.9 cm) min.
Bottom of Cabinet Height Above Cooking Surface (B)*	42" (106.7 cm) min.	58" (147.3 cm) min.	58" (147.3 cm) min.
Bottom of Cabinet Height Above Countertop (C)	18" (45.7 cm) min.	18" (45.7 cm) min.	18" (45.7 cm) min.
Distance to Fixed Wall or Combustible Material (D)	12" (30.5 cm) min.	12" (30.5 cm) min.	12" (30.5 cm) min.

\*Dimension reduced by 6" (15.2 cm) when bottom of wood or metal cabinet is covered by at least 1/4" (0.6 cm) flame retardant millboard, which is in turn covered with at least No. 28 MSG sheet metal, 0.015" (0.4 mm) stainless steel, 0.024" (0.6 mm) aluminum or 0.020" (0.5 mm) copper. If installing a hood above the rangetop, follow the hood instructions for dimensional clearances above the cooking surface.

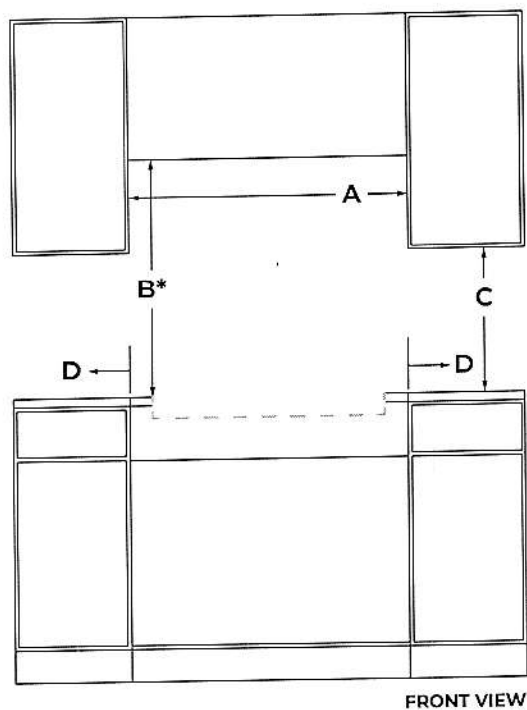

# JENNAIR® DIMENSIONS

## RANGETOPS OPENING AND CLEARANCE

	30" RANGETOP JGCP430H	36" RANGETOP JGCP436H	48" RANGETOP JGCP548H
Recommended Upper Cabinet Depth (E)	13" (33 cm)	13" (33 cm)	13" (33 cm)
Cutout to Wall Depth (F)*	1-1/2" (3.8 cm) min.	1-1/2" (3.8 cm) min.	1-1/2" (3.8 cm) min.
Cabinet to Countertop Height (G)	7-1/4" (18.4 cm)	7-1/4" (18.4 cm)	7-1/4" (18.4 cm)
Cabinet Depth (H)	24" (61 cm)	24" (61 cm)	24" (61 cm)

\*If the back wall is constructed of a combustible material and a backsplash is not installed, a 7-1/2" (19.1 cm) minimum clearance is required from the cutout or 6" (15.2 cm) minimum clearance from the back edge of the rangetop.

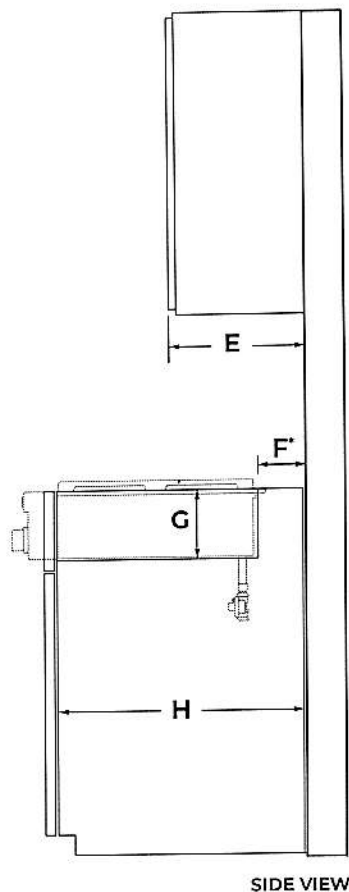



# JENNAIR® DIMENSIONS

## RANGETOPS OPENING AND CLEARANCE

		30" RANGETOP JGCP430H	36" RANGETOP JGCP436H	48" RANGETOP JGCP548H
Countertop and Cabinet Cutout Width (I)		29-1/4" (74.3 cm)	35-1/4" (89.5 cm)	47-3/8" (120.3 cm)
Countertop and Cutout Depth (J)		22-1/4" (56.5 cm)	22-1/4" (56.5 cm)	22-1/4" (56.5 cm)
Notch Width (K)		5/16" (0.8 cm)	5/16" (0.8 cm)	5/16" (0.8 cm)
Cutout Width (L)		29-7/8" (75.9 cm)	35-3/4" (90.8 cm)	47-7/8" (121.6 cm)

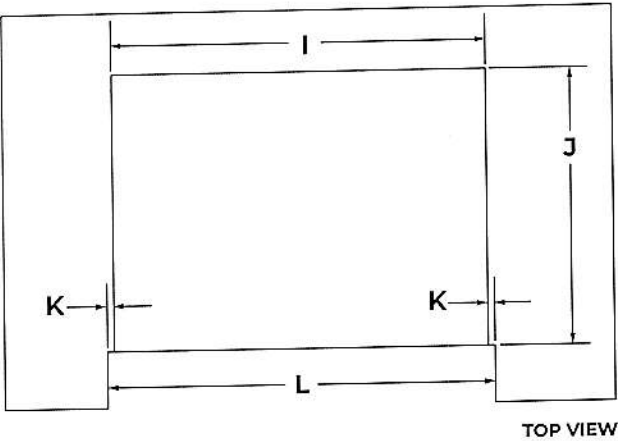

# JENNAIR® DIMENSIONS

## RANGETOPS

### ELECTRICAL REQUIREMENTS

#### ELECTRIC REQUIREMENTS CHECKLIST

- ☐ A 120 volt, 60 Hz, AC only, 15-amp fused, electrical circuit is required.
- ☐ A dedicated circuit is recommended.

#### RECOMMENDED ELECTRICAL OUTLET ZONE

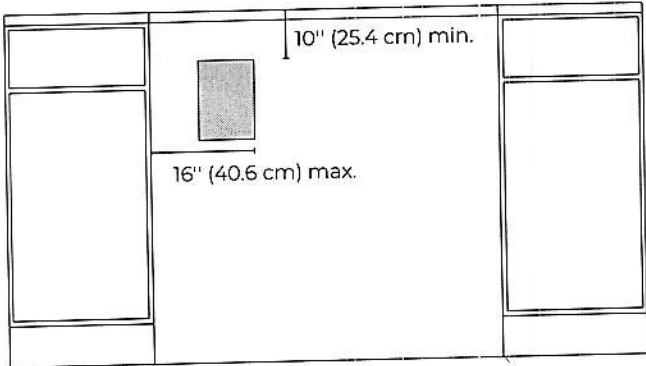

FRONT VIEW



IF YOU HAVE QUESTIONS ABOUT YOUR ELECTRICAL SUPPLY,  
CALL A LICENSED, QUALIFIED ELECTRICIAN.

# JENNAIR® DIMENSIONS

## RANGETOPS

### GAS REQUIREMENTS

#### RECOMMENDED GAS SUPPLY LOCATION

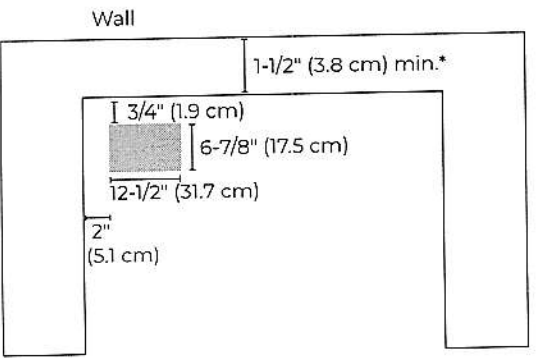

TOP VIEW

\*If the back wall is constructed of a combustible material and a backsplash is not installed, a 7-1/2" (19.1 cm) minimum clearance is required from the cutout or 6" (15.2 cm) minimum clearance from the back edge of the rangetop.

#### GAS SUPPLY ZONE

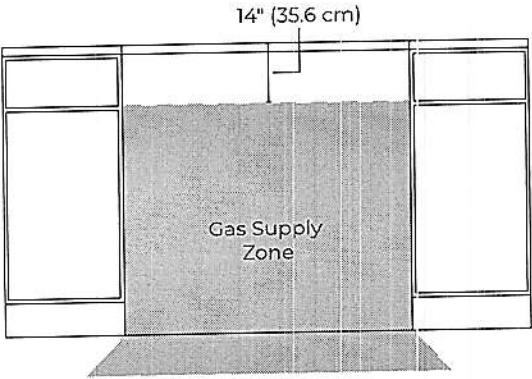

FRONT VIEW



IF YOU HAVE QUESTIONS ABOUT YOUR GAS SUPPLY,  
CALL A LICENSED, QUALIFIED SERVICE TECHNICIAN.

ELICA PRO SERIES  
AREZZO

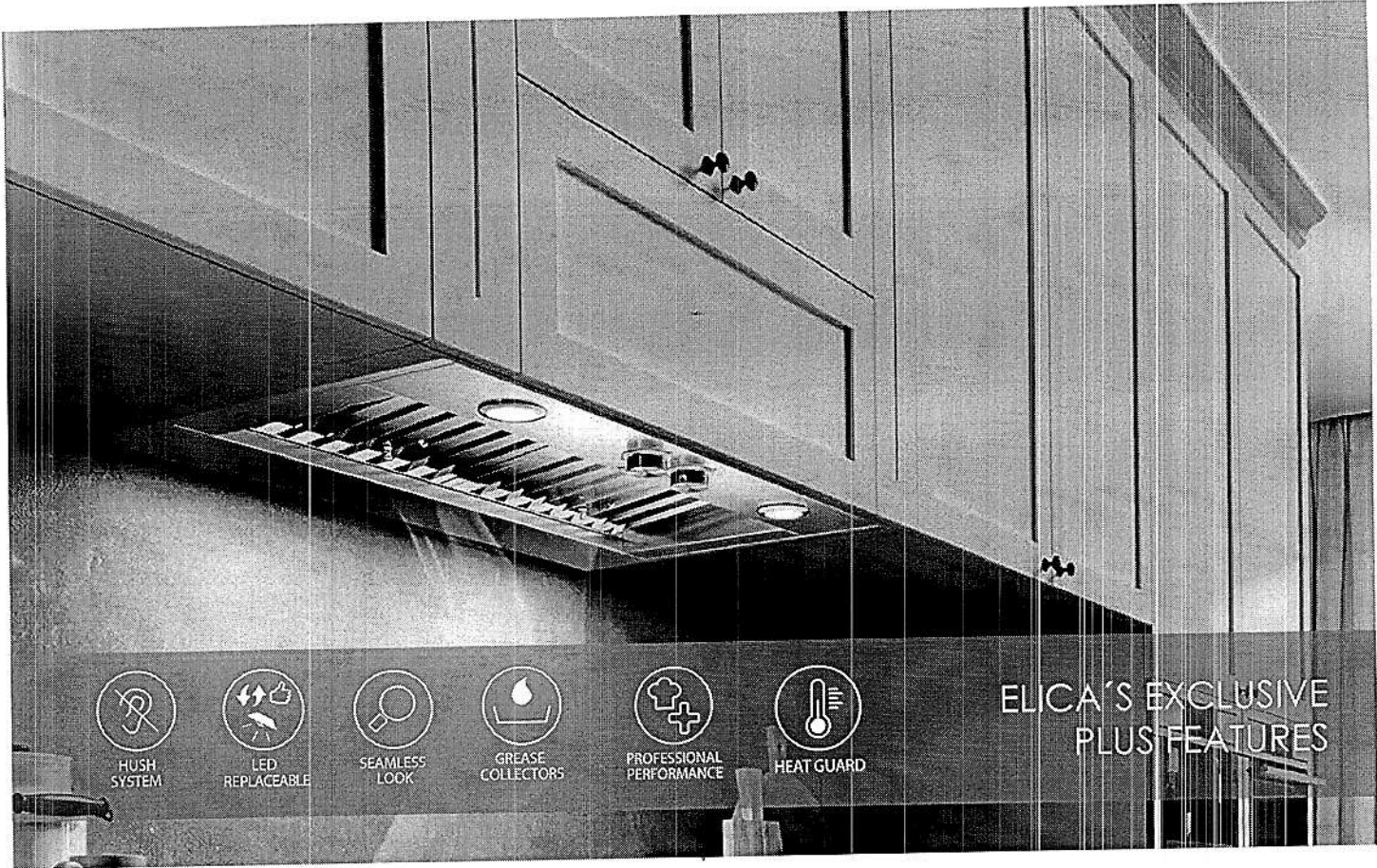

Arezzo provides professional grade performance, while being discreetly mounted inside the cabinetry. Available in 28 1/2" and 34 1/2" width with a 600 CFM blower, and equipped with a 1200 CFM blower for widths of 34 1/2", 40 1/2" and 46 1/2" for extraordinary ventilating power. The extra depth (22") is ideal for supporting powerful professional ranges. Plus the All-In-One design avoids the need to purchase a stainless liner. Hidden metallic in/out knob controls operate the 4-speed blower and LED lighting.

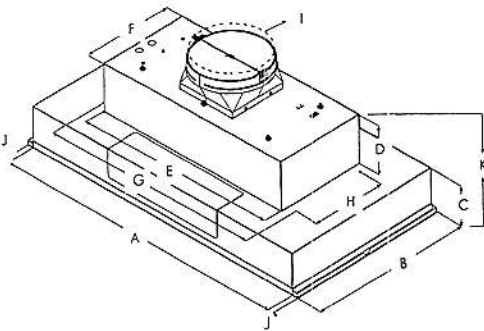

EAR634SS

	EAR628S4	EAR134S4	EAR140S4	EAR146S4
A	28½" (72.4 cm)	34½" (87.6 cm)	40½" (103 cm)	46½" (118 cm)
B	22" (55.9 cm)	22" (55.9 cm)	22" (55.9 cm)	
C	57⅙" (13.8 cm)			
D	6 ½" (16.4 cm)			
E	27 ⅞" (70 cm)			
F	12 ⅞" (31.6 cm)			
G	29 13/16" (75.7 cm)			
H	10 ⅛" (25.7 cm)			
I	10" (25.4 cm)			
J	¾" (1.9 cm)			
K	12" (30.4 cm)			

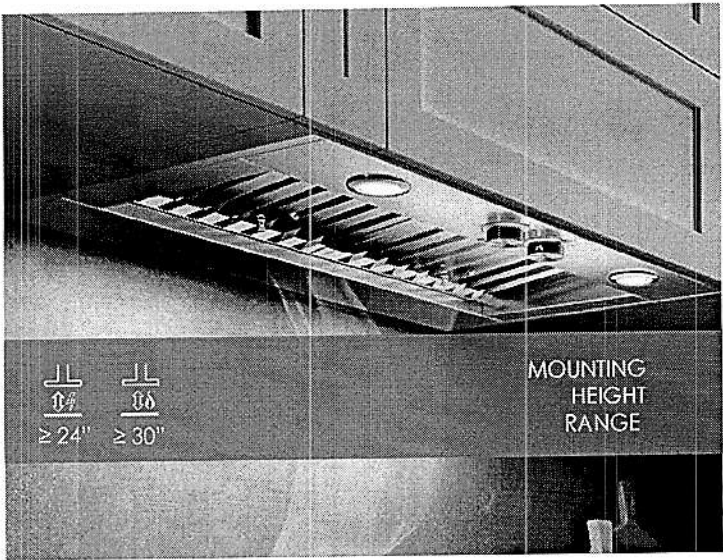

SPECIFICATIONS

	28" Unit	34" Unit	40" Unit	46" Unit
Model:	EAR628S4	EAR634SS (600 CFM) EAR134S4 (1200 CFM)	EAR140S4	EAR146S4
Dimensions:	28 1/2"W x 22"D x 11 1/2"H	34 1/2"W x 22"D x 11 1/2"H	40 1/2"W x 22"D x 11 1/2"H	46 1/2"W x 22"D x 11 1/2"H
Blower Type(internal):	600 CFM(4-speed)	600 CFM / 1200 CFM (4 speed)	1200 CFM(4-speed)	1200 CFM(4-speed)
Blower Performance:				
Speed 1	90 CFM	90 CFM    380 CFM	380 CFM	380 CFM
Speed 2	330 CFM	330 CFM    660 CFM	660 CFM	660 CFM
Speed 3	490 CFM	490 CFM    950 CFM	950 CFM	950 CFM
Speed 4	600 CFM	600 CFM    1200 CFM	1200 CFM	1200 CFM
Noise (sones):	Min:2 , Max:9.6	Min:2, Max: 9.5	Min:2.05, Max:7.5	Min:2.05, Max:7.5
Working Speed				
Finish:	Stainless Steel			
Controls:	Fully retractable rotating knobs with blue backlighting			
Illumination:	2 LED, 7.5 Watts	2 LED, 6.5 Watts (EAR634SS) 2 LED, 7.5 Watts (EAR134S4)	4 LED, 7.5 Watts	4 LED, 7.5 Watts
(replaceable lamps 1 intensity)				
Filter Type:	Dishwasher-Safe, Professional Stainless Steel Baffle Filter			
Angled Baffle Filters:	1	2	2	3
Duct Transition:	10" Round with BackDraft Damper (top only)			
Installation Type:	Ducted Installation Only			
Electrical:	120V - 60 Hz			
CONSUMABLE PARTS:				
Replacement Grease Filter (1):	GF09EA	GF09GA	GF09FA	GF09EA
Replacement Light Bulb (1):	LMP0131098	LMP0131098A (EAR634SS) LMP0131098 (EAR134S4)	LMP0131098	LMP0131098

\*Consumable parts are sold in units of one (1). Order accordingly

\*The product images shown are for illustration purposes only and may not be an exact representation of the product.

PLUS FEATURES

- 

**HUSH SYSTEM** - An exclusive sound deadening technology that effectively reduces sound levels by over 35%
- 

**LED CONSUMER REPLACEABLE BULB** - High quality LED lighting usually requires a skilled technician to replace lamps. Avoid this expense with Elica's new LED lamps that enable homeowners to replace in seconds
- 

**SEAMLESS CRAFTSMANSHIP** - Heavy gauge stainless steel "Seamless" construction that delivers refined elegance.
- 

**STAINLESS STEEL BAFFLE FILTERS WITH GREASE COLLECTORS** - Designed for high airflow cooking, the "S" shape design traps high volumes of grease
- 

**PROFESSIONAL PERFORMANCE** - Special features and high performances for models with aspiration capacity between 600 and 1200 CFM's
- 

**HEAT GUARD** - Senses extreme temperatures (>158 degrees) and automatically adjusts the blower speed to HIGH





# 24" DISHWASHER

## DETAILED PLANNING DIMENSIONS GUIDE

23<sup>7</sup>/<sub>8</sub>" (W) x 33<sup>5</sup>/<sub>8</sub>" (H) x 24<sup>1</sup>/<sub>2</sub>"

23<sup>7</sup>/<sub>8</sub>" (W) x 33<sup>5</sup>/<sub>8</sub>" (H) x 24<sup>3</sup>/<sub>4</sub>"

### PRODUCT DIMENSIONS

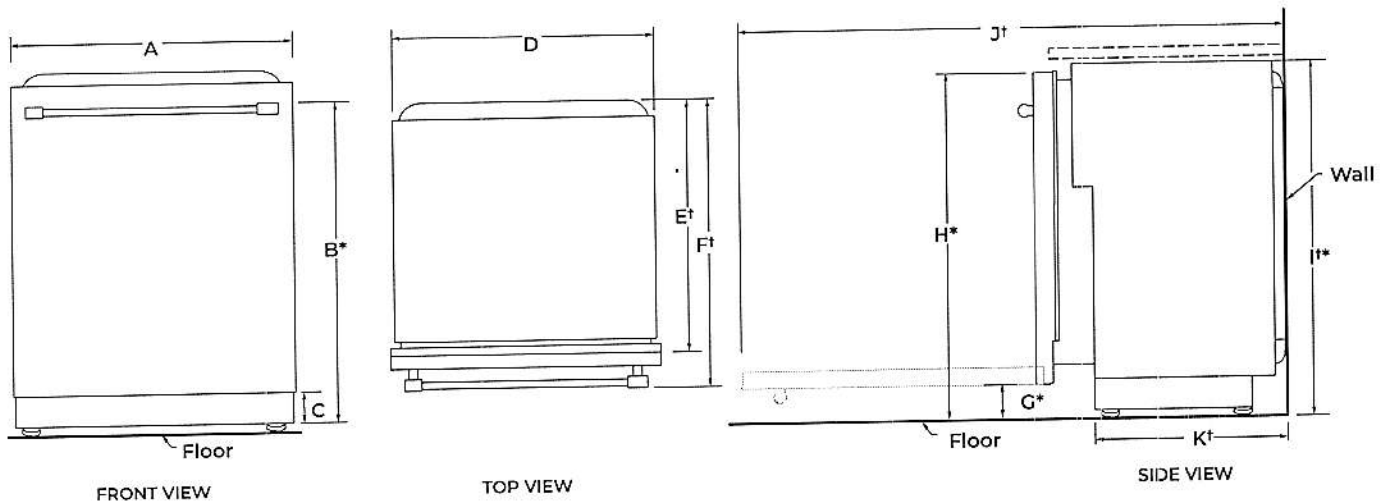

	DESCRIPTION	DIMENSIONS
A	Width of door	23 <sup>7</sup> / <sub>8</sub> " (60.6 cm)
B*	Height to top of handle	31 <sup>9</sup> / <sub>16</sub> " (80.1 cm)
C	Height of adjustable toe kick	3 <sup>1</sup> / <sub>2</sub> " (8.8 cm) - min. 4 <sup>1</sup> / <sub>4</sub> " (10.8 cm) - max.
D	Width of recessed dishwasher	23 <sup>7</sup> / <sub>8</sub> " (60.6 cm)
E†	Depth without door	22 <sup>5</sup> / <sub>8</sub> " (57.5 cm)
F†	Depth with Towel Bar Handle	27 <sup>1</sup> / <sub>4</sub> " (69.2 cm)
F†	Depth with Pocket Handle	24 <sup>1</sup> / <sub>2</sub> " (62.2 cm)
F†	Depth with Wood panel	24 <sup>3</sup> / <sub>4</sub> " (62.9 cm)**
G*	Height to bottom of door (min.)	3 <sup>5</sup> / <sub>16</sub> " (8.4 cm)
H*	Height to top of door (min.)	33 <sup>7</sup> / <sub>16</sub> " (84.9 cm)
I*	Height of recessed dishwasher (min.)	33 <sup>5</sup> / <sub>8</sub> " (85.4 cm)
J†	Depth with door fully open (min.)	50 <sup>3</sup> / <sub>16</sub> " (127.4 cm)
K†	Depth with toe kick (min.)	20 <sup>13</sup> / <sub>16</sub> " (52.9 cm)

†Insulation blanket thickness not included, can be crushed up to 1/8" (0.3 cm), or removed along the top perforate section for additional clearance.

\*Dishwasher can be raised 1<sup>7</sup>/<sub>16</sub>" (3.7 cm) with feet fully extended.

\*\*Considering 3/4" wood panel thickness.

Because Whirlpool Corporation policy includes a continuous commitment to improve our products, we reserve the right to change materials and specifications without notice.

Dimensions are for planning purposes only. For complete details, see Installation Instructions packed with product. Specifications subject to change without notice.



## DRAIN REQUIREMENTS

- A new drain hose is supplied with your dishwasher. If drain hose is not long enough, use a new drain hose with a maximum length of 12 ft (3.7 m) that meets all current AHAM/IAPMO test standards, is resistant to heat and detergent, and fits the 1" (25 mm) drain connector of the dishwasher.

**NOTE:** Do not connect multiple drain hoses together.

- Make sure to connect drain hose to waste tee or disposer inlet above drain trap in house plumbing and 20" (508 mm) minimum above the floor. It is recommended that the drain hose either be looped up and securely fastened to the underside of the counter or be connected to an air gap.
- Make sure to use an air gap if the drain hose is connected to house plumbing lower than 20" (508 mm) above subfloor or floor.

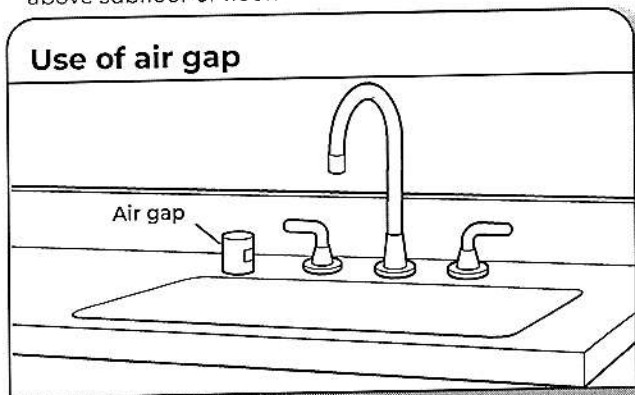

- If required, the air gap should be installed in accordance with the air gap installation instructions. When you are connecting the air gap, a rubber hose (not provided) will be needed to connect to the waste tee or disposer inlet.
- Use 1/2" (1.3 cm) minimum I.D. drain line fittings.

## WATER SUPPLY REQUIREMENTS

- This dishwasher has a water heating feature and also requires a connection to a hot water supply line.
  - A hot water line with 20 psi to 120 psi (138 kPa to 862 kPa) water pressure can be verified by a licensed plumber.
  - 120°F (49°C) water at dishwasher.
  - 3/8" (0.95 cm) O.D. copper tubing with compression fitting or flexible braided water supply line.
- NOTE:** 1/2" (1.3 cm) minimum plastic tubing is not recommended.
- A 90° elbow with 3/4" (0.95 cm) hose connection with rubber washer.
  - Do not solder within 6" (15.2 cm) of the water inlet valve.
  - If installed in new construction, make sure the house water supply lines have been flushed prior to connecting the dishwasher to remove any debris that may exist in the supply line.

**NOTE:** If replacing an existing dishwasher, it is recommended to install a new water line and drain hose (supplied) with the new dishwasher.

## ELECTRICAL REQUIREMENTS

### ⚠ WARNING



#### Electrical Shock Hazard

Plug into a grounded 3 prong outlet.

Do not remove ground prong.

Do not use an adapter.

Do not use an extension cord.

Failure to follow these instructions can result in death, fire, or electrical shock.

Be sure that the electrical connection and wire size are adequate and in conformance with the National Electrical Code, ANSI/NFPA 70 - latest edition, and all local codes and ordinances.

A copy of the above code standards can be obtained from:

National Fire Protection Association  
1 Batterymarch Park  
Quincy, MA 02169-7471

#### You Must Have:

- 120 V, 60 Hz, AC only, 15 A or 20 A, fused electrical supply
- Copper wire only
- A maximum of 2 field wiring supply conductors (12 AWG largest size) plus 1 grounding conductor are permitted in the terminal box.

#### We Recommend:

- A time-delay fuse or circuit breaker.

#### Circuit Requirements:

- The dishwasher may be installed on the same circuit as a garbage disposal providing that the branch circuit cannot exceed rated circuit load and must comply with all governing codes and regulations such as but not limited to National Electrical Code, ANSI/NFPA 70 - latest edition.
- No electrical connections other than the dishwasher power and ground connections can be made inside of the dishwasher terminal box.

#### If connecting dishwasher with a power supply cord:

- Use UL Listed power cord kit marked for use with dishwasher.
- Plug into a grounded 3 prong outlet. Outlet must meet all local codes and ordinances.



#### If connecting dishwasher with direct wiring:

- Use flexible, armored, or nonmetallic sheathed copper wire with grounding wire that meets the wiring requirements for your home and local codes and ordinances.
- Use a UL Listed/CSA Approved metallic strain relief.

