

A circular professional engineer license stamp. The outer ring contains the text "LICENSED PROFESSIONAL ENGINEER" at the top and "PROVINCE OF ONTARIO" at the bottom. The center of the stamp contains the date "2021-09-07", the name "N. R. POKHAREL", and the license number "100156322". A signature, "N. Pokharel", is written across the bottom center of the stamp.

This is to certify that these plans comply with the applicable Architectural Design Guidelines approved by the City of HAMILTON.

This stamp certifies compliance with the applicable Design Guidelines only and bears no further professional responsibility.

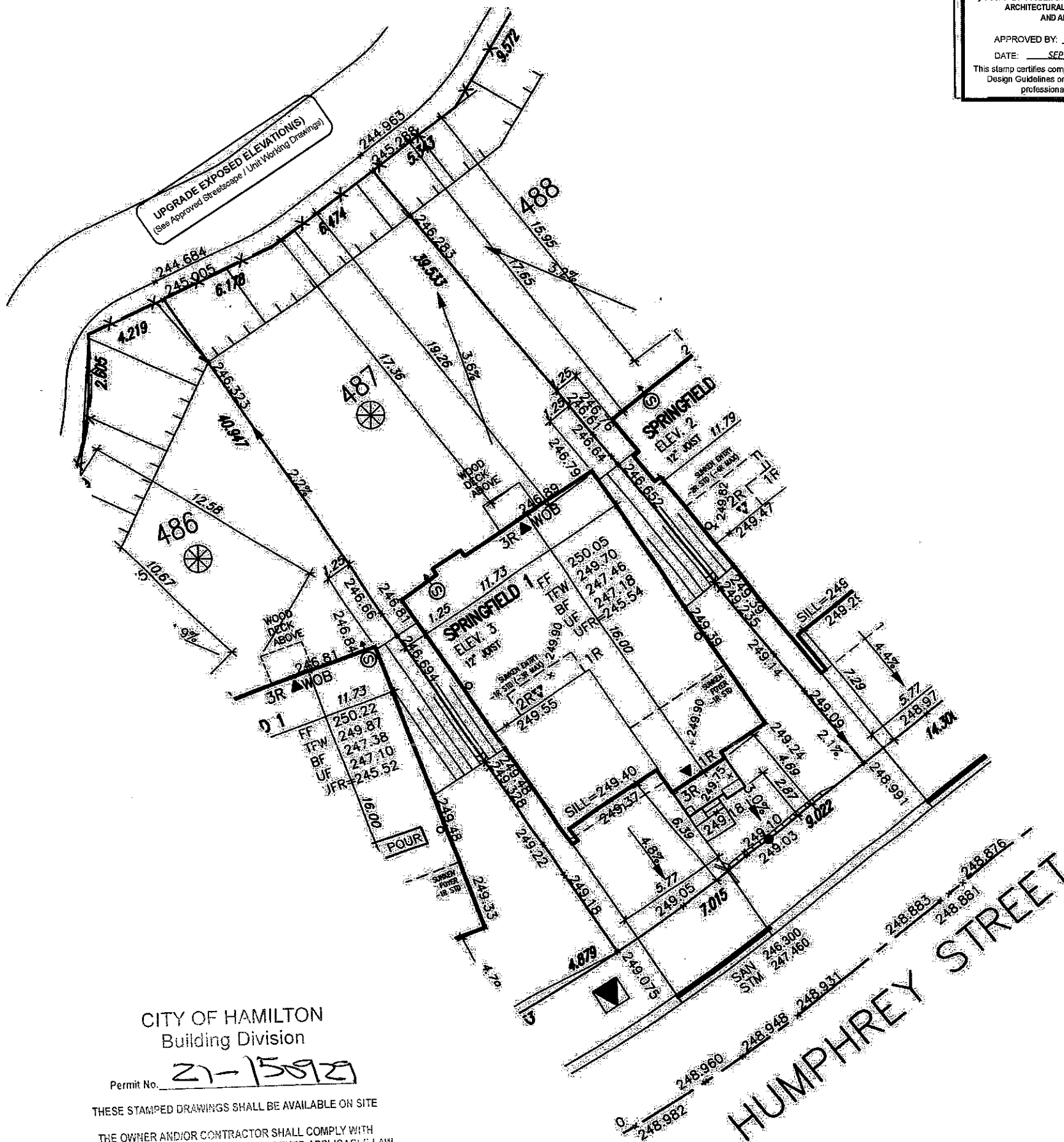

DATE _____

LOT 487		
LOT No.	LOT WIDTH (M) (@ 5.8m)	LOT AREA (M ²)
487	15.528	571.88

These drawings are to be read in conjunction with municipal approved site engineering drawings prepared by Metropolitan Consulting Inc.

[illegible]

1. NAME _____