

CONSTRUCTION SUMMARY

Reesor Ridge At Wismer - Lampone Investments Inc.

RECEIVED
MAY 19 2021

PURCHASERS: Harikeshan SUNDARAMOHAN and Eshana THARMAKUMAR

TEL:

LOT / PHASE 73 Left / 1	REG. PLAN # 65M-4573	HOUSE TYPE Peyton 2 Elev 2		
----------------------------	-------------------------	-------------------------------	--	--

CABINETRY

1 - KITCHEN - DELETE CABINETS ABOVE STOVE - VENDOR WILL SUPPLY 6 INCH VENT AS PER CONSTRUCTION SPECIFICATIONS AND VENT MAY NOT BE IN THE APPROPRIATE LOCATION FOR INSTALLATION OF PURCHASER SUPPLIED VENT - PURCHASER TO SUPPLY OWN FAN AFTER CLOSING 19May21 Note: TEMPORARY HOOD FAN MAY BE PROVIDED	
1 - CABINETRY - KITCHEN - UPGRADE 3 19May21 Note:	

CONSTRUCTION

1 - SMOOTH CEILINGS FOR SEMI FIRST FLOOR ONLY 19May21 Note:	
--	--

ELECTRICAL

1 - STANDARD DINING ROOM LIGHT TO BE CENTERED BETWEEN LIVING AND DINING ROOM 19May21 Note:	
1 - RELOCATE STANDARD KITCHEN LIGHT TO BE CENTERED OVER ISLAND 19May21 Note:	
1 - PLUG - ELECTRICAL PLUG WITH GFI AND SWITCH - FOR FESTIVE LIGHTING 19May21 Note:	

FIREPLACE AND ACCESSORIES

1 - GAS LINE ROUGH-IN FOR STOVE (INCLUDES ELECTRICAL OUTLET) - FIRST FLOOR 19May21 Note:	
---	--

HARDWOOD FLOORING

1 - LAMINATE - FJORD SERIES - - UPPER HALL 19May21 Note:	
1 - LAMINATE - FJORD SERIES - KITCHEN AND BREAKFAST 19May21 Note:	
1 - LAMINATE – UPGRADE TO FJORD SERIES IN LIEU OF STANDARD LAMINATE 19May21 Note: First Floor non tiled areas	

MIRRORS AND GLASS

1 - FRAMELESS GLASS SHOWER DOOR - INCLUDES CHROME KNOB & HINGES 19May21 Note:	
--	--

PLUMBING

1 - WATER LINE FOR FRIDGE - ROUGH-IN ONLY 19May21 Note:	
--	--

PROMOTIONAL

1 - LESS BALANCE OF CREDIT FROM PURCHASER EXTRA SHEET IN OFFER 19May21 Note:	
---	--

STAIRS AND RAILINGS



CONSTRUCTION SUMMARY

Reesor Ridge At Wismer - Lampone Investments Inc.

PURCHASERS: Harikeshan SUNDARAMOHAN and Eshana THARMAKUMAR

TEL:

LOT / PHASE 73 Left / 1	REG. PLAN # 65M-4573	HOUSE TYPE Peyton 2 Elev 2		
1 - EUROLINE 1 19May21 Note: BLACK IRON PICKET				
1 - STAINED STAIRS – STANDARD STAIRCASE - PRICE IS PER SET 19May21 Note:				

EXTRAS AS PER OFFER

PURCHASER(S) ACKNOWLEDGES THAT THE PURCHASE PRICE IS INCLUSIVE OF ALL CREDITS AND PROMOTIONAL PACKAGES AVAILABLE AT TIME OF PURCHASE. Worksheet Note:	
(Semi Detached) The Vendor agrees that notwithstanding any other term or provision in this Agreement included in the Purchase Price and in addition to those items detailed in Schedule GP to the Agreement of Purchase and Sale, the Purchaser is entitled to Worksheet Note:	

This Document is Extremely Time Sensitive - Printed 19 May 21 at 12:38

Purchasers:

Harikeshan SUNDARAMOHAN & Eshana THARI

Telephone Res. / Bus:

/

Decor Advisor:

Aly Aversa

Lock Date:

19-May-21

Property:

73 Left

Project:

Lampone Investments Inc.

Model and Elevation:

Peyton 2 Elev 2

Plan #:

65M-4573

Layout Changes: ☐ Yes ☒ No

Sketch Attached: ☐ Yes ☒ No

Exterior Colour Scheme:

1. Cabinetry

	Style and Colour	Hardware
Kitchen / Breakfast	LEGACY 614 CRISP WHITE	114SB
Laundry Room	N/A	Standard
Powder Room	CONTINENTAL 814 DARK CHOCOLATE	446SA
Master Ensuite Bathroom	DORAL W-500	446SA
Main Bathroom	CONTINENTAL 814 DARK CHOCOLATE	446SA

Appliances:

Built In Appliances ☐ Yes ☒ No

Slide In Stove ☐ Yes ☒ No

Dishwasher Cabinet ☐ Closed ☒ Open

41" Upper Cabinets ☒ Yes ☐ No

Please NOTE: Standard Cabinet Height is 30"

Stove Opening

NOTE: If not specified, opening will be set to builder's standard opening of approximately 30" width

Fridge Opening

NOTE: If not specified, opening will be set to builder's standard opening of approximately 37" width x 74" height

** Refer to Construction Summary ** NO FULL DEPTH ABOVE THE FRIDGE **

2. Counters

	Counter	Edge
Kitchen / Breakfast	LAMINATE-CALCUTTA MARBLE 4925K-07	
Laundry Room	N/A	
Powder Room	LAMINATE-CALCUTTA MARBLE 4925K-07	
Master Ensuite Bathroom	LAMINATE-CALCUTTA MARBLE 4925K-07	
Main Bathroom	LAMINATE-CALCUTTA MARBLE 4925K-07	

** Refer to Construction Summary

Initials:

Purchasers:

Harikeshan SUNDARAMOHAN & Eshana THARI

Property:

73 Left

Telephone Res. / Bus:

/

Project:

Lampone Investments Inc.

Decor Advisor:

Aly Aversa

Model and Elevation:

Peyton 2 Elev 2

Lock Date:

19-May-21

19-May-21

Plan #:

65M-4573

3. Ceramic Flooring

Entrance Vestibule

TILE-CEMENTI WHITE 12X12

☐

At a 45 Threshold-If App.

Metal Strip Where Applic.

Main Hall

N/A

☐

Kitchen / Breakfast

LAMINATE

☐

Laundry Room

TILE-COLOUR WHITE 13X13

☐

Powder Room

TILE-CEMENTI WHITE 12X12

☐

Master Ensuite Bathroom

TILE-COLOUR WHITE 13X13

☐

Main Bathroom

TILE-COLOUR WHITE 13X13

☐

SIDE ENTRANCE

TILE-CEMENTI WHITE 12X12

☐

☐

☐

☐

** Refer to Construction Summary

4. Ceramic Wall Tile

Master Ensuite Bathroom	Selection	Describe
Tub Deck Wall	TILE-GLOSSY 22500 WHITE 8X10	
Tub Deck	N/A	
Tub Deck Skirt	N/A	
Shower Stall	TILE-GLOSSY 22500 WHITE 8X10	
Bathtub Enclosure Walls	N/A	
Main Bathroom	TILE-GLOSSY 22500 WHITE 8X10	
SIDE ENTRANCE	N/A	
Kitchen Backsplash	N/A	

** Refer to Construction Summary - STANDARD GROUT THROUGHOUT UNLESS SPECIFIED

5. Plumbing Fixtures

All Bathrooms

White

Whirlpool

☐ Yes ☒ No

Dishwasher Rough-In

☒ Yes ☐ No

Waterline for Fridge

☒ Yes ☐ No

** Refer to Construction Summary

6. Trim Carpentry

Interior Doors

As Per Construction Specifications

Interior Trim

As Per Construction Specifications



Door Handles

As Per Construction Specifications

Exterior Front Door Handle

As Per Construction Specifications

** Refer to Construction Summary

Initials:  

Purchasers:

Harikeshan SUNDARAMOHAN & Eshana THARI

Telephone Res. / Bus:

/

Decor Advisor:

Aly Aversa

Lock Date:

19-May-21

Property:

73 Left

Project:

Lampone Investments Inc.

Model and Elevation:

Peyton 2 Elev 2

Plan #:

65M-4573

7. Other Flooring		Plan #:	65IM-4573
Main Hall	LAMINATE-FJORD-RUNA MAPLE-TL-NEUM08		
Living Room	LAMINATE-FJORD-RUNA MAPLE-TL-NEUM08		
Dining Room	LAMINATE-FJORD-RUNA MAPLE-TL-NEUM08		
Family Room	N/A		
Den / Library / Study	N/A		
Basement Landing(If Applies)	N/A		
Lower Landing (If Applies)	LAMINATE-FJORD-RUNA MAPLE-TL-NEUM08		
Upper Landing	LAMINATE-FJORD-RUNA MAPLE-TL-NEUM08		
Upper Hall	LAMINATE-FJORD-RUNA MAPLE-TL-NEUM08		
Master Bedroom	CARPET-MINOTAUR-A4525 - BEACH SHELL - 84558		
Bedroom #2	CARPET-MINOTAUR-A4525 - BEACH SHELL - 84558		
Bedroom #3	CARPET-MINOTAUR-A4525 - BEACH SHELL - 84558		
Bedroom #4	N/A		
Bedroom #5	N/A		
KITCHEN & BREAKFAST	LAMINATE-FJORD-RUNA MAPLE-TL-NEUM08		
Underpad	Type	Area	

** Refer to Construction Summary

8. Railings and Pickets

Railing Type	AS PER CONSTRUCTION SPECIFICATIONS	Colour	LAMINATE-FJORD-RUNA MAPLE
Picket Type	EUROLINE 1	Colour	BLACK
Stringer / Riser	AS PER CONSTRUCTION SPECIFICATIO	Colour	LAMINATE-FJORD-RUNA MAPLE
Treads	AS PER CONSTRUCTION SPECIFICATIO	Colour	LAMINATE-FJORD-RUNA MAPLE
Red Oak Stairs with Semi Gloss Finish		<input checked="" type="radio"/> Yes <input type="radio"/> No	

** Refer to Construction Summary THE STAIN COLOURS OR FINISH AVAILABLE ON RISERS, TREADS, PICKETS AND RAILS (STAIRCASES), WILL NOT BE AN EXACT MATCH TO PREFINISHED HARDWOOD OR LAMINATE FLOORS.

9. Wall Paint Flat Finish

Main & Upper Hall	43 BIRCH WHITE	Master Bedroom	43 BIRCH WHITE
Living Room	43 BIRCH WHITE	Bedroom #2	43 BIRCH WHITE
Dining Room	43 BIRCH WHITE	Bedroom #3	43 BIRCH WHITE
Kitchen / Breakfast	43 BIRCH WHITE	Bedroom #4	N/A
Family Room	N/A	Bedroom #5	N/A
Powder Room	43 BIRCH WHITE	Master Ensuite	43 BIRCH WHITE
Laundry Room	43 BIRCH WHITE	Main Bathroom	43 BIRCH WHITE
Den/Library	N/A		
Trim Paint-Semi Gloss	43 BIRCH WHITE		

Smooth Ceilings First Floor ☒ Yes ☐ No

** Refer to Construction Summary

Initials:  

Purchasers:Harikeshan SUNDARAMOHAN & Eshana THARI

Telephone Res. / Bus: /

Decor Advisor:Aly Aversa

Lock Date:19-May-21

Property: 73 Left

Project: Lampone Investments Inc.

Model and Elevation: Peyton 2 Elev 2

Plan #: 65M-4573

10. Plaster Mouldings and Medallions

Entrance Vestibule			Kitchen/Breakfast		
Main Hall			Den/Library		
Living Room			Lower Landing		
Dining Room					
Family Room					

** Refer to Construction Summary

11. Fireplace

	Living Room			Family Room			Other Room - Specify		
	Purchased	As Per Plan	N/A	Purchased	As Per Plan	N/A	Purchased	As Per Plan	N/A
Fireplace Type	<input type="radio"/>	<input type="radio"/>	<input checked="" type="radio"/>	<input type="radio"/>	<input type="radio"/>	<input checked="" type="radio"/>	<input type="radio"/>	<input type="radio"/>	<input checked="" type="radio"/>
Mantle Type									
Colour / Stain									
Surround									
Hearth									

** Refer to Construction Summary

12. Heating and Air Conditioning

Air Conditioning	NO	Gas Provisions Stove	YES
Gas Provisions Dryer	NO	Gas Provisions Barbecue	NO
Comment			

** Refer to Construction Summary

13. Electrical

Plugs and Switches	<input checked="" type="radio"/> White	Standard	Above Kitchen Cabinet Light	<input type="radio"/> Yes	<input checked="" type="radio"/> No	
Hood Fan	STANDARD WHITE TEMP.		Below Kitchen Cabinet Light	<input type="radio"/> Yes	<input checked="" type="radio"/> No	
Appliances	Built in Cooktop		Built in Oven		Gas Stove	
	<input type="radio"/> Yes	<input checked="" type="radio"/> No	<input type="radio"/> Yes	<input checked="" type="radio"/> No	Microwave	
Dishwasher Rough-in	Yes		<input checked="" type="radio"/> Yes	<input type="radio"/> Yes		<input checked="" type="radio"/> No

** Refer to Construction Summary

14. General Comments

** Refer to Construction Summary

Disclaimers and Notes

- 1) Colours of all materials are as close as possible to builder's selection, but not necessarily identical due to variances in manufacturing.
- 2) Any extras listed above are null and void unless accompanied by a separate invoice/amendment. Said invoice must be paid in full.
- 3) The Purchaser agrees that this colour selection is final and that no changes will be permitted, unless required by the Vendor.
- 4) The Purchaser acknowledges reading and accepting document which contains other miscellaneous disclaimers.

Signature:  Date: 05/19/21

Signature:  Date: May 19th/21

— Upgrade 3

Delete
Cabinet
Above stove

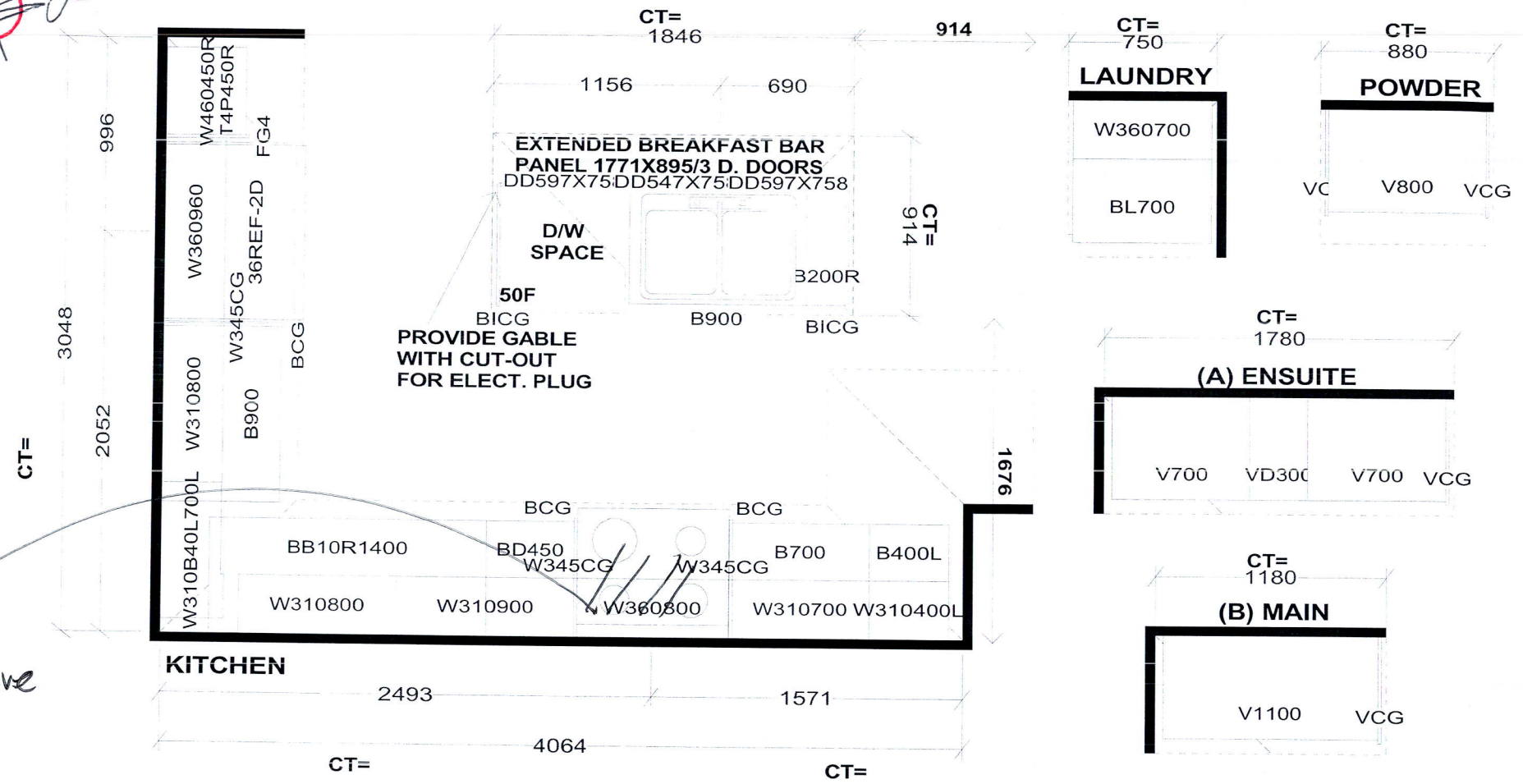
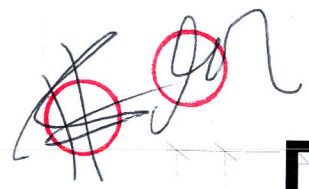

Selba Industries			J#
<small>This drawing is the intellectual property of SELBA INDUSTRIES INC. and is an original design which must not be released or copied unless applicable fee has been paid or job order placed.</small>			JOB NUMBER: BUILDER: GREENPARK SITE: LAMPONE, Markham MODEL: PEYTON 2SX EL 1,2,3 LOT #:
W WIDTH _____	W HGHT _____	W CNT _____	
FLOOR HGHT _____	DOOR HGHT _____		
ST. CENT _____	2X4 _____	VENT BOX COVER _____	

HA

GB

FC

ED

DESIGNER: KS
DATE: July 29 20

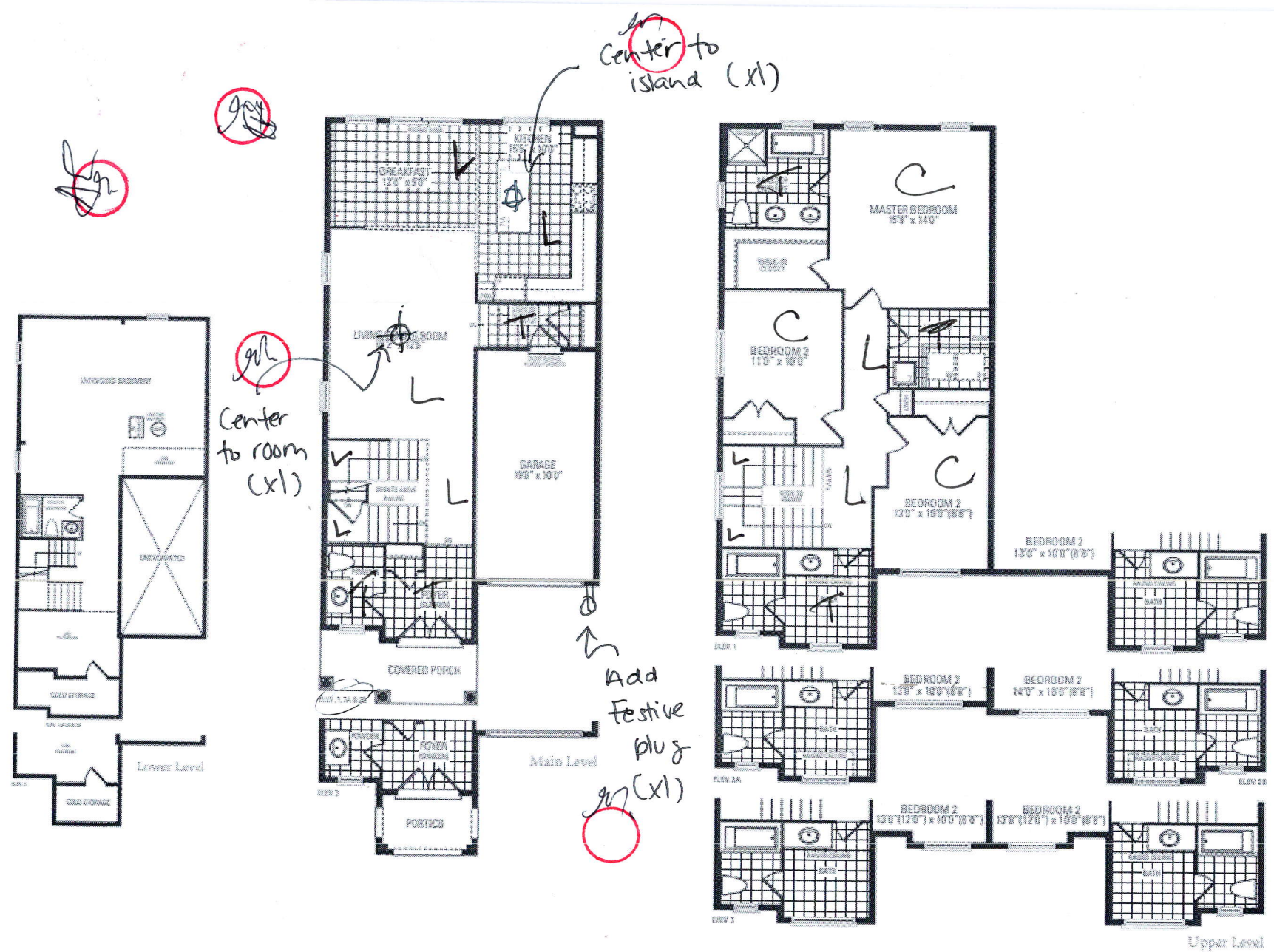

Peyton Two

Elevation 1 - 1,937 Sq.Ft. | Elevation 2 & 3 - 1,935 Sq.Ft.

Includes 11 Sq.Ft. of open area.

Orientation of home may be reversed and purchaser agrees to accept the same. Steps and porches may vary at any exterior entrance ways due to grading variance. Actual usable floor space may vary from the stated floor areas. All renderings are artist's concept. Dimensions, specifications and architectural detailing subject to modifications. Profile and adjoining model types may vary due to string. 2. & 0 E. June 2020