

CONSTRUCTION SUMMARY

Elizabeth Heights - Trinar Hall Homes Inc.

PURCHASERS: REY KEYVANI and KRISTINA EVELYN KEYVANI

TEL:

LOT / PHASE	REG. PLAN #	HOUSE TYPE		
15 / 1	65M-4671	BRENTWOOD 2 ELEV 2		

BACKSPLASH - COUNTER TOP MATERIAL

1 - COUNTER TOP - KITCHEN - BACKSPLASH 13May21 Note: CESEARSTONE	
---	--

CABINETRY

1 - CABINETRY - BEDROOM 4 ENSUITE - UPGRADE 2 13May21 Note:	
1 - CABINETRY - BEDROOM 3 ENSUITE - UPGRADE 2 13May21 Note:	
1 - CABINETRY - POWDER - UPGRADE 2 13May21 Note:	
1 - CABINETRY - BEDROOM #2 ENSUITE - UPGRADE 2 13May21 Note:	
1 - CABINETRY - ENSUITE - UPGRADE 2 13May21 Note:	
1 - CABINETRY - KITCHEN - UPGRADE 5 13May21 Note:	
1 - KITCHEN CABINETRY - VALANCE 13May21 Note:	
6 - DELETE HARDWARE NO HOLES DRILLED 13May21 Note: KITCHEN POWDER MASTER ENSUITE ENSUITE 2 ENSUITE 3 ENSUITE 4	
1 - KITCHEN CABINETRY - TWO COLOUR KITCHEN - FLAT FEE 13May21 Note:	

CABINETRY ACCESSORIES

1 - KITCHEN CABINETRY BASE - COOKTOP CABINET WITH POT DRAWERS (2 DRAWERS) - UPGRADE 5 13May21 Note:	
1 - KITCHEN CABINETRY - BUILT-IN MICROWAVE/OVEN COMBO - UPGRADE 5 13May21 Note:	
2 - KITCHEN CABINETRY BASE - PULLOUT WIRE SPICE RACK - PRICE IS EACH 13May21 Note:	
1 - KITCHEN CABINETRY BASE - PULLOUT RECYCLE 2 BIN - PRICE IS EACH 13May21 Note:	
1 - PANTRY UNIT UPGRADE - TO GO FROM 300MM TO 600MM DEEP - PRICE IS PER FOOT - UPGRADE 5 13May21 Note:	
1 - KITCHEN CABINETRY UPPER - FULL DEPTH ABOVE FRIDGE - WITH GABLES - 600MM - PRICE IS EACH - UPGRADE 5 13May21 Note:	
1 - KITCHEN HOOD CABINETS - CONTEMPORARY WOOD HOOD - UPGRADE 5 13May21 Note:	
1 - KITCHEN CABINETRY ACCESSORY - SOFT CLOSE CAB. & BLU MOTION DRAWERS - THROUGHOUT KITCHEN 13May21 Note:	

CERAMIC TILE

RECEIVED  
MAY 18 2021

CONSTRUCTION SUMMARY

Elizabeth Heights - Trinar Hall Homes Inc.

PURCHASERS: REY KEYVANI and KRISTINA EVELYN KEYVANI

TEL:

LOT / PHASE 15 / 1	REG. PLAN # 65M-4671	HOUSE TYPE BRENTWOOD 2 ELEV 2		
-----------------------	-------------------------	----------------------------------	--	--

1 - PRICE IS FOR LABOUR ONLY - INSTALL TILE IN A STAGGERED PATTERN - - BATHROOM 4 - TUB 13May21 Note:	
1 - PRICE IS FOR LABOUR ONLY - INSTALL TILE IN A STAGGERED PATTERN - - BATHROOM 3 - SHOWER 13May21 Note:	
1 - PRICE IS FOR LABOUR ONLY - INSTALL TILE IN A STAGGERED PATTERN - - BATHROOM 2 - TUB AREA 13May21 Note:	
1 - TILE - UPGRADE 1 WALL TILE - - BATHROOM 4 - TUB 13May21 Note:	
1 - TILE - UPGRADE 1 FLOOR TILE - - BATHROOM 4 - FLOOR 13May21 Note:	
1 - TILE - UPGRADE 1 WALL TILE - - BATHROOM 3 - SHOWER 13May21 Note:	
1 - TILE - UPGRADE 1 FLOOR TILE - - BATHROOM 3 - FLOOR 13May21 Note:	
1 - TILE - UPGRADE 1 WALL TILE - - BATHROOM 2 - TUB AREA 13May21 Note:	
1 - TILE - UPGRADE 1 FLOOR TILE - - BATHROOM 2 - FLOOR 13May21 Note:	
1 - TILE - UPGRADE 4 WALL TILE - - ENSUITE WALL TILE - SHOWER 13May21 Note:	
1 - TILE - UPGRADE 4 FLOOR TILE - - ENSUITE BATHROOM - FLOOR 13May21 Note:	
1 - TILE - UPGRADE 4 FLOOR TILE - - POWDER ROOM 13May21 Note:	
1 - TILE - UPGRADE 4 FLOOR TILE - - LAUNDRY ROOM 13May21 Note:	
1 - TILE - UPGRADE 4 FLOOR TILE - - FOYER 13May21 Note:	

CONSTRUCTION

1 - SMOOTH CEILINGS ON FIRST FLOOR ONLY - DET 13May21 Note:	
1 - MASTER ENSUITE- DELETE WALL AND DOOR IN FRONT OF TOILET- 21Aug20 Note:	
3 - ENLARGE BASEMENT WINDOWS (MAY REQUIRE WINDOW WELLS) - WINDOW IS 30 INCHES X 24 INCHES 21Aug20 Note:	

COUNTER TOP

1 - COUNTER TOP - KITCHEN 13May21 Note:	
1 - COUNTER TOP - POWER ROOM VANITY COUNTER TOP 13May21 Note:	
1 - COUNTER TOP - ENSUITE BATHROOM VANITY COUNTER TOP 13May21 Note:	

CONSTRUCTION SUMMARY

Elizabeth Heights - Trinar Hall Homes Inc.

PURCHASERS: REY KEYVANI and KRISTINA EVELYN KEYVANI

TEL:

LOT / PHASE 15 / 1	REG. PLAN # 65M-4671	HOUSE TYPE BRENTWOOD 2 ELEV 2		
-----------------------	-------------------------	----------------------------------	--	--

1 - COUNTER TOP - ENSUITE BATHROOM 4 VANITY COUNTER TOP 13May21 Note:	
1 - COUNTER TOP - ENSUITE BATHROOM 3 VANITY COUNTER TOP 13May21 Note:	
1 - COUNTER TOP - ENSUITE BATHROOM 2 VANITY COUNTER TOP 13May21 Note:	

DOORS AND TRIM

1 - TRIM - 7-¼” ONE STEP BB AND 3” ONE STEP CASING 13May21 Note:	
---	--

ELECTRICAL

1 - POT LIGHT - LED - SECOND FLOOR INSTALLATION 13May21 Note: MASTER BEDROOM X1 REFER TO SKETCH	
1 - PLUG - ELECTRICAL PLUG 13May21 Note: MASTER BEDROOM - X1 REFER TO SKETCH	
4 - POT LIGHT - LED - FIRST FLOOR INSTALLATION 13May21 Note: LIVING/DINING - X1 FAMILY ROOM - X1 KITCHEN - X1 DINETTE - X1	
1 - BUILT IN OVEN AND COOKTOP PROVISION - PROVISION ONLY - ELECTRICAL ONLY 13May21 Note:	
1 - KITCHEN – FAN INSERT FOR UPGRADE 36” HOOD – CYCLONE BX600-34 13May21 Note:	
<del>1 - KITCHEN – VALANCE LIGHTING – ROUGH IN ONLY</del> 13May21 <del>Note:</del> complete valance lighting- L.E.D.	
2 - PLUG - ELECTRICAL PLUG WITH GFI AND SWITCH - FOR FESTIVE LIGHTING 13May21 Note:	
2 - PLUG - ELECTRICAL PLUG - TO BE INSTALLED FOR FUTURE WALL MOUNTED TV 13May21 Note: FAMILY ROOM - X1 MASTER BEDROOM - X1 REFER TO SKETCH	
1 - PLUG - ELECTRICAL PLUG - TO BE INSTALLED OVER FIREPLACE 13May21 Note:	
1 - POT LIGHT - SHOWER POT LIGHT 13May21 Note: ENSUITE 3 - X1	
1 - IF SITE PERMITS - RELOCATE STANDARD UPPER HALLWAY LIGHT TO BE CENTERED OVER OPEN TO ABOVE STAIRCASE 13May21 Note: REFER TO SKETCH	
1 - LIGHT AND SWITCH - NO FIXTURE INCLUDED 13May21 Note: MASTER ENSUITE - WALL SCONCE X1 REFER TO SKETCH	
1 - LIGHT AND SWITCH - NO FIXTURE INCLUDED 13May21 Note: TO BE INSTALLED OVER KITCHEN ISLAND REFER TO SKETCH	
1 - RELOCATE STANDARD KITCHEN LIGHT OVER ISLAND 13May21 Note: REFER TO SKETCH	
1 - 200 AMP ELECTRICAL SERVICE 21Aug20 Note:	

FIREPLACE AND ACCESSORIES

CONSTRUCTION SUMMARY

Elizabeth Heights - Trinar Hall Homes Inc.

PURCHASERS: REY KEYVANI and KRISTINA EVELYN KEYVANI

TEL:

LOT / PHASE 15 / 1	REG. PLAN # 65M-4671	HOUSE TYPE BRENTWOOD 2 ELEV 2		
-----------------------	-------------------------	----------------------------------	--	--

1 - MANTEL - PAINTED - M6 - IN LIEU OF STANDARD MANTEL  
13May21 Note:

1 - GAS LINE ROUGH-IN FOR BARBECUE - FIRST FLOOR  
13May21 Note:

1 - GAS LINE ROUGH-IN FOR STOVE (INCLUDES ELECTRICAL OUTLET) - FIRST FLOOR  
13May21 Note:

HARDWOOD FLOORING

1 - HARDWOOD - GROUP A SERIES 5 INCH - - UPPER HALL  
13May21 Note:

1 - HARDWOOD - GROUP A SERIES 5 INCH - IN LIEU OF 2 1/4 INCH NATURAL RED OAK - - FIRST FLOOR COMPLETE  
13May21 Note:

MIRRORS AND GLASS

1 - DELETE MIRRORS THROUGHOUT  
17May21 Note:

1 - MASTER ENSUITE – FRAMELESS GLASS SHOWER ENCLOSURE – INCLUDES CHROME KNOB AND HINGES  
21Aug20 Note:

PAINTING

1 - UPGRADE - WHITE PAINT - DOORS AND TRIM THROUGHOUT  
13May21 Note:

PLUMBING

1 - KITCHEN – POT FILLER – DELTA CONTEMPORARY CHROME POT FILLER #1165LF  
13May21 Note:

1 - SINK - UNDERMOUNT SINK - BLANCO QUATRUS R15 U SUPER SINGLE #401518  
13May21 Note:

6 - SINK - UNDERMOUNT SINK - CONTRAC COLLETTE #4220CIY  
13May21 Note: POWDER X1  
MASTER ENSUITE X2  
ENSUITE 2 - X1  
ENSUITE 3 - X1  
ENSUITE 4 - X1

1 - PLUMBING - ALIGN SHOWERHEAD #S176  
13May21 Note: \*\* MASTER ENSUITE \*\*  
~~MASTER ENSUITE SHOWER HEAD AND DRAINAGE~~ ADD-6" SHOWER ARM 116651

2 - TOE TESTER - ADD TOE TESTER TO SHOWER  
13May21 Note: MASTER ENSUITE X1  
ENSUITE 3 - X1

1 - WATER LINE FOR FRIDGE - ROUGH-IN ONLY  
13May21 Note:

1 - BEDROOM 4 ENSUITE-----DELETE SHOWER AND INSTALL 5 TUB  
21Aug20 Note:

PROMOTIONAL

1 - LESS BALANCE OF CREDIT FROM PURCHASER EXTRA SHEET IN OFFER  
13May21 Note:

1 - PARTIAL REDEMPTION OF PROMOTIONAL PACKAGE \$\$\$\$\$\$ BALANCE FORWARD TO BE USED AT A LATER DATE. ORIGINAL PROMOTIONAL PACKAGE OF \$\$\$\$\$ AS PER SCHEDULE PE DATED MMMDDYYYY.  
21Aug20 Note: PROMO AS PER OFFER \$15,000.00 LESS \$6,820.00 NEW BALANCE PROMO \$8,180.00

STAIRS AND RAILINGS





CONSTRUCTION SUMMARY

Elizabeth Heights - Trinar Hall Homes Inc.

PURCHASERS: REY KEYVANI and KRISTINA EVELYN KEYVANI

TEL:

LOT / PHASE 15 / 1	REG. PLAN # 65M-4671	HOUSE TYPE BRENTWOOD 2 ELEV 2		
-----------------------	-------------------------	----------------------------------	--	--

1 - 1¾" SQUARE PICKETS 13May21 Note: STAIRCASE		
1 - V GROOVE HANDRAIL 13May21 Note: STAIRCASE		
1 - STAINED HANDRAIL, NOSING AND TREADS WITH PAINTED PICKETS, RISERS AND STRINGER - STANDARD STAIRCASE - PRICE IS PER SET 13May21 Note:		

EXTRAS AS PER OFFER

PURCHASER(S) ACKNOWLEDGES THAT THE PURCHASE PRICE IS INCLUSIVE OF ALL CREDITS AND PROMOTIONAL PACKAGES AVAILABLE AT TIME OF PURCHASE. Worksheet Note:		
The Vendor agrees that notwithstanding any other term or provision in this Agreement included in the Purchase Price and in addition to those items detailed in Schedule GP to the Agreement of Purchase and Sale, the Purchaser is entitled to a credit of Fif Worksheet Note:		

This Document is Extremely Time Sensitive - Printed 18 May 21 at 8:44

Purchasers:REY KEYVANI & KRISTINA EVELYN KEYVANI

Property: 15

Telephone Res. / Bus: /

Project: Trinar Hall Homes Inc.

Decor Advisor: Aly Aversa

Model and Elevation: BRENTWOOD 2 ELEV 2

Lock Date: 13-May-21

13-May-21

Plan #: 65M-4671

Layout Changes: ☐ Yes ☒ No

Sketch Attached: ☐ Yes ☒ No

Exterior Colour Scheme:

1. Cabinetry

	Style and Colour	Hardware
Kitchen / Breakfast	MISSION 614 CRISP WHITE / KITCHEN ISLAND MISSION 701 PEWTER	N/A
Laundry Room	ELISSE	Standard
Powder Room	SONATA SATIN SNOW	N/A
Master Ensuite Bathroom	SONATA SATIN SNOW	N/A
Ensuite Bath - Bedroom 2	SONATA SATIN SNOW	N/A
Ensuite Bath - Bedroom 3	SONATA SATIN SNOW	N/A
Ensuite Bath - Bedroom 4	SONATA SATIN SNOW	N/A

Appliances:

Built In Appliances ☒ Yes ☐ No

Slide In Stove ☐ Yes ☒ No

Dishwasher Cabinet ☐ Closed ☒ Open

41" Upper Cabinets ☒ Yes ☐ No

Please NOTE: Standard Cabinet Height is 30"

Stove Opening 36"

NOTE: If not specified, opening will be set to builder's standard opening of approximately 30" width

Fridge Opening

NOTE: If not specified, opening will be set to builder's standard opening of approximately 37" width x 74" height

\*\* Refer to Construction Summary

2. Counters

	Counter	Edge
Kitchen / Breakfast	CAESARSTONE - EMPIRA WHITE	#360 EDGE
Laundry Room	N/A	N/A
Powder Room	QUARTZ - MISTRAL	#360 EDGE
Master Ensuite Bathroom	QUARTZ-VEGA	#360 EDGE
Ensuite Bath - Bedroom 2	GRANITE-NERO ASSOLUTO	#360 EDGE
Ensuite Bath - Bedroom 3	GRANITE-NERO ASSOLUTO	#360 EDGE
Ensuite Bath - Bedroom 4	GRANITE-NERO ASSOLUTO	#360 EDGE

\*\* Refer to Construction Summary

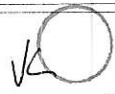
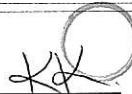
Initials:  

Page 1 of 4

Printed 5/13/2021 16:43:57

Purchasers:REY KEYVANI & KRISTINA EVELYN KEYVANI

Property: 15

Telephone Res. / Bus: /

Project: Trinar Hall Homes Inc.

Decor Advisor: Aly Aversa

Model and Elevation: BRENTWOOD 2 ELEV 2

Lock Date: 13-May-21

13-May-21

Plan #: 65M-4671

3. Ceramic Flooring

		At a 45	Threshold-If App.
Entrance Vestibule	TILE - CALACATTA (CA6083P) 24X24	<input type="checkbox"/>	Metal Strip Where Applic.
Main Hall	TILE - CALACATTA (CA6083P) 24X24	<input type="checkbox"/>	
Kitchen / Breakfast	TILE - S.N. PASTELLO BIANCO 13X13	<input type="checkbox"/>	
Laundry Room	TILE - CALACATTA (CA6083P) 24X24	<input type="checkbox"/>	
Powder Room	TILE - CALACATTA (CA6083P) 24X24	<input type="checkbox"/>	
Master Ensuite Bathroom	TILE - CALACATTA (CA6083P) 24X24	<input type="checkbox"/>	
Ensuite Bath - Bedroom 2	TILE- TRAVERTINO NERO NAT 12X24	<input type="checkbox"/>	
Ensuite Bath - Bedroom 3	TILE- TRAVERTINO NERO NAT 12X24	<input type="checkbox"/>	
Ensuite Bath - Bedroom 4	TILE- TRAVERTINO NERO NAT 12X24	<input type="checkbox"/>	
		<input type="checkbox"/>	
		<input type="checkbox"/>	

\*\* Refer to Construction Summary

4. Ceramic Wall Tile

Master Ensuite Bathroom	Selection	Describe
Tub Deck Wall	N/A	
Tub Deck	N/A	
Tub Deck Skirt	N/A	
Shower Stall	TILE - CALACATTA (CA6083P) 24X24	
Bathtub Enclosure Walls	N/A	
Ensuite Bath - Bedroom 2	TILE-GLOSSY WHITE 4500 (QT011) 4X16	STAGGERED
Ensuite Bath - Bedroom 3	TILE-GLOSSY WHITE 4500 (QT011) 4X16	STAGGERED
Ensuite Bath - Bedroom 4	TILE-GLOSSY WHITE 4500 (QT011) 4X16	STAGGERED
Kitchen Backsplash	CAESARSTONE - EMPIRA WHITE	FULL HEIGHT

\*\* Refer to Construction Summary - STANDARD GROUT THROUGHOUT UNLESS SPECIFIED

5. Plumbing Fixtures

All Bathrooms

White

Whirlpool

☐ Yes☒ No

Dishwasher Rough-In

☒ Yes☐ No

Waterline for Fridge

☒ Yes☐ No

\*\* Refer to Construction Summary

6. Trim Carpentry

Interior Doors	As Per Construction Specifications
Interior Trim	BB CASING WITH 7 1/4" BASEBOARD - ONE STEP
Door Handles	As Per Construction Specifications
Exterior Front Door Handle	As Per Construction Specifications

\*\* Refer to Construction Summary

Initials:

Purchasers:

REY KEYVANI & KRISTINA EVELYN KEYVANI

Property: 15

Telephone Res. / Bus:

/

Project: Trinar Hall Homes Inc.

Decor Advisor:

Aly Aversa

Model and Elevation: BRENTWOOD 2 ELEV 2

Lock Date:

13-May-21

13-May-21

Plan #: 65M-4671

7. Other Flooring		
Main Hall	HARDWOOD-VINTAGE-NORTHERN SOLID SAWN COLLECTION CHARACTER PEARL RED OAK 5" ANGORA	
Living Room	HARDWOOD-VINTAGE-NORTHERN SOLID SAWN COLLECTION CHARACTER PEARL RED OAK 5" ANGORA	
Dining Room	HARDWOOD-VINTAGE-NORTHERN SOLID SAWN COLLECTION CHARACTER PEARL RED OAK 5" ANGORA	
Family Room	HARDWOOD-VINTAGE-NORTHERN SOLID SAWN COLLECTION CHARACTER PEARL RED OAK 5" ANGORA	
Den / Library / Study	N/A	
Basement Landing(If Applies)	N/A	
Lower Landing (If Applies)	N/A Tile: Calacatta (CAG083P) 24x24	
Upper Landing	HARDWOOD-VINTAGE-NORTHERN SOLID SAWN COLLECTION CHARACTER PEARL RED OAK 5" ANGORA	
Upper Hall	HARDWOOD-VINTAGE-NORTHERN SOLID SAWN COLLECTION CHARACTER PEARL RED OAK 5" ANGORA	
Master Bedroom	LAMINATE-LEXINGTON-BRUSSELS OAK-TL-LW1316	
Bedroom #2	LAMINATE-LEXINGTON-BRUSSELS OAK-TL-LW1316	
Bedroom #3	LAMINATE-LEXINGTON-BRUSSELS OAK-TL-LW1316	
Bedroom #4	LAMINATE-LEXINGTON-BRUSSELS OAK-TL-LW1316	
Bedroom #5	N/A	
Underpad	Type	Area
	N/A	N/A

\*\* Refer to Construction Summary

8. Railings and Pickets

Railing Type	V-GROOVE	Colour	complimentry colour - vintage titanium oak
Picket Type	1 3/4" SQUARE PICKETS	Colour	WHITE
Stringer / Riser	AS PER CONSTRUCTION SPECIFICATIO	Colour	WHITE
Treads	AS PER CONSTRUCTION SPECIFICATIO	Colour	complimentry colour - vintage titanium oak
Red Oak Stairs with Semi Gloss Finish		<input checked="" type="radio"/> Yes <input type="radio"/> No	

\*\* Refer to Construction Summary THE STAIN COLOURS OR FINISH AVAILABLE ON RISERS, TREADS, PICKETS AND RAILS (STAIRCASES), WILL NOT BE AN EXACT MATCH TO PREFINISHED HARDWOOD OR LAMINATE FLOORS.

9. Wall Paint Flat Finish

Main & Upper Hall	22 WARM GREY	Master Bedroom	22 WARM GREY
Living Room	22 WARM GREY	Bedroom #2	22 WARM GREY
Dining Room	22 WARM GREY	Bedroom #3	22 WARM GREY
Kitchen / Breakfast	22 WARM GREY	Bedroom #4	22 WARM GREY
Family Room	22 WARM GREY	Bedroom #5	N/A
Powder Room	22 WARM GREY	Master Ensuite	22 WARM GREY
Laundry Room	22 WARM GREY	Ensuite Bath - Bedroom 2	22 WARM GREY
Den/Library	22 WARM GREY	Ensuite Bath - Bedroom 3	22 WARM GREY
Trim Paint-Semi Gloss	WHITE	Ensuite Bath - Bedroom 4	22 WARM GREY

Smooth Ceilings First Floor ☒ Yes ☐ No

\*\* Refer to Construction Summary

Initials:  

Purchasers:

REY KEYVANI & KRISTINA EVELYN KEYVANI

Property: 15

Telephone Res. / Bus:

/

Project: Trinar Hall Homes Inc.

Decor Advisor:

Aly Aversa

Model and Elevation: BRENTWOOD 2 ELEV 2

Lock Date:

13-May-21

13-May-21

Plan #:

65M-4671

10. Plaster Mouldings and Medallions

Entrance Vestibule			Kitchen/Breakfast		
Main Hall			Den/Library		
Living Room			Lower Landing		
Dining Room					
Family Room					

\*\* Refer to Construction Summary

11. Fireplace

Living Room	Family Room	Other Room - Specify
Purchased As Per Plan N/A	Purchased As Per Plan N/A	Purchased As Per Plan N/A
<input type="radio"/> <input type="radio"/> <input checked="" type="radio"/>	<input type="radio"/> <input checked="" type="radio"/> <input type="radio"/>	<input type="radio"/> <input type="radio"/> <input checked="" type="radio"/>
Fireplace Type	As Per Construction Specifications	
Mantle Type	MANTLE M6	
Colour / Stain	AS PER CONSTRUCTION SPECIFICATIONS	
Surround	BIANCO	
Hearth	N/A	

\*\* Refer to Construction Summary

12. Heating and Air Conditioning

Air Conditioning	NO	Gas Provisions Stove	YES
Gas Provisions Dryer	NO	Gas Provisions Barbecue	YES
Comment			

\*\* Refer to Construction Summary

13. Electrical

Plugs and Switches	<input checked="" type="radio"/> White <input type="radio"/> Standard	Above Kitchen Cabinet Light	<input type="radio"/> Yes <input checked="" type="radio"/> No
Hood Fan	CYCLONE INSERT 34" #BX21534	Below Kitchen Cabinet Light	<input checked="" type="radio"/> Yes <input type="radio"/> No
Appliances	Built in Cooktop Built in Oven	Gas Stove	Microwave
	<input checked="" type="radio"/> Yes <input type="radio"/> No <input checked="" type="radio"/> Yes <input type="radio"/> No	<input checked="" type="radio"/> Yes <input type="radio"/> No	<input checked="" type="radio"/> Yes <input type="radio"/> No
Dishwasher Rough-in	Yes		

\*\* Refer to Construction Summary

14. General Comments

\*\* Refer to Construction Summary

Disclaimers and Notes

1) Colours of all materials are as close as possible to builder's selection, but not necessarily identical due to variances in manufacturing.

2) Any extras listed above are null and void unless accompanied by a separate invoice/amendment. Said invoice must be paid in full.

3) The Purchaser agrees that this colour selection is final and that no changes will be permitted, unless required by the Vendor.

4) The Purchaser acknowledges reading and accepting document which contains other miscellaneous disclaimers.

Signature: 

Date: MAY 13/21

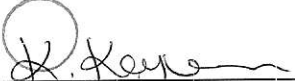
Signature: 

Date: May 13/21



BRENTWOOD 2 2810 SQ.FT.



FRONT ELEVATION 1



FRONT ELEVATION 2



FRONT ELEVATION 3

- soft close
- Two colour (island)
- delete hardware holes
- valence
- contemporary hood fan
- fan insert
- up. 5 kitchen

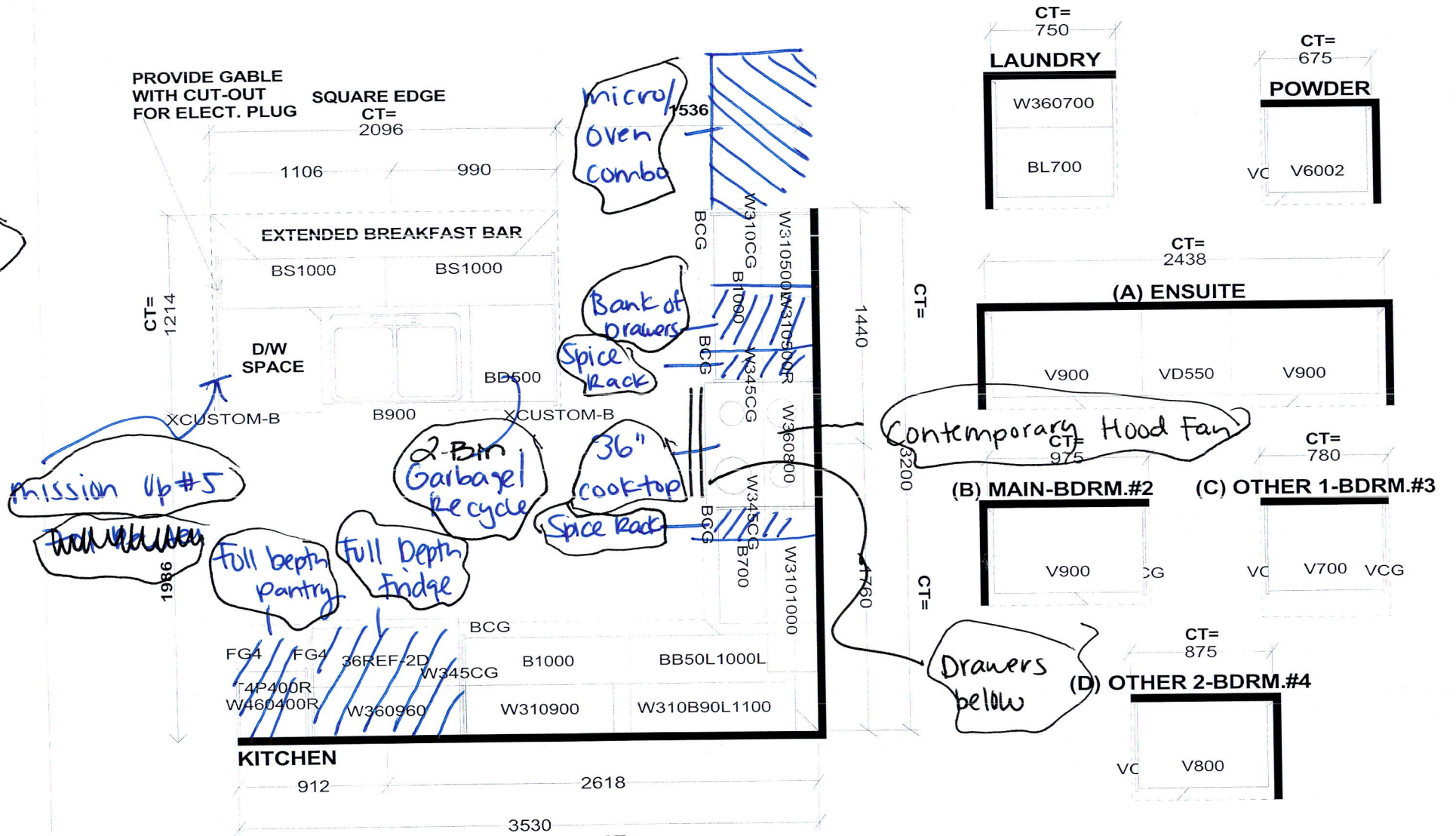

Selba Industries

W WIDTH	W HGHT	W CNT	FL HGHT	DWY H	ST CENT	2X4	VENT BOX COVER
STANDARD FEATURES:							
9' CEILINGS WITH DROP CEILING BOX							
1040MM HIGH UPPERS							
DISHWASHER SPACE							
DUMMY DOORS ON EXPOSED BACKS							
LAMINATE COUNTERTOPS							
This drawing is the intellectual property of SELBA INDUSTRIES INC. and is an original design which must not be released or copied unless applicable fee has been paid or job order placed.				GHA B C F E D		JOB NUMBER: BUILDER: GREENPARK HOMES SITE NAME: TRINAR HALL MODEL: BRENTWOOD 2X EL 1,2,3 LOT #: DESIGNER: KS DATE: APR 13 18	

# Quick guide

## LOCATION OF THE COOKTOP BURNERS AND WI-FI, BLUETOOTH BUTTONS

The control knobs operate the cooktop burners on the cooktop.

36"

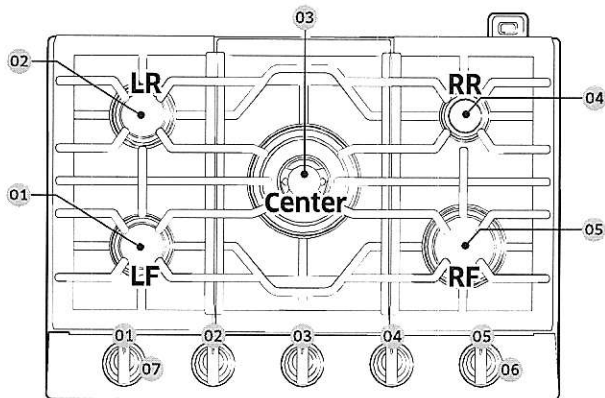

30" Model NA30N6555T\* / NA30N7755T\*

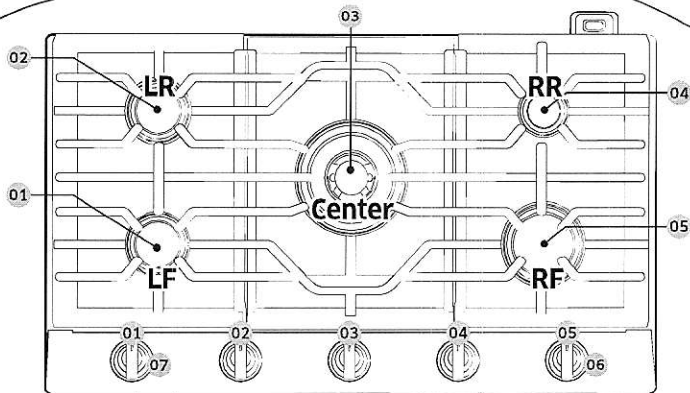

36" Model NA36N6555T\* / NA36N7755T\*

01/02 . Serni Rapid burner (Left Front/Left Rear)	General purpose simmering
03. Dual power burner (Center)	Large pots/Pans Quick boiling simmering
04. Simmer burner (Right Rear)	Simmering
05. Rapid burner (Right Front)	General purpose
06. Wi-Fi button (below knob)	
07. Bluetooth button (below knob) only NA30N7755T*/NA36N7755T*	



# Quick guide

## DIMENSIONS AND INSTALLATION INFORMATION

### Overall cooktop dimensions

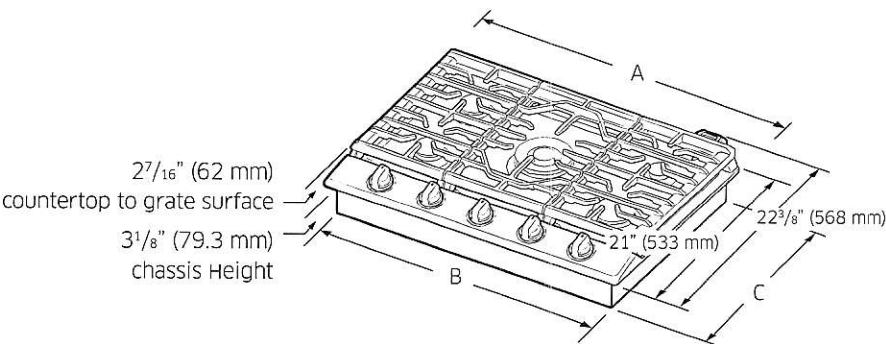

Model	A	B	C
NA30N6555T* NA30N7755T*	30" (762 mm)	$28\frac{1}{8}$ " (715 mm)	$19\frac{3}{8}$ " (492.1 mm)
NA36N6555T* NA36N7755T*	36" (914.4 mm)	$33\frac{11}{16}$ " (855 mm)	$18\frac{7}{8}$ " (479 mm)

### Cutout dimensions of countertop

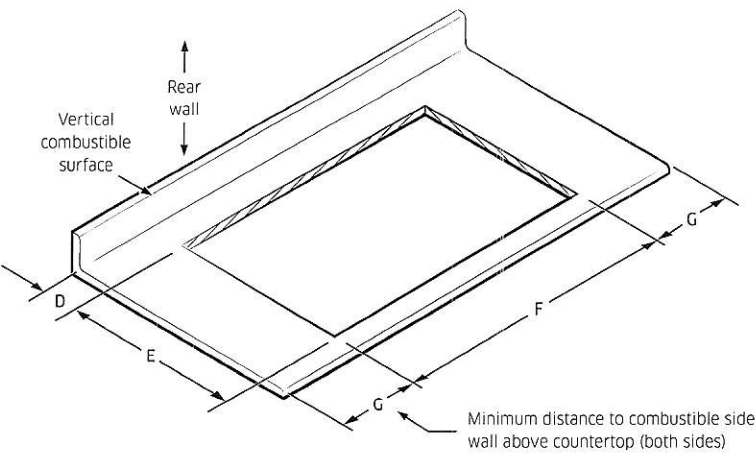

Model	(D) Min.	(E) Min.	(F) Min.	(G) Min.
NA30N6555T* NA30N7755T*	$2\frac{7}{8}$ " (73 mm)	$19\frac{5}{8}$ " (498.5 mm)	$28\frac{1}{2}$ " (723.9 mm)	12" (304.8 mm)
NA36N6555T* NA36N7755T*	$3\frac{3}{8}$ " (85.7 mm)	$19\frac{1}{8}$ " (485.8 mm)	$33\frac{7}{8}$ " (860.4mm)	12" (304.8 mm)

Location requirements and electrical requirements

- To ensure cooktop base clearance, cabinet side walls need to be wider than cutout.
- If cabinet has a drawer, allow 3<sup>9</sup>/<sub>16</sub>" minimum clearance between countertop and top of drawer.
- A 120-Volt, 60-Hz, AC, approved electrical service with 20-amp circuit breaker or time-delay fuse is required.

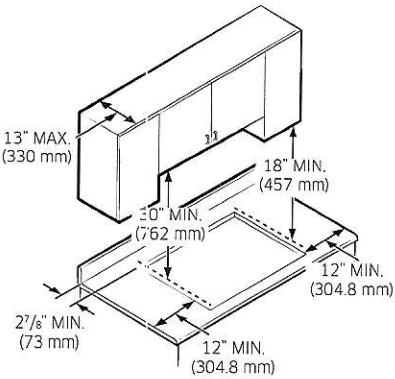

30" - NA30N6555T\* / NA30N7755T\*

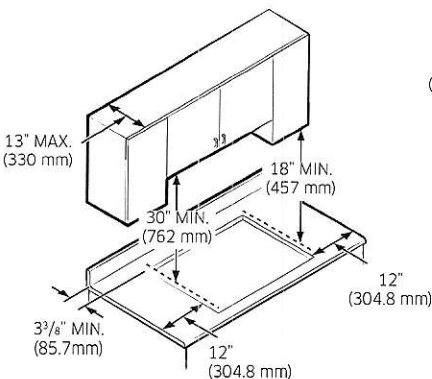

36" - NA36N6555T\* / NA36N7755T\*

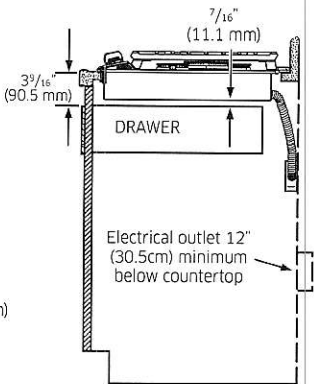

Installation over built-in oven

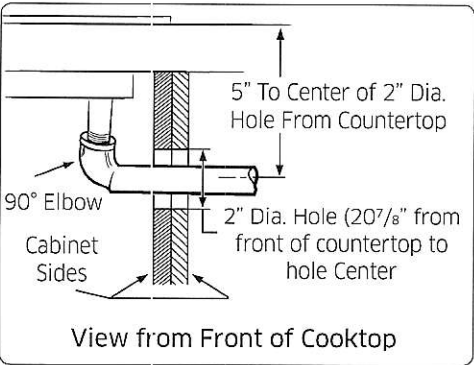

See built-in oven installation for complete installation instructions.

Utility locations and dimensions

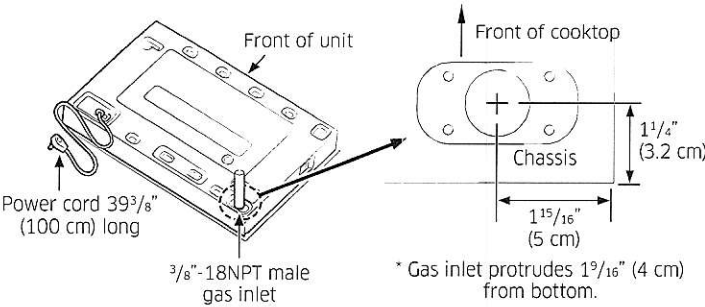



Location requirements

**IMPORTANT:** Observe all governing codes and ordinances.

- Cabinet opening dimensions that are shown must be used. Given dimensions provide minimum clearance with oven.
- Recessed installation area must provide complete enclosure around the recessed portion of the oven.
- Grounded electrical supply is required. See “Electrical connection” section.
- Electrical supply junction box should be located 3” (7.6 cm) maximum below the support surface when the oven is installed in a wall cabinet. A 1” (2.5 cm) minimum diameter hole should have been drilled in the right rear or left rear corner of the support surface to pass the appliance cable through to the junction box.

**NOTE**

For under counter installation, it is recommended that the junction box be located in the adjacent right or left cabinet. If you are installing the junction box on rear wall behind oven, it is recommended that the junction box be recessed and located in the upper Right of the cabinet.

- Oven support surface must be solid, level and flush with bottom of cabinet cutout.
- Floor must be able to support a Combi. oven weight of 287 lb (130 kg).

**IMPORTANT:** To avoid damage to your cabinets, check with your builder or cabinet supplier to make sure that the materials used will not discolor, delaminate or sustain other damage. This oven has been designed in accordance with the requirements of UL and CSA International and complies with the maximum allowable wood cabinet temperatures of 194 °F (90 °C).

Product dimensions - Combi. ovens

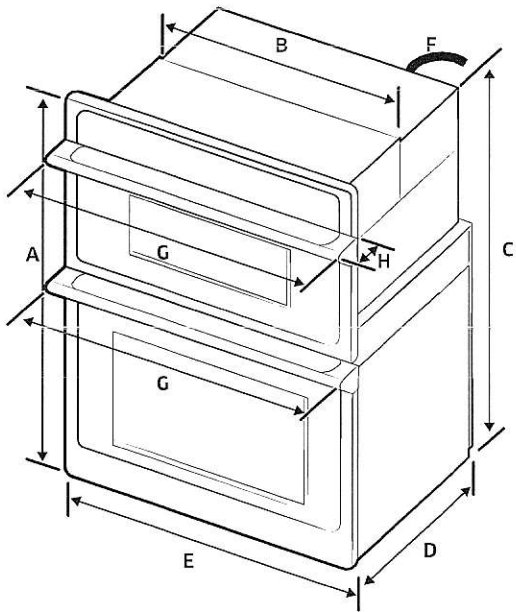

DIMENSION		
A	43 <sup>1</sup> / <sub>4</sub> " (109.9 cm)	Overall height
B	28 <sup>1</sup> / <sub>2</sub> " (72.4 cm)	Recessed width
C	42" (106.5 cm)	Recessed height
D	23 <sup>1</sup> / <sub>8</sub> " (58.7 cm)	Recessed depth
E	29 <sup>3</sup> / <sub>4</sub> " (75.6 cm)	Door Width
F	67" (170 cm)	Conduit length
G	29 <sup>7</sup> / <sub>8</sub> " (75.9 cm)	Overall width (Handle width)
H	2 <sup>9</sup> / <sub>16</sub> " (6.5 cm)	Handle Depth



# Preparation

## Cabinet dimensions - Combi. ovens

### Combi Ovens Installed in Cabinet

- 01 Junction Box
- 02 Allow a minimum of 22" for clearance to adjacent corners, drawers, walls, etc. when door is open

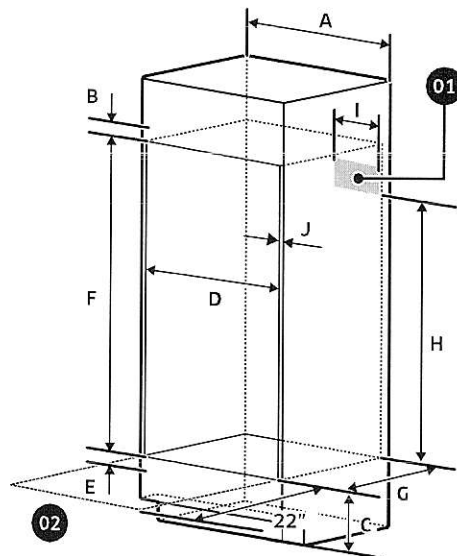

Cabinet	DIMENSION
A	30" (76.2 cm)
B	Min. 1 <sup>3</sup> / <sub>16</sub> " (3.0 cm)
C	12" (30.5 cm)
D	Min. 28 <sup>1</sup> / <sub>2</sub> " / Max. 28 <sup>5</sup> / <sub>8</sub> " (Min. 72.4 cm / Max. 72.7 cm)
E	Min. 1" / Max. 1 <sup>1</sup> / <sub>4</sub> " (Min. 2.5 cm / Max. 3.2 cm)
F	42 <sup>1</sup> / <sub>4</sub> " (107.2 cm)

Cabinet	DIMENSION
G	Min. 23 <sup>1</sup> / <sub>2</sub> " (Min. 59.7 cm)
H	Min 30 <sup>1</sup> / <sub>2</sub> " (Min 755 mm)
I	Max. 9 <sup>1</sup> / <sub>2</sub> " (Max. 24.1 cm) - Junction Box
J	Min. <sup>11</sup> / <sub>16</sub> " (1.75 cm) - Wooden cabinet thickness

If codes permit and a separate ground wire is used, it is recommended that a qualified electrical installer determine that the ground path and the wire gauge are in accordance with local codes. Check with a qualified electrical installer if you are not sure the oven is properly grounded. This oven must be connected to a grounded-metal permanent wiring system. Be sure that the electrical connection and wire size are adequate and in conformance with the National Electrical Code, ANSI/NFPA 70-latest edition or CSA Standards C22. 1-94, Canadian Electrical Code, Part 1 and C22.2 No. 0-M91-latest edition, and all local codes and ordinances. A copy of the above code standards can be obtained from:

National Fire Protection Association  
1 Batterymarch Park  
Quincy, MA 02169-7471

CSA International  
8501 East Pleasant Valley Road  
Cleveland, OH 44131-5575

Electrical Connection

To properly install your oven, you must determine the type of electrical connection you will be using and follow the instructions provided in this manual.

- Oven must be connected to the proper electrical voltage and frequency as specified on the model/serial/rating plate. The model/serial/rating plate is located below the control panel on combi ovens. See the following illustrations.

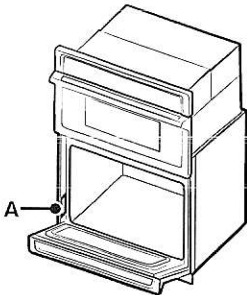

Combi. oven  
A. Model/serial/rating plate

- A circuit breaker is recommended.
- Use the chart below to determine the minimum recommended dedicated circuit protection.

KW Rating (240 V)	KW Rating (208 V)	Recommended Circuit Size (Dedicated)
≤4.8 KW	≤4.1 KW	20 Amp
4.9 KW - 7.5 KW	4.3 KW - 6.2 KW	30 Amp
7.3 KW - 9.6 KW	6.3 KW - 8.3 KW	40 Amp
9.7 KW - 12.0 KW	8.4 KW - 10.4 KW	50 Amp

- Connect directly to the circuit breaker box (or fused disconnect) through flexible, armored or nonmetallic sheathed, copper cable (with grounding wire). See “Electrical Connection” section.

- Flexible conduit from the oven should be connected directly to the junction box.
- Fuse both sides of the line.
- Do not cut the conduit. The length of conduit provided is for serviceability of the oven.
- A UL listed or CSA approved conduit connector must be provided.
- If the house has aluminum wiring, follow the procedure below:
  - Connect a section of solid copper wire to the ends of the flexible conduit leads.
  - Connect the aluminum wiring to the added section of copper wire using special connectors and/or tools designed and UL listed for joining copper to aluminum.Follow the electrical connector manufacturer’s recommended procedure. Aluminum/copper connection must conform with local codes and industry accepted wiring practices.

For power requirements for models NQ70M6650D, and NQ70M7770D refer to the following table.

Model	240 VAC	208 VAC
	kW	kW
NQ70M6650D	8.2	6.2
NQ70M7770D	9.5	7.2



[illegible]



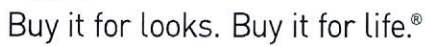

### DESCRIPTION

- ## OPERATION

- FLOW**

- ## STANDARDS

- ## WARRANTY

- Visit [www.moen.com/support](http://www.moen.com/support) for complete details and limitations

**Models:** S176 series



**WaterSense**  
Meets EPA Criteria  
Certified by IAPMO R&T

**GREEN**  
UPC®

**Models: S176EP series**

[illegible]

## (DO NOT SCALE)



LOT 15  
TRINAR HALL HOMES INC

BRENTWOOD 2  
ELEV. 2

REVISION:

1. MASTER ENSUITE - REMOVE WALL OF WC AND ADD GLASS WALL TO SHOWER AS PER SKETCH

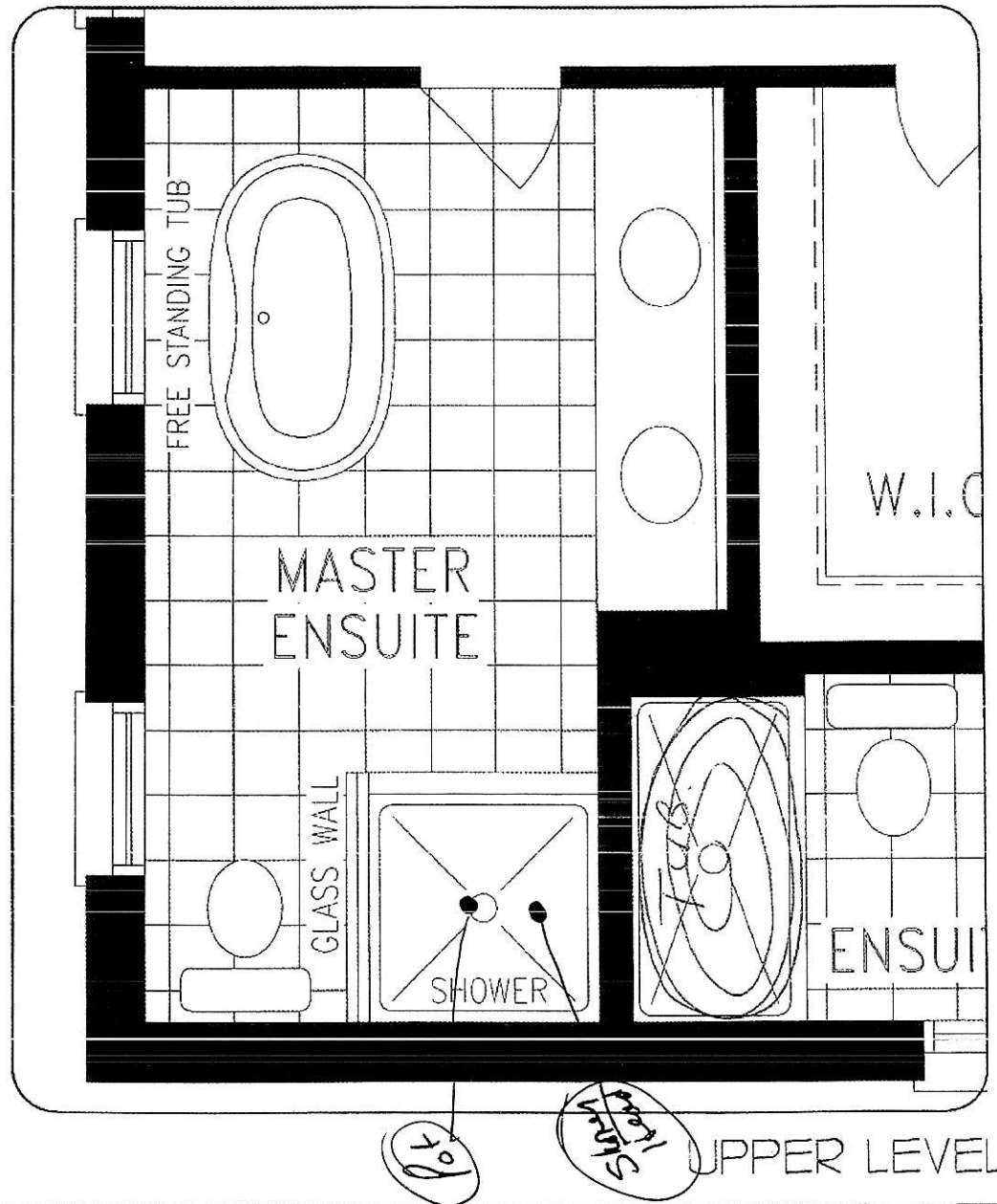

DISCLAIMERS: SKETCH NOT TO SCALE. DIMENSIONS, SPECIFICATIONS AND ARCHITECTURAL DETAILS SUBJECT TO MODIFICATION BY THE VENDOR. SKETCH IS ONLY FOR THE PURPOSE OF ILLUSTRATING REVISIONS REQUESTED BY THE PURCHASER AND ALL REVISIONS ARE SUBJECT TO VENDOR'S FINAL APPROVAL. ONLY REVISIONS ACCEPTED IN WRITING BY THE PURCHASER AND VENDOR ON A PURCHASER'S EXTRA SHEET WILL BE INCORPORATED INTO THE PLANS FILED WITH THE MUNICIPALITY. E. & O.E.

REGION DESIGN INC.

SCALE N.T.S.

BY PAGE No.

VG 1 OF 1

**Greenpark.**

*Rey Kuyumci Kristina Heydari*

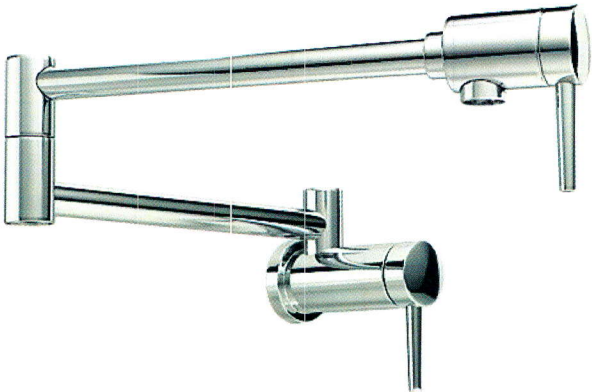

DELTA

# Contemporary Wall Mount Pot Filler

MODEL#: 1165LF

- 4 gallons per minute for quick fills
- Two swing joints
- Backed by Delta Faucet's Lifetime Limited Warranty

Finish: **Chrome**

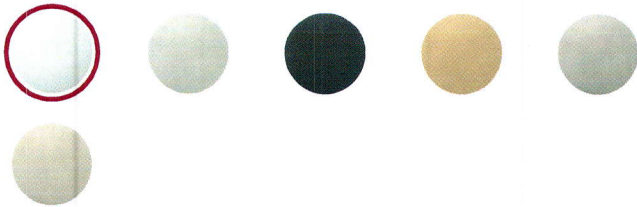



Sink Specifications

Colour	SKU
brushed finish	401518

Design and planning tips

- Min cabinet size: 36 in ( 915 mm )
- Bowl Depth: 9 in ( 230.0 mm )

Specifications:  
Sink template, Mounting clips, Installation instructions, 3 ½" (90 mm) stainless steel strainers

Depending on cabinet construction, a different cabinet size may be required. Consult the cabinet manufacturer.

Optional Accessories

Elevated Grid	406346
CapFlow Strainer Cover	517666
Workstation	406344
Sink Grid	406347
Ash Cutting Board	406345

QUATRUS R15 U SUPER SINGLE

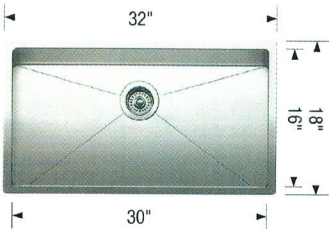

Warranty

Limited lifetime warranty on all sinks and faucets. One-year warranty on all accessories and soap dispensers.

Code/Standards Compliance

BLANCO sinks and faucets are third-party tested and certified to CSA, cUPC, ANSI/ASME, IAPMO and NSF standards and listed by applicable certification bodies. For more information on individual product listings, contact our office or listing organization.



Need support? Learn more by watching our sink & faucet How-to videos:  
<https://www.blanco.com/ca-en/support/how-to-videos/how-to-videos-for-sinks/>



BLANCO Canada Inc  
100 Corporation Drive  
Brampton ON L6S 6B5

Tel & Fax  
Tel: 905-494-2400 Toll free: 1-877-425-2626  
Fax: 905-494-2425 Toll free: 1-877-825-2626

While BLANCO strives to provide accurate information, all images and dimensions in this document are intended for reference only and are subject to change at any time without notice. This document is not intended for use as an installation guide. For technical installation details, refer to installation instructions provided with the product. BLANCO assumes no responsibility for the use of superseded or voided specifications.