

CONSTRUCTION SUMMARY

Mountainview Heights 3 (G) - Russell Gardens Building Ltd.

PURCHASERS: Pinaben Alpeshkumar PATEL and Alpeshkumar Maheshbhai PATEL

TEL:

RECEIVED
APR 14 2021

| | | | | |
|------------------------|-------------------------|---------------------------------------|--|--|
| LOT / PHASE 302 / 3 | REG. PLAN # 62M-1266 | HOUSE TYPE Valleycreek Four Elev 3 | | |
|------------------------|-------------------------|---------------------------------------|--|--|

CABINETRY

| | |
|---|--|
| 1 - KITCHEN - DELETE CABINETS ABOVE STOVE - VENDOR WILL SUPPLY 6 INCH VENT AS PER CONSTRUCTION SPECIFICATIONS AND VENT MAY NOT BE IN THE APPROPRIATE LOCATION FOR INSTALLATION OF PURCHASER SUPPLIED VENT - PURCHASER TO SUPPLY OWN FAN AFTER CLOSING 06Apr21 Note: TEMPORARY HOOD FAN MAY BE PROVIDED | |
|---|--|

CERAMIC TILE

| | |
|--|--|
| 1 - DELETE ALL CERAMIC BATHROOM ACCESSORIES - DELETE TOWEL BAR, PAPER HOLDER & SOAP DISH THROUGHOUT 06Apr21 Note: | |
| 1 - TILE - UPGRADE 4 FLOOR TILE - - SIDE HALL 06Apr21 Note: | |
| 1 - TILE - UPGRADE 4 FLOOR TILE - - POWDER ROOM 06Apr21 Note: | |
| 1 - TILE - UPGRADE 4 FLOOR TILE - - KITCHEN 06Apr21 Note: | |
| 1 - TILE - UPGRADE 4 FLOOR TILE - - FOYER 06Apr21 Note: | |

CONSTRUCTION

| | |
|--|--|
| 1 - DELETE BULK HEADS IN KITCHEN IF CONSTRUCTION PERMITS 06Apr21 Note: | |
| 1 - KITCHEN - RELOCATE SINK & DISHWASHER TO STOVE WALL AS PER SKETCH 28Jul20 Note: | |
| 3 - ENLARGE BASEMENT WINDOWS (MAY REQUIRE WINDOW WELLS) - WINDOW IS 30 INCHES X 24 INCHES 28Jul20 Note: IF CONSTRUCTION PERMITS | |

ELECTRICAL

| | |
|---|--|
| 1 - ***DELETE - PLUG - ELECTRICAL PLUG - INSTALLED 5' FROM FLOOR - MASTER BEDROOM*** 08Apr21 Note: | |
| 1 - PLUG - ELECTRICAL PLUG INSTALLED 5' FROM FLOOR - MASTER BEDROOM 06Apr21 Note: | |
| 1 - PLUG - ELECTRICAL PLUG WITH GFI AND SWITCH - FOR FESTIVE LIGHTING 06Apr21 Note: | |
| 1 - PLUG - ELECTRICAL PLUG - TO BE INSTALLED OVER FIREPLACE 06Apr21 Note: | |
| 1 - ABOVE KITCHEN ISLAND - ADD LIGHT AND SWITCH - NO FIXTURE INCLUDED 06Apr21 Note: | |
| 1 - LIGHT AND SWITCH - NO FIXTURE INCLUDED - LIVING ROOM 06Apr21 Note: | |
| 1 - 200 AMP ELECTRICAL SERVICE 28Jul20 Note: | |

| | | | | |
|--|-------------|-------------------------|--|--|
| <div>CONSTRUCTION SUMMARY</div> <div>Mountainview Heights 3 (G) - Russell Gardens Building Ltd.</div> <div>PURCHASERS: Pinaben Alpeshkumar PATEL and Alpeshkumar Maheshbhai PATEL<div>TEL:</div></div> | | | | |
| LOT / PHASE | REG. PLAN # | HOUSE TYPE | | |
| 302 / 3 | 62M-1266 | Valleycreek Four Elev 3 | | |

FIREPLACE AND ACCESSORIES

1 - GAS LINE ROUGH-IN FOR STOVE (INCLUDES ELECTRICAL OUTLET) - FIRST FLOOR

06Apr21Note:

HARDWOOD FLOORING

1 - HARDWOOD - GROUP B SERIES 5 INCH - IN LIEU OF 2 1/4 INCH NATURAL RED OAK - - MAIN HALL

06Apr21Note:

1 - HARDWOOD - GROUP B SERIES 5 INCH - IN LIEU OF 2 1/4 INCH NATURAL RED OAK - - LIVING AND DINING ROOM

06Apr21Note:

1 - HARDWOOD - GROUP B SERIES 5 INCH - IN LIEU OF 2 1/4 INCH NATURAL RED OAK - - LIBRARY/DEN

06Apr21Note:

1 - HARDWOOD - GROUP B SERIES 5 INCH - IN LIEU OF 2 1/4 INCH NATURAL RED OAK - - FAMILY ROOM

06Apr21Note:

PLUMBING

2 - SINK - DROP-IN SINK - CONTRAC LOLAND - 4" CENTER #4440BST - ENSUITE 2/3 BATHROOM & ENSUITE 4 BATHROOM

08Apr21Note:

1 - WATER LINE FOR FRIDGE - ROUGH-IN ONLY

08Apr21Note:

3 - SINK - DROP-IN SINK - CONTRAC LOLAND - 4" CENTER #4440BST - POWDER ROOM & MASTER ENSUITE BATHROOM

06Apr21Note:

3 - TOE TESTER - ADD TOE TESTER TO SHOWER - ALL SHOWERS

28Jul20Note:

PROMOTIONAL

1 - LESS BALANCE OF CREDIT FROM PURCHASER EXTRA SHEET IN OFFER

06Apr21Note:

1 - PARTIAL REDEMPTION OF PROMOTIONAL PACKAGE \$3,270.00 BALANCE (\$8,730.00) FORWARD TO BE USED AT A LATER DATE. ORIGINAL PROMOTIONAL PACKAGE OF \$12,000.00 AS PER SCHEDULE PE DATED 07/06/2020.

28Jul20Note:

STAIRS AND RAILINGS

1 - STAINED STAIRS – STANDARD STAIRCASE - PRICE IS PER SET

06Apr21Note:

1 - STAIRCASE - V GROOVE HANDRAIL

06Apr21Note:

EXTRAS AS PER OFFER

The Vendor agrees that notwithstanding any other term or provision in this Agreement included in the Purchase Price and in addition to those items detailed in Schedule GP to the Agreement of Purchase and Sale, the Purchaser is entitled to a credit of Two

WorksheetNote:

Purchasers:Pinaben Alpeshkumar PATEL & Alpeshkumar Ma

Property: 302

Telephone Res. / Bus: /

Project: Russell Gardens Building Ltd.

Decor Advisor: Candace Forza

Model and Elevation: Valleycreek Four Elev 3

Lock Date: 6-Apr-21

6-Apr-21

Plan #: 62M-1266

Layout Changes: ☒ Yes ☐ No

Sketch Attached: ☒ Yes ☐ No

Exterior Colour Scheme:

1. Cabinetry

| | Style and Colour | Hardware |
|----------------------------|----------------------------|----------|
| Kitchen / Breakfast | DORAL W-500 | 447SA |
| Laundry Room | ELISSE | Standard |
| Powder Room | MONACO 823 DRIFTWOOD | 431SA |
| Master Ensuite Bathroom | DORAL H3087 HACIENDA WHITE | 431SA |
| Ensuite Bath - Bedroom 2/3 | DORAL W-500 | 447SA |
| Ensuite Bath - Bedroom 4 | DORAL H3081 HACIENDA BLACK | 447SA |
| | N/A | N/A |
| | N/A | N/A |
| | N/A | N/A |

Appliances:

Built In Appliances ☐ Yes ☒ No

Slide In Stove ☐ Yes ☒ No

Dishwasher Cabinet

☐ Closed ☒ Open

41" Upper Cabinets ☒ Yes ☐ No

Please NOTE: Standard Cabinet Height is 30"

Stove Opening

NOTE: If not specified, opening will be set to builder's standard opening of approximately 30" width

Fridge Opening

NOTE: If not specified, opening will be set to builder's standard opening of approximately 37" width x 74" height

** Refer to Construction Summary

2. Counters

| | Counter | Edge |
|----------------------------|---------------------------------|------|
| Kitchen / Breakfast | LAMINATE-WHITE CARRARA 4924-38 | |
| Laundry Room | N/A | |
| Powder Room | LAMINATE-PALOMA POLAR 6698-46 | |
| Master Ensuite Bathroom | LAMINATE-PALOMA POLAR 6698-46 | |
| Ensuite Bath - Bedroom 2/3 | LAMINATE-CARRARA BIANCO 6696-46 | |
| Ensuite Bath - Bedroom 4 | LAMINATE-WHITE CARRARA 4924-38 | |
| | N/A | |
| | N/A | |
| | N/A | |

** Refer to Construction Summary

Initials: 

Plan #: 62M-1266

At a 45 Threshold-If App.

| | At a 45 | Threshold-If App. |
|----------------------------|---|------------------------------|
| Entrance Vestibule | TILE-CALACATTA POLISHED (CA6083P)-24X24 | metal strip where applicable |
| Main Hall | STRIP | |
| Kitchen / Breakfast | TILE-CALACATTA POLISHED (CA6083P)-24X24 | |
| Laundry Room | TILE-NEO GREY-13X13 | |
| Powder Room | TILE-CALACATTA POLISHED (CA6083P)-24X24 | |
| Master Ensuite Bathroom | TILE-ESSENZE GRIGIO-13X13 | |
| Ensuite Bath - Bedroom 2/3 | TILE-NEO GREY-13X13 | |
| Ensuite Bath - Bedroom 4 | TILE-RAINBOW WHITE-13X13 | |
| SIDE / GARAGE ENTRY | TILE-CALACATTA POLISHED (CA6083P)-24X24 | |
| | N/A | |
| | N/A | |

**** Refer to Construction Summary**

Master Ensuite Bathroom

| Master Ensuite Bathroom | Selection | Describe |
|----------------------------|---------------------------------|----------|
| Tub Deck Wall | N/A | |
| Tub Deck | N/A | |
| Tub Deck Skirt | N/A | |
| Shower Stall | TILE-LUC BLANC GROENLANDIA-8X16 | |
| Bathtub Enclosure Walls | N/A | |
| Ensuite Bath - Bedroom 2/3 | TILE-LUC BLANC GROENLANDIA-8X16 | |
| Ensuite Bath - Bedroom 4 | TILE-LUC AFRICA-8X16 | |
| SIDE / GARAGE ENTRY | N/A | |
| | N/A | |
| | N/A | |
| Kitchen Backsplash | N/A | |

**** Refer to Construction Summary - STANDARD GROUT THROUGHOUT UNLESS SPECIFIED**

All Bathrooms

| White |
|-------|
| N/A |
| N/A |
| N/A |
| N/A |
| N/A |

Whirlpool

N/A ☐ Yes ☒ No

Dishwasher Rough-In ☒ Yes ☐ No

Waterline for Fridge ☒ Yes ☐ No

**** Refer to Construction Summary**

Interior Doors

| | |
|----------------------------|------------------------------------|
| Interior Trim | As Per Construction Specifications |
| Door Handles | As Per Construction Specifications |
| Exterior Front Door Handle | As Per Construction Specifications |

**** Refer to Construction Summary**

Initials:

Purchasers:

Pinaben Alpeshkumar PATEL & Alpeshkumar Ma

Property: 302

Telephone Res. / Bus:

/

Project: Russell Gardens Building Ltd.

Decor Advisor:

Candace Forza

Model and Elevation: Valleycreek Four Elev 3

Lock Date:

6-Apr-21

6-Apr-21

Plan #: 62M-1266

7. Other Flooring

| | |
|------------------------------|---|
| Main Hall | STRIP-MIRAGE-TRUBALANCE-IMAGINE-CHARACTER-RED OAK-DURAMATT-DRIFTWOOD-5" |
| Living Room | STRIP-MIRAGE-TRUBALANCE-IMAGINE-CHARACTER-RED OAK-DURAMATT-DRIFTWOOD-5" |
| Dining Room | STRIP-MIRAGE-TRUBALANCE-IMAGINE-CHARACTER-RED OAK-DURAMATT-DRIFTWOOD-5" |
| Family Room | STRIP-MIRAGE-TRUBALANCE-IMAGINE-CHARACTER-RED OAK-DURAMATT-DRIFTWOOD-5" |
| Den / Library / Study | STRIP-MIRAGE-TRUBALANCE-IMAGINE-CHARACTER-RED OAK-DURAMATT-DRIFTWOOD-5" |
| Basement Landing(If Applies) | N/A |
| Lower Landing (If Applies) | STRIP-MIRAGE-TRUBALANCE-IMAGINE-CHARACTER-RED OAK-DURAMATT-DRIFTWOOD-5" |
| Upper Landing | STRIP-MIRAGE-TRUBALANCE-IMAGINE-CHARACTER-RED OAK-DURAMATT-DRIFTWOOD-5" |
| Upper Hall | LAMINATE-LEXINGTON-ROCHEFORT OAK-TL-LW1317 |
| Master Bedroom | LAMINATE-LEXINGTON-ROCHEFORT OAK-TL-LW1317 |
| Bedroom #2 | LAMINATE-LEXINGTON-ROCHEFORT OAK-TL-LW1317 |
| Bedroom #3 | LAMINATE-LEXINGTON-ROCHEFORT OAK-TL-LW1317 |
| Bedroom #4 | LAMINATE-LEXINGTON-ROCHEFORT OAK-TL-LW1317 |
| Bedroom #5 | N/A |
| | N/A |
| | N/A |
| | N/A |
| Underpad | TypeArea |
| | N/AN/A |

** Refer to Construction Summary

8. Railings and Pickets

| | | | |
|---------------------------------------|------------------------------------|---|--------------------------|
| Railing Type | V-GROOVE | Colour | MIRAGE DRIFTWOOD RED OAK |
| Picket Type | AS PER CONSTRUCTION SPECIFICATIONS | Colour | MIRAGE DRIFTWOOD RED OAK |
| Stringer / Riser | AS PER CONSTRUCTION SPECIFICATIO | Colour | MIRAGE DRIFTWOOD RED OAK |
| Treads | AS PER CONSTRUCTION SPECIFICATIO | Colour | MIRAGE DRIFTWOOD RED OAK |
| Red Oak Stairs with Semi Gloss Finish | | <input checked="" type="radio"/> Yes <input type="radio"/> No | |

** Refer to Construction Summary THE STAIN COLOURS OR FINISH AVAILABLE ON RISERS, TREADS, PICKETS AND RAILS (STAIRCASES), WILL NOT BE AN EXACT MATCH TO PREFINISHED HARDWOOD OR LAMINATE FLOORS.

9. Wall Paint Flat Finish

| | | | |
|-----------------------------|---|----------------------------|--------------|
| Main & Upper Hall | 22 WARM GREY | Master Bedroom | 22 WARM GREY |
| Living Room | 22 WARM GREY | Bedroom #2 | 22 WARM GREY |
| Dining Room | 22 WARM GREY | Bedroom #3 | 22 WARM GREY |
| Kitchen / Breakfast | 22 WARM GREY | Bedroom #4 | 22 WARM GREY |
| Family Room | 22 WARM GREY | Bedroom #5 | N/A |
| Powder Room | 22 WARM GREY | Master Ensuite | 22 WARM GREY |
| Laundry Room | 22 WARM GREY | Ensuite Bath - Bedroom 2/3 | 22 WARM GREY |
| Den/Library | 22 WARM GREY | Ensuite Bath - Bedroom 4 | 22 WARM GREY |
| Trim Paint-Semi Gloss | BIRCH WHITE | | N/A |
| | N/A | | N/A |
| | N/A | | N/A |
| Smooth Ceilings First Floor | <input type="radio"/> Yes <input checked="" type="radio"/> No | | |

** Refer to Construction Summary

Initials:  

Purchasers:Pinaben Alpeshkumar PATEL & Alpeshkumar Ma

Property: 302

Telephone Res. / Bus: /

Project: Russell Gardens Building Ltd.

Decor Advisor: Candace Forza

Model and Elevation: Valleycreek Four Elev 3

Lock Date: 6-Apr-21

6-Apr-21

Plan #: 62M-1266

10. Plaster Mouldings and Medallions

| | | | | | |
|--------------------|-----|-----|-------------------|-----|-----|
| Entrance Vestibule | N/A | N/A | Kitchen/Breakfast | N/A | N/A |
| Main Hall | N/A | N/A | Den/Library | N/A | N/A |
| Living Room | N/A | N/A | Lower Landing | N/A | N/A |
| Dining Room | N/A | N/A | | N/A | N/A |
| Family Room | N/A | N/A | | N/A | N/A |

** Refer to Construction Summary

11. Fireplace

| Living Room | | | Family Room | | | Other Room - Specify | | |
|-----------------------|-----------------------|----------------------------------|------------------------------------|----------------------------------|-----------------------|-----------------------|-----------------------|----------------------------------|
| Purchased | As Per Plan | N/A | Purchased | As Per Plan | N/A | Purchased | As Per Plan | N/A |
| <input type="radio"/> | <input type="radio"/> | <input checked="" type="radio"/> | <input type="radio"/> | <input checked="" type="radio"/> | <input type="radio"/> | <input type="radio"/> | <input type="radio"/> | <input checked="" type="radio"/> |
| Fireplace Type | N/A | | FLAT ON WALL | | N/A | | N/A | |
| Mantle Type | N/A | | MANTLE M1-STANDARD | | N/A | | N/A | |
| Colour / Stain | N/A | | AS PER CONSTRUCTION SPECIFICATIONS | | N/A | | N/A | |
| Surround | N/A | | NERO | | N/A | | N/A | |
| Hearth | N/A | | NO | | N/A | | N/A | |

** Refer to Construction Summary

12. Heating and Air Conditioning

| | | | |
|----------------------|----|-------------------------|----|
| Air Conditioning | NO | Gas Provisions Stove | NO |
| Gas Provisions Dryer | NO | Gas Provisions Barbecue | NO |
| Comment | | | |

** Refer to Construction Summary

13. Electrical

| | | | | | |
|---------------------|---|---|---|---------------------------|-------------------------------------|
| Plugs and Switches | <input checked="" type="radio"/> White | DECOR | Above Kitchen Cabinet Light | <input type="radio"/> Yes | <input checked="" type="radio"/> No |
| Hood Fan | STANDARD WHITE TEMP. | | Below Kitchen Cabinet Light | <input type="radio"/> Yes | <input checked="" type="radio"/> No |
| Appliances | Built in Cooktop | Built in Oven | Gas Stove | Microwave | |
| | <input type="radio"/> Yes <input checked="" type="radio"/> No | <input type="radio"/> Yes <input checked="" type="radio"/> No | <input type="radio"/> Yes <input checked="" type="radio"/> No | <input type="radio"/> Yes | <input checked="" type="radio"/> No |
| Dishwasher Rough-in | Yes | | | | |

** Refer to Construction Summary

14. General Comments

** Refer to Construction Summary

Disclaimers and Notes

- Colours of all materials are as close as possible to builder's selection, but not necessarily identical due to variances in manufacturing.
- Any extras listed above are null and void unless accompanied by a separate invoice/amendment. Said invoice must be paid in full.
- The Purchaser agrees that this colour selection is final and that no changes will be permitted, unless required by the Vendor.
- The Purchaser acknowledges reading and accepting document which contains other miscellaneous disclaimers.

Signature: 

Date: 6-4-21

Signature: 

Date: 6-4-21

FOR THE WAY IT'S MADE.®

30" (72.6 cm) and 36" (91.4 cm) Wall-Mount Canopy Range Hood

PRODUCT MODEL NUMBERS

| | |
|----------|----------|
| KVWB600D | KVWB606D |
|----------|----------|

Electrical: A 120 volt, 60 Hz., AC only, 15-amp, fused electrical circuit is required.

VENTING METHODS

This canopy range hood is factory set for venting through the roof or through the wall.

A 6" (15.2 cm) round vent system is needed for installation (not included). The hood exhaust opening is 6" (15.2 cm) round.

NOTE: Flexible vent is not recommended. Flexible vent creates back pressure and air turbulence that greatly reduce performance.

Vent system can terminate either through the roof or wall. To vent through a wall, a 90° elbow is needed.

Rear Discharge
A 90° elbow may be installed immediately above the hood.

For Non-Vented (Recirculating) Installations

If it is not possible to vent cooking fumes and vapors to the outside, the hood can be used in the non-vented (recirculating) version, using a Recirculation Kit (which includes charcoal filters and a deflector). To order, see the "Assistance or Service" section.

Roof Venting

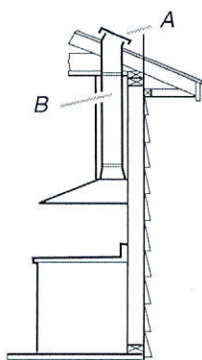

A. Roof cap
B. 6" (15.2 cm)
round vent

Wall Venting

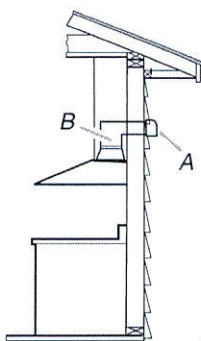

A. Wall cap
B. 6" (15.2 cm)
round vent

Non-Vented (Recirculating)

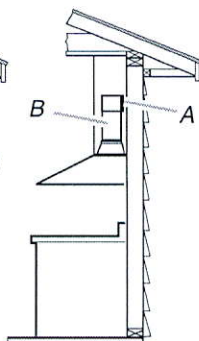



A. Diverter
B. 6" (15.2 cm)
round vent

Calculating Vent System Length

To calculate the length of the system you need, add the equivalent feet (meters) for each vent piece used in the system.

Vent System

| Vent Piece | | 6" (15.2 cm) Round |
|------------|-------------------|---|
| 45° elbow | 2.5 ft (0.8 m) |  |
| 90° elbow | 5.0 ft (1.5 m) |  |

Maximum equivalent vent length is 35 ft (10.7 m).

Example Vent System

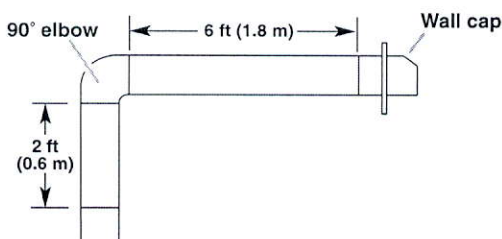

The following example falls within the maximum recommended vent length of 35 ft (10.7 m).

| | |
|-------------------------|--------------------------|
| 1 - 90° elbow | = 5.0 ft (1.5 m) |
| 1 - wall cap | = 0.0 ft (0.0 m) |
| 8 ft (2.4 m) straight | = 8.0 ft (2.4 m) |
| Length of system | = 13.0 ft (3.9 m) |

PRODUCT DIMENSIONS

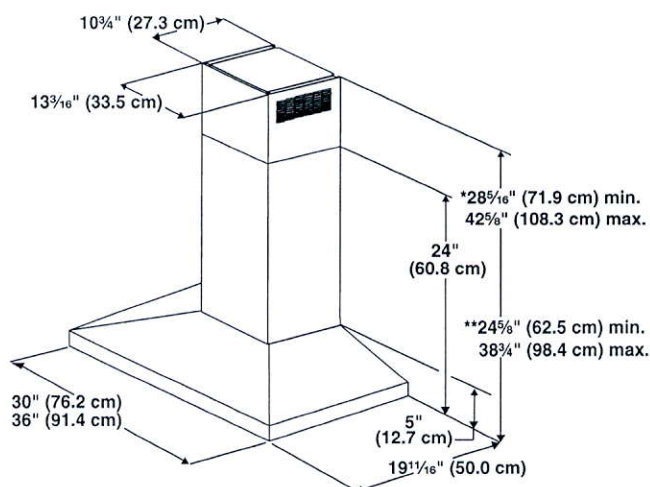

*For non-vented (recirculating) installations

**For vented installations

CABINET DIMENSIONS

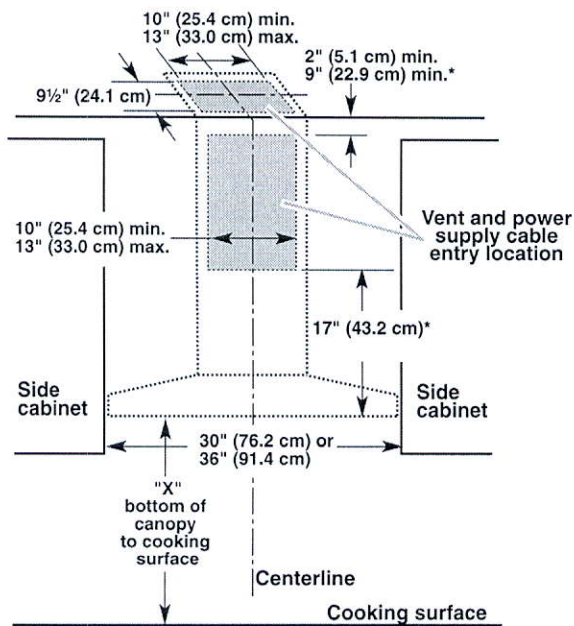

*For non-vented (recirculating) installations

IMPORTANT:

- Minimum distance "X": 24" (61.0 cm) from electric cooking surface.
- Minimum distance "X": 27" (68.6 cm) from gas cooking surfaces.
- Suggested maximum distance "X": 36" (91.4 cm)

The chimneys can be adjusted for different ceiling heights. See the following chart.

| Vented Installations | | |
|--|---------------------|---------------------|
| | Min. ceiling height | Max. ceiling height |
| Electric cooking surface | 7' 1" (2.16 m) | 9' 2" (2.79 m) |
| Gas cooking surface | 7' 4" (2.23 m) | 9' 2" (2.79 m) |
| Non-vented (recirculating) Installations | | |
| | Min. ceiling height | Max. ceiling height |
| Electric cooking surface | 7' 1" (2.16 m) | 9' 6" (2.9 m) |
| Gas cooking surface | 7' 4" (2.23 m) | 9' 6" (2.9 m) |

***NOTE:** The range hood chimneys are adjustable and designed to meet varying ceiling or soffit heights depending on the distance "X" between the bottom of the range hood and the cooking surface. For higher ceilings, a Chimney Extension Kit is available from your dealer or an authorized parts distributor. The chimney extension replaces the chimney shipped with the range hood. To order, see the "Assistance or Service" section.

LRG3601U
Thor Kitchen - 36 inch Professional
Gas Range

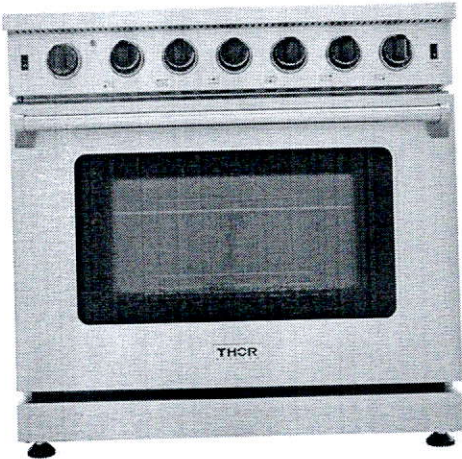

FEATURES

Black Porcelain Drip Pan for easy surface cleaning
Heavy Duty Continuous Cast Iron Cooking Grates
Black ABS Knobs
6.0 cu.ft Oven Capacity
White Flakes with Gray Background Porcelain Oven Interior
1 x Halogen Lights
Commercial Convection Fan
Three layers glass window
Storage drawer at bottom

BURNER PERFORMANCE

| | |
|-----------------------------------|-------------|
| Total Number of Range Top Burners | 6 Burners |
| Front Right (Single) | 18,000 BTU |
| Front Left (Single) | 18,000 BTU |
| Front Middle (Single) | 12,000 BTU |
| Rear Right (Single) | 9,000 BTU |
| Rear Left (Single) | 9,000 BTU |
| Rear Middle (Single) | 12,000 BTU |
| Broil burner | 10,000 BTU |
| U-shape burner (30" Oven) | 18, 500 BTU |

TECHNICAL DETAILS

| | |
|-------------------------|------------------------------|
| Fuel Type | Natural Gas / LP Convertible |
| Electrical Requirements | 120V |
| Circuit Breaker (A) | 15 or 20 A |
| Frequency (Hz) | 60 Hz |

ACCESSORIES (NOT INCLUDED)

Liquid propane Gas Conversion Kit

WARRANTY

2 Year Warranty On Parts and Labor

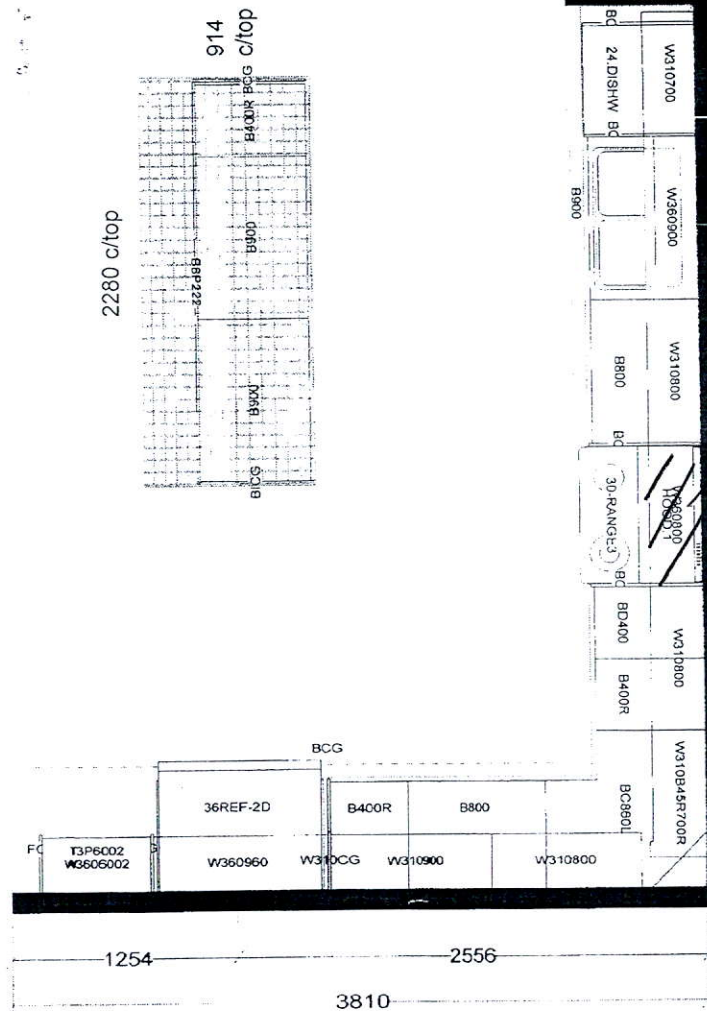
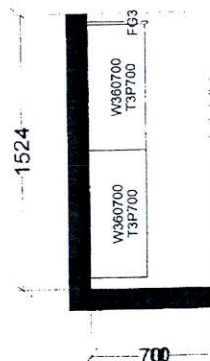

All dimensions size designations given are subject to verification on job site and adjustment to fit job conditions.



This drawing is the intellectual property of SELBA INDUSTRIES INC. and is an original design which must not be released or copied unless applicable fee has been paid or job order placed.

Designed: 7/18/2020
Printed: 7/21/2020

Valleycreek 4

All

Drawing #: 1

Scale: 1 : 40

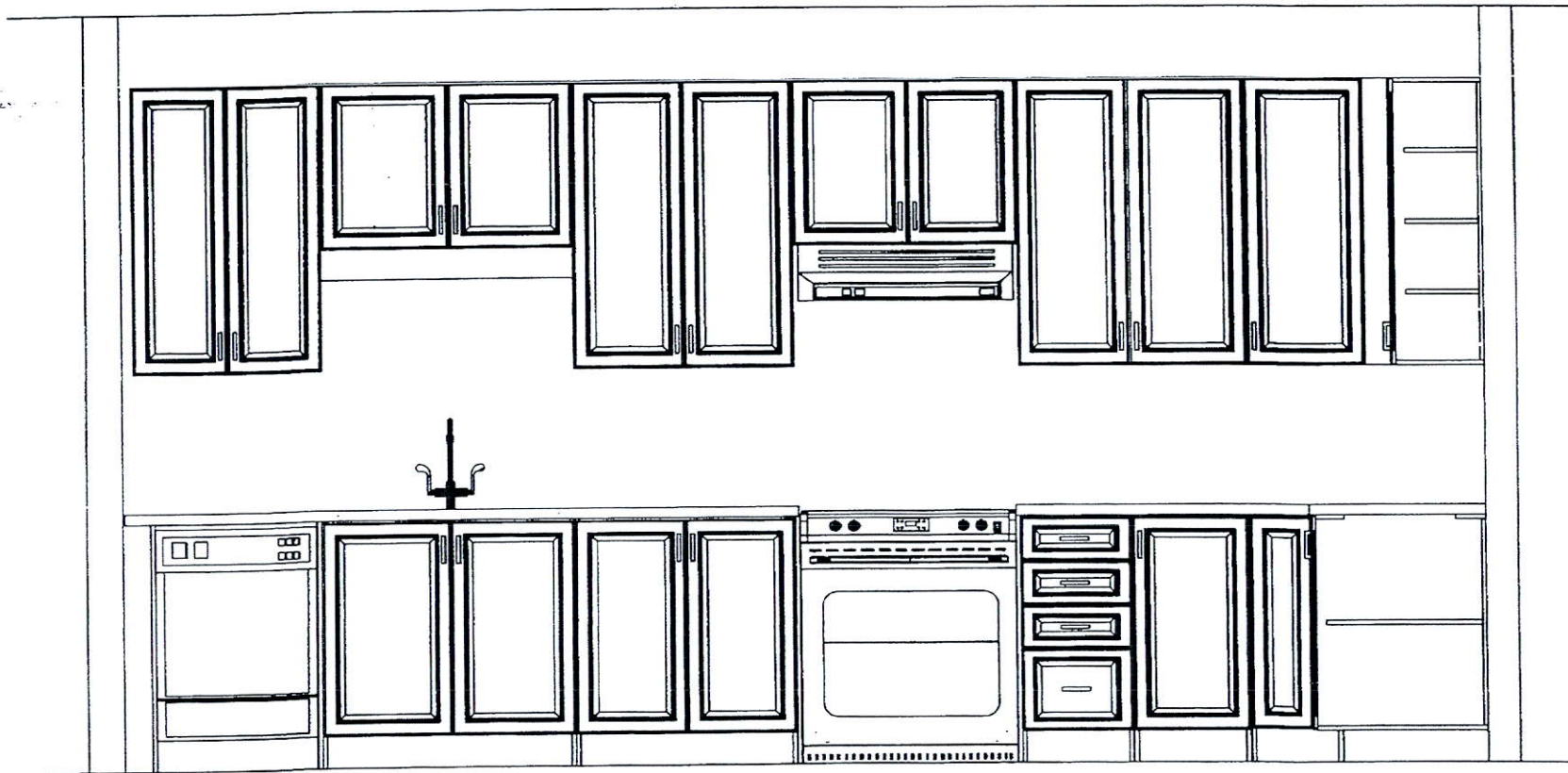

[Handwritten signature]

This drawing is the intellectual property of
SELBA INDUSTRIES INC. and is an
artistic
interpretation of the general
appearance of the design. It is
not meant to be an exact rendition.

SELBA

Kitchen + Bath Designs

Designed: 7/18/2020
Printed: 7/21/2020

Valleycreek 4

All

Drawing # 1

LOT 302
RUSSELL GARDENS
PHASE 3
MOUNTAINVIEW HEIGHTS

VALLEYCREEK 4
ELEV. 3

REVISION:

1. ALTERNATE KITCHEN LAYOUT, RELOCATED SINK, RELOCATE STOVE AS PER SKETCH

[Handwritten initials and signature]

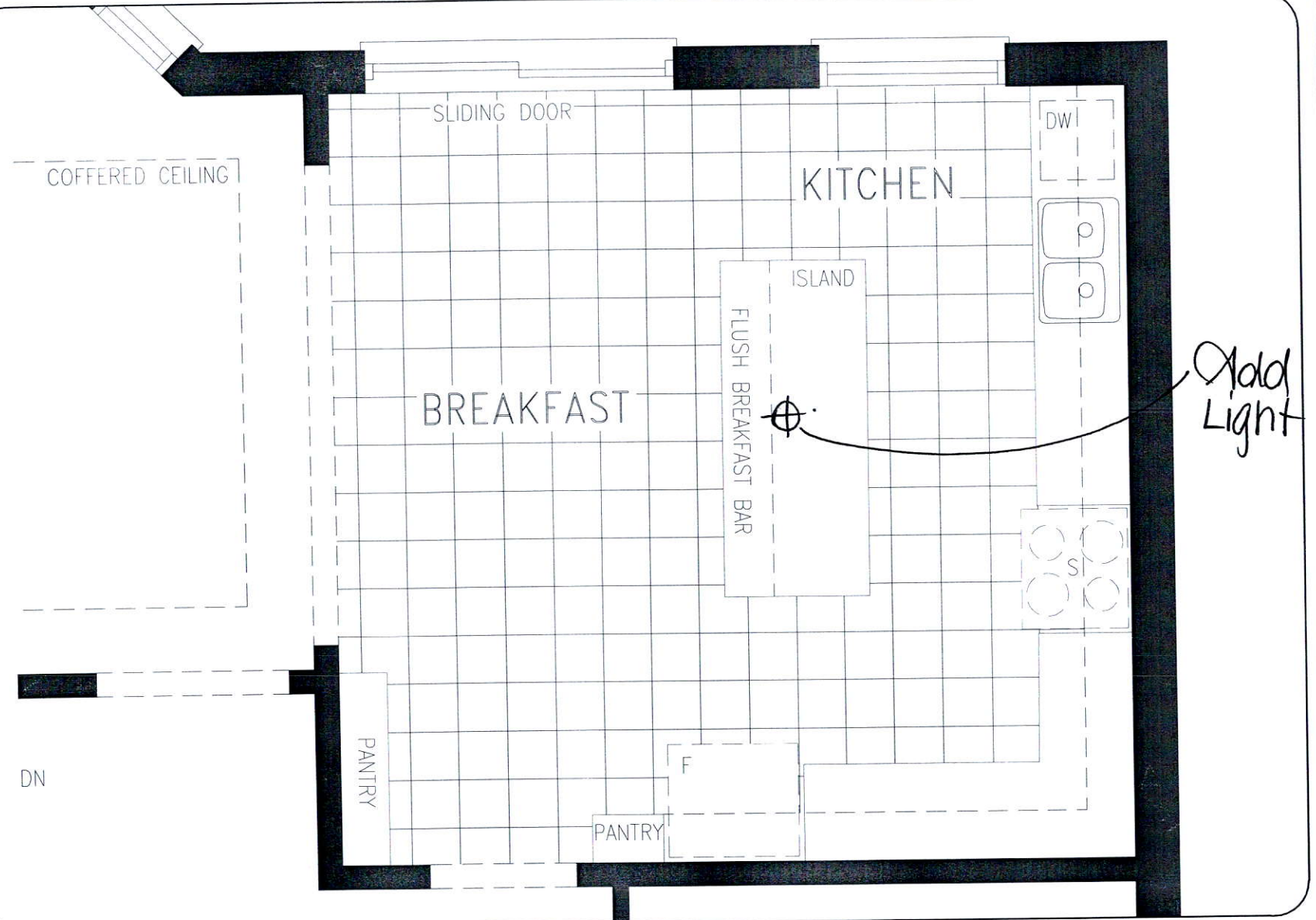

DISCLAIMERS: SKETCH NOT TO SCALE. DIMENSIONS, SPECIFICATIONS AND ARCHITECTURAL DETAILS SUBJECT TO MODIFICATION BY THE VENDOR. SKETCH IS ONLY FOR THE PURPOSE OF ILLUSTRATING REVISIONS REQUESTED BY THE PURCHASER AND ALL REVISIONS ARE SUBJECT TO VENDOR'S FINAL APPROVAL. ONLY REVISIONS ACCEPTED IN WRITING BY THE PURCHASER AND VENDOR ON A PURCHASER'S EXTRA SHEET WILL BE INCORPORATED INTO THE PLANS FILED WITH THE MUNICIPALITY. E. & O.E.

**REGION
DESIGN
INC.**

SCALE
BY VG
PAGE No.
1 OF 1
N.T.S.

Greenpark



Enlarged Basement Windows

Add Plug
Above
Fireplace

REASON
SEE SKETCH

Add Light

Festive Plug

30' x 24'

30' x 24'

RESTROOM

TOILET

HALL

EXIT

KITCHEN

DINING ROOM

LOWER LEVEL

FOUR - FIVE

Architectural floor plan of the upper level of a house. The plan shows five bedrooms, a master bedroom, a master bathroom, a dining room, a kitchen, a breakfast room, a living room, a family room, a terrace, a balcony, and a rear porch. The bedrooms are labeled: MASTER BEDROOM (16'3" x 12'6"), BEDROOM 2 (13'5" x 10'0"), BEDROOM 3 (13'6" x 12'6" x 12'0"), BEDROOM 4 (14'9" x 12'6" x 12'1"), and BEDROOM 5 (12'6" x 12'0"). The master bathroom is labeled 'MASTER BATH'. The dining room is labeled 'DINING ROOM'. The kitchen is labeled 'KITCHEN'. The breakfast room is labeled 'BREAKFAST ROOM'. The living room is labeled 'LIVING ROOM'. The family room is labeled 'FAMILY ROOM'. The terrace is labeled 'TERRACE'. The balcony is labeled 'BALCONY'. The rear porch is labeled 'REAR PORCH'. The plan also shows a 'CLOSET' and a 'CLOSET'.

UPPER LEVEL

VALLEYCREEK FOUR ELEV. 1 • 2,814 sq.ft. | ELEV. 2 • 2,805 sq.ft. | ELEV. 3 • 2,816 sq.ft.

[illegible]